

Attachment # 1

Slat Name	Slat Width	Mesh Size	Wire Gauge	Slats Per Bag
Bottom Lock 2"	1 3/32"	2"	9 or 11	Covers linear fee
Bottom Lock 2 1/4"	1 1/4"	2 1/4"	11 1/2 or 12	Covers linear fee
Bottom Lock 1 3/4"	7/8"	1 3/4" 2"	9 or 11 6	Covers linear fee

Top Locking Slat Semi Privacy

This slat provides an economical and attractive way to enhance any chain link fence. The locking system is located near the top of the slats to ensure a clean, straight edge along the top of the fence.

Design: Top-Locking Slats are flat and tubular in shape, with circular, notched holes located near the top of the slat.

Fast & Easy Installation: Simply insert the slats vertically from top to bottom, keeping the locking holes on top. Then thread the flexible locking channel horizontally through the notched holes in the slats. These holes are elliptical to ensure they always stay open for fast and easy threading.

Standard Heights: 4 ft., 5 ft., 6 ft., 7 ft., 8 ft., 10 ft., 12 ft. Special heights available upon request.

Slat Length: 2" shorter than the overall height of the fence.

Flexible, Top-Locking Channel: Also available on a continuous 200 ft. reel for larger jobs.

Wind Load and Privacy Factor: Approximately 75%.

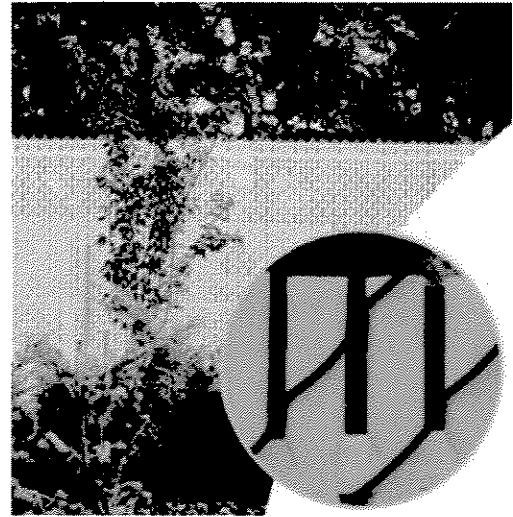

Slat Name	Slat Width	Mesh Size	Wire Gauge	Slats Per Bag
Top Lock 2"	1 3/32"	2"	9 or 11	Covers 10 linear fee
Top Lock 2 1/4"	1 1/4"	2 1/4"	11 1/2 or 12	Covers 10 linear fee
Top Lock 1 3/4"	1" 1"	1 3/4" 2"	11 6	Covers 10 linear fee

* THIS ONE WITH BLACK (FINS) SLATS

Fin Link Slat Supreme Privacy

The FinLink slat provides an increased degree of coverage with a unique configuration of 3 privacy fins. FinLink provides a quality looking installation for many years and is used together with the patented bottom-locking channel. This process ensures that all slats are even in the wire and will not slip to the ground.

Installation: Insert the slats vertically into the fence, from top to bottom, no tools are necessary. Then slip into the bottom locking channel for a clean, level look.

Standard Heights: 4 ft., 5 ft., 6 ft., 7 ft., 8 ft.
Special heights available upon request.

Slat Length: 3.5" shorter than the overall height of the fence.

Wind Load and Privacy Factor: Approximately 90%.



Slat Name	Slat Width	Mesh Size	Wire Gauge	Slats Per Bag
Fin Link	1 3/8"	2" mesh only	11 gauge only	Covers 11 linear feet

Winged Slat Supreme Privacy

When you need increased privacy, Winged Slats are the answer. With the proven quality and durability of our standard slats plus unique "wings" for extra screening and security, these slats are self-locking – no channels are needed!

Unique Patented Design: Includes a rigid, flat tubular body, with "legs" inside for extra support. Flexible and resilient wing portions are positioned on each side of the slat body. Serrations are added to the wings for easier installation and locking power.

Installation: Insert the slats vertically into the fence, from top to bottom, no tool is necessary. That's it! The serrated wings grip the knuckles of the wire mesh, securing the slat in the fence.

Standard Heights: 4 ft., 5 ft., 6 ft., 7 ft., 8 ft.
For heights exceeding 7 ft., we recommend using two half sizes (i.e. for 10 ft. fence use two 5 ft. slats.) This will help during installation and will not lessen privacy.





MILWAUKEE WOMEN'S PRE-RELEASE CENTER
MILWAUKEE, WISCONSIN
21 DECEMBER 2001

LANDSCAPE PLAN
SCALE 1/8" = 1'-0"

Ventura/Architects

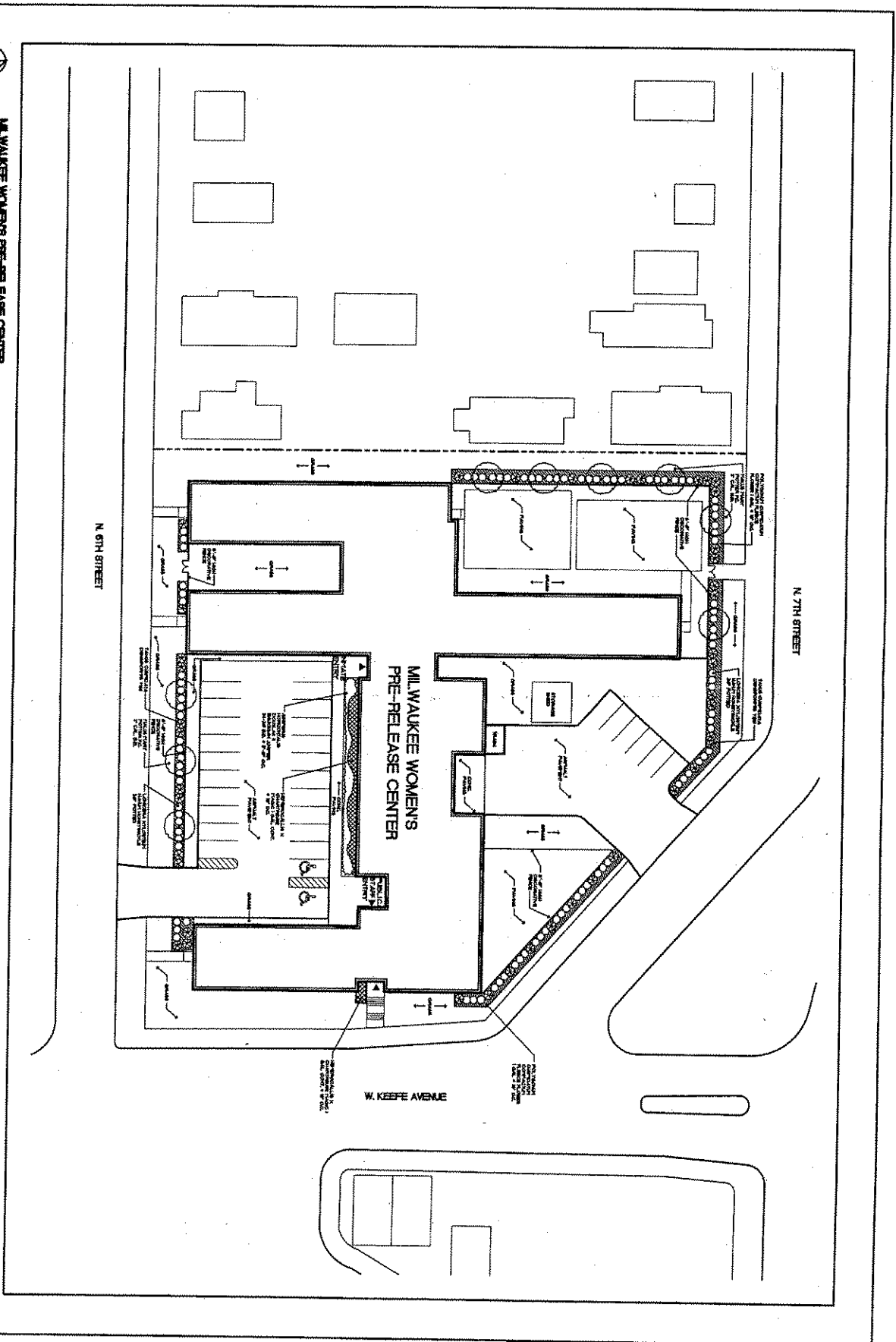

Page 10 - 2 enhanced:
Milwaukee Women's Pre-release
Center
Detailed Planned Dev.

Exhibit A
File No. 011159
POLYGONUM CUSPIDATUM AND/CC
COMPACTUM FLEECE
FLOWER 1 GAL @ 18" O.C.

1/16" = 1 FT

Attachmt. 2B

