

353

354

N.E. 1/4 SEC. 20, T.7N., R.22E.

N.W. 1/4 SEC. 21, T.7N., R.22E.

(80' R.O.W.)

E. Brown St.

St.

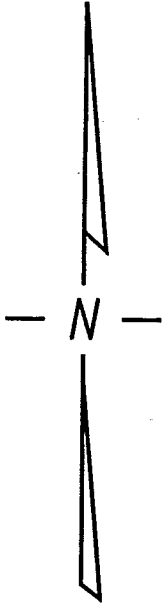

St.

N. Hubbard

St.

(70' R.O.W.)

St.

St.

St.

St.

St.

St.

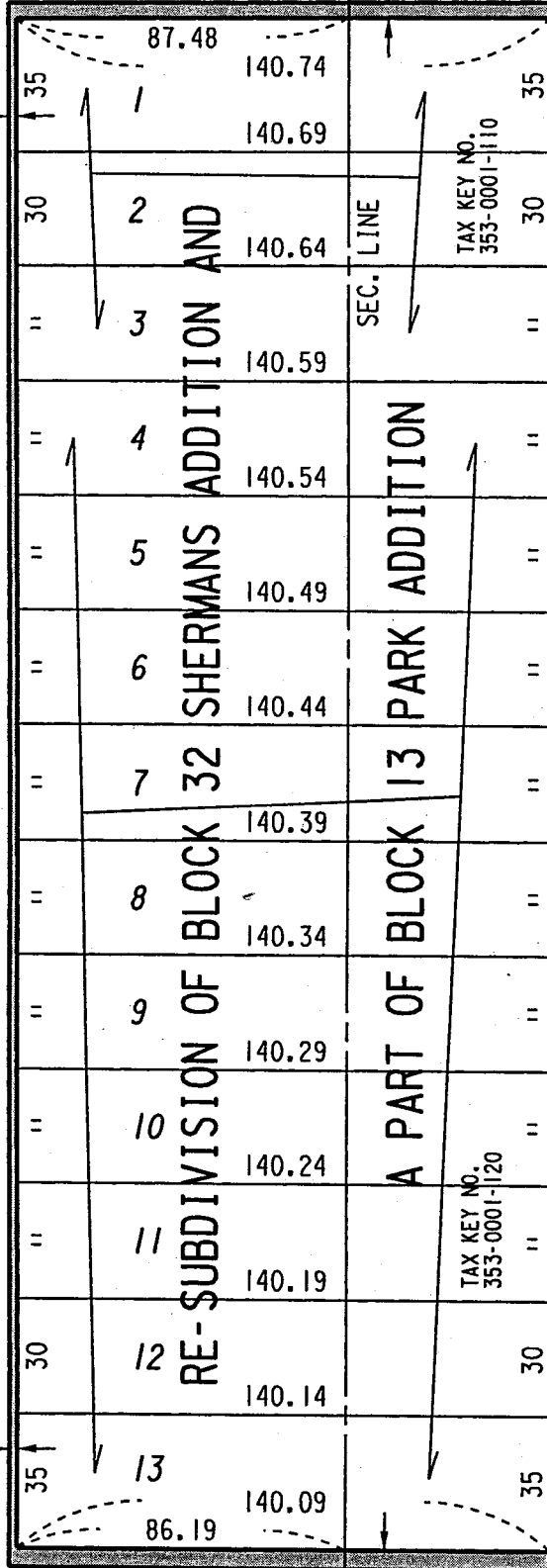

PI.

N. Killian

(50' R.O.W.)

E. Reservoir Ave.

Ave.

(80' R.O.W.)

EXHIBIT "A"

FILE NO. 021642

INFRASTRUCTURE SERVICES DIVISION

MILWAUKEE, WISCONSIN

ASSIGNED TO: W.E. FUCHS

CH'K'D. BY: M.C. WILLIAMS

DRAWN BY: W.E.F.

DATE: JULY 15, 2003

PROJECT/GRANT NO.: WK52337176

SCALE: 1" = 50'

APPROVED BY:

marcia Lindholm  
CENTRAL DRAFTING & RECORDS MANAGER

*[Signature]*  
CITY ENGINEER



PORTIONS OF PUBLIC STREETS PROPOSED TO BE VACATED