



CITY OF MILWAUKEE
OFFICE OF THE CITY CLERK

Wednesday, May 25, 2022

COMMITTEE MEETING NOTICE

AD 06

SEKHON, Parminder S, Agent
Ludhiana Inc
233 W Center St
Milwaukee, WI 53212

You are requested to attend a virtual hearing to be held on:

Tuesday, June 07, 2022 at 01:50 PM

Regarding: Your Class B Fermented Malt Beverage License Application as agent for "Ludhiana Inc" for "Li'l General" at 233 W Center St.



This meeting will be held via GoToMeeting. Please see the enclosed best practices document for further instructions. The access code is <https://meet.goto.com/127717645>. If you wish to call in, please call [+1 \(872\) 240-3212](tel:+18722403212) and use Access Code: [127-717-645](tel:127717645).

There is a possibility that your application may be denied for one or more of the following reasons: The recommendation of the committee regarding the application shall be based on evidence presented at the hearing. Per MCO 85-2.7-4, probative evidence concerning whether or not a new license should be granted may be presented on the following subjects: whether or not the applicant meets the municipal requirements, the appropriateness of the location and premises where the licensed premises is to be located and whether use of the premises for the purposes or activities permitted by the license would tend to facilitate a public or private nuisance or create undesirable neighborhood problems such as disorderly patrons, unreasonably loud noise, litter, and excessive traffic and parking congestion. Probative evidence relating to these matters may be taken from the plan of operation submitted with the license application, if any, but shall not include the content of any music. Evidence regarding the fitness of the location of the premises to be maintained as the principal place of business, including but not limited to whether there is an overconcentration of businesses of the type for which the license is sought; whether the proposal is consistent with any pertinent neighborhood business or development plans, or the location's proximity to areas where children are typically present. The applicant's record in operating similarly licensed premises; and whether or not the applicant has been charged with or convicted of any felony, misdemeanor, municipal offense or other offense, the circumstances of which substantially relate to the activity to be permitted by the license being applied for or any other factor which reasonably relates to the public health, safety or welfare may also be considered. See attached police report or correspondence.

Notice for applicants with warrants or unpaid fines:

Proof of warrant satisfaction or payment of fines must be submitted at the hearing on the above date and time. Failure to comply with this requirement may result in a delay of the granting/denial of your application.

Failure to attend this meeting may result in the denial of your license. Individual applicants and partnership applicants must attend or attend by an attorney. The agent or attorney for corporate or limited liability applicants must attend. If you wish to do so and at your own expense, you may be accompanied by an attorney of your choosing to represent you at this hearing.

You will be given an opportunity to speak on behalf of the application and to respond and challenge any charges or reasons given for the denial. No petitions can be accepted by the committee, unless the people who signed the petition attend the virtual hearing and are willing to testify. You may present witnesses under oath and you may also confront and cross-examine opposing witnesses under oath. If you have difficulty with the English language, you should request an interpreter attend the meeting with you, at your expense, so that you can answer questions and participate in your hearing.

PLEASE NOTE: Upon reasonable notice, efforts will be made to accommodate the needs of disabled individuals through sign language interpreters or other auxiliary aids. For additional information or to request this service, contact the Council Services Division ADA Coordinator at (414) 286-2998, Fax - (414) 286-3456, TDD - (414) 286-2025.

JIM OWCZARSKI, CITY CLERK

BY: _____

Jim Cooney
License Division Manager

If you have questions regarding this meeting, please contact the staff assistant, Yadira Melendez at (414) 286-2775 or stas5@milwaukee.gov

200 E. Wells Street, Room 105, City Hall, Milwaukee, WI 53202. www.milwaukee.gov/license
Phone: (414) 286-2238 Fax: (414) 286-3057 Email Address: License@milwaukee.gov

MILWAUKEE POLICE DEPARTMENT LICENSING

CRIMINAL RECORD/ORDINANCE VIOLATION/INCIDENTS SYNOPSIS

DATE: 06/15/21
LICENSE TYPE: ALQML
NEW:
RENEWAL:

No. 325384
Application Date: 06/14/21

License Location: 233 W Center St
Business Name: Lil General

Licensee/Applicant: HALSELL, Kenneth R
(Last Name, First Name, MI)
Date of Birth: 03/18/1963

Home Address: 2465 N 23rd St
City: Milwaukee State: WI Zip Code: 53206
Home Phone: 414-264-2528

This report is written by Police Officer Corstan D. COURT, assigned to the License Investigation Unit, Days.

The Milwaukee Police Department's investigation regarding this application revealed the following:

1. On 08/11/2018 a 17 year old working in conjunction with the Milwaukee Police Department and WI WINS Tobacco initiative, was able to purchase a 2 pack of Grape Swisher Sweet cigars from the clerk at Lil' General, 233 W. Center St. The clerk stated he did check her ID but only checked the year which was 2000. The applicant was mailed a MART enrollment package.

=====

Previous Premise

Date: 4/11/22
Officer: Monreal

City of Milwaukee Police Department
90-5-1.5 Crime Prevention Survey
Convenience Store/Liquor Store Inspection

Name of Premise: Li'l General
Address: 233 W Center
Phone: 414-374-3473
Owner: Sekhon, Parminder
Owner address: W133N6205 Hummingbird Way
City State Zip: Menomonee Falls, WI 53051
Owner Phone: 414-350-7431
Owner email: psekhon1234@gmail.com

Manager: Same
Home Address:
City State Zip:
Phone:
Email:

Preferred contact: Same

Location currently open: YES NO

Projected open date:

Day's open: S M T W Th F SA ALL

Hours of Operation: Sun: 8A-9P 24 hours Y N
Mon: "
Tue: "
Wed: "
Thu: "
Fri: "
Sat: "

Premise Type: Liquor Store
Convenience Store
Other:

Licenses currently held:

- Alcohol: Yes No
Tobacco: Yes No
Food: Yes No
Extended Hours: Yes No
Secondhand Dealer: Yes No
Other: Yes No
Other: Yes No

Exterior Survey:

1. Is the area around the location clean? Yes No
2. What surrounds the location? (Check all the apply)
 - a. Park
 - b. School
 - c. Youth Center
 - d. Church
 - e. Tavern(s) If so, how many
 - f. Residential
 - g. Other businesses
 - h. Other:
3. Can you see from the outside of the location into the interior Yes No
4. Can you see the employees inside of the location from the outside Yes No
5. Are exterior windows free of signage Yes No
6. Is there a parking lot Yes No
7. Is the parking lot clean? Yes No
8. Is the parking lot well lit? Yes No
9. Are there areas where a person could conceal themselves Yes No
10. Is there exterior lighting? Yes No. Does it appear to be adequate Yes No
11. Are there No Loitering Signs posted? Yes No
12. Are the address numbers prominently displayed and easy to see Yes No

Camera Survey:

13. Does this location have security cameras? Yes No
14. Are they in working order? Yes No
15. What format are the cameras?
 - a. Color Yes No
 - b. Digital Yes No
 - c. VCR Yes No
 - d. Recorded Yes No
16. Are there exterior cameras Yes No How many? 3
17. Are there interior cameras Yes No How many? 13
18. Are at least two high-resolution surveillance security cameras installed? Yes No
19. Does one camera show an overall view of the counter and register area? Yes No
20. Does one camera show a clear, identifiable, full frame image of the face of each person entering and leaving the store? Yes No
21. Are the camera views obstructed by fixtures or displays? Yes No

22. Is the recorded footage stored for at least 30 days? Yes No
23. Do all store employees know how to record footage from the camera system to media capable of being transferred to police custody? Yes No

Interior Survey:

24. Is the storeowner willing to be a standing complainant regarding loitering? Yes No
25. Is the interior of the location neat and clean? Yes No
26. Does an interior camera face the entrance/exit? Yes No
27. Is there a lockable area that separates employees from customers? Yes No
28. Does the store sell single chore boy? Yes No
29. Does the store sell blunt wraps? Yes No
30. Does the store sell scales? Yes No
31. Does the store sell items that may be used as crack pipes? Yes No
- a. Describe item
32. Does the store have an over abundance of sandwich baggies: Yes No
33. Does the owner understand that these items are often used for drug use? Yes No
34. Do the products in the store appear to be new and rotated often? Yes No
35. Are emergency and non-emergency numbers posted near the phone? Yes No
36. Does the owner know how to contact their police district directly? Yes No
- a. Did you provide a district contact guide to the owner? Yes No

Complete this section if alcohol establishment is a convenience store:

(** Read full ordinance for all details "68-4.3 Convenience Food Stores")

All convenience food stores not exempted under sub. 3 shall:

1. Is the cash register located in a manner so that at the time of a sales transaction, the employee and customer are both visible from the sidewalk? Yes No **
2. Are the glass entrance and exit doors clear of any signs or advertisements with the exception of a sign which states that the cash register contains \$50 or less and that the safe is no accessible to employees? Yes No
3. Does the store maintain one of the following on the licensed premise?
 - a. A safe that was in use at the convenience food store on August 17, 1994? Yes No
 - b. A drop-safe or time release safe that weighs at least 500 pounds or which is attached to or set into the floor in a manner approved by the police department? Yes No
4. Is lighting provided for the store's parking area during all hours of darkness when employees or customers are on the premises at a minimum average of 2-foot candles per square foot, unless the store is not open for business after sunset and before sunrise? Yes No N/A
5. Are customer entrances/exits made of glass or other transparent material? Yes No
 - a. Exception: A store that does not have such doors on August 17, 1994 shall not be required to install such doors until the holder of the store's food dealer license changes.
6. Has the owner and their employees attended the Robbery Prevention Training within 120 days of ownership or employment? Yes No
 - a. Contact Community Outreach and Education at 935-7836 for schedule.

Sub 3. Exemptions. The requirements of this section do not apply to a convenience food store that conforms to either of the following descriptions:

a-1. The store is located in an enclosed shopping structure, enclosed commercial building or hospital. A convenience food store is not in an enclosed structure or building if a customer can enter it directly from the outside.

Does store conform to a-1 Yes No

a-2 The store physically separates employees from customers with a solid partition that bars a person from entering the employee area from the customer area, has a secure lock on the employee side of any door between the employee area and the customer, and conducts all transaction through a service window or similar arrangement.

Does store conform to a-2 Yes No

a. At the commissioner's discretion, a convenience store may be exempted from any or all of the regulations specified in sub 2.

Does this location hold an exemption from the commissioner regarding any of the requirements of Sub 2? Yes No

ADDITIONAL COMMENTS/RECOMMENDATIONS:

Advised the agent to contact Community Outreach regarding Robbery Prevention 4/13



Concentration Map - 233 W Center ST

Area of Interest (AOI) Information

Area : 21,862,585.93 ft²

Mar 18 2022 14:28:39 Central Daylight Time

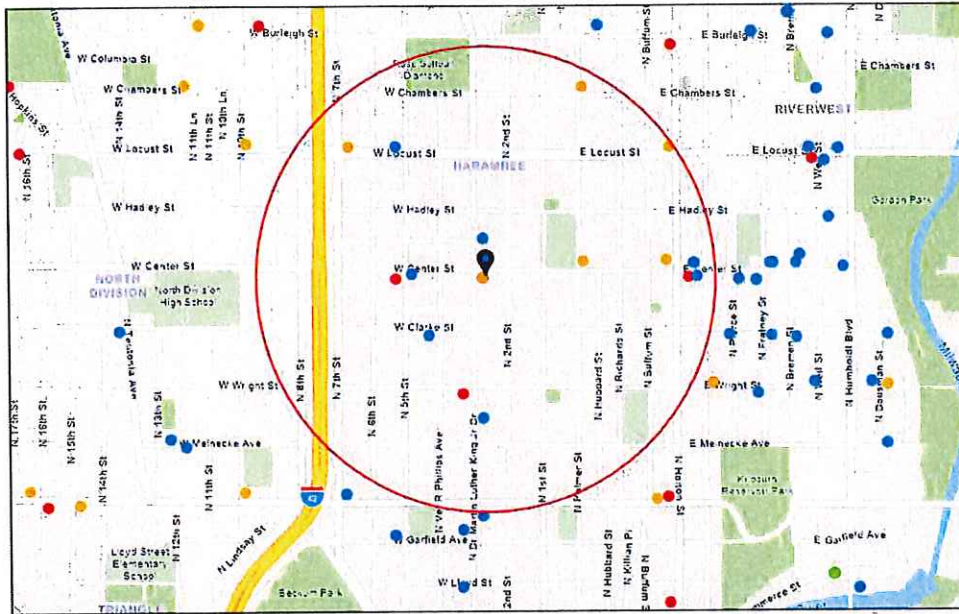

- | | | |
|-----------------------------------|-----------------------------------|-------------------------|
| ● Class A Intoxicating Liquor | ● Class A Liquor and Malt | ● Class C Wine Retailer |
| ● Class A Fermented Malt Beverage | ● Class B Fermented Malt Beverage | □ City Limits |
| ● Class B Tavern | | |

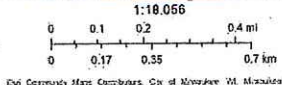

3/18/2022

Summary

Name	Count	Area(ft ²)	Length(mi)
Alcohol Licenses	18		

Alcohol Licenses

#	Legal Entity	Trade Name	Licensee	Address	License Type Name	Total Capacity	Expiration Date	Count
1	Center Street Liquor Store Inc	Center Street Liquor Store	Charanjit Kaur, Agt	513 E Center ST	Class A Malt & Class A Liquor License		12/15/2021, 6:00 PM	1
2	SINGH & WADE, INC	7TH STREET FOODS	JATINDER SINGH, Agt	2900 N 7TH ST	Class A Fermented Malt Beverage Retailer's License		1/13/2022, 6:00 PM	1
3	KISMAYO, LLC	CLUB TIMBUKTU	YOUSOUF KOMARA, Agt	520 E CENTER ST	Class B Tavern License	160	12/19/2021, 6:00 PM	1
4	ED'S LOUNGE	ED'S LOUNGE	Larissa L Sharkey, SP	2678 N 5TH ST	Class B Tavern License	80	2/28/2022, 6:00 PM	1
5	Tittu Rehmat Food Inc	Tittu Rehmat Food	Parminder Kaur, Agt	418 E CENTER ST	Class A Fermented Malt Beverage Retailer's License		2/15/2022, 6:00 PM	1
6	Lux2 LLC	Lux	THOMAS J HOLMES, Agt	2712 N MARTIN L KING JR DR	Class B Tavern License		2/9/2022, 6:00 PM	1
7	BALVINDER JASPAL, INC.	Freedom Grocery	Balvinder Singh, Agt	2909 N HOLTON ST	Class A Fermented Malt Beverage Retailer's License		4/15/2022, 7:00 PM	1
8	AR & A2 INC	Center Street Liquor	Rupinder Kaur, Agt	2667 N 5TH ST	Class A Malt & Class A Liquor License		3/24/2022, 7:00 PM	1
9	Mann Family, LLC	Palmer Center Foods	Jatinder K Mann, Agt	200 E Center ST	Class A Fermented Malt Beverage Retailer's License		4/11/2022, 7:00 PM	1
10	Chamber East Food Market LLC	Chamber East Food	Davinderjit Kaur, Agt	200 E Chambers ST	Class A Fermented Malt Beverage Retailer's License		4/20/2022, 7:00 PM	1
11	MLK QUE, LLC	Q	Darnell D Ashley, Agt	2730 N Martin L King Jr DR	Class B Tavern License		4/20/2022, 7:00 PM	1
12	Mann Family LLC	AJ King Drive Liquor and Foods	Jatinder K Mann, Agt	2469 N Martin L King Jr DR	Class A Malt & Class A Liquor License		4/27/2022, 7:00 PM	1
13	Ludhiana Inc	Li'l General	KENNETH R HALSELL, Agt	233 W Center ST	Class A Retailer's Intoxicating Liquor License		8/1/2022, 7:00 PM	1
14	Mad Planet 2, LLC	The Mad Planet	ROSEMARY S SILAGY, Agt	533 E Center ST	Class B Tavern License		7/14/2022, 7:00 PM	1
15	Ludhiana Inc	Li'l General	KENNETH R HALSELL, Agt	233 W Center ST	Class A Fermented Malt Beverage Retailer's License		8/1/2022, 7:00 PM	1

3/18/2022

16	BETTIE'S & EDDIE'S CLUB MANHATTAN	BETTIE'S & EDDIE'S CLUB MANHATTAN	VALARIE J WINGO, SP	2573 N VEL R PHILLIPS AV	Class B Tavern License	80	8/30/2022, 7:00 PM	1
17	Jo-Will, LLC	Savoy's	Tina L Johnson-Williams, Agt	2901 N 5TH ST	Class B Tavern License		9/19/2022, 7:00 PM	1
18	Great Day Investments, Inc.	Tee's Lounge	Timothy Day, Agt	2436 N MARTIN L KING JR DR	Class B Tavern License		11/5/2022, 7:00 PM	1

Establishments within a 0.5 miles radius centered on area of interest.



**CITY OF MILWAUKEE
OFFICE OF THE CITY CLERK**

Wednesday, May 25, 2022

COMMITTEE MEETING NOTICE

AD 06

SEKHON, Parminder S, Agent
Ludhiana Inc
W133 N6205 HUMMINGBIRD WAY
Menomonee Falls, WI 53051

You are requested to attend a virtual hearing to be held on:

Tuesday, June 07, 2022 at 01:50 PM

Regarding: Your Class B Fermented Malt Beverage License Application as agent for "Ludhiana Inc" for "Li'l General" at 233 W Center St.

This meeting will be held via GoToMeeting. Please see the enclosed best practices document for further instructions. The access code is <https://meet.goto.com/127717645>. If you wish to call in, please call [+1 \(872\) 240-3212](tel:+18722403212) and use Access Code: 127-717-645.

There is a possibility that your application may be denied for one or more of the following reasons: The recommendation of the committee regarding the application shall be based on evidence presented at the hearing. Per MCO 85-2.7-4, probative evidence concerning whether or not a new license should be granted may be presented on the following subjects: whether or not the applicant meets the municipal requirements, the appropriateness of the location and premises where the licensed premises is to be located and whether use of the premises for the purposes or activities permitted by the license would tend to facilitate a public or private nuisance or create undesirable neighborhood problems such as disorderly patrons, unreasonably loud noise, litter, and excessive traffic and parking congestion. Probative evidence relating to these matters may be taken from the plan of operation submitted with the license application, if any, but shall not include the content of any music. Evidence regarding the fitness of the location of the premises to be maintained as the principal place of business, including but not limited to whether there is an overconcentration of businesses of the type for which the license is sought; whether the proposal is consistent with any pertinent neighborhood business or development plans, or the location's proximity to areas where children are typically present. The applicant's record in operating similarly licensed premises; and whether or not the applicant has been charged with or convicted of any felony, misdemeanor, municipal offense or other offense, the circumstances of which substantially relate to the activity to be permitted by the license being applied for or any other factor which reasonably relates to the public health, safety or welfare may also be considered. See attached police report or correspondence.

Notice for applicants with warrants or unpaid fines:

Proof of warrant satisfaction or payment of fines must be submitted at the hearing on the above date and time. Failure to comply with this requirement may result in a delay of the granting/denial of your application.

Failure to attend this meeting may result in the denial of your license. Individual applicants and partnership applicants must attend or attend by an attorney. The agent or attorney for corporate or limited liability applicants must attend. If you wish to do so and at your own expense, you may be accompanied by an attorney of your choosing to represent you at this hearing.

You will be given an opportunity to speak on behalf of the application and to respond and challenge any charges or reasons given for the denial. No petitions can be accepted by the committee, unless the people who signed the petition attend the virtual hearing and are willing to testify. You may present witnesses under oath and you may also confront and cross-examine opposing witnesses under oath. If you have difficulty with the English language, you should request an interpreter attend the meeting with you, at your expense, so that you can answer questions and participate in your hearing.

PLEASE NOTE: Upon reasonable notice, efforts will be made to accommodate the needs of disabled individuals through sign language interpreters or other auxiliary aids. For additional information or to request this service, contact the Council Services Division ADA Coordinator at (414) 286-2998, Fax - (414) 286-3456, TDD - (414) 286-2025.

JIM OWCZARSKI, CITY CLERK

BY: _____

Jim Cooney
License Division Manager

If you have questions regarding this meeting, please contact the staff assistant, Yadira Melendez at (414) 286-2775 or stasst5@milwaukee.gov

200 E. Wells Street, Room 105, City Hall, Milwaukee, WI 53202. www.milwaukee.gov/license
Phone: (414) 286-2238 Fax: (414) 286-3057 Email Address: License@milwaukee.gov



Wednesday, May 25, 2022



Notice of Public Hearing

Blank Notice

SEKHON, Parminder S
Li'l General at 233 W Center St.
Class B Fermented Malt Beverage License Application

Tuesday, June 07, 2022 at 01:50 PM

To whom it may concern:

The above application has been made by the above named applicant(s). This requires approval from the Licenses Committee and the Common Council of the City of Milwaukee. The hearing before the Licenses Committee will take place virtually on 06/07/2022 at 01:50 PM. This is a public hearing. Those wishing to view the proceeding are able to do so via the City Channel – Channel 25 on Spectrum Cable – or on the Internet at <http://city.milwaukee.gov/citychannel>. Those wishing to provide oral testimony will be asked to do so by phone or internet and are asked to contact the staff assistant, Yadira Melendez at (414) 286-2775 or stasst5@milwaukee.gov for necessary information. Please make such requests no later than one business day prior to the start of the meeting. You are not required to attend the hearing, but please see the information below if you would like to provide testimony. Once the Licenses Committee makes its recommendation, this recommendation is forwarded to the full Common Council for approval at its next regularly scheduled hearing.

Important details for those wishing to provide information for the Licenses Committee to consider when making its recommendation:

1. The license application is scheduled to be heard at the above time. Due to other hearings running longer than scheduled, you may have to wait some time to provide your testimony.
2. You must testify as to matters that you have personally experienced or seen. (You cannot provide testimony for your neighbor, parent or anyone else; this is considered hearsay and cannot be considered by the committee.)
3. No letters or petitions can be accepted by the committee (unless the person who wrote the letter or the persons who signed the petition are willing to testify).
4. Persons opposed to the license application are given the opportunity to testify first; supporters may testify after the opponents have finished.
5. When you are called to testify, you will be sworn in and asked to give your name, and address. (If your first and/or last names are uncommon please spell them.)
6. You may then provide testimony.
 - a. Include only information relating to the above license application.
 - b. Include only information you have personally witnessed or seen.
 - c. Provide concise and relevant information detailing how this business has affected or may affect the peaceful enjoyment of your neighborhood.
 - d. If by the time you have the opportunity to testify, the information you wish to share has already been provided to the committee, you may state that you agree with the previous testimony. Redundant or repetitive testimony will not assist the committee in making its recommendation.
7. After giving your testimony, the members of the Licenses Committee and the licensee may ask questions regarding the testimony you have given or other factors relating to the license application.
8. Business Competition is not a valid basis for denial or non-renewal of a license.

Please Note: If you have submitted an objection to the above application your objection cannot be considered by the committee unless you personally testify at the hearing.

OCCUPANT	MAIL ADDRESS	CITY STATE ZIP
CURRENT OCCUPANT	200 W CENTER ST	MILWAUKEE, WI 53212-2863
CURRENT OCCUPANT	212 W CENTER ST	MILWAUKEE, WI 53212-2863
CURRENT OCCUPANT	2629 N 2ND ST	MILWAUKEE, WI 53212-2812
CURRENT OCCUPANT	2633 N 2ND ST	MILWAUKEE, WI 53212-2812
CURRENT OCCUPANT	2635 N 2ND ST	MILWAUKEE, WI 53212-2812
CURRENT OCCUPANT	2637 N 2ND ST	MILWAUKEE, WI 53212-2812
CURRENT OCCUPANT	2639 N 2ND ST	MILWAUKEE, WI 53212-2812
CURRENT OCCUPANT	2653 N 2ND ST	MILWAUKEE, WI 53212-2812
CURRENT OCCUPANT	2660 N VEL R PHILLIPS AVE	MILWAUKEE, WI 53212-2716
CURRENT OCCUPANT	2661 N 2ND ST	MILWAUKEE, WI 53212-2812
CURRENT OCCUPANT	2661 N MARTIN L KING JR DR	MILWAUKEE, WI 53212-2711
CURRENT OCCUPANT	2663 N 2ND ST	MILWAUKEE, WI 53212-2812
CURRENT OCCUPANT	2663 N MARTIN L KING JR DR	MILWAUKEE, WI 53212-2711
CURRENT OCCUPANT	2663A N 2ND ST	MILWAUKEE, WI 53212-2812
CURRENT OCCUPANT	2664 N 2ND ST	MILWAUKEE, WI 53212-2813
CURRENT OCCUPANT	2665 N 2ND ST	MILWAUKEE, WI 53212-2812
CURRENT OCCUPANT	2666 N 2ND ST	MILWAUKEE, WI 53212-2813
CURRENT OCCUPANT	2670 N 2ND ST	MILWAUKEE, WI 53212-2813
CURRENT OCCUPANT	2670 N VEL R PHILLIPS AVE	MILWAUKEE, WI 53212-2716
CURRENT OCCUPANT	2670A N VEL R PHILLIPS AVE	MILWAUKEE, WI 53212-2716
CURRENT OCCUPANT	2670B N VEL R PHILLIPS AVE	MILWAUKEE, WI 53212-2716
CURRENT OCCUPANT	2670C N VEL R PHILLIPS AVE	MILWAUKEE, WI 53212-2716
CURRENT OCCUPANT	2671 N 2ND ST	MILWAUKEE, WI 53212-2812
CURRENT OCCUPANT	2672 N 2ND ST	MILWAUKEE, WI 53212-2813
CURRENT OCCUPANT	2673 N 2ND ST	MILWAUKEE, WI 53212-2812
CURRENT OCCUPANT	2705 N 2ND ST	MILWAUKEE, WI 53212-2407
CURRENT OCCUPANT	2705 N 2ND ST, A	MILWAUKEE, WI 53212-2407
CURRENT OCCUPANT	2705 N MARTIN L KING JR DR, D	MILWAUKEE, WI 53212-2385
CURRENT OCCUPANT	2705 N MARTIN L KING JR DR, E	MILWAUKEE, WI 53212-2385
CURRENT OCCUPANT	2705 N MARTIN L KING JR DR, F	MILWAUKEE, WI 53212-2385
CURRENT OCCUPANT	2710 N MARTIN L KING JR DR	MILWAUKEE, WI 53212-2312
CURRENT OCCUPANT	2714 N MARTIN L KING JR DR	MILWAUKEE, WI 53212-2312
CURRENT OCCUPANT	2719 N MARTIN L KING JR DR, 201	MILWAUKEE, WI 53212-2382
CURRENT OCCUPANT	2719 N MARTIN L KING JR DR, 202	MILWAUKEE, WI 53212-2382
CURRENT OCCUPANT	2719 N MARTIN L KING JR DR, 203	MILWAUKEE, WI 53212-2382
CURRENT OCCUPANT	2719 N MARTIN L KING JR DR, 204	MILWAUKEE, WI 53212-2382
CURRENT OCCUPANT	2719 N MARTIN L KING JR DR, 205	MILWAUKEE, WI 53212-2382
CURRENT OCCUPANT	2719 N MARTIN L KING JR DR, 206	MILWAUKEE, WI 53212-2382
CURRENT OCCUPANT	2719 N MARTIN L KING JR DR, 207	MILWAUKEE, WI 53212-2382
CURRENT OCCUPANT	2719 N MARTIN L KING JR DR, 209	MILWAUKEE, WI 53212-2382
CURRENT OCCUPANT	2719 N MARTIN L KING JR DR, 211	MILWAUKEE, WI 53212-2382
CURRENT OCCUPANT	2719 N MARTIN L KING JR DR, 301	MILWAUKEE, WI 53212-2382
CURRENT OCCUPANT	2719 N MARTIN L KING JR DR, 302	MILWAUKEE, WI 53212-2382
CURRENT OCCUPANT	2719 N MARTIN L KING JR DR, 303	MILWAUKEE, WI 53212-2382
CURRENT OCCUPANT	2719 N MARTIN L KING JR DR, 304	MILWAUKEE, WI 53212-2382
CURRENT OCCUPANT	2719 N MARTIN L KING JR DR, 305	MILWAUKEE, WI 53212-2382

CURRENT OCCUPANT	2719 N MARTIN L KING JR DR, 306	MILWAUKEE, WI 53212-2382
CURRENT OCCUPANT	2719 N MARTIN L KING JR DR, 307	MILWAUKEE, WI 53212-2382
CURRENT OCCUPANT	2719 N MARTIN L KING JR DR, 308	MILWAUKEE, WI 53212-2382
CURRENT OCCUPANT	2719 N MARTIN L KING JR DR, 309	MILWAUKEE, WI 53212-2382
CURRENT OCCUPANT	2719 N MARTIN L KING JR DR, 310	MILWAUKEE, WI 53212-2382
CURRENT OCCUPANT	2719 N MARTIN L KING JR DR, 311	MILWAUKEE, WI 53212-2382
CURRENT OCCUPANT	2719 N MARTIN L KING JR DR, 312	MILWAUKEE, WI 53212-2382
CURRENT OCCUPANT	2724 N MARTIN L KING JR DR, 1	MILWAUKEE, WI 53212-2312
CURRENT OCCUPANT	2724 N MARTIN L KING JR DR, 2	MILWAUKEE, WI 53212-2312
CURRENT OCCUPANT	2724 N MARTIN L KING JR DR, 3	MILWAUKEE, WI 53212-2312
CURRENT OCCUPANT	2724 N MARTIN L KING JR DR, 4	MILWAUKEE, WI 53212-2312
CURRENT OCCUPANT	310 W CENTER ST, A	MILWAUKEE, WI 53212-2755
CURRENT OCCUPANT	310 W CENTER ST, B	MILWAUKEE, WI 53212-2755
CURRENT OCCUPANT	310 W CENTER ST, C	MILWAUKEE, WI 53212-2755

Blank Notice

Total Records: 60

Radius 250.0 feet and Center of Circle: 233 W Center St



BUSINESS LICENSE PLAN OF OPERATION

ccl-busplan 5/12/2020

Office of the City Clerk License Division
200 E. Wells St. Room 105, Milwaukee, WI 53202
(414) 286-2238 www.milwaukee.gov/license e-mail address: license@milwaukee.gov

1. Type of Business

- Applying for: Extended Hours (12AM to 5AM) - If a food establishment, check all that apply: Delivery Drive Thru Dining Room
- Self Service Laundry Massage Establishment Filling Station
- Other (supplemental application for specific license also required)

Provide a detailed description of the type of business you plan on operating:
To provide space to customers to set and consume Beer, Soda and food items.

Do you have any experience operating this type of business? No Yes If yes, explain:

2. Business Operations

- a. Proposed Opening Date: *As soon as we get Permit*
- b. Is this premise under construction? No Yes If yes, list estimated completion date: _____
- c. Is this a franchise? No Yes
- d. Is this premises currently licensed? No Yes If yes, list type of license: *Class A Malt. / Food Dealer.*
- e. Is the current licensee operating? No Yes If no, list date closed: _____
- f. Do you have future plans for other businesses, licenses or permits at this location? No Yes
If yes, explain: _____
- g. Have you previously held an Extended Hours License in Milwaukee? No Yes
If yes, list address(es): _____
- h. Are other businesses operating in the same building? No Yes If yes, describe: _____

3. Litter & Noise

- a. How are grounds kept clean? Sweep Pressure Wash Pick Up Litter Other: _____
- b. How often will grounds be cleaned? Daily Weekly As Needed Monthly Other: _____
- c. Grounds cleaned by: Licensee Building Owner Employees Hired Maintenance Other: _____
- d. How are noise issues prevented and/or addressed? Security Manager approaches customer(s) Call Police
 Signs Posted Other: _____
- e. Will a sound amplification system be used? No Yes If yes, describe: _____

4. Smoking & Sanitation

- a. Are there designated outdoor smoking areas? No Yes If yes, describe: _____
- b. Number of Garbage Cans: Inside: *2* Locations: *By lottery center / By cashier*
Outside: *2* Locations: *Both by entrance*
- c. Is a crowd control barrier used? No Yes If yes, describe: _____
- d. How many restrooms are on the premises? *ONE*
- e. Name of solid waste contractor: Advanced Disposal Waste Management Other: *Eagle Disposal*

5. Security

- a. Are there onsite parking spaces? No Yes If yes, how many? 15 and describe the parking security plan: We have 3 Security Cameras
- b. Is there a loading zone? No Yes If yes, describe the loading area security plan: _____
- c. Will you have security personnel on premise? No Yes If yes, how many? _____ and answer the following:
 What are their responsibilities? _____
 Is security equipment used? No Yes If yes, describe _____
 List their licensing, certification, or training credentials _____
- d. Will there be security cameras? No Yes If yes, how many? 17 and list locations: 13 outside 14 inside
- e. Will searches/identification checks be done upon entry? No Yes If yes, describe _____

6. Percentage of Sales (must total 100%)

Alcohol <u>10</u> %	Food <u>70</u> %	Secondhand Merchandise _____ %	Precious Metals & Gems _____ %
Entertainment _____ %	Cigarettes <u>20</u> %	Personal Services (such as tattoo, body piercing, salon, tailor, tanning, etc.) _____ %	Other _____ %
Pawnbroker Activity _____ %	Salvaged Materials _____ % (such as scrap metal)		Describe: _____

7. Businesses/Licenses on the Premises (check all that apply)

- Type 1**
- Full Service Restaurant
 - Night Club
 - Banquet Hall
 - Hotel/Motel : Number of Floors: _____ Number of Rooms: _____
 - Cafe/Coffee Shop
 - Tavern
 - Sports Facility
 - Rooming House: Number of Floors: _____ Number of Rooms: _____
 - Deli or Fast Food Restaurant
 - Cocktail Lounge
 - Bowling Alley
 - Private/Fraternal/Veterans Club
 - Teen Club

- Type 2**
- Liquor Store
 - Gas Station
 - Used Car Dealer
 - Corner Store
 - Amusement/Phonograph Distributor
 - Personal Service Establishment (such as tattoo business, hair salon, tailor, etc.)
 - Supermarket
 - Convenience Store
 - Recycling, Salvage or Towing
 - Recording Studio
- What other licenses/permits will you hold at this location? (check all that apply)
- Occupancy Permit
 - Cigarette & Tobacco
 - Gas Station
 - Extended Hours
 - Class "B" Tavern
 - Weights & Measures
 - Secondhand Dealer
 - Precious Metal & Gem
 - Other: _____

8. Legal Capacity (only if a Type 1 premises in #7 above)

Capacity _____ (Call the Milwaukee Development Center at 414-286-8211 if you have questions.)

9. Premises Description

- a. Identify all area(s) of the premises that will be used in operating this business (include areas used only for storage):
 1st Floor 2nd Floor Basement Storage Patio Beer Garden Sidewalk Café Deck Rooftop
 Other: Describe: _____
- b. Describe Location: Major Thoroughfare Secondary Street Other: _____
- c. Nearest Major Cross Street: DR MILK DR And Center St.
- d. Describe Building: Free Standing Building Strip Mall Other: _____
- e. Describe Premises Structure: Single Story Multi-Story - # of Stories _____ Other: _____
- f. Describe Surrounding Area: Commercial Residential Industrial Other: _____
- g. Building Owner Name: PATIOLA INC. Phone Number: (414) 374-3473
 Building Owner Address: 233 W CENTER ST MILWAUKEE WI 53212.

10. Hours of Operation & Customers

Will customers be entering the premises? No Yes

Day of the Week	Proposed Hours of Operation:		Estimated Number of Customers expected each day	Potential Age Range of Customers	Class B Tavern Applicant Only: Age Restriction (If none, write 'None')
	Open Time (include a.m. or p.m.)	Close Time (include a.m. or p.m.)			
Sunday	9 AM → 8 PM	8 PM	5 → 10	above 21 yrs	Above 21 YRS
Monday	9 AM → 8 PM	8 PM	5 → 10		
Tuesday	9 AM → 8 PM	8 PM	5 → 10		
Wednesday	9 AM → 8 PM	8 PM	5 → 10		
Thursday	9 AM → 8 PM	8 PM	5 → 10		
Friday	9 AM → 8 PM	8 PM	5 → 10		
Saturday	9 AM → 8 PM	8 PM	5 → 10		

An Extended Hours Establishment License is required for any convenience store, filling station, personal service establishment (such as tattoo, body piercing, salon, tailor, tanning, etc.), recording studio or restaurant which is open between the hours of 12:00 a.m. and 5:00 a.m.

Alcohol Establishments Permitted Hours of Operation: Class A: 8:00 am to 9:00 pm Sunday thru Saturday
 Class B: 6:00 am to 2:00 am Sunday thru Thursday, 6:00 am to 2:30 am Friday & Saturday

Entertainment Outdoor Closing Hours: 10:00pm Sunday-Thursday; 12:00am Friday & Saturday; unless a different time, either earlier or later, is established by the Common Council in its approval of the licensee's plan of operation.

11. Signature(s)

 Signature of Sole Proprietor, Partner, or 20% or more Shareholder
 (If there are no 20% or more shareholders, Corporate Officer-print name/title and sign)

 Signature of additional partner or 20% or more shareholder

See Application Information for a complete list of all required application forms.

dba L I 'Z General
233 W Center St

Milwaukee, WI 53212

W CENTER STREET

150.00'

Total
Square
Footage
17,437.5'

116.25'

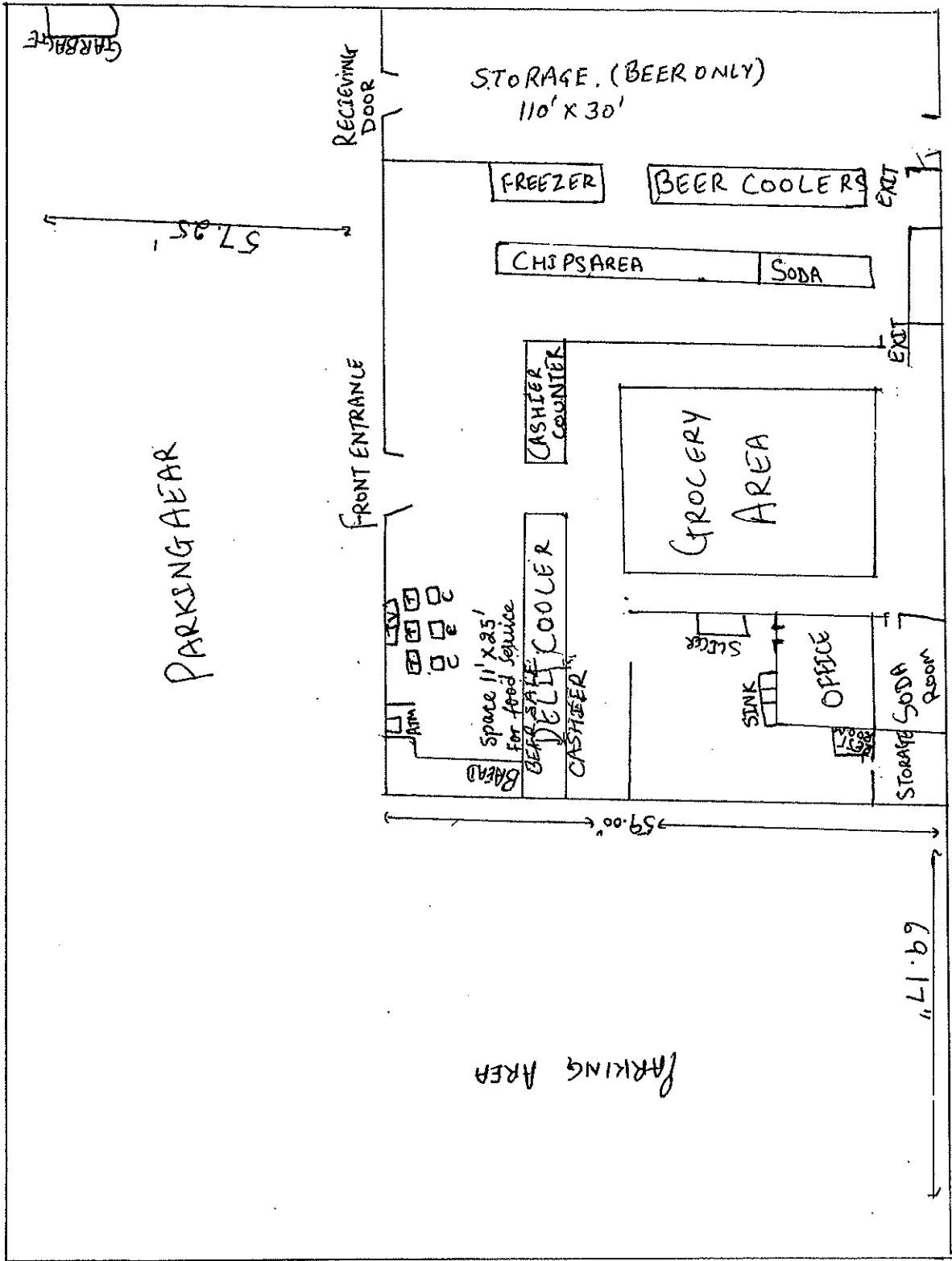

EMERGENCY
EXIT

80.83

150.00'

PARKING AREA

DR MLK DRIVE