



**CITY OF MILWAUKEE  
OFFICE OF THE CITY CLERK**

Monday, May 11, 2020

**COMMITTEE MEETING NOTICE**

AD 02

YU, Ying, Agent  
LAUGHINGCRABWI INC.  
2917 Broken Woods DR  
Coralville, IA 52241

You are requested to attend a virtual hearing to be held on:

**Friday, May 22, 2020 at 10:00 AM** 

**Regarding:** Your Class B Tavern and Food Dealer License Applications as agent for "LAUGHINGCRABWI INC." for "Laughing Crab" at 5712 W CAPITOL DR.

This meeting will be held via GoToMeeting. Please see the enclosed best practices document for further instructions. The access code is <https://global.gotomeeting.com/join/570861413>. If you wish to call in, please call +1 (669) 224-3412 and use Access Code: 570-861-413.

There is a possibility that your application may be denied for one or more of the following reasons: The recommendation of the committee regarding the application shall be based on evidence presented at the hearing. Per MCO 85-2.7-4, probative evidence concerning whether or not a new license should be granted may be presented on the following subjects: whether or not the applicant meets the municipal requirements, the appropriateness of the location and premises where the licensed premises is to be located and whether use of the premises for the purposes or activities permitted by the license would tend to facilitate a public or private nuisance or create undesirable neighborhood problems such as disorderly patrons, unreasonably loud noise, litter, and excessive traffic and parking congestion. Probative evidence relating to these matters may be taken from the plan of operation submitted with the license application, if any, but shall not include the content of any music. Evidence regarding the fitness of the location of the premises to be maintained as the principal place of business, including but not limited to whether there is an overconcentration of businesses of the type for which the license is sought; whether the proposal is consistent with any pertinent neighborhood business or development plans, or the location's proximity to areas where children are typically present. The applicant's record in operating similarly licensed premises; and whether or not the applicant has been charged with or convicted of any felony, misdemeanor, municipal offense or other offense, the circumstances of which substantially relate to the activity to be permitted by the license being applied for or any other factor which reasonably relates to the public health, safety or welfare may also be considered. See attached police report or correspondence.

**Notice for applicants with warrants or unpaid fines:** Proof of warrant satisfaction or payment of fines must be submitted at the hearing on the above date and time. Failure to comply with this requirement may result in a delay of the granting/denial of your application.

Failure to attend this meeting may result in the denial of your license. Individual applicants and partnership applicants must attend or attend by an attorney. The agent or attorney for corporate or limited liability applicants must attend. If you wish to do so and at your own expense, you may be accompanied by an attorney of your choosing to represent you at this hearing.

You will be given an opportunity to speak on behalf of the application and to respond and challenge any charges or reasons given for the denial. No petitions can be accepted by the committee, unless the people who signed the petition attend the virtual hearing and are willing to testify. You may present witnesses under oath and you may also confront and cross-examine opposing witnesses under oath. If you have difficulty with the English language, you should request an interpreter attend the meeting with you, at your expense, so that you can answer questions and participate in your hearing.

PLEASE NOTE: Upon reasonable notice, efforts will be made to accommodate the needs of disabled individuals through sign language interpreters or other auxiliary aids. For additional information or to request this service, contact the Council Services Division ADA Coordinator at (414) 286-2998, Fax - (414) 286-3456, TDD - (414) 286-2025.

JIM OWCZARSKI, CITY CLERK

BY: \_\_\_\_\_

Jessica Celella  
License Division Manager

**If you have questions regarding this meeting, please contact the staff assistant, Molly Kuether-Steele at (414) 286-2775 or [molly.kuether-steele@milwaukee.gov](mailto:molly.kuether-steele@milwaukee.gov).**



**CITY OF MILWAUKEE  
OFFICE OF THE CITY CLERK**

Monday, May 11, 2020

**COMMITTEE MEETING NOTICE**

AD 02

YU, Ying, Agent  
LAUGHINGCRABWI INC.  
532 South Park St 2FL  
Madison, WI 53715

You are requested to attend a virtual hearing to be held on:

**Friday, May 22, 2020 at 10:00 AM**

**Regarding:** Your Class B Tavern and Food Dealer License Applications as agent for "LAUGHINGCRABWI INC." for "Laughing Crab" at 5712 W CAPITOL DR.

This meeting will be held via GoToMeeting. Please see the enclosed best practices document for further instructions. The access code is <https://global.gotomeeting.com/join/570861413>. If you wish to call in, please call +1 (669) 224-3412 and use Access Code: 570-861-413.

There is a possibility that your application may be denied for one or more of the following reasons: The recommendation of the committee regarding the application shall be based on evidence presented at the hearing. Per MCO 85-2.7-4, probative evidence concerning whether or not a new license should be granted may be presented on the following subjects: whether or not the applicant meets the municipal requirements, the appropriateness of the location and premises where the licensed premises is to be located and whether use of the premises for the purposes or activities permitted by the license would tend to facilitate a public or private nuisance or create undesirable neighborhood problems such as disorderly patrons, unreasonably loud noise, litter, and excessive traffic and parking congestion. Probative evidence relating to these matters may be taken from the plan of operation submitted with the license application, if any, but shall not include the content of any music. Evidence regarding the fitness of the location of the premises to be maintained as the principal place of business, including but not limited to whether there is an overconcentration of businesses of the type for which the license is sought; whether the proposal is consistent with any pertinent neighborhood business or development plans, or the location's proximity to areas where children are typically present. The applicant's record in operating similarly licensed premises; and whether or not the applicant has been charged with or convicted of any felony, misdemeanor, municipal offense or other offense, the circumstances of which substantially relate to the activity to be permitted by the license being applied for or any other factor which reasonably relates to the public health, safety or welfare may also be considered. See attached police report or correspondence.

**Notice for applicants with warrants or unpaid fines:** Proof of warrant satisfaction or payment of fines must be submitted at the hearing on the above date and time. Failure to comply with this requirement may result in a delay of the granting/denial of your application.

Failure to attend this meeting may result in the denial of your license. Individual applicants and partnership applicants must attend or attend by an attorney. The agent or attorney for corporate or limited liability applicants must attend. If you wish to do so and at your own expense, you may be accompanied by an attorney of your choosing to represent you at this hearing.

You will be given an opportunity to speak on behalf of the application and to respond and challenge any charges or reasons given for the denial. No petitions can be accepted by the committee, unless the people who signed the petition attend the virtual hearing and are willing to testify. You may present witnesses under oath and you may also confront and cross-examine opposing witnesses under oath. If you have difficulty with the English language, you should request an interpreter attend the meeting with you, at your expense, so that you can answer questions and participate in your hearing.

PLEASE NOTE: Upon reasonable notice, efforts will be made to accommodate the needs of disabled individuals through sign language interpreters or other auxiliary aids. For additional information or to request this service, contact the Council Services Division ADA Coordinator at (414) 286-2998, Fax - (414) 286-3456, TDD - (414) 286-2025.

JIM OWCZARSKI, CITY CLERK

BY: \_\_\_\_\_

Jessica Ceella

License Division Manager

If you have questions regarding this meeting, please contact the staff assistant, Molly Kuether-Steele at (414) 286-2775 or [molly.kuether-steele@milwaukee.gov](mailto:molly.kuether-steele@milwaukee.gov).

Date: 3/2/2020

Officer: Bowie Buchner

City of Milwaukee Police Department

90-5-1.5 Crime Prevention Survey

Tavern Inspection

Name of Premise: Laughing Crab

Address: 5712 W Capitol Dr

Phone: None at time of inspection

Owner: Ying Yu

Owner address: 4361 E Tesch Av

City State Zip: Greenfield WI 53220

Owner Phone: 262-203-0096

Owner email: yingyu555@hotmail.com

Licensee/Agent: Ying Yu

Home Address: 4361 E Tesch Av

City State Zip: Greefield, WI 53220

Phone: 262-203-0096

Email: yingyu555@hotmail.com

Preferred contact: Ying Yu

Location currently open:  YES  NO

Projected open date: 4/1/2020

Day's open:  S  M  T  W  Th  F  SA  ALL

Hours of Operation: Sun: 12:00pm – 10:00pm 24 hours  Y  N

Mon: 11:00am – 10:00pm

Tue: 11:00am – 10:00pm

Wed: 11:00am – 10:00pm

Thu: 11:00am – 10:00pm

Fri: 11:00am – 11:00pm

Sat: 11:00am – 11:00pm

Premise Type:  Tavern/Bar

Restaurant

Other: Click here to enter text.

Licenses currently held:

Alcohol:  Yes  No Class:B #: BTAVN 305352

Tobacco:  Yes  No #: Click here to enter text.

Food:  Yes  No #: FREST 305353

Extended Hours:  Yes  No #: Click here to enter text.

Secondhand Dealer:  Yes  No Type: Click here to enter text. #: Click here to enter text.

Other: Yes No Type:Click here to enter text. #: Click here to enter text.

Other: Yes No Type:Click here to enter text. #: Click here to enter text.

**Exterior Survey:**

1. Is the area around the location clean? Yes No
2. What surrounds the location? (Check all the apply)
  - a. Park
  - b. School
  - c. Youth Center
  - d. Church
  - e. Tavern(s) If so, how many Click here to enter text.
  - f. Residential
  - g. Other businesses
  - h. Other: Click here to enter text.
3. Can you see from the outside of the location into the interior Yes No
4. Can you see the employees inside of the location from the outside Yes No
5. Are exterior windows free of signage Yes No
6. Is there a parking lot Yes No
7. Is the parking lot clean? Yes No
8. Off-Street parking Yes No
9. Is the parking lot well lit? Yes No
10. Valet Parking Yes No
  - a. Will this lot have a guard? Yes No
  - b. Will this lot have cameras? Yes No

11. Are there areas where a person could conceal themselves Yes No
12. Is there exterior lighting? Yes No. Does it appears to be adequate Yes No
13. Exterior Payphone? Yes No
14. Are there No Loitering Signs posted? Yes No
15. Are there exterior security cameras Yes No How Many: 2
16. Are the address numbers prominently displayed and easy to see Yes No

**Camera Survey:**

17. Does this location have security cameras? Yes No
18. Are they in working order? Yes No
19. What format are the cameras?
- a. Color Yes No
  - b. Digital Yes No
  - c. Recorded Yes No
20. How long is footage stored for later viewing: Unknown at time of inspection
21. Are there exterior cameras Yes No How many: 2
22. Are there interior cameras Yes No How many: 6
23. Do all employees know how to retrieve recorded digital images/footage? Yes No
24. Cameras located in parking lot Yes No How many Click here to enter text.

**Interior Survey:**

25. What is the planned capacity 130 maximum
26. What is the minimum number of employees that will be on premise 6
27. Is the storeowner willing to be a standing complainant regarding loitering? Yes No
- a. If yes have them fill out the standing complaint form and give them two of the commercial signs Yes No
28. Is the interior of the location neat and clean? Yes No
29. Does an interior camera face the entrance/exit? Yes No
30. Is there a lockable area that separates employees from customers? Yes No
31. Are emergency and non-emergency numbers posted near the phone? Yes No
32. Does the owner know how to contact their police district directly? Yes No
- a. Did you provide a district contact guide to the owner? Yes No

**Security**

33. How many security personnel are going to be employed: 0

34. How ill they be deployed: Interior Click here to enter text. Exterior Click here to enter text.

35. What days will they be deployed MonTueWedThuFriSatSun

36. Will the security be managed by business or contracted

37. Will they be armed Yes No

38. What type of security measures to be used:

Wanding/metal detector Click here to enter text.

ID Scanner Click here to enter text.

Dress Code Click here to enter text.

Cover Charge Click here to enter text.

Age restriction Click here to enter text.

Other Click here to enter text.

**ADDITIONAL COMMENTS/RECOMMENDATIONS:**

At the time of this inspection the location was not open and was currently under construction. The blinds where closed on the windows, preventing anyone from being able to see from the outside fo the location into the interior. However, when opened you are able to see inside from outside the building.

Regarding the security cameras, they were purchased, but not installed at the time of the inspection. The purchased system will keep video until the storage is full, at which time it will



begin to record over the oldest video. However, the owner was not sure how long that would be.

Lastly, regarding security guards, the owner did not plan to hire any for this location specifically. However, this location is in the midtown shopping center and the shopping center does have private security that they contract to drive around the shopping center.

# City of Milwaukee Concentration Map

5712 W Capitol Dr, Milwaukee, WI, 53216

Area : 21,862,585.85 ft<sup>2</sup>

Jan 17 2020 10:15:15 Central Standard Time

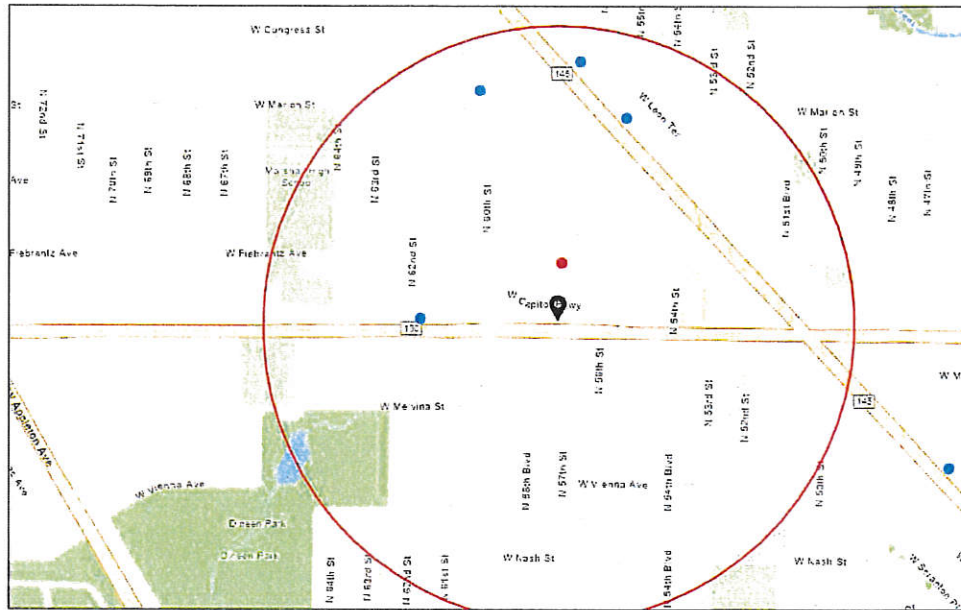

Alcohol Licenses  
● Class B Tavern  
● Class A Liquor and Malt  
□ City Boundary

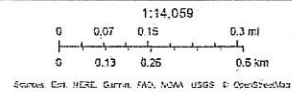

## Summary

Name	Count	Area(ft <sup>2</sup> )	Length(mi)
Alcohol Licenses	5		

## Alcohol Licenses

#	Legal Entity	Trade Name	Licensee	Address	License Type Name	Total Capacity	Expiration Date	Count
1	5700 Court LLC	Court MVP Sports Bar + Grill	Otis D Moore, Agt	5700 W FOND DU LAC AV	Class B Tavern License	99	5/7/2020, 7:00 PM	1
2	Mega Marts, LLC	Pick N Save #6365	PRINCESS Y THOMAS, Agt	5700 W Capitol DR	Class A Malt & Class A Liquor License		11/12/2020, 6:00 PM	1
3	Club 4323, LLC	Genes Supper Club	JAMES T ROBINSON, JR, Agt	4323 N 60th ST	Class B Tavern License	160	3/1/2020, 6:00 PM	1
4	DALE'S	DALE'S	DALE L MIDDLEMAN, SP	6132 W CAPITOL DR	Class B Tavern License	80	6/29/2020, 7:00 PM	1
5	Comfort Zone Banquet Facilities LLC	Comfort Zone Banquet Facilities	TRINA ECKFORD, Agt	5526 W Fond Du Lac AV	Class B Tavern License	200	3/25/2020, 7:00 PM	1

Establishments within a 0.5 miles radius centered on area of interest.



Monday, May 11, 2020

## Licenses Committee Notice of Hearing

MID MILK IMPROVEMENTS LLC  
580 WHITE PLAINS Rd  
TARRYTOWN, NY 10591

The Licenses Committee will consider the following license application:

Class B Tavern and Food Dealer License Applications  
YU, Ying, Agent  
Laughing Crab at 5712 W CAPITOL DR

Date: 5/22/2020

Time: 10:00 AM

Location: The hearing before the Licenses Committee will take place virtually on Friday, May 22, 2020. This is a public hearing. Those wishing to view the proceeding are able to do so via the City Channel – Channel 25 on Spectrum Cable – or on the Internet at <http://city.milwaukee.gov/citychannel>. Those wishing to provide oral testimony will be asked to do so by phone or internet and are asked to contact the staff assistant, Molly Kuether-Steele at (414) 286-2775 or [molly.kuether-steele@milwaukee.gov](mailto:molly.kuether-steele@milwaukee.gov) for necessary information. Please make such requests no later than one business day prior to the start of the meeting. You are not required to attend the hearing, but please see the information below if you would like to provide testimony.

Please note this application may be recommended for denial based on fitness of the location due to concentration of alcohol beverage outlets in the area. If the application is denied for this reason, no other application for an alcohol beverage license for this location shall be recommended for approval by the Licenses Committee within three years of the date of denial unless the applicant has demonstrated a change of circumstances since the prior denial.





Monday, May 11, 2020

## Licenses Committee Notice of Hearing

DLC Management Corp  
565 TatterRd  
Elmsford, NY 10523

The Licenses Committee will consider the following license application:

Class B Tavern and Food Dealer License Applications  
YU, Ying, Agent  
Laughing Crab at 5712 W CAPITOL DR

Date: 5/22/2020

Time: 10:00 AM

Location: The hearing before the Licenses Committee will take place virtually on Friday, May 22, 2020. This is a public hearing. Those wishing to view the proceeding are able to do so via the City Channel – Channel 25 on Spectrum Cable – or on the Internet at <http://city.milwaukee.gov/citychannel>. Those wishing to provide oral testimony will be asked to do so by phone or internet and are asked to contact the staff assistant, Molly Kuether-Steele at (414) 286-2775 or [molly.kuether-steele@milwaukee.gov](mailto:molly.kuether-steele@milwaukee.gov) for necessary information. Please make such requests no later than one business day prior to the start of the meeting. You are not required to attend the hearing, but please see the information below if you would like to provide testimony.

Please note this application may be recommended for denial based on fitness of the location due to concentration of alcohol beverage outlets in the area. If the application is denied for this reason, no other application for an alcohol beverage license for this location shall be recommended for approval by the Licenses Committee within three years of the date of denial unless the applicant has demonstrated a change of circumstances since the prior denial.





Monday, May 11, 2020



# Notice of Public Hearing

blank  
notice

---

YU, Ying, Agent  
Laughing Crab at 5712 W CAPITOL DR  
Class B Tavern and Food Dealer License Applications

**Friday, May 22, 2020 at 10:00 AM**

To whom it may concern:

The above application has been made by the above named applicant(s). This requires approval from the Licenses Committee and the Common Council of the City of Milwaukee. The hearing before the Licenses Committee will take place virtually on 5/22/2020 at 10:00 AM. This is a public hearing. Those wishing to view the proceeding are able to do so via the City Channel – Channel 25 on Spectrum Cable – or on the Internet at <http://city.milwaukee.gov/citychannel>. Those wishing to provide oral testimony will be asked to do so by phone or internet and are asked to contact the staff assistant, Molly Kuether-Steele at (414) 286-2775 or [molly.kuether-steele@milwaukee.gov](mailto:molly.kuether-steele@milwaukee.gov) for necessary information. Please make such requests no later than one business day prior to the start of the meeting. You are not required to attend the hearing, but please see the information below if you would like to provide testimony. Once the Licenses Committee makes its recommendation, this recommendation is forwarded to the full Common Council for approval at its next regularly scheduled hearing.

---

## Important details for those wishing to provide information for the Licenses Committee to consider when making its recommendation:

1. The license application is scheduled to be heard at the above time. Due to other hearings running longer than scheduled, you may have to wait some time to provide your testimony.
2. You must testify as to matters that you have personally experienced or seen. (You cannot provide testimony for your neighbor, parent or anyone else; this is considered hearsay and cannot be considered by the committee.)
3. No letters or petitions can be accepted by the committee (unless the person who wrote the letter or the persons who signed the petition are willing to testify).
4. Persons opposed to the license application are given the opportunity to testify first; supporters may testify after the opponents have finished.
5. When you are called to testify, you will be sworn in and asked to give your name, and address. (If your first and/or last names are uncommon please spell them.)
6. You may then provide testimony.
  - a. Include only information relating to the above license application.
  - b. Include only information you have personally witnessed or seen.
  - c. Provide concise and relevant information detailing how this business has affected or may affect the peaceful enjoyment of your neighborhood.
  - d. If by the time you have the opportunity to testify, the information you wish to share has already been provided to the committee, you may state that you agree with the previous testimony. Redundant or repetitive testimony will not assist the committee in making its recommendation.
7. After giving your testimony, the members of the Licenses Committee and the licensee may ask questions regarding the testimony you have given or other factors relating to the license application.
8. Business Competition is not a valid basis for denial or non-renewal of a license.

**Please Note: If you have submitted an objection to the above application your objection cannot be considered by the committee unless you personally testify at the hearing.**

OCCUPANT	MAIL ADDRESS	CITY, STATE ZIP
CURRENT OCCUPANT	5715 W CAPITOL DR 3	MILWAUKEE, WI 53216
CURRENT OCCUPANT	5625 W CAPITOL DR	MILWAUKEE, WI 53216
CURRENT OCCUPANT	5615 W CAPITOL DR 1	MILWAUKEE, WI 53216
CURRENT OCCUPANT	5605 W CAPITOL DR 4	MILWAUKEE, WI 53216
CURRENT OCCUPANT	5703 W CAPITOL DR 1	MILWAUKEE, WI 53216
CURRENT OCCUPANT	5619 W CAPITOL DR	MILWAUKEE, WI 53216
CURRENT OCCUPANT	5605 W CAPITOL DR 3	MILWAUKEE, WI 53216
CURRENT OCCUPANT	5729 W CAPITOL DR 1	MILWAUKEE, WI 53216
CURRENT OCCUPANT	5715 W CAPITOL DR 1	MILWAUKEE, WI 53216
CURRENT OCCUPANT	5703 W CAPITOL DR 3	MILWAUKEE, WI 53216
CURRENT OCCUPANT	5635 W CAPITOL DR 1	MILWAUKEE, WI 53216
CURRENT OCCUPANT	5615 W CAPITOL DR 2	MILWAUKEE, WI 53216
CURRENT OCCUPANT	5729 W CAPITOL DR 4	MILWAUKEE, WI 53216
CURRENT OCCUPANT	5703 W CAPITOL DR 4	MILWAUKEE, WI 53216
CURRENT OCCUPANT	5703 W CAPITOL DR 2	MILWAUKEE, WI 53216
CURRENT OCCUPANT	5635 W CAPITOL DR 3	MILWAUKEE, WI 53216
CURRENT OCCUPANT	5617 W CAPITOL DR	MILWAUKEE, WI 53216
CURRENT OCCUPANT	5729 W CAPITOL DR 2	MILWAUKEE, WI 53216
CURRENT OCCUPANT	5715 W CAPITOL DR 2	MILWAUKEE, WI 53216
CURRENT OCCUPANT	5715 W CAPITOL DR 4	MILWAUKEE, WI 53216
CURRENT OCCUPANT	5721 W CAPITOL DR 1	MILWAUKEE, WI 53216
CURRENT OCCUPANT	5631 W CAPITOL DR	MILWAUKEE, WI 53216
CURRENT OCCUPANT	5615 W CAPITOL DR 4	MILWAUKEE, WI 53216
CURRENT OCCUPANT	5729 W CAPITOL DR 3	MILWAUKEE, WI 53216
CURRENT OCCUPANT	5721 W CAPITOL DR 4	MILWAUKEE, WI 53216
CURRENT OCCUPANT	5721 W CAPITOL DR 2	MILWAUKEE, WI 53216
CURRENT OCCUPANT	5635 W CAPITOL DR 2	MILWAUKEE, WI 53216
CURRENT OCCUPANT	5623 W CAPITOL DR	MILWAUKEE, WI 53216
CURRENT OCCUPANT	5721 W CAPITOL DR 3	MILWAUKEE, WI 53216
CURRENT OCCUPANT	5635 W CAPITOL DR 4	MILWAUKEE, WI 53216
CURRENT OCCUPANT	5615 W CAPITOL DR 3	MILWAUKEE, WI 53216
CURRENT OCCUPANT	5605 W CAPITOL DR 2	MILWAUKEE, WI 53216
CURRENT OCCUPANT	5605 W CAPITOL DR 1	MILWAUKEE, WI 53216

Total Records: 33

Radius: 250.0 feet and Center of Circle: 5712 W Capitol Dr



# BUSINESS LICENSE PLAN OF OPERATION

ccl-busplan 3/15/18

Office of the City Clerk License Division  
200 E. Wells St. Room 105, Milwaukee, WI 53202  
(414) 286-2238 www.milwaukee.gov/license e-mail address: license@milwaukee.gov

## 1. Type of Business

Applying for:  Extended Hours (12AM to 5AM) - If a food establishment, check all that apply:  Delivery  Drive Thru  Dining Room  
 Self Service Laundry  Massage Establishment  Filling Station  
 Other (supplemental application for specific license also required)

Provide a detailed description of the type of business you plan on operating:

*Cajun Seafood Restaurant Serve Food and Alcohol Beverage*

Do you have any experience operating this type of business?  No  Yes If yes, explain: *I have a same type of restaurant in shreveport Louisiana.*

## 2. Business Operations

- a. Proposed Opening Date: *April 1<sup>st</sup> 2020*
- b. Is this premise under construction?  No  Yes If yes, list estimated completion date: *March 1<sup>st</sup> 2020*
- c. Is this a franchise?  No  Yes
- d. Is this premises currently licensed?  No  Yes If yes, list type of license: \_\_\_\_\_
- e. Is the current licensee operating?  No  Yes If no, list date closed: *Dec 2010*
- f. Do you have future plans for other businesses, licenses or permits at this location?  No  Yes  
If yes, explain: \_\_\_\_\_
- g. Have you previously held an Extended Hours License in Milwaukee?  No  Yes  
If yes, list address(es): \_\_\_\_\_
- h. Are other businesses operating in the same building?  No  Yes If yes, describe: \_\_\_\_\_

## 3. Litter & Noise

- a. How are grounds kept clean?  Sweep  Pressure Wash  Pick Up Litter  Other: \_\_\_\_\_
- b. How often will grounds be cleaned?  Daily  Weekly  As Needed  Monthly  Other: \_\_\_\_\_
- c. Grounds cleaned by:  Licensee  Building Owner  Employees  Hired Maintenance  Other: \_\_\_\_\_
- d. How are noise issues prevented and/or addressed?  Security  Manager approaches customer(s)  Call Police  
 Signs Posted  Other: \_\_\_\_\_
- e. Will a sound amplification system be used?  No  Yes If yes, describe: \_\_\_\_\_

## 4. Smoking & Sanitation

- a. Are there designated outdoor smoking areas?  No  Yes If yes, describe: \_\_\_\_\_
- b. Number of Garbage Cans: Inside: *5* Locations: *Bar, Servers' Station, Kitchen Area*  
Outside: *1* Locations: *By Front Door*
- c. Is a crowd control barrier used?  No  Yes If yes, describe: \_\_\_\_\_
- d. How many restrooms are on the premises? *2*
- e. Name of solid waste contractor:  Advanced Disposal  Waste Management  Other: \_\_\_\_\_



## 5. Security

- a. Are there onsite parking spaces?  No  Yes If yes, how many? 45 and describe the parking security plan: This shopping center has their own Security Guards
- b. Is there a loading zone?  No  Yes If yes, describe the loading area security plan: Security Guards everywhere in the shopping center
- c. Will you have security personnel on premise?  No  Yes If yes, how many? \_\_\_\_\_ and answer the following:  
 What are their responsibilities? \_\_\_\_\_  
 Is security equipment used?  No  Yes If yes, describe \_\_\_\_\_  
 List their licensing, certification, or training credentials \_\_\_\_\_
- d. Will there be security cameras?  No  Yes If yes, how many? 8 and list locations: Front door. Backdoor. Cashier station. Dining Area. Kitchen.
- e. Will searches/identification checks be done upon entry?  No  Yes If yes, describe \_\_\_\_\_

## 6. Percentage of Sales (must total 100%)

Alcohol <u>5</u> %	Food <u>95</u> %	Secondhand Merchandise _____ %	Precious Metals & Gems _____ %
Entertainment _____ %	Cigarettes _____ %	_____ %	_____ %
Pawnbroker Activity _____ %	Salvaged Materials _____ % (such as scrap metal)	Personal Services (such as tattoo, body piercing, salon, tailor, tanning, etc.) _____ %	Other _____ % Describe: _____

## 7. Businesses/Licenses on the Premises (check all that apply):

### Type 1

- Full Service Restaurant     Cafe/Coffee Shop     Deli or Fast Food Restaurant     Private/Fraternal/Veterans Club
- Night Club     Tavern     Cocktail Lounge     Teen Club
- Banquet Hall     Sports Facility     Bowling Alley
- Hotel/Motel : Number of Floors: \_\_\_\_\_     Rooming House: Number of Floors: \_\_\_\_\_  
 Number of Rooms: \_\_\_\_\_    Number of Rooms: \_\_\_\_\_

### Type 2

- Liquor Store     Corner Store     Supermarket     Convenience Store
- Gas Station     Amusement/Phonograph Distributor     Recycling, Salvage or Towing
- Used Car Dealer     Personal Service Establishment  
(such as tattoo business, hair salon, tailor, etc.)     Recording Studio

What other licenses/permits will you hold at this location? (check all that apply)

- Occupancy Permit     Cigarette & Tobacco     Gas Station     Extended Hours     Class "B" Tavern     Weights & Measures
- Secondhand Dealer     Precious Metal & Gem     Other: \_\_\_\_\_

## 8. Legal Capacity (only if a Type 1 premises in #7 above)

Capacity \_\_\_\_\_ (Call the Milwaukee Development Center at 414-286-8211 if you have questions.)

## 9. Premises Description

a. Identify all area(s) of the premises that will be used in operating this business (include areas used only for storage):

1<sup>st</sup> Floor  2<sup>nd</sup> Floor  Basement Storage  Patio  Beer Garden  Sidewalk Café  Deck  Rooftop

Other: Describe: \_\_\_\_\_

b. Describe Location:  Major Thoroughfare  Secondary Street  Other: \_\_\_\_\_

c. Nearest Major Cross Street: West Capitol Dr and 60th Street

d. Describe Building:  Free Standing Building  Strip Mall  Other: Single Building with Two Restaurants

e. Describe Premises Structure:  Single Story  Multi-Story - # of Stories \_\_\_\_\_  Other: \_\_\_\_\_

f. Describe Surrounding Area:  Commercial  Residential  Industrial  Other: \_\_\_\_\_

g. Building Owner Name: DLC Management Corp. Phone Number: 914-631-3131

Business Owner Address: 565 Tarter Rd, Elmsford, NY, 10523

## 10. Hours of Operation & Customers

Will customers be entering the premises?  No  Yes

Day of the Week	Proposed Hours of Operation:		Estimated Number of Customers expected each day	Potential Age Range of Customers	Class B Tavern Applicant Only: Age Restriction (If none, write 'None')
	Open Time (include a.m. or p.m.)	Close Time (include a.m. or p.m.)			
Sunday	12:00 PM	10:00 PM	150	5-65	None
Monday	11:00 AM	10:00 PM	100	5-65	
Tuesday	11:00 AM	10:00 PM	100	5-65	
Wednesday	11:00 AM	10:00 PM	100	5-65	
Thursday	11:00 AM	10:00 PM	100	5-65	
Friday	11:00 AM	11:00 PM	200	5-65	
Saturday	12:00 PM	11:00 PM	200	5-65	

An Extended Hours Establishment License is required for any convenience store, filling station, personal service establishment (such as tattoo, body piercing, salon, tailor, tanning, etc.), recording studio or restaurant which is open between the hours of 12:00 a.m. and 5:00 a.m.

Alcohol Establishments Class A: 8:00 am to 9:00 pm Sunday thru Saturday

Permitted Hours of Operation: Class B: 6:00 am to 2:00 am Sunday thru Thursday, 6:00 am to 2:30 am Friday & Saturday

Entertainment Outdoor Closing Hours: 10:00pm Sunday-Thursday; 12:00am Friday & Saturday; unless a different time, either earlier or later, is established by the Common Council in its approval of the licensee's plan of operation.

## 11. Signature(s)

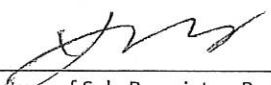
 King Yu President

Signature of Sole Proprietor, Partner, or 20% or more Shareholder

Signature of additional partner or 20% or more shareholder

(If there are no 20% or more shareholders, Corporate Officer-print name/title and sign)

See Application Information for a complete list of all required application forms.



## ALCOHOL BEVERAGE & PUBLIC ENTERTAINMENT PREMISES SUPPLEMENTAL APPLICATION

Office of the City Clerk License Division  
200 E. Wells St. Room 105, Milwaukee, WI 53202  
(414) 286-2238 e-mail address: license@milwaukee.gov [www.milwaukee.gov/license](http://www.milwaukee.gov/license)

Legal Entity Name: Laughing Crabwi, INC

Premise Address: 5712 W Capitol Dr Milwaukee WI 53216

### Proximity of Premises to Church, School, Daycare Center or Hospital

Is the building within 300 feet of any church, school, daycare center or hospital?  No  Yes

### "Service Bar Only" Designation

If applying for Class B or C license, are you applying for "Service Bar Only"?  No  Yes

Service Bar Only means customers cannot sit at the bar. Alcohol is served to employees who serve patrons seated at tables. No stools, chairs or other articles of furniture shall be placed at the service bar for patrons to sit upon.

### Business Information

a) Are you taking out this application for anyone that may not be eligible for a license?  No  Yes

If yes, list their name and address: \_\_\_\_\_

b) Will the agent, a partner or the individual licensee be conducting the day-to-day operations of the business?  No  Yes

If no, list the name and address of the person(s) who will: \_\_\_\_\_

Class B Applicants: If the agent, a partner or the individual licensee will not be conducting the day-to-day operations of the business, the person(s) listed above must obtain a Class B Managers license.

c) Does anyone else have money invested or any other interest in this business?  No  Yes

If yes, explain: \_\_\_\_\_

d) Have you made an agreement with anyone to repay any loan or any other payments based upon income from the business?

No

Yes

If yes, list name and address: \_\_\_\_\_

### Proof of Ownership, Lease, or Offer to Purchase (New & Transfer Applicants Only)

Submit proof of ownership, lease, or offer to purchase the building with this application.

A lease or offer to purchase must:

- Be in the same legal entity name as that apply for the license
- Reflect the same address as the premises address on this application
- Reflect current dates and
- Be signed by the lessor/seller and lessee/buyer

### Property Information (New & Transfer Applicants Only)

a) Do you own or lease the building?  Own  Lease

b) Who owns the fixtures (for example, coolers, etc.)? Landlord

c) Are you purchasing the stock and/or fixtures?  No  Yes If yes, amount paid \$ \_\_\_\_\_

d) Total amount paid for business \$ 0

e) Total amount paid for goodwill of the business \$ 0

Goodwill comprises the reputation and customer relationships of an existing business. If the price you pay for the business exceeds the fair market value of all of the rest of the assets of the business, the excess may be considered goodwill.

f) Have you made arrangements with the seller for payment of personal property taxes?  No  Yes

**See Application Information for a list of all required application forms.**

### Lease Information (New & Transfer Applicants who are leasing the premises only)

- a) Date lease begins 12/10/2019 Ends 4/30/2025
- b) Monthly rental \$ 6882.67
- c) Do you have an option to renew the lease?  No  Yes
- d) Does your lease allow for assignment to another party without the consent of the owner?  No  Yes
- e) For what length of time have you been guaranteed occupancy (number of years)? 5 years
- f) In addition to paying the monthly rental, will you have to pay anything additional to the owner of the building to guarantee performance of the lease?  No  Yes If yes, explain \_\_\_\_\_
- g) Does the present owner or occupancy object to the granting of your license?  No  Yes  
If yes, explain \_\_\_\_\_

### Change of Agent Applicants Only

Have there been any changes to the floor plan since the last application was submitted?  No  Yes

If no, a new floor plan is not required. If yes, submit a new floor plan and explain the change(s): only Two changes

First is the dine in Area different tables and chairs Location

Second is the different equipment under the Hood.

### Signature

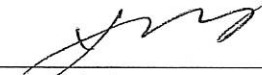
 Ying Yu President  
Signature of Sole Proprietor, Partner or 20% or More Shareholder  
(If no 20% or more Shareholder, Corporate Officer - print name/title and sign)

Note: All information contained in this application is subject to approval by the Common Council.

Deviating from approved plan of operation will subject licensee to citations, and/or suspension or non-renewal of the license.

Contact the License Division for information on how to request changes.

### New and transfer of premises applicants must submit the following:

- Proof of ownership, lease or offer to purchase the building
- Detailed floor plan
- If a restaurant, copy of the menu



# FOOD DEALER LICENSE PLAN OF OPERATION

OFFICE OF THE CITY CLERK, LICENSE DIVISION  
 CITY HALL, 200 E. WELLS ST, ROOM 105, MILWAUKEE, WI 53202  
 (414) 286-2238 • [license@milwaukee.gov](mailto:license@milwaukee.gov) • [www.milwaukee.gov/license](http://www.milwaukee.gov/license)

Legal Entity Name: Laughingcrab WI. Inc  
 Premises Address: 5712 W Capitol Dr Milwaukee WI 53216

## SECTION 1 TYPE OF BUSINESS

What will be the majority of your food sales? (check one)

Restaurant Items (meals):  
 MEALS include, but are not limited to, chicken, ribs, sandwiches, roasted corn, baked potatoes, hot dogs, brats, tacos, nachos w/ cheese and meat, French fries, cooked or deep fried vegetables/fruit, cooked cheese curds, corn dogs, egg rolls, salads.

Retail Items (snacks and beverages):  
 RETAIL items include, but are not limited to, ice cream/soft serve, lemonade, snow cones, coffee, espresso, cappuccino, tea, fruit juice, smoothies, candy, dispensed soda, fruit cups, bakery, cookies, kettle corn, cotton candy, funnel cakes, fritters, tortilla chips w/ cheese.

Will it be a convenience store?  Yes  No

A convenience store contains less than 5,000 square feet of retail space and has, as its primary business, the sale of basic food items and in addition, sells household products or is a filling station that sells basic food items and household products.

- Bed & Breakfast
- Micro Market

All Applicants: Submit a menu or a list of food items that will be sold.

Will any wholesale business be done?  No  Yes If yes, what percentage of food sales will be wholesale?

Less than 25%

25% or More AND:

Restaurant items (meals) will be sold – Complete this application and also contact DATCP.

NO restaurant items (meals) will be sold - Do NOT complete this application. Contact DATCP only.

## SECTION 2 FOOD PROCESSING

Will any food processing be done?  No  Yes

Processing is defined as assembling, grinding, cutting, mixing, baking, coating, stuffing, packing, bottling, grilling, canning, extracting, fermenting, distilling, pickling, freezing, drying, smoking, or packaging.

## SECTION 3 FOOD REQUIRING TEMPERATURE CONTROL

Will any food that requires temperature control be sold?  No  Yes  
 (includes dairy products such as milk, cheese, and ice cream, fish, shellfish, meat, poultry)

If yes, list the types of food items: Milk. Ice cream

**SECTION 4 DETAILS OF OPERATION**

- Will you have seating on site for dining?  No  Yes
- Will you be doing any catering?  No  Yes
- Will you be doing any delivery?  No  Yes
- Will you have outdoor activities?  No  Yes - Check all that apply:  Bar  Cooking/Grilling  Dining
- Will you have a drive thru window?  No  Yes - Are hours different from inside?  No  Yes  
If Yes, provide drive thru hours: \_\_\_\_\_
- Will scales or barcode scanners be used?  No  Yes - You must also apply for a Weights & Measures License.

**SECTION 5 ADDITIONAL SITES**

Where will food be prepared and/or sold?  
 At a single site  At multiple sites: How many? \_\_\_\_\_ (for example, a hotel with several dining rooms or bars)  
 If multiple sites, attach a Food Dealer Additional Site Addendum (ccl-foodadd) for each additional site.

**SECTION 6 CONSTRUCTION OR CHANGES**

Are you planning any construction, remodeling or equipment changes?  
 No If No, SKIP to Section 8  
 Yes If Yes, check all that apply:  New construction of a building  Renovation or remodeling  
 Construction changes to existing building  Equipment changes only  
 Provide a brief description of the changes: *Table and chairs change location. New equipments under the Hood.*  
 Start date: *Jan 15th*  
 Name, Address & Phone Number of Architect: \_\_\_\_\_  
 Name, Address & Phone Number of Contractor: \_\_\_\_\_

**SECTION 7 ALCOHOL BEVERAGES**

Are you applying for an alcohol beverage license?  
 No If No, SKIP to Section 8  
 Yes If YES, if your food license is approved prior to the alcohol license, when do you want the food license issued?  
 Immediately  At the same time as the alcohol license

**SECTION 8 ACKNOWLEDGEMENTS & SIGNATURE**

You must initial each item confirming your understanding:

- yy I understand the Health Department must conduct an inspection and advise the License Division of their approval before the license may be issued.
- yy I understand I must obtain an occupancy permit from the Department of Neighborhood Services and an inspection may be required. Neighborhood Services must advise the License Division of their approval before the license may be issued.
- yy I understand the district alderperson will review and either support or object to my application. If he/she objects, I may appeal and be scheduled to appear before the Licenses Committee. The Licenses Committee will then make a recommendation to the Common Council. The Common Council must grant the license before it may be issued.
- yy I understand proof of payment for all license fees must be on file in the License Division before the license may be issued and the license must be issued and posted in my establishment prior to opening for business.
- yy I will not operate my food business until the license has been issued and posted in the establishment.

Signature of Sole Proprietor, Partner, or 20% Shareholder: *[Signature]*  
 Signature of Additional Partner: \_\_\_\_\_

# LAUGHING CRAB

## Appetizers

- Crab Rangoon 4.99
- Edamame 5.99
- Onion Ring 3.99
- White wine mussel 6.99
- Sweet potato fries 3.99
- Fried cheese stick 4.99
- Chicken wings (6) 5.99 (12) 9.99  
(regular, BBQ, cajun, lemon pepper, buffalo)
- \* Raw oyster (6) 9.5 (12) 17.5

## Soup/Salad

- New England clam chowder 4.99
- Seafood Gumbo W. Rice 6.99
- Coleslaw 1.99
- House salad 2.99

## Sandwiches

Served with fries and coleslaw

- Fried Catfish 11
- Fried Shrimp 12

**PRICING AND AVAILABILITY SUBJECT TO CHANGE  
WARNING**

\* CONSUMPTION OF RAW OYSTERS OR UNDERCOOKED MEATS, POULTRIES, SEAFOODS, SHELLFISH OR EGGS MAY INCREASE YOUR RISK OF FOOD-BORNE ILLNESS, ESPECIALLY IF YOU HAVE CERTAIN ALLERGY AND MEDICAL CONDITIONS. PLEASE INFORM YOUR SERVER IF YOU HAVE ANY CONDITIONS.

## Fried basket

ALL basket come with fries

- Chicken tender(4) 10.99
- Fried Calamari(15) 9.99
- Fried catfish(6) 12.99
- Fried shrimp(10) 11.99
- Fried baby shrimp 9.99
- Fried oyster(10) 11.99
- Soft shell crab(2) 13.99













## Sides

- Extra condiments (Garlic Butter, BBQ, Buffalo) 0.5
- Sausage ( 1/2LB) 5.99  
(1LB) 9.99
- Steam rice 1.5
- Corn on the cob(3) 2.99
- POTATO(3) 2.99

## GET YOUR HANDS DIRTY

*Come with corn ,potato sausage*

STEP1: Choose Your Seafood

-  BLUE CRAB (SEASONAL)
-  SHRIMP(NO HEAD)
-  SNOW CRAB LEGS
-  CRAWFISH ( SEASONAL )
-  SHRIMP(HEAD ON)
-  CLAMS
-  GREEN MUSSEL
-  BLACK MUSSEL
-  KING CRAB LEGS
-  LOBSTER TAIL
-  DUNGENESS CRAB LEGS

STEP2: Choose Your Seasoning

CAJUN/GARLIC BUTTER/LEMON PEPPER  
HOUSE SPECIAL/OLD BAY/PLAIN

STEP3: Choose Your Spicy Level

MILD/MEDIUM/HOT/EXTRA HOT  
) ) )  
) ) )

## Create your own seafood combo

Choose any 1/2LB (MIN 2 items come with corn & potato & sausage)

- Black mussel
- Green mussel
- Clams
- crawfish
- Snow crab legs
- Shrimp (no head)
- Shrimp (head on)
- Blue crab
- Sausage

## KIDS' MENU (DRINKS INCLUDED)

Choice of fries or coleslaw or corn or potato or steam rice **6.99**

- Chicken nuggets
- Fish sticks
- Cheese sticks
- Chicken tenders

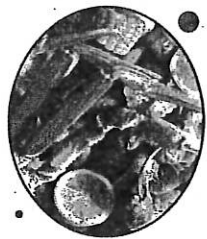

## Combo Specials

W. 2 corns + 2 potatoes + 2 eggs

<b>A</b>	\$25
*shrimp (No Head)	1LB
*crawfish	1LB
<b>B</b>	\$45
*snow crab leg	1LB 1/2LB
*shrimp (No Head)	1LB 1/2LB
*crawfish	1LB 1/2LB
<b>C</b>	\$35
*snow crab leg	1/2LB
*shrimp (No Head)	1/2LB
*lobster tail	6 OZ
<b>D</b>	\$31.99
*king crab leg	1/2LB
*shrimp (No Head)	1/2LB
*sausage	1/2LB

### Family Platter \$89

W. 4 corns + 4 potatoes + 4 eggs

- Snow Crab Legs 1LB
- Lobster Tails 1LB
- Crawfish 1LB
- Shrimp (No Head) 1LB
- Black Mussels 1LB

### Crawfish Platter

- 3lb Crawfish \$25
- W. 1 corn + 1 potato + 1 egg
- 5lb Crawfish \$45
- W. 2 corn + 2 potatoes + 2 eggs

## Lunch Menu

Mon-Fri: 11:00am to 3:00pm

### Boiled Seafood

Come W. Corn potato sausage

- L1. SHRIMP (NO HEAD) 11.00
- L2. SNOW CRAB LEGS 12.00
- L3 CRAWFISH 7.00
- L4. SHRIMP (HEAD ON) 10.00
- L5. CLAMS 7.00
- L6 GREEN MUSSELS 8.00
- L7. BLACK MUSSELS 8.00
- L8. CRAWFISH & SHRIMP (NO HEAD) 13.00
- L9 SNOW CRAB LEG & SHRIMP (NO HEAD) 18.00

## FRIED BASKETS

ALL Baskets come with fries

- FRIED SHRIMP BASKET (6 Pcs) 8.00
- FRIED CATFISH BASKET (3 Pcs) 8.00
- FRIED CALAMARI (10 Pcs) 8.00
- FRIED OYSTER BASKET (7 Pcs) 8.00
- CHICKEN TENDER BASKET (3 Pcs) 7.00
- CHICKEN WING BASKET (6 Pcs) 7.00  
choice of Cajun buffalo or lemon pepper
- LUNCH FRIED BASKET A 11.00  
4 pcs shrimp & 2 pcs catfish
- LUNCH FRIED BASKET B 10.00  
4 Pcs chicken wings & 2 pcs Chicken Tenders

An 18% Service Charge Will be Added for parties of 7 or more



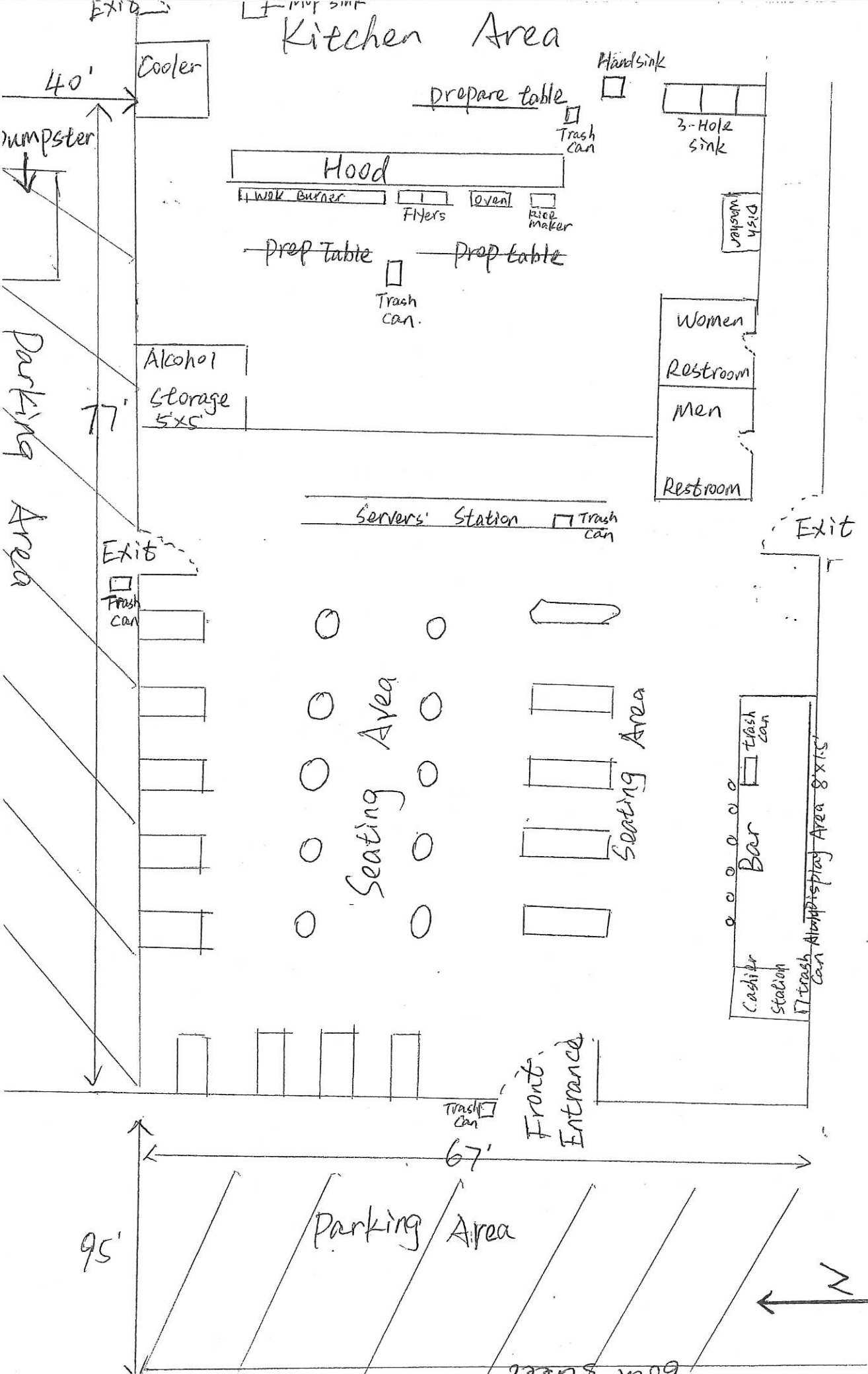

Total Square Footage is 5162'

West Capitol Drive

Ying Yu / president  
 Laughing Crab WI, INC DBA = Laughing Crab  
 5712 W Capitol Dr, Milwaukee, WI, 53216  
 Date: Jan 6th 2020