

# Thor Roffers Thor Roffers

Quote #: ZVJHKL B

A Proposal for Window and Door Products prepared for:

**Job Site:**  
53189

**Shipping Address:**

BLIFFERT LUMBER & HARDWARE-WAUKESHA  
548 W SUNSET DR  
WAUKESHA, WI 53189-7007



BRIAN PETERS  
BLIFFERT LUMBER &  
HARDWARE-WAUKESHA  
548 W SUNSET DR  
WAUKESHA, WI 53189-7007  
Phone: (262) 542-6666

Email: [brian@bliffertlumber.com](mailto:brian@bliffertlumber.com)

This report was generated on 11/3/2017 1:38:41 PM using the Marvin Order Management System, version 0002.17.00 (Current). Price in USD. Unit availability and price are subject to change. Dealer terms and conditions may apply.

## Featuring products from:



## UNIT SUMMARY

The following is a schedule of the windows and doors for this project. For additional unit details, please see Line Item Quotes.

Additional charges, tax or Terms and Conditions may apply. Detail pricing is per unit.

NUMBER OF LINES: 16		TOTAL UNIT QTY: 26		EXT NET PRICE: USD		26,508.87
LINE	MARK UNIT	BRAND	ITEM	NET PRICE	QTY	EXTENDED NET PRICE
1	1st Floor West	Marvin	Wood Marvin Assembly RO 96" X 82" Entered as RO 96" X 82"	3,002.43	1	3,002.43
2	North 1st Floor	Marvin	Wood Ultimate Double Hung RO 38" X 85 1/2" Entered as RO 38" X 85 1/2"	1,029.73	2	2,059.46
3	South 1st Floor	Marvin	Wood Ultimate Double Hung RO 37 1/2" X 76" Entered as RO 37 1/2" X 76"	921.91	2	1,843.82
4	South 1st Floor	Marvin	Wood Ultimate Double Hung RO 38 1/2" X 84" Entered as RO 38 1/2" X 84"	920.63	1	920.63
5	South 1st Floor	Marvin	Wood Ultimate Double Hung RO 32" X 45" Entered as RO 32" X 45"	596.53	1	596.53
6	South 1st Floor	Marvin	Wood Rectangle Direct Glaze RO 58" X 84" Entered as RO 58" X 84"	1,042.49	1	1,042.49
7	East Landing	Marvin	Wood Ultimate Double Hung RO 31" X 81" Entered as RO 31" X 81"	1,065.46	1	1,065.46
8	Basement Landing	Marvin	Wood Ultimate Double Hung RO 28" X 64" Entered as RO 28" X 64"	854.28	1	854.28
9	Upper Landing	Marvin	Wood Ultimate Double Hung RO 30 1/4" X 65" Entered as RO 30 1/4" X 65"	898.94	1	898.94
10	2nd Floor Landing	Marvin	Wood Ultimate Double Hung RO 31" X 73" Entered as RO 31" X 73"	984.43	1	984.43
11	South 2nd Floor	Marvin	Wood Ultimate Double Hung RO 37 1/2" X 66" Entered as RO 37 1/2" X 66"	761.13	4	3,044.52
12	North & South 2nd Floor	Marvin	Wood Ultimate Double Hung RO 37 1/2" X 74" Entered as RO 37 1/2" X 74"	817.28	5	4,086.40
13	South 2nd Floor	Marvin	Wood Rectangle Direct Glaze RO 58" X 74" Entered as	975.50	1	975.50

14	South Landing 2nd Floor	Marvin	RO 58" X 74" Wood Ultimate Double Hung RO 35" X 74" Entered as RO 35" X 74"	1,066.10	1	1,066.10
15	2nd Floor West	Marvin	Wood Marvin Assembly RO 96" X 74" Entered as RO 96" X 74"	2,729.36	1	2,729.36
16		Marvin	Clad Ultimate Insert Double Hung IO 33 1/4" X 54" Entered as Inside Opening 33 1/4" X 54"	669.26	2	1,338.52

## LINE ITEM QUOTES

The following is a schedule of the windows and doors for this project. For additional unit details, please see Line Item Quotes. Additional charges, tax or Terms and Conditions may apply. Detail pricing is per unit.

Line #1	Mark Unit: 1st Floor West	Net Price:	3,002.43
Qty: 1		Ext. Net Price:	3,002.43
		USD	

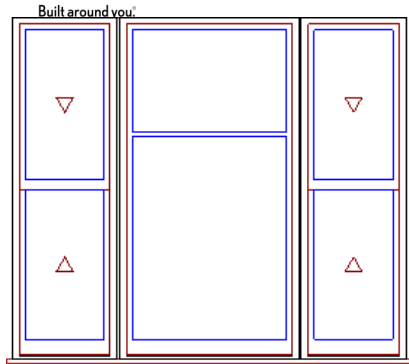

**Entered As:** RO  
**MO** 95 1/2" X 81 3/4"  
**FS** 95" X 81 1/2"  
**RO** 96" X 82"  
**Egress Information A1, A3**  
 Width: 21 13/16" Height: 34 1/2"  
 Net Clear Opening: 5.23 SqFt  
**Egress Information A2**  
 No Egress Information available.

Primed Pine Exterior	61.25
Stained Interior Finish Pine Interior	
Wheat Stained Interior Finish	365.57
3W1H - Rectangle Assembly	
Assembly Rough Opening w/ Subsill	
96" X 82"	
Unit: A1	696.70
Wood Ultimate Double Hung	
Basic Frame 25 3/8" X 80 13/32"	
Standard CN Width 20	
Rough Opening w/ Subsill	
26 3/8" X 82"	
***Sash Ship Loose	
Top Sash	
Primed Pine Sash Exterior	
Stained Interior Finish Pine Sash Interior	
Wheat Stained Interior Finish	
IG - 1 Lite	
Low E2 w/Argon	
Stainless Perimeter Bar	
Ovolo Exterior Glazing Profile	
Ovolo Interior Glazing Profile	
Bottom Sash	
Primed Pine Sash Exterior	
Stained Interior Finish Pine Sash Interior	
Wheat Stained Interior Finish	
IG - 1 Lite	
Low E2 w/Argon	
Stainless Perimeter Bar	
Ovolo Exterior Glazing Profile	
Ovolo Interior Glazing Profile	
Satin Taupe Sash Lock	
Beige Jamb Hardware	
Aluminum Screen	
Stone White Surround	
Charcoal Fiberglass Mesh	
***Screen/Combo Ship Loose	
Unit: A2	833.23
Wood Ultimate Double Hung Picture 1 5/8" Sash	
Basic Frame 43 1/2" X 80 13/32"	
Rough Opening w/ Subsill	
44 1/2" X 82"	
**Extended Size Unit**	
***Sash Ship Loose	
Primed Pine Sash Exterior	
Stained Interior Finish Pine Sash Interior	
Wheat Stained Interior Finish	
IG	
Low E2 w/Argon	
Stainless Perimeter and Spacer Bar	
1 1/8" SDL - With Spacer Bar - Stainless	40.83
Cottage - Special Cut 1W1H	
2 Rect Lites	
24" DLO Height	
Primed Pine Ext - Stained Interior Finish Pine Int	
Wheat Stained Interior Finish	
Ovolo Exterior Glazing Profile	
Ovolo Interior Glazing Profile	
Unit: A3	696.70

Wood Ultimate Double Hung  
 CN 20 X Basic Frame 80 13/32"  
 Rough Opening w/ Subsill  
 26 3/8" X 82"  
 \*\*\*Sash Ship Loose  
 Top Sash  
 Primed Pine Sash Exterior  
 Stained Interior Finish Pine Sash Interior  
 Wheat Stained Interior Finish  
 IG - 1 Lite  
 Low E2 w/Argon  
 Stainless Perimeter Bar  
 Ovolo Exterior Glazing Profile  
 Ovolo Interior Glazing Profile  
 Bottom Sash  
 Primed Pine Sash Exterior  
 Stained Interior Finish Pine Sash Interior  
 Wheat Stained Interior Finish  
 IG - 1 Lite  
 Low E2 w/Argon  
 Stainless Perimeter Bar  
 Ovolo Exterior Glazing Profile  
 Ovolo Interior Glazing Profile  
 Satin Taupe Sash Lock  
 Beige Jamb Hardware  
 Aluminum Screen  
 Stone White Surround  
 Charcoal Fiberglass Mesh  
 \*\*\*Screen/Combo Ship Loose  
 Vertical Mull Reinforcement 3/8" ..... 303.69  
 Primed Pine Exterior Mull Cover  
 Factory Mull Charge ..... 21.69  
 4 9/16" Jamb  
 Exterior Casing - None ..... -17.23  
 Primed Pine Standard Subsill  
 No Installation Method  
 \*\*\*Note: Non-certified mull: check with local code officials for project specific requirements.

Line #2	Mark Unit: North 1st Floor	Net Price:		1,029.73
Qty: 2		Ext. Net Price:	USD	2,059.46

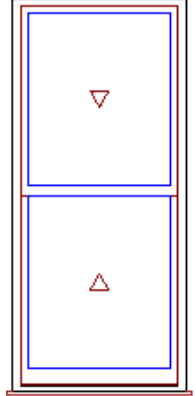

As Viewed From The Exterior

**Entered As:** RO  
**MO** 37 1/2" X 85 1/4"  
**FS** 37" X 85"  
**RO** 38" X 85 1/2"  
**Egress Information**  
 Width: 33 7/16" Height: 36 1/4"  
 Net Clear Opening: 8.42 SqFt

Primed Pine Exterior ..... 20.42  
 Stained Interior Finish Pine Interior .....  
 Wheat Stained Interior Finish ..... 112.29  
 Wood Ultimate Double Hung ..... 911.06  
 Rough Opening w/ Subsill  
 38" X 85 1/2"  
 Top Sash  
 Primed Pine Sash Exterior  
 Stained Interior Finish Pine Sash Interior  
 Wheat Stained Interior Finish  
 IG - 1 Lite  
 Low E2 w/Argon  
 Stainless Perimeter Bar  
 Ovolo Exterior Glazing Profile  
 Ovolo Interior Glazing Profile  
 Bottom Sash  
 Primed Pine Sash Exterior  
 Stained Interior Finish Pine Sash Interior  
 Wheat Stained Interior Finish  
 IG - 1 Lite  
 Low E2 w/Argon  
 Stainless Perimeter Bar  
 Ovolo Exterior Glazing Profile  
 Ovolo Interior Glazing Profile  
 Satin Taupe Sash Lock  
 Beige Jamb Hardware  
 Aluminum Screen  
 Stone White Surround  
 Charcoal Fiberglass Mesh  
 \*\*\*Screen/Combo Ship Loose  
 4 9/16" Jamb

Exterior Casing - None ..... -14.04  
 Primed Pine Standard Subsill  
 No Installation Method

Line #3	Mark Unit: South 1st Floor	Net Price:	921.91
Qty: 2		Ext. Net Price:	1,843.82
		USD	

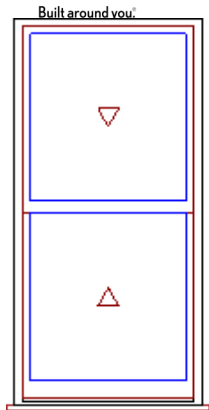

As Viewed From The Exterior

Entered As: RO  
 MO 37" X 75 3/4"  
 FS 36 1/2" X 75 1/2"  
 RO 37 1/2" X 76"  
**Egress Information**  
 Width: 32 15/16" Height: 31 1/2"  
 Net Clear Opening: 7.21 SqFt

Primed Pine Exterior ..... 20.42  
 Stained Interior Finish Pine Interior  
 Wheat Stained Interior Finish ..... 112.29  
 Wood Ultimate Double Hung ..... 801.97  
 Rough Opening w/ Subsill  
 37 1/2" X 76"  
 Top Sash  
 Primed Pine Sash Exterior  
 Stained Interior Finish Pine Sash Interior  
 Wheat Stained Interior Finish  
 IG - 1 Lite  
 Low E2 w/Argon  
 Stainless Perimeter Bar  
 Ovolo Exterior Glazing Profile  
 Ovolo Interior Glazing Profile  
 Bottom Sash  
 Primed Pine Sash Exterior  
 Stained Interior Finish Pine Sash Interior  
 Wheat Stained Interior Finish  
 IG - 1 Lite  
 Low E2 w/Argon  
 Stainless Perimeter Bar  
 Ovolo Exterior Glazing Profile  
 Ovolo Interior Glazing Profile  
 Satin Taupe Sash Lock  
 Beige Jamb Hardware  
 Aluminum Screen  
 Stone White Surround  
 Charcoal Fiberglass Mesh  
 \*\*\*Screen/Combo Ship Loose  
 4 9/16" Jamb  
 Exterior Casing - None ..... -12.76  
 Primed Pine Standard Subsill  
 No Installation Method

Line #4	Mark Unit: South 1st Floor	Net Price:	920.63
Qty: 1		Ext. Net Price:	920.63
		USD	

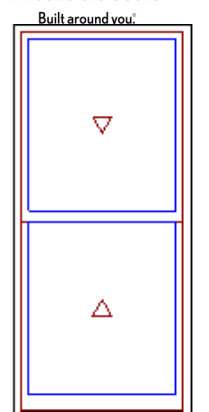

As Viewed From The Exterior

Entered As: RO  
 MO 38" X 83 3/4"  
 FS 37 1/2" X 83 1/2"  
 RO 38 1/2" X 84"  
**Egress Information**

Primed Pine Exterior ..... 20.42  
 Stained Interior Finish Pine Interior  
 Wheat Stained Interior Finish ..... 112.29  
 Wood Ultimate Double Hung ..... 801.97  
 Rough Opening w/ Subsill  
 38 1/2" X 84"  
 Top Sash  
 Primed Pine Sash Exterior  
 Stained Interior Finish Pine Sash Interior  
 Wheat Stained Interior Finish  
 IG - 1 Lite  
 Low E2 w/Argon  
 Stainless Perimeter Bar  
 Ovolo Exterior Glazing Profile  
 Ovolo Interior Glazing Profile  
 Bottom Sash  
 Primed Pine Sash Exterior  
 Stained Interior Finish Pine Sash Interior  
 Wheat Stained Interior Finish  
 IG - 1 Lite  
 Low E2 w/Argon  
 Stainless Perimeter Bar  
 Ovolo Exterior Glazing Profile  
 Ovolo Interior Glazing Profile  
 Satin Taupe Sash Lock  
 Beige Jamb Hardware

Width: 33 15/16" Height: 35 1/2"  
 Net Clear Opening: 8.37 SqFt

Aluminum Screen  
 Stone White Surround  
 Charcoal Fiberglass Mesh  
 \*\*\*Screen/Combo Ship Loose  
 4 9/16" Jambs  
 Exterior Casing - None .....-14.04  
 Primed Pine Standard Subsill  
 No Installation Method

Line #5	Mark Unit: South 1st Floor	Net Price:		596.53
Qty: 1		Ext. Net Price:	USD	596.53

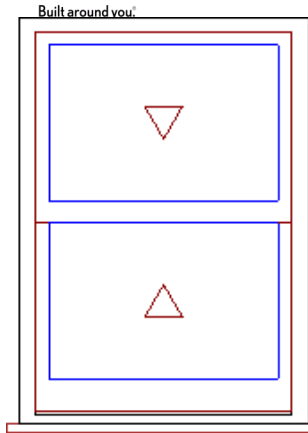

As Viewed From The Exterior

Entered As: RO  
 MO 31 1/2" X 44 3/4"  
 FS 31" X 44 1/2"  
 RO 32" X 45"

**Egress Information**  
 Width: 27 7/16" Height: 16"  
 Net Clear Opening: 3.05 SqFt

Primed Pine Exterior ..... 20.42  
 Stained Interior Finish Pine Interior .....  
 Wheat Stained Interior Finish ..... 112.29  
 Wood Ultimate Double Hung ..... 472.12  
 Rough Opening w/ Subsill  
 32" X 45"  
 Top Sash  
 Primed Pine Sash Exterior  
 Stained Interior Finish Pine Sash Interior  
 Wheat Stained Interior Finish  
 IG - 1 Lite  
 Low E2 w/Argon  
 Stainless Perimeter Bar  
 Ovolo Exterior Glazing Profile  
 Ovolo Interior Glazing Profile  
 Bottom Sash  
 Primed Pine Sash Exterior  
 Stained Interior Finish Pine Sash Interior  
 Wheat Stained Interior Finish  
 IG - 1 Lite  
 Low E2 w/Argon  
 Stainless Perimeter Bar  
 Ovolo Exterior Glazing Profile  
 Ovolo Interior Glazing Profile  
 Satin Taupe Sash Lock  
 Beige Jamb Hardware  
 Aluminum Screen  
 Stone White Surround  
 Charcoal Fiberglass Mesh  
 \*\*\*Screen/Combo Ship Loose  
 4 9/16" Jambs  
 Exterior Casing - None .....-8.29  
 Primed Pine Standard Subsill  
 No Installation Method

Line #6	Mark Unit: South 1st Floor	Net Price:		1,042.49
Qty: 1		Ext. Net Price:	USD	1,042.49

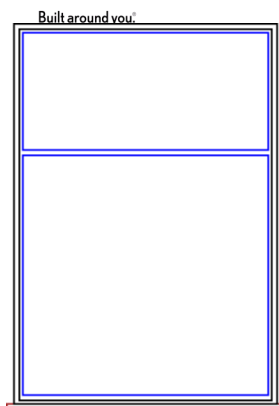

As Viewed From The Exterior

Primed Pine Exterior ..... 20.42  
 Stained Interior Finish Pine Interior .....  
 Wheat Stained Interior Finish ..... 141.00  
 Wood Rectangle Direct Glaze ..... 855.56  
 Rough Opening w/ Subsill  
 58" X 84"  
 IG  
 Low E2 w/Argon  
 Stainless Perimeter and Spacer Bar  
 Ogee Exterior Divided Lite Sticking  
 7/8" SDL - With Spacer Bar - Stainless ..... 40.83  
 Cottage - Special Cut 1W1H  
 2 Rect Lites  
 25 1/2" DLO Height  
 Primed Pine Ext - Stained Interior Finish Pine Int  
 Wheat Stained Interior Finish  
 4 9/16" Jambs  
 Exterior Casing - None .....-15.31  
 Primed Pine Standard Subsill  
 No Installation Method

**Entered As:** RO  
**MO** 57 1/2" X 83 3/4"  
**FS** 57" X 83 1/2"  
**RO** 58" X 84"

**Egress Information**  
 No Egress Information available.

Line #7	Mark Unit: East Landing	Net Price:		1,065.46
Qty: 1		Ext. Net Price:	USD	1,065.46

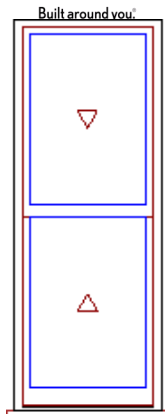

As Viewed From The Exterior

**Entered As:** RO  
**MO** 30 1/2" X 80 3/4"  
**FS** 30" X 80 1/2"  
**RO** 31" X 81"  
**Egress Information**  
 Width: 26 7/16" Height: 34"  
 Net Clear Opening: 6.24 SqFt

Primed Pine Exterior ..... 20.42  
 Stained Interior Finish Pine Interior  
 Wheat Stained Interior Finish ..... 112.29  
 Wood Ultimate Double Hung ..... 696.70  
 Rough Opening w/ Subsill  
 31" X 81"  
 Glass Add For All Sash/Panels ..... 248.82  
 Top Sash  
 Primed Pine Sash Exterior  
 Stained Interior Finish Pine Sash Interior  
 Wheat Stained Interior Finish  
 IG - 1 Lite  
 Tempered Low E2 w/Argon  
 Stainless Perimeter Bar  
 Ovolo Exterior Glazing Profile  
 Ovolo Interior Glazing Profile  
 Bottom Sash  
 Primed Pine Sash Exterior  
 Stained Interior Finish Pine Sash Interior  
 Wheat Stained Interior Finish  
 IG - 1 Lite  
 Tempered Low E2 w/Argon  
 Stainless Perimeter Bar  
 Ovolo Exterior Glazing Profile  
 Ovolo Interior Glazing Profile  
 Satin Taupe Sash Lock  
 Beige Jamb Hardware  
 Aluminum Screen  
 Stone White Surround  
 Charcoal Fiberglass Mesh  
 \*\*\*Screen/Combo Ship Loose  
 4 9/16" Jamb  
 Exterior Casing - None ..... -12.76  
 Primed Pine Standard Subsill  
 No Installation Method

Line #8	Mark Unit: Basement Landing	Net Price:		854.28
Qty: 1		Ext. Net Price:	USD	854.28

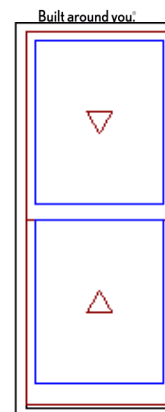

As Viewed From The Exterior

**Entered As:** RO

Primed Pine Exterior ..... 20.42  
 Stained Interior Finish Pine Interior  
 Wheat Stained Interior Finish ..... 112.29  
 Wood Ultimate Double Hung ..... 556.97  
 Rough Opening w/ Subsill  
 28" X 64"  
 Glass Add For All Sash/Panels ..... 174.81  
 Top Sash  
 Primed Pine Sash Exterior  
 Stained Interior Finish Pine Sash Interior  
 Wheat Stained Interior Finish  
 IG - 1 Lite  
 Tempered Low E2 w/Argon  
 Stainless Perimeter Bar  
 Ovolo Exterior Glazing Profile  
 Ovolo Interior Glazing Profile  
 Bottom Sash  
 Primed Pine Sash Exterior  
 Stained Interior Finish Pine Sash Interior  
 Wheat Stained Interior Finish  
 IG - 1 Lite  
 Tempered Low E2 w/Argon



**MO** 27 1/2" X 63 3/4"  
**FS** 27" X 63 1/2"  
**RO** 28" X 64"  
**Egress Information**  
 Width: 23 7/16" Height: 25 1/2"  
 Net Clear Opening: 4.15 SqFt

Stainless Perimeter Bar  
 Ovolo Exterior Glazing Profile  
 Ovolo Interior Glazing Profile  
 Satin Taupe Sash Lock  
 Beige Jamb Hardware  
 Aluminum Screen  
 Stone White Surround  
 Charcoal Fiberglass Mesh  
 \*\*\*Screen/Combo Ship Loose  
 4 9/16" Jamb  
 Exterior Casing - None ..... -10.21  
 Primed Pine Standard Subsill  
 No Installation Method

Line #9	Mark Unit: Upper Landing	Net Price:	898.94
Qty: 1		Ext. Net Price:	898.94

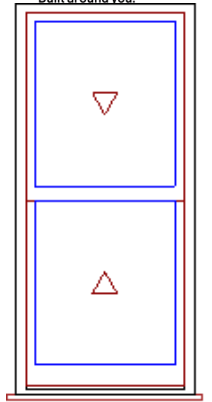

As Viewed From The Exterior

**Entered As:** RO  
**MO** 29 3/4" X 64 3/4"  
**FS** 29 1/4" X 64 1/2"  
**RO** 30 1/4" X 65"  
**Egress Information**  
 Width: 25 11/16" Height: 26"  
 Net Clear Opening: 4.64 SqFt

Primed Pine Exterior ..... 20.42  
 Stained Interior Finish Pine Interior  
 Wheat Stained Interior Finish ..... 112.29  
 Wood Ultimate Double Hung ..... 586.96  
 Rough Opening w/ Subsill  
 30 1/4" X 65"  
 Glass Add For All Sash/Panels ..... 190.12  
 Top Sash  
 Primed Pine Sash Exterior  
 Stained Interior Finish Pine Sash Interior  
 Wheat Stained Interior Finish  
 IG - 1 Lite  
 Tempered Low E2 w/Argon  
 Stainless Perimeter Bar  
 Ovolo Exterior Glazing Profile  
 Ovolo Interior Glazing Profile  
 Bottom Sash  
 Primed Pine Sash Exterior  
 Stained Interior Finish Pine Sash Interior  
 Wheat Stained Interior Finish  
 IG - 1 Lite  
 Tempered Low E2 w/Argon  
 Stainless Perimeter Bar  
 Ovolo Exterior Glazing Profile  
 Ovolo Interior Glazing Profile  
 Satin Taupe Sash Lock  
 Beige Jamb Hardware  
 Aluminum Screen  
 Stone White Surround  
 Charcoal Fiberglass Mesh  
 \*\*\*Screen/Combo Ship Loose  
 4 9/16" Jamb  
 Exterior Casing - None ..... -10.85  
 Primed Pine Standard Subsill  
 No Installation Method

Line #10	Mark Unit: 2nd Floor Landing	Net Price:	984.43
Qty: 1		Ext. Net Price:	984.43



Primed Pine Exterior ..... 20.42  
 Stained Interior Finish Pine Interior  
 Wheat Stained Interior Finish ..... 112.29  
 Wood Ultimate Double Hung ..... 639.91  
 Rough Opening w/ Subsill  
 31" X 73"  
 Glass Add For All Sash/Panels ..... 223.30  
 Top Sash  
 Primed Pine Sash Exterior  
 Stained Interior Finish Pine Sash Interior  
 Wheat Stained Interior Finish  
 IG - 1 Lite  
 Tempered Low E2 w/Argon  
 Stainless Perimeter Bar  
 Ovolo Exterior Glazing Profile

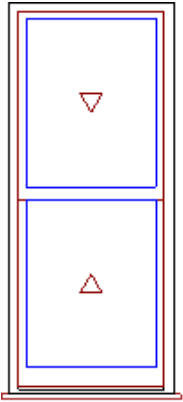

As Viewed From The Exterior

Entered As: RO  
 MO 30 1/2" X 72 3/4"  
 FS 30" X 72 1/2"  
 RO 31" X 73"

**Egress Information**  
 Width: 26 7/16" Height: 30"  
 Net Clear Opening: 5.51 SqFt

- Ovolo Interior Glazing Profile
- Bottom Sash
- Primed Pine Sash Exterior
- Stained Interior Finish Pine Sash Interior
- Wheat Stained Interior Finish
- IG - 1 Lite
- Tempered Low E2 w/Argon
- Stainless Perimeter Bar
- Ovolo Exterior Glazing Profile
- Ovolo Interior Glazing Profile
- Satin Taupe Sash Lock
- Beige Jamb Hardware
- Aluminum Screen
- Stone White Surround
- Charcoal Fiberglass Mesh
- \*\*\*Screen/Combo Ship Loose
- 4 9/16" Jambs
- Exterior Casing - None ..... -11.48
- Primed Pine Standard Subsill
- No Installation Method

Line #11	Mark Unit: South 2nd Floor	Net Price:		761.13
Qty: 4		Ext. Net Price:	USD	3,044.52

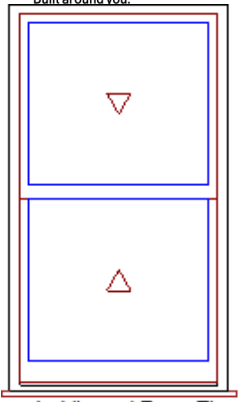

As Viewed From The Exterior

Entered As: RO  
 MO 37" X 65 3/4"  
 FS 36 1/2" X 65 1/2"  
 RO 37 1/2" X 66"  
**Egress Information**  
 Width: 32 15/16" Height: 26 1/2"  
 Net Clear Opening: 6.06 SqFt

- Primed Pine Exterior ..... 20.42
- Stained Interior Finish Pine Interior
- Wheat Stained Interior Finish ..... 112.29
- Wood Ultimate Double Hung ..... 639.91
- Rough Opening w/ Subsill
- 37 1/2" X 66"
- Top Sash
- Primed Pine Sash Exterior
- Stained Interior Finish Pine Sash Interior
- Wheat Stained Interior Finish
- IG - 1 Lite
- Low E2 w/Argon
- Stainless Perimeter Bar
- Ovolo Exterior Glazing Profile
- Ovolo Interior Glazing Profile
- Bottom Sash
- Primed Pine Sash Exterior
- Stained Interior Finish Pine Sash Interior
- Wheat Stained Interior Finish
- IG - 1 Lite
- Low E2 w/Argon
- Stainless Perimeter Bar
- Ovolo Exterior Glazing Profile
- Ovolo Interior Glazing Profile
- Satin Taupe Sash Lock
- Beige Jamb Hardware
- Aluminum Screen
- Stone White Surround
- Charcoal Fiberglass Mesh
- \*\*\*Screen/Combo Ship Loose
- 4 9/16" Jambs
- Exterior Casing - None ..... -11.48
- Primed Pine Standard Subsill
- No Installation Method

Line #12	Mark Unit: North & South 2nd Floor	Net Price:		817.28
Qty: 5		Ext. Net Price:	USD	4,086.40



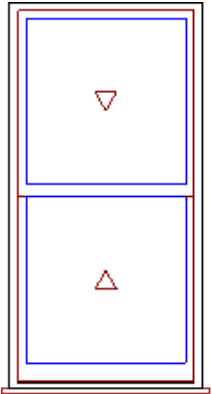

As Viewed From The Exterior

Entered As: RO  
 MO 37" X 73 3/4"  
 FS 36 1/2" X 73 1/2"  
 RO 37 1/2" X 74"  
**Egress Information**  
 Width: 32 15/16" Height: 30 1/2"  
 Net Clear Opening: 6.98 SqFt

Rough Opening w/ Subsill  
 37 1/2" X 74"  
 Top Sash  
 Primed Pine Sash Exterior  
 Stained Interior Finish Pine Sash Interior  
 Wheat Stained Interior Finish  
 IG - 1 Lite  
 Low E2 w/Argon  
 Stainless Perimeter Bar  
 Ovolo Exterior Glazing Profile  
 Ovolo Interior Glazing Profile  
 Bottom Sash  
 Primed Pine Sash Exterior  
 Stained Interior Finish Pine Sash Interior  
 Wheat Stained Interior Finish  
 IG - 1 Lite  
 Low E2 w/Argon  
 Stainless Perimeter Bar  
 Ovolo Exterior Glazing Profile  
 Ovolo Interior Glazing Profile  
 Satin Taupe Sash Lock  
 Beige Jamb Hardware  
 Aluminum Screen  
 Stone White Surround  
 Charcoal Fiberglass Mesh  
 \*\*\*Screen/Combo Ship Loose  
 4 9/16" Jamb  
 Exterior Casing - None ..... -12.12  
 Primed Pine Standard Subsill  
 No Installation Method

Line #13	Mark Unit: South 2nd Floor	Net Price:		975.50
Qty: 1		Ext. Net Price:	USD	975.50

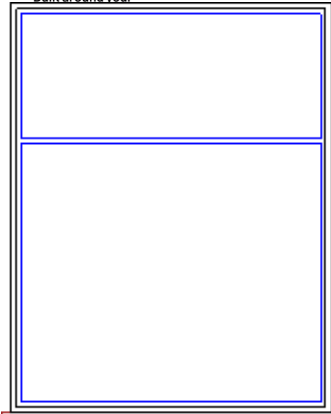

As Viewed From The Exterior

Entered As: RO  
 MO 57 1/2" X 73 3/4"  
 FS 57" X 73 1/2"  
 RO 58" X 74"  
**Egress Information**  
 No Egress Information available.

Primed Pine Exterior ..... 20.42  
 Stained Interior Finish Pine Interior  
 Wheat Stained Interior Finish ..... 141.00  
 Wood Rectangle Direct Glaze ..... 786.65  
 Rough Opening w/ Subsill  
 58" X 74"  
 IG  
 Low E2 w/Argon  
 Stainless Perimeter and Spacer Bar  
 Ogee Exterior Divided Lite Sticking  
 7/8" SDL - With Spacer Bar - Stainless ..... 40.83  
 Cottage - Special Cut 1W1H  
 2 Rect Lites  
 22" DLO Height  
 Primed Pine Ext - Stained Interior Finish Pine Int  
 Wheat Stained Interior Finish  
 4 9/16" Jamb  
 Exterior Casing - None ..... -13.40  
 Primed Pine Standard Subsill  
 No Installation Method

Line #14	Mark Unit: South Landing 2nd Floor	Net Price:		1,066.10
Qty: 1		Ext. Net Price:	USD	1,066.10



Primed Pine Exterior ..... 20.42  
 Stained Interior Finish Pine Interior  
 Wheat Stained Interior Finish ..... 112.29  
 Wood Ultimate Double Hung ..... 696.70  
 Rough Opening w/ Subsill  
 35" X 74"

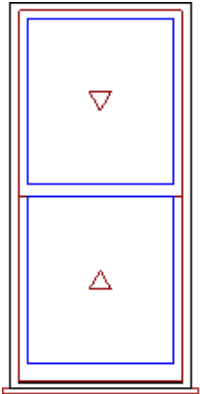

As Viewed From The Exterior

**Entered As:** RO  
**MO** 34 1/2" X 73 3/4"  
**FS** 34" X 73 1/2"  
**RO** 35" X 74"  
**Egress Information**  
 Width: 30 7/16" Height: 30 1/2"  
 Net Clear Opening: 6.45 SqFt

Glass Add For All Sash/Panels ..... 248.82  
 Top Sash  
 Primed Pine Sash Exterior  
 Stained Interior Finish Pine Sash Interior  
 Wheat Stained Interior Finish  
 IG - 1 Lite  
 Tempered Low E2 w/Argon  
 Stainless Perimeter Bar  
 Ovolo Exterior Glazing Profile  
 Ovolo Interior Glazing Profile  
 Bottom Sash  
 Primed Pine Sash Exterior  
 Stained Interior Finish Pine Sash Interior  
 Wheat Stained Interior Finish  
 IG - 1 Lite  
 Tempered Low E2 w/Argon  
 Stainless Perimeter Bar  
 Ovolo Exterior Glazing Profile  
 Ovolo Interior Glazing Profile  
 Satin Taupe Sash Lock  
 Beige Jamb Hardware  
 Aluminum Screen  
 Stone White Surround  
 Charcoal Fiberglass Mesh  
 \*\*\*Screen/Combo Ship Loose  
 4 9/16" Jambs  
 Exterior Casing - None ..... -12.12  
 Primed Pine Standard Subsill  
 No Installation Method

Line #15	Mark Unit: 2nd Floor West	Net Price:	2,729.36
Qty: 1		Ext. Net Price:	2,729.36
		USD	



Built around you!

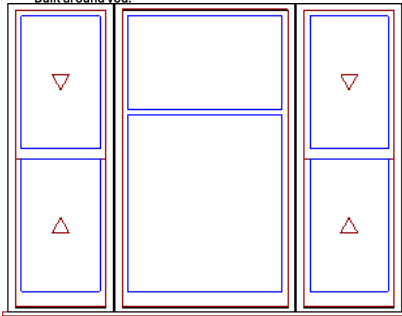

As Viewed From The Exterior

**Entered As:** RO  
**MO** 95 1/2" X 73 3/4"  
**FS** 95" X 73 1/2"  
**RO** 96" X 74"  
**Egress Information A1, A3**  
 Width: 21 13/16" Height: 30 1/2"  
 Net Clear Opening: 4.62 SqFt  
**Egress Information A2**  
 No Egress Information available.

Primed Pine Exterior ..... 61.25  
 Stained Interior Finish Pine Interior  
 Wheat Stained Interior Finish ..... 365.57  
 3W1H - Rectangle Assembly  
 Assembly Rough Opening w/ Subsill  
 96" X 74"  
 Unit: A1 ..... 602.91  
 Wood Ultimate Double Hung  
 Basic Frame 25 3/8" X 72 13/32"  
 Standard CN Width 20  
 Rough Opening w/ Subsill  
 26 3/8" X 74"  
 \*\*\*Sash Ship Loose  
 Top Sash  
 Primed Pine Sash Exterior  
 Stained Interior Finish Pine Sash Interior  
 Wheat Stained Interior Finish  
 IG - 1 Lite  
 Low E2 w/Argon  
 Stainless Perimeter Bar  
 Ovolo Exterior Glazing Profile  
 Ovolo Interior Glazing Profile  
 Bottom Sash  
 Primed Pine Sash Exterior  
 Stained Interior Finish Pine Sash Interior  
 Wheat Stained Interior Finish  
 IG - 1 Lite  
 Low E2 w/Argon  
 Stainless Perimeter Bar  
 Ovolo Exterior Glazing Profile  
 Ovolo Interior Glazing Profile  
 Satin Taupe Sash Lock  
 Beige Jamb Hardware  
 Aluminum Screen  
 Stone White Surround  
 Charcoal Fiberglass Mesh  
 \*\*\*Screen/Combo Ship Loose

Unit: A2 ..... 763.69  
 Wood Ultimate Double Hung Picture 1 5/8" Sash  
 Basic Frame 43 1/2" X 72 13/32"  
 Rough Opening w/ Subsill  
 44 1/2" X 74"  
 \*\*Extended Size Unit\*\*  
 \*\*\*Sash Ship Loose  
 Primed Pine Sash Exterior  
 Stained Interior Finish Pine Sash Interior  
 Wheat Stained Interior Finish  
 IG  
 Low E2 w/Argon  
 Stainless Perimeter and Spacer Bar  
 1 1/8" SDL - With Spacer Bar - Stainless ..... 40.83  
 Cottage - Special Cut 1W1H  
 2 Rect Lites  
 22" DLO Height  
 Primed Pine Ext - Stained Interior Finish Pine Int  
 Wheat Stained Interior Finish  
 Ovolo Exterior Glazing Profile  
 Ovolo Interior Glazing Profile

Unit: A3 ..... 602.91  
 Wood Ultimate Double Hung  
 CN 20 X Basic Frame 72 13/32"  
 Rough Opening w/ Subsill  
 26 3/8" X 74"  
 \*\*\*Sash Ship Loose  
 Top Sash  
 Primed Pine Sash Exterior  
 Stained Interior Finish Pine Sash Interior  
 Wheat Stained Interior Finish  
 IG - 1 Lite  
 Low E2 w/Argon  
 Stainless Perimeter Bar  
 Ovolo Exterior Glazing Profile  
 Ovolo Interior Glazing Profile  
 Bottom Sash  
 Primed Pine Sash Exterior  
 Stained Interior Finish Pine Sash Interior  
 Wheat Stained Interior Finish  
 IG - 1 Lite  
 Low E2 w/Argon  
 Stainless Perimeter Bar  
 Ovolo Exterior Glazing Profile  
 Ovolo Interior Glazing Profile  
 Satin Taupe Sash Lock  
 Beige Jamb Hardware  
 Aluminum Screen  
 Stone White Surround  
 Charcoal Fiberglass Mesh  
 \*\*\*Screen/Combo Ship Loose  
 Vertical Mull Reinforcement 3/8" ..... 286.46  
 Primed Pine Exterior Mull Cover  
 Factory Mull Charge ..... 21.69  
 4 9/16" Jamb  
 Exterior Casing - None ..... -15.95  
 Primed Pine Standard Subsill  
 No Installation Method  
 \*\*\*Note: Non-certified mull: check with local code officials for project specific requirements.

Line #16	Mark Unit:	Net Price:	669.26
Qty: 2		Ext. Net Price:	1,338.52
		USD	



Stone White Clad Exterior  
 Stained Interior Finish Pine Interior  
 Wheat Stained Interior Finish ..... 112.29  
 Clad Ultimate Insert Double Hung ..... 556.97  
 Inside Opening 33 1/4" X 54"  
 0 Degree Frame Bevel  
 Top Sash

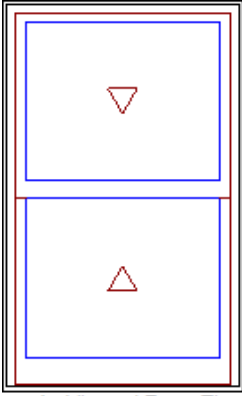

As Viewed From The  
Exterior

**Entered As:** IO

**FS** 32 7/8" X 53 3/4"

**IO** 33 1/4" X 54"

**Egress Information**

Width: 29 5/8" Height: 21 7/16"

Net Clear Opening: 4.41 SqFt

- Stone White Clad Sash Exterior
- Stained Interior Finish Pine Sash Interior
- Wheat Stained Interior Finish
- IG - 1 Lite
- Low E2 w/Argon
- Stainless Perimeter Bar
- Ovolo Interior Glazing Profile
- Bottom Sash
- Stone White Clad Sash Exterior
- Stained Interior Finish Pine Sash Interior
- Wheat Stained Interior Finish
- IG - 1 Lite
- Low E2 w/Argon
- Stainless Perimeter Bar
- Ovolo Interior Glazing Profile
- Satin Taupe Sash Lock
- Beige Jamb Hardware
- Aluminum Screen
- Stone White Surround
- Charcoal Fiberglass Mesh
- 3 1/4" Jamb

Project Subtotal Net Price: USD	26,508.87
5.600% Sales Tax: USD	1,484.50
Project Total Net Price: USD	27,993.37

## Terms and Conditions

**PURCHASE APPROVAL/SIGN OFF**

**Project Subtotal Net Price: USD 26,508.87**  
**5.600% Sales Tax: USD 1,484.50**  
**Project Total Net Price: USD 27,993.37**

I have reviewed all line item quotes in detail and agree that the product specifications and pricing are accurate, and I approve the project for order. I acknowledge that additional charges, tax or Terms and Conditions may apply.

Seller: \_\_\_\_\_

Buyer: \_\_\_\_\_