



CITY OF MILWAUKEE  
OFFICE OF THE CITY CLERK

Thursday, January 14, 2021

COMMITTEE MEETING NOTICE

AD 06

KAUR, Parminder, Agent  
Tittu Rehmat Food Inc  
8740 S COUNTRY DR #101

Oak Creek, WI 53154

You are requested to attend a virtual hearing to be held on:

**Tuesday, January 26, 2021 at 10:10 AM**

**Regarding:** Your Class A Malt, Food Dealer, and Weights & Measures License Applications as agent for "Tittu Rehmat Food Inc" for "Tittu Rehmat Food" at 418 E CENTER St.

This meeting will be held via GoToMeeting. Please see the enclosed best practices document for further instructions. The access code is <https://global.gotomeeting.com/join/778000629>. If you wish to call in, please call +1 (669) 224-3412 and use Access Code: 778-000-629.

There is a possibility that your application may be denied for one or more of the following reasons: The recommendation of the committee regarding the application shall be based on evidence presented at the hearing. Per MCO 85-2.7-4, probative evidence concerning whether or not a new license should be granted may be presented on the following subjects: whether or not the applicant meets the municipal requirements, the appropriateness of the location and premises where the licensed premises is to be located and whether use of the premises for the purposes or activities permitted by the license would tend to facilitate a public or private nuisance or create undesirable neighborhood problems such as disorderly patrons, unreasonably loud noise, litter, and excessive traffic and parking congestion. Probative evidence relating to these matters may be taken from the plan of operation submitted with the license application, if any, but shall not include the content of any music. Evidence regarding the fitness of the location of the premises to be maintained as the principal place of business, including but not limited to whether there is an overconcentration of businesses of the type for which the license is sought; whether the proposal is consistent with any pertinent neighborhood business or development plans, or the location's proximity to areas where children are typically present. The applicant's record in operating similarly licensed premises; and whether or not the applicant has been charged with or convicted of any felony, misdemeanor, municipal offense or other offense, the circumstances of which substantially relate to the activity to be permitted by the license being applied for or any other factor which reasonably relates to the public health, safety or welfare may also be considered. See attached police report or correspondence.

**Notice for applicants with warrants or unpaid fines:** Proof of warrant satisfaction or payment of fines must be submitted at the hearing on the above date and time. Failure to comply with this requirement may result in a delay of the granting/denial of your application.

Failure to attend this meeting may result in the denial of your license. Individual applicants and partnership applicants must attend or attend by an attorney. The agent or attorney for corporate or limited liability applicants must attend. If you wish to do so and at your own expense, you may be accompanied by an attorney of your choosing to represent you at this hearing.

You will be given an opportunity to speak on behalf of the application and to respond and challenge any charges or reasons given for the denial. No petitions can be accepted by the committee, unless the people who signed the petition attend the virtual hearing and are willing to testify. You may present witnesses under oath and you may also confront and cross-examine opposing witnesses under oath. If you have difficulty with the English language, you should request an interpreter attend the meeting with you, at your expense, so that you can answer questions and participate in your hearing.

PLEASE NOTE: Upon reasonable notice, efforts will be made to accommodate the needs of disabled individuals through sign language interpreters or other auxiliary aids. For additional information or to request this service, contact the Council Services Division ADA Coordinator at (414) 286-2998, Fax - (414) 286-3456, TDD - (414) 286-2025.

JIM OWCZARSKI, CITY CLERK

BY:

Jessica Celella  
License Division Manager

If you have questions regarding this meeting, please contact the staff assistant, Molly Kuether-Steele at (414) 286-2775 or [molly.kuether-steele@milwaukee.gov](mailto:molly.kuether-steele@milwaukee.gov).

200 E. Wells Street, Room 105, City Hall, Milwaukee, WI 53202. [www.milwaukee.gov/license](http://www.milwaukee.gov/license)  
Phone: (414) 286-2238 Fax: (414) 286-3057 Email Address: [License@milwaukee.gov](mailto:License@milwaukee.gov)

# MILWAUKEE POLICE DEPARTMENT LICENSING

## CRIMINAL RECORD/ORDINANCE VIOLATION/INCIDENTS SYNOPSIS

DATE: 09/06/2019

LICENSE TYPE: CLASS A MALT

No. 298714

NEW:

Application Date: 09/04/2019

RENEWAL:

License Location: 418 E Center St

Business Name: Loves Supermarket II

Licensee/Applicant: BRAICH, Harjinder S  
(Last Name, First Name, MI)

Date of Birth: 07/25/1971

Home Address: 3435 S 34<sup>th</sup> St

City: Milwaukee

State: WI Zip Code: 53215

Home Phone:

This report is written by Police Officer David Novak, assigned to the License Investigation Unit, Days.

The Milwaukee Police Department's investigation regarding this application revealed the following:

- On 11/07/2015 a 17 year old working in conjunction with the Milwaukee Police Department and WI WINS Tobacco initiative, was able to purchase a 2 pack of Swisher Diamond Cigars for \$0.99 from the clerk at 418 E. Center St, Loves Supermarket. A MARTS letter was sent. There is liquor sold at this location and the clerk did not have a Class D operators license. The applicant was cited in the City of Milwaukee at 418 W. Center St for Responsible Person on Premises Required.

Charge: Responsible Person on Premises Required  
 Finding: Guilty  
 Sentence: Fined \$150.00  
 Date: 03/02/2016  
 Case: 15068544

- 
- On 04/13/2017 the applicant was cited in the City of Milwaukee at 2305 W. Atkinson Av for Responsible Person on Premise Required.

Charge: Responsible Person on Premise Required  
 Finding: Guilty  
 Sentence: Fined \$180.00  
 Date: 06/29/2017  
 Case: 17016738

- =====
3. On 09/23/2017 a 17 year old working in conjunction with the Milwaukee Police Department and WI WINS Tobacco initiative, was able to purchase a White Owl cigar from the clerk at Loves Supermarket at 2305 W. Atkinson Av. The clerk was identified as Amardeep SINGH, who admitted to the sale stating he made a mistake on the date. The applicant was mailed a MARTS letter.
  4. On 01/25/2018 officers conducted a license premise check at Loves Supermarket, 418 E. Center St. The officer observed there was no address on the building. The clerk stated he was aware of the violation and would have it corrected. No other vioaltions were observed.
  5. On 08/11/2018 a 17 year old working in conjunction with the Milwaukee Police Department and WI WINS Tobacco initiative, was able to purchase a Grape Swisher Sweet cigar from the clerk at Love's Supermarket. The clerk was identified as Surinder SINGH, who stated he thought she was regular customer who he has ID'd in the past. The applicant was mailed a MARTS letter.
- =====

6. On 11/14/2019 at 11:50am officers, along with agents from the Wisconsin Department of Revenue, conducted a license premise check at Loves Super Market, 418 E. Center St. The Wisconsin Department of Revenue agent stated she had information the applicant was transferring alcohol between his stores to replenish supplies. The officers located spoiled food and rodent feces on the shelves. The officers located a stolen bicycle in the rear area. The applicant stated the bicycle was left behind by a former employee. The Wisconsin Department of Revenue agent located three electronic gambling machines and some minor compliance violations. The applicant was advised on how to correct the violations.

**Item #6 added as part of PREVIOUS PREMISE**

Date: 10/06/20  
Officer: Xavier Benitez

City of Milwaukee Police Department  
90-5-1.5 Crime Prevention Survey  
Tavern Inspection

Name of Premise: Tittu Rehmat Food  
Address: 418 E. Center St.  
Phone: 414 394-0814

Owner: Parminder Kaur  
Owner address: 8740 S. Country Dr. Apt #101  
City State Zip: Oak Creek WI 53154  
Owner Phone: 414 236-2862  
Owner email:

Licensee/Agent: Same  
Home Address:  
City State Zip:  
Phone:  
Email:

Preferred contact: Phone

Location currently open:  YES  NO

Projected open date: Fall 2020

Day's open: S M T W Th F SA ALL

Hours of Operation: Sun: 8am-9pm 24 hours Y N  
Mon: 8am-9pm  
Tue: 8am-9pm  
Wed: 8am-9pm  
Thu: 8am-9pm  
Fri: 8am-9pm  
Sat: 8am-9pm

Premise Type:  Tavern/Bar  
 Restaurant  
 Other: Grocery Store

Licenses currently held:

- Alcohol:  Yes  No Class: #:
- Tobacco:  Yes  No #:
- Food:  Yes  No #:
- Extended Hours:  Yes  No #:
- Secondhand Dealer:  Yes  No Type: #:
- Other:  Yes  No Type: #:
- Other:  Yes  No Type: #:

**Exterior Survey:**

1. Is the area around the location clean?  Yes  No
2. What surrounds the location? (Check all the apply)
  - a.  Park
  - b.  School
  - c.  Youth Center
  - d.  Church
  - e.  Tavern(s) If so, how many
  - f.  Residential
  - g.  Other businesses
  - h.  Other:
3. Can you see from the outside of the location into the interior  Yes  No
4. Can you see the employees inside of the location from the outside  Yes  No
5. Are exterior windows free of signage  Yes  No
6. Is there a parking lot  Yes  No
7. Is the parking lot clean?  Yes  No
8. Off-Street parking  Yes  No
9. Is the parking lot well lit?  Yes  No
10. Valet Parking  Yes  No
  - a. Will this lot have a guard?  Yes  No
  - b. Will this lot have cameras?  Yes  No
11. Are there areas where a person could conceal themselves  Yes  No
12. Is there exterior lighting?  Yes  No. Does it appears to be adequate  Yes  No
13. Exterior Payphone?  Yes  No
14. Are there No Loitering Signs posted?  Yes  No
15. Are there exterior security cameras  Yes  No How Many: 1
16. Are the address numbers prominently displayed and easy to see  Yes  No

**Camera Survey:**

17. Does this location have security cameras?  Yes  No
18. Are they in working order?  Yes  No
19. What format are the cameras?
  - a. Color  Yes  No
  - b. Digital  Yes  No
  - c. Recorded  Yes  No
20. How long is footage stored for later viewing: 7 Days
21. Are there exterior cameras  Yes  No How many: 4
22. Are there interior cameras  Yes  No How many: 12
23. Do all employees know how to retrieve recorded digital images/footage?  Yes  No

24. Cameras located in parking lot Yes No How many 1

**Interior Survey:**

- 25. What is the planned capacity N/A
- 26. What is the minimum number of employees That will be on premise 2
- 27. Is the storeowner willing to be a standing complainant regarding loitering? Yes No
  - a. If yes have them fill out the standing complaint form and give them two of the commercial signs Yes No
- 28. Is the interior of the location neat and clean? Yes No
- 29. Does an interior camera face the entrance/exit? Yes No
- 30. Is there a lockable area that separates employees from customers? Yes No
- 31. Are emergency and non-emergency numbers posted near the phone? Yes No
- 32. Does the owner know how to contact their police district directly? Yes No
  - a. Did you provide a district contact guide to the owner? Yes No

**Security**

- 33. How many security personnel are going to be employed: N/A
- 34. How ill they be deployed: Interior Exterior
- 35. What days will they be deployed MonTueWedThuFriSatSun
- 36. Will the security be managed by business or contracted
- 37. Will they be armed Yes No
- 38. What type of security measures to be used:
  - Wanding/metal detector
  - ID Scanner
  - Dress Code
  - Cover Charge
  - Age restriction
  - Other

**ADDITIONAL COMMENTS/RECOMMENDATIONS:**

The location is an established corner grocery store, closed for minor renovations. The new owner is changing minor things in the store. The agent stated that she will be adding more security cameras in stalled by ADT. The agent was advised of having a bigger storage capacity then the current 7 day hard drive.

# City of Milwaukee Concentration Map

## 418 E Center St

Area : 21,862,585.76 ft<sup>2</sup>

Sep 29 2020 10:47:26 Central Daylight Time

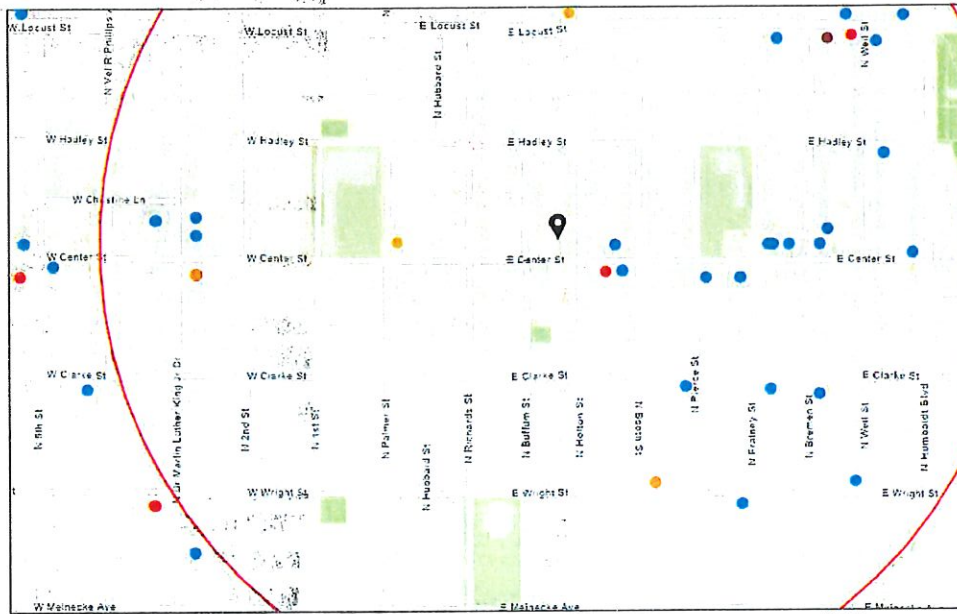

- Alcohol Licenses
  - Class A Intoxicating Liquor
  - Class A Fermented Malt Beverage
  - Class A Liquor and Malt
  - Class B Tavern
- Food Licenses

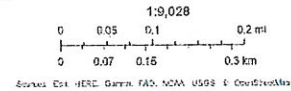

### Summary

Name	Count	Area(ft <sup>2</sup> )	Length(mi)
Food Licenses	25		
Alcohol Licenses	38		

### Food Licenses



#	Legal entity	Trade name	Licensee	Address	License type name	Total capacity	Expiration date	Count
1	TWO PS IN A POD, INC	CENTRO CAFE	MARGARET M KARPFINGER , Agt	808 E CENTER ST	Public Entertainment Premises License		10/10/2020, 7:00 PM	1
2	Rise & Grind Cafe, LLC	Rise & Grind Cafe & Market	Baboonie Tatum, Agt	2737 N Martin L King Jr DR	Public Entertainment Premises License		3/22/2021, 7:00 PM	1
3	Veggas Pub	Veggas Pub	Craig A Pape, SP	2479 N FRATNEY ST	Public Entertainment Premises License		4/7/2021, 7:00 PM	1
4	Lux2 LLC	Lux	THOMAS J HOLMES, Agt	2712 N MARTIN L KING JR DR	Public Entertainment Premises License		2/9/2021, 6:00 PM	1
5	Company Brewing LLC	Company Brewing	George D Bregar, Agt	735 E Center ST	Public Entertainment Premises License		2/25/2021, 6:00 PM	1
6	UPTOWNER	UPTOWNER	STEPHEN A JOHNSON, SP	1032 E CENTER ST	Public Entertainment Premises License		2/12/2021, 6:00 PM	1
7	Club 99	Club 99	GEORGE L ORTIZ, SP	2579 N Pierce ST	Public Entertainment Premises License		3/1/2021, 6:00 PM	1
8	Mad Planet 2, LLC	The Mad Planet	ROSEMARY S SILAGY, Agt	533 E Center ST	Public Entertainment Premises License		7/14/2021, 7:00 PM	1
9	Riverwest Public House Cooperative	Riverwest Public House Cooperative	Nicole M Kueppers, Agt	815 E LOCUST ST	Public Entertainment Premises License		3/24/2021, 7:00 PM	1
10	Ludhiana Inc	Li'l General	KENNETH R HALSELL, Agt	233 W Center ST	Public Entertainment Premises License		8/1/2021, 7:00 PM	1
11	Fly By Night LLC	High Dive	JASON R MC BRADY, Agt	701 E Center ST	Public Entertainment Premises License		7/26/2021, 7:00 PM	1
12	CIRCLE A	CIRCLE A	JENNIFER A MUELLER, SP	932 E CHAMBERS ST	Public Entertainment Premises License		10/11/2020, 7:00 PM	1
13	Two P's in a Pod Inc	Bar Centro	MARGARET M KARPFINGER , Agt	804 E Center ST	Public Entertainment Premises License		5/13/2021, 7:00 PM	1
14	Black Husky Brewing LLC	Black Husky Brewing	Timothy C Eichinger, Agt	909 E Locust ST	Public Entertainment Premises License	99	11/26/2020, 6:00 PM	1
15	FOUNDATION BAR, INC	THE FOUNDATION	CHARLES JORDAN, Agt	2718 N BREMEN ST	Public Entertainment Premises License		5/7/2021, 7:00 PM	1

16	CIRCLE A	CIRCLE A	JENNIFER A MUELLER, SP	932 E CHAMBERS ST	Public Entertainment Premises License		10/11/2021, 7:00 PM	1
17	The 4th Quarter Sports Bar & Grill LLC	The 4th Quarter	Devida M Glover, Agt	2722 N MARTIN L KING JR DR	Public Entertainment Premises License		9/20/2021, 7:00 PM	1
18	KISMAYO, LLC	CLUB TIMBUKTU	YOUSOUF KOMARA, Agt	520 E CENTER ST	Public Entertainment Premises License		12/19/2020, 6:00 PM	1
19	ILLUMINATI, LLC	BREMEN CAFE	DAVID A KOPP, Agt	901 E CLARKE ST	Public Entertainment Premises License		12/9/2020, 6:00 PM	1
20	LINNCO, INC	LINNEMAN'S RIVERWEST INN	JAMES A LINNEMAN, Agt	1001 E LOCUST ST	Public Entertainment Premises License		12/16/2020, 6:00 PM	1
21	TRACK'S OF MILWAUKEE, INC	THE TRACKS	Michael D Rebers, Agt	1020 E LOCUST ST	Public Entertainment Premises License		6/29/2021, 7:00 PM	1
22	KLINGER'S EAST, LLC	KLINGER'S EAST	GLEN F KLINGER, Agt	920 E LOCUST ST	Public Entertainment Premises License		7/9/2021, 7:00 PM	1
23	METRO ENTERPRISE S, INC	QUARTERS	DANIEL FISCHER, Agt	900 E CENTER ST	Public Entertainment Premises License		6/29/2021, 7:00 PM	1
24	Falcon Bowl	Falcon Bowl	R Lynn Okopinski, SP	801 E Clarke ST	Public Entertainment Premises License		6/29/2021, 7:00 PM	1
25	Sutrick Family LLC	Nessun Dorma	Emily E Sutrick, Agt	2778 N Weil ST	Public Entertainment Premises License		6/14/2021, 7:00 PM	1

## Alcohol Licenses

#	Legal Entity	Trade Name	Licensee	Address	License Type Name	Total Capacity	Expiration Date	Count
1	FUEL CAFE, INC	FUEL CAFE	SCOTT M JOHNSON, Agt	818 E CENTER ST	Class B Tavern License	49	9/27/2020, 7:00 PM	1
2	TWO PS IN A POD, INC	CENTRO CAFE	MARGARET M KARPFINGER, Agt	808 E CENTER ST	Class B Tavern License	40	10/10/2020, 7:00 PM	1
3	Sunrise Food & Liquor, LLC	Sunrise Food	Bharat Bansal, Agt	2879 N Weil ST	Class A Malt & Class A Liquor License		3/22/2021, 7:00 PM	1
4	Rise & Grind Cafe, LLC	Rise & Grind Cafe & Market	Baboonie Tatum, Agt	2737 N Martin L King Jr DR	Class B Tavern License		3/22/2021, 7:00 PM	1
5	Veggas Pub	Veggas Pub	Craig A Pape, SP	2479 N FRATNEY ST	Class B Tavern License		4/7/2021, 7:00 PM	1
6	FUEL CAFE, INC	FUEL CAFE	SCOTT M JOHNSON, Agt	818 E CENTER ST	Class B Tavern License	49	9/27/2021, 7:00 PM	1
7	Mondo Brothers Market, LLC	Milwaukee Beer Bistro	RUSSELL R DAVIS, Agt	2730 N HUMBOLDT BL	Class B Tavern License	198	2/8/2021, 6:00 PM	1
8	Company Brewing LLC	Company Brewing	George D Bregar, Agt	735 E Center ST	Class B Tavern License	150	2/25/2021, 6:00 PM	1
9	Lux2 LLC	Lux	THOMAS J HOLMES, Agt	2712 N MARTIN L KING JR DR	Class B Tavern License		2/9/2021, 6:00 PM	1
10	UPTOWNER	UPTOWNER	STEPHEN A JOHNSON, SP	1032 E CENTER ST	Class B Tavern License	99	2/12/2021, 6:00 PM	1
11	Club 99	Club 99	GEORGE L ORTIZ, SP	2579 N Pierce ST	Class B Tavern License	54	3/1/2021, 6:00 PM	1
12	Chamber East Food Two, Inc	Chamber East Food Two	Davinderjit Kaur, Agt	200 E Center ST	Class A Fermented Malt Beverage Retailer's License		7/23/2021, 7:00 PM	1
13	Mad Planet 2, LLC	The Mad Planet	ROSEMARY S SILAGY, Agt	533 E Center ST	Class B Tavern License		7/14/2021, 7:00 PM	1
14	Riverwest Pizza LLC	Riverwest Pizza	Todd A Fugh, Agt	932 E WRIGHT ST	Class B Tavern License	49	2/25/2021, 6:00 PM	1
15	Riverwest Public House Cooperative	Riverwest Public House Cooperative	Nicole M Kueppers, Agt	815 E LOCUST ST	Class B Tavern License	80	3/24/2021, 7:00 PM	1
16	Ludhiana Inc	Li'l General	KENNETH R HALSELL, Agt	233 W Center ST	Class A Fermented Malt Beverage Retailer's License		8/1/2021, 7:00 PM	1
17	Ludhiana Inc	Li'l General	KENNETH R HALSELL, Agt	233 W Center ST	Class A Retailer's Intoxicating Liquor License		8/1/2021, 7:00 PM	1

18	Fly By Night LLC	High Dive	JASON R MC BRADY, Agt	701 E Center ST	Class B Tavern License	67	7/26/2021, 7:00 PM	1
19	INDERPRI CORPORATION	CORNER LIQUOR II	AMANDEEP K DHINDSA, Agt	3079 N HOLTON ST	Class A Malt & Class A Liquor License		10/5/2020, 7:00 PM	1
20	CIRCLE A	CIRCLE A	JENNIFER A MUELLER, SP	932 E CHAMBERS ST	Class B Tavern License	49	10/11/2020, 7:00 PM	1
21	Chamber East Food Market LLC	Chamber East Food	Davinderjit Kaur, Agt	200 E Chambers ST	Class A Fermented Malt Beverage Retailer's License		4/20/2021, 7:00 PM	1
22	FOUNDATION BAR, INC	THE FOUNDATION	CHARLES JORDAN, Agt	2718 N BREMEN ST	Class B Tavern License	80	5/7/2021, 7:00 PM	1
23	INDERPRI CORPORATION	CORNER LIQUOR II	AMANDEEP K DHINDSA, Agt	3079 N HOLTON ST	Class A Malt & Class A Liquor License		10/5/2021, 7:00 PM	1
24	CIRCLE A	CIRCLE A	JENNIFER A MUELLER, SP	932 E CHAMBERS ST	Class B Tavern License	49	10/11/2021, 7:00 PM	1
25	Two P's in a Pod Inc	Bar Centro	MARGARET M KARPFINGER, Agt	804 E Center ST	Class B Tavern License		5/13/2021, 7:00 PM	1
26	BALVINDER JASPAL, INC.	Freedom Grocery	JASPAL SINGH, Agt	2909 N HOLTON ST	Class A Fermented Malt Beverage Retailer's License		4/15/2021, 7:00 PM	1
27	The 4th Quarter Sports Bar & Grill LLC	The 4th Quarter	Devida M Glover, Agt	2722 N MARTIN L KING JR DR	Class B Tavern License		9/20/2021, 7:00 PM	1
28	KISMAYO, LLC	CLUB TIMBUKTU	YOUSOUF KOMARA, Agt	520 E CENTER ST	Class B Tavern License	160	12/19/2020, 6:00 PM	1
29	ILLUMINATI, LLC	BREMEN CAFE	DAVID A KOPP, Agt	901 E CLARKE ST	Class B Tavern License	80	12/9/2020, 6:00 PM	1
30	Center Street Liquor Store Inc	Center Street Liquor Store	Charanjit Kaur, Agt	513 E Center ST	Class A Malt & Class A Liquor License		12/15/2020, 6:00 PM	1
31	LINNCO, INC	LINNEMAN'S RIVERWEST INN	JAMES A LINNEMAN, Agt	1001 E LOCUST ST	Class B Tavern License	160	12/16/2020, 6:00 PM	1
32	Midget Food LLC	Midget Food LLC	Nizar Y Alkhatib, Agt	2500 N Booth ST	Class A Fermented Malt Beverage Retailer's License		5/25/2021, 7:00 PM	1
33	Midget Food LLC	Midget Food LLC	Nizar Y Alkhatib, Agt	2500 N Booth ST	Class A Retailer's Intoxicating Liquor License		5/25/2021, 7:00 PM	1
34	TRACK'S OF MILWAUKEE, INC	THE TRACKS	Michael D Rebers, Agt	1020 E LOCUST ST	Class B Tavern License	99	6/29/2021, 7:00 PM	1
35	METRO ENTERPRISES, INC	QUARTERS	DANIEL FISCHER, Agt	900 E CENTER ST	Class B Tavern License	80	6/29/2021, 7:00 PM	1

36	Falcon Bowl	Falcon Bowl	R Lynn Okopinski, SP	801 E Clarke ST	Class B Tavern License	220	6/29/2021, 7:00 PM	1
37	Sutrick Family LLC	Nessun Dorma	Emily E Sutrick, Agt	2778 N Weil ST	Class B Tavern License	47	6/14/2021, 7:00 PM	1
38	KLINGER'S EAST, LLC	KLINGER'S EAST	GLEN F KLINGER, Agt	920 E LOCUST ST	Class B Tavern License	140	7/9/2021, 7:00 PM	1

Establishments within a 0.5 miles radius centered on area of interest.





Thursday, January 14, 2021

## Licenses Committee Notice of Hearing

Wilson A Fares & Rushdi O Hamdan  
8810 S Knollhaven DR  
Oak Creek, WI 53154

The Licenses Committee will consider the following license application:

Class A Malt, Food Dealer, and Weights & Measures License Applications  
KAUR, Parminder, Agent  
Tittu Rehmat Food at 418 E CENTER St

Date: 1/26/2021

Time: 10:10 AM

Location: The hearing before the Licenses Committee will take place virtually on Tuesday, January 26, 2021. This is a public hearing. Those wishing to view the proceeding are able to do so via the City Channel – Channel 25 on Spectrum Cable – or on the Internet at <http://city.milwaukee.gov/citychannel>. Those wishing to provide oral testimony will be asked to do so by phone or internet and are asked to contact the staff assistant, Molly Kuether-Steele at (414) 286-2775 or [molly.kuether-steele@milwaukee.gov](mailto:molly.kuether-steele@milwaukee.gov) for necessary information. Please make such requests no later than one business day prior to the start of the meeting. You are not required to attend the hearing, but please see the information below if you would like to provide testimony

Please note this application may be recommended for denial based on fitness of the location due to concentration of alcohol beverage outlets in the area. If the application is denied for this reason, no other application for an alcohol beverage license for this location shall be recommended for approval by the Licenses Committee within three years of the date of denial unless the applicant has demonstrated a change of circumstances since the prior denial.





Thursday, January 14, 2021

## Licenses Committee Notice of Hearing

Wilson A Fares & Rushdi O Hamdan  
2675 N HOLTON St  
MILWAUKEE, WI 53212

The Licenses Committee will consider the following license application:

Class A Malt, Food Dealer, and Weights & Measures License Applications  
KAUR, Parminder, Agent  
Tittu Rehmat Food at 418 E CENTER St

Date: 1/26/2021

Time: 10:10 AM

Location: The hearing before the Licenses Committee will take place virtually on Tuesday, January 26, 2021. This is a public hearing. Those wishing to view the proceeding are able to do so via the City Channel – Channel 25 on Spectrum Cable – or on the Internet at <http://city.milwaukee.gov/citychannel>. Those wishing to provide oral testimony will be asked to do so by phone or internet and are asked to contact the staff assistant, Molly Kuether-Steele at (414) 286-2775 or [molly.kuether-steele@milwaukee.gov](mailto:molly.kuether-steele@milwaukee.gov) for necessary information. Please make such requests no later than one business day prior to the start of the meeting. You are not required to attend the hearing, but please see the information below if you would like to provide testimony

Please note this application may be recommended for denial based on fitness of the location due to concentration of alcohol beverage outlets in the area. If the application is denied for this reason, no other application for an alcohol beverage license for this location shall be recommended for approval by the Licenses Committee within three years of the date of denial unless the applicant has demonstrated a change of circumstances since the prior denial.





Thursday, January 14, 2021



# Notice of Public Hearing

blank  
notice

---

KAUR, Parminder, Agent  
Tittu Rehmat Food at 418 E CENTER St  
Class A Malt, Food Dealer, and Weights & Measures License Applications

**Tuesday, January 26, 2021 at 10:10 AM**

To whom it may concern:

The above application has been made by the above named applicant(s). This requires approval from the Licenses Committee and the Common Council of the City of Milwaukee. The hearing before the Licenses Committee will take place virtually on 1/26/2021 at 10:10 AM. This is a public hearing. Those wishing to view the proceeding are able to do so via the City Channel – Channel 25 on Spectrum Cable – or on the Internet at <http://city.milwaukee.gov/citychannel>. Those wishing to provide oral testimony will be asked to do so by phone or internet and are asked to contact the staff assistant, Molly Kuether-Steele at (414) 286-2775 or [molly.kuether-steele@milwaukee.gov](mailto:molly.kuether-steele@milwaukee.gov) for necessary information. Please make such requests no later than one business day prior to the start of the meeting. You are not required to attend the hearing, but please see the information below if you would like to provide testimony. Once the Licenses Committee makes its recommendation, this recommendation is forwarded to the full Common Council for approval at its next regularly scheduled hearing.

---

## Important details for those wishing to provide information for the Licenses Committee to consider when making its recommendation:

1. The license application is scheduled to be heard at the above time. Due to other hearings running longer than scheduled, you may have to wait some time to provide your testimony.
2. You must testify as to matters that you have personally experienced or seen. (You cannot provide testimony for your neighbor, parent or anyone else; this is considered hearsay and cannot be considered by the committee.)
3. No letters or petitions can be accepted by the committee (unless the person who wrote the letter or the persons who signed the petition are willing to testify).
4. Persons opposed to the license application are given the opportunity to testify first; supporters may testify after the opponents have finished.
5. When you are called to testify, you will be sworn in and asked to give your name, and address. (If your first and/or last names are uncommon please spell them.)
6. You may then provide testimony.
  - a. Include only information relating to the above license application.
  - b. Include only information you have personally witnessed or seen.
  - c. Provide concise and relevant information detailing how this business has affected or may affect the peaceful enjoyment of your neighborhood.
  - d. If by the time you have the opportunity to testify, the information you wish to share has already been provided to the committee, you may state that you agree with the previous testimony. Redundant or repetitive testimony will not assist the committee in making its recommendation.
7. After giving your testimony, the members of the Licenses Committee and the licensee may ask questions regarding the testimony you have given or other factors relating to the license application.
8. Business Competition is not a valid basis for denial or non-renewal of a license.

**Please Note: If you have submitted an objection to the above application your objection cannot be considered by the committee unless you personally testify at the hearing.**



OCCUPANT	MAIL ADDRESS	CITY, STATE ZIP
CURRENT OCCUPANT	2731A N HOLTON ST	MILWAUKEE, WI 53212
CURRENT OCCUPANT	2740A N HOLTON ST	MILWAUKEE, WI 53212
CURRENT OCCUPANT	2740 N HOLTON ST	MILWAUKEE, WI 53212
CURRENT OCCUPANT	2753 N HOLTON ST	MILWAUKEE, WI 53212
CURRENT OCCUPANT	2716A N BUFFUM ST	MILWAUKEE, WI 53212
CURRENT OCCUPANT	2710 N BUFFUM ST	MILWAUKEE, WI 53212
CURRENT OCCUPANT	2669A N HOLTON ST	MILWAUKEE, WI 53212
CURRENT OCCUPANT	2663A N HOLTON ST	MILWAUKEE, WI 53212
CURRENT OCCUPANT	2676 N HOLTON ST A	MILWAUKEE, WI 53212
CURRENT OCCUPANT	320 E CENTER ST 102	MILWAUKEE, WI 53212
CURRENT OCCUPANT	320 E CENTER ST 209	MILWAUKEE, WI 53212
CURRENT OCCUPANT	320 E CENTER ST 210	MILWAUKEE, WI 53212
CURRENT OCCUPANT	320 E CENTER ST 303	MILWAUKEE, WI 53212
CURRENT OCCUPANT	320 E CENTER ST 308	MILWAUKEE, WI 53212
CURRENT OCCUPANT	2733 N BOOTH ST	MILWAUKEE, WI 53212
CURRENT OCCUPANT	2741 N HOLTON ST	MILWAUKEE, WI 53212
CURRENT OCCUPANT	2744A N HOLTON ST	MILWAUKEE, WI 53212
CURRENT OCCUPANT	2752 N HOLTON ST	MILWAUKEE, WI 53212
CURRENT OCCUPANT	2717A N HOLTON ST	MILWAUKEE, WI 53212
CURRENT OCCUPANT	2705 N HOLTON ST	MILWAUKEE, WI 53212
CURRENT OCCUPANT	320 E CENTER ST 101	MILWAUKEE, WI 53212
CURRENT OCCUPANT	320 E CENTER ST 202	MILWAUKEE, WI 53212
CURRENT OCCUPANT	320 E CENTER ST 203	MILWAUKEE, WI 53212
CURRENT OCCUPANT	320 E CENTER ST 207	MILWAUKEE, WI 53212
CURRENT OCCUPANT	320 E CENTER ST 400	MILWAUKEE, WI 53212
CURRENT OCCUPANT	2675 N BUFFUM ST	MILWAUKEE, WI 53212
CURRENT OCCUPANT	2731 N HOLTON ST	MILWAUKEE, WI 53212
CURRENT OCCUPANT	2731 N BOOTH ST	MILWAUKEE, WI 53212
CURRENT OCCUPANT	2741A N HOLTON ST	MILWAUKEE, WI 53212
CURRENT OCCUPANT	2744A N BUFFUM ST	MILWAUKEE, WI 53212
CURRENT OCCUPANT	2745 N HOLTON ST	MILWAUKEE, WI 53212
CURRENT OCCUPANT	2723 N BOOTH ST	MILWAUKEE, WI 53212
CURRENT OCCUPANT	2723A N BOOTH ST	MILWAUKEE, WI 53212
CURRENT OCCUPANT	2717 N BOOTH ST	MILWAUKEE, WI 53212
CURRENT OCCUPANT	2669B N HOLTON ST	MILWAUKEE, WI 53212
CURRENT OCCUPANT	506 E CENTER ST	MILWAUKEE, WI 53212
CURRENT OCCUPANT	320 E CENTER ST 103	MILWAUKEE, WI 53212
CURRENT OCCUPANT	320 E CENTER ST 204	MILWAUKEE, WI 53212
CURRENT OCCUPANT	320 E CENTER ST 211	MILWAUKEE, WI 53212
CURRENT OCCUPANT	320 E CENTER ST 407	MILWAUKEE, WI 53212
CURRENT OCCUPANT	320 E CENTER ST 408	MILWAUKEE, WI 53212
CURRENT OCCUPANT	320 E CENTER ST 100	MILWAUKEE, WI 53212
CURRENT OCCUPANT	2737A N HOLTON ST	MILWAUKEE, WI 53212
CURRENT OCCUPANT	2736 N BUFFUM ST	MILWAUKEE, WI 53212
CURRENT OCCUPANT	2748A N HOLTON ST	MILWAUKEE, WI 53212
CURRENT OCCUPANT	2753A N HOLTON ST	MILWAUKEE, WI 53212

CURRENT OCCUPANT	2725 N BOOTH ST	MILWAUKEE, WI 53212
CURRENT OCCUPANT	2678 N HOLTON ST	MILWAUKEE, WI 53212
CURRENT OCCUPANT	2672 N HOLTON ST A	MILWAUKEE, WI 53212
CURRENT OCCUPANT	510 E CENTER ST	MILWAUKEE, WI 53212
CURRENT OCCUPANT	320 E CENTER ST 205	MILWAUKEE, WI 53212
CURRENT OCCUPANT	320 E CENTER ST 411	MILWAUKEE, WI 53212
CURRENT OCCUPANT	2737 N BOOTH ST	MILWAUKEE, WI 53212
CURRENT OCCUPANT	2740 N BUFFUM ST	MILWAUKEE, WI 53212
CURRENT OCCUPANT	2709 N HOLTON ST	MILWAUKEE, WI 53212
CURRENT OCCUPANT	505 E CENTER ST	MILWAUKEE, WI 53212
CURRENT OCCUPANT	320 E CENTER ST 301	MILWAUKEE, WI 53212
CURRENT OCCUPANT	320 E CENTER ST 409	MILWAUKEE, WI 53212
CURRENT OCCUPANT	2737 N HOLTON ST	MILWAUKEE, WI 53212
CURRENT OCCUPANT	2736A N HOLTON ST	MILWAUKEE, WI 53212
CURRENT OCCUPANT	2740A N BUFFUM ST	MILWAUKEE, WI 53212
CURRENT OCCUPANT	2744 N BUFFUM ST	MILWAUKEE, WI 53212
CURRENT OCCUPANT	2744 N HOLTON ST	MILWAUKEE, WI 53212
CURRENT OCCUPANT	2749 N HOLTON ST	MILWAUKEE, WI 53212
CURRENT OCCUPANT	2748 N HOLTON ST	MILWAUKEE, WI 53212
CURRENT OCCUPANT	2723B N BOOTH ST	MILWAUKEE, WI 53212
CURRENT OCCUPANT	2716 N BUFFUM ST	MILWAUKEE, WI 53212
CURRENT OCCUPANT	2675 N HOLTON ST	MILWAUKEE, WI 53212
CURRENT OCCUPANT	2657 N HOLTON ST	MILWAUKEE, WI 53212
CURRENT OCCUPANT	430 E CENTER ST	MILWAUKEE, WI 53212
CURRENT OCCUPANT	2664 N HOLTON ST	MILWAUKEE, WI 53212
CURRENT OCCUPANT	512 E CENTER ST	MILWAUKEE, WI 53212
CURRENT OCCUPANT	320 E CENTER ST 208	MILWAUKEE, WI 53212
CURRENT OCCUPANT	320 E CENTER ST 305	MILWAUKEE, WI 53212
CURRENT OCCUPANT	320 E CENTER ST 311	MILWAUKEE, WI 53212
CURRENT OCCUPANT	320 E CENTER ST 410	MILWAUKEE, WI 53212
CURRENT OCCUPANT	2737 N BUFFUM ST	MILWAUKEE, WI 53212
CURRENT OCCUPANT	518 E CENTER ST	MILWAUKEE, WI 53212
CURRENT OCCUPANT	2710B N BUFFUM ST	MILWAUKEE, WI 53212
CURRENT OCCUPANT	2710A N BUFFUM ST	MILWAUKEE, WI 53212
CURRENT OCCUPANT	2665 N HOLTON ST	MILWAUKEE, WI 53212
CURRENT OCCUPANT	2668 N HOLTON ST	MILWAUKEE, WI 53212
CURRENT OCCUPANT	2668A N HOLTON ST	MILWAUKEE, WI 53212
CURRENT OCCUPANT	504 E CENTER ST	MILWAUKEE, WI 53212
CURRENT OCCUPANT	514A E CENTER ST	MILWAUKEE, WI 53212
CURRENT OCCUPANT	320 E CENTER ST 105	MILWAUKEE, WI 53212
CURRENT OCCUPANT	320 E CENTER ST 206	MILWAUKEE, WI 53212
CURRENT OCCUPANT	320 E CENTER ST 307	MILWAUKEE, WI 53212
CURRENT OCCUPANT	320 E CENTER ST 310	MILWAUKEE, WI 53212
CURRENT OCCUPANT	2677 N BUFFUM ST	MILWAUKEE, WI 53212
CURRENT OCCUPANT	2739 N BOOTH ST	MILWAUKEE, WI 53212
CURRENT OCCUPANT	2752 N BUFFUM ST	MILWAUKEE, WI 53212
CURRENT OCCUPANT	2752A N HOLTON ST	MILWAUKEE, WI 53212

CURRENT OCCUPANT	427 E CENTER ST	MILWAUKEE, WI 53212
CURRENT OCCUPANT	2674 N HOLTON ST	MILWAUKEE, WI 53212
CURRENT OCCUPANT	2662 N HOLTON ST	MILWAUKEE, WI 53212
CURRENT OCCUPANT	320 E CENTER ST 104	MILWAUKEE, WI 53212
CURRENT OCCUPANT	320 E CENTER ST 106	MILWAUKEE, WI 53212
CURRENT OCCUPANT	320 E CENTER ST 200	MILWAUKEE, WI 53212
CURRENT OCCUPANT	320 E CENTER ST 201	MILWAUKEE, WI 53212
CURRENT OCCUPANT	320 E CENTER ST 300	MILWAUKEE, WI 53212
CURRENT OCCUPANT	320 E CENTER ST 302	MILWAUKEE, WI 53212
CURRENT OCCUPANT	320 E CENTER ST 304	MILWAUKEE, WI 53212
CURRENT OCCUPANT	320 E CENTER ST 306	MILWAUKEE, WI 53212
CURRENT OCCUPANT	320 E CENTER ST 309	MILWAUKEE, WI 53212
CURRENT OCCUPANT	325 E CENTER ST	MILWAUKEE, WI 53212

blank notice

Total Records: 106

Radius: 250.0 feet and Center of Circle: 418 E Center St



# BUSINESS LICENSE PLAN OF OPERATION

ccl-busplan 5/12/2020

Office of the City Clerk License Division  
200 E. Wells St. Room 105, Milwaukee, WI 53202  
(414) 286-2238 www.milwaukee.gov/license e-mail address: license@milwaukee.gov

## 1. Type of Business

Applying for:  Extended Hours (12AM to 5AM) - If a food establishment, check all that apply:  Delivery  Drive Thru  Dining Room  
 Self Service Laundry  Massage Establishment  Filling Station  
 Other (supplemental application for specific license also required)

Provide a detailed description of the type of business you plan on operating: CONVENIENCE STORE

Do you have any experience operating this type of business?  No  Yes If yes, explain:

## 2. Business Operations

- a. Proposed Opening Date: 10/01/2020
- b. Is this premise under construction?  No  Yes If yes, list estimated completion date: \_\_\_\_\_
- c. Is this a franchise?  No  Yes
- d. Is this premises currently licensed?  No  Yes If yes, list type of license: Food, Cig, Class A Malt, W&M, Occupanc
- e. Is the current licensee operating?  No  Yes If no, list date closed: \_\_\_\_\_
- f. Do you have future plans for other businesses, licenses or permits at this location?  No  Yes  
If yes, explain: \_\_\_\_\_
- g. Have you previously held an Extended Hours License in Milwaukee?  No  Yes  
If yes, list address(es): \_\_\_\_\_
- h. Are other businesses operating in the same building?  No  Yes If yes, describe: \_\_\_\_\_

## 3. Litter & Noise

- a. How are grounds kept clean?  Sweep  Pressure Wash  Pick Up Litter  Other: \_\_\_\_\_
- b. How often will grounds be cleaned?  Daily  Weekly  As Needed  Monthly  Other: \_\_\_\_\_
- c. Grounds cleaned by:  Licensee  Building Owner  Employees  Hired Maintenance  Other: \_\_\_\_\_
- d. How are noise issues prevented and/or addressed?  Security  Manager approaches customer(s)  Call Police  
 Signs Posted  Other: \_\_\_\_\_
- e. Will a sound amplification system be used?  No  Yes If yes, describe: \_\_\_\_\_

## 4. Smoking & Sanitation

- a. Are there designated outdoor smoking areas?  No  Yes If yes, describe: \_\_\_\_\_
- b. Number of Garbage Cans: Inside: 3 Locations: By Cash Register, Deli Area and Restroom  
Outside: 1 Locations: By Front Door Outside
- c. Is a crowd control barrier used?  No  Yes If yes, describe: \_\_\_\_\_
- d. How many restrooms are on the premises? 1
- e. Name of solid waste contractor:  Advanced Disposal  Waste Management  Other: \_\_\_\_\_

### 5. Security

- a. Are there onsite parking spaces?  No  Yes If yes, how many? 5 and describe the parking security plan: Security Camera monitors parking lot 24/7
- b. Is there a loading zone?  No  Yes If yes, describe the loading area security plan: \_\_\_\_\_
- c. Will you have security personnel on premise?  No  Yes If yes, how many? \_\_\_\_\_ and answer the following:  
 What are their responsibilities? \_\_\_\_\_  
 Is security equipment used?  No  Yes If yes, describe \_\_\_\_\_  
 List their licensing, certification, or training credentials \_\_\_\_\_
- d. Will there be security cameras?  No  Yes If yes, how many? 16 and list locations: Monitors Inside and store surroundings 24/7
- e. Will searches/identification checks be done upon entry?  No  Yes If yes, describe \_\_\_\_\_

### 6. Percentage of Sales (must total 100%)

Alcohol <u>15</u> %	Food <u>50</u> %	Secondhand Merchandise _____%	Precious Metals & Gems _____%
Entertainment _____%	Cigarettes <u>30</u> %	Personal Services (such as tattoo, body piercing, salon, tailor, tanning, etc.) _____%	Other <u>5</u> % Describe: <u>lottery</u>
Pawnbroker Activity _____%	Salvaged Materials _____% (such as scrap metal)		

### 7. Businesses/Licenses on the Premises (check all that apply):

#### Type 1

- Full Service Restaurant     Cafe/Coffee Shop     Deli or Fast Food Restaurant     Private/Fraternal/Veterans Club
- Night Club     Tavern     Cocktail Lounge     Teen Club
- Banquet Hall     Sports Facility     Bowling Alley
- Hotel/Motel: Number of Floors: \_\_\_\_\_     Rooming House: Number of Floors: \_\_\_\_\_  
 Number of Rooms: \_\_\_\_\_    Number of Rooms: \_\_\_\_\_

#### Type 2

- Liquor Store     Corner Store     Supermarket     Convenience Store
- Gas Station     Amusement/Phonograph Distributor     Recycling, Salvage or Towing
- Used Car Dealer     Personal Service Establishment  
(such as tattoo business, hair salon, tailor, etc.)     Recording Studio

What other licenses/permits will you hold at this location? (check all that apply)

- Occupancy Permit     Cigarette & Tobacco     Gas Station     Extended Hours     Class "B" Tavern     Weights & Measures
- Secondhand Dealer     Precious Metal & Gem     Other: \_\_\_\_\_

### 8. Legal Capacity (only if a Type 1 premises in #7 above)

Capacity n/a (Call the Milwaukee Development Center at 414-286-8211 if you have questions.)

## 9. Premises Description

- a. Identify all area(s) of the premises that will be used in operating this business (include areas used only for storage):  
 1<sup>st</sup> Floor  2<sup>nd</sup> Floor  Basement Storage  Patio  Beer Garden  Sidewalk Café  Deck  Rooftop  
 Other: Describe: \_\_\_\_\_
- b. Describe Location:  Major Thoroughfare  Secondary Street  Other: \_\_\_\_\_
- c. Nearest Major Cross Street: Center St and Holton St
- d. Describe Building:  Free Standing Building  Strip Mall  Other: \_\_\_\_\_
- e. Describe Premises Structure:  Single Story  Multi-Story - # of Stories \_\_\_\_\_  Other: \_\_\_\_\_
- f. Describe Surrounding Area:  Commercial  Residential  Industrial  Other: \_\_\_\_\_
- g. Building Owner Name: Wilson A Fares and Rushdl Hamdan Phone Number: 414-766-4186  
 Building Owner Address: 2675 N Holton St, Milwaukee, WI 53212

## 10. Hours of Operation & Customers

Will customers be entering the premises?  No  Yes

Day of the Week	Proposed Hours of Operation:		Estimated Number of Customers expected each day	Potential Age Range of Customers	Class B Tavern Applicant Only: Age Restriction (If none, write 'None')
	Open Time (Include a.m. or p.m.)	Close Time (Include a.m. or p.m.)			
Sunday	8:00 am	9:00 pm	200	all	none
Monday	8:00 am	9:00 pm	200	all	none
Tuesday	8:00 am	9:00 pm	200	all	none
Wednesday	8:00 am	9:00 pm	200	all	none
Thursday	8:00 am	9:00 pm	200	all	none
Friday	8:00 am	9:00 pm	200	all	none
Saturday	8:00 am	9:00 pm	200	all	none

An Extended Hours Establishment License is required for any convenience store, filling station, personal service establishment (such as tattoo, body piercing, salon, taylor, tanning, etc.), recording studio or restaurant which is open between the hours of 12:00 a.m. and 5:00 a.m.

Alcohol Establishments Permitted Hours of Operation: Class A: 8:00 am to 9:00 pm Sunday thru Saturday  
 Class B: 6:00 am to 2:00 am Sunday thru Thursday, 6:00 am to 2:30 am Friday & Saturday

Entertainment Outdoor Closing Hours: 10:00pm Sunday-Thursday; 12:00am Friday & Saturday; unless a different time, either earlier or later, is established by the Common Council in its approval of the licensee's plan of operation.

## 11. Signature(s)

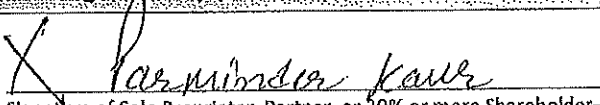
  
 Signature of Sole Proprietor, Partner, or 20% or more Shareholder  
 (If there are no 20% or more shareholders,  
 Corporate Officer - print name/title and sign)

\_\_\_\_\_  
 Signature of additional partner or 20% or more shareholder

See Application Information for a complete list of all required application forms.



## ALCOHOL BEVERAGE & PUBLIC ENTERTAINMENT PREMISES SUPPLEMENTAL APPLICATION

Office of the City Clerk License Division  
200 E. Wells St. Room 105, Milwaukee, WI 53202  
(414) 286-2238 e-mail address: llcense@milwaukee.gov [www.milwaukee.gov/license](http://www.milwaukee.gov/license)

Legal Entity Name: TITTU REHMAT FOOD INC.

Premise Address: 418 E CENTER STREET, MILWAUKEE, WI 53212

### Proximity of Premises to Church, School, Daycare Center or Hospital

Is the building within 300 feet of any church, school, daycare center or hospital?  No  Yes

### "Service Bar Only" Designation

If applying for Class B or C license, are you applying for "Service Bar Only"?  No  Yes

Service Bar Only means customers cannot sit at the bar. Alcohol is served to employees who serve patrons seated at tables. No stools, chairs or other articles of furniture shall be placed at the service bar for patrons to sit upon.

### Business Information

a) Are you taking out this application for anyone that may not be eligible for a license?  No  Yes

If yes, list their name and address: \_\_\_\_\_

b) Will the agent, a partner or the individual licensee be conducting the day-to-day operations of the business?  No  Yes

If no, list the name and address of the person(s) who will: \_\_\_\_\_

Class B Applicants: If the agent, a partner or the individual licensee will not be conducting the day-to-day operations of the business, the person(s) listed above must obtain a Class B Managers license.

c) Does anyone else have money invested or any other interest in this business?  No  Yes

If yes, explain: \_\_\_\_\_

d) Have you made an agreement with anyone to repay any loan or any other payments based upon income from the business?

No  Yes If yes, list name and address: \_\_\_\_\_

### Property Information (New & Transfer Applicants Only)

a) Do you own or lease the building?  Own  Lease

b) Who owns the fixtures (for example, coolers, etc.)? TITTU REHMAT FOOD INC.

c) Are you purchasing the stock and/or fixtures?  No  Yes If yes, amount paid \$ 8000

d) Total amount paid for business \$ 0

e) Total amount paid for goodwill of the business \$ 0

Goodwill comprises the reputation and customer relationships of an existing business. If the price you pay for the business exceeds the fair market value of all of the rest of the assets of the business, the excess may be considered goodwill.

f) Have you made arrangements with the seller for payment of personal property taxes?  No  Yes

### Lease Information (New & Transfer Applicants who are leasing the premises only)

a) Date lease begins 01/01/2021 Ends 12/31/2026

b) Monthly rental \$ 2000

c) Do you have an option to renew the lease?  No  Yes

d) Does your lease allow for assignment to another party without the consent of the owner?  No  Yes

e) For what length of time have you been guaranteed occupancy (number of years)? 5

**Lease Information (Continued)**

- f) In addition to paying the monthly rental, will you have to pay anything additional to the owner of the building to guarantee performance of the lease?  No  Yes If yes, explain \_\_\_\_\_
- g) Does the present owner or occupancy object to the granting of your license?  No  Yes  
If yes, explain \_\_\_\_\_

**Change of Agent Applicants Only**

Have there been any changes to the floor plan since the last application was submitted?  No  Yes  
If no, a new floor plan is not required. If yes, submit a new floor plan and explain the change(s):  
\_\_\_\_\_

**Signature**

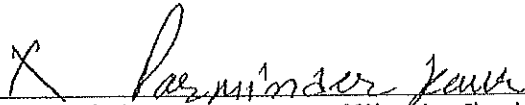

Signature of Sole Proprietor, Partner or 20% or More Shareholder  
(If no 20% or more Shareholder, Corporate Officer - print name/title and sign)

Note: All information contained in this application is subject to approval by the Common Council.  
Deviating from approved plan of operation will subject licensee to citations, and/or suspension or non-renewal of the license.  
Contact the License Division for information on how to request changes.

**New and transfer of premises applicants must submit the following:**

- Detailed floor plan
- If a restaurant, copy of the menu





# FOOD DEALER LICENSE PLAN OF OPERATION

ccl-foodplan 2/28/19

OFFICE OF THE CITY CLERK, LICENSE DIVISION  
CITY HALL, 200 E. WELLS ST, ROOM 105, MILWAUKEE, WI 53202  
(414) 286-2238 • [license@milwaukee.gov](mailto:license@milwaukee.gov) • [www.milwaukee.gov/license](http://www.milwaukee.gov/license)

Legal Entity Name: **TITU REHMAT FOOD INC**

Premises Address: **418 E CENTER ST, MILWAUKEE, WI 53212**

## SECTION 1 TYPE OF BUSINESS

What will be the majority of your food sales? (check one)

Restaurant Items (meals):

MEALS include, but are not limited to, chicken, ribs, sandwiches, roasted corn, baked potatoes, hot dogs, brats, tacos, nachos w/ cheese and meat, French fries, cooked or deep fried vegetables/fruit, cooked cheese curds, corn dogs, egg rolls, salads.

Retail Items (snacks and beverages):

RETAIL items include, but are not limited to, ice cream/soft serve, lemonade, snow cones, coffee, espresso, cappuccino, tea, fruit juice, smoothies, candy, dispensed soda, fruit cups, bakery, cookies, kettle corn, cotton candy, funnel cakes, fritters, tortilla chips w/ cheese.

Will it be a convenience store?  Yes  No

A convenience store contains less than 5,000 square feet of retail space and has, as its primary business, the sale of basic food items and in addition, sells household products or is a filling station that sells basic food items and household products.

Bed & Breakfast

Micro Market

All Applicants: Submit a menu or a list of food items that will be sold.

Will any wholesale business be done?  No  Yes If yes, what percentage of food sales will be wholesale?

Less than 25%

25% or More AND:

Restaurant Items (meals) will be sold – Complete this application and also contact DATCP.

NO restaurant items (meals) will be sold - Do NOT complete this application. Contact DATCP only.

## SECTION 2 FOOD PROCESSING

Will any food processing be done?  No  Yes

Processing is defined as assembling, grinding, cutting, mixing, baking, coating, stuffing, packing, bottling, grilling, canning, extracting, fermenting, distilling, pickling, freezing, drying, smoking, or packaging.

## SECTION 3 FOOD REQUIRING TEMPERATURE CONTROL

Will any food that requires temperature control be sold?  No  Yes

(Includes dairy products such as milk, cheese, and ice cream, fish, shellfish, meat, poultry)

If yes, list the types of food items: MILK, CHEESE, ICE CREAM, MEAT

**SECTION 4 DETAILS OF OPERATION**

Will you have seating on site for dining?  No  Yes

Will you be doing any catering?  No  Yes

Will you be doing any delivery?  No  Yes

Will you have outdoor activities?  No  Yes - Check all that apply:  Bar  Cooking/Grilling  Dining

Will you have a drive thru window?  No  Yes - Are hours different from inside?  No  Yes  
 If Yes, provide drive thru hours: \_\_\_\_\_

Will scales or barcode scanners be used?  No  Yes - You must also apply for a Weights & Measures License.

**SECTION 5 ADDITIONAL SITES**

Where will food be prepared and/or sold?  
 At a single site  At multiple sites: How many? \_\_\_\_\_ (for example, a hotel with several dining rooms or bars)  
 If multiple sites, attach a Food Dealer Additional Site Addendum (ccl-foodadd) for each additional site.

**SECTION 6 CONSTRUCTION OR CHANGES**

Are you planning any construction, remodeling or equipment changes?  
 No If No, SKIP to Section 8  
 Yes If Yes, check all that apply:  New construction of a building  Renovation or remodeling  
 Construction changes to existing building  Equipment changes only

Provide a brief description of the changes: \_\_\_\_\_

Start date: \_\_\_\_\_

Name, Address & Phone Number of Architect: \_\_\_\_\_

Name, Address & Phone Number of Contractor: \_\_\_\_\_

**SECTION 7 ALCOHOL BEVERAGES**

Are you applying for an alcohol beverage license?  
 No If No, SKIP to Section 8  
 Yes If YES, if your food license is approved prior to the alcohol license, when do you want the food license issued?  
 Immediately  At the same time as the alcohol license

**SECTION 8 ACKNOWLEDGEMENTS & SIGNATURE**

You must initial each item confirming your understanding:

*las* I understand the Health Department must conduct an inspection and advise the License Division of their approval before the license may be issued.

*las* I understand I must obtain an occupancy permit from the Department of Neighborhood Services and an inspection may be required. Neighborhood Services must advise the License Division of their approval before the license may be issued.

*las* I understand the district alderperson will review and either support or object to my application. If he/she objects, I may appeal and be scheduled to appear before the Licenses Committee. The Licenses Committee will then make a recommendation to the Common Council. The Common Council must grant the license before it may be issued.

*las* I understand proof of payment for all license fees must be on file in the License Division before the license may be issued and the license must be issued and posted in my establishment prior to opening for business.

*las* I will not operate my food business until the license has been issued and posted in the establishment.

Signature of Sole Proprietor, Partner, or 20% Shareholder: X *Harvinder Kaur*

Signature of Additional Partner: \_\_\_\_\_



**WEIGHTS & MEASURES PLAN OF OPERATION**

cci-wmplan 1/9/18

Office of the City Clerk License Division  
200 E. Wells St. Room 105, Milwaukee, WI 53202  
(414) 286-2238 [www.milwaukee.gov/license](http://www.milwaukee.gov/license) [license@milwaukee.gov](mailto:license@milwaukee.gov)

Legal Entity Name: TITU REHMAT FOOD INC

Premise Address: 418 E CENTER ST. MILWAUKEE WI 53212

**Type of Business**

Provide a brief description of the establishment/business:

CONVENIENCE STORE

*Other licenses may be required depending on the type of business you are operating.*

**Litter & Noise**

- a. How are grounds kept clean?  Sweep  Pressure Wash  Pick Up Litter  Other: \_\_\_\_\_
- b. How often will grounds be cleaned?  Daily  Weekly  As Needed  Monthly  Other: \_\_\_\_\_
- c. Grounds cleaned by:  Licensee  Building Owner  Employees  Hired Maintenance  Other: \_\_\_\_\_
- d. How are noise issues prevented and/or addressed?  Security  Manager approaches customer(s)  Call Police  
 Signs Posted  Other: \_\_\_\_\_

**Signature**

X Parminder Kaur  
Signature of Sole Proprietor, Partner, or 20% or more Shareholder  
(If there are no 20% or more shareholders,  
Corporate Officer-print name/title and sign)

\_\_\_\_\_  
Signature of additional partner or 20% or more shareholder

*This form must be submitted with the Business License Application, Weights & Measures License Supplemental Application, and appropriate fee. Forms can be obtained online at [www.milwaukee.gov/licenses](http://www.milwaukee.gov/licenses).*



E CENTER ST

32 FEET WIDTH



15 HOLTON ST

84 FEET LENGTH

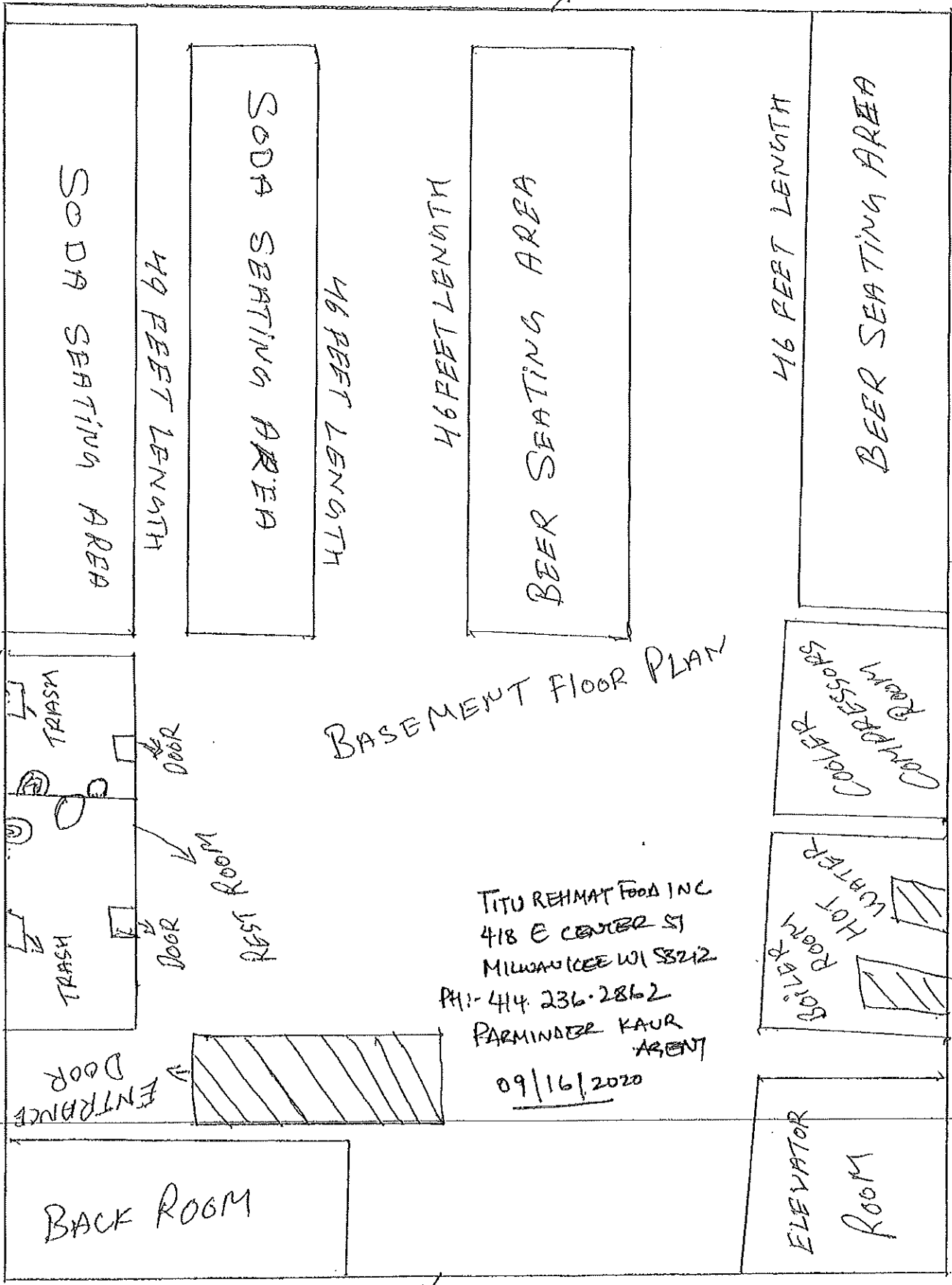

# BASEMENT FLOOR PLAN

TITU REHMAT FOOD INC  
 418 E CENTER ST  
 MILWAUKEE WI 53212  
 PH: 414.236.2862  
 PARMINDER KAUR  
 AGENT

09/16/2020

32 FEET WIDTH

84 FEET LENGTH

Wilson Fares  
414-975-0263  
Wfares01@gmail.com

January 25, 2021

Milwaukee Licenses Committee  
Attn: Molly Kuether-Steele  
City Hall  
200 East Wells Street  
Milwaukee, WI 53202  
Phone: 414-286-2775  
Fax: 414-286-3456  
[molly.kuether-steele@milwaukee.gov](mailto:molly.kuether-steele@milwaukee.gov)

Dear Milwaukee Licenses Committee:

My name is Wilson Fares, I am the owner of the building on 418 East Center Street in Milwaukee, Wisconsin. I have owned the building since 1985 and for over 20 years my partner and I ran a successful grocery store business, with fresh produce, dairy, fresh meats, a deli, beer and household goods. After selling the business we leased the building to a similar business which ran for the last 15 years. As you can see, for over 35 years under my ownership of the premises, this building has provided the local community with a source for groceries, fresh produce, dairy, household goods and specialty Hispanic food items, along with beer. Denying a class A malt and food dealer license to Tittu Rehmat Food would mean that the building would remain vacant, no other business would lease the space, and the community would have one less source for groceries in the area not to mention another closed business, another vacant building, and less tax revenue.

I ask that you please consider granting the class A malt, food dealer weights and measurements license to Tittu Foods so that they may continue the success of this property and provide an opportunity to continue to serve the surrounding community.

Thank you for your time and consideration. I welcome any questions or concerns you may have. Please feel free to contact me any time.

Sincerely,

Wilson Fares