

# LRIP 2008-2009 Possible projects

Location	Proposed pavement	Estimated cost	Thickness	Length	Width	L..	Width	F.C.	Rating	ADT
N. 13th St. - W. Highland Av. to W. Galena St.	Asphalt Surface	\$ 350,000	3"	2500'	40'	(2)	12'	Min. A.	6.0	1200
N. 27th St. - W. Villard Av. to W. Silver Spring Dr.	Asphalt Surface	\$ 460,000	3"	2700'	44'	(2)	12'	Local	4.9	750
N. 34th St. - W. Brown St. to W. North Av.	Asphalt Surface, C&G	\$ 230,000	3"	1600'	30'	(2)	11'	Local	4.6	750
N. 58th St. - W. Keefe Av. to W. Vienna Av.	Asphalt Surface	\$ 190,000	3"	1300'	36'	(2)	12'	Local	6.1	750
S. 58th St. - W. Morgan Av. to W. Ohio Av.	Asphalt Surface	\$ 150,000	3"	1600'	30'	(2)	11'	Local	4.8	750
W. Melvina St. - N. 60th St. to N. 68th St.	Asphalt Surface	\$ 400,000	3"	2700'	30'	(2)	11'	Local	4.7	750
W. Ohio Av. - S. 76th St. to S. 84th St.	Asphalt Surface	\$ 275,000	3"	2600'	34'	(2)	12'	Local	4.6	750
N. Warren Av. - E. Brady St. to E. Boyston St.	Asphalt Surface, C&G	\$ 250,000	3"	1700'	38'	(2)	11'	Local	5.3	750
<b>Total</b>		\$ 2,305,000								

8/23/07  
MLD

N 13TH ST  
W HIGHLAND AVE TO W GALENA ST

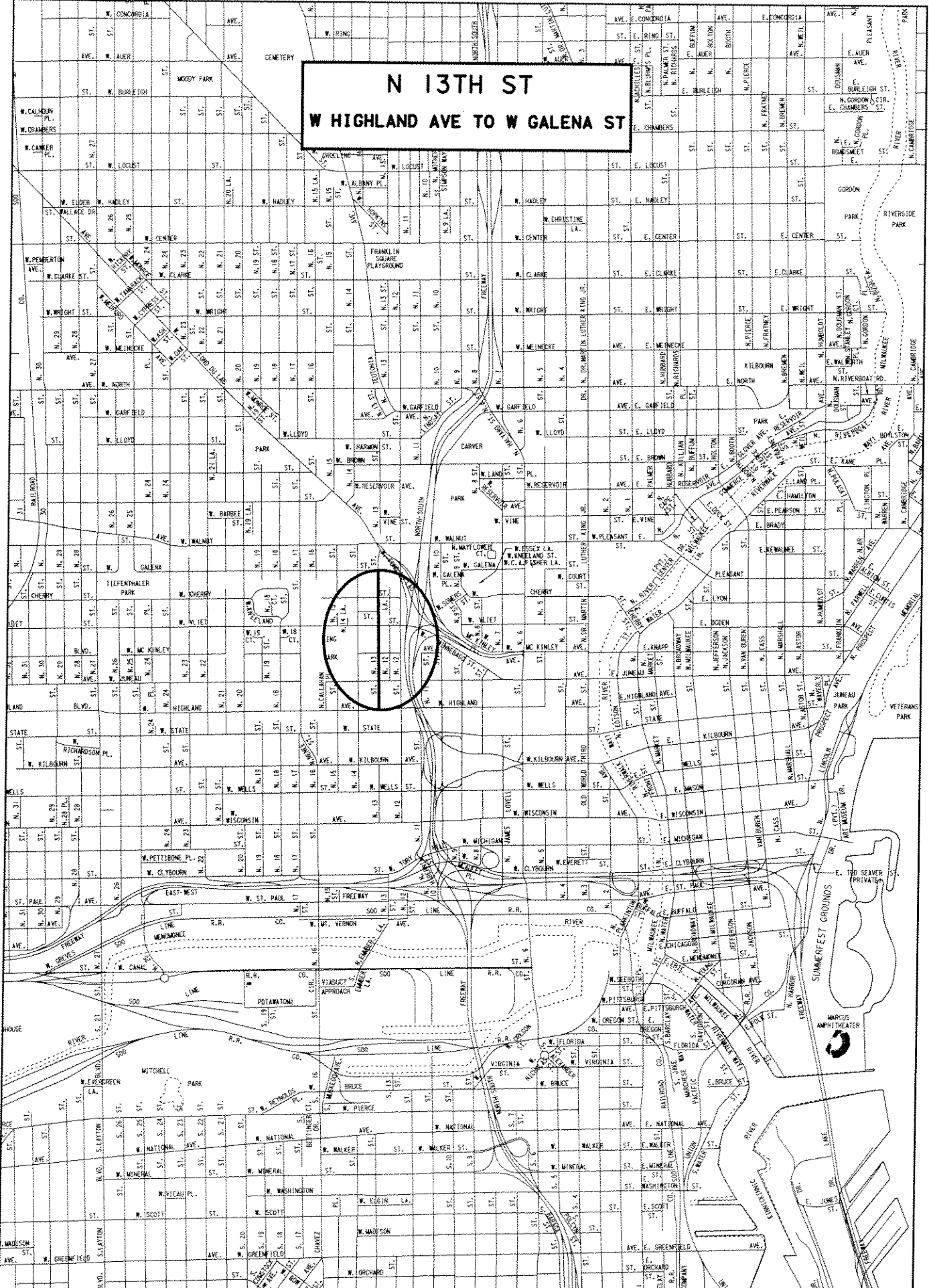

N 27TH ST

6400

W VILLARD AVE TO W SILVER SPRING DR

6000

1300

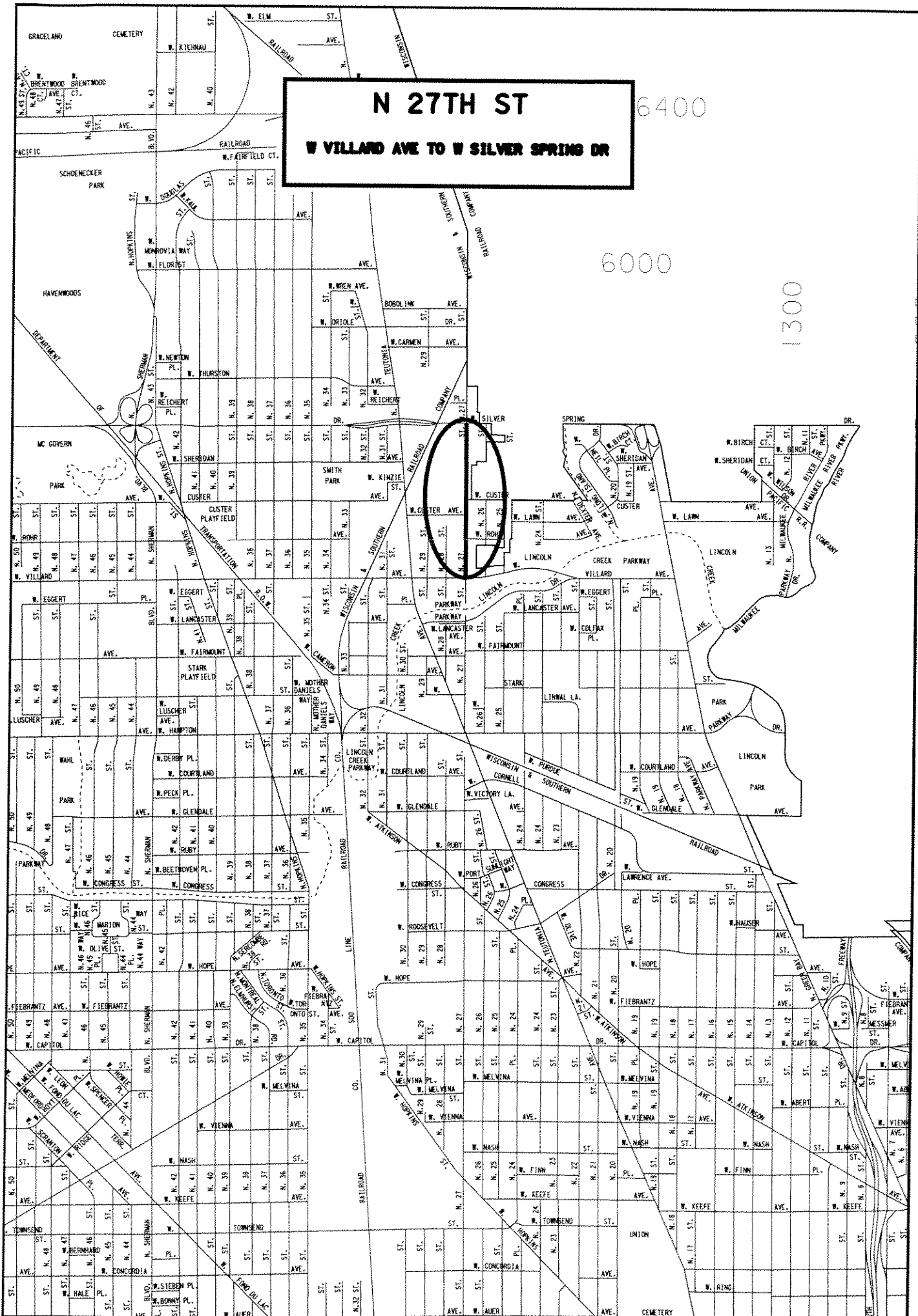

**N 34TH ST**  
**W BROWN ST TO W NORTH AVE**

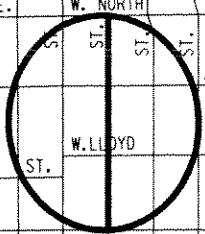
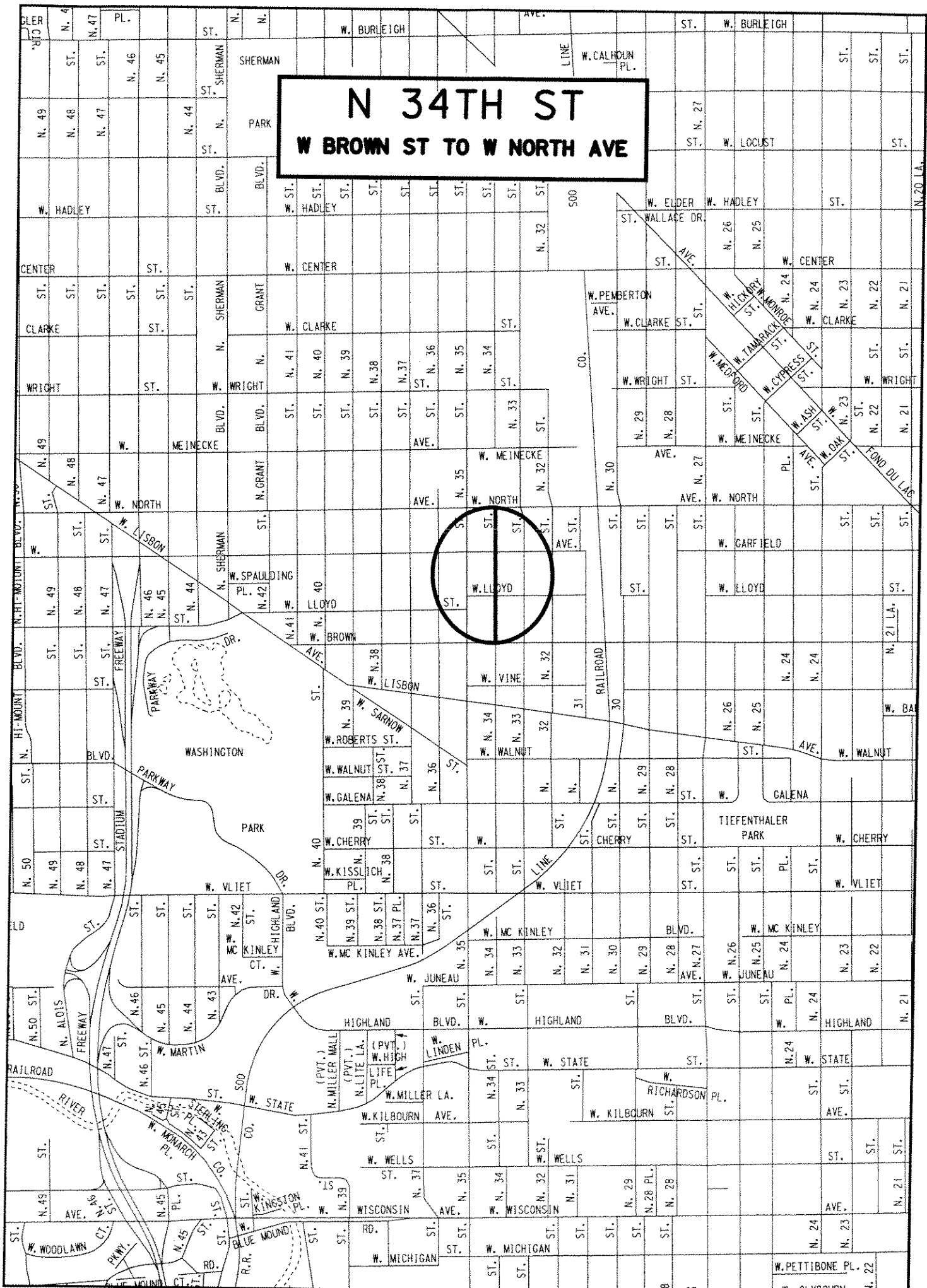



**S 58TH ST**  
**W MORGAN AVE TO W OHIO AVE**

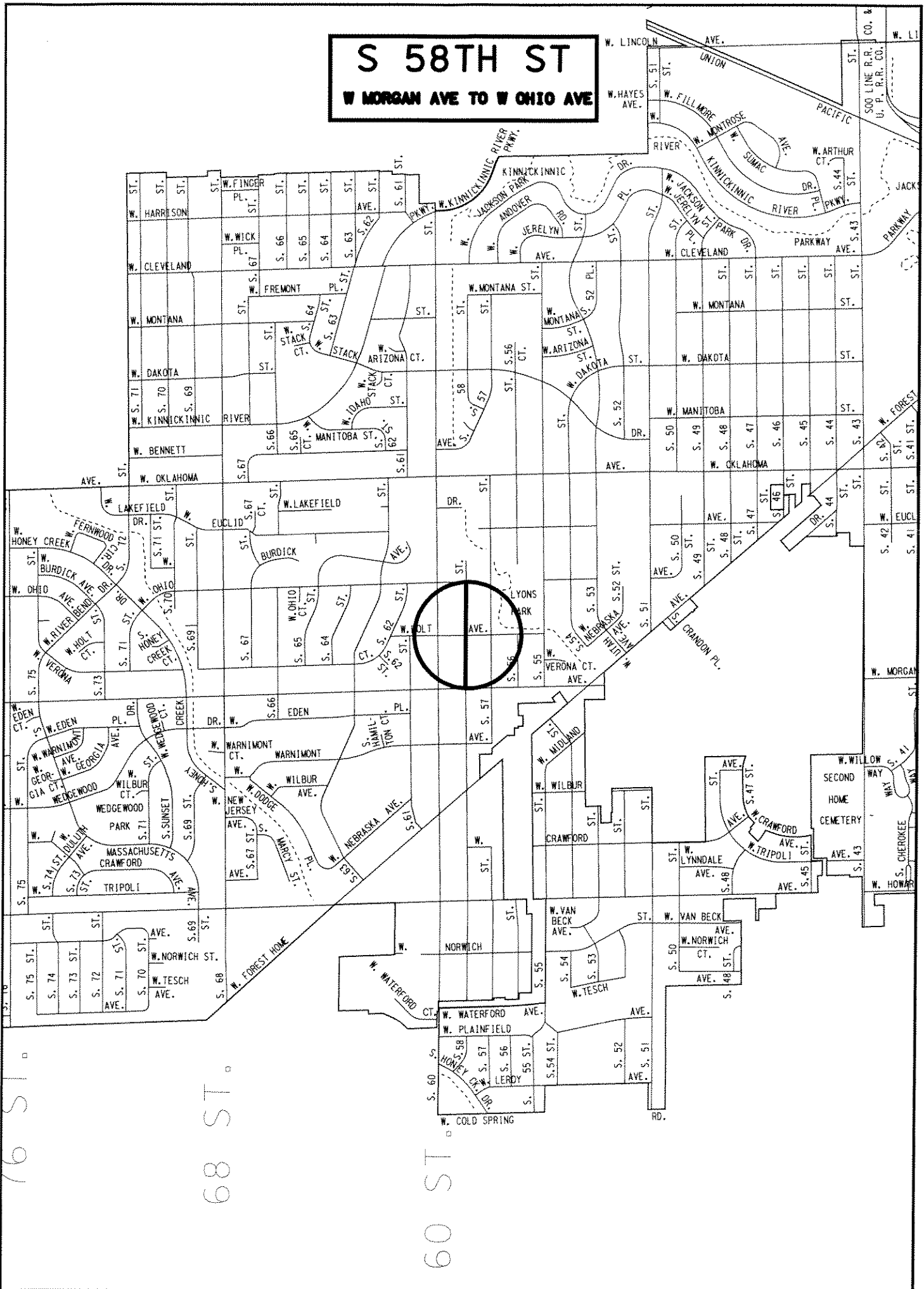

BURNHAM ST.

**W OHIO AVE**  
**S 76TH ST TO S 84TH ST**

LINCOLN AVE.

CLEVELAND AVE.

W. LINCOLN

W. HAYES AVE.

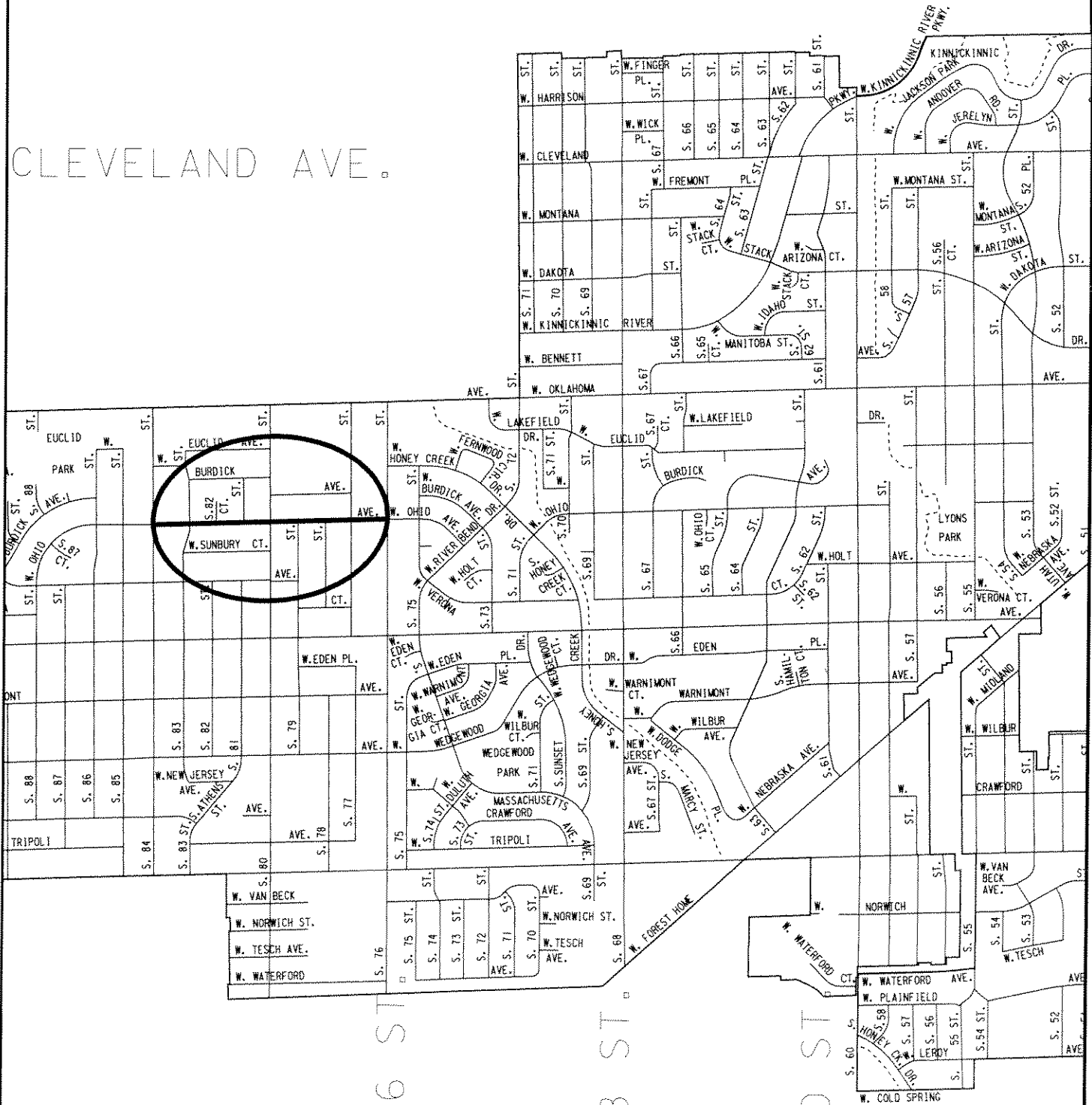

76 ST

68 ST

60 ST

