

DCO # 2530

CERTIFIED SURVEY MAP NO. BEING A REDIVISION OF THE NORTH 20 FEET OF LOT 38, ALL OF LOTS 39 AND 40, BLOCK 217, JOHN B. A. KERN'S SUBDIVISION NO. 2, BEING A PART OF THE NORTHEAST 1/4 OF THE SOUTHEAST 1/4 OF SECTION 17, TOWN 7 NORTH, RANGE 22 EAST, CITY OF MILWAUKEE, MILWAUKEE COUNTY, WISCONSIN.

- DENOTES 1.315" O.D. IRON PIPE, WEIGHING 1.13 LBS PER LINEAL FOOT, 18" IN LENGTH - SET.

BEARINGS ARE REFERENCED TO AND COMPATIBLE WITH THE NORTH LINE OF THE SE 1/4 OF SEC. 17-7-22, ASSUMED BEARING N89°08'16"E.

ALL DIMENSIONS ARE MEASURED AND COMPUTED TO THE NEAREST ONE HUNDREDTH OF A FOOT.

ANGLE TABLE
 A-89°50'41"
 B-90°09'19"
 C-89°50'41"
 D-90°09'19"

NORTHWEST CORNER OF THE SOUTHEAST 1/4 OF SECTION 17-7-22 CONC. MON W/BRASS CAP

N. PALMER STREET
80' WIDE

80' WIDE

N00°59'11"W 80.00'

D 40.00'

PARCEL 1
4,000 ST. FT.
0.09 ACRES

S89°10'08"W 100.00'

C 40.00'

PARCEL 2
4,000 ST. FT.
0.09 ACRES

S89°10'08"W 100.00'

A 40.00'

LOT 3

LOT 2

LOT 1

BLOCK 217

JOHN B. A. KERN'S SUBD. NO. 2

W/E. NORTH AVE

N. PALMER ST

N. RICHARDS ST

W/E. CENTER ST

S00°59'11"E 80.00'

C 40.00'

PARCEL 1
4,000 ST. FT.
0.09 ACRES

S89°10'08"W 100.00'

D 40.00'

PARCEL 2
4,000 ST. FT.
0.09 ACRES

S89°10'08"W 100.00'

A 40.00'

LOT 3

LOT 2

LOT 1

BLOCK 217

JOHN B. A. KERN'S SUBD. NO. 2

W/E. CENTER ST

F. CLARKE STREET

60' WIDE

S00°59'11"E 691.73'

NORTH EAST CORNER OF THE SOUTHEAST 1/4 OF SECTION 17-7-22 CONC. MON W/BRASS CAP

S89°08'16"W 437.81'

NORTH EAST CORNER OF THE SOUTHEAST 1/4 OF SECTION 17-7-22 CONC. MON W/BRASS CAP

TAX KEY NO'S 322-0509 & 322-0510
ZONED: RT4

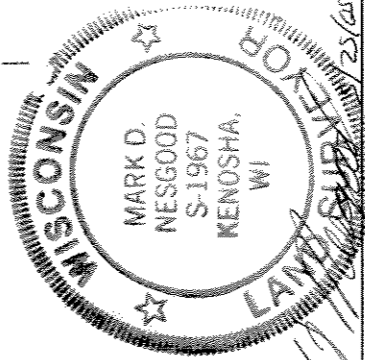

WISCONSIN REGISTERED LAND SURVEYOR
MARK D. NESGOOD S-1967

INFRASTRUCTURE SERVICES DIVISION
MARCIA D. DRISCOLL 1/9/06
CENTRAL DRAFTING & RECORDS MANAGER

Martin Legueta 1/9/06
ENGR. IN CHARGE ENVIRON. ENGR.
CORRECT
Jeffrey J. Palumbo 1/10/06
CITY ENGINEER
APPROVED

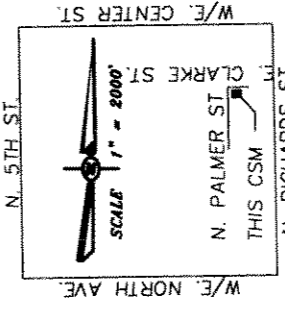

VICINITY MAP
SE 1/4 OF SEC. 17-7-22



GRAPHIC SCALE



McCLURE ENGINEERING ASSOCIATES, INC.
5417 North 118th Court, Milwaukee, WI 53225
(414) 616-4880 PROJECT NO. 06-13-05-005
(414) 616-4885 (FAX) DRAWING: 05005C1.DWG

DEPARTMENT OF CITY DEVELOPMENT
CITY OF MILWAUKEE

NOV 22 2005

STAFF APPROVED

CERTIFIED SURVEY MAP NO. _____

BEING A REDIVISION OF THE NORTH 20 FEET OF LOT 38, ALL OF LOTS 39 AND 40, BLOCK 217, JOHN B. A. KERN'S SUBDIVISION NO. 2, BEING A PART OF THE NORTHEAST 1/4 OF THE SOUTHEAST 1/4 OF SECTION 17, TOWN 7 NORTH, RANGE 22 EAST, CITY OF MILWAUKEE, MILWAUKEE COUNTY, WISCONSIN.

SURVEYOR'S CERTIFICATE

STATE OF WISCONSIN) SS
MILWAUKEE COUNTY)

I, Mark D. Nesgood, Registered Land Surveyor, do hereby certify that I have surveyed, divided and mapped a Redivision of the North 20 feet of Lot 38, all of Lots 39 and 40, Block 217, John B. A. Kern's Subdivision No. 2, being a part of the Northeast 1/4 of the Southeast 1/4 of Section 17, Town 7 North, Range 22 East, City of Milwaukee, Milwaukee County, Wisconsin, bounded and described as follows:

Commencing at the Northeast corner of the Southeast 1/4 of said Section; thence S89°08'16"W along the North line of the Southeast 1/4 of said Section 437.81 feet; thence S00°59'11"E 691.73 feet to the point of beginning; thence N89°10'08"E along the South right-of-way line of E. Clarke Street 100.00 feet; thence S00°59'11"E 80.00 feet; thence S89°10'08"W 100.00 feet to a point on the East right-of-way line of N. Palmer Street; thence N00°59'11"W along the East right-of-way line of N. Palmer Street 80.00 feet to the point of beginning.

Containing 0.18 acres of land more or less.

That I have made such survey, land division and map by the direction of the City of Milwaukee, owner of said land.

That such map is a correct representation of the exterior boundaries of the land surveyed and the land division thereof made.

That I have fully complied with the provisions of Chapter 236 of the Wisconsin Statutes and Chapter 119 of the Milwaukee Code of Ordinances in surveying, dividing and mapping the same.

Dated this 25th day of April 2005.

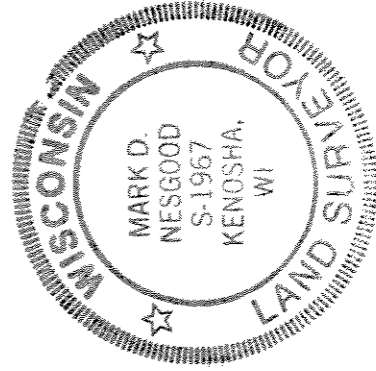

Wisconsin Registered Land Surveyor
Mark D. Nesgood S-1967

CERTIFIED SURVEY MAP NO. _____

BEING A REDIVISION OF THE NORTH 20 FEET OF LOT 38, ALL OF LOTS 39 AND 40, BLOCK 217, JOHN B. A. KERN'S SUBDIVISION NO. 2, BEING A PART OF THE NORTHEAST ¼ OF THE SOUTHEAST ¼ OF SECTION 17, TOWN 7 NORTH, RANGE 22 EAST, CITY OF MILWAUKEE, MILWAUKEE COUNTY, WISCONSIN.

CORPORATE OWNER'S CERTIFICATE

The City of Milwaukee, a corporation duly organized and existing under and by virtue of the laws of the State of Wisconsin, as owner, certifies that said corporation caused the land described on this map to be surveyed, divided, mapped and dedicated as represented on this map in accordance with the requirements of Chapter 119 of the Milwaukee Code of Ordinances.

In consideration of the approval of the map by the Common Council and in accordance with Chapter 119 of the Milwaukee Code, the undersigned agrees:

That all utility lines to provide electrical power and telephone services and cable television or communications systems lines or cables to all lots in the certified survey map shall be installed underground in easements provided therefore, where feasible.

This agreement shall be binding on the undersigned and assigns.

In Witness Whereof, the City of Milwaukee has caused these presents to be signed by Tom Barrett, its Mayor; and countersigned by Ronald D. Leonhardt, its City Clerk, at Milwaukee, Wisconsin, this 14 day of February, 2006.

IN THE PRESENCE OF:

City of Milwaukee

Kimberly Rhoads
Witness

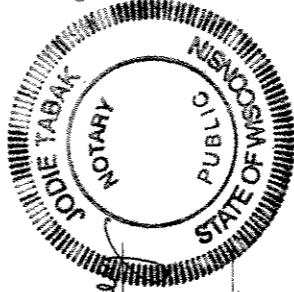

Tom Barrett
Tom Barrett, Mayor

Ronald D. Leonhardt
Witness

Ronald D. Leonhardt
Ronald D. Leonhardt, City Clerk

STATE OF WISCONSIN) SS
MILWAUKEE COUNTY)

PERSONALLY came before me this 16 day of February, 2006, Tom Barrett, Mayor of the above named corporation, to me known to be the person who executed the foregoing instrument, and to me known to be the Mayor of the corporation, and acknowledged that he executed the foregoing instrument as such officer as the deed of the corporation, by its authority.

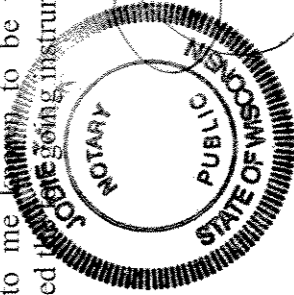
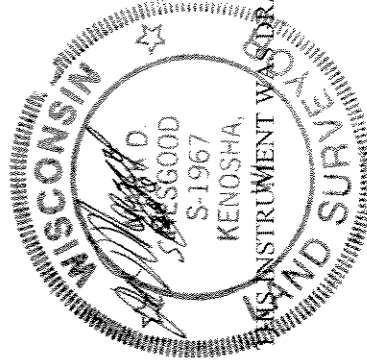

Jodie Tabak
Notary Public, State of Wisconsin
My commission expires 6-9-08

CERTIFIED SURVEY MAP NO. _____

BEING A REDIVISION OF THE NORTH 20 FEET OF LOT 38, ALL OF LOTS 39 AND 40, BLOCK 217, JOHN B. A. KERN'S SUBDIVISION NO. 2, BEING A PART OF THE NORTHEAST ¼ OF THE SOUTHEAST ¼ OF SECTION 17, TOWN 7 NORTH, RANGE 22 EAST, CITY OF MILWAUKEE, MILWAUKEE COUNTY, WISCONSIN.

STATE OF WISCONSIN) SS
MILWAUKEE COUNTY)

PERSONALLY came before me this 16th day of January, 2008, Ronald D. Leonhardt, City Clerk of the above named corporation, to me known to be the person who executed the foregoing instrument, and to me known to be the City Clerk of the corporation, and acknowledged that he executed the foregoing instrument as such officer as the deed of the corporation, by its authority.



Katherine H. Mollica
Notary Public, State of Wisconsin
My commission expires 2-10-08

CERTIFICATE OF CITY TREASURER

STATE OF WISCONSIN) SS
MILWAUKEE COUNTY)

I, WAYNE F. WHITTOW, being the duly elected, qualified and acting City Treasurer of the City of Milwaukee, do hereby certify that in accordance with the records in the Office of the City Treasurer of the City of Milwaukee, there are no unpaid taxes or unpaid special assessments on the land included in this Certified Survey Map.

Dated this 27th day of January, 2008.

Wayne F. Whittow
WAYNE F. WHITTOW, City Treasurer

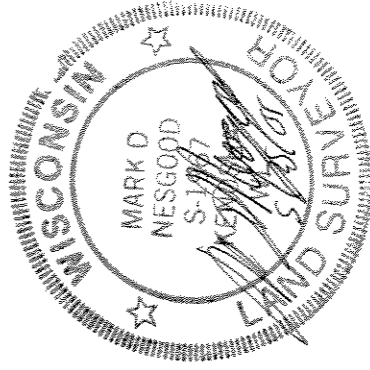

CERTIFIED SURVEY MAP NO. _____

BEING A REDIVISION OF THE NORTH 20 FEET OF LOT 38, ALL OF LOTS 39 AND 40, BLOCK 217, JOHN B. A. KERN'S SUBDIVISION NO. 2, BEING A PART OF THE NORTHEAST ¼ OF THE SOUTHEAST ¼ OF SECTION 17, TOWN 7 NORTH, RANGE 22 EAST, CITY OF MILWAUKEE, MILWAUKEE COUNTY, WISCONSIN.

COMMON COUNCIL CERTIFICATE OF APPROVAL

I HEREBY certify that this Certified Survey Map was approved under Resolution File No. 051323 adopted by the Common Council of the City of Milwaukee on this 1st day of February, 2006.

RONALD D. LEONHARDT, City Clerk

Tom Barrett, Mayor

