

Date: January 28, 2025
Revised: February 13, 2025
Survey No. 6181.00-JRT
Sheet 1 of 4 Sheets

Lots 13 through 17 of Block 2 of Sunset Heights No. 2, being a part of the Southeast 1/4 of the Southwest 1/4 of Section 3, Town 7 North, Range 21 East, in the City of Milwaukee, Milwaukee County, Wisconsin.

STATE OF WISCONSIN} :SS
MILWAUKEE COUNTY}

THAT I have survey, combined and mapped Lots 13 through 17, Block 2 in Sunset Heights No. 2, in the Southeast 1/4 of the Southwest 1/4 of Section 3, Township 7 North, Range 21 East, in the City of Milwaukee, Milwaukee County, Wisconsin, bounded and described as follows:
Commencing at the Southeast corner of the Southwest 1/4 of said Section 3; thence South 88°24'40" West along the South line of the said 1/4 Section 446.84 feet to a point; thence North 01°35'53" West 60.00 feet to a point on the North line of West Capitol Drive and the point of beginning of the lands hereinafter described; thence South 88°24'40" West along said North line 159.00 feet to a point on the East line of North 70th Street; thence North 01°35'53" West along said East line 119.87 feet to a point on the South line of a Public Alley; thence North 88°24'40" East along said South line 159.00 feet to a point on the West line of Lot 12, Block 2, Sunset Heights No. 2; thence South 01°35'53" East along said West line 119.87 feet to the point of beginning.

THAT I have made this survey, land division and map by the direction of the AHMAD PROPERTIES LLC, owners of said land.

THAT I have fully complied with the provisions of Section 236.34 of the Wisconsin Statutes, the Land Division Ordinance of the City of Milwaukee in surveying, dividing and mapping the same. Per Wis. Stat. 236.21 (1), this certificate has the same force and effect as an affidavit.

ALLEN J. SCHNEIDER

A circular professional seal for a Wisconsin Land Surveyor. The outer ring contains the text "WISCONSIN" at the top and "LAND SURVEYOR" at the bottom, separated by two five-pointed stars. The inner circle contains the name "ALLEN J. SCHNEIDER", the license number "S-2194", and the location "GREENFIELD WI". The seal is red and is stamped over a blue ink signature.

Lots 13 through 17 of Block 2 of Sunset Heights No. 2, being a part of the Southeast 1/4 of the Southwest 1/4 of Section 3, Town 7 North, Range 21 East, in the City of Milwaukee, Milwaukee County, Wisconsin.

Ahmad Properties LLC, a limited liability corporation, duly organized and existing under and by virtue of the laws of the State of _____, as owner, certifies that said entity caused the land described on this certified survey map to be surveyed, divided, dedicated and mapped as represented on this map in accordance with the requirements of Chapter 236 of the Wisconsin Statutes and Chapter 119 of the Milwaukee Code of Ordinances.

In consideration of the approval of the Certified Survey Map by the Common Council and in accordance with Chapter 119 of the City of Milwaukee Code, the undersigned agrees:

That all utility lines to provide electric power and telephone service and cable television or communications systems lines or cables to all lots in the certified survey map (other than already existing lines and cables) shall be installed underground in easements provided therefore, where feasible.

Date: 5-6-25

Signature: Q. A. L.

Type or Print Name: Omar Ahmad

Title: President

STATE OF WIS. }
WAUKESHA COUNTY } :SS

Personally came before me this 6 day of MAY, 2025, OMAR AHMAD (name), the PR-SIDENT (title) of the above named entity, to me known to be the person who executed the foregoing instrument, and acknowledged that he/she executed the foregoing instrument as such officer on behalf of the entity, by its authority.

Notary Signature: Erin J. Mahan

Print Notary Name: ELIZABETH J. MACNOWSKI

Notary Public, State of WIS, _____. My commission expires: Dec. 25, 2025 (Notary Seal)

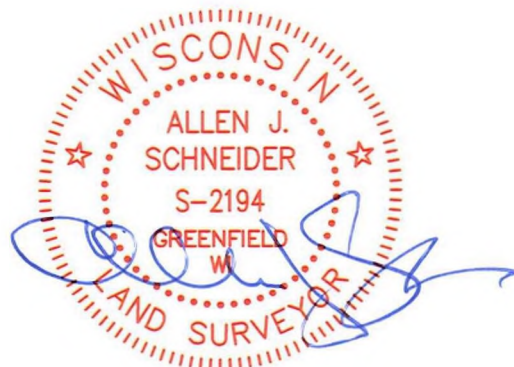

CHAPUT
LAND & SURVEYS

234 W. Florida Street
Milwaukee, WI 53204

414-224-8068
www.chaputlandsurveys.com

This instrument was drafted by Allen J. Schneider
Professional Land Surveyor S-2194

Date: January 28, 2025
Revised: February 13, 2025
Survey No. 6181.00-JRT
Sheet 3 of 4 Sheets

CERTIFIED SURVEY MAP NO. _____

Lots 13 through 17 of Block 2 of Sunset Heights No. 2, being a part of the Southeast 1/4 of the Southwest 1/4 of Section 3, Town 7 North, Range 21 East, in the City of Milwaukee, Milwaukee County, Wisconsin.

CERTIFICATE OF CITY TREASURER

I, Spencer Coggs, being the duly elected and acting City Treasurer of the City of Milwaukee, certify that in accordance with the records in the office of the City Treasurer of the City of Milwaukee there are no unpaid taxes or unpaid special assessments on the land included in this certified survey map.

Per Wis. Stat. 75.06 and 74.87, the City of Milwaukee collects property taxes and enforces nonpayment of same on parcels in the City of Milwaukee. Per Wis. Stat. 74.83, the City of Milwaukee and Milwaukee County entered into an Intergovernmental Cooperation Agreement approved by Council Resolution 901408, whereby the city is the sole collector and enforcer of property taxes for parcels in the city.

Date: May 12, 2025

Signature: Hal Quisha A Schwede
for Spencer Coggs, Treasurer

CERTIFICATE OF CITY CLERK REGARDING COMMON COUNCIL APPROVAL

I certify that this certified survey map was approved under Resolution File No. 250246, adopted by the Common Council of the City of Milwaukee on 6-3-2025.

Date: 6-11 2025

Signature: [Signature]
James R. Owczarski, City Clerk

