

CERTIFIED SURVEY MAP NO. _____

A Division of a part of Lots 1 thru 3, Block 3 in Richard Brew's Subdivision and lands, being in the Northeast 1/4 and Southeast 1/4 of the Southwest 1/4 of Section 12, Town 7 North, Range 21 East, in the City of Milwaukee, Milwaukee County, Wisconsin.

TAX KEY NO. 287-9979-100-7
ZONED LB2

- INDICATES 1" IRON PIPE (FOUND), UNLESS NOTED
- INDICATES SET 1.315" O.D. IRON PIPE AT LEAST 18" IN LENGTH, 1.68 LBS. PER LINEAL FOOT.

NE COR OF SW 1/4 OF SEC 12-7-21
FD BRASS CAP MONUMENT

ALL DIMENSIONS SHOWN ARE MEASURED TO THE NEAREST HUNDREDTH OF A FOOT. ALL BEARINGS ARE REFERENCED TO THE EAST LINE OF THE SW 1/4 OF SECTION 12, T7N, R21E, WHICH BEARS N00°44'10"W.

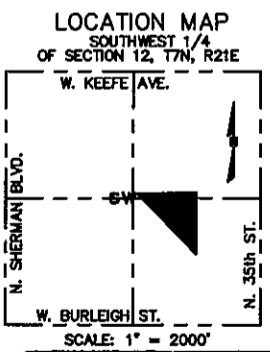
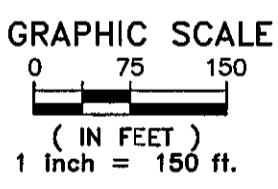
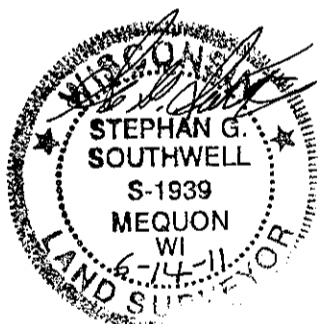
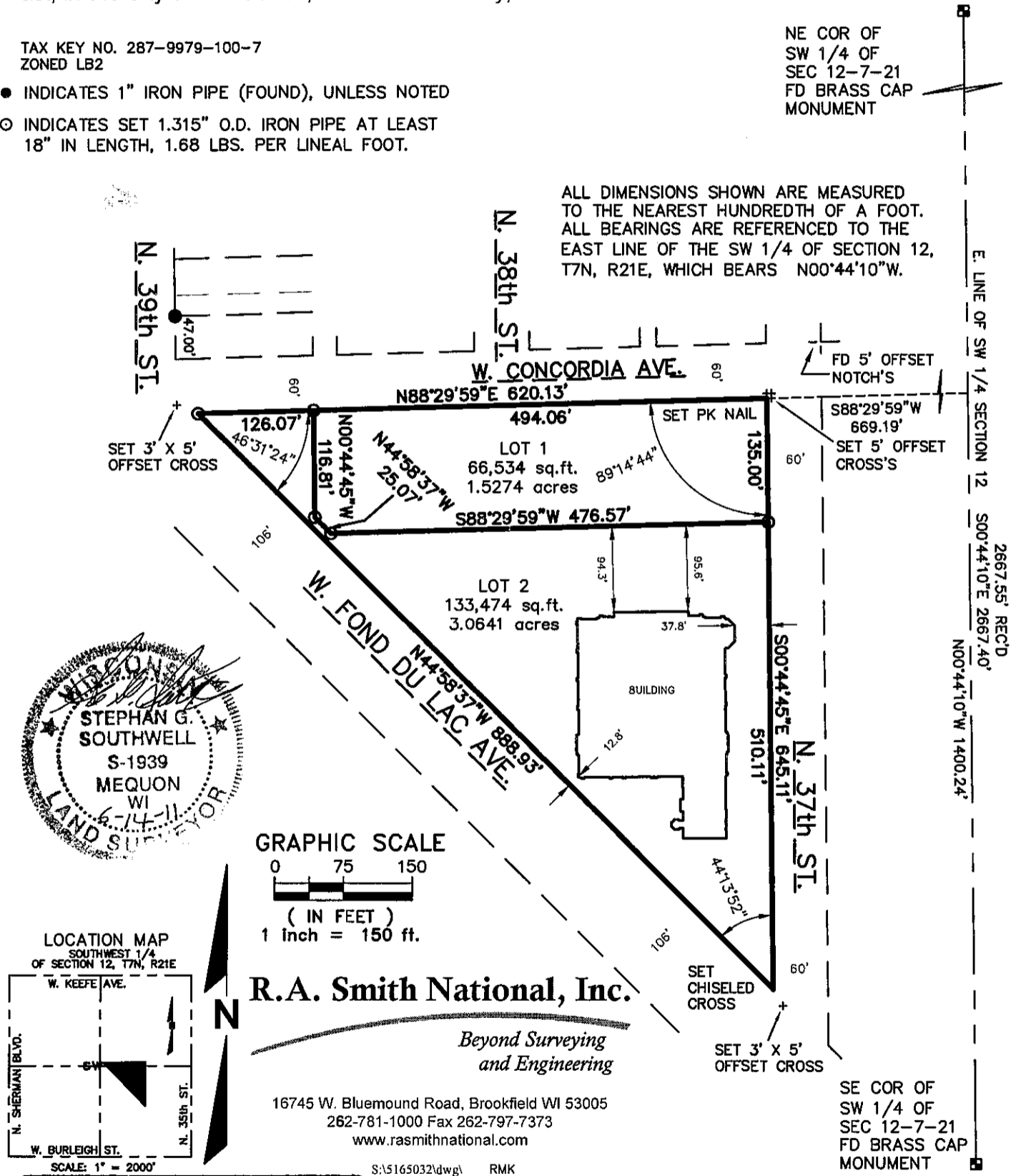

R.A. Smith National, Inc.

Beyond Surveying and Engineering

16745 W. Bluemound Road, Brookfield WI 53005
262-781-1000 Fax 262-797-7373
www.rasmithnational.com

S:\5165032\dwg\ RMK
CS101L150.dwg\CS101L150

INFRASTRUCTURE SERVICES DIVISION	
Marcia Cornell 6/21/11 CENTRAL DRAFTING & RECORDS MANAGER	
Z. Martin 6/21/11 ENGR. IN CHARGE	ENVIRON. ENGR.
CORRECT	
J. Palenoke 6/21/11 CITY ENGINEER	APPROVED

SHEET 1 OF 4 SHEETS

DLD
STAMP

CERTIFIED SURVEY MAP NO. _____

A Division of a part of Lots 1 thru 3, Block 3 in Richard Brew's Subdivision and lands, being in the Northeast 1/4 and Southeast 1/4 of the Southwest 1/4 of Section 12, Town 7 North, Range 21 East, in the City of Milwaukee, Milwaukee County, Wisconsin.

SURVEYOR'S CERTIFICATE

STATE OF WISCONSIN }
 :SS
WAUKESHA COUNTY }

I, STEPHAN G. SOUTHWELL, Registered Land Surveyor, do hereby certify:

THAT I have surveyed, divided and mapped a division of a part of Lots 1 thru 3, Block 3 in Richard Brew's Subdivision and lands, being in the Northeast 1/4 and Southeast 1/4 of the Southwest 1/4 of Section 12, Town 7 North, Range 21 East, in the City of Milwaukee, Milwaukee County, Wisconsin, which is bounded and described as follows:

COMMENCING at the Southeast corner of said 1/4 section; thence North 00°44'10" West along the east line of said 1/4 Section a distance of 1400.24 feet to a point; thence South 88°29'59" West 669.19 feet to a point in the West line of North 37th Street, the South line of West Concordia Avenue and the point of beginning of lands to be described; thence South 00°44'45" East along said West line 645.11 feet to a point in the Northerly line of West Fond Du Lac Avenue; thence North 44°58'37" West along said Northerly line 888.93 feet to a point in the South line of West Concordia Avenue; thence North 88°29'59" East along said South line 620.13 feet to the point of beginning. Said lands contain 200,009 square feet or 4.5916 acres

THAT I have made the survey, land division and map by the direction of SHERMAN PARK COMMONS, LLC., owner.

THAT the map is a correct representation of all the exterior boundaries of the land surveyed and the land division thereof made.

THAT I have fully complied with Chapter 236 of the Wisconsin Statutes and Chapter 119 of the Milwaukee Code in surveying, dividing and mapping the same.

6/14/11
DATE

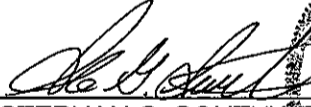
STEPHAN G. SOUTHWELL
REGISTERED LAND SURVEYOR

CERTIFIED SURVEY MAP NO. _____

A Division of a part of Lots 1 thru 3, Block 3 in Richard Brew's Subdivision and lands, being in the Northeast 1/4 and Southeast 1/4 of the Southwest 1/4 of Section 12, Town 7 North, Range 21 East, in the City of Milwaukee, Milwaukee County, Wisconsin.

CORPORATE OWNER'S CERTIFICATE

SHERMAN PARK COMMONS, LLC., a corporation duly organized and existing under and by virtue of the laws of the State of Wisconsin, as owner, certifies that said corporation caused the land described on this map, to be surveyed, divided, mapped and dedicated as represented on this Certified Survey Map in accordance with the requirements of Chapter 119 of the Milwaukee Code of Ordinances.

IN consideration of the approval of the map by the Common Council of the City of Milwaukee and in accordance with Chapter 119 of the Milwaukee Code, the undersigned agrees:

- A. That all utility lines to provide electric power and telephone service and cable television or communications systems lines or cables to all lots in the Certified Survey Map shall be installed underground in easements provided therefore, where feasible.

THIS agreement shall be binding on the undersigned and assigns.

IN Witness Whereof, SHERMAN PARK COMMONS, LLC., has caused these presents to be signed by Gary J. Gorman, its President, This _____ day of _____, 2011.

In the presence of:

Sherman Park Commons, LLC
By Sherman Park Commons MM, LLC
By Gorman & Company, Incorporated

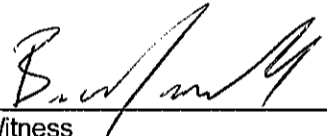

Witness

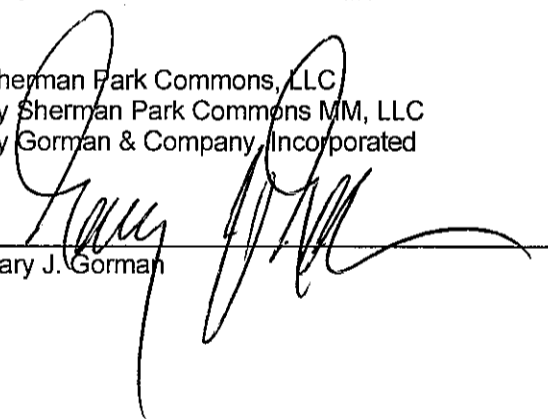

Gary J. Gorman

STATE OF WISCONSIN }
 }SS
DANE COUNTY }

PERSONALLY came before me this 14th day of June, 2011,

Gary J. Gorman, to me known as the person who executed the foregoing instrument and to me known to be the President of the corporation, and acknowledged that he executed the foregoing instrument as such officer as the deed of the corporation, by its authority.

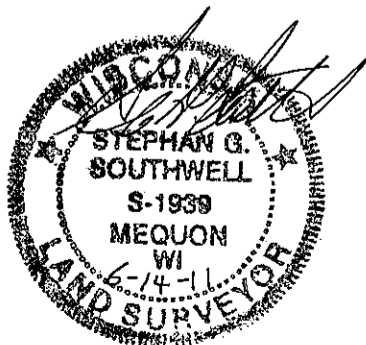

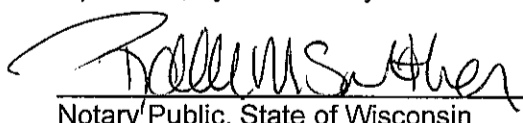
 (SEAL)
Notary Public, State of Wisconsin
My commission expires 01/18/12



CERTIFIED SURVEY MAP NO. _____



A Division of a part of Lots 1 thru 3, Block 3 in Richard Brew's Subdivision and lands, being in the Northeast 1/4 and Southeast 1/4 of the Southwest 1/4 of Section 12, Town 7 North, Range 21 East, in the City of Milwaukee, Milwaukee County, Wisconsin.

COMMON COUNCIL CERTIFICATE OF APPROVAL

I certify that this Certified Survey Map was approved under Resolution File No.

110315 adopted by the Common Council of the City of Milwaukee on _____

July 6, 2011



RONALD D. LEONHARDT, CITY CLERK

TOM BARRETT, MAYOR

CERTIFICATE OF CITY TREASURER

STATE OF WISCONSIN }
 :SS
MILWAUKEE COUNTY }

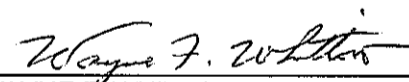
I, WAYNE F. WHITTOW, being the duly elected, qualified and acting City Treasurer of the City of Milwaukee, certify that in accordance with the records in the office of the City Treasurer of the City of Milwaukee there are no unpaid taxes or unpaid special assessments on the land included in this Certified Survey Map.

6-22-11
DATE

WAYNE F. WHITTOW, CITY TREASURER



THIS INSTRUMENT WAS DRAFTED BY STEPHAN G. SOUTHWELL,
REGISTERED LAND SURVEYOR S-1939