



HARBOR DISTRICT RIVERWALK

PLAN COMMISSION

NOVEMBER 7, 2022

COMMUNITY AND STAKEHOLDER ENGAGEMENT

COMMUNITY SURVEYS AND EVENTS

- April-May 2021: Public Survey
- July 2021: Public Survey
- July 2021: Schlitz Audubon Event
- July 2021: Harbor District BID Event
- September 2021: Harbor Fest Event

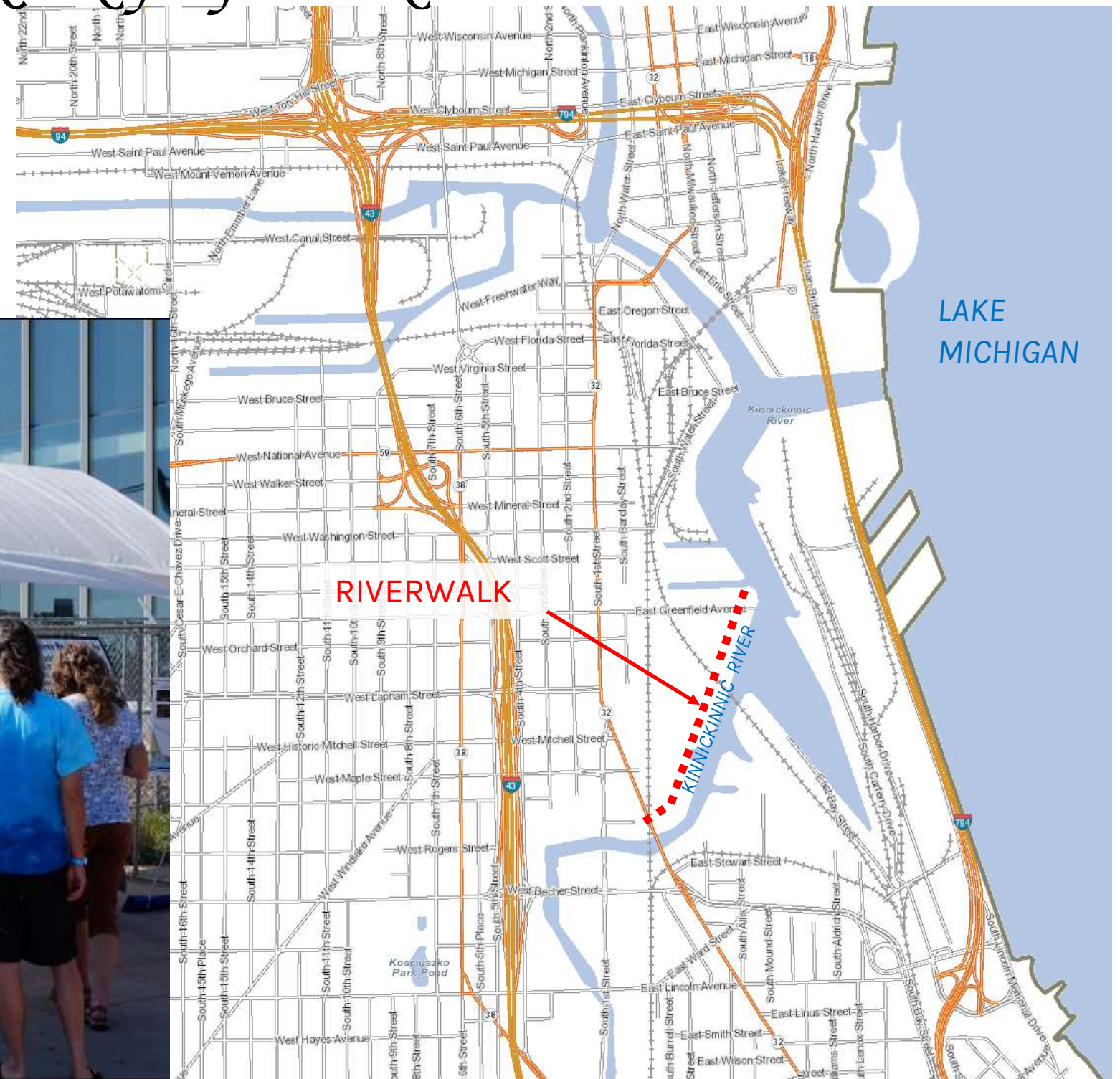

SITE PLAN

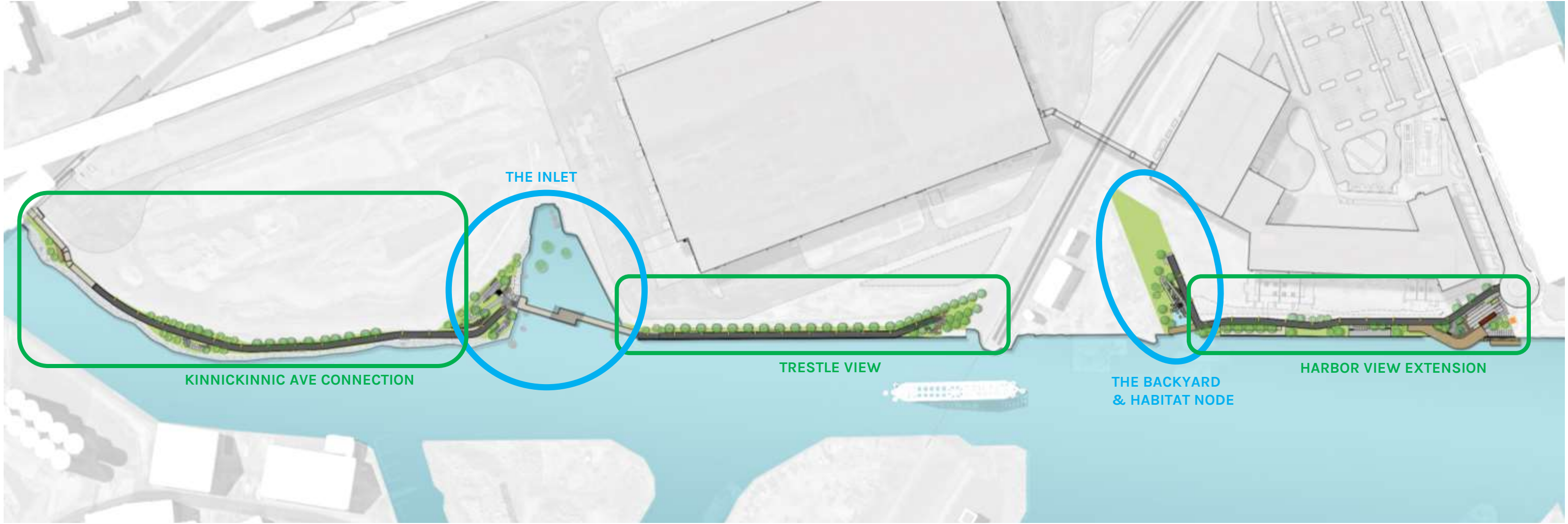

**14' ACCESSIBLE TRAIL
FLEX SPACES**

**FOCUS ON KEY NODES
SAFETY AND SECURITY**

**HABITAT & GREEN INFRASTRUCTURE
APPROPRIATE H2O ACCESS**

HARBOR DISTRICT RIVERWALK

KINNICKINNIC AVE CONNECTION



HARBOR DISTRICT RIVERWALK

THE INLET



THE INLET

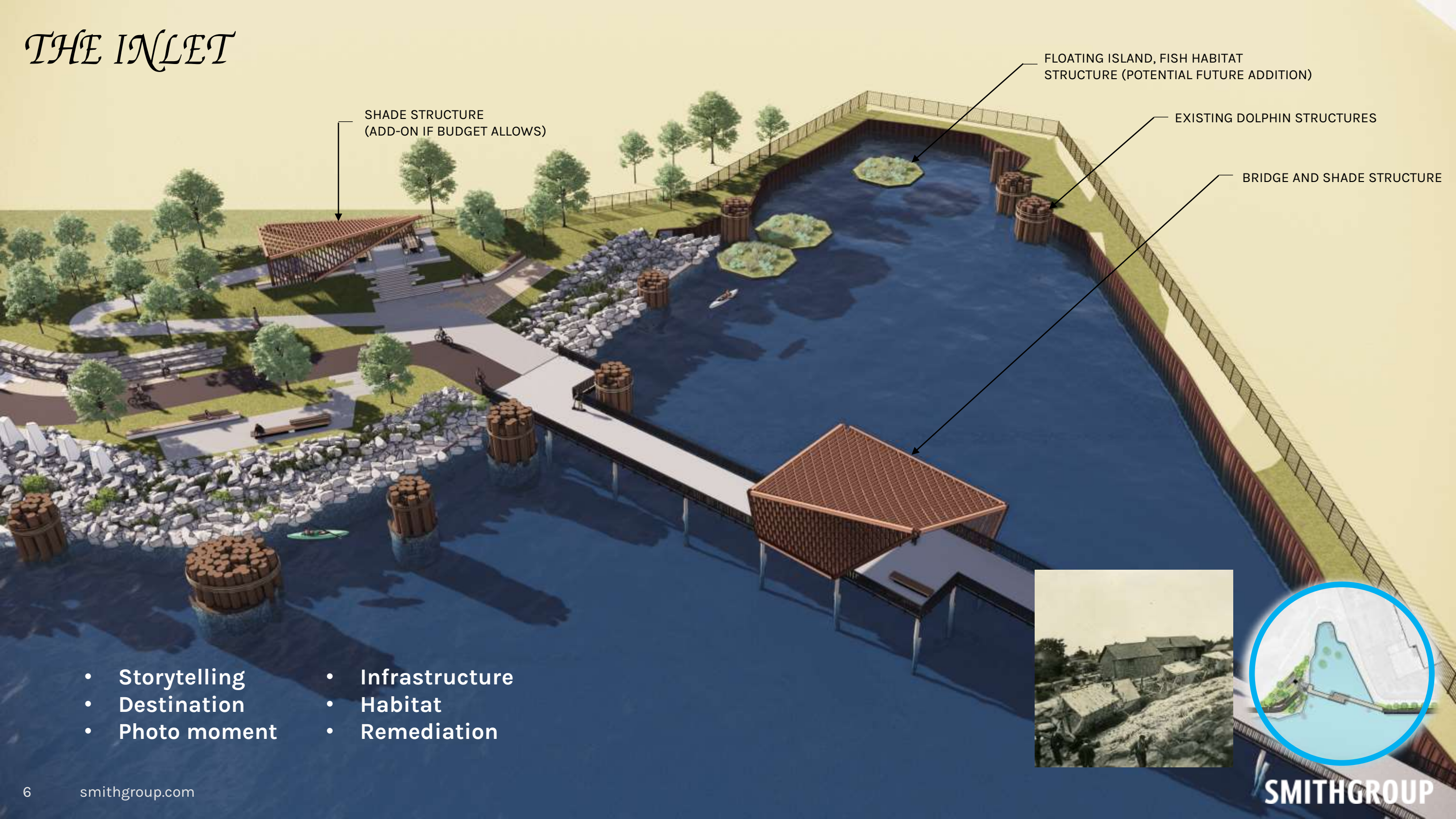

SHADE STRUCTURE
(ADD-ON IF BUDGET ALLOWS)

FLOATING ISLAND, FISH HABITAT
STRUCTURE (POTENTIAL FUTURE ADDITION)

EXISTING DOLPHIN STRUCTURES

BRIDGE AND SHADE STRUCTURE

- Storytelling
- Destination
- Photo moment
- Infrastructure
- Habitat
- Remediation



HARBOR DISTRICT RIVERWALK

THE BACKYARD & HABITAT NODE



HABITAT NODE



- Sheet pile cut
- Habitat zone
- Educational area

- Connection to water
- Safety considerations
- Grant Funding

HARBOR DISTRICT RIVERWALK

HARBOR VIEW PLAZA EXTENSION

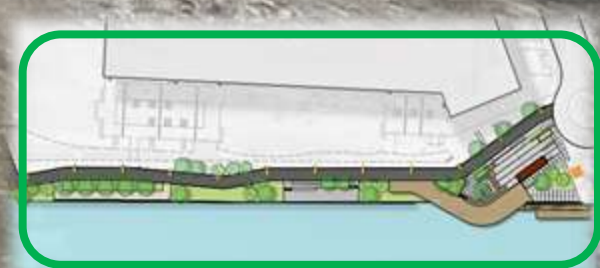

HARBORVIEW PLAZA

- Restroom building
- Flex performance area
- Boating/kayak access
- Habitat enhancements
- Fishing Access
- Seating and overlooks
- Stormwater management
- Interpretive signage



HARBORVIEW PLAZA

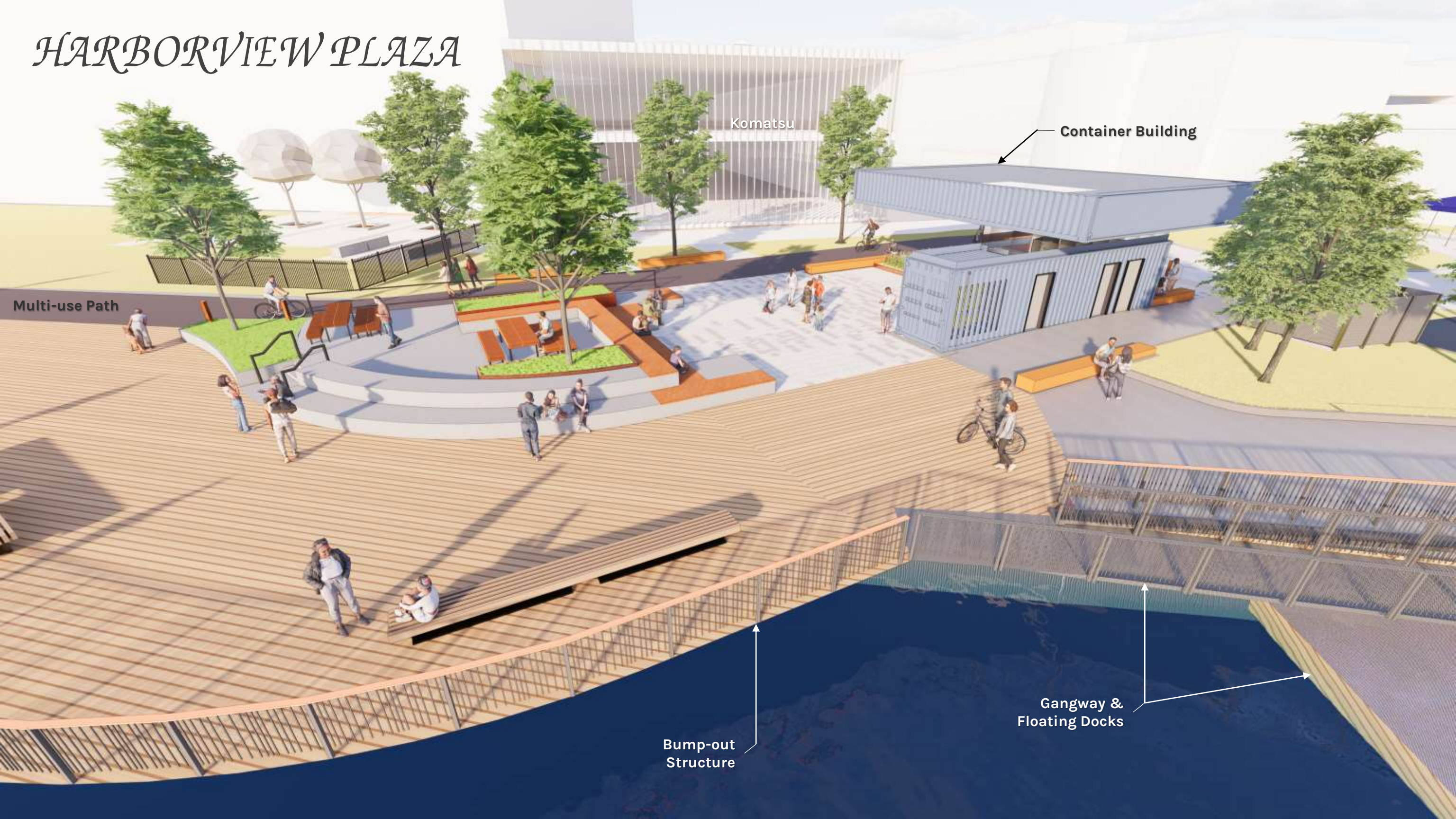

Komatsu

Container Building

Multi-use Path

Bump-out
Structure

Gangway &
Floating Docks

HARBORVIEW PLAZA



Container Building

Terrace

Kiosk Enclosure

Multi-use Path
Entry

THANK YOU

DESIGN A BETTER FUTURE