

Dear City of Milwaukee,
I Willie J. Ellis at 2245 W. Walnut.
I am appealing to you on getting
my fence fix.

My fence was damaged on
Oct. 7th between 12:00 A.M. and
5:30 A.M.

I am seeking two panels 4" high
for \$495.00. There were two brackets
that fell on it. I have a picture
of it.

Maybe the pruning date was
off.

Phone (414) 344-5934 Cell 520-3536

I Willie J. Ellis of 2245 W. Abbott St 53205

Phone (414) 348-5934 Cell 520-3536

One Decking Damages that was cause by
a City falling tree on two panels of a
New porch of two months old.

Height 4" Style Montage Black 5/8"
Picket Classic.

Replace 2 panels \$495.00

Willie J. Ellis

10-15-09

CITY OF MILWAUKEE
09 OCT 15 PM 2:50
RONALD D. LEONHARDT
CITY CLERK

CITY OF MILWAUKEE
RECEIVED
2009 OCT 16 PM 2:32
OFFICE OF
CITY ATTORNEY



1630 SOUTH 38th STREET
 MILWAUKEE, WISCONSIN 53215
 414.483.5522 • FAX: 414.483.3623

PROPOSAL / CONTRACT

Work to be performed at:

SAME

Date: 10-13-09

PROPOSAL DESCRIPTION / DETAILS / SPECIFICATIONS

HEIGHT 4' STYLE
MONTAGE BLACK
5/8" PICKET CLASSIC
3 RAIL

HAUL DAMAGE AWAY

REPLACE 2 PANELS

WILLIE ELLIS
2045 W. WALNUT STREET
MILW, WISC
53205

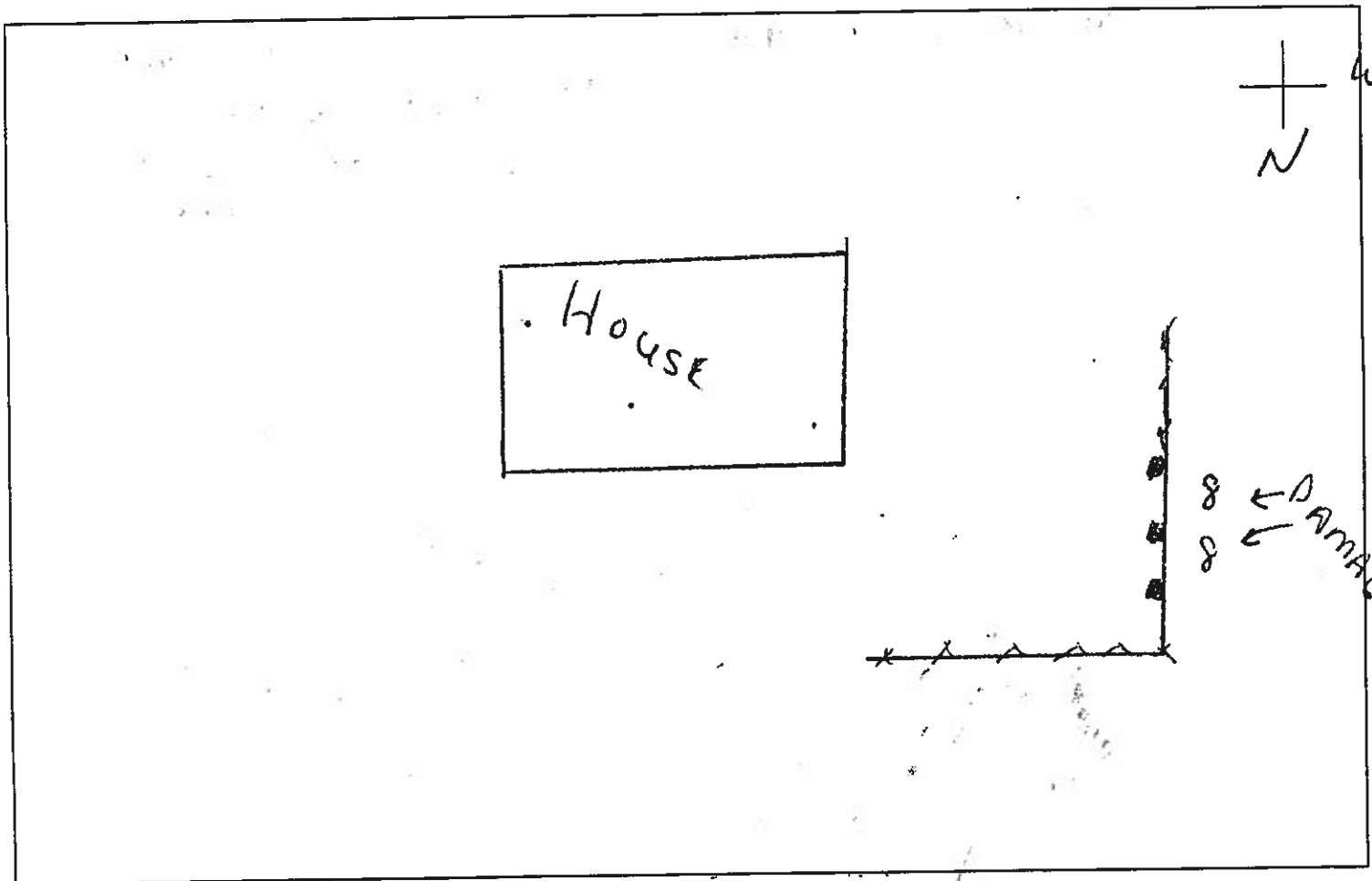

Contract Amount: \$ 495.00
 Add Permit Fee: \$ N/A
~~Add 2% Credit Card Fee: \$~~
 Total Contract Amount: \$ 495.00
 Down Payment: \$ _____
 Balance Due: \$ _____

Approved & Accepted Customer Date: 10-15-09
Willie J. Ellis
 Customers Signature
 X _____ Have Received and Accept Terms
 Customers Initials And Conditions Attachment
 Accepted For Milwaukee Fence Inc.: Date: 10-13-09
RICK MICALE
 Salesperson Signature Proposal Good for _____ Days

OFFICE OF THE CITY CLERK
Milwaukee Wisconsin

INSTRUCTIONS FOR FILING A CLAIM AGAINST THE CITY OF MILWAUKEE

To file a claim against the City a claimant must comply with Section 893.80(1), Wis. Stats., a copy of which is printed on the reverse side of this instruction sheet. Generally the statute requires the claimant to submit to the City Clerk:

1. A document stating the circumstances of the claim which must be signed by the claimant, or his/her agent or attorney. This document should be filed within 120 days of the event.
2. A document stating the address of the claimant and a statement of the relief sought. If money damages are sought, a specific sum must be stated.

(The above information may be combined in a single document.)

The following information should also be submitted to allow the City to promptly act on your claim:

1. Proof of the amount of the claim by means of either itemized receipts or two itemized estimates.
2. A phone number where the claimant can be reached during business hours as well as the claimant's e-mail address, if any.
3. As detailed a description of the incident as possible, including the date, time and place. ~~SECRET~~

All information should be submitted to:

City Clerk
ATTN: CLAIMS
200 E. Wells St., Room 205
Milwaukee, WI 53202-3567

BETWEEN
12:00 AM 5:30 AM

10-7-09

ADDITIONAL INFORMATION

Before you can file a lawsuit against the City of Milwaukee for reimbursement, State law requires that you first follow the claim procedures established by the City Clerk.

Filing a claim against the City does not automatically guarantee reimbursement from the City. However, the City examines each claim on an individual basis in determining if reimbursement is legally required.

In order to obtain reimbursement for a claim against the City, you must prove that the City or its employees acted unlawfully or negligently.

Only the City Attorney or the Common Council and the Mayor can authorize payment of a claim against the City. Any other representations made by City employees are not legally binding on the City.



893.80 Claims against governmental bodies or officers, agents or employees; notice of Injury; limitation of damages and suits. (1) Except as provided in subs. (1 g), (1 in), (1 p) and (8), no action may be brought or maintained against any volunteer fire company organized under ch. 213, political corporation, governmental subdivision or agency thereof nor against any officer, official, agent or employee of the corporation, subdivision or agency for acts done in their official capacity or in the course of their agency or employment upon a claim or cause of action unless:

(a) Within 120 days after the happening of the event giving rise to the claim, written notice of the circumstances of the claim signed by the party, agent or attorney is served on the volunteer fire company, political corporation, governmental subdivision or agency and on the officer, official, agent or employee under s. 801.11. Failure to give the requisite notice shall not bar action on the claim if the fire company, corporation, subdivision or agency had actual notice of the claim and the claimant shows to the satisfaction of the court that the delay or failure to give the requisite notice has not been prejudicial to the defendant fire company, corporation, subdivision or agency or to the defendant officer, official, agent or employee; and

(b) A claim containing the address of the claimant and an itemized statement of the relief sought is presented to the appropriate clerk or person who performs the duties of a clerk or secretary for the defendant fire company, corporation, subdivision or agency and the claim is disallowed.



