



CITY OF MILWAUKEE  
OFFICE OF THE CITY CLERK

Wednesday, February 26, 2020

COMMITTEE MEETING NOTICE

AD 08

BAHENA, Victor, Agent  
Autocami, LLC  
1543 S 29th St

Milwaukee, WI 53215

You are requested to attend a hearing which is to be held in Room 301-B, Third Floor, City Hall on:

**Tuesday, March 10, 2020 at 09:15 AM**

**Regarding:** Your Secondhand Motor Vehicle Dealer's License Application as agent for "Autocami, LLC" for "Mr. Victor Bodyshop" at 1643 S 38TH St #C.

There is a possibility that your application may be denied for one or more of the following reasons: Neighborhood Objections to the granting of such a license due to the creation of undesirable neighborhood problems, such as: parking and traffic problems which cause the normal flow of traffic on roadways and alleys to be impeded, loitering, littering, noise, loud music, and conduct which will have an adverse impact on the public health, safety and welfare of the community. Additionally, the over concentration of secondhand motor vehicle dealers in the neighborhood such that the concentration will have an adverse impact on the public health, safety and welfare of the neighborhood. you do not meet the statutory and municipal requirements; the appropriateness of the location to be licensed and whether the location will create undesirable neighborhood problems, whether or not you have been charged with or convicted of any felony, misdemeanor, municipal offense or other offense, the circumstances of which substantially relate to the licensed activity; and any other factors which reasonably relate to the public health, safety and welfare. See attached police report and/or written correspondence regarding this application. Please be advised the public will be able to provide information to the committee in person or in writing. The committee will receive and consider evidence regarding the above mentioned criteria.

**Notice for applicants with warrants or unpaid fines:**

Proof of warrant satisfaction or payment of fines must be submitted at the hearing on the above date and time. Failure to comply with this requirement may result in a delay of the granting/denial of your application.

Failure to appear at this meeting may result in the denial of your license. Individual applicants must appear only in person or by an attorney. Corporate or Limited Liability applicants must appear only by the agent designated on the application or by an attorney. Partnership applicants must appear by a partner listed on the application or by an attorney. If you wish to do so and at your own expense, you may be accompanied by an attorney of your choosing to represent you at this hearing.

You will be given an opportunity to speak on behalf of the application and to respond and challenge any charges or reasons given for the denial. No petitions can be accepted by the committee, unless the people who signed the petition are present at the committee hearing and willing to testify. You may present witnesses under oath and you may also confront and cross-examine opposing witnesses under oath. If you have difficulty with the English language, you should bring an interpreter with you, at your expense, so that you can answer questions and participate in your hearing.

You may examine the application file at this office during regular business hours prior to the hearing date. Inquiries regarding this matter may be directed to the person whose signature appears below.

Limited parking for persons attending meetings in City Hall is available at reduced rates (5 hour limit) at the Milwaukee Center on the southwest corner of East Kilbourn and North Water Street. Parking tickets must be validated in the first floor information booth in City Hall.

PLEASE NOTE: Upon reasonable notice, efforts will be made to accommodate the needs of disabled individuals through sign language interpreters or other auxiliary aids. For additional information or to request this service, contact the Council Services Division ADA Coordinator at (414) 286-2998, Fax - (414) 286-3456, TDD - (414) 286-2025.

JIM OWCZARSKI, CITY CLERK

BY:

Jessica Celella  
License Division Manager

If you have questions regarding this notice, please contact the License Division at (414) 286-2238.

**Byrd, Yashica**

---

**From:** Donovan, Robert  
**Sent:** Monday, February 10, 2020 3:42 PM  
**To:** Byrd, Yashica; Donovan, Robert  
**Cc:** Celella, Jessica  
**Subject:** RE: Community Complaint

REDACTED RECORD

Yes - ☺

Patty Doherty  
Legislative Aide  
Alderman Donovan  
8<sup>th</sup> District  
(414) 286-3533

---

**From:** Byrd, Yashica  
**Sent:** Monday, February 10, 2020 3:37 PM  
**To:** Donovan, Robert  
**Cc:** Celella, Jessica  
**Subject:** RE: Community Complaint

Patty,

Is this complaint for the Secondhand Motor Vehicle Dealer's License application you called about, Mr. Victor Body Shop at 1643 S 38<sup>th</sup> St, C?

---

**From:** Donovan, Robert  
**Sent:** Monday, February 10, 2020 3:32 PM  
**To:** Byrd, Yashica; Celella, Jessica  
**Subject:** FW: Community Complaint

FYI -

Patty Doherty  
Legislative Aide  
Alderman Donovan  
8<sup>th</sup> District  
(414) 286-3533

**From:**  
**Sent:** , February , 2020 AM  
**To:** Donovan, Robert  
**Subject:** Re: Community Complaint

Please confirm this message has been received by Alderman Donovan.

Thank you,

On Feb , 2020 at PM.

note:

Hello,

My name is [redacted] and I reside on [redacted] S. 38<sup>th</sup> Street and W. Lapham St. The neighbors and I are concerned about the businesses on the south west corner or 38<sup>th</sup> and Lapham. It has come to our attention that the owner has applied for a body shop and wholesale/second hand retail license (vehicles) on the south west corner of the property. The businesses at this corner already takes up our street parking with tow trucks constantly dropping off damaged cars on the adjacent roadways along with dumping car parts that we all constantly have to pick up or call the City about. Not to mention constant oil and fluids leaks all over the roadway. Now I've heard/read on Accela that they want to obtain a dealership and body shop license. I find this very inconsiderate and hard to believe that the City and the Aldermanic office would grant permission as these businesses are already running down the neighborhood and not up to code. We are all constantly calling the City regarding these reoccurring issues. Not only this but how can a dealership/body shop be approved for a license or occupancy permit on a gravel lot with a pull shed as an office/garage? I've walked passed and they don't even have a paint booth and they have already been fixing/painting cars at the location on the south west corner of the lot for at least the past year. In addition, the subject pull shed at the south west corner is the source of many of the oil leaks/car parts left in the right of way. I don't see how this is environmentally safe or even up to code or how they have been in business without a license prior to this. I am in the process of putting together a petition and I am also contacting DNS/City of Milwaukee to find out why/how this license would even be able to process when not up to code. Operating a business prior to proper licensing will not be welcomed or tolerated by our community. Please hear the voice of our community – Burnham Park and put a stop to this. I would appreciate if you kept my name and address anonymous as this location seems to be very shady.

Please see the following Accela record numbers for your convenience.

Record NOCC-19-02167

Tax Key 4579902000

Thank you very much,

**REDACTED RECORD**



Wednesday, February 26, 2020



# Notice of Public Hearing

---

BAHENA, Victor, Agent  
Mr. Victor Bodyshop at 1643 S 38TH St #C  
Secondhand Motor Vehicle Dealer's License Application

**Tuesday, March 10, 2020 at 9:15 AM**

To whom it may concern:

The above application has been made by the above named applicant(s). This requires approval from the Licenses Committee and the Common Council of the City of Milwaukee. The hearing before the Licenses Committee will take place on 3/10/2020 at 9:15 AM, in Room 301-B, Third Floor, City Hall. If you wish, you may provide testimony at the hearing regarding the request; see below for further information. You are not required to attend the hearing. Once the Licenses Committee makes its recommendation, this recommendation is forwarded to the full Common Council for approval at its next regularly scheduled hearing. Please review the information below and if you have further questions regarding this process, please contact the License Division at (414) 286-2238.

---

## Important details for those wishing to provide information for the Licenses Committee to consider when making its recommendation:

1. The license application is scheduled to be heard at the above time. Due to other hearings running longer than scheduled, you may have to wait some time to provide your testimony.
2. You must appear in person and testify as to matters that you have personally experienced or seen. (You cannot provide testimony for your neighbor, parent or anyone else; this is considered hearsay and cannot be considered by the committee.)
3. No letters or petitions can be accepted by the committee (unless the person who wrote the letter or the persons who signed the petition are present at the committee hearing and willing to testify).
4. Persons opposed to the license application are given the opportunity to testify first; supporters may testify after the opponents have finished.
5. When you are called to testify, you will be sworn in and asked to give your name, and address. (If your first and/or last names are uncommon please spell them.)
6. You may then provide testimony.
  - a. Include only information relating to the above license application.
  - b. Include only information you have personally witnessed or seen.
  - c. Provide concise and relevant information detailing how this business has affected or may affect the peaceful enjoyment of your neighborhood.
  - d. If by the time you have the opportunity to testify, the information you wish to share has already been provided to the committee, you may state that you agree with the previous testimony. Redundant or repetitive testimony will not assist the committee in making its recommendation.
7. After giving your testimony, the members of the Licenses Committee and the licensee may ask questions regarding the testimony you have given or other factors relating to the license application.
8. Business Competition is not a valid basis for denial or non-renewal of a license.  
**Please Note: If you have submitted an objection to the above application your objection cannot be considered by the committee unless you personally testify at the hearing.**

OCCUPANT	MAIL ADDRESS	CITY, STATE ZIP
CURRENT OCCUPANT	3723 W LAPHAM ST 1	MILWAUKEE, WI 53215
CURRENT OCCUPANT	3744 W LAPHAM ST	MILWAUKEE, WI 53215
CURRENT OCCUPANT	1620 S 38TH ST	MILWAUKEE, WI 53215
CURRENT OCCUPANT	3723 W LAPHAM ST 6	MILWAUKEE, WI 53215
CURRENT OCCUPANT	1622 S 38TH ST	MILWAUKEE, WI 53215
CURRENT OCCUPANT	1612 S 38TH ST	MILWAUKEE, WI 53215
CURRENT OCCUPANT	3723 W LAPHAM ST 3	MILWAUKEE, WI 53215
CURRENT OCCUPANT	3731 W LAPHAM ST 10	MILWAUKEE, WI 53215
CURRENT OCCUPANT	3751 W LAPHAM ST	MILWAUKEE, WI 53215
CURRENT OCCUPANT	1580 S 38TH ST	MILWAUKEE, WI 53215
CURRENT OCCUPANT	1556 S 38TH ST	MILWAUKEE, WI 53215
CURRENT OCCUPANT	3723 W LAPHAM ST 2	MILWAUKEE, WI 53215
CURRENT OCCUPANT	3731 W LAPHAM ST 7	MILWAUKEE, WI 53215
CURRENT OCCUPANT	3731 W LAPHAM ST 9	MILWAUKEE, WI 53215
CURRENT OCCUPANT	3731 W LAPHAM ST 8	MILWAUKEE, WI 53215
CURRENT OCCUPANT	3723 W LAPHAM ST 4	MILWAUKEE, WI 53215
CURRENT OCCUPANT	3735 W LAPHAM ST	MILWAUKEE, WI 53215
CURRENT OCCUPANT	3738 W LAPHAM ST	MILWAUKEE, WI 53215
CURRENT OCCUPANT	3732 W LAPHAM ST	MILWAUKEE, WI 53215
CURRENT OCCUPANT	3726 W LAPHAM ST	MILWAUKEE, WI 53215
CURRENT OCCUPANT	1564 S 38TH ST	MILWAUKEE, WI 53215
CURRENT OCCUPANT	3723 W LAPHAM ST 5	MILWAUKEE, WI 53215
CURRENT OCCUPANT	3736 W MITCHELL ST	MILWAUKEE, WI 53215
CURRENT OCCUPANT	3731 W LAPHAM ST 12	MILWAUKEE, WI 53215
CURRENT OCCUPANT	3731 W LAPHAM ST 11	MILWAUKEE, WI 53215

Total Records: 25

Radius: 250.0 feet and Center of Circle: 1643 S 38th St



## BUSINESS LICENSE PLAN OF OPERATION

ccl-busplan 3/15/18

Office of the City Clerk License Division

200 E. Wells St. Room 105, Milwaukee, WI 53202

(414) 286-2238 www.milwaukee.gov/license e-mail address: [license@milwaukee.gov](mailto:license@milwaukee.gov)

### 1. Type of Business

Applying for:  Extended Hours (12AM to 5AM) - If a food establishment, check all that apply:  Delivery  Drive Thru  Dining Room  
 Self Service Laundry  Massage Establishment  Filling Station  
 Other (supplemental application for specific license also required)

Provide a detailed description of the type of business you plan on operating: Wholesale Dealership/Retail display 2 Vehicles in front of the Autobody facility, we will not be a full bloom dealership. All advertisement will be done via online such as Facebook, Craigslist and Social media

Do you have any experience operating this type of business?  No  Yes If yes, explain: I worked in Dealership, and auto body shop

### 2. Business Operations

- a. Proposed Opening Date: March 2, 2020
- b. Is this premise under construction?  No  Yes If yes, list estimated completion date: \_\_\_\_\_
- c. Is this a franchise?  No  Yes
- d. Is this premises currently licensed?  No  Yes If yes, list type of license: Autobody
- e. Is the current licensee operating?  No  Yes If no, list date closed: \_\_\_\_\_
- f. Do you have future plans for other businesses, licenses or permits at this location?  No  Yes  
If yes, explain: \_\_\_\_\_
- g. Have you previously held an Extended Hours License in Milwaukee?  No  Yes  
If yes, list address(es): \_\_\_\_\_
- h. Are other businesses operating in the same building?  No  Yes If yes, describe: \_\_\_\_\_

### 3. Litter & Noise

- a. How are grounds kept clean?  Sweep  Pressure Wash  Pick Up Litter  Other: \_\_\_\_\_
- b. How often will grounds be cleaned?  Daily  Weekly  As Needed  Monthly  Other: \_\_\_\_\_
- c. Grounds cleaned by:  Licensee  Building Owner  Employees  Hired Maintenance  Other: \_\_\_\_\_
- d. How are noise issues prevented and/or addressed?  Security  Manager approaches customer(s)  Call Police  
 Signs Posted  Other: \_\_\_\_\_
- e. Will a sound amplification system be used?  No  Yes If yes, describe: \_\_\_\_\_

### 4. Smoking & Sanitation

- a. Are there designated outdoor smoking areas?  No  Yes If yes, describe: \_\_\_\_\_
- b. Number of Garbage Cans: Inside: 1 Locations: North east corner of building  
Outside: 1 Locations: South east corner of property
- c. Is a crowd control barrier used?  No  Yes If yes, describe: \_\_\_\_\_
- d. How many restrooms are on the premises? 1
- e. Name of solid waste contractor:  Advanced Disposal  Waste Management  Other: \_\_\_\_\_

## 5. Security

- a. Are there onsite parking spaces?  No  Yes If yes, how many? 6 and describe the parking security plan: Cameras are in place all around the facility
- b. Is there a loading zone?  No  Yes If yes, describe the loading area security plan: \_\_\_\_\_
- c. Will you have security personnel on premise?  No  Yes If yes, how many? \_\_\_\_\_ and answer the following:  
 What are their responsibilities? \_\_\_\_\_  
 Is security equipment used?  No  Yes If yes, describe \_\_\_\_\_  
 List their licensing, certification, or training credentials \_\_\_\_\_
- d. Will there be security cameras?  No  Yes If yes, how many? 2 and list locations: North West corner and South East corner
- e. Will searches/identification checks be done upon entry?  No  Yes If yes, describe \_\_\_\_\_

## 6. Percentage of Sales (must total 100%)

Alcohol _____%	Food _____%	Secondhand Merchandise _____% Text	Precious Metals & Gems _____%
Entertainment _____%	Cigarettes _____%	_____% Text	_____%
Pawnbroker Activity _____%	Salvaged Materials _____% (such as scrap metal)	Personal Services (such as tattoo, body piercing, salon, tailor, tanning, etc.) _____%	Other <u>100</u> % Describe: <u>Autobody and Sales</u>

## 7. Businesses/Licenses on the Premises (check all that apply):

### Type 1

- Full Service Restaurant       Cafe/Coffee Shop       Deli or Fast Food Restaurant       Private/Fraternal/Veterans Club
- Night Club       Tavern       Cocktail Lounge       Teen Club
- Banquet Hall       Sports Facility       Bowling Alley
- Hotel/Motel: Number of Floors: \_\_\_\_\_  
Number of Rooms: \_\_\_\_\_
- Rooming House: Number of Floors: \_\_\_\_\_  
Number of Rooms: \_\_\_\_\_

### Type 2

- Liquor Store       Corner Store       Supermarket       Convenience Store
- Gas Station       Amusement/Phonograph Distributor       Recycling, Salvage or Towing
- Used Car Dealer       Personal Service Establishment  
(such as tattoo business, hair salon, tailor, etc.)       Recording Studio

What other licenses/permits will you hold at this location? (check all that apply)

- Occupancy Permit     Cigarette & Tobacco     Gas Station     Extended Hours     Class "B" Tavern     Weights & Measures
- Secondhand Dealer     Precious Metal & Gem     Other: \_\_\_\_\_

## 8. Legal Capacity (only if a Type 1 premises in #7 above)

Capacity \_\_\_\_\_ (Call the Milwaukee Development Center at 414-286-8211 if you have questions.)

## 9. Premises Description

- a. Identify all area(s) of the premises that will be used in operating this business (include areas used only for storage):  
 1<sup>st</sup> Floor  2<sup>nd</sup> Floor  Basement Storage  Patio  Beer Garden  Sidewalk Café  Deck  Rooftop  
 Other: Describe: \_\_\_\_\_
- b. Describe Location:  Major Thoroughfare  Secondary Street  Other: \_\_\_\_\_
- c. Nearest Major Cross Street: West Mitchel St and S 38th ST
- d. Describe Building:  Free Standing Building  Strip Mall  Other: \_\_\_\_\_
- e. Describe Premises Structure:  Single Story  Multi-Story - # of Stories \_\_\_\_\_  Other: \_\_\_\_\_
- f. Describe Surrounding Area:  Commercial  Residential  Industrial  Other: \_\_\_\_\_
- g. Building Owner Name: Alex Kostner Phone Number: 608-217-1366  
 Business Owner Address: 1579 S 38th St, STE 10, Milwaukee, WI 53215

## 10. Hours of Operation & Customers

Will customers be entering the premises?  No  Yes

Day of the Week	Proposed Hours of Operation:		Estimated Number of Customers expected each day	Potential Age Range of Customers	Class B Tavern Applicant Only: Age Restriction (If none, write 'None')
	Open Time (include a.m. or p.m.)	Close Time (include a.m. or p.m.)			
<b>Sunday</b>					
<b>Monday</b>	8:00 AM	6:00 PM	2	18-99	
<b>Tuesday</b>	8:00 AM	6:00 PM	2	18-99	
<b>Wednesday</b>	8:00 AM	6:00 PM	2	18-99	
<b>Thursday</b>	8:00 AM	6:00 PM	2	18-99	
<b>Friday</b>	8:00 AM	6:00 PM	2	18-99	
<b>Saturday</b>	8:00 AM	1:00 PM	2	18-99	

An Extended Hours Establishment License is required for any convenience store, filling station, personal service establishment (such as tattoo, body piercing, salon, tailor, tanning, etc.), recording studio or restaurant which is open between the hours of 12:00 a.m. and 5:00 a.m.

Alcohol Establishments Class A: 8:00 am to 9:00 pm Sunday thru Saturday  
 Permitted Hours of Operation: Class B: 6:00 am to 2:00 am Sunday thru Thursday, 6:00 am to 2:30 am Friday & Saturday

Entertainment Outdoor Closing Hours: 10:00pm Sunday-Thursday; 12:00am Friday & Saturday; unless a different time, either earlier or later, is established by the Common Council in its approval of the licensee's plan of operation.

## 11. Signature(s)

 \_\_\_\_\_ 01/15/2020  
 Signature of Sole Proprietor, Partner, or 20% or more Shareholder  
 (If there are no 20% or more shareholders, Corporate Officer-print name/title and sign)

\_\_\_\_\_  
 Signature of additional partner or 20% or more shareholder

See Application Information for a complete list of all required application forms.





**SECONDHAND MOTOR VEHICLE DEALER LICENSE  
SUPPLEMENTAL PLAN OF OPERATION**

Office of the City Clerk License Division  
200 E. Wells St. Room 105, Milwaukee, WI 53202  
(414) 286-2238 e-mail address: [license@milwaukee.gov](mailto:license@milwaukee.gov)

Legal Entity Name: Autocami LLC

Premises Address: 1643 S 38th St, unit C, Milwaukee, WI 53215

**SECTION 1 LICENSE TYPE**

What type of license are you applying for? (check one)  Retail  Wholesale

**SECTION 2**

Will you also be dealing in secondhand vehicle parts?  Yes  No

If wholesale, is the premises address a residential (home) address?  Yes  No

If yes, you must obtain a Home Occupational Statement from the Department of Neighborhood Services (414) 286-3874.

No vehicles can be parked and no customers are allowed at the premises.

The following questions in Section 2 do not apply to wholesale from a residential address. Go to Section 3.

Number of parking spaces available to customers/employees 10

Number of parking spaces that will be used for display/storage of Secondhand Motor Vehicles 2

Do you understand that all vehicles associated with the business must be stored on the licensed premise?  Yes  No

What are your plans to ensure this requirement is met (check all that apply)?  Employee Training

Supervisor Monitoring  Fenced Lot  Keys Kept in Locked Box  Other: \_\_\_\_\_

Do you understand all maintenance/repair work to these vehicles must be confined to the licensed premise?  Yes  No

What are your plans to ensure this requirement is met (check all that apply)?  Employee Training

Supervisor Monitoring  Designated Repair Area  Other: \_\_\_\_\_

Do you understand all keys to used motor vehicles offered for sale must be kept in a secure lockbox inside the dealership building at all times when the dealership is not open for business?  Yes  No

What are your plans to ensure this requirement is met (check all that apply)?  Employee Training

Supervisor Monitoring  Other: \_\_\_\_\_

**SECTION 3 DISCLOSURE**

Has any person on the application ever had a license relating to the activities licensed in Milwaukee Code of Ordinances Chapter 92 denied, not renewed, suspended, or revoked?  No  Yes

If yes, provide the circumstances and jurisdiction in which the event occurred (including a record of any actions from the State Department of Transportation and Financial Institutions relating to suspensions, revocations, forfeitures and warnings imposed by these departments relating to the operation of any automotive sales business by the applicant):

**SECTION 4 SIGNATURES**

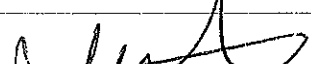
 01/15/2020

Sole Proprietor, Partner, or 20% or more Shareholder  
(If there are no 20% or more shareholders,  
Corporate Officer—print name/title and sign)

\_\_\_\_\_  
Additional partner or 20% or more shareholder



**CITY OF MILWAUKEE  
OFFICE OF THE CITY CLERK**

Friday, February 28, 2020

**COMMITTEE MEETING NOTICE**

AD 08

DHAWAN, Mandeep, Agent  
Lincoln Market Inc  
3530-34 W Lincoln Av

Milwaukee, WI 53215

You are requested to attend a hearing which is to be held in Room 301-B, Third Floor, City Hall on:

**Tuesday, March 10, 2020 at 09:15 AM**

**Regarding:** Your Class A Malt & Class A Liquor and Food Dealer License applications as agent for "Lincoln Market Inc" for "Lincoln Market Inc" at 3530-34 W Lincoln Av.

There is a possibility that your application may be denied for one or more of the following reasons: The recommendation of the committee regarding the application shall be based on evidence presented at the hearing. Per MCO 85-2.7-4, probative evidence concerning whether or not a new license should be granted may be presented on the following subjects: whether or not the applicant meets the municipal requirements, the appropriateness of the location and premises where the licensed premises is to be located and whether use of the premises for the purposes or activities permitted by the license would tend to facilitate a public or private nuisance or create undesirable neighborhood problems such as disorderly patrons, unreasonably loud noise, litter, and excessive traffic and parking congestion. Probative evidence relating to these matters may be taken from the plan of operation submitted with the license application, if any, but shall not include the content of any music. Evidence regarding the fitness of the location of the premises to be maintained as the principal place of business, including but not limited to whether there is an overconcentration of businesses of the type for which the license is sought; whether the proposal is consistent with any pertinent neighborhood business or development plans, or the location's proximity to areas where children are typically present. The applicant's record in operating similarly licensed premises; and whether or not the applicant has been charged with or convicted of any felony, misdemeanor, municipal offense or other offense, the circumstances of which substantially relate to the activity to be permitted by the license being applied for or any other factor which reasonably relates to the public health, safety or welfare may also be considered. See attached police report or correspondence.

**Notice for applicants with warrants or unpaid fines:** Proof of warrant satisfaction or payment of fines must be submitted at the hearing on the above date and time. Failure to comply with this requirement may result in a delay of the granting/denial of your application.

Failure to appear at this meeting may result in the denial of your license. Individual applicants must appear only in person or by an attorney. Corporate or Limited Liability applicants must appear only by the agent designated on the application or by an attorney. Partnership applicants must appear by a partner listed on the application or by an attorney. If you wish to do so and at your own expense, you may be accompanied by an attorney of your choosing to represent you at this hearing.

You will be given an opportunity to speak on behalf of the application and to respond and challenge any charges or reasons given for the denial. No petitions can be accepted by the committee, unless the people who signed the petition are present at the committee hearing and willing to testify. You may present witnesses under oath and you may also confront and cross-examine opposing witnesses under oath. If you have difficulty with the English language, you should bring an interpreter with you, at your expense, so that you can answer questions and participate in your hearing.

You may examine the application file at this office during regular business hours prior to the hearing date. Inquiries regarding this matter may be directed to the person whose signature appears below.

Limited parking for persons attending meetings in City Hall is available at reduced rates (5 hour limit) at the Milwaukee Center on the southwest corner of East Kilbourn and North Water Street. Parking tickets must be validated in the first floor Information booth in City Hall.

PLEASE NOTE: Upon reasonable notice, efforts will be made to accommodate the needs of disabled individuals through sign language interpreters or other auxiliary aids. For additional information or to request this service, contact the Council Services Division ADA Coordinator at (414) 286-2998, Fax - (414) 286-3456, TDD - (414) 286-2025.

JIM OWCZARSKI, CITY CLERK

BY:

Jessica Cejella  
License Division Manager

**If you have questions regarding this notice, please contact the License Division at (414) 286-2238.**

200 E. Wells Street, Room 105, City Hall, Milwaukee, WI 53202. [www.milwaukee.gov/license](http://www.milwaukee.gov/license)  
Phone: (414) 286-2238 Fax: (414) 286-3057 Email Address: [License@milwaukee.gov](mailto:License@milwaukee.gov)



**CITY OF MILWAUKEE  
OFFICE OF THE CITY CLERK**

Friday, February 28, 2020

**COMMITTEE MEETING NOTICE**

AD 08

DHAWAN, Mandeep, Agent  
Lincoln Market Inc  
3821 W College Ave

Milwaukee, WI 53221

You are requested to attend a hearing which is to be held in Room 301-B, Third Floor, City Hall on:

**Tuesday, March 10, 2020 at 09:15 AM**

**Regarding:** Your Class A Malt & Class A Liquor and Food Dealer License Applications as agent for "Lincoln Market Inc" for "Lincoln Market Inc" at 3530-34 W Lincoln Av.

There is a possibility that your application may be denied for one or more of the following reasons: The recommendation of the committee regarding the application shall be based on evidence presented at the hearing. Per MCO 85-2.7-4, probative evidence concerning whether or not a new license should be granted may be presented on the following subjects: whether or not the applicant meets the municipal requirements, the appropriateness of the location and premises where the licensed premises is to be located and whether use of the premises for the purposes or activities permitted by the license would tend to facilitate a public or private nuisance or create undesirable neighborhood problems such as disorderly patrons, unreasonably loud noise, litter, and excessive traffic and parking congestion. Probative evidence relating to these matters may be taken from the plan of operation submitted with the license application, if any, but shall not include the content of any music. Evidence regarding the fitness of the location of the premises to be maintained as the principal place of business, including but not limited to whether there is an overconcentration of businesses of the type for which the license is sought; whether the proposal is consistent with any pertinent neighborhood business or development plans, or the location's proximity to areas where children are typically present. The applicant's record in operating similarly licensed premises; and whether or not the applicant has been charged with or convicted of any felony, misdemeanor, municipal offense or other offense, the circumstances of which substantially relate to the activity to be permitted by the license being applied for or any other factor which reasonably relates to the public health, safety or welfare may also be considered. See attached police report or correspondence.

**Notice for applicants with warrants or unpaid fines:** Proof of warrant satisfaction or payment of fines must be submitted at the hearing on the above date and time. Failure to comply with this requirement may result in a delay of the granting/denial of your application.

Failure to appear at this meeting may result in the denial of your license. Individual applicants must appear only in person or by an attorney. Corporate or Limited Liability applicants must appear only by the agent designated on the application or by an attorney. Partnership applicants must appear by a partner listed on the application or by an attorney. If you wish to do so and at your own expense, you may be accompanied by an attorney of your choosing to represent you at this hearing.

You will be given an opportunity to speak on behalf of the application and to respond and challenge any charges or reasons given for the denial. No petitions can be accepted by the committee, unless the people who signed the petition are present at the committee hearing and willing to testify. You may present witnesses under oath and you may also confront and cross-examine opposing witnesses under oath. If you have difficulty with the English language, you should bring an interpreter with you, at your expense, so that you can answer questions and participate in your hearing.

You may examine the application file at this office during regular business hours prior to the hearing date. Inquiries regarding this matter may be directed to the person whose signature appears below.

Limited parking for persons attending meetings in City Hall is available at reduced rates (5 hour limit) at the Milwaukee Center on the southwest corner of East Kilbourn and North Water Street. Parking tickets must be validated in the first floor information booth in City Hall.

PLEASE NOTE: Upon reasonable notice, efforts will be made to accommodate the needs of disabled individuals through sign language interpreters or other auxiliary aids. For additional information or to request this service, contact the Council Services Division ADA Coordinator at (414) 286-2998, Fax - (414) 286-3456, TDD - (414) 286-2025.

JIM OWCZARSKI, CITY CLERK

BY: \_\_\_\_\_  
Jessica Celella

License Division Manager

**If you have questions regarding this notice, please contact the License Division at (414) 286-2238.**

200 E. Wells Street, Room 105, City Hall, Milwaukee, WI 53202. [www.milwaukee.gov/license](http://www.milwaukee.gov/license)  
Phone: (414) 286-2238 Fax: (414) 286-3057 Email Address: [License@milwaukee.gov](mailto:License@milwaukee.gov)

# MILWAUKEE POLICE DEPARTMENT LICENSING

## CRIMINAL RECORD/ORDINANCE VIOLATION/INCIDENTS SYNOPSIS

**DATE:** 01/31/2020  
**LICENSE TYPE:** ALQML  
**NEW:**   
**RENEWAL:**

**No. 305857**  
**Application Date:** 01/28/2020

**License Location:** 3530-34 W Lincoln Av  
**Business Name:** Lincoln Market

**Licensee/Applicant:** DHAWAN, Mandeep  
(Last Name, First Name, MI)  
**Date of Birth:** 03/16/1961

**Home Address:** 3821 W College Av  
**City:** Milwaukee **State:** WI **Zip Code:** 53221  
**Home Phone:**

This report is written by Police Officer David Novak, assigned to the License Investigation Unit, Days.

The Milwaukee Police Department's investigation regarding this application revealed the following:

1. On 11/14/2015 the applicant was cited in the City of Milwaukee at 3708 W. North Av for Sale of Cigarette to Minor/Underage.

**Charge:** Sale of Cigarette to Minor/Underage  
**Finding:** Guilty  
**Sentence:** Fined \$260.00  
**Date:** 11/29/2016  
**Case:** 16033199

2. On 11/25/2017 the applicant was cited in the City of Milwaukee at 3708 W. North Av for Sale of Cigarette to Minor/Underage.

**Charge:** Sale of Cigarette to Minor/Underage  
**Finding:** Guilty  
**Sentence:** Fined \$250.00  
**Date:** 01/14/2019  
**Case:** 18057055

3. On 05/11/2019 the applicant was cited in the City of Milwaukee at 3708 W. North Av for Sale of Cigarette to Minor/Underage.

Charge: Sale of Cigarette to Minor/Underage  
Finding: Guilty  
Sentence: Fined \$691.00  
Date: 11/08/2019  
Case: 19025288

4. On 10/19/2019 the applicant was cited in the City of Milwaukee at 6028 W. Fond du lac Av for Sale of Cigarette to Minor/Underage.

Charge: Sale of Cigarette to Minor/Underage  
Finding: pending Further Proceedings on 07/13/2020  
Sentence:  
Date:  
Case: 19054449

Date:2-6-20  
Officer: PO Matthew Diener

City of Milwaukee Police Department  
90-5-1.5 Crime Prevention Survey  
Convenience Store/Liquor Store Inspection

Name of Premise: Lincoln Market  
Address: 3530-34 W Lincoln Av  
Phone:

Owner: Mandeep DHAWAN  
Owner address: 3821 W College Av  
City State Zip: Milwaukee, WI 53221  
Owner Phone: 414-688-2747  
Owner email: petromandeep@yahoo.com

Manager: same  
Home Address:  
City State Zip:  
Phone:  
Email:

Preferred contact: phone

Location currently open:  YES  NO

Projected open date: December 2020

Day's open: S M T W Th F SA ALL

Hours of Operation: Sun: 8a-10p 24 hours Y N  
Mon: 8a-10p  
Tue: 8a-10p  
Wed: 8a-10p  
Thu: 8a-10p  
Fri: 8a-10p  
Sat: 8a-10p

Premise Type: Liquor Store  
Convenience Store  
Other:

Licenses currently held:

- Alcohol:  Yes  No Class: #:
- Tobacco:  Yes  No #: 1028853
- Food:  Yes  No #: 10164
- Extended Hours:  Yes  No #: 198977
- Secondhand Dealer:  Yes  No Type: #:
- Other:  Yes  No Type: W&M #: 5479
- Other:  Yes  No Type: #:

**Exterior Survey:**

1. Is the area around the location clean?  Yes  No
2. What surrounds the location? (Check all the apply)
  - a.  Park
  - b.  School
  - c.  Youth Center
  - d.  Church
  - e.  Tavern(s) If so, how many
  - f.  Residential
  - g.  Other businesses
  - h.  Other:
3. Can you see from the outside of the location into the interior  Yes  No
4. Can you see the employees inside of the location from the outside  Yes  No
5. Are exterior windows free of signage  Yes  No
6. Is there a parking lot  Yes  No
7. Is the parking lot clean?  Yes  No
8. Is the parking lot well lit?  Yes  No
9. Are there areas where a person could conceal themselves  Yes  No
10. Is there exterior lighting?  Yes  No. Does it appears to be adequate  Yes  No
11. Exterior Payphone?  Yes  No
12. Are there No Loitering Signs posted?  Yes  No
13. Are there exterior security cameras  Yes  No How Many:
14. Are the address numbers prominently displayed and easy to see  Yes  No

**Camera Survey:**

15. Does this location have security cameras?  Yes  No
16. Are they in working order?  Yes  No
17. What format are the cameras?
  - a. Color  Yes  No
  - b. Digital  Yes  No
  - c. VCR  Yes  No
  - d. Recorded  Yes  No
18. How long is footage stored for later viewing:
19. Are there exterior cameras  Yes  No How many:
20. Are there interior cameras  Yes  No How many:
21. Do all employees know how to retrieve recorded digital images/footage?  Yes  No

**Interior Survey:**

22. Is the storeowner willing to be a standing complainant regarding loitering?  Yes  No  
a. If yes have them fill out the standing complaint form and give them two of the commercial signs  Yes  No
23. Is the interior of the location neat and clean?  Yes  No
24. Does an interior camera face the entrance/exit?  Yes  No
25. Is there a lockable area that separates employees from customers?  Yes  No
26. Does the store sell single chore boy?  Yes  No
27. Does the store sell blunt wraps?  Yes  No
28. Does the store sell scales?  Yes  No
29. Does the store sell items that may be used as crack pipes?  Yes  No  
a. Describe item
30. Does the store have an over abundance of sandwich baggies:  Yes  No
31. Does the owner understand that these items are often used for drug use?  Yes  No
32. Do the products in the store appear to be new and rotated often?  Yes  No
33. Are emergency and non-emergency numbers posted near the phone?  Yes  No
34. Does the owner know how to contact their police district directly?  Yes  No  
a. Did you provide a district contact guide to the owner?  Yes  No

**Complete this section if alcohol establishment is a convenience store:**

(\* Read full ordinance for all details "68-4.3 Convenience Food Stores")

All convenience food stores not exempted under sub. 3 shall:

1. Is the cash register located in a manner so that at the time of a sales transaction, the employee and customer are both visible from the sidewalk?  Yes  No \*\*
2. Are the glass entrance and exit doors clear of any signs or advertisements with the exception of a sign which states that the cash register contains \$50 or less and that the safe is no accessible to employees?  Yes  No
3. Does the store maintain one of the following on the licensed premise:
  - a. A safe that was in use at the convenience food store on August 17, 1994?  Yes  No
  - b. A drop-safe or time release safe that weighs at least 500 pounds or which is attached to or set into the floor in a manner approved by the police department?  Yes  No
4. Is lighting provided for the store's parking area during all hours of darkness when employees or customers are on the premises at a minimum average of 2-foot candles per square foot, unless the store is not open for business after sunset and before sunrise?  Yes  No  N/A
5. Are at least two high-resolution surveillance security cameras installed?  Yes  No
6. Are the security cameras in working order?  Yes  No
7. Does one camera show an overall view of the counter and register area?  Yes  No
8. Does one camera show a clear, identifiable, full frame image of the face of each person entering and leaving the store?  Yes  No
9. Are the camera views obstructed by fixtures or displays?  Yes  No
10. Is the recorded footage stored for at least 30 days?  Yes  No
11. Do all store employees know how to record footage from the camera system to media capable of being transferred to police custody?  Yes  No



12. Are customer entrances/exits made of glass or other transparent material?  Yes  No  
a. Exception: A store that does not have such doors on August 17, 1994 shall not be required to install such doors until the holder of the store's food dealer license changes.
13. Has the owner and their employees attended the Robbery Prevention Training within 120 days of ownership or employment?  Yes  No  
a. Contact Community Outreach and Education at 935-7836 for schedule.

**Sub 3. Exemptions.** The requirements of this section do not apply to a convenience food store that conforms to either of the following descriptions:

- a-1. The store is located in an enclosed shopping structure, enclosed commercial building or hospital. A convenience food store is not in an enclosed structure or building if a customer can enter it directly from the outside.  
Does store conform to a-1  Yes  No
- a-2. The store physically separates employees from customers with a solid partition that bars a person from entering the employee area from the customer area, has a secure lock on the employee side of any door between the employee area and the customer, and conducts all transactions through a service window or similar arrangement.  
Does store conform to a-2  Yes  No
- a. At the commissioner's discretion, a convenience store may be exempted from any or all of the regulations specified in sub 2.  
Does this location hold an exemption from the commissioner regarding any of the requirements of Sub 2?  Yes  No

**ADDITIONAL COMMENTS/RECOMMENDATIONS:**

The premise is currently an empty/vacant lot, and the applicant will be constructing a new building which will be a neighborhood market/liquor store. Since there was no building to inspect, we discussed cameras and placement, which the applicant stated that he will at least be installing 4 cameras outside with at least 8 cameras inside. The applicant stated that he will have an enclosed cashier's area and a small parking lot that will be lit during the hours of darkness. The applicant is also aware of certain products that can be used as drug paraphernalia, and stated that his store will not sell these items. We also advised the applicant to install a safe that is secured to the floor and not able to be removed easily.

 **City of Milwaukee** Concentration Map



**3530-34 W Lincoln Ave**

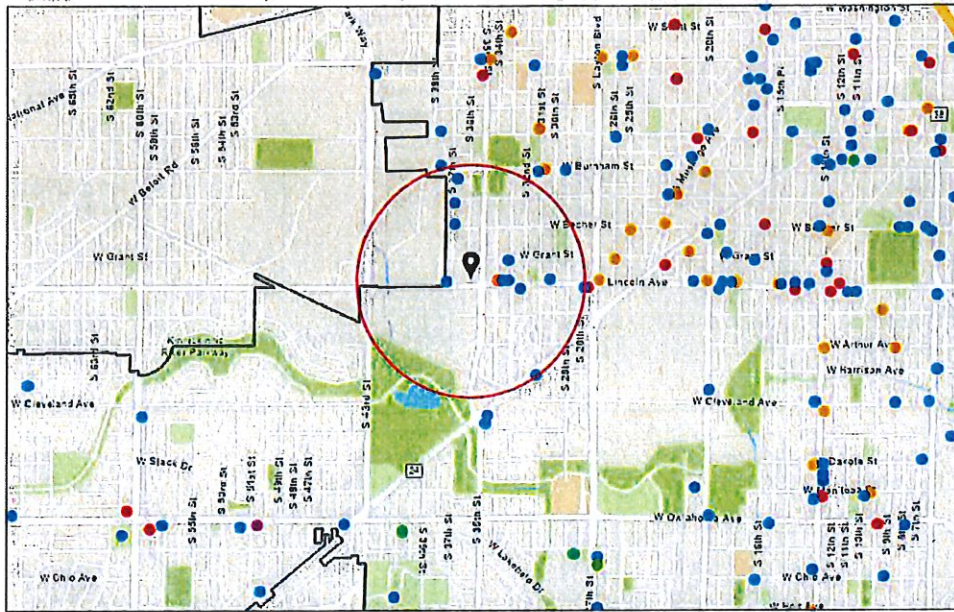

Area : 21,862,585.68 ft<sup>2</sup>



Feb 4 2020 11:07:12 Central Standard Time



**Alcohol Licenses**

-  Class A Intoxicating Liquor
-  Class A Fermented Malt Beverage

-  Class A Liquor and Malt
-  Class B Fermented Malt Beverage
-  Class B Tavern

-  Class C Wine Retailer
-  City Boundary

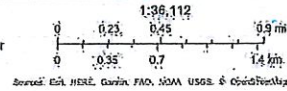

## Summary

Name	Count	Area(ft <sup>2</sup> )	Length(mi)
Alcohol Licenses	12		

## Alcohol Licenses

#	Legal Entity	Trade Name	Licensee	Address	License Type Name	Total Capacity	Expiration Date	Count
1	Agave Azul	Agave Azul	FRANCISCO RIOS, JR, SP	3316 W Lincoln AV	Class B Tavern License	94	9/23/2020, 7:00 PM	1
2	TORY OF MILWAUKEE, INC	MC KIERNANS	GENE M MC KIERNAN, Agt	2066 S 37TH ST	Class B Tavern License	99	5/30/2020, 7:00 PM	1
3	Tu Casa LLC	Tu Casa Mexican Restaurant & Bar	Susana L Barba-Martiri, Agt	3710 W LINCOLN AV	Class B Tavern License		7/8/2020, 7:00 PM	1
4	Arora Pantry Inc	Quick Pick Food Mart	Gurmeet S Arora, Agt	3332 W Lincoln AV	Class A Fermented Malt Beverage Retailer's License		7/26/2020, 7:00 PM	1
5	Arora Pantry Inc	Quick Pick Food Mart	Gurmeet S Arora, Agt	3332 W Lincoln AV	Class A Retailer's Intoxicating Liquor License		7/26/2020, 7:00 PM	1
6	CJ's Pub LLC	CJ's Pub	CORINA L WAGE, Agt	3643 W Rogers ST	Class B Tavern License	49	7/23/2020, 7:00 PM	1
7	RTSP, LLC	JUST ONE MORE	ANTONIO S PEREZ, Agt	3209 W LINCOLN AV	Class B Tavern License	25	12/19/2020, 6:00 PM	1
8	CHILLY WILLYS SALOON	CHILLY WILLYS SALOON	DAVID W OLSON, SP	3301 W GRANT ST	Class B Tavern License	25	2/29/2020, 6:00 PM	1
9	5050 Lounge LLC	Junior's Cocktail Lounge	Edward R Calloway, Agt	3300 W Lincoln AV	Class B Tavern License		1/8/2021, 6:00 PM	1
10	Villana's Place, LLC	Villana's Place	Juan Manuel Macias Gallardo, Agt	3000 W LINCOLN AV	Class B Tavern License	160	1/28/2021, 6:00 PM	1
11	MCFINAGIN LLC	BREW CITY TAP	MARK S SILBER, Agt	3105 W FOREST HOME AV	Class B Tavern License	80	10/10/2020, 7:00 PM	1
12	POLKA DOT SPIRITS, LLC	KOCHANSKI'S CONCERTINA BEER HALL	ANDREW J KOCHANSKI, Agt	1920 S 37TH ST	Class B Tavern License	80	11/3/2020, 6:00 PM	1

Establishments within a 0.5 miles radius centered on area of interest.



Friday, February 28, 2020

## Licenses Committee Notice of Hearing

City of Milwaukee  
809 N BROADWAY  
Milwaukee, WI 53202

Date: 3/10/2020  
Time: 09:15 AM  
Location: Room 301-B, Third Floor, City Hall

The Licenses Committee will consider the following license application:

Class A Malt & Class A Liquor and Food Dealer License Applications  
DHAWAN, Mandeep, Agent  
Lincoln Market Inc at 3530-34 W Lincoln Av

Please note this application may be recommended for denial based on fitness of the location due to concentration of alcohol beverage outlets in the area. If the application is denied for this reason, no other application for an alcohol beverage license for this location shall be recommended for approval by the Licenses Committee within three years of the date of denial unless the applicant has demonstrated a change of circumstances since the prior denial.

If you have any questions, please call (414) 286-2238.





Friday, February 28, 2020

## Licenses Committee Notice of Hearing

Lincoln Market LLC  
3510 W Lincoln Ave  
Milwaukee, WI 53215

Date: 3/10/2020  
Time: 09:15 AM  
Location: Room 301-B, Third Floor, City Hall

The Licenses Committee will consider the following license application:

Class A Malt & Class A Liquor and Food Dealer License Applications  
DHAWAN, Mandeep, Agent  
Lincoln Market Inc at 3530-34 W Lincoln Av

Please note this application may be recommended for denial based on fitness of the location due to concentration of alcohol beverage outlets in the area. If the application is denied for this reason, no other application for an alcohol beverage license for this location shall be recommended for approval by the Licenses Committee within three years of the date of denial unless the applicant has demonstrated a change of circumstances since the prior denial.

If you have any questions, please call (414) 286-2238.





Friday, February 28, 2020



# Notice of Public Hearing

---

DHAWAN, Mandeep, Agent  
Lincoln Market Inc at 3530-34 W Lincoln Av  
Class A Malt & Class A Liquor and Food Dealer License Applications

**Tuesday, March 10, 2020 at 9:15 AM**

To whom it may concern:

The above application has been made by the above named applicant(s). This requires approval from the Licenses Committee and the Common Council of the City of Milwaukee. The hearing before the Licenses Committee will take place on 3/10/2020 at 9:15 AM, in Room 301-B, Third Floor, City Hall. If you wish, you may provide testimony at the hearing regarding the request; see below for further information. You are not required to attend the hearing. Once the Licenses Committee makes its recommendation, this recommendation is forwarded to the full Common Council for approval at its next regularly scheduled hearing. Please review the information below and if you have further questions regarding this process, please contact the License Division at (414) 286-2238.

---

## Important details for those wishing to provide information for the Licenses Committee to consider when making its recommendation:

1. The license application is scheduled to be heard at the above time. Due to other hearings running longer than scheduled, you may have to wait some time to provide your testimony.
2. You must appear in person and testify as to matters that you have personally experienced or seen. (You cannot provide testimony for your neighbor, parent or anyone else; this is considered hearsay and cannot be considered by the committee.)
3. No letters or petitions can be accepted by the committee (unless the person who wrote the letter or the persons who signed the petition are present at the committee hearing and willing to testify).
4. Persons opposed to the license application are given the opportunity to testify first; supporters may testify after the opponents have finished.
5. When you are called to testify, you will be sworn in and asked to give your name, and address. (If your first and/or last names are uncommon please spell them.)
6. You may then provide testimony.
  - a. Include only information relating to the above license application.
  - b. Include only information you have personally witnessed or seen.
  - c. Provide concise and relevant information detailing how this business has affected or may affect the peaceful enjoyment of your neighborhood.
  - d. If by the time you have the opportunity to testify, the information you wish to share has already been provided to the committee, you may state that you agree with the previous testimony. Redundant or repetitive testimony will not assist the committee in making its recommendation.
7. After giving your testimony, the members of the Licenses Committee and the licensee may ask questions regarding the testimony you have given or other factors relating to the license application.
8. Business Competition is not a valid basis for denial or non-renewal of a license.  
**Please Note: If you have submitted an objection to the above application your objection cannot be considered by the committee unless you personally testify at the hearing.**

OCCUPANT	MAIL ADDRESS	CITY, STATE ZIP
CURRENT OCCUPANT	2248 S 36TH ST	MILWAUKEE, WI 53215
CURRENT OCCUPANT	2256 S 37TH ST	MILWAUKEE, WI 53215
CURRENT OCCUPANT	2254 S 37TH ST	MILWAUKEE, WI 53215
CURRENT OCCUPANT	2229 S 35TH ST	MILWAUKEE, WI 53215
CURRENT OCCUPANT	2257 S 35TH ST	MILWAUKEE, WI 53215
CURRENT OCCUPANT	2245A S 35TH ST	MILWAUKEE, WI 53215
CURRENT OCCUPANT	2251 S 36TH ST	MILWAUKEE, WI 53215
CURRENT OCCUPANT	2229A S 36TH ST	MILWAUKEE, WI 53215
CURRENT OCCUPANT	2245 S 35TH ST	MILWAUKEE, WI 53215
CURRENT OCCUPANT	2245 S 36TH ST	MILWAUKEE, WI 53215
CURRENT OCCUPANT	2233A S 35TH ST	MILWAUKEE, WI 53215
CURRENT OCCUPANT	2238 S 36TH ST	MILWAUKEE, WI 53215
CURRENT OCCUPANT	2250 S 37TH ST	MILWAUKEE, WI 53215
CURRENT OCCUPANT	2244 S 37TH ST	MILWAUKEE, WI 53215
CURRENT OCCUPANT	2239 S 36TH ST	MILWAUKEE, WI 53215
CURRENT OCCUPANT	2239A S 36TH ST	MILWAUKEE, WI 53215
CURRENT OCCUPANT	2235 S 36TH ST	MILWAUKEE, WI 53215
CURRENT OCCUPANT	2235A S 36TH ST	MILWAUKEE, WI 53215
CURRENT OCCUPANT	2228 S 36TH ST	MILWAUKEE, WI 53215
CURRENT OCCUPANT	2228A S 36TH ST	MILWAUKEE, WI 53215
CURRENT OCCUPANT	2254 S 36TH ST	MILWAUKEE, WI 53215
CURRENT OCCUPANT	3602 W LINCOLN AVE	MILWAUKEE, WI 53215
CURRENT OCCUPANT	2254A S 36TH ST	MILWAUKEE, WI 53215
CURRENT OCCUPANT	2248A S 36TH ST	MILWAUKEE, WI 53215
CURRENT OCCUPANT	2239 S 35TH ST	MILWAUKEE, WI 53215
CURRENT OCCUPANT	2232 S 36TH ST	MILWAUKEE, WI 53215
CURRENT OCCUPANT	2233 S 35TH ST	MILWAUKEE, WI 53215
CURRENT OCCUPANT	2229A S 35TH ST	MILWAUKEE, WI 53215
CURRENT OCCUPANT	2249 S 35TH ST	MILWAUKEE, WI 53215
CURRENT OCCUPANT	2244 S 36TH ST	MILWAUKEE, WI 53215
CURRENT OCCUPANT	2239A S 35TH ST	MILWAUKEE, WI 53215
CURRENT OCCUPANT	2255 S 36TH ST	MILWAUKEE, WI 53215
CURRENT OCCUPANT	2229 S 36TH ST	MILWAUKEE, WI 53215

Total Records: 33

Radius: 250.0 feet and Center of Circle: 3530-34 W Lincoln Ave



# BUSINESS LICENSE PLAN OF OPERATION

ccl-busplan 3/15/18

Office of the City Clerk License Division  
200 E. Wells St. Room 105, Milwaukee, WI 53202  
(414) 286-2238 www.milwaukee.gov/license e-mail address: license@milwaukee.gov

## 1. Type of Business

Applying for:  Extended Hours (12AM to 5AM) - If a food establishment, check all that apply:  Delivery  Drive Thru  Dining Room  
 Self Service Laundry  Massage Establishment  Filling Station **FOOD DELIV, TOBACCO, CLASS A BEER**  
 Other (supplemental application for specific license also required) **CLASS A LIQUOR GROCERY STORE**

Provide a detailed description of the type of business you plan on operating:

**GROCERY STORE**

Do you have any experience operating this type of business?  No  Yes If yes, explain: **GAS STATION**

## 2. Business Operations

- a. Proposed Opening Date: **NOV 30 2020**
- b. Is this premise under construction?  No  Yes If yes, list estimated completion date: \_\_\_\_\_
- c. Is this a franchise?  No  Yes
- d. Is this premises currently licensed?  No  Yes If yes, list type of license: \_\_\_\_\_
- e. Is the current licensee operating?  No  Yes If no, list date closed: \_\_\_\_\_
- f. Do you have future plans for other businesses, licenses or permits at this location?  No  Yes  
If yes, explain: \_\_\_\_\_
- g. Have you previously held an Extended Hours License in Milwaukee?  No  Yes  
If yes, list address(es): \_\_\_\_\_
- h. Are other businesses operating in the same building?  No  Yes If yes, describe: \_\_\_\_\_

## 3. Litter & Noise

- a. How are grounds kept clean?  Sweep  Pressure Wash  Pick Up Litter  Other: \_\_\_\_\_
- b. How often will grounds be cleaned?  Daily  Weekly  As Needed  Monthly  Other: \_\_\_\_\_
- c. Grounds cleaned by:  Licensee  Building Owner  Employees  Hired Maintenance  Other: \_\_\_\_\_
- d. How are noise issues prevented and/or addressed?  Security  Manager approaches customer(s)  Call Police  
 Signs Posted  Other: \_\_\_\_\_
- e. Will a sound amplification system be used?  No  Yes If yes, describe: \_\_\_\_\_

## 4. Smoking & Sanitation

- a. Are there designated outdoor smoking areas?  No  Yes If yes, describe: \_\_\_\_\_
- b. Number of Garbage Cans: Inside: **3** Locations: **UNDER NEED COUNTER AND INSIDE COUNTER**  
Outside: **1** Locations: **By the DOOR AND BY THE DOOR**
- c. Is a crowd control barrier used?  No  Yes If yes, describe: \_\_\_\_\_
- d. How many restrooms are on the premises? **1**
- e. Name of solid waste contractor:  Advanced Disposal  Waste Management  Other: \_\_\_\_\_



## 5. Security

- a. Are there onsite parking spaces?  No  Yes If yes, how many? 4 and describe the parking security plan: CAMERA, LIGHTING
- b. Is there a loading zone?  No  Yes If yes, describe the loading area security plan: \_\_\_\_\_
- c. Will you have security personnel on premise?  No  Yes If yes, how many? \_\_\_\_\_ and answer the following:  
 What are their responsibilities? \_\_\_\_\_  
 Is security equipment used?  No  Yes If yes, describe SECURITY CAMERA INSIDE BLDG AND OUTSIDE  
 List their licensing, certification, or training credentials \_\_\_\_\_
- d. Will there be security cameras?  No  Yes If yes, how many? 10 and list locations: INSIDE BLDG AND OUTSIDE PARKING LOT AND BLDG
- e. Will searches/identification checks be done upon entry?  No  Yes If yes, describe \_\_\_\_\_

## 6. Percentage of Sales (must total 100%)

Alcohol <u>40</u> %	Food <u>40</u> %	Secondhand Merchandise _____ %	Precious Metals & Gems _____ %
Entertainment _____ %	Cigarettes <u>20</u> %	Personal Services (such as tattoo, body piercing, salon, tailor, tanning, etc.) _____ %	Other _____ %
Pawnbroker Activity _____ %	Salvaged Materials _____ % (such as scrap metal)	Describe: _____	

## 7. Businesses/Licenses on the Premises (check all that apply):

### Type 1

- Full Service Restaurant       Cafe/Coffee Shop       Deli or Fast Food Restaurant       Private/Fraternal/Veterans Club
- Night Club       Tavern       Cocktail Lounge       Teen Club
- Banquet Hall       Sports Facility       Bowling Alley
- Hotel/Motel: Number of Floors: \_\_\_\_\_       Rooming House: Number of Floors: \_\_\_\_\_  
 Number of Rooms: \_\_\_\_\_      Number of Rooms: \_\_\_\_\_

### Type 2

- Liquor Store       Corner Store       Supermarket       Convenience Store
- Gas Station       Amusement/Phonograph Distributor       Recycling, Salvage or Towing
- Used Car Dealer       Personal Service Establishment  
(such as tattoo business, hair salon, tailor, etc.)       Recording Studio

What other licenses/permits will you hold at this location? (check all that apply)

- Occupancy Permit       Cigarette & Tobacco       Gas Station       Extended Hours       Class "B" Tavern       Weights & Measures
- Secondhand Dealer       Precious Metal & Gem       Other: FOOD, TOBACCO, LOTTERY

## 8. Legal Capacity (only if a Type 1 premises in #7 above)

Capacity \_\_\_\_\_ (Call the Milwaukee Development Center at 414-286-8211 if you have questions.)

## 9. Premises Description

- a. Identify all area(s) of the premises that will be used in operating this business (include areas used only for storage):  
 1<sup>st</sup> Floor  2<sup>nd</sup> Floor  Basement Storage  Patio  Beer Garden  Sidewalk Café  Deck  Rooftop  
 Other: Describe: \_\_\_\_\_
- b. Describe Location:  Major Thoroughfare  Secondary Street  Other: LINCOLN AVE 36 St
- c. Nearest Major Cross Street: LINCOLN AVE
- d. Describe Building:  Free Standing Building  Strip Mall  Other: \_\_\_\_\_
- e. Describe Premises Structure:  Single Story  Multi-Story - # of Stories \_\_\_\_\_  Other: \_\_\_\_\_
- f. Describe Surrounding Area:  Commercial  Residential  Industrial  Other: \_\_\_\_\_
- g. Building Owner Name: (BUYER) LINCOLN MARKET INC. Phone Number: 614-688-2747  
 Business Owner Address: 3510 W. LINCOLN AVE

## 10. Hours of Operation & Customers

Will customers be entering the premises?  No  Yes

Day of the Week	Proposed Hours of Operation:		Estimated Number of Customers expected each day	Potential Age Range of Customers	Class B Tavern Applicant Only: Age Restriction (If none, write 'None')
	Open Time (include a.m. or p.m.)	Close Time (include a.m. or p.m.)			
Sunday	8 AM	10 PM	300	30	
Monday	8 AM	10 PM	400	30	
Tuesday	8 AM	10 PM	400	30	
Wednesday	8 AM	10 PM	400	30	
Thursday	8 AM	10 PM	400	30	
Friday	8 AM	10 PM	500	30	
Saturday	8 AM	10 PM	500	30	

An Extended Hours Establishment License is required for any convenience store, filling station, personal service establishment (such as tattoo, body piercing, salon, tailor, tanning, etc.), recording studio or restaurant which is open between the hours of 12:00 a.m. and 5:00 a.m.

Alcohol Establishments Permitted Hours of Operation: Class A: 8:00 am to 9:00 pm Sunday thru Saturday  
 Class B: 6:00 am to 2:00 am Sunday thru Thursday, 6:00 am to 2:30 am Friday & Saturday

Entertainment Outdoor Closing Hours: 10:00pm Sunday-Thursday; 12:00am Friday & Saturday; unless a different time, either earlier or later, is established by the Common Council in its approval of the licensee's plan of operation.

## 11. Signature(s)

  
 \_\_\_\_\_  
 Signature of Sole Proprietor, Partner, or 20% or more Shareholder  
 (If there are no 20% or more shareholders,  
 Corporate Officer-print name/title and sign)

\_\_\_\_\_  
 Signature of additional partner or 20% or more shareholder

See Application Information for a complete list of all required application forms.



# ALCOHOL BEVERAGE & PUBLIC ENTERTAINMENT PREMISES SUPPLEMENTAL APPLICATION

Office of the City Clerk License Division  
200 E. Wells St. Room 105, Milwaukee, WI 53202  
(414) 286-2238. e-mail address: license@milwaukee.gov [www.milwaukee.gov/license](http://www.milwaukee.gov/license)

Legal Entity Name: LINCOLN MARKET INC

Premise Address: 3530 W. LINCOLN AVE

### Proximity of Premises to Church, School, Daycare Center or Hospital

Is the building within 300 feet of any church, school, daycare center or hospital?  No  Yes

### "Service Bar Only" Designation

If applying for Class B or C license, are you applying for "Service Bar Only"?  No  Yes  
Service Bar Only means customers cannot sit at the bar. Alcohol is served to employees who serve patrons seated at tables. No stools, chairs or other articles of furniture shall be placed at the service bar for patrons to sit upon.

### Business Information

a) Are you taking out this application for anyone that may not be eligible for a license?  No  Yes  
If yes, list their name and address: \_\_\_\_\_

b) Will the agent, a partner or the individual licensee be conducting the day-to-day operations of the business?  No  Yes  
If no, list the name and address of the person(s) who will: \_\_\_\_\_  
\_\_\_\_\_

Class B Applicants: If the agent, a partner or the individual licensee will not be conducting the day-to-day operations of the business, the person(s) listed above must obtain a Class B Managers license.

c) Does anyone else have money invested or any other interest in this business?  No  Yes  
If yes, explain: \_\_\_\_\_

d) Have you made an agreement with anyone to repay any loan or any other payments based upon income from the business?  
 No  Yes If yes, list name and address: \_\_\_\_\_

### Proof of Ownership, Lease, or Offer to Purchase (New & Transfer Applicants Only)

Submit proof of ownership, lease, or offer to purchase the building with this application.  
A lease or offer to purchase must:

- a) Be in the same legal entity name as that apply for the license
- b) Reflect the same address as the premises address on this application
- c) Reflect current dates and
- d) Be signed by the lessor/seller and lessee/buyer

### Property Information (New & Transfer Applicants Only)

a) Do you own or lease the building?  Own  Lease

b) Who owns the fixtures (for example, coolers, etc.)? LINCOLN MARKET INC

c) Are you purchasing the stock and/or fixtures?  No  Yes If yes, amount paid \$ 0

d) Total amount paid for business \$ 0

e) Total amount paid for goodwill of the business \$ 0

Goodwill comprises the reputation and customer relationships of an existing business. If the price you pay for the business exceeds the fair market value of all of the rest of the assets of the business, the excess may be considered goodwill.

f) Have you made arrangements with the seller for payment of personal property taxes?  No  Yes

**See Application Information for a list of all required application forms.**

**Lease Information (New & Transfer Applicants who are leasing the premises only)**

- a) Date lease begins \_\_\_\_\_ Ends \_\_\_\_\_
- b) Monthly rental \$ \_\_\_\_\_
- c) Do you have an option to renew the lease?  No  Yes
- d) Does your lease allow for assignment to another party without the consent of the owner?  No  Yes
- e) For what length of time have you been guaranteed occupancy (number of years)? \_\_\_\_\_
- f) In addition to paying the monthly rental, will you have to pay anything additional to the owner of the building to guarantee performance of the lease?  No  Yes If yes, explain \_\_\_\_\_
- g) Does the present owner or occupancy object to the granting of your license?  No  Yes  
If yes, explain \_\_\_\_\_

**Change of Agent Applicants Only**

Have there been any changes to the floor plan since the last application was submitted?  No  Yes  
If no, a new floor plan is not required. If yes, submit a new floor plan and explain the change(s): \_\_\_\_\_

**Signature**



Signature of Sole Proprietor, Partner or 20% or More Shareholder  
(If no 20% or more Shareholder, Corporate Officer - print name/title and sign)

Note: All information contained in this application is subject to approval by the Common Council.  
Deviating from approved plan of operation will subject licensee to citations, and/or suspension or non-renewal of the license.  
Contact the License Division for information on how to request changes.

**New and transfer of premises applicants must submit the following:**

- Proof of ownership, lease or offer to purchase the building
- Detailed floor plan
- If a restaurant, copy of the menu



# FOOD DEALER LICENSE PLAN OF OPERATION

ccl-foodplan 2/28/19

OFFICE OF THE CITY CLERK, LICENSE DIVISION  
CITY HALL, 200 E. WELLS ST, ROOM 105, MILWAUKEE, WI 53202  
(414) 286-2238 • [license@milwaukee.gov](mailto:license@milwaukee.gov) • [www.milwaukee.gov/license](http://www.milwaukee.gov/license)

Legal Entity Name: LINCOLN MARKET INC

Premises Address: 3530 W. LINCOLN AVE

## SECTION 1 TYPE OF BUSINESS

What will be the majority of your food sales? (check one)

Restaurant Items (meals):  
MEALS include, but are not limited to, chicken, ribs, sandwiches, roasted corn, baked potatoes, hot dogs, brats, tacos, nachos w/ cheese and meat, French fries, cooked or deep fried vegetables/fruit, cooked cheese curds, corn dogs, egg rolls, salads.

Retail Items (snacks and beverages):  
RETAIL items include, but are not limited to, ice cream/soft serve, lemonade, snow cones, coffee, espresso, cappuccino, tea, fruit juice, smoothies, candy, dispensed soda, fruit cups, bakery, cookies, kettle corn, cotton candy, funnel cakes, fritters, tortilla chips w/ cheese.

Will it be a convenience store?  Yes  No

A convenience store contains less than 5,000 square feet of retail space and has, as its primary business, the sale of basic food items and in addition, sells household products or is a filling station that sells basic food items and household products.

Bed & Breakfast  
 Micro Market

All Applicants: Submit a menu or a list of food items that will be sold.

Will any wholesale business be done?  No  Yes If yes, what percentage of food sales will be wholesale?

Less than 25%

25% or More AND:

Restaurant items (meals) will be sold – Complete this application and also contact DATCP.

NO restaurant items (meals) will be sold - Do NOT complete this application. Contact DATCP only.

## SECTION 2 FOOD PROCESSING

Will any food processing be done?  No  Yes

Processing is defined as assembling, grinding, cutting, mixing, baking, coating, stuffing, packing, bottling, grilling, canning, extracting, fermenting, distilling, pickling, freezing, drying, smoking, or packaging.

## SECTION 3 FOOD REQUIRING TEMPERATURE CONTROL

Will any food that requires temperature control be sold?  No  Yes  
(includes dairy products such as milk, cheese, and ice cream, fish, shellfish, meat, poultry)

If yes, list the types of food items: Milk Cheese

**SECTION 4 DETAILS OF OPERATION**

Will you have seating on site for dining?  No  Yes

Will you be doing any catering?  No  Yes

Will you be doing any delivery?  No  Yes

Will you have outdoor activities?  No  Yes - Check all that apply:  Bar  Cooking/Grilling  Dining

Will you have a drive thru window?  No  Yes - Are hours different from inside?  No  Yes  
If Yes, provide drive thru hours: \_\_\_\_\_

Will scales or barcode scanners be used?  No  Yes - You must also apply for a Weights & Measures License.

**SECTION 5 ADDITIONAL SITES**

Where will food be prepared and/or sold?

At a single site  At multiple sites: How many? \_\_\_\_\_ (for example, a hotel with several dining rooms or bars)

If multiple sites, attach a Food Dealer Additional Site Addendum (ccl-foodadd) for each additional site.

**SECTION 6 CONSTRUCTION OR CHANGES**

Are you planning any construction, remodeling or equipment changes?

No If No, SKIP to Section 8

Yes If Yes, check all that apply:  New construction of a building  Renovation or remodeling  
 Construction changes to existing building  Equipment changes only

Provide a brief description of the changes: NEW CONSTRUCTION

Start date: JUNE 2020

Name, Address & Phone Number of Architect: LUIS BARBOSA - 414-324-2818  
503 W LINCOLN AVE MILWAUKEE WI 53207

Name, Address & Phone Number of Contractor: \_\_\_\_\_

**SECTION 7 ALCOHOL BEVERAGES**

Are you applying for an alcohol beverage license?

No If No, SKIP to Section 8

Yes If YES, if your food license is approved prior to the alcohol license, when do you want the food license issued?  
 Immediately  At the same time as the alcohol license

**SECTION 8 ACKNOWLEDGEMENTS & SIGNATURE**

You must initial each item confirming your understanding:

- YES I understand the Health Department must conduct an inspection and advise the License Division of their approval before the license may be issued.
- YES I understand I must obtain an occupancy permit from the Department of Neighborhood Services and an inspection may be required. Neighborhood Services must advise the License Division of their approval before the license may be issued.
- YES I understand the district alderperson will review and either support or object to my application. If he/she objects, I may appeal and be scheduled to appear before the Licenses Committee. The Licenses Committee will then make a recommendation to the Common Council. The Common Council must grant the license before it may be issued.
- YES I understand proof of payment for all license fees must be on file in the License Division before the license may be issued and the license must be issued and posted in my establishment prior to opening for business.
- YES I will not operate my food business until the license has been issued and posted in the establishment.

Signature of Sole Proprietor, Partner, or 20% Shareholder: \_\_\_\_\_ 

Signature of Additional Partner: \_\_\_\_\_

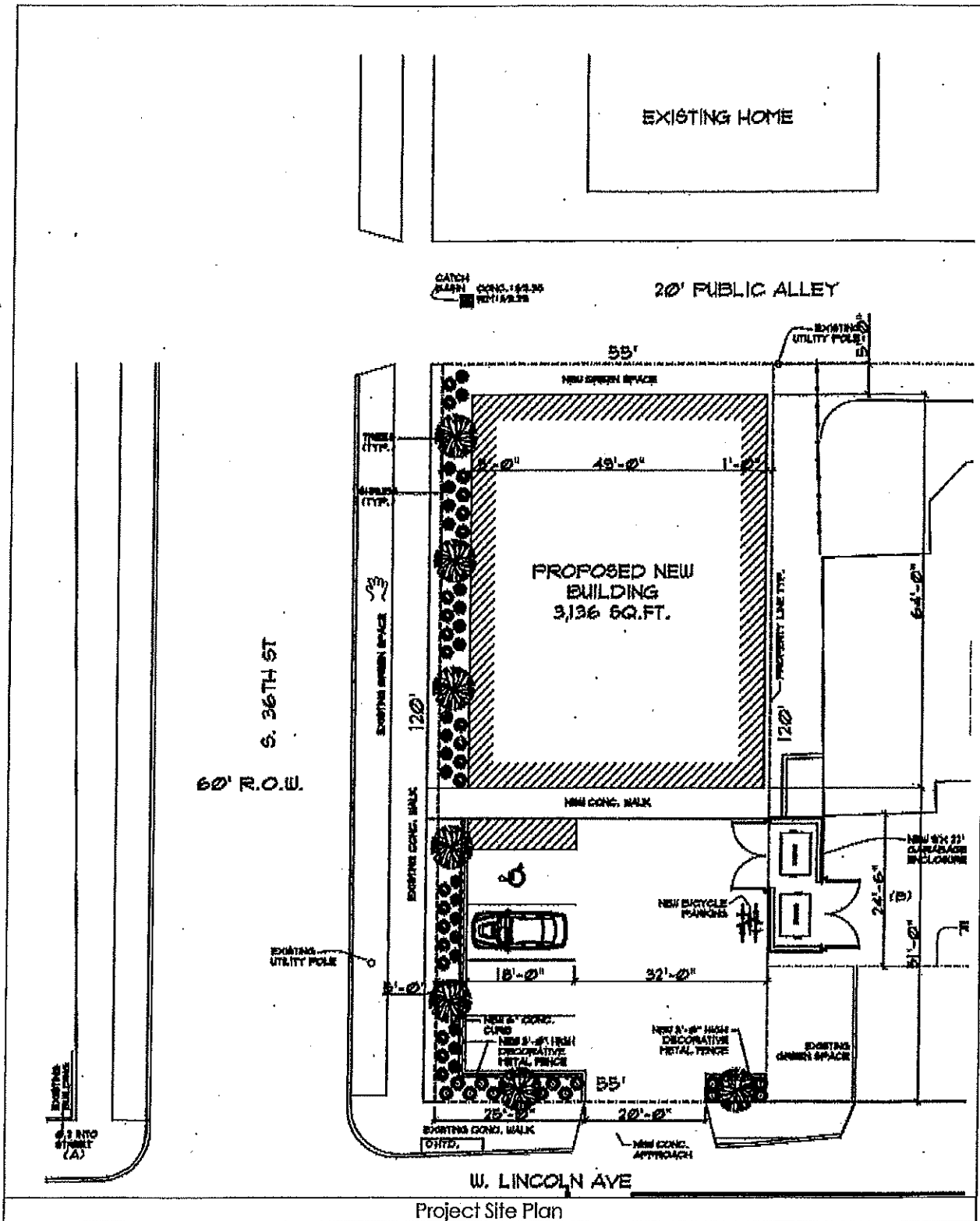

**PROPOSED DEVELOPMENT**

Development of a vacant lot with a one-story, commercial space to house a grocery store. Project costs are estimated at \$300,000. The project will be financed with the Buyer's equity and private financing. BMR Design Group are the designers of the project.

TRADE NAME  
 LINCOLN MARKET INC  
 3550 W. LINCOLN AVE  
 MILWAUKEE  
 WI 53215

CATCH  
 CONC: 49.39  
 PLAN  
 INT: 49.29

JAN. 17. 2020

20' PUBLIC ALLEY

AGENT  
 MANDIEP DYKMAN

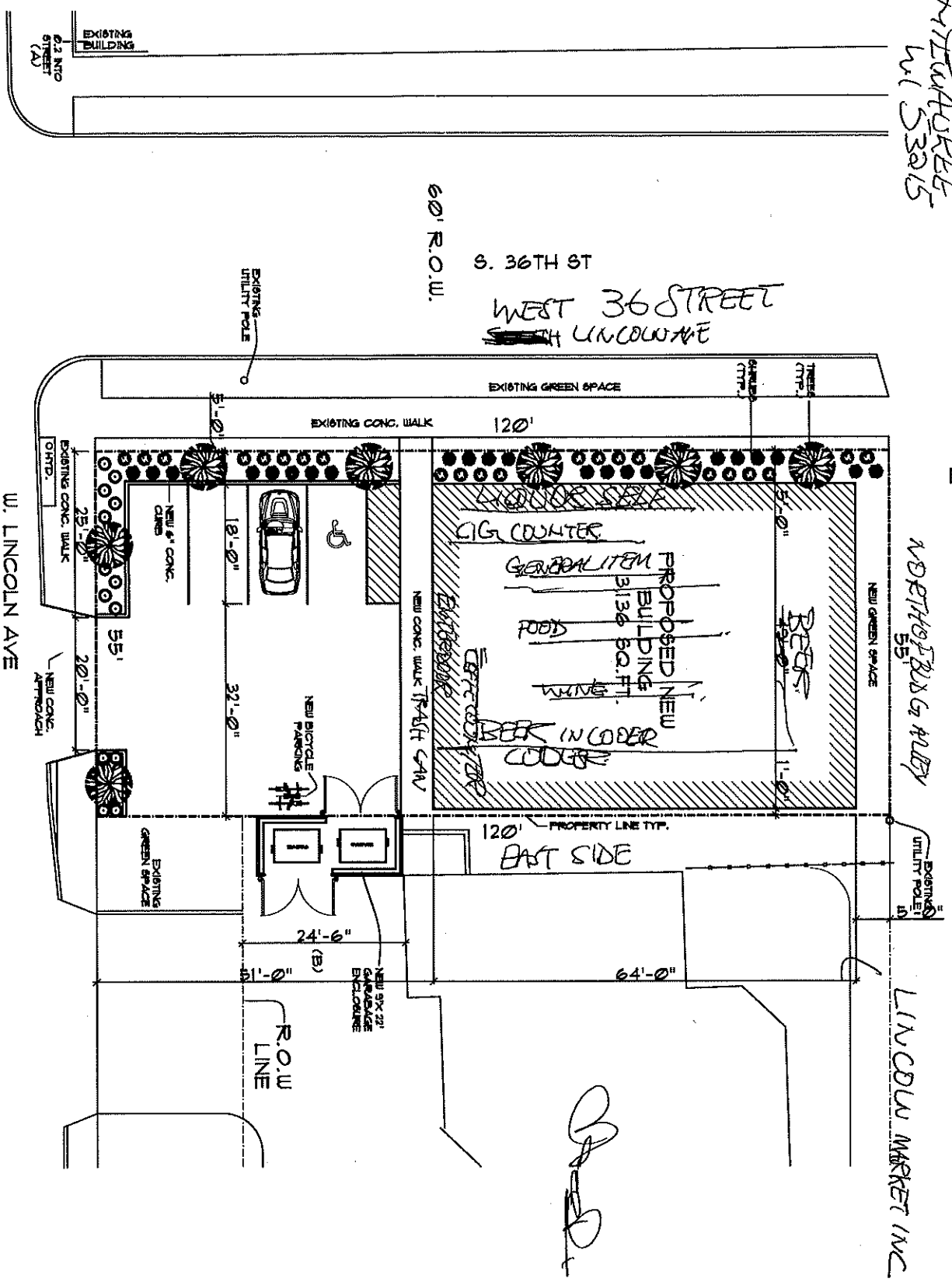

1 New Site Plan  
 C2 SCALE: N.T.S. AREA: 6600 SQ. FT.

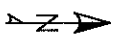

**BMR**  
 DESIGN GROUP, INC.  
 Architects - Engineers  
 503 West Lincoln Avenue  
 Milwaukee, Wisconsin 53207  
 Phone - (414) 384-2996  
 Fax - (414) 384-3904

PROJECT  
 Proposed New Grocery  
 Store  
 3550 W. Lincoln Ave,  
 Milwaukee, WI

Owner:  
 LINCOLN MARKET INC

PROJECT NO. 2019-45

DATE 01/17/2020

REVISIONS

NO.	DESCRIPTION

CHECKED BY I.B.

DRAWN BY J.C.O.A.

SCALE as noted

SHEET NO. C2





CITY OF MILWAUKEE  
OFFICE OF THE CITY CLERK

Friday, February 28, 2020

COMMITTEE MEETING NOTICE

AD 08

GOMEZ VEGA, Monica, Agent  
Chispita's Store LLC  
2000 W LINCOLN Av

Milwaukee, WI 53215

You are requested to attend a hearing which is to be held in Room 301-B, Third Floor, City Hall on:

**Tuesday, March 10, 2020 at 09:15 AM**

**Regarding:** Your Class A Malt & Class A Liquor, Food Dealer, and Weights & Measures License Applications as agent for "Chispita's Store LLC" for "Jalisco's Supermarket" 2000 W LINCOLN Av.

There is a possibility that your application may be denied for one or more of the following reasons: The recommendation of the committee regarding the application shall be based on evidence presented at the hearing. Per MCO 85-2.7-4, probative evidence concerning whether or not a new license should be granted may be presented on the following subjects: whether or not the applicant meets the municipal requirements, the appropriateness of the location and premises where the licensed premises is to be located and whether use of the premises for the purposes or activities permitted by the license would tend to facilitate a public or private nuisance or create undesirable neighborhood problems such as disorderly patrons, unreasonably loud noise, litter, and excessive traffic and parking congestion. Probative evidence relating to these matters may be taken from the plan of operation submitted with the license application, if any, but shall not include the content of any music. Evidence regarding the fitness of the location of the premises to be maintained as the principal place of business, including but not limited to whether there is an overconcentration of businesses of the type for which the license is sought; whether the proposal is consistent with any pertinent neighborhood business or development plans, or the location's proximity to areas where children are typically present. The applicant's record in operating similarly licensed premises; and whether or not the applicant has been charged with or convicted of any felony, misdemeanor, municipal offense or other offense, the circumstances of which substantially relate to the activity to be permitted by the license being applied for or any other factor which reasonably relates to the public health, safety or welfare may also be considered. See attached police report or correspondence.

**Notice for applicants with warrants or unpaid fines:** Proof of warrant satisfaction or payment of fines must be submitted at the hearing on the above date and time. Failure to comply with this requirement may result in a delay of the granting/denial of your application.

Failure to appear at this meeting may result in the denial of your license. Individual applicants must appear only in person or by an attorney. Corporate or Limited Liability applicants must appear only by the agent designated on the application or by an attorney. Partnership applicants must appear by a partner listed on the application or by an attorney. If you wish to do so and at your own expense, you may be accompanied by an attorney of your choosing to represent you at this hearing.

You will be given an opportunity to speak on behalf of the application and to respond and challenge any charges or reasons given for the denial. No petitions can be accepted by the committee, unless the people who signed the petition are present at the committee hearing and willing to testify. You may present witnesses under oath and you may also confront and cross-examine opposing witnesses under oath. If you have difficulty with the English language, you should bring an interpreter with you, at your expense, so that you can answer questions and participate in your hearing.

You may examine the application file at this office during regular business hours prior to the hearing date. Inquiries regarding this matter may be directed to the person whose signature appears below.

Limited parking for persons attending meetings in City Hall is available at reduced rates (5 hour limit) at the Milwaukee Center on the southwest corner of East Kilbourn and North Water Street. Parking tickets must be validated in the first floor information booth in City Hall.

PLEASE NOTE: Upon reasonable notice, efforts will be made to accommodate the needs of disabled individuals through sign language interpreters or other auxiliary aids. For additional information or to request this service, contact the Council Services Division ADA Coordinator at (414) 286-2998, Fax - (414) 286-3456, TDD - (414) 286-2025.

JIM OWCZARSKI, CITY CLERK

BY: \_\_\_\_\_

Jessica Celella  
License Division Manager

If you have questions regarding this notice, please contact the License Division at (414) 286-2238.

200 E. Wells Street, Room 105, City Hall, Milwaukee, WI 53202. [www.milwaukee.gov/license](http://www.milwaukee.gov/license)  
Phone: (414) 286-2238 Fax: (414) 286-3057 Email Address: [License@milwaukee.gov](mailto:License@milwaukee.gov)



CITY OF MILWAUKEE  
OFFICE OF THE CITY CLERK

Friday, February 28, 2020

COMMITTEE MEETING NOTICE

AD 08

GOMEZ VEGA, Monica, Agent  
Chispita's Store LLC  
3021 W Pierce St Upper

Milwaukee, WI 53215

You are requested to attend a hearing which is to be held in Room 301-B, Third Floor, City Hall on:

**Tuesday, March 10, 2020 at 09:15 AM**

**Regarding:** Your Class A Malt & Class A Liquor, Food Dealer, and Weights & Measures License Applications as agent for "Chispita's Store LLC" for "Jalisco's Supermarket" at 2000 W LINCOLN Av.

There is a possibility that your application may be denied for one or more of the following reasons: The recommendation of the committee regarding the application shall be based on evidence presented at the hearing. Per MCO 85-2.7-4, probative evidence concerning whether or not a new license should be granted may be presented on the following subjects: whether or not the applicant meets the municipal requirements, the appropriateness of the location and premises where the licensed premises is to be located and whether use of the premises for the purposes or activities permitted by the license would tend to facilitate a public or private nuisance or create undesirable neighborhood problems such as disorderly patrons, unreasonably loud noise, litter, and excessive traffic and parking congestion. Probative evidence relating to these matters may be taken from the plan of operation submitted with the license application, if any, but shall not include the content of any music. Evidence regarding the fitness of the location of the premises to be maintained as the principal place of business, including but not limited to whether there is an overconcentration of businesses of the type for which the license is sought; whether the proposal is consistent with any pertinent neighborhood business or development plans, or the location's proximity to areas where children are typically present. The applicant's record in operating similarly licensed premises; and whether or not the applicant has been charged with or convicted of any felony, misdemeanor, municipal offense or other offense, the circumstances of which substantially relate to the activity to be permitted by the license being applied for or any other factor which reasonably relates to the public health, safety or welfare may also be considered. See attached police report or correspondence.

**Notice for applicants with warrants or unpaid fines:** Proof of warrant satisfaction or payment of fines must be submitted at the hearing on the above date and time. Failure to comply with this requirement may result in a delay of the granting/denial of your application.

Failure to appear at this meeting may result in the denial of your license. Individual applicants must appear only in person or by an attorney. Corporate or Limited Liability applicants must appear only by the agent designated on the application or by an attorney. Partnership applicants must appear by a partner listed on the application or by an attorney. If you wish to do so and at your own expense, you may be accompanied by an attorney of your choosing to represent you at this hearing.

You will be given an opportunity to speak on behalf of the application and to respond and challenge any charges or reasons given for the denial. No petitions can be accepted by the committee, unless the people who signed the petition are present at the committee hearing and willing to testify. You may present witnesses under oath and you may also confront and cross-examine opposing witnesses under oath. If you have difficulty with the English language, you should bring an interpreter with you, at your expense, so that you can answer questions and participate in your hearing.

You may examine the application file at this office during regular business hours prior to the hearing date. Inquiries regarding this matter may be directed to the person whose signature appears below.

Limited parking for persons attending meetings in City Hall is available at reduced rates (5 hour limit) at the Milwaukee Center on the southwest corner of East Kilbourn and North Water Street. Parking tickets must be validated in the first floor information booth in City Hall.

PLEASE NOTE: Upon reasonable notice, efforts will be made to accommodate the needs of disabled individuals through sign language interpreters or other auxiliary aids. For additional information or to request this service, contact the Council Services Division ADA Coordinator at (414) 286-2998, Fax - (414) 286-3456, TDD - (414) 286-2025.

JIM OWCZARSKI, CITY CLERK

BY: \_\_\_\_\_

Jessica Ceella

License Division Manager

If you have questions regarding this notice, please contact the License Division at (414) 286-2238.

200 E. Wells Street, Room 105, City Hall, Milwaukee, WI 53202. [www.milwaukee.gov/license](http://www.milwaukee.gov/license)  
Phone: (414) 286-2238 Fax: (414) 286-3057 Email Address: [License@milwaukee.gov](mailto:License@milwaukee.gov)

Date:12/20/19  
Officer: VODICKA

City of Milwaukee Police Department  
90-5-1.5 Crime Prevention Survey  
Convenience Store/Liquor Store Inspection

Name of Premise: Jalisco's Super Market  
Address: 2000 W Lincoln Av  
Phone: 414-385-0996

Owner: Monica VEGA-GOMEZ  
Owner address: 3021 W Pierce St  
City State Zip: Milwaukee, WI 53215  
Owner Phone: 414-531-9587  
Owner email: GomezHT19@gmail.com

Manager:  
Home Address:  
City State Zip:  
Phone:  
Email:

Preferred contact: 414-531-9587

Location currently open:  YES  NO

Projected open date:

Day's open: S M T W Th F SA ALL

Hours of Operation: Sun: 9:00 am - 9:00 pm 24 hours Y N  
Mon: "  
Tue: "  
Wed: "  
Thu: "  
Fri: "  
Sat: "

Premise Type: Liquor Store  
Convenience Store  
Other:

Licenses currently held:

- Alcohol:  Yes  No Class: A Malt #: 199140
- Tobacco:  Yes  No #: CIG 1028397
- Food:  Yes  No #: FOOD 9980
- Extended Hours:  Yes  No #:
- Secondhand Dealer:  Yes  No Type: #:
- Other:  Yes  No Type: W&M #: 5158
- Other:  Yes  No Type: #:

**Exterior Survey:**

1. Is the area around the location clean?  Yes  No
2. What surrounds the location? (Check all the apply)
  - a.  Park
  - b.  School
  - c.  Youth Center
  - d.  Church
  - e.  Tavern(s) If so, how many 2
  - f.  Residential
  - g.  Other businesses
  - h.  Other:
3. Can you see from the outside of the location into the interior  Yes  No
4. Can you see the employees inside of the location from the outside  Yes  No
5. Are exterior windows free of signage  Yes  No
6. Is there a parking lot  Yes  No
7. Is the parking lot clean?  Yes  No
8. Is the parking lot well lit?  Yes  No
9. Are there areas where a person could conceal themselves  Yes  No
10. Is there exterior lighting?  Yes  No. Does it appear to be adequate  Yes  No
11. Exterior Payphone?  Yes  No
12. Are there No Loitering Signs posted?  Yes  No
13. Are there exterior security cameras  Yes  No How Many: 2
14. Are the address numbers prominently displayed and easy to see  Yes  No

**Camera Survey:**

15. Does this location have security cameras?  Yes  No
16. Are they in working order?  Yes  No
17. What format are the cameras?
  - a. Color  Yes  No
  - b. Digital  Yes  No
  - c. VCR  Yes  No
  - d. Recorded  Yes  No
18. How long is footage stored for later viewing: 1 week
19. Are there exterior cameras  Yes  No How many: 2
20. Are there interior cameras  Yes  No How many: 6
21. Do all employees know how to retrieve recorded digital images/footage?  Yes  No

**Interior Survey:**

22. Is the storeowner willing to be a standing complainant regarding loitering?  Yes  No  
a. If yes have them fill out the standing complaint form and give them two of the commercial signs  Yes  No
23. Is the interior of the location neat and clean?  Yes  No
24. Does an interior camera face the entrance/exit?  Yes  No
25. Is there a lockable area that separates employees from customers?  Yes  No
26. Does the store sell single chore boy?  Yes  No
27. Does the store sell blunt wraps?  Yes  No
28. Does the store sell scales?  Yes  No
29. Does the store sell items that may be used as crack pipes?  Yes  No  
a. Describe item
30. Does the store have an over abundance of sandwich baggies:  Yes  No
31. Does the owner understand that these items are often used for drug use?  Yes  No
32. Do the products in the store appear to be new and rotated often?  Yes  No
33. Are emergency and non-emergency numbers posted near the phone?  Yes  No
34. Does the owner know how to contact their police district directly?  Yes  No  
a. Did you provide a district contact guide to the owner?  Yes  No

**Complete this section if alcohol establishment is a convenience store:**

(\* Read full ordinance for all details "68-4.3 Convenience Food Stores")

All convenience food stores not exempted under sub. 3 shall:

1. Is the cash register located in a manner so that at the time of a sales transaction, the employee and customer are both visible from the sidewalk?  Yes  No \*\*
2. Are the glass entrance and exit doors clear of any signs or advertisements with the exception of a sign which states that the cash register contains \$50 or less and that the safe is no accessible to employees?  Yes  No
3. Does the store maintain one of the following on the licensed premise:
  - a. A safe that was in use at the convenience food store on August 17, 1994?  Yes  No
  - b. A drop-safe or time release safe that weighs at least 500 pounds or which is attached to or set into the floor in a manner approved by the police department?  Yes  No
4. Is lighting provided for the store's parking area during all hours of darkness when employees or customers are on the premises at a minimum average of 2-foot candles per square foot, unless the store is not open for business after sunset and before sunrise?  Yes  No  N/A
5. Are at least two high-resolution surveillance security cameras installed?  Yes  No
6. Are the security cameras in working order?  Yes  No
7. Does one camera show an overall view of the counter and register area?  Yes  No
8. Does one camera show a clear, identifiable, full frame image of the face of each person entering and leaving the store?  Yes  No
9. Are the camera views obstructed by fixtures or displays?  Yes  No
10. Is the recorded footage stored for at least 30 days?  Yes  No
11. Do all store employees know how to record footage from the camera system to media capable of being transferred to police custody?  Yes  No

12. Are customer entrances/exits made of glass or other transparent material?  Yes  No  
 a. Exception: A store that does not have such doors on August 17, 1994 shall not be required to install such doors until the holder of the store's food dealer license changes.
13. Has the owner and their employees attended the Robbery Prevention Training within 120 days of ownership or employment?  Yes  No  
 a. Contact Community Outreach and Education at 935-7836 for schedule.

**Sub 3. Exemptions.** The requirements of this section do not apply to a convenience food store that conforms to either of the following descriptions:

- a-1. The store is located in an enclosed shopping structure, enclosed commercial building or hospital. A convenience food store is not in an enclosed structure or building if a customer can enter it directly from the outside.  
 Does store conform to a-1  Yes  No
- a-2. The store physically separates employees from customers with a solid partition that bars a person from entering the employee area from the customer area, has a secure lock on the employee side of any door between the employee area and the customer, and conducts all transaction through a service window or similar arrangement.  
 Does store conform to a-2  Yes  No
- a. At the commissioner's discretion, a convenience store may be exempted from any or all of the regulations specified in sub 2.  
 Does this location hold an exemption from the commissioner regarding any of the requirements of Sub 2?  Yes  No

**ADDITIONAL COMMENTS/RECOMMENDATIONS:**

Store is currently using solid-wood emergency door as main entrance due to accident damage to main door. Main entrance will be replaced with glass or similar type door. Licensee does not know how to operate camera system but will learn. Cameras will be repositioned to cover temporary entrance until main entrance is repaired.  
 Premises is currently licensed/operated by applicant's sister.

# Alcohol Concentration for 2000 W Lincoln Av

City of Milwaukee, Wisconsin



## - Legend -

- Street names 10,000
- City limits
- Freeways 15,000
- Exit ramps
- Entry ramps
- Ramps
- Major streets 10,000
- Streets 10,000
- Waterways
- Milwaukee Parcels
- Alcohol licenses
  - Class A intoxicating liquor
  - Class A fermented malt beverage
  - Class A liquor and malt
  - Class B fermented malt beverage
  - Class B tavern
  - Class C wine retailer

## - Notes -

Alcohol Establishments within a .5 Mile Radius Centered on 2000 W Lincoln Av as of 11/20/2019



Department of Administration - ITMD

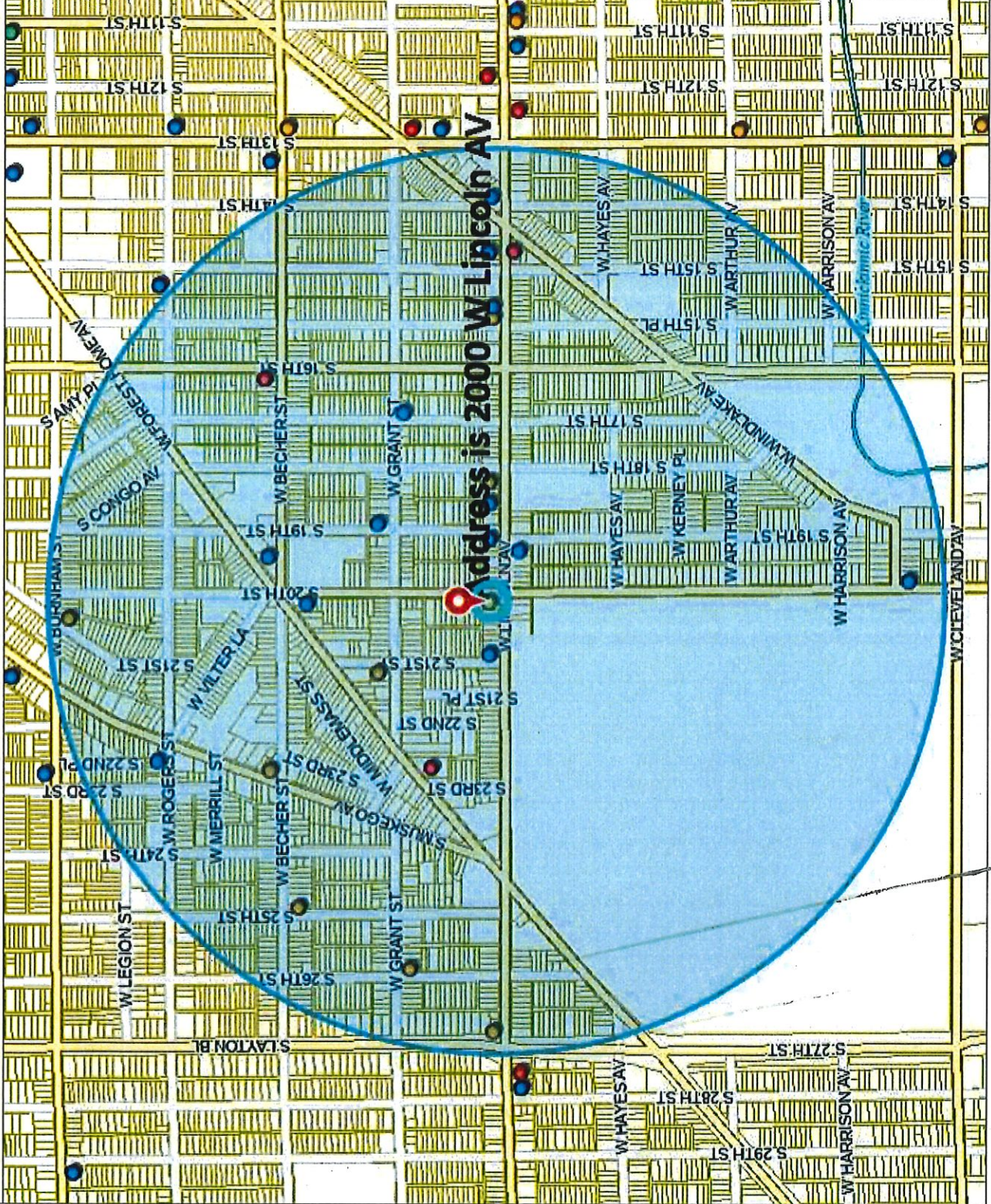

Map Scale: 1: 10,000

833.3  
0 416.67 833.3 Feet

Licensed Alcohol Beverage Establishments Within .5 Mile Radius centered on 2000 W Lincoln Av as of 11/20/19

Legal entity	Trade name	Licensee	Address	License type	License type name	Total capacity	Expiration date
YASMINE FOODS, LLC	LINCOLN SUPERMARKET	LOAI A. ATARI, Agt	1534 W LINCOLN AV	AMALT	Class A Fermented Malt Beverage Retailer's License		2019-12-11T00:00:00.0000000
Lincoln Express, Inc.	Express Pantry	PETTY BABBER, Agt	1804 W Lincoln AV	AMALT	Class A Fermented Malt Beverage Retailer's License		2020-05-04T00:00:00.0000000
Porullo, LLC	Jalisco's Super Market	Hilda Gomez, Agt	2000 W Lincoln AV	AMALT	Class A Fermented Malt Beverage Retailer's License		2020-06-02T00:00:00.0000000
Starlite Beer & Food, Inc.	Starlite Food	GURMUKH SINGH, Agt	2013 W Burnham ST	AMALT	Class A Fermented Malt Beverage Retailer's License		2020-04-21T00:00:00.0000000
MONA, LLC	Mona Grocery Store	JOSE S VIDRIO, Agt	2082 S MUSKEGO AV	AMALT	Class A Fermented Malt Beverage Retailer's License		2020-10-16T00:00:00.0000000
ABDELAL, LLC	GRANT MARKET	SAED F ABDELAL, Agt	2100 W GRANT ST	AMALT	Class A Fermented Malt Beverage Retailer's License		2020-05-14T00:00:00.0000000
Fanda, LLC	South Ave Foods	Thamer M Carcium, Agt	2108 S 25TH ST	AMALT	Class A Fermented Malt Beverage Retailer's License		2020-05-06T00:00:00.0000000
Treder KMK Inc	Supermarket La Veneacruzana	ERIC J TREDER, Agt	2539 W Grant ST	AMALT	Class A Fermented Malt Beverage Retailer's License		2019-12-17T00:00:00.0000000
Aanvind Food Mart, LLC	Lucky Food & Beer	LAKHWINDER KAUR, Agt	2638 W Lincoln AV	AMALT	Class A Fermented Malt Beverage Retailer's License		2020-02-04T00:00:00.0000000
KOTHALA, LLC	SOUTHSHORE BEER & LIQUOR	JASBIR S PANLU, Agt	1494 W WINDLAKE AV	ALQML	Class A Malt & Class A Liquor License		2019-11-28T00:00:00.0000000
Paul's Liquor LLC	Paul's Liquor	AGIAPAL SINGH, Agt	1600 W Becher ST	ALQML	Class A Malt & Class A Liquor License		2019-11-28T00:00:00.0000000
Seven Star Liquor LLC	Seven Star Liquor	JASJEET SINGH, Agt	1223 W Forest Home AV	ALQML	Class A Malt & Class A Liquor License		2020-07-26T00:00:00.0000000
3 HERMANOS, INC	3 Hermanos Club	RAMON OROZCO, Agt	1332 W LINCOLN AV	BTAVN	Class B Tavern License	163	2020-09-13T00:00:00.0000000
Kumbala Restaurant and Bar, LLC	Kumbala Restaurant and Bar, LLC	Vianey Cisneros Reyes, Agt	1428 W Lincoln AV	BTAVN	Class B Tavern License		2020-03-13T00:00:00.0000000
Kumbala Restaurant and Bar, LLC	Kumbala Restaurant and Bar, LLC	Vianey Cisneros Reyes, Agt	1428 W Lincoln AV	BTAVN	Class B Tavern License		2020-03-13T00:00:00.0000000
LA GUADALUPANA	LA GUADALUPANA	ANA M RAZO, SP	1520 W LINCOLN AV	BTAVN	Class B Tavern License		2020-01-16T00:00:00.0000000
PRIMOS PLACE	PRIMOS PLACE	ENRIQUE TERRONES, SP	1651 W GRANT ST	BTAVN	Class B Tavern License		2020-09-07T00:00:00.0000000
ANNA'S TAP	ANNA'S TAP	SAVANATHA E RITCHIE, SP	1838 W GRANT ST	BTAVN	Class B Tavern License	163	2020-06-30T00:00:00.0000000
Rococo Music LLC	El Sinaloense	JESUS MANCINAS-VILLARREAL, Agt	1900 W LINCOLN AV	BTAVN	Class B Tavern License	25	2020-06-30T00:00:00.0000000
Irene's Catering Service, Inc	Irene's Catering Service, Inc	Thomas E Revoliniski, Agt	1901 W Lincoln AV	BTAVN	Class B Tavern License	98	2019-11-13T00:00:00.0000000
PSR PETRO MART, LLC	JASSI'S PLACE	Martha Rojas, Agt	1983 W WINDLAKE AV	BTAVN	Class B Tavern License		2020-10-19T00:00:00.0000000
Forest Home Ave Chicken Palace LLC	Chicken Palace - Forest Home	Rosa Isela Real Perez, Agt	1983 W Forest Home AV	BTAVN	Class B Tavern License	71	2020-08-01T00:00:00.0000000
La Hamaca Bar LLC	La Hamaca Bar	Luis Lopez-Gonzalez, Agt	1993 S MUSKEGO AV	BTAVN	Class B Tavern License		2020-09-29T00:00:00.0000000
PROMOCIONES MEXICAS LLC	EL GRAN TSOCALLI	PALOMA NAVA, Agt	2011 W FOREST HOME AV	BTAVN	Class B Tavern License	282	2020-05-13T00:00:00.0000000
HOLLER HOUSE	HOLLER HOUSE	TODD C STUCKERT, SP	2042 W LINCOLN AV	BTAVN	Class B Tavern License		2020-05-30T00:00:00.0000000
HOLLER HOUSE	HOLLER HOUSE	NATALIA A RADICEVICH, Agt	518-522 W LINCOLN AV	BTAVN	Class B Tavern License	200	2020-09-23T00:00:00.0000000
OLD TOWN SERBIAN GOURMET RESTAURANT, LLC	OLD TOWN SERBIAN GOURMET RESTAURANT						
					Grand Total		
					Total		





Friday, February 28, 2020

## Licenses Committee Notice of Hearing

Javier Covarrubias  
1839 N Dousman Rd  
Oconomowoc, WI 53066

Date: 3/10/2020  
Time: 09:15 AM  
Location: Room 301-B, Third Floor, City Hall

The Licenses Committee will consider the following license application:

Class A Malt & Class A Liquor, Food Dealer, and Weights & Measures License  
Applications  
GOMEZ VEGA, Monica, Agent  
Jalisco's Supermarket at 2000 W LINCOLN Av

Please note this application may be recommended for denial based on fitness of the location due to concentration of alcohol beverage outlets in the area. If the application is denied for this reason, no other application for an alcohol beverage license for this location shall be recommended for approval by the Licenses Committee within three years of the date of denial unless the applicant has demonstrated a change of circumstances since the prior denial.

If you have any questions, please call (414) 286-2238.





Friday, February 28, 2020



# Notice of Public Hearing

---

GOMEZ VEGA, Monica, Agent  
Jalisco's Supermarket at 2000 W LINCOLN Av  
Class A Malt & Class A Liquor, Food Dealer, and Weights & Measures License Applications

**Tuesday, March 10, 2020 at 9:15 AM**

To whom it may concern:

The above application has been made by the above named applicant(s). This requires approval from the Licenses Committee and the Common Council of the City of Milwaukee. The hearing before the Licenses Committee will take place on 3/10/2020 at 9:15 AM, in Room 301-B, Third Floor, City Hall. If you wish, you may provide testimony at the hearing regarding the request; see below for further information. You are not required to attend the hearing. Once the Licenses Committee makes its recommendation, this recommendation is forwarded to the full Common Council for approval at its next regularly scheduled hearing. Please review the information below and if you have further questions regarding this process, please contact the License Division at (414) 286-2238.

---

## Important details for those wishing to provide information for the Licenses Committee to consider when making its recommendation:

1. The license application is scheduled to be heard at the above time. Due to other hearings running longer than scheduled, you may have to wait some time to provide your testimony.
2. You must appear in person and testify as to matters that you have personally experienced or seen. (You cannot provide testimony for your neighbor, parent or anyone else; this is considered hearsay and cannot be considered by the committee.)
3. No letters or petitions can be accepted by the committee (unless the person who wrote the letter or the persons who signed the petition are present at the committee hearing and willing to testify).
4. Persons opposed to the license application are given the opportunity to testify first; supporters may testify after the opponents have finished.
5. When you are called to testify, you will be sworn in and asked to give your name, and address. (If your first and/or last names are uncommon please spell them.)
6. You may then provide testimony.
  - a. Include only information relating to the above license application.
  - b. Include only information you have personally witnessed or seen.
  - c. Provide concise and relevant information detailing how this business has affected or may affect the peaceful enjoyment of your neighborhood.
  - d. If by the time you have the opportunity to testify, the information you wish to share has already been provided to the committee, you may state that you agree with the previous testimony. Redundant or repetitive testimony will not assist the committee in making its recommendation.
7. After giving your testimony, the members of the Licenses Committee and the licensee may ask questions regarding the testimony you have given or other factors relating to the license application.
8. Business Competition is not a valid basis for denial or non-renewal of a license.  
**Please Note: If you have submitted an objection to the above application your objection cannot be considered by the committee unless you personally testify at the hearing.**

OCCUPANT	MAIL ADDRESS	CITY, STATE ZIP
CURRENT OCCUPANT	2014 W LINCOLN AVE	MILWAUKEE, WI 53215
CURRENT OCCUPANT	2000 W LINCOLN AVE	MILWAUKEE, WI 53215
CURRENT OCCUPANT	2247 S 20TH ST	MILWAUKEE, WI 53215
CURRENT OCCUPANT	2245 S 20TH ST	MILWAUKEE, WI 53215
CURRENT OCCUPANT	2257 S 20TH ST	MILWAUKEE, WI 53215
CURRENT OCCUPANT	1923 W LINCOLN AVE	MILWAUKEE, WI 53215
CURRENT OCCUPANT	1922 W LINCOLN AVE	MILWAUKEE, WI 53215
CURRENT OCCUPANT	2257A S 19TH ST	MILWAUKEE, WI 53215
CURRENT OCCUPANT	2038 W LINCOLN AVE	MILWAUKEE, WI 53215
CURRENT OCCUPANT	2030 W LINCOLN AVE	MILWAUKEE, WI 53215
CURRENT OCCUPANT	2026 W LINCOLN AVE	MILWAUKEE, WI 53215
CURRENT OCCUPANT	2013A W LINCOLN AVE	MILWAUKEE, WI 53215
CURRENT OCCUPANT	2010 W LINCOLN AVE	MILWAUKEE, WI 53215
CURRENT OCCUPANT	1933 W LINCOLN AVE	MILWAUKEE, WI 53215
CURRENT OCCUPANT	2304 S 20TH ST A	MILWAUKEE, WI 53215
CURRENT OCCUPANT	1930 W LINCOLN AVE	MILWAUKEE, WI 53215
CURRENT OCCUPANT	1919 W LINCOLN AVE B	MILWAUKEE, WI 53215
CURRENT OCCUPANT	2247A S 19TH ST	MILWAUKEE, WI 53215
CURRENT OCCUPANT	1918A W LINCOLN AVE	MILWAUKEE, WI 53215
CURRENT OCCUPANT	1914 W LINCOLN AVE	MILWAUKEE, WI 53215
CURRENT OCCUPANT	2028 W LINCOLN AVE	MILWAUKEE, WI 53215
CURRENT OCCUPANT	2318 S 20TH ST	MILWAUKEE, WI 53215
CURRENT OCCUPANT	2246 S 21ST ST	MILWAUKEE, WI 53215
CURRENT OCCUPANT	2259 S 20TH ST	MILWAUKEE, WI 53215
CURRENT OCCUPANT	2238 S 20TH ST	MILWAUKEE, WI 53215
CURRENT OCCUPANT	2240 S 20TH ST	MILWAUKEE, WI 53215
CURRENT OCCUPANT	1934 W LINCOLN AVE	MILWAUKEE, WI 53215
CURRENT OCCUPANT	1932 W LINCOLN AVE	MILWAUKEE, WI 53215
CURRENT OCCUPANT	1928A W LINCOLN AVE	MILWAUKEE, WI 53215
CURRENT OCCUPANT	1919 W LINCOLN AVE	MILWAUKEE, WI 53215
CURRENT OCCUPANT	2253 S 19TH ST	MILWAUKEE, WI 53215
CURRENT OCCUPANT	2024 W LINCOLN AVE	MILWAUKEE, WI 53215
CURRENT OCCUPANT	2012 W LINCOLN AVE	MILWAUKEE, WI 53215
CURRENT OCCUPANT	2324 S 20TH ST	MILWAUKEE, WI 53215
CURRENT OCCUPANT	1927 W LINCOLN AVE	MILWAUKEE, WI 53215
CURRENT OCCUPANT	2235 S 20TH ST 3	MILWAUKEE, WI 53215
CURRENT OCCUPANT	2229 S 20TH ST	MILWAUKEE, WI 53215
CURRENT OCCUPANT	2248 S 21ST ST	MILWAUKEE, WI 53215
CURRENT OCCUPANT	2248 S 21ST ST A	MILWAUKEE, WI 53215
CURRENT OCCUPANT	2252 S 21ST ST	MILWAUKEE, WI 53215
CURRENT OCCUPANT	2254 S 21ST ST	MILWAUKEE, WI 53215
CURRENT OCCUPANT	2258A S 21ST ST	MILWAUKEE, WI 53215
CURRENT OCCUPANT	2258 S 21ST ST	MILWAUKEE, WI 53215
CURRENT OCCUPANT	2237 S 20TH ST	MILWAUKEE, WI 53215
CURRENT OCCUPANT	2258 S 20TH ST	MILWAUKEE, WI 53215
CURRENT OCCUPANT	1919 W LINCOLN AVE A	MILWAUKEE, WI 53215

CURRENT OCCUPANT	1918B W LINCOLN AVE	MILWAUKEE, WI 53215
CURRENT OCCUPANT	1918C W LINCOLN AVE	MILWAUKEE, WI 53215
CURRENT OCCUPANT	1913 W LINCOLN AVE	MILWAUKEE, WI 53215
CURRENT OCCUPANT	2020 W LINCOLN AVE	MILWAUKEE, WI 53215
CURRENT OCCUPANT	2022 W LINCOLN AVE	MILWAUKEE, WI 53215
CURRENT OCCUPANT	2322 S 20TH ST	MILWAUKEE, WI 53215
CURRENT OCCUPANT	2236 S 20TH ST	MILWAUKEE, WI 53215
CURRENT OCCUPANT	2232B S 20TH ST	MILWAUKEE, WI 53215
CURRENT OCCUPANT	2250 S 20TH ST	MILWAUKEE, WI 53215
CURRENT OCCUPANT	2260 S 20TH ST	MILWAUKEE, WI 53215
CURRENT OCCUPANT	1926 W LINCOLN AVE	MILWAUKEE, WI 53215
CURRENT OCCUPANT	1928 W LINCOLN AVE	MILWAUKEE, WI 53215
CURRENT OCCUPANT	2247 S 19TH ST	MILWAUKEE, WI 53215
CURRENT OCCUPANT	1918 W LINCOLN AVE	MILWAUKEE, WI 53215
CURRENT OCCUPANT	2251 S 19TH ST	MILWAUKEE, WI 53215
CURRENT OCCUPANT	2036 W LINCOLN AVE	MILWAUKEE, WI 53215
CURRENT OCCUPANT	2011 W LINCOLN AVE	MILWAUKEE, WI 53215
CURRENT OCCUPANT	2003 W LINCOLN AVE	MILWAUKEE, WI 53215
CURRENT OCCUPANT	1933 W LINCOLN AVE A	MILWAUKEE, WI 53215
CURRENT OCCUPANT	2236A S 20TH ST	MILWAUKEE, WI 53215
CURRENT OCCUPANT	2235 S 20TH ST 1	MILWAUKEE, WI 53215
CURRENT OCCUPANT	2235 S 20TH ST 2	MILWAUKEE, WI 53215
CURRENT OCCUPANT	2232 S 20TH ST	MILWAUKEE, WI 53215
CURRENT OCCUPANT	2252A S 21ST ST	MILWAUKEE, WI 53215
CURRENT OCCUPANT	2241 S 20TH ST	MILWAUKEE, WI 53215
CURRENT OCCUPANT	2253 S 20TH ST	MILWAUKEE, WI 53215
CURRENT OCCUPANT	2261 S 20TH ST	MILWAUKEE, WI 53215
CURRENT OCCUPANT	2244 S 20TH ST	MILWAUKEE, WI 53215
CURRENT OCCUPANT	1934A W LINCOLN AVE	MILWAUKEE, WI 53215
CURRENT OCCUPANT	1915 W LINCOLN AVE	MILWAUKEE, WI 53215
CURRENT OCCUPANT	2034 W LINCOLN AVE	MILWAUKEE, WI 53215
CURRENT OCCUPANT	2022A W LINCOLN AVE	MILWAUKEE, WI 53215
CURRENT OCCUPANT	2013 W LINCOLN AVE	MILWAUKEE, WI 53215
CURRENT OCCUPANT	2009 W LINCOLN AVE	MILWAUKEE, WI 53215
CURRENT OCCUPANT	2008 W LINCOLN AVE	MILWAUKEE, WI 53215
CURRENT OCCUPANT	2004 W LINCOLN AVE	MILWAUKEE, WI 53215
CURRENT OCCUPANT	2304 S 20TH ST	MILWAUKEE, WI 53215
CURRENT OCCUPANT	2232A S 20TH ST	MILWAUKEE, WI 53215
CURRENT OCCUPANT	2244 S 21ST ST	MILWAUKEE, WI 53215
CURRENT OCCUPANT	2240 S 21ST ST	MILWAUKEE, WI 53215
CURRENT OCCUPANT	2260 S 21ST ST	MILWAUKEE, WI 53215
CURRENT OCCUPANT	2237A S 20TH ST	MILWAUKEE, WI 53215
CURRENT OCCUPANT	2256 S 20TH ST	MILWAUKEE, WI 53215
CURRENT OCCUPANT	2032 W LINCOLN AVE	MILWAUKEE, WI 53215
CURRENT OCCUPANT	2016 W LINCOLN AVE	MILWAUKEE, WI 53215
CURRENT OCCUPANT	2018 W LINCOLN AVE	MILWAUKEE, WI 53215
CURRENT OCCUPANT	2006 W LINCOLN AVE	MILWAUKEE, WI 53215

CURRENT OCCUPANT	1938 W LINCOLN AVE	MILWAUKEE, WI 53215
CURRENT OCCUPANT	2235 S 20TH ST 4	MILWAUKEE, WI 53215
CURRENT OCCUPANT	2232C S 20TH ST	MILWAUKEE, WI 53215
CURRENT OCCUPANT	2231 S 20TH ST	MILWAUKEE, WI 53215
CURRENT OCCUPANT	2243 S 20TH ST	MILWAUKEE, WI 53215
CURRENT OCCUPANT	2263 S 20TH ST	MILWAUKEE, WI 53215
CURRENT OCCUPANT	2248 S 20TH ST	MILWAUKEE, WI 53215
CURRENT OCCUPANT	2253A S 19TH ST	MILWAUKEE, WI 53215
CURRENT OCCUPANT	2257 S 19TH ST	MILWAUKEE, WI 53215

Total Records: 102

Radius: 250.0 feet and Center of Circle: 2000 W Lincoln Ave



# BUSINESS LICENSE PLAN OF OPERATION

ccl-busplan 3/15/18

Office of the City Clerk License Division  
200 E. Wells St. Room 105, Milwaukee, WI 53202  
(414) 286-2238 www.milwaukee.gov/license e-mail address: license@milwaukee.gov

## 1. Type of Business

Applying for:  Extended Hours (12AM to 5AM) - If a food establishment, check all that apply:  Delivery  Drive Thru  Dining Room  
 Self Service Laundry  Massage Establishment  Filling Station  
 Other (supplemental application for specific license also required)

Provide a detailed description of the type of business you plan on operating:

CONVENIENCE STORE

Do you have any experience operating this type of business?  No  Yes If yes, explain:

## 2. Business Operations

- a. Proposed Opening Date: 12/01/19
- b. Is this premise under construction?  No  Yes If yes, list estimated completion date: \_\_\_\_\_
- c. Is this a franchise?  No  Yes
- d. Is this premises currently licensed?  No  Yes If yes, list type of license: FOOD, ALCOHOL, CIV. WORK.
- e. Is the current licensee operating?  No  Yes If no, list date closed: \_\_\_\_\_
- f. Do you have future plans for other businesses, licenses or permits at this location?  No  Yes  
If yes, explain: \_\_\_\_\_
- g. Have you previously held an Extended Hours License in Milwaukee?  No  Yes  
If yes, list address(es): \_\_\_\_\_
- h. Are other businesses operating in the same building?  No  Yes If yes, describe: \_\_\_\_\_

## 3. Litter & Noise

- a. How are grounds kept clean?  Sweep  Pressure Wash  Pick Up Litter  Other: \_\_\_\_\_
- b. How often will grounds be cleaned?  Daily  Weekly  As Needed  Monthly  Other: \_\_\_\_\_
- c. Grounds cleaned by:  Licensee  Building Owner  Employees  Hired Maintenance  Other: \_\_\_\_\_
- d. How are noise issues prevented and/or addressed?  Security  Manager approaches customer(s)  Call Police  
 Signs Posted  Other: \_\_\_\_\_
- e. Will a sound amplification system be used?  No  Yes If yes, describe: \_\_\_\_\_

## 4. Smoking & Sanitation

- a. Are there designated outdoor smoking areas?  No  Yes If yes, describe: \_\_\_\_\_
- b. Number of Garbage Cans: Inside: 1 Locations: BY CASH REGISTER  
Outside: 1 Locations: BY BACK OF THE BUILDING
- c. Is a crowd control barrier used?  No  Yes If yes, describe: \_\_\_\_\_
- d. How many restrooms are on the premises? 1
- e. Name of solid waste contractor:  Advanced Disposal  Waste Management  Other: \_\_\_\_\_

## 5. Security

- a. Are there onsite parking spaces?  No  Yes If yes, how many? \_\_\_\_\_ and describe the parking security plan: \_\_\_\_\_
- b. Is there a loading zone?  No  Yes If yes, describe the loading area security plan: \_\_\_\_\_
- c. Will you have security personnel on premise?  No  Yes If yes, how many? \_\_\_\_\_ and answer the following:  
 What are their responsibilities? \_\_\_\_\_  
 Is security equipment used?  No  Yes If yes, describe \_\_\_\_\_  
 List their licensing, certification, or training credentials \_\_\_\_\_
- d. Will there be security cameras?  No  Yes If yes, how many? 7 and list locations: 2 outside business and five inside.
- e. Will searches/identification checks be done upon entry?  No  Yes If yes, describe \_\_\_\_\_

## 6. Percentage of Sales (must total 100%)

Alcohol <u>20</u> %	Food <u>60</u> <del>80</del> %	Secondhand Merchandise _____ %	Precious Metals & Gems _____ %
Entertainment _____ %	Cigarettes _____ %	_____ %	_____ %
Pawnbroker Activity _____ %	Salvaged Materials _____ % (such as scrap metal)	Personal Services (such as tattoo, body piercing, salon, tailor, tanning, etc.) _____ %	Other <u>60</u> <del>20</del> % Describe: <u>CIG. TOBACCO</u> <u>LETTER</u>

## 7. Businesses/Licenses on the Premises (check all that apply):

### Type 1

- Full Service Restaurant  Cafe/Coffee Shop  Deli or Fast Food Restaurant  Private/Fraternal/Veterans Club
- Night Club  Tavern  Cocktail Lounge  Teen Club
- Banquet Hall  Sports Facility  Bowling Alley
- Hotel/Motel: Number of Floors: \_\_\_\_\_ Number of Rooms: \_\_\_\_\_  
 Rooming House: Number of Floors: \_\_\_\_\_ Number of Rooms: \_\_\_\_\_

### Type 2

- Liquor Store  Corner Store  Supermarket  Convenience Store
- Gas Station  Amusement/Phonograph Distributor  Recycling, Salvage or Towing
- Used Car Dealer  Personal Service Establishment (such as tattoo business, hair salon, tailor, etc.)  Recording Studio

What other licenses/permits will you hold at this location? (check all that apply)

- Occupancy Permit  Cigarette & Tobacco  Gas Station  Extended Hours  Class "B" Tavern  Weights & Measures
- Secondhand Dealer  Precious Metal & Gem  Other: \_\_\_\_\_

## 8. Legal Capacity (only if a Type 1 premises in #7 above)

Capacity \_\_\_\_\_ (Call the Milwaukee Development Center at 414-286-8211 if you have questions.) N/A

## 9. Premises Description

a. Identify all area(s) of the premises that will be used in operating this business (include areas used only for storage):

1<sup>st</sup> Floor  2<sup>nd</sup> Floor  Basement Storage  Patio  Beer Garden  Sidewalk Café  Deck  Rooftop

Other: Describe: \_\_\_\_\_

b. Describe Location:  Major Thoroughfare  Secondary Street  Other: \_\_\_\_\_

c. Nearest Major Cross Street: 20TH & LINCOLN

d. Describe Building:  Free Standing Building  Strip Mall  Other: \_\_\_\_\_

e. Describe Premises Structure:  Single Story  Multi-Story - # of Stories \_\_\_\_\_  Other: \_\_\_\_\_

f. Describe Surrounding Area:  Commercial  Residential  Industrial  Other: \_\_\_\_\_

g. Building Owner Name: SAVIER COVARRUBIAS and MARTHA COVARRUBIAS Phone Number: 414-416-4110

Business Owner Address: 1839 N DOUSMAN ROAD, OCONOMOWOC, WI 53066

## 10. Hours of Operation & Customers

Will customers be entering the premises?  No  Yes

Day of the Week	Proposed Hours of Operation:		Estimated Number of Customers expected each day	Potential Age Range of Customers	Class B Tavern Applicant Only: Age Restriction (If none, write 'None')
	Open Time (include a.m. or p.m.)	Close Time (include a.m. or p.m.)			
Sunday	9 a.m.	9 p.m.	(50)	All	
Monday	9 a.m.	9 p.m.	(50)	All	
Tuesday	9 a.m.	9 p.m.	(50)	All	
Wednesday	9 a.m.	9 p.m.	(50)	All	
Thursday	9 a.m.	9 p.m.	(50)	All	
Friday	9 a.m.	9 p.m.	(50)	All	
Saturday	9 a.m.	9 p.m.	(50)	All	

An Extended Hours Establishment License is required for any convenience store, filling station, personal service establishment (such as tattoo, body piercing, salon, tailor, tanning, etc.), recording studio or restaurant which is open between the hours of 12:00 a.m. and 5:00 a.m.

Alcohol Establishments Class A: 8:00 am to 9:00 pm Sunday thru Saturday

Permitted Hours of Operation: Class B: 6:00 am to 2:00 am Sunday thru Thursday, 6:00 am to 2:30 am Friday & Saturday

Entertainment Outdoor Closing Hours: 10:00pm Sunday-Thursday; 12:00am Friday & Saturday; unless a different time, either earlier or later, is established by the Common Council in its approval of the licensee's plan of operation.

## 11. Signature(s)

Signature of Sole Proprietor, Partner, or 20% or more Shareholder

(If there are no 20% or more shareholders,  
Corporate Officer-print name/title and sign)

Signature of additional partner or 20% or more shareholder

See Application Information for a complete list of all required application forms.





# ALCOHOL BEVERAGE & PUBLIC ENTERTAINMENT PREMISES SUPPLEMENTAL APPLICATION

Office of the City Clerk License Division  
200 E. Wells St. Room 105, Milwaukee, WI 53202  
(414) 286-2238 e-mail address: license@milwaukee.gov [www.milwaukee.gov/license](http://www.milwaukee.gov/license)

Legal Entity Name: <u>CHISHTA'S STORE LLC</u>	
Premise Address: <u>2000, W LINCOLN AVE. MILWAUKEE WI 53215</u>	
<b>Proximity of Premises to Church, School, Daycare Center or Hospital</b>	
Is the building within 300 feet of any church, school, daycare center or hospital? <input checked="" type="checkbox"/> No <input type="checkbox"/> Yes	
<b>"Service Bar Only" Designation</b>	
If applying for Class B or C license, are you applying for "Service Bar Only"? <input checked="" type="checkbox"/> No <input type="checkbox"/> Yes	
Service Bar Only means customers cannot sit at the bar. Alcohol is served to employees who serve patrons seated at tables. No stools, chairs or other articles of furniture shall be placed at the service bar for patrons to sit upon.	
<b>Business Information</b>	
a) Are you taking out this application for anyone that may not be eligible for a license? <input checked="" type="checkbox"/> No <input type="checkbox"/> Yes If yes, list their name and address: _____	
b) Will the agent, a partner or the individual licensee be conducting the day-to-day operations of the business? <input type="checkbox"/> No <input checked="" type="checkbox"/> Yes If no, list the name and address of the person(s) who will: _____	
Class B Applicants: If the agent, a partner or the individual licensee will not be conducting the day-to-day operations of the business, the person(s) listed above must obtain a Class B Managers license.	
c) Does anyone else have money invested or any other interest in this business? <input checked="" type="checkbox"/> No <input type="checkbox"/> Yes If yes, explain: _____	
d) Have you made an agreement with anyone to repay any loan or any other payments based upon income from the business? <input checked="" type="checkbox"/> No <input type="checkbox"/> Yes If yes, list name and address: _____	
<b>Proof of Ownership, Lease, or Offer to Purchase (New &amp; Transfer Applicants Only)</b>	
Submit proof of ownership, lease, or offer to purchase the building with this application. A lease or offer to purchase must:	
a) Be in the same legal entity name as that apply for the license	
b) Reflect the same address as the premises address on this application	
c) Reflect current dates and	
d) Be signed by the lessor/seller and lessee/buyer	
<b>Property Information (New &amp; Transfer Applicants Only)</b>	
a) Do you own or lease the building? <input type="checkbox"/> Own <input checked="" type="checkbox"/> Lease	
b) Who owns the fixtures (for example, coolers, etc.)? <u>ME</u>	
c) Are you purchasing the stock and/or fixtures? <input checked="" type="checkbox"/> No <input type="checkbox"/> Yes If yes, amount paid \$ _____	
d) Total amount paid for business <u>\$29,000</u>	
e) Total amount paid for goodwill of the business \$ _____	
Goodwill comprises the reputation and customer relationships of an existing business. If the price you pay for the business exceeds the fair market value of all of the rest of the assets of the business, the excess may be considered goodwill.	
f) Have you made arrangements with the seller for payment of personal property taxes? <input type="checkbox"/> No <input checked="" type="checkbox"/> Yes	

**See Application Information for a list of all required application forms.**

### Lease Information (New & Transfer Applicants who are leasing the premises only)

- a) Date lease begins October 31, 2014 Ends October 31, 2022
- b) Monthly rental \$ 900
- c) Do you have an option to renew the lease?  No  Yes
- d) Does your lease allow for assignment to another party without the consent of the owner?  No  Yes
- e) For what length of time have you been guaranteed occupancy (number of years)? \_\_\_\_\_
- f) In addition to paying the monthly rental, will you have to pay anything additional to the owner of the building to guarantee performance of the lease?  No  Yes If yes, explain \_\_\_\_\_
- g) Does the present owner or occupancy object to the granting of your license?  No  Yes  
If yes, explain \_\_\_\_\_

### Change of Agent Applicants Only

Have there been any changes to the floor plan since the last application was submitted?  No  Yes

If no, a new floor plan is not required. If yes, submit a new floor plan and explain the change(s): \_\_\_\_\_

### Signature

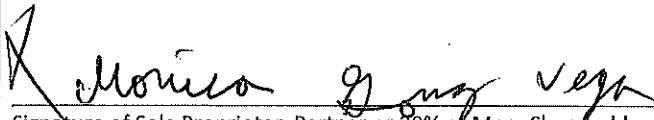

Signature of Sole Proprietor, Partner or 20% or More Shareholder  
(If no 20% or more Shareholder, Corporate Officer - print name/title and sign)

Note: All information contained in this application is subject to approval by the Common Council.  
Deviating from approved plan of operation will subject licensee to citations, and/or suspension or non-renewal of the license.  
Contact the License Division for information on how to request changes.

### New and transfer of premises applicants must submit the following:

- Proof of ownership, lease or offer to purchase the building
- Detailed floor plan
- If a restaurant, copy of the menu



# FOOD DEALER LICENSE PLAN OF OPERATION

ccl-foodplan 2/28/19

OFFICE OF THE CITY CLERK, LICENSE DIVISION  
CITY HALL, 200 E. WELLS ST, ROOM 105, MILWAUKEE, WI 53202  
(414) 286-2238 • [license@milwaukee.gov](mailto:license@milwaukee.gov) • [www.milwaukee.gov/license](http://www.milwaukee.gov/license)

Legal Entity Name: CHRISTIA'S STORE LLC

Premises Address: 2000 W. LINCOLN AVE MILWAUKEE 53225

## SECTION 1 TYPE OF BUSINESS

What will be the majority of your food sales? (check one)

Restaurant Items (meals):  
MEALS include, but are not limited to, chicken, ribs, sandwiches, roasted corn, baked potatoes, hot dogs, brats, tacos, nachos w/ cheese and meat, French fries, cooked or deep fried vegetables/fruit, cooked cheese curds, corn dogs, egg rolls, salads.

Retail Items (snacks and beverages):  
RETAIL items include, but are not limited to, ice cream/soft serve, lemonade, snow cones, coffee, espresso, cappuccino, tea, fruit juice, smoothies, candy, dispensed soda, fruit cups, bakery, cookies, kettle corn, cotton candy, funnel cakes, fritters, tortilla chips w/ cheese.

Will it be a convenience store?  Yes  No

A convenience store contains less than 5,000 square feet of retail space and has, as its primary business, the sale of basic food items and in addition, sells household products or is a filling station that sells basic food items and household products.

Bed & Breakfast

Micro Market

All Applicants: Submit a menu or a list of food items that will be sold.

Will any wholesale business be done?  No  Yes If yes, what percentage of food sales will be wholesale?

Less than 25%

25% or More AND:

Restaurant items (meals) will be sold – Complete this application and also contact DATCP.

NO restaurant items (meals) will be sold - Do NOT complete this application. Contact DATCP only.

## SECTION 2 FOOD PROCESSING

Will any food processing be done?  No ~~Yes~~

Processing is defined as assembling, grinding, cutting, mixing, baking, coating, stuffing, packing, bottling, grilling, canning, extracting, fermenting, distilling, pickling, freezing, drying, smoking, or packaging.

## SECTION 3 FOOD REQUIRING TEMPERATURE CONTROL

Will any food that requires temperature control be sold?  No  Yes  
(includes dairy products such as milk, cheese, and ice cream, fish, shellfish, meat, poultry)

If yes, list the types of food items: MILK, CHEESE, ~~ICE CREAM, PASTRY, BREAD, BUTTER, SAUSAGE, MEAT, POULTRY~~

SECTION 4      DETAILS OF OPERATION	
Will you have seating on site for dining?	<input checked="" type="checkbox"/> No <input type="checkbox"/> Yes
Will you be doing any catering?	<input checked="" type="checkbox"/> No <input type="checkbox"/> Yes
Will you be doing any delivery?	<input checked="" type="checkbox"/> No <input type="checkbox"/> Yes
Will you have outdoor activities?	<input checked="" type="checkbox"/> No <input type="checkbox"/> Yes - Check all that apply: <input type="checkbox"/> Bar <input type="checkbox"/> Cooking/Grilling <input type="checkbox"/> Dining
Will you have a drive thru window?	<input type="checkbox"/> No <input type="checkbox"/> Yes - Are hours different from inside? <input type="checkbox"/> No <input type="checkbox"/> Yes If Yes, provide drive thru hours: _____
Will scales or barcode scanners be used?	<input type="checkbox"/> No <input type="checkbox"/> Yes - You must also apply for a Weights & Measures License.
SECTION 5      ADDITIONAL SITES	
Where will food be prepared and/or sold?	
<input checked="" type="checkbox"/> At a single site <input type="checkbox"/> At multiple sites: How many? _____ (for example, a hotel with several dining rooms or bars)	
If multiple sites, attach a Food Dealer Additional Site Addendum (ccl-foodadd) for each additional site.	
SECTION 6      CONSTRUCTION OR CHANGES	
Are you planning any construction, remodeling or equipment changes?	
<input checked="" type="checkbox"/> No    If No, SKIP to Section 8	
<input type="checkbox"/> Yes    If Yes, check all that apply: <input type="checkbox"/> New construction of a building <input type="checkbox"/> Renovation or remodeling	
<input type="checkbox"/> Construction changes to existing building <input type="checkbox"/> Equipment changes only	
Provide a brief description of the changes: _____	
Start date: _____	
Name, Address & Phone Number of Architect: _____	
Name, Address & Phone Number of Contractor: _____	
SECTION 7      ALCOHOL BEVERAGES	
Are you applying for an alcohol beverage license?	
<input checked="" type="checkbox"/> No    If No, SKIP to Section 9	
<input checked="" type="checkbox"/> Yes    If YES, if your food license is approved prior to the alcohol license, when do you want the food license issued?	
<input type="checkbox"/> Immediately <input checked="" type="checkbox"/> At the same time as the alcohol license	
SECTION 8      ACKNOWLEDGEMENTS & SIGNATURE	
You must initial each item confirming your understanding:	
<u>MG</u>	I understand the Health Department must conduct an inspection and advise the License Division of their approval before the license may be issued.
<u>MG</u>	I understand I must obtain an occupancy permit from the Department of Neighborhood Services and an inspection may be required. Neighborhood Services must advise the License Division of their approval before the license may be issued.
<u>MG</u>	I understand the district alderperson will review and either support or object to my application. If he/she objects, I may appeal and be scheduled to appear before the Licenses Committee. The Licenses Committee will then make a recommendation to the Common Council. The Common Council must grant the license before it may be issued.
<u>MG</u>	I understand proof of payment for all license fees must be on file in the License Division before the license may be issued and the license must be issued and posted in my establishment prior to opening for business.
<u>MG</u>	I will not operate my food business until the license has been issued and posted in the establishment.
Signature of Sole Proprietor, Partner, or 20% Shareholder: <u>X</u> <i>Morinda Souza Vega</i>	
Signature of Additional Partner: _____	



# WEIGHTS & MEASURES PLAN OF OPERATION

ccl-wmplan 1/9/18

Office of the City Clerk License Division  
200 E. Wells St. Room 105, Milwaukee, WI 53202  
(414) 286-2238 [www.milwaukee.gov/license](http://www.milwaukee.gov/license) [license@milwaukee.gov](mailto:license@milwaukee.gov)

Legal Entity Name: Chispita's Store LLC

Premise Address: 2000 W Lincoln Avenue

### Type of Business

Provide a brief description of the establishment/business:  
ITS a small grocery store. Have a little bit of most things.

*Other licenses may be required depending on the type of business you are operating.*

### Litter & Noise

- a. How are grounds kept clean?  Sweep  Pressure Wash  Pick Up Litter  Other: \_\_\_\_\_
- b. How often will grounds be cleaned?  Daily  Weekly  As Needed  Monthly  Other: \_\_\_\_\_
- c. Grounds cleaned by:  Licensee  Building Owner  Employees  Hired Maintenance  Other: \_\_\_\_\_
- d. How are noise issues prevented and/or addressed?  Security  Manager approaches customer(s)  Call Police  
 Signs Posted  Other: \_\_\_\_\_

### Signature

Monia Bony Vega  
Signature of Sole Proprietor, Partner, or 20% or more Shareholder  
(If there are no 20% or more shareholders, Corporate Officer-print name/title and sign)

\_\_\_\_\_  
Signature of additional partner or 20% or more shareholder

*This form must be submitted with the Business License Application, Weights & Measures License Supplemental Application, and appropriate fee. Forms can be obtained online at [www.milwaukee.gov/licenses](http://www.milwaukee.gov/licenses).*



**WEIGHTS & MEASURES LICENSE  
SUPPLEMENTAL APPLICATION**

OFFICE OF THE CITY CLERK, LICENSE DIVISION  
CITY HALL, 200 E. WELLS ST, ROOM 105, MILWAUKEE, WI 53202  
(414) 286-2238 • [license@milwaukee.gov](mailto:license@milwaukee.gov) • [www.milwaukee.gov/license](http://www.milwaukee.gov/license)

**Office Use Only:**

App# \_\_\_\_\_  
 Filed \_\_\_\_\_  
 Initials \_\_\_\_\_  
 Paid \_\_\_\_\_  
 Lic # \_\_\_\_\_

Legal Entity Name: Chisita's Store LLC

Premise Address: 2000 W Lincoln Avenue

**Device Type(s)**

- Check all device types for which you need a license.
  - For each device type checked, indicate how many you have in the Number of Devices column (b).
  - Calculate the Total Fee Per Device Type by multiplying the Fee Per Device Type (a) by the Number of Devices (b).
  - Add all Total Fee Per Device Type amounts together and that will be your Total Fee Due.
- \* **Exception:** The Scanner fee is not per device. Check the box for the appropriate range.  
 If you have 1-3 scanners, the total due is \$130. If you have 4 or more scanners, the total due is \$250.  
 Check the Number of Devices (b).

Device Type	License Period	Fee Per Device Type (a)	Number of Devices (b)	Total Fee Per Device Type (a x b)
<b>Liquid Measuring Devices</b>				
<input type="checkbox"/> Retail Petroleum Meters	12 months	\$60		
<input type="checkbox"/> 0 to 30 gallons per minute	24 months	\$60		
<input type="checkbox"/> 31 to 200 gallons per minute	24 months	\$250		
<input type="checkbox"/> Over 200 gallons per minute	24 months	\$250		
<b>Scales</b>				
<input checked="" type="checkbox"/> Measuring any weight amount	24 months	\$55		
<b>Scanners</b>				
		Fee for scanners is by range	Check how many scanners you have	
<input type="checkbox"/> Up to 3 scanners	24 months	\$130 total*	<input type="checkbox"/> 1 <input type="checkbox"/> 2 <input type="checkbox"/> 3	
<input type="checkbox"/> Four or more scanners	24 months	\$250 total*	<input type="checkbox"/> 4 <input type="checkbox"/> Other _____	
<b>Other Devices</b>				
<input type="checkbox"/> Length Measuring Device	24 months	\$60		
<input type="checkbox"/> Timing Device	24 months	\$30		
<b>Total Fee Due</b>				<u>\$55</u>

**Signature**

I hereby agree that I will comply with the applicable sections of the Wisconsin State Statutes, Administrative Code and the Milwaukee Code of Ordinances regarding the operation of weighing and measuring devices.

I understand that all devices must be operated within the specifications, tolerances and other technical requirements set forth in the National Institute of Standards and Technology Handbook 44. I understand that the license for which I am applying must be posted on the premises or in my vehicle prior to opening for business or operating the device.

I understand that these device licenses are not transferable (with the exception of scanners). If the device is replaced or needs to be resealed, I must apply for and receive a new license so that an inspection of the device can be performed prior to its use.

I acknowledge that as a condition of being issued this license, I must allow the Health Department into the establishment to test the device to validate its specifications/tolerances. If my devices are found out of compliance, I may be charged inspection fees.

I have read, understand, and will adhere to all the above acknowledgments.

Monica Dong Vega  
 Signature of Sole Proprietor, Partner, or 20% or more Shareholder  
 (If there are no 20% or more shareholders, Corporate Officer-print name/title and sign)

\_\_\_\_\_  
 Signature of additional partner or 20% or more shareholder

*This form must be submitted with the Business License Application, Weights & Measures Plan of Operation, and appropriate fee. Forms can be obtained online at [www.milwaukee.gov/licenses](http://www.milwaukee.gov/licenses).*

S 20TH ST

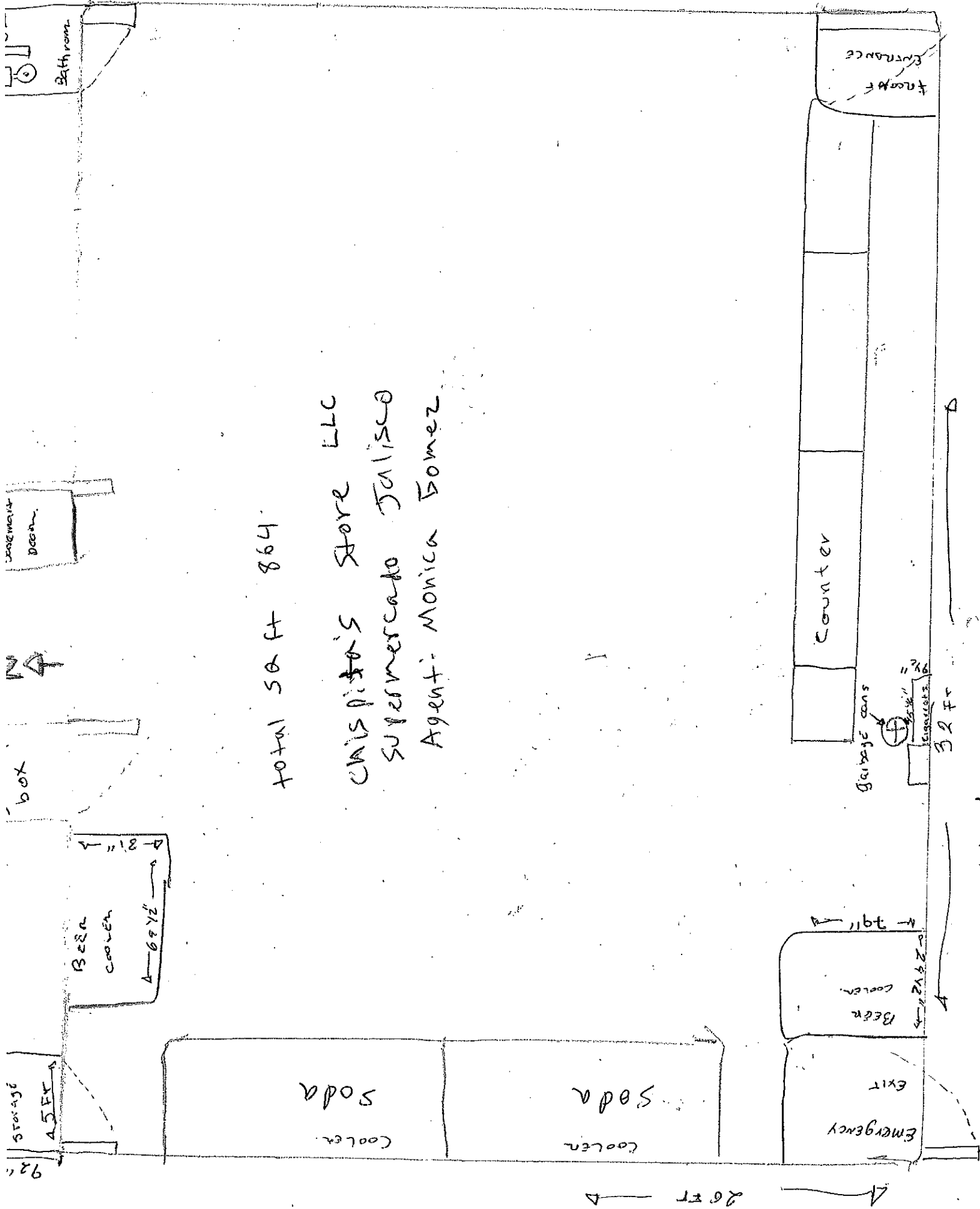

total sq ft 864

CNISPISTA'S STORE LLC  
 SUPERMERCADO TALISCO  
 Agent: MONICA BOMEZ

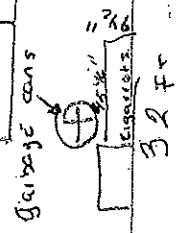
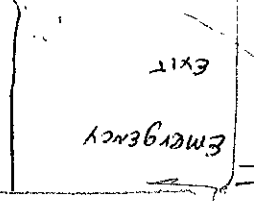
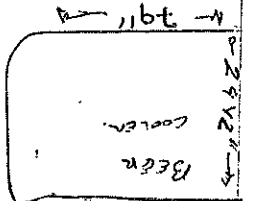
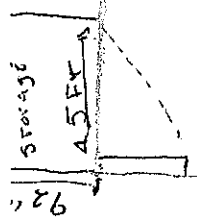
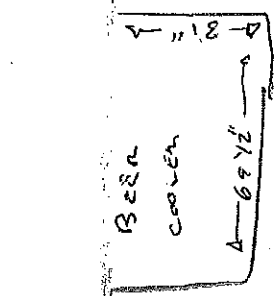
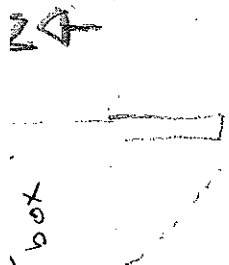
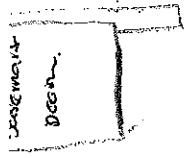

6.1. 1



CITY OF MILWAUKEE  
OFFICE OF THE CITY CLERK

Wednesday, March 04, 2020

COMMITTEE MEETING NOTICE

AD 08

SINGH, Manpreet, Agent  
National Grocery, LLC  
3501 W National Av

Milwaukee, WI 53215

You are requested to attend a hearing which is to be held in Room 301-B, Third Floor, City Hall on:

**Tuesday, March 10, 2020 at 09:15 AM**

**Regarding:** Your Class A Malt & Class A Liquor and Food Dealer License Renewal Applications as agent for "National Grocery, LLC" for "National Grocery" at 3501 W National Av.

There is a possibility that your application may be denied for one or more of the following reasons: The recommendation of the committee regarding the application shall be based on evidence presented at the hearing. Per MCO 85-4-4, unless otherwise specified in the code, probative evidence concerning non-renewal, suspension or revocation may include evidence of the following: failure of the applicant to meet municipal qualifications, pending charges against or the conviction of any felony, misdemeanor, municipal offense or other offense, the circumstances of which substantially relate to the circumstances of the particular licensed or permitted activity, by the applicant or by any employee or other agent of the applicant. If the activities of the applicant involve a licensed premises, whether the premises tends to facilitate a public or private nuisance or has been the source of congregations of persons which have resulted in any of the following: disturbance of the peace; illegal drug activity; public drunkenness; drinking in public; harassment of passers-by; gambling; prostitution; sale of stolen goods; public urination; theft; assaults; battery; acts of vandalism including graffiti, excessive littering, loitering, illegal parking, loud noise at times when the licensed premise is open for business; traffic violations; curfew violations; lewd conduct; display of materials harmful to minors, pursuant to s. 106-9.6; or any other factor which reasonably relates to the public health, safety and welfare, or failure to comply with the approved plan of operation. See attached police report or correspondence.

**Notice for applicants with warrants or unpaid fines:**

Proof of warrant satisfaction or payment of fines must be submitted at the hearing on the above date and time. Failure to comply with this requirement may result in a delay of the granting/denial of your application.

Failure to appear at this meeting may result in the denial of your license. Individual applicants must appear only in person or by an attorney. Corporate or Limited Liability applicants must appear only by the agent designated on the application or by an attorney. Partnership applicants must appear by a partner listed on the application or by an attorney. If you wish to do so and at your own expense, you may be accompanied by an attorney of your choosing to represent you at this hearing.

You will be given an opportunity to speak on behalf of the application and to respond and challenge any charges or reasons given for the denial. No petitions can be accepted by the committee, unless the people who signed the petition are present at the committee hearing and willing to testify. You may present witnesses under oath and you may also confront and cross-examine opposing witnesses under oath. If you have difficulty with the English language, you should bring an interpreter with you, at your expense, so that you can answer questions and participate in your hearing.

You may examine the application file at this office during regular business hours prior to the hearing date. Inquiries regarding this matter may be directed to the person whose signature appears below.

Limited parking for persons attending meetings in City Hall is available at reduced rates (5 hour limit) at the Milwaukee Center on the southwest corner of East Kilbourn and North Water Street. Parking tickets must be validated in the first floor information booth in City Hall.

PLEASE NOTE: Upon reasonable notice, efforts will be made to accommodate the needs of disabled individuals through sign language interpreters or other auxiliary aids. For additional information or to request this service, contact the Council Services Division ADA Coordinator at (414) 286-2998, Fax - (414) 286-3456, TDD - (414) 286-2025.

JIM OWCZARSKI, CITY CLERK

BY: \_\_\_\_\_

Jessica Ceella

License Division Manager

If you have questions regarding this notice, please contact the License Division at (414) 286-2238.

200 E. Wells Street, Room 105, City Hall, Milwaukee, WI 53202. [www.milwaukee.gov/license](http://www.milwaukee.gov/license)  
Phone: (414) 286-2238 Fax: (414) 286-3057 Email Address: [License@milwaukee.gov](mailto:License@milwaukee.gov)



Roman, Carmen

REDACTED RECORD

From: Tuesday, March 3, 2020 11:26 AM  
Sent: Roman, Carmen  
To: Becker, Keren; Schafer, Nathan; Martin, Faviola  
Cc: Re: Liquor license on 35th & National  
Subject:

The store is called National Liquor & Wine at **3501 W National Ave, Milwaukee, WI 53215**. My comments can be used if necessary, but **I'd like to remain anonymous**. My comments again:

I'd love to get rid of the liquor license there, that intersection would be so much nicer. There are always drunk people hanging around outside. I've seen bad interactions at that bus stop because of drunk people harassing people waiting for the bus. I also had to call the cops a month ago because a drunk guy was running around in the middle of the intersection and causing many near accidents. Lots of bad, illegal parking jobs there too, then people come out with just beer.

Thanks.

On Tue, Mar 3, 2020 at 11:10 AM Roman, Carmen <[Carmen.Roman@milwaukee.gov](mailto:Carmen.Roman@milwaukee.gov)> wrote:

Good Morning,

In order to properly attached this objection to the correct license we need the exact business address. Can you please provide the correct business name and address. If you have any questions you can call or email our office.

Thank you,

*Carmen Roman*

License Specialist II

City of Milwaukee

License Division

(414) 286-2238



REDACTED RECORD



**From:**  
**Sent:** Monday, March 2, 2020 4:16 PM  
**To:** License; Doherty, Patricia  
**Subject:** Fwd: Liquor license on 35th & National

----- Forwarded message -----

Date: Tue, Feb 25, 2020 at 9:22 PM  
Subject: Liquor license on 35th & National  
To: .

I'd love to get rid of the liquor license there, that intersection would be so much nicer. There are always drunk people hanging around outside. I've seen bad interactions at that bus stop because of drunk people harassing people waiting for the bus. I also had to call the cops a month ago because a drunk guy was running around in the middle of the intersection and causing many near accidents. Lots of bad, illegal parking jobs there too, then people come out with just beer.

FYI, all of this same stuff is happening at the place on the corner of 33rd & Scott (used to be call El Rincon or Scott St foods). Lots of shady stuff over there (sometimes looks like prostitution or drug dealing), which sucks because there's a little church across the street and a lot of kid traffic because there are 2 schools 2 blocks away in either direction (Doerfler & El Puente).

Similar stuff at the store on 35th & Greenfield too, but not as bad.

And the one on 31st & National.

**REDACTED RECORD**

The City of Milwaukee is subject to Wisconsin Statutes related to public records. Unless otherwise exempted from the public records law, senders and receivers of City of Milwaukee e-mail should presume that e-mail is subject to release upon request, and is subject to state records retention requirements. See City of Milwaukee full e-mail disclaimer at [www.milwaukee.gov/email\\_disclaimer](http://www.milwaukee.gov/email_disclaimer)



Wednesday, March 04, 2020



# Notice of Public Hearing

---

SINGH, Manpreet, Agent  
National Grocery at 3501 W National Av  
Class A Malt & Class A Liquor and Food Dealer License Renewal Applications

**Tuesday, March 10, 2020 at 9:15 AM**

To whom it may concern:

The above application has been made by the above named applicant(s). This requires approval from the Licenses Committee and the Common Council of the City of Milwaukee. The hearing before the Licenses Committee will take place on 3/10/2020 at 9:15 AM, in Room 301-B, Third Floor, City Hall. If you wish, you may provide testimony at the hearing regarding the request; see below for further information. You are not required to attend the hearing. Once the Licenses Committee makes its recommendation, this recommendation is forwarded to the full Common Council for approval at its next regularly scheduled hearing. Please review the information below and if you have further questions regarding this process, please contact the License Division at (414) 286-2238.

---

## Important details for those wishing to provide information for the Licenses Committee to consider when making its recommendation:

1. The license application is scheduled to be heard at the above time. Due to other hearings running longer than scheduled, you may have to wait some time to provide your testimony.
2. You must appear in person and testify as to matters that you have personally experienced or seen. (You cannot provide testimony for your neighbor, parent or anyone else; this is considered hearsay and cannot be considered by the committee.)
3. No letters or petitions can be accepted by the committee (unless the person who wrote the letter or the persons who signed the petition are present at the committee hearing and willing to testify).
4. Persons opposed to the license application are given the opportunity to testify first; supporters may testify after the opponents have finished.
5. When you are called to testify, you will be sworn in and asked to give your name, and address. (If your first and/or last names are uncommon please spell them.)
6. You may then provide testimony.
  - a. Include only information relating to the above license application.
  - b. Include only information you have personally witnessed or seen.
  - c. Provide concise and relevant information detailing how this business has affected or may affect the peaceful enjoyment of your neighborhood.
  - d. If by the time you have the opportunity to testify, the information you wish to share has already been provided to the committee, you may state that you agree with the previous testimony. Redundant or repetitive testimony will not assist the committee in making its recommendation.
7. After giving your testimony, the members of the Licenses Committee and the licensee may ask questions regarding the testimony you have given or other factors relating to the license application.
8. Business Competition is not a valid basis for denial or non-renewal of a license.  
**Please Note: If you have submitted an objection to the above application your objection cannot be considered by the committee unless you personally testify at the hearing.**

OCCUPANT	MAIL ADDRESS	CITY, STATE ZIP
CURRENT OCCUPANT	3430B W NATIONAL AVE	MILWAUKEE, WI 53215
CURRENT OCCUPANT	941 S 35TH ST	MILWAUKEE, WI 53215
CURRENT OCCUPANT	907A S 36TH ST	MILWAUKEE, WI 53215
CURRENT OCCUPANT	906 S 36TH ST 3	MILWAUKEE, WI 53215
CURRENT OCCUPANT	3526 W NATIONAL AVE A	MILWAUKEE, WI 53215
CURRENT OCCUPANT	921A S 35TH ST	MILWAUKEE, WI 53215
CURRENT OCCUPANT	907 S 35TH ST 2	MILWAUKEE, WI 53215
CURRENT OCCUPANT	930 S 35TH ST	MILWAUKEE, WI 53215
CURRENT OCCUPANT	933 S 34TH ST	MILWAUKEE, WI 53215
CURRENT OCCUPANT	931A S 34TH ST	MILWAUKEE, WI 53215
CURRENT OCCUPANT	3415 W NATIONAL AVE	MILWAUKEE, WI 53215
CURRENT OCCUPANT	3430A W NATIONAL AVE	MILWAUKEE, WI 53215
CURRENT OCCUPANT	1002 S 36TH ST	MILWAUKEE, WI 53215
CURRENT OCCUPANT	934 S 36TH ST	MILWAUKEE, WI 53215
CURRENT OCCUPANT	909A S 36TH ST	MILWAUKEE, WI 53215
CURRENT OCCUPANT	922 S 36TH ST	MILWAUKEE, WI 53215
CURRENT OCCUPANT	920 S 36TH ST	MILWAUKEE, WI 53215
CURRENT OCCUPANT	929 S 35TH ST	MILWAUKEE, WI 53215
CURRENT OCCUPANT	3509A W NATIONAL AVE	MILWAUKEE, WI 53215
CURRENT OCCUPANT	907 S 35TH ST 4	MILWAUKEE, WI 53215
CURRENT OCCUPANT	933A S 34TH ST	MILWAUKEE, WI 53215
CURRENT OCCUPANT	3427B W NATIONAL AVE	MILWAUKEE, WI 53215
CURRENT OCCUPANT	1000 S 36TH ST	MILWAUKEE, WI 53215
CURRENT OCCUPANT	909 S 36TH ST	MILWAUKEE, WI 53215
CURRENT OCCUPANT	918A S 36TH ST	MILWAUKEE, WI 53215
CURRENT OCCUPANT	3511 W NATIONAL AVE	MILWAUKEE, WI 53215
CURRENT OCCUPANT	1002 S 35TH ST	MILWAUKEE, WI 53215
CURRENT OCCUPANT	926 S 35TH ST	MILWAUKEE, WI 53215
CURRENT OCCUPANT	918 S 35TH ST	MILWAUKEE, WI 53215
CURRENT OCCUPANT	3427A W NATIONAL AVE	MILWAUKEE, WI 53215
CURRENT OCCUPANT	3415A W NATIONAL AVE	MILWAUKEE, WI 53215
CURRENT OCCUPANT	1005 S 35TH ST	MILWAUKEE, WI 53215
CURRENT OCCUPANT	907B S 36TH ST	MILWAUKEE, WI 53215
CURRENT OCCUPANT	906 S 36TH ST 2	MILWAUKEE, WI 53215
CURRENT OCCUPANT	918 S 36TH ST	MILWAUKEE, WI 53215
CURRENT OCCUPANT	3522A W NATIONAL AVE	MILWAUKEE, WI 53215
CURRENT OCCUPANT	3523 W NATIONAL AVE 2	MILWAUKEE, WI 53215
CURRENT OCCUPANT	921 S 35TH ST	MILWAUKEE, WI 53215
CURRENT OCCUPANT	925 S 35TH ST	MILWAUKEE, WI 53215
CURRENT OCCUPANT	915 S 35TH ST	MILWAUKEE, WI 53215
CURRENT OCCUPANT	1004 S 35TH ST	MILWAUKEE, WI 53215
CURRENT OCCUPANT	931 S 34TH ST	MILWAUKEE, WI 53215
CURRENT OCCUPANT	922 S 35TH ST	MILWAUKEE, WI 53215
CURRENT OCCUPANT	927 S 34TH ST	MILWAUKEE, WI 53215
CURRENT OCCUPANT	3424 W NATIONAL AVE	MILWAUKEE, WI 53215
CURRENT OCCUPANT	1006 S 36TH ST	MILWAUKEE, WI 53215

CURRENT OCCUPANT	1007 S 35TH ST	MILWAUKEE, WI 53215
CURRENT OCCUPANT	1003 S 35TH ST	MILWAUKEE, WI 53215
CURRENT OCCUPANT	930 S 36TH ST	MILWAUKEE, WI 53215
CURRENT OCCUPANT	3512 W NATIONAL AVE	MILWAUKEE, WI 53215
CURRENT OCCUPANT	1008 S 35TH ST	MILWAUKEE, WI 53215
CURRENT OCCUPANT	1010 S 35TH ST	MILWAUKEE, WI 53215
CURRENT OCCUPANT	938 S 35TH ST	MILWAUKEE, WI 53215
CURRENT OCCUPANT	934 S 35TH ST	MILWAUKEE, WI 53215
CURRENT OCCUPANT	938 S 36TH ST	MILWAUKEE, WI 53215
CURRENT OCCUPANT	906 S 36TH ST 1	MILWAUKEE, WI 53215
CURRENT OCCUPANT	3522 W NATIONAL AVE	MILWAUKEE, WI 53215
CURRENT OCCUPANT	3523 W NATIONAL AVE 3	MILWAUKEE, WI 53215
CURRENT OCCUPANT	3523 W NATIONAL AVE 1	MILWAUKEE, WI 53215
CURRENT OCCUPANT	929A S 35TH ST	MILWAUKEE, WI 53215
CURRENT OCCUPANT	933 S 35TH ST	MILWAUKEE, WI 53215
CURRENT OCCUPANT	907 S 35TH ST 3	MILWAUKEE, WI 53215
CURRENT OCCUPANT	1004A S 35TH ST	MILWAUKEE, WI 53215
CURRENT OCCUPANT	927 S 34TH ST A	MILWAUKEE, WI 53215
CURRENT OCCUPANT	3417A W NATIONAL AVE	MILWAUKEE, WI 53215
CURRENT OCCUPANT	3430C W NATIONAL AVE	MILWAUKEE, WI 53215
CURRENT OCCUPANT	936 S 36TH ST	MILWAUKEE, WI 53215
CURRENT OCCUPANT	3526 W NATIONAL AVE	MILWAUKEE, WI 53215
CURRENT OCCUPANT	930 S 35TH ST A	MILWAUKEE, WI 53215
CURRENT OCCUPANT	3428A W NATIONAL AVE	MILWAUKEE, WI 53215
CURRENT OCCUPANT	1001 S 35TH ST	MILWAUKEE, WI 53215
CURRENT OCCUPANT	934A S 36TH ST	MILWAUKEE, WI 53215
CURRENT OCCUPANT	926 S 36TH ST	MILWAUKEE, WI 53215
CURRENT OCCUPANT	907 S 35TH ST 1	MILWAUKEE, WI 53215

Total Records: 74

Radius: 250.0 feet and Center of Circle: 3501 W National Ave

## 2020-2021 Plan of Operation for 3501 W NATIONAL AV

<b>1. Litter &amp; Security Plans</b>			
How are the grounds kept clean? <input checked="" type="checkbox"/> Sweep <input checked="" type="checkbox"/> Pressure Wash <input checked="" type="checkbox"/> Pick Up Litter <input type="checkbox"/> Other:			
How often will grounds be cleaned? <input checked="" type="checkbox"/> Daily <input checked="" type="checkbox"/> Weekly <input type="checkbox"/> Other:			
Who cleans the grounds? <input checked="" type="checkbox"/> Licensee <input type="checkbox"/> Building Owner <input checked="" type="checkbox"/> Employees <input type="checkbox"/> Hired Maintenance <input type="checkbox"/> Other:			
How are noise issues prevented and/or addressed? <input type="checkbox"/> Security <input checked="" type="checkbox"/> Manager approaches customer(s) <input checked="" type="checkbox"/> Call Police <input checked="" type="checkbox"/> Signs Posted <input type="checkbox"/> Other:			
Are there designated outdoor smoking areas? <input checked="" type="checkbox"/> No <input type="checkbox"/> Yes If Yes, Describe:			
Number of garbage cans: Inside <u>2</u> Locations: <u>SIDE OF CENTER</u> Outside <u>2</u> Locations: <u>SIDE OF AUBURS</u>			
Is a crowd control barrier used? <input checked="" type="checkbox"/> No <input type="checkbox"/> Yes If Yes, Describe:			
Number of restrooms: <u>1</u>		Name of solid waste contractor: <u>WM</u>	
Are there parking spaces on the premises? <input type="checkbox"/> No <input checked="" type="checkbox"/> Yes If Yes, list number of spaces: <u>3</u> and describe security plans: <u>CAMERAS</u>			
Are there designated loading areas? <input type="checkbox"/> No <input checked="" type="checkbox"/> Yes If Yes, describe security plans: <u>SIDE OF STREET CAMERAS</u>			
Do you have security personnel on the premise? <input checked="" type="checkbox"/> No <input type="checkbox"/> Yes If Yes, how many? _____ AND What are their responsibilities? _____ What security equipment do they use? _____ List their licensing, certification or training credentials: _____			
Are there security cameras? <input type="checkbox"/> No <input checked="" type="checkbox"/> Yes If Yes, list all locations: <u>INSIDE OUTSIDE FRONT</u>			
Are searches and/or identification checks conducted upon entry? <input checked="" type="checkbox"/> No <input type="checkbox"/> Yes If Yes, describe:			
<b>2. Percentage of Sales (must total 100%)</b>			
Alcohol <u>60</u> %	Food Sales <u>40</u> %	Entertainment _____ %	Other _____ %
<b>3. Businesses On The Premises (choose all that apply):</b>			
<input type="checkbox"/> Restaurant <input type="checkbox"/> Cafe/Coffee Shop <input type="checkbox"/> Cocktail Lounge <input checked="" type="checkbox"/> Convenience Store <input type="checkbox"/> Night Club <input checked="" type="checkbox"/> Liquor Store <input type="checkbox"/> Tavern <input type="checkbox"/> Sports Facility <input type="checkbox"/> Hotel <input type="checkbox"/> Banquet Hall <input checked="" type="checkbox"/> Supermarket <input type="checkbox"/> Private/Fraternal/Veterans' Club <input type="checkbox"/> Other:			
<b>4. Hours of Operation and Age Restriction</b>			
Are there any changes to the current hours of operation or age restriction? <input checked="" type="checkbox"/> No <input type="checkbox"/> Yes If Yes, Describe:			
Please Note: If you will be open earlier or later than the hours listed on your current license for even one event or holiday (for example, St. Patrick's Day, Brewers Opening Day, etc.) during the license period, this must be reported and printed on your license. Your hours of operation and age restriction are listed on your current license.			
<b>5. Floor Plan and Capacity</b>			
Are you requesting any changes to your capacity or floor plan*? <input checked="" type="checkbox"/> No <input type="checkbox"/> Yes If yes, describe: _____ and submit a new floor plan with this renewal application. A sample plan can be found online at <a href="http://www.milwaukee.gov/licenses">www.milwaukee.gov/licenses</a> under License Forms and Related Information.			
Alcohol/Food Establishments: A "Permanent Extension of Premises Application" is required if you are adding any square footage to the licensed premises.			
<b>6. Sidewalk Dining: Fee:</b>			
Are there any changes to the sidewalk dining site plan? <input checked="" type="checkbox"/> No <input type="checkbox"/> Yes If Yes, submit an updated site plan with this application.			
<b>7. Food License: FOOD 9801 Fee: \$300.00</b>		<b>8. Weights and Measures: Fee:</b>	
Your current food license includes the following food operations: No Processing, Hazardous Foods, Sales \$20,001 - \$200,000, Convenience. Are there any changes to your food operations as listed above? <input checked="" type="checkbox"/> No <input type="checkbox"/> Yes, if Yes, explain _____		Number/Type of Devices: Are there any changes to the number or types of devices? <input checked="" type="checkbox"/> No <input type="checkbox"/> Yes If yes, contact our office for further instructions.	