



CITY OF MILWAUKEE  
OFFICE OF THE CITY CLERK

Friday, February 02, 2018

COMMITTEE MEETING NOTICE

AD 07

CLAYTON, Joseph T, Agent  
Elation Wine & Dessert Bar, LLC  
4050 N 44th St  
Milwaukee, WI 53216

You are requested to attend a hearing which is to be held in Room 301-B, Third Floor, City Hall on:

**Tuesday, February 13, 2018 at 01:45 PM**

**Regarding:** Your Request for an unusual circumstance waiver to reinstate the Class C Wine - Service Bar Only and Food Dealer License Applications as agent for "Elation Wine & Dessert Bar, LLC" for "Elation Wine & Dessert Bar" at 4706-08 W Fond du Lac Av.

There is a possibility that your application may be denied for one or more of the following reasons: The recommendation of the committee regarding the application shall be based on evidence presented at the hearing. Per MCO 85-2.7-4, probative evidence concerning whether or not a new license should be granted may be presented on the following subjects: whether or not the applicant meets the municipal requirements, the appropriateness of the location and premises where the licensed premises is to be located and whether use of the premises for the purposes or activities permitted by the license would tend to facilitate a public or private nuisance or create undesirable neighborhood problems such as disorderly patrons, unreasonably loud noise, litter, and excessive traffic and parking congestion. Probative evidence relating to these matters may be taken from the plan of operation submitted with the license application, if any, but shall not include the content of any music. Evidence regarding the fitness of the location of the premises to be maintained as the principal place of business, including but not limited to whether there is an overconcentration of businesses of the type for which the license is sought; whether the proposal is consistent with any pertinent neighborhood business or development plans, or the location's proximity to areas where children are typically present. The applicant's record in operating similarly licensed premises; and whether or not the applicant has been charged with or convicted of any felony, misdemeanor, municipal offense or other offense, the circumstances of which substantially relate to the activity to be permitted by the license being applied for or any other factor which reasonably relates to the public health, safety or welfare may also be considered. See attached police report or correspondence.

**Notice for applicants with warrants or unpaid fines:** Proof of warrant satisfaction or payment of fines must be submitted at the hearing on the above date and time. Failure to comply with this requirement may result in a delay of the granting/denial of your application.

Failure to appear at this meeting may result in the denial of your license. Individual applicants must appear only in person or by an attorney. Corporate or Limited Liability applicants must appear only by the agent designated on the application or by an attorney. Partnership applicants must appear by a partner listed on the application or by an attorney. If you wish to do so and at your own expense, you may be accompanied by an attorney of your choosing to represent you at this hearing.

You will be given an opportunity to speak on behalf of the application and to respond and challenge any charges or reasons given for the denial. No petitions can be accepted by the committee, unless the people who signed the petition are present at the committee hearing and willing to testify. You may present witnesses under oath and you may also confront and cross-examine opposing witnesses under oath. If you have difficulty with the English language, you should bring an interpreter with you, at your expense, so that you can answer questions and participate in your hearing.

You may examine the application file at this office during regular business hours prior to the hearing date. Inquiries regarding this matter may be directed to the person whose signature appears below.

Limited parking for persons attending meetings in City Hall is available at reduced rates (5 hour limit) at the Milwaukee Center on the southwest corner of East Kilbourn and North Water Street. Parking tickets must be validated in the first floor information booth in City Hall.

PLEASE NOTE: Upon reasonable notice, efforts will be made to accommodate the needs of disabled individuals through sign language interpreters or other auxiliary aids. For additional information or to request this service, contact the Council Services Division ADA Coordinator at (414) 286-2998, Fax - (414) 286-3456, TDD - (414) 286-2025.

JIM OWCZARSKI, CITY CLERK

BY:

Jessica Celella

License Division Manager

If you have questions regarding this notice, please contact the License Division at (414) 286-2238.

200 E. Wells Street, Room 105, City Hall, Milwaukee, WI 53202. [www.milwaukee.gov/license](http://www.milwaukee.gov/license)  
Phone: (414) 286-2238 Fax: (414) 286-3057 Email Address: [License@milwaukee.gov](mailto:License@milwaukee.gov)

CWINE + FREST  
4706-08 W. FdL  
Waiver Request  
cc 7/6/16

November 20, 2017

RE: Elation Wine and Bar Class C Wine License

To Whom It May Concern:

My name is Joseph Clayton. I am writing this letter to request a waiver on my food/liquor license renewal. The reason I am writing this letter is because I purchased a foreclosed commercial property through the City of Milwaukee in July of 2016. The building had extensive damage and needed an insurmountable amount of repair and renovation to achieve the desired occupancy status. Through the course of the renovation, I had some health issues, which required two surgeries and in addition one of our financing lenders dissolved their lending division. With this loss of financing, I had to recoup this money and utilize a number of personal resources to get the project completed. At this time, we are 90% complete and would like to restore our food license as well as our class C wine license, so that we may finally get to utilize this space and show our neighbors all the hard work that has been put into the building.

Please take in consideration the surgeries and financing issues that created some delays relative to our original time frame for completion. Again, we are ready to go and have been working closely with the City of Milwaukee in utilizing the commercial renovation grant to further enhance the aesthetics of this building. It has definitely been long awaited and overdue, but again we are most certainly ready to move forward in this business venture. Thank you for your time and consideration in this matter.

Best Regards,

Joseph Clayton  
Elation Wine & Dessert Bar

Agenda  
2/13/18  
1:45

Date:02/19/2016  
Officer: Daniel Pierce

City of Milwaukee Police Department  
90-5-1.5 Crime Prevention Survey  
Tavern Inspection

Name of Premise: Elation Wine & Dessert Bar  
Address: 4706 W. Fond du Lac Avenue  
Phone:

Owner: Joseph T. Clayton  
Owner address: 4050 N. 44<sup>th</sup> Street  
City State Zip: Milwaukee, WI, 53216  
Owner Phone: 414-520-0406  
Owner email: claytonjoseph@ymail.com

Licensee/Agent:  
Home Address:  
City State Zip:  
Phone:  
Email:

Preferred contact: 414-520-0406

Location currently open:  YES  NO

Projected open date: June 1<sup>st</sup>, 2016

Day's open: S M T W Th F SA ALL

Hours of Operation: Sun: 6:30am-10pm 24 hours Y N  
Mon: 6:30am-10pm  
Tue: 6:30am-10pm  
Wed: 6:30am-10pm  
Thu: 6:30am-10pm  
Fri: 6:30am-12a  
Sat: 6:30am-12a

Premise Type:  Tavern/Bar  
 Restaurant  
 Other:

Licenses currently held:

Alcohol:  Yes  No Class: CWine #: 224946  
 Tobacco:  Yes  No #:  
 Food:  Yes  No #: FREST 224949  
 Occupancy:  Yes  No #:  
 Other:  Yes  No Type: #:  
 Other:  Yes  No Type: #:

Who is your alcohol distributor? Unknown at this time

**Exterior Survey:**

1. Is the area around the location clean?  Yes  No
2. What surrounds the location? (Check all the apply)
  - a.  Park
  - b.  School
  - c.  Youth Center
  - d.  Church
  - e.  Tavern(s) If so, how many 1
  - f.  Residential
  - g.  Other businesses
  - h.  Other:
3. Can you see from the outside of the location into the interior  Yes  No
4. Can you see the employees inside of the location from the outside  Yes  No
5. Are exterior windows free of signage  Yes  No
6. Is there a bus stop?  Yes  No
7. Is there a bus shelter?  Yes  No  N/A
8. Street parking  Yes  No
9. Is there a parking lot  Yes  No
10. Is the parking lot clean?  Yes  No  N/A
11. Is the parking lot well lit?  Yes  No  N/A
12. Valet Parking  Yes  No
  - a. Will this lot have a guard?  Yes  No  N/A
  - b. Will this lot have cameras?  Yes  No  N/A
13. Are there areas where a person could conceal themselves  Yes  No
14. Is there exterior lighting?  Yes  No. Does it appears to be adequate  Yes  No
15. Exterior Payphone?  Yes  No
16. Are there No Loitering Signs posted?  Yes  No
17. Are there exterior security cameras  Yes  No How Many: 4
18. Are the address numbers prominently displayed and easy to see  Yes  No

Exterior Comments: At the time of conducting this survey the building was still awaiting the construction phase. Cameras have yet to be installed, but the owner was able to point out where they would be on the exterior of the building. "No Loitering" signs were not posted, but the owner stated that he intends to. Speaking with the owner he will be having large picture windows installed on the south side of the location and the west side of the location to improve the ability to allow citizens/police to see into/out of the location.

**Camera Survey:**

- 19. Does this location have security cameras?  Yes  No
- 20. Are they in working order?  Yes  No
- 21. What format are the cameras?
  - a. Color  Yes  No
  - b. Digital  Yes  No
  - c. VCR  Yes  No
  - d. Recorded  Yes  No
- 22. How long is footage stored for later viewing: 5-7 Days
- 23. Are there exterior cameras  Yes  No How many: 4
- 24. Are there interior cameras  Yes  No How many: 6
- 25. Do all employees know how to retrieve recorded digital images/footage?  Yes  No
- 26. Cameras located in parking lot  Yes  No  N/A How many: 1

Camera Survey Comments: No cameras are actually on the premise as of yet. Location has yet to go through construction phase. What is detailed above was given to me via statements made by the owner on what his intentions are.

**Interior Survey:**

- 27. What is the planned/posted capacity 75-100 persons
- 28. What is the minimum number of employees that will be on premise 6
- 29. Is the storeowner willing to be a standing complainant regarding loitering?  Yes  No
  - a. If yes have them fill out the standing complaint form and give them two of the commercial signs  Yes  No
- 30. Is the interior of the location neat and clean?  Yes  No
- 31. Does an interior camera face the entrance/exit?  Yes  No
- 32. Are emergency and non-emergency numbers posted near the phone?  Yes  No
- 33. Does the owner know how to contact their police district directly?  Yes  No
  - a. Did you provide a district contact guide to the owner?  Yes  No

Interior Comments: At the time of the survey there is not entrance facing camera, but the owner intends to have one placed there to deter criminal activity.

**Security**

- 34. How many security personnel are going to be employed: 1-2  N/A
- 35. How will they be deployed: Interior 1 Exterior 1  N/A
- 36. What days will they be deployed  Mon  Tue  Wed  Thu  Fri  Sat  Sun  ALL
- 37. Will the security be managed by business  or contracted
- 38. Will they be armed  Yes  No  N/A
- 39. What type of security measures will be used:  N/A
  - Wanding/metal detector wanding for weapons
  - ID Scanner
  - Dress Code
  - Cover Charge
  - Age restriction 21 and over
  - Other
- 40. When at capacity, how will the overflow crowd be managed? counter monitored by employees

41. Will a guard monitor the overflow crowd at all times?  Yes  No

Security Comments: Owner stated that he will have 2 security guards on Fridays and Saturdays. Monday through Thursday will only be one guard.

**ADDITIONAL COMMENTS/RECOMMENDATIONS:**

See comments made after each section



# Alcohol Concentration for 4706-08 W. Fond du Lac Ave

City of Milwaukee, Wisconsin



### - Legend -

- City limits
- Parcels
- Freeways
- Exit ramps
- Entry ramps
- Ramps
- Major streets
- Streets
- Waterways
- Alcohol licenses
  - Class A intoxicating liquor
  - Class A fermented malt beverage
  - Class A liquor and malt
  - Class B fermented malt beverage
  - Class B tavern
  - Class C wine retailer



### - Notes -

Alcohol establishments within a .5 mile radius centered on 4706-08 W. Fond du Lac Avenue on 2/2/16



Department of Administration - ITMD

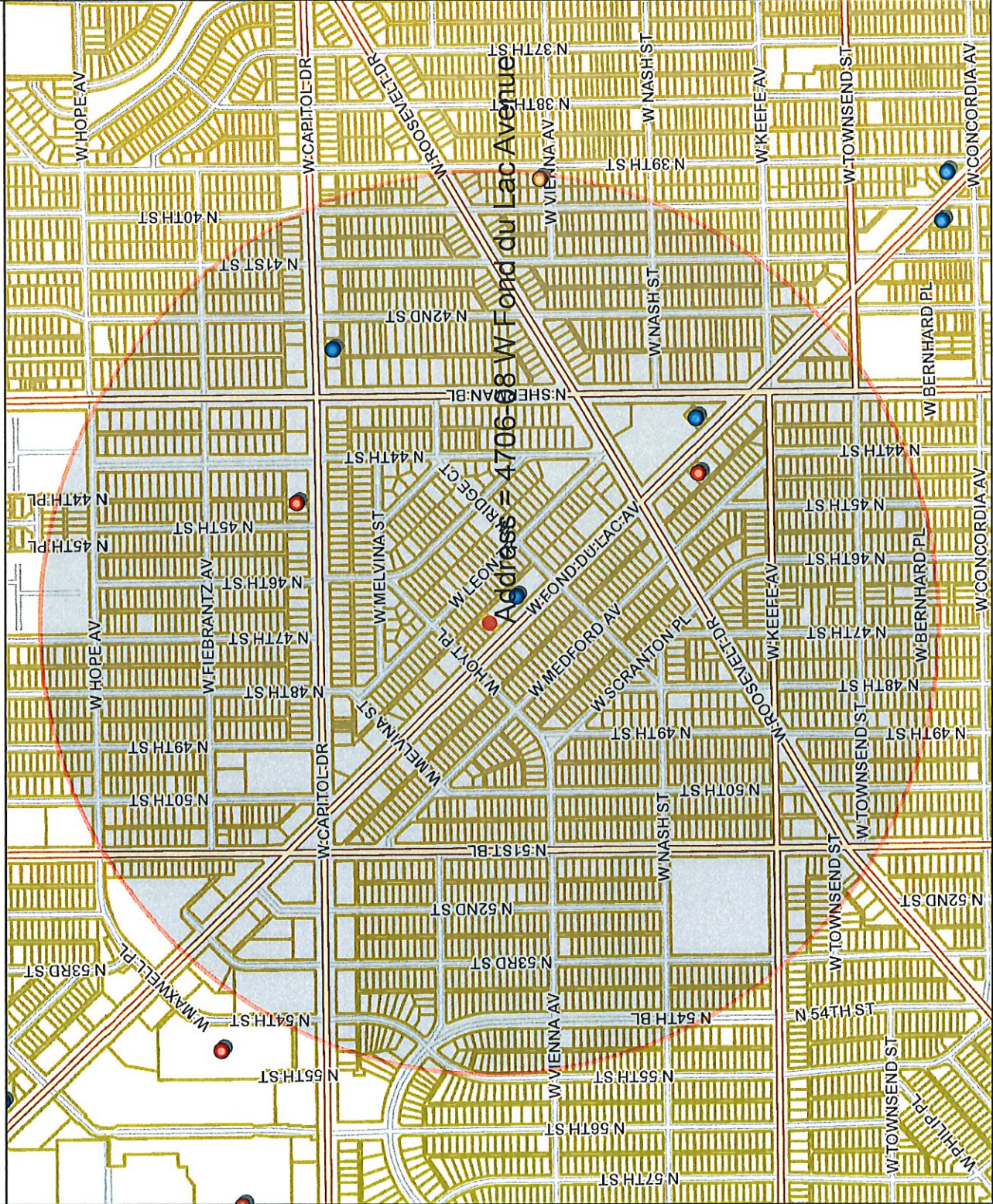

833.3 0 416.67 833.3 Feet

Map Scale: 1: 10,000









Friday, February 02, 2018



# Notice of Public Hearing

---

CLAYTON, Joseph T, Agent  
Elation Wine & Dessert Bar at 4706-08 W Fond du Lac Av  
Request for an unusual circumstance waiver to reinstate the Class C Wine - Service Bar Only and  
Food Dealer License Applications

**Tuesday, February 13, 2018 at 1:45 PM**

To whom it may concern:

The above application has been made by the above named applicant(s). This requires approval from the Licenses Committee and the Common Council of the City of Milwaukee. The hearing before the Licenses Committee will take place on 2/13/2018 at 1:45 PM, in Room 301-B, Third Floor, City Hall. If you wish, you may provide testimony at the hearing regarding the request; see below for further information. You are not required to attend the hearing. Once the Licenses Committee makes its recommendation, this recommendation is forwarded to the full Common Council for approval at its next regularly scheduled hearing. Please review the information below and if you have further questions regarding this process, please contact the License Division at (414) 286-2238.

---

## Important details for those wishing to provide information for the Licenses Committee to consider when making its recommendation:

1. The license application is scheduled to be heard at the above time. Due to other hearings running longer than scheduled, you may have to wait some time to provide your testimony.
2. You must appear in person and testify as to matters that you have personally experienced or seen. (You cannot provide testimony for your neighbor, parent or anyone else; this is considered hearsay and cannot be considered by the committee.)
3. No letters or petitions can be accepted by the committee (unless the person who wrote the letter or the persons who signed the petition are present at the committee hearing and willing to testify).
4. Persons opposed to the license application are given the opportunity to testify first; supporters may testify after the opponents have finished.
5. When you are called to testify, you will be sworn in and asked to give your name, and address. (If your first and/or last names are uncommon please spell them.)
6. You may then provide testimony.
  - a. Include only information relating to the above license application.
  - b. Include only information you have personally witnessed or seen.
  - c. Provide concise and relevant information detailing how this business has affected or may affect the peaceful enjoyment of your neighborhood.
  - d. If by the time you have the opportunity to testify, the information you wish to share has already been provided to the committee, you may state that you agree with the previous testimony. Redundant or repetitive testimony will not assist the committee in making its recommendation.
7. After giving your testimony, the members of the Licenses Committee and the licensee may ask questions regarding the testimony you have given or other factors relating to the license application.
8. Business Competition is not a valid basis for denial or non-renewal of a license.  
**Please Note: If you have submitted an objection to the above application your objection cannot be considered by the committee unless you personally testify at the hearing.**

OCCUPANT	MAIL ADDRESS	CITY, STATE ZIP
CURRENT OCCUPANT	4619 W LEON TER	MILWAUKEE, WI 53216
CURRENT OCCUPANT	4618A W LEON TER	MILWAUKEE, WI 53216
CURRENT OCCUPANT	4622 W LEON TER	MILWAUKEE, WI 53216
CURRENT OCCUPANT	4645 W FOND DU LAC AVE	MILWAUKEE, WI 53216
CURRENT OCCUPANT	4623 W FOND DU LAC AVE	MILWAUKEE, WI 53216
CURRENT OCCUPANT	4531 W LEON TER	MILWAUKEE, WI 53216
CURRENT OCCUPANT	4541 W LEON TER	MILWAUKEE, WI 53216
CURRENT OCCUPANT	4609A W LEON TER	MILWAUKEE, WI 53216
CURRENT OCCUPANT	4604 W LEON TER	MILWAUKEE, WI 53216
CURRENT OCCUPANT	4628 W LEON TER	MILWAUKEE, WI 53216
CURRENT OCCUPANT	4729 W FOND DU LAC AVE	MILWAUKEE, WI 53216
CURRENT OCCUPANT	4735 W FOND DU LAC AVE	MILWAUKEE, WI 53216
CURRENT OCCUPANT	4544 W LEON TER	MILWAUKEE, WI 53216
CURRENT OCCUPANT	4618 W LEON TER	MILWAUKEE, WI 53216
CURRENT OCCUPANT	4719 W FOND DU LAC AVE	MILWAUKEE, WI 53216
CURRENT OCCUPANT	4647 W FOND DU LAC AVE	MILWAUKEE, WI 53216
CURRENT OCCUPANT	4635 W FOND DU LAC AVE	MILWAUKEE, WI 53216
CURRENT OCCUPANT	4525 W LEON TER	MILWAUKEE, WI 53216
CURRENT OCCUPANT	4535 W LEON TER	MILWAUKEE, WI 53216
CURRENT OCCUPANT	4546 W LEON TER	MILWAUKEE, WI 53216
CURRENT OCCUPANT	4713 W FOND DU LAC AVE	MILWAUKEE, WI 53216
CURRENT OCCUPANT	4513 W LEON TER	MILWAUKEE, WI 53216
CURRENT OCCUPANT	4609 W LEON TER	MILWAUKEE, WI 53216
CURRENT OCCUPANT	4610 W LEON TER	MILWAUKEE, WI 53216
CURRENT OCCUPANT	4703 W FOND DU LAC AVE	MILWAUKEE, WI 53216
CURRENT OCCUPANT	4627 W FOND DU LAC AVE	MILWAUKEE, WI 53216
CURRENT OCCUPANT	4603 W LEON TER	MILWAUKEE, WI 53216
CURRENT OCCUPANT	4534 W LEON TER	MILWAUKEE, WI 53216
CURRENT OCCUPANT	4617 W LEON TER	MILWAUKEE, WI 53216
CURRENT OCCUPANT	4625 W LEON TER	MILWAUKEE, WI 53216
CURRENT OCCUPANT	4701 W FOND DU LAC AVE	MILWAUKEE, WI 53216
CURRENT OCCUPANT	4641 W FOND DU LAC AVE	MILWAUKEE, WI 53216
CURRENT OCCUPANT	4635A W LEON TER	MILWAUKEE, WI 53216
CURRENT OCCUPANT	4622A W LEON TER	MILWAUKEE, WI 53216
CURRENT OCCUPANT	4629 W FOND DU LAC AVE	MILWAUKEE, WI 53216
CURRENT OCCUPANT	4639 W FOND DU LAC AVE	MILWAUKEE, WI 53216
CURRENT OCCUPANT	4545 W LEON TER	MILWAUKEE, WI 53216
CURRENT OCCUPANT	4615 W LEON TER	MILWAUKEE, WI 53216
CURRENT OCCUPANT	4540 W LEON TER	MILWAUKEE, WI 53216
CURRENT OCCUPANT	4629 W LEON TER	MILWAUKEE, WI 53216
CURRENT OCCUPANT	4635 W LEON TER	MILWAUKEE, WI 53216
CURRENT OCCUPANT	4725 W FOND DU LAC AVE	MILWAUKEE, WI 53216
CURRENT OCCUPANT	4633 W FOND DU LAC AVE	MILWAUKEE, WI 53216
CURRENT OCCUPANT	4513 W LEON TER 2	MILWAUKEE, WI 53216

Total Records: 44

Radius: 250.0 feet and Center of Circle: 4706 W Fond du Lac Av



# BUSINESS LICENSE PLAN OF OPERATION

ccl-busplan 12/11/15

Office of the City Clerk License Division  
200 E. Wells St. Room 105, Milwaukee, WI 53202  
(414) 286-2238 www.milwaukee.gov/license e-mail address: license@milwaukee.gov

## 1. Type of Business

- Applying for:  Extended Hours Establishment  Filling Station  
 Self Service Laundry  Rooming House  Hotel/Motel  Massage Establishment  
 Other (supplemental application for specific license also required)

Provide a detailed description of the type of business you plan on operating:

Restaurant

Do you have any experience operating this type of business?  No  Yes If yes, explain:

## 2. Business Operations

- a. Proposed Opening Date: 6/1/16
- b. Is this premise under construction?  No  Yes If yes, list estimated completion date: \_\_\_\_\_
- c. Is this a franchise?  No  Yes
- d. Is this premises currently licensed?  No  Yes If yes, list type of license: \_\_\_\_\_
- e. Is the current licensee operating?  No  Yes If no, list date closed: \_\_\_\_\_
- f. Do you have future plans for other businesses, licenses or permits at this location?  No  Yes  
If yes, explain: \_\_\_\_\_
- g. Have you previously held an Extended Hours License in Milwaukee?  No  Yes  
If yes, list address(es): \_\_\_\_\_
- h. Are other businesses operating in the same building?  No  Yes If yes, describe: \_\_\_\_\_

## 3. Litter & Noise

- a. How are grounds kept clean?  Sweep  Pressure Wash  Pick Up Litter  Other: \_\_\_\_\_
- b. How often will grounds be cleaned?  Daily  Weekly  As Needed  Monthly  Other: \_\_\_\_\_
- c. Grounds cleaned by:  Licensee  Building Owner  Employees  Hired Maintenance  Other: \_\_\_\_\_
- d. How are noise issues prevented and/or addressed?  Security  Manager approaches customer(s)  Call Police  
 Signs Posted  Other: \_\_\_\_\_
- e. Will a sound amplification system be used?  No  Yes If yes, describe: \_\_\_\_\_

## 4. Smoking & Sanitation

- a. Are there designated outdoor smoking areas?  No  Yes If yes, describe: \_\_\_\_\_
- b. Number of Garbage Cans: Inside: 6 Locations: Kitchen, Bathroom, Bar + Dining Area  
Outside: 4 Locations: Front (1), Side (1), Rear (2)
- c. Is a crowd control barrier used?  No  Yes - If yes, describe: to control crowd + secure full parking lot
- d. How many restrooms are on the premises? 2
- e. Name of solid waste contractor:  Advanced Disposal  Waste Management  Other: \_\_\_\_\_

## 5. Security

- a. Are there onsite parking spaces?  No  Yes If yes, how many? 10  
 Describe parking security plan: Security directed (10 spots) + Self Service parking on street
- b. Is there a loading zone?  No  Yes If yes, describe loading area security plan \_\_\_\_\_
- c. Will you have security personnel on premise?  No  Yes If yes, how many? 2  
 What are their responsibilities? monitor interior/exterior, crowd control,  
 Is security equipment used?  No  Yes If yes, describe security cameras  
 List their licensing, certification, or training credentials none  
 Will there be security cameras?  No  Yes If yes, where? Interior (bar/dining) Exterior  
 Will searches/identification verification be conducted upon entry?  No  Yes If yes, describe Security checks IDs for patrons

## 6. Percentage of Sales (must total 100%)

Alcohol <u>40</u> %	Food <u>60</u> %	Secondhand Merchandise _____ %	Precious Metals & Gems _____ %
Entertainment _____ %	Cigarettes _____ %	Personal Services (such as tattoo, body piercing, salon, tailor, tanning, etc.) _____ %	Other _____ % Describe: _____
Pawnbroker Activity _____ %	Salvaged Materials _____ % (such as scrap metal)		

## 7. Businesses/Licenses on the Premises (check all that apply):

### Type 1

- Full Service Restaurant  Cafe/Coffee Shop  Deli or Fast Food Restaurant  Private/Fraternal/Veterans Club
- Night Club  Tavern  Cocktail Lounge  Teen Club
- Banquet Hall  Sports Facility  Bowling Alley
- Hotel/Motel: Number of Floors: \_\_\_\_\_ Number of Rooms: \_\_\_\_\_  
 Rooming House: Number of Floors: \_\_\_\_\_ Number of Rooms: \_\_\_\_\_

### Type 2

- Liquor Store  Corner Store  Supermarket  Convenience Store
- Gas Station  Amusement/Phonograph Distributor  Recycling, Salvage or Towing
- Used Car Dealer  Personal Service Establishment  
(such as tattoo business, hair salon, tailor, etc.)  Recording Studio

What other licenses/permits will you hold at this location? (check all that apply)

- Occupancy Permit  Cigarette & Tobacco  Gas Station  Extended Hours  Class "B" Tavern  Weights & Measures
- Secondhand Dealer  Precious Metal & Gem  Other: \_\_\_\_\_

## 8. Legal Capacity (only if a Type 1 premises in #7 above)

Capacity \_\_\_\_\_ (Call the Milwaukee Development Center at 414-286-8211 if you have questions.)



## 9. Premises Description

d. Identify all area(s) of the premises that will be used in operating this business (include areas used only for storage):

1<sup>st</sup> Floor  2<sup>nd</sup> Floor  Basement Storage  Patio  Beer Garden  Sidewalk Café  Deck  Rooftop

Other: Describe: \_\_\_\_\_

e. Describe Location:  Major Thoroughfare  Secondary Street  Other: \_\_\_\_\_

f. Nearest Major Cross Street: Fond du Lac Avenue

g. Describe Building:  Free Standing Building  Strip Mall  Other: \_\_\_\_\_

h. Describe Premises Structure:  Single Story  Multi-Story - # of Stories \_\_\_\_\_  Other: \_\_\_\_\_

i. Describe Surrounding Area:  Commercial  Residential  Industrial  Other: \_\_\_\_\_

j. Building Owner Name: A-1 Home Solutions, LLC Phone Number: 414-393-8425

Business Owner Address: 4050 N. 44<sup>th</sup> Street Milwaukee, WI 53216

## 10. Hours of Operation & Customers

Will customers be entering the premises?  No  Yes

Day of the Week	Proposed Hours of Operation:		Estimated Number of Customers expected each day	Potential Age Range of Customers	Class B Tavern Applicant Only: Age Restriction (If none, write 'None')
	Open Time (include a.m. or p.m.)	Close Time (include a.m. or p.m.)			
Sunday	6:30 am	10:00 pm	50	30-45	
Monday	6:30 am	10:00 pm	50-60	30-45	
Tuesday	6:30 am	10:00 pm	60	30-45	
Wednesday	6:30 am	10:00 pm	60	30-45	
Thursday	6:30 am	10:00 pm	60-75	30-45	
Friday	6:30 am	12:00 am	100	30-45	
Saturday	6:30 am	12:00 am	100	30-45	

Extended Hours Establishment License is required for any convenience store, filling station, personal service establishment (such as tattoo, body piercing, salon, tailor, tanning, etc.), recording studio or restaurant which is open between the hours of 12 a.m. and 5 a.m.

Entertainment Indoor Closing Hours: If alcohol beverage establishment, same as alcohol license hours.  
If non-alcohol establishment 1:00 am Sunday to Thursday; 1:30 am Friday and Saturday.

Entertainment Outdoor Closing Hours: 10:00 pm Sunday – Thursday; 12:00 am Friday and Saturday,  
unless otherwise approved by Common Council in licensee's plan of operation.

## 11. Signature(s)

  
Sole Proprietor, Partner, Agent, or 20% or more Shareholder

\_\_\_\_\_  
Signature of additional partner or 20% or more Shareholder

See Application Information for a list of all required application forms.



**ALCOHOL BEVERAGE & PUBLIC ENTERTAINMENT PREMISES  
SUPPLEMENTAL PLAN OF OPERATION**

Office of the City Clerk License Division  
200 E. Wells St. Room 105, Milwaukee, WI 53202  
(414) 286-2238 e-mail address: license@milwaukee.gov www.milwaukee.gov/license

Legal Entity Name: <u>Elation Wine &amp; Dessert Bar, LLC</u>
Premise Address: <u>4706-08 W Fond du Lac Avenue</u>
<b>Proximity of Premises to Church, School, Daycare Center or Hospital</b>
Is there at least 300 feet between the building and any church, school, daycare center or hospital? <input checked="" type="checkbox"/> Yes <input type="checkbox"/> No
<b>"Service Bar Only" Designation</b>
If applying for Class B or C license, are you applying for "Service Bar Only"? <input type="checkbox"/> No <input checked="" type="checkbox"/> Yes
Service Bar Only means customers cannot sit at the bar. Alcohol is served to patrons seated at tables. No stools, chairs or other articles of furniture shall be placed at the service bar for patrons to sit upon.
<b>Business Information</b>
a) Are you taking out this application for anyone that may not be eligible for a license? <input checked="" type="checkbox"/> No <input type="checkbox"/> Yes If yes, list name and address: _____
b) Will the agent, a partner or the individual licensee be conducting the day-to-day operations of the business? <input type="checkbox"/> No <input checked="" type="checkbox"/> Yes If no, list the name and address of the person(s) who will: _____
Class B Applicants: If the agent, a partner or the individual licensee will not be conducting the day-to-day operations of the business, the person(s) listed above must obtain a Class B Managers license.
c) Does anyone else have money invested or any other interest in this business? <input checked="" type="checkbox"/> No <input type="checkbox"/> Yes If yes, explain: _____
d) Have you made an agreement with anyone to repay any loan or any other payments based upon income from the business? <input checked="" type="checkbox"/> No <input type="checkbox"/> Yes If yes, list name and address: _____
<b>Proof of Ownership, Lease, or Offer to Purchase (new &amp; transfer applicants only)</b>
Submit proof of ownership, lease, or offer to purchase the building with this application. A lease or offer to purchase must: a) Be in the same legal entity name as that apply for the license b) Reflect the same address as the premises address on this application c) Reflect current dates and d) Be signed by the lessor/seller and lessee/buyer
<b>Property Information (new &amp; transfer applicants only)</b>
a) Do you own or lease the building? <input type="checkbox"/> Own <input checked="" type="checkbox"/> Lease
b) Who owns the fixtures (for example, coolers, etc.)? <u>Elation Wine &amp; Dessert Bar, LLC</u>
c) Are you purchasing the stock and/or fixtures? <input type="checkbox"/> No <input checked="" type="checkbox"/> Yes If yes, amount paid \$ <u>10,000.00</u>
d) Total amount paid for business \$ <u>0</u>
e) Total amount paid for goodwill of the business \$ <u>0</u>
Goodwill comprises the reputation and customer relationships of an existing business. If the price you pay for the business exceeds the fair market value of all of the rest of the assets of the business, the excess may be considered goodwill.
f) Have you made arrangements with the seller for payment of personal property taxes? <input type="checkbox"/> No <input checked="" type="checkbox"/> Yes

**See Application Information for a list of all required application forms.**

**Lease Information (new & transfer applicants who are leasing the premises only)**

- a) Date lease begins 2/1/16 Ends 2/1/18
- b) Monthly rental \$ 2,500.00
- c) Do you have an option to renew the lease?  No  Yes
- d) Does your lease allow for assignment to another party without the consent of the owner?  No  Yes
- e) For what length of time have you been guaranteed occupancy (number of years)? 5 yrs
- f) In addition to paying the monthly rental, will you have to pay anything additional to the owner of the building to guarantee performance of the lease?  No  Yes If yes, explain \_\_\_\_\_
- g) Does the present owner or occupancy object to the granting of your license?  No  Yes  
If yes, explain \_\_\_\_\_

**Change of Agent Applicants Only**

Have there been any changes to the floor plan since the last application was submitted?  No  Yes

If no, a new floor plan is not required. If yes, submit a new floor plan and explain the change(s): \_\_\_\_\_

**Notarized Signatures of Applicants**

SUBSCRIBED AND SWORN TO BEFORE ME

This 2nd day of February, 2016

*[Signature]*

(Clerk/Notary Public)

My Commission Expires 09-04-2016

\*Notary Seal must be affixed.

*[Signature]*

Sole Proprietor, Partner, 20% or more Shareholder, or Agent – only if there are no 20% or more shareholders

\_\_\_\_\_  
Additional partner or 20% or more shareholder

Note: All information contained in this application is subject to approval by the Common Council. Deviating from approved plan of operation will subject licensee to citations, and/or suspension or non-renewal of the license. Contact the License Division for information on how to request changes.

**New and transfer of premise applicants must submit the following:**

- Proof of ownership, lease or offer to purchase the building
- Detailed floor plan
- If a restaurant, copy of the menu

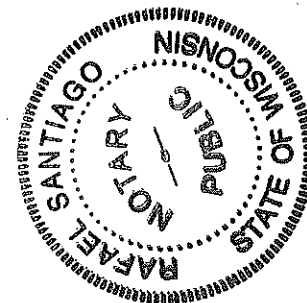



**FOOD DEALER LICENSE PLAN OF OPERATION**  
 OFFICE OF THE CITY CLERK, LICENSE DIVISION  
 CITY HALL, 200 E. WELLS ST, ROOM 105, MILWAUKEE, WI 53202 •  
 (414) 286-2238 • license@milwaukee.gov • www.milwaukee.gov/license

**Legal Entity Name:** Elation Wine & Dessert Bar, LLC  
**Premises Address:** 4706-08 W Fond du Lac Avenue

**1. Application Type**

Is this a new food business or are you taking over a food business which is currently operating?  
 Taking over a currently operating, licensed food business  
 New business (includes taking over a closed food business)

Will you be sharing kitchen space with another food establishment?  
 Yes, I intend to rent space in my kitchen to other food businesses  
 Yes, I am renting space from another food business which will also be using the kitchen\*  
 No, I will be the only food business using the space

\*If renting space in a commercial kitchen with another operator, a completed and signed Shared Kitchen Agreement is required.  
 The form is available at [www.milwaukee.gov/license](http://www.milwaukee.gov/license)

Provide a brief description of the food establishment.  
 Elation is a 5,000 sqft full service lounge that features a full service dessert menu w/ light fare appetizers. It is a destination choice that offers an upscale but casual dining experience

Attach a copy of your menu or general listing of the types of food products that will be sold. Indicate what information you will be including:  
 Menu     List of the types of products (for example: packaged foods, deli case, meat department)

What is the anticipated opening date or date of change of ownership: 6/1/16

**2. Construction, Remodeling and Equipment**

Are any construction, remodeling or equipment changes planned?  Yes     No    *If no, skip to section 3.*

Scope of the planned project?  
 New construction or conversion of an existing structure to be used as a food establishment  
 Renovation/remodeling of a food establishment, which may or may not include equipment changes  
 Renovation/remodeling limited to the installation/change/replacement of food equipment

Provide a brief summary of the proposed construction, remodeling and/or equipment change:  
 Full interior remodel adding Commercial Kitchen, 2 full bathrooms, office and dining hall area. New rubber flat roof system on exterior

Note: Building permits may be required. Contact the City of Milwaukee Development Center.

Date alterations/changes planned to begin 2/15/16

Name, address and phone number of architect  
 \_\_\_\_\_

Name, address and phone number of general contractor  
 Advanced Design Solutions 414-520-0406



### 3. Premises Description

Will food be prepared/sold at a single site or at multiple sites? (multiple site example: a hotel with multiple dining rooms or bars):

Single  Multiple

- If multiple sites will be used, how many separate sites will be used?

List all sites and briefly describe the nature of the food activities at each site:

Single site operation. Preparation of desserts and light fare appetizer dishes.

Are any outdoor operations planned?  Yes  No

- If yes, what activities will be conducted outdoors (check all that apply):

Bar  Cooking/Grilling  Dining - Patio  Dining - Sidewalk (DPW permit required)  Storage

Other, Specify

Is seating provided on site for dining?  Yes  No

- If yes, are there additional banquet facilities other than the main dining area?  Yes  No

Total square footage of the establishment (exclude space used for other purposes other than food)

Number of Full Time Employees

Number of Part Time Employees

### 4. Business Type

Select the one that best describes the proposed business:

Bed & Breakfast

Community Food Program - A meal site or food pantry where food is provided free of cost to persons in need, or to organizations serving persons in need.

Distiller or Brewer - Facility primarily engaged in the production of alcohol beverages.

Food Distributor - A business that transports food for sale to retail and wholesale establishments, and does not prepare any food items

- Is food stored on site?  Yes  No

Food Manufacturer - A commercial operation that produces, packages, labels, or stores food, but primarily does not provide food directly to a consumer. Food is sold to distributors, retailers or restaurants. There may be a small retail store onsite where only the manufacturers products are sold, but the majority of product is sold to other licensed food establishments.

- Is there a retail store onsite?  Yes  No

Food Store - An establishment in which the majority of food sales consist of beverages or multi-serving food products requiring further preparation prior to consumption. Examples of food stores include bakeries, grocery stores, convenience stores, coffee shops, liquor stores. Food stores include businesses whose primary business is other than food (book store, pharmacy, etc.), but offer convenience food items.

- If a food store, are you considered a convenience food store (see definition below)?  Yes  No  
A convenience food store contains less than 5,000 sq. ft. of retail sales space AND has as its primary business the sale of basic food items and in addition sells household products. Basic food items may include, but are not limited to, milk and dairy products, bread products, prepared sandwiches, frozen entrees, refrigerated food and baby food. Household products may include, but are not limited to, cleaning products, paper products, baby products and pet food.

School Lunch Program - Lunch program operated by an outside contractor. (If directly operated by the school, this license is not needed.)

Restaurant - An establishment in which the majority food sales consist of meals or other items ready for immediate consumption.

Shared Kitchen, Commissary or Base - A commercial kitchen used for the production of food to be served or sold at another location; a base of operations for a food peddler, caterer or seasonal market vendor.

- Will meals make up greater than 50% of your sales?  Yes  No

**4. Business Type (Continued)**

Type of sales (check all that apply, even if it reflects a small percentage of the proposed business)

Made directly to the general public or end consumer (includes internet sales)

Made to other food establishments (wholesaler, distributors, retail or restaurants) who will resell your product(s)

What percentage of your planned food sales will be meals versus grocery items?

60 % from meals (ready-to-eat food)

40 % from grocery items (foods typically requiring preparation before serving, includes typical grocery items, beverages, bakery items and raw produce)

Will customers be able to purchase food through a drive through?  Yes  No

Will customers be able to purchase food from a self-service salad or food bar?  Yes  No

Will food be prepared on site and then transported for sale or consumption at another location?  Yes  No

If yes, check all the reasons why the food will be transported:

Catering     Delivery     Base for Mobile Food Peddler     Base for temporary or seasonal food stand

Other-Describe: \_\_\_\_\_

---

**5. ISSUANCE OF LICENSE**

Will any alcohol or intoxicating beverages be sold at the establishment?  Yes  No

If yes, what type of license do you have or will you be applying for?

Class A fermented malt beverage license     Class A liquor license

Class B fermented malt beverage licenses     Class B liquor license

Class C wine license

If yes, if your food license is approved prior to the alcohol license, when would you like the food license issued?

immediately so you can open your food business     at the same time as the alcohol license

---

**6. AFFIRMATION OF UNDERSTANDING – PERMIT NEEDED TO OPERATE**

Read and initial each item confirming your understanding:

JC I understand that an inspection and sign off by the Health Department is required before my permit may be issued.

JC I understand that the Health Department will review my application and will update the application based on what is observed during my onsite inspection. My representative onsite at the time of inspection must have the authority to approve corrections to my application.

JC I understand that an occupancy permit must be issued and an inspection may be required from the Department of Neighborhood Services before my permit may be issued.

JC I understand that the Department of Neighborhood Services must sign off on my application with the License Division before my permit may be issued.

JC I understand the local council member must approve or deny my request before my permit is eligible to be issued. If denied, I understand that I may appeal and be scheduled for a hearing before the License Committee of the Common Council.

JC I understand that the License Division must have proof of payment for the associated permit fees before my permit may be issued.

JC I understand that all of the above must be complete before my permit is eligible to be issued.

JC I understand that the license for which I am applying must be issued and posted in my business premises prior to opening for business.

Joseph Clayton, will not operate my food business, until the permit has been issued and posted in the establishment.  
Name of Applicant

---

Signature of Applicant: Joseph Clayton      Date: 1/31/16

## Menu Selections

### Appetizers

#### **Bruschetta**

*(A traditional topping of Roma tomatoes, fresh mozzarella, basil, pesto, extra-virgin olive oil and balsamic drizzle)*

#### **Fruit Plate**

*(Fresh seasonal fruit)*

#### **Green Salad**

*(Mixed greens, tomatoes, cucumber, shredded carrots and choice of dressing; add chicken/shrimp)*

#### **Apple Salad**

*(Apples, candied pecans, cranberries and choice of dressing; add chicken/shrimp)*

#### **Buffalo Chicken Wings**

*(Chicken wings smothered in Buffalo Sauce with Celery and Blue Cheese or Ranch Dressing)*

#### **Meat and Cheese Plate**

*(Assortment of aged cheeses and meats)*

#### **Shrimp Cocktail**

*(Fresh lemon, herbs and cocktail sauce)*

#### **Shrimp Skewers**

*(Garlic, cilantro, veggies and fresh greens)*

#### **Glazed Salmon**

*(Brown Sugar glazed salmon on bed of brown rice and broccoli)*

## **Desserts**

### **Carrot Cake**

*(Spiced cake freshly grated carrots, layered w/ white chocolate, cream cheese frosting w/ caramel)*

### **Chocolate Covered Strawberries**

*(Fresh strawberries covered with decadent chocolate)*

### **Chocolate Molten Lava Cake**

*(Dark Chocolate cake w/ molten chocolate center served w/ whipped cream and fresh berries)*

### **Cheesecake**

*(Cheesecake topped w/ strawberry, raspberry or chocolate syrup served w/ whipped cream)*

**Featured Cheesecakes – Oreo, Turtle, Turtle Pecan, Hershey, Reese's, Snickers, Cherry, Caramel, Smores**

***\*Cheesecakes will be featured daily/weekly\****

### **Red Velvet Cake**

*(Three layers of stunning red velvet filled and topped w/ cream cheese icing. Chocolate shavings and a light chocolate drizzle)*

### **Banana Pudding**

*(Vanilla pudding, vanilla wafer cookies, sliced bananas and whipped cream)*

### **Strawberry Shortcake**

*(Decadent pound cake served with sliced strawberries and whipped cream)*

***\*Desserts served a la mode\****



## **Coffee**

*Decaffeinated*

*Espresso*

*Cappuccino*

*Double Cappuccino*

*Latte*

*Mocha*

*Iced Cappuccino*

## **Tea**

*Hot tea/Cold tea*

*Assorted selections (Teavana)*

## **Dessert Infused Drinks**

### **Kahlua Espresso**

*(Kahlua (original, French vanilla, hazelnut), Vanilla, chilled espresso, chocolate rim)*

### **Hawaiian**

*(Coconut, pineapple juice, orange juice, grenadine)*

### **Chocolate**

*(Godiva white or dark chocolate syrup, vanilla, splash of cream, cocoa rim)*

### **White Chocolate Raspberry Truffle**

*(Godiva white chocolate syrup, vanilla, raspberry, splash of cream, white chocolate shavings)*

### **Curious George**

*(Godiva white chocolate, Irish crème, banana syrup, chocolate graham cracker rim)*

### **Dreamsicle**

*(Ice cream, orange juice, orange syrup, sugared rim)*

### **Key Lime Pie**

*(Lime juice, splash of cream, lime wedge, white chocolate graham cracker rim)*

### **Thin Mint**

*(Crave mint, splash of cream, chocolate sauce)*

## **Specialty Drinks**

### **Red Wine Sangria**

(Red wine served w/ fruit and fresh mint leaves)

### **Cherry-Berry Sangria**

(Red wine served w/ cherries and blueberries)

### **Strawberry Honey Sangria**

(White wine served w/ strawberries, honey and a splash of sparkling water)

### **Sparkling Gold Sangria**

(White wine served w/ sweet cherries and raspberries garnished w/ mint leaf)

### **Cherry Sangria**

(Red wine served w/ cherries and orange juice garnished w/ cherry and orange)

### **Strawberry Sangria**

(Red wine served w/ strawberries and oranges)

### **Mock Sangria**

(Features three fruit juices and oranges, pineapple wedges and strawberries)

### **Sunset Sangria**

(Pinot Noir served with lime juice garnished w/ a lime peel and a nectarine)

## **Wine Selections**

### **Red**

Pinot Noir  
Merlot  
Zinfandel  
Cabernet

### **White**

Riesling  
Moscato  
White Zinfandel  
Pinot Grigio  
Sauvignon Blanc  
Chardonnay

### **Sparkling**

Brut  
J. Roget Asti  
Veuve Clicquot

## **Champagne Selections**

Moet & Chandon  
Moet Ice Imperial  
Moet Imperial Rose  
Ace of Spades  
Bel -Air

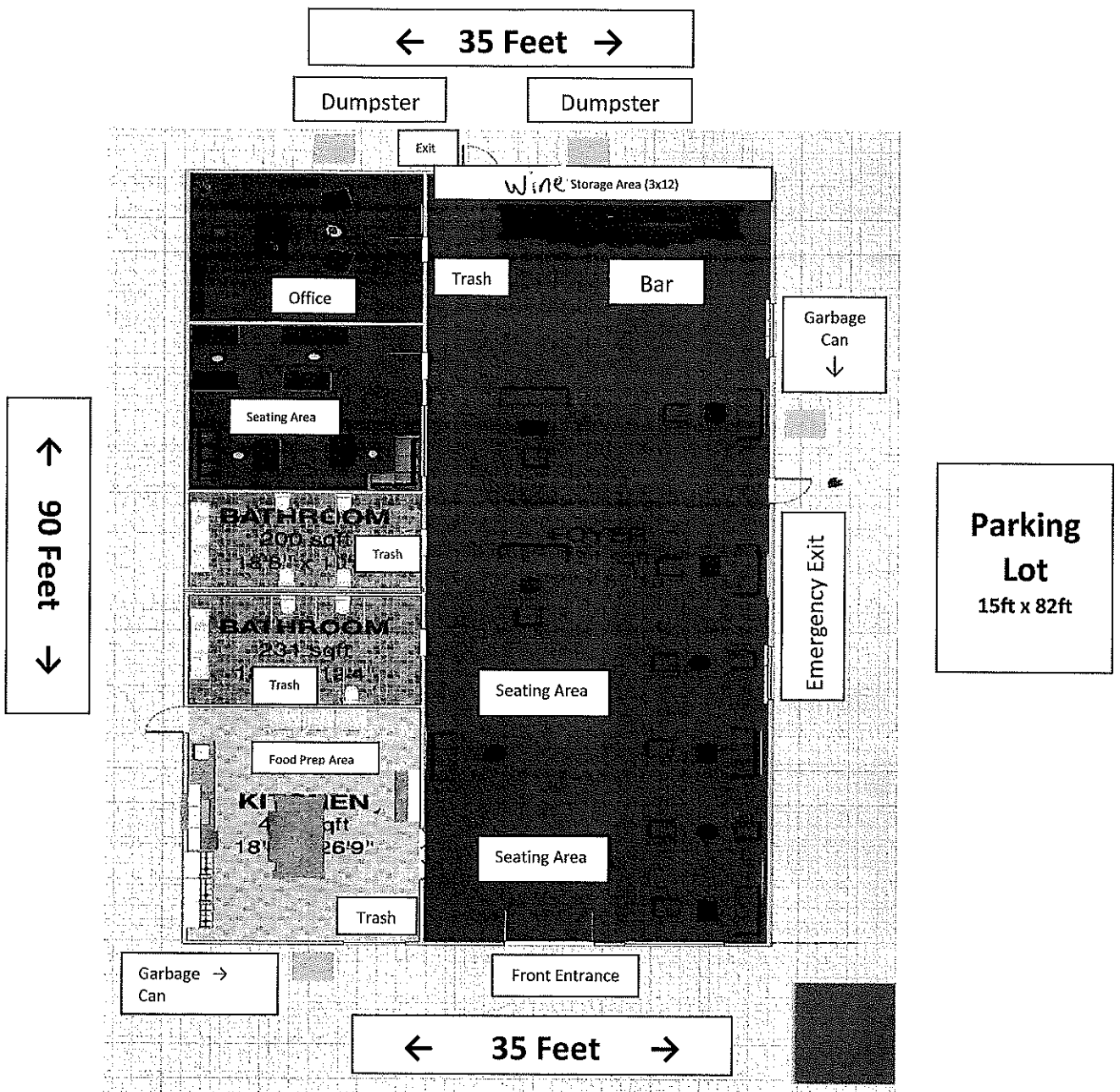

Fond du Lac Avenue

← North

Joseph Clayton – Agent  
 Elation Wine & Dessert Bar, LLC

Total Square Feet – 5,300

4706-08- W Fond du Lac Ave Milwaukee, WI 53216  
 1/31/2016

Elation Wine & Dessert Bar

CWINE 41106-08 W Ford du Lac Ave

# CERTIFICATE OF COMPLETION



This certificate is awarded to

## ELATION WINE & DESSERT BAR

in recognition of completion of the Pivot Program with the  
CITY OF MILWAUKEE

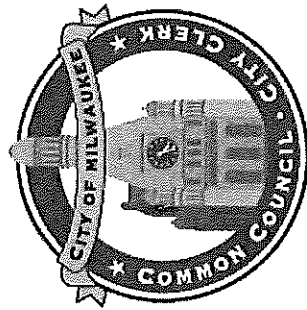

*Jane R Oefner*  
Signature

Jan. 30, 2017  
Date

*Jason Schumke*  
Signature

Jan. 30, 2017  
Date

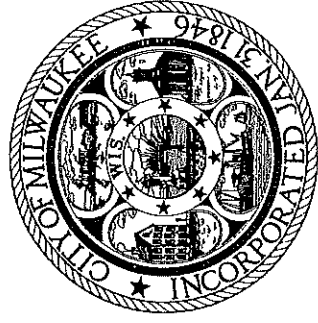

41106 W Ford du Lac



CITY OF MILWAUKEE  
OFFICE OF THE CITY CLERK

Friday, February 02, 2018

COMMITTEE MEETING NOTICE

AD 07

HADDAD, Jay, Agent  
Center Street Foods LLC  
4630 W Center St

Milwaukee, WI 53210

You are requested to attend a hearing which is to be held in Room 301-B, Third Floor, City Hall on:

**Tuesday, February 13, 2018 at 01:45 PM**

**Regarding:** Your Class A Malt and Food Dealer License Renewal Applications as agent for "Center Street Foods LLC" for "Center Street Foods" at 4630 W Center

There is a possibility that your application may be denied for one or more of the following reasons: The recommendation of the committee regarding the application shall be based on evidence presented at the hearing. Per MCO 85-4-4, unless otherwise specified in the code, probative evidence concerning non-renewal, suspension or revocation may include evidence of the following: failure of the applicant to meet municipal qualifications, pending charges against or the conviction of any felony, misdemeanor, municipal offense or other offense, the circumstances of which substantially relate to the circumstances of the particular licensed or permitted activity, by the applicant or by any employee or other agent of the applicant. If the activities of the applicant involve a licensed premises, whether the premises tends to facilitate a public or private nuisance or has been the source of congregations of persons which have resulted in any of the following: disturbance of the peace; illegal drug activity; public drunkenness; drinking in public; harassment of passers-by; gambling; prostitution; sale of stolen goods; public urination; theft; assaults; battery; acts of vandalism including graffiti, excessive littering, loitering, illegal parking, loud noise at times when the licensed premise is open for business; traffic violations; curfew violations; lewd conduct; display of materials harmful to minors, pursuant to s. 106-9.6; or any other factor which reasonably relates to the public health, safety and welfare, or failure to comply with the approved plan of operation. See attached police report or correspondence.

**Notice for applicants with warrants or unpaid fines:**

Proof of warrant satisfaction or payment of fines must be submitted at the hearing on the above date and time. Failure to comply with this requirement may result in a delay of the granting/denial of your application.

Failure to appear at this meeting may result in the denial of your license. Individual applicants must appear only in person or by an attorney. Corporate or Limited Liability applicants must appear only by the agent designated on the application or by an attorney. Partnership applicants must appear by a partner listed on the application or by an attorney. If you wish to do so and at your own expense, you may be accompanied by an attorney of your choosing to represent you at this hearing.

You will be given an opportunity to speak on behalf of the application and to respond and challenge any charges or reasons given for the denial. No petitions can be accepted by the committee, unless the people who signed the petition are present at the committee hearing and willing to testify. You may present witnesses under oath and you may also confront and cross-examine opposing witnesses under oath. If you have difficulty with the English language, you should bring an interpreter with you, at your expense, so that you can answer questions and participate in your hearing.

You may examine the application file at this office during regular business hours prior to the hearing date. Inquiries regarding this matter may be directed to the person whose signature appears below.

Limited parking for persons attending meetings in City Hall is available at reduced rates (5 hour limit) at the Milwaukee Center on the southwest corner of East Kilbourn and North Water Street. Parking tickets must be validated in the first floor information booth in City Hall.

PLEASE NOTE: Upon reasonable notice, efforts will be made to accommodate the needs of disabled individuals through sign language interpreters or other auxiliary aids. For additional information or to request this service, contact the Council Services Division ADA Coordinator at (414) 286-2998, Fax - (414) 286-3456, TDD - (414) 286-2025.

JIM OWCZARSKI, CITY CLERK

BY:

Jessica Celella

License Division Manager

If you have questions regarding this notice, please contact the License Division at (414) 286-2238.

200 E. Wells Street, Room 105, City Hall, Milwaukee, WI 53202. [www.milwaukee.gov/license](http://www.milwaukee.gov/license)  
Phone: (414) 286-2238 Fax: (414) 286-3057 Email Address: [License@milwaukee.gov](mailto:License@milwaukee.gov)



# MILWAUKEE POLICE DEPARTMENT LICENSING

## CRIMINAL RECORD/ORDINANCE VIOLATION/INCIDENTS SYNOPSIS

**DATE:** 12/28/2017  
**LICENSE TYPE:** AMALT  
**NEW:**   
**RENEWAL:**

**No. 267849**  
**Application Date:** 12/28/2017

**License Location:** 4630 West Center Street  
**Business Name:** Center Street Foods

**Licensee/Applicant:** Haddad, Jay  
(Last Name, First Name, MI)  
**Date of Birth:** 04/10/1970

**Home Address:** 149 Linden Lane #3  
**City:** Thiensville **State:** WI **Zip Code:** 53092  
**Home Phone:** 414-855-6384

This report is written by Police Officer David NOVAK, assigned to the License Investigation Unit, Days.

The Milwaukee Police Department's investigation regarding this application revealed the following:

1. On 03/31/2011 the applicant, using the name Jihad Hadadd, was charged in Milwaukee county with Place/Transport Loaded Firearm/Vehicle.

**Charge:** Place/Transport Loaded Firearm/Vehicle  
**Finding:** Guilty  
**Sentence:** Fine  
**Date:** 10/25/2011  
**Case:** 2011CM001908

=====

2. On 09/24/2015 Officers went to Center Street Market, 4630 W. Center St. for a licensed premises check. The applicant was not on scene and the clerk, Mohammad ALTARAWI, did not have a Class D Operators license. The applicant was issued a citation for Responsible Person on Premises Required.

**Charge:** Responsible Person on Premises Required  
**Finding:** Guilty  
**Sentence:** Fined \$378.00  
**Date:** 03/09/2016  
**Case:** 15058542

3. On 09/27/2015 Officers went to Center Street Market, 4630 W. Center St. for a licensed premises check. The applicant was not on scene and the clerk, Mohammad ALTARAWI, did not have a Class D Operators license. The applicant returned while officers were on scene and stated he had to leave to pick up his kids. The applicant was issued a citation for Responsible Person on Premises Required.

Charge: Responsible Person on Premises Required  
Finding: Dismissed  
Sentence:  
Date: 03/09/2016  
Case: 15058543

=====  
Items #2 and 3 updated with disposition on 12/19/2016

4. On 10/01/2016 a 17 year old working in conjunction with the Milwaukee Police Department and WI WINS Tobacco initiative, was able to purchase a 2 pack of Swisher Sweet cigars from the clerk at Center Street Foods, 4630 W. Center St. The clerk denied the sale but was the only clerk in the store. The applicant was mailed a MARTS letter.

=====

5. The applicant did register for MART regarding Item #4 but failed a mystery shopper and was issued a citation for the original incident.

Charge: Sale of Cigarettes to Minor/Underage  
Finding: Guilty  
Sentence: Fined \$260.00  
Date: 10/31/2017  
Case: 17022088

# MILWAUKEE POLICE DEPARTMENT

## REPORT OF INCIDENTS INVOLVING LICENSED PERSONS OR PREMISES

TO: Lieutenant Paris DOFFEK

Business Name: Center Street Foods  
Address of Licensed Premises: 4630 W. Center St.  
Business Phone: 414-449-0963

District: 3

Type of License: Class A

Violation /  Incident #

Date of Incident: 10/01/16

Licensee or Manager on premises at time of violation / incident?  Yes  No

Licensee cooperative?  Yes  No (If no, explain in narrative section)

Licensee Notified by Officer: PO Penny Brown

Date: 10/01/16

Time: 10:25A

Licensee or Agent's Name: HADDAD, Jay

Date of Birth: 04/10/70

Home Address: 149 Linden La #3 Thiensville, WI 53092

Home Phone: 414855-6384

Co-Licensee Name:

Date of Birth:

Home Address:

Home Phone:

Class S License Number:

Bartender Name:

Date of Birth:

Home Address:

Home Phone:

Class D License Number:

Licensed Person / Public Pass. Vehicle, etc.:

Date of Birth:

Home Address:

Home Phone:

Class D License Number:

### VIOLATION/INCIDENT - DESCRIBE FACTS AND CIRCUMSTANCES IN NARRATIVE SECTION

Name of Person Cited: Haddad, Jay  
Citation Number: J98107D6Q6

Violation & Ord. / Statue No.: 106-30-2-a Tob Minor

Date of Birth: 04/10/70  
Court Date: 06/30/17

Name of Person Cited:  
Citation Number:

Violation & Ord. / Statue No.:

Date of Birth:  
Court Date:

Name of Person Cited:  
Citation Number:

Violation & Ord. / Statue No.:

Date of Birth:  
Court Date:

Name of Person Cited:  
Citation Number:

Violation & Ord. / Statue No.:

Date of Birth:  
Court Date:

Name of Person Cited:  
Citation Number:

Violation & Ord. / Statue No.:

Date of Birth:  
Court Date:

Investigating Officer: PO Penny Brown

District / Bureau: L.I.U.

Date: 05/14/17

  
Commanding Officer

57517  
Date

### DISPOSITION - FOR LICENSING ONLY

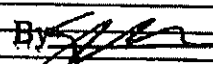
Citation No.	Case Number	Disposition	Judge	Date
		Received		
		Referred		
		By 		

PA-33E Narrative

This report is written by PO Penny BROWN assigned to the License Investigation Unit. On Saturday, October 1, 2016, I was assigned to work the Wisconsin WINS Youth Tobacco Initiative, which checks area vendors for age compliance tobacco purchases. Assisting in this assignment was: Quaveion D. BROWN B/M 03/27/99 4229 N. 76<sup>th</sup> St. phone #414-629-3763. BROWN is 17 years old and not of legal age to purchase tobacco.

At approximately 10:25A, BROWN entered Center Street Foods, located at 4630 W. Center St., and purchased a 2 pack Swisher Sweet cigar. Based on the description given to me by BROWN, I was able to immediately identify the cashier: Mohammad M. Al TARAWI A/M 05/28/80. AL TARAWI denied the sale, stating it must have been his boss, however, he was the only employee in the store. I also advised Al TARAWI that I was sitting outside the whole time and other than BROWN, no one came or left the store, therefore, it had to be him that sold the tobacco. I advised Al TARAWI I would be mailing out a notice to enroll in the M.A.R.T.S. program to the registered agent.

The agent did register for the M.A.R.T.S. program, however, failed a mystery shopper on December 22, 2016 and January 20, 2017. Therefore, a citation was mailed for the initial violation.



Friday, February 02, 2018



# Notice of Public Hearing

---

HADDAD, Jay, Agent  
Center Street Foods at 4630 W Center St  
Class A Malt and Food Dealer License Renewal Applications

**Tuesday, February 13, 2018 at 1:45 PM**

To whom it may concern:

The above application has been made by the above named applicant(s). This requires approval from the Licenses Committee and the Common Council of the City of Milwaukee. The hearing before the Licenses Committee will take place on 2/13/2018 at 1:45 PM, in Room 301-B, Third Floor, City Hall. If you wish, you may provide testimony at the hearing regarding the request; see below for further information. You are not required to attend the hearing. Once the Licenses Committee makes its recommendation, this recommendation is forwarded to the full Common Council for approval at its next regularly scheduled hearing. Please review the information below and if you have further questions regarding this process, please contact the License Division at (414) 286-2238.

---

## **Important details for those wishing to provide information for the Licenses Committee to consider when making its recommendation:**

1. The license application is scheduled to be heard at the above time. Due to other hearings running longer than scheduled, you may have to wait some time to provide your testimony.
2. You must appear in person and testify as to matters that you have personally experienced or seen. (You cannot provide testimony for your neighbor, parent or anyone else; this is considered hearsay and cannot be considered by the committee.)
3. No letters or petitions can be accepted by the committee (unless the person who wrote the letter or the persons who signed the petition are present at the committee hearing and willing to testify).
4. Persons opposed to the license application are given the opportunity to testify first; supporters may testify after the opponents have finished.
5. When you are called to testify, you will be sworn in and asked to give your name, and address. (If your first and/or last names are uncommon please spell them.)
6. You may then provide testimony.
  - a. Include only information relating to the above license application.
  - b. Include only information you have personally witnessed or seen.
  - c. Provide concise and relevant information detailing how this business has affected or may affect the peaceful enjoyment of your neighborhood.
  - d. If by the time you have the opportunity to testify, the information you wish to share has already been provided to the committee, you may state that you agree with the previous testimony. Redundant or repetitive testimony will not assist the committee in making its recommendation.
7. After giving your testimony, the members of the Licenses Committee and the licensee may ask questions regarding the testimony you have given or other factors relating to the license application.
8. Business Competition is not a valid basis for denial or non-renewal of a license.  
**Please Note: If you have submitted an objection to the above application your objection cannot be considered by the committee unless you personally testify at the hearing.**

OCCUPANT	MAIL ADDRESS	CITY, STATE ZIP
CURRENT OCCUPANT	2725 N 46TH ST	MILWAUKEE, WI 53210
CURRENT OCCUPANT	2709A N 46TH ST	MILWAUKEE, WI 53210
CURRENT OCCUPANT	2719 N 47TH ST	MILWAUKEE, WI 53210
CURRENT OCCUPANT	2654 N 47TH ST	MILWAUKEE, WI 53210
CURRENT OCCUPANT	2737 N 47TH ST	MILWAUKEE, WI 53210
CURRENT OCCUPANT	2670 N 47TH ST	MILWAUKEE, WI 53210
CURRENT OCCUPANT	2676 N 47TH ST	MILWAUKEE, WI 53210
CURRENT OCCUPANT	2707 N 47TH ST	MILWAUKEE, WI 53210
CURRENT OCCUPANT	2725 N 47TH ST	MILWAUKEE, WI 53210
CURRENT OCCUPANT	2736 N 47TH ST	MILWAUKEE, WI 53210
CURRENT OCCUPANT	2739 N 47TH ST	MILWAUKEE, WI 53210
CURRENT OCCUPANT	2741 N 47TH ST	MILWAUKEE, WI 53210
CURRENT OCCUPANT	2729 N 46TH ST	MILWAUKEE, WI 53210
CURRENT OCCUPANT	2709 N 46TH ST	MILWAUKEE, WI 53210
CURRENT OCCUPANT	2678 N 47TH ST	MILWAUKEE, WI 53210
CURRENT OCCUPANT	2708 N 48TH ST	MILWAUKEE, WI 53210
CURRENT OCCUPANT	2714 N 47TH ST	MILWAUKEE, WI 53210
CURRENT OCCUPANT	2720 N 47TH ST	MILWAUKEE, WI 53210
CURRENT OCCUPANT	2655 N 47TH ST	MILWAUKEE, WI 53210
CURRENT OCCUPANT	2667 N 46TH ST	MILWAUKEE, WI 53210
CURRENT OCCUPANT	2735 N 46TH ST	MILWAUKEE, WI 53210
CURRENT OCCUPANT	2719 N 46TH ST	MILWAUKEE, WI 53210
CURRENT OCCUPANT	2673 N 46TH ST	MILWAUKEE, WI 53210
CURRENT OCCUPANT	2677 N 46TH ST	MILWAUKEE, WI 53210
CURRENT OCCUPANT	2712 N 46TH ST	MILWAUKEE, WI 53210
CURRENT OCCUPANT	2715 N 47TH ST	MILWAUKEE, WI 53210
CURRENT OCCUPANT	2718 N 47TH ST	MILWAUKEE, WI 53210
CURRENT OCCUPANT	2656 N 47TH ST	MILWAUKEE, WI 53210
CURRENT OCCUPANT	2663 N 47TH ST	MILWAUKEE, WI 53210
CURRENT OCCUPANT	2657 N 46TH ST	MILWAUKEE, WI 53210
CURRENT OCCUPANT	2728 N 47TH ST	MILWAUKEE, WI 53210
CURRENT OCCUPANT	2704 N 46TH ST	MILWAUKEE, WI 53210
CURRENT OCCUPANT	2713 N 46TH ST	MILWAUKEE, WI 53210
CURRENT OCCUPANT	4626 W CENTER ST 1	MILWAUKEE, WI 53210
CURRENT OCCUPANT	4626 W CENTER ST 3	MILWAUKEE, WI 53210
CURRENT OCCUPANT	2712 N 47TH ST	MILWAUKEE, WI 53210
CURRENT OCCUPANT	2718 N 48TH ST	MILWAUKEE, WI 53210
CURRENT OCCUPANT	2721 N 47TH ST	MILWAUKEE, WI 53210
CURRENT OCCUPANT	2663A N 46TH ST	MILWAUKEE, WI 53210
CURRENT OCCUPANT	2724 N 47TH ST	MILWAUKEE, WI 53210
CURRENT OCCUPANT	2729 N 47TH ST	MILWAUKEE, WI 53210
CURRENT OCCUPANT	2731 N 47TH ST	MILWAUKEE, WI 53210
CURRENT OCCUPANT	2735 N 47TH ST	MILWAUKEE, WI 53210
CURRENT OCCUPANT	2741 N 46TH ST	MILWAUKEE, WI 53210
CURRENT OCCUPANT	2718 N 46TH ST	MILWAUKEE, WI 53210
CURRENT OCCUPANT	2670 N 46TH ST	MILWAUKEE, WI 53210

CURRENT OCCUPANT	2677A N 46TH ST	MILWAUKEE, WI 53210
CURRENT OCCUPANT	4730 W CENTER ST	MILWAUKEE, WI 53210
CURRENT OCCUPANT	4626 W CENTER ST 2	MILWAUKEE, WI 53210
CURRENT OCCUPANT	2709 N 47TH ST	MILWAUKEE, WI 53210
CURRENT OCCUPANT	2661 N 47TH ST	MILWAUKEE, WI 53210
CURRENT OCCUPANT	2662 N 47TH ST	MILWAUKEE, WI 53210
CURRENT OCCUPANT	2663 N 46TH ST	MILWAUKEE, WI 53210
CURRENT OCCUPANT	2727 N 47TH ST	MILWAUKEE, WI 53210
CURRENT OCCUPANT	2726 N 47TH ST	MILWAUKEE, WI 53210
CURRENT OCCUPANT	2740 N 47TH ST	MILWAUKEE, WI 53210
CURRENT OCCUPANT	2708 N 46TH ST	MILWAUKEE, WI 53210
CURRENT OCCUPANT	2713 N 47TH ST	MILWAUKEE, WI 53210
CURRENT OCCUPANT	2720 N 48TH ST	MILWAUKEE, WI 53210
CURRENT OCCUPANT	2666 N 46TH ST	MILWAUKEE, WI 53210
CURRENT OCCUPANT	2730 N 47TH ST	MILWAUKEE, WI 53210
CURRENT OCCUPANT	2734 N 47TH ST	MILWAUKEE, WI 53210
CURRENT OCCUPANT	2738 N 47TH ST	MILWAUKEE, WI 53210
CURRENT OCCUPANT	2703 N 46TH ST	MILWAUKEE, WI 53210
CURRENT OCCUPANT	2664 N 47TH ST	MILWAUKEE, WI 53210
CURRENT OCCUPANT	2666 N 47TH ST	MILWAUKEE, WI 53210
CURRENT OCCUPANT	2672 N 47TH ST	MILWAUKEE, WI 53210
CURRENT OCCUPANT	2706 N 48TH ST	MILWAUKEE, WI 53210

Total Records: 68

Radius: 250.0 feet and Center of Circle: 4630 W Center St



# 2017-2018 Plan of Operation for 4630 W CENTER ST

## 1. Litter & Security Plans

How are the grounds kept clean?  Sweep  Pressure Wash  Pick Up Litter  Other:

How often will grounds be cleaned?  Daily  Weekly  Other:

Who cleans the grounds?  Licensee  Building Owner  Employees  Hired Maintenance  Other:

How are noise issues prevented and/or addressed?  Security  Manager approaches customer(s)  Call Police  Signs Posted  Other:

Are there designated outdoor smoking areas?  No  Yes If Yes, Describe:

Number of garbage cans: Inside 3 Locations: Bathroom, Kitchen, Front  
 Outside 2 Dumpsters Locations: on side

Is a crowd control barrier used?  No  Yes If Yes, Describe:

Number of restrooms: 1 Name of solid waste contractor:

Are there parking spaces on the premises?  No  Yes If Yes, list number of spaces: 1 and describe security plans:

Are there designated loading areas?  No  Yes If Yes, describe security plans:

Do you have security personnel on the premise?  No  Yes If Yes, how many? \_\_\_\_\_

AND What are their responsibilities? \_\_\_\_\_  
 What security equipment do they use? \_\_\_\_\_  
 List their licensing, certification or training credentials: \_\_\_\_\_

Are there security cameras?  No  Yes If Yes, list all locations:

Are searches and/or identification checks conducted upon entry?  No  Yes If Yes, describe:

## 2. Percentage of Sales (must total 100%)

Alcohol 12.5 % Food Sales 57.5 % Entertainment \_\_\_\_\_ % Other 30 %

## 3. Businesses On The Premises (choose all that apply):

- Restaurant  Cafe/Coffee Shop  Cocktail Lounge  Convenience Store  Night Club  Liquor Store  Tavern  Sports Facility  
 Hotel  Banquet Hall  Supermarket  Private/Fraternal/Veterans' Club  Other:

## 4. Hours of Operation and Age Restriction

Are there any changes to the current hours of operation or age restriction?  No  Yes If Yes, Describe:

Please Note: If you will be open earlier or later than the hours listed on your current license for even one event or holiday (for example, St. Patrick's Day, Brewers Opening Day, etc.) during the license period, this must be reported and printed on your license.  
 Your hours of operation and age restriction are listed on your current license.

## 5. Floor Plan and Capacity

Are you requesting any changes to the floor plan or capacity?  No  Yes If Yes, Describe:

If requesting changes to the floor plan, submit a new floor plan with this application. Changes in floor plan include changing the location of tables, games, etc. within your current licensed premises. If your changes include adding any additional areas or square footage to your premises, or any renovations to the building will be done, a Permanent Extension of Premises application must be filed.

## 6. Sidewalk Dining: Fee

Are there any changes to the sidewalk dining site plan?  No  Yes If Yes, submit an updated site plan with this application.

## 7. Food License: FOOD 7608 Fee: \$800.00

Your current food license includes the following food operations: Processing, Hazardous Foods, Sales \$20,001 - \$200,000, Food Store. Are there any changes to your food operations as listed above?  No  Yes, if Yes, explain \_\_\_\_\_

## 8. Weights and Measures: Fee:

Number/Type of Devices:  
 Are there any changes to the number or types of devices?  No  Yes  
 If yes, contact our office for further instructions.