



CITY OF MILWAUKEE  
OFFICE OF THE CITY CLERK

Tuesday, June 30, 2015

COMMITTEE MEETING NOTICE

AD 09

GARCIA, Jennifer, Agent  
7330 Development LLC  
2769 N 44th St

Milwaukee, WI 53210

You are requested to attend a hearing which is to be held in Room 301-B, Third Floor, City Hall on:

**Tuesday, July 07, 2015 at 09:00 AM**

**Regarding:** Your Class B Tavern and Public Entertainment Premises License Transfer - Change of Age Restriction from 25+ to 21+ and adding Bands as agent for "7330 Development LLC" for "Kiss Ultra Lounge" at 7330 N 76TH St.

There is a possibility that your application may be denied for one or more of the following reasons: The recommendation of the committee regarding the application shall be based on evidence presented at the hearing. Per MCO 85-2.7-4, probative evidence concerning whether or not a new license should be granted may be presented on the following subjects: whether or not the applicant meets the municipal requirements, the appropriateness of the location and premises where the licensed premises is to be located and whether use of the premises for the purposes or activities permitted by the license would tend to facilitate a public or private nuisance or create undesirable neighborhood problems such as disorderly patrons, unreasonably loud noise, litter, and excessive traffic and parking congestion. Probative evidence relating to these matters may be taken from the plan of operation submitted with the license application, if any, but shall not include the content of any music. Evidence regarding the fitness of the location of the premises to be maintained as the principal place of business, including but not limited to whether there is an overconcentration of businesses of the type for which the license is sought; whether the proposal is consistent with any pertinent neighborhood business or development plans, or the location's proximity to areas where children are typically present. The applicant's record in operating similarly licensed premises; and whether or not the applicant has been charged with or convicted of any felony, misdemeanor, municipal offense or other offense, the circumstances of which substantially relate to the activity to be permitted by the license being applied for or any other factor which reasonably relates to the public health, safety or welfare may also be considered. See attached police report or correspondence.

**Notice for applicants with warrants or unpaid fines:**

Proof of warrant satisfaction or payment of fines must be submitted at the hearing on the above date and time. Failure to comply with this requirement may result in a delay of the granting/denial of your application.

Failure to appear at this meeting may result in the denial of your license. Individual applicants must appear only in person or by an attorney. Corporate or Limited Liability applicants must appear only by the agent designated on the application or by an attorney. Partnership applicants must appear by a partner listed on the application or by an attorney. If you wish to do so and at your own expense, you may be accompanied by an attorney of your choosing to represent you at this hearing.

You will be given an opportunity to speak on behalf of the application and to respond and challenge any charges or reasons given for the denial. No petitions can be accepted by the committee, unless the people who signed the petition are present at the committee hearing and willing to testify. You may present witnesses under oath and you may also confront and cross-examine opposing witnesses under oath. If you have difficulty with the English language, you should bring an interpreter with you, at your expense, so that you can answer questions and participate in your hearing.

You may examine the application file at this office during regular business hours prior to the hearing date. Inquiries regarding this matter may be directed to the person whose signature appears below.

Limited parking for persons attending meetings in City Hall is available at reduced rates (5 hour limit) at the Milwaukee Center on the southwest corner of East Kilbourn and North Water Street. Parking tickets must be validated in the first floor information booth in City Hall.

PLEASE NOTE: Upon reasonable notice, efforts will be made to accommodate the needs of disabled individuals through sign language interpreters or other auxiliary aids. For additional information or to request this service, contact the Council Services Division ADA Coordinator at (414) 286-2998, Fax - (414) 286-3456, TDD - (414) 286-2025.

JIM OWCZARSKI, CITY CLERK

BY: \_\_\_\_\_

Jason Schunk  
License Division Manager

If you have questions regarding this notice, please contact the License Division at (414) 286-2238.

200 E. Wells Street, Room 105, City Hall, Milwaukee, WI 53202. [www.milwaukee.gov/license](http://www.milwaukee.gov/license)  
Phone: (414) 286-2238 Fax: (414) 286-3057 Email Address: [License@milwaukee.gov](mailto:License@milwaukee.gov)

# MILWAUKEE POLICE DEPARTMENT LICENSING

## CRIMINAL RECORD/ORDINANCE VIOLATION/INCIDENTS SYNOPSIS

DATE: 06/10/15  
LICENSE TYPE: PEP  
NEW:   
RENEWAL:

No. 212672  
Application Date:

License Location: 7330 North 76<sup>th</sup> Street  
Business Name:

Licensee/Applicant: Garcia, Jennifer  
(Last Name, First Name, MI)  
Date of Birth: 04/28/1970

Home Address: 2769 North 44<sup>th</sup> Street  
City: Milwaukee State: WI Zip Code: 53210  
Home Phone: (414) 499-1115

This report is written by Police Officer KUKOWSKI, assigned to the License Investigation Unit, Days.

The Milwaukee Police Department's investigation regarding this application revealed the following:

1. The applicant owes the city of Milwaukee \$730.00 for overdue parking citations.
2. On 02/20/2013 Karen Hubbard was cited at 4405 North 36<sup>th</sup> Street in the city of Milwaukee for Building Code Violations.

Charge:	Building Code Violations
Finding:	Guilty
Sentence:	\$1680.00 fine ***in warrant status as of 01/21/2014***
Date:	11/20/2013
Case:	13093138

- \=====
3. On 04/24/15, applicant was cited for Responsible Person on Premise at 7330 N 76<sup>th</sup> Street.

Charge:	Responsible Person on Premise
Finding:	Pre Trial 07/02/15 1:30 pm
Sentence:	
Date:	
Case:	15022435



# ALCOHOL BEVERAGE & FOOD ESTABLISHMENTS REQUEST TO CHANGE HOURS OF OPERATION, FLOOR PLAN, BUSINESS OPERATIONS AND/OR AGE RESTRICTION

OFFICE OF THE CITY CLERK LICENSE DIVISION  
200 E. WELLS ST. ROOM 105, MILWAUKEE, WI 53202  
(414) 286-2238 EMAIL: [LICENSE@MILWAUKEE.GOV](mailto:LICENSE@MILWAUKEE.GOV)

Check License Type(s):  Alcohol Beverage  Food

Legal Entity Name (Individual, Partnership, Corporation or LLC): 7330 Development, LLC

Agent's Name (Corp/LLC): Jennifer Garain

Trade Name: KISS Ultra Lounge

Business Address (include city/state/zip code): 7330 N. 76<sup>th</sup> St. Milw, WI 53228 Aldermanic District: 9

Mailing Address: Identify the address where all correspondence from the License Division should be sent. Check (✓) one:  
 Same as Business Address above  
 Same as Home Address as follows: \_\_\_\_\_ (include city/state/zip code)  
 Other as follows: \_\_\_\_\_ (include city/state/zip code)

Business E-mail Address: \_\_\_\_\_ Business Phone Number: 414 499-1115 Business Fax Number: \_\_\_\_\_

### REQUEST TO CHANGE HOURS OF OPERATION AS FOLLOWS:

Day of the Week	Current Hours of Operation:		Proposed Hours of Operation:		Number of Customers expected each day	Class B Taverns: Age Restriction for each day (if over 21) (This is optional) If none, write "none"
	Open	Close	Open	Close		
Sunday						21+
Monday						21+
Tuesday						21+
Wednesday						21+
Thursday						21+
Friday						21+
Saturday						21+

Office Use Only:

Filed 6-9-15 Initials JK Food App# \_\_\_\_\_ Alcohol App# 212740 LC \_\_\_\_\_ Granted \_\_\_\_\_

Remove from MPD queue  1) Give application directly to manager and 2) send an email to the primary specialist to advise

*Follow-up w Alderman to see if still needs scheduling*

*Schedule 7/1/15  
350 notices 9:00  
No neighbors w/in 100'*

Prohibited Hours of Operation: Class A: 9:00 PM to 8:00 AM  
Class B/C: Monday thru Friday 2:00 AM – 6:00 AM; Class B/C: Saturday thru Sunday 2:30 AM – 6:00 AM  
Food: 12:00 AM to 5:00 AM (unless an Extended Hours license is also held)

REQUEST TO CHANGE FLOOR PLAN AS FOLLOWS:

New floor plan(s) must be submitted with this application.  
(See next page for detailed floor plan instructions.)

**\*\* This form should be used for changing the location of tables, games, etc. within your current licensed premises. If your changes include adding any additional areas or square footage to your premises, or any renovations to the building will be done, do NOT complete this form. A Permanent Extension of Premises is required.**

REQUEST TO CHANGE BUSINESS OPERATIONS AS FOLLOWS:

Current business operations: Current 25+  
Proposed change(s) to the business operations: lower age restriction to 21+

As a result of the changes you are requesting, are there changes being made to the:

Plan of Operation  No  Yes If yes, submit an updated Plan of Operation Supplement  
Floor Plan  No  Yes If yes, submit an updated Floor Plan

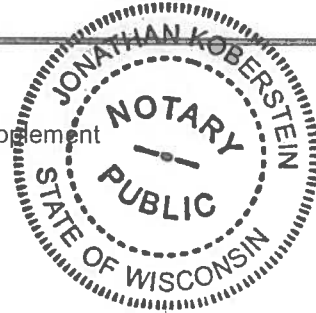

Subscribed and sworn to before me  
this 9<sup>th</sup> day of JUNE, 20 15

[Signature]  
Notary Public, State of Wisconsin  
My commission expires: MARCH 23, 2019  
Notary Seal must be affixed

Jennifer Garcia  
Print Name of Individual, Partner, Agent, or 20% or more Shareholder  
Jennifer Garcia  
Signature of Individual, Partner, Agent, or 20% or more Shareholder

Warning: Penalty provided for submitting false statements and affidavits with this application.



# PUBLIC ENTERTAINMENT PREMISES CHANGE OF ENTERTAINMENT APPLICATION

Office of the City Clerk License Division  
200 E. Wells St. Room 105, Milwaukee, WI 53202  
(414) 286-2238 www.milwaukee.gov/license  
e-mail address: license@milwaukee.gov

<b>(1) BUSINESS INFORMATION</b>																																	
Licensee (Name of individual; each partner; or agent, if a corporation or LLC): <u>Jennifer Garcia</u>	Aldermanic District: <u>9</u>																																
Corporation or LLC Name (if applicable): <u>7330 Development, LLC</u>	Business Name: <u>KISS Ultra lounge</u>																																
Business Address (include Zip Code): <u>7330 N. 76th St. Milw, WI 53228</u>																																	
Optional Mailing Address:	Business Telephone Number: <u>414 449-1115</u>																																
<b>(2) TYPES OF ENTERTAINMENT BEING REQUESTED (CHOOSE ALL THAT APPLY)</b>																																	
<table style="width: 100%; border: none;"> <tr> <td><input type="checkbox"/> Amusement Machines –</td> <td><input type="checkbox"/> Concerts</td> <td><input type="checkbox"/> Bowling Alley</td> <td><input type="checkbox"/> Pool Tables</td> </tr> <tr> <td>How many? _____</td> <td>Approx. # per year? _____</td> <td>How many? _____</td> <td>How many? _____</td> </tr> <tr> <td><input type="checkbox"/> Motion Pictures</td> <td><input type="checkbox"/> Theatrical Performances</td> <td><input type="checkbox"/> Jukebox</td> <td><input type="checkbox"/> Poetry Readings</td> </tr> <tr> <td>How many? _____</td> <td>Approx. # per year? _____</td> <td></td> <td></td> </tr> <tr> <td><input type="checkbox"/> Karaoke</td> <td><input type="checkbox"/> Patrons Dancing</td> <td><input type="checkbox"/> Disc Jockey</td> <td><input type="checkbox"/> Instrumental Musicians</td> </tr> <tr> <td><input type="checkbox"/> Dancing by Performers</td> <td><input checked="" type="checkbox"/> Bands</td> <td><input type="checkbox"/> Patron Contests</td> <td><input type="checkbox"/> Wrestling</td> </tr> <tr> <td><input type="checkbox"/> Comedy Acts</td> <td><input type="checkbox"/> Battle of the Bands</td> <td><input type="checkbox"/> Magic Shows</td> <td><input type="checkbox"/> Adult Entertainment/ Strippers/Erotic Dance</td> </tr> <tr> <td colspan="4"><input type="checkbox"/> Other: _____</td> </tr> </table>		<input type="checkbox"/> Amusement Machines –	<input type="checkbox"/> Concerts	<input type="checkbox"/> Bowling Alley	<input type="checkbox"/> Pool Tables	How many? _____	Approx. # per year? _____	How many? _____	How many? _____	<input type="checkbox"/> Motion Pictures	<input type="checkbox"/> Theatrical Performances	<input type="checkbox"/> Jukebox	<input type="checkbox"/> Poetry Readings	How many? _____	Approx. # per year? _____			<input type="checkbox"/> Karaoke	<input type="checkbox"/> Patrons Dancing	<input type="checkbox"/> Disc Jockey	<input type="checkbox"/> Instrumental Musicians	<input type="checkbox"/> Dancing by Performers	<input checked="" type="checkbox"/> Bands	<input type="checkbox"/> Patron Contests	<input type="checkbox"/> Wrestling	<input type="checkbox"/> Comedy Acts	<input type="checkbox"/> Battle of the Bands	<input type="checkbox"/> Magic Shows	<input type="checkbox"/> Adult Entertainment/ Strippers/Erotic Dance	<input type="checkbox"/> Other: _____			
<input type="checkbox"/> Amusement Machines –	<input type="checkbox"/> Concerts	<input type="checkbox"/> Bowling Alley	<input type="checkbox"/> Pool Tables																														
How many? _____	Approx. # per year? _____	How many? _____	How many? _____																														
<input type="checkbox"/> Motion Pictures	<input type="checkbox"/> Theatrical Performances	<input type="checkbox"/> Jukebox	<input type="checkbox"/> Poetry Readings																														
How many? _____	Approx. # per year? _____																																
<input type="checkbox"/> Karaoke	<input type="checkbox"/> Patrons Dancing	<input type="checkbox"/> Disc Jockey	<input type="checkbox"/> Instrumental Musicians																														
<input type="checkbox"/> Dancing by Performers	<input checked="" type="checkbox"/> Bands	<input type="checkbox"/> Patron Contests	<input type="checkbox"/> Wrestling																														
<input type="checkbox"/> Comedy Acts	<input type="checkbox"/> Battle of the Bands	<input type="checkbox"/> Magic Shows	<input type="checkbox"/> Adult Entertainment/ Strippers/Erotic Dance																														
<input type="checkbox"/> Other: _____																																	
<p><b>No changes in entertainment shall take place until a new license has been issued and posted on the premises.</b></p>																																	
<b>(3) NOTARIZED SIGNATURES OF APPLICANTS</b>																																	
I, (we), the undersigned have a knowledge of the City Ordinances currently regulating these licenses and being duly sworn under oath, depose and say that I am (we are) the person (s) and that all statements made in the foregoing application are true and correct.																																	
SUBSCRIBED AND SWORN TO BEFORE ME																																	
This <u>9<sup>th</sup></u> day of <u>JUNE</u> , 20 <u>15</u>	<u>Jennifer Garcia</u> Agent/Owner/Partner																																
<u>[Signature]</u> (Clerk/Notary Public)																																	
My Commission Expires <u>MARCH 22, 2019</u>	Additional Owner/Partner																																
*Notary Seal must be affixed.																																	

**Office Use Only:**

Current Entertainment: COMEDY ACTS, POETRY READINGS, PATRONS DANCING, DJSC JOCKEY, JUKEBOX, KARAOKE, 3 AMUSE MACHINES / POOL TABLE

Changes Being Requested: BANDS

Queued to:  MPD  DNS (if adding entertainment)

Initials: JG Filed: 6-9-15 App #: 212762 Granted: \_\_\_\_\_ Issued: \_\_\_\_\_ (no fee)

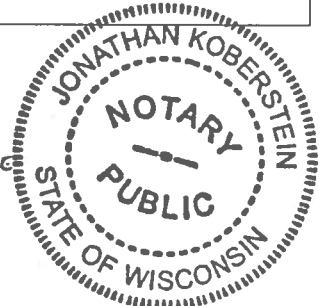



CITY OF MILWAUKEE  
OFFICE OF THE CITY CLERK

Thursday, June 25, 2015

COMMITTEE MEETING NOTICE

AD 14

JONAS, Paul U, Agent  
U.C. Jonas Inc  
1501 E Manitoba St

Milwaukee, WI 53207

You are requested to attend a hearing which is to be held in Room 301-B, Third Floor, City Hall on:

**Tuesday, July 07, 2015 at 09:00 AM**

**Regarding:** Your Class B Tavern and Public Entertainment Premises License Applications Requesting a Jukebox as agent for "U.C. Jonas Inc" for "Urban BayView" at 939 E Lincoln Av.

There is a possibility that your application may be denied for one or more of the following reasons: The recommendation of the committee regarding the application shall be based on evidence presented at the hearing. Per MCO 85-2.7-4, probative evidence concerning whether or not a new license should be granted may be presented on the following subjects: whether or not the applicant meets the municipal requirements, the appropriateness of the location and premises where the licensed premises is to be located and whether use of the premises for the purposes or activities permitted by the license would tend to facilitate a public or private nuisance or create undesirable neighborhood problems such as disorderly patrons, unreasonably loud noise, litter, and excessive traffic and parking congestion. Probative evidence relating to these matters may be taken from the plan of operation submitted with the license application, if any, but shall not include the content of any music. Evidence regarding the fitness of the location of the premises to be maintained as the principal place of business, including but not limited to whether there is an overconcentration of businesses of the type for which the license is sought; whether the proposal is consistent with any pertinent neighborhood business or development plans, or the location's proximity to areas where children are typically present. The applicant's record in operating similarly licensed premises; and whether or not the applicant has been charged with or convicted of any felony, misdemeanor, municipal offense or other offense, the circumstances of which substantially relate to the activity to be permitted by the license being applied for or any other factor which reasonably relates to the public health, safety or welfare may also be considered. See attached police report or correspondence.

**Notice for applicants with warrants or unpaid fines:**

Proof of warrant satisfaction or payment of fines must be submitted at the hearing on the above date and time. Failure to comply with this requirement may result in a delay of the granting/denial of your application.

Failure to appear at this meeting may result in the denial of your license. Individual applicants must appear only in person or by an attorney. Corporate or Limited Liability applicants must appear only by the agent designated on the application or by an attorney. Partnership applicants must appear by a partner listed on the application or by an attorney. If you wish to do so and at your own expense, you may be accompanied by an attorney of your choosing to represent you at this hearing.

You will be given an opportunity to speak on behalf of the application and to respond and challenge any charges or reasons given for the denial. No petitions can be accepted by the committee, unless the people who signed the petition are present at the committee hearing and willing to testify. You may present witnesses under oath and you may also confront and cross-examine opposing witnesses under oath. If you have difficulty with the English language, you should bring an interpreter with you, at your expense, so that you can answer questions and participate in your hearing.

You may examine the application file at this office during regular business hours prior to the hearing date. Inquiries regarding this matter may be directed to the person whose signature appears below.

Limited parking for persons attending meetings in City Hall is available at reduced rates (5 hour limit) at the Milwaukee Center on the southwest corner of East Kilbourn and North Water Street. Parking tickets must be validated in the first floor information booth in City Hall.

PLEASE NOTE: Upon reasonable notice, efforts will be made to accommodate the needs of disabled individuals through sign language interpreters or other auxiliary aids. For additional information or to request this service, contact the Council Services Division ADA Coordinator at (414) 286-2998, Fax - (414) 286-3456, TDD - (414) 286-2025.

JIM OWCZARSKI, CITY CLERK

BY: \_\_\_\_\_

Jason Schunk  
License Division Manager

**If you have questions regarding this notice, please contact the License Division at (414) 286-2238.**

200 E. Wells Street, Room 105, City Hall, Milwaukee, WI 53202. [www.milwaukee.gov/license](http://www.milwaukee.gov/license)  
Phone: (414) 286-2238 Fax: (414) 286-3057 Email Address: [License@milwaukee.gov](mailto:License@milwaukee.gov)

Date:06/17/15  
Officer: Klein

City of Milwaukee Police Department  
90-5-1.5 Crime Prevention Survey  
Tavern Inspection

Name of Premise: Urban Bayview  
Address: 939 E. Lincoln Ave. Milwaukee, Wi. 53207  
Phone: 414-588-7366

Owner: Paul Jonas  
Owner address: 1501 E Manitoba St  
City State Zip: Milwaukee, Wi 53207  
Owner Phone: 414-588-7366  
Owner email: pujonas@yahoo.com

Licensee/Agent: Same  
Home Address:  
City State Zip:  
Phone:  
Email:

Preferred contact: Same

Location currently open:  YES  NO

Projected open date: 08/01/15

Day's open: S M T W Th F SA ALL

Hours of Operation: Sun: 4:00 pm to 2:00 am  
Mon: 4:00 pm to 2:00 am  
Tue: 4:00 pm to 2:00 am  
Wed: 4:00 pm to 2:00 am  
Thu: 4:00 pm to 2:00 am  
Fri: 4:00 pm to 2:30 am  
Sat: 4:00 pm to 2:30 am  
24 hours Y N

Premise Type: Tavern/Bar  
Restaurant  
Other:

Licenses currently held:

Alcohol:	<input checked="" type="checkbox"/> Yes <input type="checkbox"/> No	Class:	#: The Tonic Tavern
Tobacco:	<input checked="" type="checkbox"/> Yes <input type="checkbox"/> No		#: The Tonic Tavern
Food:	<input type="checkbox"/> Yes <input type="checkbox"/> No		#:
Occupancy:	<input checked="" type="checkbox"/> Yes <input type="checkbox"/> No		#: The Tonic Tavern
Other:	<input type="checkbox"/> Yes <input type="checkbox"/> No	Type:	#:
Other:	<input type="checkbox"/> Yes <input type="checkbox"/> No	Type:	#:

**Exterior Survey:**

1. Is the area around the location clean? Yes No
2. What surrounds the location? (Check all the apply)
  - a. Park
  - b. School
  - c. Youth Center
  - d. Church
  - e. Tavern(s) If so, how many
  - f. Residential
  - g. Other businesses
  - h. Other:
3. Can you see from the outside of the location into the interior Yes No
4. Can you see the employees inside of the location from the outside Yes No
5. Are exterior windows free of signage Yes No
6. Is there a bus stop? Yes No
7. Is there a bus shelter? Yes No N/A
8. Street parking Yes No
9. Is there a parking lot Yes No
10. Is the parking lot clean? Yes No N/A
11. Is the parking lot well lit? Yes No N/A
12. Valet Parking Yes No
  - a. Will this lot have a guard? Yes No N/A
  - b. Will this lot have cameras? Yes No N/A
13. Are there areas where a person could conceal themselves Yes No
14. Is there exterior lighting? Yes No. Does it appears to be adequate Yes No
15. Exterior Payphone? Yes No
16. Are there No Loitering Signs posted? Yes No
17. Are there exterior security cameras Yes No How Many:
18. Are the address numbers prominently displayed and easy to see Yes No

Exterior Comments: Building is under construction. Interior is gutted and exterior is being re-done

**Camera Survey:**

19. Does this location have security cameras? Yes No
20. Are they in working order? Yes No
21. What format are the cameras?
  - a. Color Yes No
  - b. Digital Yes No



- c. VCR  Yes  No  
 d. Recorded  Yes  No

22. How long is footage stored for later viewing: 2 weeks  
 23. Are there exterior cameras  Yes  No How many:  
 24. Are there interior cameras  Yes  No How many:  
 25. Do all employees know how to retrieve recorded digital images/footage?  Yes  No  
 26. Cameras located in parking lot  Yes  No  N/A How many

Camera Survey Comments: A camera system will be installed at a later date. Interior is gutted and done to the studs

**Interior Survey:**

27. What is the planned/posted capacity 90  
 28. What is the minimum number of employees that will be on premise 1  
 29. Is the storeowner willing to be a standing complainant regarding loitering?  Yes  No  
 a. If yes have them fill out the standing complaint form and give them two of the commercial signs  Yes  No  
 30. Is the interior of the location neat and clean?  Yes  No  
 31. Does an interior camera face the entrance/exit?  Yes  No  
 32. Are emergency and non-emergency numbers posted near the phone?  Yes  No  
 33. Does the owner know how to contact their police district directly?  Yes  No  
 a. Did you provide a district contact guide to the owner?  Yes  No

Interior Comments: Interior is gutted

**Security**

34. How many security personnel are going to be employed:  N/A  
 35. How will they be deployed: Interior Exterior  N/A  
 36. What days will they be deployed  Mon  Tue  Wed  Thu  Fri  Sat  Sun  ALL  
 37. Will the security be managed by business  or contracted   
 38. Will they be armed  Yes  No  N/A  
 39. What type of security measures will be used:  N/A  
 Wanding/metal detector  
 ID Scanner  
 Dress Code  
 Cover Charge  
 Age restriction  
 Other  
 40. When at capacity, how will the overflow crowd be managed? Bar tender  
 41. Will a guard monitor the overflow crowd at all times?  Yes  No

Security Comments: Interior is gutted

**ADDITIONAL COMMENTS/RECOMMENDATIONS:**

They are waiting for a occupancy permit so they can pull permits to work on the inside. This report needs to be submitted before they can go to the License meeting to get occupancy permit. Interior is gutted down to the studs. Owner was advised on installing a camera system to include inside and outside.

# Alcohol License Concentration for 939 E Lincoln Ave

City of Milwaukee, Wisconsin

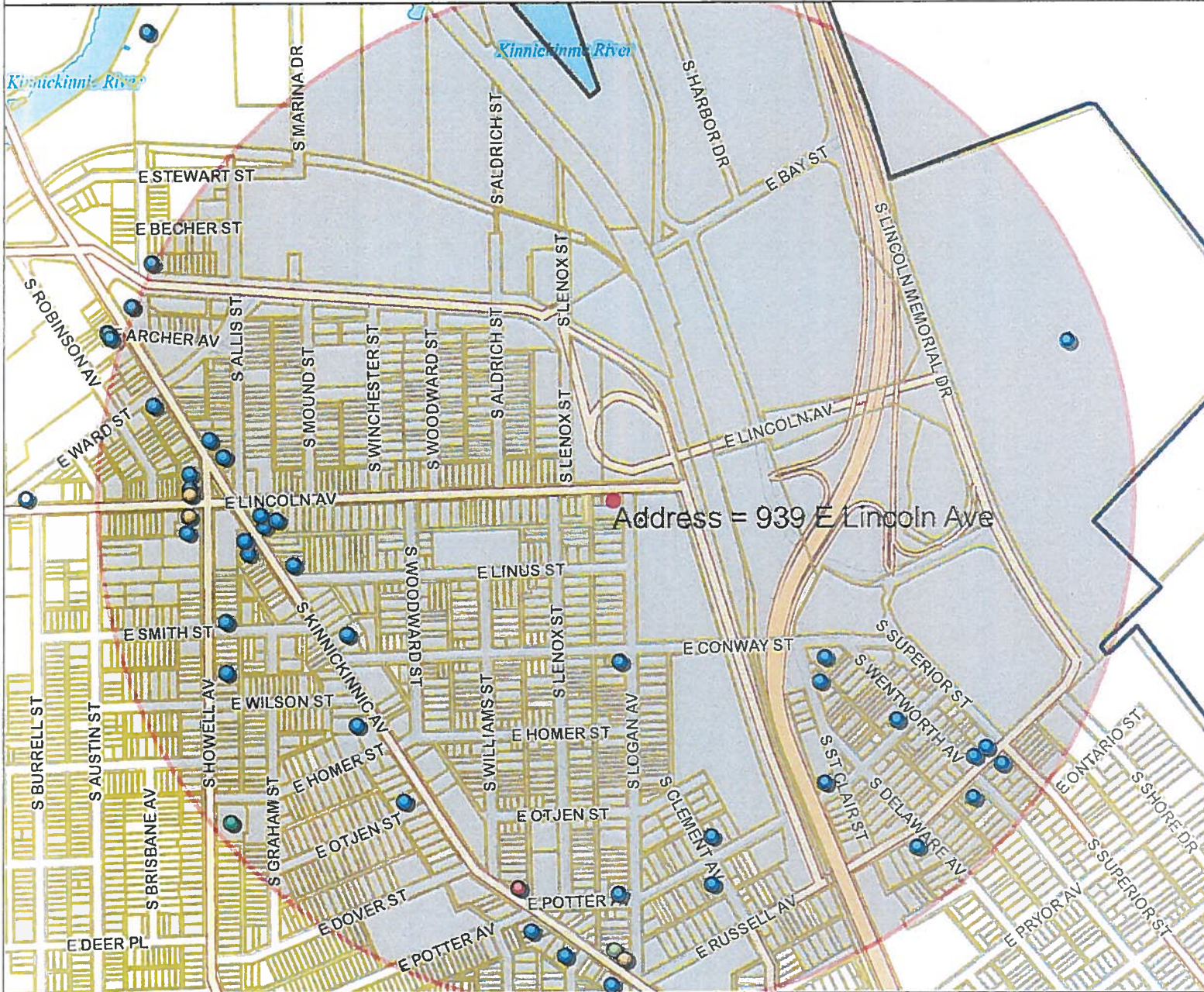

### - Legend -

- City limits
- Parcels
- Freeways
  - Freeways
  - Exit ramps
  - Entry ramps
  - Ramps
- Major streets
- Streets
- Waterways
- Alcohol licenses
  - Class A intoxicating liquor
  - Class A fermented malt beverage
  - Class A liquor and malt
  - Class B fermented malt beverage
  - Class B tavern
  - Class C wine retailer

Address = 939 E Lincoln Ave

### - Notes -

Licensed Alcohol Establishments Within a .5 Mile Radius Centered on 939 E Lincoln Ave on 05/18/2015





Licensed Alcohol Establishments Within a .5 Mile Radius Centered on 939 E Lincoln Ave on 05/18/2015							Total
License Summary:							
Class A Fermented Malt Beverage Retailer's License							3
Class A Malt & Class A Liquor License							1
Class B Fermented Malt Beverage Retailer's License							2
Class B Tavern License							34
Class C Wine Retailer's License							1
							Grand Total = 41
Legal entity	Trade name	Licensee	Address	License type name	Total capacity	Room capacity	Expiration date
A K FOOD MART	A K FOOD MART	PARSHOTAM SINGH, SP	2305 S HOWELL AV	Class A Fermented Malt Beverage Retailer's License			2/27/2016
BAY VIEW QUICK MART, LLC	BAY VIEW QUICK MART	YASSER JABER, Agt	2690 S KINNICKINNIC AV	Class A Fermented Malt Beverage Retailer's License			3/22/2016
MPR CORPORATION	Bay View Supermarket	PARESH C PATEL, Agt	2277 S HOWELL AV	Class A Fermented Malt Beverage Retailer's License			6/18/2015
SIEGEL LIQUOR, INC	SIEGEL LIQUOR	AMARJIT S VIRK, Agt	2632 S KINNICKINNIC AV	Class A Malt & Class A Liquor License			9/24/2015
No 1 Chinese Restaurant, LLC	No 1 Chinese Restaurant	Xiao Yan Zhang, Agt	2678 S Kinnickinnic AV	Class B Fermented Malt Beverage Retailer's License			12/19/2015
ST AUGUSTINE CONGREGATION	ST AUGUSTINE CONGREGATION	TIMOTHY SCHUMACHER, Agt	2530 S HOWELL AV	Class B Fermented Malt Beverage Retailer's License			12/31/2015
AT RANDOM, INC	AT RANDOM COCKTAIL LOUNGE	RONALD A ZELLER, Agt	2501 S DELAWARE AV	Class B Tavern License	75		6/30/2015
BAY VIEW SPORTS BAR, INC	BAY VIEW SPORTS BAR	JOHN J KARDARIS, Agt	2327 S KINNICKINNIC AV	Class B Tavern License	80		10/12/2015
BCT5 LLC	Vanguard	CHRISTOPHER J SCHULIST, Agt	2659 S KINNICKINNIC AV	Class B Tavern License			10/15/2015
BYO STUDIO, LLC	Studio Lounge	KENDRICK B YANDELL, Agt	2246 S KINNICKINNIC AV	Class B Tavern License	49		9/21/2015
CACTUS CLUB	CACTUS CLUB	ERIC J UECKE, SP	2496 S WENTWORTH AV	Class B Tavern License	80		7/29/2015
CIAO CUCINA, LLC	CAFE LULU	SARAH F JONAS, Agt	2261-65 S Howell AV	Class B Tavern License	139	50 - cafe & 139 - tavern	4/9/2016
COMET GROUP, INC	HONEYPIE CAFE	VALERIE A LUCKS, Agt	2643 S KINNICKINNIC AV	Class B Tavern License	49		5/4/2016
District 14 Craft Brewing, LLC	D14 Brewery & Pub	MATTHEW G MC CULLOCH, Agt	2273 S Howell AV	Class B Tavern License	75		9/22/2015
DOMINIC & PHILIP, INC	DE MARINIS ORIGINAL RECIPES	LUCIA R DE MARINIS, Agt	1211 E CONWAY ST	Class B Tavern License	160		11/5/2015
DRI 5 BAYVIEW LLC	CAFE CENTRAAL	MICHAEL J EITEL, Agt	2306 S KINNICKINNIC AV	Class B Tavern License	261		6/30/2015
FRANK'S NEWPORT, LLC	THE NEWPORT LOUNGE	FRANCIS C CREED, Agt	939 E CONWAY ST	Class B Tavern License	80		5/19/2016
Guanajuato Mexican Restaurant, LLC	Guanajuato Mexican Restaurant	CAROLINA GAMINO, Agt	2317 S Howell AV	Class B Tavern License			7/30/2015
HIGGSKI, INC	BAY VIEW BOWL	MICHAEL S KOSINSKI, Agt	2416 S KINNICKINNIC AV	Class B Tavern License	160		7/12/2015
HOWLING YAM, INC	CLUB GARIBALDI	JOSEPH F DEAN, Agt	2501 S SUPERIOR ST	Class B Tavern License	150		5/19/2016
LAKE EXPRESS, LLC	LAKE EXPRESS	KENNETH J SZALLAI, Agt	2330 S LINCOLN MEMORIAL DR	Class B Tavern License			1/27/2016
LANDLUBBERS, INC	VICTORIA'S	GENE M MC KIERNAN, Agt	1100 E POTTER AV	Class B Tavern License			9/29/2015
Lazy Susan MKE Inc	Lazy Susan MKE	AMANDA J DIXON, Agt	2376-78 S Howell AV	Class B Tavern License	80		1/21/2016
LOGAN & POTTER, INC	BURNHEARTS	WILLIAM J SEIDEL, Agt	2599 S LOGAN AV	Class B Tavern License	80		9/24/2015
Love Bowl Inc	Goodkind	WILLIAM J SEIDEL, Agt	2457 S Wentworth AV	Class B Tavern License			5/12/2016
MAPLE LEAF ENTERPRISES, LLC	SUGAR MAPLE	BRUNO JOHNSON, Agt	441 E LINCOLN AV	Class B Tavern License	160		7/30/2015
Marcat Corp	Hue Restaurant	MARK V NIELSEN, Agt	2691 S Kinnickinnic AV	Class B Tavern License	48		4/1/2016
MIDWEST DINER SOUTH, INC	MIDWEST DINER	JOHN J KARDARIS, Agt	2321 S KINNICKINNIC AV	Class B Tavern License			2/1/2016
MO JO OF MILWAUKEE, INC	PALOMINO BAR	SCOTT M JOHNSON, Agt	2491 S SUPERIOR ST	Class B Tavern License	80		9/23/2015
Morgan Kenwood, LTD	Avalon	JOHN P BRANNAN, Agt	2473 S Kinnickinnic AV	Class B Tavern License			12/15/2015
NEHRING'S BAYVIEW MARKET, LLC	G GROPP'S FOOD MARKET	ANNE C FINCH-NEHRING, Agt	1441 E RUSSELL AV	Class B Tavern License			9/26/2015
NEVADA PRODUCTIONS LLC	THE TONIC TAVERN	PAUL U JONAS, Agt	2335 S KINNICKINNIC AV	Class B Tavern License	99		2/10/2016
Piedmont Property Corporation	Puddler's Hall	Casey C Foltz, Agt	2461 S St Clair ST	Class B Tavern License	80		9/9/2015
RADBAT LLC	Odd Duck	ROSS M BACHHUBER, Agt	2352-54 S Kinnickinnic AV	Class B Tavern License	80		2/27/2016
Rap Us Corp	Cafe India - Bar & Grill	RAKESH REHAN, Agt	2201 S Kinnickinnic AV	Class B Tavern License			9/15/2015
SPECTACLE ENTERPRISES, INC	The Down And Over Pub	TIMOTHY J BRODERSEN, Agt	2535 S KINNICKINNIC AV	Class B Tavern License	140		6/30/2015
Still Shakers	Still Shakers	Brent A Rupcich, SP	1051 E POTTER AV	Class B Tavern License	65		11/1/2015
SUMO, LLC	THE HIGHBURY PUB	JOSEPH R KATZ, Agt	2322 S KINNICKINNIC AV	Class B Tavern License	80		6/14/2015
THREE BROTHERS RESTAURANT LLC	THREE BROTHERS RESTAURANT	Patricia J Radicevic, Agt	2414 S ST CLAIR ST	Class B Tavern License	25		5/19/2015
Three Sheets LLC	The Stone	SHAWN T LEET, Agt	2422 S Howell AV	Class B Tavern License			7/29/2015
TOTA'S, LLC	RIVIERA MAYA RESTAURANT	JOSE G BOTELLO, Agt	2258-60 S KINNICKINNIC AV	Class B Tavern License	90		7/6/2015
No 1 Chinese Restaurant, LLC	No 1 Chinese Restaurant	Xiao Yan Zhang, Agt	2678 S Kinnickinnic AV	Class C Wine Retailer's License			12/19/2015



Thursday, June 25, 2015



# Notice of Public Hearing

---

JONAS, Paul U, Agent  
Urban BayView at 939 E Lincoln Av  
Class B Tavern and Public Entertainment Premises License Applications Requesting a Jukebox

**Tuesday, July 07, 2015 at 9:00 AM**

To whom it may concern:

The above application has been made by the above named applicant(s). This requires approval from the Licenses Committee and the Common Council of the City of Milwaukee. The hearing before the Licenses Committee will take place on 7/7/2015 at 9:00 AM, in Room 301-B, Third Floor, City Hall. If you wish, you may provide testimony at the hearing regarding the request; see below for further information. You are not required to attend the hearing. Once the Licenses Committee makes its recommendation, this recommendation is forwarded to the full Common Council for approval at its next regularly scheduled hearing. Please review the information below and if you have further questions regarding this process, please contact the License Division at (414) 286-2238.

---

## Important details for those wishing to provide information for the Licenses Committee to consider when making its recommendation:

1. The license application is scheduled to be heard at the above time. Due to other hearings running longer than scheduled, you may have to wait some time to provide your testimony.
2. You must appear in person and testify as to matters that you have personally experienced or seen. (You cannot provide testimony for your neighbor, parent or anyone else; this is considered hearsay and cannot be considered by the committee.)
3. No letters or petitions can be accepted by the committee (unless the person who wrote the letter or the persons who signed the petition are present at the committee hearing and willing to testify).
4. Persons opposed to the license application are given the opportunity to testify first; supporters may testify after the opponents have finished.
5. When you are called to testify, you will be sworn in and asked to give your name, and address. (If your first and/or last names are uncommon please spell them.)
6. You may then provide testimony.
  - a. Include only information relating to the above license application.
  - b. Include only information you have personally witnessed or seen.
  - c. Provide concise and relevant information detailing how this business has affected or may affect the peaceful enjoyment of your neighborhood.
  - d. If by the time you have the opportunity to testify, the information you wish to share has already been provided to the committee, you may state that you agree with the previous testimony. Redundant or repetitive testimony will not assist the committee in making its recommendation.
7. After giving your testimony, the members of the Licenses Committee and the licensee may ask questions regarding the testimony you have given or other factors relating to the license application.
8. Business Competition is not a valid basis for denial or non-renewal of a license.  
**Please Note: If you have submitted an objection to the above application your objection cannot be considered by the committee unless you personally testify at the hearing.**

RESIDENT	MAIL ADDRESS	CITY AND ZIP CODE
CURRENT RESIDENT	2313 S LOGAN AVE	MILWAUKEE, WI 53207-1716
CURRENT RESIDENT	2316 S LENOX ST	MILWAUKEE, WI 53207-1704
CURRENT RESIDENT	2319 S LOGAN AVE	MILWAUKEE, WI 53207-1716
CURRENT RESIDENT	2322 S LENOX ST	MILWAUKEE, WI 53207-1704
CURRENT RESIDENT	2323 S LOGAN AVE	MILWAUKEE, WI 53207-1716
CURRENT RESIDENT	2325 S LOGAN AVE	MILWAUKEE, WI 53207-1716
CURRENT RESIDENT	2325A S LOGAN AVE	MILWAUKEE, WI 53207-1716
CURRENT RESIDENT	2326 S LENOX ST	MILWAUKEE, WI 53207-1704
CURRENT RESIDENT	2327 S LOGAN AVE	MILWAUKEE, WI 53207-1716
CURRENT RESIDENT	2327A S LOGAN AVE	MILWAUKEE, WI 53207-1716
CURRENT RESIDENT	2328 S LENOX ST	MILWAUKEE, WI 53207-1704
CURRENT RESIDENT	2328A S LENOX ST	MILWAUKEE, WI 53207-1704
CURRENT RESIDENT	2332 S LENOX ST	MILWAUKEE, WI 53207-1704
CURRENT RESIDENT	2337 S LOGAN AVE	MILWAUKEE, WI 53207-1716
CURRENT RESIDENT	903 E LINCOLN AVE	MILWAUKEE, WI 53207-1711
CURRENT RESIDENT	909 E LINCOLN AVE	MILWAUKEE, WI 53207-1711
CURRENT RESIDENT	912 E LINUS ST	MILWAUKEE, WI 53207-1715
CURRENT RESIDENT	914 E LINUS ST	MILWAUKEE, WI 53207-1715
CURRENT RESIDENT	915 E LINCOLN AVE	MILWAUKEE, WI 53207-1711
CURRENT RESIDENT	919 E LINCOLN AVE	MILWAUKEE, WI 53207-1711
CURRENT RESIDENT	925 E LINCOLN AVE	MILWAUKEE, WI 53207-1711
CURRENT RESIDENT	929 E LINCOLN AVE	MILWAUKEE, WI 53207-1711
CURRENT RESIDENT	930 E LINUS ST	MILWAUKEE, WI 53207-1715

**Total Records: 24**

**Radius: 250.0 feet and Center of Circle: 939 E Lincoln AV**



Thursday, June 25, 2015

## Licenses Committee Notice of Hearing

GERRY'S DIAMOND TAP, LLC  
939 E LINCOLN Av

MILWAUKEE, WI 53207

Date: 7/7/2015  
Time: 09:00 AM  
Location: Room 301-B, Third Floor, City Hall

The Licenses Committee will consider the following license application:

Class B Tavern and Public Entertainment Premises License Applications  
Requesting a Jukebox  
JONAS, Paul U, Agent  
Urban BayView at 939 E Lincoln Av

Please note this application may be recommended for denial based on fitness of the location due to concentration of alcohol beverage outlets in the area. If the application is denied for this reason, no other application for an alcohol beverage license for this location shall be recommended for approval by the Licenses Committee within three years of the date of denial unless the applicant has demonstrated a change of circumstances since the prior denial.

If you have any questions, please call (414) 286-2238.





Thursday, June 25, 2015

## Licenses Committee Notice of Hearing

Paul Jonas  
1501 E Manitoba St  
Milwaukee, WI 53207

Date: 7/7/2015  
Time: 09:00 AM  
Location: Room 301-B, Third Floor, City Hall

The Licenses Committee will consider the following license application:

Class B Tavern and Public Entertainment Premises License Applications  
Requesting a Jukebox  
JONAS, Paul U, Agent  
Urban BayView at 939 E Lincoln Av

Please note this application may be recommended for denial based on fitness of the location due to concentration of alcohol beverage outlets in the area. If the application is denied for this reason, no other application for an alcohol beverage license for this location shall be recommended for approval by the Licenses Committee within three years of the date of denial unless the applicant has demonstrated a change of circumstances since the prior denial.

If you have any questions, please call (414) 286-2238.





**ALCOHOL BEVERAGE & PUBLIC ENTERTAINMENT PREMISES  
SUPPLEMENTAL PLAN OF OPERATION**

Office of the City Clerk License Division  
200 E. Wells St. Room 105, Milwaukee, WI 53202  
(414) 286-2238 e-mail address: license@milwaukee.gov [www.milwaukee.gov/license](http://www.milwaukee.gov/license)

Legal Entity Name: <u>U.C. JONAS INC.</u>
Premise Address: <u>939 E LINCOLN AVE</u>
<b>Proximity of Premises to Church, School, Daycare Center or Hospital</b>
Is there at least 300 feet between the building and any church, school, daycare center or hospital? <input checked="" type="checkbox"/> Yes <input type="checkbox"/> No
<b>"Service Bar Only" Designation</b>
If applying for Class B or C license, are you applying for "Service Bar Only"? <input checked="" type="checkbox"/> No <input type="checkbox"/> Yes Service Bar Only means customers cannot sit at the bar. Alcohol is served to patrons seated at tables. No stools, chairs or other articles of furniture shall be placed at the service bar for patrons to sit upon.
<b>Business Information</b>
a) Are you taking out this application for anyone that may not be eligible for a license? <input checked="" type="checkbox"/> No <input type="checkbox"/> Yes If yes, list name and address: _____
b) Will the agent, a partner or the individual licensee be conducting the day-to-day operations of the business? <input type="checkbox"/> No <input checked="" type="checkbox"/> Yes If no, list the name and address of the person(s) who will: _____  Class B Applicants: If the agent, a partner or the individual licensee will not be conducting the day-to-day operations of the business, the person(s) listed above must obtain a Class B Managers license.
c) Does anyone else have money invested or any other interest in this business? <input checked="" type="checkbox"/> No <input type="checkbox"/> Yes If yes, explain: _____
d) Have you made an agreement with anyone to repay any loan or any other payments based upon income from the business? <input type="checkbox"/> No <input checked="" type="checkbox"/> Yes If yes, list name and address: <u>SPRING BANK 16620 W BULLIEMOUND RD #100</u>
<b>Proof of Ownership, Lease, or Offer to Purchase (new &amp; transfer applicants only)</b> <u>#100 BROADFIELD, WI 53005</u>
Submit proof of ownership, lease, or offer to purchase the building with this application. A lease or offer to purchase must: a) Be in the same legal entity name as that apply for the license b) Reflect the same address as the premises address on this application c) Reflect current dates and d) Be signed by the lessor/seller and lessee/buyer
<b>Property Information (new &amp; transfer applicants only)</b>
a) Do you own or lease the building? <input checked="" type="checkbox"/> Own <input type="checkbox"/> Lease
b) Who owns the fixtures (for example, coolers, etc.)? <u>ME</u>
c) Are you purchasing the stock and/or fixtures? <input type="checkbox"/> No <input checked="" type="checkbox"/> Yes If yes, amount paid \$ <u>0</u>
d) Total amount paid for business \$ _____
e) Total amount paid for goodwill of the business \$ <u>0</u> Goodwill comprises the reputation and customer relationships of an existing business. If the price you pay for the business exceeds the fair market value of all of the rest of the assets of the business, the excess may be considered goodwill.
f) Have you made arrangements with the seller for payment of personal property taxes? <input checked="" type="checkbox"/> No <input type="checkbox"/> Yes

See Application Information for a list of all required application forms.



**Lease Information (new & transfer applicants who are leasing the premises only)**

- a) Date lease begins MAY 1 2015 Ends \_\_\_\_\_
- b) Monthly rental \$ 3800.00
- c) Do you have an option to renew the lease?  No  Yes
- d) Does your lease allow for assignment to another party without the consent of the owner?  No  Yes
- e) For what length of time have you been guaranteed occupancy (number of years)? \_\_\_\_\_
- f) In addition to paying the monthly rental, will you have to pay anything additional to the owner of the building to guarantee performance of the lease?  No  Yes If yes, explain \_\_\_\_\_
- g) Does the present owner or occupancy object to the granting of your license?  No  Yes  
If yes, explain \_\_\_\_\_

**Change of Agent Applicants Only**

Have there been any changes to the floor plan since the last application was submitted?  No  Yes  
If no, a new floor plan is not required. If yes, submit a new floor plan and explain the change(s): \_\_\_\_\_

**Notarized Signatures of Applicants**

SUBSCRIBED AND SWORN TO BEFORE ME  
This 1st day of MAY, 20 15

[Signature]  
(Clerk/Notary Public)

My Commission Expires MARCH 22, 2019  
\*Notary Seal must be affixed.

[Signature]  
Sole Proprietor, Partner, 20% or more Shareholder, or  
Agent—only if there are no 20% or more shareholders

Additional partner or 20% or more shareholder

Note: All information contained in this application is subject to approval by the Common Council.  
Deviating from approved plan of operation will subject licensee to citations, and/or suspension or non-renewal of the license.  
Contact the License Division for information on how to request changes.

**New and transfer of premise applicants must submit the following:**

- Proof of ownership, lease or offer to purchase the building
- Detailed floor plan
- If a restaurant, copy of the menu

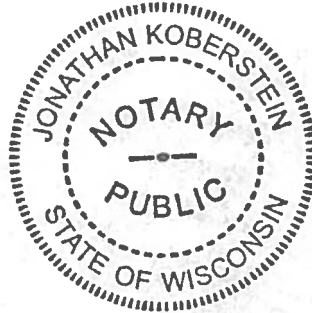



# BUSINESS LICENSE PLAN OF OPERATION

ccl-busplan 3/17/15

Office of the City Clerk License Division  
200 E. Wells St. Room 105, Milwaukee, WI 53202  
(414) 286-2238 www.milwaukee.gov/license e-mail address: [license@milwaukee.gov](mailto:license@milwaukee.gov)

## 1. Type of Business

Applying for:  Extended Hours Establishment License  Filling Station License  Other (plan of operation for specific license also required)

Provide a detailed description of the type of business you plan on operating:

CLASS 'B' TAVERN

Do you have any experience operating this type of business?  No  Yes

If yes, explain:

## 2. Business Operations

- a. Proposed Opening Date: JULY 4th 2015
- b. Is this premise under construction?  No  Yes If yes, list estimated completion date: JULY 1 2015
- c. Is this a franchise?  No  Yes
- d. Is this premises currently licensed?  No  Yes If yes, list type of license: \_\_\_\_\_
- e. Is the current licensee operating?  No  Yes If no, list date closed: \_\_\_\_\_
- f. Do you have future plans for other businesses, licenses or permits at this location?  No  Yes  
If yes, explain: \_\_\_\_\_
- g. Have you previously held an Extended Hours License in Milwaukee?  No  Yes  
If yes, list address(es): \_\_\_\_\_
- h. Are other businesses operating in the same building?  No  Yes If yes, describe: \_\_\_\_\_

## 3. Litter & Noise Control

- a. How are grounds kept clean?  Sweep  Pressure Wash  Pick Up Litter  Hired Maintenance  
 Building Owner Responsibility  Garbage Cans Outside  Other: \_\_\_\_\_
- b. How often will grounds be cleaned?  Daily  Weekly  As Needed  Monthly  Other: \_\_\_\_\_
- c. Grounds cleaned by:  Licensee  Building Owner  Employees  Hired Maintenance  Other: \_\_\_\_\_
- d. How are noise issues prevented and/or addressed?  Security  Manager approaches customer(s)  Call Police  
 Signs Posted  Other: \_\_\_\_\_  
Will a sound amplification system be used?  No  Yes If yes, describe: STEREO SYSTEM
- e. Are there designated outdoor smoking areas?  No  Yes If yes, describe: PATIO TO WEST
- f. Number of Garbage Cans: Inside: 6 Locations: BATHROOMS, BACK BAR, common AREA  
Outside: 2 Locations: NORTH & SOUTH CORNER
- g. Is a crowd control barrier used?  No  Yes If yes, describe: \_\_\_\_\_
- h. Describe sanitation facilities (restrooms): ALL NEW (2015) ADA ACCESSIBLE
- i. Name of solid waste contractor:  Advanced Disposal  Waste Management  Other: \_\_\_\_\_

#### 4. Parking & Security

- a. Are there off-street parking places?  No  Yes If yes, how many? \_\_\_\_\_  
 Describe security plan for parking lot: \_\_\_\_\_
- b. Is there a loading zone?  No  Yes If yes, describe security for loading zone \_\_\_\_\_
- c. Will you have security personnel on premise?  No  Yes If yes, how many? \_\_\_\_\_  
 What are their responsibilities? \_\_\_\_\_  
 Is security equipment used?  No  Yes If yes, describe \_\_\_\_\_  
 List their licensing, certification, or training credentials \_\_\_\_\_  
 Will there be security cameras?  No  Yes If yes, where? INTERIOR  
 Will searches or identification checks be conducted upon entry?  No  Yes If yes, describe \_\_\_\_\_

#### 5. Percentage of Sales (must total 100%)

Alcohol <u>100%</u>	Food _____%	Secondhand Merchandise _____%	Precious Metals & Gems _____%
Entertainment _____%	Cigarettes <u>2</u> %		
Pawnbroker Activity _____%	Salvaged Materials _____% (such as scrap metal)	Other _____% Describe: _____	

#### 6. Businesses/Licenses on the Premises (check all that apply):

##### Type 1

- Full Service Restaurant   
  Cafe/Coffee Shop   
  Deli or Fast Food Restaurant   
  Private/Fraternal/Veterans Club  
 Night Club   
  Tavern   
  Cocktail Lounge   
  Teen Club  
 Bowling Alley   
  Hotel   
  Banquet Hall   
  Sports Facility

##### Type 2

- Liquor Store   
  Corner Store   
  Supermarket   
  Convenience Store  
 Gas Station   
  Amusement/Phonograph Distributor   
  Auto Wrecker  
 Used Car Dealer   
  Used Auto Parts   
  Personal Service Establishment   
  Recording Studio

What other types of licenses/permits will you hold at this location? (check all that apply)

- Occupancy Permit   
  Cigarette & Tobacco   
  Gas Station   
  Extended Hours   
  Class "B" Tavern   
  Weights & Measures  
 Secondhand Dealer   
 Precious Metal & Gem   
 Other: \_\_\_\_\_

#### 7. Legal Capacity (only if a Type 1 premises in #6 above)

Capacity 80 (Call the Milwaukee Development Center at 414-286-8211 if you have questions.)

## 8. Premises Description

d. Identify all area(s) of the premises that will be used in operating this business (include areas used only for storage):

1<sup>st</sup> Floor  2<sup>nd</sup> Floor  Basement Storage  Patio  Beer Garden  Sidewalk Café  Deck  Rooftop

Other: Describe: \_\_\_\_\_

e. Describe Location:  Major Thoroughfare  Secondary Street  Other: \_\_\_\_\_

f. Nearest Major Cross Street: KINNIE KINNIE & BAY STREET

g. Describe Building:  Free Standing Building  Strip Mall  Other: \_\_\_\_\_

h. Describe Premises Structure:  Single Story  Multi-Story - # of Stories 2  Other: \_\_\_\_\_

i. Describe Surrounding Area:  Commercial  Residential  Industrial  Other: \_\_\_\_\_

j. Property Owner's Name: Paul JONAS Phone Number: 414-588-7366

Address: 1501 E MANITOBA ST. MILWAUKEE WI 53207

## 9. Hours of Operation & Customers

Will customers be entering the premises?  No  Yes

Day of the Week	Proposed Hours of Operation:		Number of Customers expected each day	Potential Age Range of Customers	Class B Applicants: Age Restriction (If none, write 'None')
	Open (include a.m. or p.m.)	Close (include a.m. or p.m.)			
Sunday	6:00 AM	2 AM	40	25-50	NONE
Monday	↓	↓	40	↓	↓
Tuesday	↓	↓	40	↓	↓
Wednesday	↓	↓	40	↓	↓
Thursday	↓	2:00 AM	60	↓	↓
Friday	↓	2:30 AM	80	↓	↓
Saturday	6:00 AM	2:30 AM	80	25-50	

Entertainment Indoor Closing Hours - If alcohol beverage establishment, same as alcohol license hours.  
If non-alcohol establishment 1:00 am Sunday to Thursday; 1:30 am Friday and Saturday.

Entertainment Outdoor Closing Hours - 10:00 pm Sunday - Thursday; 12:00 am Friday and Saturday,  
unless otherwise approved by Common Council in licensee's plan of operation.

## 10. Required Signature(s)

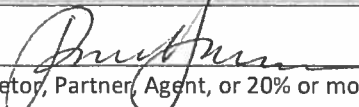
  
Sole Proprietor, Partner, Agent, or 20% or more Shareholder

\_\_\_\_\_  
Signature of additional partner or 20% or more Shareholder

See Application Information for a list of all required application forms.



# PUBLIC ENTERTAINMENT PREMISES LICENSE SUPPLEMENTAL APPLICATION

Office of the City Clerk License Division  
200 E. Wells St. Room 105, Milwaukee, WI 53202  
(414) 285-2238 [www.milwaukee.gov/license](http://www.milwaukee.gov/license) e-mail address: [license@milwaukee.gov](mailto:license@milwaukee.gov)

TYPES OF ENTERTAINMENT (CHECK ALL THAT APPLY)			
<input type="checkbox"/> Instrumental Musicians	<input type="checkbox"/> Bands	<input type="checkbox"/> Battle of the Bands	<input type="checkbox"/> Comedy Acts
<input type="checkbox"/> Disc Jockey	<input type="checkbox"/> Magic Shows	<input type="checkbox"/> Poetry Readings	<input type="checkbox"/> Dancing by Performers
<input type="checkbox"/> Adult Entertainment/ Strippers/Erotic Dance	<input type="checkbox"/> Wrestling	<input type="checkbox"/> Patron Contests	<input type="checkbox"/> Patrons Dancing
<input checked="" type="checkbox"/> Jukebox	<input type="checkbox"/> Karaoke	<input type="checkbox"/> Bowling Alley	<input type="checkbox"/> Pool Tables
<input type="checkbox"/> Motion Pictures	<input type="checkbox"/> Amusement Machines -	<input type="checkbox"/> Concerts	<input type="checkbox"/> Theatrical Performances
How many? _____	How many? _____	Approx. # per year? _____	Approx. # per year? _____
<input checked="" type="checkbox"/> Other: <u>HUGE MUSIC SYSTEM</u>			
WILL PROMOTERS EVER BE USED FOR ANY OF THE ENTERTAINMENT?			
<input checked="" type="checkbox"/> No <input type="checkbox"/> Yes, describe: _____			
LEGAL CAPACITY OF PREMISES			
_____ (Call the Development Center at 414-286-8211 with questions.) Legal capacity determines the fee for your Public Entertainment Premises License. If you would like to request the license be approved with a lower capacity than that listed above, indicate the lower capacity here: _____. If approved, this lower capacity will print on your license and override the capacity listed on your Occupancy Permit.			
WILL SOUND AMPLIFICATION EVER BE USED?			
<input type="checkbox"/> No <input checked="" type="checkbox"/> Yes, describe: <u>IN HUGE STEREO SYSTEM</u>			
DECLARATIONS, ACKNOWLEDGEMENTS, & DISCLOSURES			
Read And Initial Each Item Confirming Your Understanding:			
1 <input checked="" type="checkbox"/> I understand that after the license has been issued, a change to the plan of operation will require a written request to change and approval from the Common Council.			
2 <input checked="" type="checkbox"/> I agree to inform the City Clerk within 10 days of any substantial changes in the information supplied in this application.			
3 <input checked="" type="checkbox"/> I understand that I shall not willfully refuse to provide the services offered under this license, or add charges or require deposits not required of the general public because of race, color, sex, religion, national origin or ancestry, age, handicap, lawful source of income, marital status, sexual orientation, gender identity or expression, familial status or the fact that a person is now or has been a member of the military service, whether dressed in uniform or not; and shall not seek such information as a condition of employment, or penalize any employee or discriminate in the selection of personnel for training or promotion on the basis of such information.			
4 <input checked="" type="checkbox"/> I have knowledge of the City Ordinances currently regulating public entertainment, and understand that the license may be subject to suspension, non-renewal or revocation, if I violate any rule, law or regulation of the city of Milwaukee and State of Wisconsin.			
NOTARIZED SIGNATURES OF APPLICANTS			
SUBSCRIBED AND SWORN TO BEFORE ME			
This <u>18<sup>th</sup></u> day of <u>MAY</u> , 20 <u>15</u>		<u>[Signature]</u> Agent/ Owner/ Partner	
<u>[Signature]</u> (Clerk/Notary Public)		Additional Owner/ Partner	
My Commission Expires <u>MARCH 22, 2019</u> * Notary Seal must be affixed.			

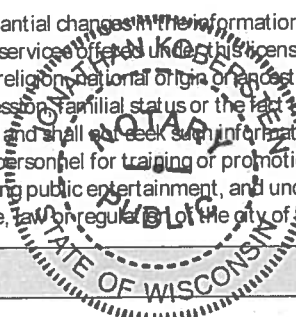

Office Use Only: Initials: \_\_\_\_\_ Filed: \_\_\_\_\_ App: \_\_\_\_\_

Check if only PEP (must be heard w/in 60 days) Granted \_\_\_\_\_ License # \_\_\_\_\_

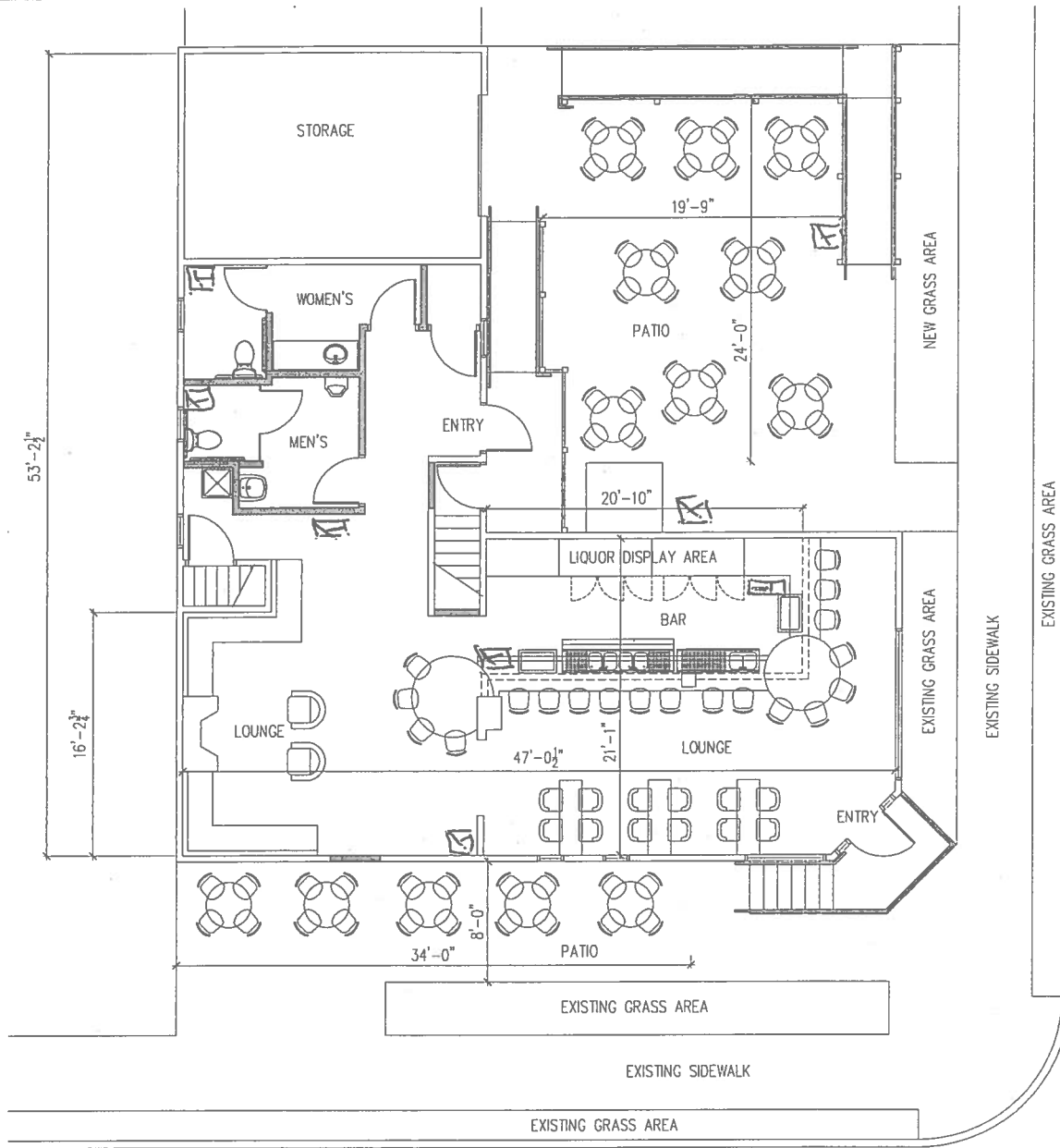

← LOGAN AVE →

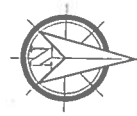

# FIRST FLOOR PLAN

NOT TO SCALE 1,696 sq.ft.

5/18/15

AGENT: PAUL JONAS  
 LEGAL: UC JONAS INC  
 TRADE: URBAN, BAYVIEW  
 2301 S LOGAN /  
 939 E LINCOLN

↑ LINCOLN AVE ↓

VAVRA  
 DESIGN LLC  
 P.O. BOX 70087  
 MILWAUKEE, WISCONSIN 53207  
 414-732-9163

TAVERN REMODELING  
 2301 SOUTH LOGAN AVE  
 MILWAUKEE, WISCONSIN 53207

DATE ISSUED  
 MAY 18th 2015

SHEET  
 11

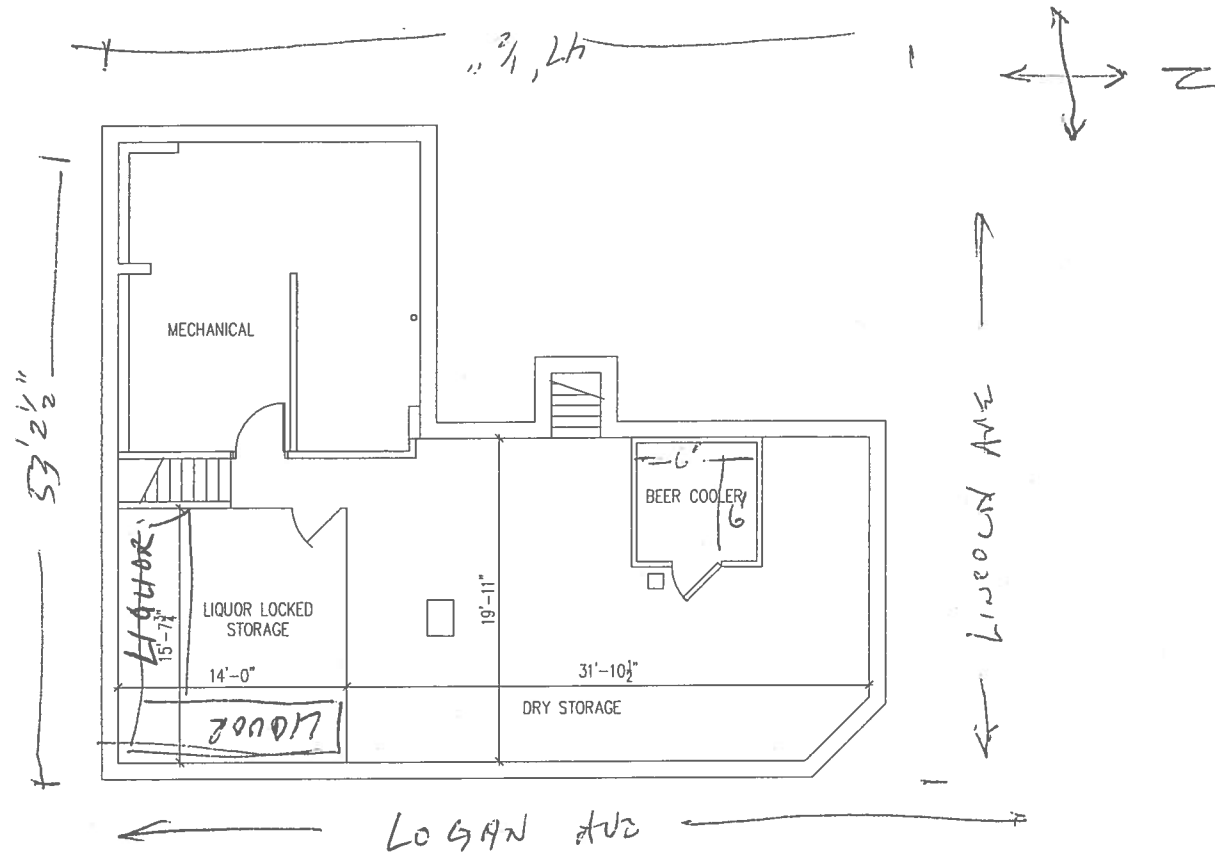

5/18/15

AGENT = PAUL JONAS  
 LEGAL = U.C JONAS  
 TRADE : URBAN, BAY VIEW  
 2301 S LOGAN  
 939 E LINCOLN

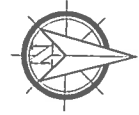

# LOWER LEVEL FLOOR PLAN

NOT TO SCALE

1,410 sq.ft.

SHEET TITLE  
TAVERN REMODELING

2301 SOUTH LOGAN AVE  
MILWAUKEE, WISCONSIN 53207

DATE ISSUED  
MAY 18th 2015

SHEET

# A2



CITY OF MILWAUKEE  
OFFICE OF THE CITY CLERK

Wednesday, June 24, 2015

COMMITTEE MEETING NOTICE

AD 14

LEET, Shawn T, Agent  
Three Sheets LLC  
2422 S Howell Av

Milwaukee, WI 53207

You are requested to attend a hearing which is to be held in Room 301-B, Third Floor, City Hall on:

**Tuesday, July 07, 2015 at 09:00 AM**

**Regarding:** Your Class B Tavern and Public Entertainment Premises License Renewal Applications as agent for "Three Sheets LLC" for "The Stone" at 2422 S Howell Av.

There is a possibility that your application may be denied for one or more of the following reasons: The recommendation of the committee regarding the application shall be based on evidence presented at the hearing. Per MCO 85-4-4, unless otherwise specified in the code, probative evidence concerning non-renewal, suspension or revocation may include evidence of the following: failure of the applicant to meet municipal qualifications, pending charges against or the conviction of any felony, misdemeanor, municipal offense or other offense, the circumstances of which substantially relate to the circumstances of the particular licensed or permitted activity, by the applicant or by any employee or other agent of the applicant. If the activities of the applicant involve a licensed premises, whether the premises tends to facilitate a public or private nuisance or has been the source of congregations of persons which have resulted in any of the following: disturbance of the peace; illegal drug activity; public drunkenness; drinking in public; harassment of passers-by; gambling; prostitution; sale of stolen goods; public urination; theft; assaults; battery; acts of vandalism including graffiti, excessive littering, loitering, illegal parking, loud noise at times when the licensed premise is open for business; traffic violations; curfew violations; lewd conduct; display of materials harmful to minors, pursuant to s. 106-9.6; or any other factor which reasonably relates to the public health, safety and welfare, or failure to comply with the approved plan of operation. See attached police report or correspondence.

**Notice for applicants with warrants or unpaid fines:**

Proof of warrant satisfaction or payment of fines must be submitted at the hearing on the above date and time. Failure to comply with this requirement may result in a delay of the granting/denial of your application.

Failure to appear at this meeting may result in the denial of your license. Individual applicants must appear only in person or by an attorney. Corporate or Limited Liability applicants must appear only by the agent designated on the application or by an attorney. Partnership applicants must appear by a partner listed on the application or by an attorney. If you wish to do so and at your own expense, you may be accompanied by an attorney of your choosing to represent you at this hearing.

You will be given an opportunity to speak on behalf of the application and to respond and challenge any charges or reasons given for the denial. No petitions can be accepted by the committee, unless the people who signed the petition are present at the committee hearing and willing to testify. You may present witnesses under oath and you may also confront and cross-examine opposing witnesses under oath. If you have difficulty with the English language, you should bring an interpreter with you, at your expense, so that you can answer questions and participate in your hearing.

You may examine the application file at this office during regular business hours prior to the hearing date. Inquiries regarding this matter may be directed to the person whose signature appears below.

Limited parking for persons attending meetings in City Hall is available at reduced rates (5 hour limit) at the Milwaukee Center on the southwest corner of East Kilbourn and North Water Street. Parking tickets must be validated in the first floor information booth in City Hall.

PLEASE NOTE: Upon reasonable notice, efforts will be made to accommodate the needs of disabled individuals through sign language interpreters or other auxiliary aids. For additional information or to request this service, contact the Council Services Division ADA Coordinator at (414) 286-2998, Fax - (414) 286-3456, TDD - (414) 286-2025.

JIM OWCZARSKI, CITY CLERK

BY: \_\_\_\_\_

Jason Schunk  
License Division Manager

**If you have questions regarding this notice, please contact the License Division at (414) 286-2238.**

200 E. Wells Street, Room 105, City Hall, Milwaukee, WI 53202. [www.milwaukee.gov/license](http://www.milwaukee.gov/license)  
Phone: (414) 286-2238 Fax: (414) 286-3057 Email Address: [License@milwaukee.gov](mailto:License@milwaukee.gov)



MILWAUKEE POLICE DEPARTMENT  
LICENSE INVESTIGATION UNIT

CRIMINAL RECORD/ORDINANCE VIOLATION/INCIDENTS  
SYNOPSIS

DATE: 05/27/2015

LICENSE TYPE: BTAVN

NEW:

RENEWAL: X

No. 211760

Application Date: 05/27/2015

Expiration Date:

License Location: 2422 S Howell Avenue

Aldermanic District: 14

Business Name: Stepping Stone

Licensee/Applicant: Leet, Shawn T

(Last Name, First Name, MI)

Date of Birth: 11/25/72

Male:

Female:

Home Address: 2424 S Howell Avenue

City: Milwaukee

State: Wi

Zip Code: 53207

Home Phone: (414) 507-8244

This report is written by Police Officer Gilbert Gwinn, assigned to the License Investigation Unit, Days.

The Milwaukee Police Department's investigation regarding this application revealed the following:

1. On 10-22-1993 Shawn T Leet was arrested and convicted in then State of California for Operating While Intoxicated.
2. On 10-30-2000 Shawn T Leet was arrested in Milwaukee County for the following:

Charge	: Operating While Intoxicated (2 <sup>nd</sup> )
Finding	: Guilty
Sentence	: Fined & Suspended 18 months,
Date	: 2-27-2001
Case	: 00CT006191 Oak Creek PD

3. On 11-16-2003 at 3:11am Milwaukee Police were sent to 2422 S Howell Ave, Stepping Stone, for a tavern violation. Upon arrival police saw seven persons inside the tavern including the licensee. When officers pounded on the front door some patrons ran out the back door and some ran upstairs to the apartment above the tavern. Someone shouted that the cops were outside but no one opened the door even after continued pounding by an officer. The patrons and licensee were found at the back door.

As to the licensee, Leet, Shawn T:

Charge : a. Immediate Entry For Police  
b. Patrons After Hours  
Finding : a. Guilty  
b. Case Dismissed w/o Prejudice  
Sentence : a. \$300.00  
Date : 2-13-2004 both  
Case : a. 03170029  
b. 03170030

4. On 9-23-2004 Milwaukee Police Officers conducted a licensed premise check at the Stepping Stone tavern, 2422 S Howell Ave. They found a cigarette vending machine and a game machine and a pull tab machine on the premises. The premise did not have a cigarette license nor any amusement machine license. The licensee Shawn T Leet was issued citation for the following:

Charge : a. License & Permit Req./Video & Amusement  
b. Cigarette & Tobacco License  
Finding : a. Guilty  
b. Dismissed  
Sentence : a. \$212.00  
Date : a. 11-16-2004  
Case : a. 04115990  
b. 04115989

5. On 12-10-2004 at 7:20pm, an underage Milwaukee police aide entered the Stepping Stone tavern at 2422 S Howell Ave, at the direction of Milwaukee police officers. The aide was able to purchase a bottle of beer from the bartender, Wayne A Miller.

The licensee, Shawn T Leet was cited for the following:

Charge: SaleTo Underage  
Finding: Dismissed w/o Prejudice  
Date: 07-18-05  
Case : 05003870

The bartender, Wayne A Miller was cited for the following:

Charge : Sale To Underage  
Finding : Guilty  
Sentence : \$152.00  
Date : 2-1-2005  
Case : 05003883

6. On 2-1-2005 at 2:40am Milwaukee Police Officers on routine patrol heard loud music coming from the tavern, The Stepping Stone, 2422 S Howell Ave. They then observed 3 persons sitting at the bar. When officers knocked on the door two persons ran to an eastside door and when they opened the door, they saw an officer, closed the door and were later found hiding in the basement cooler (one of them was 19 years old). Shawn Leet was behind the bar. He told officers that the other two persons were employees. Officers observed the rear door dead bolted. Also, there was not an address on the front of the building. Shawn Leet was cited for the following:

Charge : a. Obstructing Issuance of Citation  
b. Exterior Code Violation  
c. Sale To Underage  
d. Presence of Underage  
e. Class B Tavern-Patrons After Hours  
f. Safe Egress From Ent Doors

Finding a. Dismissed w/o Prejudice  
b. Guilty  
c. Dismissed w/o Prejudice  
d. Dismissed w/o Prejudice  
e. Guilty  
f. Dismissed w/o Prejudice

Sentence b. Fined \$398.00  
e. Fined \$831.72

Date 07-18-05

Case : a. 05021125  
b. 05021127  
c. 05021126  
d. 05021123  
e. 05021124  
f. 05021128

7. On 03-09-05 at 12:00 am, applicant received a citation for B & Z Violations at 2422-24 S. Howell Ave.

Charge: B & Z Violations  
Finding: Guilty  
Sentence: Fined \$612.00  
Date: 05-18-06  
Case: 06000505

---

8. On 10/29/06 at 9:26am, Milwaukee Police investigated a Battery complaint that occurred earlier that morning at the Stepping Stone tavern. Investigation revealed that the owner, Shawn Leet, stated that there was a male patron in the bar who was indecently touching female patrons and that he asked this patron to leave the tavern. The patron refused and Leet physically escorted the patron out with the help from other patrons. Leet states neither he nor any of his patrons ever punched or struck the subject. The victim states he suffered bruises to his face because the owner of the bar beat him up. Victim refused medical attention. No citations were issued to either party.

=====

9. On 02/14/09 at 2:38 pm, Milwaukee police were dispatched to 2422 S Howell Avenue for an Entry complaint. Investigation revealed unknown actor(s) pried and kicked in the side entrance door to gain entry to the business and removed liquor and money from the business cash register drawer and fled via the point of entry. A report was filed.

=====

10. On 04/15/2014 the Kristin Pochowski was cited at 2422 South Howell Avenue in the city of Milwaukee for Building Code Violations. Kristin Pochowski is listed on the application as 50% shareholder.

Charge: Building Code Violations  
Finding: Due for further proceedings 06/18/2015 1:30pm branch 3  
Sentence:  
Date:  
Case: 15008241

11. On 07/18/2014 Milwaukee police were dispatched to a noise nuisance complaint at 2422 South Howell Avenue (Stepping Stone). The caller indicated she wanted them to either turn down the music or close the door. Officers discovered the door to the business was open and music could be heard from the sidewalk. The bartender, Elizabeth Schneider, was cooperative and closed the door when asked. No citations were issued.

12. On 12/05/2014 Milwaukee police told Kristin Pochowski, who is listed as 50% shareholder, to fix the light in front of the business at 2422 South Howell Avenue. The officer indicates that he had told the applicant to repair the light in October of 2014.

13. On 01/18/2015 Milwaukee police were dispatched to a noise nuisance complaint at 2422 South Howell Avenue (Stepping Stone). Officers spoke to Kristin Pochowski, who is listed as 50% shareholder, who immediately turned down the music. All the licenses were checked and were up to date.

14. On 03/08/2015 Milwaukee police were dispatched to a noise nuisance complaint at 2422 South Howell Avenue (Stepping Stone). Officers spoke to Kristin Pochowski, who is listed as 50% shareholder, who immediately turned down the music. All the licenses were checked and were up to date.

MILWAUKEE POLICE DEPARTMENT
REPORT OF INCIDENTS INVOLVING LICENSED PERSONS OR PREMISES

TO: Captain of Police Diana ROWE

Business Name: Stepping Stone

Address of Licensed Premises: 2422 S Howell, Milwaukee, WI, 53207

District: 6

Business Phone: 414-483-3888

Type of License: BTAVERN

Violation / Incident #

Date of Incident: 07/18/14

Licensee or Manager on premises at time of violation / incident? Yes No

Licensee cooperative? Yes No (if no, explain in narrative section)

Licensee Notified by Officer: P.O. Jeanine SEE

Date: 07/18/14

Time: 1830

Licensee or Agent's Name: Shawn T. LEET

Date of Birth: 11/25/72

Home Address: 2424 S Howell, Milwaukee

Home Phone: 414-507-8241

Co-Licensee Name:

Date of Birth:

Home Address:

Home Phone:

Class S License Number:

Bartender Name: Elizabeth N. SCHNEIDER

Date of Birth: 06/05/87

Home Address: 601 N. 54th St, Milwaukee, WI 53208

Home Phone: 414-202-4020

Class D License Number: 02013-01

Licensed Person / Public Pass. Vehicle, etc.: SAME AS ABOVE

Date of Birth:

Home Address:

Home Phone:

Class D License Number: 0211728

VIOLATION/INCIDENT - DESCRIBE FACTS AND CIRCUMSTANCES IN NARRATIVE SECTION

Name of Person Cited:

Date of Birth:

Citation Number:

Violation & Ord. / Statue No.:

Court Date:

Name of Person Cited:

Date of Birth:

Citation Number:

Violation & Ord. / Statue No.:

Court Date:

Name of Person Cited:

Date of Birth:

Citation Number:

Violation & Ord. / Statue No.:

Court Date:

Name of Person Cited:

Date of Birth:

Citation Number:

Violation & Ord. / Statue No.:

Court Date:

Name of Person Cited:

Date of Birth:

Citation Number:

Violation & Ord. / Statue No.:

Court Date:

Investigating Officer:

District / Bureau:

Date:

Capt. D. Rowe

AUG 01 2014

Commanding Officer

Date

DISPOSITION - FOR LICENSING ONLY

Table with 5 columns: Citation No., Case Number, Disposition, Judge, Date. Includes handwritten entries for 'LICENSE INVESTIGATION UNIT', 'Received', 'Referred', and 'By'.

PA-33E Narrative

This report is typed by P.O. Jeanine SEE, assigned to District 6, Day Shift.

On 07/18/14 at 621pm, I was assigned to Sq 6240 and dispatched to a Noise Nuisance complaint at 2422 S Howell (Stepping Stone) tavern.

Upon arrival I did observe the front door to the tavern open music was playing, but the music could not be heard more than 50' away.

I could hear the music from the public sidewalk in front of the business, but could not hear the music from the opposite side of the houses to the North and South.

The caller was "Nichole", #414-324-6808, who told me she just wanted the music turned down or the door closed.

I spoke with bartender Elizabeth N. SCHNEIDER (w/f-06-05-87) who was very cooperative and closed the door.

No citations were issued.

# MILWAUKEE POLICE DEPARTMENT

## REPORT OF INCIDENTS INVOLVING LICENSED PERSONS OR PREMISES

TO: Captain Diana Rowe

Business Name: Three Sheets LLC  
Address of Licensed Premises: 2422 S. Howell Ave.  
Business Phone: 483-3888

Type of License: BTavern

District: 6

Violation /  Incident #

Date of Incident: 12/05/14

Licensee or Manager on premises at time of violation / incident?  Yes  No

Licensee cooperative?  Yes  No (If no, explain in narrative section)

Licensee Notified by Officer: Felix, Carlos

Date:  
12/05/14

Time: 5:30PM

Licensee or Agent's Name: Shawn T. Leef  
Home Address: 319 E. Wilbur

Date of Birth: 11/25/72  
Home Phone: 414-507-8244

Co-Licensee Name: Kristin T. Pochowski  
Home Address: 319 E. Wibur Ave  
Class S License Number:

Date of Birth: 07/12/74  
Home Phone: 507-2440

Bartender Name:  
Home Address:  
Class D License Number:

Date of Birth:  
Home Phone:

Licensed Person / Public Pass. Vehicle, etc.:  
Home Address:  
Class D License Number:

Date of Birth:  
Home Phone:

### VIOLATION/INCIDENT - DESCRIBE FACTS AND CIRCUMSTANCES IN NARRATIVE SECTION

Name of Person Cited: N/A  
Citation Number:

Violation & Ord. / Statue No.:

Date of Birth:  
Court Date:

Name of Person Cited:  
Citation Number:

Violation & Ord. / Statue No.:

Date of Birth:  
Court Date:

Name of Person Cited:  
Citation Number:

Violation & Ord. / Statue No.:

Date of Birth:  
Court Date:

Name of Person Cited:  
Citation Number:

Violation & Ord. / Statue No.:

Date of Birth:  
Court Date:

Name of Person Cited:  
Citation Number:

Violation & Ord. / Statue No.:

Date of Birth:  
Court Date:

Investigating Officer:

*Sgt. D. Paszkiewicz*  
Commanding Officer

District / Bureau:

12-9-14

Date:

Date

*Capt. Diana Rowe*

### DISPOSITION - FOR LICENSING ONLY

Citation No.	Case Number	Disposition	Judge	Date

LICENSE INVESTIGATION UNIT

Received *12-30-14*

Referred

By

*[Signature]*

PA-33E Narrative

This report is being submitted by Officer Carlos Felix assigned to squad 6264 at District Six early shift.

On Friday December 5, 2014 at 5:30PM I conducted follow up at 2422 S. Howell Ave The Three Sheets LLC Tavern regarding fixing an exterior light, which Mattt Dama and I advised one of the owner's to repair on October 3, 2014.

---

Upon my arrival I spoke to Kristin T. Pochowski (F/W 07/12/74) who stated she was one of the owners. I advised her of my conversation with owner Shawn T. Leet (M/W 11/25/72), whom she stated was her boyfriend. I informed her that the dark area in the front of the business was public safety issue and light needs to be provided at the entry. I also told her that Dama would be issuing them an Order from the city to correct the problem. She stated that Leet may have been busy and forgot to fix the light, but she would make sure it was replaced.

I filed a PA33 in October regarding my contact with Leet.

This was the end of the follow up.

Respectfully Submitted,



PO. Carlos Felix 015476





PA-33E Narrative

This report is being submitted by Officer Carlos Felix assigned to squad 6264 at District Six early shift.

On Friday December 5, 2014 at 5:30PM I conducted follow up at 2422 S. Howell Ave The Three Sheets LLC Tavern regarding fixing an exterior light, which Mattt Dama and I advised one of the owner's to repair on October 3, 2014.

---

Upon my arrival I spoke to Kristin T. Pochowski (FW 07/12/74) who stated she was one of the owners. I advised her of my conversation with owner Shawn T. Leet (M/W 11/25/72), whom she stated was her boyfriend. I informed her that the dark area in the front of the business was public safety issue and light needs to be provided at the entry. I also told her that Dama would be issuing them an Order from the city to correct the problem. She stated that Leet may have been busy and forgot to fix the light, but she would make sure it was replaced.

I filed a PA33 in October regarding my contact with Leet.

This was the end of the follow up.

Respectfully Submitted,

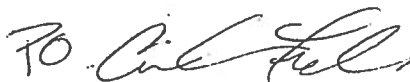

PO. Carlos Felix 015476

# MILWAUKEE POLICE DEPARTMENT

## REPORT OF INCIDENTS INVOLVING LICENSED PERSONS OR PREMISES

TO: Diana ROWE - Captain Of Police

Business Name: The Stone

Address of Licensed Premises: 2422 S. Howell av.

District: 6

Business Phone: 507-8244

Type of License: Class B

Violation /  Incident #

Date of Incident: 01/18/2015

Licensee or Manager on premises at time of violation / Incident?  Yes  No

Licensee cooperative?  Yes  No (if no, explain in narrative section)

Licensee Notified by Officer: P.O. C.JACKSON

Date: 01/18/2015

Time: 8:50am

Licensee or Agent's Name: LEET, Shawn T.

Home Address: 319 E. Wilbur Av.

Date of Birth: 11-25-72

Home Phone: 507-8244

Co-Licensee Name:

Home Address:

Class S License Number:

Date of Birth:

Home Phone:

Bartender Name: POCHOWSKI, Kristin T.

Home Address: 319 E. Wilbur Av

Class D License Number: 210080-25

Date of Birth: 7-12-74

Home Phone: 507-2400

Licensed Person / Public Pass. Vehicle, etc.:

Home Address:

Class D License Number:

Date of Birth:

Home Phone:

### VIOLATION/INCIDENT - DESCRIBE FACTS AND CIRCUMSTANCES IN NARRATIVE SECTION

Name of Person Cited:

Citation Number:

Violation & Ord. / Statue No.:

Date of Birth:

Court Date:

Name of Person Cited:

Citation Number:

Violation & Ord. / Statue No.:

Date of Birth:

Court Date:

Name of Person Cited:

Citation Number:

Violation & Ord. / Statue No.:

Date of Birth:

Court Date:

Name of Person Cited:

Citation Number:

Violation & Ord. / Statue No.:

Date of Birth:

Court Date:

Name of Person Cited:

Citation Number:

Violation & Ord. / Statue No.:

Date of Birth:

Court Date:

Investigating Officer: P.O. Christopher JACKSON

District / Bureau: MPD 6

Date: 01/18/2015

*Capt D. Rowe*

Commanding Officer

JAN 30 2015  
Date

### DISPOSITION - FOR LICENSING ONLY

Citation No.	Case Number	Disposition	Judge	Date

LICENSE INVESTIGATION UNIT

Received

*2-6-15*

Referred

By

*[Signature]*

This report is being written by P.O. Christopher JACKSON, assigned to District Six, Power Shift.

On Sunday January 18th 2015, at approximately 8:50pm I along with P.O. Kristopher MADUSCHA while assigned to Sq. 6468 responded to a call for service at 2422 S. Howell Av. in the City of Milwaukee. The call referred to a noise nuisance complaint at "The Stone" tavern.

Upon arrival to the location I spoke with the caller Nicki LARSEN. LARSEN stated that she lives across the street from the tavern and that she can feel the bass of the music in her residence. She further stated that when the patrons exit the tavern to smoke that the music gets louder. She attempted to contact the tavern by sending a facebook message and calling a number on the taverns website but was unable to get into contact with anyone.

Before entering the tavern P.O. MADUSCHA and myself stayed in our squad car parked across the street from the tavern and monitored the music level. As we waited outside the tavern while doors were closed slight music could be heard, none of which violated the 50 foot noise nuisance ordinance. I did observe subjects exiting the tavern, at this time I could hear the music louder which could be considered a disturbance to neighbors.

When officers entered the tavern I spoke with the subject standing behind the bar and serving drinks. That subject was identified as Kristin T. POCHOWSKI F/W 07/12/74 and she stated that she is part owner of the tavern. When I informed her of the loud music complaint she immediately turned the volume down and explained that she is trying to ask the subjects that exit the tavern to smoke to quickly close the door behind them.

POCHOWSKI worked well in wanting to correct the issue to avoid further problems. All the licenses were checked and were up to date. Later at District Six I checked the Lira system and observed a different subject listed as the applicant agent. POCHOWSKI is listed on the same form is listed as the building owner and has a valid bartenders license on file.

A verbal warning for the music complaint was given and the following license premise report was filed regarding this call.

# MILWAUKEE POLICE DEPARTMENT

## REPORT OF INCIDENTS INVOLVING LICENSED PERSONS OR PREMISES

TO: Captain Diana ROWE

Business Name: The Stone  
Address of Licensed Premises: 2422 S. Howell av.  
Business Phone: 507-8244

District: 6

Type of License: Class B

Violation /  Incident # Loud Music Date of Incident: 3-8-15

Licensee or Manager on premises at time of violation / incident?  Yes  No

Licensee cooperative?  Yes  No (if no, explain in narrative section)

Licensee Notified by Officer: P.O. Kristopher MADUSCHA Date: 3-8-15 Time: 8:35 PM

Licensee or Agent's Name: LEET, Shawn T. Date of Birth: 11-25-72  
Home Address: 319 E. Wilbur Av. Home Phone: 507-8244

Co-Licensee Name: Date of Birth:  
Home Address: Home Phone:  
Class S License Number:

Bartender Name: POCHOWSKI, Kristin T. Date of Birth: 7-12-74  
Home Address: 319 E. Wilbur Av Home Phone: 507-2400  
Class D License Number: 210080-25

Licensed Person / Public Pass. Vehicle, etc.: Date of Birth:  
Home Address: Home Phone:  
Class D License Number:

### VIOLATION/INCIDENT - DESCRIBE FACTS AND CIRCUMSTANCES IN NARRATIVE SECTION

Name of Person Cited:	Date of Birth:
Citation Number:	Court Date:
Violation & Ord. / Statue No.:	
Name of Person Cited:	Date of Birth:
Citation Number:	Court Date:
Violation & Ord. / Statue No.:	
Name of Person Cited:	Date of Birth:
Citation Number:	Court Date:
Violation & Ord. / Statue No.:	
Name of Person Cited:	Date of Birth:
Citation Number:	Court Date:
Violation & Ord. / Statue No.:	
Name of Person Cited:	Date of Birth:
Citation Number:	Court Date:
Violation & Ord. / Statue No.:	

Investigating Officer: P.O. Kristopher MADUSCHA District / Bureau: 64 Date: 3-8-15

*[Signature]*  
Commanding Officer

MAR 23 2015  
Date

### DISPOSITION - FOR LICENSING ONLY

Citation No.	Case Number	Disposition	Judge	Date

LICENSE INVESTIGATION UNIT  
Received 4275  
Referred  
By *[Signature]*

This report is typed by PO Kristopher MADUSCHA, assigned to District Six, Power Shift, Squad 6468, along with PO Justin JOLLIFF.

On Sunday March 8th 2015, at approximately 8:23 pm, PO JACKSON and I were dispatched to 2422 S. Howell Av. (Stone Tavern) for a loud music complaint. The call referred to a noise nuisance complaint at "The Stone" tavern.

Upon arrival, I positioned the squad car on the eastside of the street in the 2300 block of S. Howell Av with the windows down. I observed 3-5 patrons standing in front of the tavern. I could not hear music coming from the tavern. I then positioned the squad car directly across from the tavern. I observed several patrons exiting the tavern and I could not hear music coming from the tavern.

PO JOLLIFF and I walked towards the tavern, the only time I heard music coming from the tavern was when I was approximately 10 feet away.

I entered the tavern and spoke with the bartender/part owner Kristin T. POCHOWSKI (W/F, 7-12-74). I informed Kristin regarding the loud music complaint. Kristin immediately turned the volume down and stated she has a sign on the door for the patrons to close the door quickly after exiting.

Kristin asked if there was anything that can be done to avoid further issues. I advised Kristin about the patrons exiting and entering the tavern closing the door quickly and to keep the volume down. Kristin wants to correct the problem to avoid further issues. All the licenses were checked and were up to date. Later at District Six, I checked the Lira system and observed a different subject Shawn T. LEET (W/M, 11-25-72) as the listed owner. Kristin is listed on the same form, as is Shawn, as the owner. Kristin also has a valid bartender's license on file.

PO JOLLIFF spoke with the caller Nichole T. LARSON (W/F, 12-15-81) who stated she lives across the street from the tavern. Nichole stated she hears the bass when patrons exit and enter the tavern after smoking.

A verbal warning for the music complaint was given and the following license premise report was filed regarding this call.



Wednesday, June 24, 2015



# Notice of Public Hearing

---

LEET, Shawn T, Agent  
The Stone at 2422 S Howell Av  
Class B Tavern and Public Entertainment Premises License Renewal Applications

**Tuesday, July 07, 2015 at 9:00 AM**

To whom it may concern:

The above application has been made by the above named applicant(s). This requires approval from the Licenses Committee and the Common Council of the City of Milwaukee. The hearing before the Licenses Committee will take place on 7/7/2015 at 9:00 AM, in Room 301-B, Third Floor, City Hall. If you wish, you may provide testimony at the hearing regarding the request; see below for further information. You are not required to attend the hearing. Once the Licenses Committee makes its recommendation, this recommendation is forwarded to the full Common Council for approval at its next regularly scheduled hearing. Please review the information below and if you have further questions regarding this process, please contact the License Division at (414) 286-2238.

---

## Important details for those wishing to provide information for the Licenses Committee to consider when making its recommendation:

1. The license application is scheduled to be heard at the above time. Due to other hearings running longer than scheduled, you may have to wait some time to provide your testimony.
2. You must appear in person and testify as to matters that you have personally experienced or seen. (You cannot provide testimony for your neighbor, parent or anyone else; this is considered hearsay and cannot be considered by the committee.)
3. No letters or petitions can be accepted by the committee (unless the person who wrote the letter or the persons who signed the petition are present at the committee hearing and willing to testify).
4. Persons opposed to the license application are given the opportunity to testify first; supporters may testify after the opponents have finished.
5. When you are called to testify, you will be sworn in and asked to give your name, and address. (If your first and/or last names are uncommon please spell them.)
6. You may then provide testimony.
  - a. Include only information relating to the above license application.
  - b. Include only information you have personally witnessed or seen.
  - c. Provide concise and relevant information detailing how this business has affected or may affect the peaceful enjoyment of your neighborhood.
  - d. If by the time you have the opportunity to testify, the information you wish to share has already been provided to the committee, you may state that you agree with the previous testimony. Redundant or repetitive testimony will not assist the committee in making its recommendation.
7. After giving your testimony, the members of the Licenses Committee and the licensee may ask questions regarding the testimony you have given or other factors relating to the license application.
8. Business Competition is not a valid basis for denial or non-renewal of a license.  
**Please Note: If you have submitted an objection to the above application your objection cannot be considered by the committee unless you personally testify at the hearing.**

RESIDENT	MAIL ADDRESS	CITY AND ZIP CODE
CURRENT RESIDENT	2379 S HOWELL AVE	MILWAUKEE, WI 53207-1601
CURRENT RESIDENT	2400 S HOWELL AVE	MILWAUKEE, WI 53207-1603
CURRENT RESIDENT	2404 S HOWELL AVE	MILWAUKEE, WI 53207-1603
CURRENT RESIDENT	2408 S HOWELL AVE	MILWAUKEE, WI 53207-1603
CURRENT RESIDENT	2414 S HOWELL AVE	MILWAUKEE, WI 53207-1603
CURRENT RESIDENT	2414A S HOWELL AVE	MILWAUKEE, WI 53207-1603
CURRENT RESIDENT	2415 S GRAHAM ST	MILWAUKEE, WI 53207-1617
CURRENT RESIDENT	2415 S HOWELL AVE	MILWAUKEE, WI 53207-1663
CURRENT RESIDENT	2415A S GRAHAM ST	MILWAUKEE, WI 53207-1617
CURRENT RESIDENT	2417 S HOWELL AVE	MILWAUKEE, WI 53207-1663
CURRENT RESIDENT	2417A S HOWELL AVE	MILWAUKEE, WI 53207-1663
CURRENT RESIDENT	2418 S HOWELL AVE	MILWAUKEE, WI 53207-1603
CURRENT RESIDENT	2418A S HOWELL AVE	MILWAUKEE, WI 53207-1603
CURRENT RESIDENT	2419 S GRAHAM ST	MILWAUKEE, WI 53207-1617
CURRENT RESIDENT	2421 S HOWELL AVE	MILWAUKEE, WI 53207-1663
CURRENT RESIDENT	2423 S HOWELL AVE	MILWAUKEE, WI 53207-1663
CURRENT RESIDENT	2424 S GRAHAM ST	MILWAUKEE, WI 53207-1618
CURRENT RESIDENT	2424 S HOWELL AVE	MILWAUKEE, WI 53207-1603
CURRENT RESIDENT	2425 S HOWELL AVE	MILWAUKEE, WI 53207-1663
CURRENT RESIDENT	2427 S HOWELL AVE	MILWAUKEE, WI 53207-1663
CURRENT RESIDENT	2428 S HOWELL AVE	MILWAUKEE, WI 53207-1603
CURRENT RESIDENT	2429 S HOWELL AVE	MILWAUKEE, WI 53207-1663
CURRENT RESIDENT	2431 S HOWELL AVE	MILWAUKEE, WI 53207-1663
CURRENT RESIDENT	2432 S HOWELL AVE	MILWAUKEE, WI 53207-1603
CURRENT RESIDENT	2437 S HOWELL AVE	MILWAUKEE, WI 53207-1663
CURRENT RESIDENT	2438 S HOWELL AVE	MILWAUKEE, WI 53207-1603
CURRENT RESIDENT	2438A S HOWELL AVE	MILWAUKEE, WI 53207-1603
CURRENT RESIDENT	2439 S HOWELL AVE	MILWAUKEE, WI 53207-1663
CURRENT RESIDENT	2447 S GRAHAM ST	MILWAUKEE, WI 53207-1648
CURRENT RESIDENT	2451 S GRAHAM ST	MILWAUKEE, WI 53207-1648
CURRENT RESIDENT	2451 S HOWELL AVE	MILWAUKEE, WI 53207-1638
CURRENT RESIDENT	2454 S HOWELL AVE	MILWAUKEE, WI 53207-1637
CURRENT RESIDENT	2455 S GRAHAM ST	MILWAUKEE, WI 53207-1648
CURRENT RESIDENT	2455A S GRAHAM ST	MILWAUKEE, WI 53207-1648
CURRENT RESIDENT	2457A S HOWELL AVE	MILWAUKEE, WI 53207-1638
CURRENT RESIDENT	2458 S HOWELL AVE	MILWAUKEE, WI 53207-1637
CURRENT RESIDENT	340 E WILSON ST	MILWAUKEE, WI 53207-1509
CURRENT RESIDENT	340 E WILSON ST C	MILWAUKEE, WI 53207-1509
CURRENT RESIDENT	340A E WILSON ST	MILWAUKEE, WI 53207-1509
CURRENT RESIDENT	340B E WILSON ST	MILWAUKEE, WI 53207-1509
CURRENT RESIDENT	345 E SMITH ST	MILWAUKEE, WI 53207-1507
CURRENT RESIDENT	346 E WILSON ST	MILWAUKEE, WI 53207-1509
CURRENT RESIDENT	349 E SMITH ST	MILWAUKEE, WI 53207-1507
CURRENT RESIDENT	361 E WILSON ST	MILWAUKEE, WI 53207-1571
CURRENT RESIDENT	404 E SMITH ST	MILWAUKEE, WI 53207-1607
CURRENT RESIDENT	420 E WILSON ST	MILWAUKEE, WI 53207-1634
CURRENT RESIDENT	421 E SMITH ST	MILWAUKEE, WI 53207-1606
CURRENT RESIDENT	421 E WILSON ST	MILWAUKEE, WI 53207-1633
CURRENT RESIDENT	423 E WILSON ST	MILWAUKEE, WI 53207-1633
CURRENT RESIDENT	424 E SMITH ST	MILWAUKEE, WI 53207-1607
CURRENT RESIDENT	425 E SMITH ST	MILWAUKEE, WI 53207-1606
CURRENT RESIDENT	425A E SMITH ST	MILWAUKEE, WI 53207-1606
CURRENT RESIDENT	425B E SMITH ST	MILWAUKEE, WI 53207-1606
CURRENT RESIDENT	426 E SMITH ST	MILWAUKEE, WI 53207-1607
CURRENT RESIDENT	426 E WILSON ST	MILWAUKEE, WI 53207-1634



CURRENT RESIDENT	426A E SMITH ST	MILWAUKEE, WI 53207-1607
CURRENT RESIDENT	428 E WILSON ST	MILWAUKEE, WI 53207-1634
CURRENT RESIDENT	430 E WILSON ST	MILWAUKEE, WI 53207-1634
CURRENT RESIDENT	431 E SMITH ST	MILWAUKEE, WI 53207-1606
CURRENT RESIDENT	433 E SMITH ST	MILWAUKEE, WI 53207-1606
CURRENT RESIDENT	434 E WILSON ST	MILWAUKEE, WI 53207-1634
CURRENT RESIDENT	438 E WILSON ST	MILWAUKEE, WI 53207-1634
CURRENT RESIDENT	438A E WILSON ST	MILWAUKEE, WI 53207-1634
CURRENT RESIDENT	500 E WILSON ST	MILWAUKEE, WI 53207-1636
CURRENT RESIDENT	502 E WILSON ST	MILWAUKEE, WI 53207-1636
CURRENT RESIDENT	504 E WILSON ST	MILWAUKEE, WI 53207-1636
CURRENT RESIDENT	506 E WILSON ST	MILWAUKEE, WI 53207-1636
CURRENT RESIDENT	506A E WILSON ST	MILWAUKEE, WI 53207-1636

**Total Records: 69**

**Radius: 250.0 feet and Center of Circle: 2422 S Howell AV**

## 2015-2016 Plan of Operation for 2422 S HOWELL AV

### 1. Litter and Noise

How are the grounds kept clean?  Sweep  Pressure Wash  Pick Up Litter  Other: \_\_\_\_\_

How often will grounds be cleaned?  Daily  Weekly  Other: \_\_\_\_\_

Grounds Cleaned By:  Licensee  Building Owner  Employees  Hired Maintenance  Other: \_\_\_\_\_

How are noise issues prevented and/or addressed?  Security  Manager approaches customer(s)  Call Police  
 Signs Posted  Other: \_\_\_\_\_

### 2. Smoking and Sanitation

Are there designated outdoor smoking areas?  No  Yes  
 If yes, describe the area(s) and provide location(s): In front of establishment

Number of Garbage Cans: Inside: 4 Locations: behind bar, both bathrooms, in storage area  
 Outside: 1 Locations: In front

Is a Crowd Control Barrier used?  No  Yes If yes, describe: \_\_\_\_\_

Describe sanitation facilities (restrooms): 1 mens' room 1 ladies room

Provide name of solid waste contractor: Advance Disposal

### 3. Security

Are there parking spaces on the premises?  No  Yes If yes, number of spaces: \_\_\_\_\_ and describe security provisions: \_\_\_\_\_

Are there designated loading areas?  No  Yes If yes, describe security provisions \_\_\_\_\_

Do you have security personnel on the premise?  No  Yes If yes, how many? 1

AND What are their responsibilities? \_\_\_\_\_

What security equipment do they use? \_\_\_\_\_

List their licensing, certification or training credentials: \_\_\_\_\_

Are there security cameras?  No  Yes If yes, list all locations: \_\_\_\_\_

Are searches and/or identification checks conducted upon entry?  No  Yes If yes, describe: ID checks are performed on any questionable person

### 4. Percentage of Sales (must total 100%)

Alcohol 99 % Food Sales 0 % Entertainment \_\_\_\_\_ % Other 1 %

### 5. Businesses On The Premise (choose all that apply):

- |  |  |  |   |
|--|--|--|---|
| <input type="checkbox"/> Full Service Restaurant | <input type="checkbox"/> Cafe/Coffee Shop  | <input type="checkbox"/> Deli or Fast Food Rest. | <input type="checkbox"/> Private/Fraternal/Veterans' Club |
| <input type="checkbox"/> Night Club              | <input checked="" type="checkbox"/> Tavern | <input type="checkbox"/> Cocktail Lounge         | <input type="checkbox"/> Teen Club                        |
| <input type="checkbox"/> Bowling Alley           | <input type="checkbox"/> Hotel             | <input type="checkbox"/> Banquet Hall            | <input type="checkbox"/> Sports Facility                  |
| <input type="checkbox"/> Liquor Store            | <input type="checkbox"/> Corner Store      | <input type="checkbox"/> Supermarket             | <input type="checkbox"/> Convenience Store                |
| <input type="checkbox"/> Gas Station             | <input type="checkbox"/> Other _____       |  |   |

### 6. Hours of Operation and Age Restriction

Are there any changes to the current hours of operation or age restriction?  No  Yes If yes, describe \_\_\_\_\_

Please Note: If you will be open earlier or later than the hours listed on your current license for even one event or holiday (for example, St. Patrick's Day, Brewers Opening Day, etc.) during the license period, this must be reported and printed on your license. Your hours of operation and age restriction are listed on your current license.

### 7. Floor Plan

Are there any changes to the current floor plan?  No  Yes If yes, describe \_\_\_\_\_

AND submit a new floor plan with this application. Changes in floor plan include changing the location of tables, games, etc. within your current licensed premises. If your changes include adding any additional areas or square footage to your premises, or any renovations to the building will be done, a Permanent Extension of Premises application must be filed.

(1) CURRENT ENTERTAINMENT

The following types of entertainment have been approved for your current Public Entertainment Premises license: Instrumental Musicians, Disc Jockey, Poetry Readings, Patron Contests, Karaoke, Jukebox, 2 Amusement Machines

(2) SELECT ANY TYPES OF ENTERTAINMENT THAT YOU ARE REQUESTING TO ADD \*No changes in entertainment shall take place until approved by the Common Council and a new license has been issued and posted on the premises.

Grid of checkboxes for entertainment types: Instrumental Musicians, Bands, Battle of the Bands, Comedy Acts, Disc Jockey, Magic Shows, Poetry Readings, Dancing by Performers, Jukebox, Wrestling, Patron Contests, Patrons Dancing, Adult Entertainment/Strippers/Erotic Dance, Karaoke, Bowling Alley, Pool Tables, Motion Pictures, Amusement Machines, Concerts, Theatrical Performances. Includes fields for 'How many screens?' and 'Approx. # per year?'.

(3) REMOVE ENTERTAINMENT

If applicable, list any entertainment you wish to remove:

(4) WILL PROMOTERS EVER BE USED FOR ANY OF THE ENTERTAINMENT?

[X] No [ ] Yes, describe:

(5) LEGAL CAPACITY OF PREMISES

79 (Call the Milwaukee Development Center at 414-286-8211 if you have questions.) Your legal capacity will determine the license fee for your Public Entertainment Premise License. If you would like to request that the license be approved with a lower capacity than that listed above, indicate lower capacity. If approved, this lower capacity will print on your license and override the capacity listed on your Occupancy Permit.

(6) IDENTIFY IF SOUND AMPLIFICATION IS USED

[ ] No [X] Yes, describe: Six speakers run on 2 power amplifiers

(7) DECLARATIONS, ACKNOWLEDGEMENTS, & DISCLOSURES

Read And Initial Each Item Confirming Your Understanding:

- 1 SL I understand that after the license has been issued, a change to the plan of operation will require a written request to change and approval from the Common Council.
2 SL I agree to inform the City Clerk within 10 days of any substantial changes in the information supplied in this application.
3 SL I understand that I shall not willfully refuse to provide the services offered under this license, or add charges or require deposits not required of the general public because of race, color, sex, religion, national origin or ancestry, age, handicap, lawful source of income, marital status, sexual orientation, gender identity or expression, familial status or the fact that a person is now or has been a member of the military service, whether dressed in uniform or not; and shall not seek such information as a condition of employment, or penalize any employee or discriminate in the selection of personnel for training or promotion on the basis of such information.
4 SL I have knowledge of the City Ordinances currently regulating public entertainment, and understand that the license may be subject to suspension, non-renewal or revocation, if I violate any rule, law or regulation of the city of Milwaukee and State of Wisconsin.

(8) NOTARIZED SIGNATURES OF APPLICANTS

SUBSCRIBED AND SWORN TO BEFORE ME

This 26th day of MAY, 20

(Clerk/Notary Public) My Commission Expires 3-6-16

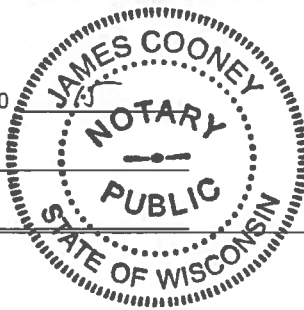

Handwritten signature of Agent/Owner/Partner

Additional Owner/Partner

\*Notary Seal must be affixed.



CITY OF MILWAUKEE  
OFFICE OF THE CITY CLERK

Thursday, June 25, 2015

COMMITTEE MEETING NOTICE

AD 14

MAAS, James F, Agent  
JIMAS LLC  
4116 S 3RD St

MILWAUKEE, WI 53207

You are requested to attend a hearing which is to be held in Room 301-B, Third Floor, City Hall on:

**Tuesday, July 07, 2015 at 09:00 AM**

**Regarding:** Your Class B Tavern and Public Entertainment Premises License Renewal Applications as agent for "JIMAS LLC" for "THE LOST CAUSE" at 733 W OKLAHOMA Av.

There is a possibility that your application may be denied for one or more of the following reasons: The recommendation of the committee regarding the application shall be based on evidence presented at the hearing. Per MCO 85-4-4, unless otherwise specified in the code, probative evidence concerning non-renewal, suspension or revocation may include evidence of the following: failure of the applicant to meet municipal qualifications, pending charges against or the conviction of any felony, misdemeanor, municipal offense or other offense, the circumstances of which substantially relate to the circumstances of the particular licensed or permitted activity, by the applicant or by any employee or other agent of the applicant. If the activities of the applicant involve a licensed premises, whether the premises tends to facilitate a public or private nuisance or has been the source of congregations of persons which have resulted in any of the following: disturbance of the peace; illegal drug activity; public drunkenness; drinking in public; harassment of passers-by; gambling; prostitution; sale of stolen goods; public urination; theft; assaults; battery; acts of vandalism including graffiti, excessive littering, loitering, illegal parking, loud noise at times when the licensed premise is open for business; traffic violations; curfew violations; lewd conduct; display of materials harmful to minors, pursuant to s. 106-9.6; or any other factor which reasonably relates to the public health, safety and welfare, or failure to comply with the approved plan of operation. See attached police report or correspondence.

**Notice for applicants with warrants or unpaid fines:**

Proof of warrant satisfaction or payment of fines must be submitted at the hearing on the above date and time. Failure to comply with this requirement may result in a delay of the granting/denial of your application.

Failure to appear at this meeting may result in the denial of your license. Individual applicants must appear only in person or by an attorney. Corporate or Limited Liability applicants must appear only by the agent designated on the application or by an attorney. Partnership applicants must appear by a partner listed on the application or by an attorney. If you wish to do so and at your own expense, you may be accompanied by an attorney of your choosing to represent you at this hearing.

You will be given an opportunity to speak on behalf of the application and to respond and challenge any charges or reasons given for the denial. No petitions can be accepted by the committee, unless the people who signed the petition are present at the committee hearing and willing to testify. You may present witnesses under oath and you may also confront and cross-examine opposing witnesses under oath. If you have difficulty with the English language, you should bring an interpreter with you, at your expense, so that you can answer questions and participate in your hearing.

You may examine the application file at this office during regular business hours prior to the hearing date. Inquiries regarding this matter may be directed to the person whose signature appears below.

Limited parking for persons attending meetings in City Hall is available at reduced rates (5 hour limit) at the Milwaukee Center on the southwest corner of East Kilbourn and North Water Street. Parking tickets must be validated in the first floor information booth in City Hall.

PLEASE NOTE: Upon reasonable notice, efforts will be made to accommodate the needs of disabled individuals through sign language interpreters or other auxiliary aids. For additional information or to request this service, contact the Council Services Division ADA Coordinator at (414) 286-2998, Fax - (414) 286-3456, TDD - (414) 286-2025.

JIM OWCZARSKI, CITY CLERK

BY: \_\_\_\_\_

Jason Schunk  
License Division Manager

**If you have questions regarding this notice, please contact the License Division at (414) 286-2238.**

200 E. Wells Street, Room 105, City Hall, Milwaukee, WI 53202. [www.milwaukee.gov/license](http://www.milwaukee.gov/license)  
Phone: (414) 286-2238 Fax: (414) 286-3057 Email Address: [License@milwaukee.gov](mailto:License@milwaukee.gov)

# MILWAUKEE POLICE DEPARTMENT

## LICENSE INVESTIGATION UNIT

### CRIMINAL RECORD/ORDINANCE VIOLATION/INCIDENTS SYNOPSIS

DATE: 06/04/2015

LICENSE TYPE: BTAVN

NEW:

RENEWAL: X

No. 212464

Application Date: 06/04/2015

Expiration Date:

License Location: 733 West Oklahoma Ave.

Aldermanic District: 14

Business Name: The Lost Cause

Licensee/Applicant: Maas, James F.

(Last Name, First Name, MI)

Date of Birth: 05/16/1961

Home Address: 4116 South 3rd

City: Milwaukee

State: WI

Zip Code: 53207

Home Phone: (414) 803-3640

This report is written by Police Officer Gilbert Gwinn, assigned to the License Investigation Unit, Days.

The Milwaukee Police Department's investigation regarding this application revealed the following:

1. On 02/05/2008 at 12:05am Milwaukee Police responded to the battery complaint at 733 West Oklahoma Ave. (The Lost Cause). The caller, Jose J. Rios, states that a female attempted to slap him while they were both in the bar, but that she missed and he was not injured. Officers spoke to several patrons at the bar who stated there was a disturbance inside the bar earlier in the evening, but no one stated they were injured or that they observed anyone else receive any injuries. No violations were observed and no citations were issued.

2. On 11/29/08 at 1:43 am, Milwaukee police were dispatched to 733 W Oklahoma for a Trouble With Subject complaint. Officers spoke to the bartender, Lora King, who stated a patron has passed out and fallen off her bar stool hitting her head on the bottom rail of the bar. King stated she had only served the patron two beers. The bar owner, James Maas, was notified of this incident. No tavern violations were observed.

3. On 06/10/09 at 1:30 am, Milwaukee police were dispatched to 733 W Oklahoma for a Fight complaint. Investigation revealed a patron was in the Lost Cause bar when the bartender stopped serving him. The bartender then called a cab for the patron and when the cab arrived, a couple of patrons assisted the subject to the cab when the subject became combative and struck one of the patrons in the face. The cab driver also attempted to assist but was also struck in the face. The subject then fell hitting his head but refused medical attention. Police cited the subject for assault and battery and disorderly conduct. No tavern violations were observed.

4. On 04/05/2015 Milwaukee police were dispatched to a fight at 733 West Oklahoma Avenue (Lost Cause). Investigation revealed there was a fight inside the business between at least two female patrons. When these patrons were escorted out of the business by the doorman, a larger fight commenced. Milwaukee police incident report #150950025 filed.

# MILWAUKEE POLICE DEPARTMENT

## REPORT OF INCIDENTS INVOLVING LICENSED PERSONS OR PREMISES

TO: Diana ROWE

Business Name: Lost Cause Bar

Address of Licensed Premises: 733 W. Oklahoma Av

District: 6

Business Phone: 294-4600

Type of License: Class B

Violation /  Incident # 15-095-0025

Date of Incident: 04/05/2015

Licensee or Manager on premises at time of violation / Incident?  Yes  No

Licensee cooperative?  Yes  No (if no, explain in narrative section)

Licensee Notified by Officer:

Date:

Time:

Licensee or Agent's Name: MASS, James

Date of Birth: 05/16/1961

Home Address: 4116 s 3<sup>rd</sup> St.

Home Phone: 489-9675

Co-Licensee Name:

Date of Birth:

Home Address:

Home Phone:

Class S License Number:

Bartender Name: SOMMERFELT, Jacqueline Q.

Date of Birth: 09/23/1982

Home Address: 4535 S. Whitnall Av. #8

Home Phone: 294-4600

Class D License Number:

Licensed Person / Public Pass. Vehicle, etc.:

Date of Birth:

Home Address:

Home Phone:

Class D License Number:

### VIOLATION/INCIDENT – DESCRIBE FACTS AND CIRCUMSTANCES IN NARRATIVE SECTION

Name of Person Cited:

Date of Birth:

Citation Number:

Violation & Ord. / Statue No.:

Court Date:

Name of Person Cited:

Date of Birth:

Citation Number:

Violation & Ord. / Statue No.:

Court Date:

Name of Person Cited:

Date of Birth:

Citation Number:

Violation & Ord. / Statue No.:

Court Date:

Name of Person Cited:

Date of Birth:

Citation Number:

Violation & Ord. / Statue No.:

Court Date:

Name of Person Cited:

Date of Birth:

Citation Number:

Violation & Ord. / Statue No.:

Court Date:

Investigating Officer: P.O. Christopher JACKSON

District / Bureau: 64

Date: 04/05/2015

*Capt Diana Rowe*

APR 09 2015

Commanding Officer

Date

### DISPOSITION – FOR LICENSING ONLY

Citation No.	Case Number	Disposition	Judge	Date
		LICENSE INVESTIGATION UNIT		
		Received		4-17-15
		Referred		

By *[Signature]*

This report is being written by Police Officer Christopher JACKSON, assigned to District Six, Power Shift.

On Sunday, April 5, 2015 at approximately I along with P.O. Kristopher MADUSCHA while assigned to Sq. 6468 were dispatched to 733 W. Oklahoma Av. in the City of Milwaukee for a Fight complaint. Other units that assisted on this call were: Sq. 6340, P.O. Tyler PILEGGI, Sq. 6323, P.O. Dale STASZEWSKI, Sq. 6320, P.O. Brian HEDER and Sq. 6311, Sgt. Robert THIEL.

Upon arrival to the location the premise was recognized as the Lost Cause Bar. Outside the tavern several squads interviewed witnesses that stated all the subjects involved in the physical altercation had left the area in unknown directions.

I then entered the tavern and spoke with the on duty bartender Patricia A. LISTON F/W 08/09/62. LISTON stated that as she served customers on one end of the bar she noticed that group began to gather and a commotion began. She then stated that the doorman escorted the subjects outside the tavern. Minutes later LISTON was directed to the window, facing north on to W. Oklahoma Av. by customers claiming a fight was taking place outside the tavern. LISTON observed the fight but could not identify any of the subjects involved. She had no further information regarding.

I then spoke with the on duty manger of the tavern Jacqueline Q. SOMMERFELT F/W 09/23/82. SOMMERFELT had a similar recollection of the incident that took place. She stated once the subjects were escorted out the tavern that they would just leave and did not believe it would escalate to a physical fight. SOMMERFELT informed me that the owner of the tavern was out of town on vacation and probably would not answer any phone calls. I then asked SOMMERFELT as the manager and in charge person of the tavern to make contact with the owner regarding the incident.

When I exited the tavern a gray 4dr SUV pulled up to the location. Exiting the vehicle was a subject identified as Jessica NAVEJAR F/W 06/30/77. NAVEJAR stated that she was at the tavern celebrating a birthday of her 21-year-old daughter. While inside the tavern she states that a w/f that she previously was involved in a physical altercation with entered. She stated to me that she believed the female name to be Magdalia MURILLO and should be approximately 35years old. She states that the two of them watched each and made several faces towards each other. The two then approached each other and a physical altercation began. The doorman then escorted them out of the tavern.

NAVEJAR states that outside the tavern she was jumped by the female and two or three male subjects. She received several scratches to the face and left shoulder. NAVEJAR was also bleeding from her left pinky finger with broken skin that she stated she received when the female bit her. She stated that when the fight was broken up that she drove home and wiped off her face and cleaned up.

On scene NAVEJAR denied medical attention but stated that she will go to the hospital on her own time. I informed NAVEJAR that I would need to view her discharge paperwork if she visits the hospital regarding on how the report will be filed. I also informed NAVEJAR that I would need time to attempt to identify the f/w involved in this incident and would contact her at 7pm later in the evening.

On 04/05/15 at approximately 7:00pm I called NAVEJAR using the cell phone number she confirm with me. I was unable to reach NAVEJAR to find out if she received any additional medical attention for her injuries. I also called at 8:15pm and left a recorded voicemail on the phone to reach me at the district. The last attempt to contact NAVEJAR was on 04/06/15 at 7:10pm and I once again was unable to make contact.





Thursday, June 25, 2015



# Notice of Public Hearing

---

MAAS, James F, Agent  
THE LOST CAUSE at 733 W OKLAHOMA Av  
Class B Tavern and Public Entertainment Premises License Renewal Applications

**Tuesday, July 07, 2015 at 9:00 AM**

To whom it may concern:

The above application has been made by the above named applicant(s). This requires approval from the Licenses Committee and the Common Council of the City of Milwaukee. The hearing before the Licenses Committee will take place on 7/7/2015 at 9:00 AM, in Room 301-B, Third Floor, City Hall. If you wish, you may provide testimony at the hearing regarding the request; see below for further information. You are not required to attend the hearing. Once the Licenses Committee makes its recommendation, this recommendation is forwarded to the full Common Council for approval at its next regularly scheduled hearing. Please review the information below and if you have further questions regarding this process, please contact the License Division at (414) 286-2238.

---

## Important details for those wishing to provide information for the Licenses Committee to consider when making its recommendation:

1. The license application is scheduled to be heard at the above time. Due to other hearings running longer than scheduled, you may have to wait some time to provide your testimony.
2. You must appear in person and testify as to matters that you have personally experienced or seen. (You cannot provide testimony for your neighbor, parent or anyone else; this is considered hearsay and cannot be considered by the committee.)
3. No letters or petitions can be accepted by the committee (unless the person who wrote the letter or the persons who signed the petition are present at the committee hearing and willing to testify).
4. Persons opposed to the license application are given the opportunity to testify first; supporters may testify after the opponents have finished.
5. When you are called to testify, you will be sworn in and asked to give your name, and address. (If your first and/or last names are uncommon please spell them.)
6. You may then provide testimony.
  - a. Include only information relating to the above license application.
  - b. Include only information you have personally witnessed or seen.
  - c. Provide concise and relevant information detailing how this business has affected or may affect the peaceful enjoyment of your neighborhood.
  - d. If by the time you have the opportunity to testify, the information you wish to share has already been provided to the committee, you may state that you agree with the previous testimony. Redundant or repetitive testimony will not assist the committee in making its recommendation.
7. After giving your testimony, the members of the Licenses Committee and the licensee may ask questions regarding the testimony you have given or other factors relating to the license application.
8. Business Competition is not a valid basis for denial or non-renewal of a license.  
**Please Note: If you have submitted an objection to the above application your objection cannot be considered by the committee unless you personally testify at the hearing.**

RESIDENT	MAIL ADDRESS	CITY AND ZIP CODE
CURRENT RESIDENT	3061 S 7TH ST	MILWAUKEE, WI 53215-3931
CURRENT RESIDENT	3063 S 7TH ST	MILWAUKEE, WI 53215-3931
CURRENT RESIDENT	3063 S 8TH ST	MILWAUKEE, WI 53215-3937
CURRENT RESIDENT	3064 S 8TH ST	MILWAUKEE, WI 53215-3938
CURRENT RESIDENT	3064A S 8TH ST	MILWAUKEE, WI 53215-3938
CURRENT RESIDENT	3065 S 7TH ST	MILWAUKEE, WI 53215-3931
CURRENT RESIDENT	3067 S 7TH ST	MILWAUKEE, WI 53215-3931
CURRENT RESIDENT	3112 S 9TH ST	MILWAUKEE, WI 53215-4723
CURRENT RESIDENT	3113 S 8TH ST	MILWAUKEE, WI 53215-4707
CURRENT RESIDENT	3113A S 8TH ST	MILWAUKEE, WI 53215-4707
CURRENT RESIDENT	3114 S 9TH ST	MILWAUKEE, WI 53215-4723
CURRENT RESIDENT	3116 S 8TH ST	MILWAUKEE, WI 53215-4708
CURRENT RESIDENT	3116 S 9TH ST	MILWAUKEE, WI 53215-4723
CURRENT RESIDENT	3118 S 9TH ST	MILWAUKEE, WI 53215-4723
CURRENT RESIDENT	3120 S 8TH ST	MILWAUKEE, WI 53215-4708
CURRENT RESIDENT	3120 S 9TH ST	MILWAUKEE, WI 53215-4723
CURRENT RESIDENT	3121 S 7TH ST	MILWAUKEE, WI 53215-4703
CURRENT RESIDENT	3121 S 8TH ST	MILWAUKEE, WI 53215-4707
CURRENT RESIDENT	3121A S 8TH ST	MILWAUKEE, WI 53215-4707
CURRENT RESIDENT	3124 S 8TH ST	MILWAUKEE, WI 53215-4708
CURRENT RESIDENT	3125 S 7TH ST	MILWAUKEE, WI 53215-4703
CURRENT RESIDENT	3125 S 8TH ST	MILWAUKEE, WI 53215-4707
CURRENT RESIDENT	3125A S 8TH ST	MILWAUKEE, WI 53215-4707
CURRENT RESIDENT	3126 S 9TH ST	MILWAUKEE, WI 53215-4723
CURRENT RESIDENT	3128 S 8TH ST	MILWAUKEE, WI 53215-4708
CURRENT RESIDENT	3128A S 8TH ST	MILWAUKEE, WI 53215-4708
CURRENT RESIDENT	3132 S 8TH ST	MILWAUKEE, WI 53215-4708
CURRENT RESIDENT	3132 S 9TH ST	MILWAUKEE, WI 53215-4723
CURRENT RESIDENT	3132A S 8TH ST	MILWAUKEE, WI 53215-4708
CURRENT RESIDENT	3132A S 9TH ST	MILWAUKEE, WI 53215-4723
CURRENT RESIDENT	3135 S 7TH ST	MILWAUKEE, WI 53215-4703
CURRENT RESIDENT	3135 S 8TH ST	MILWAUKEE, WI 53215-4707
CURRENT RESIDENT	3135A S 8TH ST	MILWAUKEE, WI 53215-4707
CURRENT RESIDENT	3136 S 8TH ST	MILWAUKEE, WI 53215-4708
CURRENT RESIDENT	3139 S 7TH ST	MILWAUKEE, WI 53215-4703
CURRENT RESIDENT	3140 S 8TH ST	MILWAUKEE, WI 53215-4708
CURRENT RESIDENT	3141 S 8TH ST	MILWAUKEE, WI 53215-4707
CURRENT RESIDENT	3145 S 7TH ST	MILWAUKEE, WI 53215-4703
CURRENT RESIDENT	3147 S 8TH ST	MILWAUKEE, WI 53215-4707
CURRENT RESIDENT	3148 S 8TH ST	MILWAUKEE, WI 53215-4708
CURRENT RESIDENT	715 W OKLAHOMA AVE	MILWAUKEE, WI 53215-4719
CURRENT RESIDENT	722 W OKLAHOMA AVE	MILWAUKEE, WI 53215-4720
CURRENT RESIDENT	723 W OKLAHOMA AVE	MILWAUKEE, WI 53215-4719
CURRENT RESIDENT	723A W OKLAHOMA AVE	MILWAUKEE, WI 53215-4719
CURRENT RESIDENT	728 W OKLAHOMA AVE	MILWAUKEE, WI 53215-4720
CURRENT RESIDENT	728A W OKLAHOMA AVE	MILWAUKEE, WI 53215-4720
CURRENT RESIDENT	729 W OKLAHOMA AVE	MILWAUKEE, WI 53215-4719
CURRENT RESIDENT	731 W OKLAHOMA AVE	MILWAUKEE, WI 53215-4719
CURRENT RESIDENT	732 W OKLAHOMA AVE	MILWAUKEE, WI 53215-4720
CURRENT RESIDENT	802 W OKLAHOMA AVE	MILWAUKEE, WI 53215-4742
CURRENT RESIDENT	805 W OKLAHOMA AVE	MILWAUKEE, WI 53215-4741
CURRENT RESIDENT	807 W OKLAHOMA AVE	MILWAUKEE, WI 53215-4741
CURRENT RESIDENT	814 W OKLAHOMA AVE	MILWAUKEE, WI 53215-4742
CURRENT RESIDENT	814A W OKLAHOMA AVE	MILWAUKEE, WI 53215-4742
CURRENT RESIDENT	821 W OKLAHOMA AVE	MILWAUKEE, WI 53215-4741

CURRENT RESIDENT 821A W OKLAHOMA AVE MILWAUKEE, WI 53215-4741

**Total Records: 57**  
**Radius: 250.0 feet and Center of Circle: 733 W Oklahama AV**

# 2015-2016 Plan of Operation for 733 W OKLAHOMA AV

## 1. Litter and Noise

How are the grounds kept clean?  Sweep  Pressure Wash  Pick Up Litter  Other: \_\_\_\_\_

How often will grounds be cleaned?  Daily  Weekly  Other: \_\_\_\_\_

Grounds Cleaned By:  Licensee  Building Owner  Employees  Hired Maintenance  Other: \_\_\_\_\_

How are noise issues prevented and/or addressed?  Security  Manager approaches customer(s)  Call Police  
 Signs Posted  Other: \_\_\_\_\_

## 2. Smoking and Sanitation

Are there designated outdoor smoking areas?  No  Yes  
 If yes, describe the area(s) and provide location(s): sidewalk outside building

Number of Garbage Cans: Inside: 4 Locations: restrooms, bar area  
 Outside: 4 Locations: side of building

Is a Crowd Control Barrier used?  No  Yes If yes, describe: \_\_\_\_\_

Describe sanitation facilities (restrooms): Mens uninal & toilet Womens toilet

Provide name of solid waste contractor: waste management

## 3. Security

Are there parking spaces on the premises?  No  Yes If yes, number of spaces: \_\_\_\_\_ and describe security provisions: \_\_\_\_\_

Are there designated loading areas?  No  Yes If yes, describe security provisions \_\_\_\_\_

Do you have security personnel on the premise?  No  Yes If yes, how many? \_\_\_\_\_  
 AND What are their responsibilities? \_\_\_\_\_  
 What security equipment do they use? \_\_\_\_\_  
 List their licensing, certification or training credentials: \_\_\_\_\_

Are there security cameras?  No  Yes If yes, list all locations: \_\_\_\_\_

Are searches and/or identification checks conducted upon entry?  No  Yes If yes, describe: verification of age

CITY OF MILWAUKEE  
 LICENSE DIVISION  
 2015 JUN - 2 A 2:44

## 4. Percentage of Sales (must total 100%)

Alcohol 100 %      Food Sales \_\_\_\_\_ %      Entertainment \_\_\_\_\_ %      Other \_\_\_\_\_ %

## 5. Businesses On The Premise (choose all that apply):

- |  |  |  |   |
|--|--|--|---|
| <input type="checkbox"/> Full Service Restaurant | <input type="checkbox"/> Cafe/Coffee Shop  | <input type="checkbox"/> Deli or Fast Food Rest. | <input type="checkbox"/> Private/Fraternal/Veterans' Club |
| <input type="checkbox"/> Night Club              | <input checked="" type="checkbox"/> Tavern | <input type="checkbox"/> Cocktail Lounge         | <input type="checkbox"/> Teen Club                        |
| <input type="checkbox"/> Bowling Alley           | <input type="checkbox"/> Hotel             | <input type="checkbox"/> Banquet Hall            | <input type="checkbox"/> Sports Facility                  |
| <input type="checkbox"/> Liquor Store            | <input type="checkbox"/> Corner Store      | <input type="checkbox"/> Supermarket             | <input type="checkbox"/> Convenience Store                |
| <input type="checkbox"/> Gas Station             | <input type="checkbox"/> Other _____       |  |   |

## 6. Hours of Operation and Age Restriction

Are there any changes to the current hours of operation or age restriction?  No  Yes If yes, describe \_\_\_\_\_

**Please Note:** If you will be open earlier or later than the hours listed on your current license for even one event or holiday (for example, St. Patrick's Day, Brewers Opening Day, etc.) during the license period, this must be reported and printed on your license. Your hours of operation and age restriction are listed on your current license.

## 7. Floor Plan

Are there any changes to the current floor plan?  No  Yes If yes, describe \_\_\_\_\_

AND submit a new floor plan with this application. Changes in floor plan include changing the location of tables, games, etc. within your current licensed premises. If your changes include adding any additional areas or square footage to your premises, or any renovations to the building will be done, a Permanent Extension of Premises application must be filed.

**(1) CURRENT ENTERTAINMENT**

The following types of entertainment have been approved for your current Public Entertainment Premises license:  
Karaoke, Jukebox, 1 Pool Table, 8 Amusement Machines

**(2) SELECT ANY TYPES OF ENTERTAINMENT THAT YOU ARE REQUESTING TO ADD \*No changes in entertainment shall take place until approved by the Common Council and a new license has been issued and posted on the premises.**

<input type="checkbox"/> Instrumental Musicians	<input type="checkbox"/> Bands	<input type="checkbox"/> Battle of the Bands	<input type="checkbox"/> Comedy Acts
<input type="checkbox"/> Disc Jockey	<input type="checkbox"/> Magic Shows	<input type="checkbox"/> Poetry Readings	<input type="checkbox"/> Dancing by Performers
<input type="checkbox"/> Jukebox	<input type="checkbox"/> Wrestling	<input type="checkbox"/> Patron Contests	<input type="checkbox"/> Patrons Dancing
<input type="checkbox"/> Adult Entertainment/ Strippers/Erotic Dance	<input type="checkbox"/> Karaoke	<input type="checkbox"/> Bowling Alley	<input type="checkbox"/> Pool Tables
<input type="checkbox"/> Motion Pictures	<input type="checkbox"/> Amusement Machines -	<input type="checkbox"/> Concerts	<input type="checkbox"/> Theatrical Performances
How many screens? _____	How many? _____	Approx. # per year? _____	Approx. # per year? _____
<input type="checkbox"/> Other: _____			

**(3) REMOVE ENTERTAINMENT**

If applicable, list any entertainment you wish to remove: \_\_\_\_\_

**(4) WILL PROMOTERS EVER BE USED FOR ANY OF THE ENTERTAINMENT?**

No  Yes, describe: \_\_\_\_\_

**(5) LEGAL CAPACITY OF PREMISES**

76 (Call the Milwaukee Development Center at 414-286-8211 if you have questions.) Your legal capacity will determine the license fee for your Public Entertainment Premise License. If you would like to request that the license be approved with a lower capacity than that listed above, indicate lower capacity \_\_\_\_\_. If approved, this lower capacity will print on your license and override the capacity listed on your Occupancy Permit.

**(6) IDENTIFY IF SOUND AMPLIFICATION IS USED**

No  Yes, describe: \_\_\_\_\_

**(7) DECLARATIONS, ACKNOWLEDGEMENTS, & DISCLOSURES**

Read And Initial Each Item Confirming Your Understanding:

- h I understand that after the license has been issued, a change to the plan of operation will require a written request to change and approval from the Common Council.
- h I agree to inform the City Clerk within 10 days of any substantial changes in the information supplied in this application.
- h I understand that I shall not willfully refuse to provide the services offered under this license, or add charges or require deposits not required of the general public because of race, color, sex, religion, national origin or ancestry, age, handicap, lawful source of income, marital status, sexual orientation, gender identity or expression, familial status or the fact that a person is now or has been a member of the military service, whether dressed in uniform or not; and shall not seek such information as a condition of employment, or penalize any employee or discriminate in the selection of personnel for training or promotion on the basis of such information.
- h I have knowledge of the City Ordinances currently regulating public entertainment, and understand that the license may be subject to suspension, non-renewal or revocation, if I violate any rule, law or regulation of the city of Milwaukee and State of Wisconsin.

**(8) NOTARIZED SIGNATURES OF APPLICANTS**

SUBSCRIBED AND SWORN TO BEFORE ME

This 29 day of MAY  
[Signature]  
Clerk/Notary Public  
My Commission Expires \_\_\_\_\_

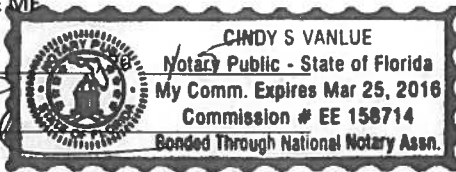

[Signature]  
Agent/Owner/Partner JAMES F. MAAS

Additional Owner/Partner

\*Notary Seal must be affixed.