



**CITY OF MILWAUKEE
OFFICE OF THE CITY CLERK**

Wednesday, March 26, 2025

COMMITTEE MEETING NOTICE

AD 08

HICKMAN, Ryan E, Agent
AUTO WRECKERS MILWAUKEE TOWING & RECYCLING LLC
3162 S 29TH ST
Milwaukee, WI 53215

You are requested to attend a hearing which is to be held in Room 301-B, Third Floor, City Hall or you may attend virtually using the link below.

Tuesday, April 08, 2025 at 02:50 PM

The access code is <https://meet.goto.com/902734029>. Please see the enclosed best practices document for further instructions.

Regarding: Your Recycling, Salvaging, or Towing Premises Application Requesting Non-Consensual Towing as agent for "AUTO WRECKERS MILWAUKEE TOWING & RECYCLING LLC" for "AUTO WRECKERS MILWAUKEE TOWING & RECYCLING LLC" at 2776 S 34th St.

There is a possibility that your application may be denied for one or more of the following reasons: The recommendation of the committee regarding the application shall be based on evidence presented at the hearing. Per MCO 85-2.7-4, probative evidence concerning whether or not a new license should be granted may be presented on the following subjects: whether or not the applicant meets the municipal requirements, the appropriateness of the location and premises where the licensed premises is to be located and whether use of the premises for the purposes or activities permitted by the license would tend to facilitate a public or private nuisance or create undesirable neighborhood problems such as disorderly patrons, unreasonably loud noise, litter, and excessive traffic and parking congestion. Probative evidence relating to these matters may be taken from the plan of operation submitted with the license application, if any, but shall not include the content of any music. Evidence regarding the fitness of the location of the premises to be maintained as the principal place of business, including but not limited to whether there is an overconcentration of businesses of the type for which the license is sought; whether the proposal is consistent with any pertinent neighborhood business or development plans, or the location's proximity to areas where children are typically present. The applicant's record in operating similarly licensed premises; and whether or not the applicant has been charged with or convicted of any felony, misdemeanor, municipal offense or other offense, the circumstances of which substantially relate to the activity to be permitted by the license being applied for or any other factor which reasonably relates to the public health, safety or welfare may also be considered. See attached police report or correspondence.

**Notice for applicants with
warrants or unpaid fines:**

Proof of warrant satisfaction or payment of fines must be submitted at the hearing on the above date and time. Failure to comply with this requirement may result in a delay of the granting/denial of your application.

Failure to appear at this meeting may result in the denial of your license. Individual applicants must appear only in person or by an attorney. Corporate or Limited Liability applicants must appear only by the agent designated on the application or by an attorney. Partnership applicants must appear by a partner listed on the application or by an attorney. If you wish to do so and at your own expense, you may be accompanied by an attorney of your choosing to represent you at this hearing.

You will be given an opportunity to speak on behalf of the application and to respond and challenge any charges or reasons given for the denial. No petitions can be accepted by the committee, unless the people who signed the petition are present at the committee hearing and willing to testify. You may present witnesses under oath and you may also confront and cross-examine opposing witnesses under oath. If you have difficulty with the English language, you should bring an interpreter with you, at your expense, so that you can answer questions and participate in your hearing.

You may examine the application file at this office during regular business hours prior to the hearing date. Inquiries regarding this matter may be directed to the person whose signature appears below.

Limited parking for persons attending meetings during normal business hours is available at reduced rates (5 hour limit) at the Milwaukee Center on the southwest corner of Kilbourn Avenue and Water Street. You must present a copy of the meeting notice to the parking cashier.

PLEASE NOTE: Upon reasonable notice, efforts will be made to accommodate the needs of disabled individuals through sign language interpreters or other auxiliary aids. For additional information or to request this service, contact the Council Services Division ADA Coordinator at (414) 286-2998, Fax - (414) 286-3456, TDD - (414) 286-2025.

JIM OWCZARSKI, CITY CLERK

BY: _____

Jim Cooney
License Division Manager

If you have questions regarding this notice, please contact the License Division at (414) 286-2238.

200 E. Wells Street, Room 105, City Hall, Milwaukee, WI 53202. www.milwaukee.gov/license
Phone: (414) 286-2238 Fax: (414) 286-3057 Email Address: License@milwaukee.gov

Doherty, Patricia

From:
Sent: Tuesday, March 25, 2025 9:55 AM
To: Zamarripa, JoCasta
Subject: Application for towing business 2776 S. 34th St.

Dear JoCasta,

My name is , and I live from applicants address. I'm at

I think they already have a towing business there, Limitless towing. There are two buildings on that lot. Maybe current business is associated with the building to the north of 2776 so 34th st. So I'm guessing this means they want to have a towing business attached to each building. In my opinion, this location is not really suited for either towing business. There is not a lot of storage space for cars on thier lot, which means they are constantly shuffling cars around, and use the street around the buildings for staging and parking purposes. They often ride up on lawns with disregard for residents, saw off catalytic converters at all hours of the day, have gatherings of thier obnoxious friends who bring thier hot rods and motorcycles, and race up and down the street, going WAY TO FAST, and being WAY TO LOUD. Every summer we get to look forward to all the fireworks they blow off, then pick up all the remnants left behind. So loud as to alert the police into thinking they were building bombs in one of the garages. Which in tern brought the frickin S.W.A.T. team to our neighborhood and then proceeded to break down the doors of the buildings. Green plywood still covers those doors.

I also think they have, or have had people living inside these buildings. Not just any people, but the kind that do drug deals right there on the street. I have personally seen these take place, I know what that looks like. Alot of thier associates are questionable and even one of the owners asked me if I wanted to buy some Milwaukee power tools that fell off a truck. Yeah right. The buildings could use alot of work, but the crackheads they hire don't seem to finish anything. I think there are 2 brothers associated with these properties. One is decent, the other a total jerkbag, who leaves his dogs in the building over the winter months for the pleasure of subjecting everyone in the area to the constant barking, and worrisome conditions of thier health. I urge you to come look at this property to see for yourself if this is a good idea. I ,and all my neighbors, are registered voters, and hope to god you make the right decision.

Thank you for your time
Sincerely,

Feel free to call me



Wednesday, March 26, 2025



Notice of Public Hearing

Blank Notice

HICKMAN, Ryan E, Agent
AUTO WRECKERS MILWAUKEE TOWING & RECYCLING LLC at 2776 S 34th St
Recycling, Salvaging, or Towing Premises Application Requesting Non-Consensual Towing

Tuesday, April 08, 2025 at 2:50 PM

To whom it may concern:

The above application has been made by the above named applicant(s). This requires approval from the Licenses Committee and the Common Council of the City of Milwaukee. The hearing before the Licenses Committee will take place on 4/8/2025 at 2:50 PM in Room 301-B, Third Floor, City Hall. This is a public hearing. Those wishing to view the proceeding are able to do so via the City Channel – Channel 25 on Spectrum Cable – or on the Internet at <http://city.milwaukee.gov/citychannel>. Those wishing to provide oral testimony via internet are asked to contact the staff assistant, Yadira Melendez at (414) 286-2775 or stasst5@milwaukee.gov for necessary information. Please make such requests no later than one business day prior to the start of the meeting. You are not required to attend the hearing, but please see the information below if you would like to provide testimony. Once the Licenses Committee makes its recommendation, this recommendation is forwarded to the full Common Council for approval at its next regularly scheduled hearing.

Important details for those wishing to provide information for the Licenses Committee to consider when making its recommendation:

1. The license application is scheduled to be heard at the above time. Due to other hearings running longer than scheduled, you may have to wait some time to provide your testimony.
2. You must appear in person and testify as to matters that you have personally experienced or seen. (You cannot provide testimony for your neighbor, parent or anyone else; this is considered hearsay and cannot be considered by the committee.)
3. No letters or petitions can be accepted by the committee (unless the person who wrote the letter or the persons who signed the petition are present at the committee hearing and willing to testify).
4. Persons opposed to the license application are given the opportunity to testify first; supporters may testify after the opponents have finished.
5. When you are called to testify, you will be sworn in and asked to give your name, and address. (If your first and/or last names are uncommon please spell them.)
6. You may then provide testimony.
 - a. Include only information relating to the above license application.
 - b. Include only information you have personally witnessed or seen.
 - c. Provide concise and relevant information detailing how this business has affected or may affect the peaceful enjoyment of your neighborhood.
 - d. If by the time you have the opportunity to testify, the information you wish to share has already been provided to the committee, you may state that you agree with the previous testimony. Redundant or repetitive testimony will not assist the committee in making its recommendation.
7. After giving your testimony, the members of the Licenses Committee and the licensee may ask questions regarding the testimony you have given or other factors relating to the license application.
8. Business Competition is not a valid basis for denial or non-renewal of a license.
Please Note: If you have submitted an objection to the above application your objection cannot be considered by the committee unless you personally testify at the hearing.

OCCUPANT	MAIL ADDRESS	CITY STATE ZIP
CURRENT OCCUPANT	2761 S 34TH ST	MILWAUKEE, WI 53215-3541
CURRENT OCCUPANT	2800 S 35TH ST	MILWAUKEE, WI 53215-3546
CURRENT OCCUPANT	2802 S 34TH ST	MILWAUKEE, WI 53215-3544
CURRENT OCCUPANT	2803 S 33RD ST	MILWAUKEE, WI 53215-3618
CURRENT OCCUPANT	2803 S 34TH ST	MILWAUKEE, WI 53215-3543
CURRENT OCCUPANT	2805 S 33RD ST	MILWAUKEE, WI 53215-3618
CURRENT OCCUPANT	2806 S 35TH ST	MILWAUKEE, WI 53215-3546
CURRENT OCCUPANT	2809 S 34TH ST	MILWAUKEE, WI 53215-3543
CURRENT OCCUPANT	2810 S 33RD ST	MILWAUKEE, WI 53215-5203
CURRENT OCCUPANT	2810 S 34TH ST	MILWAUKEE, WI 53215-3544
CURRENT OCCUPANT	2811 S 33RD ST	MILWAUKEE, WI 53215-3618
CURRENT OCCUPANT	2812 S 33RD ST	MILWAUKEE, WI 53215-5203
CURRENT OCCUPANT	2812 S 34TH ST	MILWAUKEE, WI 53215-3544
CURRENT OCCUPANT	2813 S 33RD ST	MILWAUKEE, WI 53215-3618
CURRENT OCCUPANT	2814 S 33RD ST	MILWAUKEE, WI 53215-5203
CURRENT OCCUPANT	2815 S 34TH ST	MILWAUKEE, WI 53215-3543
CURRENT OCCUPANT	2816 S 33RD ST	MILWAUKEE, WI 53215-5203
CURRENT OCCUPANT	2816 S 34TH ST	MILWAUKEE, WI 53215-3544
CURRENT OCCUPANT	2818 S 33RD ST	MILWAUKEE, WI 53215-5203
CURRENT OCCUPANT	2819 S 33RD ST	MILWAUKEE, WI 53215-3618
CURRENT OCCUPANT	2819 S 34TH ST	MILWAUKEE, WI 53215-3543
CURRENT OCCUPANT	2820 S 33RD ST	MILWAUKEE, WI 53215-5203
CURRENT OCCUPANT	2820 S 34TH ST	MILWAUKEE, WI 53215-3544
CURRENT OCCUPANT	2821 S 33RD ST	MILWAUKEE, WI 53215-3618
CURRENT OCCUPANT	2821 S 34TH ST	MILWAUKEE, WI 53215-3543
CURRENT OCCUPANT	3209 W MONTANA ST	MILWAUKEE, WI 53215-5204
CURRENT OCCUPANT	3211 W MONTANA ST	MILWAUKEE, WI 53215-5204
CURRENT OCCUPANT	3213 W MONTANA ST	MILWAUKEE, WI 53215-5204
CURRENT OCCUPANT	3215 W MONTANA ST	MILWAUKEE, WI 53215-5204
CURRENT OCCUPANT	3217 W MONTANA ST	MILWAUKEE, WI 53215-5204
CURRENT OCCUPANT	3219 W MONTANA ST	MILWAUKEE, WI 53215-5204
CURRENT OCCUPANT	3225 W MONTANA ST	MILWAUKEE, WI 53215-5205
CURRENT OCCUPANT	3227 W MONTANA ST	MILWAUKEE, WI 53215-5205
CURRENT OCCUPANT	3229 W MONTANA ST	MILWAUKEE, WI 53215-5205
CURRENT OCCUPANT	3231 W MONTANA ST	MILWAUKEE, WI 53215-5205
CURRENT OCCUPANT	3233 W MONTANA ST	MILWAUKEE, WI 53215-5205
CURRENT OCCUPANT	3235 W MONTANA ST	MILWAUKEE, WI 53215-5205
CURRENT OCCUPANT	3237 W MONTANA ST	MILWAUKEE, WI 53215-5205
CURRENT OCCUPANT	3239 W MONTANA ST	MILWAUKEE, WI 53215-5205
CURRENT OCCUPANT	3241 W MONTANA ST	MILWAUKEE, WI 53215-5205
CURRENT OCCUPANT	3243 W MONTANA ST	MILWAUKEE, WI 53215-5205
CURRENT OCCUPANT	3245 W MONTANA ST	MILWAUKEE, WI 53215-5205
CURRENT OCCUPANT	3247 W MONTANA ST	MILWAUKEE, WI 53215-5205

Blank Notice

Total Records: 43

Radius 250 feet and Center of the Circle: 2776 S 34th St



BUSINESS LICENSE PLAN OF OPERATION

ccl-busplan 5/12/2020

Office of the City Clerk License Division
200 E. Wells St. Room 105, Milwaukee, WI 53202
(414) 286-2238 www.milwaukee.gov/license e-mail address: license@milwaukee.gov

1. Type of Business

Applying for: ☐ Extended Hours (12AM to 5AM) - If a food establishment, check all that apply: ☐ Delivery ☐ Drive Thru ☐ Dining Room
☐ Self Service Laundry ☐ Massage Establishment ☐ Filling Station
☒ Other (supplemental application for specific license also required)

Provide a detailed description of the type of business you plan on operating:

Towing of Vehicles

Do you have any experience operating this type of business? ☐ No ☒ Yes If yes, explain: Worked for City TowLot

2. Business Operations

- a. Proposed Opening Date: ASAP
- b. Is this premise under construction? ☒ No ☐ Yes If yes, list estimated completion date: _____
- c. Is this a franchise? ☒ No ☐ Yes
- d. Is this premises currently licensed? ☒ No ☐ Yes If yes, list type of license: _____
- e. Is the current licensee operating? ☐ No ☒ Yes If no, list date closed: _____
- f. Do you have future plans for other businesses, licenses or permits at this location? ☒ No ☐ Yes
If yes, explain: _____
- g. Have you previously held an Extended Hours License in Milwaukee? ☒ No ☐ Yes
If yes, list address(es): _____
- h. Are other businesses operating in the same building? ☒ No ☐ Yes If yes, describe: _____

3. Litter & Noise

- a. How are grounds kept clean? ☒ Sweep ☒ Pressure Wash ☒ Pick Up Litter ☐ Other: _____
- b. How often will grounds be cleaned? ☐ Daily ☐ Weekly ☒ As Needed ☐ Monthly ☐ Other: _____
- c. Grounds cleaned by: ☐ Licensee ☐ Building Owner ☐ Employees ☐ Hired Maintenance ☒ Other: Myself
- d. How are noise issues prevented and/or addressed? ☒ Security ☐ Manager approaches customer(s) ☐ Call Police
☒ Signs Posted ☒ Other: Myself
- e. Will a sound amplification system be used? ☒ No ☐ Yes If yes, describe: _____

4. Smoking & Sanitation

- a. Are there designated outdoor smoking areas? ☒ No ☐ Yes If yes, describe: _____
- b. Number of Garbage Cans: Inside: 2 Locations: front & back entrance
As needed Outside: 2 Locations: Back parking area
- c. Is a crowd control barrier used? ☒ No ☐ Yes If yes, describe: _____
- d. How many restrooms are on the premises? 1
- e. Name of solid waste contractor: ☐ Advanced Disposal ☐ Waste Management ☒ Other: Myself will take to dump / city

5. Security

- a. Are there onsite parking spaces? ☐ No ☒ Yes If yes, how many? 15/20 and describe the parking security plan: The inside is locked & secured building / lighting / cameras
- b. Is there a loading zone? ☒ No ☐ Yes If yes, describe the loading area security plan: _____
- c. Will you have licensed security on premise? ☒ No ☐ Yes If yes, how many? _____ and answer the following:
What are their responsibilities? _____
Describe equipment used _____
List their License Number (s) _____
- d. Will there be security cameras? ☐ No ☒ Yes If yes, how many? 4 and list locations: All around the building
- e. Will searches/identification checks be done upon entry? ☒ No ☐ Yes If yes, describe _____

6. Percentage of Sales (must total 100%)

Alcohol _____%	Food _____% Cigarettes, Electronic Vape Devices, Tobacco Products _____%	Secondhand Merchandise _____%	Precious Metals & Gems _____%
Entertainment _____%			
Pawnbroker Activity _____%	Salvaged Materials _____% (such as scrap metal)	Personal Services (such as tattoo, body piercing, salon, tailor, tanning, etc.) _____%	Other <u>100</u> % Describe: <u>Towing Fees</u>

7. Businesses/Licenses on the Premises (check all that apply):

Type 1

- | | | | |
|---|---|---|--|
| <input type="checkbox"/> Full Service Restaurant | <input type="checkbox"/> Cafe/Coffee Shop | <input type="checkbox"/> Deli or Fast Food Restaurant | <input type="checkbox"/> Private/Fraternal/Veterans Club |
| <input type="checkbox"/> Night Club | <input type="checkbox"/> Tavern | <input type="checkbox"/> Cocktail Lounge | <input type="checkbox"/> Teen Club |
| <input type="checkbox"/> Banquet Hall | <input type="checkbox"/> Sports Facility | <input type="checkbox"/> Bowling Alley | |
| <input type="checkbox"/> Hotel/Motel: Number of Floors: _____
Number of Rooms: _____ | <input type="checkbox"/> Rooming House: Number of Floors: _____
Number of Rooms: _____ | | |

Type 2

- | | | | |
|--|--|--------------------------------------|---|
| <input type="checkbox"/> Liquor Store | <input type="checkbox"/> Corner Store | <input type="checkbox"/> Supermarket | <input type="checkbox"/> Convenience Store |
| <input type="checkbox"/> Gas Station | <input type="checkbox"/> Amusement/Phonograph Distributor | | <input type="checkbox"/> Recycling, Salvage or Towing |
| <input type="checkbox"/> Used Car Dealer | <input type="checkbox"/> Personal Service Establishment
(such as tattoo business, hair salon, tailor, etc.) | | <input type="checkbox"/> Recording Studio |

What other licenses/permits will you hold at this location? (check all that apply)

- ☒ Occupancy Permit ☐ Cigarette, Tobacco, Electronic Vape Products ☐ Gas Station ☐ Extended Hours ☐ Class "B" Tavern ☐ Weights & Measures
☐ Secondhand Dealer ☐ Precious Metal & Gem ☐ Other: _____

8. Legal Capacity (only if a Type 1 premises in #7 above)

Capacity _____ (Call the Milwaukee Development Center at 414-286-8211 if you have questions.)

9. Premises Description

a. Identify all area(s) of the premises that will be used in operating this business (include areas used only for storage):

☒ 1st Floor ☐ 2nd Floor ☐ Basement Storage ☐ Patio ☐ Beer Garden ☐ Sidewalk Café ☐ Deck ☐ Rooftop

☐ Other: Describe: _____

b. Describe Location: ☐ Major Thoroughfare ☐ Secondary Street ☒ Other: Inside building

c. Nearest Major Cross Street: 34th & Montana

d. Describe Building: ☒ Free Standing Building ☐ Strip Mall ☐ Other: _____

e. Describe Premises Structure: ☒ Single Story ☐ Multi-Story - # of Stories _____ ☐ Other: _____

f. Describe Surrounding Area: ☒ Commercial ☐ Residential ☐ Industrial ☐ Other: _____

g. Building Owner Name: Jimmy Berserbrf Phone Number: 414.938-6666

Building Owner Address: 3728 E Adams

10. Hours of Operation & Customers

Will customers be entering the premises? ☐ No ☒ Yes

Day of the Week	Proposed Hours of Operation:		Estimated Number of Customers expected each day	Potential Age Range of Customers	Class B Tavern Applicant Only: Age Restriction (If none, write 'None')
	Open Time (include a.m. or p.m.)	Close Time (include a.m. or p.m.)			
Sunday	_____	_____			
Monday	<u>8am</u>	<u>4pm</u>	<u>NA</u>	<u>NA</u>	
Tuesday	<u>8am</u>	<u>4pm</u>	<u>NA</u>	<u>NA</u>	
Wednesday	<u>8am</u>	<u>4pm</u>	<u>NA</u>	<u>NA</u>	
Thursday	<u>8am</u>	<u>4pm</u>	<u>NA</u>	<u>NA</u>	
Friday	<u>8am</u>	<u>4pm</u>	<u>NA</u>	<u>NA</u>	
Saturday	<u>8am</u>	<u>4pm</u>	<u>NA</u>	<u>NA</u>	

An Extended Hours Establishment License is required for any convenience store, filling station, personal service establishment (such as tattoo, body piercing, salon, tailor, tanning, etc.), recording studio or restaurant which is open between the hours of 12:00 a.m. and 5:00 a.m.

Alcohol Establishments Class A: 8:00 am to 9:00 pm Sunday thru Saturday
Permitted Hours of Operation: Class B: 6:00 am to 2:00 am Sunday thru Thursday, 6:00 am to 2:30 am Friday & Saturday

Entertainment Outdoor Closing Hours: 10:00pm Sunday-Thursday; 12:00am Friday & Saturday; unless a different time, either earlier or later, is established by the Common Council in its approval of the licensee's plan of operation.

11. Signature(s)

[Signature]
Signature of Sole Proprietor, Partner, or 20% or more Shareholder
(If there are no 20% or more shareholders,
Corporate Officer-print name/title and sign)

Signature of additional partner or 20% or more shareholder

See Application Information for a complete list of all required application forms.



RECYCLING, SALVAGING OR TOWING PREMISES LICENSE SUPPLEMENTAL APPLICATION

ccl-rstprem 8/30/2022

Office of the City Clerk License Division
200 E. Wells St. Room 105, Milwaukee, WI 53202
(414) 286-2238 e-mail address: license@milwaukee.gov

Legal Entity Name: Auto Wreckers Milwaukee Towing & Recycling LLC

Business Address:

Do you currently hold any licenses in the City of Milwaukee? ☐ No ☒ Yes If yes, list:

RSTV

Has any person on the application ever had a license relating to the activities licensed in Milwaukee Code of Ordinances Chapter 93 denied, not renewed, suspended, or revoked? ☒ No ☐ Yes

If yes, provide the circumstances and jurisdiction in which the event occurred (including a record of any actions from the State Department of Transportation and Financial Institutions relating to suspensions, revocations, forfeitures and warnings imposed by these departments relating to the operation of any automotive sales business by the applicant):

Do you understand that you must follow all recordkeeping, reporting and operating regulations in MCO 93-43-49? ☐ No ☒ Yes
Do you understand that all records and reports must be available to the police department upon request? ☐ No ☒ Yes

Business Operations

Check all activities that apply:

☒ Non-Consensual Towing:

Provide the address within the City of Milwaukee where vehicles will be towed:

2776 S. 34th St

Junk/Valuable Metal:

☐ Dealing, Storing and/or Transporting

☐ Removing and/or Recycling

Waste Tires:

☐ Dealing, Storing and/or Transporting

☐ Removing and/or Recycling

Salvaged Motor Vehicle Parts:

☐ Dealing, Storing and/or Transporting

☐ Removing and/or Recycling

(including secondhand tires/batteries)

Do you have an additional yard(s) used for storage? ☒ No ☐ Yes
If yes, provide the address(es) below and submit an additional \$63 per yard:

How many motor vehicles will be used in the business operations? 1 Provide information for each vehicle on page 2.

Required Signature(s)

Ryan A. Ackman

Sole Proprietor, Partner, or 20% or more Shareholder
(If there are no 20% or more shareholders,
Corporate Officer-print name/title and sign)

Additional partner or 20% or more shareholder

Office Use Only:			Initials	Filed
App# <u>RSTP</u>	YD#	Permit #s	Paid	MPD
DNS <u>316413</u>	LC	CC	Mayor's Signature	License #

LEGAL ENTITY NAME: AUTO WRECKERS MILWAUKEE TOWING & RECYCLING LLC
STREET ADDRESS: 2776 S 34TH STREET MILWAUKEE WI 53215
DATE OF SUBMISSION: JANUARY 31, 2025

Agent: Ryan Hickman

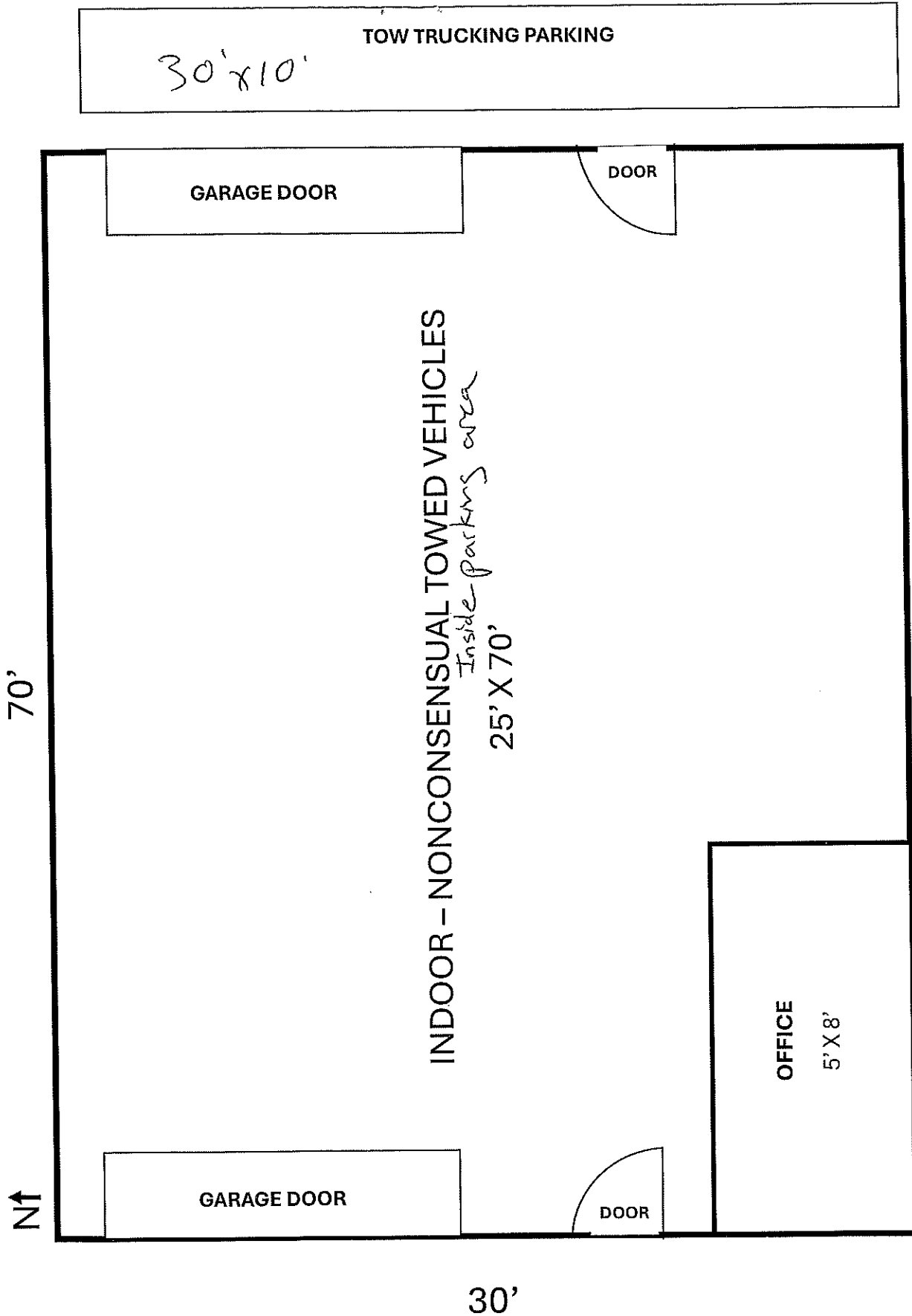

WEST MONTANA STREET OFF STREET PARKING