



CITY OF MILWAUKEE
OFFICE OF THE CITY CLERK

Monday, March 28, 2022

COMMITTEE MEETING NOTICE

AD 04

DEHNE, Jacob E, Agent
PTM VENTURES LLC
2365 Robbie Cir
Brookfield, WI 53005

You are requested to attend a virtual hearing to be held on:

Wednesday, April 06, 2022 at 02:40 PM

Regarding: Your Class B Tavern, Food Dealer, Sidewalk Dining and Public Entertainment Premises License Applications Requesting Instrumental Musicians, Jukeboxes, 3 Amusement Machines, Patrons Dancing and Dart Boards as agent for "PTM VENTURES LLC" for "State Street Pizza Pub" at 322 W STATE St.

This meeting will be held via GoToMeeting. Please see the enclosed best practices document for further instructions. The access code is https://meet.goto.com/376935573. If you wish to call in, please call +1 (669) 224-3412 and use Access Code: 376-935-573.

There is a possibility that your application may be denied for one or more of the following reasons: The recommendation of the committee regarding the application shall be based on evidence presented at the hearing. Per MCO 85-2.7-4, probative evidence concerning whether or not a new license should be granted may be presented on the following subjects: whether or not the applicant meets the municipal requirements, the appropriateness of the location and premises where the licensed premises is to be located and whether use of the premises for the purposes or activities permitted by the license would tend to facilitate a public or private nuisance or create undesirable neighborhood problems such as disorderly patrons, unreasonably loud noise, litter, and excessive traffic and parking congestion. Probative evidence relating to these matters may be taken from the plan of operation submitted with the license application, if any, but shall not include the content of any music. Evidence regarding the fitness of the location of the premises to be maintained as the principal place of business, including but not limited to whether there is an overconcentration of businesses of the type for which the license is sought; whether the proposal is consistent with any pertinent neighborhood business or development plans, or the location's proximity to areas where children are typically present. The applicant's record in operating similarly licensed premises; and whether or not the applicant has been charged with or convicted of any felony, misdemeanor, municipal offense or other offense, the circumstances of which substantially relate to the activity to be permitted by the license being applied for or any other factor which reasonably relates to the public health, safety or welfare may also be considered. See attached police report or correspondence.

Notice for applicants with warrants or unpaid fines: Proof of warrant satisfaction or payment of fines must be submitted at the hearing on the above date and time. Failure to comply with this requirement may result in a delay of the granting/denial of your application.

Failure to attend this meeting may result in the denial of your license. Individual applicants and partnership applicants must attend or attend by an attorney. The agent or attorney for corporate or limited liability applicants must attend. If you wish to do so and at your own expense, you may be accompanied by an attorney of your choosing to represent you at this hearing.

You will be given an opportunity to speak on behalf of the application and to respond and challenge any charges or reasons given for the denial. No petitions can be accepted by the committee, unless the people who signed the petition attend the virtual hearing and are willing to testify. You may present witnesses under oath and you may also confront and cross-examine opposing witnesses under oath. If you have difficulty with the English language, you should request an interpreter attend the meeting with you, at your expense, so that you can answer questions and participate in your hearing.

PLEASE NOTE: Upon reasonable notice, efforts will be made to accommodate the needs of disabled individuals through sign language interpreters or other auxiliary aids. For additional information or to request this service, contact the Council Services Division ADA Coordinator at (414) 286-2998, Fax - (414) 286-3456, TDD - (414) 286-2025.

JIM OWCZARSKI, CITY CLERK

BY: [Signature]

Jim Cooney
License Division Manager

If you have questions regarding this meeting, please contact the staff assistant, Yadira Melendez at (414) 286-2775 or stas5@milwaukee.gov

200 E. Wells Street, Room 105, City Hall, Milwaukee, WI 53202. www.milwaukee.gov/license
Phone: (414) 286-2238 Fax: (414) 286-3057 Email Address: License@milwaukee.gov

**MILWAUKEE POLICE DEPARTMENT**  
**LICENSE INVESTIGATION UNIT**

**CRIMINAL RECORD/ORDINANCE VIOLATION/INCIDENTS**  
**SYNOPSIS**

**DATE: 07/24/20**

**LICENSE TYPE: BTAVN**

**NEW:**

**RENEWAL: X**

**No. 311974**

**Application Date: 07/22/20**

**Expiration Date:**

**License Location: 322 West State Street**

**Aldermanic District:**

**Business Name: Point Burger Express**

**Licensee/Applicant: Ward, Brian J.**

(Last Name, First Name, MI)

**Date of Birth: 06/06/1976**

**Home Address: 1820 Windrush DR**

**City: Grafton**

**State: WI**

**Zip Code: 53024**

**Home Phone: (414)223-0135**

This report is written by Police Officer Corstan D. COURT, assigned to the License Investigation Unit, Days.

The Milwaukee Police Department's investigation regarding this application revealed the following:

1. On 07/09/2008 the Wisconsin Department of Transportation revoked Jacob Dehne's driver's license for 6 months for Prohibited Alcohol Content. Jacob Dehne is listed on the application as 20% shareholder.
2. On 05/03/2014 Jacob Dehne was cited at 1044 North Old World Third Street in the city of Milwaukee. Jacob Dehne is listed on the application as 20% shareholder.

**Charge: Allow Underage on Premises**

**Finding: Guilty**

**Sentence: \$192.00 fine**

**Date: 09/12/2014**

**Case: 14041909**

3. On 05/04/2014 Jacob Dehne received two citations at 322 West State Street in the city of Milwaukee. Jacob Dehne is listed on the application as 20% shareholder.

Charge 1: Allow Underage on Premises  
2: Sale of Alcohol to Underage Person  
Finding 1: Guilty  
2: Guilty  
Sentence 1: \$192.00 fine  
2: \$90.00 fine  
Date : 09/12/2014  
Case 1: 14041904  
2: 14041905

4. On 05/04/2014 Jacob Dehne was cited at 1101 N. Old World Third Street in the city of Milwaukee. Jacob Dehne is listed on the application as 20% shareholder.

Charge: Allow Underage on Premises  
Finding: Guilty  
Sentence: \$192.00 fine  
Date: 09/12/2014  
Case: 14041908

5. On 05/04/2014 Jacob Dehne was cited at 1044 North Old World Third Street in the city of Milwaukee. Jacob Dehne is listed on the application as 20% shareholder.

Charge: Sale of Alcohol to Underage Person  
Finding: Guilty  
Sentence: \$90.00 fine  
Date: 09/12/2014  
Case: 14041907

6. On 05/31/2014 (municipal court records indicate 05/31/2004) Jacob Dehne was cited at 1044 North Old World Third Street in the city of Milwaukee. Jacob Dehne is listed on the application as 20% shareholder.

Charge: Sale of Alcohol to Underage Person  
Finding: Guilty  
Sentence: \$90.00 fine  
Date: 09/12/2014  
Case: 14041906

=====  
7. On 11/29/2018 officers conducted underage tavern enforcement in District 1. An underage Police Aide attempted to gain entry to Point Burger Express, 322 W. State St. The Police Aide was allowed entry and was able to purchase a Miller Lite for \$4.00. The officer advised the manager they failed the inspection and the bartender was issued a citation.  
=====

**Previous Premise**

Date: 2/18/22  
Officer: PLUMLEY

City of Milwaukee Police Department  
90-5-1.5 Crime Prevention Survey  
Tavern Inspection

Name of Premise: Backwoods Tavern & Oasis  
Address: 322 W. State St  
Phone: 920-242-6821

Owner: KORSLIN, Taylor L  
Owner address: 807 E Juneau Av #24  
City State Zip: Milwaukee WI 53202  
Owner Phone: 920-242-6821  
Owner email: tkorslin20@gmail.com

Licensee/Agent: KORSLIN, Taylor L  
Home Address: 807 E Juneau Av #24  
City State Zip: Milwaukee WI 53202  
Phone: 920-242-6821  
Email: tkorslin20@gmail.com

Preferred contact: Phone

Location currently open:  YES  NO

Projected open date: 3/11/22

Day's open: S M T W Th F SA ALL

Hours of Operation: Sun: 11A-2A 24 hours Y N  
Mon: 11A-2A  
Tue: 11A-2A  
Wed: 11A-2A  
Thu: 11A-2A  
Fri: 11A-2:30A  
Sat: 11A-2:30A

Premise Type:  Tavern/Bar  
 Restaurant  
 Other:

Licenses currently held:

- Alcohol:  Yes  No Class: #:
- Tobacco:  Yes  No #:
- Food:  Yes  No #:
- Extended Hours:  Yes  No #:
- Secondhand Dealer:  Yes  No Type: #:
- Other:  Yes  No Type: #:
- Other:  Yes  No Type: #:

**Exterior Survey:**

1. Is the area around the location clean?  Yes  No
2. What surrounds the location? (Check all the apply)
  - a.  Park
  - b.  School
  - c.  Youth Center
  - d.  Church
  - e.  Tavern(s) If so, how many
  - f.  Residential
  - g.  Other businesses
  - h.  Other:
3. Can you see from the outside of the location into the interior  Yes  No
4. Can you see the employees inside of the location from the outside  Yes  No
5. Are exterior windows free of signage  Yes  No
6. Is there a parking lot  Yes  No
7. Is the parking lot clean?  Yes  No
8. Off-Street parking  Yes  No
9. Is the parking lot well lit?  Yes  No
10. Valet Parking  Yes  No
  - a. Will this lot have a guard?  Yes  No
  - b. Will this lot have cameras?  Yes  No
11. Are there areas where a person could conceal themselves  Yes  No
12. Is there exterior lighting?  Yes  No. Does it appears to be adequate  Yes  No
13. Exterior Payphone?  Yes  No
14. Are there No Loitering Signs posted?  Yes  No
15. Are there exterior security cameras  Yes  No How Many: 1
16. Are the address numbers prominently displayed and easy to see  Yes  No

**Camera Survey:**

17. Does this location have security cameras?  Yes  No
18. Are they in working order?  Yes  No
19. What format are the cameras?
  - a. Color  Yes  No
  - b. Digital  Yes  No
  - c. Recorded  Yes  No
20. How long is footage stored for later viewing:
21. Are there exterior cameras  Yes  No How many: 1
22. Are there interior cameras  Yes  No How many: 4
23. Do all employees know how to retrieve recorded digital images/footage?  Yes  No

24. Cameras located in parking lot  Yes  No How many

**Interior Survey:**

25. What is the planned capacity 99
26. What is the minimum number of employees That will be on premise 2
27. Is the storeowner willing to be a standing complainant regarding loitering?  Yes  No
- a. If yes have them fill out the standing complaint form and give them two of the commercial signs  Yes  No
28. Is the interior of the location neat and clean?  Yes  No
29. Does an interior camera face the entrance/exit?  Yes  No
30. Is there a lockable area that separates employees from customers?  Yes  No
31. Are emergency and non-emergency numbers posted near the phone?  Yes  No
32. Does the owner know how to contact their police district directly?  Yes  No
- a. Did you provide a district contact guide to the owner?  Yes  No

**Security**

33. How many security personnel are going to be employed: 0
34. How ill they be deployed: Interior Exterior
35. What days will they be deployed  Mon  Tue  Wed  Thu  Fri  Sat  Sun
36. Will the security be managed by business  or contracted
37. Will they be armed  Yes  No
38. What type of security measures to be used:
- Wanding/metal detector
  - ID Scanner
  - Dress Code
  - Cover Charge
  - Age restriction
  - Other

**ADDITIONAL COMMENTS/RECOMMENDATIONS:**

Advised he might want to consider security at least on Thursday, Friday, and Saturday. Informed if he hires security he should consider some sort of fake ID training to prevent underage patrons in the tavern. Taylor informed me he has not checked the current surveillance cameras but was informed from previous owners that they are in working order. The current address numers are attached to previous business sign and will need to be replaced.



# Concentration Map 322 W State St

## Area of Interest (AOI) Information

Area : 21,862,585.55 ft<sup>2</sup>

Feb 1 2022 7:44:14 Central Standard Time

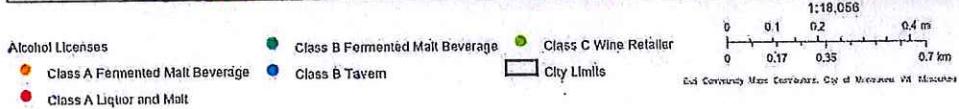
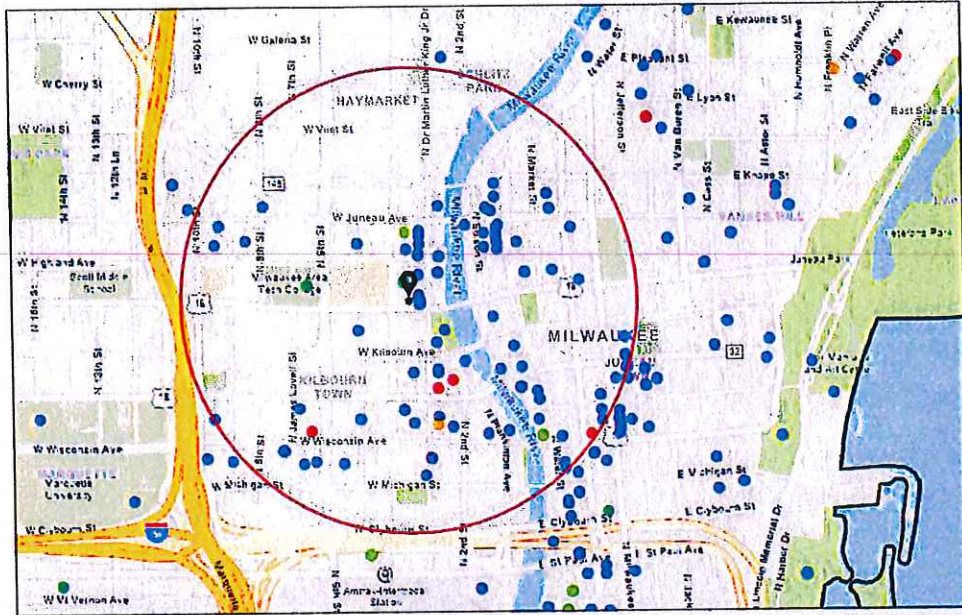

Concentration Map 322 W State St

### Summary

Name	Count	Area(ft <sup>2</sup> )	Length(mi)
Alcohol Licenses	108		

Alcohol Licenses



#	Legal Entity	Trade Name	Licensee	Address	License Type Name	Total Capacity	Expiration Date	Count
1	Uncle Bucks Red Star on 3rd, Inc	Uncle Bucks on 3rd	MICHAEL J VITUCCI, Agt	1125 N Dr Martin L King Jr DR	Class B Tavern License		2/6/2022, 6:00 PM	1
2	Good City Brewing LLC	Good City Brewing	David C Dupee, Agt	333 W JUNEAU AV	Class C Wine Retailer's License		1/21/2022, 6:00 PM	1
3	Tourist Convenience LLC	Racks Full of Snacks	AHMED K YAFAI, Agt	240 W Wells ST	Class A Malt & Class A Liquor License		11/28/2021, 6:00 PM	1
4	Mader's German Restaurant, Inc	Mader's German Restaurant	DANIEL J HAZARD, Agt	1037 N Dr Martin L King Jr DR	Class B Tavern License	370	11/21/2021, 6:00 PM	1
5	BOOBY JDK, LLC	McGillicuddy's Bar & Grill	ANDREW C DEUSTER, Agt	1133-37 N Water ST	Class B Tavern License	300	11/28/2021, 6:00 PM	1
6	MKE Water Street LLC	ELMNT Lounge	HABIB MANJEE, Agt	618 N WATER ST	Class B Tavern License		12/17/2021, 6:00 PM	1
7	Double Dragon MKE LLC	White Tail	NATHAN T TUSLER, Agt	1110 N Dr Martin L King Jr DR	Class B Tavern License	80	12/12/2021, 6:00 PM	1
8	OUZO CAFE	OUZO CAFE	NICKEY G PAPPAS, Agt	776 N MILWAUKEE ST	Class B Tavern License	40	11/22/2021, 6:00 PM	1
9	THE KING AND I RESTAURANT, INC	THE KING AND I RESTAURANT	DEREK E PHOUNGPHO L, Agt	830 N Dr Martin L King Jr DR	Class B Tavern License	240	12/20/2021, 6:00 PM	1
10	In & Out Pantry LLC	In & Out Pantry LLC	Abdalmajid Qetairi, Agt	701 W Wisconsin AV	Class A Malt & Class A Liquor License		2/12/2022, 6:00 PM	1
11	Tua Pasta LLC	Tua Pasta	Alvaro Nino de Guzman Ramirez, Agt	100 E WISCONSIN AV LL101	Class B Fermented Malt Beverage Retailer's License		12/28/2021, 6:00 PM	1
12	DEER CAMP, LLC	Deer Camp	Paul C Hackbarth, Agt	1023-1027 N Dr Martin L King Jr DR	Class B Tavern License		12/21/2021, 6:00 PM	1
13	Rogues Gallery, LLC	Rogues Gallery	Nathan S Showers, Agt	134 E Juneau AV	Class B Tavern License	290	1/19/2022, 6:00 PM	1
14	Tua Pasta LLC	Tua Pasta	Alvaro Nino de Guzman Ramirez, Agt	100 E WISCONSIN AV LL101	Class C Wine Retailer's License		12/28/2021, 6:00 PM	1
15	Oak Barrel Public House LLC	Oak Barrel	ROBERT L WILTGEN, Agt	1033 N Dr Martin L King Jr DR	Class B Tavern License		1/29/2022, 6:00 PM	1
16	AJ Bombers MKE, LLC	AJ Bombers	David J Marcus, Agt	1245 N WATER ST	Class B Tavern License	160	2/6/2022, 6:00 PM	1
17	Fazzari & Company, LLC	San Giorgio Pizzeria Napoletana	GIORGIO G FAZZARI, Agt	838 N Dr Martin L King Jr DR	Class B Tavern License		1/1/2022, 6:00 PM	1
18	MCR Milwaukee Tenant LLC	Courtyard by Marriott Milwaukee Downtown	Kerri Huelsbeck, Agt	300 W Michigan ST	Class B Tavern License		2/4/2022, 6:00 PM	1

19	Milwaukee Athletic Club	Milwaukee Athletic Club	Maikel Correa, Agt	731 N WATER ST 190	Class B Tavern License		1/17/2022, 6:00 PM	1
20	CHINA GOURMET, INC	CHINA GOURMET RESTAURANT	ROBERT C TSAO, Agt	117 E WELLS ST	Class B Tavern License	165	1/17/2022, 6:00 PM	1
21	Lazo Brothers LLC	Lazo's Taco Shack	Alfonso Lazo, Agt	641 N JAMES LOVELL ST	Class B Tavern License		1/17/2022, 6:00 PM	1
22	Levy @ Milwaukee Symphony	Levy @ Milwaukee Symphony	Amanda S Ridout, Agt	212 W WISCONSIN AV	Class B Tavern License		2/2/2022, 6:00 PM	1
23	LOWCOUNTRY MILWAUKEE INC	Lowcountry	Tyler E Mei, Agt	1114 N WATER ST	Class B Tavern License		2/7/2022, 6:00 PM	1
24	Who's Milwaukee LLC	Who's on Third, Milwaukee's Pub	ROBERT L WILTGEN, Agt	1003&1007-N Dr Martin L King Jr DR	Class B Tavern License		3/2/2022, 6:00 PM	1
25	MILWAUKEE WATERFRONT DELI, INC	MILWAUKEE WATERFRONT DELI	JEREMIAH D PANDL, Agt	761 N WATER ST	Class B Tavern License		2/26/2022, 6:00 PM	1
26	Pourman's LLC	Pourman's	BENJAMIN A HEBL, Agt	1127 N Water ST	Class B Tavern License	80	2/7/2022, 6:00 PM	1
27	Lucille's Dueling Piano Bar, LLC	Third Street Tavern	Jack Roman, Agt	1110 N Dr Martin L King Jr DR	Class B Tavern License	320	2/17/2022, 6:00 PM	1
28	Mojo MKE LLC	Mojo MKE	Todd M Wargula, Agt	134 E JUNEAU AV	Class B Tavern License	239	2/21/2022, 6:00 PM	1
29	International Exports LLC	The Safe House	Michael L Swasey, Agt	779 N Front ST	Class B Tavern License	248	3/8/2022, 6:00 PM	1
30	Wisconsinbly Holdings, LLC	Drink Wisconsinbly Pub	John R Casanova, Agt	320 W Highland AV	Class B Tavern License		3/26/2022, 7:00 PM	1
31	Blazin Wings, Inc	Buffalo Wild Wings #407	Nicole M Kejo, Agt	1123 N WATER ST	Class B Tavern License	253	3/24/2022, 7:00 PM	1
32	PABST THEATER CONCESSIONS, LLC	TURNER HALL BALLROOM	RICHARD J RYAN, Agt	1040 N VEL R PHILLIPS AV	Class B Tavern License	987	3/24/2022, 7:00 PM	1
33	Commerce Building Restaurant LLC	Doc's Commerce Smokehouse	Brian Atkinson, Agt	754 N VEL R PHILLIPS AV	Class B Tavern License		3/26/2022, 7:00 PM	1
34	Milwaukee Area Technical College	MATC Cuisine Restaurant	RICHARD A BUSALACCHI, Agt	1015 N 6th ST	Class C Wine Retailer's License		4/11/2022, 7:00 PM	1
35	Milwaukee Area Technical College	MATC Cuisine Restaurant	RICHARD A BUSALACCHI, Agt	1015 N 6th ST	Class B Fermented Malt Beverage Retailer's License		4/11/2022, 7:00 PM	1
36	Higbee's MKE LLC	District IV	PATSY SMITH-JAMES, Agt	628 N Water ST	Class B Tavern License	225	4/13/2022, 7:00 PM	1

37	NOBLE BEVERAGE MANAGEMENT, LLC	HYATT REGENCY MILWAUKEE	Colin C Walsh, Agt	333 W KILBOURN AV	Class B Tavern License	930	5/13/2022, 7:00 PM	1
38	Olive Tree LLC	Convenience +	Jamal T Shawar, Agt	308 E Wisconsin AV	Class A Malt & Class A Liquor License		5/19/2022, 7:00 PM	1
39	MILWAUKEE SCHOOL OF ENGINEERING	MILWAUKEE SCHOOL OF ENGINEERING	Jeffrey LaTaille, Agt	1245 N BROADWAY	Class B Tavern License	2,759	5/18/2022, 7:00 PM	1
40	Milwaukee School of Engineering	Milwaukee School of Engineering	Jeffrey LaTaille, Agt	1000 N BROADWAY	Class B Tavern License	480	5/18/2022, 7:00 PM	1
41	MILWAUKEE SCHOOL OF ENGINEERING	MILWAUKEE SCHOOL OF ENGINEERING	Jeffrey LaTaille, Agt	1120 N BROADWAY	Class B Tavern License	208	5/18/2022, 7:00 PM	1
42	Milwaukee School of Engineering	Milwaukee School of Engineering	Jeffrey LaTaille, Agt	1025 N BROADWAY	Class B Tavern License		5/18/2022, 7:00 PM	1
43	Grandview Management Inc	Zilli Hospitality Group	ROBERT J ZILLI, Agt	910 N Dr Martin L King Jr DR	Class B Tavern License		5/25/2022, 7:00 PM	1
44	PPH Properties I LLC	Silk Exotic Gentlemen's Club	SCOTT A KRAHN, Agt	730 N Dr Martin L King Jr DR	Class B Tavern License	297	5/25/2022, 7:00 PM	1
45	ZARLETTI, LLC	ZARLETTI	BRIAN C ZARLETTI, Agt	741 N MILWAUKEE ST 1	Class B Tavern License		5/23/2022, 7:00 PM	1
46	Cheese Mart, Inc	Wisconsin Cheese Mart	KENNETH J MC NULTY, Agt	215 W Highland AV	Class B Tavern License	133	5/22/2022, 7:00 PM	1
47	V & V PARTNERS, LLC	BENIHANA	SABAH M LIDDAWYEH, Agt	850 N PLANKINTON AV	Class B Tavern License	180	5/17/2022, 7:00 PM	1
48	WESTOWN ASSOCIATION OF MILW, INC	WESTOWN ASSOCIATION	STACIE J CALLIES, Agt	950 N Dr Martin L King Jr DR	Class B Tavern License		5/22/2022, 7:00 PM	1
49	The Loft Mini Mart LLC	The Loft Mini Mart	Larry J Courtney, Agt	823 N 2ND ST 007	Class A Malt & Class A Liquor License		5/19/2022, 7:00 PM	1
50	Cairo Co LLC	BB'S	Omar Amin, Agt	633 W Wisconsin AV 105	Class B Tavern License		5/23/2022, 7:00 PM	1
51	MILWAUKEE TURNERS, INC	MILWAUKEE TURNERS	Emilio J De Torre, Agt	1034 N VEL R PHILLIPS AV	Class B Fermented Malt Beverage Retailer's License		5/23/2022, 7:00 PM	1
52	Carson's Ribs of Milwaukee, LLC	Carson's	RICHARD J BARRETT, Agt	301 W Juneau AV	Class B Tavern License	150	5/23/2022, 7:00 PM	1
53	RIVER HOUSE RESTAURANT, INC	VagaBond	ROBERT C SCHMIDT, JR, Agt	1122 N EDISON ST	Class B Tavern License	150	6/1/2022, 7:00 PM	1
54	Truth Lounge, LLC	Truth Lounge	Tino K Bates, Agt	1111 N Martin L King DR	Class B Tavern License	90	5/25/2022, 7:00 PM	1

55	LEVY PREMIUM FOOD SERVICE, LP	LEVY RESTAURANTS at WISCONSIN CENTER DISTRICT	Nikki L Dewey, Agt.	400 W WISCONSIN AV	Class B Tavern License		6/22/2022, 7:00 PM	1
56	THIS IS IT, INC	THIS IS IT	GEORGE R-SCHNEIDER, Agt	418 E WELLS ST	Class B Tavern License	160	6/29/2022, 7:00 PM	1
57	CAPITAL GRILLE HOLDINGS, INC	THE CAPITAL GRILLE OF MILW #8027	Lindsey R FitzMaurice, Agt	310 W WISCONSIN AV 100	Class B Tavern License	200	6/18/2022, 7:00 PM	1
58	BRICK 3 PIZZA, LLC	BRICK 3 PIZZA	RICHARD J BARRETT, Agt	1107 N Martin L King Jr DR	Class B Tavern License	57	7/5/2022, 7:00 PM	1
59	ELSA'S ON THE PARK, LTD	ELSA'S ON THE PARK	KARL R KOPP, Agt	833 N JEFFERSON ST	Class B Tavern License	100	6/29/2022, 7:00 PM	1
60	MY OFFICE, INC	MY OFFICE	BRIAN J PETERSON, Agt	759-763 N MILWAUKEE ST	Class B Tavern License		6/29/2022, 7:00 PM	1
61	MKE Hotel, LLC	Hyatt Place - Milwaukee Downtown	Angel Rivera, Agt	800 W Juneau AV	Class B Tavern License		7/7/2022, 7:00 PM	1
62	GRAND CONVENIENT , LLC	GRAND CONVENIENT STORE	AHMED K YAFAI, Agt	724 N Martin L King Jr DR	Class A Fermented Malt Beverage Retailer's License		6/13/2022, 7:00 PM	1
63	HB Milwaukee Inc	Old German Beer Hall	HANS WEISSGERBER, III, Agt	1009 N MARTIN L KING JR DR	Class B Tavern License	120	6/13/2022, 7:00 PM	1
64	MARCUS HOTELS HOSPITALITY, LLC	HILTON MILWAUKEE CITY CENTER	CARRIE L AMAYA, Agt	509 W WISCONSIN AV	Class B Tavern License	175	7/5/2022, 7:00 PM	1
65	MARCUS HOTELS HOSPITALITY, LLC	Saint Kate-The Arts Hotel	CARRIE L AMAYA, Agt	139 E KILBOURN AV	Class B Tavern License		7/5/2022, 7:00 PM	1
66	WALGREEN CO	WALGREENS #1200	Nicole R Davis, Agt	275 W WISCONSIN AV 1108	Class A Malt & Class A Liquor License		7/27/2022, 7:00 PM	1
67	ARBED, LLC	MO'S IRISH PUB	JAMES A VASSALLO, Agt	142-44 W Wisconsin AV	Class B Tavern License	480	7/26/2022, 7:00 PM	1
68	746JAMESLO VELLBAR LLC	Stella's	STEPHEN G GILBERTSON , Agt	746 N James Lovell ST	Class B Tavern License		7/29/2022, 7:00 PM	1
69	PABST THEATER CONCESSIONS, LLC	THE PABST THEATER	Richard J Ryan, Agt	144 E WELLS ST	Class B Tavern License		7/5/2022, 7:00 PM	1
70	DJ ENTERPRISE S I, INC	GRACE CENTER	JOAN M GROH, Agt	250 E JUNEAU AV	Class B Tavern License	330	6/17/2022, 7:00 PM	1
71	Wisconsin City and Country Club LLC	Wisconsin Club	BRET J CLARK, Agt	900 W Wisconsin AV	Class B Tavern License	600	7/8/2022, 7:00 PM	1

72	FLANNERY'S PUB, INC	FLANNERY'S BAR & RESTAURANT	STEVEN W SMITH, Agt	425-29 E WELLS ST	Class B Tavern License	270	7/29/2022, 7:00 PM	1
73	Fenix Milwaukee LLC	Rodizio Grill	Renan Utrera De Paula, Agt	777 N WATER ST	Class B Tavern License		7/5/2022, 7:00 PM	1
74	SAZAMA'S FINE CATERING, INC	SAZAMA'S FINE CATERING	TIMOTHY G HILBERT, Agt	929 N WATER ST	Class B Tavern License		8/30/2022, 7:00 PM	1
75	TACO MIKES LLC	Taco Mikes LLC	Michael P Holz, Agt	1001 N MARTIN L KING JR DR	Class B Tavern License		8/11/2022, 7:00 PM	1
76	Art's Performing Center, LLC	Silk on Water	SCOTT A KRAHN, Agt	144 E Juneau AV	Class B Tavern License	80	7/25/2022, 7:00 PM	1
77	Wild Rogues LLC	Elwood's Liquor & Tap	Nathan S Showers, Agt	1111 N Water ST	Class B Tavern License		7/25/2022, 7:00 PM	1
78	Sunstone Studios Inc	Sunstone Studios	Amber J Regan, Agt	127 E Wells ST	Class B Tavern License		8/1/2022, 7:00 PM	1
79	AVENUE LIQUOR, INC	AVENUE LIQUOR	Mohammad S Siddique, Agt	616 W WISCONSIN AV	Class A Malt & Class A Liquor License		8/30/2022, 7:00 PM	1
80	MILWAUKEE BRAT HOUSE, LLC	MILWAUKEE BRAT HOUSE	SCOTT A SCHAEFER, Agt	1013 N Dr Martin L King Jr DR	Class B Tavern License	191	9/14/2022, 7:00 PM	1
81	High Note Inc	The High Note Karaoke Lounge	Evan R DuQuaine, Agt	645 N James Lovell ST	Class B Tavern License	49	9/5/2022, 7:00 PM	1
82	Water Street Brewery Inc	Water Street Brewery	MATTHEW R SCHMIDT, Agt	1101 N WATER ST	Class B Tavern License	300	9/13/2022, 7:00 PM	1
83	Best Place at Pabst LTD	Best Place at the Pabst	JAMES C HAERTEL, Agt	915 W Juneau AV	Class B Tavern License	868	9/22/2022, 7:00 PM	1
84	JSWD Commerce LLC	SpringHill Suites by Marriott Milwaukee Downtown	Benjamin A Risseeuw, Agt	744 N VEL R PHILLIPS AV	Class B Tavern License	95	8/30/2022, 7:00 PM	1
85	Bull & A Boy LLC	Bottle House 42	Kaelyn M Cervero, Agt	1130 N 9TH ST	Class B Tavern License	450	8/30/2022, 7:00 PM	1
86	Sirk Steak LLC	Mo's A Place for Steaks	JAMES A VASSALLO, Agt	720 N Plankinton AV	Class B Tavern License		9/2/2022, 7:00 PM	1
87	MILWAUKEE REPERTORY THEATER, INC	MILWAUKEE REPERTORY THEATER	Melissa N Vartanian-Mikaelian, Agt	108 E WELLS ST	Class B Tavern License		9/7/2022, 7:00 PM	1
88	Levy Restaurants at Wisconsin Center District	Levy Restaurants at Wisconsin Center District	Nikki L Dewey, Agt	420-500 W Kilbourn AV	Class B Tavern License		9/26/2022, 7:00 PM	1
89	THE HARP IRISH PUB, INC	THE HARP	ROBERT C SCHMIDT, JR, Agt	113 E JUNEAU AV	Class B Tavern License	325	9/14/2022, 7:00 PM	1

90	WELLS-JEFFERSON CORPORATION	TAYLOR'S	DANIEL R TAYLOR, Agt	795 N JEFFERSON ST	Class B Tavern License	160	9/25/2022, 7:00 PM	1
91	BAR NONE MILWAUKEE, LLC	BAR NONE	AMY M BLADOW, Agt	1139 N WATER ST	Class B Tavern License	60	10/11/2022, 7:00 PM	1
92	Drury Hotels Company, LLC	Drury Plaza Hotel - Milwaukee Downtown	Chris Palid, Agt	700 N Water ST	Class B Tavern License		10/2/2022, 7:00 PM	1
93	PTG Live Events LLC	The Riverside	Richard J Ryan, Agt	116 W Wisconsin AV	Class B Tavern License	2,480	7/29/2022, 7:00 PM	1
94	BRG 1000 Water St LLC	Room @ The Rumpus Room	CHRISTIAN M DAMIANO, Agt	1020 N Water ST	Class B Tavern License		9/21/2022, 7:00 PM	1
95	BRG 1000 Water Street, LLC	Rumpus Room - A Bartolotta Gastropub	CHRISTIAN M DAMIANO, Agt	1030 N Water ST	Class B Tavern License	254	9/21/2022, 7:00 PM	1
96	Coaches Restaurant & Bar LLC	Coaches	CHARLES E FOWLKES, Agt	1125 N 9TH ST	Class B Tavern License	250	10/11/2022, 7:00 PM	1
97	Charro Latino, LLC	The Garden/Lucid	SEAN A PLISS, Agt	725-729 N Milwaukee ST	Class B Tavern License	490	3/21/2022, 7:00 PM	1
98	LUKE'S OF MILWAUKEE, LTD	RED ROCK SALOON MILWAUKEE	JEFFREY A KOVACOVICH, JR, Agt	1225 N WATER ST	Class B Tavern License	390	9/24/2022, 7:00 PM	1
99	REAL CHILI OF MILWAUKEE, INC	REAL CHILI	STEPHEN J KASTELIC, Agt	419 E WELLS ST	Class B Tavern License	80	10/2/2022, 7:00 PM	1
100	TRIPLE CROWN, INC	BUCK BRADLEY'S EATERY & SALOON	WALTER PAGET, Agt	1019 N Dr Martin L King Jr DR	Class B Tavern License	599	12/16/2021, 6:00 PM	1
101	BREW CITY BAR B Q, INC	TRINITY THREE IRISH PUBS	ROBERT C SCHMIDT, JR, Agt	125 E JUNEAU AV	Class B Tavern License	833	10/16/2022, 7:00 PM	1
102	New Punch Bowl Milwaukee LLC	Punch Bowl Social	Andrea Cornog Kenealey, Agt	1122 N VEL R PHILLIPS AV	Class B Tavern License		10/23/2022, 7:00 PM	1
103	HOJOP, INC	AVENUE BAR & GRILL	JEFFREY M WELK, Agt	611 W WISCONSIN AV	Class B Tavern License		11/10/2022, 6:00 PM	1
104	MIDAS HOSPITALITY, LLC	Aloft Milwaukee Downtown	Mathew W Meadows, Agt	1230 N Dr Martin L King Jr DR	Class B Tavern License		11/22/2022, 6:00 PM	1
105	Levy at Bucks Arena	Levy at Bucks Arena	Jamie L Waters, Agt	1111 N Vel R Phillips AV	Class B Tavern License		7/17/2022, 7:00 PM	1
106	The Chalk House MKE Inc	The Loaded Slate	DOUGLAS L DAUL, Agt	1137 N Dr Martin L King Jr DR	Class B Tavern License	99	10/31/2022, 7:00 PM	1
107	MKE Events LLC	Red White and Blue	JACOB E DEHNE, Agt	1044 N Dr Martin L King Jr DR	Class B Tavern License	824	11/5/2022, 7:00 PM	1

2/1/22, 7:44 AM

108	3rd Street Market LLC	3rd St Market Hall	Jaime A Jacobs-Schroeder, Agt	275 W Wisconsin AV 100	Class B Tavern License		11/9/2022, 6:00 PM	1
-----	-----------------------	--------------------	-------------------------------	------------------------	------------------------	--	--------------------	---

Establishments within a 0.5 miles radius centered on area of interest.



Monday, March 28, 2022



# Notice of Public Hearing

Blank Notice

---

DEHNE, Jacob E  
State Street Pizza Pub at 322 W STATE St.  
Class B Tavern, Food Dealer, Sidewalk Dining and Public Entertainment Premises License  
Applications Requesting Instrumental Musicians, Jukebox, Bands, 3 Amusement Machines,  
Patrons Dancing and Dart Boards

**Wednesday, April 06, 2022 at 02:40 PM**

To whom it may concern:

The above application has been made by the above named applicant(s). This requires approval from the Licenses Committee and the Common Council of the City of Milwaukee. The hearing before the Licenses Committee will take place virtually on 4/06/2022 at 02:40 PM. This is a public hearing. Those wishing to view the proceeding are able to do so via the City Channel – Channel 25 on Spectrum Cable – or on the Internet at <http://city.milwaukee.gov/citychannel>. Those wishing to provide oral testimony will be asked to do so by phone or internet and are asked to contact the staff assistant, Yadira Melendez at (414) 286-2775 or [stasst5@milwaukee.gov](mailto:stasst5@milwaukee.gov) for necessary information. Please make such requests no later than one business day prior to the start of the meeting. You are not required to attend the hearing, but please see the information below if you would like to provide testimony. Once the Licenses Committee makes its recommendation, this recommendation is forwarded to the full Common Council for approval at its next regularly scheduled hearing.

---

## Important details for those wishing to provide information for the Licenses Committee to consider when making its recommendation:

1. The license application is scheduled to be heard at the above time. Due to other hearings running longer than scheduled, you may have to wait some time to provide your testimony.
2. You must testify as to matters that you have personally experienced or seen. (You cannot provide testimony for your neighbor, parent or anyone else; this is considered hearsay and cannot be considered by the committee.)
3. No letters or petitions can be accepted by the committee (unless the person who wrote the letter or the persons who signed the petition are willing to testify).
4. Persons opposed to the license application are given the opportunity to testify first; supporters may testify after the opponents have finished.
5. When you are called to testify, you will be sworn in and asked to give your name, and address. (If your first and/or last names are uncommon please spell them.)
6. You may then provide testimony.
  - a. Include only information relating to the above license application.
  - b. Include only information you have personally witnessed or seen.
  - c. Provide concise and relevant information detailing how this business has affected or may affect the peaceful enjoyment of your neighborhood.
  - d. If by the time you have the opportunity to testify, the information you wish to share has already been provided to the committee, you may state that you agree with the previous testimony. Redundant or repetitive testimony will not assist the committee in making its recommendation.
7. After giving your testimony, the members of the Licenses Committee and the licensee may ask questions regarding the testimony you have given or other factors relating to the license application.
8. Business Competition is not a valid basis for denial or non-renewal of a license.

**Please Note: If you have submitted an objection to the above application your objection cannot be considered by the committee unless you personally testify at the hearing.**



OCCUPANT	MAIL ADDRESS	CITY STATE ZIP
CURRENT OCCUPANT	1011 N MARTIN L KING JR DR, 1	MILWAUKEE, WI 53203-1317
CURRENT OCCUPANT	1011 N MARTIN L KING JR DR, 2	MILWAUKEE, WI 53203-1317
CURRENT OCCUPANT	1011 N MARTIN L KING JR DR, 3	MILWAUKEE, WI 53203-1317
CURRENT OCCUPANT	1011 N OLD WORLD THIRD ST, 1	MILWAUKEE, WI 53203-1317
CURRENT OCCUPANT	1011 N OLD WORLD THIRD ST, 2	MILWAUKEE, WI 53203-1317
CURRENT OCCUPANT	1011 N OLD WORLD THIRD ST, 3	MILWAUKEE, WI 53203-1317
CURRENT OCCUPANT	1013 N MARTIN L KING JR DR	MILWAUKEE, WI 53203-1301
CURRENT OCCUPANT	1013 N OLD WORLD THIRD ST	MILWAUKEE, WI 53203-1301
CURRENT OCCUPANT	1029 N MARTIN L KING JR DR	MILWAUKEE, WI 53203-1301
CURRENT OCCUPANT	1029 N MARTIN L KING JR DR, A	MILWAUKEE, WI 53203-1301
CURRENT OCCUPANT	1029 N MARTIN L KING JR DR, B	MILWAUKEE, WI 53203-1301
CURRENT OCCUPANT	1029 N OLD WORLD THIRD ST	MILWAUKEE, WI 53203-1301
CURRENT OCCUPANT	1029 N OLD WORLD THIRD ST, A	MILWAUKEE, WI 53203-1301
CURRENT OCCUPANT	1029 N OLD WORLD THIRD ST, B	MILWAUKEE, WI 53203-1301
CURRENT OCCUPANT	1033 N MARTIN L KING JR DR, 301	MILWAUKEE, WI 53203-1301
CURRENT OCCUPANT	1033 N MARTIN L KING JR DR, 302	MILWAUKEE, WI 53203-1301
CURRENT OCCUPANT	1033 N MARTIN L KING JR DR, 401	MILWAUKEE, WI 53203-1301
CURRENT OCCUPANT	1033 N MARTIN L KING JR DR, 402	MILWAUKEE, WI 53203-1301
CURRENT OCCUPANT	1033 N MARTIN L KING JR DR, 501	MILWAUKEE, WI 53203-1301
CURRENT OCCUPANT	1033 N OLD WORLD THIRD ST, 301	MILWAUKEE, WI 53203-1301
CURRENT OCCUPANT	1033 N OLD WORLD THIRD ST, 302	MILWAUKEE, WI 53203-1301
CURRENT OCCUPANT	1033 N OLD WORLD THIRD ST, 401	MILWAUKEE, WI 53203-1301
CURRENT OCCUPANT	1033 N OLD WORLD THIRD ST, 402	MILWAUKEE, WI 53203-1301
CURRENT OCCUPANT	1033 N OLD WORLD THIRD ST, 501	MILWAUKEE, WI 53203-1301
CURRENT OCCUPANT	322 W STATE ST, 302	MILWAUKEE, WI 53203-1315
CURRENT OCCUPANT	925 N MARTIN L KING JR DR, 403	MILWAUKEE, WI 53203-1509
CURRENT OCCUPANT	925 N MARTIN L KING JR DR, 404	MILWAUKEE, WI 53203-1509
CURRENT OCCUPANT	925 N MARTIN L KING JR DR, 405	MILWAUKEE, WI 53203-1509
CURRENT OCCUPANT	925 N MARTIN L KING JR DR, 407	MILWAUKEE, WI 53203-1509
CURRENT OCCUPANT	925 N MARTIN L KING JR DR, 408	MILWAUKEE, WI 53203-1509
CURRENT OCCUPANT	925 N MARTIN L KING JR DR, 409	MILWAUKEE, WI 53203-1509
CURRENT OCCUPANT	925 N MARTIN L KING JR DR, 410	MILWAUKEE, WI 53203-1509
CURRENT OCCUPANT	925 N MARTIN L KING JR DR, 411	MILWAUKEE, WI 53203-1509
CURRENT OCCUPANT	925 N MARTIN L KING JR DR, 500	MILWAUKEE, WI 53203-1510
CURRENT OCCUPANT	925 N MARTIN L KING JR DR, 501	MILWAUKEE, WI 53203-1510
CURRENT OCCUPANT	925 N MARTIN L KING JR DR, 502	MILWAUKEE, WI 53203-1510
CURRENT OCCUPANT	925 N MARTIN L KING JR DR, 503	MILWAUKEE, WI 53203-1510
CURRENT OCCUPANT	925 N MARTIN L KING JR DR, 504	MILWAUKEE, WI 53203-1510
CURRENT OCCUPANT	925 N MARTIN L KING JR DR, 505	MILWAUKEE, WI 53203-1510
CURRENT OCCUPANT	925 N MARTIN L KING JR DR, 506	MILWAUKEE, WI 53203-1510
CURRENT OCCUPANT	925 N MARTIN L KING JR DR, 507	MILWAUKEE, WI 53203-1510
CURRENT OCCUPANT	925 N MARTIN L KING JR DR, 508	MILWAUKEE, WI 53203-1510
CURRENT OCCUPANT	925 N MARTIN L KING JR DR, 509	MILWAUKEE, WI 53203-1510
CURRENT OCCUPANT	925 N MARTIN L KING JR DR, 510	MILWAUKEE, WI 53203-1510
CURRENT OCCUPANT	925 N MARTIN L KING JR DR, 511	MILWAUKEE, WI 53203-1510

Blank Notice

Total Records: 45

Radius: 250.0 feet and Center of Circle: 322 W State St



# BUSINESS LICENSE PLAN OF OPERATION

ccl-busplan 5/12/2020

Office of the City Clerk License Division  
200 E. Wells St. Room 105, Milwaukee, WI 53202  
(414) 286-2238 www.milwaukee.gov/license e-mail address: [license@milwaukee.gov](mailto:license@milwaukee.gov)

## 1. Type of Business

Applying for:  Extended Hours (12AM to 5AM) - If a food establishment, check all that apply:  Delivery  Drive Thru  Dining Room  
 Self Service Laundry  Massage Establishment  Filling Station  
 Other (supplemental application for specific license also required)

Provide a detailed description of the type of business you plan on operating: A tavern that offers food.

Do you have any experience operating this type of business?  No  Yes If yes, explain:

## 2. Business Operations

- a. Proposed Opening Date: March 11, 2022
- b. Is this premise under construction?  No  Yes If yes, list estimated completion date: 3/4/22
- c. Is this a franchise?  No  Yes
- d. Is this premises currently licensed?  No  Yes If yes, list type of license: na
- e. Is the current licensee operating?  No  Yes If no, list date closed: na
- f. Do you have future plans for other businesses, licenses or permits at this location?  No  Yes  
If yes, explain: \_\_\_\_\_
- g. Have you previously held an Extended Hours License in Milwaukee?  No  Yes  
If yes, list address(es): \_\_\_\_\_
- h. Are other businesses operating in the same building?  No  Yes If yes, describe: An AirBnB operates in 2nd/3rd floors

## 3. Litter & Noise

- a. How are grounds kept clean?  Sweep  Pressure Wash  Pick Up Litter  Other: \_\_\_\_\_
- b. How often will grounds be cleaned?  Daily  Weekly  As Needed  Monthly  Other: \_\_\_\_\_
- c. Grounds cleaned by:  Licensee  Building Owner  Employees  Hired Maintenance  Other: \_\_\_\_\_
- d. How are noise issues prevented and/or addressed?  Security  Manager approaches customer(s)  Call Police  
 Signs Posted  Other: \_\_\_\_\_
- e. Will a sound amplification system be used?  No  Yes If yes, describe: Sound system and speakers are used

## 4. Smoking & Sanitation

- a. Are there designated outdoor smoking areas?  No  Yes If yes, describe: \_\_\_\_\_
- b. Number of Garbage Cans: Inside: 6 Locations: Behind the bar and in Kitchen  
Outside: 2 Locations: Dumpsters behind/on side of building
- c. Is a crowd control barrier used?  No  Yes If yes, describe: \_\_\_\_\_
- d. How many restrooms are on the premises? 2
- e. Name of solid waste contractor:  Advanced Disposal  Waste Management  Other: \_\_\_\_\_

## 5. Security

- a. Are there onsite parking spaces?  No  Yes If yes, how many? \_\_\_\_\_ and describe the parking security plan: \_\_\_\_\_
- b. Is there a loading zone?  No  Yes If yes, describe the loading area security plan: \_\_\_\_\_  
The alley serves as a loading zone to adjacent bars, there are cameras placed in alley
- c. Will you have security personnel on premise?  No  Yes If yes, how many? 1 and answer the following:  
 What are their responsibilities? Security will check ID's and monitor general bar area at busy times  
 Is security equipment used?  No  Yes If yes, describe Camera system and monitors  
 List their licensing, certification, or training credentials \_\_\_\_\_
- d. Will there be security cameras?  No  Yes If yes, how many? 5 and list locations: front/side of building,  
in general area of bar, behind the bar, and in alley
- e. Will searches/identification checks be done upon entry?  No  Yes If yes, describe Bouncers will check ID's

## 6. Percentage of Sales (must total 100%)

Alcohol <u>60</u> %	Food <u>38</u> %	Secondhand Merchandise _____ %	Precious Metals & Gems _____ %
Entertainment _____ %	Cigarettes _____ %		
Pawnbroker Activity _____ %	Salvaged Materials _____ % (such as scrap metal)	Personal Services (such as tattoo, body piercing, salon, tailor, tanning, etc.) _____ %	Other <u>2</u> % Describe: <u>TSHIRTS</u>

## 7. Businesses/Licenses on the Premises (check all that apply):

### Type 1

- Full Service Restaurant  Cafe/Coffee Shop  Deli or Fast Food Restaurant  Private/Fraternal/Veterans Club
- Night Club  Tavern  Cocktail Lounge  Teen Club
- Banquet Hall  Sports Facility  Bowling Alley
- Hotel/Motel : Number of Floors: 1  Rooming House: Number of Floors: \_\_\_\_\_  
 Number of Rooms: 5 Number of Rooms: \_\_\_\_\_

### Type 2

- Liquor Store  Corner Store  Supermarket  Convenience Store
- Gas Station  Amusement/Phonograph Distributor  Recycling, Salvage or Towing
- Used Car Dealer  Personal Service Establishment (such as tattoo business, hair salon, tailor, etc.)  Recording Studio

What other licenses/permits will you hold at this location? (check all that apply)

- Occupancy Permit  Cigarette & Tobacco  Gas Station Extended Hours  Class "B" Tavern  Weights & Measures
- Secondhand Dealer  Precious Metal & Gem  Other: \_\_\_\_\_

## 8. Legal Capacity (only if a Type 1 premises in #7 above)

Capacity 99 (Call the Milwaukee Development Center at 414-286-8211 if you have questions.)

## 9. Premises Description

- a. Identify all area(s) of the premises that will be used in operating this business (include areas used only for storage):  
 1<sup>st</sup> Floor  2<sup>nd</sup> Floor  Basement Storage  Patio  Beer Garden  Sidewalk Café  Deck  Rooftop  
 Other: Describe: \_\_\_\_\_
- b. Describe Location:  Major Thoroughfare  Secondary Street  Other: \_\_\_\_\_
- c. Nearest Major Cross Street: King Dr. (3rd Street) & State Street
- d. Describe Building:  Free Standing Building  Strip Mall  Other: \_\_\_\_\_
- e. Describe Premises Structure:  Single Story  Multi-Story - # of Stories 3  Other: \_\_\_\_\_
- f. Describe Surrounding Area:  Commercial  Residential  Industrial  Other: \_\_\_\_\_
- g. Building Owner Name: Jake Dehne Phone Number: 262-893-5421  
 Building Owner Address: 2365 Robbie Court, Brookfield WI 53005

## 10. Hours of Operation & Customers

Will customers be entering the premises?  No  Yes

Day of the Week	Proposed Hours of Operation:		Estimated Number of Customers expected each day	Potential Age Range of Customers	Class B Tavern Applicant Only: Age Restriction (If none, write 'None')
	Open Time (include a.m. or p.m.)	Close Time (include a.m. or p.m.)			
Sunday	11 a.m.	2 a.m.	60	21-70	none
Monday	3 p.m.	2 a.m.	30	21-70	none
Tuesday	3 p.m.	2 a.m.	40	21-70	none
Wednesday	3 p.m.	2 a.m.	60	21-70	none
Thursday	11 a.m.	2 a.m.	100	21-70	21 after 8pm
Friday	11 a.m.	2:30 a.m.	150	21-70	21 after 8pm
Saturday	11 a.m.	2:30 a.m.	200	21-70	21 after 8pm

An Extended Hours Establishment License is required for any convenience store, filling station, personal service establishment (such as tattoo, body piercing, salon, tailor, tanning, etc.), recording studio or restaurant which is open between the hours of 12:00 a.m. and 5:00 a.m.

Alcohol Establishments Class A: 8:00 am to 9:00 pm Sunday thru Saturday  
 Permitted Hours of Operation: Class B: 6:00 am to 2:00 am Sunday thru Thursday, 6:00 am to 2:30 am Friday & Saturday

Entertainment Outdoor Closing Hours: 10:00pm Sunday-Thursday; 12:00am Friday & Saturday; unless a different time, either earlier or later, is established by the Common Council in its approval of the licensee's plan of operation.

## 11. Signature(s)

  
 Signature of Sole Proprietor, Partner, or 20% or more Shareholder  
 (If there are no 20% or more shareholders, Corporate Officer-print name/title and sign)

\_\_\_\_\_  
 Signature of additional partner or 20% or more shareholder

**See Application Information for a complete list of all required application forms.**



## ALCOHOL BEVERAGE & PUBLIC ENTERTAINMENT PREMISES SUPPLEMENTAL APPLICATION

Office of the City Clerk License Division  
200 E. Wells St. Room 105, Milwaukee, WI 53202  
(414) 286-2238 e-mail address: license@milwaukee.gov [www.milwaukee.gov/license](http://www.milwaukee.gov/license)

Legal Entity Name: PTM Ventures LLC

Premise Address: 322 W State Street, Milwaukee, WI 53203

### Proximity of Premises to Church, School, Daycare Center or Hospital

Is the building within 300 feet of any church, school, daycare center or hospital?  No  Yes

### "Service Bar Only" Designation

If applying for Class B or C license, are you applying for "Service Bar Only"?  No  Yes

Service Bar Only means customers cannot sit at the bar. Alcohol is served to employees who serve patrons seated at tables. No stools, chairs or other articles of furniture shall be placed at the service bar for patrons to sit upon.

### Business Information

a) Are you taking out this application for anyone that may not be eligible for a license?  No  Yes

If yes, list their name and address: \_\_\_\_\_

b) Will the agent, a partner or the individual licensee be conducting the day-to-day operations of the business?  No  Yes

If no, list the name and address of the person(s) who will: \_\_\_\_\_

Class B Applicants: If the agent, a partner or the individual licensee will not be conducting the day-to-day operations of the business, the person(s) listed above must obtain a Class B Managers license.

c) Does anyone else have money invested or any other interest in this business?  No  Yes

If yes, explain: \_\_\_\_\_

d) Have you made an agreement with anyone to repay any loan or any other payments based upon income from the business?

No  Yes If yes, list name and address: \_\_\_\_\_

### Property Information (New & Transfer Applicants Only)

a) Do you own or lease the building?  Own  Lease

b) Who owns the fixtures (for example, coolers, etc.)? Building owner

c) Are you purchasing the stock and/or fixtures?  No  Yes If yes, amount paid \$ \_\_\_\_\_

d) Total amount paid for business \$ na

e) Total amount paid for goodwill of the business \$ na

Goodwill comprises the reputation and customer relationships of an existing business. If the price you pay for the business exceeds the fair market value of all of the rest of the assets of the business, the excess may be considered goodwill.

f) Have you made arrangements with the seller for payment of personal property taxes?  No  Yes

### Lease Information (New & Transfer Applicants who are leasing the premises only)

a) Date lease begins 1/1/22 Ends 7/31/27

b) Monthly rental \$ 5,500.00

c) Do you have an option to renew the lease?  No  Yes

d) Does your lease allow for assignment to another party without the consent of the owner?  No  Yes

e) For what length of time have you been guaranteed occupancy (number of years)? 5 1/2 years

**Lease Information (Continued)**

- f) In addition to paying the monthly rental, will you have to pay anything additional to the owner of the building to guarantee performance of the lease?  No  Yes If yes, explain \_\_\_\_\_
- g) Does the present owner or occupancy object to the granting of your license?  No  Yes  
If yes, explain \_\_\_\_\_

**Change of Agent Applicants Only**

Have there been any changes to the floor plan since the last application was submitted?  No  Yes  
If no, a new floor plan is not required. If yes, submit a new floor plan and explain the change(s):  
\_\_\_\_\_

**Signature**

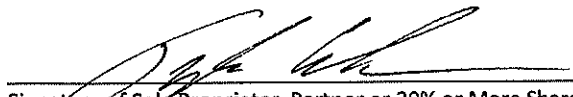
  
\_\_\_\_\_  
Signature of Sole Proprietor, Partner or 20% or More Shareholder  
(If no 20% or more Shareholder, Corporate Officer - print name/title and sign)

Note: All information contained in this application is subject to approval by the Common Council.  
Deviating from approved plan of operation will subject licensee to citations, and/or suspension or non-renewal of the license.  
Contact the License Division for information on how to request changes.

**New and transfer of premises applicants must submit the following:**

- Detailed floor plan
- If a restaurant, copy of the menu



# FOOD DEALER LICENSE PLAN OF OPERATION

ccl-foodplan 2/28/19

OFFICE OF THE CITY CLERK, LICENSE DIVISION  
CITY HALL, 200 E. WELLS ST, ROOM 105, MILWAUKEE, WI 53202  
(414) 286-2238 • [license@milwaukee.gov](mailto:license@milwaukee.gov) • [www.milwaukee.gov/license](http://www.milwaukee.gov/license)

Legal Entity Name: PTM Ventures LLC

Premises Address: 322 W State St, Milwaukee, WI 53203

## SECTION 1 TYPE OF BUSINESS

What will be the majority of your food sales? (check one)

**Restaurant Items (meals):**

MEALS include, but are not limited to, chicken, ribs, sandwiches, roasted corn, baked potatoes, hot dogs, brats, tacos, nachos w/ cheese and meat, French fries, cooked or deep fried vegetables/fruit, cooked cheese curds, corn dogs, egg rolls, salads.

**Retail Items (snacks and beverages):**

RETAIL items include, but are not limited to, ice cream/soft serve, lemonade, snow cones, coffee, espresso, cappuccino, tea, fruit juice, smoothies, candy, dispensed soda, fruit cups, bakery, cookies, kettle corn, cotton candy, funnel cakes, fritters, tortilla chips w/ cheese.

Will it be a convenience store?  Yes  No

A convenience store contains less than 5,000 square feet of retail space and has, as its primary business, the sale of basic food items and in addition, sells household products or is a filling station that sells basic food items and household products.

**Bed & Breakfast**

**Micro Market**

All Applicants: Submit a menu or a list of food items that will be sold.

Will any wholesale business be done?  No  Yes If yes, what percentage of food sales will be wholesale?

Less than 25%

25% or More AND:

Restaurant items (meals) will be sold – Complete this application and also contact DATCP.

NO restaurant items (meals) will be sold - Do NOT complete this application. Contact DATCP only.

## SECTION 2 FOOD PROCESSING

Will any food processing be done?  No  Yes

Processing is defined as assembling, grinding, cutting, mixing, baking, coating, stuffing, packing, bottling, grilling, canning, extracting, fermenting, distilling, pickling, freezing, drying, smoking, or packaging.

## SECTION 3 FOOD REQUIRING TEMPERATURE CONTROL

Will any food that requires temperature control be sold?  No  Yes  
(includes dairy products such as milk, cheese, and ice cream, fish, shellfish, meat, poultry)

If yes, list the types of food items: Fish, Meat, Poultry, cheese



**SECTION 4 DETAILS OF OPERATION**

Will you have seating on site for dining?  No  Yes

Will you be doing any catering?  No  Yes

Will you be doing any delivery?  No  Yes

Will you have outdoor activities?  No  Yes - Check all that apply:  Bar  Cooking/Grilling  Dining

Will you have a drive thru window?  No  Yes - Are hours different from inside?  No  Yes  
 If Yes, provide drive thru hours: \_\_\_\_\_

Will scales or barcode scanners be used?  No  Yes - You must also apply for a Weights & Measures License.

**SECTION 5 ADDITIONAL SITES**

Where will food be prepared and/or sold?  
 At a single site  At multiple sites: How many? \_\_\_\_\_ (for example, a hotel with several dining rooms or bars)  
 If multiple sites, attach a Food Dealer Additional Site Addendum (ccl-foodadd) for each additional site.

**SECTION 6 CONSTRUCTION OR CHANGES**

Are you planning any construction, remodeling or equipment changes?  
 No If No, SKIP to Section 8  
 Yes If Yes, check all that apply:  New construction of a building  Renovation or remodeling  
 Construction changes to existing building  Equipment changes only

Provide a brief description of the changes: Construction of bar, remodel of kitchen, new equip

Start date: 02/7/22

Name, Address & Phone Number of Architect: Norman Barrientos (Barrientos Design)  
205 W. Highland Ave. Milwaukee WI 53203

Name, Address & Phone Number of Contractor: TBD

**SECTION 7 ALCOHOL BEVERAGES**

Are you applying for an alcohol beverage license?  
 No If No, SKIP to Section 8  
 Yes If YES, if your food license is approved prior to the alcohol license, when do you want the food license issued?  
 Immediately  At the same time as the alcohol license

**SECTION 8 ACKNOWLEDGEMENTS & SIGNATURE**

You must initial each item confirming your understanding:

TK I understand the Health Department must conduct an inspection and advise the License Division of their approval before the license may be issued.

TK I understand I must obtain an occupancy permit from the Department of Neighborhood Services and an inspection may be required. Neighborhood Services must advise the License Division of their approval before the license may be issued.

TK I understand the district alderperson will review and either support or object to my application. If he/she objects, I may appeal and be scheduled to appear before the Licenses Committee. The Licenses Committee will then make a recommendation to the Common Council. The Common Council must grant the license before it may be issued.

TK I understand proof of payment for all license fees must be on file in the License Division before the license may be issued and the license must be issued and posted in my establishment prior to opening for business.

TK I will not operate my food business until the license has been issued and posted in the establishment.

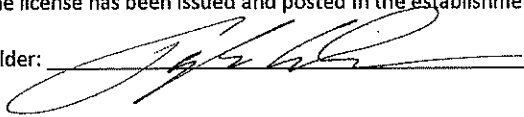
Signature of Sole Proprietor, Partner, or 20% Shareholder: 

Signature of Additional Partner: \_\_\_\_\_



# PUBLIC ENTERTAINMENT PREMISES LICENSE SUPPLEMENTAL APPLICATION

Office of the City Clerk License Division  
200 E. Wells St. Room 105, Milwaukee, WI 53202  
(414) 286-2238 [www.milwaukee.gov/license](http://www.milwaukee.gov/license) e-mail address: [license@milwaukee.gov](mailto:license@milwaukee.gov)

**PREMISES ADDRESS:** 322 W State St, Milwaukee, WI 53203

**TYPES OF ENTERTAINMENT (CHECK ALL THAT APPLY)**

- |   |  |   |   |
|---|--|---|---|
| <input checked="" type="checkbox"/> Instrumental Musicians                          | <input type="checkbox"/> Battle of the Bands | <input type="checkbox"/> Dancing by Performers                          | <input checked="" type="checkbox"/> Amusement Machines<br>How many? <u>3</u>  |
| <input checked="" type="checkbox"/> Bands   | <input type="checkbox"/> Comedy Acts         | <input type="checkbox"/> Adult Entertainment/<br>Strippers/Erotic Dance | <input type="checkbox"/> Concerts<br>Approx. # per year? _____                |
| <input type="checkbox"/> Bowling Alley<br>How many? _____                           | <input type="checkbox"/> Disc Jockey         | <input type="checkbox"/> Wrestling                                      | <input type="checkbox"/> Theatrical Performances<br>Approx. # per year? _____ |
| <input type="checkbox"/> Pool Tables<br>How many? _____                             | <input type="checkbox"/> Magic Shows         | <input type="checkbox"/> Patron Contests                                | <input checked="" type="checkbox"/> Jukebox                                   |
| <input type="checkbox"/> Motion Pictures (movies by<br>admission) - How many? _____ | <input type="checkbox"/> Poetry Readings     | <input checked="" type="checkbox"/> Patrons Dancing                     | <input type="checkbox"/> Karaoke  |
| <input checked="" type="checkbox"/> Other: <u>Dart boards</u>                       |  |   |   |

*Entertainment Outdoor Closing Hours: 10:00pm Sunday-Thursdays; 12:00am Friday & Saturday; unless a different time, either earlier or later, is established by the Common Council in its approval of the licensee's plan of operation.*

**PROMOTERS/SOUND AMPLIFICATION**

Will promoters ever be used for any of the entertainment?  No  Yes If Yes, Describe:

At any time will sound amplification be used?  No  Yes If Yes, Describe: Speaker system for bands and jukebox

**LEGAL CAPACITY OF PREMISES**

99 (Call the Development Center at 414-286-8211 with questions.) Legal capacity determines the fee for your Public Entertainment Premises License. If you would like to request the license be approved with a lower capacity than that listed above, indicate the lower capacity here: na. If approved, this lower capacity will print on your license and override the capacity listed on your Occupancy Permit.

**ACKNOWLEDGEMENT/SIGNATURE**

I understand that after the license has been issued, a change to the plan of operation will require a written request to change and approval from the Common Council. I agree to inform the City Clerk within 10 days of any substantial changes in the information supplied in this application. I understand that I shall not willfully refuse to provide the services offered under this license, or add charges or require deposits not required of the general public because of race, color, sex, religion, national origin or ancestry, age, handicap, lawful source of income, marital status, sexual orientation, gender identity or expression, familial status or the fact that a person is now or has been a member of the military service, whether dressed in uniform or not; and shall not seek such information as a condition of employment, or penalize any employee or discriminate in the selection of personnel for training or promotion on the basis of such information.

I have knowledge of the City Ordinances currently regulating public entertainment, and understand that the license may be subject to suspension, non-renewal or revocation, if I violate any rule, law or regulation of the city of Milwaukee and State of Wisconsin.

  
\_\_\_\_\_  
Signature of Sole Proprietor, Partner or 20% or More Shareholder  
(If no 20% or more Shareholder, Corporate Officer - print name/title and sign)

**Office Use Only:**

Initials: \_\_\_\_\_ Filed: \_\_\_\_\_ App: \_\_\_\_\_

Only PEP?  No  Yes If Yes,  Queue to MPD and  Email Mgrs/Team Lead (must be heard w/in 60 days)



# Sidewalk Dining Facility Supplemental Application

ccl-side1 2/21/18

Office of the City Clerk License Division  
200 E. Wells St. Room 105, Milwaukee, WI 53202  
(414) 286-2238 [www.milwaukee.gov/license](http://www.milwaukee.gov/license) e-mail address: [license@milwaukee.gov](mailto:license@milwaukee.gov)

Business Name: <b>BACKWOODS TAVERN &amp; OYSTERS</b>	Aldermanic District # <b>4</b>
--	--------------------------------

Premises Address: **322 W. STATE ST. MILWAUKEE WI 53203**

## Business Operations

Check one:  I/we are also applying for Food/Alcohol license(s) at this time.  
 I/we currently hold Food/Alcohol license(s) AND ....

confirm that the Business Plan of Operation on file which was previously submitted with the Food and/or Alcohol application has not changed, except for the addition of this sidewalk dining facility.

have included a new Business Plan of Operation reflecting requested changes.

Sidewalk Dining Facility will operate from: Start Date: **TBD** to End Date: \_\_\_\_\_

Will any food preparation be done outdoors?  No  Yes  
 If yes, describe: \_\_\_\_\_

Will any sidewalk dining facility improvements be physically attached to public structures?  No  Yes  
 If yes, describe: **PARKLET WILL BE CONTACTING DAWN SCHMIDT**

## Property Owner

Check one:  Applicant owns the property  
 Property owner's information/signature provided below (REQUIRED):

Name: \_\_\_\_\_ Phone # \_\_\_\_\_

Address: \_\_\_\_\_

Property Owner's Signature: \_\_\_\_\_

## Signature(s)

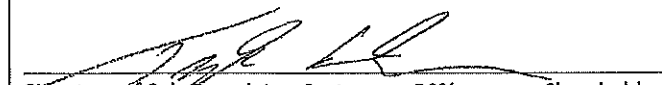
  
 Signature of Sole Proprietor, Partner, or 20% or more Shareholder  
 (If there are no 20% or more shareholders, Corporate Officer-print name/title and sign)

\_\_\_\_\_  
 Signature of additional partner or 20% or more shareholder

**Office Use Only:**

Initials \_\_\_\_\_ Filed \_\_\_\_\_ App # \_\_\_\_\_

Processing LS: Queue to:  HD  DNS  CC Email To:  DPW  Primary LS

Also:  holds  is applying for:  Food  Alcohol  Perm Ext

- Vel R. Phillips Ave. -

- PUBLIC PARKING LOT -  
200' x 100'

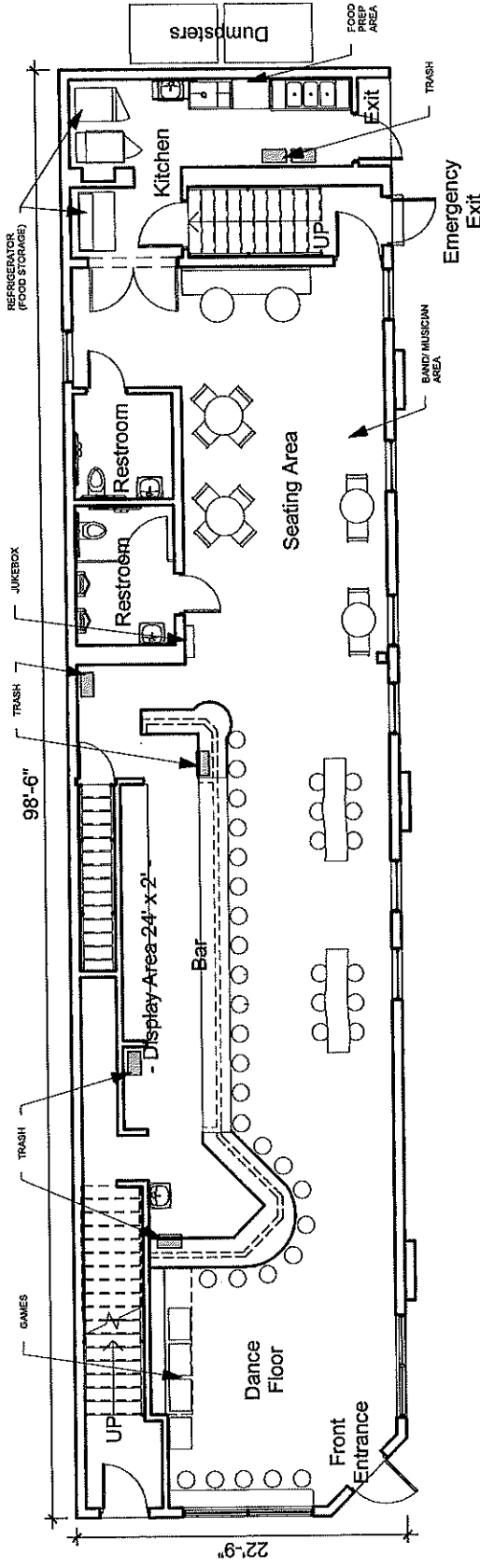

- EXISTING ALLEY -

- W. STATE STREET -

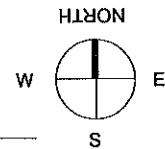

Ground Level: 2,265 SF  
 Basement: 2,265 SF  
 TOTAL: 4,530 SF

"Backwoods Tavern & Oasis"  
 Taylor Korslin agent for "PTM Ventures LLC"  
 322 W. State Street, Milwaukee, WI. 53203  
 January 25, 2022

- Vel R. Phillips Ave. -

- W. STATE STREET -

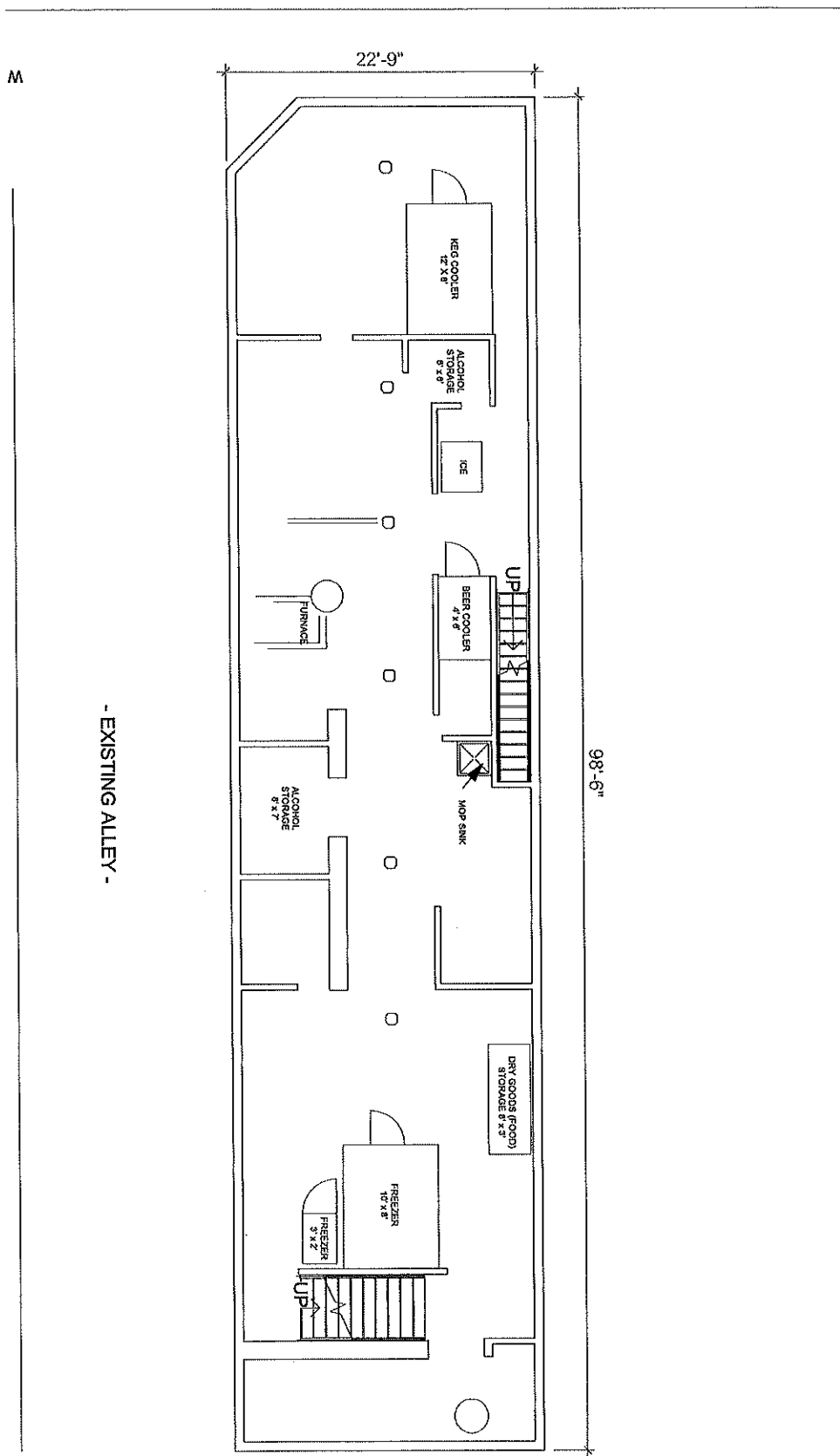
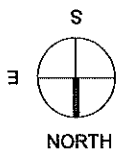

"Backwoods Tavern & Oasis"  
Taylor Korslin agent for "PTM Ventures LLC"  
322 W. State Street, Milwaukee, WI. 53203  
January 25, 2022

Ground Level: 2,265 SF  
Basement: 2,265 SF  
TOTAL: 4,530 SF

- Vel R. Phillips Ave. -

- PUBLIC PARKING LOT -  
200' x 100'

- W. STATE STREET -

Sidewalk cafe  
(parklet) 20' x 7'

SIDEWALK ACCESS TO PARKLET  
22'-9"

- EXISTING ALLEY -

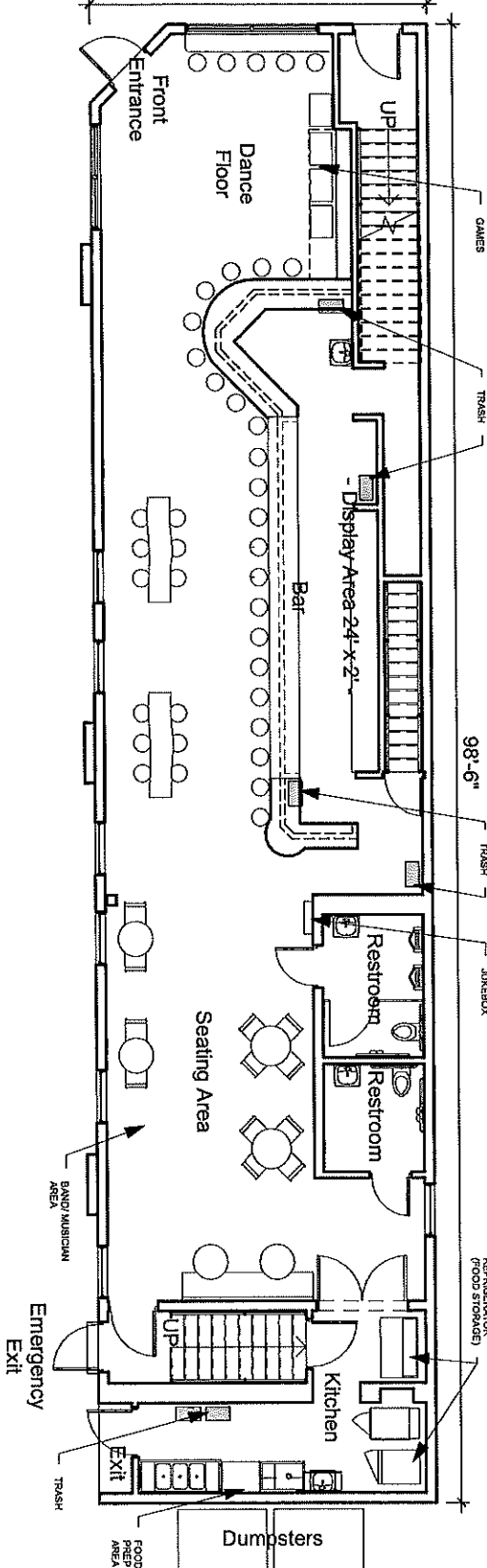
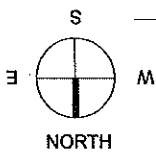

"Backwoods Tavern & Oasis"  
Taylor Korslin agent for "PTM Ventures LLC"  
322 W. State Street, Milwaukee, WI. 53203  
January 25, 2022

Ground Level: 2,265 SF  
Basement: 2,265 SF  
TOTAL: 4,530 SF