

PLAT OF MILWAUKEE IN SEC.(28-29-33)-7-22

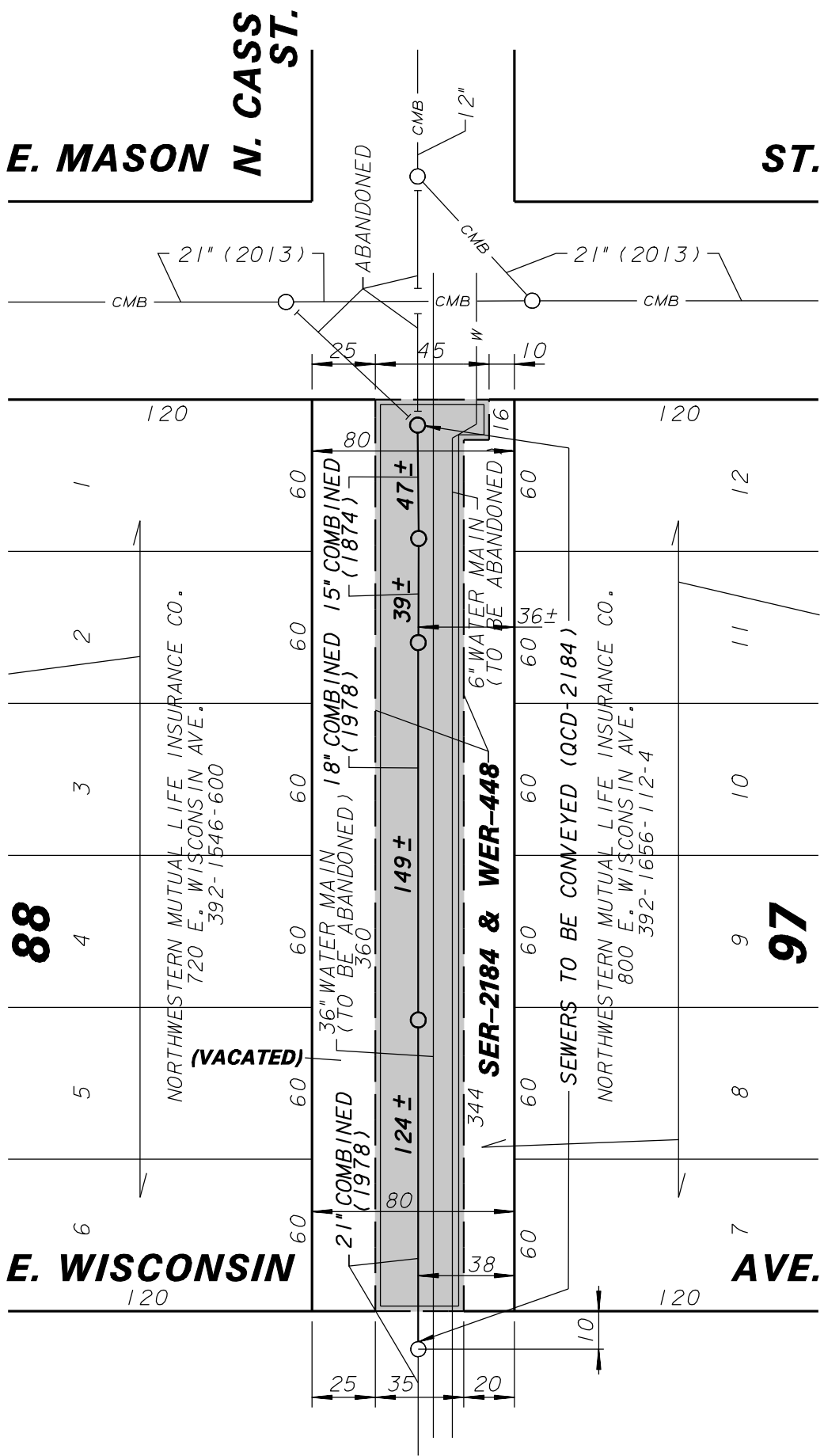

88

97

ENVIRONMENTAL ENGINEERING SECTION
INFRASTRUCTURE SERVICES DIVISION
DEPARTMENT OF PUBLIC WORKS
MILWAUKEE, WISCONSIN

PLAN OF SEWER EASEMENT

AREA IN	N.W.1/4 SEC.28, T.7 N., R.22 E.		
VACATED N. CASS ST. FROM E. WISCONSIN AVE.			
TO E. MASON ST.			
SCALE 1" =	60'	ATLAS PAGE NO.	393
		SER-2184, WER-448, &	QCD-2184
DRAWN BY	M.SAIFULLAH	CH'KD. BY	S.BEKELE
		W.O. NO.	
APPROVED	<i>Timothy J. Thun</i>		DATE
APPROVED	<i>[Signature]</i>		08-11-14
			FILE NO.
			198-7-15