



CERTIFICATE OF APPROPRIATENESS APPLICATION FORM

Incomplete applications will not be processed for Commission review.

Please print legibly.

1. HISTORIC NAME OF PROPERTY OR HISTORIC DISTRICT: (if known)

ADDRESS OF PROPERTY:

2649 N. Terrace Ave.

2. NAME AND ADDRESS OF OWNER:

Name(s): Sheryl Ellis

Address: 2649 N. Terrace Ave

City: Milwaukee State: WI. ZIP: 53211

Email: janebabe@aol.com

Telephone number (area code & number) Daytime: Cell 414 333-1423 Evening: Home 414-962-3873

3. APPLICANT, AGENT OR CONTRACTOR: (if different from owner)

Name(s): Michael Luethe

Address: 101 E Abert Pl.

City: Milwaukee State: WI. ZIP Code: 53212

Email: mike@badgerfence.com

Telephone number (area code & number) Daytime: 414-466-7510 ext. 203. Evening:

4. ATTACHMENTS: (Because projects can vary in size and scope, please call the HPC Office at 414-286-5712 for submittal requirements)

A. REQUIRED FOR MAJOR PROJECTS:

Photographs of affected areas & all sides of the building (annotated photos recommended)

Sketches and Elevation Drawings (1 full size and 1 reduced to 11" x 17" or 8 1/2" x 11")
A digital copy of the photos and drawings is also requested.

Material and Design Specifications (see next page)

B. NEW CONSTRUCTION ALSO REQUIRES:

Floor Plans (1 full size and 1 reduced to a maximum of 11" x 17")

Site Plan showing location of project and adjoining structures and fences

PLEASE NOTE: YOUR APPLICATION CANNOT BE PROCESSED UNLESS BOTH PAGES OF THIS FORM ARE PROPERLY COMPLETED AND SIGNED.

5. DESCRIPTION OF PROJECT:

Tell us what you want to do. Describe all proposed work including materials, design, and dimensions. Additional pages may be attached.

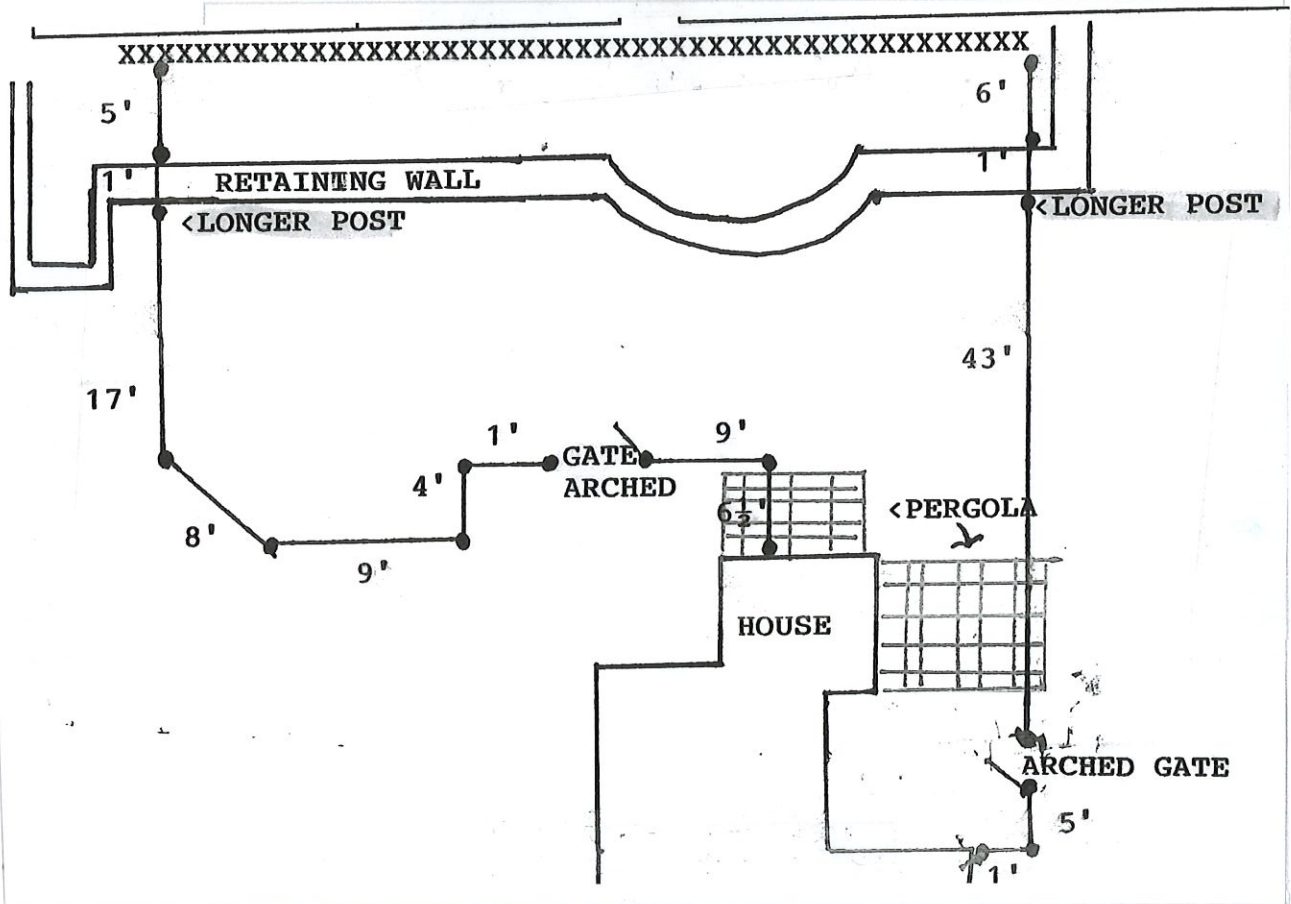

6. SIGNATURE OF APPLICANT:

Michael Luethe
Signature

Michael Luethe
Please print or type name

4-3-18
Date

This form and all supporting documentation **MUST** arrive by 12:00 noon on the deadline date established to be considered at the next Historic Preservation Commission Meeting. Any information not provided to staff in advance of the meeting will not be considered by the Commission during their deliberation. Please call if you have any questions and staff will assist you.

Hand Deliver or Mail Form to:
Historic Preservation Commission
City Clerk's Office
200 E. Wells St. Room B-4
Milwaukee, WI 53202

PHONE: (414) 286-5722

hpc@milwaukee.gov

www.milwaukee.gov/hpc

Or click the **SUBMIT** button to automatically email this form for submission.

SUBMIT

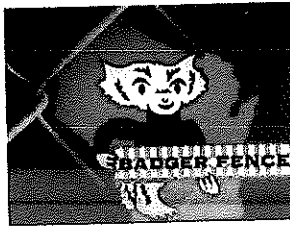

Salesmen

Date

3/26/2018

ML

Proposal #

3038

INSTALLED AT:

SHERYL ELLIS
 2649 N. TERRACE AVE.
 MILWAUKEE, WI 53211
 333-1423 OR 962-3873

| SET DATE: _____ CREW: _____ | | | | COMPLETION DATE: _____ CREW: _____ | | | | |
|---|--------|-----|---------|------------------------------------|-------|------------------------|-----------|-------|
| Description | Lineal | HT | Style | Line | Term | Gates | Gate Post | Rails |
| MONTAGE STEEL MAJESTIC WITH BALL CAPS | 116.5' | 5' | ORN. | 2" | 14@2" | 2@45" <i>Arched</i> | 4@2" | YES |
| PERMIT BADGER TO INSTALL APPROX. 3-4 WEEKS, WEATHER PERMITTING. BADGER TO OBTAIN PERMIT. GATES ARE ARCHED. ALL POSTS HAVE BALL CAPS. NEED TWO LONGER POSTS TO GO OVER RETAINING WALL. | | | | | | | | |
| All Posts in Concrete | | YES | HOTLINE | | | | | |

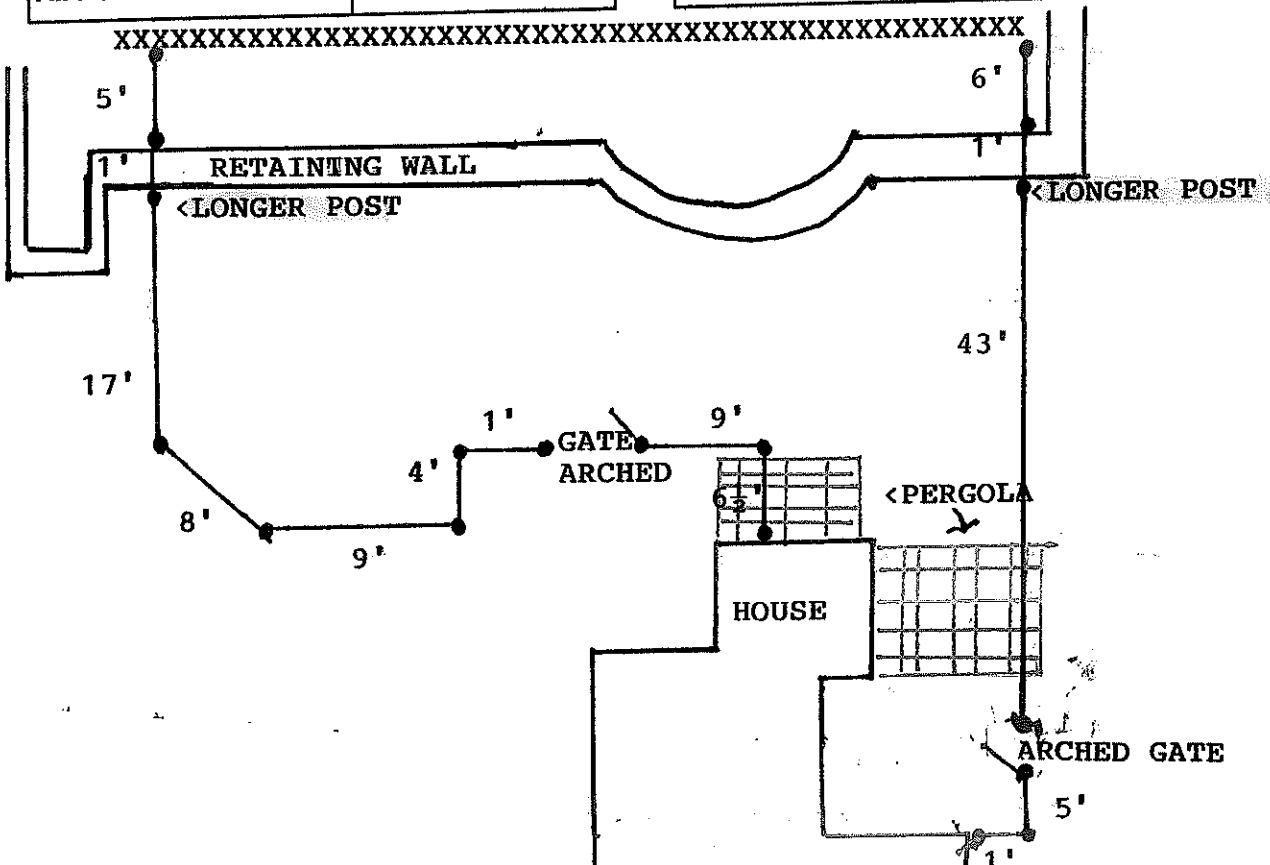





Sheryl Ellis

Legend

 2649 N Terrace Ave

9 N Terrace Ave

Google Earth

© 2018 Google

40 ft

