



CITY OF MILWAUKEE
OFFICE OF THE CITY CLERK

Monday, November 19, 2018

COMMITTEE MEETING NOTICE

AD 12

SADIQ, Usman, Agent
National Oil LLC
1831 W NATIONAL Av

Milwaukee, WI 53204

You are requested to attend a hearing which is to be held in Room 301-B, Third Floor, City Hall on:

Tuesday, December 04, 2018 at 09:00 AM

Regarding: Your Extended Hours Establishments, Food Dealer, Filling Station, and Weights & Measures License Renewal Applications as agent for "National Oil LLC" for "Citgo" at 1831 W NATIONAL Av.

There is a possibility that your application may be denied for one or more of the following reasons: The recommendation of the committee regarding the application shall be based on evidence presented at the hearing. Per MCO 85-4-4, unless otherwise specified in the code, probative evidence concerning non-renewal, suspension or revocation may include evidence of the following: failure of the applicant to meet municipal qualifications, pending charges against or the conviction of any felony, misdemeanor, municipal offense or other offense, the circumstances of which substantially relate to the circumstances of the particular licensed or permitted activity, by the applicant or by any employee or other agent of the applicant. If the activities of the applicant involve a licensed premises, whether the premises tends to facilitate a public or private nuisance or has been the source of congregations of persons which have resulted in any of the following: disturbance of the peace; illegal drug activity; public drunkenness; drinking in public; harassment of passers-by; gambling; prostitution; sale of stolen goods; public urination; theft; assaults; battery; acts of vandalism including graffiti, excessive littering, loitering, illegal parking, loud noise at times when the licensed premise is open for business; traffic violations; curfew violations; lewd conduct; display of materials harmful to minors, pursuant to s. 106-9.6; or any other factor which reasonably relates to the public health, safety and welfare, or failure to comply with the approved plan of operation. See attached police report or correspondence.

Notice for applicants with warrants or unpaid fines:

Proof of warrant satisfaction or payment of fines must be submitted at the hearing on the above date and time. Failure to comply with this requirement may result in a delay of the granting/denial of your application.

Failure to appear at this meeting may result in the denial of your license. Individual applicants must appear only in person or by an attorney. Corporate or Limited Liability applicants must appear only by the agent designated on the application or by an attorney. Partnership applicants must appear by a partner listed on the application or by an attorney. If you wish to do so and at your own expense, you may be accompanied by an attorney of your choosing to represent you at this hearing.

You will be given an opportunity to speak on behalf of the application and to respond and challenge any charges or reasons given for the denial. No petitions can be accepted by the committee, unless the people who signed the petition are present at the committee hearing and willing to testify. You may present witnesses under oath and you may also confront and cross-examine opposing witnesses under oath. If you have difficulty with the English language, you should bring an interpreter with you, at your expense, so that you can answer questions and participate in your hearing.

You may examine the application file at this office during regular business hours prior to the hearing date. Inquiries regarding this matter may be directed to the person whose signature appears below.

Limited parking for persons attending meetings in City Hall is available at reduced rates (5 hour limit) at the Milwaukee Center on the southwest corner of East Kilbourn and North Water Street. Parking tickets must be validated in the first floor information booth in City Hall.

PLEASE NOTE: Upon reasonable notice, efforts will be made to accommodate the needs of disabled individuals through sign language interpreters or other auxiliary aids. For additional information or to request this service, contact the Council Services Division ADA Coordinator at (414) 286-2998, Fax - (414) 286-3456, TDD - (414) 286-2025.

JIM OWCZARSKI, CITY CLERK

BY:

Jessica Celella
License Division Manager

If you have questions regarding this notice, please contact the License Division at (414) 286-2238.

Ceella, Jessica

From: Murillo, Maribel
Sent: Monday, November 19, 2018 10:31 AM
To: Ceella, Jessica; Byrd, Yashica
Subject: 1831 W National Ave

Good morning,

I would like to inform you that on May 23rd, 2018 Alderman Pérez received a complaint in regards to the prostitution that is taking place at 1831 W National Ave.

If you need further information please feel free to contact me.

Alderman would like to put this email on file as an objection.

Respectfully,

Maribel Murillo

Legislative Assistant to

12th District

Alderman José Pérez

Office of the City Clerk

200 E. Wells St, Room 205

414-286-2861

Maribel.Murillo@Milwaukee.gov

To report a City service related issue, you may also use Click for [Action](#) or call 414-286-CITY (2489)

MILWAUKEE POLICE DEPARTMENT LICENSING

CRIMINAL RECORD/ORDINANCE VIOLATION/INCIDENTS SYNOPSIS

DATE: 10/30/18
LICENSE TYPE: 24HR/FILLING
NEW:
RENEWAL:

No. 284524/284523
Application Date: 10/29/18

License Location: 1831 W. National Avenue
Business Name: Citgo

Licensee/Applicant: SADIQ, Usman
(Last Name, First Name, MI)

Date of Birth: 07/25/1984

Home Address: 5344 W. Behrendt Street
City: Franklin **State:** WI **Zip Code:** 53132
Home Phone: 262-271-2496

This report is written by Police Officer Corstan D. COURT, assigned to the License Investigation Unit, Days.

The Milwaukee Police Department's investigation regarding this application revealed the following:

1. On 09/25/18 a 17 year old working in conjunction with the Milwaukee Police Department and WI WINS Tobacco initiative, was able to purchase a 2 pack of Grape Swisher Sweet Cigars at 1831 W. National Avenue, The sales clerk admitted to selling the item and the station was mailed a MARTS enrollment packet.

Milwaukee Police Department

749 W. State Street Milwaukee, WI 53233

414-933-4444



Case #:182370045

OtherEvent #: 18-LP-0292

Incident

1831 W NATIONAL AV Milwaukee, WISCONSIN 53204

Incident Date/Time:: 08/25/2018 09:15:19
CAD Number:: 182370698
District:: 2
Beat:: 230
Reporting Area:: 5264

Business Agent (1)

USMAN, SADIQ

Person Involvement:: Agent
DOB:: 07/25/1984
Sex:: MALE
Race:: WHITE
Address:: 2601 EMSLIE DR
City:: WAUKESHA
State:: WISCONSIN

Licensed Persons Involved (1)

Barkat, Ali

Person Involvement:: Merchant
DOB:: 09/25/1980
Sex:: MALE
Race:: ASIAN
Phone 1 Number:: 2622717796
Address:: 5344 W Behrendt St
City:: Franklin
State:: WISCONSIN
Zip Code:: 53132

Narrative (1)

INITIAL INVESTIGATION

Brown, Penny A 014805

08/25/2018

This report is written by PO Penny MONREAL assigned to the License Investigation Unit.

On Saturday, August 25, 2018, I was assigned to work Wisconsin WINS Youth Tobacco Initiative, which checks area vendors for age compliant tobacco sales. Assisting in this assignment were: Tierra R. POLE B/F 11/8/00 5663 N. 95th St. Milwaukee 53225. POLE is 17 years old and not of legal age to purchase tobacco.

At approximately 9:10A, POLE entered Citgo, located at 1831 W. National Av., and purchased a 2 pack

Milwaukee Police Department

749 W. State Street Milwaukee, WI 53233

414-933-4444



Case #:182370045

OtherEvent #: 18-LP-0292

Grape Swisher Cigars from the cashier described as: A/M 50's wearing a plaid polo shirt, who checked her ID, but sold anyway. I entered the store and identified the cashier based on the description. The cashier/agent was identified as: Ali BARAKAT A/M 09/25/80. BARAKAT admitted to the sale and apologized, stating he was confused and distracted at the time of the sale. I explained I will be mailing out a MARTS enrollment packet.

Officer (2)

Reporting Officer:	Brown, Penny A (014805)	08/25/2018 12:58:00
Section: (Work Location):	27	
Approving Officer:	Raden, Chad M (010032)	08/28/2018 13:25:57
Section: (Work Location):	27	



Monday, November 19, 2018



Notice of Public Hearing

SADIQ, Usman, Agent
Citgo at 1831 W NATIONAL Av
Extended Hours Establishments, Food Dealer, Filling Station, and Weights & Measures License
Renewal Applications

Tuesday, December 04, 2018 at 9:00 AM

To whom it may concern:

The above application has been made by the above named applicant(s). This requires approval from the Licenses Committee and the Common Council of the City of Milwaukee. The hearing before the Licenses Committee will take place on 12/4/2018 at 9:00 AM, in Room 301-B, Third Floor, City Hall. If you wish, you may provide testimony at the hearing regarding the request; see below for further information. You are not required to attend the hearing. Once the Licenses Committee makes its recommendation, this recommendation is forwarded to the full Common Council for approval at its next regularly scheduled hearing. Please review the information below and if you have further questions regarding this process, please contact the License Division at (414) 286-2238.

Important details for those wishing to provide information for the Licenses Committee to consider when making its recommendation:

1. The license application is scheduled to be heard at the above time. Due to other hearings running longer than scheduled, you may have to wait some time to provide your testimony.
2. You must appear in person and testify as to matters that you have personally experienced or seen. (You cannot provide testimony for your neighbor, parent or anyone else; this is considered hearsay and cannot be considered by the committee.)
3. No letters or petitions can be accepted by the committee (unless the person who wrote the letter or the persons who signed the petition are present at the committee hearing and willing to testify).
4. Persons opposed to the license application are given the opportunity to testify first; supporters may testify after the opponents have finished.
5. When you are called to testify, you will be sworn in and asked to give your name, and address. (If your first and/or last names are uncommon please spell them.)
6. You may then provide testimony.
 - a. Include only information relating to the above license application.
 - b. Include only information you have personally witnessed or seen.
 - c. Provide concise and relevant information detailing how this business has affected or may affect the peaceful enjoyment of your neighborhood.
 - d. If by the time you have the opportunity to testify, the information you wish to share has already been provided to the committee, you may state that you agree with the previous testimony. Redundant or repetitive testimony will not assist the committee in making its recommendation.
7. After giving your testimony, the members of the Licenses Committee and the licensee may ask questions regarding the testimony you have given or other factors relating to the license application.
8. Business Competition is not a valid basis for denial or non-renewal of a license.
Please Note: If you have submitted an objection to the above application your objection cannot be considered by the committee unless you personally testify at the hearing.

OCCUPANT	MAIL ADDRESS	CITY, STATE ZIP
CURRENT OCCUPANT	829 S 19TH ST 1	MILWAUKEE, WI 53204
CURRENT OCCUPANT	907 S 19TH ST	MILWAUKEE, WI 53204
CURRENT OCCUPANT	908 S 19TH ST	MILWAUKEE, WI 53204
CURRENT OCCUPANT	909A S 18TH ST	MILWAUKEE, WI 53204
CURRENT OCCUPANT	911A S 18TH ST	MILWAUKEE, WI 53204
CURRENT OCCUPANT	903A S 18TH ST	MILWAUKEE, WI 53204
CURRENT OCCUPANT	827 S 18TH ST B	MILWAUKEE, WI 53204
CURRENT OCCUPANT	827 S 18TH ST D	MILWAUKEE, WI 53204
CURRENT OCCUPANT	827 S 18TH ST C	MILWAUKEE, WI 53204
CURRENT OCCUPANT	821 S 18TH ST	MILWAUKEE, WI 53204
CURRENT OCCUPANT	814 S 18TH ST	MILWAUKEE, WI 53204
CURRENT OCCUPANT	829 S 19TH ST 5	MILWAUKEE, WI 53204
CURRENT OCCUPANT	813 S 18TH ST B	MILWAUKEE, WI 53204
CURRENT OCCUPANT	808 S 18TH ST	MILWAUKEE, WI 53204
CURRENT OCCUPANT	829 S 19TH ST 6	MILWAUKEE, WI 53204
CURRENT OCCUPANT	915 S 18TH ST A	MILWAUKEE, WI 53204
CURRENT OCCUPANT	813 S 18TH ST C	MILWAUKEE, WI 53204
CURRENT OCCUPANT	820 S 18TH ST	MILWAUKEE, WI 53204
CURRENT OCCUPANT	820A S 18TH ST	MILWAUKEE, WI 53204
CURRENT OCCUPANT	822 S 20TH ST	MILWAUKEE, WI 53204
CURRENT OCCUPANT	909 S 18TH ST	MILWAUKEE, WI 53204
CURRENT OCCUPANT	904 S 19TH ST	MILWAUKEE, WI 53204
CURRENT OCCUPANT	905 S 18TH ST	MILWAUKEE, WI 53204
CURRENT OCCUPANT	835 S 18TH ST	MILWAUKEE, WI 53204
CURRENT OCCUPANT	834 S 18TH ST	MILWAUKEE, WI 53204
CURRENT OCCUPANT	816 S 18TH ST	MILWAUKEE, WI 53204
CURRENT OCCUPANT	820 S 20TH ST	MILWAUKEE, WI 53204
CURRENT OCCUPANT	828 S 20TH ST	MILWAUKEE, WI 53204
CURRENT OCCUPANT	830 S 20TH ST	MILWAUKEE, WI 53204
CURRENT OCCUPANT	829 S 19TH ST 2	MILWAUKEE, WI 53204
CURRENT OCCUPANT	829 S 19TH ST 4	MILWAUKEE, WI 53204
CURRENT OCCUPANT	915 S 18TH ST	MILWAUKEE, WI 53204
CURRENT OCCUPANT	836 S 19TH ST	MILWAUKEE, WI 53204
CURRENT OCCUPANT	833 S 18TH ST	MILWAUKEE, WI 53204
CURRENT OCCUPANT	827 S 18TH ST A	MILWAUKEE, WI 53204
CURRENT OCCUPANT	824 S 18TH ST	MILWAUKEE, WI 53204
CURRENT OCCUPANT	900 S 20TH ST	MILWAUKEE, WI 53204
CURRENT OCCUPANT	906 S 19TH ST	MILWAUKEE, WI 53204
CURRENT OCCUPANT	911 S 18TH ST	MILWAUKEE, WI 53204
CURRENT OCCUPANT	834 S 19TH ST	MILWAUKEE, WI 53204
CURRENT OCCUPANT	821 S 19TH ST	MILWAUKEE, WI 53204
CURRENT OCCUPANT	903 S 18TH ST	MILWAUKEE, WI 53204
CURRENT OCCUPANT	813 S 18TH ST A	MILWAUKEE, WI 53204
CURRENT OCCUPANT	823 S 18TH ST	MILWAUKEE, WI 53204
CURRENT OCCUPANT	818 S 20TH ST	MILWAUKEE, WI 53204
CURRENT OCCUPANT	824 S 20TH ST	MILWAUKEE, WI 53204

CURRENT OCCUPANT	829 S 19TH ST 3	MILWAUKEE, WI 53204
CURRENT OCCUPANT	907A S 19TH ST	MILWAUKEE, WI 53204
CURRENT OCCUPANT	913 S 19TH ST	MILWAUKEE, WI 53204
CURRENT OCCUPANT	912 S 19TH ST	MILWAUKEE, WI 53204
CURRENT OCCUPANT	902 S 19TH ST	MILWAUKEE, WI 53204
CURRENT OCCUPANT	822 S 19TH ST	MILWAUKEE, WI 53204
CURRENT OCCUPANT	828 S 18TH ST	MILWAUKEE, WI 53204
CURRENT OCCUPANT	813 S 18TH ST D	MILWAUKEE, WI 53204
CURRENT OCCUPANT	802 S 18TH ST	MILWAUKEE, WI 53204

Total Records: 55

Radius: 250.0 feet and Center of Circle: 1831 W National Ave



BUSINESS LICENSE RENEWAL PLAN OF OPERATION

Office of the City Clerk License Division
200 E. Wells St. Room 105, Milwaukee, WI 53202

Licenses to be Renewed	Renewal Fee(s)	
Food Dealer - FOOD 8672	\$575.00	Expiration Date: 1/16/2019 File By Date: 10/18/2018 Date Late Fee Begins: 10/19/2018 Late Fee Amount: \$75.00
Extended Hours - 24HRS 198526	\$225.00	
Filling Station - FILL 847	\$250.00	
Cigarette & Tobacco - CIG 1027180	\$100.00	
Weights & Measures - W&M 4076	\$1,020.00	
Sidewalk Dining -		
TOTAL DUE	\$2,170.00	

Legal Entity Name: **National Oil LLC**

Premises Address: **1831 W NATIONAL AV**

Changes Since Last Application?

Are there any changes in your plans to address litter, noise, and/or security? No Yes If yes, describe: _____

Are there any changes to the hours of operation (as listed on your current license)? No Yes If yes, describe: _____

Are there any changes to your current plan of operation or floor plan*? No Yes If yes, describe: _____

*If there are changes to the floor plan, a new floor plan must be submitted with this renewal application. A sample plan can be found online at www.milwaukee.gov/licenses under License Forms and Related Information.

Weights & Measures Licensees Only

Number/Type of Devices:
Retail Petroleum Meters = 17
Are there any changes to the number or types of devices? No Yes If yes, contact our office for further instructions.

Food Dealer Licensees Only

Your current food license includes the following business operations: **Processing, Hazardous Foods, Sales \$20,001 - \$200,000, Convenience - Gas Station**
Are there any changes to your plan of operation (for example, adding processing, changing sales amount or complexity, etc.)? No Yes
If yes, you must complete a "Request to Modify Food Establishment/Food Operation Plan" which can be obtained at www.milwaukee.gov/licenses under "Forms and Related Information" or by contacting our office.

All Applicants: Signature

Barbara A. [Signature]
Signature of Sole Proprietor; a Partner; or if a Corporation or LLC, the Agent must sign



CITY OF MILWAUKEE
OFFICE OF THE CITY CLERK

Tuesday, November 27, 2018

COMMITTEE MEETING NOTICE

AD 09

DIMERCURIO, Thomas J, Agent
Flyers Energy, LLC
2360 Lindbergh St

Auburn, CA 95602

You are requested to attend a hearing which is to be held in Room 301-B, Third Floor, City Hall on:

Tuesday, December 04, 2018 at 09:00 AM

Regarding: Your Extended Hours Establishments, Filling Station, and Weights & Measures License Applications
Requesting to be Open 24 Hrs as agent for "Flyers Energy, LLC" for "Quick Fuel #3134" at 9110 N 107th St.

There is a possibility that your application may be denied for one or more of the following reasons: The recommendation of the committee regarding the application shall be based on evidence presented at the hearing. Per MCO 85-2.7-4, probative evidence concerning whether or not a new license should be granted may be presented on the following subjects: whether or not the applicant meets the municipal requirements, the appropriateness of the location and premises where the licensed premises is to be located and whether use of the premises for the purposes or activities permitted by the license would tend to facilitate a public or private nuisance or create undesirable neighborhood problems such as disorderly patrons, unreasonably loud noise, litter, and excessive traffic and parking congestion. Probative evidence relating to these matters may be taken from the plan of operation submitted with the license application, if any, but shall not include the content of any music. Evidence regarding the fitness of the location of the premises to be maintained as the principal place of business, including but not limited to whether there is an overconcentration of businesses of the type for which the license is sought; whether the proposal is consistent with any pertinent neighborhood business or development plans, or the location's proximity to areas where children are typically present. The applicant's record in operating similarly licensed premises; and whether or not the applicant has been charged with or convicted of any felony, misdemeanor, municipal offense or other offense, the circumstances of which substantially relate to the activity to be permitted by the license being applied for or any other factor which reasonably relates to the public health, safety or welfare may also be considered.

Notice for applicants with warrants or unpaid fines: Proof of warrant satisfaction or payment of fines must be submitted at the hearing on the above date and time. Failure to comply with this requirement may result in a delay of the granting/denial of your application.

Failure to appear at this meeting may result in the denial of your license. Individual applicants must appear only in person or by an attorney. Corporate or Limited Liability applicants must appear only by the agent designated on the application or by an attorney. Partnership applicants must appear by a partner listed on the application or by an attorney. If you wish to do so and at your own expense, you may be accompanied by an attorney of your choosing to represent you at this hearing.

You will be given an opportunity to speak on behalf of the application and to respond and challenge any charges or reasons given for the denial. No petitions can be accepted by the committee, unless the people who signed the petition are present at the committee hearing and willing to testify. You may present witnesses under oath and you may also confront and cross-examine opposing witnesses under oath. If you have difficulty with the English language, you should bring an interpreter with you, at your expense, so that you can answer questions and participate in your hearing.

You may examine the application file at this office during regular business hours prior to the hearing date. Inquiries regarding this matter may be directed to the person whose signature appears below.

Limited parking for persons attending meetings in City Hall is available at reduced rates (5 hour limit) at the Milwaukee Center on the southwest corner of East Kilbourn and North Water Street. Parking tickets must be validated in the first floor information booth in City Hall.

PLEASE NOTE: Upon reasonable notice, efforts will be made to accommodate the needs of disabled individuals through sign language interpreters or other auxiliary aids. For additional information or to request this service, contact the Council Services Division ADA Coordinator at (414) 286-2998, Fax - (414) 286-3456, TDD - (414) 286-2025.

JIM OWCZARSKI, CITY CLERK

BY: _____
Jessica Celella

License Division Manager

If you have questions regarding this notice, please contact the License Division at (414) 286-2238.

200 E. Wells Street, Room 105, City Hall, Milwaukee, WI 53202. www.milwaukee.gov/license
Phone: (414) 286-2238 Fax: (414) 286-3057 Email Address: License@milwaukee.gov



CITY OF MILWAUKEE
OFFICE OF THE CITY CLERK

Tuesday, November 27, 2018

COMMITTEE MEETING NOTICE

AD 09

DIMERCURIO, Thomas J, Agent
Flyers Energy, LLC
2201 Ursula way

Roseville, CA 95661

You are requested to attend a hearing which is to be held in Room 301-B, Third Floor, City Hall on:

Tuesday, December 04, 2018 at 09:00 AM

Regarding: Your Extended Hours Establishments, Filling Station, and Weights & Measures License Applications
Requesting to be Open 24 Hrs as agent for "Flyers Energy, LLC" for "Quick Fuel #3134" at 9110 N 107th St.

There is a possibility that your application may be denied for one or more of the following reasons: The recommendation of the committee regarding the application shall be based on evidence presented at the hearing. Per MCO 85-2.7-4, probative evidence concerning whether or not a new license should be granted may be presented on the following subjects: whether or not the applicant meets the municipal requirements, the appropriateness of the location and premises where the licensed premises is to be located and whether use of the premises for the purposes or activities permitted by the license would tend to facilitate a public or private nuisance or create undesirable neighborhood problems such as disorderly patrons, unreasonably loud noise, litter, and excessive traffic and parking congestion. Probative evidence relating to these matters may be taken from the plan of operation submitted with the license application, if any, but shall not include the content of any music. Evidence regarding the fitness of the location of the premises to be maintained as the principal place of business, including but not limited to whether there is an overconcentration of businesses of the type for which the license is sought; whether the proposal is consistent with any pertinent neighborhood business or development plans, or the location's proximity to areas where children are typically present. The applicant's record in operating similarly licensed premises; and whether or not the applicant has been charged with or convicted of any felony, misdemeanor, municipal offense or other offense, the circumstances of which substantially relate to the activity to be permitted by the license being applied for or any other factor which reasonably relates to the public health, safety or welfare may also be considered.

Notice for applicants with warrants or unpaid fines: Proof of warrant satisfaction or payment of fines must be submitted at the hearing on the above date and time. Failure to comply with this requirement may result in a delay of the granting/denial of your application.

Failure to appear at this meeting may result in the denial of your license. Individual applicants must appear only in person or by an attorney. Corporate or Limited Liability applicants must appear only by the agent designated on the application or by an attorney. Partnership applicants must appear by a partner listed on the application or by an attorney. If you wish to do so and at your own expense, you may be accompanied by an attorney of your choosing to represent you at this hearing.

You will be given an opportunity to speak on behalf of the application and to respond and challenge any charges or reasons given for the denial. No petitions can be accepted by the committee, unless the people who signed the petition are present at the committee hearing and willing to testify. You may present witnesses under oath and you may also confront and cross-examine opposing witnesses under oath. If you have difficulty with the English language, you should bring an interpreter with you, at your expense, so that you can answer questions and participate in your hearing.

You may examine the application file at this office during regular business hours prior to the hearing date. Inquiries regarding this matter may be directed to the person whose signature appears below.

Limited parking for persons attending meetings in City Hall is available at reduced rates (5 hour limit) at the Milwaukee Center on the southwest corner of East Kilbourn and North Water Street. Parking tickets must be validated in the first floor information booth in City Hall.

PLEASE NOTE: Upon reasonable notice, efforts will be made to accommodate the needs of disabled individuals through sign language interpreters or other auxiliary aids. For additional information or to request this service, contact the Council Services Division ADA Coordinator at (414) 286-2998, Fax - (414) 286-3456, TDD - (414) 286-2025.

JIM OWCZARSKI, CITY CLERK

BY: _____

Jessica Celella

License Division Manager

If you have questions regarding this notice, please contact the License Division at (414) 286-2238.

200 E. Wells Street, Room 105, City Hall, Milwaukee, WI 53202. www.milwaukee.gov/license
Phone: (414) 286-2238 Fax: (414) 286-3057 Email Address: License@milwaukee.gov



BUSINESS LICENSE PLAN OF OPERATION

cci-busplan 3/15/18

Office of the City Clerk License Division
200 E. Wells St. Room 105, Milwaukee, WI 53202
(414) 286-2238 www.milwaukee.gov/license e-mail address: license@milwaukee.gov

1. Type of Business

Applying for: Extended Hours (12AM to 5AM) - If a food establishment, check all that apply: Delivery Drive Thru Dining Room
 Self Service Laundry Massage Establishment Filling Station
 Other (supplemental application for specific license also required)

Provide a detailed description of the type of business you plan on operating:
Unmanned filling station (24 hour operation)

Do you have any experience operating this type of business? No Yes If yes, explain: Flyers Energy LLC has multiple cardlock locations in CA and NV.

2. Business Operations

- a. Proposed Opening Date: 6/21/2018
- b. Is this premise under construction? No Yes If yes, list estimated completion date: _____
- c. Is this a franchise? No Yes
- d. Is this premises currently licensed? No Yes If yes, list type of license: _____
- e. Is the current licensee operating? No Yes If no, list date closed: _____
- f. Do you have future plans for other businesses, licenses or permits at this location? No Yes
If yes, explain: _____
- g. Have you previously held an Extended Hours License in Milwaukee? No Yes
If yes, list address(es): 1010 Boden Ct, 5008 N 119th St, 9110 N 170th St
- h. Are other businesses operating in the same building? No Yes If yes, describe: _____

3. Litter & Noise

- a. How are grounds kept clean? Sweep Pressure Wash Pick Up Litter Other: _____
- b. How often will grounds be cleaned? Daily Weekly As Needed Monthly Other: _____
- c. Grounds cleaned by: Licensee Building Owner Employees Hired Maintenance Other: _____
- d. How are noise issues prevented and/or addressed? Security Manager approaches customer(s) Call Police
 Signs Posted Other: or technician/employee on site
- e. Will a sound amplification system be used? No Yes If yes, describe: _____

4. Smoking & Sanitation

- a. Are there designated outdoor smoking areas? No Yes If yes, describe: _____
- b. Number of Garbage Cans: Inside: NA Locations: _____
Outside: 5 Locations: Dispensing Islands
- c. Is a crowd control barrier used? No Yes If yes, describe: _____
- d. How many restrooms are on the premises? 0
- e. Name of solid waste contractor: Advanced Disposal Waste Management Other: _____

5. Security

a. Are there onsite parking spaces? No Yes If yes, how many? _____ and describe the parking security plan: _____

b. Is there a loading zone? No Yes If yes, describe the loading area security plan: _____

c. Will you have security personnel on premise? No Yes If yes, how many? _____ and answer the following:

What are their responsibilities? _____

Is security equipment used? No Yes If yes, describe _____

List their licensing, certification, or training credentials _____

d. Will there be security cameras? No Yes If yes, how many? 5 and list locations: Island Canopy Posts

e. Will searches/identification checks be done upon entry? No Yes If yes, describe _____

6. Percentage of Sales (must total 100%)

Alcohol _____%	Food _____%	Secondhand Merchandise _____%	Precious Metals & Gems _____%
Entertainment _____%	Cigarettes _____%		
Pawnbroker Activity _____%	Salvaged Materials _____% (such as scrap metal)	Personal Services (such as tattoo, body piercing, salon, tailor, tanning, etc.) _____%	Other <u>100</u> % Describe: <u>Fuel</u>

7. Businesses/Licenses on the Premises (check all that apply):

Type 1

- | | | | |
|---|---|---|--|
| <input type="checkbox"/> Full Service Restaurant | <input type="checkbox"/> Cafe/Coffee Shop | <input type="checkbox"/> Deli or Fast Food Restaurant | <input type="checkbox"/> Private/Fraternal/Veterans Club |
| <input type="checkbox"/> Night Club | <input type="checkbox"/> Tavern | <input type="checkbox"/> Cocktail Lounge | <input type="checkbox"/> Teen Club |
| <input type="checkbox"/> Banquet Hall | <input type="checkbox"/> Sports Facility | <input type="checkbox"/> Bowling Alley | |
| <input type="checkbox"/> Hotel/Motel: Number of Floors: _____
Number of Rooms: _____ | <input type="checkbox"/> Rooming House: Number of Floors: _____
Number of Rooms: _____ | | |

Type 2

- | | | | |
|---|--|---|--|
| <input type="checkbox"/> Liquor Store | <input type="checkbox"/> Corner Store | <input type="checkbox"/> Supermarket | <input type="checkbox"/> Convenience Store |
| <input checked="" type="checkbox"/> Gas Station | <input type="checkbox"/> Amusement/Phonograph Distributor | <input type="checkbox"/> Recycling, Salvage or Towing | |
| <input type="checkbox"/> Used Car Dealer | <input type="checkbox"/> Personal Service Establishment
(such as tattoo business, hair salon, tailor, etc.) | <input type="checkbox"/> Recording Studio | |

What other licenses/permits will you hold at this location? (check all that apply)

- Occupancy Permit Cigarette & Tobacco Gas Station Extended Hours Class "B" Tavern Weights & Measures
 Secondhand Dealer Precious Metal & Gem Other: _____

8. Legal Capacity (only if a Type 1 premises in #7 above)

Capacity _____ (Call the Milwaukee Development Center at 414-286-8211 if you have questions.)

9. Premises Description

- a. Identify all area(s) of the premises that will be used in operating this business (include areas used only for storage):
 1st Floor 2nd Floor Basement Storage Patio Beer Garden Sidewalk Café Deck Rooftop
 Other: Describe: Unmanned Fueling Station
- b. Describe Location: Major Thoroughfare Secondary Street Other: _____
- c. Nearest Major Cross Street: W. Brown Deer Rd
- d. Describe Building: Free Standing Building Strip Mall Other: _____
- e. Describe Premises Structure: Single Story Multi-Story - # of Stories _____ Other: _____
- f. Describe Surrounding Area: Commercial Residential Industrial Other: _____
- g. Building Owner Name: Jacobus Energy Inc Phone Number: 800-522-6287
 Business Owner Address: 11815 W Bradley Rd Milwaukee, WI 53224

10. Hours of Operation & Customers

Will customers be entering the premises? No Yes

Day of the Week	Proposed Hours of Operation:		Estimated Number of Customers expected each day	Potential Age Range of Customers	Class B Tavern Applicant Only: Age Restriction (If none, write 'None')
	Open Time (include a.m. or p.m.)	Close Time (include a.m. or p.m.)			
Sunday	24 hours				
Monday	24 hours				
Tuesday	24 hours				
Wednesday	24 hours				
Thursday	24 hours				
Friday	24 hours				
Saturday	24 hours				

An Extended Hours Establishment License is required for any convenience store, filling station, personal service establishment (such as tattoo, body piercing, salon, tailor, tanning, etc.), recording studio or restaurant which is open between the hours of 12:00 a.m. and 5:00 a.m.

Alcohol Establishments Class A: 8:00 am to 9:00 pm Sunday thru Saturday
 Permitted Hours of Operation: Class B: 6:00 am to 2:00 am Sunday thru Thursday, 6:00 am to 2:30 am Friday & Saturday

Entertainment Outdoor Closing Hours: 10:00pm Sunday-Thursday; 12:00am Friday & Saturday; unless a different time, either earlier or later, is established by the Common Council in its approval of the licensee's plan of operation.

11. Signature(s)

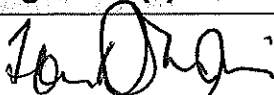
 Tom DiMercurio CFO
 Signature of Sole Proprietor, Partner, or 20% or more Shareholder
 (If there are no 20% or more shareholders, Corporate Officer-print name/title and sign)

 Signature of additional partner or 20% or more shareholder

See Application Information for a complete list of all required application forms.



**FILLING STATION LICENSE AND
WEIGHTS & MEASURES (RETAIL PETROLEUM METERS)
LICENSE SUPPLEMENTAL APPLICATION**

OFFICE OF THE CITY CLERK, LICENSE DIVISION
CITY HALL, 200 E. WELLS ST, ROOM 105, MILWAUKEE, WI 53202
(414) 286-2238 • license@milwaukee.gov • www.milwaukee.gov/license

Legal Entity Name: Flyers Energy LLC DBA Quick Fuel

Premise Address: Quick Fuel #3134 9110 N 107th St Milwaukee, WI 53224

Filling Station License Fee \$ 275

Weights & Measures License Fee
Number of Retail Petroleum Meters* 10 x \$60 per meter = \$ 600.00

*For each nozzle, count the number of grades (not including midgrade if mixed in the pump), add the number of all grades together and that is your number of retail petroleum meters.

Will electronic scanners be used to determine/record the price of items? No Yes
Will scales be used to price items based on their weight? No Yes
If yes to either or both questions, a separate Weights & Measures License Application must be submitted for these devices.

Acknowledgements and Signature

I confirm that all information is true and correct. I understand any changes to the information in this application must be reported to the City Clerk License Division within 10 days. I have knowledge of the City of Milwaukee ordinances currently regulating the licenses applied for and understand that the licenses may be subject to suspension, non-renewal, or revocation if I violate these regulations.

 Tom DiMercurio CFO
Signature of Sole Proprietor, Partner, or 20% or more Shareholder
(If no 20% or more Shareholder, Corporate Officer must sign and provide title)

Signature of Additional Partner or 20% or more Shareholder

Submit this form with the following:

- Business License Application
- Business Plan of Operation
- Floor plan
- License fees

Forms can be obtained online at www.milwaukee.gov/licenses

Office Use Only:

App# _____	Filed _____	Initials _____
Paid _____	MPD _____	CC _____
HD _____	DNS _____	Lic # _____



WEIGHTS & MEASURES LICENSE SUPPLEMENTAL APPLICATION

OFFICE OF THE CITY CLERK, LICENSE DIVISION
CITY HALL, 200 E. WELLS ST, ROOM 105, MILWAUKEE, WI 53202
(414) 286-2238 • license@milwaukee.gov • www.milwaukee.gov/license

Office Use Only:

App# _____
Filed _____
Initials _____
Paid _____
Lic # _____

Legal Entity Name: Flyers Energy LLC DBA Quick Fuel

Premise Address: Quick Fuel #3134 9110 N 107th St Milwaukee WI 53224

Device Type(s)

- Check all device types for which you need a license.
 - For each device type checked, indicate how many you have in the Number of Devices column (b).
 - Calculate the Total Fee Per Device Type by multiplying the Fee Per Device Type (a) by the Number of Devices (b).
 - Add all Total Fee Per Device Type amounts together and that will be your Total Fee Due.
- * **Exception:** The Scanner fee is not per device. Check the box for the appropriate range.
If you have 1-3 scanners, the total due is \$130. If you have 4 or more scanners, the total due is \$250.
Check the Number of Devices (b).

Device Type	License Period	Fee Per Device Type (a)	Number of Devices (b)	Total Fee Per Device Type (a x b)
Liquid Measuring Devices				
<input checked="" type="checkbox"/> Retail Petroleum Meters	12 months	\$60	10	\$600.00
<input type="checkbox"/> 0 to 30 gallons per minute	24 months	\$60		
<input type="checkbox"/> 31 to 200 gallons per minute	24 months	\$250		
<input type="checkbox"/> Over 200 gallons per minute	24 months	\$250		
Scales				
<input type="checkbox"/> 0 to 300 pounds	24 months	\$55		
<input type="checkbox"/> 301 to 5,000 pounds	24 months	\$190		
<input type="checkbox"/> 5,001 to 40,000 pounds	24 months	\$300		
<input type="checkbox"/> Over 40,000 pounds	24 months	\$400		
Scanners				
		Fee for scanners is by range	Check how many scanners you have	
<input type="checkbox"/> Up to 3 scanners	24 months	\$130 total*	<input type="checkbox"/> 1 <input type="checkbox"/> 2 <input type="checkbox"/> 3	
<input type="checkbox"/> Four or more scanners	24 months	\$250 total*	<input type="checkbox"/> 4 <input type="checkbox"/> Other _____	
Other Devices				
<input type="checkbox"/> Length Measuring Device	24 months	\$60		
<input type="checkbox"/> Timing Device	24 months	\$30		

Total Fee Due 600 -

Signature

I hereby agree that I will comply with the applicable sections of the Wisconsin State Statutes, Administrative Code and the Milwaukee Code of Ordinances regarding the operation of weighing and measuring devices.

I understand that all devices must be operated within the specifications, tolerances and other technical requirements set forth in the National Institute of Standards and Technology Handbook 44. I understand that the license for which I am applying must be posted on the premises or in my vehicle prior to opening for business or operating the device.

I understand that these device licenses are not transferable (with the exception of scanners). If the device is replaced or needs to be resealed, I must apply for and receive a new license so that an inspection of the device can be performed prior to its use.

I acknowledge that as a condition of being issued this license, I must allow the Health Department into the establishment to test the device to validate its specifications/tolerances. If my devices are found out of compliance, I may be charged inspection fees.

I have read, understand, and will adhere to all the above acknowledgments.

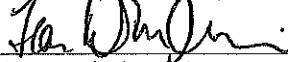
 Tom DiMercurio CFO
Signature of Sole Proprietor, Partner, or 20% or more Shareholder
(If there are no 20% or more shareholders, Corporate Officer-print name/title and sign)

Signature of additional partner or 20% or more shareholder

This form must be submitted with the Business License Application, Weights & Measures Plan of Operation, and appropriate fee. Forms can be obtained online at www.milwaukee.gov/licenses.



WEIGHTS & MEASURES PLAN OF OPERATION

ccl-wmpln 1/9/18

Office of the City Clerk License Division
200 E. Wells St. Room 105, Milwaukee, WI 53202
(414) 286-2238 www.milwaukee.gov/license license@milwaukee.gov

Legal Entity Name: Flyers Energy LLC DBA Quick Fuel	
Premise Address: Quick Fuel #3134 9110 N 107th St Milwaukee, WI 53224	
Type of Business	
Provide a brief description of the establishment/business: Unmanned fueling station.	
<i>Other licenses may be required depending on the type of business you are operating.</i>	
Litter & Noise	
a. How are grounds kept clean? <input checked="" type="checkbox"/> Sweep <input type="checkbox"/> Pressure Wash <input checked="" type="checkbox"/> Pick Up Litter <input type="checkbox"/> Other: _____ b. How often will grounds be cleaned? <input type="checkbox"/> Daily <input type="checkbox"/> Weekly <input checked="" type="checkbox"/> As Needed <input type="checkbox"/> Monthly <input type="checkbox"/> Other: _____ c. Grounds cleaned by: <input type="checkbox"/> Licensee <input type="checkbox"/> Building Owner <input checked="" type="checkbox"/> Employees <input type="checkbox"/> Hired Maintenance <input type="checkbox"/> Other: _____ d. How are noise issues prevented and/or addressed? <input type="checkbox"/> Security <input checked="" type="checkbox"/> Manager approaches customer(s) <input type="checkbox"/> Call Police <input type="checkbox"/> Signs Posted <input checked="" type="checkbox"/> Other: _____ or technician/employee on site	
Signature	
 _____ Signature of Sole Proprietor, Partner, or 20% or more Shareholder (If there are no 20% or more shareholders, Corporate Officer-print name/title and sign)	_____ Signature of additional partner or 20% or more shareholder
<p><i>This form must be submitted with the Business License Application, Weights & Measures License Supplemental Application, and appropriate fee. Forms can be obtained online at www.milwaukee.gov/licenses.</i></p>	

NORTH 107TH STREET

RISSELL ANDERSON'S INTERMEDIATION
 EMERGENCY STOP SWITCHES
 1 ON POST BY PAY PHONE
 1 ON NORTH SIDE OF ISLAND
 NORTH OF ISLAND CROSS STREET BREAKER INSIDE BUILDING
 PUSH TO STOP

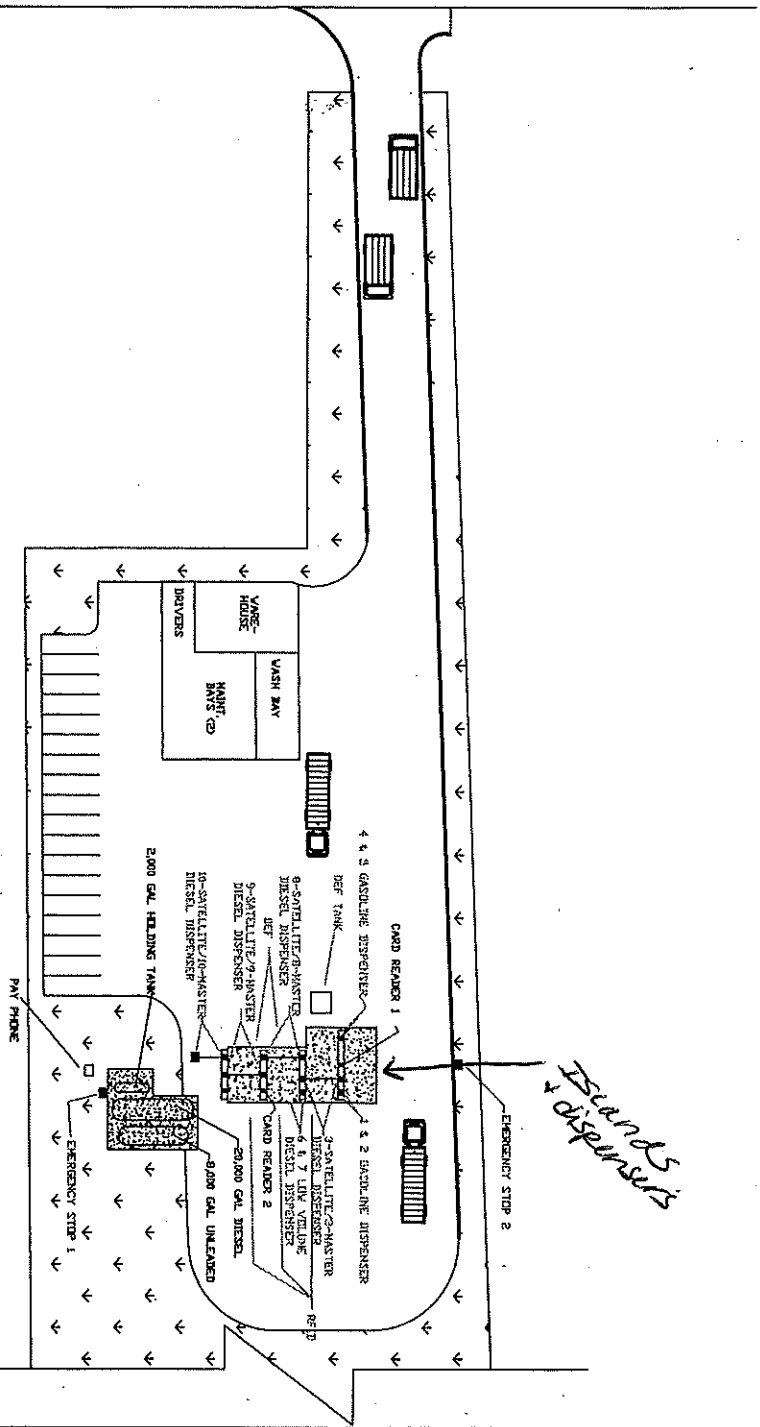

QUICK FUEL
 Fleet Services

PROJECT NAME: 9110 N. 107TH STREET MIL WAUKEE, WI 53224	REVISION NUMBER:
DRAWN BY: H. FARAKAS	DATE: 4/16/03
SCALE: NTS	

#3189



CITY OF MILWAUKEE
OFFICE OF THE CITY CLERK

Monday, November 19, 2018

COMMITTEE MEETING NOTICE

AD 09

LAMPLEY, Marrion, Agent
Aggressive Remarketing, LLC
4116 N 51st Bl

Milwaukee, WI 53216

You are requested to attend a hearing which is to be held in Room 301-B, Third Floor, City Hall on:

Tuesday, December 04, 2018 at 09:00 AM

Regarding: Your Secondhand Motor Vehicle Dealer's - Wholesale Only License Application as agent for "Aggressive Remarketing, LLC" for "Aggressive Remarketing, LLC" at 9310 N 107TH St #A104.

There is a possibility that your application may be denied for one or more of the following reasons: Neighborhood Objections to the granting of such a license due to the creation of undesirable neighborhood problems, such as: parking and traffic problems which cause the normal flow of traffic on roadways and alleys to be impeded, loitering, littering, noise, loud music, and conduct which will have an adverse impact on the public health, safety and welfare of the community. Additionally, the over concentration of secondhand motor vehicle dealers in the neighborhood such that the concentration will have an adverse impact on the public health, safety and welfare of the neighborhood. you do not meet the statutory and municipal requirements; the appropriateness of the location to be licensed and whether the location will create undesirable neighborhood problems, whether or not you have been charged with or convicted of any felony, misdemeanor, municipal offense or other offense, the circumstances of which substantially relate to the licensed activity; and any other factors which reasonably relate to the public health, safety and welfare. See attached police report and/or written correspondence regarding this application. Please be advised the public will be able to provide information to the committee in person or in writing. The committee will receive and consider evidence regarding the above mentioned criteria.

Notice for applicants with warrants or unpaid fines:

Proof of warrant satisfaction or payment of fines must be submitted at the hearing on the above date and time. Failure to comply with this requirement may result in a delay of the granting/denial of your application.

Failure to appear at this meeting may result in the denial of your license. Individual applicants must appear only in person or by an attorney. Corporate or Limited Liability applicants must appear only by the agent designated on the application or by an attorney. Partnership applicants must appear by a partner listed on the application or by an attorney. If you wish to do so and at your own expense, you may be accompanied by an attorney of your choosing to represent you at this hearing.

You will be given an opportunity to speak on behalf of the application and to respond and challenge any charges or reasons given for the denial. No petitions can be accepted by the committee, unless the people who signed the petition are present at the committee hearing and willing to testify. You may present witnesses under oath and you may also confront and cross-examine opposing witnesses under oath. If you have difficulty with the English language, you should bring an interpreter with you, at your expense, so that you can answer questions and participate in your hearing.

You may examine the application file at this office during regular business hours prior to the hearing date. Inquiries regarding this matter may be directed to the person whose signature appears below.

Limited parking for persons attending meetings in City Hall is available at reduced rates (5 hour limit) at the Milwaukee Center on the southwest corner of East Kilbourn and North Water Street. Parking tickets must be validated in the first floor information booth in City Hall.

PLEASE NOTE: Upon reasonable notice, efforts will be made to accommodate the needs of disabled individuals through sign language interpreters or other auxiliary aids. For additional information or to request this service, contact the Council Services Division ADA Coordinator at (414) 286-2998, Fax - (414) 286-3456, TDD - (414) 286-2025.

JIM OWCZARSKI, CITY CLERK

BY:

Jessica Celella
License Division Manager

If you have questions regarding this notice, please contact the License Division at (414) 286-2238.

MILWAUKEE POLICE DEPARTMENT
LICENSING

CRIMINAL RECORD/ORDINANCE VIOLATION/INCIDENTS
SYNOPSIS

DATE: 10/30/2018

LICENSE TYPE: USED CAR

NEW:

RENEWAL:

No. 284395

Application Date: 10/29/2018

License Location: 9310 N 107th St #A104

Business Name: Aggressive Remarketing, LLC

Licensee/Applicant: LAMPLEY, Marrion R.
(Last Name, First Name, MI)

Date of Birth: 08/19/1981

Home Address: 4116 N 51st St

City: Milwaukee

State: WI Zip Code: 53216

Home Phone:

This report is written by Police Officer David Novak, assigned to the License Investigation Unit, Days.

The Milwaukee Police Department's investigation regarding this application revealed the following:

1. On 04/30/2011 the applicant was cited for Operating While Intoxicated. He was convicted on 04/19/2012 and his license was revoked for 6 months.



BUSINESS LICENSE PLAN OF OPERATION

ccl-busplan 3/15/18

Office of the City Clerk License Division
200 E. Wells St. Room 105, Milwaukee, WI 53202
(414) 286-2238 www.milwaukee.gov/license e-mail address: license@milwaukee.gov

1. Type of Business

Applying for: Extended Hours (12AM to 5AM) - If a food establishment, check all that apply: Delivery Drive Thru Dining Room
 Self Service Laundry Massage Establishment Filling Station
 Other (supplemental application for specific license also required)

Provide a detailed description of the type of business you plan on operating:
Second Hand Car dealership "Wholesale"

Do you have any experience operating this type of business? No Yes If yes, explain:

2. Business Operations

- a. Proposed Opening Date: 12-1-2018
- b. Is this premise under construction? No Yes If yes, list estimated completion date: _____
- c. Is this a franchise? No Yes
- d. Is this premises currently licensed? No Yes If yes, list type of license: other Dealers in the Building
- e. Is the current licensee operating? No Yes If no, list date closed: _____
- f. Do you have future plans for other businesses, licenses or permits at this location? No Yes
If yes, explain: _____
- g. Have you previously held an Extended Hours License in Milwaukee? No Yes
If yes, list address(es): _____
- h. Are other businesses operating in the same building? No Yes If yes, describe: Two other Wholesale dealers.

3. Litter & Noise

- a. How are grounds kept clean? Sweep Pressure Wash Pick Up Litter Other: _____
- b. How often will grounds be cleaned? Daily Weekly As Needed Monthly Other: _____
- c. Grounds cleaned by: Licensee Building Owner Employees Hired Maintenance Other: _____
- d. How are noise issues prevented and/or addressed? Security Manager approaches customer(s) Call Police
 Signs Posted Other: _____
- e. Will a sound amplification system be used? No Yes If yes, describe: _____

4. Smoking & Sanitation

- a. Are there designated outdoor smoking areas? No Yes If yes, describe: _____
- b. Number of Garbage Cans: Inside: Various Locations: offices, Rest Rooms, Kitchen
Outside: 1 Locations: Rear
- c. Is a crowd control barrier used? No Yes If yes, describe: _____
- d. How many restrooms are on the premises? 2
- e. Name of solid waste contractor: Advanced Disposal Waste Management Other: _____

5. Security

- a. Are there onsite parking spaces? No Yes If yes, how many? 24 and describe the parking security plan: NOT SURE OF THE PLAN
- b. Is there a loading zone? No Yes If yes, describe the loading area security plan: _____
- c. Will you have security personnel on premise? No Yes If yes, how many? _____ and answer the following:
 What are their responsibilities? _____
 Is security equipment used? No Yes If yes, describe _____
 List their licensing, certification, or training credentials _____
- d. Will there be security cameras? No Yes If yes, how many? _____ and list locations: outside
Multiple
- e. Will searches/identification checks be done upon entry? No Yes If yes, describe _____

6. Percentage of Sales (must total 100%)

Alcohol _____%	Food _____%	Secondhand Merchandise _____%	Precious Metals & Gems _____%
Entertainment _____%	Cigarettes _____%		
Pawnbroker Activity _____%	Salvaged Materials _____% (such as scrap metal)	Personal Services (such as tattoo, body piercing, salon, tailor, tanning, etc.) _____%	Other <u>100</u> % Describe: <u>CQR</u>

7. Businesses/Licenses on the Premises (check all that apply):

Type 1

- Full Service Restaurant Cafe/Coffee Shop Deli or Fast Food Restaurant Private/Fraternal/Veterans Club
- Night Club Tavern Cocktail Lounge Teen Club
- Banquet Hall Sports Facility Bowling Alley
- Hotel/Motel: Number of Floors: 1 Rooming House: Number of Floors: _____
 Number of Rooms: _____ Number of Rooms: _____

Type 2

- Liquor Store Corner Store Supermarket Convenience Store
- Gas Station Amusement/Phonograph Distributor Recycling, Salvage or Towing
- Used Car Dealer Personal Service Establishment
 (such as tattoo business, hair salon, tailor, etc.) Recording Studio

What other licenses/permits will you hold at this location? (check all that apply)

- Occupancy Permit Cigarette & Tobacco Gas Station Extended Hours Class "B" Tavern Weights & Measures
- Secondhand Dealer Precious Metal & Gem Other: _____

8. Legal Capacity (only if a Type 1 premises in #7 above)

Capacity _____ (Call the Milwaukee Development Center at 414-286-8211 if you have questions.)

9. Premises Description

a. Identify all area(s) of the premises that will be used in operating this business (include areas used only for storage):

1st Floor 2nd Floor Basement Storage Patio Beer Garden Sidewalk Café Deck Rooftop

Other: Describe: _____

b. Describe Location: Major Thoroughfare Secondary Street Other: Main street industrial Building and Basement

c. Nearest Major Cross Street: 187th Brown Deer

d. Describe Building: Free Standing Building Strip Mall Other: _____

e. Describe Premises Structure: Single Story Multi-Story - # of Stories _____ Other: _____

f. Describe Surrounding Area: Commercial Residential Industrial Other: _____

g. Building Owner Name: Wayne Staats Phone Number: 414 305-9130

Business Owner Address: 9310 N 107th

10. Hours of Operation & Customers

Will customers be entering the premises? No Yes

Day of the Week	Proposed Hours of Operation:		Estimated Number of Customers expected each day	Potential Age Range of Customers	Class B Tavern Applicant Only: Age Restriction (If none, write 'None')
	Open Time (include a.m. or p.m.)	Close Time (include a.m. or p.m.)			
Sunday	closed	closed	↓		
Monday	2 PM	6 PM			
Tuesday	closed	closed			
Wednesday	closed	closed			
Thursday	2 PM	6 PM			
Friday	2 PM	6 PM			
Saturday	closed	closed			

An Extended Hours Establishment License is required for any convenience store, filling station, personal service establishment (such as tattoo, body piercing, salon, tailor, tanning, etc.), recording studio or restaurant which is open between the hours of 12:00 a.m. and 5:00 a.m.

Alcohol Establishments Permitted Hours of Operation: Class A: 8:00 am to 9:00 pm Sunday thru Saturday
Class B: 6:00 am to 2:00 am Sunday thru Thursday, 6:00 am to 2:30 am Friday & Saturday

Entertainment Outdoor Closing Hours: 10:00pm Sunday-Thursday; 12:00am Friday & Saturday; unless a different time, either earlier or later, is established by the Common Council in its approval of the licensee's plan of operation.

11. Signature(s)

[Signature]
Signature of Sole Proprietor, Partner, or 20% or more Shareholder

(If there are no 20% or more shareholders, Corporate Officer-print name/title and sign)

Signature of additional partner or 20% or more shareholder

See Application Information for a complete list of all required application forms.



**SECONDHAND MOTOR VEHICLE DEALER LICENSE
SUPPLEMENTAL PLAN OF OPERATION**

Office of the City Clerk License Division
200 E. Wells St. Room 105, Milwaukee, WI 53202
(414) 286-2238 e-mail address: license@milwaukee.gov

Legal Entity Name: Aggressive Remarketing LLC
 Premise Address: (cannot be a home) 9310 N 107th ~~St~~ 53224 # A-104
 What type of license are you applying for? (check one) Retail Wholesale
 In addition to secondhand vehicles, will you be dealing in secondhand vehicle parts? Yes No

RETAIL DEALERS ONLY

Total Number of Parking Spaces (including customer/employee parking) 6
 Number of Parking Spaces that will be used for Display/Storage of Secondhand Motor Vehicles 4

STORAGE, MAINTENANCE & REPAIR

1. Do you understand that all vehicles associated with the business must be stored on the licensed premise? Yes No
 What are your plans to ensure this requirement is met (check all that apply)?
 Employee Training Supervisor Monitoring Fenced Lot Keys Kept in Locked Box
 Other: _____

2. Do you understand all maintenance/repair work to these vehicles must be confined to the licensed premise? Yes No
 What are your plans to ensure this requirement is met (check all that apply)?
 Employee Training Supervisor Monitoring Designated Repair Area
 Other: Repairs By Escase Mechanic

3. Do you understand all keys to used motor vehicles offered for sale must be kept in a secure lockbox inside the dealership building at all times when the dealership is not open for business? Yes No
 What are your plans to ensure this requirement is met (check all that apply)?
 Employee Training Supervisor Monitoring Other: _____

DISCLOSURE

Has any person on the application ever had a license relating to the activities licensed in Milwaukee Code of Ordinances Chapter 92 denied, not renewed, suspended, or revoked? No Yes
 If yes, provide the circumstances and jurisdiction in which the event occurred (including a record of any actions from the State Department of Transportation and Financial Institutions relating to suspensions, revocations, forfeitures and warnings imposed by these departments relating to the operation of any automotive sales business by the applicant):

REQUIRED SIGNATURE(S)

[Signature] _____
 Sole Proprietor, Partner, or 20% or more Shareholder
 (If there are no 20% or more shareholders,
 Corporate Officer-print name/title and sign)

_____ Additional partner or 20% or more shareholder

SUBMIT THIS FORM WITH THE BUSINESS LICENSE APPLICATION & PLAN OF OPERATION

Office Use Only:				
Initials	Filed	App #	Paid	MPD
DNS	LC	CC	Issued	License #



**CITY OF MILWAUKEE
OFFICE OF THE CITY CLERK**

Tuesday, November 20, 2018

COMMITTEE MEETING NOTICE

AD 09

SINGH, Satwinder, Agent
Spring Circle LLC
8210 W Capitol DR

Milwaukee, WI 53222

You are requested to attend a hearing which is to be held in Room 301-B, Third Floor, City Hall on:

Tuesday, December 04, 2018 at 09:00 AM

Regarding: Your Class A Malt & Class A Liquor License Application as agent for  "Spring Circle LLC" for "Circle Liquor" at 8659 W BROWN DEER Rd.

There is a possibility that your application may be denied for one or more of the following reasons: The recommendation of the committee regarding the application shall be based on evidence presented at the hearing. Per MCO 85-2.7-4, probative evidence concerning whether or not a new license should be granted may be presented on the following subjects: whether or not the applicant meets the municipal requirements, the appropriateness of the location and premises where the licensed premises is to be located and whether use of the premises for the purposes or activities permitted by the license would tend to facilitate a public or private nuisance or create undesirable neighborhood problems such as disorderly patrons, unreasonably loud noise, litter, and excessive traffic and parking congestion. Probative evidence relating to these matters may be taken from the plan of operation submitted with the license application, if any, but shall not include the content of any music. Evidence regarding the fitness of the location of the premises to be maintained as the principal place of business, including but not limited to whether there is an overconcentration of businesses of the type for which the license is sought; whether the proposal is consistent with any pertinent neighborhood business or development plans, or the location's proximity to areas where children are typically present. The applicant's record in operating similarly licensed premises; and whether or not the applicant has been charged with or convicted of any felony, misdemeanor, municipal offense or other offense, the circumstances of which substantially relate to the activity to be permitted by the license being applied for or any other factor which reasonably relates to the public health, safety or welfare may also be considered. See attached police report or correspondence.

Notice for applicants with warrants or unpaid fines:

Proof of warrant satisfaction or payment of fines must be submitted at the hearing on the above date and time. Failure to comply with this requirement may result in a delay of the granting/denial of your application.

Failure to appear at this meeting may result in the denial of your license. Individual applicants must appear only in person or by an attorney. Corporate or Limited Liability applicants must appear only by the agent designated on the application or by an attorney. Partnership applicants must appear by a partner listed on the application or by an attorney. If you wish to do so and at your own expense, you may be accompanied by an attorney of your choosing to represent you at this hearing.

You will be given an opportunity to speak on behalf of the application and to respond and challenge any charges or reasons given for the denial. No petitions can be accepted by the committee, unless the people who signed the petition are present at the committee hearing and willing to testify. You may present witnesses under oath and you may also confront and cross-examine opposing witnesses under oath. If you have difficulty with the English language, you should bring an interpreter with you, at your expense, so that you can answer questions and participate in your hearing.

You may examine the application file at this office during regular business hours prior to the hearing date. Inquiries regarding this matter may be directed to the person whose signature appears below.

Limited parking for persons attending meetings in City Hall is available at reduced rates (5 hour limit) at the Milwaukee Center on the southwest corner of East Kilbourn and North Water Street. Parking tickets must be validated in the first floor information booth in City Hall.

PLEASE NOTE: Upon reasonable notice, efforts will be made to accommodate the needs of disabled individuals through sign language interpreters or other auxiliary aids. For additional information or to request this service, contact the Council Services Division ADA Coordinator at (414) 286-2998, Fax - (414) 286-3456, TDD - (414) 286-2025.

JIM OWCZARSKI, CITY CLERK

BY: _____

Jessica Celella

License Division Manager

If you have questions regarding this notice, please contact the License Division at (414) 286-2238.

200 E. Wells Street, Room 105, City Hall, Milwaukee, WI 53202. www.milwaukee.gov/license
Phone: (414) 286-2238 Fax: (414) 286-3057 Email Address: License@milwaukee.gov



CITY OF MILWAUKEE
OFFICE OF THE CITY CLERK

Tuesday, November 20, 2018

COMMITTEE MEETING NOTICE

AD 09

SINGH, Satwinder, Agent
Spring Circle LLC
3380 Bradee Rd

Brookfield, WI 53005

You are requested to attend a hearing which is to be held in Room 301-B, Third Floor, City Hall on:

Tuesday, December 04, 2018 at 09:00 AM

Regarding: Your Class A Malt & Class A Liquor License Application as agent for "Spring Circle LLC" for "Circle Liquor" at 8659 W BROWN DEER Rd.

There is a possibility that your application may be denied for one or more of the following reasons: The recommendation of the committee regarding the application shall be based on evidence presented at the hearing. Per MCO 85-2.7-4, probative evidence concerning whether or not a new license should be granted may be presented on the following subjects: whether or not the applicant meets the municipal requirements, the appropriateness of the location and premises where the licensed premises is to be located and whether use of the premises for the purposes or activities permitted by the license would tend to facilitate a public or private nuisance or create undesirable neighborhood problems such as disorderly patrons, unreasonably loud noise, litter, and excessive traffic and parking congestion. Probative evidence relating to these matters may be taken from the plan of operation submitted with the license application, if any, but shall not include the content of any music. Evidence regarding the fitness of the location of the premises to be maintained as the principal place of business, including but not limited to whether there is an overconcentration of businesses of the type for which the license is sought; whether the proposal is consistent with any pertinent neighborhood business or development plans, or the location's proximity to areas where children are typically present. The applicant's record in operating similarly licensed premises; and whether or not the applicant has been charged with or convicted of any felony, misdemeanor, municipal offense or other offense, the circumstances of which substantially relate to the activity to be permitted by the license being applied for or any other factor which reasonably relates to the public health, safety or welfare may also be considered. See attached police report or correspondence.

Notice for applicants with warrants or unpaid fines:

Proof of warrant satisfaction or payment of fines must be submitted at the hearing on the above date and time. Failure to comply with this requirement may result in a delay of the granting/denial of your application.

Failure to appear at this meeting may result in the denial of your license. Individual applicants must appear only in person or by an attorney. Corporate or Limited Liability applicants must appear only by the agent designated on the application or by an attorney. Partnership applicants must appear by a partner listed on the application or by an attorney. If you wish to do so and at your own expense, you may be accompanied by an attorney of your choosing to represent you at this hearing.

You will be given an opportunity to speak on behalf of the application and to respond and challenge any charges or reasons given for the denial. No petitions can be accepted by the committee, unless the people who signed the petition are present at the committee hearing and willing to testify. You may present witnesses under oath and you may also confront and cross-examine opposing witnesses under oath. If you have difficulty with the English language, you should bring an interpreter with you, at your expense, so that you can answer questions and participate in your hearing.

You may examine the application file at this office during regular business hours prior to the hearing date. Inquiries regarding this matter may be directed to the person whose signature appears below.

Limited parking for persons attending meetings in City Hall is available at reduced rates (5 hour limit) at the Milwaukee Center on the southwest corner of East Kilbourn and North Water Street. Parking tickets must be validated in the first floor information booth in City Hall.

PLEASE NOTE: Upon reasonable notice, efforts will be made to accommodate the needs of disabled individuals through sign language interpreters or other auxiliary aids. For additional information or to request this service, contact the Council Services Division ADA Coordinator at (414) 286-2998, Fax - (414) 286-3456, TDD - (414) 286-2025.

JIM OWZARSKI, CITY CLERK

BY: _____

Jessica Celella

License Division Manager

If you have questions regarding this notice, please contact the License Division at (414) 286-2238.

200 E. Wells Street, Room 105, City Hall, Milwaukee, WI 53202. www.milwaukee.gov/license
Phone: (414) 286-2238 Fax: (414) 286-3057 Email Address: License@milwaukee.gov

Cooney, Jim

From: [REDACTED]
Sent: Wednesday, August 29, 2018 5:26 PM
To: License
Subject: License Objection at 8659 W Brown Deer Rd.

To Whom may it concern: My name is [REDACTED] objective to a license application filed for 8659 W Brown Deer Rd. Business Name: Circle Liquor. There is already a saturation of liquor stores in this area. It will make the neighborhood look very bad to see this many liquor stores with in walking distance of one another. There is already one across the street of the address which this application is filed under and also one kitty corner of it as well. Having this many liquor stores will be an eyesore to the people driving on this road as well to the people who live in the neighborhood around it. What kind of impression does that set for the people who live here and work around here. What future business would want to move here it see type of license just being handed out like its nothing. Please contact me, [REDACTED] [REDACTED] for the hearing on this license application.

REDACTED RECORD

Date:10/01/18
Officer: Geniesse

City of Milwaukee Police Department
90-5-1.5 Crime Prevention Survey
Convenience Store/Liquor Store Inspection

Name of Premise: Circle Liquor
Address: 8659 W Brown Deer Rd
Phone: 414-588-0554

Owner: Satwinder NMI Singh I/M 04/01/66
Owner address: 3380 Bradee Rd
City State Zip: Brookfield, WI. 53005
Owner Phone: 262-751-6546 or 414-588-0554
Owner email: samkalsi@yahoo.com

Manager: Satwinder NMI Singh I/M 04/01/66
Home Address: 3380 Bradee Rd
City State Zip: Brookfield, WI 53005
Phone: 262-751-6456 or 414-588-0554
Email: samkalsi@yahoo.com

Preferred contact: Satwinder Singh 414-588-0554

Location currently open: YES NO

Projected open date: 01/01/19

Day's open: S M T W Th F SA ALL

Hours of Operation: Sun: 9a-9p 24 hours Y N
Mon: 9a-9p
Tue: 9a-9p
Wed: 9a-9p
Thu: 9a-9p
Fri: 9a-9p
Sat: 9a-9p

Premise Type: Liquor Store
Convenience Store
Other:

Licenses currently held:

- Alcohol: Yes No Class: #:
- Tobacco: Yes No #:
- Food: Yes No #:
- Extended Hours: Yes No #:
- Secondhand Dealer: Yes No Type: #:
- Other: Yes No Type: #:
- Other: Yes No Type: #:

Exterior Survey:

1. Is the area around the location clean? Yes No
2. What surrounds the location? (Check all the apply)
 - a. Park
 - b. School
 - c. Youth Center
 - d. Church
 - e. Tavern(s) If so, how many
 - f. Residential
 - g. Other businesses
 - h. Other:
3. Can you see from the outside of the location into the interior Yes No
4. Can you see the employees inside of the location from the outside Yes No
5. Are exterior windows free of signage Yes No
6. Is there a parking lot Yes No
7. Is the parking lot clean? Yes No
8. Is the parking lot well lit? Yes No
9. Are there areas where a person could conceal themselves Yes No
10. Is there exterior lighting? Yes No. Does it appears to be adequate Yes No
11. Exterior Payphone? Yes No
12. Are there No Loitering Signs posted? Yes No
13. Are there exterior security cameras Yes No How Many:
14. Are the address numbers prominently displayed and easy to see Yes No

Camera Survey:

15. Does this location have security cameras? Yes No
16. Are they in working order? Yes No
17. What format are the cameras?
 - a. Color Yes No
 - b. Digital Yes No
 - c. VCR Yes No
 - d. Recorded Yes No
18. How long is footage stored for later viewing:
19. Are there exterior cameras Yes No How many:
20. Are there interior cameras Yes No How many:
21. Do all employees know how to retrieve recorded digital images/footage? Yes No

Interior Survey:

22. Is the storeowner willing to be a standing complainant regarding loitering? Yes No
a. If yes have them fill out the standing complaint form and give them two of the commercial signs Yes No
23. Is the interior of the location neat and clean? Yes No
24. Does an interior camera face the entrance/exit? Yes No
25. Is there a lockable area that separates employees from customers? Yes No
26. Does the store sell single chore boy? Yes No
27. Does the store sell blunt wraps? Yes No
28. Does the store sell scales? Yes No
29. Does the store sell items that may be used as crack pipes? Yes No
a. Describe item
30. Does the store have an over abundance of sandwich baggies: Yes No
31. Does the owner understand that these items are often used for drug use? Yes No
32. Do the products in the store appear to be new and rotated often? Yes No
33. Are emergency and non-emergency numbers posted near the phone? Yes No
34. Does the owner know how to contact their police district directly? Yes No
a. Did you provide a district contact guide to the owner? Yes No

Complete this section if alcohol establishment is a convenience store:

(** Read full ordinance for all details "68-4.3 Convenience Food Stores")

All convenience food stores not exempted under sub. 3 shall:

1. Is the cash register located in a manner so that at the time of a sales transaction, the employee and customer are both visible from the sidewalk? Yes No **
2. Are the glass entrance and exit doors clear of any signs or advertisements with the exception of a sign which states that the cash register contains \$50 or less and that the safe is no accessible to employees? Yes No
3. Does the store maintain one of the following on the licensed premise:
 - a. A safe that was in use at the convenience food store on August 17, 1994? Yes No
 - b. A drop-safe or time release safe that weighs at least 500 pounds or which is attached to or set into the floor in a manner approved by the police department? Yes No
4. Is lighting provided for the store's parking area during all hours of darkness when employees or customers are on the premises at a minimum average of 2-foot candles per square foot, unless the store is not open for business after sunset and before sunrise? Yes No N/A
5. Are at least two high-resolution surveillance security cameras installed? Yes No
6. Are the security cameras in working order? Yes No
7. Does one camera show an overall view of the counter and register area? Yes No
8. Does one camera show a clear, identifiable, full frame image of the face of each person entering and leaving the store? Yes No
9. Are the camera views obstructed by fixtures or displays? Yes No
10. Is the recorded footage stored for at least 30 days? Yes No
11. Do all store employees know how to record footage from the camera system to media capable of being transferred to police custody? Yes No

12. Are customer entrances/exits made of glass or other transparent material? Yes No
a. Exception: A store that does not have such doors on August 17, 1994 shall not be required to install such doors until the holder of the store's food dealer license changes.
13. Has the owner and their employees attended the Robbery Prevention Training within 120 days of ownership or employment? Yes No
a. Contact Community Outreach and Education at 935-7836 for schedule.

Sub 3. Exemptions. The requirements of this section do not apply to a convenience food store that conforms to either of the following descriptions:

- a-1. The store is located in an enclosed shopping structure, enclosed commercial building or hospital. A convenience food store is not in an enclosed structure or building if a customer can enter it directly from the outside.

Does store conform to a-1 Yes No

- a-2. The store physically separates employees from customers with a solid partition that bars a person from entering the employee area from the customer area, has a secure lock on the employee side of any door between the employee area and the customer, and conducts all transaction through a service window or similar arrangement.

Does store conform to a-2 Yes No

- a. At the commissioner's discretion, a convenience store may be exempted from any or all of the regulations specified in sub 2.

Does this location hold an exemption from the commissioner regarding any of the requirements of Sub 2? Yes No

ADDITIONAL COMMENTS/RECOMMENDATIONS:

This building is completely under construction. Owner stated he will call for a final walk through prior to opening. I recommended cameras, interior and exterior. Post address on the exterior of the business. Post no loitering signs on the exterior of the building.

Alcohol concentration for 8659 W Brown Deer Rd

City of Milwaukee, Wisconsin

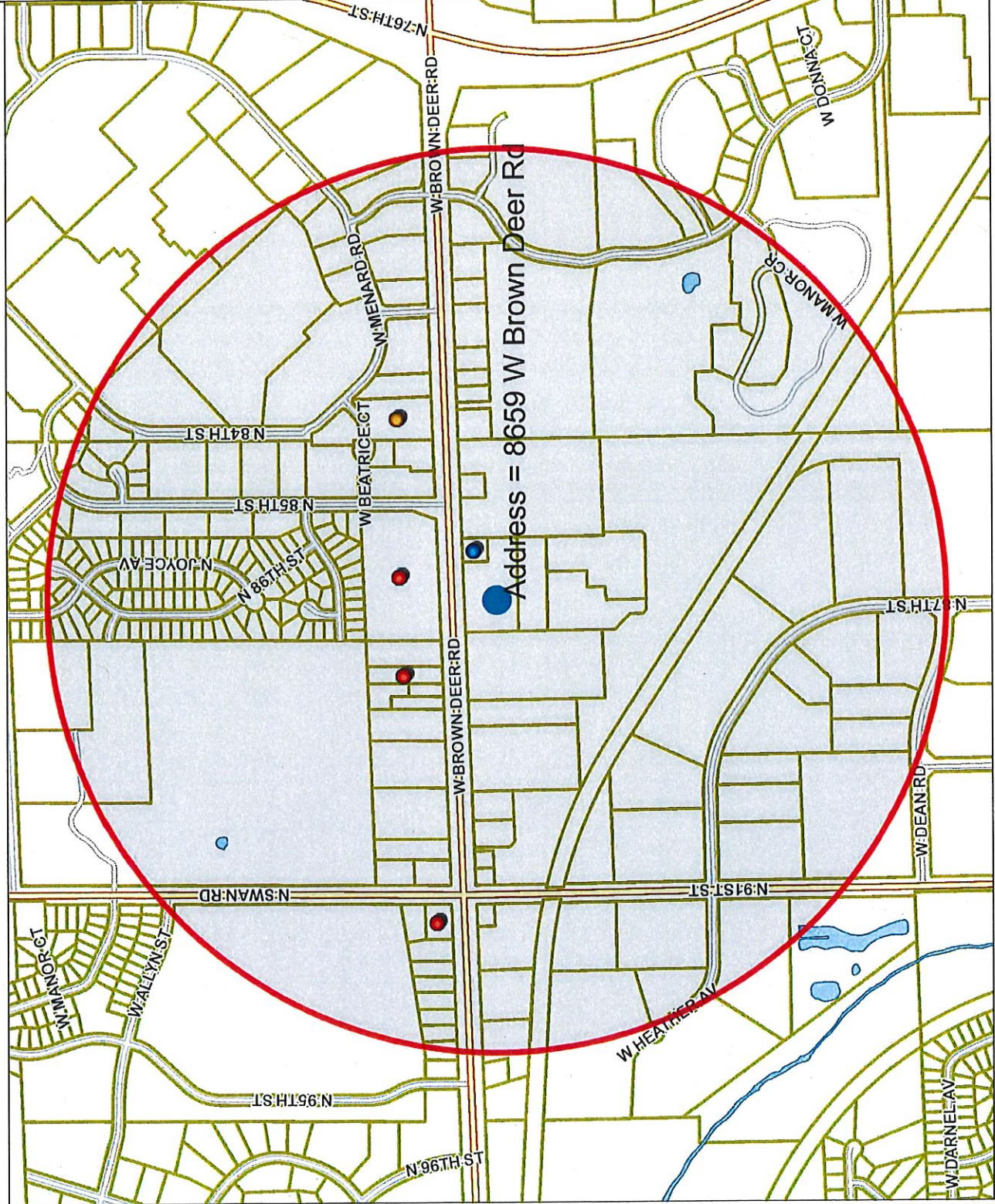

- Legend -

- Street names 10,000
- City limits
- Freeways 15,000
- Freeways
- Exit ramps
- Entry ramps
- Ramps
- Major streets 10,000
- Streets 10,000
- Waterways
- Millwaukee Parcels
- Street names 10,000
- Alcohol licenses
 - Class A intoxicating liquor
 - Class A fermented malt beverage
 - Class A liquor and malt
 - Class B fermented malt beverage
 - Class B tavern
 - Class C wine retailer

- Notes -

Alcohol establishments within a .5 mile radius centered on 8659 W Brown Deer Rd on 8/8/2018



Department of Administration - IT/MD

833.3 0 416.67 833.3 Feet

Map Scale: 1: 10,000

© City of Milwaukee, Wisconsin
Map Milwaukee: Property Information
Disclaimer
8/8/2018

Alcohol establishments within a .5 mile radius centered on 8659 W Brown Deer Rd on 8/8/2018

License summary

- Class A Fermented Malt Beverage Retailer's License
- Class A Malt & Class A Liquor License
- Class B Tavern License

Total: 1
3
1

Legal entity	Trade name	Licensee	License type name	Total capacity	Room capacity	Address	Expiration date
Family Foods Corporation	Family Foods	VIPAN DUTTA, Agt	Class A Fermented Malt Beverage Retailer's License			8328 W Brown Deer RD	7/9/2019 7:38
Daxa LLC	Brown Deer Beverage	CHIRAG J PATEL, Agt	Class A Malt & Class A Liquor License			8564 W Brown Deer RD	9/20/2018 19:00
FAMILY MART, LLC	LIQUOR DEPOT	VIPAN DUTTA, Agt	Class A Malt & Class A Liquor License			9108 W BROWN DEER RD	2/4/2019 18:00
Royal Plaza Liquor Inc	Royal Plaza Liquor Inc	GURMEET K DHILLON, Agt	Class A Malt & Class A Liquor License			8700 W BROWN DEER RD	4/9/2019 19:00
GMRI, INC	THE OLIVE GARDEN ITALIAN RES #1443	JASON J GREGGS, Agt	Class B Tavern License	300		8531 W BROWN DEER RD	6/2/2019 19:00

Grand total: 5



Tuesday, November 20, 2018

Licenses Committee Notice of Hearing

Slinger Cheese LLC
12419 W Hampton Av
Butler, WI 53007

Date: 12/4/2018
Time: 09:00 AM
Location: Room 301-B, Third Floor, City Hall

The Licenses Committee will consider the following license application:

Class A Malt & Class A Liquor License Application
SINGH, Satwinder, Agent
Circle Liquor at 8659 W BROWN DEER Rd

Please note this application may be recommended for denial based on fitness of the location due to concentration of alcohol beverage outlets in the area. If the application is denied for this reason, no other application for an alcohol beverage license for this location shall be recommended for approval by the Licenses Committee within three years of the date of denial unless the applicant has demonstrated a change of circumstances since the prior denial.

If you have any questions, please call (414) 286-2238.





Tuesday, November 20, 2018



Notice of Public Hearing

SINGH, Satwinder, Agent
Circle Liquor at 8659 W BROWN DEER Rd
Class A Malt & Class A Liquor License Application

Tuesday, December 04, 2018 at 9:00 AM

To whom it may concern:

The above application has been made by the above named applicant(s). This requires approval from the Licenses Committee and the Common Council of the City of Milwaukee. The hearing before the Licenses Committee will take place on 12/4/2018 at 9:00 AM, in Room 301-B, Third Floor, City Hall. If you wish, you may provide testimony at the hearing regarding the request; see below for further information. You are not required to attend the hearing. Once the Licenses Committee makes its recommendation, this recommendation is forwarded to the full Common Council for approval at its next regularly scheduled hearing. Please review the information below and if you have further questions regarding this process, please contact the License Division at (414) 286-2238.

Important details for those wishing to provide information for the Licenses Committee to consider when making its recommendation:

1. The license application is scheduled to be heard at the above time. Due to other hearings running longer than scheduled, you may have to wait some time to provide your testimony.
2. You must appear in person and testify as to matters that you have personally experienced or seen. (You cannot provide testimony for your neighbor, parent or anyone else; this is considered hearsay and cannot be considered by the committee.)
3. No letters or petitions can be accepted by the committee (unless the person who wrote the letter or the persons who signed the petition are present at the committee hearing and willing to testify).
4. Persons opposed to the license application are given the opportunity to testify first; supporters may testify after the opponents have finished.
5. When you are called to testify, you will be sworn in and asked to give your name, and address. (If your first and/or last names are uncommon please spell them.)
6. You may then provide testimony.
 - a. Include only information relating to the above license application.
 - b. Include only information you have personally witnessed or seen.
 - c. Provide concise and relevant information detailing how this business has affected or may affect the peaceful enjoyment of your neighborhood.
 - d. If by the time you have the opportunity to testify, the information you wish to share has already been provided to the committee, you may state that you agree with the previous testimony. Redundant or repetitive testimony will not assist the committee in making its recommendation.
7. After giving your testimony, the members of the Licenses Committee and the licensee may ask questions regarding the testimony you have given or other factors relating to the license application.
8. Business Competition is not a valid basis for denial or non-renewal of a license.
Please Note: If you have submitted an objection to the above application your objection cannot be considered by the committee unless you personally testify at the hearing.

OCCUPANT	MAIL ADDRESS	CITY, STATE ZIP
CURRENT OCCUPANT	8935 N 85TH ST 2	MILWAUKEE, WI 53224
CURRENT OCCUPANT	8671 W GREENBROOK DR	MILWAUKEE, WI 53224
CURRENT OCCUPANT	8915 N 85TH ST 2	MILWAUKEE, WI 53224
CURRENT OCCUPANT	8915 N 85TH ST 3	MILWAUKEE, WI 53224
CURRENT OCCUPANT	8613 W GREENBROOK DR	MILWAUKEE, WI 53224
CURRENT OCCUPANT	8545 W GREENBROOK DR 3	MILWAUKEE, WI 53224
CURRENT OCCUPANT	8711 W GREENBROOK DR	MILWAUKEE, WI 53224
CURRENT OCCUPANT	8915 N 85TH ST 1	MILWAUKEE, WI 53224
CURRENT OCCUPANT	8623 W GREENBROOK DR	MILWAUKEE, WI 53224
CURRENT OCCUPANT	8919 N 87TH CT	MILWAUKEE, WI 53224
CURRENT OCCUPANT	8661 W GREENBROOK DR	MILWAUKEE, WI 53224
CURRENT OCCUPANT	8603 W GREENBROOK DR	MILWAUKEE, WI 53224
CURRENT OCCUPANT	8545 W GREENBROOK DR 2	MILWAUKEE, WI 53224
CURRENT OCCUPANT	8651 W GREENBROOK DR	MILWAUKEE, WI 53224
CURRENT OCCUPANT	8915 N 85TH ST 4	MILWAUKEE, WI 53224
CURRENT OCCUPANT	8545 W GREENBROOK DR 1	MILWAUKEE, WI 53224
CURRENT OCCUPANT	8545 W GREENBROOK DR 4	MILWAUKEE, WI 53224
CURRENT OCCUPANT	8641 W GREENBROOK DR	MILWAUKEE, WI 53224
CURRENT OCCUPANT	8631 W GREENBROOK DR	MILWAUKEE, WI 53224
CURRENT OCCUPANT	8621 W GREENBROOK DR	MILWAUKEE, WI 53224
CURRENT OCCUPANT	8929 N 85TH ST 4	MILWAUKEE, WI 53224
CURRENT OCCUPANT	8929 N 85TH ST 1	MILWAUKEE, WI 53224
CURRENT OCCUPANT	8935 N 85TH ST 4	MILWAUKEE, WI 53224
CURRENT OCCUPANT	8935 N 85TH ST 1	MILWAUKEE, WI 53224
CURRENT OCCUPANT	8701 W GREENBROOK DR	MILWAUKEE, WI 53224
CURRENT OCCUPANT	8643 W GREENBROOK DR	MILWAUKEE, WI 53224
CURRENT OCCUPANT	8601 W GREENBROOK DR	MILWAUKEE, WI 53224
CURRENT OCCUPANT	8929 N 85TH ST 2	MILWAUKEE, WI 53224
CURRENT OCCUPANT	8656 W GREENBROOK DR	MILWAUKEE, WI 53224
CURRENT OCCUPANT	8610 W GREENBROOK DR	MILWAUKEE, WI 53224
CURRENT OCCUPANT	8633 W GREENBROOK DR	MILWAUKEE, WI 53224
CURRENT OCCUPANT	8611 W GREENBROOK DR	MILWAUKEE, WI 53224
CURRENT OCCUPANT	8929 N 85TH ST 3	MILWAUKEE, WI 53224
CURRENT OCCUPANT	8935 N 85TH ST 3	MILWAUKEE, WI 53224
CURRENT OCCUPANT	8624 W GREENBROOK DR	MILWAUKEE, WI 53224
CURRENT OCCUPANT	8920 N 87TH CT	MILWAUKEE, WI 53224

Total Records: 36

Radius: 250.0 feet and Center of Circle: 8600 W Brown Deer Rd



BUSINESS LICENSE PLAN OF OPERATION

ccl-busplan 12/14/17

Office of the City Clerk License Division
200 E. Wells St. Room 105, Milwaukee, WI 53202
(414) 286-2238 www.milwaukee.gov/license e-mail address: license@milwaukee.gov

1. Type of Business

Applying for: Extended Hours (12AM to 5AM) - If a food establishment, check all that apply: Delivery Drive Thru Dining Room
 Self Service Laundry Massage Establishment Filling Station
 Other (supplemental application for specific license also required)

Provide a detailed description of the type of business you plan on operating:

Liquor Store

Do you have any experience operating this type of business? No Yes If yes, explain: Already own at Butler Hwy west L-L-L

2. Business Operations

- a. Proposed Opening Date: October 1, 2018
- b. Is this premise under construction? No Yes If yes, list estimated completion date: Sept 30, 2018
- c. Is this a franchise? No Yes
- d. Is this premises currently licensed? No Yes If yes, list type of license: _____
- e. Is the current licensee operating? No Yes If no, list date closed: _____
- f. Do you have future plans for other businesses, licenses or permits at this location? No Yes
If yes, explain: _____
- g. Have you previously held an Extended Hours License in Milwaukee? No Yes
If yes, list address(es): _____
- h. Are other businesses operating in the same building? No Yes If yes, describe: Restaurant, Gas & Shop etc

3. Litter & Noise

- a. How are grounds kept clean? Sweep Pressure Wash Pick Up Litter Other: _____
- b. How often will grounds be cleaned? Daily Weekly As Needed Monthly Other: _____
- c. Grounds cleaned by: Licensee Building Owner Employees Hired Maintenance Other: _____
- d. How are noise issues prevented and/or addressed? Security Manager approaches customer(s) Call Police
 Signs Posted Other: _____
- e. Will a sound amplification system be used? No Yes If yes, describe: _____

4. Smoking & Sanitation

- a. Are there designated outdoor smoking areas? No Yes If yes, describe: _____
- b. Number of Garbage Cans: Inside: 2 Locations: In front up store entrance
Outside: 4 Locations: In front of store
- c. Is a crowd control barrier used? No Yes If yes, describe: N/A
- d. How many restrooms are on the premises? 2
- e. Name of solid waste contractor: Advanced Disposal Waste Management Other: _____

5. Security

- a. Are there onsite parking spaces? No Yes If yes, indicate how many? 10 and describe the parking security plan: 3rd PART of shopping mall
- b. Is there a loading zone? No Yes If yes, describe the loading area security plan: _____
- c. Will you have security personnel on premise? No Yes If yes, how many? 1 and answer the following:
 What are their responsibilities? Help Customers
 Is security equipment used? No Yes If yes, describe _____
 List their licensing, certification, or training credentials N/A
- d. Will there be security cameras? No Yes If yes, where? inside and outside
- e. Will searches/identification checks be done upon entry? No Yes If yes, describe _____

6. Percentage of Sales (must total 100%)

Alcohol <u>80</u> %	Food <u>—</u> %	Secondhand Merchandise _____ %	Precious Metals & Gems _____ %
Entertainment _____ %	Cigarettes <u>10</u> %	Personal Services (such as tattoo, body piercing, salon, tailor, tanning, etc.) _____ %	Other <u>10</u> %
Pawnbroker Activity _____ %	Salvaged Materials _____ % (such as scrap metal)		Describe: <u>General merchandise</u>

7. Businesses/Licenses on the Premises (check all that apply):

Type 1

- Full Service Restaurant Cafe/Coffee Shop Deli or Fast Food Restaurant Private/Fraternal/Veterans Club
- Night Club Tavern Cocktail Lounge Teen Club
- Banquet Hall Sports Facility Bowling Alley
- Hotel/Motel : Number of Floors: _____ Rooming House: Number of Floors: _____
 Number of Rooms: _____ Number of Rooms: _____

Type 2

- Liquor Store Corner Store Supermarket Convenience Store
- Gas Station Amusement/Phonograph Distributor Recycling, Salvage or Towing
- Used Car Dealer Personal Service Establishment
(such as tattoo business, hair salon, tailor, etc.) Recording Studio

What other licenses/permits will you hold at this location? (check all that apply)

- Occupancy Permit Cigarette & Tobacco Gas Station Extended Hours Class "B" Tavern Weights & Measures
- Secondhand Dealer Precious Metal & Gem Other: _____

8. Legal Capacity (only if a Type 1 premises in #7 above)

Capacity _____ (Call the Milwaukee Development Center at 414-286-8211 if you have questions.)

nr

9. Premises Description

a. Identify all area(s) of the premises that will be used in operating this business (include areas used only for storage):

1st Floor 2nd Floor Basement Storage Patio Beer Garden Sidewalk Café Deck Rooftop

Other: Describe: 8659 W. Brown Deer East of South

b. Describe Location: Major Thoroughfare Secondary Street Other: Brown Deer Rd

c. Nearest Major Cross Street: 91st

d. Describe Building: Free Standing Building Strip Mall Other: _____

e. Describe Premises Structure: Single Story Multi-Story - # of Stories _____ Other: _____

f. Describe Surrounding Area: Commercial Residential Industrial Other: _____

g. Building Owner Name: SLinga Cheese, LLC Phone Number: 414-588-0554

Business Owner Address: 12919 W. Hampton Ave Butler WI 53007

10. Hours of Operation & Customers

Will customers be entering the premises? No Yes

Day of the Week	Proposed Hours of Operation:		Estimated Number of Customers expected each day	Potential Age Range of Customers	Class B Tavern Applicant Only: Age Restriction (If none, write 'None')
	Open Time (include a.m. or p.m.)	Close Time (include a.m. or p.m.)			
Sunday	8 AM - 9 PM	9 PM	25-80	25-80	
Monday	8 AM - 9 PM	9 PM	25-80		
Tuesday	8 AM - 9 PM	9 PM	25-80		
Wednesday	8 AM - 9 PM	9 PM	25-80		
Thursday	8 AM - 9 PM	9 PM	25-80		
Friday	8 AM - 9 PM	9 PM	25-80		
Saturday	8 AM - 9 PM	9 PM	25-80		

An Extended Hours Establishment License is required for any convenience store, filling station, personal service establishment (such as tattoo, body piercing, salon, tailor, tanning, etc.), recording studio or restaurant which is open between the hours of 12:00 a.m. and 5:00 a.m.

Alcohol Establishments Permitted Hours of Operation: Class A: 8:00 am to 9:00 pm Sunday thru Saturday
Class B: 6:00 am to 2:00 am Sunday thru Thursday, 6:00 am to 2:30 am Friday & Saturday

Entertainment Outdoor Closing Hours: 10:00pm Sunday-Thursday; 12:00am Friday & Saturday; unless a different time, either earlier or later, is established by the Common Council in its approval of the licensee's plan of operation.

11. Signature(s)

[Signature]
Signature of Sole Proprietor, Partner, or 20% or more Shareholder
(If there are no 20% or more shareholders, Corporate Officer-print name/title and sign)

[Signature]
Signature of additional partner or 20% or more shareholder

See Application Information for a complete list of all required application forms.



**ALCOHOL BEVERAGE & PUBLIC ENTERTAINMENT PREMISES
SUPPLEMENTAL APPLICATION**

Office of the City Clerk License Division
200 E. Wells St. Room 105, Milwaukee, WI 53202
(414) 286-2238 e-mail address: license@milwaukee.gov www.milwaukee.gov/license

Legal Entity Name:	Spring Circle, LLC
Premise Address:	8659 W. Brown Deer Rd
Proximity of Premises to Church, School, Daycare Center or Hospital	
Is the building within 300 feet of any church, school, daycare center or hospital?	<input checked="" type="checkbox"/> No <input type="checkbox"/> Yes
"Service Bar Only" Designation	
If applying for Class B or C license, are you applying for "Service Bar Only"?	<input type="checkbox"/> No <input type="checkbox"/> Yes <u>N/A</u>
Service Bar Only means customers cannot sit at the bar. Alcohol is served to patrons seated at tables. No stools, chairs or other articles of furniture shall be placed at the service bar for patrons to sit upon.	
Business Information	
a) Are you taking out this application for anyone that may not be eligible for a license?	<input checked="" type="checkbox"/> No <input type="checkbox"/> Yes
If yes, list their name and address: _____	
b) Will the agent, a partner or the individual licensee be conducting the day-to-day operations of the business?	<input type="checkbox"/> No <input checked="" type="checkbox"/> Yes
If no, list the name and address of the person(s) who will: _____	
Class B Applicants: If the agent, a partner or the individual licensee will not be conducting the day-to-day operations of the business, the person(s) listed above must obtain a Class B Managers license.	
c) Does anyone else have money invested or any other interest in this business?	<input checked="" type="checkbox"/> No <input type="checkbox"/> Yes
If yes, explain: _____	
d) Have you made an agreement with anyone to repay any loan or any other payments based upon income from the business?	<input checked="" type="checkbox"/> No <input type="checkbox"/> Yes If yes, list name and address: _____
Proof of Ownership, Lease, or Offer to Purchase (New & Transfer Applicants Only)	
Submit proof of ownership, lease, or offer to purchase the building with this application. A lease or offer to purchase must:	
a) Be in the same legal entity name as that apply for the license	
b) Reflect the same address as the premises address on this application	
c) Reflect current dates and	
d) Be signed by the lessor/seller and lessee/buyer	<u>lease</u>
Property Information (New & Transfer Applicants Only)	
a) Do you own or lease the building?	<input type="checkbox"/> Own <input checked="" type="checkbox"/> Lease
b) Who owns the fixtures (for example, coolers, etc.)?	<u>Spring Circle, LLC</u>
c) Are you purchasing the stock and/or fixtures?	<input checked="" type="checkbox"/> No <input type="checkbox"/> Yes If yes, amount paid \$ _____
d) Total amount paid for business	\$ <u>N/A</u>
e) Total amount paid for goodwill of the business	\$ <u>N/A</u>
Goodwill comprises the reputation and customer relationships of an existing business. If the price you pay for the business exceeds the fair market value of all of the rest of the assets of the business, the excess may be considered goodwill.	
f) Have you made arrangements with the seller for payment of personal property taxes?	<input checked="" type="checkbox"/> No <input type="checkbox"/> Yes

See Application Information for a list of all required application forms.

Lease Information (New & Transfer Applicants who are leasing the premises only)

- a) Date lease begins Now Ends 07/31/2028
- b) Monthly rental \$ 3,000
- c) Do you have an option to renew the lease? No Yes
- d) Does your lease allow for assignment to another party without the consent of the owner? No Yes
- e) For what length of time have you been guaranteed occupancy (number of years)? 10 Yrs.
- f) In addition to paying the monthly rental, will you have to pay anything additional to the owner of the building to guarantee performance of the lease? No Yes If yes, explain None
- g) Does the present owner or occupancy object to the granting of your license? No Yes
If yes, explain _____

Change of Agent Applicants Only

Have there been any changes to the floor plan since the last application was submitted? No Yes
If no, a new floor plan is not required. If yes, submit a new floor plan and explain the change(s): _____

Notarized Signatures of Applicants

SUBSCRIBED AND SWORN TO BEFORE ME

This 6th day of August 2021

Laura A. Helbert
(Clerk/Notary Public)

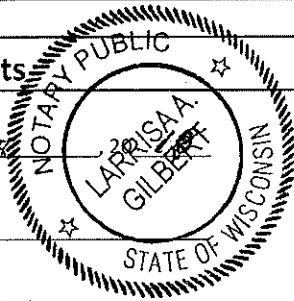

Sharon Wilcia

Sole Proprietor, Partner, 20% or more Shareholder, or Agent – only if there are no 20% or more shareholders

My Commission Expires 04-18-2021

*Notary Seal must be affixed.

Additional partner or 20% or more shareholder

Note: All information contained in this application is subject to approval by the Common Council. Deviating from approved plan of operation will subject licensee to citations, and/or suspension or non-renewal of the license. Contact the License Division for information on how to request changes.

New and transfer of premise applicants must submit the following:

- Proof of ownership, lease or offer to purchase the building
- Detailed floor plan
- If a restaurant, copy of the menu

Spring Car Wash, LLC DISTRICT OFFICE
 8659 W. Brown Deer Rd.
 Milwaukee, WI 53224
 Agent: Satwinder Singh
 August 2, 2018

Total 59 FT 4,600 SQ. FT

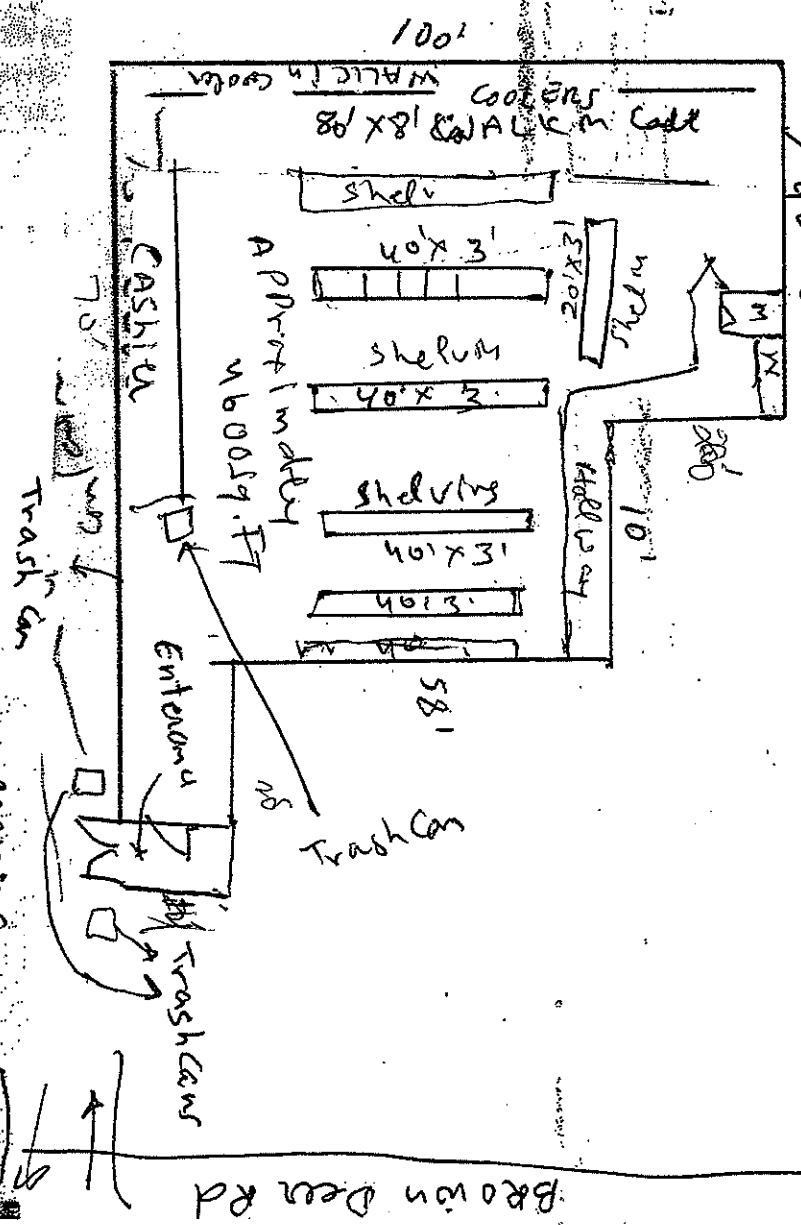

400' x 150'
 Parking Lot

