

CERTIFIED SURVEY MAP NO. _____

A division of Lot B of Block 21 of North Milwaukee Townsite Company's Addition No. 2, in the Northwest 1/4 of the Northeast 1/4, Section 1, Township 7 North, Range 21 East, in the City of Milwaukee, Milwaukee County, Wisconsin.

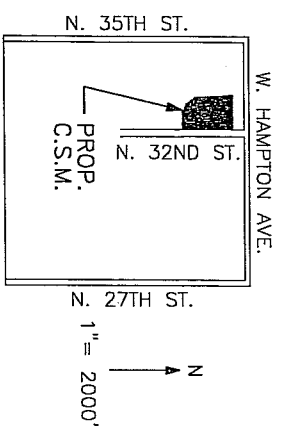
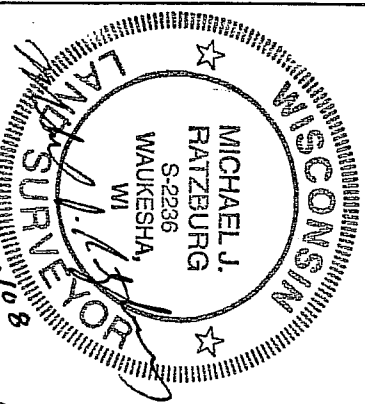

NORTH LINE OF THE
NW 1/4, SECT. 1,
T.7N., R.21E.

WEST HAMPTON AVENUE
N.89°17'43"E. 2718.82'

NW 1/4, SECT. 1, T.7N., R.21E.
LOCATION MAP

NW. COR. OF THE
NW 1/4, SECT. 1,
T.7N., R.21E.

NE. COR. OF THE
NW 1/4, SECT. 1,
T.7N., R.21E.

CURVE 1

DEL. = 03°31'00"
TAN. = 89.49'
LEN. = 178.92'
RAD. = 2915.00'
C.B. = N.05°21'06"W.
CHD. = 178.89'

LEGEND

- FOUND 1" IRON PIPE
- 1" DIA.x24" LG. IRON PIPE SET, MINIMUM WEIGHT 1.13 LBS./FT.
- FOUND CONC. MONUMENT W/BRASS CAP

OWNER

Bishop's Creek Community
Development Corporation
3500 W. Mother Daniels Way
Milwaukee, WI. 53209

REFERENCE BEARING

All bearings are referenced to the North line of the NW 1/4 of Sect. 1, T.7N. R.21E. which bears N.89°17'43"E. and is referenced to Grid North of the Wisconsin State Plane Coordinate System, South Zone.

VACATED WEST COURTLAND AVENUE

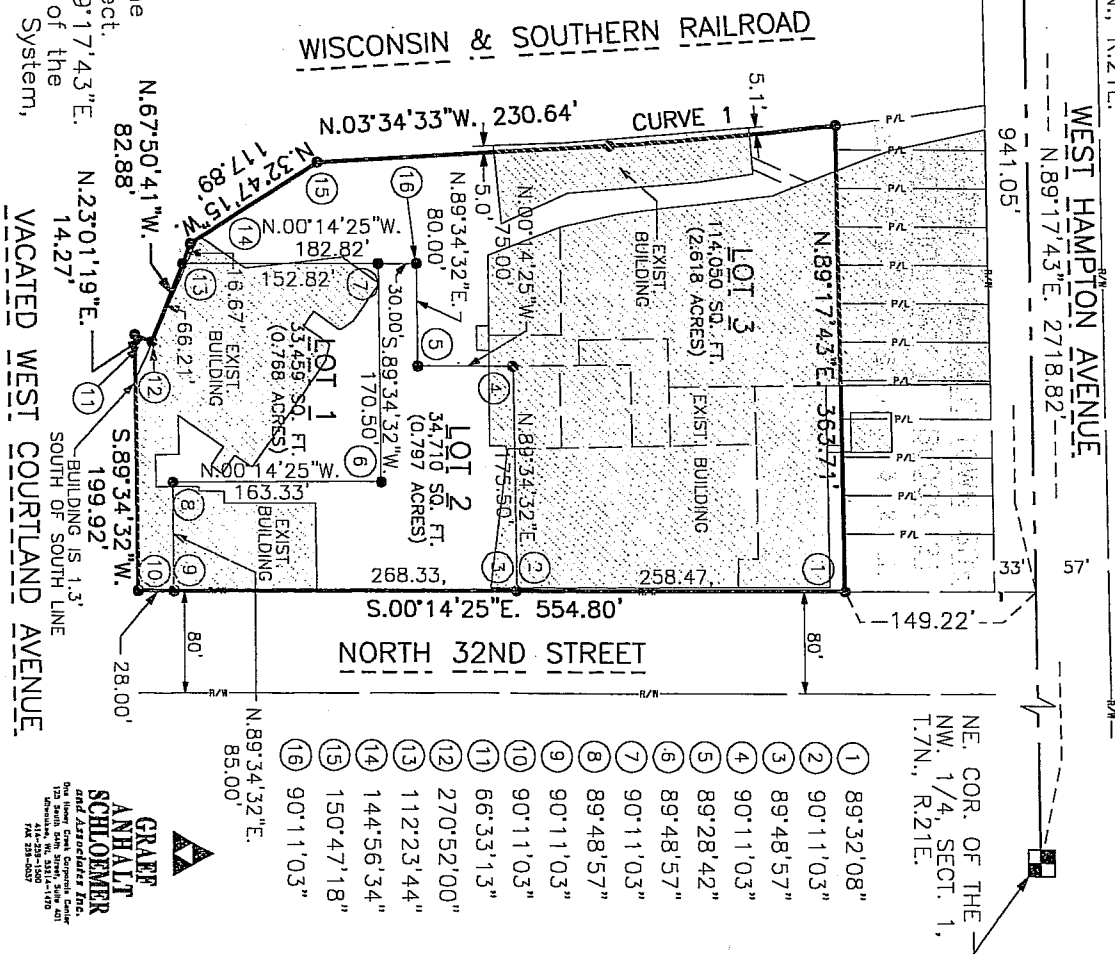

- ① 89°32'08"
- ② 90°11'03"
- ③ 89°48'57"
- ④ 90°11'03"
- ⑤ 89°28'42"
- ⑥ 89°48'57"
- ⑦ 90°11'03"
- ⑧ 89°48'57"
- ⑨ 90°11'03"
- ⑩ 90°11'03"
- ⑪ 66°33'13"
- ⑫ 270°52'00"
- ⑬ 112°23'44"
- ⑭ 144°56'34"
- ⑮ 150°47'18"
- ⑯ 90°11'03"

GRAFF
ANHALT
SCHLOEMER
SURVEYORS
100 North Greenfield Road
P.O. Box 1000
Milwaukee, WI 53213
Phone: 414-224-1800
Fax: 414-224-0807

CERTIFIED SURVEY MAP NO. _____

A division of Lot B of Block 21 of North Milwaukee Townsite Company's Addition No. 2, in the Northwest 1/4 of the Northeast 1/4, Section 1, Township 7 North, Range 21 East, in the City of Milwaukee, Milwaukee County, Wisconsin.

SURVEYOR'S CERTIFICATE

STATE OF WISCONSIN)
) SS
MILWAUKEE COUNTY)

I, Michael J. Ratzburg, a registered land surveyor, do hereby certify:

That I have surveyed and mapped a division of Lot B of Block 21 of North Milwaukee Townsite Company's Addition No. 2, in the Northwest 1/4 of the Northeast 1/4, Section 1, Township 7 North, Range 21 East, in the City of Milwaukee, Milwaukee County, Wisconsin, more particularly described as follows:

Commencing at the northwest corner of said Northeast 1/4; thence North 88°55'43" East, on and along the north line of said Northeast 1/4, 38.54 feet; thence North 89°17' 43" East, on and along said north line, 941.05 feet; thence South 00°14'25" East, 149.22 feet to the northeast corner of said Lot B and the point of beginning; thence South 00°14'25" East, on and along the east line of said Lot B, 554.80 feet; thence South 89°34'32" West, on and along the south line of said Lot B, 199.92 feet; thence North 23°01'19" East, on and along the south line of said Lot B, 14.27 feet; thence North 67°50'41" West, on and along the south line of said Lot B, 82.88 feet; thence North 32°47'15" West, on and along the west line of said Lot B, 117.89 feet; thence North 03°34' 33" West, on and along the west line of said Lot B, 230.64 feet to the beginning of a curve to the left, having a radius of 2,915.00 feet and a long chord of North 06°30'14" West, 296.04 feet; thence northwesterly, on and along the arc of said curve and said west line of said Lot B, 296.16 feet to a point on the north line of said Lot B; thence North 89°17'43" East, on and along said north line, 363.71 feet to the point of beginning.

Containing 182,219 square feet (4.183 acres), more or less.

That I have made such survey, land division, and map by the direction of the Bishop's Creek Community Development Corporation, owner of said land. That such map is a correct representation of all the exterior boundaries of the land surveyed and the land division thereof made.

That I have fully complied with Chapter 236 of the Wisconsin Statutes and Chapter 119 of the Milwaukee Code of Ordinances in surveying, dividing and mapping the same.

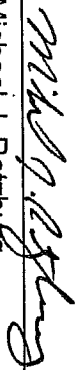

Michael J. Ratzburg, S-2236
Registered Wisconsin Land Surveyor

Date: 07/10/09

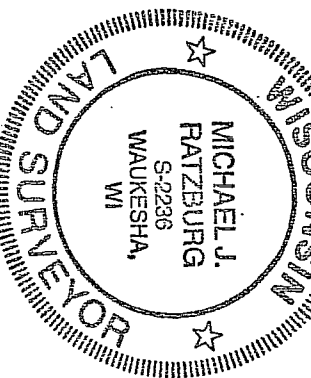

CORPORATE OWNER'S CERTIFICATE

Bishop's Creek Community Development Corporation, a corporation duly organized and existing under and by virtue of the laws of the State of Wisconsin, as owner, certify that said corporation caused the land described on this map to be surveyed, divided, mapped and dedicated as represented on this map in accordance with the requirements of Chapter 119 of the Milwaukee Code of Ordinances.

In consideration of the approval of the map by the Common Council and in accordance with Chapter 119 of the Milwaukee Code, the undersigned agrees:

- a. That all utility lines to provide electric power and telephone services and cable television or communications systems lines or cables to all lots in the certified survey map shall be installed underground in easements provided therefore, where feasible.
- b. That no lots created by this land division shall be conveyed, except in conformance with applicable zoning regulations.

CERTIFIED SURVEY MAP NO. _____

A division of Lot B of Block 21 of North Milwaukee Townsite Company's Addition No. 2, in the Northwest 1/4 of the Northeast 1/4, Section 1, Township 7 North, Range 21 East, in the City of Milwaukee, Milwaukee County, Wisconsin.

This agreement shall be binding on the undersigned and assigns.

In Witness Where of, the Bishop's Creek Community Development Corporation has caused these presents to be signed by Sedwikh Daniels, its President, at Milwaukee, Wisconsin, this 15 day of July, 2008.

In the presence of:

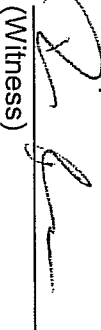
(Witness)

Bishop's Creek Community Development Corporation

STATE OF WISCONSIN)
) SS
Milwaukee COUNTY)

Personally came before me this 15 day of July, 2008, Sedwikh Daniels, President of the above named corporation, to me known as the person who executed the foregoing instrument, and to me known to be the resident and officer of the corporation, and acknowledged that they executed the foregoing instrument as such officers as the deed of the corporation, by its authority.

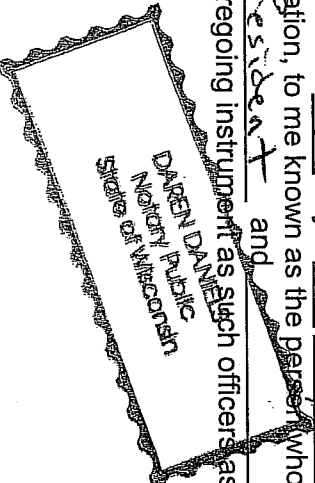

Daren Daniels
NOTARY PUBLIC, STATE OF WISCONSIN
My Commission Expires: 8/9/2009

OWNER'S CERTIFICATE

Bishop's Creek Family Housing, LLC, a limited liability company duly organized and existing under and by virtue of the laws of the State of Wisconsin, as owner, certify that said company caused the land described on this map to be surveyed, divided, mapped and dedicated as represented on this Certified Survey Map in accordance with the requirements of Chapter 119 of the Milwaukee Code of Ordinances.
In consideration of the approval of the map by the Common Council and in accordance with Chapter 119 of the Milwaukee Code, the undersigned agrees:

- a. That all utility lines to provide electric power and telephone services and cable television or communications systems lines or cables to all lots in the certified survey map shall be installed underground in easements provided therefore, where feasible.
- b. That no lots created by this land division shall be conveyed, except in conformance with applicable zoning regulations.

This agreement shall be binding on the undersigned and assigns.

In Witness Where of, the Bishop's Creek Family Housing, LLC, has caused these presents to be signed by Ellen Higgins, its Vice President, at Milwaukee, Wisconsin, this 17th day of July, 2008.

In the presence of: Bishop's Creek Family Housing, LLC
By Common Bond Investment Corporation, Manager

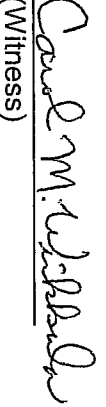
its Vice President

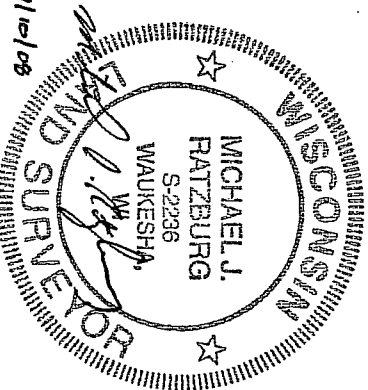
(Witness)



CERTIFIED SURVEY MAP NO. _____

A division of Lot B of Block 21 of North Milwaukee Townsite Company's Addition No. 2, in the Northwest 1/4 of the Northeast 1/4, Section 1, Township 7 North, Range 21 East, in the City of Milwaukee, Milwaukee County, Wisconsin.

STATE OF WISCONSIN)
) SS
MILWAUKEE COUNTY)

Personally came before me this 11th day of July, 2008, Ellen Higgins, ^{Vice} President of the above named corporation, to me known as the person who executed the foregoing instrument, and to me known to be the Vice President and _____ of the corporation, and acknowledged that they executed the foregoing instrument as such officers as the deed of the corporation, by its authority.

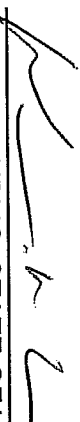
NOTARY PUBLIC, STATE OF WISCONSIN
My Commission Expires 12 permaent

CERTIFICATE OF THE CITY TREASURER

STATE OF WISCONSIN)
) SS
MILWAUKEE COUNTY)

I, Wayne F. Whitrow, being the duly elected, qualified and acting City Treasurer of the City of Milwaukee, certify that in accordance with the records in the office of the City Treasurer of the City of Milwaukee there are no unpaid taxes or unpaid special assessments on the land included in this certified survey map.

Date _____
Wayne F. Whitrow, City Treasurer

COMMON COUNCIL CERTIFICATE OF APPROVAL

I certify that this Certified Survey Map was approved under Resolution File No. _____ adopted by the Common Council of the City of Milwaukee on _____.

Ronald D. Leonhardt, City Clerk

Tom Barrett, Mayor

