



**CITY OF MILWAUKEE
OFFICE OF THE CITY CLERK**

Monday, July 11, 2022

COMMITTEE MEETING NOTICE

AD 03

CALHOUN, Kirlilah E, Agent
Juice Game LLC
2220 N Prospect Av
Milwaukee, WI 53202

You are requested to attend a virtual hearing to be held on:

Monday, July 18, 2022 at 10:30 AM

Regarding: Your Food Dealer License Application as agent for "Juice Game LLC" for "Kwench Juice" at 2220 N Prospect Av.

This meeting will be held via GoToMeeting. Please see the enclosed best practices document for further instructions. The access code is <https://meet.goto.com/293357997>. If you wish to call in, please call [+1 \(312\) 757-3121](tel:+13127573121) and use Access Code: 293-357-997.

There is a possibility that your application may be denied for one or more of the following reasons: The recommendation of the committee regarding the application shall be based on evidence presented at the hearing. Per MCO 85-2.7-4, probative evidence concerning whether or not a new license should be granted may be presented on the following subjects: whether or not the applicant meets the municipal requirements, the appropriateness of the location and premises where the licensed premises is to be located and whether use of the premises for the purposes or activities permitted by the license would tend to facilitate a public or private nuisance or create undesirable neighborhood problems such as disorderly patrons, unreasonably loud noise, litter, and excessive traffic and parking congestion. Probative evidence relating to these matters may be taken from the plan of operation submitted with the license application, if any, but shall not include the content of any music. Evidence regarding the fitness of the location of the premises to be maintained as the principal place of business, including but not limited to whether there is an overconcentration of businesses of the type for which the license is sought; whether the proposal is consistent with any pertinent neighborhood business or development plans, or the location's proximity to areas where children are typically present. The applicant's record in operating similarly licensed premises; and whether or not the applicant has been charged with or convicted of any felony, misdemeanor, municipal offense or other offense, the circumstances of which substantially relate to the activity to be permitted by the license being applied for or any other factor which reasonably relates to the public health, safety or welfare may also be considered. See attached police report or correspondence.

Notice for applicants with warrants or unpaid fines:

Proof of warrant satisfaction or payment of fines must be submitted at the hearing on the above date and time. Failure to comply with this requirement may result in a delay of the granting/denial of your application.

Failure to attend this meeting may result in the denial of your license. Individual applicants and partnership applicants must attend or attend by an attorney. The agent or attorney for corporate or limited liability applicants must attend. If you wish to do so and at your own expense, you may be accompanied by an attorney of your choosing to represent you at this hearing.

You will be given an opportunity to speak on behalf of the application and to respond and challenge any charges or reasons given for the denial. No petitions can be accepted by the committee, unless the people who signed the petition attend the virtual hearing and are willing to testify. You may present witnesses under oath and you may also confront and cross-examine opposing witnesses under oath. If you have difficulty with the English language, you should request an interpreter attend the meeting with you, at your expense, so that you can answer questions and participate in your hearing.

PLEASE NOTE: Upon reasonable notice, efforts will be made to accommodate the needs of disabled individuals through sign language interpreters or other auxiliary aids. For additional information or to request this service, contact the Council Services Division ADA Coordinator at (414) 286-2998, Fax - (414) 286-3456, TDD - (414) 286-2025.

JIM OWCZARSKI, CITY CLERK

BY: _____

Jim Cooney
License Division Manager

If you have questions regarding this meeting, please contact the staff assistant, Yadira Melendez at (414) 286-2775 or stas5@milwaukee.gov

200 E. Wells Street, Room 105, City Hall, Milwaukee, WI 53202. www.milwaukee.gov/license
Phone: (414) 286-2238 Fax: (414) 286-3057 Email Address: License@milwaukee.gov



CITY OF MILWAUKEE
OFFICE OF THE CITY CLERK

Monday, July 11, 2022

COMMITTEE MEETING NOTICE

AD 03

CALHOUN, Kirlilah E, Agent
Juice Game LLC
1918 E LAFAYETTE PL UNIT 1-1201
Milwaukee, WI 53202

You are requested to attend a virtual hearing to be held on:

Monday, July 18, 2022 at 10:30 AM

Regarding: Your Food Dealer License Application as agent for "Juice Game LLC" for "Kwench Juice" at 2220 N Prospect Av.

This meeting will be held via GoToMeeting. Please see the enclosed best practices document for further instructions. The access code is <https://meet.goto.com/293357997>. If you wish to call in, please call [+1 \(312\) 757-3121](tel:+13127573121) and use Access Code: 293-357-997.

There is a possibility that your application may be denied for one or more of the following reasons: The recommendation of the committee regarding the application shall be based on evidence presented at the hearing. Per MCO 85-2.7-4, probative evidence concerning whether or not a new license should be granted may be presented on the following subjects: whether or not the applicant meets the municipal requirements, the appropriateness of the location and premises where the licensed premises is to be located and whether use of the premises for the purposes or activities permitted by the license would tend to facilitate a public or private nuisance or create undesirable neighborhood problems such as disorderly patrons, unreasonably loud noise, litter, and excessive traffic and parking congestion. Probative evidence relating to these matters may be taken from the plan of operation submitted with the license application, if any, but shall not include the content of any music. Evidence regarding the fitness of the location of the premises to be maintained as the principal place of business, including but not limited to whether there is an overconcentration of businesses of the type for which the license is sought; whether the proposal is consistent with any pertinent neighborhood business or development plans, or the location's proximity to areas where children are typically present. The applicant's record in operating similarly licensed premises; and whether or not the applicant has been charged with or convicted of any felony, misdemeanor, municipal offense or other offense, the circumstances of which substantially relate to the activity to be permitted by the license being applied for or any other factor which reasonably relates to the public health, safety or welfare may also be considered. See attached police report or correspondence.

Notice for applicants with warrants or unpaid fines:

Proof of warrant satisfaction or payment of fines must be submitted at the hearing on the above date and time. Failure to comply with this requirement may result in a delay of the granting/denial of your application.

Failure to attend this meeting may result in the denial of your license. Individual applicants and partnership applicants must attend or attend by an attorney. The agent or attorney for corporate or limited liability applicants must attend. If you wish to do so and at your own expense, you may be accompanied by an attorney of your choosing to represent you at this hearing.

You will be given an opportunity to speak on behalf of the application and to respond and challenge any charges or reasons given for the denial. No petitions can be accepted by the committee, unless the people who signed the petition attend the virtual hearing and are willing to testify. You may present witnesses under oath and you may also confront and cross-examine opposing witnesses under oath. If you have difficulty with the English language, you should request an interpreter attend the meeting with you, at your expense, so that you can answer questions and participate in your hearing.

PLEASE NOTE: Upon reasonable notice, efforts will be made to accommodate the needs of disabled individuals through sign language interpreters or other auxiliary aids. For additional information or to request this service, contact the Council Services Division ADA Coordinator at (414) 286-2998, Fax - (414) 286-3456, TDD - (414) 286-2025.

JIM OWCZARSKI, CITY CLERK

BY: _____

Jim Cooney
License Division Manager

If you have questions regarding this meeting, please contact the staff assistant, Yadira Melendez at (414) 286-2775 or stas5@milwaukee.gov

200 E. Wells Street, Room 105, City Hall, Milwaukee, WI 53202. www.milwaukee.gov/license
Phone: (414) 286-2238 Fax: (414) 286-3057 Email Address: License@milwaukee.gov

MILWAUKEE POLICE DEPARTMENT

LICENSING

CRIMINAL RECORD/ORDINANCE VIOLATION/INCIDENTS SYNOPSIS

DATE: 07/08/22
LICENSE TYPE: FOOD
NEW:
RENEWAL:

No. 340010
Application Date: 07/07/22

License Location: 2220 N. Prospect Avenue
Business Name: Juice Game

Licensee/Applicant: CALHOUN, Kiriliah E.
(Last Name, First Name, MI)

Date of Birth: 01/30/1978

Home Address: 1918 E. Lafayette Place #1201
City: Milwaukee State: WI Zip Code: 53202
Home Phone: 708-898-8441

This report is written by Police Officer Corstan D. COURT, assigned to the License Investigation Unit, Days.

The Milwaukee Police Department's investigation regarding this application revealed the following:

1. The applicant was found guilty on 12/19/21 in Illinois for Implied Consent.



Monday, July 11, 2022



Notice of Public Hearing

Blank Notice

CALHOUN, Kiriliah E
Kwench Juice at 2220 N Prospect Av.
Food Dealer License Application

Monday, July 18, 2022 at 10:30 AM

To whom it may concern:

The above application has been made by the above named applicant(s). This requires approval from the Licenses Committee and the Common Council of the City of Milwaukee. The hearing before the Licenses Committee will take place virtually on 07/18/2022 at 10:30 AM. This is a public hearing. Those wishing to view the proceeding are able to do so via the City Channel – Channel 25 on Spectrum Cable – or on the Internet at <http://city.milwaukee.gov/citychannel>. Those wishing to provide oral testimony will be asked to do so by phone or internet and are asked to contact the staff assistant, Yadira Melendez at (414) 286-2775 or stasst5@milwaukee.gov for necessary information. Please make such requests no later than one business day prior to the start of the meeting. You are not required to attend the hearing, but please see the information below if you would like to provide testimony. Once the Licenses Committee makes its recommendation, this recommendation is forwarded to the full Common Council for approval at its next regularly scheduled hearing.

Important details for those wishing to provide information for the Licenses Committee to consider when making its recommendation:

1. The license application is scheduled to be heard at the above time. Due to other hearings running longer than scheduled, you may have to wait some time to provide your testimony.
2. You must testify as to matters that you have personally experienced or seen. (You cannot provide testimony for your neighbor, parent or anyone else; this is considered hearsay and cannot be considered by the committee.)
3. No letters or petitions can be accepted by the committee (unless the person who wrote the letter or the persons who signed the petition are willing to testify).
4. Persons opposed to the license application are given the opportunity to testify first; supporters may testify after the opponents have finished.
5. When you are called to testify, you will be sworn in and asked to give your name, and address. (If your first and/or last names are uncommon please spell them.)
6. You may then provide testimony.
 - a. Include only information relating to the above license application.
 - b. Include only information you have personally witnessed or seen.
 - c. Provide concise and relevant information detailing how this business has affected or may affect the peaceful enjoyment of your neighborhood.
 - d. If by the time you have the opportunity to testify, the information you wish to share has already been provided to the committee, you may state that you agree with the previous testimony. Redundant or repetitive testimony will not assist the committee in making its recommendation.
7. After giving your testimony, the members of the Licenses Committee and the licensee may ask questions regarding the testimony you have given or other factors relating to the license application.
8. Business Competition is not a valid basis for denial or non-renewal of a license.

Please Note: If you have submitted an objection to the above application your objection cannot be considered by the committee unless you personally testify at the hearing.

CURRENT OCCUPANT	2244 N PROSPECT AVE, 21	MILWAUKEE, WI 53202-6309
CURRENT OCCUPANT	2244 N PROSPECT AVE, 22	MILWAUKEE, WI 53202-6309
CURRENT OCCUPANT	2244 N PROSPECT AVE, 23	MILWAUKEE, WI 53202-6309
CURRENT OCCUPANT	2244 N PROSPECT AVE, 24	MILWAUKEE, WI 53202-6309
CURRENT OCCUPANT	2244 N PROSPECT AVE, 25	MILWAUKEE, WI 53202-6309
CURRENT OCCUPANT	2244 N PROSPECT AVE, 26	MILWAUKEE, WI 53202-6309
CURRENT OCCUPANT	2244 N PROSPECT AVE, 27	MILWAUKEE, WI 53202-6309
CURRENT OCCUPANT	2244 N PROSPECT AVE, 28	MILWAUKEE, WI 53202-6309
CURRENT OCCUPANT	2244 N PROSPECT AVE, 29	MILWAUKEE, WI 53202-6309
CURRENT OCCUPANT	2244 N PROSPECT AVE, 3	MILWAUKEE, WI 53202-6309
CURRENT OCCUPANT	2244 N PROSPECT AVE, 30	MILWAUKEE, WI 53202-6309
CURRENT OCCUPANT	2244 N PROSPECT AVE, 31	MILWAUKEE, WI 53202-6309
CURRENT OCCUPANT	2244 N PROSPECT AVE, 32	MILWAUKEE, WI 53202-6309
CURRENT OCCUPANT	2244 N PROSPECT AVE, 33	MILWAUKEE, WI 53202-6309
CURRENT OCCUPANT	2244 N PROSPECT AVE, 34	MILWAUKEE, WI 53202-6309
CURRENT OCCUPANT	2244 N PROSPECT AVE, 35	MILWAUKEE, WI 53202-6309
CURRENT OCCUPANT	2244 N PROSPECT AVE, 36	MILWAUKEE, WI 53202-6309
CURRENT OCCUPANT	2244 N PROSPECT AVE, 37	MILWAUKEE, WI 53202-6309
CURRENT OCCUPANT	2244 N PROSPECT AVE, 38	MILWAUKEE, WI 53202-6309
CURRENT OCCUPANT	2244 N PROSPECT AVE, 39	MILWAUKEE, WI 53202-6309
CURRENT OCCUPANT	2244 N PROSPECT AVE, 4	MILWAUKEE, WI 53202-6309
CURRENT OCCUPANT	2244 N PROSPECT AVE, 40	MILWAUKEE, WI 53202-6309
CURRENT OCCUPANT	2244 N PROSPECT AVE, 41	MILWAUKEE, WI 53202-6309
CURRENT OCCUPANT	2244 N PROSPECT AVE, 5	MILWAUKEE, WI 53202-6309
CURRENT OCCUPANT	2244 N PROSPECT AVE, 6	MILWAUKEE, WI 53202-6309
CURRENT OCCUPANT	2244 N PROSPECT AVE, 7	MILWAUKEE, WI 53202-6309
CURRENT OCCUPANT	2244 N PROSPECT AVE, 8	MILWAUKEE, WI 53202-6309
CURRENT OCCUPANT	2244 N PROSPECT AVE, 9	MILWAUKEE, WI 53202-6309
CURRENT OCCUPANT	2247 N SUMMIT AVE	MILWAUKEE, WI 53202-1245
CURRENT OCCUPANT	2247A N SUMMIT AVE	MILWAUKEE, WI 53202-1245
CURRENT OCCUPANT	2249 N SUMMIT AVE	MILWAUKEE, WI 53202-1245
CURRENT OCCUPANT	2251 N SUMMIT AVE	MILWAUKEE, WI 53202-1245
CURRENT OCCUPANT	2253 N SUMMIT AVE	MILWAUKEE, WI 53202-1245
CURRENT OCCUPANT	2257 N SUMMIT AVE	MILWAUKEE, WI 53202-1245
CURRENT OCCUPANT	2263 N SUMMIT AVE	MILWAUKEE, WI 53202-1245
CURRENT OCCUPANT	2263 N SUMMIT AVE, A	MILWAUKEE, WI 53202-1245
CURRENT OCCUPANT	2263 N SUMMIT AVE, B	MILWAUKEE, WI 53202-1245

Blank Notice

Total Records: 412

Radius 250.0 feet and Center of Circle: 2220 N Prospect Av



BUSINESS LICENSE PLAN OF OPERATION

ccl-busplan 5/12/2020

Office of the City Clerk License Division
200 E. Wells St. Room 105, Milwaukee, WI 53202
(414) 286-2238 www.milwaukee.gov/license e-mail address: license@milwaukee.gov

1. Type of Business

- Applying for: Extended Hours (12AM to 5AM) - If a food establishment, check all that apply: Delivery Drive Thru Dining Room
 Self Service Laundry Massage Establishment Filling Station
 Other (supplemental application for specific license also required)

Provide a detailed description of the type of business you plan on operating:

Fresh Squeezed Juices and Smoothies

Do you have any experience operating this type of business? No Yes If yes, explain:

worked at many restaurants

2. Business Operations

- a. Proposed Opening Date: ASAP
- b. Is this premise under construction? No Yes If yes, list estimated completion date: _____
- c. Is this a franchise? No Yes
- d. Is this premises currently licensed? No Yes If yes, list type of license: _____
- e. Is the current licensee operating? No Yes If no, list date closed: _____
- f. Do you have future plans for other businesses, licenses or permits at this location? No Yes
If yes, explain: _____
- g. Have you previously held an Extended Hours License in Milwaukee? No Yes
If yes, list address(es): _____
- h. Are other businesses operating in the same building? No Yes If yes, describe: _____

3. Litter & Noise

- a. How are grounds kept clean? Sweep Pressure Wash Pick Up Litter Other: _____
- b. How often will grounds be cleaned? Daily Weekly As Needed Monthly Other: _____
- c. Grounds cleaned by: Licensee Building Owner Employees Hired Maintenance Other: _____
- d. How are noise issues prevented and/or addressed? Security Manager approaches customer(s) Call Police
 Signs Posted Other: _____
- e. Will a sound amplification system be used? No Yes If yes, describe: _____

4. Smoking & Sanitation

- a. Are there designated outdoor smoking areas? No Yes If yes, describe: _____
- b. Number of Garbage Cans: Inside: 2 Locations: Around store
Outside: 1 Locations: In front of store
- c. Is a crowd control barrier used? No Yes If yes, describe: _____
- d. How many restrooms are on the premises? 1
- e. Name of solid waste contractor: Advanced Disposal Waste Management Other: _____

5. Security

a. Are there onsite parking spaces? No Yes If yes, how many? _____ and describe the parking security plan: _____

b. Is there a loading zone? No Yes If yes, describe the loading area security plan: _____

c. Will you have security personnel on premise? No Yes If yes, how many? _____ and answer the following:

What are their responsibilities? _____
 Is security equipment used? No Yes If yes, describe _____
 List their licensing, certification, or training credentials TBD

d. Will there be security cameras? No Yes (if yes, how many? 4 and list locations: _____)

e. Will searches/identification checks be done upon entry? No Yes If yes, describe front door, rear door, above cashier station and prep fruit area

6. Percentage of Sales (must total 100%)

Alcohol <u>0</u> %	Food <u>100</u> %	Secondhand Merchandise <u>0</u> %	Precious Metals & Gems <u>0</u> %
Entertainment _____ %	Cigarettes _____ %	Personal Services (such as tattoo, body piercing, salon, tailor, tanning, etc.) <u>0</u> %	Other _____ %
Pawnbroker Activity <u>0</u> %	Salvaged Materials (such as scrap metal) <u>0</u> %	Describe: _____	

7. Businesses/Licenses on the Premises (check all that apply):

- Type 1
- Full Service Restaurant
 - Cafe/Coffee Shop
 - Deli or Fast Food Restaurant
 - Private/Fraternal/Veterans Club
 - Night Club
 - Tavern
 - Cocktail Lounge
 - Teen Club
 - Banquet Hall
 - Sports Facility
 - Bowling Alley
 - Hotel/Motel: Number of Floors: _____ Number of Rooms: _____
 - Rooming House: Number of Floors: _____ Number of Rooms: _____

- Type 2
- Liquor Store
 - Corner Store
 - Supermarket
 - Convenience Store
 - Gas Station
 - Amusement/Phonograph Distributor
 - Recycling, Salvage or Towing
 - Used Car Dealer
 - Personal Service Establishment (such as tattoo business, hair salon, tailor, etc.)
 - Recording Studio

What other licenses/permits will you hold at this location? (check all that apply)

- Occupancy Permit
- Cigarette & Tobacco
- Gas Station
- Extended Hours
- Class "B" Tavern
- Weights & Measures
- Secondhand Dealer
- Precious Metal & Gem
- Other: _____

8. Legal Capacity (only if a Type 1 premises in #7 above)

Capacity _____ (Call the Milwaukee Development Center at 414-286-8211 if you have questions.)

9. Premises Description

a. Identify all area(s) of the premises that will be used in operating this business (include areas used only for storage):

1st Floor 2nd Floor Basement Storage Patio Beer Garden Sidewalk Café Deck Rooftop

Other: Describe: _____

b. Describe Location: Major Thoroughfare Secondary Street Other: _____

c. Nearest Major Cross Street: 2. Ivanhoe Place

d. Describe Building: Free Standing Building Strip Mall Other: multi-unit Resid/comm

e. Describe Premises Structure: Single Story Multi-Story All of Stories Other: _____

f. Describe Surrounding Area: Commercial Residential Industrial Other: _____

g. Building Owner Name: Nathan Bernstein Phone Number: (414) 988-7883

Building Owner Address: 11711 Jefferson St - Suite 200

www.sosrhppropertydevelopment.com

10. Hours of Operation & Customers

Will customers be entering the premises? Yes

Day of the Week	Proposed Hours of Operation:		Estimated Number of Customers expected each day	Potential Age Range of Customers	Class B Tavern Applicant Only: Age Restriction (If none, write 'None')
	Open Time (Include a.m. or p.m.)	Close Time (Include a.m. or p.m.)			
Sunday	10 AM	5:00 PM	50+	21-60	None
Monday	8:00 AM	2:00 PM	↓		↓
Tuesday	8:00 AM	6:00 PM			
Wednesday	8:00 AM	6:00 PM			
Thursday	8:00 AM	6:00 PM			
Friday	8:00 AM	6:00 PM			
Saturday	10 AM	5:00 PM			

An Extended Hours Establishment License is required for any convenience store, filling station, personal service establishment (such as tattoo, body piercing, salon, tailor, tanning, etc.), recording studio or restaurant which is open between the hours of 12:00 a.m. and 5:00 a.m.

Alcohol Establishments Permitted Hours of Operation: Class A: 8:00 am to 9:00 pm Sunday thru Saturday
Class B: 6:00 am to 2:00 am Sunday thru Thursday, 6:00 am to 2:30 am Friday & Saturday

Entertainment Outdoor Closing Hours: 10:00 pm Sunday-Thursday, 12:00 am Friday & Saturday, unless a different time, either earlier or later, is established by the Common Council in its approval of the licensee's plan of operation.

11. Signature(s)

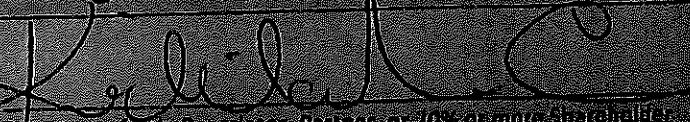

Signature of Sole Proprietor, Partner, or 70% or more shareholder
(If there are no 70% or more shareholders,
Corporate Officer print name/title and sign)

Signature of additional partner or 20% or more shareholder

See Application Information for a complete list of all required application forms.



FOOD DEALER LICENSE PLAN OF OPERATION

ccl-foodplan 2/28/19

OFFICE OF THE CITY CLERK, LICENSE DIVISION
CITY HALL, 200 E. WELLS ST, ROOM 105, MILWAUKEE, WI 53202
(414) 286-2238 • license@milwaukee.gov • www.milwaukee.gov/license

Legal Entity Name: Juice Game LLC
Premises Address: 2220 N. Prospect Ave

SECTION 1 TYPE OF BUSINESS Milwaukee, WI

What will be the majority of your food sales? (check one)

53202

Restaurant Items (meals):

MEALS include, but are not limited to, chicken, ribs, sandwiches, roasted corn, baked potatoes, hot dogs, brats, tacos, nachos w/ cheese and meat, French fries, cooked or deep fried vegetables/fruit, cooked cheese curds, corn dogs, egg rolls, salads.

Retail Items (snacks and beverages):

RETAIL items include, but are not limited to, ice cream/soft serve, lemonade, snow cones, coffee, espresso, cappuccino, tea, fruit juice, smoothies, candy, dispensed soda, fruit cups, bakery, cookies, kettle corn, cotton candy, funnel cakes, fritters, tortilla chips w/ cheese.

Will it be a convenience store? Yes No

A convenience store contains less than 5,000 square feet of retail space and has, as its primary business, the sale of basic food items and in addition, sells household products or is a filling station that sells basic food items and household products.

Bed & Breakfast

Micro Market

All Applicants: Submit a menu or a list of food items that will be sold.

Will any wholesale business be done? No Yes If yes, what percentage of food sales will be wholesale?

Less than 25%

25% or More AND:

Restaurant items (meals) will be sold - Complete this application and also contact DATCP.

NO restaurant items (meals) will be sold - Do NOT complete this application. Contact DATCP only.

SECTION 2 FOOD PROCESSING

Will any food processing be done? No Yes

Processing is defined as assembling, grinding, cutting, mixing, baking, coating, stuffing, packing, bottling, grilling, canning, extracting, fermenting, distilling, pickling, freezing, drying, smoking, or packaging.

SECTION 3 FOOD REQUIRING TEMPERATURE CONTROL

Will any food that requires temperature control be sold? No Yes
(includes dairy products such as milk, cheese, and ice cream, fish, shellfish, meat, poultry)

If yes, list the types of food items: _____

SECTION 4 DETAILS OF OPERATION

Will you have seating on site for dining? No Yes

Will you be doing any catering? No Yes

Will you be doing any delivery? No Yes

Will you have outdoor activities? No Yes - Check all that apply: Bar Cooking/Grilling Dining

Will you have a drive thru window? No Yes - Are hours different from inside? No Yes
 If Yes, provide drive thru hours: _____

Will scales or barcode scanners be used? No Yes - You must also apply for a Weights & Measures License.

SECTION 5 ADDITIONAL SITES

Where will food be prepared and/or sold?
 At a single site At multiple sites: How many? _____ (for example, a hotel with several dining rooms or bars)
 If multiple sites, attach a Food Dealer Additional Site Addendum (ccl-foodadd) for each additional site.

SECTION 6 CONSTRUCTION OR CHANGES

Are you planning any construction, remodeling or equipment changes?
 No If No, SKIP to Section 8
 Yes If Yes, check all that apply: New construction of a building Renovation or remodeling
 Construction changes to existing building Equipment changes only

Provide a brief description of the changes: Per Plans

Start date: _____

Name, Address & Phone Number of Architect: Logic Design Architecture Inc
802 N. 109th St
Helwaukee, WI

Name, Address & Phone Number of Contractor: ADAM Stein
(414) 909-0880

SECTION 7 ALCOHOL BEVERAGES

Are you applying for an alcohol beverage license?
 No If No, SKIP to Section 8
 Yes If YES, if your food license is approved prior to the alcohol license, when do you want the food license issued?
 Immediately At the same time as the alcohol license

SECTION 8 ACKNOWLEDGEMENTS & SIGNATURE

You must initial each item confirming your understanding:

- KC I understand the Health Department must conduct an inspection and advise the License Division of their approval before the license may be issued.
- KC I understand I must obtain an occupancy permit from the Department of Neighborhood Services and an inspection may be required. Neighborhood Services must advise the License Division of their approval before the license may be issued.
- KC I understand the district alderperson will review and either support or object to my application. If he/she objects, I may appeal and be scheduled to appear before the Licenses Committee. The Licenses Committee will then make a recommendation to the Common Council. The Common Council must grant the license before it may be issued.
- KC I understand proof of payment for all license fees must be on file in the License Division before the license may be issued and the license must be issued and posted in my establishment prior to opening for business.
- KC I will not operate my food business until the license has been issued and posted in the establishment.

Signature of Sole Proprietor, Partner, or 20% Shareholder: [Handwritten Signature]

Signature of Additional Partner: _____

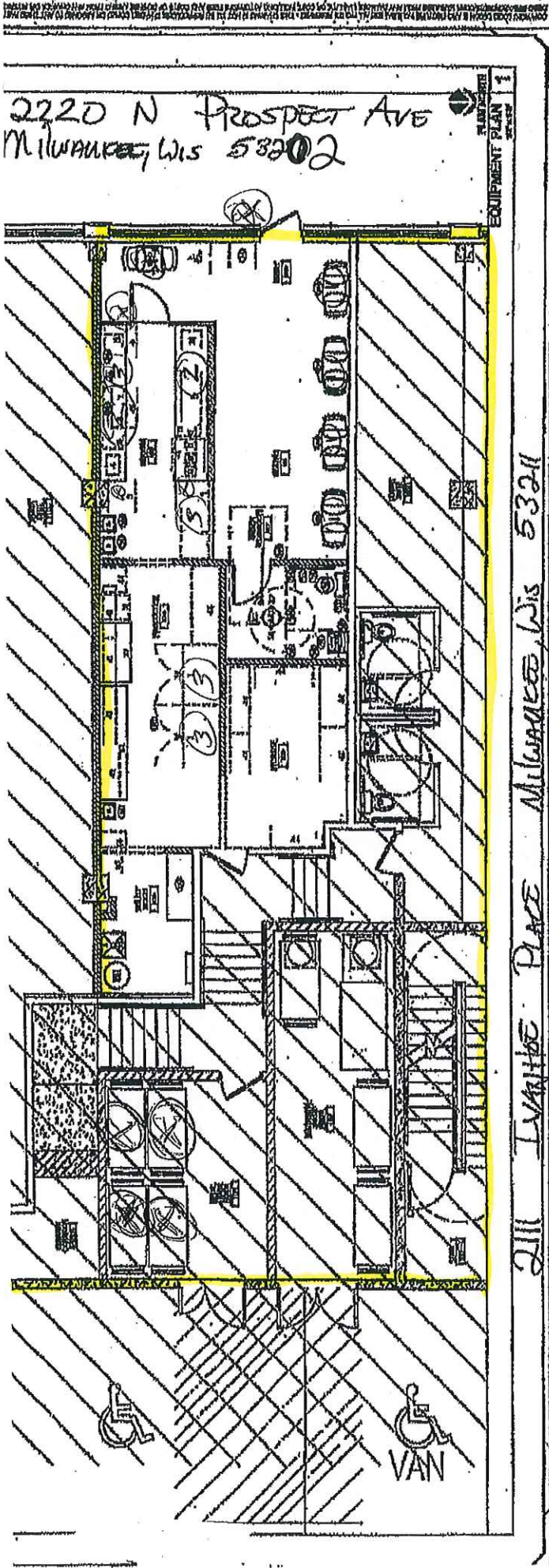

SCALE 1/4" = 1'0"

KIRUBAH CARTOUN / KUDRACH SWICZ JUICE GAME LLC
 2220 N PROSPECT AVE CARZ
 MILWAUKEE, WIS 53202

KEY

- ① SEATING AREA
- ② = FOOD PREPARATION AREA / COUNTER TOP
- ③ DISPLAYED / STORED
- ⊗ = GAME AREA

SQFT = 1030

WIDTH = 85 FT + 11 INCH

DEPTH = 12 FT + 2 INCH

⊗ = GAME AREA
 NOT EXACT
 BEARING

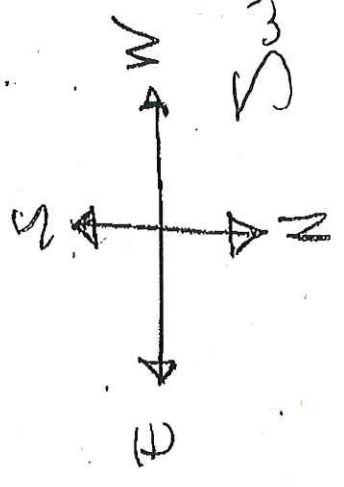

Swiss

2027

Power Juices

Regular 16 oz. \$8 | Large 24 oz. \$10

Bucks (285/428)

beet, carrot, celery, ginger, lemon & hemp protein

Brewers (265/398)

apple, cucumber, lemon, wheatgrass & bee pollen

Miller Valley (265/398)

celery, pineapple, cucumber, pear, wheatgrass, spirulina

River Walk (285/428)

apple, apple, mint, kale, spinach & whey protein

Vitamin C (204/306)

orange, lemon, lime, grapefruit

Superfood Choices

- Amla Berry \$1
- Baobab
- Bee Pollen
- Cacao Nibs/Powder
- Chia Seeds
- Chlorella
- Collagen
- Flax Seeds
- Goji Berries/Powder
- Hemp
- Lucuma
- Maca
- Sea Moss Powder
- Sea Moss Gel
- Spirulina
- Whey Protein
- Chocolate Whey
- Vanilla Whey

Juice Cleanse

\$44.99

- consist of -

5 regular juices and

1 large smoothie or another juice

16 oz. \$7 | 24 oz. \$9

Berry Blast (163/244)

banana, blackberry, strawberry, blueberry, raspberry, coconut water

Green Goblin (224/336)

avocado, banana, apple, celery, spinach, agave, liquid choice

Cacao Fix (241/361)

avocado, banana, cacao powder, honey, liquid choice

Beach Bomb (190/285)

blueberry, blackberry, banana, strawberry, kiwi, grapefruit juice

Tropical Infusion (195/293)

banana, mango, pineapple, strawberry, orange

Namaste (233/349)

kale, banana, spinach, lemon, mango, apple juice

Green Wave (256/384)

banana, kiwi, kale, spinach, celery, liquid choice

Replenish (185/278)

banana, strawberry, liquid choice

Kwench (213/320)

banana, strawberry, blackberry, raspberry, pineapple, apple juice

Beast Mode (242/363)

banana, kale, spinach, cacao, butter choice, liquid choice

Old Fashioned (265/398)

banana, strawberry, raspberry, granola, almonds, agave, liquid choice

Evolution (238/398)

banana, dates, cacao, agave, butter choice, liquid choice

Superman (224/336)

banana, mango, pineapple, kiwi, strawberry, raspberry, liquid choice

Create Your Own

customize your own raw smoothie

Add ins

\$1

Liquid: • Almond Milk (vanilla or regular)

• Oat Milk

• Coconut Water

• Peanut butter

• Almond butter

• Nutella



~~16 oz. \$10~~

Rainbow Bowl (330)

Base: açai/pitaya, blueberry, banana, (liquid choice)
Toppings: goji berries & cacao nibs

Milwaukie Bowl (325)

Base: açai/pitaya, banana, strawberry, (butter & liquid choice)
Toppings: granola & choice of berries

Market Bowl (315)

Base: açai/pitaya, raspberry, blueberry, banana, (liquid choice)
Toppings: banana, shredded coconut, & granola

Kwench Bowl (330)

Base: açai/pitaya, banana, kiwi, strawberry, (liquid choice)
Toppings: granola, almonds, & choice of berries

Dragon Bowl (320)

Base: açai/pitaya, banana, strawberry, pineapple, (liquid choice)
Toppings: kiwi, blackberry, & granola

Cacao Bowl (320)

Base: açai/pitaya, banana, strawberry, cacao, (liquid choice)
Toppings: shredded coconut, banana, & cacao nibs

Tropical Bowl (310)

Base: açai/pitaya, banana, mango, pineapple, (liquid choice)
Toppings: kiwi & shredded coconut

Create Your Own

Customize your own açai or pitaya bowl

Grab & GO

Banana Bread Energy Bites \$4.50

banana, peanut butter, honey, pecans, chia, cinnamon, oats, chocolate chips

Blueberry Energy Bites \$4.50

blueberries, dates, oats, chia, lemon, monk fruit

Peanut Butter Energy Bites \$4.50

peanut butter, chocolate chips, oats, coconut, flaxseed, chia, honey

Shrimp & Cacao Bars \$4.50

dates, almonds, pecans, cashews, coconut flakes, cinnamon, blueberries, cherries

Chocolate Chia Pudding \$4.50

dates, chia, cashews, agave coconut, cacao powder

Steel Cut Oats \$4.50

steel cut oats, dates, cashews coconut oil, agave

Power Juices

Regular 16 oz. \$8 | Large 24 oz. \$10

Bucks (285/428)

beet, carrot, celery, ginger, lemon & hemp protein

Brewers (265/398)

le, cucumber, carrot, lemon, wheatgrass & bee pollen

Miller Valley (265/398)

nach, pineapple, cucumber, pear, wheatgrass, spirulina

River Walk (285/428)

eapple, apple, mint, kale, spinach & whey protein

Vitamin C (204/306)

orange, lemon, lime, grapefruit

Superfood Choices

- Amla Berry \$1
- Baobab
- Bee Pollen
- Cacao Nibs/Pwdr
- Chia Seeds
- Chlorella
- Collagen
- Flax Seeds
- Goji Berries/Pwdr
- Hemp
- Lucuma
- Maca
- Sea Moss Pwdr
- Sea Moss Gel
- Spirulina
- Whey Protein
- Chocolate Whey
- Vanilla Whey



Juice Cleanse

\$44.99

~ consist of ~

5 regular juices and 1 large smoothie or another juice

16 oz. \$7 | 24 oz. \$9

Berry Blast (163/244)

banana, blackberry, strawberry, blueberry, raspberry, coconut water

Green Goblin (224/336)

avocado, banana, apple, celery, spinach, agave, liquid choice

Cacao Fix (241/361)

avocado, banana, cacao powder, honey, liquid choice

Beach Bomb (190/285)

blueberry, blackberry, banana, strawberry, kiwi, grapefruit juice

Tropical Infusion (195/293)

banana, mango, pineapple, strawberry, orange

Namaste (233/349)

kale, banana, spinach, lemon, mango, apple juice

Green Wave (256/384)

banana, kiwi, kale, spinach, celery, liquid choice

Replenish (185/278)

banana, strawberry, liquid choice

Kwench (213/320)

banana, strawberry, blackberry, raspberry, pineapple, apple juice

Beast Mode (242/363)

banana, kale, spinach, cacao, butter choice, liquid choice

Old Fashioned (265/398)

banana, strawberry, raspberry, granola, almonds, agave, liquid choice

Evolution (238/398)

banana, dates, cacao, agave, butter choice, liquid choice

Superman (224/336)

banana, mango, pineapple, kiwi, strawberry, raspberry, liquid choice

Create Your Own

customize your own raw smoothie

Add ins

\$1

Liquid: • Almond Milk (vanilla or regular)

• Oat Milk

• Coconut Water

• Peanut butter

• Almond butter

• Nutella



16 oz. \$10

Rainbow Bowl (330)

Base: açai/pitaya, blueberry, banana, (liquid choice)
Toppings: goji berries & cacao nibs

Milwaukeee Bowl (325)

Base: açai/pitaya, banana, strawberry, (butter & liquid choice)
Toppings: granola & choice of berries

Market Bowl (315)

Base: açai/pitaya, raspberry, blueberry, banana, (liquid choice)
Toppings: banana, shredded coconut, & granola

Kwench Bowl (330)

Base: açai/pitaya, banana, kiwi, strawberry, (liquid choice)
Toppings: granola, almonds, & choice of berries

Dragon Bowl (320)

Base: açai/pitaya, banana, strawberry, pineapple, (liquid choice)
Toppings: kiwi, blackberry, & granola

Cacao Bowl (320)

Base: açai/pitaya, banana, strawberry, cacao, (liquid choice)
Toppings: shredded coconut, banana, & cacao nibs

Tropical Bowl (310)

Base: açai/pitaya, banana, mango, pineapple, (liquid choice)
Toppings: kiwi & shredded coconut

Create Your Own

Customize your own açai or pitaya bowl

Grab & GO

Banana Bread Energy Bites \$4.50

banana, peanut butter, honey, pecans, chia, cinnamon, oats, chocolate chips

Blueberry Energy Bites \$4.50

blueberries, dates, oats, chia, lemon, monk fruit

Peanut Butter Energy Bites \$4.50

peanut butter, chocolate chips, oats, coconut, flaxseed, chia, honey

Superfood Bars \$4.50

dates, almonds, pecans, cashews, coconut flakes, cinnamon, blueberries, cherries

Chocolate Chia Pudding \$4.50

dates, chia, cashews, agave coconut, cacao powder

Steel Cut Oats \$4.50

steel cut oats, dates, cashews coconut oil, agave