



LIVING WITH HISTORY

Certificate of Appropriateness

Milwaukee Historic Preservation Commission/200 E. Wells Street/Milwaukee, WI 53202/phone 414-286-5712/fax 414-286-3004

Property 2635 N. TERRACE AV. North Point North Historic District
Description of work Remove existing garage doors on rear elevation of house. Install new all wood overhead garage doors made to look like swinging of sliding doors.
Date issued 4/27/2012 PTS ID 79614 COA, new garage doors

In accordance with the provisions of Section 320-21 (11) and (12) of the Milwaukee Code of Ordinances, the Milwaukee Historic Preservation Commission has issued a certificate of appropriateness for the work listed above. The work was found to be consistent with preservation guidelines. The following conditions apply to this certificate of appropriateness:

All work will be done according to attached photos and drawings. Doors will be painted or stained upon completion.

All work must be done in a craftsman-like manner, and must be completed within one year of the date this certificate was issued. Staff must approve any changes or additions to this certificate before work begins. Work that is not completed in accordance with this certificate may be subject to correction orders or citations. If you require technical assistance, please contact Paul Jakubovich of the Historic Preservation department as follows: Phone: (414) 286-5712 Fax: (414) 286-3004 E-mail: pjakub@milwaukee.gov.

If permits are required, you are responsible for obtaining them from the Milwaukee Development Center. If you have questions about permit requirements, please consult the Development Center's web site, www.mkedcd.org/build, or call (414) 286-8210.

Paul Jakubovich
City of Milwaukee Historic Preservation

Copies to: Development Center, Ald. Nik Kovac, contractor Geis Door, Inspector Please call (286-2513); Inspector Heidi Weed



Remove existing overhead doors on rear elevation

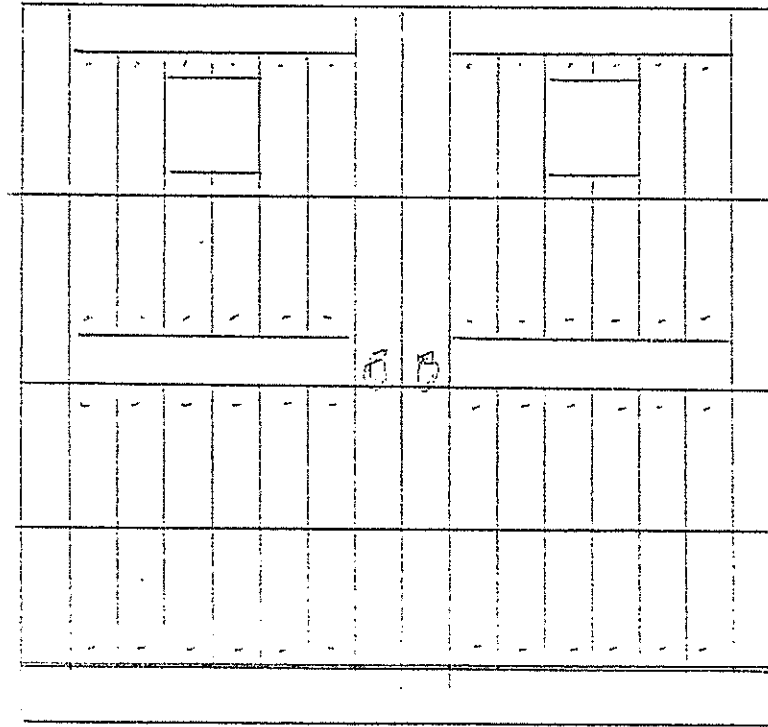

New, all wood overhead doors made to look like swinging or sliding doors to be installed in place of existing overhead doors on rear elevation of house. New doors must fill the original openings. (No blocking down of the doors)