



CITY OF MILWAUKEE  
OFFICE OF THE CITY CLERK

Wednesday, November 16, 2016

COMMITTEE MEETING NOTICE

AD 15

QANDEEL, Salah, Agent  
Y & A Food Inc  
2672 N 35th St

Milwaukee, WI 53210

You are requested to attend a hearing which is to be held in Room 301-B,  Floor, City Hall on:

**Tuesday, November 29, 2016 at 10:15 AM**

**Regarding:** Your Class A Malt, Food Dealer, and Weights & Measures License Applications as agent for "Y & A Food Inc" for "Alliance Super Food Market" at 2672 N 35th St.

There is a possibility that your application may be denied for one or more of the following reasons: The recommendation of the committee regarding the application shall be based on evidence presented at the hearing. Per MCO 85-2.7-4, probative evidence concerning whether or not a new license should be granted may be presented on the following subjects: whether or not the applicant meets the municipal requirements, the appropriateness of the location and premises where the licensed premises is to be located and whether use of the premises for the purposes or activities permitted by the license would tend to facilitate a public or private nuisance or create undesirable neighborhood problems such as disorderly patrons, unreasonably loud noise, litter, and excessive traffic and parking congestion. Probative evidence relating to these matters may be taken from the plan of operation submitted with the license application, if any, but shall not include the content of any music. Evidence regarding the fitness of the location of the premises to be maintained as the principal place of business, including but not limited to whether there is an overconcentration of businesses of the type for which the license is sought; whether the proposal is consistent with any pertinent neighborhood business or development plans, or the location's proximity to areas where children are typically present. The applicant's record in operating similarly licensed premises; and whether or not the applicant has been charged with or convicted of any felony, misdemeanor, municipal offense or other offense, the circumstances of which substantially relate to the activity to be permitted by the license being applied for or any other factor which reasonably relates to the public health, safety or welfare may also be considered. See attached police report or correspondence.

**Notice for applicants with warrants or unpaid fines:**

**Proof of warrant satisfaction or payment of fines must be submitted at the hearing on the above date and time. Failure to comply with this requirement may result in a delay of the granting/denial of your application.**

Failure to appear at this meeting may result in the denial of your license. Individual applicants must appear only in person or by an attorney. Corporate or Limited Liability applicants must appear only by the agent designated on the application or by an attorney. Partnership applicants must appear by a partner listed on the application or by an attorney. If you wish to do so and at your own expense, you may be accompanied by an attorney of your choosing to represent you at this hearing.

You will be given an opportunity to speak on behalf of the application and to respond and challenge any charges or reasons given for the denial. No petitions can be accepted by the committee, unless the people who signed the petition are present at the committee hearing and willing to testify. You may present witnesses under oath and you may also confront and cross-examine opposing witnesses under oath. If you have difficulty with the English language, you should bring an interpreter with you, at your expense, so that you can answer questions and participate in your hearing.

You may examine the application file at this office during regular business hours prior to the hearing date. Inquiries regarding this matter may be directed to the person whose signature appears below.

Limited parking for persons attending meetings in City Hall is available at reduced rates (5 hour limit) at the Milwaukee Center on the southwest corner of East Kilbourn and North Water Street. Parking tickets must be validated in the first floor information booth in City Hall.

PLEASE NOTE: Upon reasonable notice, efforts will be made to accommodate the needs of disabled individuals through sign language interpreters or other auxiliary aids. For additional information or to request this service, contact the Council Services Division ADA Coordinator at (414) 286-2998, Fax - (414) 286-3456, TDD - (414) 286-2025.

JIM OW CZARSKI, CITY CLERK

BY:   
\_\_\_\_\_  
Jason Schunk  
License Division Manager

**If you have questions regarding this notice, please contact the License Division at (414) 286-2238.**

200 E. Wells Street, Room 105, City Hall, Milwaukee, WI 53202. [www.milwaukee.gov/license](http://www.milwaukee.gov/license)  
Phone: (414) 286-2238 Fax: (414) 286-3057 Email Address: [License@milwaukee.gov](mailto:License@milwaukee.gov)



**CITY OF MILWAUKEE  
OFFICE OF THE CITY CLERK**

Wednesday, November 16, 2016

**COMMITTEE MEETING NOTICE**

AD 15

QANDEEL, Salah, Agent  
Y & A Food Inc  
2009 N 26th St

Sheboygan, WI 53081

---

You are requested to attend a hearing which is to be held in Room 301-B, Third Floor, City Hall on:

**Tuesday, November 29, 2016 at 10:15 AM**

**Regarding:** Your Class A Malt, Food Dealer, and Weights & Measures License Applications as agent for "Y & A Food Inc" for "Alliance Super Food Market" at 2672 N 35th St.

There is a possibility that your application may be denied for one or more of the following reasons: The recommendation of the committee regarding the application shall be based on evidence presented at the hearing. Per MCO 85-2.7-4, probative evidence concerning whether or not a new license should be granted may be presented on the following subjects: whether or not the applicant meets the municipal requirements, the appropriateness of the location and premises where the licensed premises is to be located and whether use of the premises for the purposes or activities permitted by the license would tend to facilitate a public or private nuisance or create undesirable neighborhood problems such as disorderly patrons, unreasonably loud noise, litter, and excessive traffic and parking congestion. Probative evidence relating to these matters may be taken from the plan of operation submitted with the license application, if any, but shall not include the content of any music. Evidence regarding the fitness of the location of the premises to be maintained as the principal place of business, including but not limited to whether there is an overconcentration of businesses of the type for which the license is sought; whether the proposal is consistent with any pertinent neighborhood business or development plans, or the location's proximity to areas where children are typically present. The applicant's record in operating similarly licensed premises; and whether or not the applicant has been charged with or convicted of any felony, misdemeanor, municipal offense or other offense, the circumstances of which substantially relate to the activity to be permitted by the license being applied for or any other factor which reasonably relates to the public health, safety or welfare may also be considered. See attached police report or correspondence.

**Notice for applicants with warrants or unpaid fines:**

**Proof of warrant satisfaction or payment of fines must be submitted at the hearing on the above date and time. Failure to comply with this requirement may result in a delay of the granting/denial of your application.**

Failure to appear at this meeting may result in the denial of your license. Individual applicants must appear only in person or by an attorney. Corporate or Limited Liability applicants must appear only by the agent designated on the application or by an attorney. Partnership applicants must appear by a partner listed on the application or by an attorney. If you wish to do so and at your own expense, you may be accompanied by an attorney of your choosing to represent you at this hearing.

You will be given an opportunity to speak on behalf of the application and to respond and challenge any charges or reasons given for the denial. No petitions can be accepted by the committee, unless the people who signed the petition are present at the committee hearing and willing to testify. You may present witnesses under oath and you may also confront and cross-examine opposing witnesses under oath. If you have difficulty with the English language, you should bring an interpreter with you, at your expense, so that you can answer questions and participate in your hearing.

You may examine the application file at this office during regular business hours prior to the hearing date. Inquiries regarding this matter may be directed to the person whose signature appears below.

Limited parking for persons attending meetings in City Hall is available at reduced rates (5 hour limit) at the Milwaukee Center on the southwest corner of East Kilbourn and North Water Street. Parking tickets must be validated in the first floor information booth in City Hall.

PLEASE NOTE: Upon reasonable notice, efforts will be made to accommodate the needs of disabled individuals through sign language interpreters or other auxiliary aids. For additional information or to request this service, contact the Council Services Division ADA Coordinator at (414) 286-2998, Fax - (414) 286-3456, TDD - (414) 286-2025.

**JIM OWCZARSKI, CITY CLERK**

BY:   
\_\_\_\_\_  
Jason Schunk  
License Division Manager

**If you have questions regarding this notice, please contact the License Division at (414) 286-2238.**

200 E. Wells Street, Room 105, City Hall, Milwaukee, WI 53202. [www.milwaukee.gov/license](http://www.milwaukee.gov/license)  
Phone: (414) 286-2238 Fax: (414) 286-3057 Email Address: [License@milwaukee.gov](mailto:License@milwaukee.gov)

Date: 9/28/16  
Officer: Darcie Trunkel

City of Milwaukee Police Department  
90-5-1.5 Crime Prevention Survey  
Convenience Store/Liquor Store Inspection

Name of Premise: Alliance  
Address: 2672 N 35<sup>th</sup> ST  
Phone: 414-614-9932

Owner: QANDEEL, Salah M  
Owner address: 2009 N 26<sup>th</sup> St  
City State Zip: Sheboygan, WI 53081  
Owner Phone: 414-442-6110  
Owner email: qandeelwi@aol.com

Manager: Khaled A FARHUD  
Home Address: 2327 W Minnesota Av  
City State Zip: Franklin, WI 53132  
Phone: 414-758-3532  
Email: charkiefarhud@outlook.com

Preferred contact: Store Phone

Location currently open:  YES  NO

Projected open date: 11/1/16

Day's open: S M T W Th F SA ALL

Hours of Operation: Sun: 10a-10p  
Mon: 9a-9p  
Tue: 8a-10p  
Wed: 8a-10p  
Thu: 8a-10p  
Fri: 8a-10p  
Sat: 8a-10p  
24 hours Y N

Premise Type: Liquor Store  
Convenience Store  
Other:

Licenses currently held:

- Alcohol:  Yes  No Class: Amalt #: 0198709  
Tobacco:  Yes  No #: 1025625  
Food:  Yes  No #: 0006684  
Extended Hours:  Yes  No #:  
Secondhand Dealer:  Yes  No Type: #:  
Other:  Yes  No Type: #:  
Other:  Yes  No Type: #:

**Exterior Survey:**

1. Is the area around the location clean?  Yes  No
2. What surrounds the location? (Check all the apply)
  - a.  Park
  - b.  School
  - c.  Youth Center
  - d.  Church
  - e.  Tavern(s) If so, how many
  - f.  Residential
  - g.  Other businesses
  - h.  Other:
3. Can you see from the outside of the location into the interior  Yes  No
4. Can you see the employees inside of the location from the outside  Yes  No
5. Are exterior windows free of signage  Yes  No
6. Is there a parking lot  Yes  No
7. Is the parking lot clean?  Yes  No
8. Is the parking lot well lit?  Yes  No
9. Are there areas where a person could conceal themselves  Yes  No
10. Is there exterior lighting?  Yes  No. Does it appears to be adequate  Yes  No
11. Exterior Payphone?  Yes  No
12. Are there No Loitering Signs posted?  Yes  No
13. Are there exterior security cameras  Yes  No How Many: 4
14. Are the address numbers prominently displayed and easy to see  Yes  No

**Camera Survey:**

15. Does this location have security cameras?  Yes  No
16. Are they in working order?  Yes  No
17. What format are the cameras?
  - a. Color  Yes  No
  - b. Digital  Yes  No
  - c. VCR  Yes  No
  - d. Recorded  Yes  No
18. How long is footage stored for later viewing:
19. Are there exterior cameras  Yes  No How many: 4
20. Are there interior cameras  Yes  No How many: 8 capacity for 25 views
21. Do all employees know how to retrieve recorded digital images/footage?  Yes  No

**Interior Survey:**

22. Is the storeowner willing to be a standing complainant regarding loitering? Yes No  
a. If yes have them fill out the standing complaint form and give them two of the commercial signs Yes No
23. Is the interior of the location neat and clean? Yes No
24. Does an interior camera face the entrance/exit? Yes No
25. Is there a lockable area that separates employees from customers? Yes No
26. Does the store sell single chore boy? Yes No
27. Does the store sell blunt wraps? Yes No
28. Does the store sell scales? Yes No
29. Does the store sell items that may be used as crack pipes? Yes No  
a. Describe item N/A
30. Does the store have an over abundance of sandwich baggies: Yes No
31. Does the owner understand that these items are often used for drug use? Yes No
32. Do the products in the store appear to be new and rotated often? Yes No
33. Are emergency and non-emergency numbers posted near the phone? Yes No
34. Does the owner know how to contact their police district directly? Yes No  
a. Did you provide a district contact guide to the owner? Yes No

**Complete this section if alcohol establishment is a convenience store:**

(\*\* Read full ordinance for all details "68-55 Convenience Food Stores")

All convenience food stores not exempted under sub. 3 shall:

1. Is the cash register located in a manner so that at the time of a sales transaction, the employee and customer are both visible from the sidewalk? Yes No \*\*
2. Are the glass entrance and exit doors clear of any signs or advertisements with the exception of a sign which states that the cash register contains \$50 or less and that the safe is no accessible to employees? Yes No
3. Does the store maintain one of the following on the licensed premise:
  - a. A safe that was in use at the convenience food store on August 17, 1994? Yes No
  - b. A drop-safe or time release safe that weighs at least 500 pounds or which is attached to or set into the floor in a manner approved by the police department? Yes No
4. Is lighting provided for the store's parking area during all hours of darkness when employees or customers are on the premises at a minimum average of 2-foot candles per square foot, unless the store is not open for business after sunset and before sunrise? Yes No N/A
5. Are at least two high-resolution surveillance security cameras installed? Yes No
6. Are the security cameras in working order? Yes No
7. Does one camera show an overall view of the counter and register area? Yes No
8. Does one camera show a clear, identifiable, full frame image of the face of each person entering and leaving the store? Yes No
9. Are the camera views obstructed by fixtures or displays? Yes No
10. Is the recorded footage stored for at least 30 days? Yes No

11. Do all store employees know how to record footage from the camera system to media capable of being transferred to police custody?  Yes  No
12. Are customer entrances/exits made of glass or other transparent material?  Yes  No
  - a. Exception: A store that does not have such doors on August 17, 1994 shall not be required to install such doors until the holder of the store's food dealer license changes.
13. Has the owner and their employees attended the Robbery Prevention Training within 120 days of ownership or employment?  Yes  No
  - a. Contact Community Outreach and Education at 935-7836 for schedule.

**Sub 3. Exemptions.** The requirements of this section do not apply to a convenience food store that conforms to either of the following descriptions:

- a-1. The store is located in an enclosed shopping structure, enclosed commercial building or hospital. A convenience food store is not in an enclosed structure or building if a customer can enter it directly from the outside.  
Does store conform to a-1  Yes  No
- a-2. The store physically separates employees from customers with a solid partition that bars a person from entering the employee area from the customer area, has a secure lock on the employee side of any door between the employee area and the customer, and conducts all transaction through a service window or similar arrangement.  
Does store conform to a-2  Yes  No
  - a. At the commissioner's discretion, a convenience store may be exempted from any or all of the regulations specified in sub 2.  
Does this location hold an exemption from the commissioner regarding any of the requirements of Sub 2?  Yes  No

**ADDITIONAL COMMENTS/RECOMMENDATIONS:**

This business is currently open and operating. The business is in NUSIANCE STAUS and BILLING STATUS.

There is a sloppy hand written one NO Loitering scribble on the outside of the building.

The new owner will not be on sight. The current owner will be running the business.

The video is only kept for a week or two.

They did not have the tobacco license posted during our survey. It was not on premise.

The occupancy was also not posted. It was not on premise.



3. On 05/04/2008 at 2:25pm Milwaukee Police were flagged down regarding a subject with a gun complaint at 2672 N. 35<sup>th</sup> Street (Alliance Super Food Market). Investigation revealed an armed robbery-pretend weapon had occurred inside the store. Nothing was obtained, there were no injuries and the applicant co-operated with the police during the investigation. A subject was arrested regarding this offense and subsequently convicted of Theft of Movable Property. Incident report #081250113 filed.

=====

4. On 11/14/10 at 6:45 pm, Milwaukee police were investigating a complaint that involved a subject selling pirated DVD's inside 2672 N 35<sup>th</sup> Street, Alliance Foods. Officers arrested the subject who was selling the DVD's and spoke with Farhud Khaled, owner of the store. Khaled stated he allowed the subject to sell the DVD's inside and that he didn't know it was illegal. Police spoke with the subject who stated he was allowed to sell the DVD's inside the store by Khaled in exchange for unpaid help he provided which consisted of cutting meat, stocking displays and providing security for the store.

5. On 03/14/11 at 7:46 pm, Milwaukee police were conducting sales of alcohol to underage persons and had a Milwaukee police enter 2672 N 35<sup>th</sup> Street in attempts to purchase alcohol. The aide was able to buy a 6 pack of Heineken beer in 12 oz bottles without being asked to provide ID. The clerk was identified as Riyadh Salem and both Salem and the licensee, Farhud Khaled were cited for this violation.

As to Khaled:

Charge: Sale of Alcohol To Underage Person  
Finding: Guilty  
Sentence: Fined \$100.00  
Date: 06/08/11  
Case: 11038834

As to Salem:

Charge: Sale of Alcohol To Underage Person  
Finding: Guilty  
Sentence: Fined \$100.00  
Date: 06/08/11  
Case: 11038868

=====

Incident # 5 previously reported, disposition now added on 04/23/12.

=====

6. On 05/01/2013 a Milwaukee police officer observed a subject standing outside 2672 North 35<sup>th</sup> Street (Alliance Food Market) near a "No Loitering" sign. A field interview was conducted and the subject ultimately arrested for possession of marijuana. Milwaukee police incident report #131210171 filed.

7. On 05/06/2013 a Milwaukee police officer observed a subject standing outside 2672 North 35<sup>th</sup> Street (Alliance Food Market) near a "No Loitering" sign. This subject had been warned earlier in the day not to loiter in front of the store. The subject was arrested and issued a citation for Loitering.



8. On 05/08/2013 a Milwaukee police officer observed a subject standing outside 2672 North 35<sup>th</sup> Street (Alliance Food Market) near a "No Loitering" sign. A field interview was conducted and the subject ultimately arrested for Loitering. During a search incident to arrest, it was discovered the subject possessed marijuana. Milwaukee police incident report #131280129 filed.
9. On 05/10/2013 a Milwaukee police officer observed a subject standing outside 2672 North 35<sup>th</sup> Street (Alliance Food Market) near a "No Loitering" sign. This subject had been warned earlier in the day not to loiter in front of the store. The subject was arrested and issued a citation for Loitering.
10. On 05/17/2013 Milwaukee police were dispatched to 2672 North 35<sup>th</sup> Street (Alliance Food Market) for a Trouble with a Subject complaint. The applicant told police that a female subject had been inside the store creating a disturbance by shouting obscenities as well as other behavior causing the applicant to call police. This subject was located and arrested a short time later. Milwaukee police incident report #131360148 filed.

=====

11. On 12/03/2015 Milwaukee police conducted a field interview of a subject in the parking lot of the Alliance Food Mart located near north 35<sup>th</sup> Street and West Center Street. This interview resulted in the recovery of 17.6 grams of marijuana and .93 grams of heroin as well as the arrest of two subjects. Milwaukee police incident report #153370098 filed.
12. On 12/10/2015 Milwaukee police responded to a shooting at 2672 North 35<sup>th</sup> Street (Alliance Super Food Market). The victim told officers he had been at the bus stop on the southeast corner of North 35<sup>th</sup> Street and West Center Street when he heard several gunshots and realized he had been shot in the arm. Officers recovered several casings and bullet fragments from the scene. The 14 year old victim was conveyed to Children's Hospital. A nurse turned over the victim's clothing and money to a detective who counted \$274.00 in currency with an odor of marijuana emanating from it. The victim told officers he received the money from selling a video game system and refused to answer most other questions. Milwaukee police incident report #153440150 filed.
13. On 01/02/2016 Milwaukee police responded to a suspicious person/auto at 2672 North 35<sup>th</sup> Street (Alliance Super Food Market). Several subjects were loitering outside the business. One subject possessed marijuana and a handgun. This subject was arrested. Milwaukee police incident report #160020126 filed.
14. On 03/02/2016 a reliable citizen informant described two subjects who were selling marijuana in the parking lot of Alliance Super Food Market (2672 North 35<sup>th</sup> Street). These subjects were detained and marijuana was recovered. Milwaukee police incident report #160620092 filed.
15. On 03/27/2016 officers observed a drug transaction in the parking lot of Alliance Super Food Market (2672 North 35<sup>th</sup> Street). Marijuana was recovered and a subject was arrested for delivery of a controlled substance. Milwaukee police incident report #160870087 filed.
16. On 05/28/2016 Milwaukee police were dispatched to St. Joseph's Hospital for a shooting. Investigation revealed the victim was shot in the abdomen in the parking lot of Alliance Super Food Market (2672 North 35<sup>th</sup> Street) while he was being robbed. Milwaukee police incident report #161490142 filed.

Items #11 through #16 added as 09/09/2016 as part of previous premise.



Licensed alcohol beverage establishments within a half mile radius centered on 2672 N 35th St on July 27, 2016									
License Summary	Trade name	Licensee	Address	License type name	Total capacity	Expiration date			
Class A Fermented Malt Beverage Retailer's License	FOND DU LAC SUPERMARKET	JALAL A ZANOUN, Agt	2709 N 28TH ST	Class A Fermented Malt Beverage Retailer's License		11/14/2016			
Class A Malt & Class A Liquor License	FAMILY FOOD MARKET	NASER A ASAD, SP	2803 N 35TH ST	Class A Fermented Malt Beverage Retailer's License		4/24/2017			
Class B Tavern License	H & F CORP	ALLIANCE SUPER FOOD MARKET	2672 N 35TH ST	Class A Fermented Malt Beverage Retailer's License		6/28/2017			
	QUICK FOOD MARKET	BALLEET KAUR, Raghvinder Singh	3833 W CENTER ST	Class A Fermented Malt Beverage Retailer's License		12/20/2016			
	SKYWAY FOOD MART	AVTAR S KANG, SP	2601 N 35TH ST	Class A Fermented Malt Beverage Retailer's License		3/23/2017			
	Walkers Grocery	ASTON B WALTERS, Agt	3821 W LOCUST ST	Class A Fermented Malt Beverage Retailer's License		6/10/2017			
	BUYRITE FOOD & LIQUOR	GEORGE C KUSAK, SP	2500 N 35TH ST	Class A Malt & Class A Liquor License		5/10/2017			
	MEGA MARTS, LLC	PICK 'N SAVE #6879	2355 N 35TH ST	Class A Malt & Class A Liquor License		1/18/2017			
	NAT LIQUOR & FOOD MART, INC	S & A LIQUOR	3725 W CENTER ST	Class A Malt & Class A Liquor License		5/4/2017			
	Ravneet Liquor, Inc	ABC Beer & Liquor Depot	2816 W Fond du Lac AV	Class A Malt & Class A Liquor License		7/27/2016			
	Brazilionnaires Lounge, Inc	Brazilionnaires Lounge	2679 N 30th ST	Class B Tavern License	50	7/25/2016			
			Total						



Wednesday, November 16, 2016

## Licenses Committee Notice of Hearing

Nimer Musaitif  
2129 Erie St

Racine, WI 53402

Date: 11/29/2016  
Time: 10:15 AM  
Location: Room 301-B, Third Floor, City Hall

The Licenses Committee will consider the following license application:

Class A Malt, Food Dealer, and Weights & Measures License Applications  
QANDEEL, Salah, Agent  
Alliance Super Food Market at 2672 N 35th St

Please note this application may be recommended for denial based on fitness of the location due to concentration of alcohol beverage outlets in the area. If the application is denied for this reason, no other application for an alcohol beverage license for this location shall be recommended for approval by the Licenses Committee within three years of the date of denial unless the applicant has demonstrated a change of circumstances since the prior denial.

If you have any questions, please call (414) 286-2238.





Wednesday, November 16, 2016



# Notice of Public Hearing

---

QANDEEL, Salah, Agent  
Alliance Super Food Market at 2672 N 35th St  
Class A Malt, Food Dealer, and Weights & Measures License Applications

**Tuesday, November 29, 2016 at 10:15 AM**

To whom it may concern:

The above application has been made by the above named applicant(s). This requires approval from the Licenses Committee and the Common Council of the City of Milwaukee. The hearing before the Licenses Committee will take place on 11/29/2016 at 10:15 AM, in Room 301-B, Third Floor, City Hall. If you wish, you may provide testimony at the hearing regarding the request; see below for further information. You are not required to attend the hearing. Once the Licenses Committee makes its recommendation, this recommendation is forwarded to the full Common Council for approval at its next regularly scheduled hearing. Please review the information below and if you have further questions regarding this process, please contact the License Division at (414) 286-2238.

---

## Important details for those wishing to provide information for the Licenses Committee to consider when making its recommendation:

1. The license application is scheduled to be heard at the above time. Due to other hearings running longer than scheduled, you may have to wait some time to provide your testimony.
2. You must appear in person and testify as to matters that you have personally experienced or seen. (You cannot provide testimony for your neighbor, parent or anyone else; this is considered hearsay and cannot be considered by the committee.)
3. No letters or petitions can be accepted by the committee (unless the person who wrote the letter or the persons who signed the petition are present at the committee hearing and willing to testify).
4. Persons opposed to the license application are given the opportunity to testify first; supporters may testify after the opponents have finished.
5. When you are called to testify, you will be sworn in and asked to give your name, and address. (If your first and/or last names are uncommon please spell them.)
6. You may then provide testimony.
  - a. Include only information relating to the above license application.
  - b. Include only information you have personally witnessed or seen.
  - c. Provide concise and relevant information detailing how this business has affected or may affect the peaceful enjoyment of your neighborhood.
  - d. If by the time you have the opportunity to testify, the information you wish to share has already been provided to the committee, you may state that you agree with the previous testimony. Redundant or repetitive testimony will not assist the committee in making its recommendation.
7. After giving your testimony, the members of the Licenses Committee and the licensee may ask questions regarding the testimony you have given or other factors relating to the license application.
8. Business Competition is not a valid basis for denial or non-renewal of a license.  
**Please Note: If you have submitted an objection to the above application your objection cannot be considered by the committee unless you personally testify at the hearing.**

OCCUPANT	MAIL ADDRESS	CITY AND ZIP CODE
CURRENT OCCUPANT	2676 N 36TH ST	MILWAUKEE, WI 53210-2523
CURRENT OCCUPANT	3521 W CENTER ST	MILWAUKEE, WI 53210-2536
CURRENT OCCUPANT	2632 N 35TH ST	MILWAUKEE, WI 53210-2519
CURRENT OCCUPANT	2646A N 35TH ST	MILWAUKEE, WI 53210-2519
CURRENT OCCUPANT	2646 N 35TH ST	MILWAUKEE, WI 53210-2519
CURRENT OCCUPANT	2646A N 34TH ST	MILWAUKEE, WI 53210-2515
CURRENT OCCUPANT	2651A N 34TH ST	MILWAUKEE, WI 53210-2516
CURRENT OCCUPANT	2654 N 35TH ST	MILWAUKEE, WI 53210-2519
CURRENT OCCUPANT	3406 W CENTER ST	MILWAUKEE, WI 53210-2533
CURRENT OCCUPANT	2666 N 36TH ST	MILWAUKEE, WI 53210-2523
CURRENT OCCUPANT	2660 N 36TH ST	MILWAUKEE, WI 53210-2523
CURRENT OCCUPANT	3519 W CENTER ST	MILWAUKEE, WI 53210-2536
CURRENT OCCUPANT	2632A N 35TH ST	MILWAUKEE, WI 53210-2519
CURRENT OCCUPANT	2640 N 35TH ST	MILWAUKEE, WI 53210-2519
CURRENT OCCUPANT	2655 N 34TH ST	MILWAUKEE, WI 53210-2516
CURRENT OCCUPANT	2661 N 34TH ST	MILWAUKEE, WI 53210-2516
CURRENT OCCUPANT	2719 N 34TH ST	MILWAUKEE, WI 53210-2518
CURRENT OCCUPANT	2635 N 34TH ST	MILWAUKEE, WI 53210-2516
CURRENT OCCUPANT	2642 N 34TH ST	MILWAUKEE, WI 53210-2515
CURRENT OCCUPANT	2651 N 34TH ST	MILWAUKEE, WI 53210-2516
CURRENT OCCUPANT	2658 N 34TH ST	MILWAUKEE, WI 53210-2515
CURRENT OCCUPANT	3415 W CENTER ST	MILWAUKEE, WI 53210-2534
CURRENT OCCUPANT	3417 W CENTER ST	MILWAUKEE, WI 53210-2534
CURRENT OCCUPANT	3402A W CENTER ST	MILWAUKEE, WI 53210-2533
CURRENT OCCUPANT	2713 N 34TH ST	MILWAUKEE, WI 53210-2518
CURRENT OCCUPANT	2666A N 36TH ST	MILWAUKEE, WI 53210-2523
CURRENT OCCUPANT	3517 W CENTER ST	MILWAUKEE, WI 53210-2536
CURRENT OCCUPANT	2631 N 35TH ST	MILWAUKEE, WI 53210-2520
CURRENT OCCUPANT	2627 N 34TH ST	MILWAUKEE, WI 53210-2516
CURRENT OCCUPANT	2657 N 34TH ST	MILWAUKEE, WI 53210-2516
CURRENT OCCUPANT	3324 W CENTER ST	MILWAUKEE, WI 53210-2531
CURRENT OCCUPANT	2678 N 36TH ST	MILWAUKEE, WI 53210-2523
CURRENT OCCUPANT	2660A N 36TH ST	MILWAUKEE, WI 53210-2523
CURRENT OCCUPANT	2646 N 34TH ST	MILWAUKEE, WI 53210-2515
CURRENT OCCUPANT	2656 N 35TH ST	MILWAUKEE, WI 53210-2519
CURRENT OCCUPANT	2659 N 34TH ST	MILWAUKEE, WI 53210-2516
CURRENT OCCUPANT	3402 W CENTER ST	MILWAUKEE, WI 53210-2533
CURRENT OCCUPANT	2674 N 36TH ST	MILWAUKEE, WI 53210-2523
CURRENT OCCUPANT	2656 N 36TH ST	MILWAUKEE, WI 53210-2523
CURRENT OCCUPANT	2644 N 36TH ST	MILWAUKEE, WI 53210-2523
CURRENT OCCUPANT	3515 W CENTER ST	MILWAUKEE, WI 53210-2536
CURRENT OCCUPANT	2655 N 35TH ST	MILWAUKEE, WI 53210-2520
CURRENT OCCUPANT	2631A N 35TH ST	MILWAUKEE, WI 53210-2520
CURRENT OCCUPANT	2660 N 35TH ST	MILWAUKEE, WI 53210-2519
CURRENT OCCUPANT	3324A W CENTER ST	MILWAUKEE, WI 53210-2531
CURRENT OCCUPANT	2649 N 34TH ST	MILWAUKEE, WI 53210-2516
CURRENT OCCUPANT	2658 N 35TH ST	MILWAUKEE, WI 53210-2519
CURRENT OCCUPANT	2719A N 34TH ST	MILWAUKEE, WI 53210-2518
CURRENT OCCUPANT	2644A N 36TH ST	MILWAUKEE, WI 53210-2523
CURRENT OCCUPANT	2657 N 35TH ST	MILWAUKEE, WI 53210-2520

**Total Records: 51**

**Radius: 250.0 feet and Center of Circle: 2672 N 35th ST**



# BUSINESS LICENSE PLAN OF OPERATION

ccl-busplan 9/15/15

Office of the City Clerk License Division  
200 E. Wells St. Room 105, Milwaukee, WI 53202  
(414) 286-2238 www.milwaukee.gov/license e-mail address: license@milwaukee.gov

## 1. Type of Business

- Applying for:  Extended Hours Establishment  Filling Station  Waste Tire Transporter  Waste Tire Generator  
 Self Service Laundry  Rooming House: Number of Units: \_\_\_\_\_  Hotel/Motel: Number of Units: \_\_\_\_\_  
 Massage Establishment  Other (supplemental application for specific license also required) **GROCERY STORE**

Provide a detailed description of the type of business you plan on operating:

**CONVENIENCE STORE**

Do you have any experience operating this type of business?  No  Yes If yes, explain: **PREVIOUSLY RAN STORE**

## 2. Business Operations

- a. Proposed Opening Date: **8-15-16**
- b. Is this premise under construction?  No  Yes If yes, list estimated completion date: \_\_\_\_\_
- c. Is this a franchise?  No  Yes
- d. Is this premises currently licensed?  No  Yes If yes, list type of license: **OCCUPANCY, FOOD PERMIT, ALCOHOL**
- e. Is the current licensee operating?  No  Yes If no, list date closed: \_\_\_\_\_
- f. Do you have future plans for other businesses, licenses or permits at this location?  No  Yes  
If yes, explain: \_\_\_\_\_
- g. Have you previously held an Extended Hours License in Milwaukee?  No  Yes  
If yes, list address(es): \_\_\_\_\_
- h. Are other businesses operating in the same building?  No  Yes If yes, describe: \_\_\_\_\_

## 3. Litter & Noise

- a. How are grounds kept clean?  Sweep  Pressure Wash  Pick Up Litter  Hired Maintenance  
 Building Owner Responsibility  Garbage Cans Outside  Other: \_\_\_\_\_
- b. How often will grounds be cleaned?  Daily  Weekly  As Needed  Monthly  Other: \_\_\_\_\_
- c. Grounds cleaned by:  Licensee  Building Owner  Employees  Hired Maintenance  Other: \_\_\_\_\_
- d. How are noise issues prevented and/or addressed?  Security  Manager approaches customer(s)  Call Police  
 Signs Posted  Other: \_\_\_\_\_
- e. Will a sound amplification system be used?  No  Yes If yes, describe: \_\_\_\_\_

## 4. Smoking & Sanitation

- f. Are there designated outdoor smoking areas?  No  Yes If yes, describe: \_\_\_\_\_
- g. Number of Garbage Cans: Inside: **4** Locations: **BY CASH REGISTER NEAR**  
Outside: **1** Locations: **ENTRANCE, BEHIND BUILDING**
- h. Is a crowd control barrier used?  No  Yes If yes, describe: \_\_\_\_\_
- i. Describe sanitation facilities (restrooms): **1**  
Name of solid waste contractor:  Advanced Disposal  Waste Management  Other: \_\_\_\_\_



### 5. Security

- a. Are there onsite parking spaces?  No  Yes If yes, how many? 10  
 Describe parking security plan: LINED
- b. Is there a loading zone?  No  Yes If yes, describe loading area security plan \_\_\_\_\_
- c. Will you have security personnel on premise?  No  Yes If yes, how many? 1  
 What are their responsibilities? SECURITY  
 Is security equipment used?  No  Yes If yes, describe \_\_\_\_\_  
 List their licensing, certification, or training credentials \_\_\_\_\_  
 Will there be security cameras?  No  Yes If yes, where? inside + outside  
 Will searches/identification verification be conducted upon entry?  No  Yes If yes, describe \_\_\_\_\_

### 6. Percentage of Sales (must total 100%)

Alcohol <u>35</u> %	Food <u>40</u> %	Secondhand Merchandise _____ %	Precious Metals & Gems _____ %
Entertainment _____ %	Cigarettes <u>25</u> %	Personal Services (such as tattoo, body piercing, salon, tailor, tanning, etc.) _____ %	Other _____ % Describe: _____
Pawnbroker Activity _____ %	Salvaged Materials _____ % (such as scrap metal)		

### 7. Businesses/Licenses on the Premises (check all that apply):

#### Type 1

- Full Service Restaurant     Cafe/Coffee Shop     Deli or Fast Food Restaurant     Private/Fraternal/Veterans Club
- Night Club     Tavern     Cocktail Lounge     Teen Club
- Banquet Hall     Sports Facility
- Hotel/Motel – Number of Rooms: \_\_\_\_\_     Rooming House – Number of Rooms: \_\_\_\_\_

#### Type 2

- Liquor Store     Corner Store     Supermarket     Convenience Store
- Gas Station     Amusement/Phonograph Distributor     Auto Wrecker
- Used Car Dealer     Used Auto Parts     Personal Service Establishment (such as tattoo business, hair salon, tailor, etc.)     Recording Studio

What other licenses/permits will you hold at this location? (check all that apply)

- Occupancy Permit     Cigarette & Tobacco     Gas Station     Extended Hours     Class "B" Tavern     Weights & Measures
- Secondhand Dealer     Precious Metal & Gem     Other: \_\_\_\_\_

### 8. Legal Capacity (only if a Type 1 premises in #6 above)

Capacity 25 (Call the Milwaukee Development Center at 414-286-8211 if you have questions.)

# FOR FOOD

## 9. Premises Description

- a. Identify all area(s) of the premises that will be used in operating this business (include areas used only for storage):  
 1<sup>st</sup> Floor  2<sup>nd</sup> Floor  Basement Storage  Patio  Beer Garden  Sidewalk Café  Deck  Rooftop  
 Other: Describe: \_\_\_\_\_
- b. Describe Location:  Major Thoroughfare  Secondary Street  Other: \_\_\_\_\_
- c. Nearest Major Cross Street: N. 35<sup>th</sup> Street
- d. Describe Building:  Free Standing Building  Strip Mall  Other: \_\_\_\_\_
- e. Describe Premises Structure:  Single Story  Multi-Story - # of Stories \_\_\_\_\_  Other: \_\_\_\_\_
- f. Describe Surrounding Area:  Commercial  Residential  Industrial  Other: \_\_\_\_\_
- g. Building Owner Name: Nimer Musaitif Phone Number: 262-939-8491  
 Business Owner Address: 2129 Erie St, Racine, WI 53402

## 10. Hours of Operation & Customers

Will customers be entering the premises?  No  Yes

Day of the Week	Proposed Hours of Operation:		Estimated Number of Customers expected each day	Potential Age Range of Customers	Class B Tavern Applicant Only: Age Restriction (If none, write 'None')
	Open Time (include a.m. or p.m.)	Close Time (include a.m. or p.m.)			
Sunday	10:00 am	10:00 pm	150	Varies	
Monday	8:00 am	10:00 pm	190	"	
Tuesday	N	N	N	"	
Wednesday	N	N	175	"	
Thursday	N	N	150	"	
Friday	"	"	180	"	
Saturday	10:00	10:00 pm	180	"	

Extended Hours Establishment License is required for any convenience store, filling station, personal service establishment (such as tattoo, body piercing, salon, tailor, tanning, etc.), recording studio or restaurant which is open between the hours of 12 a.m. and 5 a.m.

Entertainment Indoor Closing Hours : If alcohol beverage establishment, same as alcohol license hours.  
 If non-alcohol establishment 1:00 am Sunday to Thursday; 1:30 am Friday and Saturday.

Entertainment Outdoor Closing Hours : 10:00 pm Sunday – Thursday; 12:00 am Friday and Saturday,  
 unless otherwise approved by Common Council in licensee's plan of operation.

## 11. Signature(s)

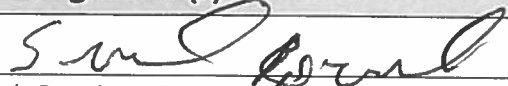
  
 Sole Proprietor, Partner, Agent, or 20% or more Shareholder

\_\_\_\_\_  
 Signature of additional partner or 20% or more Shareholder

See Application Information for a list of all required application forms.

# FOB AMALT

## 9. Premises Description

d. Identify all area(s) of the premises that will be used in operating this business (include areas used only for storage):

1st Floor  2nd Floor  Basement Storage  Patio  Beer Garden  Sidewalk Café  Deck  Rooftop

Other: Describe: \_\_\_\_\_

e. Describe Location:  Major Thoroughfare  Secondary Street  Other: \_\_\_\_\_

f. Nearest Major Cross Street: 35 E CENTER

g. Describe Building:  Free Standing Building  Strip Mall  Other: \_\_\_\_\_

h. Describe Premises Structure:  Single Story  Multi-Story - # of Stories \_\_\_\_\_  Other: \_\_\_\_\_

i. Describe Surrounding Area:  Commercial  Residential  Industrial  Other: \_\_\_\_\_

j. Building Owner Name: NIMRA MUSAITHI Phone Number: 262-939-8491

Business Owner Address: 2129 ERIE STREET RACINE, WI 53402

## 10. Hours of Operation & Customers

Will customers be entering the premises?  No  Yes

Day of the Week	Proposed Hours of Operation:		Estimated Number of Customers expected each day	Potential Age Range of Customers	Class B Applicants: Age Restriction (If none, write 'None')
	Open Time (include a.m. or p.m.)	Closing Time (include a.m. or p.m.)			
Sunday	10:00 A.M. ONLY	9:00 P.M.	150	8-70	
Monday	8:00 AM	9:00 PM	190	8-70	
Tuesday	8:00am	9:00pm	11	8-70	
Wednesday	8:00am	9:00pm	175	8-70	
Thursday	8:00am	9:00pm	150	8-70	
Friday	8:00am	9:00 pm	180	8-90	
Saturday	10:00am	9:00pm	180	8-70	

Extended Hours Establishment License is required for any convenience store, filling station, personal service establishment (such as tattoo, body piercing, salon, tailor, tanning, etc.), recording studio or restaurant which is open between the hours of 12 a.m. and 5 a.m.

Entertainment Indoor Closing Hours - If alcohol beverage establishment, same as alcohol license hours.  
If non-alcohol establishment 1:00 am Sunday to Thursday; 1:30 am Friday and Saturday.

Entertainment Outdoor Closing Hours - 10:00 pm Sunday - Thursday; 12:00 am Friday and Saturday, unless otherwise approved by Common Council in licensee's plan of operation.

## 11. Signature(s)

Saleh  
Sole Proprietor, Partner, Agent, or 20% or more Shareholder

\_\_\_\_\_  
Signature of additional partner or 20% or more Shareholder

See Application Information for a list of all required application forms.



# ALCOHOL BEVERAGE & PUBLIC ENTERTAINMENT PREMISES SUPPLEMENTAL PLAN OF OPERATION

Office of the City Clerk License Division  
200 E. Wells St. Room 105, Milwaukee, WI 53202  
(414) 286-2238 e-mail address: license@milwaukee.gov www.milwaukee.gov/license

Legal Entity Name: <u>Y &amp; A <sup>FOOD</sup> INC.</u>
Premise Address: <u>2672 N. 35<sup>th</sup> ST. Milwaukee, WI 53120</u>
<b>Proximity of Premises to Church, School, Daycare Center or Hospital</b>
Is there at least 300 feet between the building and any church, school, daycare center or hospital? <input checked="" type="checkbox"/> Yes <input type="checkbox"/> No
<b>"Service Bar Only" Designation</b>
If applying for Class B or C license, are you applying for "Service Bar Only"? <input checked="" type="checkbox"/> No <input type="checkbox"/> Yes Service Bar Only means customers cannot sit at the bar. Alcohol is served to patrons seated at tables. No stools, chairs or other articles of furniture shall be placed at the service bar for patrons to sit upon.
<b>Business Information</b>
a) Are you taking out this application for anyone that may not be eligible for a license? <input checked="" type="checkbox"/> No <input type="checkbox"/> Yes If yes, list name and address: _____
b) Will the agent, a partner or the individual licensee be conducting the day-to-day operations of the business? <input type="checkbox"/> No <input checked="" type="checkbox"/> Yes If no, list the name and address of the person(s) who will: _____
Class B Applicants: If the agent, a partner or the individual licensee will not be conducting the day-to-day operations of the business, the person(s) listed above must obtain a Class B Managers license.
c) Does anyone else have money invested or any other interest in this business? <input checked="" type="checkbox"/> No <input type="checkbox"/> Yes If yes, explain: _____
d) Have you made an agreement with anyone to repay any loan or any other payments based upon income from the business? <input checked="" type="checkbox"/> No <input type="checkbox"/> Yes If yes, list name and address: _____
<b>Proof of Ownership, Lease, or Offer to Purchase (new &amp; transfer applicants only)</b>
Submit proof of ownership, lease, or offer to purchase the building with this application. A lease or offer to purchase must: a) Be in the same legal entity name as that apply for the license b) Reflect the same address as the premises address on this application c) Reflect current dates and d) Be signed by the lessor/seller and lessee/buyer
<b>Property Information (new &amp; transfer applicants only)</b>
a) Do you own or lease the building? <input type="checkbox"/> Own <input checked="" type="checkbox"/> Lease
b) Who owns the fixtures (for example, coolers, etc.)? <u>Y &amp; A INC.</u>
c) Are you purchasing the stock and/or fixtures? <input type="checkbox"/> No <input checked="" type="checkbox"/> Yes If yes, amount paid \$ <u>5,000</u>
d) Total amount paid for business \$ <u>50,000</u>
e) Total amount paid for goodwill of the business \$ <u>20,000</u>
Goodwill comprises the reputation and customer relationships of an existing business. If the price you pay for the business exceeds the fair market value of all of the rest of the assets of the business, the excess may be considered goodwill.
f) Have you made arrangements with the seller for payment of personal property taxes? <input type="checkbox"/> No <input checked="" type="checkbox"/> Yes

**See Application Information for a list of all required application forms.**

**Lease Information (new & transfer applicants who are leasing the premises only)**

- a) Date lease begins 2016 Ends 2026
- b) Monthly rental \$ 3100
- c) Do you have an option to renew the lease?  No  Yes
- d) Does your lease allow for assignment to another party without the consent of the owner?  No  Yes
- e) For what length of time have you been guaranteed occupancy (number of years)? 10 yrs
- f) In addition to paying the monthly rental, will you have to pay anything additional to the owner of the building to guarantee performance of the lease?  No  Yes If yes, explain \_\_\_\_\_
- g) Does the present owner or occupancy object to the granting of your license?  No  Yes  
If yes, explain \_\_\_\_\_

**Change of Agent Applicants Only**

Have there been any changes to the floor plan since the last application was submitted?  No  Yes  
If no, a new floor plan is not required. If yes, submit a new floor plan and explain the change(s): \_\_\_\_\_

**Notarized Signatures of Applicants**

SUBSCRIBED AND SWORN TO BEFORE ME

This 19<sup>th</sup> day of July, 2016

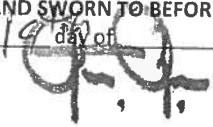

[Signature]  
Sole Proprietor, Partner, 20% or more Shareholder, or Agent – only if there are no 20% or more shareholders

(Clerk/Notary Public)

My Commission Expires 10/15/2017  
\*Notary Seal must be affixed.

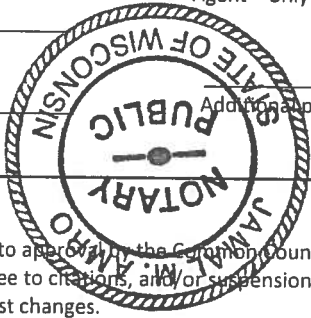

Note: All information contained in this application is subject to approval by the Common Council. Deviating from approved plan of operation will subject licensee to citations, and/or suspension or non-renewal of the license. Contact the License Division for information on how to request changes.

**New and transfer of premise applicants must submit the following:**

- Proof of ownership, lease or offer to purchase the building
- Detailed floor plan
- If a restaurant, copy of the menu



# FOOD DEALER LICENSE PLAN OF OPERATION

ccl-foodplan 2/22/16

OFFICE OF THE CITY CLERK, LICENSE DIVISION  
CITY HALL, 200 E. WELLS ST, ROOM 105, MILWAUKEE, WI 53202  
(414) 286-2238 • [license@milwaukee.gov](mailto:license@milwaukee.gov) • [www.milwaukee.gov/license](http://www.milwaukee.gov/license)

Legal Entity Name: JLA Food INC

Premises Address: 2672 N. 35th St Milwaukee WI 53210

### SECTION 1

Type of application (check one):  taking over a currently operating business  starting a new business

Anticipated opening date? 8/15/2016

Check the type that best describes your business (check only one):  
See Food Dealer License Information sheet for definitions.

Restaurant  Community Food Program  
 Retail Establishment  Bed & Breakfast  
 If retail, will it be a convenience store?  Yes  No  
 (less than 5,000 sq ft of retail space, primary business is the sale of basic food items, and in addition sells household products)  Base for Food Peddler  
 Base for Temporary/Seasonal Food Stand

In addition, will any wholesale business be done?  Yes  No

If yes, what percentage of the business will be wholesale?  Less than 25%  25% or More (Contact DATCP)\*

Will retail items be sold?  No  Yes If Yes, indicate percentage of food sales 100 %

Will restaurant items be sold?  No\*  Yes If Yes, indicate percentage of food sales \_\_\_\_\_ %

\* If you checked "25% or More" of the business will be wholesale and answered "No" to restaurant items being sold, do not continue completing this application. A City of Milwaukee License is not required. Contact DATCP only.

### SECTION 2

Will you be sharing kitchen space with another operator?

No If No, SKIP to Section 3

Yes If Yes, check one:

I will rent space from another operator ("Shared Kitchen Agreement" is required)

I will rent space to another operator (peddler/caterer)

### SECTION 3

Answer the following questions:

Will you have seating on site for dining?  No  Yes

Will you be doing any catering?  No  Yes

Will you be doing any delivery?  No  Yes

Will you have outdoor activities?  No  Yes

If Yes to outdoor activities, check all that apply:  Bar  Cooking/Grilling  Dining

Will you have a drive thru window?  No  Yes

If Yes to drive thru, are hours different from inside?  No  Yes

If Yes, provide drive thru hours: \_\_\_\_\_

Will any scales or barcode scanners be used?  No  Yes

If Yes, a Weights & Measures application must be completed and a license obtained.

**SECTION 4**

Where will food be prepared and/or sold?

- At a single site
- At multiple sites (for example, a hotel with several dining rooms or bars) How many? \_\_\_\_\_
- If multiple sites, attach a Food Dealer Additional Site Addendum (ccl-foodadd) for each additional site.

**SECTION 5**

Are you planning any construction, remodeling or equipment changes?

- No If No, SKIP to Section 6
- Yes If Yes, check all that apply:
- New construction of a building
  - Construction changes to an existing building
  - Renovation or remodeling
  - Equipment changes only (installation or replacement)

Provide a brief description of the changes: \_\_\_\_\_

Start date: \_\_\_\_\_

Name, Address & Phone Number of Architect: \_\_\_\_\_

Name, Address & Phone Number of Contractor: \_\_\_\_\_

**SECTION 6**

Are you applying for an alcohol beverage license?

- No If No, SKIP to Section 7
- Yes If YES, if your food license is approved prior to the alcohol beverage license, when do you want the food license issued?  Immediately  At the same time as the alcohol license

**SECTION 7**

You must initial each item confirming your understanding:

- SP I understand the Health Department must conduct an inspection and advise the License Division of their approval before the license may be issued.
- SP I understand I must obtain an occupancy permit from the Department of Neighborhood Services and an inspection may be required. Neighborhood Services must advise the License Division of their approval before the license may be issued.
- SP I understand the district alderperson will review and either approve or deny my application. If denied, I may appeal and be scheduled to appear before the Licenses Committee. The Licenses Committee will then make a recommendation to the Common Council. The Common Council must grant the license before it may be issued.
- SP I understand proof of payment for all license fees must be on file in the License Division before the license may be issued.
- SP I understand the license must be issued and posted in my establishment prior to opening for business.
- SP I will not operate my food business until the license has been issued and posted in the establishment.

Signature of sole proprietor, partner, agent or 20% shareholder: \_\_\_\_\_

Signature of additional partner(s): Sum [Signature]



**WEIGHTS & MEASURES LICENSE SUPPLEMENTAL APPLICATION**

OFFICE OF THE CITY CLERK, LICENSE DIVISION  
 CITY HALL, 200 E. WELLS ST, ROOM 105, MILWAUKEE, WI 53202 •  
 (414) 286-2238 • [license@milwaukee.gov](mailto:license@milwaukee.gov) • [www.milwaukee.gov/license](http://www.milwaukee.gov/license)

Legal Entity Name: V+A Food inc

Premise Address: 2672 N 35<sup>th</sup> milway WI 53210

**1. Device Type(s)**

- Check all device types for which you need a license.
- For each device type checked, indicate how many you have in the Number of Devices column (b).
- Calculate the Total Fee Per Device Type by multiplying the Fee Per Device Type (a) by the Number of Devices (b).
- Add all Total Fee Per Device Type amounts together and that will be your Total Fee Due.
- \* **Exception:** The Scanner fee is not per device. Check the box for the appropriate range.  
 If you have 1-3 scanners, the total due is \$130. If you have 4 or more scanners, the total due is \$250.  
 Check the Number of Devices (b).

Device Type	License Period	Fee Per Device Type (a)	Number of Devices (b)	Total Fee Per Device Type (a x b)
<b>Liquid Measuring Devices</b>				
<input type="checkbox"/> Retail Petroleum Meters	12 months	\$60		
<input type="checkbox"/> 0 to 30 gallons per minute	24 months	\$60		
<input type="checkbox"/> 31 to 200 gallons per minute	24 months	\$250		
<input type="checkbox"/> Over 200 gallons per minute	24 months	\$250		
<b>Scales</b>				
<input checked="" type="checkbox"/> 0 to 300 pounds	24 months	\$55	1	\$55
<input type="checkbox"/> 301 to 5,000 pounds	24 months	\$190		
<input type="checkbox"/> 5,001 to 40,000 pounds	24 months	\$300		
<input type="checkbox"/> Over 40,000 pounds	24 months	\$400		
<b>Scanners</b>				
		Fee for scanners is by range	Check how many scanners you have	
<input type="checkbox"/> Up to 3 scanners	24 months	\$130 total*	<input type="checkbox"/> 1 <input type="checkbox"/> 2 <input type="checkbox"/> 3	
<input type="checkbox"/> Four or more scanners	24 months	\$250 total*	<input type="checkbox"/> 4 <input type="checkbox"/> Other__	
<b>Other Devices</b>				
<input type="checkbox"/> Length Measuring Device	24 months	\$60		
<input type="checkbox"/> Taxi Cab Meter	24 months	\$130		
<input type="checkbox"/> Timing Device	24 months	\$30		
<b>Total Fee Due</b>				<b>\$55</b>

**2. Establishment Type**

Provide a brief description of the establishment/business:

Convince Store

Other licenses may be required depending on the type of business you are operating.



### 3. Acknowledgements and Signature

I hereby agree that I will comply with the applicable sections of the Wisconsin State Statutes, Administrative Code and the Milwaukee Code of Ordinances regarding the operation of weighing and measuring devices.

I understand that all devices must be operated within the specifications, tolerances and other technical requirements set forth in the National Institute of Standards and Technology Handbook 44.

I understand that the license for which I am applying must be posted on the premises or in my vehicle prior to opening for business or operating the device.

I understand that these device licenses are not transferable (with the exception of scanners). If the device is replaced or needs to be resealed, I must apply for and receive a new license so that an inspection of the device can be performed prior to its use.

I acknowledge that as a condition of being issued this license, I must allow the Health Department into the establishment to test the device to validate its specifications/tolerances. If my devices are found out of compliance, I may be charged inspection fees.

I have read, understand, and will adhere to all the above acknowledgments.

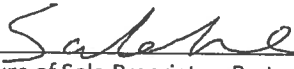

\_\_\_\_\_  
Signature of Sole Proprietor, Partner, 20% or more Shareholder  
or Agent – if there are no 20% or more shareholders

Date: 7.20.16

W ←

← Alley →

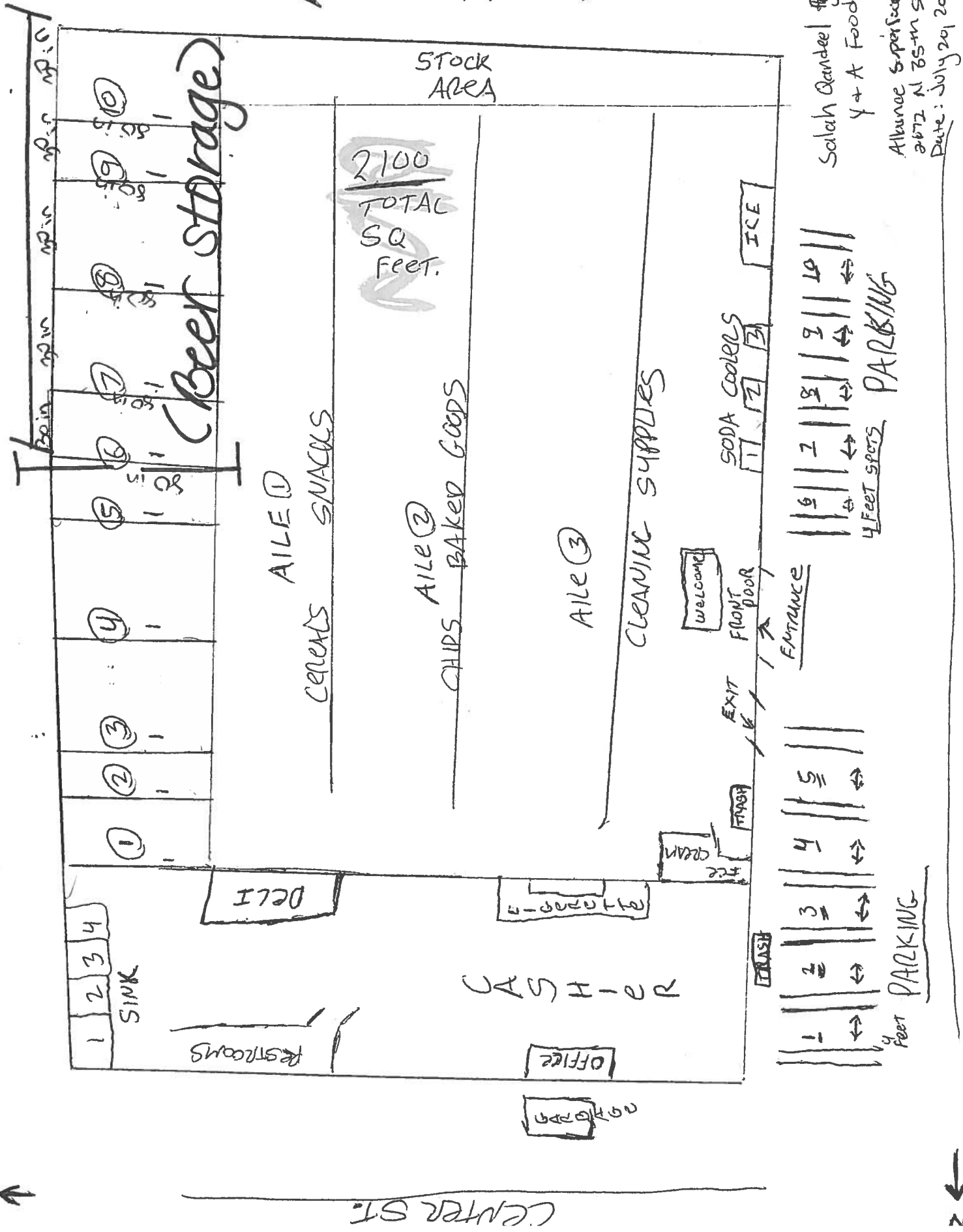

Solish Qandeel Agent for  
Y + A Food inc.

Alhance Superfood market  
2672 N 85th St

Date: July 20, 2016

←



**CITY OF MILWAUKEE  
OFFICE OF THE CITY CLERK**

Wednesday, November 16, 2016

**COMMITTEE MEETING NOTICE**

AD 15

SINGH, Balwinder, Agent  
New Rainbow, LLC  
4065 S 84th St #8

Greenfield, WI 53228

You are requested to attend a hearing which is to be held in Room 301-B, Third Floor, City Hall on:

**Tuesday, November 29, 2016 at 10:15 AM**

**Regarding:** Your Class A Malt, Food Dealer, and Weights & Measures License Renewal Applications as agent for "New Rainbow, LLC" for "New Rainbow Foods" at 1433 W North Av.

There is a possibility that your application may be denied for one or more of the following reasons: The recommendation of the committee regarding the application shall be based on evidence presented at the hearing. Per MCO 85-4-4, unless otherwise specified in the code, probative evidence concerning non-renewal, suspension or revocation may include evidence of the following: failure of the applicant to meet municipal qualifications, pending charges against or the conviction of any felony, misdemeanor, municipal offense or other offense, the circumstances of which substantially relate to the circumstances of the particular licensed or permitted activity, by the applicant or by any employee or other agent of the applicant. If the activities of the applicant involve a licensed premises, whether the premises tends to facilitate a public or private nuisance or has been the source of congregations of persons which have resulted in any of the following: disturbance of the peace; illegal drug activity; public drunkenness; drinking in public; harassment of passers-by; gambling; prostitution; sale of stolen goods; public urination; theft; assaults; battery; acts of vandalism including graffiti, excessive littering, loitering, illegal parking, loud noise at times when the licensed premise is open for business; traffic violations; curfew violations; lewd conduct; display of materials harmful to minors, pursuant to s. 106-9.6; or any other factor which reasonably relates to the public health, safety and welfare, or failure to comply with the approved plan of operation. See attached police report or correspondence.

**Notice for applicants with warrants or unpaid fines:**

Proof of warrant satisfaction or payment of fines must be submitted at the hearing on the above date and time. Failure to comply with this requirement may result in a delay of the granting/denial of your application.

Failure to appear at this meeting may result in the denial of your license. Individual applicants must appear only in person or by an attorney. Corporate or Limited Liability applicants must appear only by the agent designated on the application or by an attorney. Partnership applicants must appear by a partner listed on the application or by an attorney. If you wish to do so and at your own expense, you may be accompanied by an attorney of your choosing to represent you at this hearing.

You will be given an opportunity to speak on behalf of the application and to respond and challenge any charges or reasons given for the denial. No petitions can be accepted by the committee, unless the people who signed the petition are present at the committee hearing and willing to testify. You may present witnesses under oath and you may also confront and cross-examine opposing witnesses under oath. If you have difficulty with the English language, you should bring an interpreter with you, at your expense, so that you can answer questions and participate in your hearing.

You may examine the application file at this office during regular business hours prior to the hearing date. Inquiries regarding this matter may be directed to the person whose signature appears below.

Limited parking for persons attending meetings in City Hall is available at reduced rates (5 hour limit) at the Milwaukee Center on the southwest corner of East Kilbourn and North Water Street. Parking tickets must be validated in the first floor information booth in City Hall.

PLEASE NOTE: Upon reasonable notice, efforts will be made to accommodate the needs of disabled individuals through sign language interpreters or other auxiliary aids. For additional information or to request this service, contact the Council Services Division ADA Coordinator at (414) 286-2998, Fax - (414) 286-3456, TDD - (414) 286-2025.

JIM OW CZARSKI, CITY CLERK

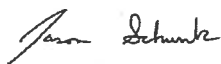
BY:   
\_\_\_\_\_  
Jason Schunk  
License Division Manager

**If you have questions regarding this notice, please contact the License Division at (414) 286-2238.**

200 E. Wells Street, Room 105, City Hall, Milwaukee, WI 53202. [www.milwaukee.gov/license](http://www.milwaukee.gov/license)  
Phone: (414) 286-2238 Fax: (414) 286-3057 Email Address: [License@milwaukee.gov](mailto:License@milwaukee.gov)

MILWAUKEE POLICE DEPARTMENT  
LICENSE INVESTIGATION UNIT

CRIMINAL RECORD/ORDINANCE VIOLATION/INCIDENTS  
SYNOPSIS

**DATE:** 10/12/2016

**LICENSE TYPE:** CLASS A MALT

**NEW:**

**RENEWAL:** X

**No.** 239955

**Application Date:** 10/12/2016

**Expiration Date:**

**License Location:** 1433 W North Avenue

**Aldermanic District:**

**Business Name:** New Rainbow, LLC

**Licensee/Applicant:** Singh, Balwinder

(Last Name, First Name, MI)

**Date of Birth:** 06/01/1965

**Male:**

**Female:**

**Home Address:** 4065 S. 84<sup>th</sup> St. #8

**City:** Greenfield

**State:** WI

**Zip Code:** 53228

**Home Phone:** (414) 327-8725

This report is written by Police Officer Gilbert Gwinn, assigned to the License Investigation Unit, Days.

The Milwaukee Police Department's investigation regarding this application revealed the following:

1. On 03/14/2011 at 5:44 pm, Milwaukee police were conducting sales of alcohol to underage persons and had a police aide who is under the age of 21, enter 2101 N 38<sup>th</sup> in attempts to purchase liquor. The aide was sold a 6 pack of Heineken beer even though he provided his ID that showed him to be under the age of 21. The clerk was identified as Vikramsingh Vala who denied selling any alcohol to an underage person. The listed agent, Balwinder Singh, was not on scene, however was advised by officers of the incident and cited. The clerk was verbally warned.

**Charge:** Sale of Alcohol to Underage Person

**Finding:** Guilty

**Sentence:** \$171.00 fine

**Date:** 05/04/2011

**Case:** 11038870

=====

2. On 09/25/2013 a Milwaukee police officer met with the applicant at 1433 West North Avenue (Rainbow Foods). The officer's purpose was to provide the applicant with a copy of Milwaukee municipal ordinance 92 as it pertains to secondhand dealers. The officer also told the applicant that he could not sell cell phones until he obtained a secondhand dealers license.
3. On 11/09/2013 a 17 year old, working in conjunction with Milwaukee police, was able to purchase a Swisher Sweets brand cigar from the applicant at 1433 West North Avenue (Rainbow Foods). The applicant was cited.

Charge: Sale of Cigarettes to Minor/Underage  
Finding: Guilty  
Sentence: \$100.00 fine  
Date: 01/10/2014  
Case: 13106745

=====

4. On 07/20/2015 the applicant was cited at 3018 North 12<sup>th</sup> Street in the city of Milwaukee for Building Code Violations.

Charge: Building Code Violations  
Finding: Guilty  
Sentence: \$780.00 fine  
Date: 02/09/2016  
Case: 15055370

=====

Item #4 previously reported, disposition added 10/12/2016.

5. On 11/14/2015 the applicant was cited at 2101 North 38<sup>th</sup> Street in the city of Milwaukee for Sale of Cigarettes to Minor/Underage.

Charge: Sale of Cigarettes to Minor/Underage  
Finding: Guilty  
Sentence: \$260.00 fine  
Date: 02/09/2016  
Case: 16001081

6. On 11/28/2015 a 17 year old, working in conjunction with Milwaukee police, was able to purchase a Black and Mild Wine Flavored Cigar from the cashier at 1433 West North Avenue (New Rainbow). The cashier was advised an M.A.R.T.S. enrollment letter would be sent to the applicant. The business did enroll in the M.A.R.T.S. program, but failed a mystery shopper inspection on 02/02/2016. Therefore, the applicant was cited.

Charge: Sale of Cigarettes to Minor/Underage  
Finding: Guilty  
Sentence: \$260.00 fine  
Date: 07/27/2016  
Case: 16038322

7. On 01/27/16, Officers were dispatched to 1433 W North Ave, to investigate a property damage complaint. The licensee called 911 regarding a citizen who was angry for not being paid for doing work at the premise. He told officers the subject wasn't employee and voluntarily helps out at the premise. The citizen became upset and was banging on the door and broke the door. A citation was issued to the subject.
8. On 03/01/2016 Milwaukee police conducted a licensed premise check at 1433 West North Avenue (New Rainbow Foods) based on a complaint from the health department regarding the robbery prevention course. The applicant stated he will make sure his employees attend the course.
9. On 03/19/16, Officers were dispatched to 1433 W North Av, to investigate a DV battery. The victim exited the store and entered a vehicle of known drug dealer. The father of the victims children opened the car door and punched the victim several times to the face. The suspect then produced a handgun and hit the victim with the firearm. A temporary warrant was placed for the suspect who was not on the scene.
10. On 06/04/2016 the applicant was cited at 2101 West Lloyd Street in the city of Milwaukee for Sale of Cigarettes to Minor/Underage.

Charge: Sale of Cigarettes to Minor/Underage  
Finding: Due for arraignment 10/14/2016 1:30pm branch 1  
Sentence:  
Date:  
Case: 16052846



PA-33E Narrative

This report is written by P.O. Frank YINKO, District Three, Late Power Shift.

This report is based on CAD#160272735.

MPD officers were dispatched to 1433 W. North Ave. (New Rainbow Foods) on 01-27/16, at 9:00pm, for a Property Damage.

The licensee of the premise called 911, regarding an citizen who was angry about not being paid for working at the premise. He advised officers he never hired the citizen, but the citizen voluntarilly helps out at the premise. The citizen was upset, and demanded to get paid for his services. The licensee was forced to close the premise, due to the disturbance created by the citizen.

The citizen became increasingly upset, banged on the door, and demanded and demanded to get paid. The licensee would not unlock the door, and the citizen hit the door until he broke it.

The responding officers will issue "Ryan JACKSON" a Property Damage citation in the future.

Squads on scene:

3221 - P.O. William SCHMITZ and P.O. Dexter LEE





PA-33E Narrative

This report is written by P.O. Frank YINKO, District Three, Late Power Shift.

This report is based on officers reports under MPD IR#160790138.

On 03-19-16, at 6:54pm, MPD officers were dispatched to 1433 W. North Ave. (New Rainbow Foods) for a Battery DV.

The victim exited the premise, and entered a vehicle of a drug dealer known to the victim. The father (suspect) of the victim's children, observed her go into the drug dealer's vehicle. The suspect opened the car door and punched the victim in the face two to three times.

The suspect than produced a handgun, and struck the victim twice in the face and once in the back of the head.

The officers were unable to locate the suspect, and a temporary misdemeanor want for Battery DV (while Armed) was entered for the suspect.

Squads on scene:

3221 - P.O. William SCHMITZ and P.O. Natalie CRUZ

3251 - P.O. Kevin GAULKE and P.O. Dexter LEE

755 - P.O. Jeffrey LEPIANKA

3215 - Sgt. Michael PELNAR

3270 - P.O. Randall PEREZ



**PA-33E Narrative**

This report is written by PO Penny BROWN assigned to the License Investigation Unit. On Saturday, November 28, 2015, I was assigned to work the Wisconsin WINS Youth Tobacco Initiative, which checks area vendors for age compliance tobacco purchases. Assisting in this assignment was Najila N. HINTON B/F 12/06/97, 2831 N. 45<sup>th</sup> St., Milwaukee, WI 53210. HINTON is 17 years old and not of legal age to purchase tobacco. A photo of HINTON was taken at the beginning of the assignment for identification.

At approximately 11:05A, HINTON entered New Rainbow, located at 1433 W. North Ave., and purchased a Black and Mild Wine Flavored Cigar. HINTON provided a description of the cashier that sold her the tobacco. I entered the store and spoke with the cashier that matched the description. The subject was identified as Tracy L. MUELLER W/F 12/22/70. MUELLER admitted to the sale and stated she did check her identification, however, failed to realize HINTON had not turned 18 years old. MUELLER was advised an enrollment letter for the M.A.R.T.S. program would be mailed to the agent.



PA-33E Narrative

This report is written by PO Penny BROWN assigned to the License Investigation Unit. On Saturday, November 28, 2015, I was assigned to work the Wisconsin WINS Youth Tobacco Initiative, which checks area vendors for age compliance tobacco purchases. Assisting in this assignment was Najila N. HINTON B/F 12/06/97, 2831 N. 45<sup>th</sup> St., Milwaukee, WI 53210. HINTON is 17 years old and not of legal age to purchase tobacco. A photo of HINTON was taken at the beginning of the assignment for identification.

At approximately 11:05A, HINTON entered New Rainbow, located at 1433 W. North Ave., and purchased a Black and Mild Wine Flavored Cigar. HINTON provided a description of the cashier that sold her the tobacco. I entered the store and spoke with the cashier that matched the description. The subject was identified as Tracy L. MUELLER W/F 12/22/70. MUELLER admitted to the sale and stated she did check her identification, however, failed to realize HINTON had not turned 18 years old. MUELLER was advised an enrollment letter for the M.A.R.T.S. program would be mailed to the agent.

The establishment did enroll in the M.A.R.T.S. program, however, there was a failed mystery shopper inspection on 02/02/16. Therefore, a citation was mailed for the initial violation.

# MILWAUKEE POLICE DEPARTMENT

## REPORT OF INCIDENTS INVOLVING LICENSED PERSONS OR PREMISES

TO: Derrick L. HARRIS

Business Name: New Rainbow Foods  
Address of Licensed Premises: 1433 W. North Ave.  
Business Phone: 414-265-7481

Type of License: Class A

District: 3

Violation /  Incident #

Date of Incident: 03/01/16

Licensee or Manager on premises at time of violation / incident?  Yes  No

Licensee cooperative?  Yes  No (If no, explain in narrative section)

Licensee Notified by Officer: PO Penny Brown

Date: 03/01/16

Time: 9:00A

Licensee or Agent's Name: SINGH, Balwinder  
Home Address: 4065 S. 84<sup>th</sup> St. #3 Greenfield, WI 53228

Date of Birth: 6/1/65  
Home Phone: 414-327-8725

Co-Licensee Name:  
Home Address:  
Class S License Number:

Date of Birth:  
Home Phone:

Bartender Name:  
Home Address:  
Class D License Number:

Date of Birth:  
Home Phone:

Licensed Person / Public Pass. Vehicle, etc.:  
Home Address:  
Class D License Number:

Date of Birth:  
Home Phone:

### VIOLATION/INCIDENT - DESCRIBE FACTS AND CIRCUMSTANCES IN NARRATIVE SECTION

Name of Person Cited:  
Citation Number:

Violation & Ord. / Statue No.:

Date of Birth:  
Court Date:

Name of Person Cited:  
Citation Number:

Violation & Ord. / Statue No.:

Date of Birth:  
Court Date:

Name of Person Cited:  
Citation Number:

Violation & Ord. / Statue No.:

Date of Birth:  
Court Date:

Name of Person Cited:  
Citation Number:

Violation & Ord. / Statue No.:

Date of Birth:  
Court Date:

Name of Person Cited:  
Citation Number:

Violation & Ord. / Statue No.:

Date of Birth:  
Court Date:

Investigating Officer: PO Penny Brown

District / Bureau: L.I.U.

Date: 03/01/16

Sgt CLP  
Commanding Officer

3-2-16  
Date

### DISPOSITION - FOR LICENSING ONLY

Citation No.	Case Number	Disposition	Judge	Date
		LICENSE INVESTIGATION UNIT		
		Received		3-2-16
		Referred		

By Sgt CLP

PA-33E Narrative

This report is written by PO Penny Brown assigned to the License Unit. On Tuesday, March 01, 2016, I conducted a license premise check at New Rainbow Foods, located at 1433 W. North Ave.

This was as a result of a complaint from the City of Milwaukee Health Department regarding the Robbery Prevention Course. Health Inspector Rob KIESER, conducted an inspection and found the owner, Balwinder SINGH, had completed the course, however, none of his employees had. I interviewed SINGH regarding this and he stated KIESER was in his establishment a few weeks ago and advised him of this. I advised SINGH the next date for the course was April 7, 2016. SINGH stated he will comply and make sure both his employees attend the course.





Wednesday, November 16, 2016



# Notice of Public Hearing

---

SINGH, Balwinder, Agent  
New Rainbow Foods at 1433 W North Av  
Class A Malt, Food Dealer, and Weights & Measures License Renewal Applications

**Tuesday, November 29, 2016 at 10:15 AM**

To whom it may concern:

The above application has been made by the above named applicant(s). This requires approval from the Licenses Committee and the Common Council of the City of Milwaukee. The hearing before the Licenses Committee will take place on 11/29/2016 at 10:15 AM, in Room 301-B, Third Floor, City Hall. If you wish, you may provide testimony at the hearing regarding the request; see below for further information. You are not required to attend the hearing. Once the Licenses Committee makes its recommendation, this recommendation is forwarded to the full Common Council for approval at its next regularly scheduled hearing. Please review the information below and if you have further questions regarding this process, please contact the License Division at (414) 286-2238.

---

## Important details for those wishing to provide information for the Licenses Committee to consider when making its recommendation:

1. The license application is scheduled to be heard at the above time. Due to other hearings running longer than scheduled, you may have to wait some time to provide your testimony.
2. You must appear in person and testify as to matters that you have personally experienced or seen. (You cannot provide testimony for your neighbor, parent or anyone else; this is considered hearsay and cannot be considered by the committee.)
3. No letters or petitions can be accepted by the committee (unless the person who wrote the letter or the persons who signed the petition are present at the committee hearing and willing to testify).
4. Persons opposed to the license application are given the opportunity to testify first; supporters may testify after the opponents have finished.
5. When you are called to testify, you will be sworn in and asked to give your name, and address. (If your first and/or last names are uncommon please spell them.)
6. You may then provide testimony.
  - a. Include only information relating to the above license application.
  - b. Include only information you have personally witnessed or seen.
  - c. Provide concise and relevant information detailing how this business has affected or may affect the peaceful enjoyment of your neighborhood.
  - d. If by the time you have the opportunity to testify, the information you wish to share has already been provided to the committee, you may state that you agree with the previous testimony. Redundant or repetitive testimony will not assist the committee in making its recommendation.
7. After giving your testimony, the members of the Licenses Committee and the licensee may ask questions regarding the testimony you have given or other factors relating to the license application.
8. Business Competition is not a valid basis for denial or non-renewal of a license.  
**Please Note: If you have submitted an objection to the above application your objection cannot be considered by the committee unless you personally testify at the hearing.**

OCCUPANT	MAIL ADDRESS	CITY AND ZIP CODE
CURRENT OCCUPANT	2256A N 15TH ST	MILWAUKEE, WI 53205-1211
CURRENT OCCUPANT	2236 N 15TH ST	MILWAUKEE, WI 53205-1211
CURRENT OCCUPANT	2245 N 14TH ST	MILWAUKEE, WI 53205-1206
CURRENT OCCUPANT	2231 N 14TH ST	MILWAUKEE, WI 53205-1206
CURRENT OCCUPANT	2233 N 14TH ST	MILWAUKEE, WI 53205-1206
CURRENT OCCUPANT	2256B N 15TH ST	MILWAUKEE, WI 53205-1211
CURRENT OCCUPANT	2325 N 14TH ST	MILWAUKEE, WI 53206-2511
CURRENT OCCUPANT	2237 N 15TH ST	MILWAUKEE, WI 53205-1212
CURRENT OCCUPANT	2324 N 15TH ST	MILWAUKEE, WI 53206-2005
CURRENT OCCUPANT	2250 N 15TH ST	MILWAUKEE, WI 53205-1211
CURRENT OCCUPANT	2327 N 14TH ST	MILWAUKEE, WI 53206-2511
CURRENT OCCUPANT	2239 N 14TH ST	MILWAUKEE, WI 53205-1206
CURRENT OCCUPANT	2261 N 14TH ST	MILWAUKEE, WI 53205-1206
CURRENT OCCUPANT	2243 N 15TH ST	MILWAUKEE, WI 53205-1212
CURRENT OCCUPANT	2229 N 15TH ST	MILWAUKEE, WI 53205-1212
CURRENT OCCUPANT	2324A N 15TH ST	MILWAUKEE, WI 53206-2005
CURRENT OCCUPANT	2227 N 14TH ST	MILWAUKEE, WI 53205-1206
CURRENT OCCUPANT	2228 N 15TH ST	MILWAUKEE, WI 53205-1211
CURRENT OCCUPANT	2323 N 14TH ST	MILWAUKEE, WI 53206-2511
CURRENT OCCUPANT	2239 N 15TH ST	MILWAUKEE, WI 53205-1212
CURRENT OCCUPANT	2233 N 15TH ST	MILWAUKEE, WI 53205-1212
CURRENT OCCUPANT	2259 N 14TH ST	MILWAUKEE, WI 53205-1206
CURRENT OCCUPANT	2256 N 15TH ST	MILWAUKEE, WI 53205-1211
CURRENT OCCUPANT	2234 N 15TH ST	MILWAUKEE, WI 53205-1211
CURRENT OCCUPANT	2329 N 14TH ST	MILWAUKEE, WI 53206-2511

**Total Records: 26**

**Radius: 250.0 feet and Center of Circle: 1433 W North AV**

# 2016-2017 Plan of Operation for 1433 W NORTH AV

## 1. Litter & Security Plans

How are the grounds kept clean?  Sweep  Pressure Wash  Pick Up Litter  Other:

How often will grounds be cleaned?  Daily  Weekly  Other:

Who cleans the grounds?  Licensee  Building Owner  Employees  Hired Maintenance  Other:

How are noise issues prevented and/or addressed?  Security  Manager approaches customer(s)  Call Police  Signs Posted  Other:

Are there designated outdoor smoking areas?  No  Yes If Yes, Describe: No smoking in or around store.

Number of garbage cans: Inside 3 Locations: Cashier, Deli, Door  
 Outside 2 Locations: By door, behind building

Is a crowd control barrier used?  No  Yes If Yes, Describe:

Number of restrooms: 1 Name of solid waste contractor: Advanced Disposal

Are there parking spaces on the premises?  No  Yes If Yes, list number of spaces: 5 and describe security plans:  
Lighted parking lot with security cameras

Are there designated loading areas?  No  Yes If Yes, describe security plans:

Do you have security personnel on the premise?  No  Yes If Yes, how many? \_\_\_\_\_  
 AND What are their responsibilities? \_\_\_\_\_  
 What security equipment do they use? \_\_\_\_\_  
 List their licensing, certification or training credentials: \_\_\_\_\_

Are there security cameras?  No  Yes If Yes, list all locations: 9 cameras at various locations (2 outside, 7 inside)

Are searches and/or identification checks conducted upon entry?  No  Yes If Yes, describe:

## 2. Percentage of Sales (must total 100%)

Alcohol 10 % Food Sales 80 % Entertainment \_\_\_\_\_ % Other 10 %

## 3. Businesses On The Premises (choose all that apply):

Restaurant  Cafe/Coffee Shop  Cocktail Lounge  Convenience Store  Night Club  Liquor Store  Tavern  Sports Facility  
 Hotel  Banquet Hall  Supermarket  Private/Fraternal/Veterans' Club  Other:

## 4. Hours of Operation and Age Restriction

Are there any changes to the current hours of operation or age restriction?  No  Yes If Yes, Describe:

Please Note: If you will be open earlier or later than the hours listed on your current license for even one event or holiday (for example, St. Patrick's Day, Brewers Opening Day, etc.) during the license period, this must be reported and printed on your license.  
 Your hours of operation and age restriction are listed on your current license.

## 5. Floor Plan and Capacity

Are you requesting any changes to the floor plan or capacity?  No  Yes If Yes, Describe:

If requesting changes to the floor plan, submit a new floor plan with this application. Changes in floor plan include changing the location of tables, games, etc. within your current licensed premises. If your changes include adding any additional areas or square footage to your premises, or any renovations to the building will be done, a Permanent Extension of Premises application must be filed.

## 6. Sidewalk Dining (If renewing a current license - Renewal Fee : \$)

Are there any changes to the sidewalk dining site plan?  No  Yes If Yes, submit an updated site plan with this application.

## 7. Food Licenses (If renewing a current license - Renewal Fee : \$300)

Do you sell ONLY prepackaged foods?  No  Yes  
 If yes, do you sell ONLY non hazardous foods?  No  Yes (FROZEN PIZZA is a HAZARDOUS FOOD)  
 If you answered YES to both questions, YOU DO NOT NEED TO RENEW YOUR FOOD LICENSE.



# WEIGHTS AND MEASURES LICENSE SUPPLEMENTAL RENEWAL APPLICATION

OFFICE OF THE CITY CLERK, LICENSE DIVISION  
 CITY HALL, 200 E. WELLS ST, ROOM 105, MILWAUKEE, WI 53202  
 (414) 286-2238 • [license@milwaukee.gov](mailto:license@milwaukee.gov) • [www.milwaukee.gov/license](http://www.milwaukee.gov/license)

Establishment Name/Address: **New Rainbow, LLC dba New Rainbow Foods 1433 W NORTH AV**

## 1. Type(s) of Devices

The Type(s) and number of Devices you're currently licensed for are listed below. The renewal fee for these devices has been provided. If additional devices need to be added, please refer to the table below for the fees. If adding devices, please check the appropriate box, and include the additional fee with your renewal application.

**Current W&M Type(s): Scales: 0 to 300 pounds Quantity- 1      Renewal Fee: \$50.42**

Check the type of device permit requested. For each item checked designate the number of devices and calculate the fee per device type by multiplying the value in column (a) by the value in column (b):

Device	License Period	Fee Per Device (a)	Number of Devices (b)	Amount (a x b)
<b>Liquid Measuring Devices</b>				
<input type="checkbox"/> Retail Petroleum Meters	12 months	\$60		
<input type="checkbox"/> 0 to 30 gallons per minute	24 months	\$60		
<input type="checkbox"/> 31 to 200 gallons per minute	24 months	\$250		
<input type="checkbox"/> Over 200 gallons per minute	24 months	\$250		
<b>Scales</b>				
<input type="checkbox"/> 0 to 300 pounds	24 months	\$55		
<input type="checkbox"/> 301 to 5,000 pounds	24 months	\$190		
<input type="checkbox"/> 5,001 to 40,000 pounds	24 months	\$300		
<input type="checkbox"/> Over 40,000 pounds	24 months	\$400		
<b>Scanners</b>				
<input type="checkbox"/> Up to 3 scanners	24 months	\$130	Not applicable	\$130
<input type="checkbox"/> Four or more scanners	24 months	\$250	Not applicable	\$250
<b>Other Devices</b>				
<input type="checkbox"/> Length Measuring Device	24 months	\$60		
<input type="checkbox"/> Taxi Cab Meter	24 months	\$130		
<input type="checkbox"/> Timing Device	24 months	\$30		
<b>Total</b>				

## 3. Acknowledgement & Signatures

Read and initial all statements and sign the supplemental application. The supplemental application will be returned if all areas are not initialed or signed.

BS By signing this application, I hereby agree that I will comply with the applicable sections of the Wisconsin State Statutes, Administrative Code and the Milwaukee Code of Ordinances regarding the operation of weighing and measuring devices.

BS I understand that all devices must be operated within the specifications, tolerances and other technical requirements set forth in the National Institute of Standards and Technology Handbook 44 (specifications, tolerances and other technical requirements for weighing and measuring devices)

BS I understand that the license/permit for which I am applying must be issued and posted in my business premises or in my vehicle prior to opening for business or operating the device.

BS I acknowledge that as a condition of being issued this permit, I must allow the Health Department into the establishment to test the device to validate its specifications/tolerances. If my devices are found out of compliance, I may be charged inspection fees.

*Balwin def*

Date: 10-12-16

Signature of Sole Proprietor, Partner, 20% or more Shareholder  
 or Agent – if there are no 20% or more shareholders



**CITY OF MILWAUKEE  
OFFICE OF THE CITY CLERK**

Wednesday, November 16, 2016

**COMMITTEE MEETING NOTICE**

AD 15

Raghwinder Singh, BALJEET KAUR, Partners

3833 W CENTER St

MILWAUKEE, WI 53210

You are requested to attend a hearing which is to be held in Room 301-B, Third Floor, City Hall on:

**Tuesday, November 29, 2016 at 10  AM**

**Regarding:** Your Class A Malt and Food Dealer License Renewal Applications partnership as agent for "" for "QUICK FOOD MARKET" at 3833 W CENTER St.

There is a possibility that your application may be denied for one or more of the following reasons: The recommendation of the committee regarding the application shall be based on evidence presented at the hearing. Per MCO 85-4-4, unless otherwise specified in the code, probative evidence concerning non-renewal, suspension or revocation may include evidence of the following: failure of the applicant to meet municipal qualifications, pending charges against or the conviction of any felony, misdemeanor, municipal offense or other offense, the circumstances of which substantially relate to the circumstances of the particular licensed or permitted activity, by the applicant or by any employee or other agent of the applicant. If the activities of the applicant involve a licensed premises, whether the premises tends to facilitate a public or private nuisance or has been the source of congregations of persons which have resulted in any of the following: disturbance of the peace; illegal drug activity; public drunkenness; drinking in public; harassment of passers-by; gambling; prostitution; sale of stolen goods; public urination; theft; assaults; battery; acts of vandalism including graffiti, excessive littering, loitering, illegal parking, loud noise at times when the licensed premise is open for business; traffic violations; curfew violations; lewd conduct; display of materials harmful to minors, pursuant to s. 106-9.6; or any other factor which reasonably relates to the public health, safety and welfare, or failure to comply with the approved plan of operation. See attached police report or correspondence.

**Notice for applicants with warrants or unpaid fines:**

Proof of warrant satisfaction or payment of fines must be submitted at the hearing on the above date and time. Failure to comply with this requirement may result in a delay of the granting/denial of your application.

Failure to appear at this meeting may result in the denial of your license. Individual applicants must appear only in person or by an attorney. Corporate or Limited Liability applicants must appear only by the agent designated on the application or by an attorney. Partnership applicants must appear by a partner listed on the application or by an attorney. If you wish to do so and at your own expense, you may be accompanied by an attorney of your choosing to represent you at this hearing.

You will be given an opportunity to speak on behalf of the application and to respond and challenge any charges or reasons given for the denial. No petitions can be accepted by the committee, unless the people who signed the petition are present at the committee hearing and willing to testify. You may present witnesses under oath and you may also confront and cross-examine opposing witnesses under oath. If you have difficulty with the English language, you should bring an interpreter with you, at your expense, so that you can answer questions and participate in your hearing.

You may examine the application file at this office during regular business hours prior to the hearing date. Inquiries regarding this matter may be directed to the person whose signature appears below.

Limited parking for persons attending meetings in City Hall is available at reduced rates (5 hour limit) at the Milwaukee Center on the southwest corner of East Kilbourn and North Water Street. Parking tickets must be validated in the first floor information booth in City Hall.

PLEASE NOTE: Upon reasonable notice, efforts will be made to accommodate the needs of disabled individuals through sign language interpreters or other auxiliary aids. For additional information or to request this service, contact the Council Services Division ADA Coordinator at (414) 286-2998, Fax - (414) 286-3456, TDD - (414) 286-2025.

**JIM OWCZARSKI, CITY CLERK**

BY: \_\_\_\_\_

Jason Schunk  
License Division Manager

**If you have questions regarding this notice, please contact the License Division at (414) 286-2238.**

200 E. Wells Street, Room 105, City Hall, Milwaukee, WI 53202. [www.milwaukee.gov/license](http://www.milwaukee.gov/license)  
Phone: (414) 286-2238 Fax: (414) 286-3057 Email Address: [License@milwaukee.gov](mailto:License@milwaukee.gov)

MILWAUKEE POLICE DEPARTMENT  
LICENSE INVESTIGATION UNIT

CRIMINAL RECORD/ORDINANCE VIOLATION/INCIDENTS  
SYNOPSIS

DATE: 10/13/2016  
LICENSE TYPE: AMALT  
NEW:  
RENEWAL: X

No. 240031  
Application Date: 10/12/2016  
Expiration Date:

License Location: 3833 W Center Street  
Business Name: Quick Food Market

Aldermanic District:15

Licensee/Applicant: Singh, Raghwinder  
(Last Name, First Name, MI)  
Date of Birth: 05/20/57

Male: X Female:

Home Address: 7355 S. Cambridge Dr.  
City: Franklin  
Home Phone: (414) 425-5972

State: WI Zip Code: 53132

This report is written by Police Officer Gilbert Gwinn, assigned to the License Investigation Unit, Days.

The Milwaukee Police Department's investigation regarding this application revealed the following:

1. On 1-17-06, police officers, along with an underage police aide, conducted a premises check at Quick Food Market, 3833 W Center Street. The police aide entered the premises and purchased a 6 pack of Seagrams Smooth Green Machine for \$7.50 from the clerk Kuldip Singh. Applicant is the licensee at that premises, and was issued the following citation.

Charge: Sale of Alcohol to Underage  
Finding: Guilty  
Sentence: Fined \$100.00  
Date: 09/18/06  
Case: 06016158  
Citation: 59251161

- On 11/08/99, applicant was convicted of OWI in Milwaukee County. His license was suspended for 6 months.

- 
2. On 05/17/06 the applicant was cited in the City of Milwaukee for Building and Zoning Violation at 4028 W. Lisbon Ave.

Charge: Building and Zoning Violation  
Finding: Guilty, Municipal Court  
Sentence: \$150.00 fine  
Date: 12/12/06  
Case: 06054876

---

**Applicant's name on the liquor license application shows Raghwinder S Nat however DOT shows applicants name as Raghwinder Singh. The below listed incident is under the name Raghwinder Singh.**

- On 08/16/10, applicant was charged with OWI in Milwaukee County.

Charge: OWI  
Finding: **Guilty**  
Sentence: License revoked for 6 months  
Date: **01/19/11**  
Case: 10TR027943

- On 09/15/10, applicant was convicted of BAC in Milwaukee County. His license was suspended for 6 months.

=====

Singh's charge of OWI on 08/16/10 was updated on 10/07/11.

3. On 03/07/11 at 8:29 pm, Milwaukee police conducted a License Premise Check at 3833 W Center Avenue. Investigation found that the clerk, identified as Mangit Shergill, did not have a valid a bartender's license as well as another employee who was identified as Sukswinder Singh. Officers later spoke with the licensee Raghwinder Singh who was advised of the incident and he was cited for Responsible Person on Premised Required.

Charge: Responsible Person on Premise  
Finding: Guilty  
Sentence: Fined \$368.00  
Date: 09/19/11  
Case: 11034961

- =====
4. On 02/26/13 at 3:08 pm, Milwaukee police conducted a License Premise Check at 3833 W Center Street. Investigation found that clerk, Bhagwant Singh, did not have a valid bartender's license and the agent, Raghwinder Singh, was not on scene, nor was any other licensed employee. The wife of Raghwinder Singh arrived on scene shortly after and advised police that she told Bhagwant not to sell any alcohol while she was gone. Raghwinder Singh was cited for Responsible person on Premise Required. Bhagwant Singh was cited for no license.

As to Raghwinder Singh:

Charge: Responsible Person on Premise Required  
Finding: Dismissed w/o prejudice  
Date: 09/19/13  
Case: 13029497

As to Bhagwant Singh:

Charge: Class D Operator's License  
Finding: Guilty  
Sentence: Fined \$388.00  
Date: 07/25/13  
Case: 13029496

5. On 05/13/13, applicant received a citation for Building Code Violations at 4028 W Lisbon Avenue.

Charge: Building Code Violations  
Finding: Guilty  
Sentence: \$480.00 fine \*\*\*in warrant status\*\*\*  
Date: 11/19/2013  
Case: 13075227

=====  
**Item #5 previously reported, disposition added 10/23/2014. This item is now in warrant status.**

6. On 10/11/2012 the applicant was cited at 4028 West Lisbon Avenue in the city of Milwaukee for Building Code Violations.

Charge: Building Code Violations  
Finding: Guilty  
Sentence: \$230.00 fine  
Date: 05/07/2013  
Case: 13015169

- =====  
7. On May 10, 2016, Officers were dispatched to a property damage complaint at 3833 W Center. Three juveniles entered the premise and attempted to steal food. During the theft the subjects kicked in an office door, breaking the glass. Subjects fled before officers arrived.
8. On July, 10, 2016, a subject entered 3833 W Center and took a bottle of alcohol and placed it into his pants. The subject then exited the store without paying for the item. The clerk followed the subject and informed him he had to pay for the item and upon seeing a second subject waiting outside he informed them no to return to the store. The subjects later returned to the store, armed with bats. One subject struck the clerk in the hand with the bat. The clerk retrieved a pipe to defend himself and the subjects left the store. The clerk exited the store and found the store owners cars windows were broken. Video could not accessed because of a security code.
  9. On 10/01/2016 a 17 year old, working in conjunction with Milwaukee police, was able to purchase a pack of Newport cigarettes from the cashier at 3833 West Center Street (Quick Food Market). The cashier was advised a notice to enroll in the M.A.R.T.S. program would be mailed to the agent.





PA-33E Narrative

This report is written by P.O. Michael FASULO, District #3, Late Power Shift.

This report is a summary of reports filed by investigating officers.

On May 10, 2016 at 8:14pm, Officers were dispatched to premise for a property damage complaint. 3 black male juveniles entered the premise and attempted to steal soda. During the process the subjects kicked in an office door breaking the glass. Subjects fled premise on foot.

Squads on scene: 3230 (P.O. Daniel MEILICKE and P.O. Alexander REED)



PA-33E Narrative

This report is written by P.O. Michael FASULO, District #3, Late Power Shift.

This report is a summary of reports written by investigating officers.

On Sunday, July 10, 2016 a black male subject entered the premise, took 2 40oz bottles of Old English Malt liquor and placed them into his pants. The subject then went past the last point of sale and exited the premise without paying. The premise clerk exited the premise informing the subject he needed to pay for items. The clerk observed a second subject and told them not to return to the premise.

The subjects returned later to the premise armed with baseball bats. The clerk began yelling at the subjects to leave the premise. Subject #1 then swung the baseball bat at the clerk in an attempt to strike him. The clerk put up his right hand to block the bat and was struck in the right hand. The clerk retreated to the back of the store and retrieved a pipe to defend himself. The 2 subjects then exited the premise. The clerk exited the premise and found the owners vehicle with 7 of its 8 windows smashed out. The premise had working video, but it could not be accessed at the time by officers, because of a security code.

Squads on Scene: 251 (P.O. Minisha HOWARD and P.O. Troy CARUS)  
1730 (Forensic Investigator Alan WINTER)



PA-33E Narrative

This report is written by PO Penny BROWN assigned to the License Investigation Unit. On Saturday, October 1, 2016, I was assigned to work the Wisconsin WINS Youth Tobacco Initiative, which checks area vendors for age compliance tobacco purchases. Assisting in this assignment was: Quaveion D. BROWN B/M 03/27/99 4229 N. 76<sup>th</sup> St. phone #414-629-3763. BROWN is 17 years old and not of legal age to purchase tobacco.

At approximately 10:43A, BROWN entered Quick Food Market, located at 3833 W. Center St., and purchased a pack of Newport 100's in the box. Based on the description provided to me by BROWN, I was able to immediately identify the cashier: Baljeet KAUR A/F 10/16/46. KAUR stated she did not recall if she sold to BROWN or not. I advised KAUR3 I would be mailing out a notice to enroll in the M.A.R.T.S. program to the registered agent.



Wednesday, November 16, 2016



# Notice of Public Hearing

---

SINGH, Raghwinder AND KAUR, Baljeet  
QUICK FOOD MARKET at 3833 W CENTER St  
Class A Malt and Food Dealer License Renewal Applications

**Tuesday, November 29, 2016 at 10:15 AM**

To whom it may concern:

The above application has been made by the above named applicant(s). This requires approval from the Licenses Committee and the Common Council of the City of Milwaukee. The hearing before the Licenses Committee will take place on 11/29/2016 at 10:15 AM, in Room 301-B, Third Floor, City Hall. If you wish, you may provide testimony at the hearing regarding the request; see below for further information. You are not required to attend the hearing. Once the Licenses Committee makes its recommendation, this recommendation is forwarded to the full Common Council for approval at its next regularly scheduled hearing. Please review the information below and if you have further questions regarding this process, please contact the License Division at (414) 286-2238.

---

## Important details for those wishing to provide information for the Licenses Committee to consider when making its recommendation:

1. The license application is scheduled to be heard at the above time. Due to other hearings running longer than scheduled, you may have to wait some time to provide your testimony.
2. You must appear in person and testify as to matters that you have personally experienced or seen. (You cannot provide testimony for your neighbor, parent or anyone else; this is considered hearsay and cannot be considered by the committee.)
3. No letters or petitions can be accepted by the committee (unless the person who wrote the letter or the persons who signed the petition are present at the committee hearing and willing to testify).
4. Persons opposed to the license application are given the opportunity to testify first; supporters may testify after the opponents have finished.
5. When you are called to testify, you will be sworn in and asked to give your name, and address. (If your first and/or last names are uncommon please spell them.)
6. You may then provide testimony.
  - a. Include only information relating to the above license application.
  - b. Include only information you have personally witnessed or seen.
  - c. Provide concise and relevant information detailing how this business has affected or may affect the peaceful enjoyment of your neighborhood.
  - d. If by the time you have the opportunity to testify, the information you wish to share has already been provided to the committee, you may state that you agree with the previous testimony. Redundant or repetitive testimony will not assist the committee in making its recommendation.
7. After giving your testimony, the members of the Licenses Committee and the licensee may ask questions regarding the testimony you have given or other factors relating to the license application.
8. Business Competition is not a valid basis for denial or non-renewal of a license.  
**Please Note: If you have submitted an objection to the above application your objection cannot be considered by the committee unless you personally testify at the hearing.**

OCCUPANT	MAIL ADDRESS	CITY AND ZIP CODE
CURRENT OCCUPANT	2708 N 39TH ST	MILWAUKEE, WI 53210-2550
CURRENT OCCUPANT	2717 N 39TH ST	MILWAUKEE, WI 53210-2551
CURRENT OCCUPANT	2672 N 40TH ST	MILWAUKEE, WI 53210-2504
CURRENT OCCUPANT	2669 N 39TH ST	MILWAUKEE, WI 53210-2503
CURRENT OCCUPANT	2644 N 40TH ST	MILWAUKEE, WI 53210-2504
CURRENT OCCUPANT	2677 N 39TH ST	MILWAUKEE, WI 53210-2503
CURRENT OCCUPANT	2663 N 39TH ST	MILWAUKEE, WI 53210-2503
CURRENT OCCUPANT	2629 N 39TH ST	MILWAUKEE, WI 53210-2503
CURRENT OCCUPANT	3912A W CENTER ST	MILWAUKEE, WI 53210-2556
CURRENT OCCUPANT	2674 N 40TH ST	MILWAUKEE, WI 53210-2504
CURRENT OCCUPANT	2651 N 39TH ST	MILWAUKEE, WI 53210-2503
CURRENT OCCUPANT	2631 N 39TH ST	MILWAUKEE, WI 53210-2503
CURRENT OCCUPANT	2715 N 38TH ST	MILWAUKEE, WI 53210-2549
CURRENT OCCUPANT	3912B W CENTER ST	MILWAUKEE, WI 53210-2556
CURRENT OCCUPANT	2662 N 40TH ST	MILWAUKEE, WI 53210-2504
CURRENT OCCUPANT	2651A N 39TH ST	MILWAUKEE, WI 53210-2503
CURRENT OCCUPANT	2645 N 39TH ST	MILWAUKEE, WI 53210-2503
CURRENT OCCUPANT	2647 N 39TH ST	MILWAUKEE, WI 53210-2503
CURRENT OCCUPANT	2641A N 39TH ST	MILWAUKEE, WI 53210-2503
CURRENT OCCUPANT	2641 N 39TH ST	MILWAUKEE, WI 53210-2503
CURRENT OCCUPANT	2635 N 39TH ST	MILWAUKEE, WI 53210-2503
CURRENT OCCUPANT	3912 W CENTER ST	MILWAUKEE, WI 53210-2556
CURRENT OCCUPANT	2709 N 39TH ST	MILWAUKEE, WI 53210-2551
CURRENT OCCUPANT	2706 N 39TH ST	MILWAUKEE, WI 53210-2550
CURRENT OCCUPANT	2654 N 40TH ST	MILWAUKEE, WI 53210-2504
CURRENT OCCUPANT	2650 N 40TH ST	MILWAUKEE, WI 53210-2504
CURRENT OCCUPANT	2675 N 39TH ST	MILWAUKEE, WI 53210-2503
CURRENT OCCUPANT	2661 N 39TH ST	MILWAUKEE, WI 53210-2503
CURRENT OCCUPANT	2637 N 39TH ST	MILWAUKEE, WI 53210-2503
CURRENT OCCUPANT	2719 N 38TH ST	MILWAUKEE, WI 53210-2549
CURRENT OCCUPANT	2709 N 38TH ST	MILWAUKEE, WI 53210-2549
CURRENT OCCUPANT	2668 N 40TH ST	MILWAUKEE, WI 53210-2504
CURRENT OCCUPANT	2646 N 40TH ST	MILWAUKEE, WI 53210-2504
CURRENT OCCUPANT	2667 N 39TH ST	MILWAUKEE, WI 53210-2503
CURRENT OCCUPANT	2655 N 39TH ST	MILWAUKEE, WI 53210-2503
CURRENT OCCUPANT	2704 N 39TH ST	MILWAUKEE, WI 53210-2550
CURRENT OCCUPANT	3823 W CENTER ST	MILWAUKEE, WI 53210-2555
CURRENT OCCUPANT	3812 W CENTER ST	MILWAUKEE, WI 53210-2554
CURRENT OCCUPANT	2713 N 39TH ST	MILWAUKEE, WI 53210-2551
CURRENT OCCUPANT	2719 N 39TH ST	MILWAUKEE, WI 53210-2551
CURRENT OCCUPANT	2724 N 39TH ST	MILWAUKEE, WI 53210-2550
CURRENT OCCUPANT	2708 N 40TH ST	MILWAUKEE, WI 53210-2545
CURRENT OCCUPANT	2702 N 40TH ST	MILWAUKEE, WI 53210-2545
CURRENT OCCUPANT	2670 N 40TH ST	MILWAUKEE, WI 53210-2504
CURRENT OCCUPANT	2656 N 40TH ST	MILWAUKEE, WI 53210-2504
CURRENT OCCUPANT	2652 N 40TH ST	MILWAUKEE, WI 53210-2504
CURRENT OCCUPANT	2673 N 39TH ST	MILWAUKEE, WI 53210-2503
CURRENT OCCUPANT	2657 N 39TH ST	MILWAUKEE, WI 53210-2503
CURRENT OCCUPANT	2702 N 39TH ST	MILWAUKEE, WI 53210-2550
CURRENT OCCUPANT	2704 N 40TH ST	MILWAUKEE, WI 53210-2545
CURRENT OCCUPANT	2660 N 40TH ST	MILWAUKEE, WI 53210-2504
CURRENT OCCUPANT	2679 N 39TH ST	MILWAUKEE, WI 53210-2503
CURRENT OCCUPANT	2701 N 39TH ST	MILWAUKEE, WI 53210-2551
CURRENT OCCUPANT	2703 N 39TH ST	MILWAUKEE, WI 53210-2551
CURRENT OCCUPANT	2703 N 38TH ST	MILWAUKEE, WI 53210-2549



CURRENT OCCUPANT 3807 W CENTER ST MILWAUKEE, WI 53210-2555

**Total Records: 57**

**Radius: 250.0 feet and Center of Circle: 3833 W Center ST**

## 2016-2017 Plan of Operation for 3833 W CENTER ST

1. Litter & Security Plans			
How are the grounds kept clean? <input checked="" type="checkbox"/> Sweep <input type="checkbox"/> Pressure Wash <input checked="" type="checkbox"/> Pick Up Litter <input type="checkbox"/> Other:			
How often will grounds be cleaned? <input checked="" type="checkbox"/> Daily <input type="checkbox"/> Weekly <input type="checkbox"/> Other:			
Who cleans the grounds? <input type="checkbox"/> Licensee <input type="checkbox"/> Building Owner <input checked="" type="checkbox"/> Employees <input type="checkbox"/> Hired Maintenance <input type="checkbox"/> Other:			
How are noise issues prevented and/or addressed? <input type="checkbox"/> Security <input checked="" type="checkbox"/> Manager approaches customer(s) <input type="checkbox"/> Call Police <input type="checkbox"/> Signs Posted <input type="checkbox"/> Other:			
Are there designated outdoor smoking areas? <input checked="" type="checkbox"/> No <input type="checkbox"/> Yes If Yes, Describe:			
Number of garbage cans: Inside <u>2</u> Locations: <u>NEAR THE COUNTER &amp; NEAR THE MEAT</u> Outside <u>1</u> Locations: <u>NEAR THE DOOR</u> <span style="float: right;"><u>COUNTER</u></span>			
Is a crowd control barrier used? <input checked="" type="checkbox"/> No <input type="checkbox"/> Yes If Yes, Describe:			
Number of restrooms: <u>ONE</u>		Name of solid waste contractor: <u>EAGLE DISPOSAL</u>	
Are there parking spaces on the premises? <input checked="" type="checkbox"/> No <input type="checkbox"/> Yes If Yes, list number of spaces: _____ and describe security plans:			
Are there designated loading areas? <input checked="" type="checkbox"/> No <input type="checkbox"/> Yes If Yes, describe security plans:			
Do you have security personnel on the premise? <input checked="" type="checkbox"/> No <input type="checkbox"/> Yes If Yes, how many? _____			
AND What are their responsibilities? _____			
What security equipment do they use? _____			
List their licensing, certification or training credentials: _____			
Are there security cameras? <input type="checkbox"/> No <input checked="" type="checkbox"/> Yes If Yes, list all locations: <u>OUTSIDE &amp; INSIDE</u>			
Are searches and/or identification checks conducted upon entry? <input checked="" type="checkbox"/> No <input type="checkbox"/> Yes If Yes, describe:			
2. Percentage of Sales (must total 100%)			
Alcohol <u>10</u> %	Food Sales <u>70</u> %	Entertainment _____ %	Other <u>20</u> %
3. Businesses On The Premises (choose all that apply):			
<input type="checkbox"/> Restaurant <input type="checkbox"/> Cafe/Coffee Shop <input type="checkbox"/> Cocktail Lounge <input checked="" type="checkbox"/> Convenience Store <input type="checkbox"/> Night Club <input type="checkbox"/> Liquor Store <input type="checkbox"/> Tavern <input type="checkbox"/> Sports Facility <input type="checkbox"/> Hotel <input type="checkbox"/> Banquet Hall <input type="checkbox"/> Supermarket <input type="checkbox"/> Private/Fraternal/Veterans' Club <input type="checkbox"/> Other:			
4. Hours of Operation and Age Restriction			
Are there any changes to the current hours of operation or age restriction? <input checked="" type="checkbox"/> No <input type="checkbox"/> Yes If Yes, Describe:			
<p><b>Please Note:</b> If you will be open earlier or later than the hours listed on your current license for even one event or holiday (for example, St. Patrick's Day, Brewers Opening Day, etc.) during the license period, this must be reported and printed on your license.</p> <p>Your hours of operation and age restriction are listed on your current license.</p>			
5. Floor Plan and Capacity			
Are you requesting any changes to the floor plan or capacity? <input checked="" type="checkbox"/> No <input type="checkbox"/> Yes If Yes, Describe:			
<p>If requesting changes to the floor plan, submit a new floor plan with this application. Changes in floor plan include changing the location of tables, games, etc. within your current licensed premises. If your changes include adding any additional areas or square footage to your premises, or any renovations to the building will be done, a Permanent Extension of Premises application must be filed.</p>			
6. Sidewalk Dining (If renewing a current license – Renewal Fee : \$)			
Are there any changes to the sidewalk dining site plan? <input type="checkbox"/> No <input type="checkbox"/> Yes If Yes, submit an updated site plan with this application.			
7. Food Licenses (If renewing a current license – Renewal Fee : \$575)			
Do you sell <b>ONLY</b> prepackaged foods? <input type="checkbox"/> No <input checked="" type="checkbox"/> Yes			
If yes, do you sell <b>ONLY</b> non hazardous foods? <input checked="" type="checkbox"/> No <input type="checkbox"/> Yes (FROZEN PIZZA is a HAZARDOUS FOOD)			
If you answered <b>YES</b> to both questions, YOU DO NOT NEED TO RENEW YOUR FOOD LICENSE.			