



CITY OF MILWAUKEE  
OFFICE OF THE CITY CLERK

Wednesday, April 13, 2022

COMMITTEE MEETING NOTICE

AD 12

CURTIS A WOLF

2179 S 16TH St  
Milwaukee, WI 53215

You are requested to attend a virtual hearing to be held on:

**Tuesday, April 26, 2022 at 01:45 PM**

**Regarding:** Your Public Entertainment Premises License Application Requesting Disc Jockey, Jukebox and 3 Amusement Machines for "Smokeys Lounge" at 2179 S 16TH St.

This meeting will be held via GoToMeeting. Please see the enclosed best practices document for further instructions. The access code is <https://meet.goto.com/279418573>. If you wish to call in, please call [+1 \(872\) 240-3212](tel:+18722403212) and use Access Code: 279-418-573.

There is a possibility that your application may be denied for one or more of the following reasons: The recommendation of the committee regarding the application shall be based on evidence presented at the hearing. Per MCO 85-2.7-4, probative evidence concerning whether or not a new license should be granted may be presented on the following subjects: whether or not the applicant meets the municipal requirements, the appropriateness of the location and premises where the licensed premises is to be located and whether use of the premises for the purposes or activities permitted by the license would tend to facilitate a public or private nuisance or create undesirable neighborhood problems such as disorderly patrons, unreasonably loud noise, litter, and excessive traffic and parking congestion. Probative evidence relating to these matters may be taken from the plan of operation submitted with the license application, if any, but shall not include the content of any music. Evidence regarding the fitness of the location of the premises to be maintained as the principal place of business, including but not limited to whether there is an overconcentration of businesses of the type for which the license is sought; whether the proposal is consistent with any pertinent neighborhood business or development plans, or the location's proximity to areas where children are typically present. The applicant's record in operating similarly licensed premises; and whether or not the applicant has been charged with or convicted of any felony, misdemeanor, municipal offense or other offense, the circumstances of which substantially relate to the activity to be permitted by the license being applied for or any other factor which reasonably relates to the public health, safety or welfare may also be considered. See attached police report or correspondence.

**Notice for applicants with warrants or unpaid fines:**

**Proof of warrant satisfaction or payment of fines must be submitted at the hearing on the above date and time. Failure to comply with this requirement may result in a delay of the granting/denial of your application.**

Failure to attend this meeting may result in the denial of your license. Individual applicants and partnership applicants must attend or attend by an attorney. The agent or attorney for corporate or limited liability applicants must attend. If you wish to do so and at your own expense, you may be accompanied by an attorney of your choosing to represent you at this hearing.

You will be given an opportunity to speak on behalf of the application and to respond and challenge any charges or reasons given for the denial. No petitions can be accepted by the committee, unless the people who signed the petition attend the virtual hearing and are willing to testify. You may present witnesses under oath and you may also confront and cross-examine opposing witnesses under oath. If you have difficulty with the English language, you should request an interpreter attend the meeting with you, at your expense, so that you can answer questions and participate in your hearing.

PLEASE NOTE: Upon reasonable notice, efforts will be made to accommodate the needs of disabled individuals through sign language interpreters or other auxiliary aids. For additional information or to request this service, contact the Council Services Division ADA Coordinator at (414) 286-2998, Fax - (414) 286-3456, TDD - (414) 286-2025.

JIM OWCZARSKI, CITY CLERK

BY: \_\_\_\_\_

Jim Cooney  
License Division Manager

**If you have questions regarding this meeting, please contact the staff assistant, Yadira Melendez at (414) 286-2775 or [stasst5@milwaukee.gov](mailto:stasst5@milwaukee.gov)**



**CITY OF MILWAUKEE  
OFFICE OF THE CITY CLERK**

Wednesday, April 13, 2022

**COMMITTEE MEETING NOTICE**

AD 12

CURTIS A WOLF

5278 SOMERSET LN  
GREENFIELD, WI 53221

You are requested to attend a virtual hearing to be held on:

**Tuesday, April 26, 2022 at 01:45 PM**

**Regarding:** Your Public Entertainment Premises License Application Requesting Disc Jockey, Jukebox and 3 Amusement Machines for "Smokeys Lounge" at 2179 S 16TH St.

This meeting will be held via GoToMeeting. Please see the enclosed best practices document for further instructions. The access code is <https://meet.goto.com/279418573>. If you wish to call in, please call [+1 \(872\) 240-3212](tel:+18722403212) and use Access Code: 279-418-573.

There is a possibility that your application may be denied for one or more of the following reasons: The recommendation of the committee regarding the application shall be based on evidence presented at the hearing. Per MCO 85-2.7-4, probative evidence concerning whether or not a new license should be granted may be presented on the following subjects: whether or not the applicant meets the municipal requirements, the appropriateness of the location and premises where the licensed premises is to be located and whether use of the premises for the purposes or activities permitted by the license would tend to facilitate a public or private nuisance or create undesirable neighborhood problems such as disorderly patrons, unreasonably loud noise, litter, and excessive traffic and parking congestion. Probative evidence relating to these matters may be taken from the plan of operation submitted with the license application, if any, but shall not include the content of any music. Evidence regarding the fitness of the location of the premises to be maintained as the principal place of business, including but not limited to whether there is an overconcentration of businesses of the type for which the license is sought; whether the proposal is consistent with any pertinent neighborhood business or development plans, or the location's proximity to areas where children are typically present. The applicant's record in operating similarly licensed premises; and whether or not the applicant has been charged with or convicted of any felony, misdemeanor, municipal offense or other offense, the circumstances of which substantially relate to the activity to be permitted by the license being applied for or any other factor which reasonably relates to the public health, safety or welfare may also be considered. See attached police report or correspondence.

**Notice for applicants with warrants or unpaid fines:**

**Proof of warrant satisfaction or payment of fines must be submitted at the hearing on the above date and time. Failure to comply with this requirement may result in a delay of the granting/denial of your application.**

Failure to attend this meeting may result in the denial of your license. Individual applicants and partnership applicants must attend or attend by an attorney. The agent or attorney for corporate or limited liability applicants must attend. If you wish to do so and at your own expense, you may be accompanied by an attorney of your choosing to represent you at this hearing.

You will be given an opportunity to speak on behalf of the application and to respond and challenge any charges or reasons given for the denial. No petitions can be accepted by the committee, unless the people who signed the petition attend the virtual hearing and are willing to testify. You may present witnesses under oath and you may also confront and cross-examine opposing witnesses under oath. If you have difficulty with the English language, you should request an interpreter attend the meeting with you, at your expense, so that you can answer questions and participate in your hearing.

PLEASE NOTE: Upon reasonable notice, efforts will be made to accommodate the needs of disabled individuals through sign language interpreters or other auxiliary aids. For additional information or to request this service, contact the Council Services Division ADA Coordinator at (414) 286-2998, Fax - (414) 286-3456, TDD - (414) 286-2025.

JIM OWCZARSKI, CITY CLERK

BY: \_\_\_\_\_

Jim Cooney  
License Division Manager

**If you have questions regarding this meeting, please contact the staff assistant, Yadira Melendez at (414) 286-2775 or [stasst5@milwaukee.gov](mailto:stasst5@milwaukee.gov)**



Wednesday, April 13, 2022



# Notice of Public Hearing

Blank Notice

---

CURTIS A WOLF  
Smokeys Lounge at 2179 S 16TH St.  
Public Entertainment Premises License Application Requesting Disc Jockey, Jukebox and 3  
Amusement Machines

**Tuesday, April 26, 2022 at 01:45 PM**

To whom it may concern:

The above application has been made by the above named applicant(s). This requires approval from the Licenses Committee and the Common Council of the City of Milwaukee. The hearing before the Licenses Committee will take place virtually on 04/26/2022 at 01:45 PM. This is a public hearing. Those wishing to view the proceeding are able to do so via the City Channel – Channel 25 on Spectrum Cable – or on the Internet at <http://city.milwaukee.gov/citychannel>. Those wishing to provide oral testimony will be asked to do so by phone or internet and are asked to contact the staff assistant, Yadira Melendez at (414) 286-2775 or [stasst5@milwaukee.gov](mailto:stasst5@milwaukee.gov) for necessary information. Please make such requests no later than one business day prior to the start of the meeting. You are not required to attend the hearing, but please see the information below if you would like to provide testimony. Once the Licenses Committee makes its recommendation, this recommendation is forwarded to the full Common Council for approval at its next regularly scheduled hearing.

---

## Important details for those wishing to provide information for the Licenses Committee to consider when making its recommendation:

1. The license application is scheduled to be heard at the above time. Due to other hearings running longer than scheduled, you may have to wait some time to provide your testimony.
2. You must testify as to matters that you have personally experienced or seen. (You cannot provide testimony for your neighbor, parent or anyone else; this is considered hearsay and cannot be considered by the committee.)
3. No letters or petitions can be accepted by the committee (unless the person who wrote the letter or the persons who signed the petition are willing to testify).
4. Persons opposed to the license application are given the opportunity to testify first; supporters may testify after the opponents have finished.
5. When you are called to testify, you will be sworn in and asked to give your name, and address. (If your first and/or last names are uncommon please spell them.)
6. You may then provide testimony.
  - a. Include only information relating to the above license application.
  - b. Include only information you have personally witnessed or seen.
  - c. Provide concise and relevant information detailing how this business has affected or may affect the peaceful enjoyment of your neighborhood.
  - d. If by the time you have the opportunity to testify, the information you wish to share has already been provided to the committee, you may state that you agree with the previous testimony. Redundant or repetitive testimony will not assist the committee in making its recommendation.
7. After giving your testimony, the members of the Licenses Committee and the licensee may ask questions regarding the testimony you have given or other factors relating to the license application.
8. Business Competition is not a valid basis for denial or non-renewal of a license.

**Please Note: If you have submitted an objection to the above application your objection cannot be considered by the committee unless you personally testify at the hearing.**

OCCUPANT	MAIL ADDRESS	CITY STATE ZIP
CURRENT OCCUPANT	1550 W GRANT ST	MILWAUKEE, WI 53215-2662
CURRENT OCCUPANT	1552 W GRANT ST	MILWAUKEE, WI 53215-2662
CURRENT OCCUPANT	1552A W GRANT ST	MILWAUKEE, WI 53215-2662
CURRENT OCCUPANT	1605 W GRANT ST, 1	MILWAUKEE, WI 53215-2633
CURRENT OCCUPANT	1605 W GRANT ST, 2	MILWAUKEE, WI 53215-2633
CURRENT OCCUPANT	1605 W GRANT ST, 3	MILWAUKEE, WI 53215-2633
CURRENT OCCUPANT	1619 W GRANT ST	MILWAUKEE, WI 53215-2633
CURRENT OCCUPANT	1623 W GRANT ST	MILWAUKEE, WI 53215-2633
CURRENT OCCUPANT	1631 W GRANT ST	MILWAUKEE, WI 53215-2633
CURRENT OCCUPANT	2141 S 16TH ST	MILWAUKEE, WI 53215-2617
CURRENT OCCUPANT	2141A S 16TH ST	MILWAUKEE, WI 53215-2617
CURRENT OCCUPANT	2142 S 16TH ST	MILWAUKEE, WI 53215-2618
CURRENT OCCUPANT	2142 S 17TH ST	MILWAUKEE, WI 53215-2622
CURRENT OCCUPANT	2142A S 17TH ST	MILWAUKEE, WI 53215-2622
CURRENT OCCUPANT	2146 S 16TH ST	MILWAUKEE, WI 53215-2618
CURRENT OCCUPANT	2146 S 17TH ST	MILWAUKEE, WI 53215-2622
CURRENT OCCUPANT	2149 S 16TH ST	MILWAUKEE, WI 53215-2617
CURRENT OCCUPANT	2150 S 17TH ST	MILWAUKEE, WI 53215-2622
CURRENT OCCUPANT	2150A S 16TH ST	MILWAUKEE, WI 53215-2618
CURRENT OCCUPANT	2150A S 17TH ST	MILWAUKEE, WI 53215-2622
CURRENT OCCUPANT	2150B S 16TH ST	MILWAUKEE, WI 53215-2618
CURRENT OCCUPANT	2150C S 16TH ST	MILWAUKEE, WI 53215-2618
CURRENT OCCUPANT	2150D S 16TH ST	MILWAUKEE, WI 53215-2618
CURRENT OCCUPANT	2151 S 15TH PL	MILWAUKEE, WI 53215-2641
CURRENT OCCUPANT	2151 S 16TH ST	MILWAUKEE, WI 53215-2617
CURRENT OCCUPANT	2152 S 16TH ST	MILWAUKEE, WI 53215-2618
CURRENT OCCUPANT	2153 S 16TH ST	MILWAUKEE, WI 53215-2617
CURRENT OCCUPANT	2154 S 16TH ST	MILWAUKEE, WI 53215-2618
CURRENT OCCUPANT	2155 S 16TH ST	MILWAUKEE, WI 53215-2617
CURRENT OCCUPANT	2155 S 17TH ST	MILWAUKEE, WI 53215-2621
CURRENT OCCUPANT	2155A S 17TH ST	MILWAUKEE, WI 53215-2621
CURRENT OCCUPANT	2156 S 16TH ST	MILWAUKEE, WI 53215-2618
CURRENT OCCUPANT	2158 S 17TH ST	MILWAUKEE, WI 53215-2622
CURRENT OCCUPANT	2158A S 17TH ST	MILWAUKEE, WI 53215-2622
CURRENT OCCUPANT	2159 S 16TH ST	MILWAUKEE, WI 53215-2617
CURRENT OCCUPANT	2159 S 17TH ST	MILWAUKEE, WI 53215-2621
CURRENT OCCUPANT	2160 S 16TH ST	MILWAUKEE, WI 53215-2618
CURRENT OCCUPANT	2160 S 17TH ST	MILWAUKEE, WI 53215-2622
CURRENT OCCUPANT	2160A S 16TH ST	MILWAUKEE, WI 53215-2618
CURRENT OCCUPANT	2161 S 16TH ST	MILWAUKEE, WI 53215-2617
CURRENT OCCUPANT	2162 S 17TH ST	MILWAUKEE, WI 53215-2622
CURRENT OCCUPANT	2163 S 15TH PL	MILWAUKEE, WI 53215-2641
CURRENT OCCUPANT	2163 S 16TH ST	MILWAUKEE, WI 53215-2617
CURRENT OCCUPANT	2163 S 17TH ST	MILWAUKEE, WI 53215-2621
CURRENT OCCUPANT	2163A S 15TH PL	MILWAUKEE, WI 53215-2641
CURRENT OCCUPANT	2164 S 16TH ST	MILWAUKEE, WI 53215-2618

CURRENT OCCUPANT	2165 S 17TH ST	MILWAUKEE, WI 53215-2621
CURRENT OCCUPANT	2166 S 16TH ST	MILWAUKEE, WI 53215-2618
CURRENT OCCUPANT	2167 S 16TH ST	MILWAUKEE, WI 53215-2617
CURRENT OCCUPANT	2167 S 17TH ST	MILWAUKEE, WI 53215-2621
CURRENT OCCUPANT	2167A S 16TH ST	MILWAUKEE, WI 53215-2617
CURRENT OCCUPANT	2167A S 17TH ST	MILWAUKEE, WI 53215-2621
CURRENT OCCUPANT	2167B S 16TH ST	MILWAUKEE, WI 53215-2617
CURRENT OCCUPANT	2168 S 16TH ST	MILWAUKEE, WI 53215-2618
CURRENT OCCUPANT	2169 S 15TH PL	MILWAUKEE, WI 53215-2641
CURRENT OCCUPANT	2169 S 15TH PL, A	MILWAUKEE, WI 53215-2641
CURRENT OCCUPANT	2169 S 16TH ST	MILWAUKEE, WI 53215-2617
CURRENT OCCUPANT	2169 S 17TH ST	MILWAUKEE, WI 53215-2621
CURRENT OCCUPANT	2169A S 16TH ST	MILWAUKEE, WI 53215-2617
CURRENT OCCUPANT	2170 S 16TH ST	MILWAUKEE, WI 53215-2618
CURRENT OCCUPANT	2172 S 17TH ST	MILWAUKEE, WI 53215-2622
CURRENT OCCUPANT	2174 S 16TH ST, 1	MILWAUKEE, WI 53215-2618
CURRENT OCCUPANT	2174 S 16TH ST, 2	MILWAUKEE, WI 53215-2618
CURRENT OCCUPANT	2174 S 16TH ST, 3	MILWAUKEE, WI 53215-2618
CURRENT OCCUPANT	2174 S 17TH ST	MILWAUKEE, WI 53215-2622
CURRENT OCCUPANT	2177 S 17TH ST	MILWAUKEE, WI 53215-2621
CURRENT OCCUPANT	2177 S 17TH ST, A	MILWAUKEE, WI 53215-2621
CURRENT OCCUPANT	2177 S 17TH ST, B	MILWAUKEE, WI 53215-2621
CURRENT OCCUPANT	2200 S 16TH ST	MILWAUKEE, WI 53215-2620
CURRENT OCCUPANT	2200 S 16TH ST, A	MILWAUKEE, WI 53215-2620
CURRENT OCCUPANT	2200 S 16TH ST, B	MILWAUKEE, WI 53215-2620
CURRENT OCCUPANT	2201 S 16TH ST	MILWAUKEE, WI 53215-2619
CURRENT OCCUPANT	2201 S 17TH ST	MILWAUKEE, WI 53215-2623
CURRENT OCCUPANT	2203 S 17TH ST	MILWAUKEE, WI 53215-2623
CURRENT OCCUPANT	2207 S 16TH ST	MILWAUKEE, WI 53215-2619
CURRENT OCCUPANT	2207A S 16TH ST	MILWAUKEE, WI 53215-2619
CURRENT OCCUPANT	2208 S 16TH ST, 1	MILWAUKEE, WI 53215-2620
CURRENT OCCUPANT	2208 S 16TH ST, 2	MILWAUKEE, WI 53215-2620
CURRENT OCCUPANT	2208 S 16TH ST, 3	MILWAUKEE, WI 53215-2620
CURRENT OCCUPANT	2208 S 16TH ST, 4	MILWAUKEE, WI 53215-2620
CURRENT OCCUPANT	2208 S 17TH ST	MILWAUKEE, WI 53215-2624
CURRENT OCCUPANT	2208A S 17TH ST	MILWAUKEE, WI 53215-2624
CURRENT OCCUPANT	2209 S 17TH ST	MILWAUKEE, WI 53215-2623
CURRENT OCCUPANT	2209A S 17TH ST	MILWAUKEE, WI 53215-2623
CURRENT OCCUPANT	2210 S 17TH ST	MILWAUKEE, WI 53215-2624
CURRENT OCCUPANT	2211 S 16TH ST	MILWAUKEE, WI 53215-2619
CURRENT OCCUPANT	2211A S 16TH ST	MILWAUKEE, WI 53215-2619
CURRENT OCCUPANT	2212 S 16TH ST	MILWAUKEE, WI 53215-2620
CURRENT OCCUPANT	2213 S 15TH PL	MILWAUKEE, WI 53215-2615
CURRENT OCCUPANT	2213 S 15TH PL, A	MILWAUKEE, WI 53215-2615
CURRENT OCCUPANT	2213 S 15TH PL, B	MILWAUKEE, WI 53215-2615
CURRENT OCCUPANT	2213 S 15TH PL, C	MILWAUKEE, WI 53215-2615
CURRENT OCCUPANT	2213 S 16TH ST	MILWAUKEE, WI 53215-2619

CURRENT OCCUPANT	2213 S 17TH ST	MILWAUKEE, WI 53215-2623
CURRENT OCCUPANT	2214 S 16TH ST	MILWAUKEE, WI 53215-2620
CURRENT OCCUPANT	2214 S 17TH ST	MILWAUKEE, WI 53215-2624
CURRENT OCCUPANT	2216 S 16TH ST	MILWAUKEE, WI 53215-2620
CURRENT OCCUPANT	2218 S 16TH ST	MILWAUKEE, WI 53215-2620
CURRENT OCCUPANT	2220 S 17TH ST	MILWAUKEE, WI 53215-2624
CURRENT OCCUPANT	2221 S 16TH ST	MILWAUKEE, WI 53215-2619
CURRENT OCCUPANT	2222 S 16TH ST	MILWAUKEE, WI 53215-2620
CURRENT OCCUPANT	2224 S 17TH ST	MILWAUKEE, WI 53215-2624

Blank Notice

Total Records: 102

Radius 250.0 feet and Center of Circle: 2179 S 16th St



# BUSINESS LICENSE PLAN OF OPERATION

ccl-busplan 5/12/2020

Office of the City Clerk License Division  
200 E. Wells St. Room 105, Milwaukee, WI 53202  
(414) 286-2238 www.milwaukee.gov/license e-mail address: license@milwaukee.gov

## 1. Type of Business

- Applying for:  Extended Hours (12AM to 5AM) - If a food establishment, check all that apply:  Delivery  Drive Thru  Dining Room
- Self Service Laundry  Massage Establishment  Filling Station
- Other (supplemental application for specific license also required)

Provide a detailed description of the type of business you plan on operating:

TAVERN

Do you have any experience operating this type of business?  No  Yes If yes, explain: TAVERN OWNER/MANAGER/STAFF

## 2. Business Operations

- a. Proposed Opening Date: 03/01/22
- b. Is this premise under construction?  No  Yes If yes, list estimated completion date: \_\_\_\_\_
- c. Is this a franchise?  No  Yes
- d. Is this premises currently licensed?  No  Yes If yes, list type of license: TAVERN
- e. Is the current licensee operating?  No  Yes If no, list date closed: \_\_\_\_\_
- f. Do you have future plans for other businesses, licenses or permits at this location?  No  Yes  
If yes, explain: \_\_\_\_\_
- g. Have you previously held an Extended Hours License in Milwaukee?  No  Yes  
If yes, list address(es): \_\_\_\_\_
- h. Are other businesses operating in the same building?  No  Yes If yes, describe: \_\_\_\_\_

## 3. Litter & Noise

- a. How are grounds kept clean?  Sweep  Pressure Wash  Pick Up Litter  Other: \_\_\_\_\_
- b. How often will grounds be cleaned?  Daily  Weekly  As Needed  Monthly  Other: \_\_\_\_\_
- c. Grounds cleaned by:  Licensee  Building Owner  Employees  Hired Maintenance  Other: \_\_\_\_\_
- d. How are noise issues prevented and/or addressed?  Security  Manager approaches customer(s)  Call Police  
 Signs Posted  Other: \_\_\_\_\_
- e. Will a sound amplification system be used?  No  Yes If yes, describe: DJ

## 4. Smoking & Sanitation

- a. Are there designated outdoor smoking areas?  No  Yes If yes, describe: \_\_\_\_\_
- b. Number of Garbage Cans: Inside: 5 Locations: BAR, KITCHEN, BATH ROOMS  
Outside: 2 Locations: ALLEY / GARAGE
- c. Is a crowd control barrier used?  No  Yes If yes, describe: \_\_\_\_\_
- d. How many restrooms are on the premises? 3
- e. Name of solid waste contractor:  Advanced Disposal  Waste Management  Other: JOHNS

### 5. Security

- a. Are there onsite parking spaces?  No  Yes If yes, how many? \_\_\_\_\_ and describe the parking security plan: \_\_\_\_\_
- b. Is there a loading zone?  No  Yes If yes, describe the loading area security plan: \_\_\_\_\_
- c. Will you have security personnel on premise?  No  Yes If yes, how many? \_\_\_\_\_ and answer the following:  
 What are their responsibilities? \_\_\_\_\_  
 Is security equipment used?  No  Yes If yes, describe \_\_\_\_\_  
 List their licensing, certification, or training credentials \_\_\_\_\_
- d. Will there be security cameras?  No  Yes If yes, how many? 5 and list locations: EXITS, BAR, KITCHEN
- e. Will searches/identification checks be done upon entry?  No  Yes If yes, describe ID CHECK/AGE

### 6. Percentage of Sales (must total 100%)

Alcohol <u>75</u> %	Food <u>25</u> %	Secondhand Merchandise _____ %	Precious Metals & Gems _____ %
Entertainment _____ %	Cigarettes _____ %	Personal Services (such as tattoo, body piercing, salon, tailor, tanning, etc.) _____ %	Other _____ % Describe: _____
Pawnbroker Activity _____ %	Salvaged Materials _____ % (such as scrap metal)		

### 7. Businesses/Licenses on the Premises (check all that apply):

#### Type 1

- Full Service Restaurant  Cafe/Coffee Shop  Deli or Fast Food Restaurant  Private/Fraternal/Veterans Club
- Night Club  Tavern  Cocktail Lounge  Teen Club
- Banquet Hall  Sports Facility  Bowling Alley
- Hotel/Motel: Number of Floors: \_\_\_\_\_  Rooming House: Number of Floors: \_\_\_\_\_  
 Number of Rooms: \_\_\_\_\_ Number of Rooms: \_\_\_\_\_

#### Type 2

- Liquor Store  Corner Store  Supermarket  Convenience Store
- Gas Station  Amusement/Phonograph Distributor  Recycling, Salvage or Towing
- Used Car Dealer  Personal Service Establishment (such as tattoo business, hair salon, tailor, etc.)  Recording Studio

What other licenses/permits will you hold at this location? (check all that apply)

- Occupancy Permit  Cigarette & Tobacco  Gas Station  Extended Hours  Class "B" Tavern  Weights & Measures
- Secondhand Dealer  Precious Metal & Gem  Other: FOOD

### 8. Legal Capacity (only if a Type 1 premises in #7 above)

Capacity 25 (Call the Milwaukee Development Center at 414-286-8211 if you have questions.)



## 9. Premises Description

- a. Identify all area(s) of the premises that will be used in operating this business (include areas used only for storage):  
 1<sup>st</sup> Floor  2<sup>nd</sup> Floor  Basement Storage  Patio  Beer Garden  Sidewalk Café  Deck  Rooftop

Other: Describe: \_\_\_\_\_

- b. Describe Location:  Major Thoroughfare  Secondary Street  Other: \_\_\_\_\_

c. Nearest Major Cross Street: LINCOLN

- d. Describe Building:  Free Standing Building  Strip Mall  Other: \_\_\_\_\_

e. Describe Premises Structure:  Single Story  Multi-Story - # of Stories 2  Other: \_\_\_\_\_

- f. Describe Surrounding Area:  Commercial  Residential  Industrial  Other: \_\_\_\_\_

g. Building Owner Name: DAVA PROPERTY MANAGEMENT CO Phone Number: (414) 405-4357

Building Owner Address: 2432 W BURNHAM ST MILWAUKEE WI 53204

## 10. Hours of Operation & Customers

Will customers be entering the premises?  No  Yes

Day of the Week	Proposed Hours of Operation:		Estimated Number of Customers expected each day	Potential Age Range of Customers	Class B Tavern Applicant Only: Age Restriction (if none, write 'None')
	Open Time (include a.m. or p.m.)	Close Time (include a.m. or p.m.)			
Sunday	6:00 AM	2:00 AM	40	21-75	NONE
Monday	6:00 AM	2:00 AM	40	21-75	NONE
Tuesday	6:00 AM	2:00 AM	40	21-75	NONE
Wednesday	6:00 AM	2:00 AM	40	21-75	NONE
Thursday	6:00 AM	2:00 AM	40	21-75	NONE
Friday	6:00 AM	2:30 AM	40	21-75	NONE
Saturday	6:00 AM	2:30 AM	40	21-75	NONE

An Extended Hours Establishment License is required for any convenience store, filling station, personal service establishment (such as tattoo, body piercing, salon, tailor, tanning, etc.), recording studio or restaurant which is open between the hours of 12:00 a.m. and 5:00 a.m.

Alcohol Establishments Class A: 8:00 am to 9:00 pm Sunday thru Saturday  
 Permitted Hours of Operation: Class B: 6:00 am to 2:00 am Sunday thru Thursday, 6:00 am to 2:30 am Friday & Saturday

Entertainment Outdoor Closing Hours: 10:00pm Sunday-Thursday; 12:00am Friday & Saturday; unless a different time, either earlier or later, is established by the Common Council in its approval of the licensee's plan of operation.

## 11. Signature(s)

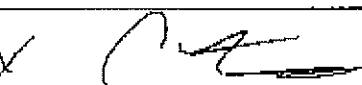
  
 Signature of Sole Proprietor, Partner, or 20% or more Shareholder  
 (If there are no 20% or more shareholders,  
 Corporate Officer-print name/title and sign)

Signature of additional partner or 20% or more shareholder

See Application Information for a complete list of all required application forms.



**ALCOHOL BEVERAGE & PUBLIC ENTERTAINMENT PREMISES  
SUPPLEMENTAL APPLICATION**

Office of the City Clerk License Division  
200 E. Wells St. Room 105, Milwaukee, WI 53202  
(414) 286-2238 e-mail address: license@milwaukee.gov www.milwaukee.gov/license

Legal Entity Name: CURTIS ANDREW WOLF

Premise Address: 2179 S 16TH ST

**Proximity of Premises to Church, School, Daycare Center or Hospital**

Is the building within 300 feet of any church, school, daycare center or hospital?  No  Yes

**"Service Bar Only" Designation**

If applying for Class B or C license, are you applying for "Service Bar Only"?  No  Yes  
Service Bar Only means customers cannot sit at the bar. Alcohol is served to employees who serve patrons seated at tables. No stools, chairs or other articles of furniture shall be placed at the service bar for patrons to sit upon.

**Business Information**

- a) Are you taking out this application for anyone that may not be eligible for a license?  No  Yes  
If yes, list their name and address: \_\_\_\_\_
- b) Will the agent, a partner or the individual licensee be conducting the day-to-day operations of the business?  No  Yes  
If no, list the name and address of the person(s) who will: \_\_\_\_\_
- Class B Applicants: If the agent, a partner or the individual licensee will not be conducting the day-to-day operations of the business, the person(s) listed above must obtain a Class B Managers license.
- c) Does anyone else have money invested or any other interest in this business?  No  Yes  
If yes, explain: \_\_\_\_\_
- d) Have you made an agreement with anyone to repay any loan or any other payments based upon income from the business?  
 No  Yes If yes, list name and address: \_\_\_\_\_

**Property Information (New & Transfer Applicants Only)**

- a) Do you own or lease the building?  Own  Lease
- b) Who owns the fixtures (for example, coolers, etc.)? STAVA PROPERTY MANAGEMENT CO
- c) Are you purchasing the stock and/or fixtures?  No  Yes If yes, amount paid \$ \_\_\_\_\_
- d) Total amount paid for business \$ 0
- e) Total amount paid for goodwill of the business \$ 0
- Goodwill comprises the reputation and customer relationships of an existing business. If the price you pay for the business exceeds the fair market value of all of the rest of the assets of the business, the excess may be considered goodwill.
- f) Have you made arrangements with the seller for payment of personal property taxes?  No  Yes

**Lease Information (New & Transfer Applicants who are leasing the premises only)**

- a) Date lease begins 07/01/21 Ends 06/30/25
- b) Monthly rental \$ 200
- c) Do you have an option to renew the lease?  No  Yes
- d) Does your lease allow for assignment to another party without the consent of the owner?  No  Yes
- e) For what length of time have you been guaranteed occupancy (number of years)? 5 YRS

**Lease Information (Continued)**

- f) In addition to paying the monthly rental, will you have to pay anything additional to the owner of the building to guarantee performance of the lease?  No  Yes If yes, explain \_\_\_\_\_
- g) Does the present owner or occupancy object to the granting of your license?  No  Yes  
If yes, explain \_\_\_\_\_

**Change of Agent Applicants Only**

Have there been any changes to the floor plan since the last application was submitted?  No  Yes  
If no, a new floor plan is not required. If yes, submit a new floor plan and explain the change(s):  
\_\_\_\_\_

**Signature**



Signature of Sole Proprietor, Partner or 20% or More Shareholder  
(If no 20% or more Shareholder, Corporate Officer - print name/title and sign)

Note: All information contained in this application is subject to approval by the Common Council.  
Deviating from approved plan of operation will subject licensee to citations, and/or suspension or non-renewal of the license.  
Contact the License Division for information on how to request changes.

**New and transfer of premises applicants must submit the following:**

- Detailed floor plan
- If a restaurant, copy of the menu



## PUBLIC ENTERTAINMENT PREMISES LICENSE SUPPLEMENTAL APPLICATION

Office of the City Clerk License Division  
200 E. Wells St. Room 105, Milwaukee, WI 53202  
(414) 286-2238 [www.milwaukee.gov/license](http://www.milwaukee.gov/license) e-mail address: [license@milwaukee.gov](mailto:license@milwaukee.gov)

**PREMISES ADDRESS:** 2179 S 16TH ST

**TYPES OF ENTERTAINMENT (CHECK ALL THAT APPLY)**

<input type="checkbox"/> Instrumental Musicians	<input type="checkbox"/> Battle of the Bands	<input type="checkbox"/> Dancing by Performers	<input checked="" type="checkbox"/> Amusement Machines How many? <u>3</u>
<input type="checkbox"/> Bands	<input type="checkbox"/> Comedy Acts	<input type="checkbox"/> Adult Entertainment/ Strippers/Erotic Dance	<input type="checkbox"/> Concerts Approx. # per year? _____
<input type="checkbox"/> Bowling Alley How many? _____	<input checked="" type="checkbox"/> Disc Jockey	<input type="checkbox"/> Wrestling	<input type="checkbox"/> Theatrical Performances Approx. # per year? _____
<input type="checkbox"/> Pool Tables How many? _____	<input type="checkbox"/> Magic Shows	<input type="checkbox"/> Patron Contests	<input checked="" type="checkbox"/> Jukebox
<input type="checkbox"/> Motion Pictures (movies by admission) - How many? _____	<input type="checkbox"/> Poetry Readings	<input type="checkbox"/> Patrons Dancing	<input type="checkbox"/> Karaoke
<input type="checkbox"/> Other: _____			

*Entertainment Outdoor Closing Hours: 10:00pm Sunday-Thursdays; 12:00am Friday & Saturday; unless a different time, either earlier or later, is established by the Common Council in its approval of the licensee's plan of operation.*

**PROMOTERS/SOUND AMPLIFICATION**

Will promoters ever be used for any of the entertainment?  No  Yes If Yes, Describe: DJ/ADS

At any time will sound amplification be used?  No  Yes If Yes, Describe: DJ/SYSTEM

**LEGAL CAPACITY OF PREMISES**

25 (Call the Development Center at 414-286-8211 with questions.) Legal capacity determines the fee for your Public Entertainment Premises License. If you would like to request the license be approved with a lower capacity than that listed above, indicate the lower capacity here: \_\_\_\_\_. If approved, this lower capacity will print on your license and override the capacity listed on your Occupancy Permit.

**ACKNOWLEDGEMENT/SIGNATURE**

I understand that after the license has been issued, a change to the plan of operation will require a written request to change and approval from the Common Council. I agree to inform the City Clerk within 10 days of any substantial changes in the information supplied in this application. I understand that I shall not willfully refuse to provide the services offered under this license, or add charges or require deposits not required of the general public because of race, color, sex, religion, national origin or ancestry, age, handicap, lawful source of income, marital status, sexual orientation, gender identity or expression, familial status or the fact that a person is now or has been a member of the military service, whether dressed in uniform or not; and shall not seek such information as a condition of employment, or penalize any employee or discriminate in the selection of personnel for training or promotion on the basis of such information.

I have knowledge of the City Ordinances currently regulating public entertainment, and understand that the license may be subject to suspension, non-renewal or revocation, if I violate any rule, law or regulation of the city of Milwaukee and State of Wisconsin.

*[Handwritten Signature]*

Signature of Sole Proprietor, Partner or 20% or More Shareholder  
(If no 20% or more Shareholder, Corporate Officer - print name/title and sign)

**Office Use Only:**  
 Initials: \_\_\_\_\_ Filed: \_\_\_\_\_ App: \_\_\_\_\_  
 Only PEP?  No  Yes If Yes,  Queue to MPD and  Email Mgrs/Team Lead (must be heard w/in 60 days)

09/12/21

Current use D/B/A  
SMOKER'S LOUNGE  
2179 SOUTH 16TH ST

EACH SQUARE EQUALS 2 FEET

A ROBERT

TOTAL  
1,440 SQ FT

① TRASH CANS

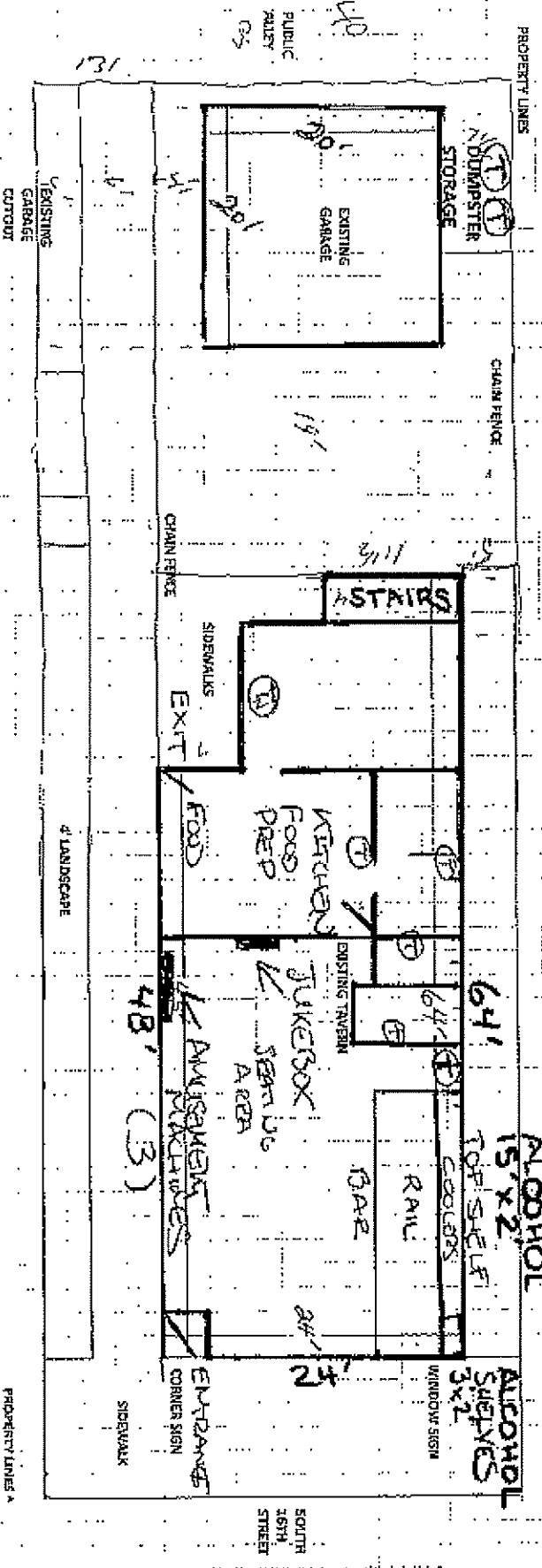

09/12/24

CURTIS WOLF DESIGN  
SMOKERS LOUNGE

2179 S 16TH ST

BASEMENT  
LEVEL

1260 SQUARE FEET

