



PETITION FOR A SPECIAL PRIVILEGE

ccl-246 (8/10)

SP 2555

- New application \$250.00 Fee**
- Amendment to add items to Special Privilege # _____ (\$125.00 Fee)**
- Amendment to remove items from Special Privilege # _____ (No fee)**
- Amendment for change of ownership for Special Privilege # _____ (No fee)**

- File petition with the Department of Public Works, 841 North Broadway, Room 919, Milwaukee, WI 53202, telephone (414) 286-2454.
- Fee must be submitted with petition. Checks should be made payable to the City of Milwaukee.
- Petition must be submitted in duplicate.

To the Honorable, The Common Council of the City of Milwaukee:

The Licensee Urban Ecology Center
(Name of Individual, Partners, Corporation or LLC)

being the owners of the following property known by street address as 3700 W Pierce Street
(Street Address and Zip Code)

in the 8th Aldermanic District respectfully petition the Common Council of the City of Milwaukee according to the provisions of Section 66.0425 of the Wisconsin Statutes, that the following privilege be granted:

Description of Special Privilege: Sloped sidewalk and curb in the City ROW for ADA access into a new community/ educational center. The proposed center will consist of a remodeled building and addition, with the existing first floor approximately 14" above the sidewalk, necessitating sloping part of the sidewalk to provide wheelchair access.

Of which a plan or sketch is herewith submitted. Petitioner agrees to comply with all laws and all ordinances of the City of Milwaukee, to abide by any order or resolution of the Common Council affecting this privilege, to be primarily liable for damages to person or property by reason of the granting of such privilege, pay annual compensation as provided by law in the sum to be fixed by the proper city officers, and to file and keep current throughout the existence of the privilege, a certificate of insurance indicating applicant holds a public liability policy in at least the sums of \$25,000.00/\$50,000.00 bodily injury, and \$10,000.00 property damage, insuring the city against any liability that might arise by reason of the privilege.

Petitioner further agrees to remove said privilege whenever public necessity so requires when so ordered upon resolution adopted by the Common Council or other legislative body.

Should this special privilege be discontinued for any reason whatsoever, petitioner agrees to remove all construction work executed pursuant to this special privilege, to restore to its former condition and to the approval of the Commissioner of Public Works, any curb, pavement, or other public improvement which was removed, changed or disturbed by reason of the granting of this special privilege. Petitioner further agrees not to contest the validity of Section 66.0425 of the Wisconsin Statutes, or the legality of this special privilege in any way.

Name (Please Print): Judy Krause
(Individual, Partner, or Agent if corporation or LLC as shown above)

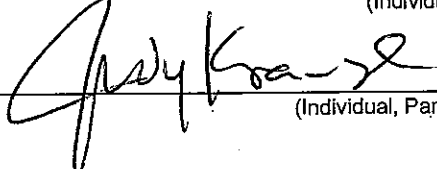
Signature: 
(Individual, Partner, or Agent if corporation or LLC)

Corporation or LLC Name: Urban Ecology Center
(If applicable, as shown above)

Mailing Address (If different than property address above): 1500 E. Park Place, Milwaukee WI 53211

(OVER)

City: Milwaukee State: WI Zip: 53211

Telephone: (414) 964-8505 E-Mail: jkrause@urbanecologycenter.org

Architect/Engineer/Contractor (If Applicable)

Name: Troy Wohlt, AIA, Uihlein/Wilson Architects

Address: 322 E Michigan Street, Suite 400

City: Milwaukee State: WI Zip: 53202

Telephone: (414) 271-8899 E-Mail: troyw@uihlein-wilson.com

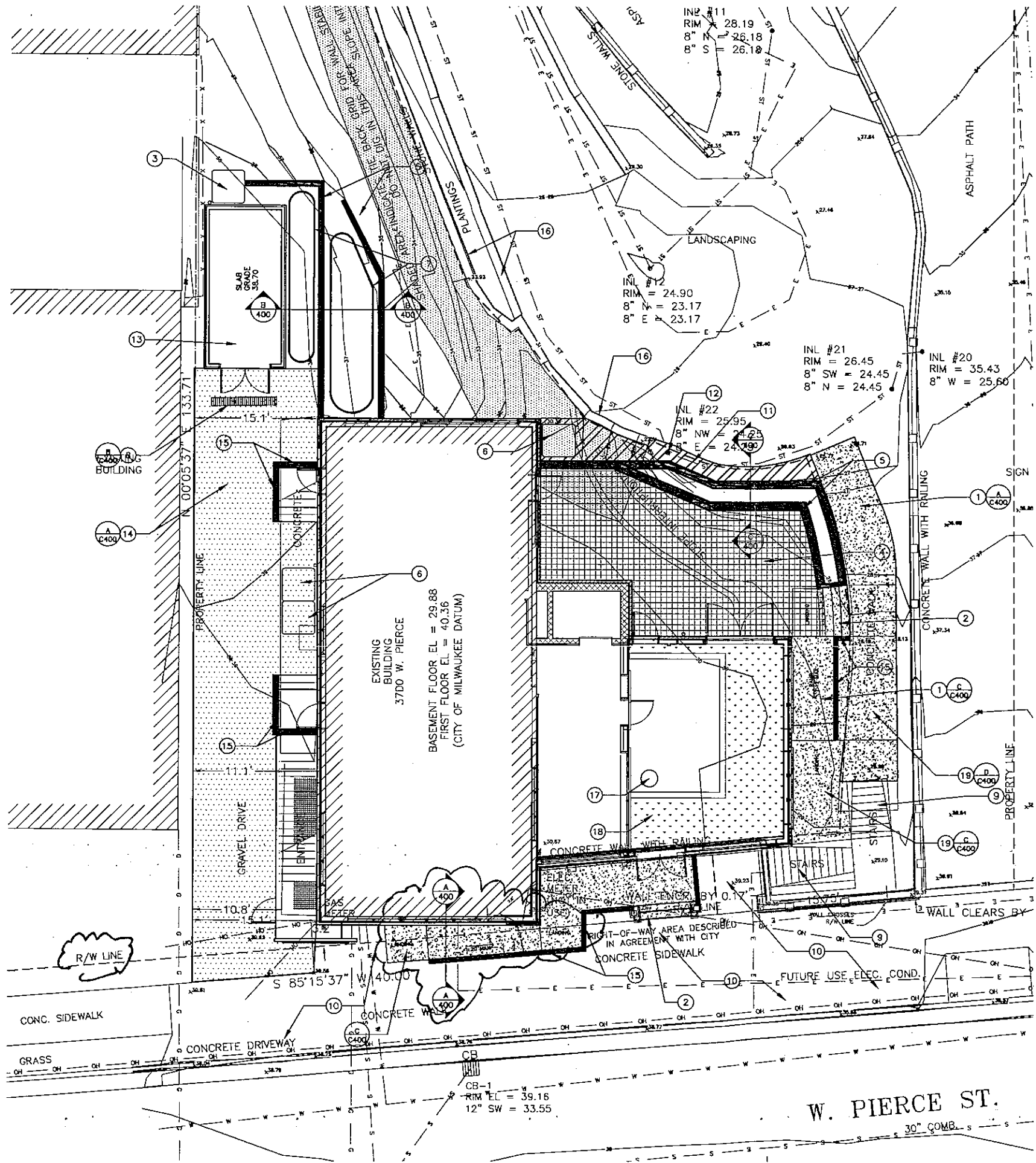

- GENERAL NOTES:**
1. WORK TO BE COMPLETED BY CONTRACTOR IS INDICATED IN BOLD LINE TYPE. EXISTING CONDITIONS ARE INDICATED IN LIGHT LINE TYPE.
 2. CALL DIGGER'S HOTLINE PRIOR TO ANY CONSTRUCTION. CONTRACTOR SHALL BE RESPONSIBLE FOR PROTECTION OF ANY UTILITIES.
 3. INSTALL EROSION CONTROL MEASURES PRIOR TO INITIATION OF ANY SITE WORK.
 4. BASE PLAN BASED ON SURVEY BY SIGMA DEVELOPMENT. VERIFY ALL DIMENSIONS IN THE FIELD. IF ANY ERRORS, DISCREPANCIES, OR OMISSIONS ARE APPARENT, BRING SAME TO ATTENTION OF THE PROJECT ENGINEER PRIOR TO CONSTRUCTION OF ANYTHING AFFECTED SO THAT CLARIFICATION OF REVISIONS MAY OCCUR.
 5. SAWCUT PAVEMENTS TO BE REMOVED WITH NEAT CLEAN EDGES THAT ARE PARALLEL AND PERPENDICULAR LINES PRIOR TO REMOVAL.

- KEYED NOTES:**
1. PROPOSED CONCRETE ADA RAMP.
 2. PROPOSED CONCRETE STAIRS. REFER TO GRADING PLAN FOR GRADES.
 3. PROPOSED 250 GALLON STORM COLLECTOR CUBE BY OWNER.
 4. PROPOSED LOOSE JOINTED (PERMEABLE) PAVER PATIO.
 5. PROPOSED MODULAR BLOCK RETAINING WALL.
 6. PROPOSED 2 250 GALLON STACKED STORM COLLECTOR CUBES BY OWNER.
 7. PROPOSED RAIN GARDENS. PLANTINGS BY OWNER.
 8. PROPOSED TRENCH DRAIN.
 9. EXISTING STAIRS TO REMAIN.
 10. EXISTING CONCRETE WALK TO REMAIN.
 11. GRASS LANDSCAPE AREA.
 12. EXISTING CATCH BASIN TO REMAIN.
 13. PROPOSED SHED.
 14. ASPHALT PAVEMENT.
 15. PROPOSED CONCRETE CURB/WALL.
 16. EX. RETAINING WALL TO REMAIN.
 17. PROPOSED RAIN BARREL BY OWNER.
 18. GREEN ROOF AREA.
 19. PROPOSED CONCRETE WALK.

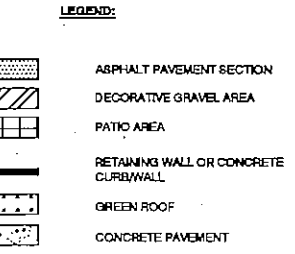

- NOTES:**
1. ALL RAIN CUBES / BARRELS ARE BY OWNER.

**UIHLEIN
WILSON
ARCHITECTS**

322 East Michigan Street
Milwaukee, WI 53202

telephone | 414.271.8899
facsimile | 414.271.8942
email | office@uihlein-wilson.com

REVISIONS

No.	Date	Description

SIGMA GROUP

1300 Forest Court Street
Milwaukee, WI 53233
Phone: 414-443-4200
Fax: 414-443-4210

**URBAN
ECOLOGY CENTER**

PROJECT

Site Improvement Plan

DATE
June 30, 2011

PROJECT NO.
10-112

SHEET NO.

GRAPHIC SCALE

C200