



CITY OF MILWAUKEE
OFFICE OF THE CITY CLERK

Monday, October 14, 2019

COMMITTEE MEETING NOTICE

AD 10

ADAMS, Bryant L, Agent
Battlebox Cafe & Lounge LLC
2719 N 11TH St

Milwaukee, WI 53206

You are requested to attend a hearing which is to be held in Room 301-B, Third Floor, City Hall on:

Tuesday, October 22, 2019 at 10:00 AM

Regarding: Your Class B Tavern, Food Dealer, and Public Entertainment Premises License Renewal Applications with Change of Floor Plan Adding Area to West Side of Premises as agent for "Battlebox Cafe & Lounge LLC" for "Battlebox Cafe & Lounge" at 5411 Lisbon Av.

There is a possibility that your application may be denied for one or more of the following reasons: The recommendation of the committee regarding the application shall be based on evidence presented at the hearing. Per MCO 85-4-4, unless otherwise specified in the code, probative evidence concerning non-renewal, suspension or revocation may include evidence of the following: failure of the applicant to meet municipal qualifications, pending charges against or the conviction of any felony, misdemeanor, municipal offense or other offense, the circumstances of which substantially relate to the circumstances of the particular licensed or permitted activity, by the applicant or by any employee or other agent of the applicant. If the activities of the applicant involve a licensed premises, whether the premises tends to facilitate a public or private nuisance or has been the source of congregations of persons which have resulted in any of the following: disturbance of the peace; illegal drug activity; public drunkenness; drinking in public; harassment of passers-by; gambling; prostitution; sale of stolen goods; public urination; theft; assaults; battery; acts of vandalism including graffiti, excessive littering, loitering, illegal parking, loud noise at times when the licensed premise is open for business; traffic violations; curfew violations; lewd conduct; display of materials harmful to minors, pursuant to s. 106-9.6; or any other factor which reasonably relates to the public health, safety and welfare, or failure to comply with the approved plan of operation.

Notice for applicants with warrants or unpaid fines:

Proof of warrant satisfaction or payment of fines must be submitted at the hearing on the above date and time. Failure to comply with this requirement may result in a delay of the granting/denial of your application.

Failure to appear at this meeting may result in the denial of your license. Individual applicants must appear only in person or by an attorney. Corporate or Limited Liability applicants must appear only by the agent designated on the application or by an attorney. Partnership applicants must appear by a partner listed on the application or by an attorney. If you wish to do so and at your own expense, you may be accompanied by an attorney of your choosing to represent you at this hearing.

You will be given an opportunity to speak on behalf of the application and to respond and challenge any charges or reasons given for the denial. No petitions can be accepted by the committee, unless the people who signed the petition are present at the committee hearing and willing to testify. You may present witnesses under oath and you may also confront and cross-examine opposing witnesses under oath. If you have difficulty with the English language, you should bring an interpreter with you, at your expense, so that you can answer questions and participate in your hearing.

You may examine the application file at this office during regular business hours prior to the hearing date. Inquiries regarding this matter may be directed to the person whose signature appears below.

Limited parking for persons attending meetings in City Hall is available at reduced rates (5 hour limit) at the Milwaukee Center on the southwest corner of East Kilbourn and North Water Street. Parking tickets must be validated in the first floor information booth in City Hall.

PLEASE NOTE: Upon reasonable notice, efforts will be made to accommodate the needs of disabled individuals through sign language interpreters or other auxiliary aids. For additional information or to request this service, contact the Council Services Division ADA Coordinator at (414) 286-2998, Fax - (414) 286-3456, TDD - (414) 286-2025.

JIM OWCZARSKI, CITY CLERK

BY:

Jessica Celella

License Division Manager

If you have questions regarding this notice, please contact the License Division at (414) 286-2238.

200 E. Wells Street, Room 105, City Hall, Milwaukee, WI 53202. www.milwaukee.gov/license
Phone: (414) 286-2238 Fax: (414) 286-3057 Email Address: License@milwaukee.gov



Monday, October 14, 2019



Notice of Public Hearing

ADAMS, Bryant L, Agent
Battlebox Cafe & Lounge at 5419 W Lisbon Av
Class B Tavern, Food Dealer, and Public Entertainment Premises License Renewal Applications
with Change of Floor Plan Adding Area to the West Side of Premises

Tuesday, October 22, 2019 at 10:00 AM

To whom it may concern:

The above application has been made by the above named applicant(s). This requires approval from the Licenses Committee and the Common Council of the City of Milwaukee. The hearing before the Licenses Committee will take place on 10/22/2019 at 10:00 AM, in Room 301-B, Third Floor, City Hall. If you wish, you may provide testimony at the hearing regarding the request; see below for further information. You are not required to attend the hearing. Once the Licenses Committee makes its recommendation, this recommendation is forwarded to the full Common Council for approval at its next regularly scheduled hearing. Please review the information below and if you have further questions regarding this process, please contact the License Division at (414) 286-2238.

Important details for those wishing to provide information for the Licenses Committee to consider when making its recommendation:

1. The license application is scheduled to be heard at the above time. Due to other hearings running longer than scheduled, you may have to wait some time to provide your testimony.
2. You must appear in person and testify as to matters that you have personally experienced or seen. (You cannot provide testimony for your neighbor, parent or anyone else; this is considered hearsay and cannot be considered by the committee.)
3. No letters or petitions can be accepted by the committee (unless the person who wrote the letter or the persons who signed the petition are present at the committee hearing and willing to testify).
4. Persons opposed to the license application are given the opportunity to testify first; supporters may testify after the opponents have finished.
5. When you are called to testify, you will be sworn in and asked to give your name, and address. (If your first and/or last names are uncommon please spell them.)
6. You may then provide testimony.
 - a. Include only information relating to the above license application.
 - b. Include only information you have personally witnessed or seen.
 - c. Provide concise and relevant information detailing how this business has affected or may affect the peaceful enjoyment of your neighborhood.
 - d. If by the time you have the opportunity to testify, the information you wish to share has already been provided to the committee, you may state that you agree with the previous testimony. Redundant or repetitive testimony will not assist the committee in making its recommendation.
7. After giving your testimony, the members of the Licenses Committee and the licensee may ask questions regarding the testimony you have given or other factors relating to the license application.
8. Business Competition is not a valid basis for denial or non-renewal of a license.
Please Note: If you have submitted an objection to the above application your objection cannot be considered by the committee unless you personally testify at the hearing.

OCCUPANT	MAIL ADDRESS	CITY, STATE ZIP
CURRENT OCCUPANT	2500 N 56TH ST	MILWAUKEE, WI 53210
CURRENT OCCUPANT	2516 N 56TH ST	MILWAUKEE, WI 53210
CURRENT OCCUPANT	2523 N 55TH ST	MILWAUKEE, WI 53210
CURRENT OCCUPANT	2512 N 56TH ST	MILWAUKEE, WI 53210
CURRENT OCCUPANT	2508 N 56TH ST	MILWAUKEE, WI 53210
CURRENT OCCUPANT	2502 N 55TH ST	MILWAUKEE, WI 53210
CURRENT OCCUPANT	2470 N 55TH ST	MILWAUKEE, WI 53210
CURRENT OCCUPANT	2530 N 56TH ST	MILWAUKEE, WI 53210
CURRENT OCCUPANT	2514 N 56TH ST	MILWAUKEE, WI 53210
CURRENT OCCUPANT	2532 N 56TH ST	MILWAUKEE, WI 53210
CURRENT OCCUPANT	2558 N 55TH ST	MILWAUKEE, WI 53210
CURRENT OCCUPANT	2464 N 55TH ST	MILWAUKEE, WI 53210
CURRENT OCCUPANT	2475 N 54TH ST	MILWAUKEE, WI 53210
CURRENT OCCUPANT	2502 N 56TH ST	MILWAUKEE, WI 53210
CURRENT OCCUPANT	2509 N 55TH ST	MILWAUKEE, WI 53210
CURRENT OCCUPANT	2522 N 56TH ST	MILWAUKEE, WI 53210
CURRENT OCCUPANT	2524 N 56TH ST	MILWAUKEE, WI 53210
CURRENT OCCUPANT	2518 N 56TH ST	MILWAUKEE, WI 53210
CURRENT OCCUPANT	2502A N 55TH ST	MILWAUKEE, WI 53210
CURRENT OCCUPANT	2474 N 55TH ST	MILWAUKEE, WI 53210
CURRENT OCCUPANT	2479A N 54TH ST	MILWAUKEE, WI 53210
CURRENT OCCUPANT	2557 N 54TH ST	MILWAUKEE, WI 53210
CURRENT OCCUPANT	2513 N 55TH ST	MILWAUKEE, WI 53210
CURRENT OCCUPANT	2501 N 55TH ST	MILWAUKEE, WI 53210
CURRENT OCCUPANT	2479 N 54TH ST	MILWAUKEE, WI 53210
CURRENT OCCUPANT	2465 N 54TH ST	MILWAUKEE, WI 53210
CURRENT OCCUPANT	2517 N 55TH ST	MILWAUKEE, WI 53210
CURRENT OCCUPANT	2478 N 55TH ST	MILWAUKEE, WI 53210
CURRENT OCCUPANT	5321 W LISBON AVE	MILWAUKEE, WI 53210
CURRENT OCCUPANT	5336 W LISBON AVE	MILWAUKEE, WI 53210

Total Records: 30

Radius: 250.0 feet and Center of Circle: 5419 W Lisbon Ave

2018-2019 Plan of Operation for 5419 W LISBON AV

1. Litter & Security Plans			
How are the grounds kept clean? <input checked="" type="checkbox"/> Sweep <input checked="" type="checkbox"/> Pressure Wash <input checked="" type="checkbox"/> Pick Up Litter <input type="checkbox"/> Other:			
How often will grounds be cleaned? <input checked="" type="checkbox"/> Daily <input type="checkbox"/> Weekly <input type="checkbox"/> Other:			
Who cleans the grounds? <input type="checkbox"/> Licensee <input checked="" type="checkbox"/> Building Owner <input checked="" type="checkbox"/> Employees <input checked="" type="checkbox"/> Hired Maintenance <input type="checkbox"/> Other:			
How are noise issues prevented and/or addressed? <input checked="" type="checkbox"/> Security <input type="checkbox"/> Manager approaches customer(s) <input type="checkbox"/> Call Police <input type="checkbox"/> Signs Posted <input type="checkbox"/> Other:			
Are there designated outdoor smoking areas? <input checked="" type="checkbox"/> No <input type="checkbox"/> Yes If Yes, Describe:			
Number of garbage cans: Inside <u>5</u> Locations: <u>Bar, Kitchen + bathrooms</u> Outside <u>1</u> Locations: <u>Side of Garage Waste Management</u>			
Is a crowd control barrier used? <input checked="" type="checkbox"/> No <input type="checkbox"/> Yes If Yes, Describe:			
Number of restrooms: <u>3</u>		Name of solid waste contractor: <u>waste management</u>	
Are there parking spaces on the premises? <input type="checkbox"/> No <input checked="" type="checkbox"/> Yes If Yes, list number of spaces: <u>12</u> and describe security plans:			
Are there designated loading areas? <input type="checkbox"/> No <input checked="" type="checkbox"/> Yes If Yes, describe security plans: <u>Parking Lot</u>			
Do you have security personnel on the premise? <input type="checkbox"/> No <input checked="" type="checkbox"/> Yes If Yes, how many? _____ AND What are their responsibilities? <u>check IDs enforce rules & regulations</u> What security equipment do they use? <u>cameras ID scanners</u> List their licensing, certification or training credentials: _____			
Are there security cameras? <input type="checkbox"/> No <input checked="" type="checkbox"/> Yes If Yes, list all locations:			
Are searches and/or identification checks conducted upon entry? <input type="checkbox"/> No <input checked="" type="checkbox"/> Yes If Yes, describe:			
2. Percentage of Sales (must total 100%)			
Alcohol <u>30</u> %	Food Sales <u>35</u> %	Entertainment <u>35</u> %	Other _____ %
3. Businesses On The Premises (choose all that apply):			
<input type="checkbox"/> Restaurant <input checked="" type="checkbox"/> Cafe/Coffee Shop <input checked="" type="checkbox"/> Cocktail Lounge <input type="checkbox"/> Convenience Store <input type="checkbox"/> Night Club <input type="checkbox"/> Liquor Store <input type="checkbox"/> Tavern <input type="checkbox"/> Sports Facility <input type="checkbox"/> Hotel <input type="checkbox"/> Banquet Hall <input type="checkbox"/> Supermarket <input type="checkbox"/> Private/Frater nal /Vete rans ' Club <input type="checkbox"/> Other:			
4. Hours of Operation and Age Restriction			
Are there any changes to the current hours of operation or age restriction? <input checked="" type="checkbox"/> No <input type="checkbox"/> Yes If Yes, Describe:			
Please Note: If you will be open earlier or later than the hours listed on your current license for even one event or holiday (for example, St. Patrick's Day, Brewers Opening Day, etc.) during the license period, this must be reported and printed on your license. Your hours of operation and age restriction are listed on your current license.			
5. Floor Plan and Capacity			
Are you requesting any changes to your capacity or floor plan*? <input checked="" type="checkbox"/> No <input type="checkbox"/> Yes If yes, describe: _____ and submit a new floor plan with this renewal application. A sample plan can be found online at www.milwaukee.gov/licenses under License Forms and Related Information.			
Alcohol/Food Establishments: A "Permanent Extension of Premises Application" is required if you are adding any square footage to the licensed premises.			
6. Sidewalk Dining: Fee:			
Are there any changes to the sidewalk dining site plan? <input checked="" type="checkbox"/> No <input type="checkbox"/> Yes If Yes, submit an updated site plan with this application.			
7. Food License: Fee:		8. Weights and Measures: Fee:	
Your current food license includes the following food operations: Are there any changes to your food operations as listed above? <input type="checkbox"/> No <input checked="" type="checkbox"/> Yes, if Yes, explain <u>Changed from full kitchen to</u> <u>Prepackaged Foods</u>		Number/Type of Devices: Are there any changes to the number or types of devices? <input checked="" type="checkbox"/> No <input type="checkbox"/> Yes If yes, contact our office for further instructions.	

1. CURRENT APPROVED ENTERTAINMENT

The following types of entertainment have been approved for your current Public Entertainment Premises license:

Video game consoles and machines

2. ADDING ENTERTAINMENT

If applicable, check any entertainment you wish to add: **ONLY CHECK ENTERTAINMENT TYPE(S) YOU ARE ADDING. YOUR CURRENT APPROVED ENTERTAINMENT IS LISTED ABOVE.**

- | | | | |
|---|--|--|---|
| <input type="checkbox"/> Instrumental Musicians | <input type="checkbox"/> Bands | <input type="checkbox"/> Battle of the Bands | <input type="checkbox"/> Comedy Acts |
| <input type="checkbox"/> Disc Jockey | <input type="checkbox"/> Magic Shows | <input checked="" type="checkbox"/> Poetry Readings | <input type="checkbox"/> Dancing by Performers |
| <input type="checkbox"/> Jukebox | <input type="checkbox"/> Wrestling | <input checked="" type="checkbox"/> Patron Contests | <input checked="" type="checkbox"/> Patrons Dancing |
| <input type="checkbox"/> Adult Entertainment/
Strippers/Erotic Dance | <input checked="" type="checkbox"/> Karaoke | <input type="checkbox"/> Bowling Alley
How many? _____ | <input type="checkbox"/> Pool Tables
How many? _____ |
| <input type="checkbox"/> Motion Pictures (movies by admission)
How many screens? _____ | <input type="checkbox"/> Amusement Machines
How many? _____ | <input type="checkbox"/> Concerts
Approx. # per year? _____ | <input type="checkbox"/> Theatrical Performances
Approx. # per year? _____ |

Other: Patron contest is tournament once per month 50 to 100 people
No entertainment changes can take place until approved by Common Council and a new license has been issued and posted on the premises.

3. REMOVING ENTERTAINMENT

If applicable, list any entertainment you wish to remove:

4. PROMOTERS/SOUND AMPLIFICATION

Will promoters ever be used for any of the entertainment? No Yes If Yes, Describe:

At any time will sound amplification be used? No Yes If Yes, Describe:

Surround Sound for gaming tournaments and dancing.

5. SIGNATURE

I understand that after the license has been issued, a change to the plan of operation will require a written request to change and approval from the Common Council.

I agree to inform the City Clerk within 10 days of any substantial changes in the information supplied in this application.

I understand that I shall not willfully refuse to provide the services offered under this license, or add charges or require deposits not required of the general public because of race, color, sex, religion, national origin or ancestry, age, handicap, lawful source of income, marital status, sexual orientation, gender identity or expression, familial status or the fact that a person is now or has been a member of the military service, whether dressed in uniform or not; and shall not seek such information as a condition of employment, or penalize any employee or discriminate in the selection of personnel for training or promotion on the basis of such information.

I have knowledge of the City Ordinances currently regulating public entertainment, and understand that the license may be subject to suspension, non-renewal or revocation, if I violate any rule, law or regulation of the city of Milwaukee and State of Wisconsin.

Bryant Adams
Signature of Sole Proprietor, a Partner, or if a Corporation or LLC, the Agent must sign

Total square footage
2210'

32'

BACK EMPLOYEE
ENTRANCE / EXIT

garbage

alcohol
storage

30' x 20'
12 car
**PARKING
LOT**

KITCHEN AREA

25' x 15'
375 sqft.













LOT ENTRANCE / EXIT

65'

5' x 8'
FREEZER

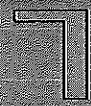
alcohol
storage

**BASEMENT
STAIRS**

-  TABLES & STOOLS
-  PATRONS
-  REST ROOMS
-  ARCADE CONSOLES
-  WINDOWS
-  DOORWAYS
-  PATIO FENCE
-  PLANT BOXES
-  PATRON
COUNTER
TOPS
-  STOOLS
-  SCREENS
-  FIRE EXT.

**MENS
ROOM**

KITCHEN
ENTRANCE

EXIT TO
PATIO

ENTRANCE
EXIT

**LADYS
ROOM**

CAFE & LOUNGE AREA

25' x 35'
875 sqft.

30' x 32'
**OUTSIDE
PATIO AREA**
960 sqft.

2 x 25

D I S P L A Y

seating area

2 x 25

D I S P L A Y

PRIVACY FENCE

FRONT ENTRANCE

32'

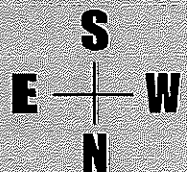

Bryant L. Adams : agent for
BATTLEBOX CAFE' & LOUNGE LLC.
 5419 w Lisbon ave. 53210
 date: june 7th 2017

west LISBON ave.

WEST LISBON AVE.

ENTRANCE #1

ENTRANCE #2

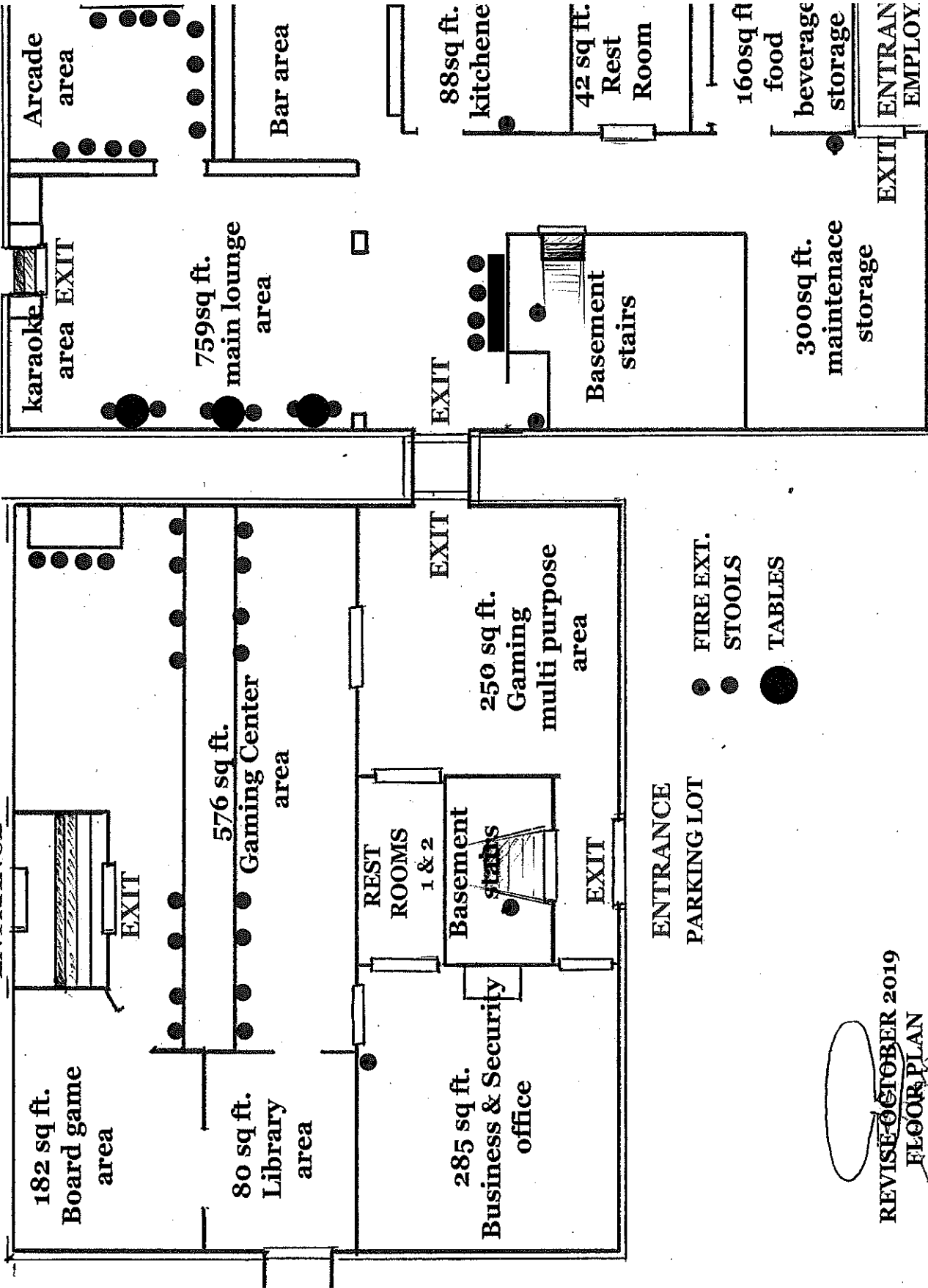

REVISED OCTOBER 2019
FLOOR PLAN

55TH STREET



CITY OF MILWAUKEE
OFFICE OF THE CITY CLERK

Monday, October 14, 2019

COMMITTEE MEETING NOTICE

AD 10

FELTEN, Brian V, Agent
BF @ GL Properties LLC
532 N 62nd St

Wauwatosa, WI 53213

You are requested to attend a hearing which is to be held in Room 301-B, Third Floor, City Hall on:

Tuesday, October 22, 2019 at 10:00 AM

Regarding: Your Class B Tavern, Food Dealer, and Public Entertainment Premises License Applications Requesting Jukebox as agent for "BF @ GL Properties LLC" for "The Neighborhood Draft" at 5921 W VLIET St.

There is a possibility that your application may be denied for one or more of the following reasons: The recommendation of the committee regarding the application shall be based on evidence presented at the hearing. Per MCO 85-2.7-4, probative evidence concerning whether or not a new license should be granted may be presented on the following subjects: whether or not the applicant meets the municipal requirements, the appropriateness of the location and premises where the licensed premises is to be located and whether use of the premises for the purposes or activities permitted by the license would tend to facilitate a public or private nuisance or create undesirable neighborhood problems such as disorderly patrons, unreasonably loud noise, litter, and excessive traffic and parking congestion. Probative evidence relating to these matters may be taken from the plan of operation submitted with the license application, if any, but shall not include the content of any music. Evidence regarding the fitness of the location of the premises to be maintained as the principal place of business, including but not limited to whether there is an overconcentration of businesses of the type for which the license is sought; whether the proposal is consistent with any pertinent neighborhood business or development plans, or the location's proximity to areas where children are typically present. The applicant's record in operating similarly licensed premises; and whether or not the applicant has been charged with or convicted of any felony, misdemeanor, municipal offense or other offense, the circumstances of which substantially relate to the activity to be permitted by the license being applied for or any other factor which reasonably relates to the public health, safety or welfare may also be considered. See attached police report or correspondence.

Notice for applicants with warrants or unpaid fines:

Proof of warrant satisfaction or payment of fines must be submitted at the hearing on the above date and time. Failure to comply with this requirement may result in a delay of the granting/denial of your application.

Failure to appear at this meeting may result in the denial of your license. Individual applicants must appear only in person or by an attorney. Corporate or Limited Liability applicants must appear only by the agent designated on the application or by an attorney. Partnership applicants must appear by a partner listed on the application or by an attorney. If you wish to do so and at your own expense, you may be accompanied by an attorney of your choosing to represent you at this hearing.

You will be given an opportunity to speak on behalf of the application and to respond and challenge any charges or reasons given for the denial. No petitions can be accepted by the committee, unless the people who signed the petition are present at the committee hearing and willing to testify. You may present witnesses under oath and you may also confront and cross-examine opposing witnesses under oath. If you have difficulty with the English language, you should bring an interpreter with you, at your expense, so that you can answer questions and participate in your hearing.

You may examine the application file at this office during regular business hours prior to the hearing date. Inquiries regarding this matter may be directed to the person whose signature appears below.

Limited parking for persons attending meetings in City Hall is available at reduced rates (5 hour limit) at the Milwaukee Center on the southwest corner of East Kilbourn and North Water Street. Parking tickets must be validated in the first floor information booth in City Hall.

PLEASE NOTE: Upon reasonable notice, efforts will be made to accommodate the needs of disabled individuals through sign language interpreters or other auxiliary aids. For additional information or to request this service, contact the Council Services Division ADA Coordinator at (414) 286-2998, Fax - (414) 286-3456, TDD - (414) 286-2025.

JIM OWCZARSKI, CITY CLERK

BY: _____

Jessica Celella

License Division Manager

If you have questions regarding this notice, please contact the License Division at (414) 286-2238.

200 E. Wells Street, Room 105, City Hall, Milwaukee, WI 53202. www.milwaukee.gov/license
Phone: (414) 286-2238 Fax: (414) 286-3057 Email Address: License@milwaukee.gov

Date: 09/23/19
Officer: Whittenberger

City of Milwaukee Police Department
90-5-1.5 Crime Prevention Survey
Tavern Inspection

Name of Premise: The Neighborhood Draft
Address: 5921 W Vliet St, Milwaukee, WI 53208
Phone: N/A

Owner: Brian Felten
Owner address: 532 N 62nd St
City State Zip: Wauwatosa, WI 53213
Owner Phone: 414-837-8789
Owner email: bfelt@gmail.com

Licensee/Agent: Same
Home Address: "
City State Zip: "
Phone: "
Email: "

Preferred contact: Brian Felten

Location currently open: YES NO

Projected open date: 11/01/19

Day's open: S M T W Th F SA ALL

Hours of Operation: Sun: 12P – 8P 24 hours Y N
Mon:
Tue: 3P – 10P
Wed: 3P – 10P
Thu: 3P – 10P
Fri: 3P – 12A
Sat: 12P – 12A

Premise Type: Tavern/Bar
Restaurant
Other:

Licenses currently held:

- Alcohol: Yes No Class: #:
- Tobacco: Yes No #:
- Food: Yes No #:
- Extended Hours: Yes No #:
- Secondhand Dealer: Yes No Type: #:
- Other: Yes No Type: #:
- Other: Yes No Type: #:

Exterior Survey:

1. Is the area around the location clean? Yes No
2. What surrounds the location? (Check all the apply)
 - a. Park
 - b. School
 - c. Youth Center
 - d. Church
 - e. Tavern(s) If so, how many 1
 - f. Residential
 - g. Other businesses
 - h. Other:
3. Can you see from the outside of the location into the interior Yes No
4. Can you see the employees inside of the location from the outside Yes No
5. Are exterior windows free of signage Yes No
6. Is there a parking lot Yes No
7. Is the parking lot clean? N/A
8. Off-Street parking Yes No
9. Is the parking lot well lit? N/A
10. Valet Parking Yes No
 - a. Will this lot have a guard? Yes No
 - b. Will this lot have cameras? Yes No
11. Are there areas where a person could conceal themselves Yes No
12. Is there exterior lighting? Yes No. Does it appears to be adequate Yes No
13. Exterior Payphone? Yes No
14. Are there No Loitering Signs posted? Yes No
15. Are there exterior security cameras Yes No How Many:
16. Are the address numbers prominently displayed and easy to see Yes No

Camera Survey:

17. Does this location have security cameras? Yes No
18. Are they in working order? Yes No
19. What format are the cameras?
 - a. Color Yes No
 - b. Digital Yes No
 - c. Recorded Yes No
20. How long is footage stored for later viewing:
21. Are there exterior cameras Yes No How many:
22. Are there interior cameras Yes No How many:
23. Do all employees know how to retrieve recorded digital images/footage? Yes No

24. Cameras located in parking lot Yes No How many

Interior Survey:

- 25. What is the planned capacity? 70
- 26. What is the minimum number of employees that will be on premise? 4
- 27. Is the storeowner willing to be a standing complainant regarding loitering? Yes No
 - a. If yes have them fill out the standing complaint form and give them two of the commercial signs Yes No
- 28. Is the interior of the location neat and clean? Yes No
- 29. Does an interior camera face the entrance/exit? Yes No
- 30. Is there a lockable area that separates employees from customers? Yes No
- 31. Are emergency and non-emergency numbers posted near the phone? Yes No
- 32. Does the owner know how to contact their police district directly? Yes No
 - a. Did you provide a district contact guide to the owner? Yes No

Security

- 33. How many security personnel are going to be employed: 0
- 34. How ill they be deployed: Interior 0 Exterior 0
- 35. What days will they be deployed: none
- 36. Will the security be managed by business or contracted
- 37. Will they be armed Yes No
- 38. What type of security measures to be used:
 - Wanding/metal detector
 - ID Scanner
 - Dress Code
 - Cover Charge
 - Age restriction
 - Other Card any suspicious people

ADDITIONAL COMMENTS/RECOMMENDATIONS:

Owner is currently still remodeling. Owner stated that he will have video surveillance once the store is up and running. Owner stated he was not going to put no loitering signs up at this time, but if it ever became an issue he would put up the signs and sign a standing complaint form.

Alcohol Concentration for 5921 W Vliet St.

City of Milwaukee, Wisconsin

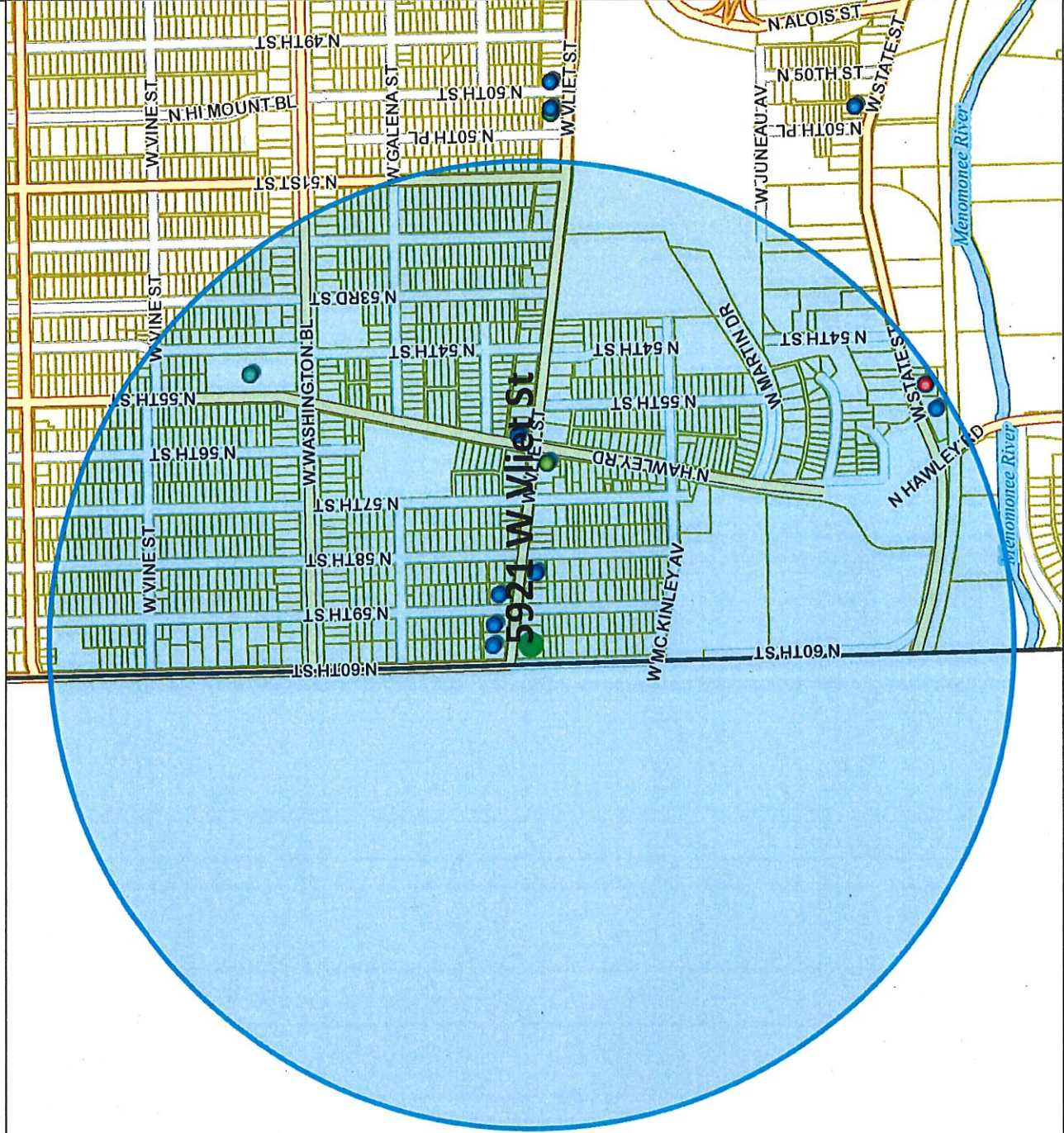

Map Scale: 1: 10,000

© City of Milwaukee, Wisconsin
 Map Milwaukee: Property Information
 Disclaimer
 8/19/2019



- Legend -

- Street names 10,000
- City limits
- Freeways 15,000
- Freeways
- Exit ramps
- Entry ramps
- Ramps
- Major streets 10,000
- Streets 10,000
- Waterways
- Milwaukee Parcels
- Alcohol licenses
 - Class A intoxicating liquor
 - Class A fermented malt beverage
 - Class A liquor and malt
 - Class B fermented malt beverage
 - Class B tavern
 - Class C wine retailer



- Notes -

Alcohol Establishments within a .5 Mile Radius Centered on 5921 N Vliet St. as of 08/19/2019



Department of Administration - ITMD



Monday, October 14, 2019

Licenses Committee Notice of Hearing

BF MF LLC
5921 W VLIET St
Milwaukee, WI 53208

Date: 10/22/2019
Time: 10:00 AM
Location: Room 301-B, Third Floor, City Hall

The Licenses Committee will consider the following license application:

Class B Tavern, Food Dealer, and Public Entertainment Premises License
Applications Requesting Jukebox
FELTEN, Brian V, Agent
The Neighborhood Draft at 5921 W VLIET St

Please note this application may be recommended for denial based on fitness of the location due to concentration of alcohol beverage outlets in the area. If the application is denied for this reason, no other application for an alcohol beverage license for this location shall be recommended for approval by the Licenses Committee within three years of the date of denial unless the applicant has demonstrated a change of circumstances since the prior denial.

If you have any questions, please call (414) 286-2238.





Monday, October 14, 2019

Licenses Committee Notice of Hearing

Brian Felton
532 N 62nd St
Wauwatosa, WI 53213

Date: 10/22/2019
Time: 10:00 AM
Location: Room 301-B, Third Floor, City Hall

The Licenses Committee will consider the following license application:

Class B Tavern, Food Dealer, and Public Entertainment Premises License
Applications Requesting Jukebox
FELTEN, Brian V, Agent
The Neighborhood Draft at 5921 W VLIET St

Please note this application may be recommended for denial based on fitness of the location due to concentration of alcohol beverage outlets in the area. If the application is denied for this reason, no other application for an alcohol beverage license for this location shall be recommended for approval by the Licenses Committee within three years of the date of denial unless the applicant has demonstrated a change of circumstances since the prior denial.

If you have any questions, please call (414) 286-2238.





Monday, October 14, 2019



Notice of Public Hearing

FELTEN, Brian V, Agent
The Neighborhood Draft at 5921 W VLIET St
Class B Tavern, Food Dealer, and Public Entertainment Premises License Applications
Requesting Jukebox

Tuesday, October 22, 2019 at 10:00 AM

To whom it may concern:

The above application has been made by the above named applicant(s). This requires approval from the Licenses Committee and the Common Council of the City of Milwaukee. The hearing before the Licenses Committee will take place on 10/22/2019 at 10:00 AM, in Room 301-B, Third Floor, City Hall. If you wish, you may provide testimony at the hearing regarding the request; see below for further information. You are not required to attend the hearing. Once the Licenses Committee makes its recommendation, this recommendation is forwarded to the full Common Council for approval at its next regularly scheduled hearing. Please review the information below and if you have further questions regarding this process, please contact the License Division at (414) 286-2238.

Important details for those wishing to provide information for the Licenses Committee to consider when making its recommendation:

1. The license application is scheduled to be heard at the above time. Due to other hearings running longer than scheduled, you may have to wait some time to provide your testimony.
2. You must appear in person and testify as to matters that you have personally experienced or seen. (You cannot provide testimony for your neighbor, parent or anyone else; this is considered hearsay and cannot be considered by the committee.)
3. No letters or petitions can be accepted by the committee (unless the person who wrote the letter or the persons who signed the petition are present at the committee hearing and willing to testify).
4. Persons opposed to the license application are given the opportunity to testify first; supporters may testify after the opponents have finished.
5. When you are called to testify, you will be sworn in and asked to give your name, and address. (If your first and/or last names are uncommon please spell them.)
6. You may then provide testimony.
 - a. Include only information relating to the above license application.
 - b. Include only information you have personally witnessed or seen.
 - c. Provide concise and relevant information detailing how this business has affected or may affect the peaceful enjoyment of your neighborhood.
 - d. If by the time you have the opportunity to testify, the information you wish to share has already been provided to the committee, you may state that you agree with the previous testimony. Redundant or repetitive testimony will not assist the committee in making its recommendation.
7. After giving your testimony, the members of the Licenses Committee and the licensee may ask questions regarding the testimony you have given or other factors relating to the license application.
8. Business Competition is not a valid basis for denial or non-renewal of a license.
Please Note: If you have submitted an objection to the above application your objection cannot be considered by the committee unless you personally testify at the hearing.

OCCUPANT	MAIL ADDRESS	CITY, STATE ZIP
CURRENT OCCUPANT	1357 N 59TH ST	MILWAUKEE, WI 53208
CURRENT OCCUPANT	1378 N 60TH ST	MILWAUKEE, WI 53208
CURRENT OCCUPANT	1392 N 59TH ST 1	MILWAUKEE, WI 53208
CURRENT OCCUPANT	1392 N 59TH ST 4	MILWAUKEE, WI 53208
CURRENT OCCUPANT	5923 W VLIET ST	MILWAUKEE, WI 53208
CURRENT OCCUPANT	1393 N 59TH ST	MILWAUKEE, WI 53208
CURRENT OCCUPANT	1400 N 59TH ST 1	MILWAUKEE, WI 53208
CURRENT OCCUPANT	1502 N 60TH ST	MILWAUKEE, WI 53208
CURRENT OCCUPANT	1506 N 60TH ST	MILWAUKEE, WI 53208
CURRENT OCCUPANT	1364 N 60TH ST	MILWAUKEE, WI 53208
CURRENT OCCUPANT	1370 N 59TH ST	MILWAUKEE, WI 53208
CURRENT OCCUPANT	1372 N 59TH ST	MILWAUKEE, WI 53208
CURRENT OCCUPANT	1380 N 59TH ST	MILWAUKEE, WI 53208
CURRENT OCCUPANT	1382 N 60TH ST	MILWAUKEE, WI 53208
CURRENT OCCUPANT	5921 W VLIET ST B	MILWAUKEE, WI 53208
CURRENT OCCUPANT	1379 N 59TH ST	MILWAUKEE, WI 53208
CURRENT OCCUPANT	1378A N 60TH ST	MILWAUKEE, WI 53208
CURRENT OCCUPANT	5903 W VLIET ST	MILWAUKEE, WI 53208
CURRENT OCCUPANT	1506A N 60TH ST	MILWAUKEE, WI 53208
CURRENT OCCUPANT	1365 N 59TH ST	MILWAUKEE, WI 53208
CURRENT OCCUPANT	1385 N 59TH ST	MILWAUKEE, WI 53208
CURRENT OCCUPANT	1392 N 59TH ST 3	MILWAUKEE, WI 53208
CURRENT OCCUPANT	1361 N 59TH ST	MILWAUKEE, WI 53208
CURRENT OCCUPANT	5926 W VLIET ST 1	MILWAUKEE, WI 53208
CURRENT OCCUPANT	1356 N 60TH ST	MILWAUKEE, WI 53208
CURRENT OCCUPANT	1368 N 59TH ST	MILWAUKEE, WI 53208
CURRENT OCCUPANT	1371 N 59TH ST	MILWAUKEE, WI 53208
CURRENT OCCUPANT	1378 N 59TH ST	MILWAUKEE, WI 53208
CURRENT OCCUPANT	1400 N 59TH ST 2	MILWAUKEE, WI 53208
CURRENT OCCUPANT	1502 N 60TH ST A	MILWAUKEE, WI 53208
CURRENT OCCUPANT	1368 N 60TH ST	MILWAUKEE, WI 53208
CURRENT OCCUPANT	1370 N 60TH ST	MILWAUKEE, WI 53208
CURRENT OCCUPANT	1375 N 59TH ST	MILWAUKEE, WI 53208
CURRENT OCCUPANT	1392 N 59TH ST 2	MILWAUKEE, WI 53208
CURRENT OCCUPANT	5926 W VLIET ST 5	MILWAUKEE, WI 53208
CURRENT OCCUPANT	5926 W VLIET ST 2	MILWAUKEE, WI 53208
CURRENT OCCUPANT	5926 W VLIET ST 3	MILWAUKEE, WI 53208
CURRENT OCCUPANT	5926 W VLIET ST 4	MILWAUKEE, WI 53208
CURRENT OCCUPANT	1374 N 59TH ST	MILWAUKEE, WI 53208
CURRENT OCCUPANT	1374 N 60TH ST	MILWAUKEE, WI 53208
CURRENT OCCUPANT	1509 N 59TH ST	MILWAUKEE, WI 53208

Total Records: 41

Radius: 250.0 feet and Center of Circle: 5921 W Vliet St



BUSINESS LICENSE PLAN OF OPERATION

ccl-busplan 3/15/18

Office of the City Clerk License Division
200 E. Wells St. Room 105, Milwaukee, WI 53202
(414) 286-2238 www.milwaukee.gov/license e-mail address: license@milwaukee.gov

1. Type of Business

Applying for: Extended Hours (12AM to 5AM) - If a food establishment, check all that apply: Delivery Drive Thru Dining Room
 Self Service Laundry Massage Establishment Filling Station
 Other (supplemental application for specific license also required)

Provide a detailed description of the type of business you plan on operating:
RESTAURANT

Do you have any experience operating this type of business? No Yes If yes, explain: 20+ years w/ family business (Tomken's)

2. Business Operations

a. Proposed Opening Date: October 7th 2019
b. Is this premise under construction? No Yes If yes, list estimated completion date: _____
c. Is this a franchise? No Yes
d. Is this premises currently licensed? No Yes If yes, list type of license: _____
e. Is the current licensee operating? No Yes If no, list date closed: 4-29-19
f. Do you have future plans for other businesses, licenses or permits at this location? No Yes
If yes, explain: _____
g. Have you previously held an Extended Hours License in Milwaukee? No Yes
If yes, list address(es): _____
h. Are other businesses operating in the same building? No Yes If yes, describe: _____

3. Litter & Noise

a. How are grounds kept clean? Sweep Pressure Wash Pick Up Litter Other: _____
b. How often will grounds be cleaned? Daily Weekly As Needed Monthly Other: _____
c. Grounds cleaned by: Licensee Building Owner Employees Hired Maintenance Other: _____
d. How are noise issues prevented and/or addressed? Security Manager approaches customer(s) Call Police
 Signs Posted Other: Controlled hours
e. Will a sound amplification system be used? No Yes If yes, describe: Jukebox, background music

4. Smoking & Sanitation

a. Are there designated outdoor smoking areas? No Yes If yes, describe: _____
b. Number of Garbage Cans: Inside: 5 Locations: Bar & Kitchen
Outside: 2 Locations: Patio & Side
c. Is a crowd control barrier used? No Yes If yes, describe: _____
d. How many restrooms are on the premises? 2
e. Name of solid waste contractor: Advanced Disposal Waste Management Other: Johns Disposal

5. Security

- a. Are there onsite parking spaces? No Yes If yes, how many? _____ and describe the parking security plan: _____
- b. Is there a loading zone? No Yes If yes, describe the loading area security plan: _____
- c. Will you have security personnel on premise? No Yes If yes, how many? _____ and answer the following:
 What are their responsibilities? _____
 Is security equipment used? No Yes If yes, describe _____
 List their licensing, certification, or training credentials _____
- d. Will there be security cameras? No Yes If yes, how many? 4 and list locations: FRONT DOOR, REGISTER, INTERIOR (OPPOSITE DIRECTIONS)
- e. Will searches/identification checks be done upon entry? No Yes If yes, describe CHECK ID FOR ALCOHOL SALES

6. Percentage of Sales (must total 100%)

Alcohol <u>58</u> %	Food <u>40</u> %	Secondhand Merchandise <u>0</u> %	Precious Metals & Gems <u>0</u> %
Entertainment <u>2</u> %	Cigarettes <u>0</u> %		
Pawnbroker Activity <u>0</u> %	Salvaged Materials <u>0</u> % (such as scrap metal)	Personal Services (such as tattoo, body piercing, salon, tailor, tanning, etc.) <u>0</u> %	Other <u>0</u> % Describe: _____

7. Businesses/Licenses on the Premises (check all that apply):

Type 1

- Full Service Restaurant Cafe/Coffee Shop Deli or Fast Food Restaurant Private/Fraternal/Veterans Club
- Night Club Tavern Cocktail Lounge Teen Club
- Banquet Hall Sports Facility Bowling Alley
- Hotel/Motel : Number of Floors: _____ Number of Rooms: _____
 Rooming House: Number of Floors: _____ Number of Rooms: _____

Type 2

- Liquor Store Corner Store Supermarket Convenience Store
- Gas Station Amusement/Phonograph Distributor Recycling, Salvage or Towing
- Used Car Dealer Personal Service Establishment (such as tattoo business, hair salon, tailor, etc.) Recording Studio

What other licenses/permits will you hold at this location? (check all that apply)

- Occupancy Permit Cigarette & Tobacco Gas Station Extended Hours Class "B" Tavern Weights & Measures
- Secondhand Dealer Precious Metal & Gem Other: _____

8. Legal Capacity (only if a Type 1 premises in #7 above)

Capacity 70 (Call the Milwaukee Development Center at 414-286-8211 if you have questions.)

9. Premises Description

a. Identify all area(s) of the premises that will be used in operating this business (include areas used only for storage):

1st Floor 2nd Floor Basement Storage Patio Beer Garden Sidewalk Café Deck Rooftop

Other: Describe: _____

b. Describe Location: Major Thoroughfare Secondary Street Other: _____

c. Nearest Major Cross Street: Villet & Both St

d. Describe Building: Free Standing Building Strip Mall Other: _____

e. Describe Premises Structure: Single Story Multi-Story - # of Stories 2 Other: _____

f. Describe Surrounding Area: Commercial Residential Industrial Other: _____

g. Building Owner Name: Brian Felten Phone Number: 414-837-8789

Business Owner Address: 532 N 12nd St, Wauwatosa WI 53213

10. Hours of Operation & Customers

Will customers be entering the premises? No Yes

Day of the Week	Proposed Hours of Operation:		Estimated Number of Customers expected each day	Potential Age Range of Customers	Class B Tavern Applicant Only: Age Restriction (If none, write 'None')
	Open Time (include a.m. or p.m.)	Close Time (include a.m. or p.m.)			
Sunday	12 PM	8 PM	40+45	25-55	None
Monday	3 PM CLOSED			25-55	None
Tuesday	3 PM	10 PM	30 to 40	25-55	None
Wednesday	3 PM	10 PM	30 to 40	25-55	None
Thursday	3 PM	10 PM	40 to 50	25-55	None
Friday	3 PM	12 AM	40 to 60	25-55	None
Saturday	12 PM	12 AM	40 to 60	25-55	None

An Extended Hours Establishment License is required for any convenience store, filling station, personal service establishment (such as tattoo, body piercing, salon, tailor, tanning, etc.), recording studio or restaurant which is open between the hours of 12:00 a.m. and 5:00 a.m.

Alcohol Establishments Class A: 8:00 am to 9:00 pm Sunday thru Saturday
 Permitted Hours of Operation: Class B: 6:00 am to 2:00 am Sunday thru Thursday, 6:00 am to 2:30 am Friday & Saturday

Entertainment Outdoor Closing Hours: 10:00pm Sunday-Thursday; 12:00am Friday & Saturday; unless a different time, either earlier or later, is established by the Common Council in its approval of the licensee's plan of operation.

11. Signature(s)

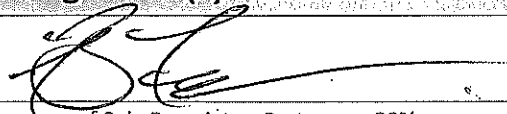
 Signature of Sole Proprietor, Partner, or 20% or more Shareholder
 (If there are no 20% or more shareholders,
 Corporate Officer-print name/title and sign)

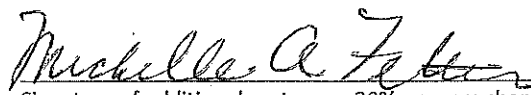
 Signature of additional partner or 20% or more shareholder

See Application Information for a complete list of all required application forms.



**ALCOHOL BEVERAGE & PUBLIC ENTERTAINMENT PREMISES
SUPPLEMENTAL APPLICATION**

Office of the City Clerk License Division
200 E. Wells St. Room 105, Milwaukee, WI 53202
(414) 286-2238 e-mail address: license@milwaukee.gov www.milwaukee.gov/license

Legal Entity Name: BF@GL Properties LLC

Premise Address: 5921 W Vliet

Proximity of Premises to Church, School, Daycare Center or Hospital

Is the building within 300 feet of any church, school, daycare center or hospital? No Yes

"Service Bar Only" Designation

If applying for Class B or C license, are you applying for "Service Bar Only"? No Yes
Service Bar Only means customers cannot sit at the bar. Alcohol is served to employees who serve patrons seated at tables. No stools, chairs or other articles of furniture shall be placed at the service bar for patrons to sit upon.

Business Information

- a) Are you taking out this application for anyone that may not be eligible for a license? No Yes
If yes, list their name and address: _____
 - b) Will the agent, a partner or the individual licensee be conducting the day-to-day operations of the business? No Yes
If no, list the name and address of the person(s) who will: _____
- Class B Applicants: If the agent, a partner or the individual licensee will not be conducting the day-to-day operations of the business, the person(s) listed above must obtain a Class B Managers license.
- c) Does anyone else have money invested or any other interest in this business? No Yes
If yes, explain: Michelle Felton, LLC partner
 - d) Have you made an agreement with anyone to repay any loan or any other payments based upon income from the business? No Yes If yes, list name and address: _____

Proof of Ownership, Lease, or Offer to Purchase (New & Transfer Applicants Only)

Submit proof of ownership, lease, or offer to purchase the building with this application.
A lease or offer to purchase must:

- a) Be in the same legal entity name as that apply for the license
- b) Reflect the same address as the premises address on this application
- c) Reflect current dates and
- d) Be signed by the lessor/seller and lessee/buyer

Property Information (New & Transfer Applicants Only)

- a) Do you own or lease the building? Own Lease
 - b) Who owns the fixtures (for example, coolers, etc.)? MC
 - c) Are you purchasing the stock and/or fixtures? No Yes If yes, amount paid \$ _____
 - d) Total amount paid for business \$ 250,000
 - e) Total amount paid for goodwill of the business \$ 0
- Goodwill comprises the reputation and customer relationships of an existing business. If the price you pay for the business exceeds the fair market value of all of the rest of the assets of the business, the excess may be considered goodwill.
- f) Have you made arrangements with the seller for payment of personal property taxes? No Yes

See Application Information for a list of all required application forms.

Lease Information (New & Transfer Applicants who are leasing the premises only)

- a) Date lease begins Aug 8 2016 ends September 1st 2022
- b) Monthly rental \$ 3000.00
- c) Do you have an option to renew the lease? No Yes
- d) Does your lease allow for assignment to another party without the consent of the owner? No Yes
- e) For what length of time have you been guaranteed occupancy (number of years) 3 years
- f) In addition to paying the monthly rental, will you have to pay anything additional to the owner of the building to guarantee performance of the lease? No Yes If yes, explain _____
- g) Does the present owner or occupancy object to the granting of your license? No Yes
If yes, explain the owner is also the tenant

Change of Agent Applicants Only

- Have there been any changes to the floor plan since the last application was submitted? No Yes
- If no, a new floor plan is not required. If yes, submit a new floor plan and explain the change(s): _____

Signature

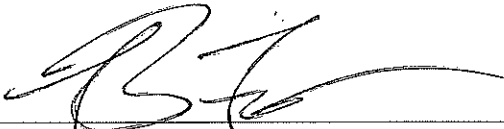

Signature of Sole Proprietor, Partner or 20% or More Shareholder
(If no 20% or more Shareholder, Corporate Officer - print name/title and sign)

Note: All information contained in this application is subject to approval by the Common Council.
Deviating from approved plan of operation will subject licensee to citations, and/or suspension or non-renewal of the license.
Contact the License Division for information on how to request changes.

New and transfer of premises applicants must submit the following:

- Proof of ownership, lease or offer to purchase the building
- Detailed floor plan
- If a restaurant, copy of the menu



PUBLIC ENTERTAINMENT PREMISES LICENSE SUPPLEMENTAL APPLICATION

Office of the City Clerk License Division
200 E. Wells St. Room 105, Milwaukee, WI 53202
(414) 286-2238 www.milwaukee.gov/license e-mail address: license@milwaukee.gov

PREMISES ADDRESS: 5921 West Vliet Street, MILW WI 53208

TYPES OF ENTERTAINMENT (CHECK ALL THAT APPLY)

<input type="checkbox"/> Instrumental Musicians	<input type="checkbox"/> Battle of the Bands	<input type="checkbox"/> Dancing by Performers	<input type="checkbox"/> Amusement Machines How many? _____
<input type="checkbox"/> Bands	<input type="checkbox"/> Comedy Acts	<input type="checkbox"/> Adult Entertainment/ Strippers/Erotic Dance	<input type="checkbox"/> Concerts Approx. # per year? _____
<input type="checkbox"/> Bowling Alley How many? _____	<input type="checkbox"/> Disc Jockey	<input type="checkbox"/> Wrestling	<input type="checkbox"/> Theatrical Performances Approx. # per year? _____
<input type="checkbox"/> Pool Tables How many? _____	<input type="checkbox"/> Magic Shows	<input type="checkbox"/> Patron Contests	<input checked="" type="checkbox"/> Jukebox
<input type="checkbox"/> Motion Pictures (movies by admission) - How many? _____	<input type="checkbox"/> Poetry Readings	<input type="checkbox"/> Patrons Dancing	<input type="checkbox"/> Karaoke
<input type="checkbox"/> Other: _____			

Entertainment Outdoor Closing Hours: 10:00pm Sunday-Thursday; 12:00am Friday & Saturday; unless a different time, either earlier or later, is established by the Common Council in its approval of the licensee's plan of operation.

PROMOTERS/SOUND AMPLIFICATION

Will promoters ever be used for any of the entertainment? No Yes If Yes, Describe:

At any time will sound amplification be used? No Yes If Yes, Describe: SPEAKERS IN RESTAURANT

LEGAL CAPACITY OF PREMISES

70 (Call the Development Center at 414-286-8211 with questions.) Legal capacity determines the fee for your Public Entertainment Premises License. If you would like to request the license be approved with a lower capacity than that listed above, indicate the lower capacity here: _____. If approved, this lower capacity will print on your license and override the capacity listed on your Occupancy Permit.

ACKNOWLEDGEMENT/SIGNATURE

I understand that after the license has been issued, a change to the plan of operation will require a written request to change and approval from the Common Council. I agree to inform the City Clerk within 10 days of any substantial changes in the information supplied in this application. I understand that I shall not willfully refuse to provide the services offered under this license, or add charges or require deposits not required of the general public because of race, color, sex, religion, national origin or ancestry, age, handicap, lawful source of income, marital status, sexual orientation, gender identity or expression, familial status or the fact that a person is now or has been a member of the military service, whether dressed in uniform or not; and shall not seek such information as a condition of employment, or penalize any employee or discriminate in the selection of personnel for training or promotion on the basis of such information.

I have knowledge of the City Ordinances currently regulating public entertainment, and understand that the license may be subject to suspension, non-renewal or revocation, if I violate any rule, law or regulation of the city of Milwaukee and State of Wisconsin.

Signature of Sole Proprietor, Partner or 20% or More Shareholder
(If no 20% or more Shareholder, Corporate Officer - print name/title and sign)

Office Use Only:

Initials: _____ Filed: _____ App: _____

Only PEP? No Yes If Yes, Queue to MPD and Email Mgrs/Team Lead (must be heard w/in 60 days)



FOOD DEALER LICENSE PLAN OF OPERATION

OFFICE OF THE CITY CLERK, LICENSE DIVISION
 CITY HALL, 200 E. WELLS ST, ROOM 105, MILWAUKEE, WI 53202
 (414) 286-2238 • license@milwaukee.gov • www.milwaukee.gov/license

Legal Entity Name: BF @ OL PROPERTIES LLC

Premises Address: 5921 W Vliet, MILW WI 53208

SECTION 1 TYPE OF BUSINESS

What will be the majority of your food sales? (check one)

Restaurant Items (meals):
 MEALS include, but are not limited to, chicken, ribs, sandwiches, roasted corn, baked potatoes, hot dogs, brats, tacos, nachos w/ cheese and meat, French fries, cooked or deep fried vegetables/fruit, cooked cheese curds, corn dogs, egg rolls, salads.

Retail Items (snacks and beverages):
 RETAIL items include, but are not limited to, ice cream/soft serve, lemonade, snow cones, coffee, espresso, cappuccino, tea, fruit juice, smoothies, candy, dispensed soda, fruit cups, bakery, cookies, kettle corn, cotton candy, funnel cakes, fritters, tortilla chips w/ cheese.

Will it be a convenience store? Yes No
 A convenience store contains less than 5,000 square feet of retail space and has, as its primary business, the sale of basic food items and in addition, sells household products or is a filling station that sells basic food items and household products.

- Bed & Breakfast
- Micro Market

All Applicants: Submit a menu or a list of food items that will be sold.

Will any wholesale business be done? No Yes If yes, what percentage of food sales will be wholesale?
 Less than 25%
 25% or More AND:
 Restaurant items (meals) will be sold – Complete this application and also contact DATCP.
 NO restaurant items (meals) will be sold - Do NOT complete this application. Contact DATCP only.

SECTION 2 FOOD PROCESSING

Will any food processing be done? No Yes

Processing is defined as assembling, grinding, cutting, mixing, baking, coating, stuffing, packing, bottling, grilling, canning, extracting, fermenting, distilling, pickling, freezing, drying, smoking, or packaging.

SECTION 3 FOOD REQUIRING TEMPERATURE CONTROL

Will any food that requires temperature control be sold? No Yes
 (includes dairy products such as milk, cheese, and ice cream, fish, shellfish, meat, poultry)

If yes, list the types of food items: Fish, meat, poultry, dairy

SECTION 4 DETAILS OF OPERATION

- Will you have seating on site for dining? No Yes
- Will you be doing any catering? No Yes
- Will you be doing any delivery? No Yes
- Will you have outdoor activities? No Yes - Check all that apply: Bar Cooking/Grilling Dining
- Will you have a drive thru window? No Yes - Are hours different from inside? No Yes
- If Yes, provide drive thru hours: _____
- Will scales or barcode scanners be used? No Yes - You must also apply for a Weights & Measures License.

SECTION 5 ADDITIONAL SITES

Where will food be prepared and/or sold?

At a single site At multiple sites: How many? _____ (for example, a hotel with several dining rooms or bars)

If multiple sites, attach a Food Dealer Additional Site Addendum (ccl-foodadd) for each additional site.

SECTION 6 CONSTRUCTION OR CHANGES

Are you planning any construction, remodeling or equipment changes?

No If No, SKIP to Section 8

Yes If Yes, check all that apply: New construction of a building Renovation or remodeling

Construction changes to existing building Equipment changes only

Provide a brief description of the changes: _____

Start date: _____

Name, Address & Phone Number of Architect: _____

Name, Address & Phone Number of Contractor: _____

SECTION 7 ALCOHOL BEVERAGES

Are you applying for an alcohol beverage license?

No If No, SKIP to Section 9

Yes If YES, if your food license is approved prior to the alcohol license, when do you want the food license issued?

Immediately At the same time as the alcohol license

SECTION 8 ACKNOWLEDGEMENTS & SIGNATURE

You must initial each item confirming your understanding:

[Handwritten initials]

[Handwritten initials]

[Handwritten initials]

[Handwritten initials]

[Handwritten initials]

[Handwritten initials]

- I understand the Health Department must conduct an inspection and advise the License Division of their approval before the license may be issued.
- I understand I must obtain an occupancy permit from the Department of Neighborhood Services and an inspection may be required. Neighborhood Services must advise the License Division of their approval before the license may be issued.
- I understand the district alderperson will review and either support or object to my application. If he/she objects, I may appeal and be scheduled to appear before the Licenses Committee. The Licenses Committee will then make a recommendation to the Common Council. The Common Council must grant the license before it may be issued.
- I understand proof of payment for all license fees must be on file in the License Division before the license may be issued and the license must be issued and posted in my establishment prior to opening for business.
- I will not operate my food business until the license has been issued and posted in the establishment.

Signature of Sole Proprietor, Partner, or 20% Shareholder: _____

Signature of Additional Partner: *Michelle A. Felton*

First Floor

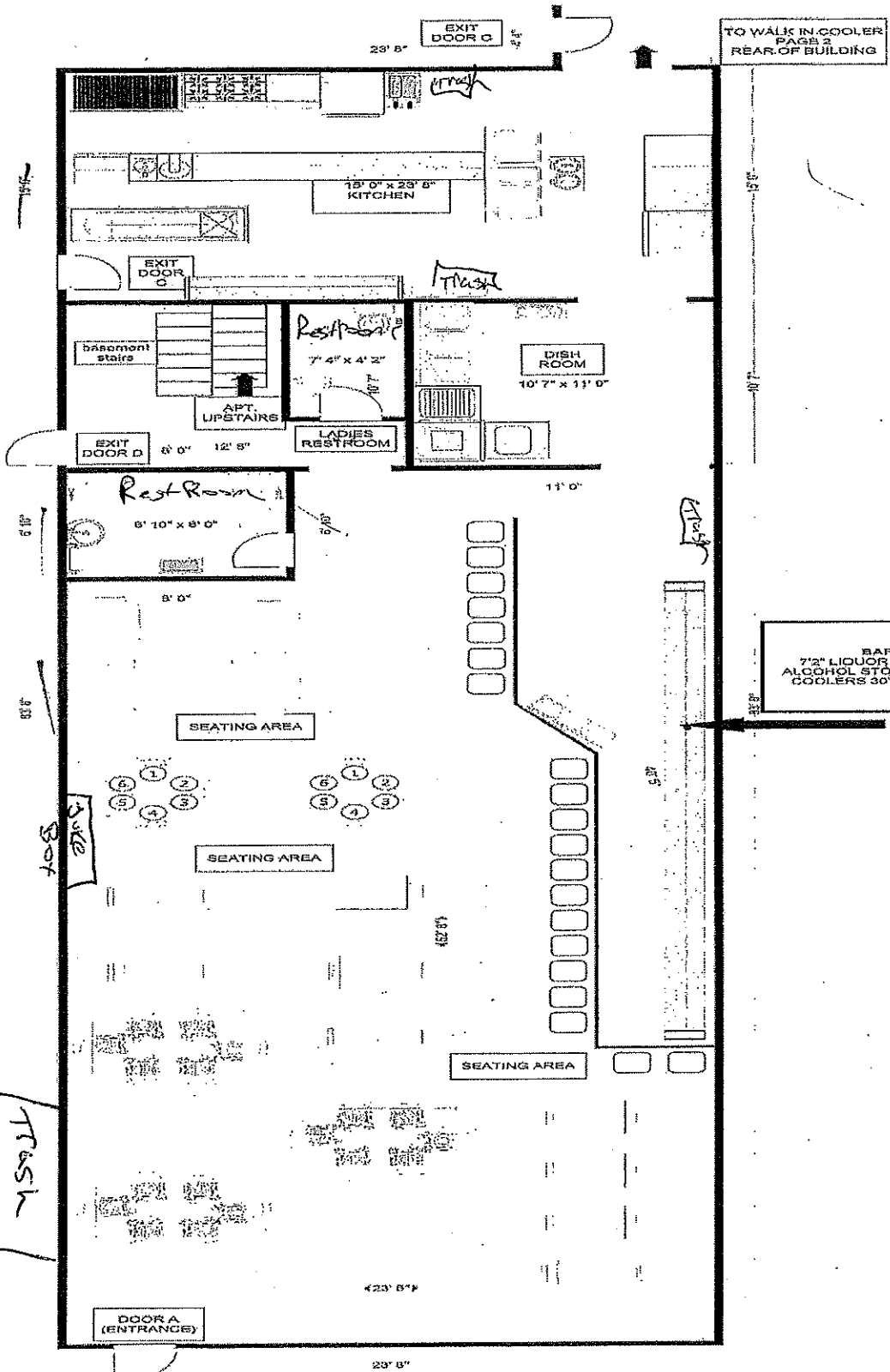

5
↑
60th Street
22
↓

E ←  NORTH → W
Vliet Street

The Neighborhood Draft 5921 W Vliet Street Milwaukee, WI 53208	DRAWN BY Brian Felten (Agent)		DATE 07/30/2019
	Square Footage 1999.11 Sq. Ft.	FLOOR MAIN	SHEET NO. 1/3

REAR OF BUILDING

Patio & Kitchen

BF@GL Properties LLC

The Neighborhood Draft 5921 W Vliet Street Milwaukee, WI 53208	DRAWN BY Brian Felten (Agent)	DATE 07/30/2019
	Square Footage 360 Sq.Ft.	FLOOR REAR/PATIO/ WALK IN

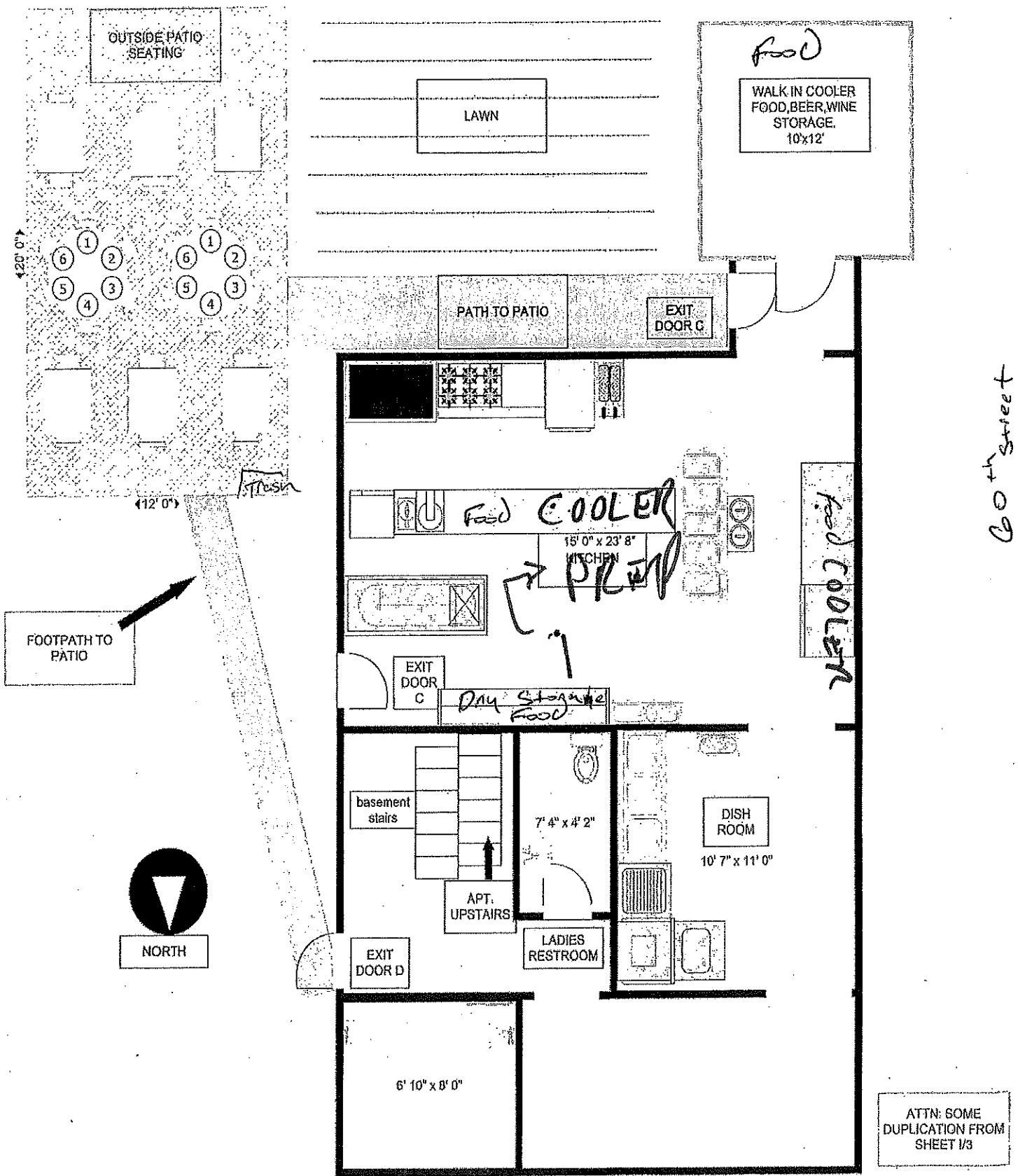

ATTN: SOME
 DUPLICATION FROM
 SHEET 1/3

Basement (Storage)

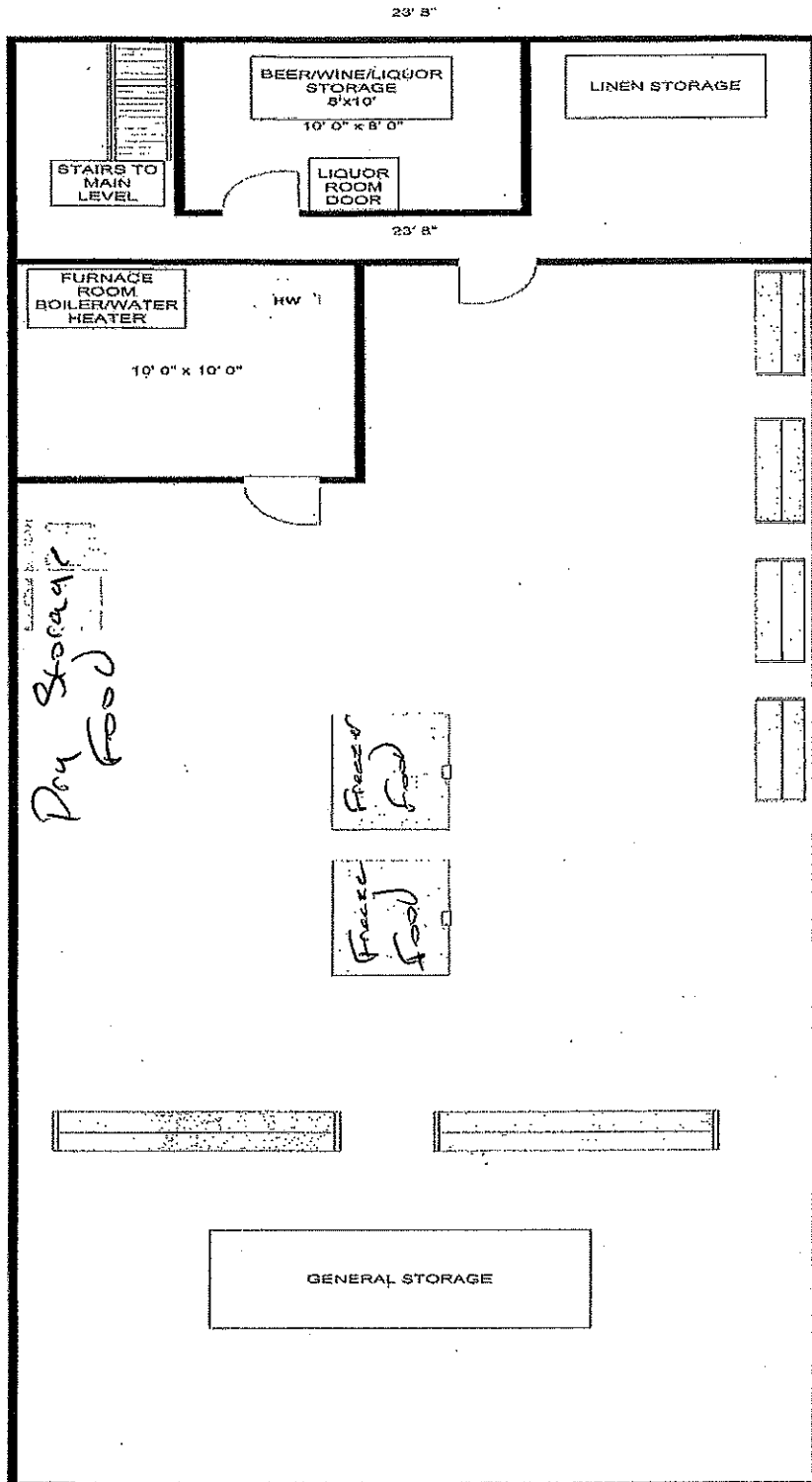

↑
K + G O S

60th Street

↓

The Neighborhood Draft 5921 W Vliet Street Milwaukee, WI 53208	DRAWN BY Brian Felten (Agent)		DATE 07/30/2019
	Square Footage 1625.11 Sq. Ft.	FLOOR BASEMENT/ LIQUOR ROOM/ GENERAL STORAGE	SHEET NO. 3/3

BF@GC Properties LLC

East ←

Vliet Street

→ West