

DCO # 2478

CERTIFIED SURVEY MAP NO.

BEING A REDIVISION OF LOT 6 AND PART OF LOTS 5, AND 7, BLOCK 17, PRINCETON GARDENS, ALSO THAT PART OF VACATED ALLEY ADJACENT AND THAT PART OF VACATED W. THURSTON AVENUE AND N. 75TH STREET ADJACENT, BEING PART OF THE SOUTHWEST 1/4 OF THE SOUTHWEST 1/4 OF SECTION 27, TOWN 8 NORTH, RANGE 21 EAST, CITY OF MILWAUKEE, MILWAUKEE COUNTY, WISCONSIN.

- - DENOTES 1.315" O.D. IRON PIPE WEIGHING 1.13 LBS PER LINEAL FOOT, 18" IN LENGTH - SET.

NORTHWEST CORNER OF THE SOUTHWEST 1/4 OF SECTION 27-8-21
 N-417,064.31
 E-2,532,310.72
 BRASS CAP CONC. MON.

BEARINGS ARE REFERENCED TO THE WISCONSIN STATE PLANE COORDINATE SYSTEM, SOUTH ZONE, THE WEST LINE OF THE SOUTHWEST 1/4 OF SECTION 28-8-21 - ASSUMED BEARING N01°08'52"W. (JUNE 2003 DATUM)

ALL DIMENSIONS ARE COMPUTED AND MEASURED TO THE NEAREST ONE HUNDREDTH OF A FOOT.

TAX KEY NO.: 175-0554-113 ZONING:RM1

GRAPHIC SCALE

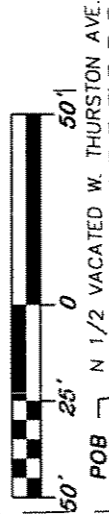

FOUND 1/2" RE-BAR
 TAN. BRG. N00°39'36"W

POB N 1/2 VACATED W. THURSTON AVE.
 N89°20'24"E 130.00'
 45.00'
 PARCEL 1
 10,659 SQ. FT.
 0.24 ACRES
 SEWER EASEMENT SE-2763

PT LOT 7, BLOCK 17, PRINCETON GARDENS
 N61°02'08"W 80.92'
 N64°11'35"W 22.44'
 N74°00'05"W 104.65'
 22.35'
 S31°15'24"W 74.47'
 45.70'
 25.07'

PARCEL 2
 8,687 SQ. FT.
 0.20 ACRES
 N77°30'56"E 45.90'
 N89°20'24"E 15.00'
 N66°46'44"W 49.40'
 S01°08'52"E 109.41'
 E 1/2 VACATED N 75TH ST.

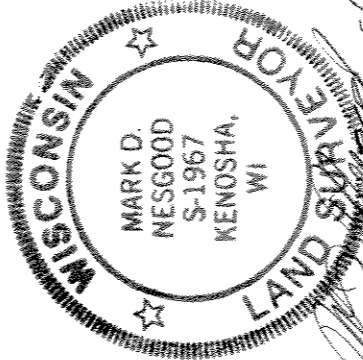
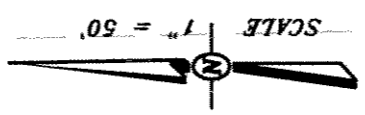

WISCONSIN REGISTERED LAND SURVEYOR
 MARK D. NESGOOD, S-1967

SOUTHWEST CORNER OF THE SOUTHWEST 1/4 OF SECTION 27-8-21
 N-414,407.80
 E-2,532,363.95
 BRASS CAP CONC. MON.

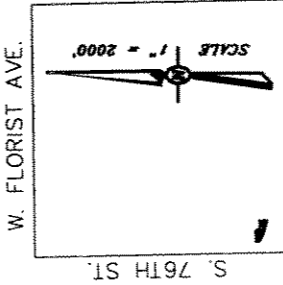

W. SILVER SPRING DR.
 VICINITY MAP
 SW 1/4 SEC. 27-8-21

CURVE TABLE					
CURVE RADIUS	LENGTH	CHORD	BEARING	DELTA	DELTA 1/2
C1	45.00'	70.69'	S45°39'36"E	90°00'00"	45°00'00"
C2	45.00'	45.62'	S29°42'06"E	58°05'00"	29°02'30"
C3	45.00'	25.07'	S74°42'06"E	31°55'00"	15°57'30"

INFRASTRUCTURE SERVICES DIVISION
 Central Drafting & Records Manager
 Martin Legunas
 ENGR. IN CHARGE ENVIRON. ENGR.
 CITY ENGINEER
 APPROVED

CERTIFIED SURVEY MAP NO. _____

BEING A REDIVISION OF LOT 6 AND PART OF LOTS 5 AND 7, BLOCK 17, PRINCETON GARDENS, ALSO THAT PART OF VACATED ALLEY ADJACENT AND THAT PART OF VACATED W. THURSTON AVENUE AND N. 75TH STREET ADJACENT, BEING PART OF THE SOUTHWEST ¼ OF THE SOUTHWEST ¼ OF SECTION 27, TOWN 8 NORTH, RANGE 21 EAST, CITY OF MILWAUKEE, MILWAUKEE COUNTY, WISCONSIN.

SURVEYOR'S CERTIFICATE

STATE OF WISCONSIN) SS
MILWAUKEE COUNTY)

I, Mark D. Nesgood, Registered Land Surveyor, do hereby certify that I have surveyed, divided and mapped a Redivision of Lot 6 and part of Lots 5 and 7, Block 17, Princeton Gardens, also that part of vacated alley adjacent and that part of vacated W. Thurston Avenue and N. 75th Street adjacent, being part of the Southwest ¼ of the Southwest ¼ of Section 27, Town 8 North, Range 21 East, City of Milwaukee, Milwaukee County, Wisconsin, bounded and described as follows:

Commencing at the Southwest corner of the Southwest ¼ of said Section; thence N01°08'52"W along the West line of said ¼ Section 344.49 feet; thence N89°20'24"E 110.39 feet to the point of beginning; thence continue N89°20'24"E 130.00 feet to a point on a curve and the West right-of-way line of W. Thurston Avenue; thence Southeasterly along an arc of a curve and the West right-of-way line of said Avenue, whose center lies to the East, whose radius is 45.00 feet, whose chord bears S45°39'36"E 63.64 feet; a distance of 70.69 feet to a point of tangency; thence N89°20'24"E along the South right-of-way line of said Avenue 15.00 feet; thence N77°30'56"E along the South right-of-way line of said Avenue 45.90 feet; thence S01°08'52"E 109.41 feet; thence N66°46'44"W 49.40 feet; thence N74°00'05"W 104.65 feet; thence N64°11'35"W 22.44 feet; thence N61°02'08"W 80.92 feet; thence N00°39'36"W 45.00 feet to the point of beginning. Containing 0.44 acres of land more or less.

That I have made such survey, land division and map by the direction of the City of Milwaukee, owner of said land.

That such map is a correct representation of the exterior boundaries of the land surveyed and the land division thereof made.

That I have fully complied with the provisions of Chapter 236 of the Wisconsin Statutes and Chapter 119 of the Milwaukee Code of Ordinances in surveying, dividing and mapping the same.

Dated this 16 day of May, 2005.

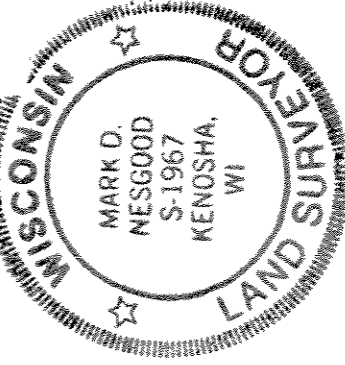

Wisconsin Registered Land Surveyor
Mark D. Nesgood S-1967

CERTIFIED SURVEY MAP NO. _____

BEING A REDIVISION OF LOT 6 AND PART OF LOTS 5 AND 7, BLOCK 17, PRINCETON GARDENS, ALSO THAT PART OF VACATED ALLEY ADJACENT AND THAT PART OF VACATED W. THURSTON AVENUE AND N. 75TH STREET ADJACENT, BEING PART OF THE SOUTHWEST ¼ OF THE SOUTHWEST ¼ OF SECTION 27, TOWN 8 NORTH, RANGE 21 EAST, CITY OF MILWAUKEE, MILWAUKEE COUNTY, WISCONSIN.

CORPORATE OWNER'S CERTIFICATE

The City of Milwaukee, a corporation duly organized and existing under and by virtue of the laws of the State of Wisconsin, as owner, certifies that said corporation caused the land described on this map to be surveyed, divided, mapped and dedicated as represented on this map in accordance with the requirements of Chapter 119 of the Milwaukee Code of Ordinances.

In consideration of the approval of the map by the Common Council and in accordance with Chapter 119 of the Milwaukee Code, the undersigned agrees:

- a. That all utility lines to provide electrical power and telephone services and cable television or communications systems lines or cables to all lots in the Certified Survey Map shall be installed underground in easements provided therefore.

This agreement shall be binding on the undersigned and assigns.

In Witness Where of, the City of Milwaukee has caused these presents to be signed by Tom Barrett its Mayor, and countersigned by Ronald D. Leonhardt, its City Clerk, at Milwaukee, Wisconsin, this _____ day _____.

IN THE PRESENCE OF:

City of Milwaukee

Kimberly Montgomery
Witness

Tom Barrett
Tom Barrett, Mayor

Ronald D. Leonhardt
Ronald D. Leonhardt, City Clerk

Witness

STATE OF WISCONSIN) SS
MILWAUKEE COUNTY)

PERSONALLY came before me this _____ day of _____, 2005, Tom Barrett, Mayor of the above named corporation, to me known to be the person who executed the foregoing instrument, and to me known to be the Mayor of the corporation, and acknowledged that he executed the foregoing instrument as such officer as the deed of the _____ by its authority.

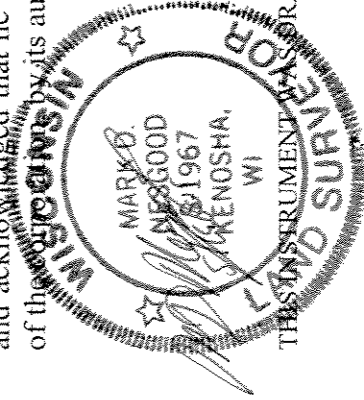

Notary Public, State of Wisconsin
My commission expires _____

CERTIFIED SURVEY MAP NO. _____

BEING A REDIVISION OF LOT 6 AND PART OF LOTS 5 AND 7, BLOCK 17, PRINCETON GARDENS, ALSO THAT PART OF VACATED ALLEY ADJACENT AND THAT PART OF VACATED W. THURSTON AVENUE AND N. 75TH STREET ADJACENT, BEING PART OF THE SOUTHWEST ¼ OF THE SOUTHWEST ¼ OF SECTION 27, TOWN 8 NORTH, RANGE 21 EAST, CITY OF MILWAUKEE, MILWAUKEE COUNTY, WISCONSIN.

STATE OF WISCONSIN) SS
MILWAUKEE COUNTY)

PERSONALLY came before me this _____ day of _____, 2005, Ronald D. Leonhardt, City Clerk of the above named corporation, to me known to be the person who executed the foregoing instrument, and to me known to be the City Clerk of the corporation, and acknowledged that he executed the foregoing instrument as such officer as the deed of the corporation, by its authority.

Notary Public, State of Wisconsin
My commission expires _____

CERTIFICATE OF CITY TREASURER

STATE OF WISCONSIN)
MILWAUKEE COUNTY)

I, WAYNE F. WHITTOW, being the duly elected, qualified and acting City Treasurer of the City of Milwaukee, do hereby certify that in accordance with the records in the Office of the City Treasurer of the City of Milwaukee, there are no unpaid taxes or unpaid special assessments on the land included in this Certified Survey Map.

Dated this 17th day of JUNE, 2005.



Wayne F. Whittow, City Treasurer

COMMON COUNCIL CERTIFICATE OF APPROVAL

I HEREBY certify that this Certified Survey Map was approved under Resolution File No. 050306 adopted by the Common Council of the City of Milwaukee on this 28th day of June, 2005.

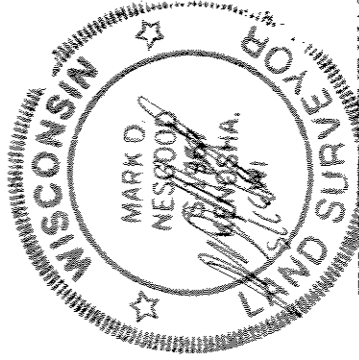
Ronald D. Leonhardt, City Clerk



Tom Barrett, Mayor