



CITY OF MILWAUKEE
OFFICE OF THE CITY CLERK

Thursday, October 06, 2022

COMMITTEE MEETING NOTICE

AD 14

ERNST, Sheryl, Agent
BOB-E-LANES STILL, LLC
6906 W ADLER St
Milwaukee, WI 53214

You are requested to attend a hearing which is to be held in Room 301-B, Third Floor, City Hall or you may attend virtually using the link below. The hearing will be held at:

Tuesday, October 18, 2022 at 02:00 PM

The access code is https://meet.goto.com/763126797. If you wish to call in, please call +1 (646) 749-3122 and use Access Code: 763-126-797. Please see the enclosed best practices document for further instructions.

Regarding: Your Class B Tavern and Public Entertainment Premises License Applications Requesting Jukebox, 5 Amusement Machines and 6 Bowling Lanes To Close at 2AM Sun and at 2:30AM Fri & Sat; as agent for "BOB-E-LANES STILL, LLC" for "BOB-E-LANES STILL" at S 13TH St.

There is a possibility that your application may be denied for one or more of the following reasons: The recommendation of the committee regarding the application shall be based on evidence presented at the hearing. Per MCO 85-2.7-4, probative evidence concerning whether or not a new license should be granted may be presented on the following subjects: whether or not the applicant meets the municipal requirements, the appropriateness of the location and premises where the licensed premises is to be located and whether use of the premises for the purposes or activities permitted by the license would tend to facilitate a public or private nuisance or create undesirable neighborhood problems such as disorderly patrons, unreasonably loud noise, litter, and excessive traffic and parking congestion. Probative evidence relating to these matters may be taken from the plan of operation submitted with the license application, if any, but shall not include the content of any music. Evidence regarding the fitness of the location of the premises to be maintained as the principal place of business, including but not limited to whether there is an overconcentration of businesses of the type for which the license is sought; whether the proposal is consistent with any pertinent neighborhood business or development plans, or the location's proximity to areas where children are typically present. The applicant's record in operating similarly licensed premises; and whether or not the applicant has been charged with or convicted of any felony, misdemeanor, municipal offense or other offense, the circumstances of which substantially relate to the activity to be permitted by the license being applied for or any other factor which reasonably relates to the public health, safety or welfare may also be considered. See attached police report or correspondence.

Notice for applicants with warrants or unpaid fines: Proof of warrant satisfaction or payment of fines must be submitted at the hearing on the above date and time. Failure to comply with this requirement may result in a delay of the granting/denial of your application.

Failure to appear at this meeting may result in the denial of your license. Individual applicants must appear only in person or by an attorney. Corporate or Limited Liability applicants must appear only by the agent designated on the application or by an attorney. Partnership applicants must appear by a partner listed on the application or by an attorney. If you wish to do so and at your own expense, you may be accompanied by an attorney of your choosing to represent you at this hearing.

You will be given an opportunity to speak on behalf of the application and to respond and challenge any charges or reasons given for the denial. No petitions can be accepted by the committee, unless the people who signed the petition are present at the committee hearing and willing to testify. You may present witnesses under oath and you may also confront and cross-examine opposing witnesses under oath. If you have difficulty with the English language, you should bring an interpreter with you, at your expense, so that you can answer questions and participate in your hearing.

You may examine the application file at this office during regular business hours prior to the hearing date. Inquiries regarding this matter may be directed to the person whose signature appears below.

Limited parking for persons attending meetings in City Hall is available at reduced rates (5 hour limit) at the Milwaukee Center on the southwest corner of East Kilbourn and North Water Street. Parking tickets must be validated in the first floor information booth in City Hall.

PLEASE NOTE: Upon reasonable notice, efforts will be made to accommodate the needs of disabled individuals through sign language interpreters or other auxiliary aids. For additional information or to request this service, contact the Council Services Division ADA Coordinator at (414) 286-2998, Fax - (414) 286-3456, TDD - (414) 286-2025.

JIM OWCZARSKI, CITY CLERK

[Signature of Jim Cooney]

BY: \_\_\_\_\_

Jim Cooney
License Division Manager

If you have questions regarding this notice, please contact the License Division at (414) 286-2238.

200 E. Wells Street, Room 105, City Hall, Milwaukee, WI 53202. www.milwaukee.gov/license
Phone: (414) 286-2238 Fax: (414) 286-3057 Email Address: License@milwaukee.gov



Friday, October 07, 2022



# Notice of Public Hearing

Blank Notice

---

ERNST, Sheryl, Agent

BOB-E-LANES STILL at 2932 S 13TH St

Class B Tavern and Public Entertainment Premises License Applications Requesting Jukebox, 5 Amusement Machines and 6 Bowling Lanes To Close at 2AM Sun – Thu and at 2:30AM Fri & Sat

**Tuesday, October 18, 2022 at 2:00 PM**

To whom it may concern:

The above application has been made by the above named applicant(s). This requires approval from the Licenses Committee and the Common Council of the City of Milwaukee. The hearing before the Licenses Committee will take place on 10/18/2022 at 2:00 PM in Room 301-B, Third Floor, City Hall. This is a public hearing. Those wishing to view the proceeding are able to do so via the City Channel – Channel 25 on Spectrum Cable – or on the Internet at <http://city.milwaukee.gov/citychannel>. Those wishing to provide oral testimony via phone or internet are asked to contact the staff assistant, Yadira Melendez at (414) 286-2775 or [stasst5@milwaukee.gov](mailto:stasst5@milwaukee.gov) for necessary information. Please make such requests no later than one business day prior to the start of the meeting. You are not required to attend the hearing, but please see the information below if you would like to provide testimony. Once the Licenses Committee makes its recommendation, this recommendation is forwarded to the full Common Council for approval at its next regularly scheduled hearing.

---

## Important details for those wishing to provide information for the Licenses Committee to consider when making its recommendation:

1. The license application is scheduled to be heard at the above time. Due to other hearings running longer than scheduled, you may have to wait some time to provide your testimony.
2. You must appear in person and testify as to matters that you have personally experienced or seen. (You cannot provide testimony for your neighbor, parent or anyone else; this is considered hearsay and cannot be considered by the committee.)
3. No letters or petitions can be accepted by the committee (unless the person who wrote the letter or the persons who signed the petition are present at the committee hearing and willing to testify).
4. Persons opposed to the license application are given the opportunity to testify first; supporters may testify after the opponents have finished.
5. When you are called to testify, you will be sworn in and asked to give your name, and address. (If your first and/or last names are uncommon please spell them.)
6. You may then provide testimony.
  - a. Include only information relating to the above license application.
  - b. Include only information you have personally witnessed or seen.
  - c. Provide concise and relevant information detailing how this business has affected or may affect the peaceful enjoyment of your neighborhood.
  - d. If by the time you have the opportunity to testify, the information you wish to share has already been provided to the committee, you may state that you agree with the previous testimony. Redundant or repetitive testimony will not assist the committee in making its recommendation.
7. After giving your testimony, the members of the Licenses Committee and the licensee may ask questions regarding the testimony you have given or other factors relating to the license application.
8. Business Competition is not a valid basis for denial or non-renewal of a license.

**Please Note: If you have submitted an objection to the above application your objection cannot be considered by the committee unless you personally testify at the hearing.**

OCCUPANT	MAIL ADDRESS	CITY STATE ZIP
CURRENT OCCUPANT	1231 W DAKOTA ST	MILWAUKEE, WI 53215-3845
CURRENT OCCUPANT	1305 W DAKOTA ST# 1	MILWAUKEE, WI 53215-3847
CURRENT OCCUPANT	1305 W DAKOTA ST# 2	MILWAUKEE, WI 53215-3847
CURRENT OCCUPANT	1305 W DAKOTA ST# 3	MILWAUKEE, WI 53215-3847
CURRENT OCCUPANT	1305 W DAKOTA ST# 4	MILWAUKEE, WI 53215-3847
CURRENT OCCUPANT	2903 S 12TH ST	MILWAUKEE, WI 53215-3819
CURRENT OCCUPANT	2906 S 13TH ST	MILWAUKEE, WI 53215-3824
CURRENT OCCUPANT	2906A S 13TH ST	MILWAUKEE, WI 53215-3824
CURRENT OCCUPANT	2908 S 12TH ST	MILWAUKEE, WI 53215-3820
CURRENT OCCUPANT	2909 S 12TH ST	MILWAUKEE, WI 53215-3819
CURRENT OCCUPANT	2909A S 12TH ST	MILWAUKEE, WI 53215-3819
CURRENT OCCUPANT	2912 S 12TH ST	MILWAUKEE, WI 53215-3820
CURRENT OCCUPANT	2912 S 13TH ST	MILWAUKEE, WI 53215-3824
CURRENT OCCUPANT	2912 S 14TH ST	MILWAUKEE, WI 53215-3842
CURRENT OCCUPANT	2912A S 12TH ST	MILWAUKEE, WI 53215-3820
CURRENT OCCUPANT	2913 S 12TH ST	MILWAUKEE, WI 53215-3819
CURRENT OCCUPANT	2916 S 12TH ST	MILWAUKEE, WI 53215-3820
CURRENT OCCUPANT	2916 S 13TH ST	MILWAUKEE, WI 53215-3824
CURRENT OCCUPANT	2916A S 12TH ST	MILWAUKEE, WI 53215-3820
CURRENT OCCUPANT	2917 S 12TH ST	MILWAUKEE, WI 53215-3819
CURRENT OCCUPANT	2918 S 14TH ST	MILWAUKEE, WI 53215-3842
CURRENT OCCUPANT	2918A S 14TH ST	MILWAUKEE, WI 53215-3842
CURRENT OCCUPANT	2920 S 12TH ST	MILWAUKEE, WI 53215-3820
CURRENT OCCUPANT	2920A S 12TH ST	MILWAUKEE, WI 53215-3820
CURRENT OCCUPANT	2922 S 14TH ST	MILWAUKEE, WI 53215-3842
CURRENT OCCUPANT	2923 S 12TH ST	MILWAUKEE, WI 53215-3819
CURRENT OCCUPANT	2924 S 12TH ST	MILWAUKEE, WI 53215-3820
CURRENT OCCUPANT	2924A S 12TH ST	MILWAUKEE, WI 53215-3820
CURRENT OCCUPANT	2925 S 12TH ST	MILWAUKEE, WI 53215-3819
CURRENT OCCUPANT	2927 S 12TH ST	MILWAUKEE, WI 53215-3819
CURRENT OCCUPANT	2928 S 12TH ST	MILWAUKEE, WI 53215-3820
CURRENT OCCUPANT	2929 S 12TH ST	MILWAUKEE, WI 53215-3819
CURRENT OCCUPANT	2930 S 14TH ST	MILWAUKEE, WI 53215-3842
CURRENT OCCUPANT	2932 S 12TH ST	MILWAUKEE, WI 53215-3820
CURRENT OCCUPANT	2932A S 12TH ST	MILWAUKEE, WI 53215-3820
CURRENT OCCUPANT	2933 S 12TH ST	MILWAUKEE, WI 53215-3819
CURRENT OCCUPANT	2934 S 14TH ST	MILWAUKEE, WI 53215-3842
CURRENT OCCUPANT	2934A S 14TH ST	MILWAUKEE, WI 53215-3842
CURRENT OCCUPANT	2936A S 13TH ST	MILWAUKEE, WI 53215-3872
CURRENT OCCUPANT	2936A S 13TH ST# 1	MILWAUKEE, WI 53215-3872
CURRENT OCCUPANT	2936A S 13TH ST# 2	MILWAUKEE, WI 53215-3872
CURRENT OCCUPANT	2936A S 13TH ST# 3	MILWAUKEE, WI 53215-3872
CURRENT OCCUPANT	2936A S 13TH ST# 4	MILWAUKEE, WI 53215-3872
CURRENT OCCUPANT	2937 S 12TH ST	MILWAUKEE, WI 53215-3819
CURRENT OCCUPANT	2938 S 12TH ST	MILWAUKEE, WI 53215-3820
CURRENT OCCUPANT	2941 S 12TH ST	MILWAUKEE, WI 53215-3819

CURRENT OCCUPANT	2941 S 13TH ST	MILWAUKEE, WI 53215-3823
CURRENT OCCUPANT	2941 S 13TH ST# 2	MILWAUKEE, WI 53215-3823
CURRENT OCCUPANT	2941 S 13TH ST# 3	MILWAUKEE, WI 53215-3823
CURRENT OCCUPANT	2942 S 13TH ST# A	MILWAUKEE, WI 53215-3824
CURRENT OCCUPANT	2942 S 13TH ST# B	MILWAUKEE, WI 53215-3824
CURRENT OCCUPANT	2942 S 13TH ST# C	MILWAUKEE, WI 53215-3824
CURRENT OCCUPANT	2942 S 14TH ST	MILWAUKEE, WI 53215-3842
CURRENT OCCUPANT	2942A S 14TH ST	MILWAUKEE, WI 53215-3842
CURRENT OCCUPANT	2944 S 12TH ST	MILWAUKEE, WI 53215-3820
CURRENT OCCUPANT	2945 S 12TH ST	MILWAUKEE, WI 53215-3819
CURRENT OCCUPANT	2945A S 12TH ST	MILWAUKEE, WI 53215-3819
CURRENT OCCUPANT	2946 S 14TH ST	MILWAUKEE, WI 53215-3842
CURRENT OCCUPANT	2946A S 14TH ST	MILWAUKEE, WI 53215-3842
CURRENT OCCUPANT	2948 S 12TH ST	MILWAUKEE, WI 53215-3820
CURRENT OCCUPANT	2948 S 14TH ST	MILWAUKEE, WI 53215-3842
CURRENT OCCUPANT	2948A S 12TH ST	MILWAUKEE, WI 53215-3820
CURRENT OCCUPANT	2949 S 12TH ST	MILWAUKEE, WI 53215-3819
CURRENT OCCUPANT	2949 S 13TH ST	MILWAUKEE, WI 53215-3823
CURRENT OCCUPANT	2950 S 13TH ST	MILWAUKEE, WI 53215-3824
CURRENT OCCUPANT	2952 S 12TH ST	MILWAUKEE, WI 53215-3820
CURRENT OCCUPANT	2952A S 13TH ST	MILWAUKEE, WI 53215-3824
CURRENT OCCUPANT	2953 S 12TH ST	MILWAUKEE, WI 53215-3819
CURRENT OCCUPANT	2953A S 12TH ST	MILWAUKEE, WI 53215-3819
CURRENT OCCUPANT	2953A S 13TH ST	MILWAUKEE, WI 53215-3823
CURRENT OCCUPANT	2953B S 13TH ST	MILWAUKEE, WI 53215-3823
CURRENT OCCUPANT	2953C S 13TH ST	MILWAUKEE, WI 53215-3823
CURRENT OCCUPANT	2957 S 12TH ST# A	MILWAUKEE, WI 53215-3819
CURRENT OCCUPANT	2957 S 12TH ST# B	MILWAUKEE, WI 53215-3819
CURRENT OCCUPANT	2957 S 12TH ST# C	MILWAUKEE, WI 53215-3819
CURRENT OCCUPANT	2957 S 12TH ST# D	MILWAUKEE, WI 53215-3819
CURRENT OCCUPANT	2960 S 13TH ST	MILWAUKEE, WI 53215-3824
CURRENT OCCUPANT	2960A S 13TH ST	MILWAUKEE, WI 53215-3824
CURRENT OCCUPANT	2961 S 12TH ST	MILWAUKEE, WI 53215-3819
CURRENT OCCUPANT	2963 S 13TH ST	MILWAUKEE, WI 53215-3823
CURRENT OCCUPANT	2964 S 13TH ST	MILWAUKEE, WI 53215-3824
CURRENT OCCUPANT	2965 S 12TH ST	MILWAUKEE, WI 53215-3819
CURRENT OCCUPANT	2965A S 12TH ST	MILWAUKEE, WI 53215-3819
CURRENT OCCUPANT	2966 S 13TH ST	MILWAUKEE, WI 53215-3824
CURRENT OCCUPANT	2969 S 12TH ST	MILWAUKEE, WI 53215-3819
CURRENT OCCUPANT	2969A S 12TH ST	MILWAUKEE, WI 53215-3819
CURRENT OCCUPANT	2970 S 13TH ST	MILWAUKEE, WI 53215-3824
CURRENT OCCUPANT	2970 S 13TH ST# A	MILWAUKEE, WI 53215-3824

Blank Notice

Total Records: 88

Radius 250.0 feet and Center of Circle: 2932 S 13th St

Date: 09/29/2022  
Officer: PO Fabian Garcia

City of Milwaukee Police Department  
90-5-1.5 Crime Prevention Survey  
Tavern Inspection

Name of Premise: Bob-E-Lanes Still  
Address: 2932 S. 13<sup>th</sup> Street  
Phone:

Owner:  
Owner address:  
City State Zip:  
Owner Phone:  
Owner email:

Licensee/Agent: Sheryl L. Ernst  
Home Address: 6906 W Adler Street  
City State Zip: Milwaukee, WI 53214  
Phone: 262-235-3433  
Email: jsr.sheryl@gmail.com

Preferred contact: either email or phone

Location currently open:  YES  NO

Projected open date:

Day's open: S M T W Th F SA ALL

Hours of Operation: Sun: 8a-2a 24 hours Y N  
Mon: 8a-2a  
Tue: 8a-2a  
Wed: 8a-2a  
Thu: 8a-2a  
Fri: 8a-2:30a  
Sat: 8a-2:30a

Premise Type: Tavern/Bar  
Restaurant  
Other: Bowling



Licenses currently held:

- Alcohol:  Yes  No Class: #:   
Tobacco:  Yes  No #:   
Food:  Yes  No #:   
Extended Hours:  Yes  No #:   
Secondhand Dealer:  Yes  No Type: #:   
Other:  Yes  No Type: #:   
Other:  Yes  No Type: #:

**Exterior Survey:**

1. Is the area around the location clean?  Yes  No
2. What surrounds the location? (Check all the apply)
  - a.  Park
  - b.  School
  - c.  Youth Center
  - d.  Church
  - e.  Tavern(s) If so, how many
  - f.  Residential
  - g.  Other businesses
  - h.  Other:
3. Can you see from the outside of the location into the interior  Yes  No
4. Can you see the employees inside of the location from the outside  Yes  No
5. Are exterior windows free of signage  Yes  No
6. Is there a parking lot  Yes  No
7. Is the parking lot clean?  Yes  No N/A
8. Off-Street parking  Yes  No
9. Is the parking lot well lit?  Yes  No N/A
10. Valet Parking  Yes  No
  - a. Will this lot have a guard?  Yes  No N/A
  - b. Will this lot have cameras?  Yes  No N/A
11. Are there areas where a person could conceal themselves  Yes  No
12. Is there exterior lighting?  Yes  No. Does it appears to be adequate  Yes  No
13. Exterior Payphone?  Yes  No
14. Are there No Loitering Signs posted?  Yes  No
15. Are there exterior security cameras  Yes  No How Many:
16. Are the address numbers prominently displayed and easy to see  Yes  No

**Camera Survey:**

17. Does this location have security cameras?  Yes  No
18. Are they in working order?  Yes  No N/A
19. What format are the cameras?
  - a. Color  Yes  No
  - b. Digital  Yes  No
  - c. Recorded  Yes  No
20. How long is footage stored for later viewing:
21. Are there exterior cameras  Yes  No How many:
22. Are there interior cameras  Yes  No How many:

23. Do all employees know how to retrieve recorded digital images/footage?  Yes  No  
 24. Cameras located in parking lot  Yes  No How many

**Interior Survey:**

25. What is the planned capacity 51  
 26. What is the minimum number of employees That will be on premise 1  
 27. Is the storeowner willing to be a standing complainant regarding loitering?  Yes  No  
 a. If yes have them fill out the standing complaint form and give them two of the commercial signs  Yes  No  
 28. Is the interior of the location neat and clean?  Yes  No  
 29. Does an interior camera face the entrance/exit?  Yes  No **NO CAMERA**  
 30. Is there a lockable area that separates employees from customers?  Yes  No  
 31. Are emergency and non-emergency numbers posted near the phone?  Yes  No  
 32. Does the owner know how to contact their police district directly?  Yes  No  
 a. Did you provide a district contact guide to the owner?  Yes  No

**Security No planned Security**

33. How many security personnel are going to be employed:  
 34. How will they be deployed: Interior Exterior  
 35. What days will they be deployed  Mon  Tue  Wed  Thu  Fri  Sat  Sun  
 36. Will the security be managed by business  or contracted   
 37. Will they be armed  Yes  No  
 38. What type of security measures to be used:  
 Wanding/metal detector  
 ID Scanner  
 Dress Code  
 Cover Charge  
 Age restriction  
 Other

**ADDITIONAL COMMENTS/RECOMMENDATIONS:**

This report was written by Police Officer Fabian GARCIA assigned to District 6-Early Power, Squad 6264, Community Partnership Unit/Community Liaison Officers.

On Thursday, September 29, 2022, at 2:00pm, my partner PO Michael WARD and I met with the new owners/licensee of Bob-E-Lanes Still, Sheryl L. Ernst. Also present was the former owner James R Rydzewski (414-531-8133/gym23@sbcglobal.net). James stated that he will still be employed by Sheryl for an additional year. James stated that he has been in business for the past 40 years at the same location.

Sheryl stated that the location currently does not have any cameras but plans on installing 3 to 4 interior cameras. Discussions were had regarding placement of the cameras and the importance of covering the front entry and exit points and cash register area. Sheryl stated that they would only be the ones to access the surveillance footage once installed. The location does not currently have any built in exterior lighting on the property, but does have a street light just outside of the front entrance door that could provide adequate lighting. There are only two smaller glass block windows near the front, which does make it hard to see out and into the location. There is a smaller clear window on the front entrance door. James stated that the 40 years that he has been in business there has rarely ever been an issues at the location. Sheryl was provided a District 6 resource guide and stated that they will have emergency and non-emergency numbers posted near the phones and may plan on posting "No Loitering" signs.





# Concentration Map 2932 S 13TH ST

## Area of Interest (AOI) Information

Area : 21,862,585.97 ft<sup>2</sup>

Sep 21 2022 12:57:36 Central Daylight Time

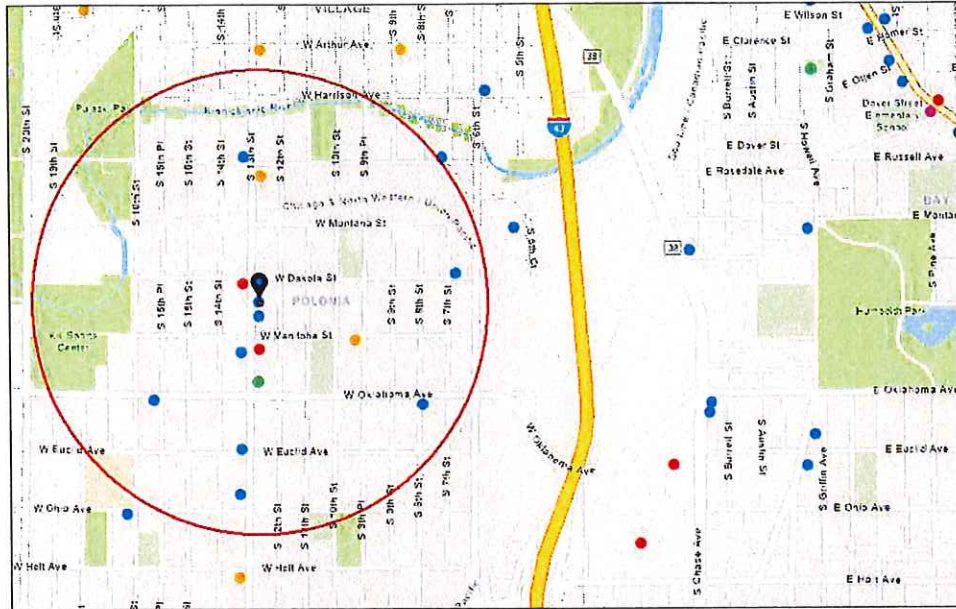

- Alcohol Licenses (active)
- Class A Intoxicating Liquor
- Class A Fermented Malt Beverage
- Class A Liquor and Mall
- Class B Fermented Malt Beverage
- Class B Tavern
- Class C Wine Retailer
- City Limits

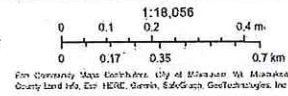

2932 S 13TH ST

### Summary

Name	Count	Area(ft <sup>2</sup> )	Length(mi)
Alcohol Licenses	16		

Alcohol Licenses

#	Legal Entity	Trade Name	Licensee	Address	License Type Name	Total Capacity	Expiration Date	Count
1	JJ STRIPES	JJ STRIPES	JAMES J DORANGRIC HIA, SR, SP	3101 S 15TH PL	Class B Tavern License	55	12/16/2021, 6:00 PM	1
2	C & R MARKET, LLC	C & R MARKET	LISA J YANKE, Agt	3001 S 9TH PL	Class A Fermented Malt Beverage Retailer's License		2/27/2022, 6:00 PM	1
3	Karina's Pizza LLC	Karina's Pizza	Gabriela Zapot Mendoza, Agt	2952 S 13TH ST	Class B Tavern License	28	4/14/2022, 7:00 PM	1
4	El Relajo LLC	El Relajo	JOSE S VIDRIO, Agt	733 W Oklahoma AV	Class B Tavern License	76	4/11/2022, 7:00 PM	1
5	IGG, LLC	Mi Tierra Food Mart	Parminder S Ghotra, Agt	2901 S 13th ST	Class A Malt & Class A Liquor License		6/14/2022, 7:00 PM	1
6	MONTE ENTERPRISE S LLC	MONTERREY MARKET	Robert Montemayor, Agt	3014 S 13TH ST	Class A Malt & Class A Liquor License		6/8/2022, 7:00 PM	1
7	BOB-E-LANES, INC	BOB-E-LANES	JAMES R RYDZEWSKI, Agt	2932 S 13TH ST	Class B Tavern License	51	6/13/2022, 7:00 PM	1
8	Nick's Anvil Inn	Nick's Anvil Inn	Nancy J Tribbey, SP	2900 S 13th ST	Class B Tavern License	25	6/29/2022, 7:00 PM	1
9	URBAL LLC	Urbal Tea Company	Nicholas T Nowaczyk, Agt	3060 S 13TH ST	Class C Wine Retailer's License		7/13/2022, 7:00 PM	1
10	URBAL LLC	Urbal Tea Company	Nicholas T Nowaczyk, Agt	3060 S 13TH ST	Class B Fermented Malt Beverage Retailer's License		7/13/2022, 7:00 PM	1
11	Taqueria La Sierrita LLC	Taqueria La Sierrita	Miguel Leon Santos, Agt	2689 S 13th ST	Class B Tavern License	64	7/22/2022, 7:00 PM	1
12	JOBIN, INC	B & B TAP	PATRICIA L WESTPHAL, Agt	3021 S 13TH ST	Class B Tavern License	49	7/25/2022, 7:00 PM	1
13	El Tucanazo Taqueria Y Mariscos Corp	El Tucanazo Taqueria Y Mariscos	FRANCISCO J GONZALEZ, Agt	3261 S 13TH ST	Class B Tavern License	65	7/26/2022, 7:00 PM	1
14	JAZZ'S CLUB 2020 LLC	Jazz's Club 2020	Yazmin Fernandez Otero, Agt	3173 S 13TH ST	Class B Tavern License		7/27/2022, 7:00 PM	1
15	BROWNS PLACE, LLC	BROWNS PLACE	JO ANN BROWN, Agt	2874 S 7TH ST	Class B Tavern License	25	10/8/2022, 7:00 PM	1
16	Singh's Corner Grocery Inc	South Star Food	BALJINDER SINGH, Agt	2714 S 13th ST	Class A Fermented Malt Beverage Retailer's License		10/31/2022, 7:00 PM	1



# BUSINESS LICENSE PLAN OF OPERATION

ccl-busplan 5/12/2020

Office of the City Clerk License Division  
200 E. Wells St. Room 105, Milwaukee, WI 53202  
(414) 286-2238 www.milwaukee.gov/license e-mail address: license@milwaukee.gov

## 1. Type of Business

Applying for:  Extended Hours (12AM to 5AM) - If a food establishment, check all that apply:  Delivery  Drive Thru  Dining Room  
 Self Service Laundry  Massage Establishment  Filling Station  
 Other (supplemental application for specific license also required)

Provide a detailed description of the type of business you plan on operating: Bowling Alley

Do you have any experience operating this type of business?  No  Yes If yes, explain:

## 2. Business Operations

- a. Proposed Opening Date: 11/15/2022
- b. Is this premise under construction?  No  Yes If yes, list estimated completion date: \_\_\_\_\_
- c. Is this a franchise?  No  Yes
- d. Is this premises currently licensed?  No  Yes If yes, list type of license: Class B Tavern
- e. Is the current licensee operating?  No  Yes If no, list date closed: \_\_\_\_\_
- f. Do you have future plans for other businesses, licenses or permits at this location?  No  Yes  
If yes, explain: possible food license to serve pizza and other air fryer foods
- g. Have you previously held an Extended Hours License in Milwaukee?  No  Yes  
If yes, list address(es): \_\_\_\_\_
- h. Are other businesses operating in the same building?  No  Yes If yes, describe: \_\_\_\_\_

## 3. Litter & Noise

- a. How are grounds kept clean?  Sweep  Pressure Wash  Pick Up Litter  Other: \_\_\_\_\_
- b. How often will grounds be cleaned?  Daily  Weekly  As Needed  Monthly  Other: \_\_\_\_\_
- c. Grounds cleaned by:  Licensee  Building Owner  Employees  Hired Maintenance  Other: \_\_\_\_\_
- d. How are noise issues prevented and/or addressed?  Security  Manager approaches customer(s)  Call Police  
 Signs Posted  Other: \_\_\_\_\_
- e. Will a sound amplification system be used?  No  Yes If yes, describe: \_\_\_\_\_

## 4. Smoking & Sanitation

- a. Are there designated outdoor smoking areas?  No  Yes If yes, describe: \_\_\_\_\_
- b. Number of Garbage Cans: Inside: 8 Locations: 1 in each bathrm, 4 behind bar, 1 by sink, 1 doorway  
Outside: 1 Locations: Alley
- c. Is a crowd control barrier used?  No  Yes If yes, describe: \_\_\_\_\_
- d. How many restrooms are on the premises? 2
- e. Name of solid waste contractor:  Advanced Disposal  Waste Management  Other: \_\_\_\_\_

## 5. Security

- a. Are there onsite parking spaces?  No  Yes If yes, how many? \_\_\_\_\_ and describe the parking security plan: \_\_\_\_\_
- b. Is there a loading zone?  No  Yes If yes, describe the loading area security plan: \_\_\_\_\_
- c. Will you have security personnel on premise?  No  Yes If yes, how many? \_\_\_\_\_ and answer the following:  
 What are their responsibilities? \_\_\_\_\_  
 Is security equipment used?  No  Yes If yes, describe \_\_\_\_\_  
 List their licensing, certification, or training credentials \_\_\_\_\_
- d. Will there be security cameras?  No  Yes If yes, how many? \_\_\_\_\_ and list locations: \_\_\_\_\_
- e. Will searches/identification checks be done upon entry?  No  Yes If yes, describe bartender/mgr ck ID's b4 serve

## 6. Percentage of Sales (must total 100%)

Alcohol <u>60</u> %	Food _____ %	Secondhand Merchandise _____ %	Precious Metals & Gems _____ %
Entertainment <u>40</u> %	Cigarettes _____ %	Personal Services (such as tattoo, body piercing, salon, tailor, tanning, etc.) _____ %	Other _____ % Describe: _____
Pawnbroker Activity _____ %	Salvaged Materials _____ % (such as scrap metal)		

## 7. Businesses/Licenses on the Premises (check all that apply):

### Type 1

- Full Service Restaurant     Cafe/Coffee Shop     Deli or Fast Food Restaurant     Private/Fraternal/Veterans Club
- Night Club     Tavern     Cocktail Lounge     Teen Club
- Banquet Hall     Sports Facility     Bowling Alley
- Hotel/Motel : Number of Floors: \_\_\_\_\_     Rooming House: Number of Floors: \_\_\_\_\_  
 Number of Rooms: \_\_\_\_\_    Number of Rooms: \_\_\_\_\_

### Type 2

- Liquor Store     Corner Store     Supermarket     Convenience Store
- Gas Station     Amusement/Phonograph Distributor     Recycling, Salvage or Towing
- Used Car Dealer     Personal Service Establishment  
(such as tattoo business, hair salon, tailor, etc.)     Recording Studio

What other licenses/permits will you hold at this location? (check all that apply)

- Occupancy Permit     Cigarette & Tobacco     Gas Station     Extended Hours     Class "B" Tavern     Weights & Measures
- Secondhand Dealer     Precious Metal & Gem     Other: \_\_\_\_\_

## 8. Legal Capacity (only if a Type 1 premises in #7 above)

Capacity 51 (Call the Milwaukee Development Center at 414-286-8211 if you have questions.)



## 9. Premises Description

- a. Identify all area(s) of the premises that will be used in operating this business (include areas used only for storage):  
 1<sup>st</sup> Floor  2<sup>nd</sup> Floor  Basement Storage  Patio  Beer Garden  Sidewalk Café  Deck  Rooftop  
 Other: Describe: \_\_\_\_\_
- b. Describe Location:  Major Thoroughfare  Secondary Street  Other: \_\_\_\_\_
- c. Nearest Major Cross Street: South 13th St
- d. Describe Building:  Free Standing Building  Strip Mall  Other: \_\_\_\_\_
- e. Describe Premises Structure:  Single Story  Multi-Story - # of Stories 2  Other: \_\_\_\_\_
- f. Describe Surrounding Area:  Commercial  Residential  Industrial  Other: \_\_\_\_\_
- g. Building Owner Name: Sheryl Ernst Phone Number: 262-235-3433  
 Building Owner Address: 6906 W Adler St, Milwaukee WI 53214

## 10. Hours of Operation & Customers

Will customers be entering the premises?  No  Yes

Day of the Week	Proposed Hours of Operation:		Estimated Number of Customers expected each day	Potential Age Range of Customers	Class B Tavern Applicant Only: Age Restriction (If none, write 'None')
	Open Time (include a.m. or p.m.)	Close Time (include a.m. or p.m.)			
Sunday	8:00am	2:00am	45	5-90	none
Monday	8:00am	2:00am	45	5-90	none
Tuesday	8:00am	2:00am	45	5-90	none
Wednesday	8:00am	2:00am	45	5-90	none
Thursday	8:00am	2:00am	45	5-90	none
Friday	8:00am	2:30am	45	5-90	none
Saturday	8:00am	12:30am	45	5-90	none

An Extended Hours Establishment License is required for any convenience store, filling station, personal service establishment (such as tattoo, body piercing, salon, tailor, tanning, etc.), recording studio or restaurant which is open between the hours of 12:00 a.m. and 5:00 a.m.

Alcohol Establishments Class A: 8:00 am to 9:00 pm Sunday thru Saturday  
 Permitted Hours of Operation: Class B: 6:00 am to 2:00 am Sunday thru Thursday, 6:00 am to 2:30 am Friday & Saturday

Entertainment Outdoor Closing Hours: 10:00pm Sunday-Thursday; 12:00am Friday & Saturday; unless a different time, either earlier or later, is established by the Common Council in its approval of the licensee's plan of operation.

## 11. Signature(s)

Sheryl L. Ernst  
 Signature of Sole Proprietor, Partner, or 20% or more Shareholder  
 (If there are no 20% or more shareholders,  
 Corporate Officer-print name/title and sign)

[Signature]  
 Signature of additional partner or 20% or more shareholder

See Application Information for a complete list of all required application forms.



## ALCOHOL BEVERAGE & PUBLIC ENTERTAINMENT PREMISES SUPPLEMENTAL APPLICATION

Office of the City Clerk License Division  
200 E. Wells St. Room 105, Milwaukee, WI 53202  
(414) 286-2238 e-mail address: license@milwaukee.gov [www.milwaukee.gov/license](http://www.milwaukee.gov/license)

Legal Entity Name: <b>Bob-E-Lanes Still, LLC</b>
Premise Address: <b>2932 S 13th St, Milwaukee WI 53215</b>
<b>Proximity of Premises to Church, School, Daycare Center or Hospital</b>
Is the building within 300 feet of any church, school, daycare center or hospital? <input checked="" type="checkbox"/> No <input type="checkbox"/> Yes
<b>"Service Bar Only" Designation</b>
If applying for Class B or C license, are you applying for "Service Bar Only"? <input checked="" type="checkbox"/> No <input type="checkbox"/> Yes Service Bar Only means customers cannot sit at the bar. Alcohol is served to employees who serve patrons seated at tables. No stools, chairs or other articles of furniture shall be placed at the service bar for patrons to sit upon.
<b>Business Information</b>
a) Are you taking out this application for anyone that may not be eligible for a license? <input checked="" type="checkbox"/> No <input type="checkbox"/> Yes If yes, list their name and address: _____
b) Will the agent, a partner or the individual licensee be conducting the day-to-day operations of the business? <input type="checkbox"/> No <input checked="" type="checkbox"/> Yes If no, list the name and address of the person(s) who will: _____ _____
Class B Applicants: If the agent, a partner or the individual licensee will not be conducting the day-to-day operations of the business, the person(s) listed above must obtain a Class B Managers license.
c) Does anyone else have money invested or any other interest in this business? <input checked="" type="checkbox"/> No <input type="checkbox"/> Yes If yes, explain: _____
d) Have you made an agreement with anyone to repay any loan or any other payments based upon income from the business? <input checked="" type="checkbox"/> No <input type="checkbox"/> Yes If yes, list name and address: _____
<b>Property Information (New &amp; Transfer Applicants Only)</b>
a) Do you own or lease the building? <input checked="" type="checkbox"/> Own <input type="checkbox"/> Lease
b) Who owns the fixtures (for example, coolers, etc.)? <u>Bob-E-Lanes Still, LLC</u>
c) Are you purchasing the stock and/or fixtures? <input type="checkbox"/> No <input checked="" type="checkbox"/> Yes If yes, amount paid \$ <u>ZERO</u>
d) Total amount paid for business \$ <u>180000</u>
e) Total amount paid for goodwill of the business \$ <u>15000</u>
Goodwill comprises the reputation and customer relationships of an existing business. If the price you pay for the business exceeds the fair market value of all of the rest of the assets of the business, the excess may be considered goodwill.
f) Have you made arrangements with the seller for payment of personal property taxes? <input type="checkbox"/> No <input checked="" type="checkbox"/> Yes
<b>Lease Information (New &amp; Transfer Applicants who are leasing the premises only)</b>
a) Date lease begins _____ Ends _____
b) Monthly rental \$ _____
c) Do you have an option to renew the lease? <input type="checkbox"/> No <input type="checkbox"/> Yes
d) Does your lease allow for assignment to another party without the consent of the owner? <input type="checkbox"/> No <input type="checkbox"/> Yes
e) For what length of time have you been guaranteed occupancy (number of years)? _____

### Lease Information (Continued)

- f) In addition to paying the monthly rental, will you have to pay anything additional to the owner of the building to guarantee performance of the lease?  No  Yes If yes, explain \_\_\_\_\_
- g) Does the present owner or occupancy object to the granting of your license?  No  Yes  
If yes, explain \_\_\_\_\_

### Change of Agent Applicants Only

Have there been any changes to the floor plan since the last application was submitted?  No  Yes

If no, a new floor plan is not required. If yes, submit a new floor plan and explain the change(s):

NO FLOOR PLAN ON FILE SO FLOOR PLAN INCLUDED EVEN THOUGH NO CHANGES HAVE BEEN MADE IN 40 YEARS.

### Signature

*Sheryl L. Ernst*

Signature of Sole Proprietor, Partner or 20% or More Shareholder  
(If no 20% or more Shareholder, Corporate Officer - print name/title and sign)

Note: All information contained in this application is subject to approval by the Common Council.  
Deviating from approved plan of operation will subject licensee to citations, and/or suspension or non-renewal of the license.  
Contact the License Division for information on how to request changes.

### New and transfer of premises applicants must submit the following:

- Detailed floor plan
- If a restaurant, copy of the menu



## PUBLIC ENTERTAINMENT PREMISES LICENSE SUPPLEMENTAL APPLICATION

Office of the City Clerk License Division  
200 E. Wells St. Room 105, Milwaukee, WI 53202  
(414) 286-2238 [www.milwaukee.gov/license](http://www.milwaukee.gov/license) e-mail address: [license@milwaukee.gov](mailto:license@milwaukee.gov)

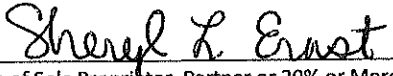
<b>PREMISES ADDRESS: 2932 S 13th St, Milwaukee WI 53215</b>			
<b>TYPES OF ENTERTAINMENT (CHECK ALL THAT APPLY)</b>			
<input type="checkbox"/> Instrumental Musicians	<input type="checkbox"/> Battle of the Bands	<input type="checkbox"/> Dancing by Performers	<input checked="" type="checkbox"/> Amusement Machines How many? <u>up to 5</u>
<input type="checkbox"/> Bands	<input type="checkbox"/> Comedy Acts	<input type="checkbox"/> Adult Entertainment/ Strippers/Erotic Dance	<input type="checkbox"/> Concerts Approx. # per year? _____
<input checked="" type="checkbox"/> Bowling Alley How many? <u>6 Lanes</u>	<input type="checkbox"/> Disc Jockey	<input type="checkbox"/> Wrestling	<input type="checkbox"/> Theatrical Performances Approx. # per year? _____
<input type="checkbox"/> Pool Tables How many? _____	<input type="checkbox"/> Magic Shows	<input type="checkbox"/> Patron Contests	<input checked="" type="checkbox"/> Jukebox
<input type="checkbox"/> Motion Pictures (movies by admission) - How many? _____	<input type="checkbox"/> Poetry Readings	<input type="checkbox"/> Patrons Dancing	<input type="checkbox"/> Karaoke
<input type="checkbox"/> Other: _____			
<i>Entertainment Outdoor Closing Hours: 10:00pm Sunday-Thursday; 12:00am Friday &amp; Saturday; unless a different time, either earlier or later, is established by the Common Council in its approval of the licensee's plan of operation.</i>			
<b>PROMOTERS/SOUND AMPLIFICATION</b>			
Will promoters ever be used for any of the entertainment? <input checked="" type="checkbox"/> No <input type="checkbox"/> Yes If Yes, Describe:			
At any time will sound amplification be used? <input checked="" type="checkbox"/> No <input type="checkbox"/> Yes If Yes, Describe:			
<b>LEGAL CAPACITY OF PREMISES</b>			
51 (Call the Development Center at 414-286-8211 with questions.) Legal capacity determines the fee for your Public Entertainment Premises License. If you would like to request the license be approved with a lower capacity than that listed above, indicate the lower capacity here: _____. If approved, this lower capacity will print on your license and override the capacity listed on your Occupancy Permit.			
<b>ACKNOWLEDGEMENT/SIGNATURE</b>			
I understand that after the license has been issued, a change to the plan of operation will require a written request to change and approval from the Common Council. I agree to inform the City Clerk within 10 days of any substantial changes in the information supplied in this application. I understand that I shall not willfully refuse to provide the services offered under this license, or add charges or require deposits not required of the general public because of race, color, sex, religion, national origin or ancestry, age, handicap, lawful source of income, marital status, sexual orientation, gender identity or expression, familial status or the fact that a person is now or has been a member of the military service, whether dressed in uniform or not; and shall not seek such information as a condition of employment, or penalize any employee or discriminate in the selection of personnel for training or promotion on the basis of such information.			
I have knowledge of the City Ordinances currently regulating public entertainment, and understand that the license may be subject to suspension, non-renewal or revocation, if I violate any rule, law or regulation of the city of Milwaukee and State of Wisconsin.			
 _____ Signature of Sole Proprietor, Partner or 20% or More Shareholder (If no 20% or more Shareholder, Corporate Officer - print name/title and sign)			

**Office Use Only:**

Initials: \_\_\_\_\_ Filed: \_\_\_\_\_ App: \_\_\_\_\_

Only PEP?  No  Yes If Yes,  Queue to MPD and  Email Mgrs/Team Lead (must be heard w/in 60 days)

**FLOOR PLAN FOR BOWLING ALLEY**

**Bob-E-Lanes Still, LLC**

**2932 South 13th Street, Milwaukee WI 53215**

**First Floor Bowling Alley, Bar and Sittee Area**

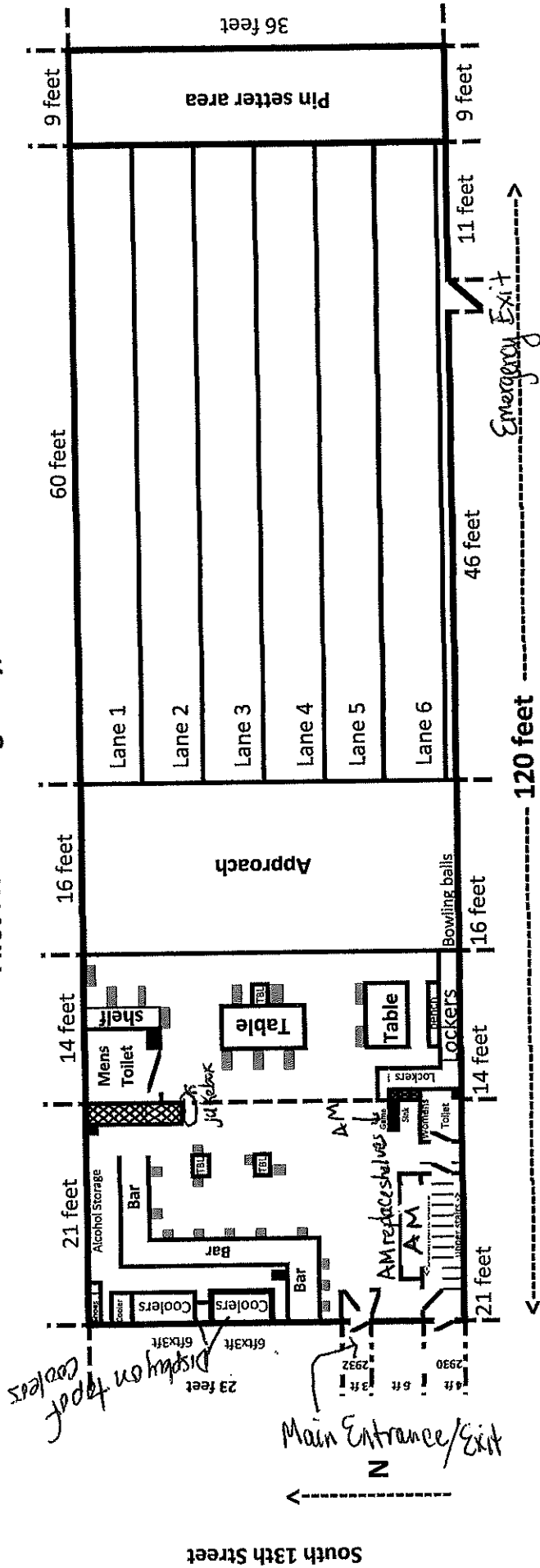

Sheryl L. Ernst, Agent for Bob-E-Lanes Still, LLC

**BOB-E-LANES STILL**

Date: September 20, 2022

**Total Square Footage: 4320**

Trash cans represented by blackened spots

Display of Alcohol - On top of two 6 ft x 3ft coolers as well as under bar 8 feet

Storage of Alcohol on floor behind bar 12ft x 1 ft

Chairs are designated by blue spots

*AM - Amusement Machines will go where shelves are currently*



**FLOOR PLAN FOR BOWLING ALLEY**  
**Bob-E-Lanes Still, LLC**  
**2932 South 13th Street, Milwaukee WI 53215**

**Basement Storage**

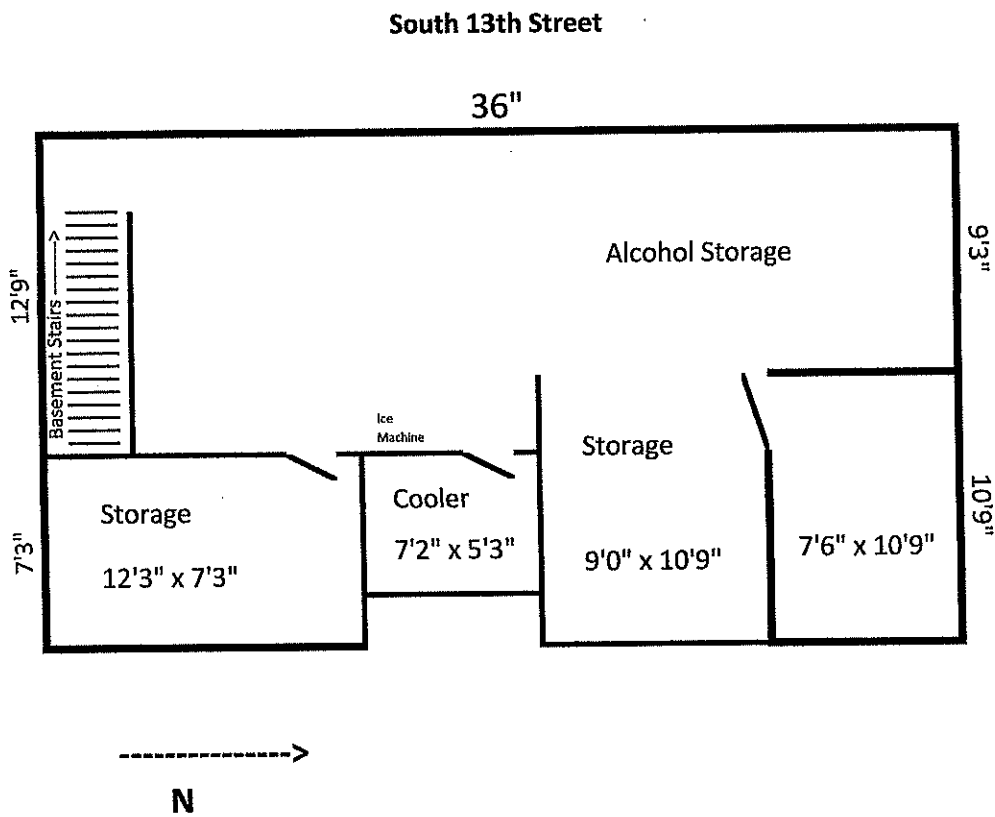

Sheryl L. Ernst, Agent for Bob-E-Lanes Still, LLC  
BOB-E-LANES STILL  
Date: September 20, 2022

Total Square Footage: 720