



CITY OF MILWAUKEE
OFFICE OF THE CITY CLERK

Wednesday, July 12, 2017

COMMITTEE MEETING NOTICE

AD 06

BALISTRERI, Dawn M, Agent
Urban Beets Inc
1407 N MARTIN L KING JR DR
Milwaukee, WI 53212

You are requested to attend a hearing which is to be held in Room 301-B, Third Floor, City Hall on:

Tuesday, July 18, 2017 at 11:00 AM

Regarding: Your Class B Beer and Class C Wine License Applications and Food Dealer Transfer Application with Change of Hours From Sun Closed, Mon - Fri 7 AM - 6:30 PM, Sat 9 AM - 4 PM on - Sun 7 AM - 12 AM as agent for "Urban Beets Inc" for "Urban Beets Cafe & Juicery" at 1401 N Martin King Jr DR.

There is a possibility that your application may be denied for one or more of the following reasons: The recommendation of the committee regarding the application shall be based on evidence presented at the hearing. Per MCO 85-2.7-4, probative evidence concerning whether or not a new license should be granted may be presented on the following subjects: whether or not the applicant meets the municipal requirements, the appropriateness of the location and premises where the licensed premises is to be located and whether use of the premises for the purposes or activities permitted by the license would tend to facilitate a public or private nuisance or create undesirable neighborhood problems such as disorderly patrons, unreasonably loud noise, litter, and excessive traffic and parking congestion. Probative evidence relating to these matters may be taken from the plan of operation submitted with the license application, if any, but shall not include the content of any music. Evidence regarding the fitness of the location of the premises to be maintained as the principal place of business, including but not limited to whether there is an overconcentration of businesses of the type for which the license is sought; whether the proposal is consistent with any pertinent neighborhood business or development plans, or the location's proximity to areas where children are typically present. The applicant's record in operating similarly licensed premises; and whether or not the applicant has been charged with or convicted of any felony, misdemeanor, municipal offense or other offense, the circumstances of which substantially relate to the activity to be permitted by the license being applied for or any other factor which reasonably relates to the public health, safety or welfare may also be considered. See attached police report or correspondence.

Notice for applicants with warrants or unpaid fines:

Proof of warrant satisfaction or payment of fines must be submitted at the hearing on the above date and time. Failure to comply with this requirement may result in a delay of the granting/denial of your application.

Failure to appear at this meeting may result in the denial of your license. Individual applicants must appear only in person or by an attorney. Corporate or Limited Liability applicants must appear only by the agent designated on the application or by an attorney. Partnership applicants must appear by a partner listed on the application or by an attorney. If you wish to do so and at your own expense, you may be accompanied by an attorney of your choosing to represent you at this hearing.

You will be given an opportunity to speak on behalf of the application and to respond and challenge any charges or reasons given for the denial. No petitions can be accepted by the committee, unless the people who signed the petition are present at the committee hearing and willing to testify. You may present witnesses under oath and you may also confront and cross-examine opposing witnesses under oath. If you have difficulty with the English language, you should bring an interpreter with you, at your expense, so that you can answer questions and participate in your hearing.

You may examine the application file at this office during regular business hours prior to the hearing date. Inquiries regarding this matter may be directed to the person whose signature appears below.

Limited parking for persons attending meetings in City Hall is available at reduced rates (5 hour limit) at the Milwaukee Center on the southwest corner of East Kilbourn and North Water Street. Parking tickets must be validated in the first floor information booth in City Hall.

PLEASE NOTE: Upon reasonable notice, efforts will be made to accommodate the needs of disabled individuals through sign language interpreters or other auxiliary aids. For additional information or to request this service, contact the Council Services Division ADA Coordinator at (414) 286-2998, Fax - (414) 286-3456, TDD - (414) 286-2025.

JIM OWCZARSKI, CITY CLERK

BY:

Jessica Celella
License Division Manager

If you have questions regarding this notice, please contact the License Division at (414) 286-2238.

200 E. Wells Street, Room 105, City Hall, Milwaukee, WI 53202. www.milwaukee.gov/license
Phone: (414) 286-2238 Fax: (414) 286-3057 Email Address: License@milwaukee.gov



CITY OF MILWAUKEE
OFFICE OF THE CITY CLERK

Wednesday, July 12, 2017

COMMITTEE MEETING NOTICE

AD 06

BALISTRERI, Dawn M, Agent
Urban Beets Inc
413 N 2nd Street, #600
Milwaukee, WI 53203

You are requested to attend a hearing which is to be held in Room 301-B, Third Floor, City Hall on:

Tuesday, July 18, 2017 at 11:00 AM

Regarding: Your Class B Beer and Class C Wine License Applications and Food Dealer Transfer Application with Change of Hours From Sun Closed, Mon - Fri 7 AM - 6:30 PM, Sat 9 AM - 4 PM To Mon - Sun 7 AM - 12 AM as agent for "Urban Beets Inc" for "Urban Beets Cafe & Juicery" at 1401 N Martin L King Jr DR.

There is a possibility that your application may be denied for one or more of the following reasons: The recommendation of the committee regarding the application shall be based on evidence presented at the hearing. Per MCO 85-2.7-4, probative evidence concerning whether or not a new license should be granted may be presented on the following subjects: whether or not the applicant meets the municipal requirements, the appropriateness of the location and premises where the licensed premises is to be located and whether use of the premises for the purposes or activities permitted by the license would tend to facilitate a public or private nuisance or create undesirable neighborhood problems such as disorderly patrons, unreasonably loud noise, litter, and excessive traffic and parking congestion. Probative evidence relating to these matters may be taken from the plan of operation submitted with the license application, if any, but shall not include the content of any music. Evidence regarding the fitness of the location of the premises to be maintained as the principal place of business, including but not limited to whether there is an overconcentration of businesses of the type for which the license is sought; whether the proposal is consistent with any pertinent neighborhood business or development plans, or the location's proximity to areas where children are typically present. The applicant's record in operating similarly licensed premises, and whether or not the applicant has been charged with or convicted of any felony, misdemeanor, municipal offense or other offense, the circumstances of which substantially relate to the activity to be permitted by the license being applied for or any other factor which reasonably relates to the public health, safety or welfare may also be considered. See attached police report or correspondence.

Notice for applicants with warrants or unpaid fines:

Proof of warrant satisfaction or payment of fines must be submitted at the hearing on the above date and time. Failure to comply with this requirement may result in a delay of the granting/denial of your application.

Failure to appear at this meeting may result in the denial of your license. Individual applicants must appear only in person or by an attorney. Corporate or Limited Liability applicants must appear only by the agent designated on the application or by an attorney. Partnership applicants must appear by a partner listed on the application or by an attorney. If you wish to do so and at your own expense, you may be accompanied by an attorney of your choosing to represent you at this hearing.

You will be given an opportunity to speak on behalf of the application and to respond and challenge any charges or reasons given for the denial. No petitions can be accepted by the committee, unless the people who signed the petition are present at the committee hearing and willing to testify. You may present witnesses under oath and you may also confront and cross-examine opposing witnesses under oath. If you have difficulty with the English language, you should bring an interpreter with you, at your expense, so that you can answer questions and participate in your hearing.

You may examine the application file at this office during regular business hours prior to the hearing date. Inquiries regarding this matter may be directed to the person whose signature appears below.

Limited parking for persons attending meetings in City Hall is available at reduced rates (5 hour limit) at the Milwaukee Center on the southwest corner of East Kilbourn and North Water Street. Parking tickets must be validated in the first floor information booth in City Hall.

PLEASE NOTE: Upon reasonable notice, efforts will be made to accommodate the needs of disabled individuals through sign language interpreters or other auxiliary aids. For additional information or to request this service, contact the Council Services Division ADA Coordinator at (414) 286-2998, Fax - (414) 286-3456, TDD - (414) 286-2025.

JIM OW CZARSKI, CITY CLERK

BY:

Jessica Celella
License Division Manager

If you have questions regarding this notice, please contact the License Division at (414) 286-2238.

200 E. Wells Street, Room 105, City Hall, Milwaukee, WI 53202. www.milwaukee.gov/license
Phone: (414) 286-2238 Fax: (414) 286-3057 Email Address: License@milwaukee.gov

Date:07/06/2017
Officer: Thomas Kline

City of Milwaukee Police Department
90-5-1.5 Crime Prevention Survey
Tavern Inspection

Name of Premise: Urban Beets Cafe
Address: 1401 N Martin Luther King Dr
Phone: 414 336-5096

Owner: Balistreri, Dawn M
Owner address: 413 N. 2nd Street
City State Zip: Milwaukee, WI 53203
Owner Phone: 414 336-5096
Owner email:

Licensee/Agent:
Home Address:
City State Zip:
Phone:
Email:

Preferred contact: Owner

Location currently open: YES NO

Projected open date:

Day's open: S M T W Th F SA ALL

Hours of Operation: Sun: 9am-9pm 24 hours Y N
Mon: Closed
Tue: 7am-9pm
Wed: 7am-9pm
Thu: 7am-9pm
Fri: 7am-9pm
Sat: 9am-9pm

Premise Type: Tavern/Bar
 Restaurant
 Other:

Licenses currently held:

- Alcohol: Yes No Class: #:
- Tobacco: Yes No #:
- Food: Yes No #:
- Other: Yes No Type: #:
- Other: Yes No Type: #:

Exterior Survey:

1. Is the area around the location clean? Yes No
2. What surrounds the location? (Check all the apply)
 - a. Park
 - b. School
 - c. Youth Center
 - d. Church
 - e. Tavern(s) If so, how many
 - f. Residential
 - g. Other businesses
 - h. Other:
3. Can you see from the outside of the location into the interior Yes No
4. Can you see the employees inside of the location from the outside Yes No
5. Are exterior windows free of signage Yes No
6. Street parking Yes No
7. Is there a parking lot Yes No
8. Is the parking lot clean? Yes No
9. Is the parking lot well lit? Yes No
10. Valet Parking Yes No
 - a. Will this lot have a guard? Yes No
 - b. Will this lot have cameras? Yes No
11. Are there areas where a person could conceal themselves Yes No
12. Is there exterior lighting? Yes No. Does it appears to be adequate Yes No
13. Exterior Payphone? Yes No
14. Are there No Loitering Signs posted? Yes No
15. Are there exterior security cameras Yes No How Many: 2
16. Are the address numbers prominently displayed and easy to see Yes No

Camera Survey:

17. Does this location have security cameras? Yes No
18. Are they in working order? Yes No
19. What format are the cameras?
 - a. Color Yes No
 - b. Digital Yes No
 - c. VCR Yes No
 - d. Recorded Yes No
20. How long is footage stored for later viewing: 30 days
21. Are there exterior cameras Yes No How many: 2
22. Are there interior cameras Yes No How many: 3

23. Do all employees know how to retrieve recorded digital images/footage? Yes No
 24. Cameras located in parking lot Yes No How many 3

Interior Survey:

25. What is the planned/posted capacity 55
 26. What is the minimum number of employees that will be on premise 4
 27. Is the storeowner willing to be a standing complainant regarding loitering? Yes No
 a. If yes have them fill out the standing complaint form and give them two of the commercial signs Yes No
 28. Is the interior of the location neat and clean? Yes No
 29. Does an interior camera face the entrance/exit? Yes No
 30. Are emergency and non-emergency numbers posted near the phone? Yes No
 31. Does the owner know how to contact their police district directly? Yes No
 a. Did you provide a district contact guide to the owner? Yes No

Security

32. How many security personnel are going to be employed: 0
 33. How will they be deployed: Interior Exterior
 34. What days will they be deployed Mon Tue Wed Thu Fri Sat Sun
 35. Will the security be managed by business or contracted
 36. Will they be armed Yes No
 37. What type of security measures will be used:
 Wanding/metal detector
 ID Scanner
 Dress Code
 Cover Charge
 Age restriction
 Other
 38. When at capacity, how will the overflow crowd be managed? Line outside
 39. Will a guard monitor the overflow crowd at all times? Yes No

ADDITIONAL COMMENTS/RECOMMENDATIONS:

- *Renovation costs \$150K
- *Business is attached to an apartment building
- *Parking lot is at the rear of the building

Alcohol License Concentration for 1401 N Martin L King Jr Dr

City of Milwaukee, Wisconsin

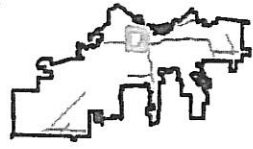

- Legend -**
- Milwaukee parcels
 - Street names 15,000
 - City limits
 - Freeways 15,000
 - Freeways
 - Exit ramps
 - Entry ramps
 - Ramps
 - Major streets 15,000
 - Streets 15,000
 - Street names 15,000
 - Alcohol licenses
 - Class A intoxicating liquor
 - Class A fermented malt beverage
 - Class A liquor and malt
 - Class B fermented malt beverage
 - Class B tavern
 - Class C wine retailer

- Notes -
 Licensed Alcohol Beverage Establishments Within a 5 Mile Radius Centered on 1401 N MLK Jr Dr on 05/30/2017

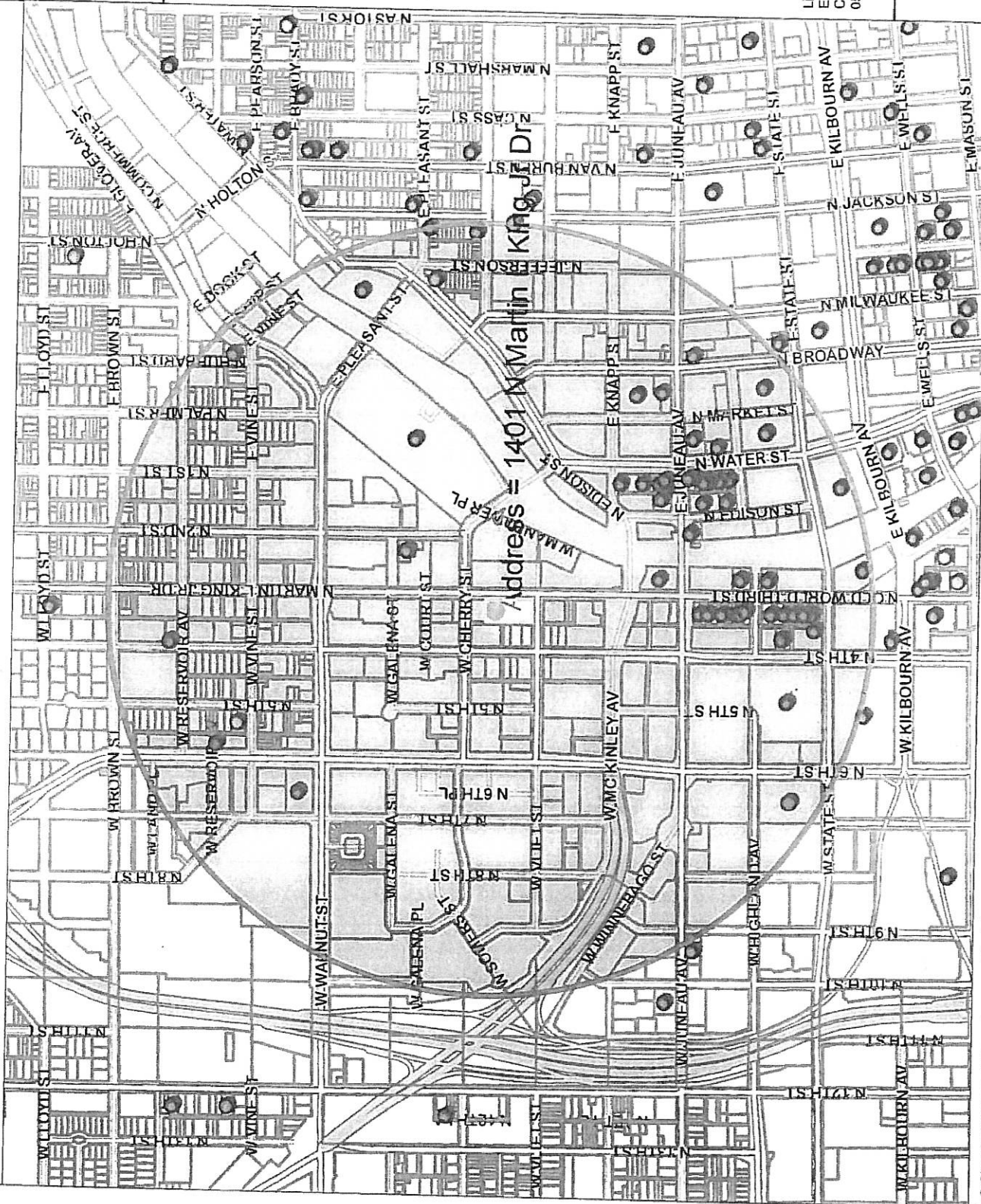

Map Scale: 1: 11,540

© City of Milwaukee, Wisconsin
 Map Milwaukee: Property Information
 Disclaimer
 5/30/2017

Unlicensed Alcohol Beverage Establishments Within a .5 Mile Radius Centered on 3101 N Martin L King Jr Dr on 05/30/2017

License Summary:
 Class A Fermented Malt Beverage Retailer's License
 Class B Fermented Malt Beverage Retailer's License
 Class C Wine Retailer's License

Legal entity	Trade name	Licensee	License type name	Total Capacity	Room capacity	Expiration date
Penny Saver, LLC	Penny Saver	Mayel M Azam, Agt	Class B Tavern License	369		11/29/2017 18:00
Aldebran Holdings LLC	Aldebran Coffee	David M Neumann, Agt	Class A Fermented Malt Beverage Retailer's License			10/13/2017 19:00
Milwaukee Area Technical College	MATC Culinary Restaurant	RICHARD A BUSALACCHI, Agt	Class B Fermented Malt Beverage Retailer's License			11/29/2017 19:00
1209 WATERS ST, INC	BROTHERS BAR & GRILL	Scott S Severson, Agt	Class B Tavern License	160		5/16/2018 18:00
JAMBIDGE CONCESSIONS, INC	ALFOT MILWAUKEE DOWNTOWN	Christopher R Torres, Agt	Class B Tavern License	160	Remin area cap 50, WXYZ area cap 46	11/29/2017 18:00
AI Bombers MKE, LLC	AI Bombers	JOSEPH J SORICE, JR, Agt	Class B Tavern License	80		7/23/2018 18:00
Art's Performing Center	Art's Performing Center	RICHARD D WAGNER, Agt	Class B Tavern License	60		10/11/2017 19:00
BAR MONIE MILWAUKEE, LLC	BAR LOUIE	AWAYM BLADROW, Agt	Class B Tavern License	300		7/23/2017 19:00
BLU RESTAURANT OPERATIONS, LLC	Bluebird Wild Wings #407	Jacob L Schmetzler, Agt	Class B Tavern License	353		3/19/2018 19:00
Bluelin Wings, Inc	MacGillivray's Bar & Grill	CHIKI Moore, Agt	Class B Tavern License	300		11/29/2017 18:00
BREZZES	BREZZES	ANDREW CHRISTEL, Agt	Class B Tavern License	833		10/16/2017 19:00
BREW CITY BAR & Q, INC	TRINITY THREE IRISH PUBS	ROBERT C SCHMIDT, JR, Agt	Class B Tavern License	254		9/21/2017 19:00
BRG 1000 Water St LLC	Rumpus @ The Rumpus Room	JOHN M WISE, Agt	Class B Tavern License	57		9/21/2017 19:00
BRICK 3 PIZZA, LLC	Rumpus Room - A Bartolotta Gastropub	RICHARD J BARRETT, Agt	Class B Tavern License	130		5/19/2018 19:00
Canon's ribs of Milwaukee, LLC	CRFron's	KEITHETH J MC RULTY, Agt	Class B Tavern License	133		3/1/2018 18:00
Collaborative Partners LLC	Wisconsin Cheese Mart	RICHARD J SCHAEFER, Agt	Class B Tavern License			10/10/2017 19:00
D & S Food Services Inc	Suite 414	Juliah A Schaefer, Agt	Class B Tavern License			6/30/2017 19:00
D&S Food Services, Inc	The Brown Bottle	Juliah A Schaefer, Agt	Class B Tavern License			12/1/2017 18:00
D&S Foodservice Inc	GRACE CENTER	JOAN M GIBLIN, Agt	Class B Tavern License			6/12/2017 19:00
DI ENTERPRISES I, INC	Fusionline MKE	SYSAHIRE M AYER, Agt	Class B Tavern License	330		9/23/2017 19:00
Evolution of Milwaukee LLC	Old German Beer Hall	HANS WEGEGEBER, III, Agt	Class B Tavern License	577		6/9/2017 19:00
HEM Milwaukee Inc	SCOOTERS PUB / DIKES OH WATER	NAMES A BAUDE, Agt	Class B Tavern License	400		11/24/2017 18:00
KEMELLIOT'S, INC	Fresh Thyme Eatery Market	Cand Ducheny, Agt	Class B Tavern License	160		5/29/2018 19:00
Lakes Venture LLC	POINTS EAST PUB	LOUIE HUSSETTI, Agt	Class B Tavern License	320		10/10/2017 19:00
LANDFALL II, LLC	Levy Restaurants at the Bradley Center	Conal A Caramello, Agt	Class B Tavern License	390		6/12/2017 19:00
Levy Restaurants at the Bradley Center	Maidor	Mark A Hebbelot, Agt	Class B Tavern License			11/30/2017 18:00
Lucille's Duetting Piano Bar, LLC	RED ROCK SALOON MILWAUKEE	JEFFREY A KOVICOVICH, JR, Agt	Class B Tavern License			9/23/2017 19:00
LUKE'S OF MILWAUKEE LTD						
Mader's German Restaurant, Inc	Mader's German Restaurant	DANIEL J HAZARD, Agt	Class B Tavern License	170 - upper		11/21/2017 18:00
Mai Bar LLC	Mai Bar	Kevin D Perkins, Agt	Class B Tavern License	370 272 - lower		3/29/2018 19:00
Major Gooch's Inc	Turner Hall Restaurant	POSTRICK M JOHNS, Agt	Class B Tavern License			11/9/2017 18:00
MILWAUKEE BRAT HOUSE, LLC	MILWAUKEE BRAT HOUSE	SCOTT A SCHAEFER, Agt	Class B Tavern License	193		9/14/2017 19:00
MILWAUKEE SCHOOL OF ENGINEERING	Milwaukee School of Engineering	John Henning, Agt	Class B Tavern License	2759 Foyer - 600, Lounge/Meeting Room - 400, Upper Foyer - 160, Field House - 1533, Hall of Fame Room - 66		5/18/2018 19:00
MILWAUKEE SCHOOL OF ENGINEERING	Milwaukee School of Engineering	John Henning, Agt	Class B Tavern License	208		5/18/2018 19:00
MILWAUKEE SCHOOL OF ENGINEERING	Milwaukee School of Engineering	John Henning, Agt	Class B Tavern License			5/18/2018 19:00
MKE Events LLC	Red White and Blue	JACOB E DEHNE, Agt	Class B Tavern License	824		6/26/2017 19:00
MKE TPC LLC	The Pub Club	Timothy G Thompson, Agt	Class B Tavern License	288		9/26/2017 19:00
MREA LLC	ale Avallon Riverhouse	RICHARD J IVAH, Agt	Class B Tavern License	987 Main floor - 607, Balcony - 380		12/13/2017 18:00
PABST THEATER CONCESSIONS, LLC	TURNER HALL BALLROOM	ROBERT C SCHMIDT, JR, Agt	Class B Tavern License	458		11/7/2017 18:00
Premier Milwaukee, LLC	Ugly's	BEHANMIRA HIEL, Agt	Class B Tavern License	370		2/5/2018 18:00
RIVER HOUSE RESTAURANT, INC	PRINCE HALL DOERS CLUB	ROBERTA BETTECASE, Agt	Class B Tavern License	150		13/28/2017 18:00
Rogues Gallery, LLC	Rogues Gallery	ADRIEL GIVIAN, Agt	Class B Tavern License	270 1st Floor - 140, 2nd Floor - 50, Beer Garden - 50 (Beer Garden - 100 with 2 Portable Restrooms)		7/4/2017 19:00
SAMANA'S FIRE CATERING, INC	SAMANA'S FIRE CATERING	RATHUN S SHOWERS, Agt	Class B Tavern License	99		11/29/2018 19:00
The Chalk House MKE Inc	The Localist State	JOSEPH M Hunt, Agt	Class B Tavern License	305 160 inside, 165 patio		9/14/2017 19:00
THE HARP IRISH PUB, INC	THE HARP	ROBERT C SCHMIDT, JR, Agt	Class B Tavern License	600 300 upper		12/16/2017 18:00
TUFTO PROMOTIONS, LLC	BUCK BRADLEY'S CATERY & SALOON	BERNARD PACOT, SR, Agt	Class B Tavern License	600 300 First Floor - 300 second floor		6/17/2017 19:00
UGO'S, LLC	Giovanni's Kennedy Pub	GIOVANNI SAFINA, Agt	Class B Tavern License	99		10/13/2017 19:00
Water Street Brewery Inc	Water Street Brewery	JACOB E DEHNE, Agt	Class B Tavern License	300		9/13/2017 19:00
WESTTOWN ASSOCIATION OF MILW, INC	Westtown Association of Milwaukee	ROBERT C SCHMIDT, JR, Agt	Class B Tavern License			5/22/2018 19:00
Wolf Peach, LLC	Wolf Peach	STACEY CALHIES, Agt	Class B Tavern License			10/21/2017 19:00
WTRWKS, LLC	RODIE'S WATERWORKS	GIRA M GRUENEWALD, Agt	Class B Tavern License	144		1/20/2018 18:00
	MATC Culinary Restaurant	JAMES P PACK, Agt	Class B Tavern License			
		RICHARD A BUSALACCHI, Agt	Class C Wine Retailer's License			

TOTAL

1
2
54
1

Grand Total = 58



Wednesday, July 12, 2017



Notice of Public Hearing

BALISTRERI, Dawn M, Agent
Urban Beets Cafe & Juicery at 1401 N Martin L King Jr DR
Class B Beer and Class C Wine License Applications and Food Dealer Transfer Application with
Change of Hours From Sun Closed, Mon - Fri 7 AM - 6:30 PM, Sat 9 AM - 4 PM To Mon - Sun 7
AM - 12 AM

Tuesday, July 18, 2017 at 11:00 AM

To whom it may concern:

The above application has been made by the above named applicant(s). This requires approval from the Licenses Committee and the Common Council of the City of Milwaukee. The hearing before the Licenses Committee will take place on 7/18/2017 at 11:00 AM, in Room 301-B, Third Floor, City Hall. If you wish, you may provide testimony at the hearing regarding the request; see below for further information. You are not required to attend the hearing. Once the Licenses Committee makes its recommendation, this recommendation is forwarded to the full Common Council for approval at its next regularly scheduled hearing. Please review the information below and if you have further questions regarding this process, please contact the License Division at (414) 286-2238.

Important details for those wishing to provide information for the Licenses Committee to consider when making its recommendation:

1. The license application is scheduled to be heard at the above time. Due to other hearings running longer than scheduled, you may have to wait some time to provide your testimony.
2. You must appear in person and testify as to matters that you have personally experienced or seen. (You cannot provide testimony for your neighbor, parent or anyone else; this is considered hearsay and cannot be considered by the committee.)
3. No letters or petitions can be accepted by the committee (unless the person who wrote the letter or the persons who signed the petition are present at the committee hearing and willing to testify).
4. Persons opposed to the license application are given the opportunity to testify first; supporters may testify after the opponents have finished.
5. When you are called to testify, you will be sworn in and asked to give your name, and address. (If your first and/or last names are uncommon please spell them.)
6. You may then provide testimony.
 - a. Include only information relating to the above license application.
 - b. Include only information you have personally witnessed or seen.
 - c. Provide concise and relevant information detailing how this business has affected or may affect the peaceful enjoyment of your neighborhood.
 - d. If by the time you have the opportunity to testify, the information you wish to share has already been provided to the committee, you may state that you agree with the previous testimony. Redundant or repetitive testimony will not assist the committee in making its recommendation.
7. After giving your testimony, the members of the Licenses Committee and the licensee may ask questions regarding the testimony you have given or other factors relating to the license application.
8. Business Competition is not a valid basis for denial or non-renewal of a license.
Please Note: If you have submitted an objection to the above application your objection cannot be considered by the committee unless you personally testify at the hearing.

CURRENT OCCUPANT 1407 N DR MARTIN LUTHER KING DR 419 MILWAUKEE, WI 53212-3997
CURRENT OCCUPANT 1407 N DR MARTIN LUTHER KING DR 417 MILWAUKEE, WI 53212-3997
CURRENT OCCUPANT 1407 N DR MARTIN LUTHER KING DR 104 MILWAUKEE, WI 53212-3976
CURRENT OCCUPANT 1407 N DR MARTIN LUTHER KING DR 313 MILWAUKEE, WI 53212-3996
CURRENT OCCUPANT 1407 N DR MARTIN LUTHER KING DR 315 MILWAUKEE, WI 53212-3996
CURRENT OCCUPANT 1407 N DR MARTIN LUTHER KING DR 407 MILWAUKEE, WI 53212-3997
CURRENT OCCUPANT 1407 N DR MARTIN LUTHER KING DR 410 MILWAUKEE, WI 53212-3997
CURRENT OCCUPANT 1407 N DR MARTIN LUTHER KING DR 418 MILWAUKEE, WI 53212-3997
CURRENT OCCUPANT 1407 N DR MARTIN LUTHER KING DR 206 MILWAUKEE, WI 53212-3995
CURRENT OCCUPANT 1407 N DR MARTIN LUTHER KING DR 317 MILWAUKEE, WI 53212-3996
CURRENT OCCUPANT 1407 N DR MARTIN LUTHER KING DR 411 MILWAUKEE, WI 53212-3997
CURRENT OCCUPANT 1407 N DR MARTIN LUTHER KING DR 102 MILWAUKEE, WI 53212-3976
CURRENT OCCUPANT 1407 N DR MARTIN LUTHER KING DR 114 MILWAUKEE, WI 53212-3976
CURRENT OCCUPANT 1407 N DR MARTIN LUTHER KING DR 202 MILWAUKEE, WI 53212-3995
CURRENT OCCUPANT 1407 N DR MARTIN LUTHER KING DR 213 MILWAUKEE, WI 53212-3995
CURRENT OCCUPANT 1407 N DR MARTIN LUTHER KING DR 302 MILWAUKEE, WI 53212-3996
CURRENT OCCUPANT 1407 N DR MARTIN LUTHER KING DR 316 MILWAUKEE, WI 53212-3996
CURRENT OCCUPANT 1407 N DR MARTIN LUTHER KING DR 324 MILWAUKEE, WI 53212-3996
CURRENT OCCUPANT 1407 N DR MARTIN LUTHER KING DR 101 MILWAUKEE, WI 53212-3976
CURRENT OCCUPANT 1407 N DR MARTIN LUTHER KING DR 111 MILWAUKEE, WI 53212-3976
CURRENT OCCUPANT 1407 N DR MARTIN LUTHER KING DR 204 MILWAUKEE, WI 53212-3995
CURRENT OCCUPANT 1407 N DR MARTIN LUTHER KING DR 216 MILWAUKEE, WI 53212-3995
CURRENT OCCUPANT 1407 N DR MARTIN LUTHER KING DR 220 MILWAUKEE, WI 53212-3995
CURRENT OCCUPANT 1407 N DR MARTIN LUTHER KING DR 225 MILWAUKEE, WI 53212-3995
CURRENT OCCUPANT 1407 N DR MARTIN LUTHER KING DR 305 MILWAUKEE, WI 53212-3996
CURRENT OCCUPANT 1407 N DR MARTIN LUTHER KING DR 307 MILWAUKEE, WI 53212-3996
CURRENT OCCUPANT 1407 N DR MARTIN LUTHER KING DR 319 MILWAUKEE, WI 53212-3996
CURRENT OCCUPANT 1407 N DR MARTIN LUTHER KING DR 325 MILWAUKEE, WI 53212-3996
CURRENT OCCUPANT 1407 N DR MARTIN LUTHER KING DR 405 MILWAUKEE, WI 53212-3997
CURRENT OCCUPANT 1407 N DR MARTIN LUTHER KING DR 409 MILWAUKEE, WI 53212-3997
CURRENT OCCUPANT 1407 N DR MARTIN LUTHER KING DR 414 MILWAUKEE, WI 53212-3997

Total Records: 87

Radius: 250.0 feet and Center of Circle: 1401 N Martin L King Jr DR



Wednesday, July 12, 2017

Licenses Committee Notice of Hearing

PARK EAST ENTERPRISE LOFTS
200 N MAIN St
OREGON, WI 53575

Date: 7/18/2017
Time: 11:00 AM
Location: Room 301-B, Third Floor, City Hall

The Licenses Committee will consider the following license application:

Class B Beer and Class C Wine License Applications and Food Dealer Transfer
Application with Change of Hours From Sun Closed, Mon - Fri 7 AM - 6:30 PM, Sat
9 AM - 4 PM To Mon - Sun 7 AM - 12 AM
BALISTRERI, Dawn M, Agent
Urban Beets Cafe & Juicery at 1401 N Martin L King Jr DR

Please note this application may be recommended for denial based on fitness of the location due to concentration of alcohol beverage outlets in the area. If the application is denied for this reason, no other application for an alcohol beverage license for this location shall be recommended for approval by the Licenses Committee within three years of the date of denial unless the applicant has demonstrated a change of circumstances since the prior denial.

If you have any questions, please call (414) 286-2238.





Wednesday, July 12, 2017

Licenses Committee Notice of Hearing

Gorman & Co.
310 W Vliet Street
Milwaukee, WI 53212

Date: 7/18/2017
Time: 11:00 AM
Location: Room 301-B, Third Floor, City Hall

The Licenses Committee will consider the following license application:

Class B Beer and Class C Wine License Applications and Food Dealer Transfer
Application with Change of Hours From Sun Closed, Mon - Fri 7 AM - 6:30 PM, Sat
9 AM - 4 PM To Mon - Sun 7 AM - 12 AM
BALISTRERI, Dawn M, Agent
Urban Beets Cafe & Juicery at 1401 N Martin L King Jr DR

Please note this application may be recommended for denial based on fitness of the location due to concentration of alcohol beverage outlets in the area. If the application is denied for this reason, no other application for an alcohol beverage license for this location shall be recommended for approval by the Licenses Committee within three years of the date of denial unless the applicant has demonstrated a change of circumstances since the prior denial.

If you have any questions, please call (414) 286-2238.





BUSINESS LICENSE PLAN OF OPERATION

ccl-busplan 9/26/16

Office of the City Clerk License Division
200 E. Wells St. Room 105, Milwaukee, WI 53202
(414) 286-2238 www.milwaukee.gov/license e-mail address: license@milwaukee.gov

1. Type of Business

Applying for: Extended Hours (12AM to 5AM) - If a food establishment, check all that apply: Delivery Drive Thru Dining Room
 Self Service Laundry Massage Establishment Filling Station
 Other (supplemental application for specific license also required)

Provide a detailed description of the type of business you plan on operating:

Cafe with CLASS B + C

Do you have any experience operating this type of business? No Yes If yes, explain:

2. Business Operations

- a. Proposed Opening Date: 6/30/17
- b. Is this premise under construction? No Yes If yes, list estimated completion date: 6/15/17
- c. Is this a franchise? No Yes
- d. Is this premises currently licensed? No Yes If yes, list type of license: food
- e. Is the current licensee operating? No Yes If no, list date closed: _____
- f. Do you have future plans for other businesses, licenses or permits at this location? No Yes
If yes, explain: CLASS B + C
- g. Have you previously held an Extended Hours License in Milwaukee? No Yes
If yes, list address(es): _____
- h. Are other businesses operating in the same building? No Yes If yes, describe: _____

3. Litter & Noise

- a. How are grounds kept clean? Sweep Pressure Wash Pick Up Litter Other: _____
- b. How often will grounds be cleaned? Daily Weekly As Needed Monthly Other: _____
- c. Grounds cleaned by: Licensee Building Owner Employees Hired Maintenance Other: _____
- d. How are noise issues prevented and/or addressed? Security Manager approaches customer(s) Call Police
 Signs Posted Other: _____
- e. Will a sound amplification system be used? No Yes If yes, describe: _____

4. Smoking & Sanitation

- a. Are there designated outdoor smoking areas? No Yes If yes, describe: _____
- b. Number of Garbage Cans: Inside: 4 Locations: 2-North + 1-S + 1-W
Outside: 1 Locations: North exit
- c. Is a crowd control barrier used? No Yes If yes, describe: _____
- d. How many restrooms are on the premises? 2
- e. Name of solid waste contractor: Advanced Disposal Waste Management Other: _____

5. Security

- a. Are there onsite parking spaces? No Yes If yes, indicate how many? _____ and describe the parking security plan: _____
- b. Is there a loading zone? No Yes If yes, describe the loading area security plan: _____
- c. Will you have security personnel on premise? No Yes If yes, how many? _____ and answer the following:
 What are their responsibilities? _____
 Is security equipment used? No Yes If yes, describe camera
 List their licensing, certification, or training credentials _____
- d. Will there be security cameras? No Yes If yes, where? front entrances + cash
- e. Will searches/identification checks be done upon entry? No Yes If yes, describe _____

6. Percentage of Sales (must total 100%)

Alcohol <u>20</u> %	Food <u>80</u> %	Secondhand Merchandise _____ %	Precious Metals & Gems _____ %
Entertainment _____ %	Cigarettes _____ %	_____ %	_____ %
Pawnbroker Activity _____ %	Salvaged Materials _____ % (such as scrap metal)	Personal Services (such as tattoo, body piercing, salon, tailor, tanning, etc.) _____ %	Other _____ % Describe: _____

7. Businesses/Licenses on the Premises (check all that apply):

Type 1

- Full Service Restaurant Cafe/Coffee Shop Deli or Fast Food Restaurant Private/Fraternal/Veterans Club
- Night Club Tavern Cocktail Lounge Teen Club
- Banquet Hall Sports Facility Bowling Alley
- Hotel/Motel : Number of Floors: _____ Rooming House: Number of Floors: _____
 Number of Rooms: _____ Number of Rooms: _____

Type 2

- Liquor Store Corner Store Supermarket Convenience Store
- Gas Station Amusement/Phonograph Distributor Recycling, Salvage or Towing
- Used Car Dealer Personal Service Establishment (such as tattoo business, hair salon, tailor, etc.) Recording Studio

What other licenses/permits will you hold at this location? (check all that apply)

- Occupancy Permit Cigarette & Tobacco Gas Station Extended Hours Class "B" Tavern Weights & Measures
- Secondhand Dealer Precious Metal & Gem Other: _____

8. Legal Capacity (only if a Type 1 premises in #7 above)

Capacity _____ (Call the Milwaukee Development Center at 414-286-8211 if you have questions.)

9. Premises Description

- a. Identify all area(s) of the premises that will be used in operating this business (include areas used only for storage):
 1st Floor 2nd Floor Basement Storage Patio Beer Garden Sidewalk Café Deck Rooftop
 Other: Describe: _____
- b. Describe Location: Major Thoroughfare Secondary Street Other: _____
- c. Nearest Major Cross Street: McKinley
- d. Describe Building: Free Standing Building Strip Mall Other: _____
- e. Describe Premises Structure: Single Story Multi-Story - # of Stories 4 Other: _____
- f. Describe Surrounding Area: Commercial Residential Industrial Other: _____
- g. Building Owner Name: Gorman & Co. Phone Number: 608-835-3900
 Business Owner Address: 310 W. Ullet St.

10. Hours of Operation & Customers

Will customers be entering the premises? No Yes

Day of the Week	Proposed Hours of Operation:		Estimated Number of Customers expected each day	Potential Age Range of Customers	Class B Tavern Applicant Only: Age Restriction (If none, write 'None')
	Open Time (include a.m. or p.m.)	Close Time (include a.m. or p.m.)			
Sunday	7am	12am	300	25-80	None ↓
Monday	7am	12am	300	25-80	
Tuesday	7am	12am	300	25-80	
Wednesday	7am	12am	300	25-80	
Thursday	7am	12am	300	25-80	
Friday	7am	12am	300	25-80	
Saturday	7am	12am	300	25-80	

An Extended Hours Establishment License is required for any convenience store, filling station, personal service establishment (such as tattoo, body piercing, salon, tailor, tanning, etc.), recording studio or restaurant which is open between the hours of 12:00 a.m. and 5:00 a.m.

Alcohol Establishments Permitted Hours of Operation: Class A: 8:00 am to 9:00 pm Sunday thru Saturday
 Class B: 6:00 am to 2:00 am Sunday thru Thursday, 6:00 am to 2:30 am Friday & Saturday

Entertainment Closing Hours: Indoors: Alcohol beverage establishments: Same as alcohol license hours
 Non-alcohol establishments: 1:00 am Sunday thru Thursday, 1:30 am Friday & Saturday
 Outdoors: All establishments: 10:00 pm Sunday thru Thursday, 12:00 am Friday & Saturday
 (unless otherwise approved by the Common Council in licensee's plan of operation)

11. Signature(s)

[Signature]
 Sole Proprietor, Partner, Agent, or 20% or more Shareholder

[Signature]
 Signature of additional partner or 20% or more Shareholder

See Application Information for a complete list of all required application forms.



ALCOHOL BEVERAGE & PUBLIC ENTERTAINMENT PREMISES SUPPLEMENTAL PLAN OF OPERATION

ccl-alcpeplan 2/18/15

Office of the City Clerk License Division
200 E. Wells St. Room 105, Milwaukee, WI 53202

(414) 286-2238 e-mail address: license@milwaukee.gov www.milwaukee.gov/license

Legal Entity Name: Urban Beets, Inc.

Premise Address: 1401 N. Dr. Martin Luther King Dr.

Proximity of Premises to Church, School, Daycare Center or Hospital

Is there at least 300 feet between the building and any church, school, daycare center or hospital? Yes No

"Service Bar Only" Designation

If applying for Class B or C license, are you applying for "Service Bar Only"? No Yes

Service Bar Only means customers cannot sit at the bar. Alcohol is served to patrons seated at tables. No stools, chairs or other articles of furniture shall be placed at the service bar for patrons to sit upon.

Business Information

a) Are you taking out this application for anyone that may not be eligible for a license? No Yes
If yes, list name and address: _____

b) Will the agent, a partner or the individual licensee be conducting the day-to-day operations of the business? No Yes
If no, list the name and address of the person(s) who will: _____

Class B Applicants: If the agent, a partner or the individual licensee will not be conducting the day-to-day operations of the business, the person(s) listed above must obtain a Class B Managers license.

c) Does anyone else have money invested or any other interest in this business? No Yes
If yes, explain: _____

d) Have you made an agreement with anyone to repay any loan or any other payments based upon income from the business? No Yes
If yes, list name and address: _____

Proof of Ownership, Lease, or Offer to Purchase (new & transfer applicants only)

Submit proof of ownership, lease, or offer to purchase the building with this application.
A lease or offer to purchase must:

- Be in the same legal entity name as that apply for the license
- Reflect the same address as the premises address on this application
- Reflect current dates and
- Be signed by the lessor/seller and lessee/buyer

Property Information (new & transfer applicants only)

a) Do you own or lease the building? Own Lease

b) Who owns the fixtures (for example, coolers, etc.)? Urban Beets

c) Are you purchasing the stock and/or fixtures? No Yes If yes, amount paid \$ _____

d) Total amount paid for business \$ 0

e) Total amount paid for goodwill of the business \$ 0

Goodwill comprises the reputation and customer relationships of an existing business. If the price you pay for the business exceeds the fair market value of all of the rest of the assets of the business, the excess may be considered goodwill.

f) Have you made arrangements with the seller for payment of personal property taxes? No Yes

See Application Information for a list of all required application forms.

Lease Information (new & transfer applicants who are leasing the premises only)

- a) Date lease begins 2015 Ends 2026
- b) Monthly rental \$ 3,600
- c) Do you have an option to renew the lease? No Yes
- d) Does your lease allow for assignment to another party without the consent of the owner? No Yes
- e) For what length of time have you been guaranteed occupancy (number of years)? 9
- f) In addition to paying the monthly rental, will you have to pay anything additional to the owner of the building to guarantee performance of the lease? No Yes If yes, explain _____
- g) Does the present owner or occupancy object to the granting of your license? No Yes
If yes, explain _____

Change of Agent Applicants Only

Have there been any changes to the floor plan since the last application was submitted? No Yes
If no, a new floor plan is not required. If yes, submit a new floor plan and explain the change(s): _____

Notarized Signatures of Applicants

SUBSCRIBED AND SWORN TO BEFORE ME

This 30th day of May, 20 17

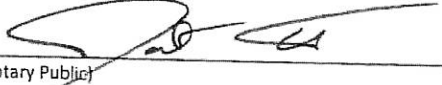

(Clerk/Notary Public)

My Commission Expires MAY 23 2019

*Notary Seal must be affixed

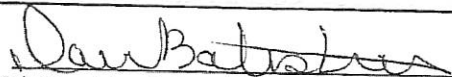

Sole Proprietor, Partner, 20% or more Shareholder, or Agent - only if there are no 20% or more shareholders

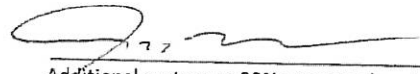

Additional partner or 20% or more shareholder

Note: All information contained in this application is subject to approval by the Common Council. Deviating from approved plan of operation will subject licensee to citations, and/or suspension or non-renewal of the license. Contact the License Division for information on how to request changes.

New and transfer of premise applicants must submit the following:

- Proof of ownership, lease or offer to purchase the building
- Detailed floor plan
- If a restaurant, copy of the menu

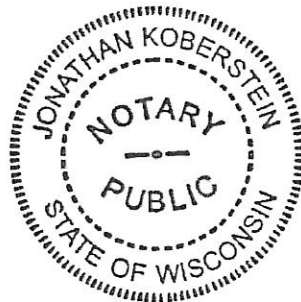



PERMANENT CHANGE TO BUSINESS PLAN OF OPERATION APPLICATION

ccl-permchgop 1/5/17

OFFICE OF THE CITY CLERK LICENSE DIVISION
200 E. WELLS ST. ROOM 105, MILWAUKEE, WI 53202
(414) 286-2238 EMAIL: LICENSE@MILWAUKEE.GOV

Check/List All License Type(s): Alcohol Beverage Food Other(s):

Legal Entity Name (Sole Proprietor, Partnership, Corporation or LLC): Urban Beets, Inc.

Agent's Name (Corp/LLC): Dawn Balistreri

Trade Name: Urban Beets Cafe + Juicery

Business Address (include city/state/zip code): 1407 W. Dr. Martin Luther King Aldermanic District: _____

REQUEST TO CHANGE HOURS OF OPERATION AS FOLLOWS: Milwa, WI 53212

Day of the Week	Current Hours of Operation:		Proposed Hours of Operation:		Number of Customers expected each day	Class B Taverns: Age Restriction for each day (if over 21) (This is optional) If none, write "none"
	Open	Close	Open	Close		
Sunday	-	-	7am	12am	300	None
Monday	7am	6:30	7am	12am	↓	↓
Tuesday	7am	6:30	7am	12am		
Wednesday	7am	6:30	7am	12am		
Thursday	7am	6:30	7am	12am		
Friday	7am	6:30	7am	12am		
Saturday	9am	4pm	7am	12am		

Prohibited Hours of Operation: Class A: 9:00 PM to 8:00 AM
Class B/C: Monday thru Friday 2:00 AM – 6:00 AM; Class B/C: Saturday thru Sunday 2:30 AM – 6:00 AM
Food: 12:00 AM to 5:00 AM (unless an Extended Hours license is also held)

REQUEST TO CHANGE FLOOR PLAN AS FOLLOWS:

New floor plan(s) must be submitted with this application.
(See next page for detailed floor plan instructions.)

** Alcohol Beverage Establishments. This form should be used for changing the location of tables, games, etc within your current licensed premises. If your changes include adding any additional areas or square footage to your premises, or any renovations to the building will be done, do NOT complete this form. A Permanent Extension of Premises is required.

Office Use Only:
Filed 5-30-17 Initials JK App#s 256467
MPD (Alcohol) _____ LC _____ CC _____ License #s _____

+

REQUEST TO CHANGE BUSINESS OPERATIONS AS FOLLOWS:

Current business operations: ~~road~~ food

Proposed change(s) to the business operations: food + class B + C

Besides the changes requested above, there are no further changes. The current plan of operation (including floor plan) will be followed. I understand any changes to the plan of operation (including floor plan) need to be requested and approved before implementing.

For alcohol establishment and public entertainment premises licenses, the signature must be notarized.

Subscribed and sworn to before me
this 30th day of MAY, 2017

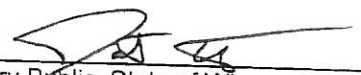

Notary Public, State of Wisconsin
My commission expires: MARCH 23, 2019
Notary Seal must be affixed

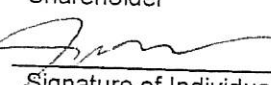
Jason Massmen Dawn Balistreri
Print Name of Individual, Partner, Agent, or 20% or more
Shareholder
 Dawn Balistreri
Signature of Individual, Partner, Agent, or 20% or more
Shareholder

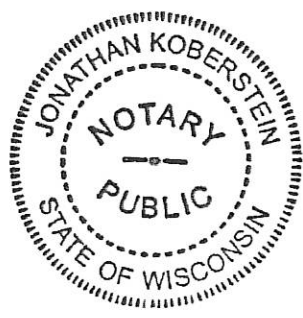

Alcohol beverage storage
 (Shelves) and bar coolers
 (10'x10') (40')

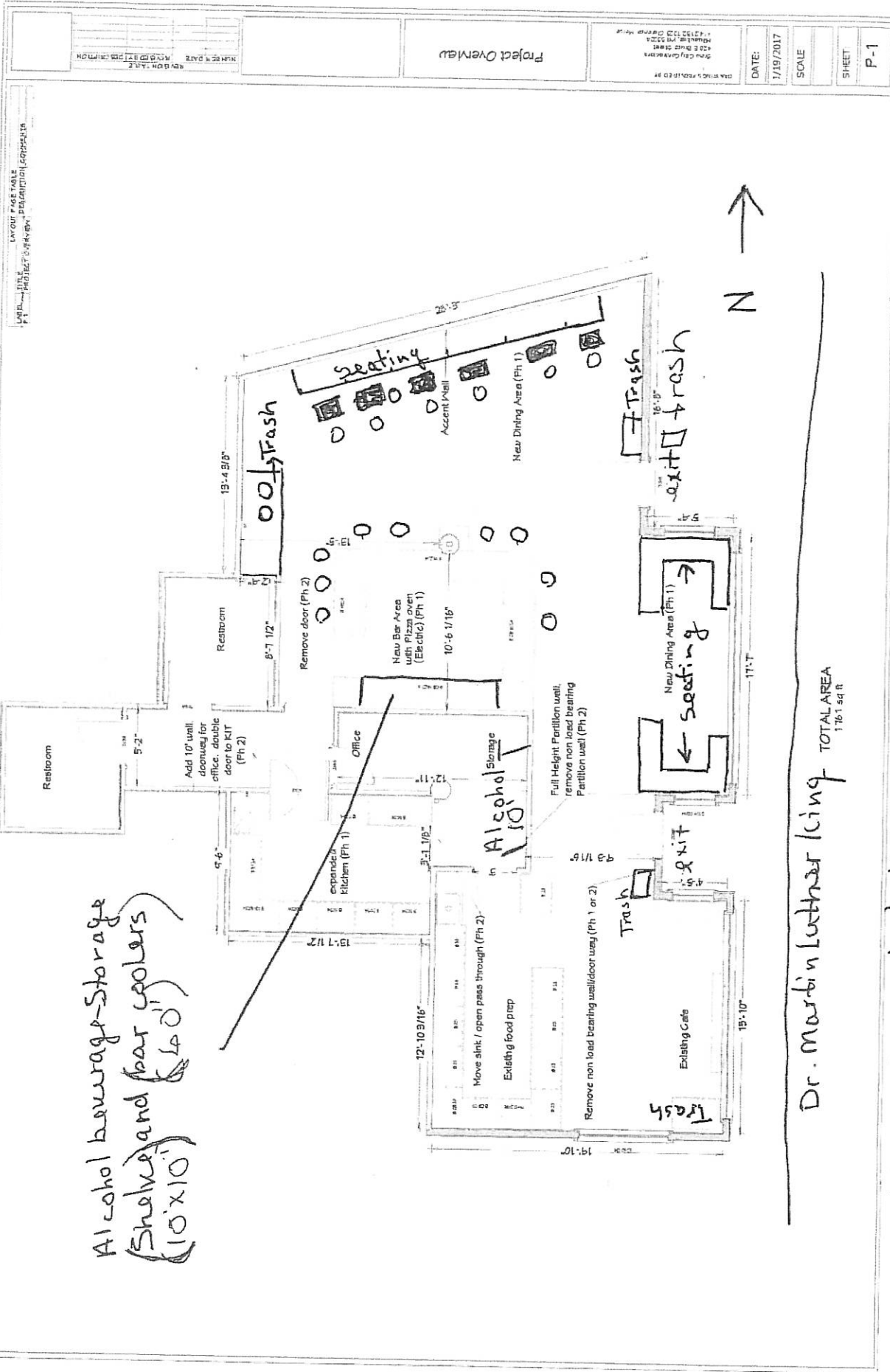

Dr. Martin Luther King TOTAL AREA 1,761 sq. ft.

1401 N. Dr. Martin Luther King 1st floor
 Milwaukee, WI 53212

Urban Beets, Inc. (Urban Beets
 Dawn Balistreri cafe + jewelry)
 5/15/17

LAYOUT SHEET
 PROJECT: 17-100-00000-000000-000000

DATE: 1/19/2017
 SCALE:
 SHEET: P-1

Project Overview

Dr. King's Project # 17-100-00000-000000-000000
 420 E. Ohio Street
 Milwaukee, WI 53224
 414.224.1234
 17-100-00000-000000-000000



CITY OF MILWAUKEE
OFFICE OF THE CITY CLERK

Wednesday, July 05, 2017

COMMITTEE MEETING NOTICE

AD 06

CETTERY M GARDNER
3751 N TEUTONIA Av
MILWAUKEE, WI 53206

You are requested to attend a hearing which is to be held in Room 301-B, Third Floor, City Hall on:

Tuesday, July 18, 2017 at 11:00 AM

Regarding: Your Class B Tavern and Public Entertainment Premises License Renewal Applications for "SHANANIGANS" at 3751 N TEUTONIA Av.



There is a possibility that your application may be denied for one or more of the following reasons: The recommendation of the committee regarding the application shall be based on evidence presented at the hearing. Per MCO 85-4-4, unless otherwise specified in the code, probative evidence concerning non-renewal, suspension or revocation may include evidence of the following: failure of the applicant to meet municipal qualifications, pending charges against or the conviction of any felony, misdemeanor, municipal offense or other offense, the circumstances of which substantially relate to the circumstances of the particular licensed or permitted activity, by the applicant or by any employee or other agent of the applicant. If the activities of the applicant involve a licensed premises, whether the premises tends to facilitate a public or private nuisance or has been the source of congregations of persons which have resulted in any of the following: disturbance of the peace; illegal drug activity; public drunkenness; drinking in public; harassment of passers-by; gambling; prostitution; sale of stolen goods; public urination; theft; assaults; battery; acts of vandalism including graffiti, excessive littering, loitering, illegal parking, loud noise at times when the licensed premise is open for business; traffic violations; curfew violations; lewd conduct; display of materials harmful to minors, pursuant to s. 106-9.6; or any other factor which reasonably relates to the public health, safety and welfare, or failure to comply with the approved plan of operation. See attached police report or correspondence.

Notice for applicants with warrants or unpaid fines:

Proof of warrant satisfaction or payment of fines must be submitted at the hearing on the above date and time. Failure to comply with this requirement may result in a delay of the granting/denial of your application.

Failure to appear at this meeting may result in the denial of your license. Individual applicants must appear only in person or by an attorney. Corporate or Limited Liability applicants must appear only by the agent designated on the application or by an attorney. Partnership applicants must appear by a partner listed on the application or by an attorney. If you wish to do so and at your own expense, you may be accompanied by an attorney of your choosing to represent you at this hearing.

You will be given an opportunity to speak on behalf of the application and to respond and challenge any charges or reasons given for the denial. No petitions can be accepted by the committee, unless the people who signed the petition are present at the committee hearing and willing to testify. You may present witnesses under oath and you may also confront and cross-examine opposing witnesses under oath. If you have difficulty with the English language, you should bring an interpreter with you, at your expense, so that you can answer questions and participate in your hearing.

You may examine the application file at this office during regular business hours prior to the hearing date. Inquiries regarding this matter may be directed to the person whose signature appears below.

Limited parking for persons attending meetings in City Hall is available at reduced rates (5 hour limit) at the Milwaukee Center on the southwest corner of East Kilbourn and North Water Street. Parking tickets must be validated in the first floor information booth in City Hall.

PLEASE NOTE: Upon reasonable notice, efforts will be made to accommodate the needs of disabled individuals through sign language interpreters or other auxiliary aids. For additional information or to request this service, contact the Council Services Division ADA Coordinator at (414) 286-2998, Fax - (414) 286-3456, TDD - (414) 286-2025.

JIM OWCZARSKI, CITY CLERK

BY:

Jessica Celella
License Division Manager

If you have questions regarding this notice, please contact the License Division at (414) 286-2238.

200 E. Wells Street, Room 105, City Hall, Milwaukee, WI 53202. www.milwaukee.gov/license

**MILWAUKEE POLICE DEPARTMENT
LICENSE INVESTIGATION UNIT**

**CRIMINAL RECORD/ORDINANCE VIOLATION/INCIDENTS
SYNOPSIS**

DATE: 06/26/2017
LICENSE TYPE: BTAVN
NEW:
RENEWAL: X

No. 258034
Application Date: 06/26/2017
Expiration Date:

License Location: 3751 N Teutonia Avenue
Business Name: Shananigans

Aldermanic District: 06

Licensee/Applicant: Gardner, Cettery M
(Last Name, First Name, MI)
Date of Birth: 12/14/1968

Home Address: 3736 N 3rd St
City: Milwaukee
Home Phone: (414) 704 - 7951

State: WI **Zip Code: 53212**

This report is written by Police Officer Gilbert Gwinn, assigned to the License Investigation Unit, Days.

The Milwaukee Police Department's investigation regarding this application revealed the following:

1. On 10/31/2002, the applicant was cited by City of Milwaukee for:

Charge: B & Z Violations
Finding: Guilty – Milwaukee Municipal Court
Sentence: \$222.50 penalty
Date: 12/18/2003
Case#: 03155000

2. On 06/10/2003, the applicant was cited by Milwaukee Police Department for:

Charge: Exterior Wood Surfaces Protected
Finding: Guilty – Milwaukee Municipal Court
Sentence: \$100.00 penalty
Date: 10/09/2003
Case#: 03109927

=====

3. On 03/26/2010 the applicant was cited in the city of Milwaukee for Building Code Violations.

Charge: Building Code Violations
Finding: Guilty
Sentence: \$230.00 fine
Date: 02/24/2011
Case: 10137946

4. On 08/23/2010 the applicant was cited in the city of Milwaukee for Building Code Violations.

Charge: Building Code Violations
Finding: Guilty
Sentence: \$50.00 fine
Date: 12/16/2010
Case: 10106622

5. On 08/23/2010 the applicant was cited in the city of Milwaukee for Fail to Inform Tenant of Inspection.

Charge: Fail to Inform Tenant of Inspection
Finding: Guilty
Sentence: \$100.00 fine
Date: 12/16/2010
Case: 10106620

=====
6. On 01/23/2013 the applicant was cited at 3747 North Teutonia Avenue in the city of Milwaukee for Building Code Violations.

Charge: Building Code Violations
Finding: Guilty
Sentence: \$980.00 fine
Date: 03/06/2014
Case: 14000982

=====
7. On 05/19/2015 the applicant was cited in the City of Milwaukee at 2259 N. 14th St for Fail to Inform Tenant of Inspection.

Charge: Fail to Inform Tenant of Inspection
Finding: Guilty
Sentence: Fined \$250.00
Date: 06/25/2015
Case: 15027063
=====

8. On 08/24/2016 the applicant was cited in the city of Milwaukee for Building Code Violations.

Charge: Building Code Violations
Finding: Due for further proceedings 07/25/2017 8:30am branch 3
Sentence:
Date:
Case: 17007577



Wednesday, July 05, 2017



Notice of Public Hearing

GARDNER, Cettery M
SHANANIGANS at 3751 N TEUTONIA Av
Class B Tavern and Public Entertainment Premises License Renewal Applications

Tuesday, July 18, 2017 at 11:00 AM

To whom it may concern:

The above application has been made by the above named applicant(s). This requires approval from the Licenses Committee and the Common Council of the City of Milwaukee. The hearing before the Licenses Committee will take place on 7/18/2017 at 11:00 AM, in Room 301-B, Third Floor, City Hall. If you wish, you may provide testimony at the hearing regarding the request; see below for further information. You are not required to attend the hearing. Once the Licenses Committee makes its recommendation, this recommendation is forwarded to the full Common Council for approval at its next regularly scheduled hearing. Please review the information below and if you have further questions regarding this process, please contact the License Division at (414) 286-2238.

Important details for those wishing to provide information for the Licenses Committee to consider when making its recommendation:

1. The license application is scheduled to be heard at the above time. Due to other hearings running longer than scheduled, you may have to wait some time to provide your testimony.
2. You must appear in person and testify as to matters that you have personally experienced or seen. (You cannot provide testimony for your neighbor, parent or anyone else; this is considered hearsay and cannot be considered by the committee.)
3. No letters or petitions can be accepted by the committee (unless the person who wrote the letter or the persons who signed the petition are present at the committee hearing and willing to testify).
4. Persons opposed to the license application are given the opportunity to testify first; supporters may testify after the opponents have finished.
5. When you are called to testify, you will be sworn in and asked to give your name, and address. (If your first and/or last names are uncommon please spell them.)
6. You may then provide testimony.
 - a. Include only information relating to the above license application.
 - b. Include only information you have personally witnessed or seen.
 - c. Provide concise and relevant information detailing how this business has affected or may affect the peaceful enjoyment of your neighborhood.
 - d. If by the time you have the opportunity to testify, the information you wish to share has already been provided to the committee, you may state that you agree with the previous testimony. Redundant or repetitive testimony will not assist the committee in making its recommendation.
7. After giving your testimony, the members of the Licenses Committee and the licensee may ask questions regarding the testimony you have given or other factors relating to the license application.
8. Business Competition is not a valid basis for denial or non-renewal of a license.
Please Note: If you have submitted an objection to the above application your objection cannot be considered by the committee unless you personally testify at the hearing.

OCCUPANT	MAIL ADDRESS	CITY AND ZIP CODE
CURRENT OCCUPANT	1968 W VIENNA AVE	MILWAUKEE, WI 53206-1912
CURRENT OCCUPANT	3819A N 19TH PL	MILWAUKEE, WI 53206-1902
CURRENT OCCUPANT	2022 W VIENNA AVE	MILWAUKEE, WI 53206-1956
CURRENT OCCUPANT	3752 N 20TH ST	MILWAUKEE, WI 53206-1800
CURRENT OCCUPANT	3745 N 20TH ST	MILWAUKEE, WI 53206-1832
CURRENT OCCUPANT	3805 N 20TH ST	MILWAUKEE, WI 53206-1962
CURRENT OCCUPANT	3808 N TEUTONIA AVE	MILWAUKEE, WI 53206-1950
CURRENT OCCUPANT	1962 W VIENNA AVE	MILWAUKEE, WI 53206-1912
CURRENT OCCUPANT	1961 W VIENNA AVE	MILWAUKEE, WI 53206-1913
CURRENT OCCUPANT	3744 N 21ST ST	MILWAUKEE, WI 53206-1833
CURRENT OCCUPANT	3725 N 20TH ST	MILWAUKEE, WI 53206-1832
CURRENT OCCUPANT	3824 N 20TH ST 2	MILWAUKEE, WI 53206-1927
CURRENT OCCUPANT	3824 N 20TH ST 8	MILWAUKEE, WI 53206-1927
CURRENT OCCUPANT	3824 N 20TH ST 7	MILWAUKEE, WI 53206-1927
CURRENT OCCUPANT	3824 N 20TH ST 4	MILWAUKEE, WI 53206-1927
CURRENT OCCUPANT	3824 N 20TH ST 3	MILWAUKEE, WI 53206-1927
CURRENT OCCUPANT	3819 N 19TH PL	MILWAUKEE, WI 53206-1902
CURRENT OCCUPANT	1960 W VIENNA AVE	MILWAUKEE, WI 53206-1912
CURRENT OCCUPANT	3737 N 20TH ST	MILWAUKEE, WI 53206-1832
CURRENT OCCUPANT	3719 N 20TH ST	MILWAUKEE, WI 53206-1832
CURRENT OCCUPANT	2022A W VIENNA AVE	MILWAUKEE, WI 53206-1956
CURRENT OCCUPANT	3805A N 20TH ST	MILWAUKEE, WI 53206-1962
CURRENT OCCUPANT	3761 N 20TH ST	MILWAUKEE, WI 53206-1832
CURRENT OCCUPANT	1966 W VIENNA AVE	MILWAUKEE, WI 53206-1912
CURRENT OCCUPANT	1956 W VIENNA AVE	MILWAUKEE, WI 53206-1912
CURRENT OCCUPANT	3739 N 20TH ST	MILWAUKEE, WI 53206-1832
CURRENT OCCUPANT	3763 N 20TH ST	MILWAUKEE, WI 53206-1832
CURRENT OCCUPANT	3749 N 20TH ST	MILWAUKEE, WI 53206-1832
CURRENT OCCUPANT	3824 N 20TH ST 1	MILWAUKEE, WI 53206-1927
CURRENT OCCUPANT	3824 N 20TH ST 6	MILWAUKEE, WI 53206-1927
CURRENT OCCUPANT	3745A N 20TH ST	MILWAUKEE, WI 53206-1832
CURRENT OCCUPANT	3731 N 20TH ST	MILWAUKEE, WI 53206-1832
CURRENT OCCUPANT	2023 W VIENNA AVE	MILWAUKEE, WI 53206-1957
CURRENT OCCUPANT	1958 W VIENNA AVE	MILWAUKEE, WI 53206-1912
CURRENT OCCUPANT	3810 N 21ST ST	MILWAUKEE, WI 53206-1930
CURRENT OCCUPANT	3748 N 21ST ST	MILWAUKEE, WI 53206-1833
CURRENT OCCUPANT	3755 N 20TH ST	MILWAUKEE, WI 53206-1832
CURRENT OCCUPANT	3824 N 20TH ST 5	MILWAUKEE, WI 53206-1927

Total Records: 39

Radius: 250.0 feet and Center of Circle: 3751 N Teutonia AV

2017-2018 Plan of Operation for 3751 N TEUTONIA AV

1. Litter & Security Plans			
How are the grounds kept clean? <input type="checkbox"/> Sweep <input type="checkbox"/> Pressure Wash <input checked="" type="checkbox"/> Pick Up Litter <input type="checkbox"/> Other:			
How often will grounds be cleaned? <input checked="" type="checkbox"/> Daily <input type="checkbox"/> Weekly <input type="checkbox"/> Other:			
Who cleans the grounds? <input checked="" type="checkbox"/> Licensee <input type="checkbox"/> Building Owner <input type="checkbox"/> Employees <input type="checkbox"/> Hired Maintenance <input type="checkbox"/> Other:			
How are noise issues prevented and/or addressed? <input type="checkbox"/> Security <input type="checkbox"/> Manager approaches customer(s) <input type="checkbox"/> Call Police <input type="checkbox"/> Signs Posted <input checked="" type="checkbox"/> Other: <i>ask them to turn it down</i>			
Are there designated outdoor smoking areas? <input checked="" type="checkbox"/> No <input type="checkbox"/> Yes If Yes, Describe:			
Number of garbage cans:		Locations:	
Inside <u>6</u>	Locations: <u>2 Behind bar 1 by sink bathr in back door in By pak</u>	Outside <u>1</u>	Locations: <u>Back of Building</u>
Is a crowd control barrier used? <input checked="" type="checkbox"/> No <input type="checkbox"/> Yes If Yes, Describe:			
Number of restrooms: <u>2</u>			
Name of solid waste contractor: <u>Advanced</u>			
Are there parking spaces on the premises? <input checked="" type="checkbox"/> No <input type="checkbox"/> Yes If Yes, list number of spaces: _____ and describe security plans:			
Are there designated loading areas? <input checked="" type="checkbox"/> No <input type="checkbox"/> Yes If Yes, describe security plans:			
Do you have security personnel on the premise? <input checked="" type="checkbox"/> No <input type="checkbox"/> Yes If Yes, how many? _____			
AND What are their responsibilities? _____			
What security equipment do they use? _____			
List their licensing, certification or training credentials: _____			
Are there security cameras? <input type="checkbox"/> No <input checked="" type="checkbox"/> Yes If Yes, list all locations: <u>inside</u>			
Are searches and/or identification checks conducted upon entry? <input type="checkbox"/> No <input checked="" type="checkbox"/> Yes If Yes, describe: <u>ask them for ID if they dont look old enough & signs no weapons allowed</u>			
2. Percentage of Sales (must total 100%)			
Alcohol <u>100</u> %	Food Sales _____ %	Entertainment _____ %	Other _____ %
3. Businesses On The Premises (choose all that apply):			
<input type="checkbox"/> Restaurant	<input type="checkbox"/> Cafe/Coffee Shop	<input type="checkbox"/> Cocktail Lounge	<input type="checkbox"/> Convenience Store <input type="checkbox"/> Other:
<input type="checkbox"/> Night Club	<input checked="" type="checkbox"/> Tavern	<input type="checkbox"/> Banquet Hall	<input type="checkbox"/> Sports Facility
<input type="checkbox"/> Liquor Store	<input type="checkbox"/> Hotel	<input type="checkbox"/> Supermarket	<input type="checkbox"/> Private/Fraternal/Veterans' Club
4. Hours of Operation and Age Restriction			
Are there any changes to the current hours of operation or age restriction? <input checked="" type="checkbox"/> No <input type="checkbox"/> Yes If Yes, Describe:			
Please Note: If you will be open earlier or later than the hours listed on your current license for even one event or holiday (for example, St. Patrick's Day, Brewers Opening Day, etc.) during the license period, this must be reported and printed on your license. Your hours of operation and age restriction are listed on your current license.			
5. Floor Plan and Capacity			
Are you requesting any changes to the floor plan or capacity? <input checked="" type="checkbox"/> No <input type="checkbox"/> Yes If Yes, Describe:			
If requesting changes to the floor plan, submit a new floor plan with this application. Changes in floor plan include changing the location of tables, games, etc. within your current licensed premises. If your changes include adding any additional areas or square footage to your premises, or any renovations to the building will be done, a Permanent Extension of Premises application must be filed.			
6. Sidewalk Dining (if renewing a current license)			
Are there any changes to the sidewalk dining site plan? <input checked="" type="checkbox"/> No <input type="checkbox"/> Yes If Yes, submit an updated site plan with this application.			

PUBLIC ENTERTAINMENT PREMISES RENEWAL SUPPLEMENTARY APPLICATION

1. CURRENT APPROVED ENTERTAINMENT

The following types of entertainment have been approved for your current Public Entertainment Premises license:

Disc Jockey, jukebox, 5 Amusement Machines, 1 Pool Table

2. ADDING ENTERTAINMENT

If applicable, check any entertainment you wish to ADD:

- | | | | |
|---|---|--|--|
| <input type="checkbox"/> Instrumental Musicians | <input type="checkbox"/> Bands | <input type="checkbox"/> Battle of the Bands | <input type="checkbox"/> Comedy Acts |
| <input type="checkbox"/> Disc Jockey | <input type="checkbox"/> Magic Shows | <input type="checkbox"/> Poetry Readings | <input type="checkbox"/> Dancing by Performers |
| <input type="checkbox"/> Jukebox | <input type="checkbox"/> Wrestling | <input type="checkbox"/> Patron Contests | <input type="checkbox"/> Patrons Dancing |
| <input type="checkbox"/> Adult Entertainment/
Strippers/Erotic Dance | <input type="checkbox"/> Karaoke | <input type="checkbox"/> Bowling Alley | <input type="checkbox"/> Pool Tables |
| <input type="checkbox"/> Motion Pictures | <input type="checkbox"/> Amusement Machines - | <input type="checkbox"/> Concerts | <input type="checkbox"/> Theatrical Performances |
| How many screens? _____ | How many? _____ | Approx. # per year? _____ | Approx. # per year? _____ |
| <input type="checkbox"/> Other: _____ | | | |

No entertainment changes can take place until approved by Common Council and a new license has been issued and posted on the premises.

3. REMOVING ENTERTAINMENT

If applicable, list any entertainment you wish to remove:

4. PROMOTERS/SOUND AMPLIFICATION

Will promoters ever be used for any of the entertainment? No Yes If Yes, Describe:

At any time will sound amplification be used? No Yes If Yes, Describe:

5. NOTARIZED SIGNATURES

I understand that after the license has been issued, a change to the plan of operation will require a written request to change and approval from the Common Council.

I agree to inform the City Clerk within 10 days of any substantial changes in the information supplied in this application.

I understand that I shall not willfully refuse to provide the services offered under this license, or add charges or require deposits not required of the general public because of race, color, sex, religion, national origin or ancestry, age, handicap, lawful source of income, marital status, sexual orientation, gender identity or expression, familial status or the fact that a person is now or has been a member of the military service, whether dressed in uniform or not; and shall not seek such information as a condition of employment, or penalize any employee or discriminate in the selection of personnel for training or promotion on the basis of such information.

I have knowledge of the City Ordinances currently regulating public entertainment, and understand that the license may be subject to suspension, non-renewal or revocation, if I violate any rule, law or regulation of the city of Milwaukee and State of Wisconsin.

SUBSCRIBED AND SWORN TO BEFORE ME

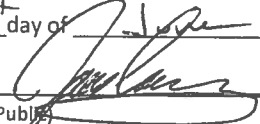
This 26th day of June

 (Clerk/Notary Public)

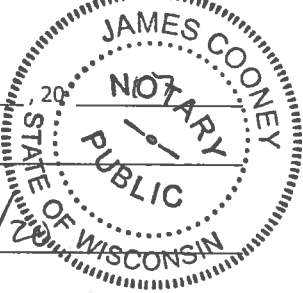



 Agent/20% or More Shareholder/Partner

 Additional 20% or More Shareholder/Partner

My Commission Expires 3/2/20
 *Notary Seal must be affixed.



CITY OF MILWAUKEE
OFFICE OF THE CITY CLERK

Wednesday, July 05, 2017

COMMITTEE MEETING NOTICE

AD 06

Devida M Glover
3532 N 14th St
Milwaukee, WI 53206

You are requested to attend a hearing which is to be held in Room 301-B, Third Floor, City Hall on:

Tuesday, July 18, 2017 at 11:00 AM

Regarding: Your Class B Tavern, Food Dealer, and Public Entertainment Premises License Applications Requesting Jukebox, Bands, Karaoke, 4 Amusement Machines, Poetry Readings, Patrons Dancing, and 2 Pool Tables for "4th Quarter" at 2722 N MARTIN L KING JR DR.



There is a possibility that your application may be denied for one or more of the following reasons: The recommendation of the committee regarding the application shall be based on evidence presented at the hearing. Per MCO 85-2.7-4, probative evidence concerning whether or not a new license should be granted may be presented on the following subjects: whether or not the applicant meets the municipal requirements, the appropriateness of the location and premises where the licensed premises is to be located and whether use of the premises for the purposes or activities permitted by the license would tend to facilitate a public or private nuisance or create undesirable neighborhood problems such as disorderly patrons, unreasonably loud noise, litter, and excessive traffic and parking congestion. Probative evidence relating to these matters may be taken from the plan of operation submitted with the license application, if any, but shall not include the content of any music. Evidence regarding the fitness of the location of the premises to be maintained as the principal place of business, including but not limited to whether there is an overconcentration of businesses of the type for which the license is sought; whether the proposal is consistent with any pertinent neighborhood business or development plans, or the location's proximity to areas where children are typically present. The applicant's record in operating similarly licensed premises; and whether or not the applicant has been charged with or convicted of any felony, misdemeanor, municipal offense or other offense, the circumstances of which substantially relate to the activity to be permitted by the license being applied for or any other factor which reasonably relates to the public health, safety or welfare may also be considered. See attached police report or correspondence.

Notice for applicants with warrants or unpaid fines: Proof of warrant satisfaction or payment of fines must be submitted at the hearing on the above date and time. Failure to comply with this requirement may result in a delay of the granting/denial of your application.

Failure to appear at this meeting may result in the denial of your license. Individual applicants must appear only in person or by an attorney. Corporate or Limited Liability applicants must appear only by the agent designated on the application or by an attorney. Partnership applicants must appear by a partner listed on the application or by an attorney. If you wish to do so and at your own expense, you may be accompanied by an attorney of your choosing to represent you at this hearing.

You will be given an opportunity to speak on behalf of the application and to respond and challenge any charges or reasons given for the denial. No petitions can be accepted by the committee, unless the people who signed the petition are present at the committee hearing and willing to testify. You may present witnesses under oath and you may also confront and cross-examine opposing witnesses under oath. If you have difficulty with the English language, you should bring an interpreter with you, at your expense, so that you can answer questions and participate in your hearing.

You may examine the application file at this office during regular business hours prior to the hearing date. Inquiries regarding this matter may be directed to the person whose signature appears below.

Limited parking for persons attending meetings in City Hall is available at reduced rates (5 hour limit) at the Milwaukee Center on the southwest corner of East Kilbourn and North Water Street. Parking tickets must be validated in the first floor information booth in City Hall.

PLEASE NOTE: Upon reasonable notice, efforts will be made to accommodate the needs of disabled individuals through sign language interpreters or other auxiliary aids. For additional information or to request this service, contact the Council Services Division ADA Coordinator at (414) 286-2998, Fax - (414) 286-3456, TDD - (414) 286-2025.

JIM OWCZARSKI, CITY CLERK

BY:

Jessica Ceella
License Division Manager

If you have questions regarding this notice, please contact the License Division at (414) 286-2238.

200 E. Wells Street, Room 105, City Hall, Milwaukee, WI 53202. www.milwaukee.gov/license
Phone: (414) 286-2238 Fax: (414) 286-3057 Email Address: License@milwaukee.gov

Date:6/20
Officer: Brown

City of Milwaukee Police Department
90-5-1.5 Crime Prevention Survey
Tavern Inspection

Name of Premise: 4th Quarter Sports Bar
Address: 2722 N. MLK
Phone:

Owner: Glover, Devida
Owner address: 3532 N. 14th St.
City State Zip: Milw, WI 53206
Owner Phone: 414-236-1138
Owner email: devidaap@att.net

Licensee/Agent: Same
Home Address:
City State Zip:
Phone:
Email:

Preferred contact: Agent

Location currently open: YES ~~NO~~

Projected open date: 08/01/17

Day's open: S M T W Th F SA ALL

Hours of Operation: Sun: 10A-2A 24 hours Y N
Mon: 10A-2A
Tue: 10A-2A
Wed: 10A-2A
Thu: 10A-230A
Fri: 10A-230A
Sat: 10A-230A

Premise Type: Tavern/Bar
Restaurant
Other:

Licenses currently held:

- Alcohol: Yes No Class: #:
- Tobacco: Yes No #:
- Food: Yes No #:
- Extended Hours: Yes No #:
- Secondhand Dealer: Yes No Type: #:
- Other: Yes No Type: #:
- Other: Yes No Type: #:

Exterior Survey:

1. Is the area around the location clean? Yes No
2. What surrounds the location? (Check all the apply)
 - a. Park
 - b. School
 - c. Youth Center
 - d. Church
 - e. Tavern(s) If so, how many
 - f. Residential
 - g. Other businesses
 - h. Other:
3. Can you see from the outside of the location into the interior Yes No
4. Can you see the employees inside of the location from the outside Yes No
5. Are exterior windows free of signage Yes No
6. Is there a parking lot Yes No
7. Is the parking lot clean? Yes No
8. Off-Street parking Yes No
9. Is the parking lot well lit? Yes No
10. Valet Parking Yes No
 - a. Will this lot have a guard? Yes No
 - b. Will this lot have cameras? Yes No
11. Are there areas where a person could conceal themselves Yes No
12. Is there exterior lighting? Yes No. Does it appear to be adequate Yes No
13. Exterior Payphone? Yes No
14. Are there No Loitering Signs posted? Yes No
15. Are there exterior security cameras Yes No How Many: 4 5
16. Are the address numbers prominently displayed and easy to see Yes No

Camera Survey:

17. Does this location have security cameras? Yes No
18. Are they in working order? Yes No
19. What format are the cameras?
 - a. Color Yes No
 - b. Digital Yes No
 - c. Recorded Yes No
20. How long is footage stored for later viewing:
21. Are there exterior cameras Yes No How many: 5
22. Are there interior cameras Yes No How many: 5
23. Do all employees know how to retrieve recorded digital images/footage? Yes No

24. Cameras located in parking lot Yes No How many 3

Interior Survey:

25. What is the planned capacity 160
26. What is the minimum number of employees That will be on premise 3
27. Is the storeowner willing to be a standing complainant regarding loitering? Yes No
a. If yes have them fill out the standing complaint form and give them two of the commercial signs Yes No
28. Is the interior of the location neat and clean? Yes No
29. Does an interior camera face the entrance/exit? Yes No
30. Is there a lockable area that separates employees from customers? Yes No
31. Are emergency and non-emergency numbers posted near the phone? Yes No
32. Does the owner know how to contact their police district directly? Yes No
a. Did you provide a district contact guide to the owner? Yes No

Security

33. How many security personnel are going to be employed: |
34. How ill they be deployed: Interior | Exterior |
35. What days will they be deployed Mon Tue Wed Thu Fri Sat Sun
36. Will the security be managed by business or contracted
37. Will they be armed Yes No
38. What type of security measures to be used:
 Wanding/metal detector
 ID Scanner
 Dress Code
 Cover Charge
 Age restriction
 Other

ADDITIONAL COMMENTS/RECOMMENDATIONS:

Alcohol concentration for 2722 N Martin Luther King Jr DR

City of Milwaukee, Wisconsin

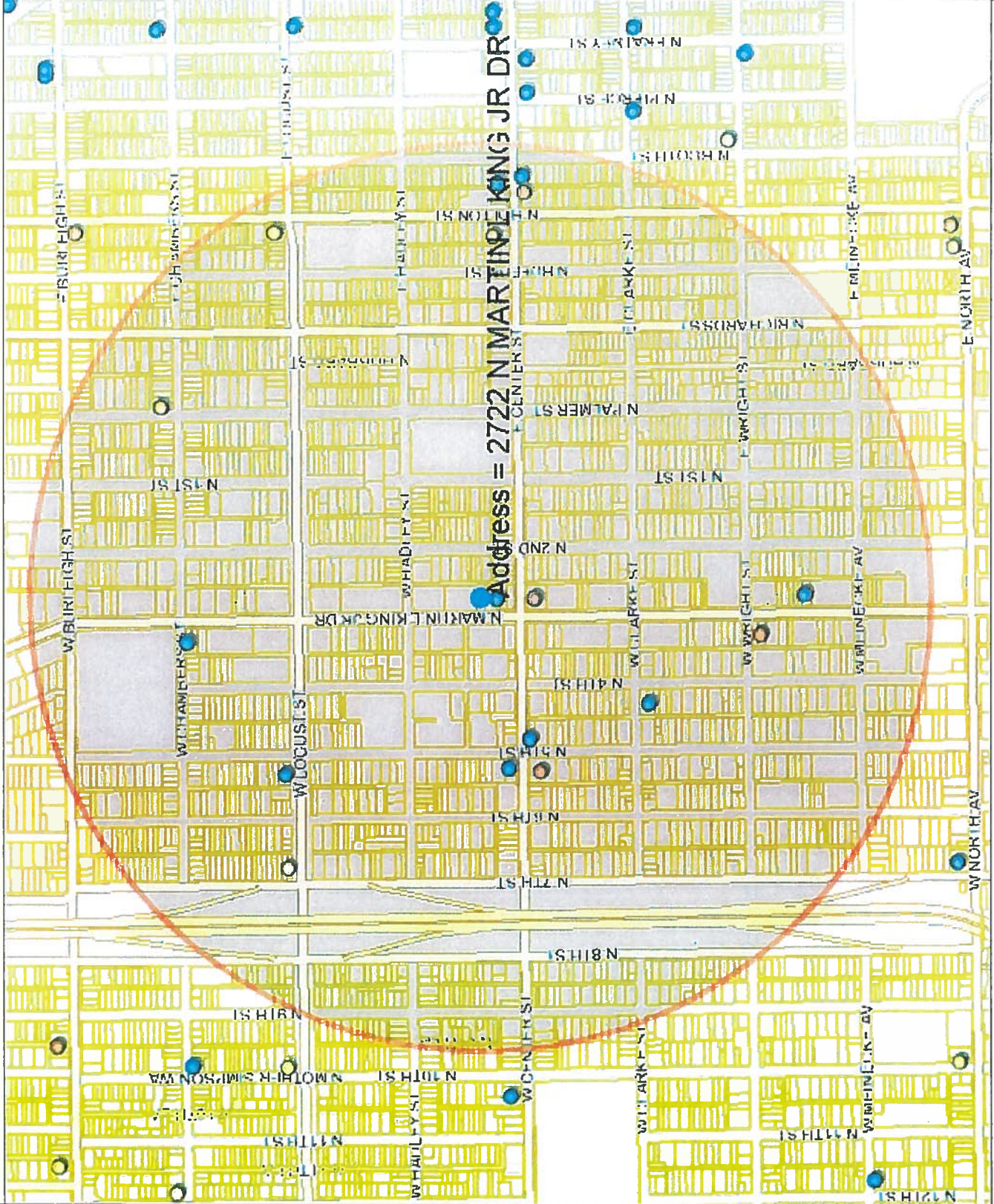



Wednesday, July 05, 2017



Notice of Public Hearing

GLOVER, Devida M
4th Quarter at 2722 N MARTIN L KING JR DR
Class B Tavern, Food Dealer, and Public Entertainment Premises License Applications
Requesting Jukebox, Bands, Karaoke, 4 Amusement Machines, Poetry Readings, Patrons
Dancing, and 2 Pool Tables

Tuesday, July 18, 2017 at 11:00 AM

To whom it may concern:

The above application has been made by the above named applicant(s). This requires approval from the Licenses Committee and the Common Council of the City of Milwaukee. The hearing before the Licenses Committee will take place on 7/18/2017 at 11:00 AM, in Room 301-B, Third Floor, City Hall. If you wish, you may provide testimony at the hearing regarding the request; see below for further information. You are not required to attend the hearing. Once the Licenses Committee makes its recommendation, this recommendation is forwarded to the full Common Council for approval at its next regularly scheduled hearing. Please review the information below and if you have further questions regarding this process, please contact the License Division at (414) 286-2238.

Important details for those wishing to provide information for the Licenses Committee to consider when making its recommendation:

1. The license application is scheduled to be heard at the above time. Due to other hearings running longer than scheduled, you may have to wait some time to provide your testimony.
2. You must appear in person and testify as to matters that you have personally experienced or seen. (You cannot provide testimony for your neighbor, parent or anyone else; this is considered hearsay and cannot be considered by the committee.)
3. No letters or petitions can be accepted by the committee (unless the person who wrote the letter or the persons who signed the petition are present at the committee hearing and willing to testify).
4. Persons opposed to the license application are given the opportunity to testify first; supporters may testify after the opponents have finished.
5. When you are called to testify, you will be sworn in and asked to give your name, and address. (If your first and/or last names are uncommon please spell them.)
6. You may then provide testimony.
 - a. Include only information relating to the above license application.
 - b. Include only information you have personally witnessed or seen.
 - c. Provide concise and relevant information detailing how this business has affected or may affect the peaceful enjoyment of your neighborhood.
 - d. If by the time you have the opportunity to testify, the information you wish to share has already been provided to the committee, you may state that you agree with the previous testimony. Redundant or repetitive testimony will not assist the committee in making its recommendation.
7. After giving your testimony, the members of the Licenses Committee and the licensee may ask questions regarding the testimony you have given or other factors relating to the license application.
8. Business Competition is not a valid basis for denial or non-renewal of a license.
Please Note: If you have submitted an objection to the above application your objection cannot be considered by the committee unless you personally testify at the hearing.

OCCUPANT	MAIL ADDRESS	CITY AND ZIP CODE
CURRENT OCCUPANT	2724 N 4TH ST	MILWAUKEE, WI 53212-2316
CURRENT OCCUPANT	2719 N DR MARTIN LUTHER KING DR 304	MILWAUKEE, WI 53212-2382
CURRENT OCCUPANT	2719 N DR MARTIN LUTHER KING DR 305	MILWAUKEE, WI 53212-2382
CURRENT OCCUPANT	2727 N 2ND ST	MILWAUKEE, WI 53212-2407
CURRENT OCCUPANT	2774 N DR MARTIN LUTHER KING DR 203	MILWAUKEE, WI 53212-2373
CURRENT OCCUPANT	2774 N DR MARTIN LUTHER KING DR 202	MILWAUKEE, WI 53212-2373
CURRENT OCCUPANT	2774 N DR MARTIN LUTHER KING DR 307	MILWAUKEE, WI 53212-2374
CURRENT OCCUPANT	310 W CENTER ST C	MILWAUKEE, WI 53212-2755
CURRENT OCCUPANT	216 W CENTER ST	MILWAUKEE, WI 53212-2863
CURRENT OCCUPANT	212 W CENTER ST	MILWAUKEE, WI 53212-2863
CURRENT OCCUPANT	2722 N 4TH ST	MILWAUKEE, WI 53212-2316
CURRENT OCCUPANT	2719 N DR MARTIN LUTHER KING DR 204	MILWAUKEE, WI 53212-2382
CURRENT OCCUPANT	2719 N DR MARTIN LUTHER KING DR 308	MILWAUKEE, WI 53212-2382
CURRENT OCCUPANT	2719 N DR MARTIN LUTHER KING DR 312	MILWAUKEE, WI 53212-2382
CURRENT OCCUPANT	2730 N 4TH ST	MILWAUKEE, WI 53212-2316
CURRENT OCCUPANT	2739A N 2ND ST	MILWAUKEE, WI 53212-2407
CURRENT OCCUPANT	2774 N DR MARTIN LUTHER KING DR 208	MILWAUKEE, WI 53212-2373
CURRENT OCCUPANT	310 W CENTER ST B	MILWAUKEE, WI 53212-2755
CURRENT OCCUPANT	2719 N DR MARTIN LUTHER KING DR 201	MILWAUKEE, WI 53212-2382
CURRENT OCCUPANT	2719 N DR MARTIN LUTHER KING DR 205	MILWAUKEE, WI 53212-2382
CURRENT OCCUPANT	2719 N DR MARTIN LUTHER KING DR 206	MILWAUKEE, WI 53212-2382
CURRENT OCCUPANT	2719 N DR MARTIN LUTHER KING DR 310	MILWAUKEE, WI 53212-2382
CURRENT OCCUPANT	2774 N DR MARTIN LUTHER KING DR 304	MILWAUKEE, WI 53212-2374
CURRENT OCCUPANT	2710 N DR MARTIN LUTHER KING DR	MILWAUKEE, WI 53212-2312
CURRENT OCCUPANT	2712 N 4TH ST	MILWAUKEE, WI 53212-2316
CURRENT OCCUPANT	2716 N 4TH ST	MILWAUKEE, WI 53212-2316
CURRENT OCCUPANT	2719 N DR MARTIN LUTHER KING DR 301	MILWAUKEE, WI 53212-2382
CURRENT OCCUPANT	2774 N DR MARTIN LUTHER KING DR 302	MILWAUKEE, WI 53212-2374
CURRENT OCCUPANT	2705 N 2ND ST	MILWAUKEE, WI 53212-2407
CURRENT OCCUPANT	2710 N 4TH ST	MILWAUKEE, WI 53212-2316
CURRENT OCCUPANT	2719 N DR MARTIN LUTHER KING DR 209	MILWAUKEE, WI 53212-2382
CURRENT OCCUPANT	2719 N DR MARTIN LUTHER KING DR 309	MILWAUKEE, WI 53212-2382
CURRENT OCCUPANT	2719 N DR MARTIN LUTHER KING DR 311	MILWAUKEE, WI 53212-2382
CURRENT OCCUPANT	2724 N DR MARTIN LUTHER KING DR 4	MILWAUKEE, WI 53212-2312
CURRENT OCCUPANT	2747A N 2ND ST	MILWAUKEE, WI 53212-2407
CURRENT OCCUPANT	2751 N 2ND ST	MILWAUKEE, WI 53212-2407
CURRENT OCCUPANT	2774 N DR MARTIN LUTHER KING DR 201	MILWAUKEE, WI 53212-2373
CURRENT OCCUPANT	2774 N DR MARTIN LUTHER KING DR 209	MILWAUKEE, WI 53212-2373
CURRENT OCCUPANT	2774 N DR MARTIN LUTHER KING DR 204	MILWAUKEE, WI 53212-2373
CURRENT OCCUPANT	2774 N DR MARTIN LUTHER KING DR 207	MILWAUKEE, WI 53212-2373
CURRENT OCCUPANT	2714 N 4TH ST	MILWAUKEE, WI 53212-2316
CURRENT OCCUPANT	2720 N 4TH ST	MILWAUKEE, WI 53212-2316
CURRENT OCCUPANT	2719 N DR MARTIN LUTHER KING DR 202	MILWAUKEE, WI 53212-2382
CURRENT OCCUPANT	2719 N DR MARTIN LUTHER KING DR 307	MILWAUKEE, WI 53212-2382
CURRENT OCCUPANT	2724 N DR MARTIN LUTHER KING DR 2	MILWAUKEE, WI 53212-2312
CURRENT OCCUPANT	2774 N DR MARTIN LUTHER KING DR 303	MILWAUKEE, WI 53212-2374
CURRENT OCCUPANT	2774 N DR MARTIN LUTHER KING DR 305	MILWAUKEE, WI 53212-2374
CURRENT OCCUPANT	2774 N DR MARTIN LUTHER KING DR 306	MILWAUKEE, WI 53212-2374
CURRENT OCCUPANT	2774 N DR MARTIN LUTHER KING DR 301	MILWAUKEE, WI 53212-2374
CURRENT OCCUPANT	2774 N DR MARTIN LUTHER KING DR 308	MILWAUKEE, WI 53212-2374
CURRENT OCCUPANT	2705 N DR MARTIN LUTHER KING DR D	MILWAUKEE, WI 53212-2385
CURRENT OCCUPANT	2719 N DR MARTIN LUTHER KING DR 211	MILWAUKEE, WI 53212-2382
CURRENT OCCUPANT	2719 N DR MARTIN LUTHER KING DR 302	MILWAUKEE, WI 53212-2382
CURRENT OCCUPANT	2724 N DR MARTIN LUTHER KING DR 1	MILWAUKEE, WI 53212-2312
CURRENT OCCUPANT	2739 N 2ND ST	MILWAUKEE, WI 53212-2407

CURRENT OCCUPANT 2774 N DR MARTIN LUTHER KING DR 309 MILWAUKEE, WI 53212-2374
CURRENT OCCUPANT 2774 N DR MARTIN LUTHER KING DR 206 MILWAUKEE, WI 53212-2373
CURRENT OCCUPANT 2759 N 2ND ST MILWAUKEE, WI 53212-2407
CURRENT OCCUPANT 2719 N DR MARTIN LUTHER KING DR 303 MILWAUKEE, WI 53212-2382
CURRENT OCCUPANT 2719 N DR MARTIN LUTHER KING DR 203 MILWAUKEE, WI 53212-2382
CURRENT OCCUPANT 2719 N DR MARTIN LUTHER KING DR 306 MILWAUKEE, WI 53212-2382
CURRENT OCCUPANT 2714 N DR MARTIN LUTHER KING DR MILWAUKEE, WI 53212-2312
CURRENT OCCUPANT 2724 N DR MARTIN LUTHER KING DR 3 MILWAUKEE, WI 53212-2312
CURRENT OCCUPANT 2728 N 4TH ST MILWAUKEE, WI 53212-2316
CURRENT OCCUPANT 2747 N 2ND ST MILWAUKEE, WI 53212-2407
CURRENT OCCUPANT 2774 N DR MARTIN LUTHER KING DR 205 MILWAUKEE, WI 53212-2373
CURRENT OCCUPANT 2761 N 2ND ST MILWAUKEE, WI 53212-2407
CURRENT OCCUPANT 2705 N DR MARTIN LUTHER KING DR E MILWAUKEE, WI 53212-2385
CURRENT OCCUPANT 2705 N DR MARTIN LUTHER KING DR F MILWAUKEE, WI 53212-2385
CURRENT OCCUPANT 200 W CENTER ST MILWAUKEE, WI 53212-2863
CURRENT OCCUPANT 2705 N 2ND ST A MILWAUKEE, WI 53212-2407

Total Records: 72

Radius: 250.0 feet and Center of Circle: 2722 N Martin L King Jr DR



Wednesday, July 05, 2017

Licenses Committee Notice of Hearing

Yusuf Dahl
PO Box 72007
Milwaukee, WI 53212

Date: 7/18/2017
Time: 11:00 AM
Location: Room 301-B, Third Floor, City Hall

The Licenses Committee will consider the following license application:

Class B Tavern, Food Dealer, and Public Entertainment Premises License
Applications Requesting Jukebox, Bands, Karaoke, 4 Amusement Machines, Poetry
Readings, Patrons Dancing, and 2 Pool Tables
Devida M Glover
4th Quarter at 2722 N MARTIN L KING JR DR

Please note this application may be recommended for denial based on fitness of the location due to concentration of alcohol beverage outlets in the area. If the application is denied for this reason, no other application for an alcohol beverage license for this location shall be recommended for approval by the Licenses Committee within three years of the date of denial unless the applicant has demonstrated a change of circumstances since the prior denial.

If you have any questions, please call (414) 286-2238.





Wednesday, July 05, 2017

Licenses Committee Notice of Hearing

Joe Dahl
PO Box 72007
Milwaukee, WI 53212

Date: 7/18/2017
Time: 11:00 AM
Location: Room 301-B, Third Floor, City Hall

The Licenses Committee will consider the following license application:

Class B Tavern, Food Dealer, and Public Entertainment Premises License
Applications Requesting Jukebox, Bands, Karaoke, 4 Amusement Machines, Poetry
Readings, Patrons Dancing, and 2 Pool Tables
Devida M Glover
4th Quarter at 2722 N MARTIN L KING JR DR

Please note this application may be recommended for denial based on fitness of the location due to concentration of alcohol beverage outlets in the area. If the application is denied for this reason, no other application for an alcohol beverage license for this location shall be recommended for approval by the Licenses Committee within three years of the date of denial unless the applicant has demonstrated a change of circumstances since the prior denial.

If you have any questions, please call (414) 286-2238.





BUSINESS LICENSE PLAN OF OPERATION

ccl-busplan 9/26/16

Office of the City Clerk License Division
200 E. Wells St. Room 105, Milwaukee, WI 53202
(414) 286-2238 www.milwaukee.gov/license e-mail address: license@milwaukee.gov

1. Type of Business

Applying for: Extended Hours (12AM to 5AM) - If a food establishment, check all that apply: Delivery Drive Thru Dining Room
 Self Service Laundry Massage Establishment Filling Station
 Other (supplemental application for specific license also required)

Provide a detailed description of the type of business you plan on operating:

SPORTS BAR and GRILL

Do you have any experience operating this type of business? No Yes If yes, explain: currently for Bestfriends

2. Business Operations

- a. Proposed Opening Date: Aug 1 19
- b. Is this premise under construction? No Yes If yes, list estimated completion date: _____
- c. Is this a franchise? No Yes
- d. Is this premises currently licensed? No Yes If yes, list type of license: _____
- e. Is the current licensee operating? No Yes If no, list date closed: _____
- f. Do you have future plans for other businesses, licenses or permits at this location? No Yes
If yes, explain: _____
- g. Have you previously held an Extended Hours License in Milwaukee? No Yes
If yes, list address(es): _____
- h. Are other businesses operating in the same building? No Yes If yes, describe: _____

3. Litter & Noise

- a. How are grounds kept clean? Sweep Pressure Wash Pick Up Litter Other: _____
- b. How often will grounds be cleaned? Daily Weekly As Needed Monthly Other: _____
- c. Grounds cleaned by: Licensee Building Owner Employees Hired Maintenance Other: _____
- d. How are noise issues prevented and/or addressed? Security Manager approaches customer(s) Call Police
 Signs Posted Other: _____
- e. Will a sound amplification system be used? No Yes If yes, describe: _____

4. Smoking & Sanitation

- a. Are there designated outdoor smoking areas? No Yes If yes, describe: _____
- b. Number of Garbage Cans: Inside: 0 Locations: Kitchen, Bathrooms, BACK area and BAR
Outside: 2 Locations: REAR OF BUILDING
- c. Is a crowd control barrier used? No Yes If yes, describe: _____
- d. How many restrooms are on the premises? 2
- e. Name of solid waste contractor: Advanced Disposal Waste Management Other: _____

5. Security

- a. Are there onsite parking spaces? No Yes If yes, indicate how many? 12 and describe the parking security plan: Camera + lighting
- b. Is there a loading zone? No Yes If yes, describe the loading area security plan: _____
- c. Will you have security personnel on premise? No Yes If yes, how many? 2 and answer the following:
 What are their responsibilities? Safety of customers
 Is security equipment used? No Yes If yes, describe _____
 → List their licensing, certification, or training credentials in house
- d. Will there be security cameras? No Yes If yes, where? inside and outside
- e. Will searches/identification checks be done upon entry? No Yes If yes, describe Search by hand r

6. Percentage of Sales (must total 100%)

Alcohol <u>50</u> %	Food <u>40</u> %	Secondhand Merchandise _____%	Precious Metals & Gems _____%
Entertainment <u>10</u> %	Cigarettes _____%	_____%	_____%
Pawnbroker Activity _____%	Salvaged Materials _____% (such as scrap metal)	Personal Services (such as tattoo, body piercing, salon, tailor, tanning, etc.) _____%	Other _____% Describe: _____

7. Businesses/Licenses on the Premises (check all that apply):

Type 1

- Full Service Restaurant Cafe/Coffee Shop Deli or Fast Food Restaurant Private/Fraternal/Veterans Club
- Night Club Tavern Cocktail Lounge Teen Club
- Banquet Hall Sports Facility Bowling Alley
- Hotel/Motel : Number of Floors: _____ Rooming House: Number of Floors: _____
 Number of Rooms: _____ Number of Rooms: _____

Type 2

- Liquor Store Corner Store Supermarket Convenience Store
- Gas Station Amusement/Phonograph Distributor Recycling, Salvage or Towing
- Used Car Dealer Personal Service Establishment
 (such as tattoo business, hair salon, tailor, etc.) Recording Studio

What other licenses/permits will you hold at this location? (check all that apply)

- Occupancy Permit Cigarette & Tobacco Gas Station Extended Hours Class "B" Tavern Weights & Measures
- Secondhand Dealer Precious Metal & Gem Other: _____

8. Legal Capacity (only if a Type 1 premises in #7 above)

Capacity 100 (Call the Milwaukee Development Center at 414-286-8211 if you have questions.)

9. Premises Description

a. Identify all area(s) of the premises that will be used in operating this business (include areas used only for storage):

1st Floor 2nd Floor Basement Storage Patio Beer Garden Sidewalk Café Deck Rooftop

Other: Describe: _____

b. Describe Location: Major Thoroughfare Secondary Street Other: _____

c. Nearest Major Cross Street: Center

d. Describe Building: Free Standing Building Strip Mall Other: _____

e. Describe Premises Structure: Single Story Multi-Story - # of Stories _____ Other: _____

f. Describe Surrounding Area: Commercial Residential Industrial Other: _____

g. Building Owner Name: JOE DAHL Phone Number: 414-828-9397

Business Owner Address: metro management po Box 72007 milwaukee WI 53219

10. Hours of Operation & Customers

Will customers be entering the premises? No Yes

Day of the Week	Proposed Hours of Operation:		Estimated Number of Customers expected each day	Potential Age Range of Customers	Class B Tavern Applicant Only: Age Restriction (If none, write 'None')
	Open Time (include a.m. or p.m.)	Close Time (include a.m. or p.m.)			
Sunday	10 AM	2 AM	30	21-up	none
Monday	10 AM	2 AM	50	21-up	none
Tuesday	10 AM	2 AM	50	21-up	none
Wednesday	10 AM	2 AM	50	21-up	none
Thursday	10 AM	2 ³⁰ AM	60	21-up	none
Friday	10 AM	2 ³⁰ AM	100	25-up	none
Saturday	10 AM	2 ³⁰ AM	100	25-up	none

An Extended Hours Establishment License is required for any convenience store, filling station, personal service establishment (such as tattoo, body piercing, salon, tailor, tanning, etc.), recording studio or restaurant which is open between the hours of 12:00 a.m. and 5:00 a.m.

Alcohol Establishments Class A: 8:00 am to 9:00 pm Sunday thru Saturday
Permitted Hours of Operation: Class B: 6:00 am to 2:00 am Sunday thru Thursday, 6:00 am to 2:30 am Friday & Saturday

Entertainment Closing Hours: Indoors: Alcohol beverage establishments: Same as alcohol license hours
Non-alcohol establishments: 1:00 am Sunday thru Thursday, 1:30 am Friday & Saturday
Outdoors: All establishments: 10:00 pm Sunday thru Thursday, 12:00 am Friday & Saturday
(unless otherwise approved by the Common Council in licensee's plan of operation)

11. Signature(s)

[Signature]
Sole Proprietor, Partner, Agent, or 20% or more Shareholder

Signature of additional partner or 20% or more Shareholder

See Application Information for a complete list of all required application forms.



ALCOHOL BEVERAGE & PUBLIC ENTERTAINMENT PREMISES SUPPLEMENTAL PLAN OF OPERATION

Office of the City Clerk License Division
200 E. Wells St. Room 105, Milwaukee, WI 53202
(414) 286-2238 e-mail address: license@milwaukee.gov www.milwaukee.gov/license

Legal Entity Name: DEVIDA GLOVER

Premise Address: 2722 W MLK DE MILW WI 53212

Proximity of Premises to Church, School, Daycare Center or Hospital

Is there at least 300 feet between the building and any church, school, daycare center or hospital? Yes No

"Service Bar Only" Designation

If applying for Class B or C license, are you applying for "Service Bar Only"? No Yes
Service Bar Only means customers cannot sit at the bar. Alcohol is served to patrons seated at tables. No stools, chairs or other articles of furniture shall be placed at the service bar for patrons to sit upon.

Business Information

- a) Are you taking out this application for anyone that may not be eligible for a license? No Yes
If yes, list name and address: _____
 - b) Will the agent, a partner or the individual licensee be conducting the day-to-day operations of the business? No Yes
If no, list the name and address of the person(s) who will: _____
- Class B Applicants: If the agent, a partner or the individual licensee will not be conducting the day-to-day operations of the business, the person(s) listed above must obtain a Class B Managers license.
- c) Does anyone else have money invested or any other interest in this business? No Yes
If yes, explain: _____
 - d) Have you made an agreement with anyone to repay any loan or any other payments based upon income from the business? No Yes If yes, list name and address: _____

Proof of Ownership, Lease, or Offer to Purchase (new & transfer applicants only)

Submit proof of ownership, lease, or offer to purchase the building with this application.
A lease or offer to purchase must:

- a) Be in the same legal entity name as that apply for the license
- b) Reflect the same address as the premises address on this application
- c) Reflect current dates and
- d) Be signed by the lessor/seller and lessee/buyer

Property Information (new & transfer applicants only)

- a) Do you own or lease the building? Own Lease
 - b) Who owns the fixtures (for example, coolers, etc.)? lessor
 - c) Are you purchasing the stock and/or fixtures? No Yes If yes, amount paid \$ _____
 - d) Total amount paid for business \$ 0
 - e) Total amount paid for goodwill of the business \$ 0
- Goodwill comprises the reputation and customer relationships of an existing business. If the price you pay for the business exceeds the fair market value of all of the rest of the assets of the business, the excess may be considered goodwill.
- f) Have you made arrangements with the seller for payment of personal property taxes? No Yes

See Application Information for a list of all required application forms.

Lease Information (new & transfer applicants who are leasing the premises only)

- a) Date lease begins Aug 1 17 Ends Aug 1 18
- b) Monthly rental \$ 56.00
- c) Do you have an option to renew the lease? No Yes
- d) Does your lease allow for assignment to another party without the consent of the owner? No Yes
- e) For what length of time have you been guaranteed occupancy (number of years)? _____
- f) In addition to paying the monthly rental, will you have to pay anything additional to the owner of the building to guarantee performance of the lease? No Yes If yes, explain _____
- g) Does the present owner or occupancy object to the granting of your license? No Yes
If yes, explain _____

Change of Agent Applicants Only

Have there been any changes to the floor plan since the last application was submitted? No Yes
If no, a new floor plan is not required. If yes, submit a new floor plan and explain the change(s): _____

Notarized Signatures of Applicants

SUBSCRIBED AND SWORN TO BEFORE ME
This 2nd day of June

(Clerk/Notary Public)

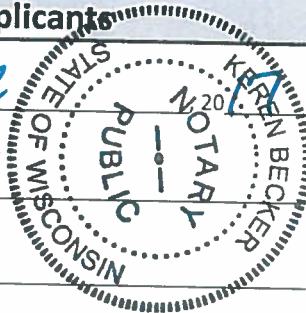

My Commission Expires 10/7/18
*Notary Seal must be affixed.

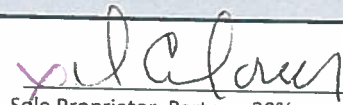

Sole Proprietor, Partner, 20% or more Shareholder, or
Agent – only if there are no 20% or more shareholders

Additional partner or 20% or more shareholder

Note: All information contained in this application is subject to approval by the Common Council.
Deviating from approved plan of operation will subject licensee to citations, and/or suspension or non-renewal of the license.
Contact the License Division for information on how to request changes.

New and transfer of premise applicants must submit the following:

- Proof of ownership, lease or offer to purchase the building
- Detailed floor plan
- If a restaurant, copy of the menu



PUBLIC ENTERTAINMENT PREMISES LICENSE SUPPLEMENTAL APPLICATION

Office of the City Clerk License Division
200 E. Wells St. Room 105, Milwaukee, WI 53202
(414) 286-2238 www.milwaukee.gov/license e-mail address: license@milwaukee.gov

TYPES OF ENTERTAINMENT (CHECK ALL THAT APPLY)

<input type="checkbox"/> Instrumental Musicians	<input checked="" type="checkbox"/> Bands	<input type="checkbox"/> Battle of the Bands	<input type="checkbox"/> Comedy Acts
<input type="checkbox"/> Disc Jockey	<input type="checkbox"/> Magic Shows	<input checked="" type="checkbox"/> Poetry Readings	<input type="checkbox"/> Dancing by Performers
<input checked="" type="checkbox"/> Jukebox	<input type="checkbox"/> Wrestling	<input type="checkbox"/> Patron Contests	<input checked="" type="checkbox"/> Patrons Dancing
<input type="checkbox"/> Adult Entertainment/ Strippers/Erotic Dance	<input checked="" type="checkbox"/> Karaoke	<input type="checkbox"/> Bowling Alley	<input checked="" type="checkbox"/> Pool Tables
<input type="checkbox"/> Motion Pictures	<input checked="" type="checkbox"/> Amusement Machines –	How many? _____	How many? <u>2</u>
How many? _____	How many? <u>4</u>	<input type="checkbox"/> Concerts	<input type="checkbox"/> Theatrical Performances
<input type="checkbox"/> Other: _____		Approx. # per year? _____	Approx. # per year? _____

Entertainment Indoor Hours: Alcohol beverage establishment: same as alcohol license hours.
Non-alcohol establishment: 10:30am to 1:00am Sun to Thurs; 1:30am Fri-Sat

Entertainment Outdoor Closing Hours: 10:00pm Sunday-Thurs; 12:00am Friday & Saturday; unless otherwise approved by Common Council.

PROMOTERS/SOUND AMPLIFICATION

Will promoters ever be used for any of the entertainment? No Yes If Yes, Describe:

At any time will sound amplification be used? No Yes If Yes, Describe:

LEGAL CAPACITY OF PREMISES

160 (Call the Development Center at 414-286-8211 with questions.) Legal capacity determines the fee for your Public Entertainment Premises License. If you would like to request the license be approved with a lower capacity than that listed above, indicate the lower capacity here: _____. If approved, this lower capacity will print on your license and override the capacity listed on your Occupancy Permit.

NOTARIZED SIGNATURES

I understand that after the license has been issued, a change to the plan of operation will require a written request to change and approval from the Common Council.

I agree to inform the City Clerk within 10 days of any substantial changes in the information supplied in this application.

I understand that I shall not willfully refuse to provide the services offered under this license, or add charges or require deposits not required of the general public because of race, color, sex, religion, national origin or ancestry, age, handicap, lawful source of income, marital status, sexual orientation, gender identity or expression, familial status or the fact that a person is now or has been a member of the military service, whether dressed in uniform or not; and shall not seek such information as a condition of employment, or penalize any employee or discriminate in the selection of personnel for training or promotion on the basis of such information.

I have knowledge of the City Ordinances currently regulating public entertainment, and understand that the license may be subject to suspension, non-renewal or revocation, if I violate any rule, law or regulation of the city of Milwaukee and State of Wisconsin.

SUBSCRIBED AND SWORN TO BEFORE ME

This 2nd day of June, 2016

[Signature]

(Clerk/Notary Public)

My Commission Expires 10/7/18

*Notary Seal must be affixed.

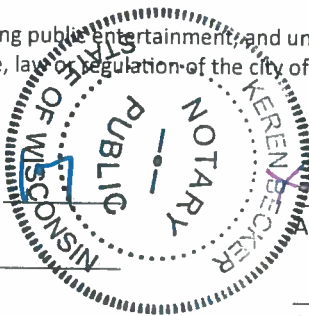

[Signature]

Agent/20% or More Shareholder/Partner

Additional 20% or More Shareholder/Partner

Office Use Only: Initials: _____ Filed: _____ App: _____

Check if only PEP (must be heard w/in 60 days) Granted _____ License # _____



FOOD DEALER LICENSE PLAN OF OPERATION

ccl-foodplan 8/1/16

OFFICE OF THE CITY CLERK, LICENSE DIVISION
CITY HALL, 200 E. WELLS ST, ROOM 105, MILWAUKEE, WI 53202
(414) 286-2238 • license@milwaukee.gov • www.milwaukee.gov/license

Legal Entity Name: DEVIDA GLOVER M

Premises Address: 2722 N MILK DR

SECTION 1 TYPE OF BUSINESS

Type of application (check one): taking over a currently operating business starting a new business

Anticipated opening date? Aug 1

Check the type that best describes your business (check only one):

See Food Dealer License Information sheet for definitions.

Restaurant

Retail Establishment

If retail, will it be a convenience store? Yes No

(less than 5,000 sq ft of retail space, primary business is the sale of basic food items, and in addition sells household products)

Community Food Program

Bed & Breakfast

Base for Food Peddler

Base for Temporary/Seasonal Food Stand

In addition, will any wholesale business be done? Yes No

If yes, what percentage of the business will be wholesale? Less than 25% 25% or More (Contact DATCP)*

Will retail items be sold? No Yes If Yes, indicate percentage of food sales _____ %

Will restaurant items be sold? No* Yes If Yes, indicate percentage of food sales 40 %

* If you checked "25% or More" of the business will be wholesale and answered "No" to restaurant items being sold, do not continue completing this application. A City of Milwaukee License is not required. Contact DATCP only.

SECTION 2 FOOD PROCESSING

Will any food processing be done? No Yes

Processing is defined as assembling, grinding, cutting, mixing, baking, coating, stuffing, packing, bottling, grilling, canning, extracting, fermenting, distilling, pickling, freezing, drying, smoking, or packaging.

If Yes, check the types of food items:

SNACKS & BEVERAGES

includes, but is not limited to, ice cream/soft serve, lemonade, snow cones, coffee, espresso, cappuccino, tea, fruit juice, smoothies, candy, dispensed soda, fruit cups, bakery, cookies, popcorn, kettle corn, cotton candy, funnel cakes, fritters, tortilla chips w/ cheese

MEALS

includes, but is not limited to, chicken, ribs, sandwiches, roasted corn, baked potatoes, hot dogs, brats, tacos, nachos w/ cheese and meat, French fries, cooked or deep fried vegetables/fruit, cooked cheese curds, corn dogs, egg rolls, salads

SECTION 3 HAZARDOUS FOODS

Will any hazardous food be sold? No Yes

Hazardous foods require temperature control (includes dairy products such as milk, cheese, and ice cream, fish shellfish, meat, poultry)

If yes, list the types of food items: Cheese chicken fish pork chops

SECTION 4 SHARED KITCHEN

Will you be sharing kitchen space with another operator?

- No If No, SKIP to Section 5
- Yes If Yes, check one:
 - I will rent space from another operator ("Shared Kitchen Agreement" is required)
 - I will rent space to another operator (peddler/caterer)

SECTION 5 DETAILS OF OPERATION

Answer the following questions:

- Will you have seating on site for dining? No Yes
- Will you be doing any catering? No Yes
- Will you be doing any delivery? No Yes
- Will you have outdoor activities? No Yes
 - If Yes to outdoor activities, check all that apply: Bar Cooking/Grilling Dining
- Will you have a drive thru window? No Yes
 - If Yes to drive thru, are hours different from inside? No Yes
 - If Yes, provide drive thru hours: _____
- Will any scales or barcode scanners be used? No Yes
 - If Yes, a Weights & Measures application must be completed and a license obtained.

SECTION 6 ADDITIONAL SITES

Where will food be prepared and/or sold?

- At a single site
 - At multiple sites (for example, a hotel with several dining rooms or bars) How many? _____
- If multiple sites, attach a Food Dealer Additional Site Addendum (ccl-foodadd) for each additional site.

SECTION 7 CONSTRUCTION OR CHANGES

Are you planning any construction, remodeling or equipment changes?

- No If No, SKIP to Section 6
- Yes If Yes, check all that apply:
 - New construction of a building
 - Construction changes to an existing building
 - Renovation or remodeling
 - Equipment changes only (installation or replacement)

Provide a brief description of the changes: _____

Start date: _____

Name, Address & Phone Number of Architect: _____

Name, Address & Phone Number of Contractor: _____

SECTION 8 ALCOHOL BEVERAGES

Are you applying for an alcohol beverage license?

No If No, SKIP to Section 9

Yes If YES, if your food license is approved prior to the alcohol beverage license, when do you want the food license issued? Immediately At the same time as the alcohol license

SECTION 9 ACKNOWLEDGEMENTS & SIGNATURE

You must initial each item confirming your understanding:

- DG I understand the Health Department must conduct an inspection and advise the License Division of their approval before the license may be issued.
- DG I understand I must obtain an occupancy permit from the Department of Neighborhood Services and an inspection may be required. Neighborhood Services must advise the License Division of their approval before the license may be issued.
- DG I understand the district alderperson will review and either approve or deny my application. If denied, I may appeal and be scheduled to appear before the Licenses Committee. The Licenses Committee will then make a recommendation to the Common Council. The Common Council must grant the license before it may be issued.
- DG I understand proof of payment for all license fees must be on file in the License Division before the license may be issued.
- DG I understand the license must be issued and posted in my establishment prior to opening for business.
- DG I will not operate my food business until the license has been issued and posted in the establishment.

Signature of sole proprietor, partner, agent or 20% shareholder: D Clower

Signature of additional partner(s): _____

144 ft x 30 ft
 PARKING

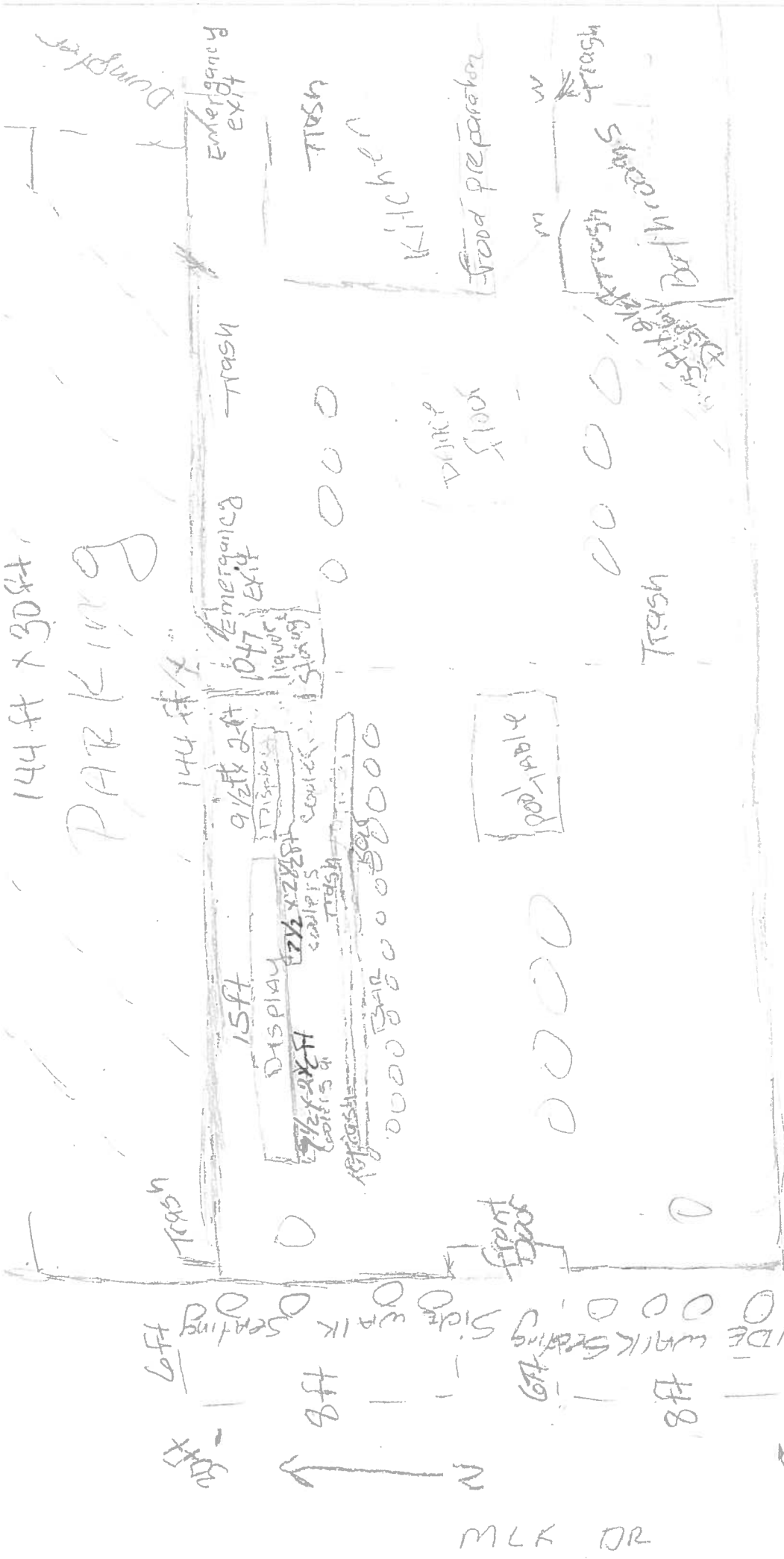

Total
 Square
 Footage
 4440

DEVIDA GLOVER - AGENT
 4TH QUARTER
 2728 N MLK DR.
 JUNE 2, 2017

APPETIZERS

- Basket of Seasoned Fries.....\$3.75
- Basket of Fried Pickles served with spicy house dressing\$5.75
- Mozzarella sticks served with Marinara sauce.....\$5.75
- Chicken Tenders Served with BBQ, Bleu cheese, Honey mustard or Ranch dressing.....\$6.00
- add Fries.....\$1.50
- Basket of Mushrooms served with Ranch dressings.....\$5.50
- Fried Okra.....\$4.75

SALADS

- Chicken Salad (Grilled or Fried) chicken breast over spring mix with onions, cucumber, tomatoes, chopped boiled eggs and cheddar cheese with the choice Italian, Ranch or French dressing.....\$7.00

Side Salad

- spring mix with cucumbers, tomatoes and cheese with choice of Italian, Ranch or French dressing.....\$4.00

SANDWICHES

- Chicken Breast (grilled or fried) served on bed of lettuce with tomatoes.....\$7.00
- Pork Chop (grilled or fried) served on bed of lettuce with tomatoes.....\$7.00
- Fish (Catfish, Perch or Tilapia) served on bed of lettuce.....\$7.00
- Best Friendz Corned Beef served on rye bread with choice of brown or yellow mustard, potato chip and pickle spear.....\$7.00
- Granny Hope Burger homemade burger served with lettuce tomatoes and onions.....\$7.00

- Best Friendz Klubhouse Burger 2 homemade burger parties served with lettuce, tomatoes, onions and jalapenos.....\$9.00
- add bacon.....\$1.50
- Turkey Burger served on bed of lettuce with tomatoes.....\$7.00

WINGS

- 5 Battered Whole Wings served with fries.....\$6.50
- add Ranch or Bleu Cheese.....\$.50
- 6 Sauced Wings with Celery Choose from these flavors:
BBQ, Bourbon, Caribbean Jerk, Teriyaki, Garlic Parmesan, Sweet and Tangy orange, Hot and Mango Habanero
- with choice of one Ranch or Bleu Cheese Dressing.....\$7.00
- add extra Ranch or Bleu cheese.....\$.50

PLATTERS

- Best Friendz Wing Platter choice of 4(24)wing Flavors with celery Ranch or Bleu Cheese Dressing.....\$22.00
- Best Friendz Appetizer Platter fried Pickles, Mozzarella sticks, Mushrooms and okra.....\$18.00

DINNERS

- Pork Chop (grilled or fried) 2 pork chops, bread, fries and coleslaw.....\$9.00

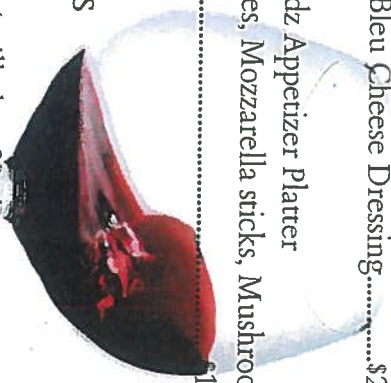

All sandwiches are served on a toasted bun or texas toast with fries.
Add cheese additional.....\$.50
Add bacon.....\$1.50

- Fish (grilled or fried) Catfish, Perch or Tilapia 2 fillers, bread, fries and coleslaw\$10.00

HAPPY HOUR

SUNDAY - THURSDAY 2PM - 6PM

\$3 BOTTOM SHELF

Smirnoff Seagrams Gin

\$4 MIDDLE SHELF

Crown Bacardi Grey goose

\$5 TOP SHELF

Patron

WEEKLY SPECIALS

TACO TUESDAY

\$1 Tacos \$5 Taco pizza and \$3 Margaritas

WING WEDNESDAY

5pm - 9pm

\$.50 wings \$2 domestic beer and \$3 margaritas

THURSDAY

Old school Thursday and Lady's Night

5pm - 9pm

\$1 Amsterdam Gin and Vodka Flavors

9pm - Midnight

**\$3 Strong Island Tequila Sunrise Paaty Dropper
and Jolly Ranchers**

FRIDAY

5pm - 9pm

\$5 Fish Basket \$2 Domestic Beer

\$3 Margaritas

SATURDAY

5pm - 8pm

\$.50 Wings



Hours of Operation

Open daily at 2pm

Closed Monday

Kitchen hours

Tuesday 4pm - Midnight

Wednesday 4pm - Midnight

Thursday 4pm - Midnight

Friday 4pm - 1am

Saturday 3pm - 1am

Sunday 3pm - 10pm

**BEST FRIENDZ
SPORTS BAR N GRILL**

A Great place for great people like you.

BEST FRIENDZ SPORTS BAR N GRILL

2722 N MLK DR Milwaukee WI 53212



**CITY OF MILWAUKEE
OFFICE OF THE CITY CLERK**

Wednesday, July 05, 2017

COMMITTEE MEETING NOTICE

AD 06

Mohanned Musaitif
432 E CHAMBERS St
Milwaukee, WI 53212

You are requested to attend a hearing which is to be held in Room 301-B, Third Floor, City Hall on:

Tuesday, July 18, 2017 at 11:00 AM

Regarding: Your Food Dealer Application for "M&M Food" at 432 E CHAMBERS St.

There is a possibility that your application may be denied for one or more of the following reasons: The recommendation of the committee regarding the application shall be based on evidence presented at the hearing. Per MCO 85-2.7-4, probative evidence concerning whether or not a new license should be granted may be presented on the following subjects: whether or not the applicant meets the municipal requirements, the appropriateness of the location and premises where the licensed premises is to be located and whether use of the premises for the purposes or activities permitted by the license would tend to facilitate a public or private nuisance or create undesirable neighborhood problems such as disorderly patrons, unreasonably loud noise, litter, and excessive traffic and parking congestion. Probative evidence relating to these matters may be taken from the plan of operation submitted with the license application, if any, but shall not include the content of any music. Evidence regarding the fitness of the location of the premises to be maintained as the principal place of business, including but not limited to whether there is an overconcentration of businesses of the type for which the license is sought; whether the proposal is consistent with any pertinent neighborhood business or development plans, or the location's proximity to areas where children are typically present. The applicant's record in operating similarly licensed premises; and whether or not the applicant has been charged with or convicted of any felony, misdemeanor, municipal offense or other offense, the circumstances of which substantially relate to the activity to be permitted by the license being applied for or any other factor which reasonably relates to the public health, safety or welfare may also be considered. See attached police report or correspondence.

Notice for applicants with warrants or unpaid fines:

Proof of warrant satisfaction or payment of fines must be submitted at the hearing on the above date and time. Failure to comply with this requirement may result in a delay of the granting/denial of your application.

Failure to appear at this meeting may result in the denial of your license. Individual applicants must appear only in person or by an attorney. Corporate or Limited Liability applicants must appear only by the agent designated on the application or by an attorney. Partnership applicants must appear by a partner listed on the application or by an attorney. If you wish to do so and at your own expense, you may be accompanied by an attorney of your choosing to represent you at this hearing.

You will be given an opportunity to speak on behalf of the application and to respond and challenge any charges or reasons given for the denial. No petitions can be accepted by the committee, unless the people who signed the petition are present at the committee hearing and willing to testify. You may present witnesses under oath and you may also confront and cross-examine opposing witnesses under oath. If you have difficulty with the English language, you should bring an interpreter with you, at your expense, so that you can answer questions and participate in your hearing.

You may examine the application file at this office during regular business hours prior to the hearing date. Inquiries regarding this matter may be directed to the person whose signature appears below.

Limited parking for persons attending meetings in City Hall is available at reduced rates (5 hour limit) at the Milwaukee Center on the southwest corner of East Kilbourn and North Water Street. Parking tickets must be validated in the first floor information booth in City Hall.

PLEASE NOTE: Upon reasonable notice, efforts will be made to accommodate the needs of disabled individuals through sign language interpreters or other auxiliary aids. For additional information or to request this service, contact the Council Services Division ADA Coordinator at (414) 286-2998, Fax - (414) 286-3456, TDD - (414) 286-2025.

JIM OWCZARSKI, CITY CLERK

BY: _____

Jessica Celella

License Division Manager

If you have questions regarding this notice, please contact the License Division at (414) 286-2238.

200 E. Wells Street, Room 105, City Hall, Milwaukee, WI 53202. www.milwaukee.gov/license
Phone: (414) 286-2238 Fax: (414) 286-3057 Email Address: License@milwaukee.gov



CITY OF MILWAUKEE
OFFICE OF THE CITY CLERK

Wednesday, July 05, 2017

COMMITTEE MEETING NOTICE

AD 06

Mohanned Musaitif
2121 W Bridge St
Milwaukee, WI 53221

You are requested to attend a hearing which is to be held in Room 301-B, Third Floor, City Hall on:

Tuesday, July 18, 2017 at 11:00 AM

Regarding: Your Food Dealer Application for "M&M Food" at 432 E CHAMBERS St.

There is a possibility that your application may be denied for one or more of the following reasons: The recommendation of the committee regarding the application shall be based on evidence presented at the hearing. Per MCO 85-2.7-4, probative evidence concerning whether or not a new license should be granted may be presented on the following subjects: whether or not the applicant meets the municipal requirements, the appropriateness of the location and premises where the licensed premises is to be located and whether use of the premises for the purposes or activities permitted by the license would tend to facilitate a public or private nuisance or create undesirable neighborhood problems such as disorderly patrons, unreasonably loud noise, litter, and excessive traffic and parking congestion. Probative evidence relating to these matters may be taken from the plan of operation submitted with the license application, if any, but shall not include the content of any music. Evidence regarding the fitness of the location of the premises to be maintained as the principal place of business, including but not limited to whether there is an overconcentration of businesses of the type for which the license is sought; whether the proposal is consistent with any pertinent neighborhood business or development plans, or the location's proximity to areas where children are typically present. The applicant's record in operating similarly licensed premises; and whether or not the applicant has been charged with or convicted of any felony, misdemeanor, municipal offense or other offense, the circumstances of which substantially relate to the activity to be permitted by the license being applied for or any other factor which reasonably relates to the public health, safety or welfare may also be considered. See attached police report or correspondence.

Notice for applicants with warrants or unpaid fines:

Proof of warrant satisfaction or payment of fines must be submitted at the hearing on the above date and time. Failure to comply with this requirement may result in a delay of the granting/denial of your application.

Failure to appear at this meeting may result in the denial of your license. Individual applicants must appear only in person or by an attorney. Corporate or Limited Liability applicants must appear only by the agent designated on the application or by an attorney. Partnership applicants must appear by a partner listed on the application or by an attorney. If you wish to do so and at your own expense, you may be accompanied by an attorney of your choosing to represent you at this hearing.

You will be given an opportunity to speak on behalf of the application and to respond and challenge any charges or reasons given for the denial. No petitions can be accepted by the committee, unless the people who signed the petition are present at the committee hearing and willing to testify. You may present witnesses under oath and you may also confront and cross-examine opposing witnesses under oath. If you have difficulty with the English language, you should bring an interpreter with you, at your expense, so that you can answer questions and participate in your hearing.

You may examine the application file at this office during regular business hours prior to the hearing date. Inquiries regarding this matter may be directed to the person whose signature appears below.

Limited parking for persons attending meetings in City Hall is available at reduced rates (5 hour limit) at the Milwaukee Center on the southwest corner of East Kilbourn and North Water Street. Parking tickets must be validated in the first floor information booth in City Hall.

PLEASE NOTE: Upon reasonable notice, efforts will be made to accommodate the needs of disabled individuals through sign language interpreters or other auxiliary aids. For additional information or to request this service, contact the Council Services Division ADA Coordinator at (414) 286-2998, Fax - (414) 286-3456, TDD - (414) 286-2025.

JIM OWCZARSKI, CITY CLERK

BY: _____

Jessica Celella
License Division Manager

If you have questions regarding this notice, please contact the License Division at (414) 286-2238.

June 16th, 2017

License Division
City Hall, Room 105
200 E. Wells St.
Milwaukee, WI 53202

To the License Committee of the Common Council,

My name is Mohanned Musaitif. I am trying to open a convenience store at 432 E. Chambers St. which is in the sixth district. I sent in an application for a Food Dealer License which has been denied.

I am writing this letter to request an appeal of the denial of my Food Dealer application. Please let me know what the next steps are in order for me to appeal the denial.

Thank you in advance for your cooperation.

Sincerely,

Mohanned Musaitif
M&M Food Owner

Cooney, James

From: Celella, Jessica
Sent: Wednesday, June 14, 2017 9:29 AM
To: Cooney, James
Cc: Kuether-Steele, Molly
Subject: FW: 432 e chambers

Please add.

From: Raden, Chad
Sent: Wednesday, June 14, 2017 9:27 AM
To: Celella, Jessica
Subject: 432 e chambers

Can you attach this to their record. The owner told me by phone that the food was for his house

Chad Raden
Police Sergeant
Milwaukee Police Department
License Investigation Unit
(414) 935-7455 craden@milwaukee.gov

Sent: Wednesday, June 14, 2017 9:24 AM
To: Raden, Chad
Subject:

REDACTED RECORD



Sent from my iPhone

Cooney, James

From: Celella, Jessica
Sent: Wednesday, June 14, 2017 9:29 AM
To: Cooney, James
Cc: Kuether-Steele, Molly
Subject: FW: 432 e chambers

Please add.

From: Raden, Chad
Sent: Wednesday, June 14, 2017 9:27 AM
To: Celella, Jessica
Subject: 432 e chambers

Can you attach this to their record. The owner told me by phone that the food was for his house

Chad Raden
Police Sergeant
Milwaukee Police Department
License Investigation Unit
(414) 935-7455 craden@milwaukee.gov

From: DENISE RUEDA [<mailto:rude1grl@gmail.com>]
Sent: Wednesday, June 14, 2017 9:24 AM
To: Raden, Chad
Subject:



Sent from my iPhone

Cooney, James

From: Celella, Jessica
Sent: Wednesday, June 14, 2017 8:53 AM
To: Cooney, James
Subject: Fw: FOOD 256340

Sent using OWA for iPhone

From: Raden, Chad
Sent: Wednesday, June 14, 2017 8:23:20 AM
To: Celella, Jessica
Subject: RE: FOOD 256340

We did go out there regarding an anonymous complaint. They were selling frozen foods and single cigarettes to which we cited

Chad Raden
Police Sergeant
Milwaukee Police Department
License Investigation Unit
(414) 935-7455 craden@milwaukee.gov

From: Celella, Jessica
Sent: Wednesday, June 14, 2017 8:09 AM
To: Raden, Chad
Subject: FW: FOOD 256340

FYI – 432 E Chambers

From: Cooney, James
Sent: Tuesday, June 13, 2017 9:36 AM
To: Celella, Jessica
Cc: Kuether-Steele, Molly
Subject: FOOD 256340

FYI,

This operator says that MPD is hassling him for selling pre-packaged non-hazardous foods. He's called twice each time asking if a myriad of food items fall under that category. He's listed most everything you would find in a grocery store except for meat, dairy and produce. Maybe there is more going on than I know. I just reiterated pre-pack, non-hazardous and told him to work it out with MPD. Also told him to contact Ald. Coggs regarding the pending application.

Thought you might want to know.

Jim Cooney
License Specialist III
City of Milwaukee, License Division

200 E Wells St #105 Milwaukee, WI 53202
414-286-2238



MILWAUKEE POLICE DEPARTMENT LICENSING

CRIMINAL RECORD/ORDINANCE VIOLATION/INCIDENTS SYNOPSIS

DATE: 06/14/2017

LICENSE TYPE: FOOD DEALER

NEW:

RENEWAL:

No. 256430

Application Date: 05/26/2017

License Location: 432 E. Chambers St.

Business Name: M&M Food

Licensee/Applicant: Mustaitif, Mohammed R.
(Last Name, First Name, MI)

Date of Birth: 06/09/1997

Home Address: 2121 W. Bridge St.

City: Milwaukee

Home Phone: 414-687-9234

State: WI **Zip Code:** 53221

This report is written by Police Officer Gilbert Gwinn, assigned to the License Investigation Unit, Days.

The Milwaukee Police Department's investigation regarding this application revealed the following:

1. On 06/06/2017 Milwaukee police conducted a licensed premise check at 432 E. Chambers (M&M Food). This check was based on an anonymous complaint that the store was selling food without the appropriate license and a check of LIRA indicating that a food dealer license had been applied for but not yet granted. Officers observed the freezer to be stocked with food. As officers discussed the issue, they observed open packs of cigarettes and a bucket containing loose change near the cash register. During this exchange, a customer entered the store and asked R. Mustaitif "can I get a single". R. Mustaitif denied selling single cigarettes. The applicant was issued two citations, Food License Required and Sell Cigarette in Package/Container w/o Stamp.

MILWAUKEE POLICE DEPARTMENT

REPORT OF INCIDENTS INVOLVING LICENSED PERSONS OR PREMISES

TO: Lieutenant Paris DOFFEK

Business Name: M & M Food
Address of Licensed Premises: 432 E. Chambers
Business Phone: 414-687-9234

Type of License: Tobacco

District: 5

Violation / Incident #

Date of Incident: 06/06/17

Licensee or Manager on premises at time of violation / incident? Yes No

Licensee cooperative? Yes No (if no, explain in narrative section)

Licensee Notified by Officer: PO Penny Brown

Date: 06/06/17

Time: 11:30A

Licensee or Agent's Name: MUSTAITIF, Mohanned R.
Home Address: 2121 W. Bridge St. Milwaukee, WI 53221

Date of Birth: 06/09/97
Home Phone: 414-687-9234

Co-Licensee Name:
Home Address:
Class S License Number:

Date of Birth:
Home Phone:

Bartender Name:
Home Address:
Class D License Number:

Date of Birth:
Home Phone:

Licensed Person / Public Pass. Vehicle, etc.:
Home Address:
Class D License Number:

Date of Birth:
Home Phone:

VIOLATION/INCIDENT - DESCRIBE FACTS AND CIRCUMSTANCES IN NARRATIVE SECTION

Name of Person Cited: MUSTAITIF, Mohanned R.

Citation Number: J98107D6QC

Violation & Ord. / Statue No.: 106-30-3-e Cig in Pkg

Date of Birth: 06/09/97

Court Date: 07/21/17

Name of Person Cited: MUSTAITIF, Mohanned R.

Citation Number: J98107D6QD

Violation & Ord. / Statue No.: 68-21-1-a Food Lic Req

Date of Birth: 06/09/97

Court Date: 07/21/17

Name of Person Cited:

Citation Number:

Violation & Ord. / Statue No.:

Date of Birth:

Court Date:

Name of Person Cited:

Citation Number:

Violation & Ord. / Statue No.:

Date of Birth:

Court Date:

Name of Person Cited:

Citation Number:

Violation & Ord. / Statue No.:

Date of Birth:

Court Date:

Investigating Officer: PO Penny Brown

District / Bureau: LIU

Date: 06/07/17



Commanding Officer

6-9-17

Date

DISPOSITION - FOR LICENSING ONLY

Citation No.	Case Number	Disposition	Judge	Date
_____	_____	_____	_____	_____
_____	_____	LICENSE INVESTIGATION UNIT	_____	_____
_____	_____	Received <u>6-9-17</u>	_____	_____
_____	_____	Referred	_____	_____

By 

PA-33E Narrative

This report is written by PO Penny Brown assigned to the License Investigation Unit. On Tuesday, June 6, 2017, PO Denise Rueda and I conducted a license premise check at M & M Food, located at 432 E. Chambers. This was as a result of an anonymous complaint from a citizen they were selling food without a license.

Prior to arrival I checked LIRA (License Information and Reporting Administration), and found the only valid license for the establishment was a tobacco license. A food license application was on file, however, had not yet been granted. On arrival PO Rueda and I introduced ourselves to the sole employee on scene (Radeeh M. MUSTAITIF A/M 05/07/62. I requested to see the licenses, however, MUSTAITIF stated they were not open for business and were just installing AT & T services. I advised M. MUSTAITIF that I observed a customer exit the store on arrival and they could be open for business, I just needed to see the food license. M. MUSTAITIF was not able to provide any license and contacted the agent (Mohanned R. MUSTAITIF A/M 06/09/97) via telephone.

M. MUSTAITIF stated he applied for a food license, however, was aware he did not yet have one. M. MUSTAITIF stated his understanding was dry foods were allowed, not frozen. I advised M. MUSTAITIF that he was allowed to sell pre-packaged dry food, however, nothing that would require refrigeration. M. MUSTAITIF asked what other food I was talking about, to which I advised him of the freezer which was stocked with food.

As officers were discussing the issue we observed 2 open packs of Newport 100's cigarettes right next to the cash register. One pack contained 4, the other 14 single cigarettes. There was also a clear plastic bucket with mostly quarters and loose change. A customer then entered the store and asked R. MUSTAITIF "can I get a single". R. MUSTAITIF shook his head and said "no" quietly, as if to not alert officers to what was being requested. The customer then exited the store and PO RUEDA interviewed him outside and asked if he was trying to purchase a single cigarette. The customer did not want to provide PO RUEDA with his information, however, stated "yes, he buys them from the store often". I then asked R. MUSTAITIF if he was selling single cigarettes, to which he denied. I advised him that two open packs next to a register along with the loose change was evidence of this. R. MUSTAITIF continued to deny this. I advised M. MUSTAITIF of the situation and advised him the customer admitted he purchases them at his business and it is not legal. M. MUSTAITIF stated he understood and would not sell single cigarettes.



Wednesday, July 05, 2017



Notice of Public Hearing

MUSAITIF, Mohanned
M&M Food at 432 E CHAMBERS St
Food Dealer Application

Tuesday, July 18, 2017 at 11:00 AM

To whom it may concern:

The above application has been made by the above named applicant(s). This requires approval from the Licenses Committee and the Common Council of the City of Milwaukee. The hearing before the Licenses Committee will take place on 7/18/2017 at 11:00 AM, in Room 301-B, Third Floor, City Hall. If you wish, you may provide testimony at the hearing regarding the request; see below for further information. You are not required to attend the hearing. Once the Licenses Committee makes its recommendation, this recommendation is forwarded to the full Common Council for approval at its next regularly scheduled hearing. Please review the information below and if you have further questions regarding this process, please contact the License Division at (414) 286-2238.

Important details for those wishing to provide information for the Licenses Committee to consider when making its recommendation:

1. The license application is scheduled to be heard at the above time. Due to other hearings running longer than scheduled, you may have to wait some time to provide your testimony.
2. You must appear in person and testify as to matters that you have personally experienced or seen. (You cannot provide testimony for your neighbor, parent or anyone else; this is considered hearsay and cannot be considered by the committee.)
3. No letters or petitions can be accepted by the committee (unless the person who wrote the letter or the persons who signed the petition are present at the committee hearing and willing to testify).
4. Persons opposed to the license application are given the opportunity to testify first; supporters may testify after the opponents have finished.
5. When you are called to testify, you will be sworn in and asked to give your name, and address. (If your first and/or last names are uncommon please spell them.)
6. You may then provide testimony.
 - a. Include only information relating to the above license application.
 - b. Include only information you have personally witnessed or seen.
 - c. Provide concise and relevant information detailing how this business has affected or may affect the peaceful enjoyment of your neighborhood.
 - d. If by the time you have the opportunity to testify, the information you wish to share has already been provided to the committee, you may state that you agree with the previous testimony. Redundant or repetitive testimony will not assist the committee in making its recommendation.
7. After giving your testimony, the members of the Licenses Committee and the licensee may ask questions regarding the testimony you have given or other factors relating to the license application.
8. Business Competition is not a valid basis for denial or non-renewal of a license.
Please Note: If you have submitted an objection to the above application your objection cannot be considered by the committee unless you personally testify at the hearing.

OCCUPANT	MAIL ADDRESS	CITY AND ZIP CODE
CURRENT OCCUPANT	3032 N HOLTON ST	MILWAUKEE, WI 53212-2123
CURRENT OCCUPANT	3028A N HOLTON ST	MILWAUKEE, WI 53212-2123
CURRENT OCCUPANT	520 E CHAMBERS ST	MILWAUKEE, WI 53212-2509
CURRENT OCCUPANT	3003 N BOOTH ST	MILWAUKEE, WI 53212-2130
CURRENT OCCUPANT	2963 N HOLTON ST	MILWAUKEE, WI 53212-2523
CURRENT OCCUPANT	2965 N HOLTON ST	MILWAUKEE, WI 53212-2523
CURRENT OCCUPANT	3037A N HOLTON ST	MILWAUKEE, WI 53212-2122
CURRENT OCCUPANT	3033 N HOLTON ST	MILWAUKEE, WI 53212-2122
CURRENT OCCUPANT	515 E CHAMBERS ST	MILWAUKEE, WI 53212-2508
CURRENT OCCUPANT	3029 N HOLTON ST	MILWAUKEE, WI 53212-2122
CURRENT OCCUPANT	3019 N HOLTON ST	MILWAUKEE, WI 53212-2122
CURRENT OCCUPANT	420 E CHAMBERS ST	MILWAUKEE, WI 53212-2507
CURRENT OCCUPANT	3024 N HOLTON ST	MILWAUKEE, WI 53212-2123
CURRENT OCCUPANT	412 E CHAMBERS ST	MILWAUKEE, WI 53212-2507
CURRENT OCCUPANT	414A E CHAMBERS ST	MILWAUKEE, WI 53212-2507
CURRENT OCCUPANT	509 E CHAMBERS ST	MILWAUKEE, WI 53212-2508
CURRENT OCCUPANT	2958A N BUFFUM ST	MILWAUKEE, WI 53212-2514
CURRENT OCCUPANT	2958 N BUFFUM ST	MILWAUKEE, WI 53212-2514
CURRENT OCCUPANT	401 E CHAMBERS ST	MILWAUKEE, WI 53212-2506
CURRENT OCCUPANT	3002 N BUFFUM ST	MILWAUKEE, WI 53212-2113
CURRENT OCCUPANT	2961 N HOLTON ST	MILWAUKEE, WI 53212-2523
CURRENT OCCUPANT	3021 N HOLTON ST	MILWAUKEE, WI 53212-2122
CURRENT OCCUPANT	3023 N HOLTON ST	MILWAUKEE, WI 53212-2122
CURRENT OCCUPANT	3042 N HOLTON ST	MILWAUKEE, WI 53212-2123
CURRENT OCCUPANT	414 E CHAMBERS ST	MILWAUKEE, WI 53212-2507
CURRENT OCCUPANT	3025A N BOOTH ST	MILWAUKEE, WI 53212-2130
CURRENT OCCUPANT	409A E CHAMBERS ST	MILWAUKEE, WI 53212-2506
CURRENT OCCUPANT	418 E CHAMBERS ST	MILWAUKEE, WI 53212-2507
CURRENT OCCUPANT	426 E CHAMBERS ST	MILWAUKEE, WI 53212-2507
CURRENT OCCUPANT	3042A N HOLTON ST	MILWAUKEE, WI 53212-2123
CURRENT OCCUPANT	3032A N HOLTON ST	MILWAUKEE, WI 53212-2123
CURRENT OCCUPANT	3030A N BUFFUM ST	MILWAUKEE, WI 53212-2113
CURRENT OCCUPANT	2964 N HOLTON ST	MILWAUKEE, WI 53212-2524
CURRENT OCCUPANT	2956B N HOLTON ST	MILWAUKEE, WI 53212-2524
CURRENT OCCUPANT	507 E CHAMBERS ST	MILWAUKEE, WI 53212-2508
CURRENT OCCUPANT	3029 N BOOTH ST	MILWAUKEE, WI 53212-2130
CURRENT OCCUPANT	3029A N BOOTH ST	MILWAUKEE, WI 53212-2130
CURRENT OCCUPANT	523 E CHAMBERS ST	MILWAUKEE, WI 53212-2508
CURRENT OCCUPANT	3007 N BOOTH ST	MILWAUKEE, WI 53212-2130
CURRENT OCCUPANT	3007A N BOOTH ST	MILWAUKEE, WI 53212-2130
CURRENT OCCUPANT	409 E CHAMBERS ST	MILWAUKEE, WI 53212-2506
CURRENT OCCUPANT	2959 N HOLTON ST	MILWAUKEE, WI 53212-2523
CURRENT OCCUPANT	3028 N HOLTON ST	MILWAUKEE, WI 53212-2123
CURRENT OCCUPANT	509A E CHAMBERS ST	MILWAUKEE, WI 53212-2508
CURRENT OCCUPANT	515A E CHAMBERS ST	MILWAUKEE, WI 53212-2508
CURRENT OCCUPANT	3017A N BOOTH ST	MILWAUKEE, WI 53212-2130
CURRENT OCCUPANT	3015 N BOOTH ST	MILWAUKEE, WI 53212-2130
CURRENT OCCUPANT	2968A N BUFFUM ST	MILWAUKEE, WI 53212-2514
CURRENT OCCUPANT	421 E CHAMBERS ST	MILWAUKEE, WI 53212-2506
CURRENT OCCUPANT	3027 N HOLTON ST	MILWAUKEE, WI 53212-2122
CURRENT OCCUPANT	3006 N BUFFUM ST	MILWAUKEE, WI 53212-2113
CURRENT OCCUPANT	3008 N BUFFUM ST	MILWAUKEE, WI 53212-2113
CURRENT OCCUPANT	2956 N HOLTON ST	MILWAUKEE, WI 53212-2524
CURRENT OCCUPANT	2956A N HOLTON ST	MILWAUKEE, WI 53212-2524
CURRENT OCCUPANT	526 E CHAMBERS ST	MILWAUKEE, WI 53212-2509

CURRENT OCCUPANT	2968 N BUFFUM ST	MILWAUKEE, WI 53212-2514
CURRENT OCCUPANT	403 E CHAMBERS ST	MILWAUKEE, WI 53212-2506
CURRENT OCCUPANT	2957 N HOLTON ST	MILWAUKEE, WI 53212-2523
CURRENT OCCUPANT	505 E CHAMBERS ST	MILWAUKEE, WI 53212-2508
CURRENT OCCUPANT	3037 N HOLTON ST	MILWAUKEE, WI 53212-2122
CURRENT OCCUPANT	3015 N HOLTON ST	MILWAUKEE, WI 53212-2122
CURRENT OCCUPANT	3011 N HOLTON ST	MILWAUKEE, WI 53212-2122
CURRENT OCCUPANT	430 E CHAMBERS ST	MILWAUKEE, WI 53212-2507
CURRENT OCCUPANT	3024A N HOLTON ST	MILWAUKEE, WI 53212-2123
CURRENT OCCUPANT	3030 N BUFFUM ST	MILWAUKEE, WI 53212-2113
CURRENT OCCUPANT	3014B N BUFFUM ST	MILWAUKEE, WI 53212-2113
CURRENT OCCUPANT	3025 N BOOTH ST	MILWAUKEE, WI 53212-2130
CURRENT OCCUPANT	3017 N BOOTH ST	MILWAUKEE, WI 53212-2130
CURRENT OCCUPANT	521 E CHAMBERS ST	MILWAUKEE, WI 53212-2508
CURRENT OCCUPANT	2955 N HOLTON ST	MILWAUKEE, WI 53212-2523

Total Records: 71

Radius: 250.0 feet and Center of Circle: 432 E Chambers ST



BUSINESS LICENSE PLAN OF OPERATION

ccl-busplan 9/26/16

Office of the City Clerk License Division
200 E. Wells St. Room 105, Milwaukee, WI 53202
(414) 286-2238 www.milwaukee.gov/license e-mail address: license@milwaukee.gov

1. Type of Business

- Applying for: Extended Hours (12AM to 5AM) - If a food establishment, check all that apply: Delivery Drive Thru Dining Room
 Self Service Laundry Massage Establishment Filling Station
 Other (supplemental application for specific license also required)

Provide a detailed description of the type of business you plan on operating:

Fresh Foods, grocery, produce, snack items, and tobacco.

Do you have any experience operating this type of business? No Yes If yes, explain: *I have worked in a store with family over 5 years*

2. Business Operations

- a. Proposed Opening Date: 05/26/17
- b. Is this premise under construction? No Yes If yes, list estimated completion date: _____
- c. Is this a franchise? No Yes
- d. Is this premises currently licensed? No Yes If yes, list type of license: Food, tobacco
- e. Is the current licensee operating? No Yes If no, list date closed: _____
- f. Do you have future plans for other businesses, licenses or permits at this location? No Yes
If yes, explain: _____
- g. Have you previously held an Extended Hours License in Milwaukee? No Yes
If yes, list address(es): _____
- h. Are other businesses operating in the same building? No Yes If yes, describe: _____

3. Litter & Noise

- a. How are grounds kept clean? Sweep Pressure Wash Pick Up Litter Other: _____
- b. How often will grounds be cleaned? Daily Weekly As Needed Monthly Other: _____
- c. Grounds cleaned by: Licensee Building Owner Employees Hired Maintenance Other: _____
- d. How are noise issues prevented and/or addressed? Security Manager approaches customer(s) Call Police
 Signs Posted Other: _____
- e. Will a sound amplification system be used? No Yes If yes, describe: _____

4. Smoking & Sanitation

- a. Are there designated outdoor smoking areas? No Yes If yes, describe: _____
- b. Number of Garbage Cans: Inside: 7 Locations: behind counter, by nacho stand, by front door
Outside: 1 Locations: in front of store
- c. Is a crowd control barrier used? No Yes If yes, describe: _____
- d. How many restrooms are on the premises? 1
- e. Name of solid waste contractor: Advanced Disposal Waste Management Other: _____

5. Security

- a. Are there onsite parking spaces? No Yes If yes, indicate how many? _____ and describe the parking security plan: _____
- b. Is there a loading zone? No Yes If yes, describe the loading area security plan: _____
- c. Will you have security personnel on premise? No Yes If yes, how many? _____ and answer the following:
 What are their responsibilities? _____
 Is security equipment used? No Yes If yes, describe Cameras / Alarm System
 List their licensing, certification, or training credentials _____
- d. Will there be security cameras? No Yes If yes, where? 2 outside, 4 inside
- e. Will searches/identification checks be done upon entry? No Yes If yes, describe _____

6. Percentage of Sales (must total 100%)

Alcohol <u>0</u> %	Food <u>75</u> %	Secondhand Merchandise <u>0</u> %	Precious Metals & Gems <u>0</u> %
Entertainment <u>0</u> %	Cigarettes <u>10</u> %	Personal Services (such as tattoo, body piercing, salon, tailor, tanning, etc.) <u>0</u> %	Other <u>15</u> % Describe: <u>non food.</u>
Pawnbroker Activity <u>0</u> %	Salvaged Materials <u>0</u> % (such as scrap metal)		

7. Businesses/Licenses on the Premises (check all that apply):

Type 1

- Full Service Restaurant Cafe/Coffee Shop Deli or Fast Food Restaurant Private/Fraternal/Veterans Club
- Night Club Tavern Cocktail Lounge Teen Club
- Banquet Hall Sports Facility Bowling Alley
- Hotel/Motel : Number of Floors: _____ Rooming House: Number of Floors: _____
 Number of Rooms: _____ Number of Rooms: _____

Type 2

- Liquor Store Corner Store Supermarket Convenience Store
- Gas Station Amusement/Phonograph Distributor Recycling, Salvage or Towing
- Used Car Dealer Personal Service Establishment
(such as tattoo business, hair salon, tailor, etc.) Recording Studio

What other licenses/permits will you hold at this location? (check all that apply)

- Occupancy Permit Cigarette & Tobacco Gas Station Extended Hours Class "B" Tavern Weights & Measures
- Secondhand Dealer Precious Metal & Gem Other: _____

8. Legal Capacity (only if a Type 1 premises in #7 above)

Capacity _____ (Call the Milwaukee Development Center at 414-286-8211 if you have questions.)

9. Premises Description

a. Identify all area(s) of the premises that will be used in operating this business (include areas used only for storage):
 1st Floor 2nd Floor Basement Storage Patio Beer Garden Sidewalk Café Deck Rooftop

Other: Describe: _____

b. Describe Location: Major Thoroughfare Secondary Street Other: _____

c. Nearest Major Cross Street: Holton & Chambers

d. Describe Building: Free Standing Building Strip Mall Other: _____

e. Describe Premises Structure: Single Story Multi-Story - # of Stories 2 Other: _____

f. Describe Surrounding Area: Commercial Residential Industrial Other: _____

g. Building Owner Name: Rabeeh Masaiti Phone Number: 414-378-6062

Business Owner Address: 2121 W. Bridge St

10. Hours of Operation & Customers

Will customers be entering the premises? No Yes

Day of the Week	Proposed Hours of Operation:		Estimated Number of Customers expected each day	Potential Age Range of Customers	Class B Tavern Applicant Only: Age Restriction (If none, write 'None')
	Open Time (include a.m. or p.m.)	Close Time (include a.m. or p.m.)			
Sunday	8 am	9 pm	70	10-50	
Monday	↓	↓	↓	↓	
Tuesday					
Wednesday					
Thursday					
Friday					
Saturday					

An Extended Hours Establishment License is required for any convenience store, filling station, personal service establishment (such as tattoo, body piercing, salon, tailor, tanning, etc.), recording studio or restaurant which is open between the hours of 12:00 a.m. and 5:00 a.m.

Alcohol Establishments Class A: 8:00 am to 9:00 pm Sunday thru Saturday
 Permitted Hours of Operation: Class B: 6:00 am to 2:00 am Sunday thru Thursday, 6:00 am to 2:30 am Friday & Saturday

Entertainment Closing Hours: Indoors: Alcohol beverage establishments: Same as alcohol license hours
 Non-alcohol establishments: 1:00 am Sunday thru Thursday, 1:30 am Friday & Saturday
 Outdoors: All establishments: 10:00 pm Sunday thru Thursday, 12:00 am Friday & Saturday
 (unless otherwise approved by the Common Council in licensee's plan of operation)

11. Signature(s)

Sole Proprietor, Partner, Agent, or 20% or more Shareholder

Signature of additional partner or 20% or more Shareholder

See Application Information for a complete list of all required application forms.



FOOD DEALER LICENSE PLAN OF OPERATION

ccl-foodplan 8/1/16

OFFICE OF THE CITY CLERK, LICENSE DIVISION
CITY HALL, 200 E. WELLS ST, ROOM 105, MILWAUKEE, WI 53202
(414) 286-2238 • license@milwaukee.gov • www.milwaukee.gov/license

Legal Entity Name: MOHANNED MUSAITIF

Premises Address: 432 E. CHAMBERS ST

SECTION 1 TYPE OF BUSINESS

Type of application (check one): taking over a currently operating business starting a new business
Anticipated opening date? 5-26-17

Check the type that best describes your business (check only one):
See Food Dealer License Information sheet for definitions.

- Restaurant
- Retail Establishment
 - If retail, will it be a convenience store? Yes No
 - (less than 5,000 sq ft of retail space, primary business is the sale of basic food items, and in addition sells household products)
- Community Food Program
- Bed & Breakfast
- Base for Food Peddler
- Base for Temporary/Seasonal Food Stand

In addition, will any wholesale business be done? Yes No

If yes, what percentage of the business will be wholesale? Less than 25% 25% or More (Contact DATCP)*

Will retail items be sold? No Yes If Yes, indicate percentage of food sales 75 %

Will restaurant items be sold? No* Yes If Yes, indicate percentage of food sales _____ %

* If you checked "25% or More" of the business will be wholesale and answered "No" to restaurant items being sold, do not continue completing this application. A City of Milwaukee License is not required. Contact DATCP only.

SECTION 2 FOOD PROCESSING

Will any food processing be done? No Yes
Processing is defined as assembling, grinding, cutting, mixing, baking, coating, stuffing, packing, bottling, grilling, canning, extracting, fermenting, distilling, pickling, freezing, drying, smoking, or packaging.

If Yes, check the types of food items:

- SNACKS & BEVERAGES
includes, but is not limited to, ice cream/soft serve, lemonade, snow cones, coffee, espresso, cappuccino, tea, fruit juice, smoothies, candy, dispensed soda, fruit cups, bakery, cookies, popcorn, kettle corn, cotton candy, funnel cakes, fritters, tortilla chips w/ cheese
- MEALS
includes, but is not limited to, chicken, ribs, sandwiches, roasted corn, baked potatoes, hot dogs, brats, tacos, nachos w/ cheese and meat, French fries, cooked or deep fried vegetables/fruit, cooked cheese curds, corn dogs, egg rolls, salads

SECTION 3 HAZARDOUS FOODS

Will any hazardous food be sold? No Yes
Hazardous foods require temperature control (includes dairy products such as milk, cheese, and ice cream, fish shellfish, meat, poultry)

If yes, list the types of food items: Cheese, Milk, Eggs, Ice Cream

SECTION 4 SHARED KITCHEN

Will you be sharing kitchen space with another operator?

- No If No, SKIP to Section 5
- Yes If Yes, check one:
 - I will rent space from another operator ("Shared Kitchen Agreement" is required)
 - I will rent space to another operator (peddler/caterer)

SECTION 5 DETAILS OF OPERATION

Answer the following questions:

- Will you have seating on site for dining? No Yes
- Will you be doing any catering? No Yes
- Will you be doing any delivery? No Yes
- Will you have outdoor activities? No Yes
 - If Yes to outdoor activities, check all that apply: Bar Cooking/Grilling Dining
- Will you have a drive thru window? No Yes
 - If Yes to drive thru, are hours different from inside? No Yes
 - If Yes, provide drive thru hours: _____
- Will any scales or barcode scanners be used? No Yes
 - If Yes, a Weights & Measures application must be completed and a license obtained.

SECTION 6 ADDITIONAL SITES

Where will food be prepared and/or sold?

- At a single site
 - At multiple sites (for example, a hotel with several dining rooms or bars) How many? _____
- If multiple sites, attach a Food Dealer Additional Site Addendum (ccl-foodadd) for each additional site.

SECTION 7 CONSTRUCTION OR CHANGES

Are you planning any construction, remodeling or equipment changes?

- No If No, SKIP to Section 6
- Yes If Yes, check all that apply:
 - New construction of a building
 - Construction changes to an existing building
 - Renovation or remodeling
 - Equipment changes only (installation or replacement)

Provide a brief description of the changes: _____

Start date: _____

Name, Address & Phone Number of Architect: _____

Name, Address & Phone Number of Contractor: _____

SECTION 8 ALCOHOL BEVERAGES

Are you applying for an alcohol beverage license?

- No If No, SKIP to Section 9
- Yes If YES, if your food license is approved prior to the alcohol beverage license, when do you want the food license issued? Immediately At the same time as the alcohol license

SECTION 9 ACKNOWLEDGEMENTS & SIGNATURE

You must initial each item confirming your understanding:

- MM I understand the Health Department must conduct an inspection and advise the License Division of their approval before the license may be issued.
- MM I understand I must obtain an occupancy permit from the Department of Neighborhood Services and an inspection may be required. Neighborhood Services must advise the License Division of their approval before the license may be issued.
- MM I understand the district alderperson will review and either approve or deny my application. If denied, I may appeal and be scheduled to appear before the Licenses Committee. The Licenses Committee will then make a recommendation to the Common Council. The Common Council must grant the license before it may be issued.
- MM I understand proof of payment for all license fees must be on file in the License Division before the license may be issued.
- MM I understand the license must be issued and posted in my establishment prior to opening for business.
- MM I will not operate my food business until the license has been issued and posted in the establishment.

Signature of sole proprietor, partner, agent or 20% shareholder: 

Signature of additional partner(s): _____

TOTAL SF 480

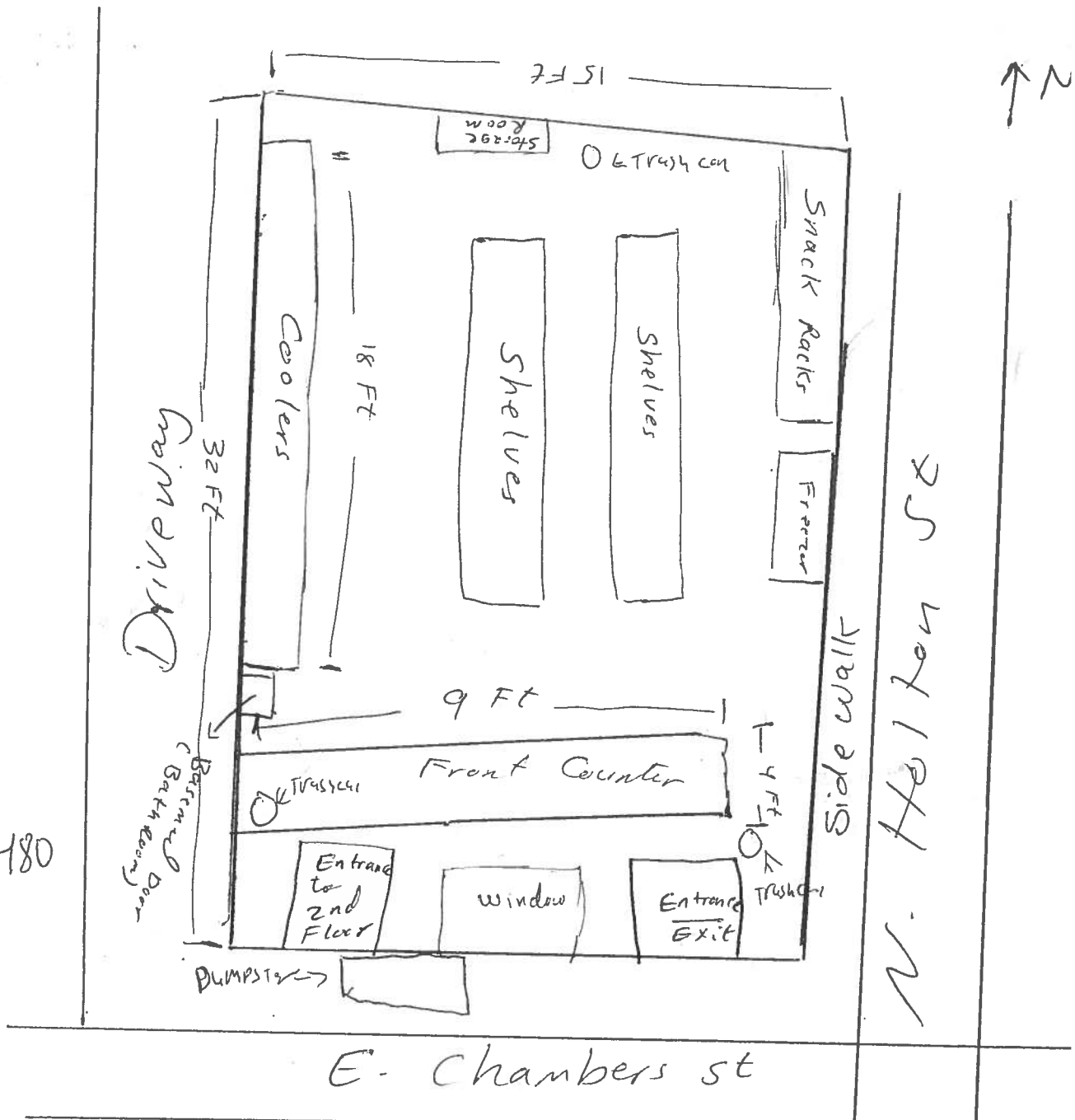

M & M Food
432 E. Chambers St
Milwaukee, WI 53212

5/26/17

Mohanned Musaitif