



MILWAUKEE
HISTORIC
PRESERVATION
COMMISSION

LIVING WITH HISTORY

Certificate of Appropriateness

Milwaukee Historic Preservation Commission/200 E. Wells Street/Milwaukee, WI 53202/phone 414-286-5712/fax 414-286-3004

Property **601 W. HISTORIC MITCHELL ST.** **Mitchell Street Historic District**
Description of work New, enlarged parking lot in back of building.
Date issued 1/31/2014 PTS ID **92521 COA, parking lot**

In accordance with the provisions of Section 320-21 (11) and (12) of the Milwaukee Code of Ordinances, the Milwaukee Historic Preservation Commission has issued a certificate of appropriateness for the work listed above. The work was found to be consistent with preservation guidelines. The following conditions apply to this certificate of appropriateness:

All work will be done according to attached illustrations and specifications. Mulch will be crushed or pulverized stone. Wood chip mulch will not be used.

All work must be done in a craftsman-like manner, and must be completed within one year of the date this certificate was issued. Staff must approve any changes or additions to this certificate before work begins. Work that is not completed in accordance with this certificate may be subject to correction orders or citations. If you require technical assistance, please contact Paul Jakubovich of the Historic Preservation staff as follows: Phone: (414) 286-5712 Fax: (414) 286-3004 E-mail: pjakub@milwaukee.gov.

If permits are required, you are responsible for obtaining them from the Milwaukee Development Center. If you have questions about permit requirements, please consult the Development Center's web site, www.milwaukee.gov/build, or call (414) 286-8210.

City of Milwaukee Historic Preservation

Copies to: Development Center, Ald. Jose Perez, Inspector Mike Niedermann (286-2560), Inspector Heidi Weed

LANDSCAPE PLANTINGS PER TABLE 295-405 TYPE B: ALONG STREET

PLANT SCHEDULE (CONTRACTOR RESPONSIBLE FOR VERIFYING PLANT QUANTITIES)							
QUANTITY	SYMBOL	BOTANICAL NAME	COMMON NAME	MATURE SIZE	PLANTING	SIZE	TYPE
4	GT	<i>Gleditsia triacanthos</i> 'Impcole'	Imperial Honeylocust	35'-40'	B / B	2 1/2"	Shade Tree
5	TA	<i>Tilia americana</i> 'Redmond'	Redmond Linden	35'-40'	B / B	2 1/2"	Shade Tree
3	SR	<i>Syringa reticulata</i> 'Ivory Silk'	Ivory Silk Tree Lilac	15'-20'	B / B	2"	Ornamental Tree
21	BT	<i>Berberis thunbergii</i> 'Rose Glo'	Rose Glo Barberry	3'-4'	POT	2 Gal	Deciduous Shrub
10	RA	<i>Ribes alpinum</i>	Alpine Currant	3'-4'	POT	18"	Deciduous Shrub
26	SG	<i>Spiraea</i> x 'Goldflame'	Goldflame Spirea	3'-4'	POT	2 Gal	Deciduous Shrub
14	JS	<i>Juniperus sabina</i> 'Broadmoor'	Broadmoor Juniper	2' x 4'	POT	5 Gal	Evergreen Shrub
13	TM	<i>Taxus x media</i> 'Runyan'	Runyan Yew	3' x 5'	POT	18"	Evergreen Shrub
15	CA	<i>Calamagrostis acutiflora</i> 'Karl Foerster'	Karl Foerster Grass	42"-48"	POT	1 Gal	Ornamental Grass
24	HS	<i>Hemerocallis</i> x 'Stella D'oro'	Stella D'oro Daylily	18"-24"	POT	1 Gal	Perennial

Reference this table for plantings indicated on attached plan.

W. MITCHELL STREET

Plan View 601 W. Mitchell Street showing parking lot

ALLEY

EX. BUILDING

S. 6TH STREET

Shrubs, trees, fencing and stone mulch along east perimeter of the parking lot. See attached details and elevations

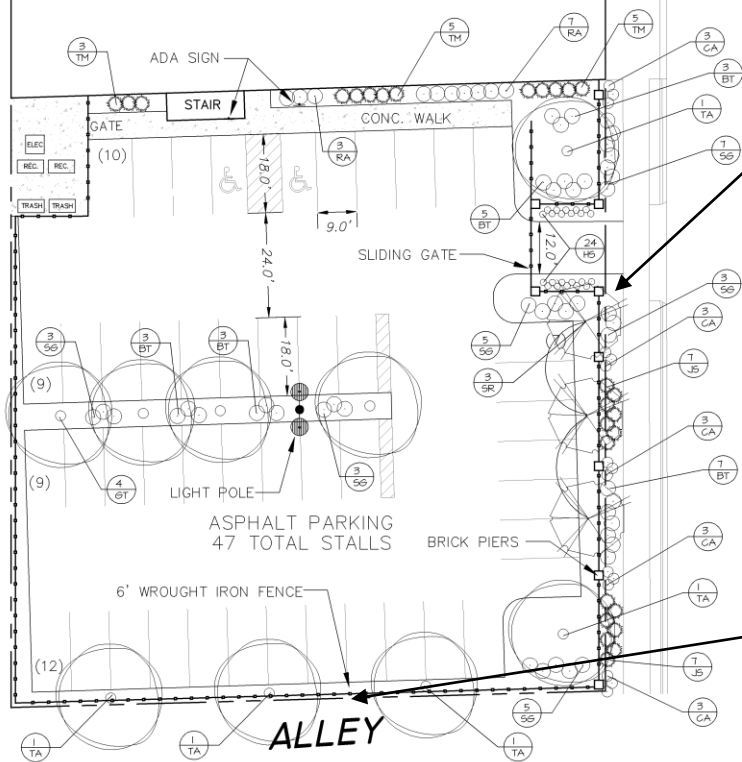

Metal fence along alley sides of the lot

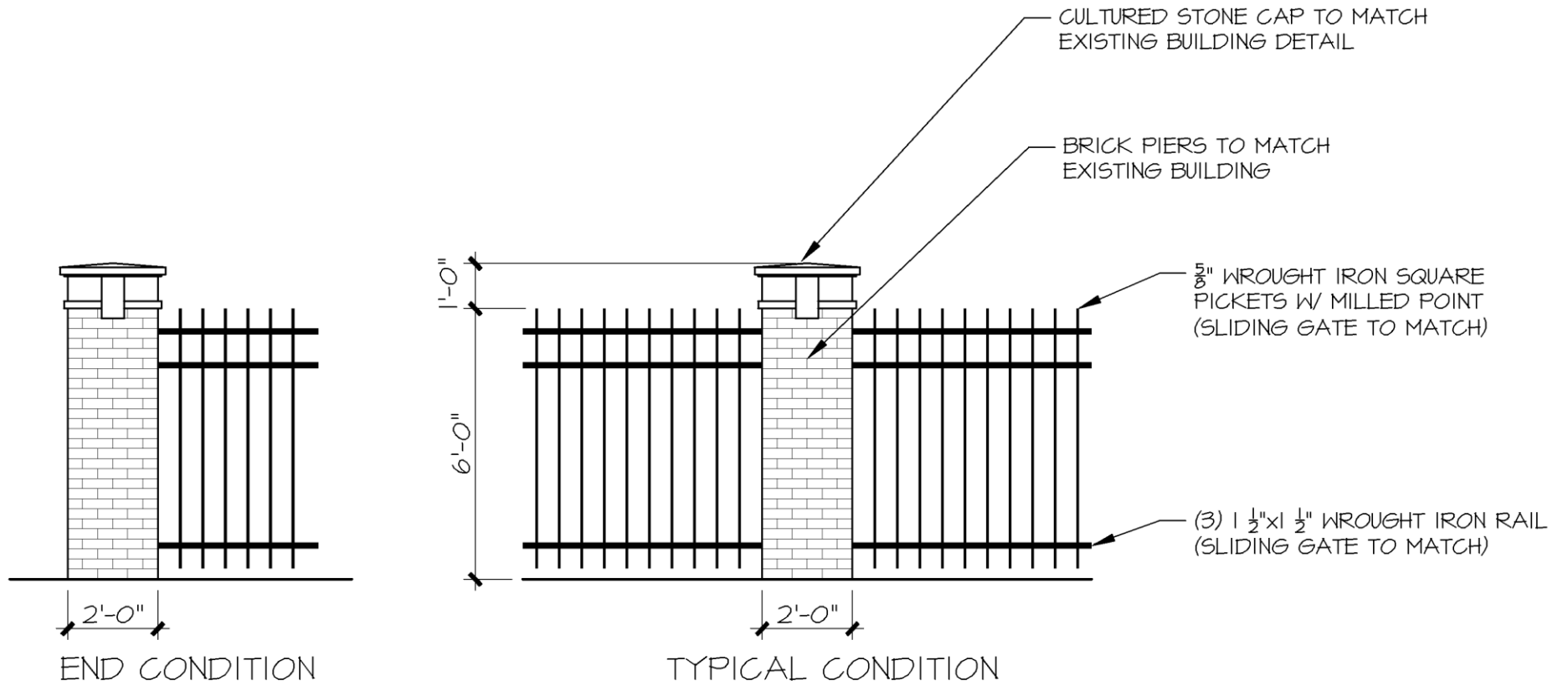

7 FENCE ELEVATION AT STREET
 SCALE = 1/4" = 1'-0"

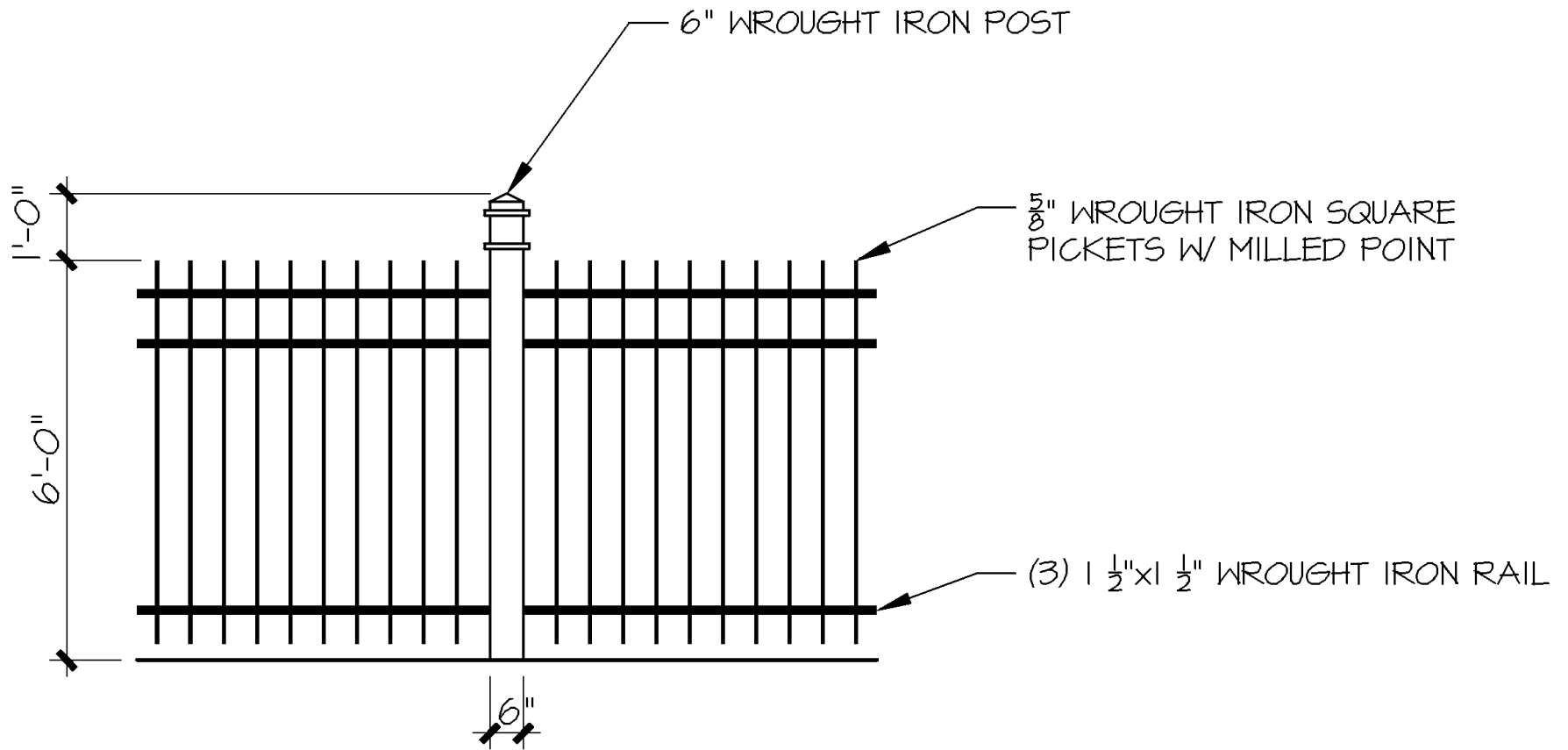

8

FENCE ELEVATION AT ALLEY

SCALE = $\frac{1}{4}$ " = 1'-0"

GENERAL LANDSCAPE NOTES:

- 1.) ALL FINISHED GRADES TO BE 1" BELOW TOP OF CURBS OR PAVEMENT.
- 2.) BACKFILL AND GRADE ALL PLANTING AREAS WITH MIN. 12" BLENDED TOPSOIL.
- 3.) ALL PLANTING BEDS TO BE MULCHED AT 2" DEPTH WITH STONE MULCH
- 4.) ALL PLANT MATERIAL SHALL CONFORM TO AMERICAN STANDARD FOR NURSERY STOCK.
- 5.) ALL TREES NOT IN A PLANTING BED SHALL BE MULCHED WITH A MINIMUM 1' RADIUS FOR EACH 1 INCH CALIPER. USE STONE MULCH AT 2" DEPTH.
- 6.) PROVIDE MIN. 2 YEAR WARRANTY ON ALL PLANT MATERIAL.
- 7.) DEPRESS LANDSCAPE AREA ALONG PUBLIC SIDEWALK 2" FOR MULCH.

General specifications include the use of stone mulch around planting at sidewalk and the interior of the lot.

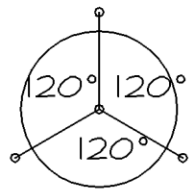

STAKING
DIAGRAM

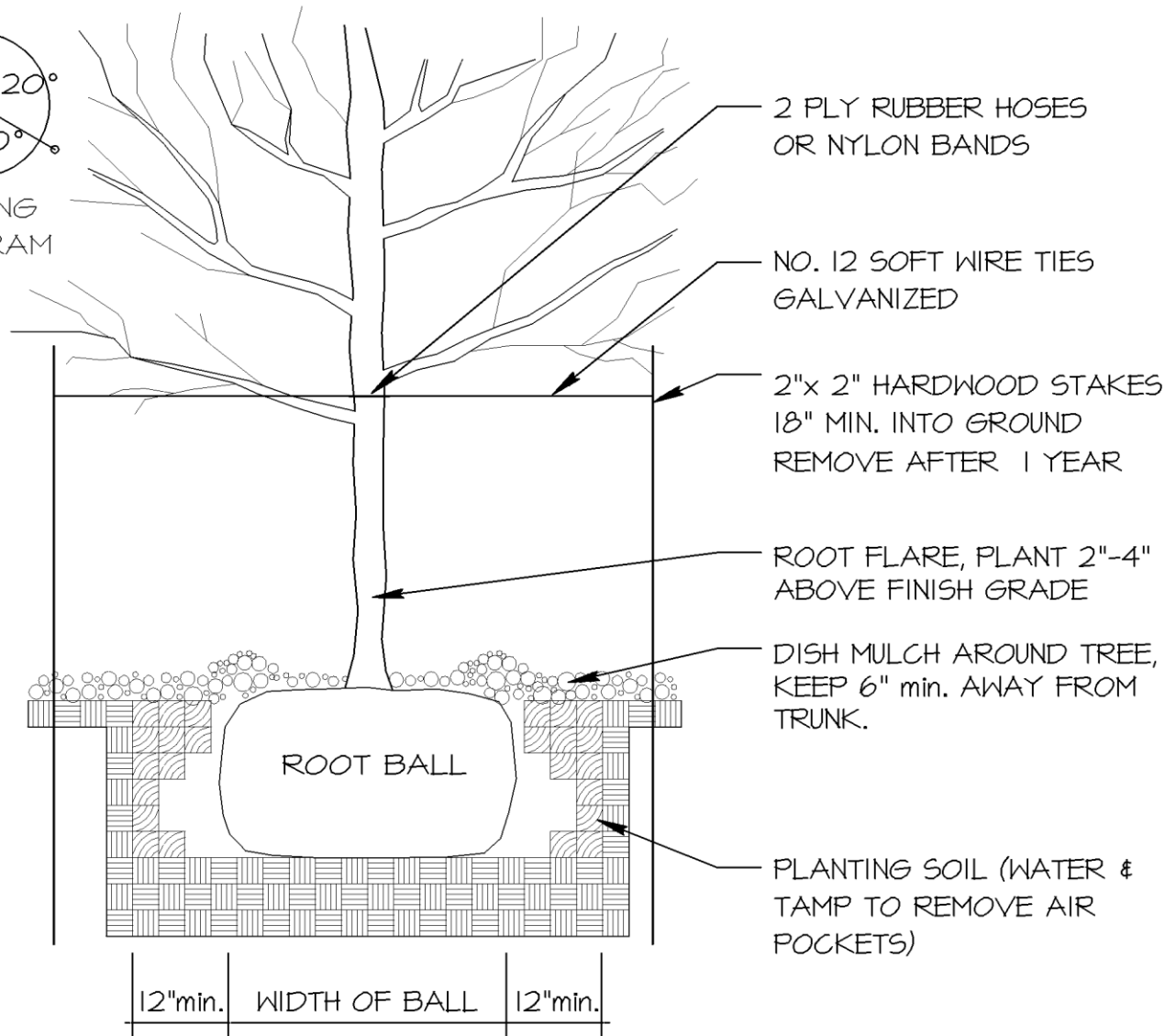

6

DECIDUOUS TREE

N.T.S.

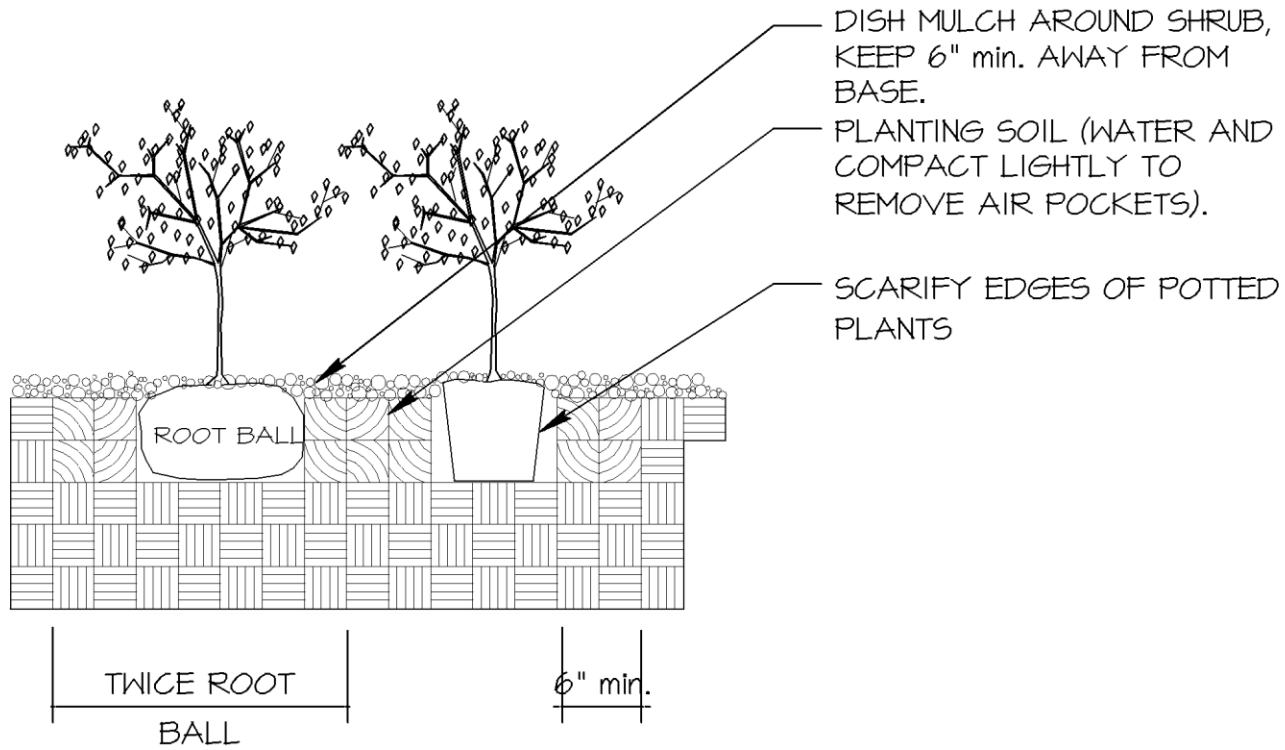

4

SHRUB PLANTING

N.T.S.