

CERTIFIED SURVEY MAP NO. _____

THE NORTHWEST CORNER
OF THE SOUTHEAST 1/4
OF SECTION 30, T8N, R21E
CONC. MON. WITH BRASS CAP

BEING A PART OF THE NORTHEAST 1/4 OF THE SOUTHEAST 14 OF SECTION 30,
IN TOWNSHIP 8 NORTH, RANGE 21 EAST IN THE CITY OF MILWAUKEE,
MILWAUKEE COUNTY, WISCONSIN.

DEDICATED TO CITY OF MILWAUKEE
FOR PUBLIC STREET PURPOSES
WEST BOBOLINK AVENUE: 3,942 SQ. FT.

WEST BOBOLINK AVENUE

N. LOVERS LANE ROAD
N00°02'22"E 2637.19'
N00°02'22"E 1978.06'

THE WEST LINE OF
THE SOUTHEAST 1/4
OF SECTION 30, T8N, R21E

N87°32'22"E 1494.53'
THE CENTERLINE OF W. BOBOLINK AVENUE

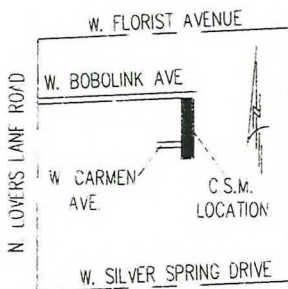

LOCATION SKETCH

SOUTHEAST 1/4 SECTION 30-8-21
1" = 2000'

THE SOUTHWEST CORNER
OF THE SOUTHEAST 1/4
OF SECTION 30, T8N, R21E
CONC. MON. WITH BRASS CAP

PROPERTY OWNERS:
RICHARD B GILSON
SUSAN E. CRAIG-GILSON
11001 W. BOBOLINK AVENUE
MILWAUKEE, WI 53225

- - DENOTES FOUND 1" DIA. IRON PIPE
 - - DENOTES SET 3/4" X 18" LONG
IRON REBAR WEIGHING 15 LBS.
PER LINEAL FOOT.
- ALL BEARINGS ARE REFERENCED TO
THE WEST LINE OF THE SOUTHEAST
1/4 OF SECTION 30-8-21, WHICH IS
ASSUMED TO BEAR N00°02'22"E,
STATE PLANE COORDINATE SYSTEM
NAD 27 SOUTH ZONE FEB. 2015 DATUM.
- TAX KEY NO. 1809984000
ZONING: R-3 RESIDENTIAL 1-FAMILY

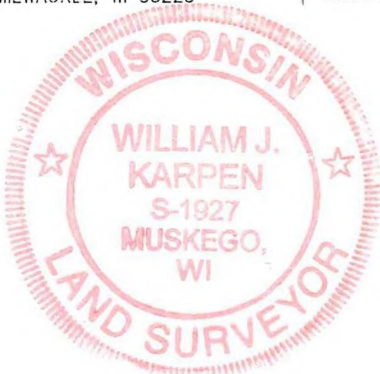

SCALE: 1" = 80'

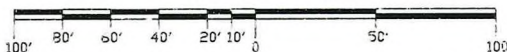

William Karpén 2-8-2025

WILLIAM J. KARPEN S-1927

INSTRUMENT DRAFTED BY: WILLIAM J. KARPEN SHEET 1 OF 3

INFRASTRUCTURE
SERVICES DIVISION

WJ 3/31/25
CENTRAL DRAFTING & RECORDS MANAGER

KT 3.31.25
ENGR. IN CHARGE ENVIRON. ENGR.

CORRECT

K. J. Karpén 3/31/2025
CITY ENGINEER

APPROVED

DEPARTMENT OF CITY
DEVELOPMENT
CITY OF MILWAUKEE

20 2024
Sum Lan
STAFF APPROVED

POINT OF
BEGINNING

PARCEL 1, C.S.M. NO 3466

PARCEL 1, C.S.M. NO 6320

PARCEL 2
C.S.M. NO 6320

N87°32'22"E 131.40'

N87°32'22"E 131.40'

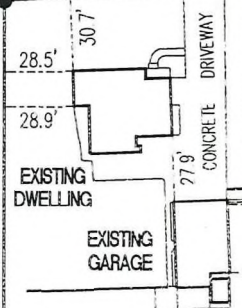

327.18'

659.84'

LOT 1
42,950.5 SQ. FT.
0.99 ACRE

N87°32'22"E 131.40'

302.63'

LOT 2
39,732.1 SQ. FT.
0.91 ACRE

S87°34'02"W 131.40'

UNPLATTED LANDS

UNPLATTED LANDS

S00°02'22"W

302.69'

659.90'

30.03'

30.00'

CERTIFIED SURVEY MAP NO. _____

BEING A PART OF THE NORTHEAST 1/4 OF THE SOUTHEAST 14 OF SECTION 30, IN TOWNSHIP 8 NORTH, RANGE 21 EAST, IN THE CITY OF MILWAUKEE, MILWAUKEE COUNTY, WISCONSIN.

SURVEYORS CERTIFICATE

STATE OF WISCONSIN)

SS

MILWAUKEE COUNTY)

I, WILLIAM J. KARPEN, A REGISTERED LAND SURVEYOR DO HEREBY CERTIFY THAT I HAVE SURVEYED, DIVIDED, DEDICATED AND MAPPED THAT PART OF THE NORTHEAST 1/4 OF THE SOUTHEAST 14 OF SECTION 30, IN TOWNSHIP 8 NORTH, RANGE 21 EAST, IN THE CITY OF MILWAUKEE, MILWAUKEE COUNTY, WISCONSIN, BOUNDED AND DESCRIBED AS FOLLOWS:

COMMENCING AT THE SOUTHWEST CORNER OF THE SOUTHEAST 1/4 OF SECTION 30, THENCE NORTH 00°02'22" EAST 1,978.06 FEET, ALONG THE WEST LINE OF THE SOUTHEAST 1/4, TO A POINT ON THE CENTERLINE OF WEST BOBOLINK AVENUE; THENCE NORTH 87°32'22" EAST 1,494.53 FEET ALONG SAID CENTERLINE TO THE POINT OF BEGINNING OF THE LANDS TO BE DESCRIBED; THENCE CONTINUE NORTH 87°32'22" EAST ALONG SAID CENTERLINE 131.40 FEET; THENCE SOUTH 00°02'22" WEST 659.90 FEET; THENCE SOUTH 87°34'02" WEST 131.40 FEET TO THE SOUTHEAST CORNER OF PARCEL 2 CERTIFIED SURVEY MAP NO. 6320; THENCE NORTH 00°02'22" EAST ALONG THE EAST LINE OF CERTIFIED SURVEY MAP NO. 6320 AND CERTIFIED SURVEY MAP NO. 3466 659.84 FEET TO THE PLACE OF BEGINNING. CONTAINING 1.99 ACRES OF LAND MORE OR LESS AND DEDICATING THE NORTH 30.00 FEET TO THE CITY OF MILWAUKEE FOR PUBLIC STREET PURPOSES, (WEST BOBOLINK AVENUE).

THAT I HAVE MADE SUCH SURVEY AND MAP BY THE DIRECTION OF RICHARD B. GILSON AND SUSAN E. CRAIG-GILSON, OWNERS OF SAID LAND DESCRIBED ABOVE.

THAT SUCH MAP IS A CORRECT REPRESENTATION OF THE EXTERIOR BOUNDARIES OF THE LAND SURVEYED.

THAT I HAVE FULLY COMPLIED WITH THE PROVISIONS OF CHAPTER 236.34 OF THE WISCONSIN STATUTES AND CHAPTER 119 OF THE MILWAUKEE CODE OF ORDINANCES IN SURVEYING, JOINING TOGETHER AND MAPPING THE SAME. PER WIS. STAT. 236.21 (1), THIS CERTIFICATE HAS THE SAME FORCE AND EFFECT AS AN AFFIDAVIT.

DATED THIS 8th OF February 2025.

William J. Karpen
WILLIAM J KARPEN S-1927

WISCONSIN REGISTERED LAND SURVEYOR



OWNER'S CERTIFICATE:

AS OWNERS, WE CERTIFY THAT WE CAUSED THE LANDS DESCRIBED ON THIS CERTIFIED SURVEY MAP TO BE SURVEYED, DEDICATED AND MAPPED AS REPRESENTED ON THIS MAP IN ACCORDANCE WITH THE REQUIREMENTS OF CHAPTER 119 OF THE MILWAUKEE CODE OF ORDINANCES.

IN CONSIDERATION OF THE APPROVAL OF THE MAP BY THE COMMON COUNCIL AND IN ACCORDANCE WITH CHAPTER 119 OF THE MILWAUKEE CODE, THE UNDERSIGNED AGGREE:

THAT ALL UTILITY LINES TO PROVIDE ELECTRIC POWER AND TELEPHONE SERVICE AND CABLE TELEVISION OR COMMUNICATIONS SYSTEMS LINES OR CABLES TO ALL LOTS IN THE CERTIFIED SURVEY MAP (OTHER THAN ALREADY EXISTING LINES AND CABLES) SHALL BE INSTALLED UNDERGROUND IN EASEMENTS PROVIDED THEREFORE, WHERE FEASIBLE.

THIS AGREEMENT SHALL BE BINDING ON THE UNDERSIGNED AND ASSIGNS.

DATE February 11, 2025

SIGNATURES [Signature]

TYPE OR PRINT NAMES RICHARD GILSON

[Signature]

SUSAN E. CRAIG-GILSON

STATE OF WI

MILWAUKEE COUNTY)

PERSONALLY CAME BEFORE ME THIS 11 DAY OF February, 2025, RICHARD B. GILSON AND SUSAN E. CRAIG-GILSON TO ME KNOWN TO BE THE PERSONS WHO EXECUTED THE FOREGOING INSTRUMENT AND ACKNOWLEDGED THE SAME.

Brenda L Myszka
NOTARY PUBLIC, STATE OF WISCONSIN (PRINT NAME)

Brenda L Myszka
(PRINT NAME)

MY COMMISSION EXPIRES 5/17/2027

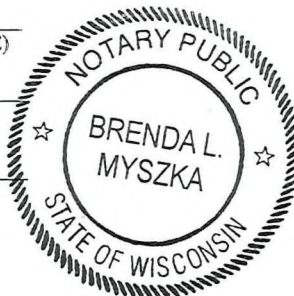

PREPARED FOR:
RICHARD B. GILSON AND SUSAN E. CRAIG-GILSON
11001 W. BOBOLINK AVENUE
MILWAUKEE, WI 53225

PREPARED BY:
WILLIAM J. KARPEN RPLS
S63W13007 JANESVILLE ROAD
MUSKEGO, WI 53150

CERTIFIED SURVEY MAP NO. _____

BEING A PART OF THE NORTHEAST 1/4 OF THE SOUTHEAST 14 OF SECTION 30, IN TOWNSHIP 8 NORTH, RANGE 21 EAST, IN THE CITY OF MILWAUKEE, MILWAUKEE COUNTY, WISCONSIN.

CERTIFICATE OF CITY TREASURER

I, SPENCER COGGS BEING THE DULY ELECTED AND ACTING CITY TREASURER OF THE CITY OF MILWAUKEE, CERTIFY THAT IN ACCORDANCE WITH THE RECORDS IN THE OFFICE OF THE CITY TREASURER OF THE CITY OF MILWAUKEE THERE ARE NO UNPAID TAXES OR UNPAID SPECIAL ASSESSMENTS ON THE LANDS INCLUDED IN THIS CERTIFIED SURVEY MAP.

PER WIS. STAT. 75.06 AND 74.87, THE CITY OF MILWAUKEE COLLECTS PROPERTY TAXES AND ENFORCES NONPAYMENT OF SAME ON PARCELS IN THE CITY OF MILWAUKEE. PER WIS. STAT. 74.83, THE CITY OF MILWAUKEE AND MILWAUKEE COUNTY ENTERED INTO AN INTERGOVERNMENTAL COOPERATION AGREEMENT APPROVED BY COMMON COUNCIL RESOLUTION FILE NO. 901408, WHEREBY THE CITY IS THE SOLE COLLECTOR AND ENFORCER OF PROPERTY TAXES FOR PARCELS IN THE CITY.

DATE: 4/2/2025

SIGNATURE: [Signature]
for SPENCER COGGS, CITY TREASURER

CERTIFICATE OF CITY CLERK REGARDING COMMON COUNCIL APPROVAL

I CERTIFY THAT THIS CERTIFIED SURVEY MAP WAS APPROVED UNDER RESOLUTION FILE NO. 241334 ADOPTED BY THE COMMON COUNCIL OF THE CITY OF MILWAUKEE ON 4-22-2025.

DATE: 4-29-2025

SIGNATURE: [Signature]

TYPE OR PRINT NAME: JAMES R. OWCZARSKI
JAMES OWCZARSKI (CITY CLERK)



William Karpen
2-8-2025