

INFRASTRUCTURE SERVICES DIVISION - TRANSPORTATION
 DEPARTMENT OF PUBLIC WORKS - CITY OF MILWAUKEE
 STATE PROJECT I.D.#2984-75-77
 LED RETROFIT PROJECT
 101 SIGNALIZED INTERSECTIONS
 CITY STREET LOCATIONS, MILWAUKEE COUNTY

SUMMARY COST ESTIMATE - TRAFFIC SIGNALS

<u>ITEM</u>	<u>DESCRIPTION</u>	<u>UNIT</u>	<u>QUANTITY</u>	<u>UNIT COST</u>	<u>TOTAL UNIT COST</u>
71066RL	PED DW-W SIG. HOUS. RETROFIT LED	EACH	758	\$247.43	\$187,551.94
71064RL	112 SIGNAL HOUSING RETROFIT RED LED	EACH	452	\$86.11	\$38,921.72
71064YL	112 SIGNAL HOUSING RETROFIT YELLOW LED	EACH	439	\$92.61	\$40,655.79
71064GL	112 SIGNAL HOUSING RETROFIT GREEN LED	EACH	435	\$134.95	\$58,703.25
71072RL	18 SIGNAL HOUSING RETROFIT RED LED	EACH	711	\$95.58	\$67,957.38
71072YL	18 SIGNAL HOUSING RETROFIT YELLOW LED	EACH	742	\$100.15	\$74,311.30
71072GL	18 SIGNAL HOUSING RETROFIT GREEN LED	EACH	741	\$126.39	\$93,654.99
71064RAL	112 SIG. HOUS. RETROFIT RED ARROW LED	EACH	2	\$86.28	\$172.56
71064YAL	112 SIG. HOUS. RETROFIT YELLOW ARROW LED	EACH	49	\$87.19	\$4,272.31
71064GAL	112 SIG. HOUS. RETROFIT GREEN ARROW LED	EACH	59	\$117.83	\$6,951.97
				TOTAL	\$573,153.21

ESTIMATED COST OF 2004 HAZARD ELIMINATION
 SAFETY PROGRAM

APPROVED BY:



ROBERT W. BRYSON
 TRAFFIC CONTROL ENGINEER V

TRANSPORTATION SECTION
 TRAFFIC & LIGHTING DESIGN UNIT
 JOSEPH A. BONDOWSKI
 December 2, 2004

INFRASTRUCTURE SERVICES DIVISION-TRANSPORTATION
DEPARTMENT OF PUBLIC WORKS-CITY OF MILWAUKEE
STATE PROJECT NUMBER I.D. 2984-75-77
LED RETROFIT PROJECT
101 SIGNALIZED INTERSECTIONS
CITY STREET LOCATIONS

Signalized Intersection List

ITEM	71066RL	71064RL	71064YL	71064GL	71072RL	71072YL	71072GL	71064RAL	71064YAL	71064GAL
	Ped DW-W	12" R	12" Y	12" G	8"R	8" Y	8" G	12" RA	12" YA	12" GA
Street 1	Street 2	Street 3								
Belleview	Downer		2	2	10	10	10	0	0	0
Bradford	Oakland		4	4	8	8	8	0	0	0
Brown	27th		4	4	8	8	8	0	0	0
Brown	35th		4	4	8	8	8	0	0	0
Brown	6th		2	2	11	11	11	0	0	0
Brown	Dr. MLK		2	2	10	10	10	0	0	0
Burleigh	24th		0	0	12	12	12	0	0	0
Burleigh	27th		8	8	4	4	4	0	0	0
Burleigh	46th		4	4	8	8	8	0	0	0
Burleigh	55th		5	5	7	7	7	0	0	0
Burleigh	7th		1	1	8	8	8	0	0	0
Burleigh	84th		4	4	8	8	8	0	0	0
Burleigh	8th		2	2	9	9	9	0	0	0
Burleigh	92nd		8	8	8	8	8	0	0	0
Burleigh	Dr. MLK		5	5	7	7	7	0	0	0
Burleigh	Hoiton		0	0	12	12	12	0	0	0
Burleigh	Lisbon		10	10	6	6	6	4	4	4
Burleigh	Meno River Pkwy		6	6	6	6	6	0	0	0
Burleigh	Roosevelt	60th	3	3	13	14	14	2	4	4
Burleigh	Sherman		8	8	6	6	6	0	0	0
Burleigh	Teutonia		2	2	7	7	7	0	0	0
Center	16th		0	0	9	9	9	0	0	0
Center	27th		7	7	4	4	4	0	0	0
Center	51st		8	8	4	4	4	0	0	0
Center	55th		6	6	6	6	6	0	0	0
Center	68th		4	4	8	8	8	0	0	0
Center	7th		9	9	4	4	4	2	2	2
Center	84th		2	2	10	10	10	0	0	0

ITEM	Street 1	Street 2	Street 3	71066RL Ped DW-W	71064RL 12" R	71064YL 12" Y	71064GL 12" G	71072RL 8" R	71072YL 8" Y	71072GL 8" G	71064RAL 12" RA	71064YAL 12" YA	71064GAL 12" GA
	Center	8th		6	2	2	2	7	7	7		0	0
	Center	92nd		8	6	6	6	6	6	6		0	0
	Center	Dr. MLK		8	8	8	8	4	4	4		0	0
	Center	Holton		8	8	8	8	4	4	4		0	0
	Center	Humboldt		6	8	8	8	3	3	3		0	0
	Center	Lisbon	60th	13	6	6	6	8	8	8		0	0
	Center	Sherman		8	4	4	4	10	10	10		0	0
	Chambers	51st		8	4	4	4	8	8	8		0	0
	Chambers	Hopkins	17th	8	6	8	8	4	4	4		4	4
	Chambers	Teutonia		6	1	1	1	11	11	11		2	2
	Commerce	Humboldt		8	4	4	4	8	8	8		0	0
	Downer	Kenwood		8	8	8	8	5	5	5		0	0
	Downer	Locust		8	2	2	2	10	10	10		0	0
	Dr. MLK	Wright		8	2	2	2	10	10	10		0	0
	Frainey	Locust		8	0	0	0	12	12	12		0	0
	Garfield	7th	Halyard	4	3	0	0	6	9	9		0	2
	Garfield	8th	Halyard	4	5	4	4	5	6	6		0	0
	Gordon Pl	Locust		2	8	6	6	0	6	6		0	0
	Holton	Locust		8	8	8	8	4	4	4		0	0
	Holton	North		8	7	8	8	4	4	4		0	0
	Holton	Wright		8	0	0	0	12	12	12		0	0
	Hopkins	Locust		3	3	3	3	5	5	5		0	0
	Humboldt	Locust		8	6	6	6	10	10	10		7	7
	Humboldt	North		8	5	5	5	7	7	7		4	4
	Humboldt	Wright		8	4	4	4	8	8	8		0	0
	Kenwood	Maryland		8	8	8	8	5	5	5		0	0
	Kenwood	Oakland		8	8	8	8	4	4	4		0	0
	Lake Dr	North		8	2	2	2	11	11	11		4	4
	Lisbon	27th		8	8	8	8	6	6	6		2	2
	Lisbon	35th		8	8	8	8	4	4	4		0	0
	Lisbon	40th		8	3	3	2	10	10	10		0	2
	Lisbon	68th		8	6	6	6	8	8	8		0	0
	Lisbon	Walnut		8	6	6	6	6	6	6		0	0
	Lloyd	12th	24th	8	0	0	0	12	12	12		0	0
	Lloyd	46th		6	6	6	6	4	4	4		0	0
	Lloyd	47th		6	4	4	4	5	5	5		0	0
	Lloyd	55th		8	0	0	0	12	12	12		0	0
	Lloyd	60th		8	0	0	0	12	12	12		0	0

ITEM	Street 1	Street 2	71066RL Ped DW-W	71064RL 12" R	71064YL 12" Y	71064GL 12" G	71072RL 8" R	71072YL 8" Y	71072GL 8" G	12" RA	12" YA	12" GA
		Street 3										
Lloyd		Sherman	4	5	3	3	3	3	3	4	4	4
Locust		12th	8	8	8	8	4	4	4	0	0	0
Locust		24th	8	0	0	0	12	12	12	0	0	0
Locust		27th	8	6	6	6	6	6	6	0	0	0
Locust		35th	8	7	7	7	5	5	5	0	0	0
Locust		51st	8	4	4	4	8	8	8	0	0	0
Locust		7th	8	7	7	7	4	4	4	0	0	2
Locust		8th	6	6	6	6	3	3	3	0	0	2
Locust		Maryland	8	0	0	0	12	12	12	0	0	0
Locust		Newhall	6	5	5	5	7	7	7	0	0	0
Locust		Oakland	8	0	6	6	0	6	6	6	6	6
Locust		Sherman	8	2	2	2	9	9	9	0	0	0
Locust		Teutonia	8	9	9	9	4	4	4	2	2	2
North		12th	8	3	3	3	7	7	7	0	0	0
North		16th	8	1	1	1	8	8	8	0	0	0
North		17th	8	6	5	5	6	7	7	0	0	0
North		2nd	8	4	2	2	8	10	10	0	0	0
North		32nd	8	3	3	3	8	8	8	0	0	0
North		35th	8	8	8	8	4	4	4	0	0	0
North		46th	8	6	5	5	3	4	4	0	0	2
North		49th	8	3	3	3	7	7	7	2	2	2
North		4th	8	4	2	2	8	10	10	0	0	0
North		55th	8	6	6	6	6	6	6	0	0	0
North		60th	8	0	0	0	12	12	12	0	0	0
North		7th	6	4	4	4	4	4	4	0	0	0
North		8th	7	6	6	6	3	3	3	0	0	0
North		Oakland	8	6	6	6	6	6	6	2	2	2
Oakland		Park	8	4	4	4	8	8	8	0	0	0
Reservoir		6th	6	8	2	2	1	7	7	0	0	0
Sherman		Wright	8	2	2	2	10	10	10	0	0	0
Teutonia		Wright	8	0	0	0	12	12	12	0	0	0
Walnut		12th	8	8	8	8	6	6	6	0	0	0
Walnut		17th	8	8	8	8	4	4	4	0	0	0
Wright		7th	6	3	2	2	6	7	7	0	0	0
Wright		8th	6	3	2	2	6	7	7	0	0	0
ITEM TOTALS			758	452	439	435	711	742	741	2	49	59

2004 HES Grant-Signal Locations

Local Streets

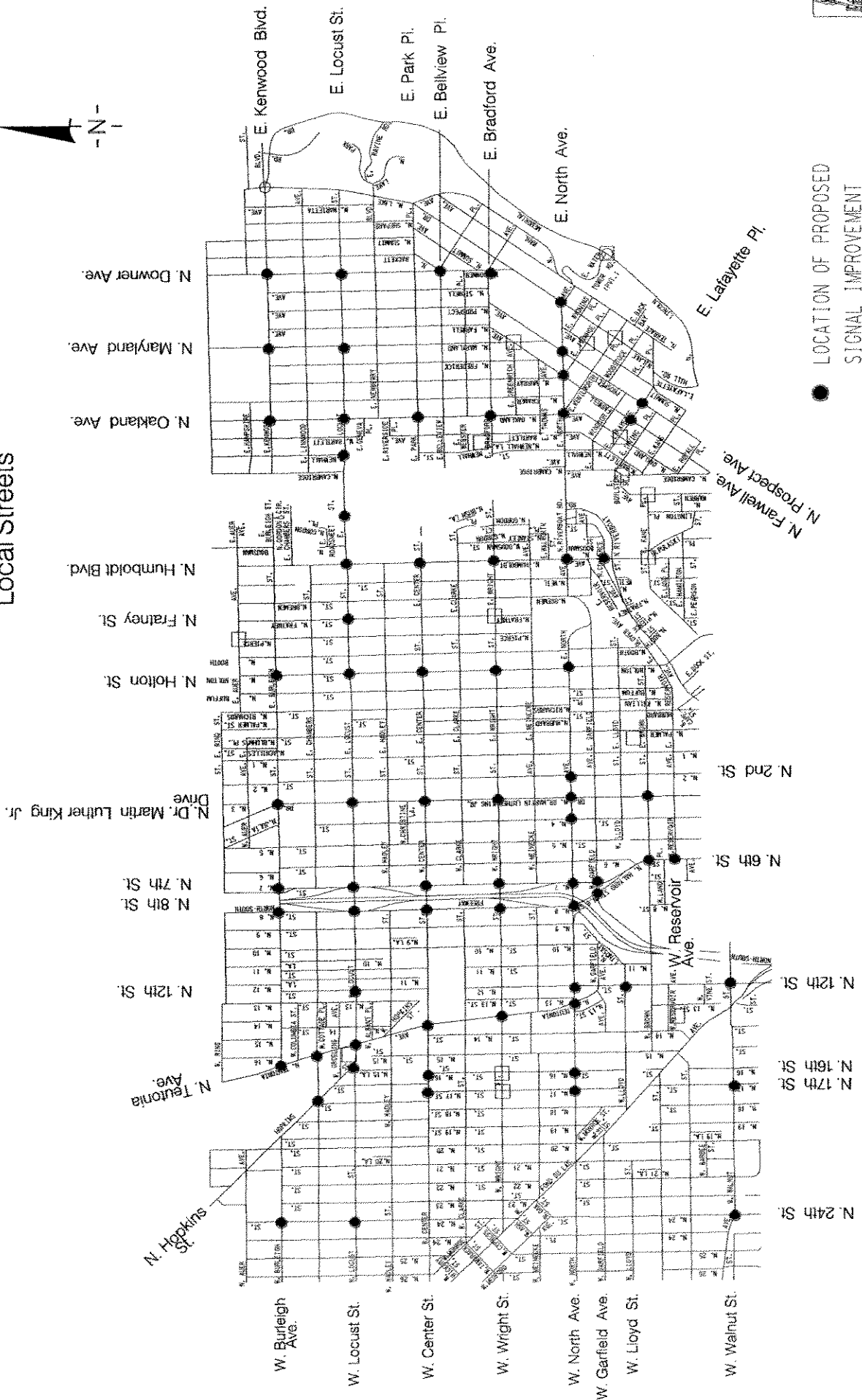

● LOCATION OF PROPOSED
SIGNAL IMPROVEMENT

2004 HES Grant-Signal Locations

Local Streets

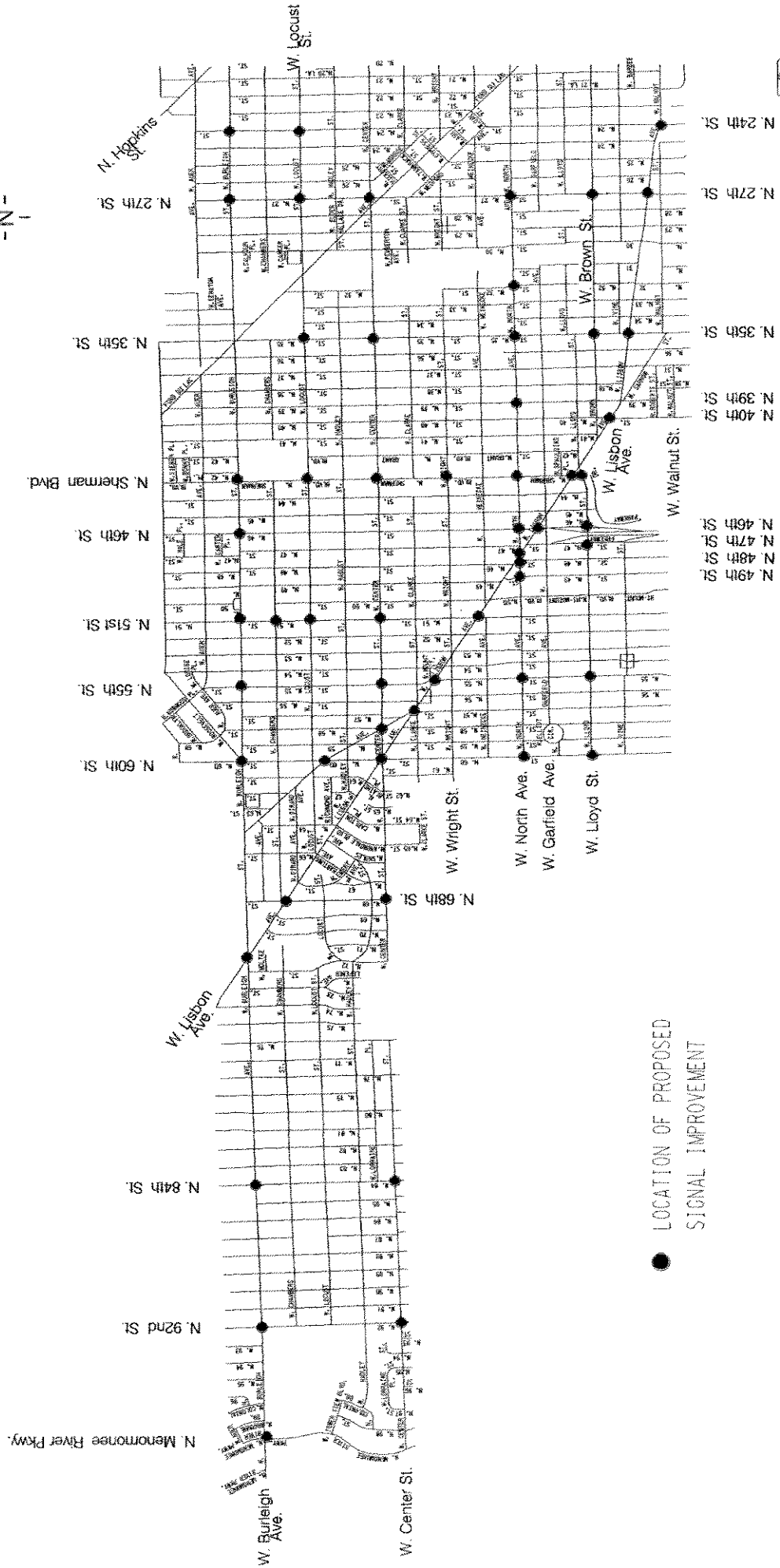

● LOCATION OF PROPOSED
SIGNAL IMPROVEMENT

