

DD# 2532

CERTIFIED SURVEY MAP NO.

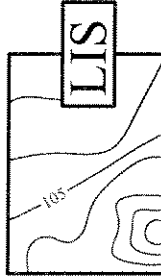

BEING A REDIVISION OF LOTS 13 AND 14, IN BLOCK 3 OF WECHSELBERG AND ELLIOTT'S SUBDIVISION, IN THE SOUTHEAST 1/4 OF THE NORTHEAST 1/4 OF SECTION 17, TOWNSHIP 7 NORTH, RANGE 22 EAST, IN THE CITY OF MILWAUKEE, COUNTY OF MILWAUKEE, STATE OF WISCONSIN.

LAND INFORMATION SERVICES, INC.
ENGINEERS, SURVEYORS & CONSULTANTS

9722 WATERTOWN PLANK ROAD
BUILDING S-5
WAUWATOSA, WI 53226
T 414-302-9515 F 414-302-9516
DRAWN BY: J.D.H. 08/21/06

○ INDICATES IRON PIPE FOUND

● INDICATES 1 INCH DIA. IRON PIPE, 18 INCHES IN LENGTH, WEIGHING 1.13 LBS PER LINEAL FOOT, SET.

ALL DIMENSIONS SHOWN ARE MEASURED TO THE NEAREST HUNDREDTH OF A FOOT.

ALL BEARINGS SHOWN ARE REFERENCED TO THE EAST LINE OF THE NORTHEAST 1/4 OF SECTION 17-7-22, WISCONSIN STATE PLANE COORDINATE SYSTEM GRID, SOUTH ZONE, AND ALL BEARINGS ARE REFERENCED TO GRID NORTH. (DEC. 2005 DATUM)

TAX KEY NUMBER: 313-2242-100

ZONING: RT4



NORTH PALMER STREET (80' RM)

NE COR. OF THE
NE 1/4 OF SEC
17-7-22
N. 398.72552
E. 2.559,007.37
CONCRETE MONUMENT
WITH BRASS CAP

LOT 12
BLOCK 3, WECHSELBERG & ELLIOTT'S SUBDIVISION

N 89°05'35" E 115.18'

LOT 1
3.455 SO.FT.
OR 0.079 AC.

LOT 2
3.455 SO.FT.
OR 0.079 AC.

N 89°05'35" E 115.18'

115.18'

S 89°05'35" W 115.18'

LOT 15
BLOCK 3, WECHSELBERG & ELLIOTT'S SUBDIVISION

437.18'

E. HADLEY ST.

S 89°05'35" W

VICINITY MAP

SCALE = 1" = 2000'

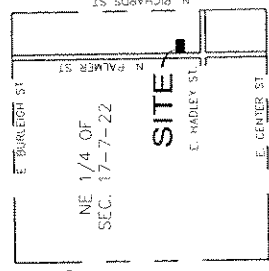

GRAPHIC SCALE



INFRASTRUCTURE SERVICES DIVISION
CENTRAL DRAFTING & RECORDS MANAGER
ENGR. IN CHARGE ENVIRON. ENGR.
CITY ENGINEER
APPROVED

Maxine Lindholm 10/16/06
Mark L. Wertz 10/16/06
Mark L. Wertz 10/16/06

THIS INSTRUMENT DRAFTED BY MARK L. WERTZ

D60 #2582

CERTIFIED SURVEY MAP NO.

BEING A REDIVISION OF LOTS 13 AND 14, IN BLOCK 3 OF WECHSELBERG AND ELLIOTT'S SUBDIVISION, IN THE SOUTHEAST 1/4 OF THE NORTHEAST 1/4 OF SECTION 17, TOWNSHIP 7 NORTH, RANGE 22 EAST, IN THE CITY OF MILWAUKEE, COUNTY OF MILWAUKEE, STATE OF WISCONSIN.

SURVEYOR'S CERTIFICATE

STATE OF WISCONSIN) SS
MILWAUKEE COUNTY)

I, MARK L. WERTZ, A REGISTERED LAND SURVEYOR, HEREBY CERTIFY:

THAT I HAVE SURVEYED, REDIVIDED AND MAPPED LOTS 13 AND 14, IN BLOCK 3 OF WECHSELBERG AND ELLIOTT'S SUBDIVISION, IN THE SOUTHEAST 1/4 OF THE NORTHEAST 1/4 OF SECTION 17, TOWNSHIP 7 NORTH, RANGE 22 EAST, IN THE CITY OF MILWAUKEE, COUNTY OF MILWAUKEE, STATE OF WISCONSIN, BOUNDED AND DESCRIBED AS FOLLOWS:

COMMENCING AT THE SOUTHEAST CORNER OF THE NORTHEAST 1/4 OF SECTION 17, TOWNSHIP 7 NORTH, RANGE 22 EAST, THENCE NORTH 00°57'57" WEST ALONG THE EAST LINE OF SAID 1/4 SECTION, 694.52 FEET TO A POINT ON THE NORTH LINE OF EAST HADLEY STREET AND ITS EXTENSION THEREOF; THENCE SOUTH 89°05'35" WEST, ALONG SAID NORTH LINE 437.18 FEET TO A POINT ON THE EAST LINE OF NORTH PALMER STREET; THENCE NORTH 00°56'00" WEST ALONG SAID EAST LINE, 180.00 FEET TO THE POINT OF BEGINNING; THENCE CONTINUING NORTH 00°56'00" WEST, 60.00 FEET; THENCE NORTH 89°05'35" EAST, 115.18 FEET; THENCE SOUTH 00°56'00" EAST, 60.00 FEET; THENCE SOUTH 89°05'35" WEST 115.18 FEET TO THE POINT OF BEGINNING.

CONTAINING 6,910 SQUARE FEET, 0.158 ACRES

THAT I HAVE MADE SUCH SURVEY, LAND DIVISION AND MAP BY THE DIRECTION OF BRILLIANT G. NIMMER, OWNER OF SAID LAND.

THAT SUCH MAP IS A CORRECT REPRESENTATION OF ALL EXTERIOR BOUNDARIES OF THE LAND SURVEYED AND THE DIVISION THEREOF MADE.

THAT I HAVE FULLY COMPLIED WITH THE PROVISIONS OF CHAPTER 236.34 OF THE STATUTES OF THE STATE OF WISCONSIN AND THE REQUIREMENTS OF CHAPTER 119 OF THE MILWAUKEE CODE OF ORDINANCES IN SURVEYING, DIVIDING, MAPPING AND DEDICATING THE SAME.

DATED THIS 21 DAY OF August, 2006.

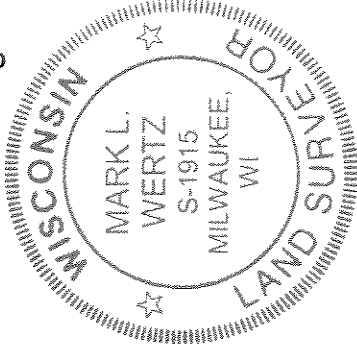

MARK L. WERTZ
REGISTERED LAND SURVEYOR, S-1915
STATE OF WISCONSIN

DCD #2582

CERTIFIED SURVEY MAP NO.

BEING A REDIVISION OF LOTS 13 AND 14, IN BLOCK 3 OF WECHSELBERG AND ELLIOTT'S SUBDIVISION, IN THE SOUTHEAST 1/4 OF THE NORTHEAST 1/4 OF SECTION 17, TOWNSHIP 7 NORTH, RANGE 22 EAST, IN THE CITY OF MILWAUKEE, COUNTY OF MILWAUKEE, STATE OF WISCONSIN.

OWNER'S CERTIFICATE

BRILLIANT G. NIMMER, DOES HEREBY CERTIFY THAT HE HAS CAUSED THE LAND DESCRIBED ON THIS MAP TO BE SURVEYED, REDIVIDED AND MAPPED AS REPRESENTED ON THIS MAP IN ACCORDANCE WITH THE REQUIREMENTS OF CHAPTER 119 OF THE MILWAUKEE CODE OF ORDINANCES.

IN CONSIDERATION OF THE APPROVAL OF THE MAP BY THE COMMON COUNCIL OF THE CITY OF MILWAUKEE AND IN ACCORDANCE WITH CHAPTER 119 OF THE MILWAUKEE CODE, THE UNDERSIGNED AGREES:

A. THAT ALL UTILITY LINES TO PROVIDE ELECTRIC POWER AND TELEPHONE SERVICE AND CABLE TELEVISION OR COMMUNICATIONS SYSTEMS LINES OR CABLES TO ALL LOTS IN THE CERTIFIED SURVEY MAP SHALL BE INSTALLED UNDERGROUND IN EASEMENTS PROVIDED THEREFORE, WHERE FEASIBLE.

THIS AGREEMENT SHALL BE BINDING ON THE UNDERSIGNED AND ASSIGNS. WITNESS THE HAND AND SEAL OF SAID OWNER THIS DAY OF , 2006.

Brilliant G. Nimmer
BRILLIANT G. NIMMER, OWNER

Eric J
(WITNESS)

STATE OF WISCONSIN) SS
MILWAUKEE COUNTY)

PERSONALLY CAME BEFORE ME THIS 9th DAY OF October, 2006, THE ABOVE--NAMED, BRILLIANT G. NIMMER, TO ME KNOWN TO BE THE PERSON WHO EXECUTED THE FOREGOING INSTRUMENT AND ACKNOWLEDGED THE SAME.

Jennifer J. Jurek
NOTARY PUBLIC
STATE OF WISCONSIN
MY COMMISSION EXPIRES: 15 PERMANENT

CERTIFICATE OF CITY TREASURER

STATE OF WISCONSIN) SS
MILWAUKEE COUNTY)

I, WAYNE F. WHITTOW, BEING THE DULY ELECTED, QUALIFIED AND ACTING CITY TREASURER OF THE CITY OF MILWAUKEE, CERTIFY THAT IN ACCORDANCE WITH THE RECORDS IN THE OFFICE OF THE CITY TREASURER OF THE CITY OF MILWAUKEE THERE ARE NO UNPAID TAXES OR UNPAID SPECIAL ASSESSMENTS ON THE LAND INCLUDED IN THIS CERTIFIED SURVEY MAP.

(DATE) 10-17-06

Wayne F. Whittow
WAYNE F. WHITTOW, CITY TREASURER

COMMON COUNCIL CERTIFICATE OF APPROVAL

I HEREBY CERTIFY THAT THIS CERTIFIED SURVEY MAP WAS APPROVED UNDER RESOLUTION FILE NO. 06-0821, ADOPTED BY THE COMMON COUNCIL OF THE CITY OF MILWAUKEE ON THIS 21st DAY OF October, 2006.



Ronald D. Leonhardt
RONALD D. LEONHARDT, CITY CLERK

Tom Barrett
TOM BARRETT, MAYOR