

CERTIFIED SURVEY MAP NO. _____

RE-DIVISION OF LOTS 1 THRU 8, BLOCK 2, GREENDALE No. 3 BEING PART OF THE SOUTHEAST 1/4 OF THE SOUTHWEST 1/4 OF SECTION 2, TOWNSHIP 7 NORTH, RANGE 21 EAST OF THE FOURTH PRINCIPAL MERIDIAN, IN THE CITY OF MILWAUKEE, COUNTY OF MILWAUKEE, STATE OF WISCONSIN.

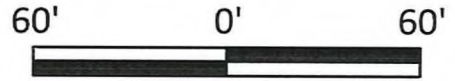

SCALE 1"=60'

NOTES:
ZONING OF PARCELS IS: RB2

TAX ID: 249-0511-110 AND
249-0510-000

N 53rd STREET
(60' WIDTH)

N 45°43'07" E 120.00

W FOND DU LAC AVENUE
(160' WIDTH)

S 44°16'53" E 330.00

PUBLIC ALLEY (20' WIDTH)

LOT 1
0.909 Acres
39,600 Sq.Ft.

10
BLOCK 2
GREENDALE No. 3

N 44°16'53" W 330.00

EX. BLDG. TO BE RAZED

PROP. BLDG.

EX. BLDG. TO BE RAZED

24
GREENDALE No. 3

BLOCK 2

S 45°43'07" W 120.00
N 52nd STREET
(90' WIDTH)



Nielsen Madsen + Barber

CIVIL ENGINEERS AND LAND SURVEYORS
1458 Horizon Blvd. Suite 200, Racine, WI. 53406
Tele: (262)634-5588 Website: www.nmbssc.net

This Instrument was drafted by Mark R. Madsen April 7, 2023 Revised May 12, 2023

SW COR. SW 1/4
SECTION 2-7-21
N 403,752.58
E 2,506,165.33

S 89°20'37" W 2297.41
S.L. OF SW 1/4 SECTION 2-7-21

S 89°20'37" W 349.16
S 89°20'37" W 2646.57

SE COR. SW 1/4
SECTION 2-7-21
N 403,782.89
E 2,508,811.51

2022.0245.01.DWG
SHEET 1 OF 5 SHEETS

INFRASTRUCTURE SERVICES DIVISION

John M... 6/7/2023
CENTRAL DRAFTING & RECORDS MANAGER

KT... 6-7-23
ENGR. IN CHARGE ENVIRON. ENGR.

[Signature] 6/8/2023
CITY ENGINEER

APPROVED

DEPARTMENT OF CITY DEVELOPMENT
CITY OF MILWAUKEE

APR 24 2023
[Signature]
STAFF APPROVED

CERTIFIED SURVEY MAP NO. _____

RE-DIVISION OF LOTS 1 THRU 8, BLOCK 2, GREENDALE No. 3 BEING PART OF THE
SOUTHEAST 1/4 OF THE SOUTHWEST 1/4 OF SECTION 2, TOWNSHIP 7 NORTH,
RANGE 21 EAST OF THE FOURTH PRINCIPAL MERIDIAN, IN THE CITY OF MILWAUKEE,
COUNTY OF MILWAUKEE, STATE OF WISCONSIN.

BUILDING DETAIL

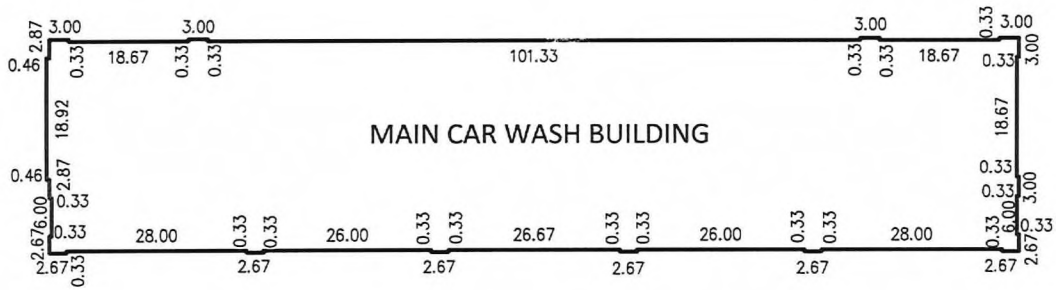
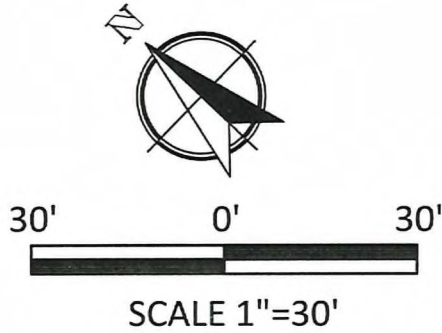

WARMING AND VACUUM BUILDING



NOTES:

OWNER/LAND SPLITTER: PARK & PARK PROPERTY LLC.
ADDRESS: 5225 W. FOND DU LAC AVENUE
MILWAUKEE, WI 53216

BEARINGS BASE: GRID NORTH, WISCONSIN
COORDINATE SYSTEM, SOUTH ZONE. BASED UPON
NAD 1983 / 2011. THE SOUTH LINE OF THE SW 1/4 OF
SECTION 2-7-21 IS ASSUMED TO BEAR S 89°20'37" W.

LEGEND:

- 1" O.D. IRON PIPE FOUND
- 3/4" O.D. x 18" REBAR - 1.51 LBS/LIN FT. SET
- ⊕ 6" CONC. MON. W / SEWRPC BRASS CAP FOUND

LOCATION MAP

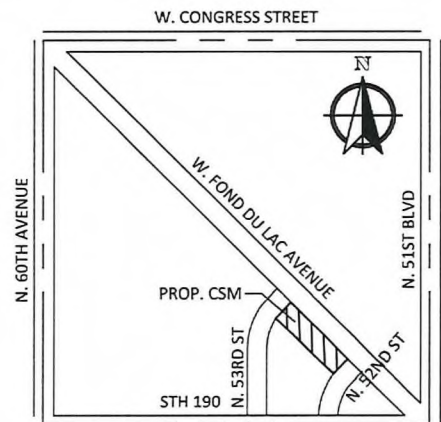

SOUTHWEST 1/4 SECTION 2-7-21



Nielsen Madsen + Barber

CIVIL ENGINEERS AND LAND SURVEYORS
1458 Horizon Blvd. Suite 200, Racine, WI. 53406
Tele: (262)634-5588 Website: www.nmbc.net

CERTIFIED SURVEY MAP NO. _____

RE-DIVISION OF LOTS 1 THRU 8, BLOCK 2, GREENDALE No. 3 BEING PART OF THE SOUTHEAST 1/4 OF THE SOUTHWEST 1/4 OF SECTION 2, TOWNSHIP 7 NORTH, RANGE 21 EAST OF THE FOURTH PRINCIPAL MERIDIAN, IN THE CITY OF MILWAUKEE, COUNTY OF MILWAUKEE, STATE OF WISCONSIN.

SURVEYOR'S CERTIFICATE

STATE OF WISCONSIN)
): ss
MILWAUKEE COUNTY)

I, MARK R. MADSEN, professional land surveyor, certify:

That I have surveyed, divided and mapped the following described properties; Lots 1, 2, 3, 4, 5, 6, 7, and 8, Block 2 of Greendale No. 3 a recorded plat in the City of Milwaukee, being a part of the of the Southeast 1/4 of the Southwest 1/4 of Section 2, Township 7 North, Range 21 East of the Fourth Principal Meridian, in the City of Milwaukee, Milwaukee County, Wisconsin. Containing 39,600 Sq. Ft. or 0.909 acres.

That I have made the survey, land division, and map by the direction of TSUNAMI EXPRESS CAR WASH MILWAUKEE LLC. That the map is a correct representation of all the exterior boundaries of the land surveyed and the land division thereof made.

That I have fully complied with Chapter 236 of the Wisconsin Statutes and Chapter 119 of the Milwaukee Code of Ordinances in surveying, dividing and mapping the same.

May 12, 2023



Mark R. Madsen, P.E., P.L.S. No. S-2271
Nielsen Madsen & Barber SC
1458 Horizon Blvd, Suite 200
Racine, WI 53406
(262) 634-5588



Nielsen Madsen + Barber
CIVIL ENGINEERS AND LAND SURVEYORS
1458 Horizon Blvd. Suite 200, Racine, WI. 53406
Tele: (262)634-5588 Website: www.nmbssc.net

