



CITY OF MILWAUKEE
OFFICE OF THE CITY CLERK

Thursday, December 17, 2020

COMMITTEE MEETING NOTICE

AD 13

SRAN, Gagandeep S, Agent
Sran Beer and Liquor Inc
3511 S 20TH St

Milwaukee, WI 53221

You are requested to attend a virtual hearing to be held on:

Tuesday, January 05, 2021 at 02:50 PM

Regarding: Your Class A Malt & Class A Liquor and Food Dealer License Applications as agent for "Sran Beer and Liquor Inc" for "Wilson Park Beverage Mart" at 3511 S 20TH St.

This meeting will be held via GoToMeeting. Please see the enclosed best practices document for further instructions. The access code is <https://global.gotomeeting.com/join/306018541>. If you wish to call in, please call +1 (408) 650-3123 and use Access Code: 306-018-541.

There is a possibility that your application may be denied for one or more of the following reasons: The recommendation of the committee regarding the application shall be based on evidence presented at the hearing. Per MCO 85-2.7-4, probative evidence concerning whether or not a new license should be granted may be presented on the following subjects: whether or not the applicant meets the municipal requirements, the appropriateness of the location and premises where the licensed premises is to be located and whether use of the premises for the purposes or activities permitted by the license would tend to facilitate a public or private nuisance or create undesirable neighborhood problems such as disorderly patrons, unreasonably loud noise, litter, and excessive traffic and parking congestion. Probative evidence relating to these matters may be taken from the plan of operation submitted with the license application, if any, but shall not include the content of any music. Evidence regarding the fitness of the location of the premises to be maintained as the principal place of business, including but not limited to whether there is an overconcentration of businesses of the type for which the license is sought; whether the proposal is consistent with any pertinent neighborhood business or development plans, or the location's proximity to areas where children are typically present. The applicant's record in operating similarly licensed premises; and whether or not the applicant has been charged with or convicted of any felony, misdemeanor, municipal offense or other offense, the circumstances of which substantially relate to the activity to be permitted by the license being applied for or any other factor which reasonably relates to the public health, safety or welfare may also be considered. See attached police report or correspondence.

Notice for applicants with warrants or unpaid fines: Proof of warrant satisfaction or payment of fines must be submitted at the hearing on the above date and time. Failure to comply with this requirement may result in a delay of the granting/denial of your application.

Failure to attend this meeting may result in the denial of your license. Individual applicants and partnership applicants must attend or attend by an attorney. The agent or attorney for corporate or limited liability applicants must attend. If you wish to do so and at your own expense, you may be accompanied by an attorney of your choosing to represent you at this hearing.

You will be given an opportunity to speak on behalf of the application and to respond and challenge any charges or reasons given for the denial. No petitions can be accepted by the committee, unless the people who signed the petition attend the virtual hearing and are willing to testify. You may present witnesses under oath and you may also confront and cross-examine opposing witnesses under oath. If you have difficulty with the English language, you should request an interpreter attend the meeting with you, at your expense, so that you can answer questions and participate in your hearing.

PLEASE NOTE: Upon reasonable notice, efforts will be made to accommodate the needs of disabled individuals through sign language interpreters or other auxiliary aids. For additional information or to request this service, contact the Council Services Division ADA Coordinator at (414) 286-2998, Fax - (414) 286-3456, TDD - (414) 286-2025.

JIM OWCZARSKI, CITY CLERK

BY: _____

Jessica Cejella

License Division Manager

If you have questions regarding this meeting, please contact the staff assistant, Molly Kuether-Steele at (414) 286-2775 or molly.kuether-steele@milwaukee.gov.

200 E. Wells Street, Room 105, City Hall, Milwaukee, WI 53202. www.milwaukee.gov/license
Phone: (414) 286-2238 Fax: (414) 286-3057 Email Address: License@milwaukee.gov



CITY OF MILWAUKEE
OFFICE OF THE CITY CLERK

Thursday, December 17, 2020

COMMITTEE MEETING NOTICE

AD 13

SRAN, Gagandeep S, Agent
Sran Beer and Liquor Inc
428 1/2 Montana Ave

South Milwaukee, WI 53172

You are requested to attend a virtual hearing to be held on:

Tuesday, January 05, 2021 at 02:50 PM

Regarding: Your Class A Malt & Class A Liquor and Food Dealer License Applications as agent for "Sran Beer and Liquor Inc" for "Wilson Park Beverage Mart" at 3511 S 20TH St.

This meeting will be held via GoToMeeting. Please see the enclosed best practices document for further instructions. The access code is <https://global.gotomeeting.com/join/306018541>. If you wish to call in, please call +1 (408) 650-3123 and use Access Code: 306-018-541.

There is a possibility that your application may be denied for one or more of the following reasons: The recommendation of the committee regarding the application shall be based on evidence presented at the hearing. Per MCO 85-2.7-4, probative evidence concerning whether or not a new license should be granted may be presented on the following subjects: whether or not the applicant meets the municipal requirements, the appropriateness of the location and premises where the licensed premises is to be located and whether use of the premises for the purposes or activities permitted by the license would tend to facilitate a public or private nuisance or create undesirable neighborhood problems such as disorderly patrons, unreasonably loud noise, litter, and excessive traffic and parking congestion. Probative evidence relating to these matters may be taken from the plan of operation submitted with the license application, if any, but shall not include the content of any music. Evidence regarding the fitness of the location of the premises to be maintained as the principal place of business, including but not limited to whether there is an overconcentration of businesses of the type for which the license is sought; whether the proposal is consistent with any pertinent neighborhood business or development plans, or the location's proximity to areas where children are typically present. The applicant's record in operating similarly licensed premises; and whether or not the applicant has been charged with or convicted of any felony, misdemeanor, municipal offense or other offense, the circumstances of which substantially relate to the activity to be permitted by the license being applied for or any other factor which reasonably relates to the public health, safety or welfare may also be considered. See attached police report or correspondence.

Notice for applicants with warrants or unpaid fines: Proof of warrant satisfaction or payment of fines must be submitted at the hearing on the above date and time. Failure to comply with this requirement may result in a delay of the granting/denial of your application.

Failure to attend this meeting may result in the denial of your license. Individual applicants and partnership applicants must attend or attend by an attorney. The agent or attorney for corporate or limited liability applicants must attend. If you wish to do so and at your own expense, you may be accompanied by an attorney of your choosing to represent you at this hearing.

You will be given an opportunity to speak on behalf of the application and to respond and challenge any charges or reasons given for the denial. No petitions can be accepted by the committee, unless the people who signed the petition attend the virtual hearing and are willing to testify. You may present witnesses under oath and you may also confront and cross-examine opposing witnesses under oath. If you have difficulty with the English language, you should request an interpreter attend the meeting with you, at your expense, so that you can answer questions and participate in your hearing.

PLEASE NOTE: Upon reasonable notice, efforts will be made to accommodate the needs of disabled individuals through sign language interpreters or other auxiliary aids. For additional information or to request this service, contact the Council Services Division ADA Coordinator at (414) 286-2998, Fax - (414) 286-3456, TDD - (414) 286-2025.

JIM OWCZARSKI, CITY CLERK

BY: _____

Jessica Celella

License Division Manager

If you have questions regarding this meeting, please contact the staff assistant, Molly Kuether-Steele at (414) 286-2775 or molly.kuether-steele@milwaukee.gov.

200 E. Wells Street, Room 105, City Hall, Milwaukee, WI 53202. www.milwaukee.gov/license
Phone: (414) 286-2238 Fax: (414) 286-3057 Email Address: License@milwaukee.gov

Date: 11-20-2020
Officer: PO Michael WARD

City of Milwaukee Police Department
90-5-1.5 Crime Prevention Survey
Convenience Store/Liquor Store Inspection

Name of Premise: Sran Liquor and Beer
Address: 3511 S. 20th St. Milwaukee, WI 53221
Phone: 414-281-8383

Owner: SRAN, Gagandeep Singh
Owner address: 428 1/2 Montana Ave.
City State Zip: South Milwaukee, WI 53172
Owner Phone: 414-248-4228
Owner email: gagandeepsran1989@Gmail.com

Manager:
Home Address:
City State Zip:
Phone:
Email:

Preferred contact: SRAN, Gagandeep

Location currently open: YES NO **Still under old ownership.**

Projected open date:

Day's open: S M T W Th F SA ALL

Hours of Operation: Sun: 9am to 9pm 24 hours Y N
Mon: 9am to 9pm
Tue: 9am to 9pm
Wed: 9am to 9pm
Thu: 9am to 9pm
Fri: 9am to 9pm
Sat: 9am to 9pm

Premise Type: Liquor Store
Convenience Store
Other:

Licenses currently held:

- Alcohol: Yes No Class: #:
- Tobacco: Yes No #:
- Food: Yes No #:
- Extended Hours: Yes No #:
- Secondhand Dealer: Yes No Type: #:
- Other: Yes No Type: #:
- Other: Yes No Type: #:

Exterior Survey:

1. Is the area around the location clean? Yes No
2. What surrounds the location? (Check all the apply)
 - a. Park
 - b. School
 - c. Youth Center
 - d. Church
 - e. Tavern(s) If so, how many
 - f. Residential
 - g. Other businesses
 - h. Other:
3. Can you see from the outside of the location into the interior Yes No **40%**
4. Can you see the employees inside of the location from the outside Yes No – **Minimal**
5. Are exterior windows free of signage Yes No **Advised to remove signage and large shelf near exterior window. Moved some signage while on scene.**
6. Is there a parking lot Yes No
7. Is the parking lot clean? Yes No
8. Is the parking lot well lit? Yes No **Did not observe during hours of darkness.**
9. Are there areas where a person could conceal themselves Yes No
10. Is there exterior lighting? Yes No. Does it appears to be adequate Yes No
11. Exterior Payphone? Yes No
12. Are there No Loitering Signs posted? Yes No
13. Are there exterior security cameras Yes No How Many: **2**
14. Are the address numbers prominently displayed and easy to see Yes No

Camera Survey:

15. Does this location have security cameras? Yes No
16. Are they in working order? Yes No
17. What format are the cameras?
 - a. Color Yes No
 - b. Digital Yes No
 - c. VCR Yes No
 - d. Recorded Yes No
18. How long is footage stored for later viewing: **One Month**
19. Are there exterior cameras Yes No How many: **2**
20. Are there interior cameras Yes No How many: **6**

21. Do all employees know how to retrieve recorded digital images/footage? Yes No

Interior Survey:

22. Is the storeowner willing to be a standing complainant regarding loitering? Yes No
a. If yes have them fill out the standing complaint form and give them two of the commercial signs Yes No
23. Is the interior of the location neat and clean? Yes No
24. Does an interior camera face the entrance/exit? Yes No
25. Is there a lockable area that separates employees from customers? Yes No
26. Does the store sell single chore boy? Yes No
27. Does the store sell blunt wraps? Yes No
28. Does the store sell scales? Yes No
29. Does the store sell items that may be used as crack pipes? Yes No
a. Describe item:
30. Does the store have an over abundance of sandwich baggies: Yes No
31. Does the owner understand that these items are often used for drug use? Yes No
32. Do the products in the store appear to be new and rotated often? Yes No
33. Are emergency and non-emergency numbers posted near the phone? Yes No
34. Does the owner know how to contact their police district directly? Yes No
a. Did you provide a district contact guide to the owner? Yes No

Complete this section if alcohol establishment is a convenience store:

(** Read full ordinance for all details "68-4.3 Convenience Food Stores")

All convenience food stores not exempted under sub. 3 shall:

1. Is the cash register located in a manner so that at the time of a sales transaction, the employee and customer are both visible from the sidewalk? Yes No **
2. Are the glass entrance and exit doors clear of any signs or advertisements with the exception of a sign which states that the cash register contains \$50 or less and that the safe is no accessible to employees? Yes No
3. Does the store maintain one of the following on the licensed premise:
 - a. A safe that was in use at the convenience food store on August 17, 1994? Yes No
 - b. A drop-safe or time release safe that weighs at least 500 pounds or which is attached to or set into the floor in a manner approved by the police department? Yes No **Safe was open in an unsecured room. Was advised to keep safe secured at all times.**
4. Is lighting provided for the store's parking area during all hours of darkness when employees or customers are on the premises at a minimum average of 2-foot candles per square foot, unless the store is not open for business after sunset and before sunrise? Yes No N/A **Observed lighting but not at hours of darkness.**
5. Are at least two high-resolution surveillance security cameras installed? Yes No
6. Are the security cameras in working order? Yes No
7. Does one camera show an overall view of the counter and register area? Yes No
8. Does one camera show a clear, identifiable, full frame image of the face of each person entering and leaving the store? Yes No

9. Are the camera views obstructed by fixtures or displays? Yes No
10. Is the recorded footage stored for at least 30 days? Yes No
11. ~~Do all store employees know how to record footage from the camera system to media capable of~~
being transferred to police custody? Yes No
12. Are customer entrances/exits made of glass or other transparent material? Yes No
- a. Exception: A store that does not have such doors on August 17, 1994 shall not be required to install such doors until the holder of the store's food dealer license changes.
13. Has the owner and their employees attended the Robbery Prevention Training within 120 days of ownership or employment? Yes No
- a. Contact Community Outreach and Education at 935-7836 for schedule.

Sub 3. Exemptions. The requirements of this section do not apply to a convenience food store that conforms to either of the following descriptions:

- a-1. The store is located in an enclosed shopping structure, enclosed commercial building or hospital. A convenience food store is not in an enclosed structure or building if a customer can enter it directly from the outside.
Does store conform to a-1 Yes No
- a-2. The store physically separates employees from customers with a solid partition that bars a person from entering the employee area from the customer area, has a secure lock on the employee side of any door between the employee area and the customer, and conducts all transaction through a service window or similar arrangement.
Does store conform to a-2 Yes No
- a. At the commissioner's discretion, a convenience store may be exempted from any or all of the regulations specified in sub 2.
Does this location hold an exemption from the commissioner regarding any of the requirements of Sub 2? Yes No

ADDITIONAL COMMENTS/RECOMMENDATIONS:

This report is written by Police Officer Michael WARD. On this day I was assigned to Squad 6264 with Police Officer Fabian GARCIA.

On November 20th, 2020, we conducted a CPTED survey at 3511 S. 20th St., Wilson Park Liquor. Future new owner and agent, Gagandeep Singh SRAN (A/M, 12-25-1989) was present during the time of the survey.

Recommendations and observations made:

1. Safe is located in the breakroom bolted to the floor but unsecured. Advised to keep safe secured at all times. Also advised adding a door that can be secured for the breakroom. Currently just a curtain separates break room and sales floor.

2. Signage on exterior windows blocks view in to store. Advised signage and large shelf in front of window be removed to have better sight lines into the store. While on scene some of the signage was removed.

3. Basement is used for storage. Advised to put an adequate lock on door to prevent customers going down stairs.

4. ATM located in the store near entrance.

Register counter is surrounded with plexi glass and has a door which secures from the inside.

Mr. SRAN was receptive to our recommendations and was advised this survey would be submitted.



Concentration Map 3511 S 20th ST

Area of Interest (AOI) Information

Area : 21,862,585.72 ft²

Nov 13 2020 12:41:54 Central Standard Time

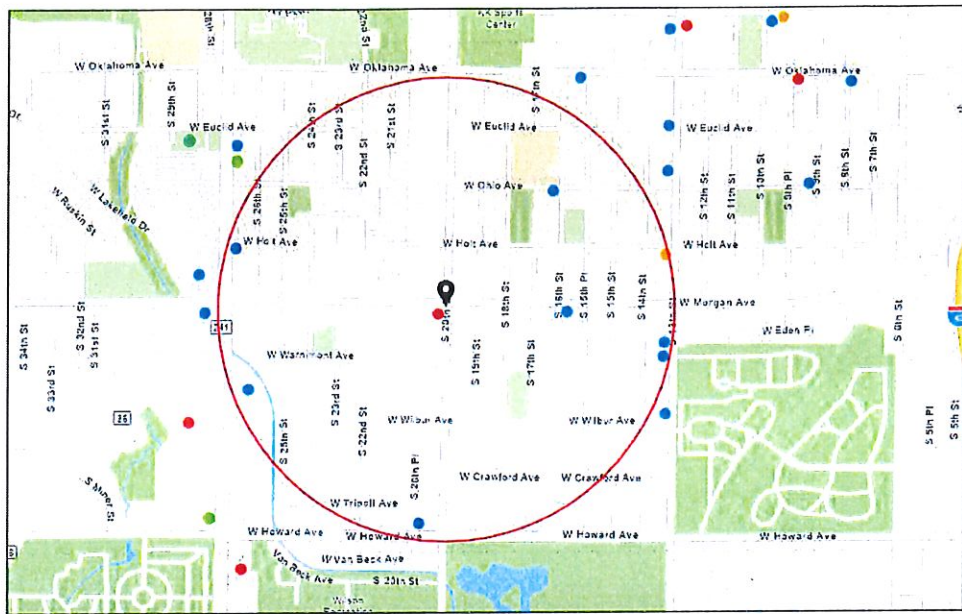

- Alcohol Licenses
 - Class A Fermented Malt Beverage
 - Class A Liquor and Malt
 - Class B Fermented Malt Beverage
 - Class B Tavern
 - Class C Wine Retailer

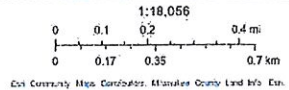

3511 S 20th ST

Summary

Name	Count	Area(ft ²)	Length(mi)
Alcohol Licenses	10		

Alcohol Licenses

#	Legal Entity	Trade Name	Licensee	Address	License Type Name	Total Capacity	Expiration Date	Count
1	Blazin Wings, Inc	Buffalo Wild Wings #415	Matthew F Horgan, Agt	3636 S 27th ST	Class B Tavern License		3/20/2021, 7:00 PM	1
2	THREE BLONDES, INC	MAVERICKS	CAROL J PETERSON, Agt	2030 W HOWARD AV	Class B Tavern License	99	7/26/2021, 7:00 PM	1
3	J B Beer & Liquor, Inc	Wilson Park Beverage Mart	BALJIT SINGH, Agt	3511 S 20th ST	Class A Malt & Class A Liquor License		10/13/2021, 7:00 PM	1
4	Emerald City Enterprises LLC	Emerald City Catering and Events	Steve T Ozbolt, Agt	3555 S 13th ST	Class B Tavern License		5/28/2021, 7:00 PM	1
5	GARY J'S PUB	GARY J'S PUB	GARY M JASICKI, SP	3303 S 16TH ST	Class B Tavern License	25	12/19/2020, 6:00 PM	1
6	P T G, LLC	COOP'S TAVERN	JASON L MOELLER, Agt	1577 W MORGAN AV	Class B Tavern License	73	12/10/2020, 6:00 PM	1
7	GURU BEER & LIQUOR, LLC	GURU BEER & LIQUOR	Iqbal K Ghotra, Agt	3404 S 27TH ST	Class A Malt & Class A Liquor License		1/18/2021, 6:00 PM	1
8	JSJK Inc	Royal India Bar & Grill	Paramjit Kaur, Agt	3400 S 27th ST	Class B Tavern License		5/25/2021, 7:00 PM	1
9	Camacho's Family Restaurant LLC	Camacho's Family Restaurant	Jose Camacho, Agt	3577 S 13TH ST	Class B Tavern License	260	6/23/2021, 7:00 PM	1
10	Gurmehar, LLC	Best Foods	Kanwal B Singh, Agt	3405 S 13th ST	Class A Fermented Malt Beverage Retailer's License		2/28/2021, 6:00 PM	1

Establishments within a 0.5 miles radius centered on area of interest.



Thursday, December 17, 2020

Licenses Committee Notice of Hearing

JASPAL FARWAHA
BALJIT SINGH
8641 S STONE CREEK DR
OAK CREEK, WI 53154

The Licenses Committee will consider the following license application:

Class A Malt & Class A Liquor and Food Dealer License Applications
SRAN, Gagandeep S, Agent
Wilson Park Beverage Mart at 3511 S 20TH St

Date: 1/5/2021

Time: 02:50 PM

Location: The hearing before the Licenses Committee will take place virtually on Tuesday, January 5, 2021. This is a public hearing. Those wishing to view the proceeding are able to do so via the City Channel – Channel 25 on Spectrum Cable – or on the Internet at <http://city.milwaukee.gov/citychannel>. Those wishing to provide oral testimony will be asked to do so by phone or internet and are asked to contact the staff assistant, Molly Kuether-Steele at (414) 286-2775 or molly.kuether-steele@milwaukee.gov for necessary information. Please make such requests no later than one business day prior to the start of the meeting. You are not required to attend the hearing, but please see the information below if you would like to provide testimony

Please note this application may be recommended for denial based on fitness of the location due to concentration of alcohol beverage outlets in the area. If the application is denied for this reason, no other application for an alcohol beverage license for this location shall be recommended for approval by the Licenses Committee within three years of the date of denial unless the applicant has demonstrated a change of circumstances since the prior denial.





Thursday, December 17, 2020

Licenses Committee Notice of Hearing

BALJIT SINGH
2411 5th Ave
South Milwaukee, WI 53172

The Licenses Committee will consider the following license application:

Class A Malt & Class A Liquor and Food Dealer License Applications
SRAN, Gagandeep S, Agent
Wilson Park Beverage Mart at 3511 S 20TH St

Date: 1/5/2021

Time: 02:50 PM

Location: The hearing before the Licenses Committee will take place virtually on Tuesday, January 5, 2021. This is a public hearing. Those wishing to view the proceeding are able to do so via the City Channel – Channel 25 on Spectrum Cable – or on the Internet at <http://city.milwaukee.gov/citychannel>. Those wishing to provide oral testimony will be asked to do so by phone or internet and are asked to contact the staff assistant, Molly Kuether-Steele at (414) 286-2775 or molly.kuether-steele@milwaukee.gov for necessary information. Please make such requests no later than one business day prior to the start of the meeting. You are not required to attend the hearing, but please see the information below if you would like to provide testimony

Please note this application may be recommended for denial based on fitness of the location due to concentration of alcohol beverage outlets in the area. If the application is denied for this reason, no other application for an alcohol beverage license for this location shall be recommended for approval by the Licenses Committee within three years of the date of denial unless the applicant has demonstrated a change of circumstances since the prior denial.





Thursday, December 17, 2020



Notice of Public Hearing

blank
notice

SRAN, Gagandeep S, Agent
Wilson Park Beverage Mart at 3511 S 20TH St
Class A Malt & Class A Liquor and Food Dealer License Applications

Tuesday, January 5, 2021 at 2:50 PM

To whom it may concern:

The above application has been made by the above named applicant(s). This requires approval from the Licenses Committee and the Common Council of the City of Milwaukee. The hearing before the Licenses Committee will take place virtually on 1/5/2021 at 2:50 PM. This is a public hearing. Those wishing to view the proceeding are able to do so via the City Channel – Channel 25 on Spectrum Cable – or on the Internet at <http://city.milwaukee.gov/citychannel>. Those wishing to provide oral testimony will be asked to do so by phone or internet and are asked to contact the staff assistant, Molly Kuether-Steele at (414) 286-2775 or molly.kuether-steele@milwaukee.gov for necessary information. Please make such requests no later than one business day prior to the start of the meeting. You are not required to attend the hearing, but please see the information below if you would like to provide testimony. Once the Licenses Committee makes its recommendation, this recommendation is forwarded to the full Common Council for approval at its next regularly scheduled hearing.

Important details for those wishing to provide information for the Licenses Committee to consider when making its recommendation:

1. The license application is scheduled to be heard at the above time. Due to other hearings running longer than scheduled, you may have to wait some time to provide your testimony.
2. You must testify as to matters that you have personally experienced or seen. (You cannot provide testimony for your neighbor, parent or anyone else; this is considered hearsay and cannot be considered by the committee.)
3. No letters or petitions can be accepted by the committee (unless the person who wrote the letter or the persons who signed the petition are willing to testify).
4. Persons opposed to the license application are given the opportunity to testify first; supporters may testify after the opponents have finished.
5. When you are called to testify, you will be sworn in and asked to give your name, and address. (If your first and/or last names are uncommon please spell them.)
6. You may then provide testimony.
 - a. Include only information relating to the above license application.
 - b. Include only information you have personally witnessed or seen.
 - c. Provide concise and relevant information detailing how this business has affected or may affect the peaceful enjoyment of your neighborhood.
 - d. If by the time you have the opportunity to testify, the information you wish to share has already been provided to the committee, you may state that you agree with the previous testimony. Redundant or repetitive testimony will not assist the committee in making its recommendation.
7. After giving your testimony, the members of the Licenses Committee and the licensee may ask questions regarding the testimony you have given or other factors relating to the license application.
8. Business Competition is not a valid basis for denial or non-renewal of a license.

Please Note: If you have submitted an objection to the above application your objection cannot be considered by the committee unless you personally testify at the hearing.

OCCUPANT	MAIL ADDRESS	CITY, STATE ZIP
CURRENT OCCUPANT	3543 S 20TH ST	MILWAUKEE, WI 53221
CURRENT OCCUPANT	3525 S 20TH ST	MILWAUKEE, WI 53221
CURRENT OCCUPANT	3530 S 20TH ST	MILWAUKEE, WI 53221
CURRENT OCCUPANT	3534A S 20TH ST	MILWAUKEE, WI 53221
CURRENT OCCUPANT	3553 S 20TH ST	MILWAUKEE, WI 53221
CURRENT OCCUPANT	3531 S 19TH ST	MILWAUKEE, WI 53221
CURRENT OCCUPANT	3531 S 20TH ST	MILWAUKEE, WI 53221
CURRENT OCCUPANT	1915A W MORGAN AVE	MILWAUKEE, WI 53221
CURRENT OCCUPANT	3547 S 20TH ST	MILWAUKEE, WI 53221
CURRENT OCCUPANT	3540 S 20TH ST	MILWAUKEE, WI 53221
CURRENT OCCUPANT	1919 W MORGAN AVE	MILWAUKEE, WI 53221
CURRENT OCCUPANT	3515 S 19TH ST	MILWAUKEE, WI 53221
CURRENT OCCUPANT	1915 W MORGAN AVE	MILWAUKEE, WI 53221
CURRENT OCCUPANT	3519 S 19TH ST	MILWAUKEE, WI 53221
CURRENT OCCUPANT	3537 S 20TH ST	MILWAUKEE, WI 53221
CURRENT OCCUPANT	3525 S 19TH ST	MILWAUKEE, WI 53221
CURRENT OCCUPANT	3475 S 20TH ST	MILWAUKEE, WI 53215
CURRENT OCCUPANT	3469 S 20TH ST	MILWAUKEE, WI 53215
CURRENT OCCUPANT	3463 S 20TH ST	MILWAUKEE, WI 53215
CURRENT OCCUPANT	3516 S 20TH ST	MILWAUKEE, WI 53221
CURRENT OCCUPANT	3522 S 20TH ST	MILWAUKEE, WI 53221
CURRENT OCCUPANT	3522A S 20TH ST	MILWAUKEE, WI 53221
CURRENT OCCUPANT	3542 S 20TH ST	MILWAUKEE, WI 53221
CURRENT OCCUPANT	3516A S 20TH ST	MILWAUKEE, WI 53221
CURRENT OCCUPANT	3534 S 20TH ST	MILWAUKEE, WI 53221
CURRENT OCCUPANT	3550 S 20TH ST	MILWAUKEE, WI 53221
blank	notice	

Total Records: 26

Radius: 250.0 feet and Center of Circle: 3511 S 20th St



BUSINESS LICENSE PLAN OF OPERATION

ccl-busplan 5/12/2020

Office of the City Clerk License Division
200 E. Wells St. Room 105, Milwaukee, WI 53202
(414) 286-2238 www.milwaukee.gov/license e-mail address: license@milwaukee.gov

1. Type of Business

Applying for: Extended Hours (12AM to 5AM) - If a food establishment, check all that apply: Delivery Drive Thru Dining Room
 Self Service Laundry Massage Establishment Filling Station
 Other (supplemental application for specific license also required)

Provide a detailed description of the type of business you plan on operating: LIQUOR STORE

Do you have any experience operating this type of business? No Yes If yes, explain: I am a manager of this store from last 2 years

2. Business Operations

- a. Proposed Opening Date: 10/01/2020
- b. Is this premise under construction? No Yes If yes, list estimated completion date: _____
- c. Is this a franchise? No Yes
- d. Is this premises currently licensed? No Yes If yes, list type of license: Class A Liquor, Cigarette, Food
- e. Is the current licensee operating? No Yes If no, list date closed: _____
- f. Do you have future plans for other businesses, licenses or permits at this location? No Yes
If yes, explain: _____
- g. Have you previously held an Extended Hours License in Milwaukee? No Yes
If yes, list address(es): _____
- h. Are other businesses operating in the same building? No Yes If yes, describe: _____

3. Litter & Noise

- a. How are grounds kept clean? Sweep Pressure Wash Pick Up Litter Other: _____
- b. How often will grounds be cleaned? Daily Weekly As Needed Monthly Other: _____
- c. Grounds cleaned by: Licensee Building Owner Employees Hired Maintenance Other: _____
- d. How are noise issues prevented and/or addressed? Security Manager approaches customer(s) Call Police
 Signs Posted Other: _____
- e. Will a sound amplification system be used? No Yes If yes, describe: _____

4. Smoking & Sanitation

- a. Are there designated outdoor smoking areas? No Yes If yes, describe: _____
- b. Number of Garbage Cans: Inside: 2 Locations: by cash register and restroom inside
Outside: 1 Locations: by front door outside
- c. Is a crowd control barrier used? No Yes If yes, describe: _____
- d. How many restrooms are on the premises? 1
- e. Name of solid waste contractor: Advanced Disposal Waste Management Other: _____

5. Security

- a. Are there onsite parking spaces? No Yes If yes, how many? 5 and describe the parking security plan: Security camera system monitors parking lot 24/7
- b. Is there a loading zone? No Yes If yes, describe the loading area security plan: _____
- c. Will you have security personnel on premise? No Yes If yes, how many? _____ and answer the following:
 What are their responsibilities? _____
 Is security equipment used? No Yes If yes, describe _____
 List their licensing, certification, or training credentials _____
- d. Will there be security cameras? No Yes If yes, how many? 16 and list locations: monitors inside of the store and store surroundings.
- e. Will searches/identification checks be done upon entry? No Yes If yes, describe _____

6. Percentage of Sales (must total 100%)

Alcohol <u>80</u> %	Food <u>5</u> %	Secondhand Merchandise <u>0</u> %	Precious Metals & Gems <u>0</u> %
Entertainment <u>0</u> %	Cigarettes <u>30</u> %	Personal Services (such as tattoo, body piercing, salon, tailor, tanning, etc.) <u>0</u> %	Other <u>5</u> % Describe: <u>lottery</u>
Pawnbroker Activity <u>0</u> %	Salvaged Materials <u>0</u> % (such as scrap metal)		

7. Businesses/Licenses on the Premises (check all that apply):

Type 1

Full Service Restaurant Cafe/Coffee Shop Deli or Fast Food Restaurant Private/fraternal/Veterans Club

Night Club Tavern Cocktail Lounge Teen Club

Banquet Hall Sports Facility Bowling Alley

Hotel/Motel: Number of Floors: _____ Rooming House: Number of Floors: _____
 Number of Rooms: _____ Number of Rooms: _____

Type 2

Liquor Store Corner Store Supermarket Convenience Store

Gas Station Amusement/Phonograph Distributor Recycling, Salvage or Towing

Used Car Dealer Personal Service Establishment
 (such as tattoo business, hair salon, tailor, etc.) Recording Studio

What other licenses/permits will you hold at this location? (check all that apply)

Occupancy Permit Cigarette & Tobacco Gas Station Extended Hours Class "B" Tavern Weights & Measures

Secondhand Dealer Precious Metal & Gem Other: _____

8. Legal Capacity (only if a Type 1 premises in #7 above)

Capacity n/a (Call the Milwaukee Development Center at 414-286-8211 if you have questions.)

9. Premises Description

- a. Identify all area(s) of the premises that will be used in operating this business (include areas used only for storage):
 1st Floor 2nd Floor Basement Storage Patio Beer Garden Sidewalk Café Deck Rooftop
 Other: Describe: _____
- b. Describe Location: Major Thoroughfare Secondary Street Other: _____
- c. Nearest Major Cross Street: 20th and Oklahoma ave
- d. Describe Building: Free Standing Building Strip Mall Other: _____
- e. Describe Premises Structure: Single Story Multi-Story - # of Stories 2 Others: _____
- f. Describe Surrounding Area: Commercial Residential Industrial Other: _____
- g. Building Owner Name: Baljit Singh Phone Number: 414-943-7264
 Building Owner Address: 2411 6th Ave, South Milwaukee WI 53172

10. Hours of Operation & Customers

Will customers be entering the premises? No Yes

Day of the Week	Proposed Hours of Operation:		Estimated Number of Customers expected each day	Potential Age Range of Customers	Class II Tavern Applicant Only: Age restriction (if none, write "None")
	Open Time (include a.m. or p.m.)	Close Time (include a.m. or p.m.)			
Sunday	8:00am	9:00pm	200	18+	
Monday	8:00am	9:00pm	200	18+	
Tuesday	8:00am	9:00pm	200	18+	
Wednesday	8:00am	9:00pm	200	18+	
Thursday	8:00am	9:00pm	200	18+	
Friday	8:00am	9:00pm	200	18+	
Saturday	8:00am	9:00pm	200	18+	

An Extended Hours Establishment License is required for any convenience store, filling station, personal service establishment (such as tattoo, body piercing, salon, taylor, tanning, etc.), recording studio or restaurant which is open between the hours of 12:00 a.m. and 5:00 a.m.

Alcohol Establishments Permitted Hours of Operation: Class A: 8:00 am to 9:00 pm Sunday thru Saturday
 Class B: 6:00 am to 2:00 am Sunday thru Thursday, 6:00 am to 2:30 am Friday & Saturday

Entertainment Outdoor Closing Hours: 10:00pm Sunday-Thursday; 12:00am Friday & Saturday; unless a different time, either earlier or later, is established by the Common Council in its approval of the licensee's plan of operation.

11. Signature(s)

Baljit Singh
 Signature of Sole Proprietor, Partner, or 20% or more Shareholder
 (If there are no 20% or more shareholders,
 Corporate Officer-print name/title and sign)

Signature of additional partner or 20% or more shareholder

See Application Information for a complete list of all required application forms.



ALCOHOL BEVERAGE & PUBLIC ENTERTAINMENT PREMISES

SUPPLEMENTAL APPLICATION

Office of the City Clerk License Division
200 E. Wells St. Room 105, Milwaukee, WI 53202
(414) 286-2238 e-mail address: llcense@milwaukee.gov www.milwaukee.gov/llcense

Legal Entity Name: SRAN BEER & LIQUOR INC

Premise Address: 3511 S 20TH STREET, MILWAUKEE, WI 53221

Proximity of Premises to Church, School, Daycare Center or Hospital

Is the building within 300 feet of any church, school, daycare center or hospital? No Yes

Service Bar Only Designation

If applying for Class B or C license, are you applying for "Service Bar Only"? No Yes
Service Bar Only means customers cannot sit at the bar. Alcohol is served to employees who serve patrons seated at tables. No stools, chairs or other articles of furniture shall be placed at the service bar for patrons to sit upon.

Business Information

- a) Are you taking out this application for anyone that may not be eligible for a license? No Yes
If yes, list their name and address: _____
- b) Will the agent, a partner or the individual licensee be conducting the day-to-day operations of the business? No Yes
If no, list the name and address of the person(s) who will: _____

Class B Applicants: If the agent, a partner or the individual licensee will not be conducting the day-to-day operations of the business, the person(s) listed above must obtain a Class B Managers license.
- c) Does anyone else have money invested or any other interest in this business? No Yes
If yes, explain: _____
- d) Have you made an agreement with anyone to repay any loan or any other payments based upon income from the business?
 No Yes If yes, list name and address: _____

Property Information (New & Transfer Applicants Only)

- a) Do you own or lease the building? Own Lease
- b) Who owns the fixtures (for example, coolers, etc.)? SRAN BEER & LIQUOR INC
- c) Are you purchasing the stock and/or fixtures? No Yes If yes, amount paid \$ 150000
- d) Total amount paid for business \$ 0
- e) Total amount paid for goodwill of the business \$ 0

Goodwill comprises the reputation and customer relationships of an existing business. If the price you pay for the business exceeds the fair market value of all of the rest of the assets of the business, the excess may be considered goodwill.
- f) Have you made arrangements with the seller for payment of personal property taxes? No Yes

Lease Information (New & Transfer Applicants who are leasing the premises only)

- a) Date lease begins 10/01/2020 Ends 09/30/2026
- b) Monthly rental \$ 6500
- c) Do you have an option to renew the lease? No Yes
- d) Does your lease allow for assignment to another party without the consent of the owner? No Yes
- e) For what length of time have you been guaranteed occupancy (number of years)? 6

Lease Information (Continued)

- f) In addition to paying the monthly rental, will you have to pay anything additional to the owner of the building to guarantee performance of the lease? No Yes If yes, explain _____
- g) Does the present owner or occupancy object to the granting of your license? No Yes
If yes, explain _____

Change of Agent Applicants Only

Have there been any changes to the floor plan since the last application was submitted? No Yes
If no, a new floor plan is not required. If yes, submit a new floor plan and explain the change(s):

Signature

X Rajinderdeep S. Grewal
Signature of Sole Proprietor, Partner or 20% or More Shareholder
(If no 20% or more Shareholder, Corporate Officer - print name/title and sign)

Note: All information contained in this application is subject to approval by the Common Council.
Develling from approved plan of operation will subject licensee to citations, and/or suspension or non-renewal of the license.
Contact the License Division for information on how to request changes.

New and transfer of premises applicants must submit the following:

- Detailed floor plan
- If a restaurant, copy of the menu



FOOD DEALER LICENSE PLAN OF OPERATION

OFFICE OF THE CITY CLERK, LICENSE DIVISION
 CITY HALL, 200 E. WELLS ST, ROOM 105, MILWAUKEE, WI 53202
 (414) 286-2238 • license@milwaukee.gov • www.milwaukee.gov/license

Legal Entity Name: SRAN BEER & LIQUOR INC
Premises Address: 3511 S 20TH STREET, MILWAUKEE, WI 53221
SECTION 1: TYPE OF BUSINESS
<p>What will be the majority of your food sales? (check one)</p> <p><input type="checkbox"/> Restaurant Items (meals): MEALS include, but are not limited to, chicken, ribs, sandwiches, roasted corn, baked potatoes, hot dogs, brats, tacos, nachos w/ cheese and meat, French fries, cooked or deep fried vegetables/fruit, cooked cheese curds, corn dogs, egg rolls, salads.</p> <p><input checked="" type="checkbox"/> Retail Items (snacks and beverages): RETAIL items include, but are not limited to, ice cream/soft serve, lemonade, snow cones, coffee, espresso, cappuccino, tea, fruit juice, smoothies, candy, dispensed soda, fruit cups, bakery, cookies, kettle corn, cotton candy, funnel cakes, fritters, tortilla chips w/ cheese.</p> <p>Will it be a convenience store? <input checked="" type="checkbox"/> Yes <input type="checkbox"/> No A convenience store contains less than 5,000 square feet of retail space and has, as its primary business, the sale of basic food items and in addition, sells household products or is a filling station that sells basic food items and household products.</p> <p><input type="checkbox"/> Diner & Breakfast <input type="checkbox"/> Micro Market</p> <p>All Applicants: Submit a menu or a list of food items that will be sold.</p>
<p>Will any wholesale business be done? <input checked="" type="checkbox"/> No <input type="checkbox"/> Yes If yes, what percentage of food sales will be wholesale?</p> <p><input type="checkbox"/> Less than 25%</p> <p><input type="checkbox"/> 25% or More AND: <input type="checkbox"/> Restaurant Items (meals) will be sold - Complete this application and also contact DATCP. <input type="checkbox"/> NO restaurant items (meals) will be sold - Do NOT complete this application. Contact DATCP only.</p>
SECTION 2: FOOD PROCESSING
<p>Will any food processing be done? <input checked="" type="checkbox"/> No <input type="checkbox"/> Yes</p> <p>Processing is defined as assembling, grinding, cutting, mixing, baking, coating, stuffing, packing, bottling, grilling, canning, extracting, fermenting, distilling, pickling, freezing, drying, smoking, or packaging.</p>
SECTION 3: FOOD REQUIRING TEMPERATURE CONTROL
<p>Will any food that requires temperature control be sold? <input type="checkbox"/> No <input checked="" type="checkbox"/> Yes (includes dairy products such as milk, cheese, and ice cream, fish, shellfish, meat, poultry)</p> <p>If yes, list the types of food items: <u>MILK, CHEESE, ICE CREAM, FROZEN FOOD</u></p>

SECTION A: DETAILS OF OPERATION

- Will you have seating on site for dining? No Yes
- Will you be doing any catering? No Yes
- Will you be doing any delivery? No Yes
- Will you have outdoor activities? No Yes - Check all that apply: Bar Cooking/Grilling Dining
- Will you have a drive thru window? No Yes - Are hours different from inside? No Yes
 If Yes, provide drive thru hours: _____
- Will scales or barcode scanners be used? No Yes - You must also apply for a Weights & Measures License.

SECTION B: ADDITIONAL SITES

Where will food be prepared and/or sold?
 At a single site At multiple sites: How many? _____ (for example, a hotel with several dining rooms or bars)
 If multiple sites, attach a Food Dealer Additional Site Addendum (ccl-foodadd) for each additional site.

SECTION C: CONSTRUCTION OR CHANGES

Are you planning any construction, remodeling or equipment changes?
 No If No, SKIP to Section B
 Yes If Yes, check all that apply: New construction of a building Renovation or remodeling
 Construction changes to existing building Equipment changes only

Provide a brief description of the changes: _____
 Start date: _____
 Name, Address & Phone Number of Architect: _____
 Name, Address & Phone Number of Contractor: _____

SECTION D: ALCOHOL BEVERAGES

Are you applying for an alcohol beverage license?
 No If No, SKIP to Section B
 Yes If YES, if your food license is approved prior to the alcohol license, when do you want the food license issued?
 Immediately At the same time as the alcohol license

SECTION E: ACKNOWLEDGMENTS & SIGNATURE

You must initial each item confirming your understanding:

[Signature] I understand the Health Department must conduct an inspection and advise the License Division of their approval before the license may be issued.

[Signature] I understand I must obtain an occupancy permit from the Department of Neighborhood Services and an inspection may be required. Neighborhood Services must advise the License Division of their approval before the license may be issued.

[Signature] I understand the district alderperson will review and either support or object to my application. If he/she objects, I may appeal and be scheduled to appear before the Licenses Committee. The Licenses Committee will then make a recommendation to the Common Council. The Common Council must grant the license before it may be issued.

[Signature] I understand proof of payment for all license fees must be on file in the License Division before the license may be issued and the license must be issued and posted in my establishment prior to opening for business.

[Signature] I will not operate my food business until the license has been issued and posted in the establishment.

Signature of Sole Proprietor, Partner, or 20% Shareholder: *[Signature]*

Signature of Additional Partner: _____

SRAN BEER & LIQUOR INC
 15181A ~~SPAIN~~ WILSON PARK BEVERAGE MARKET
 3511 S. 20TH ST. MILWAUKEE WI 53221
 MR. GAQANDEEP S. SRAN, AGENT
 PH: 414.248.4228

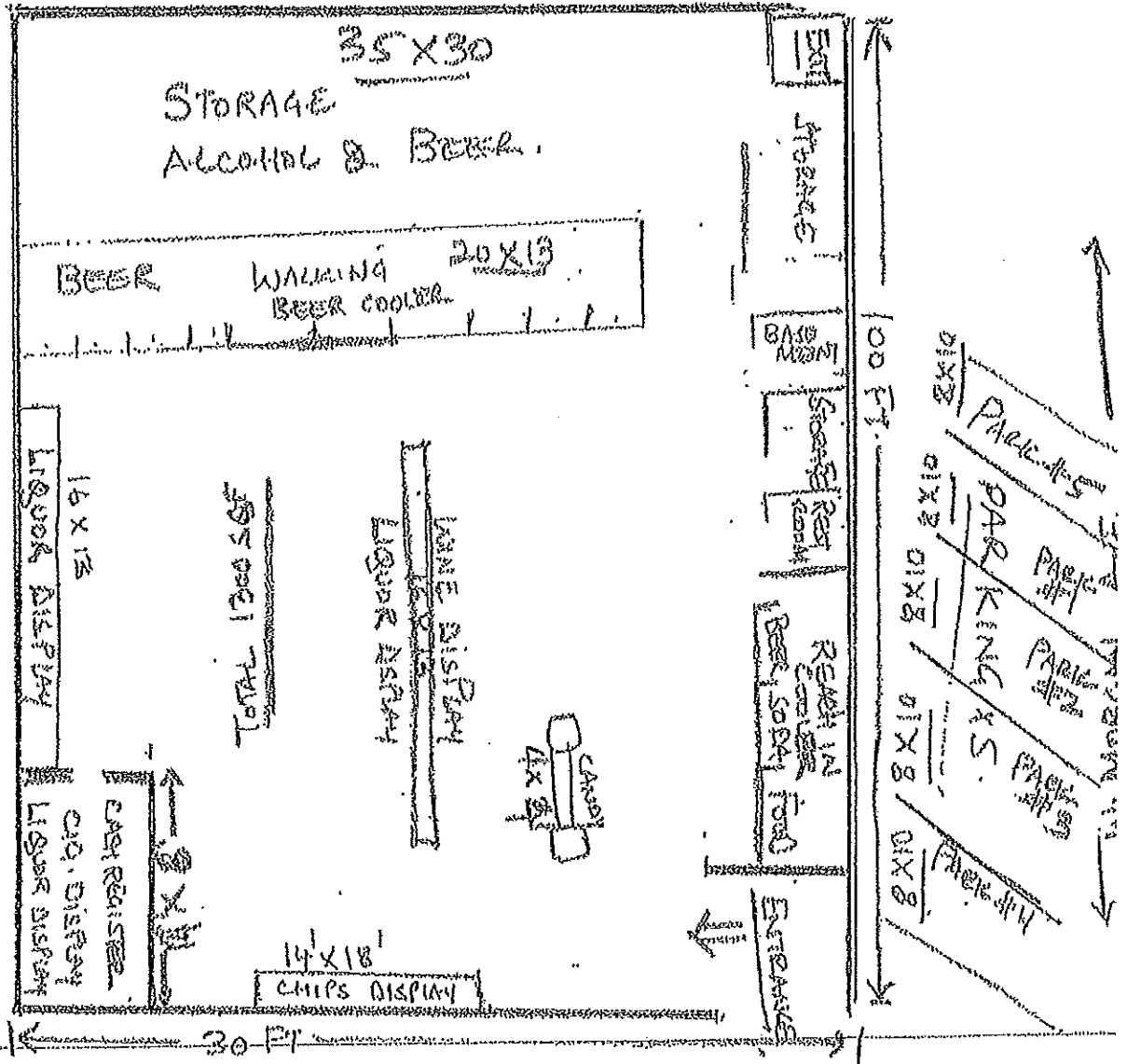

← LOCALS HWY 5 →

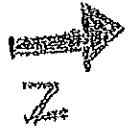

SRAN BEER & LIQUOR INC.
D/B/A WILSON PARK BEVERAGE MART
3511 S. 20TH ST. MILWAUKEE WI 53221
"MR. GARGANDEEP S. SRAN," AGENT
PH: 414.248.4228

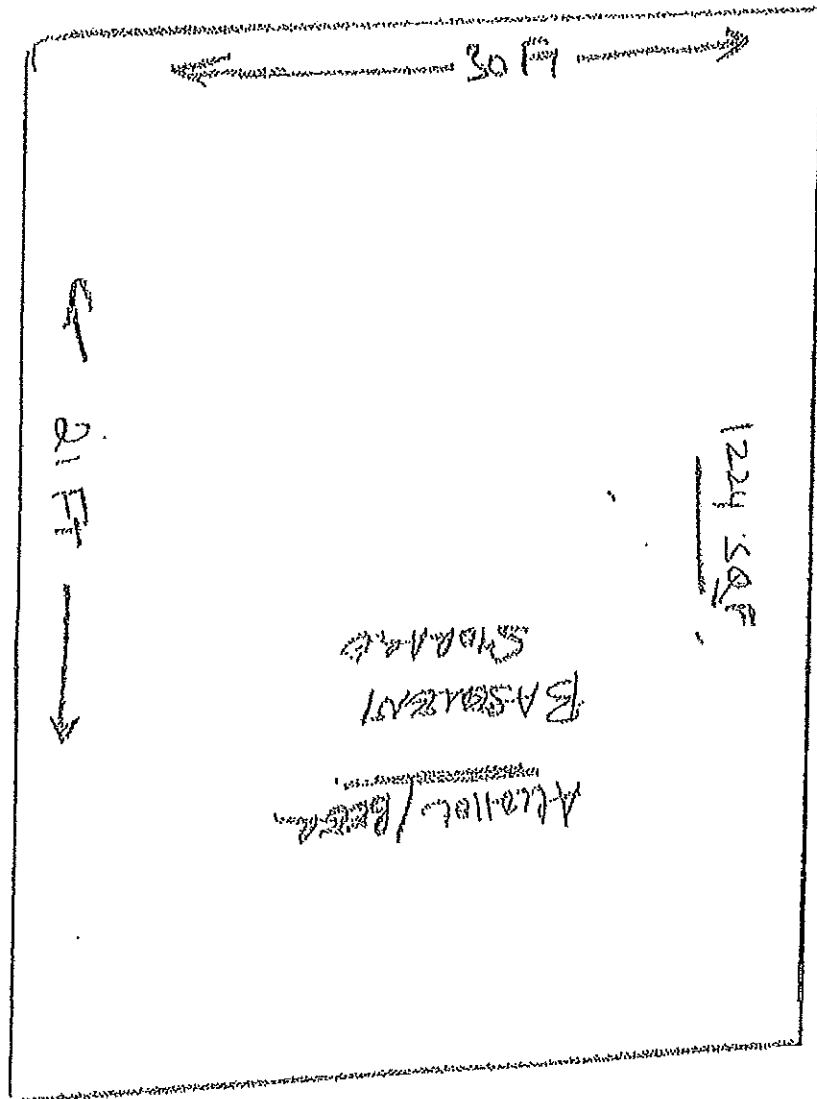

➔
Z