

CERTIFIED SURVEY MAP NO _____

Lots 6, 7, 8, 9, 10, And 11, in Block 13, in Vliet's Addition, Being Part of The Northeast 1/4 Of The Northeast 1/4 Of Section 19 And Part of the Northwest 1/4 Of The Northwest 1/4 Of Section 20, Town 7 North, Range 22 East, in The City Of Milwaukee, County Of Milwaukee, State Of Wisconsin.

SURVEYOR'S CERTIFICATE

STATE OF WISCONSIN}

:SS

WAUKESHA COUNTY }

I, STEPHAN G. SOUTHWELL, Registered Land Surveyor, do hereby certify:

THAT I have surveyed, divided and mapped a division of Lots Six (6) through Eleven (11) in Block 13, Vliet's Addition, , Being Part of The Northeast 1/4 Of The Northeast 1/4 Of Section 19 And Part of the Northwest 1/4 Of The Northwest 1/4 Of Section 20, Town 7 North, Range 22 East, in The City Of Milwaukee, County Of Milwaukee, State Of Wisconsin, bounded and described as follows:

COMMENCING at the Northeast corner of said Northwest 1/4 of said Section 20; thence South 89°08'31" East along the north line of said Section 20, 2657.090 feet to the Northeast corner of the Northeast 1/4 of said Section 19; thence South 00°43'58" East along the East line of the Northeast 1/4 of said Section 19, 272.080 feet to a point in the westerly line of North Teutonia Avenue; thence North 25°39'12" West, along said westerly line 51.230 feet to the point of beginning of the lands to be described; thence South 25°39'12" East along said westerly line, 135.744 feet to a point; thence South 37°54'38" East, along said westerly line, 72.796 feet to a point at the Northwesterly intersection of North Teutonia Avenue and West Garfield Avenue; thence South 56°36'42" West along said North line, 153.992 feet to a point at the northeast intersection of North 13th Street and West Garfield Avenue; thence North 30°56'08" West along the easterly line of North 13th Street, 124.308 feet to a point; thence North 26°37'06" West along said easterly line, 106.612 feet to a point; thence North 65°24'08" East, 150.402 feet to the point of beginning.
Containing 32,697 square feet or 0.7506 acres.

THAT I have made this survey, land division and map by the direction of PRINCE HALL VILLAGE, LLC.

THAT such map is a correct representation of all the exterior boundaries of the land surveyed and the land division thereof made.

THAT I have fully complied with the provisions of Chapter 236 of the Wisconsin Statutes and Chapter 119 of the City of Milwaukee Municipal Code in surveying, dividing and mapping the same.

9/17/07 Revised 9/26/07
DATE

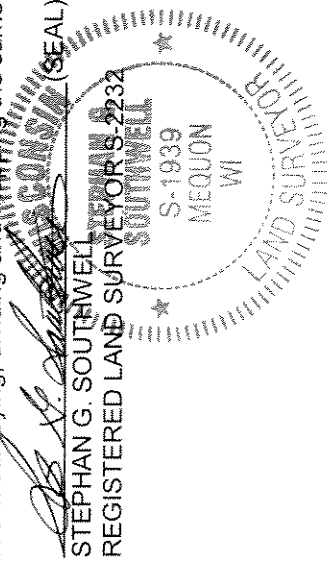

DGD#2660

CERTIFIED SURVEY MAP NO _____

Lots 6, 7, 8, 9, 10, And 11, In Block 13, In Vliet's Addition, Being Part of The Northeast 1/4 Of The Northeast 1/4 Of Section 19 And Part of The Northwest 1/4 Of The Northwest 1/4 Of Section 20, Town 7 North, Range 22 East, In The City Of Milwaukee, County Of Milwaukee, State Of Wisconsin.

CORPORATE OWNER'S CERTIFICATE

PRINCE HALL VILLAGE, LLC, a corporation duly organized and existing under and by virtue of the laws of the State of WISCONSIN, as owner, certifies that said corporation caused the land described on this map to be surveyed, and mapped as represented on this map in accordance with the requirements of Chapter 119 of the Milwaukee Code of Ordinances.

IN consideration of the approval of the map by the Common Council of the City of Milwaukee and in accordance with Chapter 119 of the Milwaukee Code, the undersigned agrees:

- A. That all utility lines to provide electric power and telephone service and cable television or communications systems lines or cables to all lots in the Certified Survey Map shall be installed underground in easements provided therefore, where feasible.

THIS agreement shall be binding on the undersigned and assigns.

IN Witness Whereof PRINCE HALL VILLAGE, LLC, as owner, has caused these presents to be signed by, this 18th day of September, 2007.

PRINCE HALL VILLAGE, LLC
By: PHV Commonwealth, LLC, Managing Member
By: Commonwealth Management Corporation, Sole Member

Louie A. Lange III
Louie A. Lange, III, President

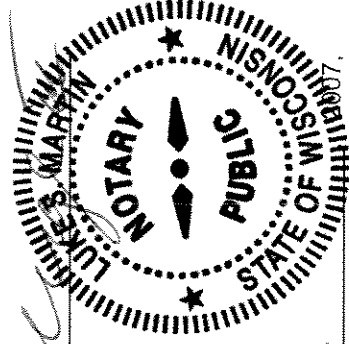

STATE OF WISCONSIN }
County of La Crosse COUNTY } :SS

PERSONALLY came before me this 18th day of September, 2007, the above named Louie A. Lange III to me known to be the person who executed the foregoing instrument, and acknowledged the same.

Louie A. Lange III
Notary Public, State of WISCONSIN (SEAL)
My Commission Expires 9/17/11

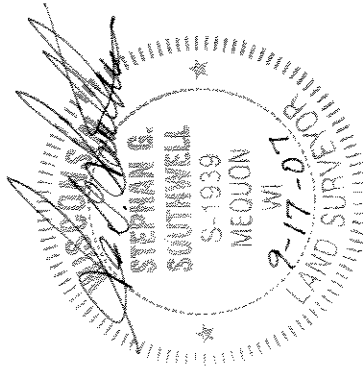

DCP#2660

CERTIFIED SURVEY MAP NO

Lots 6, 7, 8, 9, 10, And 11, In Block 13, In Vliet's Addition, Being Part Of The Northeast 1/4 Of The Northeast 1/4 Of Section 19 And Part Of The Northwest 1/4 Of The Northwest 1/4 Of Section 20, Town 7 North, Range 22 East, In The City Of Milwaukee, County Of Milwaukee, State Of Wisconsin.

CERTIFICATE OF CITY TREASURER

STATE OF WISCONSIN)
:SS
MILWAUKEE COUNTY)

I, WAYNE F. WHITTOW, being the duly elected, qualified and acting City Treasurer of the City of Milwaukee, certify that in accordance with the records in the office of the City Treasurer of the City of Milwaukee there are no unpaid taxes or unpaid special assessments on the land included in this Certified Survey Map.

10-15-07

DATE

James Z. Tooman
Deputy City Treasurer for
WAYNE F. WHITTOW, CITY TREASURER

COMMON COUNCIL CERTIFICATE OF APPROVAL

I certify that this Certified Survey Map was approved under Resolution File No. 070864 adopted by the Common Council of the City of Milwaukee on October 23, 2007

Ronald D. Leonhardt
RONALD D. LEONHARDT, CITY CLERK
Tom Barrett
TOM BARRETT, MAYOR

