



CITY OF MILWAUKEE
OFFICE OF THE CITY CLERK

Tuesday, August 31, 2021

COMMITTEE MEETING NOTICE

AD 02

XIONG, Sia, Agent
An Ox LLC
7402 W DERBY PI
Milwaukee, WI 53218

You are requested to attend a virtual hearing to be held on:

Monday, September 20, 2021 at 09:25 AM

Regarding: Your Class B Tavern, Food Dealer, and Public Entertainment Premises License Applications Requesting Instrumental Musicians, Disc Jockey, Jukebox, Bands, Karaoke, Patrons Dancing, 6 Amusement Machines, and 2 Pool Tables as agent for "An Ox LLC" for "An Ox Cafe" at 7411 W HAMPTON Av.

This meeting will be held via GoToMeeting. Please see the enclosed best practices document for further instructions. The access code is <https://global.gotomeeting.com/join/733111181>. If you wish to call in, please call +1 (646) 749-3122 and use Access Code: 733-111-181.

There is a possibility that your application may be denied for one or more of the following reasons: The recommendation of the committee regarding the application shall be based on evidence presented at the hearing. Per MCO 85-2.7-4, probative evidence concerning whether or not a new license should be granted may be presented on the following subjects: whether or not the applicant meets the municipal requirements, the appropriateness of the location and premises where the licensed premises is to be located and whether use of the premises for the purposes or activities permitted by the license would tend to facilitate a public or private nuisance or create undesirable neighborhood problems such as disorderly patrons, unreasonably loud noise, litter, and excessive traffic and parking congestion. Probative evidence relating to these matters may be taken from the plan of operation submitted with the license application, if any, but shall not include the content of any music. Evidence regarding the fitness of the location of the premises to be maintained as the principal place of business, including but not limited to whether there is an overconcentration of businesses of the type for which the license is sought; whether the proposal is consistent with any pertinent neighborhood business or development plans, or the location's proximity to areas where children are typically present. The applicant's record in operating similarly licensed premises; and whether or not the applicant has been charged with or convicted of any felony, misdemeanor, municipal offense or other offense, the circumstances of which substantially relate to the activity to be permitted by the license being applied for or any other factor which reasonably relates to the public health, safety or welfare may also be considered. See attached police report or correspondence.

Notice for applicants with warrants or unpaid fines: Proof of warrant satisfaction or payment of fines must be submitted at the hearing on the above date and time. Failure to comply with this requirement may result in a delay of the granting/denial of your application.

Failure to attend this meeting may result in the denial of your license. Individual applicants and partnership applicants must attend or attend by an attorney. The agent or attorney for corporate or limited liability applicants must attend. If you wish to do so and at your own expense, you may be accompanied by an attorney of your choosing to represent you at this hearing.

You will be given an opportunity to speak on behalf of the application and to respond and challenge any charges or reasons given for the denial. No petitions can be accepted by the committee, unless the people who signed the petition attend the virtual hearing and are willing to testify. You may present witnesses under oath and you may also confront and cross-examine opposing witnesses under oath. If you have difficulty with the English language, you should request an interpreter attend the meeting with you, at your expense, so that you can answer questions and participate in your hearing.

PLEASE NOTE: Upon reasonable notice, efforts will be made to accommodate the needs of disabled individuals through sign language interpreters or other auxiliary aids. For additional information or to request this service, contact the Council Services Division ADA Coordinator at (414) 286-2998, Fax - (414) 286-3456, TDD - (414) 286-2025.

JIM OWCZARSKI, CITY CLERK

BY: _____

Jim Cooney
License Division Manager

If you have questions regarding this meeting, please contact the staff assistant, Molly Kuether-Steele at (414) 286-2775 or molly.kuether-steele@milwaukee.gov.

200 E. Wells Street, Room 105, City Hall, Milwaukee, WI 53202. www.milwaukee.gov/license
Phone: (414) 286-2238 Fax: (414) 286-3057 Email Address: License@milwaukee.gov



CITY OF MILWAUKEE
OFFICE OF THE CITY CLERK

Tuesday, August 31, 2021

COMMITTEE MEETING NOTICE

AD 02

XIONG, Sia, Agent
An Ox LLC
261 Cedar Beach Rd
Belgium, WI 53004

You are requested to attend a virtual hearing to be held on:

Monday, September 20, 2021 at 09:25 AM

Regarding: Your Class B Tavern, Food Dealer, and Public Entertainment Premises License Applications Requesting Instrumental Musicians, Disc Jockey, Jukebox, Bands, Karaoke, Patrons Dancing, 6 Amusement Machines, and 2 Pool Tables as agent for "An Ox LLC" for "An Ox Cafe" at 7411 W HAMPTON Av.

This meeting will be held via GoToMeeting. Please see the enclosed best practices document for further instructions. The access code is <https://global.gotomeeting.com/join/733111181>. If you wish to call in, please call +1 (646) 749-3122 and use Access Code: 733-111-181.

There is a possibility that your application may be denied for one or more of the following reasons: The recommendation of the committee regarding the application shall be based on evidence presented at the hearing. Per MCO 85-2.7-4, probative evidence concerning whether or not a new license should be granted may be presented on the following subjects: whether or not the applicant meets the municipal requirements, the appropriateness of the location and premises where the licensed premises is to be located and whether use of the premises for the purposes or activities permitted by the license would tend to facilitate a public or private nuisance or create undesirable neighborhood problems such as disorderly patrons, unreasonably loud noise, litter, and excessive traffic and parking congestion. Probative evidence relating to these matters may be taken from the plan of operation submitted with the license application, if any, but shall not include the content of any music. Evidence regarding the fitness of the location of the premises to be maintained as the principal place of business, including but not limited to whether there is an overconcentration of businesses of the type for which the license is sought; whether the proposal is consistent with any pertinent neighborhood business or development plans, or the location's proximity to areas where children are typically present. The applicant's record in operating similarly licensed premises; and whether or not the applicant has been charged with or convicted of any felony, misdemeanor, municipal offense or other offense, the circumstances of which substantially relate to the activity to be permitted by the license being applied for or any other factor which reasonably relates to the public health, safety or welfare may also be considered. See attached police report or correspondence.

Notice for applicants with warrants or unpaid fines:

Proof of warrant satisfaction or payment of fines must be submitted at the hearing on the above date and time. Failure to comply with this requirement may result in a delay of the granting/denial of your application.

Failure to attend this meeting may result in the denial of your license. Individual applicants and partnership applicants must attend or attend by an attorney. The agent or attorney for corporate or limited liability applicants must attend. If you wish to do so and at your own expense, you may be accompanied by an attorney of your choosing to represent you at this hearing.

You will be given an opportunity to speak on behalf of the application and to respond and challenge any charges or reasons given for the denial. No petitions can be accepted by the committee, unless the people who signed the petition attend the virtual hearing and are willing to testify. You may present witnesses under oath and you may also confront and cross-examine opposing witnesses under oath. If you have difficulty with the English language, you should request an interpreter attend the meeting with you, at your expense, so that you can answer questions and participate in your hearing.

PLEASE NOTE: Upon reasonable notice, efforts will be made to accommodate the needs of disabled individuals through sign language interpreters or other auxiliary aids. For additional information or to request this service, contact the Council Services Division ADA Coordinator at (414) 286-2998, Fax - (414) 286-3456, TDD - (414) 286-2025.

JIM OWCZARSKI, CITY CLERK

BY: _____

Jim Cooney
License Division Manager

If you have questions regarding this meeting, please contact the staff assistant, Molly Kuether-Steele at (414) 286-2775 or molly.kuether-steele@milwaukee.gov.

200 E. Wells Street, Room 105, City Hall, Milwaukee, WI 53202. www.milwaukee.gov/license
Phone: (414) 286-2238 Fax: (414) 286-3057 Email Address: License@milwaukee.gov

Leon-Van Meter, Daniela

From: License
Sent: Thursday, July 1, 2021 4:09 PM
To: Leon-Van Meter, Daniela
Cc: Byrd, Yashica; Martin, Faviola
Subject: FW: An Ox Cafe opposition

Follow Up Flag: Follow up
Flag Status: Flagged

Please add

REDACTED RECORD

From: _____
Sent: Thursday, July 1, 2021 7:58 AM
To: License <LICENSE@milwaukee.gov>
Subject: An Ox Cafe opposition

I am opposed to granting a license for the An Ox Cafe 7411W Hampton for a liquor license. We do not need another bar in the area. This is adjacent to a residential area and with bars brings noise, violence, garbage, fights, drug deals and shootings. This sounds like a late night establishment. My backyard will be across the alley from the parking lot. This will be another time the city of Milwaukee does care about it's tax paying homeowners. We already have a problematic bar a block away.

Date: 07/02/21
Officer: Xavier Benitez

City of Milwaukee Police Department
90-5-1.5 Crime Prevention Survey
Tavern Inspection

Name of Premise: An Ox
Address: 7411 W. Hampton Ave
Phone: 414 202-7386

Owner: Xiong, Sia
Owner address: 7411 W. Hampton Av
City State Zip: Milwaukee WI 53218
Owner Phone: 414 627-4488
Owner email: sxv@pphcare.net

Licensee/Agent: Same
Home Address:
City State Zip:
Phone:
Email:

Preferred contact: by phone

Location currently open: YES NO

Projected open date: Late July

Day's open: S M T W Th F SA ALL

Hours of Operation: Sun: 6am-2am 24 hours Y N
Mon: 6am-2am
Tue: 6am-2am
Wed: 6am-2am
Thu: 6am-2am
Fri: 6am-2:30am
Sat: 6am-2:30am

Premise Type: Tavern/Bar
 Restaurant
 Other:

Licenses currently held:

Alcohol: Yes No Class: #:
 Tobacco: Yes No #:
 Food: Yes No #:
 Extended Hours: Yes No #:
 Secondhand Dealer: Yes No Type: #:
 Other: Yes No Type: #:
 Other: Yes No Type: #:

Exterior Survey:

1. Is the area around the location clean? Yes No
2. What surrounds the location? (Check all the apply)
 - a. Park
 - b. School
 - c. Youth Center
 - d. Church
 - e. Tavern(s) If so, how many
 - f. Residential
 - g. Other businesses
 - h. Other:
3. Can you see from the outside of the location into the interior Yes No
4. Can you see the employees inside of the location from the outside Yes No
5. Are exterior windows free of signage Yes No
6. Is there a parking lot Yes No
7. Is the parking lot clean? Yes No
8. Off-Street parking Yes No
9. Is the parking lot well lit? Yes No
10. Valet Parking Yes No
 - a. Will this lot have a guard? Yes No
 - b. Will this lot have cameras? Yes No
11. Are there areas where a person could conceal themselves Yes No
12. Is there exterior lighting? Yes No. Does it appears to be adequate Yes No
13. Exterior Payphone? Yes No
14. Are there No Loitering Signs posted? Yes No
15. Are there exterior security cameras Yes No How Many: 6
16. Are the address numbers prominently displayed and easy to see Yes No

Camera Survey:

17. Does this location have security cameras? Yes No
18. Are they in working order? Yes No
19. What format are the cameras?
 - a. Color Yes No
 - b. Digital Yes No
 - c. Recorded Yes No
20. How long is footage stored for later viewing: approx. 30 Days
21. Are there exterior cameras Yes No How many: 6
22. Are there interior cameras Yes No How many: 26
23. Do all employees know how to retrieve recorded digital images/footage? Yes No

24. Cameras located in parking lot Yes No How many 6

Interior Survey:

- 25. What is the planned capacity 353
- 26. What is the minimum number of employees That will be on premise 8
- 27. Is the storeowner willing to be a standing complainant regarding loitering? Yes No
 - a. If yes have them fill out the standing complaint form and give them two of the commercial signs Yes No
- 28. Is the interior of the location neat and clean? Yes No
- 29. Does an interior camera face the entrance/exit? Yes No
- 30. Is there a lockable area that separates employees from customers? Yes No
- 31. Are emergency and non-emergency numbers posted near the phone? Yes No
- 32. Does the owner know how to contact their police district directly? Yes No
 - a. Did you provide a district contact guide to the owner? Yes No

Security

- 33. How many security personnel are going to be employed: N/A
- 34. How ill they be deployed: Interior Exterior
- 35. What days will they be deployed Mon Tue Wed Thu Fri Sat Sun
- 36. Will the security be managed by business or contracted
- 37. Will they be armed Yes No
- 38. What type of security measures to be used:
 - Wanding/metal detector
 - ID Scanner
 - Dress Code
 - Cover Charge
 - Age restriction
 - Other

ADDITIONAL COMMENTS/RECOMMENDATIONS:

The location is a restaurant with outside patio seating. The agent stated that they currently have a 32 camera system, which he may add more cameras to. The agent stated that he may want to have better coverage of the parking lot.



7411 W Hampton Av

Area of Interest (AOI) Information

Area : 21,862,585.72 ft²

Jun 23 2021 12:37:11 Central Daylight Time

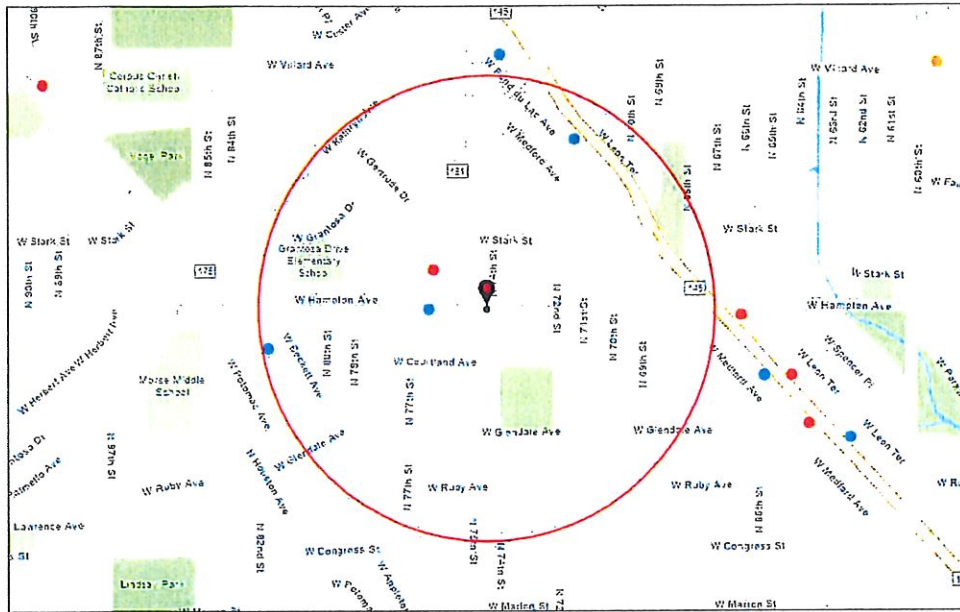

- Alcohol Licenses
 - Class A Fermented Malt Beverage
 - Class A Liquor and Malt
 - Class B Tavern
- City Limits

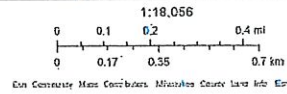

Summary

Name	Count	Area(ft ²)	Length(mi)
Alcohol Licenses	6		

Alcohol Licenses

#	Legal Entity	Trade Name	Licensee	Address	License Type Name	Total Capacity	Expiration Date	Count
1	BURRITO BUENO, INC	BURRITO BUENO	MARCO ARTEAGA, Agt	8238 W APPLETON AV	Class B Tavern License	90	7/4/2021, 7:00 PM	1
2	Moran Foods, LLC	Save-A-Lot #8013	Jason Peregoy, Agt	4821 N 76th ST	Class A Malt & Class A Liquor License		7/27/2021, 7:00 PM	1
3	THE STAGE, LLC	THE STAGE	LAURA L LEWAND, Agt	7200 W FOND DU LAC AV	Class B Tavern License	150	9/25/2021, 7:00 PM	1
4	HAMPTON BEER & LIQUOR MART, LLC	HAMPTON BEER & LIQUOR MART	HAKAM SINGH, Agt	7410 W HAMPTON AV	Class A Malt & Class A Liquor License		3/17/2022, 7:00 PM	1
5	DIAMONDS, INC	DIAMONDS PUB & GRILL	HUMPHREY F NANGAH, Agt	7607 W HAMPTON AV	Class B Tavern License	100	3/24/2022, 7:00 PM	1
6	BURRITO BUENO, INC	BURRITO BUENO	MARCO ARTEAGA, Agt	8238 W APPLETON AV	Class B Tavern License	90	7/4/2022, 7:00 PM	1

Establishments within a 0.5 miles radius centered on area of interest.



Tuesday, August 31, 2021

Licenses Committee Notice of Hearing

Sia Xiong
261 Cedar Beach Rd
Belgium, WI 53004

The Licenses Committee will consider the following license application:

Class B Tavern, Food Dealer, and Public Entertainment Premises License
Applications Requesting Instrumental Musicians, Disc Jockey, Jukebox, Bands,
Karaoke, Patrons Dancing, 6 Amusement Machines, and 2 Pool Tables
XIONG, Sia, Agent
An Ox Cafe at 7411 W HAMPTON Av

Date: 9/20/2021

Time: 09:25 AM

Location: The hearing before the Licenses Committee will take place virtually on Monday, September 20, 2021. This is a public hearing. Those wishing to view the proceeding are able to do so via the City Channel – Channel 25 on Spectrum Cable – or on the Internet at <http://city.milwaukee.gov/citychannel>. Those wishing to provide oral testimony will be asked to do so by phone or internet and are asked to contact the staff assistant, Molly Kuether-Steele at (414) 286-2775 or molly.kuether-steele@milwaukee.gov for necessary information. Please make such requests no later than one business day prior to the start of the meeting. You are not required to attend the hearing, but please see the information below if you would like to provide testimony

Please note this application may be recommended for denial based on fitness of the location due to concentration of alcohol beverage outlets in the area. If the application is denied for this reason, no other application for an alcohol beverage license for this location shall be recommended for approval by the Licenses Committee within three years of the date of denial unless the applicant has demonstrated a change of circumstances since the prior denial.



Tuesday, August 31, 2021



Notice of Public Hearing

blank
notice

XIONG, Sia, Agent
An Ox Cafe at 7411 W HAMPTON Av
Class B Tavern, Food Dealer, and Public Entertainment Premises License Applications
Requesting Instrumental Musicians, Disc Jockey, Jukebox, Bands, Karaoke, Patrons Dancing, 6
Amusement Machines, and 2 Pool Tables

Monday, September 20, 2021 at 9:25 AM

To whom it may concern:

The above application has been made by the above named applicant(s). This requires approval from the Licenses Committee and the Common Council of the City of Milwaukee. The hearing before the Licenses Committee will take place virtually on 9/20/2021 at 9:25 AM. This is a public hearing. Those wishing to view the proceeding are able to do so via the City Channel – Channel 25 on Spectrum Cable – or on the Internet at <http://city.milwaukee.gov/citychannel>. Those wishing to provide oral testimony will be asked to do so by phone or internet and are asked to contact the staff assistant, Molly Kuether-Steele at (414) 286-2775 or molly.kuether-steele@milwaukee.gov for necessary information. Please make such requests no later than one business day prior to the start of the meeting. You are not required to attend the hearing, but please see the information below if you would like to provide testimony. Once the Licenses Committee makes its recommendation, this recommendation is forwarded to the full Common Council for approval at its next regularly scheduled hearing.

Important details for those wishing to provide information for the Licenses Committee to consider when making its recommendation:

1. The license application is scheduled to be heard at the above time. Due to other hearings running longer than scheduled, you may have to wait some time to provide your testimony.
2. You must testify as to matters that you have personally experienced or seen. (You cannot provide testimony for your neighbor, parent or anyone else; this is considered hearsay and cannot be considered by the committee.)
3. No letters or petitions can be accepted by the committee (unless the person who wrote the letter or the persons who signed the petition are willing to testify).
4. Persons opposed to the license application are given the opportunity to testify first; supporters may testify after the opponents have finished.
5. When you are called to testify, you will be sworn in and asked to give your name, and address. (If your first and/or last names are uncommon please spell them.)
Please Note: If you have submitted an objection to the above application your objection cannot be considered by the committee unless you personally testify at the hearing.
6. You may then provide testimony.
 - a. Include only information relating to the above license application.
 - b. Include only information you have personally witnessed or seen.
 - c. Provide concise and relevant information detailing how this business has affected or may affect the peaceful enjoyment of your neighborhood.
 - d. If by the time you have the opportunity to testify, the information you wish to share has already been provided to the committee, you may state that you agree with the previous testimony. Redundant or repetitive testimony will not assist the committee in making its recommendation.
7. After giving your testimony, the members of the Licenses Committee and the licensee may ask questions regarding the testimony you have given or other factors relating to the license application.
8. Business Competition is not a valid basis for denial or non-renewal of a license.

OCCUPANT	MAIL ADDRESS	CITY STATE ZIP
CURRENT OCCUPANT	4735 N 74TH ST	MILWAUKEE, WI 53218-4716
CURRENT OCCUPANT	4738 N 75TH ST	MILWAUKEE, WI 53218-4720
CURRENT OCCUPANT	4740 N 74TH ST	MILWAUKEE, WI 53218-4715
CURRENT OCCUPANT	4740 N 75TH ST	MILWAUKEE, WI 53218-4720
CURRENT OCCUPANT	4741 N 74TH ST	MILWAUKEE, WI 53218-4716
CURRENT OCCUPANT	4749 N 75TH ST	MILWAUKEE, WI 53218-4721
CURRENT OCCUPANT	4750 N 74TH ST	MILWAUKEE, WI 53218-4715
CURRENT OCCUPANT	4756 N 74TH ST	MILWAUKEE, WI 53218-4715
CURRENT OCCUPANT	4757 N 73RD ST	MILWAUKEE, WI 53218-4714
CURRENT OCCUPANT	4762 N 74TH ST	MILWAUKEE, WI 53218-4715
CURRENT OCCUPANT	4763 N 73RD ST	MILWAUKEE, WI 53218-4714
CURRENT OCCUPANT	4806 N 74TH ST	MILWAUKEE, WI 53218-3819
CURRENT OCCUPANT	4821 N 74TH ST	MILWAUKEE, WI 53218-3820
CURRENT OCCUPANT	7314 W HAMPTON AVE	MILWAUKEE, WI 53218-4744
CURRENT OCCUPANT	7321 W HAMPTON AVE	MILWAUKEE, WI 53218-4745
CURRENT OCCUPANT	7325 W HAMPTON AVE	MILWAUKEE, WI 53218-4745
CURRENT OCCUPANT	7326 W HAMPTON AVE	MILWAUKEE, WI 53218-4744
CURRENT OCCUPANT	7335 W HAMPTON AVE	MILWAUKEE, WI 53218-4745
CURRENT OCCUPANT	7402 W DERBY PL	MILWAUKEE, WI 53218-4742
CURRENT OCCUPANT	7406 W DERBY PL	MILWAUKEE, WI 53218-4742
CURRENT OCCUPANT	7408 W DERBY PL	MILWAUKEE, WI 53218-4742
CURRENT OCCUPANT	7410 W HAMPTON AVE	MILWAUKEE, WI 53218-4746
CURRENT OCCUPANT	7414 W DERBY PL	MILWAUKEE, WI 53218-4742
CURRENT OCCUPANT	7418 W DERBY PL	MILWAUKEE, WI 53218-4742
CURRENT OCCUPANT	7428 W DERBY PL, 1	MILWAUKEE, WI 53218-4742
CURRENT OCCUPANT	7428 W DERBY PL, 2	MILWAUKEE, WI 53218-4742
CURRENT OCCUPANT	7428 W DERBY PL, 3	MILWAUKEE, WI 53218-4742
CURRENT OCCUPANT	7428 W DERBY PL, 4	MILWAUKEE, WI 53218-4742
CURRENT OCCUPANT	7504 W HAMPTON AVE, 1	MILWAUKEE, WI 53218-4753
CURRENT OCCUPANT	7504 W HAMPTON AVE, 2	MILWAUKEE, WI 53218-4753
CURRENT OCCUPANT	7504 W HAMPTON AVE, 3	MILWAUKEE, WI 53218-4753
blank	notice	

Total Records: 31

Radius: 250.0 feet and Center of Circle: 7411 W Hampton Ave



BUSINESS LICENSE PLAN OF OPERATION

ccl-busplan 5/12/2020

Office of the City Clerk License Division
200 E. Wells St. Room 105, Milwaukee, WI 53202
(414) 286-2238 www.milwaukee.gov/license e-mail address: license@milwaukee.gov

1. Type of Business

Applying for: Extended Hours (12AM to 5AM) - If a food establishment, check all that apply: Delivery Drive Thru Dining Room
 Self Service Laundry Massage Establishment Filling Station
 Other (supplemental application for specific license also required)

Provide a detailed description of the type of business you plan on operating: RESTAURANT / BAR

Do you have any experience operating this type of business? No Yes If yes, explain: HAVE BEEN IN FOOD/BAR BUSINESS

2. Business Operations

- a. Proposed Opening Date: June 1st, 2021
- b. Is this premise under construction? No Yes if yes, list estimated completion date: _____
- c. Is this a franchise? No Yes
- d. Is this premises currently licensed? No Yes If yes, list type of license: _____
- e. Is the current licensee operating? No Yes If no, list date closed: _____
- f. Do you have future plans for other businesses, licenses or permits at this location? No Yes
If yes, explain: _____
- g. Have you previously held an Extended Hours License in Milwaukee? No Yes
If yes, list address(es): _____
- h. Are other businesses operating in the same building? No Yes If yes, describe: _____

3. Litter & Noise

- a. How are grounds kept clean? Sweep Pressure Wash Pick Up Litter Other: _____
- b. How often will grounds be cleaned? Daily Weekly As Needed Monthly Other: _____
- c. Grounds cleaned by: Licensee Building Owner Employees Hired Maintenance Other: _____
- d. How are noise issues prevented and/or addressed? Security Manager approaches customer(s) Call Police
 Signs Posted Other: _____
- e. Will a sound amplification system be used? No Yes If yes, describe: USE FOR TVS

4. Smoking & Sanitation

- a. Are there designated outdoor smoking areas? No Yes If yes, describe: OUTSIDE PATIO
- b. Number of Garbage Cans: Inside: 9 Locations: BARS, KITCHEN, OUTDOOR PATIO AND BATHROOM
Outside: 1 Locations: EAST SIDE OF THE BUILDING
- c. Is a crowd control barrier used? No Yes If yes, describe: _____
- d. How many restrooms are on the premises? 2
- e. Name of solid waste contractor: Advanced Disposal Waste Management Other: _____

5. Security

- a. Are there onsite parking spaces? No Yes If yes, how many? 53+ and describe the parking security plan: PARKING LOT LIGHTING, SECURITY CAMERAS ON BUILDING, LIGHTING ON BUILDING
- b. Is there a loading zone? No Yes If yes, describe the loading area security plan: WE HAVE A RECEIVING AREA ON SOUTHEAST CORNER OF THE BUILDING.
- c. Will you have security personnel on premise? No Yes If yes, how many? _____ and answer the following:
 What are their responsibilities? _____
 Is security equipment used? No Yes If yes, describe SECURITY CAMERAS AND ALARM SYSTEM
 List their licensing, certification, or training credentials _____
- d. Will there be security cameras? No Yes If yes, how many? 17 and list locations: INSIDE BUILDING AND OUTSIDE BUILDING
- e. Will searches/identification checks be done upon entry? No Yes If yes, describe WILL CHECK ID FOR ALCOHOL

6. Percentage of Sales (must total 100%)

Alcohol <u>35</u> %	Food <u>60</u> %	Secondhand Merchandise _____ %	Precious Metals & Gems _____ %
Entertainment <u>4</u> %	Cigarettes <u>1</u> %		
Pawnbroker Activity _____ %	Salvaged Materials _____ % (such as scrap metal)	Personal Services (such as tattoo, body piercing, salon, tailor, tanning, etc.) _____ %	Other _____ % Describe: _____

7. Businesses/Licenses on the Premises (check all that apply):

Type 1

- Full Service Restaurant Cafe/Coffee Shop Deli or Fast Food Restaurant Private/Fraternal/Veterans Club
- Night Club Tavern Cocktail Lounge Teen Club
- Banquet Hall Sports Facility Bowling Alley
- Hotel/Motel : Number of Floors: _____ Rooming House: Number of Floors: _____
 Number of Rooms: _____ Number of Rooms: _____

Type 2

- Liquor Store Corner Store Supermarket Convenience Store
- Gas Station Amusement/Phonograph Distributor Recycling, Salvage or Towing
- Used Car Dealer Personal Service Establishment
(such as tattoo business, hair salon, tailor, etc.) Recording Studio

What other licenses/permits will you hold at this location? (check all that apply)

- Occupancy Permit Cigarette & Tobacco Gas Station Extended Hours Class "B" Tavern Weights & Measures
- Secondhand Dealer Precious Metal & Gem Other: _____

8. Legal Capacity (only if a Type 1 premises in #7 above)

Capacity 353 (Call the Milwaukee Development Center at 414-286-8211 if you have questions.)

9. Premises Description

- a. Identify all area(s) of the premises that will be used in operating this business (include areas used only for storage):
 1st Floor 2nd Floor Basement Storage Patio Beer Garden Sidewalk Café Deck Rooftop
 Other: Describe: _____
- b. Describe Location: Major Thoroughfare Secondary Street Other: _____
- c. Nearest Major Cross Street: 74TH AND HAMPTON AVE
- d. Describe Building: Free Standing Building Strip Mall Other: _____
- e. Describe Premises Structure: Single Story Multi-Story - # of Stories _____ Other: _____
- f. Describe Surrounding Area: Commercial Residential Industrial Other: _____
- g. Building Owner Name: SIA XIONG Phone Number: 414-627-4488
 Building Owner Address: 261 CEDAR BEACH RD, BELGIUM WI53004

10. Hours of Operation & Customers

Will customers be entering the premises? No Yes

Day of the Week	Proposed Hours of Operation:		Estimated Number of Customers expected each day	Potential Age Range of Customers	Class B Tavern Applicant Only: Age Restriction (If none, write 'None')
	Open Time (include a.m. or p.m.)	Close Time (Include a.m. or p.m.)			
Sunday	6AM	2AM	100+	ANY AGE	None
Monday	6AM	2AM	100+	ANY AGE	None
Tuesday	6AM	2AM	100+	ANY AGE	None
Wednesday	6AM	2AM	100+	ANY AGE	None
Thursday	6AM	2AM	100+	ANY AGE	None
Friday	6AM	2:30AM	100+	ANY AGE	None
Saturday	6AM	2:30AM	100+	ANY AGE	None

An Extended Hours Establishment License is required for any convenience store, filling station, personal service establishment (such as tattoo, body piercing, salon, tailor, tanning, etc.), recording studio or restaurant which is open between the hours of 12:00 a.m. and 5:00 a.m.

Alcohol Establishments Permitted Hours of Operation: Class A: 8:00 am to 9:00 pm Sunday thru Saturday
 Class B: 6:00 am to 2:00 am Sunday thru Thursday, 6:00 am to 2:30 am Friday & Saturday

Entertainment Outdoor Closing Hours: 10:00pm Sunday-Thursday; 12:00am Friday & Saturday; unless a different time, either earlier or later, is established by the Common Council in its approval of the licensee's plan of operation.

11. Signature(s)

Sia Xiong

Digitally signed by Sia Xiong
 Date: 2021.05.04 11:18:50 -05'00'

Signature of Sole Proprietor, Partner, or 20% or more Shareholder
 (If there are no 20% or more shareholders,
 Corporate Officer-print name/title and sign)

Signature of additional partner or 20% or more shareholder

See Application Information for a complete list of all required application forms.



ALCOHOL BEVERAGE & PUBLIC ENTERTAINMENT PREMISES SUPPLEMENTAL APPLICATION

Office of the City Clerk License Division
200 E. Wells St. Room 105, Milwaukee, WI 53202
(414) 286-2238 e-mail address: license@milwaukee.gov www.milwaukee.gov/license

Legal Entity Name: AN OX LLC	
Premise Address: 7411 W. HAMPTON AVE. MILWAUKEE WI 53218	
Proximity of Premises to Church, School, Daycare Center or Hospital	
Is the building within 300 feet of any church, school, daycare center or hospital? <input checked="" type="checkbox"/> No <input type="checkbox"/> Yes	
"Service Bar Only" Designation	
If applying for Class B or C license, are you applying for "Service Bar Only"? <input checked="" type="checkbox"/> No <input type="checkbox"/> Yes	
Service Bar Only means customers cannot sit at the bar. Alcohol is served to employees who serve patrons seated at tables. No stools, chairs or other articles of furniture shall be placed at the service bar for patrons to sit upon.	
Business Information	
a) Are you taking out this application for anyone that may not be eligible for a license? <input checked="" type="checkbox"/> No <input type="checkbox"/> Yes If yes, list their name and address: _____	
b) Will the agent, a partner or the individual licensee be conducting the day-to-day operations of the business? <input type="checkbox"/> No <input checked="" type="checkbox"/> Yes If no, list the name and address of the person(s) who will: _____	
Class B Applicants: If the agent, a partner or the individual licensee will not be conducting the day-to-day operations of the business, the person(s) listed above must obtain a Class B Managers license.	
c) Does anyone else have money invested or any other interest in this business? <input checked="" type="checkbox"/> No <input type="checkbox"/> Yes If yes, explain: _____	
d) Have you made an agreement with anyone to repay any loan or any other payments based upon income from the business? <input checked="" type="checkbox"/> No <input type="checkbox"/> Yes If yes, list name and address: _____	
Property Information (New & Transfer Applicants Only)	
a) Do you own or lease the building? <input checked="" type="checkbox"/> Own <input type="checkbox"/> Lease	
b) Who owns the fixtures (for example, coolers, etc.)? <u>AN OX LLC</u>	
c) Are you purchasing the stock and/or fixtures? <input checked="" type="checkbox"/> No <input type="checkbox"/> Yes If yes, amount paid \$ _____	
d) Total amount paid for business <u>\$ 0.00</u>	
e) Total amount paid for goodwill of the business <u>\$ 0.00</u>	
Goodwill comprises the reputation and customer relationships of an existing business. If the price you pay for the business exceeds the fair market value of all of the rest of the assets of the business, the excess may be considered goodwill.	
f) Have you made arrangements with the seller for payment of personal property taxes? <input checked="" type="checkbox"/> No <input type="checkbox"/> Yes	
Lease Information (New & Transfer Applicants who are leasing the premises only)	
a) Date lease begins <u>10/01/2018</u> Ends <u>09/30/2023</u>	
b) Monthly rental <u>\$ 2,000.00</u>	
c) Do you have an option to renew the lease? <input type="checkbox"/> No <input checked="" type="checkbox"/> Yes	
d) Does your lease allow for assignment to another party without the consent of the owner? <input checked="" type="checkbox"/> No <input type="checkbox"/> Yes	
e) For what length of time have you been guaranteed occupancy (number of years)? <u>5 YRS</u>	

Lease Information (Continued)

- f) In addition to paying the monthly rental, will you have to pay anything additional to the owner of the building to guarantee performance of the lease? No Yes If yes, explain _____
- g) Does the present owner or occupancy object to the granting of your license? No Yes
If yes, explain _____

Change of Agent Applicants Only

Have there been any changes to the floor plan since the last application was submitted? No Yes
If no, a new floor plan is not required. If yes, submit a new floor plan and explain the change(s):

Signature

Sia Xiong

Digitally signed by Sia Xiong
DN: cn=Sia Xiong, o=

Signature of Sole Proprietor, Partner or 20% or More Shareholder
(If no 20% or more Shareholder, Corporate Officer - print name/title and sign)

Note: All information contained in this application is subject to approval by the Common Council.
Deviating from approved plan of operation will subject licensee to citations, and/or suspension or non-renewal of the license.
Contact the License Division for information on how to request changes.

New and transfer of premises applicants must submit the following:

- Detailed floor plan
- If a restaurant, copy of the menu

**FOOD DEALER LICENSE PLAN OF OPERATION**

OFFICE OF THE CITY CLERK, LICENSE DIVISION
CITY HALL, 200 E. WELLS ST, ROOM 105, MILWAUKEE, WI 53202
(414) 286-2238 • license@milwaukee.gov • www.milwaukee.gov/license

Legal Entity Name: AN OX LLC	
Premises Address: 7411 W. HAMPTON AVE. MILWAUKEE, WI 53218	
SECTION 1	TYPE OF BUSINESS
What will be the majority of your food sales? (check one)	
<input checked="" type="checkbox"/> Restaurant Items (meals): MEALS include, but are not limited to, chicken, ribs, sandwiches, roasted corn, baked potatoes, hot dogs, brats, tacos, nachos w/ cheese and meat, French fries, cooked or deep fried vegetables/fruit, cooked cheese curds, corn dogs, egg rolls, salads.	
<input type="checkbox"/> Retail Items (snacks and beverages): RETAIL items include, but are not limited to, ice cream/soft serve, lemonade, snow cones, coffee, espresso, cappuccino, tea, fruit juice, smoothies, candy, dispensed soda, fruit cups, bakery, cookies, kettle corn, cotton candy, funnel cakes, fritters, tortilla chips w/ cheese.	
Will it be a convenience store? <input type="checkbox"/> Yes <input type="checkbox"/> No A convenience store contains less than 5,000 square feet of retail space and has, as its primary business, the sale of basic food items and in addition, sells household products or is a filling station that sells basic food items and household products.	
<input type="checkbox"/> Bed & Breakfast <input type="checkbox"/> Micro Market	
All Applicants: Submit a menu or a list of food items that will be sold.	
Will any wholesale business be done? <input checked="" type="checkbox"/> No <input type="checkbox"/> Yes If yes, what percentage of food sales will be wholesale?	
<input type="checkbox"/> Less than 25%	
<input type="checkbox"/> 25% or More AND: <input type="checkbox"/> Restaurant items (meals) will be sold – Complete this application and also contact DATCP. <input type="checkbox"/> NO restaurant items (meals) will be sold - Do NOT complete this application. Contact DATCP only.	
SECTION 2	FOOD PROCESSING
Will any food processing be done? <input type="checkbox"/> No <input checked="" type="checkbox"/> Yes	
Processing is defined as assembling, grinding, cutting, mixing, baking, coating, stuffing, packing, bottling, grilling, canning, extracting, fermenting, distilling, pickling, freezing, drying, smoking, or packaging.	
SECTION 3	FOOD REQUIRING TEMPERATURE CONTROL
Will any food that requires temperature control be sold? <input type="checkbox"/> No <input checked="" type="checkbox"/> Yes (includes dairy products such as milk, cheese, and ice cream, fish, shellfish, meat, poultry)	
If yes, list the types of food items: <u>ice cream, fish, shellfish, meat, poultry</u>	

SECTION 4 DETAILS OF OPERATION

- Will you have seating on site for dining? No Yes
- Will you be doing any catering? No Yes
- Will you be doing any delivery? No Yes
- Will you have outdoor activities? No Yes - Check all that apply: Bar Cooking/Grilling Dining
- Will you have a drive thru window? No Yes - Are hours different from inside? No Yes
If Yes, provide drive thru hours: _____
- Will scales or barcode scanners be used? No Yes - You must also apply for a Weights & Measures License.

SECTION 5 ADDITIONAL SITES

Where will food be prepared and/or sold?

- At a single site At multiple sites: How many? _____ (for example, a hotel with several dining rooms or bars)

If multiple sites, attach a Food Dealer Additional Site Addendum (ccl-foodadd) for each additional site.

SECTION 6 CONSTRUCTION OR CHANGES

Are you planning any construction, remodeling or equipment changes?

- No If No, SKIP to Section 8
- Yes If Yes, check all that apply: New construction of a building Renovation or remodeling
 Construction changes to existing building Equipment changes only

Provide a brief description of the changes: _____

Start date: _____

Name, Address & Phone Number of Architect: _____

Name, Address & Phone Number of Contractor: _____

SECTION 7 ALCOHOL BEVERAGES

Are you applying for an alcohol beverage license?

- No If No, SKIP to Section 8
- Yes If YES, if your food license is approved prior to the alcohol license, when do you want the food license issued?
 Immediately At the same time as the alcohol license

SECTION 8 ACKNOWLEDGEMENTS & SIGNATURE

You must initial each item confirming your understanding:

- SX I understand the Health Department must conduct an inspection and advise the License Division of their approval before the license may be issued.
- SX I understand I must obtain an occupancy permit from the Department of Neighborhood Services and an inspection may be required. Neighborhood Services must advise the License Division of their approval before the license may be issued.
- SX I understand the district alderperson will review and either support or object to my application. If he/she objects, I may appeal and be scheduled to appear before the Licenses Committee. The Licenses Committee will then make a recommendation to the Common Council. The Common Council must grant the license before it may be issued.
- SX I understand proof of payment for all license fees must be on file in the License Division before the license may be issued and the license must be issued and posted in my establishment prior to opening for business.
- SX I will not operate my food business until the license has been issued and posted in the establishment.

Signature of Sole Proprietor, Partner, or 20% Shareholder: Sia Xiong

Digitally signed by Sia Xiong
Date: 2021.05.04 11:46:16 -05'00'

Signature of Additional Partner: _____



PUBLIC ENTERTAINMENT PREMISES LICENSE SUPPLEMENTAL APPLICATION

Office of the City Clerk License Division
200 E. Wells St. Room 105, Milwaukee, WI 53202
(414) 286-2238 www.milwaukee.gov/license e-mail address: license@milwaukee.gov

PREMISES ADDRESS: 7411 W. HAMPTON AVE, MILWAUKEE, WI 53218			
TYPES OF ENTERTAINMENT (CHECK ALL THAT APPLY)			
<input checked="" type="checkbox"/> Instrumental Musicians	<input type="checkbox"/> Battle of the Bands	<input type="checkbox"/> Dancing by Performers	<input checked="" type="checkbox"/> Amusement Machines How many? ⁶ _____
<input checked="" type="checkbox"/> Bands	<input type="checkbox"/> Comedy Acts	<input type="checkbox"/> Adult Entertainment/ Strippers/Erotic Dance	<input type="checkbox"/> Concerts Approx. # per year? _____
<input type="checkbox"/> Bowling Alley How many? _____	<input checked="" type="checkbox"/> Disc Jockey	<input type="checkbox"/> Wrestling	<input type="checkbox"/> Theatrical Performances Approx. # per year? _____
<input checked="" type="checkbox"/> Pool Tables How many? ¹⁻² _____	<input type="checkbox"/> Magic Shows	<input type="checkbox"/> Patron Contests	<input checked="" type="checkbox"/> Jukebox
<input type="checkbox"/> Motion Pictures (movies by admission) - How many? _____	<input type="checkbox"/> Poetry Readings	<input checked="" type="checkbox"/> Patrons Dancing	<input checked="" type="checkbox"/> Karaoke
<input type="checkbox"/> Other: _____			
<i>Entertainment Outdoor Closing Hours: 10:00pm Sunday-Thursday; 12:00am Friday & Saturday; unless a different time, either earlier or later, is established by the Common Council in its approval of the licensee's plan of operation.</i>			
PROMOTERS/SOUND AMPLIFICATION			
Will promoters ever be used for any of the entertainment? <input checked="" type="checkbox"/> No <input type="checkbox"/> Yes If Yes, Describe: _____			
At any time will sound amplification be used? <input type="checkbox"/> No <input checked="" type="checkbox"/> Yes If Yes, Describe: MUSIC AND TVS			
LEGAL CAPACITY OF PREMISES			
353 _____ (Call the Development Center at 414-286-8211 with questions.) Legal capacity determines the fee for your Public Entertainment Premises License. If you would like to request the license be approved with a lower capacity than that listed above, indicate the lower capacity here: _____. If approved, this lower capacity will print on your license and override the capacity listed on your Occupancy Permit.			
ACKNOWLEDGEMENT/SIGNATURE			
I understand that after the license has been issued, a change to the plan of operation will require a written request to change and approval from the Common Council. I agree to inform the City Clerk within 10 days of any substantial changes in the information supplied in this application. I understand that I shall not willfully refuse to provide the services offered under this license, or add charges or require deposits not required of the general public because of race, color, sex, religion, national origin or ancestry, age, handicap, lawful source of income, marital status, sexual orientation, gender identity or expression, familial status or the fact that a person is now or has been a member of the military service, whether dressed in uniform or not; and shall not seek such information as a condition of employment, or penalize any employee or discriminate in the selection of personnel for training or promotion on the basis of such information.			
I have knowledge of the City Ordinances currently regulating public entertainment, and understand that the license may be subject to suspension, non-renewal or revocation, if I violate any rule, law or regulation of the city of Milwaukee and State of Wisconsin.			
Sia Xiong		Digitally signed by Sia Xiong Date: 2021.05.04 11:27:14 -05'00'	
Signature of Sole Proprietor, Partner or 20% or More Shareholder (If no 20% or more Shareholder, Corporate Officer - print name/title and sign)			

Office Use Only:

Initials: _____ Filed: _____ App: _____

Only PEP? No Yes If Yes, Queue to MPD and Email Mgrs/Team Lead (must be heard w/in 60 days)

AN OX CAFE ¹

7411 W. Hampton Ave, Milwaukee, WI 53218

Appetizers

- **Chicken wings**
6 Pieces Deep Fried chicken wings served with your choice of sauce: Buffalo, BBQ, Ranch, Sweet Sriracha
- **Spring rolls**
Two fresh shrimp spring rolls with house peanut sauce.
- **Egg Rolls**
Four fried pork egg rolls with house sweet chili sauce.
- **Fries**
Marinated battered deep fried fries.
- **Tum Som (Papaya salad)**
Shredded green papaya, peanuts, tomatoes seasoned with chili and fresh lime juice.

Entree

- *** Pho**
Regular house special combo with rare slices of steak, well done brisket, flank, tendon, tripe & meatballs.
- **Crispy Roast Pork w/ rice**
8 oz Marinated Crispy Roast Pork sliced on top of a bed of jasmine rice served with house special spicy sauce.
- **Hmong Sausage w/ rice**
Roasted Hmong sausage sliced on top of a bed of jasmine rice served with house special spicy sauce.
- **Roast Beef w/ rice**
8 oz Marinated Roast beef sliced on top of a bed of jasmine rice served with house special spicy sauce.
- **Fried Rice**
Choice of chicken, beef or pork stir-fried with rice, egg, onion, carrot and tomato.
- **Pad Thai**
Thin rice noodles stir-fried with shrimp, chicken, egg, ground peanut, bean sprout and green onion.
- **Pad See Ew**
Pan-fried wide rice noodles with sweet soy sauce , Chinese broccoli, egg and choice of chicken, beef or pork.
- *** Build your own burger**
1/2 lb 100% Certified Black Angus Beef \$9 (add extra patty for \$3.5) / 1/4 lb 100% Certified Black Angus Beef \$7.5 / Turkey Burger \$8.5 and choice of sauce and dressing.

* Our burgers are cooked to order. Consuming raw or undercooked meats, poultry, seafood, shellfish or eggs may increase your risk of foodborne illness.

Sia Xiong Agent for "AN OX LLC"
 "AN OX CAFE"
 7411 W Hampton Ave
 Milwaukee, WI 53218
 8/23/2018

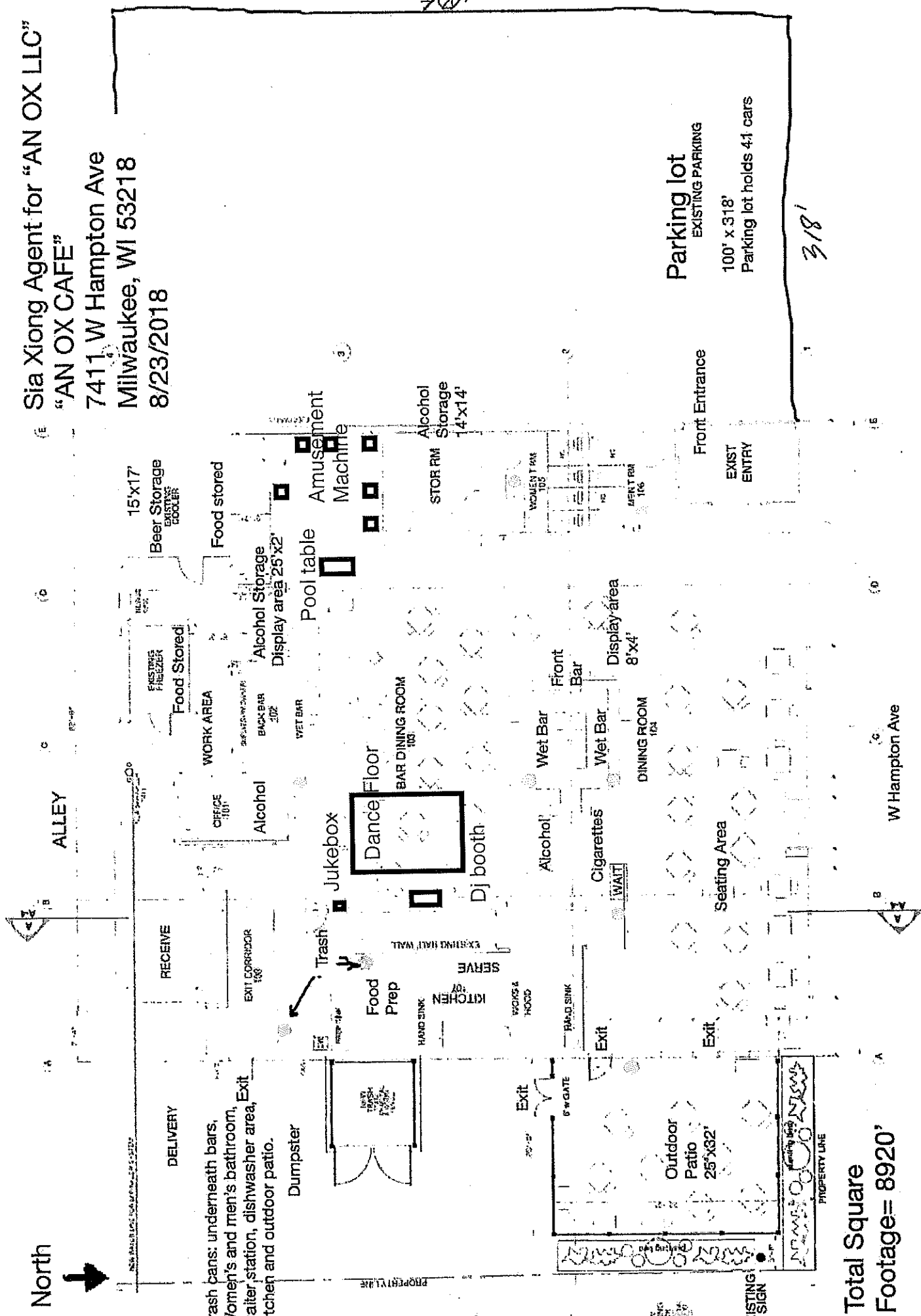

Parking lot
 EXISTING PARKING
 100' x 318'
 Parking lot holds 41 cars
 318'

Total Square Footage= 8920'

W Hampton Ave

