



CITY OF MILWAUKEE
OFFICE OF THE CITY CLERK

Tuesday, August 23, 2022

COMMITTEE MEETING NOTICE

AD 03

LARGENT, Marc A, Agent
Premium Loaves II, Inc.
1717 Ft Jesse Rd #STE 3
Normal, IL 61761

You are requested to attend a virtual hearing to be held on:

Friday, September 02, 2022 at 10:55 AM

Regarding: Your Food Dealer License Application as agent for "Premium Loaves II, Inc." for "Jimmy John's" at 1344 E BRADY St.

This meeting will be held via GoToMeeting. Please see the enclosed best practices document for further instructions. The access code is <https://meet.goto.com/392400829>. If you wish to call in, please call [+1 \(571\) 317-3112](tel:+15713173112) and use Access Code: 392-400-829.

There is a possibility that your application may be denied for one or more of the following reasons: The recommendation of the committee regarding the application shall be based on evidence presented at the hearing. Per MCO 85-2.7-4, probative evidence concerning whether or not a new license should be granted may be presented on the following subjects: whether or not the applicant meets the municipal requirements, the appropriateness of the location and premises where the licensed premises is to be located and whether use of the premises for the purposes or activities permitted by the license would tend to facilitate a public or private nuisance or create undesirable neighborhood problems such as disorderly patrons, unreasonably loud noise, litter, and excessive traffic and parking congestion. Probative evidence relating to these matters may be taken from the plan of operation submitted with the license application, if any, but shall not include the content of any music. Evidence regarding the fitness of the location of the premises to be maintained as the principal place of business, including but not limited to whether there is an overconcentration of businesses of the type for which the license is sought; whether the proposal is consistent with any pertinent neighborhood business or development plans, or the location's proximity to areas where children are typically present. The applicant's record in operating similarly licensed premises; and whether or not the applicant has been charged with or convicted of any felony, misdemeanor, municipal offense or other offense, the circumstances of which substantially relate to the activity to be permitted by the license being applied for or any other factor which reasonably relates to the public health, safety or welfare may also be considered. See attached police report or correspondence.

Notice for applicants with warrants or unpaid fines:

Proof of warrant satisfaction or payment of fines must be submitted at the hearing on the above date and time. Failure to comply with this requirement may result in a delay of the granting/denial of your application.

Failure to attend this meeting may result in the denial of your license. Individual applicants and partnership applicants must attend or attend by an attorney. The agent or attorney for corporate or limited liability applicants must attend. If you wish to do so and at your own expense, you may be accompanied by an attorney of your choosing to represent you at this hearing.

You will be given an opportunity to speak on behalf of the application and to respond and challenge any charges or reasons given for the denial. No petitions can be accepted by the committee, unless the people who signed the petition attend the virtual hearing and are willing to testify. You may present witnesses under oath and you may also confront and cross-examine opposing witnesses under oath. If you have difficulty with the English language, you should request an interpreter attend the meeting with you, at your expense, so that you can answer questions and participate in your hearing.

PLEASE NOTE: Upon reasonable notice, efforts will be made to accommodate the needs of disabled individuals through sign language interpreters or other auxiliary aids. For additional information or to request this service, contact the Council Services Division ADA Coordinator at (414) 286-2998, Fax - (414) 286-3456, TDD - (414) 286-2025.

JIM OWCZARSKI, CITY CLERK

BY: _____

Jim Cooney
License Division Manager

If you have questions regarding this meeting, please contact the staff assistant, Yadira Melendez at (414) 286-2775 or stas5@milwaukee.gov



CITY OF MILWAUKEE
OFFICE OF THE CITY CLERK

Tuesday, August 23, 2022

COMMITTEE MEETING NOTICE

AD 03

LARGENT, Marc A, Agent
Premium Loaves II, Inc.
2002 CRIMSON LN
BLOOMINGTON, IL 61704

You are requested to attend a virtual hearing to be held on:

Friday, September 02, 2022 at 10:55 AM

Regarding: Your Food Dealer License Application as agent for "Premium Loaves II, Inc." for "Jimmy John's" at 1344 E BRADY St.

This meeting will be held via GoToMeeting. Please see the enclosed best practices document for further instructions. The access code is <https://meet.goto.com/392400829>. If you wish to call in, please call [+1 \(571\) 317-3112](tel:+15713173112) and use Access Code: 392-400-829.

There is a possibility that your application may be denied for one or more of the following reasons: The recommendation of the committee regarding the application shall be based on evidence presented at the hearing. Per MCO 85-2.7-4, probative evidence concerning whether or not a new license should be granted may be presented on the following subjects: whether or not the applicant meets the municipal requirements, the appropriateness of the location and premises where the licensed premises is to be located and whether use of the premises for the purposes or activities permitted by the license would tend to facilitate a public or private nuisance or create undesirable neighborhood problems such as disorderly patrons, unreasonably loud noise, litter, and excessive traffic and parking congestion. Probative evidence relating to these matters may be taken from the plan of operation submitted with the license application, if any, but shall not include the content of any music. Evidence regarding the fitness of the location of the premises to be maintained as the principal place of business, including but not limited to whether there is an overconcentration of businesses of the type for which the license is sought; whether the proposal is consistent with any pertinent neighborhood business or development plans, or the location's proximity to areas where children are typically present. The applicant's record in operating similarly licensed premises; and whether or not the applicant has been charged with or convicted of any felony, misdemeanor, municipal offense or other offense, the circumstances of which substantially relate to the activity to be permitted by the license being applied for or any other factor which reasonably relates to the public health, safety or welfare may also be considered. See attached police report or correspondence.

Notice for applicants with warrants or unpaid fines:

Proof of warrant satisfaction or payment of fines must be submitted at the hearing on the above date and time. Failure to comply with this requirement may result in a delay of the granting/denial of your application.

Failure to attend this meeting may result in the denial of your license. Individual applicants and partnership applicants must attend or attend by an attorney. The agent or attorney for corporate or limited liability applicants must attend. If you wish to do so and at your own expense, you may be accompanied by an attorney of your choosing to represent you at this hearing.

You will be given an opportunity to speak on behalf of the application and to respond and challenge any charges or reasons given for the denial. No petitions can be accepted by the committee, unless the people who signed the petition attend the virtual hearing and are willing to testify. You may present witnesses under oath and you may also confront and cross-examine opposing witnesses under oath. If you have difficulty with the English language, you should request an interpreter attend the meeting with you, at your expense, so that you can answer questions and participate in your hearing.

PLEASE NOTE: Upon reasonable notice, efforts will be made to accommodate the needs of disabled individuals through sign language interpreters or other auxiliary aids. For additional information or to request this service, contact the Council Services Division ADA Coordinator at (414) 286-2998, Fax - (414) 286-3456, TDD - (414) 286-2025.

JIM OWCZARSKI, CITY CLERK

BY: _____

Jim Cooney
License Division Manager

If you have questions regarding this meeting, please contact the staff assistant, Yadira Melendez at (414) 286-2775 or stas5@milwaukee.gov



Tuesday, August 23, 2022



Notice of Public Hearing

Blank Notice

LARGENT, Marc A
Jimmy John's at 1344 E BRADY St.
Food Dealer License Application

Friday, September 02, 2022 at 10:55 AM

To whom it may concern:

The above application has been made by the above named applicant(s). This requires approval from the Licenses Committee and the Common Council of the City of Milwaukee. The hearing before the Licenses Committee will take place virtually on 09/02/2022 AT 10:55 AM . This is a public hearing. Those wishing to view the proceeding are able to do so via the City Channel – Channel 25 on Spectrum Cable – or on the Internet at <http://city.milwaukee.gov/citychannel>. Those wishing to provide oral testimony will be asked to do so by phone or internet and are asked to contact the staff assistant, Yadira Melendez at (414) 286-2775 or stasst5@milwaukee.gov for necessary information. Please make such requests no later than one business day prior to the start of the meeting. You are not required to attend the hearing, but please see the information below if you would like to provide testimony. Once the Licenses Committee makes its recommendation, this recommendation is forwarded to the full Common Council for approval at its next regularly scheduled hearing.

Important details for those wishing to provide information for the Licenses Committee to consider when making its recommendation:

1. The license application is scheduled to be heard at the above time. Due to other hearings running longer than scheduled, you may have to wait some time to provide your testimony.
2. You must testify as to matters that you have personally experienced or seen. (You cannot provide testimony for your neighbor, parent or anyone else; this is considered hearsay and cannot be considered by the committee.)
3. No letters or petitions can be accepted by the committee (unless the person who wrote the letter or the persons who signed the petition are willing to testify).
4. Persons opposed to the license application are given the opportunity to testify first; supporters may testify after the opponents have finished.
5. When you are called to testify, you will be sworn in and asked to give your name, and address. (If your first and/or last names are uncommon please spell them.)
6. You may then provide testimony.
 - a. Include only information relating to the above license application.
 - b. Include only information you have personally witnessed or seen.
 - c. Provide concise and relevant information detailing how this business has affected or may affect the peaceful enjoyment of your neighborhood.
 - d. If by the time you have the opportunity to testify, the information you wish to share has already been provided to the committee, you may state that you agree with the previous testimony. Redundant or repetitive testimony will not assist the committee in making its recommendation.
7. After giving your testimony, the members of the Licenses Committee and the licensee may ask questions regarding the testimony you have given or other factors relating to the license application.
8. Business Competition is not a valid basis for denial or non-renewal of a license.

Please Note: If you have submitted an objection to the above application your objection cannot be considered by the committee unless you personally testify at the hearing.

OCCUPANT	MAIL ADDRESS	CITY STATE ZIP
CURRENT OCCUPANT	1303 E BRADY ST	MILWAUKEE, WI 53202-1612
CURRENT OCCUPANT	1305 E BRADY ST	MILWAUKEE, WI 53202-1612
CURRENT OCCUPANT	1309 E BRADY ST	MILWAUKEE, WI 53202-1612
CURRENT OCCUPANT	1327A E BRADY ST	MILWAUKEE, WI 53202-1612
CURRENT OCCUPANT	1329A E BRADY ST	MILWAUKEE, WI 53202-1612
CURRENT OCCUPANT	1337 E BRADY ST	MILWAUKEE, WI 53202-1612
CURRENT OCCUPANT	1340A E BRADY ST	MILWAUKEE, WI 53202-1613
CURRENT OCCUPANT	1340B E BRADY ST	MILWAUKEE, WI 53202-1613
CURRENT OCCUPANT	1340C E BRADY ST	MILWAUKEE, WI 53202-1613
CURRENT OCCUPANT	1413 E BRADY ST, UPPR	MILWAUKEE, WI 53202-1614
CURRENT OCCUPANT	1639 N FARWELL AVE, 101	MILWAUKEE, WI 53202-2330
CURRENT OCCUPANT	1639 N FARWELL AVE, 102	MILWAUKEE, WI 53202-2330
CURRENT OCCUPANT	1639 N FARWELL AVE, 103	MILWAUKEE, WI 53202-2330
CURRENT OCCUPANT	1639 N FARWELL AVE, 104	MILWAUKEE, WI 53202-2330
CURRENT OCCUPANT	1639 N FARWELL AVE, 105	MILWAUKEE, WI 53202-2330
CURRENT OCCUPANT	1639 N FARWELL AVE, 106	MILWAUKEE, WI 53202-2330
CURRENT OCCUPANT	1639 N FARWELL AVE, 107	MILWAUKEE, WI 53202-2330
CURRENT OCCUPANT	1639 N FARWELL AVE, 108	MILWAUKEE, WI 53202-2330
CURRENT OCCUPANT	1639 N FARWELL AVE, 109	MILWAUKEE, WI 53202-2330
CURRENT OCCUPANT	1639 N FARWELL AVE, 110	MILWAUKEE, WI 53202-2330
CURRENT OCCUPANT	1639 N FARWELL AVE, 201	MILWAUKEE, WI 53202-2330
CURRENT OCCUPANT	1639 N FARWELL AVE, 202	MILWAUKEE, WI 53202-2330
CURRENT OCCUPANT	1639 N FARWELL AVE, 203	MILWAUKEE, WI 53202-2330
CURRENT OCCUPANT	1639 N FARWELL AVE, 204	MILWAUKEE, WI 53202-2330
CURRENT OCCUPANT	1639 N FARWELL AVE, 205	MILWAUKEE, WI 53202-2330
CURRENT OCCUPANT	1639 N FARWELL AVE, 206	MILWAUKEE, WI 53202-2330
CURRENT OCCUPANT	1639 N FARWELL AVE, 207	MILWAUKEE, WI 53202-2330
CURRENT OCCUPANT	1639 N FARWELL AVE, 208	MILWAUKEE, WI 53202-2330
CURRENT OCCUPANT	1639 N FARWELL AVE, 209	MILWAUKEE, WI 53202-2330
CURRENT OCCUPANT	1639 N FARWELL AVE, 210	MILWAUKEE, WI 53202-2330
CURRENT OCCUPANT	1649 N WARREN AVE	MILWAUKEE, WI 53202-2215
CURRENT OCCUPANT	1651 N FARWELL AVE, 101	MILWAUKEE, WI 53202-2302
CURRENT OCCUPANT	1651 N FARWELL AVE, 102	MILWAUKEE, WI 53202-2302
CURRENT OCCUPANT	1651 N FARWELL AVE, 103	MILWAUKEE, WI 53202-2302
CURRENT OCCUPANT	1651 N FARWELL AVE, 104	MILWAUKEE, WI 53202-2302
CURRENT OCCUPANT	1651 N FARWELL AVE, 105	MILWAUKEE, WI 53202-2302
CURRENT OCCUPANT	1651 N FARWELL AVE, 106	MILWAUKEE, WI 53202-2302
CURRENT OCCUPANT	1651 N FARWELL AVE, 107	MILWAUKEE, WI 53202-2302
CURRENT OCCUPANT	1651 N FARWELL AVE, 108	MILWAUKEE, WI 53202-2302
CURRENT OCCUPANT	1651 N FARWELL AVE, 109	MILWAUKEE, WI 53202-2304
CURRENT OCCUPANT	1651 N FARWELL AVE, 110	MILWAUKEE, WI 53202-2304
CURRENT OCCUPANT	1651 N FARWELL AVE, 201	MILWAUKEE, WI 53202-2304
CURRENT OCCUPANT	1651 N FARWELL AVE, 202	MILWAUKEE, WI 53202-2304
CURRENT OCCUPANT	1651 N FARWELL AVE, 203	MILWAUKEE, WI 53202-2304
CURRENT OCCUPANT	1651 N FARWELL AVE, 204	MILWAUKEE, WI 53202-2304
CURRENT OCCUPANT	1651 N FARWELL AVE, 205	MILWAUKEE, WI 53202-2304

CURRENT OCCUPANT	1651 N FARWELL AVE, 206	MILWAUKEE, WI 53202-2304
CURRENT OCCUPANT	1651 N FARWELL AVE, 207	MILWAUKEE, WI 53202-2301
CURRENT OCCUPANT	1651 N FARWELL AVE, 208	MILWAUKEE, WI 53202-2301
CURRENT OCCUPANT	1651 N FARWELL AVE, 209	MILWAUKEE, WI 53202-2301
CURRENT OCCUPANT	1651 N FARWELL AVE, 210	MILWAUKEE, WI 53202-2301
CURRENT OCCUPANT	1651 N FARWELL AVE, 301	MILWAUKEE, WI 53202-2301
CURRENT OCCUPANT	1651 N FARWELL AVE, 302	MILWAUKEE, WI 53202-2301
CURRENT OCCUPANT	1651 N FARWELL AVE, 303	MILWAUKEE, WI 53202-2303
CURRENT OCCUPANT	1651 N FARWELL AVE, 304	MILWAUKEE, WI 53202-2303
CURRENT OCCUPANT	1651 N FARWELL AVE, 305	MILWAUKEE, WI 53202-2303
CURRENT OCCUPANT	1651 N FARWELL AVE, 306	MILWAUKEE, WI 53202-2303
CURRENT OCCUPANT	1651 N FARWELL AVE, 307	MILWAUKEE, WI 53202-2303
CURRENT OCCUPANT	1651 N FARWELL AVE, 308	MILWAUKEE, WI 53202-2303
CURRENT OCCUPANT	1651 N FARWELL AVE, 309	MILWAUKEE, WI 53202-2303
CURRENT OCCUPANT	1651 N FARWELL AVE, 310	MILWAUKEE, WI 53202-2303
CURRENT OCCUPANT	1651 N WARREN AVE	MILWAUKEE, WI 53202-2215
CURRENT OCCUPANT	1652 N WARREN AVE	MILWAUKEE, WI 53202-2216
CURRENT OCCUPANT	1653 N WARREN AVE	MILWAUKEE, WI 53202-2215
CURRENT OCCUPANT	1654 N WARREN AVE	MILWAUKEE, WI 53202-2216
CURRENT OCCUPANT	1655 N WARREN AVE	MILWAUKEE, WI 53202-2215
CURRENT OCCUPANT	1656 N WARREN AVE, 1	MILWAUKEE, WI 53202-2257
CURRENT OCCUPANT	1656 N WARREN AVE, 2	MILWAUKEE, WI 53202-2257
CURRENT OCCUPANT	1656 N WARREN AVE, 3	MILWAUKEE, WI 53202-2257
CURRENT OCCUPANT	1656 N WARREN AVE, 4	MILWAUKEE, WI 53202-2257
CURRENT OCCUPANT	1659 N WARREN AVE	MILWAUKEE, WI 53202-2215
CURRENT OCCUPANT	1659A N WARREN AVE	MILWAUKEE, WI 53202-2215
CURRENT OCCUPANT	1660 N ARLINGTON PL, B	MILWAUKEE, WI 53202-2218
CURRENT OCCUPANT	1660 N ARLINGTON PL, LOWER	MILWAUKEE, WI 53202-2218
CURRENT OCCUPANT	1660 N ARLINGTON PL, REAR	MILWAUKEE, WI 53202-2218
CURRENT OCCUPANT	1660 N ARLINGTON PL, SIDE	MILWAUKEE, WI 53202-2218
CURRENT OCCUPANT	1660 N ARLINGTON PL, UPPER	MILWAUKEE, WI 53202-2218
CURRENT OCCUPANT	1660 N WARREN AVE	MILWAUKEE, WI 53202-2216
CURRENT OCCUPANT	1660 N WARREN AVE, A	MILWAUKEE, WI 53202-2216
CURRENT OCCUPANT	1664 N ARLINGTON PL	MILWAUKEE, WI 53202-2218
CURRENT OCCUPANT	1664 N WARREN AVE	MILWAUKEE, WI 53202-2216
CURRENT OCCUPANT	1668A N WARREN AVE	MILWAUKEE, WI 53202-2216
CURRENT OCCUPANT	1703A N ARLINGTON PL	MILWAUKEE, WI 53202-1618
CURRENT OCCUPANT	1703B N ARLINGTON PL	MILWAUKEE, WI 53202-1618
CURRENT OCCUPANT	1706 N ARLINGTON PL, A	MILWAUKEE, WI 53202-1619
CURRENT OCCUPANT	1706 N ARLINGTON PL, B	MILWAUKEE, WI 53202-1619
CURRENT OCCUPANT	1708 N ARLINGTON PL, A	MILWAUKEE, WI 53202-1619
CURRENT OCCUPANT	1708 N ARLINGTON PL, B	MILWAUKEE, WI 53202-1619
CURRENT OCCUPANT	1719 N ARLINGTON PL	MILWAUKEE, WI 53202-1618
CURRENT OCCUPANT	1721 N ARLINGTON PL	MILWAUKEE, WI 53202-1618
CURRENT OCCUPANT	1723 N ARLINGTON PL	MILWAUKEE, WI 53202-1618
CURRENT OCCUPANT	1723 N WARREN AVE	MILWAUKEE, WI 53202-1616
CURRENT OCCUPANT	1724 N WARREN AVE	MILWAUKEE, WI 53202-1617

CURRENT OCCUPANT	1733 N CAMBRIDGE AVE, 307	MILWAUKEE, WI 53202-1814
CURRENT OCCUPANT	1733 N CAMBRIDGE AVE, 308	MILWAUKEE, WI 53202-1814
CURRENT OCCUPANT	1733 N CAMBRIDGE AVE, 309	MILWAUKEE, WI 53202-1814
CURRENT OCCUPANT	1733 N CAMBRIDGE AVE, 310	MILWAUKEE, WI 53202-1814
CURRENT OCCUPANT	1733 N CAMBRIDGE AVE, 311	MILWAUKEE, WI 53202-1814
CURRENT OCCUPANT	1733 N CAMBRIDGE AVE, 312	MILWAUKEE, WI 53202-1814
CURRENT OCCUPANT	1734 N ARLINGTON PL	MILWAUKEE, WI 53202-1619
CURRENT OCCUPANT	1734 N WARREN AVE	MILWAUKEE, WI 53202-1617
CURRENT OCCUPANT	1734A N WARREN AVE	MILWAUKEE, WI 53202-1617
CURRENT OCCUPANT	1734B N WARREN AVE	MILWAUKEE, WI 53202-1617
CURRENT OCCUPANT	1735 N WARREN AVE	MILWAUKEE, WI 53202-1616
CURRENT OCCUPANT	1736 N ARLINGTON PL	MILWAUKEE, WI 53202-1619
CURRENT OCCUPANT	1736A N ARLINGTON PL	MILWAUKEE, WI 53202-1619
CURRENT OCCUPANT	1739 N WARREN AVE	MILWAUKEE, WI 53202-1616
CURRENT OCCUPANT	1740 N ARLINGTON PL	MILWAUKEE, WI 53202-1619
CURRENT OCCUPANT	1740 N ARLINGTON PL, A	MILWAUKEE, WI 53202-1619
CURRENT OCCUPANT	1740 N WARREN AVE	MILWAUKEE, WI 53202-1617
CURRENT OCCUPANT	1741 N WARREN AVE	MILWAUKEE, WI 53202-1616
CURRENT OCCUPANT	1742 N WARREN AVE	MILWAUKEE, WI 53202-1617
CURRENT OCCUPANT	1742 N WARREN AVE, A	MILWAUKEE, WI 53202-1617
CURRENT OCCUPANT	1744A N ARLINGTON PL	MILWAUKEE, WI 53202-1619
CURRENT OCCUPANT	1744B N ARLINGTON PL	MILWAUKEE, WI 53202-1619
CURRENT OCCUPANT	1745 N WARREN AVE	MILWAUKEE, WI 53202-1616
CURRENT OCCUPANT	1747 N WARREN AVE	MILWAUKEE, WI 53202-1616
CURRENT OCCUPANT	1747A N WARREN AVE	MILWAUKEE, WI 53202-1616

Blank Notice

Total Records: 165

Radius 250.0 feet and Center of Circle: 1344 E Brady St

#276



BUSINESS LICENSE PLAN OF OPERATION

ccf-busplan 5/12/2020

Office of the City Clerk License Division
200 E. Wells St. Room 105, Milwaukee, WI 53202
(414) 286-2238 www.milwaukee.gov/license e-mail address: license@milwaukee.gov

1. Type of Business

Applying for: Extended Hours (12AM to 5AM) - If a food establishment, check all that apply: Delivery Drive Thru Dining Room
 Self Service Laundry Massage Establishment Filling Station
 Other (supplemental application for specific license also required)

Provide a detailed description of the type of business you plan on operating: Fast Food Sandwiches - Jimmy John's

Do you have any experience operating this type of business? No Yes If yes, explain: Currently own 24 Jimmy John's locations

2. Business Operations

- a. Proposed Opening Date: 06-15-2022
- b. Is this premise under construction? No Yes If yes, list estimated completion date: _____
- c. Is this a franchise? No Yes
- d. Is this premises currently licensed? No Yes If yes, list type of license: Business License & Food Dealer License
- e. Is the current licensee operating? No Yes If no, list date closed: _____
- f. Do you have future plans for other businesses, licenses or permits at this location? No Yes
If yes, explain: _____
- g. Have you previously held an Extended Hours License in Milwaukee? No Yes
If yes, list address(es): _____
- h. Are other businesses operating in the same building? No Yes If yes, describe: _____

3. Litter & Noise

- a. How are grounds kept clean? Sweep Pressure Wash Pick Up Litter Other: _____
- b. How often will grounds be cleaned? Daily Weekly As Needed Monthly Other: _____
- c. Grounds cleaned by: Licensee Building Owner Employees Hired Maintenance Other: _____
- d. How are noise issues prevented and/or addressed? Security Manager approaches customer(s) Call Police
 Signs Posted Other: _____
- e. Will a sound amplification system be used? No Yes If yes, describe: _____

4. Smoking & Sanitation

- a. Are there designated outdoor smoking areas? No Yes If yes, describe: _____
- b. Number of Garbage Cans: Inside: 7 Locations: Front House, Kitchen, Back of House
Outside: 3 Locations: Back Dumpster, Front Garbage
- c. Is a crowd control barrier used? No Yes If yes, describe: _____
- d. How many restrooms are on the premises? 2
- e. Name of solid waste contractor: Advanced Disposal Waste Management Other: Eagle Disposal or GFL

5. Security

- a. Are there onsite parking spaces? No Yes If yes, how many? _____ and describe the parking security plan: _____
- b. Is there a loading zone? No Yes If yes, describe the loading area security plan: _____
- c. Will you have security personnel on premise? No Yes If yes, how many? _____ and answer the following:
 What are their responsibilities? _____
 Is security equipment used? No Yes If yes, describe _____
 List their licensing, certification, or training credentials _____
- d. Will there be security cameras? No Yes If yes, how many? _____ and list locations: _____
- e. Will searches/identification checks be done upon entry? No Yes If yes, describe _____

6. Percentage of Sales (must total 100%)

Alcohol _____%	Food <u>100</u> %	Secondhand Merchandise _____%	Precious Metals & Gems _____%
Entertainment _____%	Cigarettes _____%		
Pawnbroker Activity _____%	Salvaged Materials _____% (such as scrap metal)	Personal Services (such as tattoo, body piercing, salon, tailor, tanning, etc.) _____%	Other _____% Describe: _____

7. Businesses/Licenses on the Premises (check all that apply):

- Type 1**
- Full Service Restaurant Cafe/Coffee Shop Deli or Fast Food Restaurant Private/Fraternal/Veterans Club
- Night Club Tavern Cocktail Lounge Teen Club
- Banquet Hall Sports Facility Bowling Alley
- Hotel/Motel : Number of Floors: _____ Rooming House: Number of Floors: _____
 Number of Rooms: _____ Number of Rooms: _____

- Type 2**
- Liquor Store Corner Store Supermarket Convenience Store
- Gas Station Amusement/Phonograph Distributor Recycling, Salvage or Towing
- Used Car Dealer Personal Service Establishment
(such as tattoo business, hair salon, tailor, etc.) Recording Studio

What other licenses/permits will you hold at this location? (check all that apply)

Occupancy Permit Cigarette & Tobacco Gas Station Extended Hours Class "B" Tavern Weights & Measures

Secondhand Dealer Precious Metal & Gem Other: _____

8. Legal Capacity (only if a Type 1 premises in #7 above)

Capacity 49 (Call the Milwaukee Development Center at 414-286-8211 if you have questions.)

9. Premises Description

- a. Identify all area(s) of the premises that will be used in operating this business (include areas used only for storage):
 1st Floor 2nd Floor Basement Storage Patio Beer Garden Sidewalk Café Deck Rooftop
 Other: Describe: _____
- b. Describe Location: Major Thoroughfare Secondary Street Other: _____
- c. Nearest Major Cross Street: _____
- d. Describe Building: Free Standing Building Strip Mall Other: _____
- e. Describe Premises Structure: Single Story Multi-Story - # of Stories _____ Other: _____
- f. Describe Surrounding Area: Commercial Residential Industrial Other: _____
- g. Building Owner Name: Sandra A Orcholski Phone Number: _____
 Building Owner Address: 1809 E Cumberland Blvd, Milwaukee, WI 53211

10. Hours of Operation & Customers

Will customers be entering the premises? No Yes

Day of the Week	Proposed Hours of Operation:		Estimated Number of Customers expected each day	Potential Age Range of Customers	Class B Tavern Applicant Only: Age Restriction (if none, write 'None')
	Open Time (include a.m. or p.m.)	Close Time (include a.m. or p.m.)			
Sunday	11:00 am	12:00 am	100	1-100	
Monday	11:00 am	12:00 am	100	1-100	
Tuesday	11:00 am	12:00 am	100	1-100	
Wednesday	11:00 am	10:00 pm	100	1-100	
Thursday	11:00 am	10:00 pm	100	1-100	
Friday	11:00 am	12:00 am	100	1-100	
Saturday	11:00 am	12:00 am	100	1-100	

An Extended Hours Establishment License is required for any convenience store, filling station, personal service establishment (such as tattoo, body piercing, salon, tailor, tanning, etc.), recording studio or restaurant which is open between the hours of 12:00 a.m. and 5:00 a.m.

Alcohol Establishments Class A: 8:00 am to 9:00 pm Sunday thru Saturday
 Permitted Hours of Operation: Class B: 6:00 am to 2:00 am Sunday thru Thursday, 6:00 am to 2:30 am Friday & Saturday

Entertainment Outdoor Closing Hours: 10:00pm Sunday-Thursday; 12:00am Friday & Saturday; unless a different time, either earlier or later, is established by the Common Council in its approval of the licensee's plan of operation.

11. Signature(s)

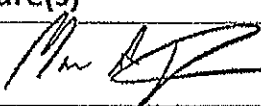
 Signature of Sole Proprietor, Partner, or 20% or more Shareholder
 (If there are no 20% or more shareholders,
 Corporate Officer-print name/title and sign)

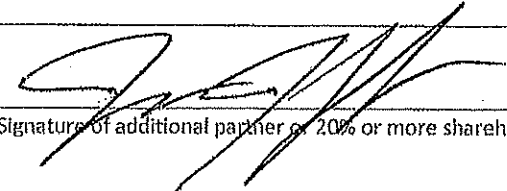
 Signature of additional partner or 20% or more shareholder

See Application Information for a complete list of all required application forms.

#276



FOOD DEALER LICENSE PLAN OF OPERATION

ccl-foodplan 2/28/19

OFFICE OF THE CITY CLERK, LICENSE DIVISION
CITY HALL, 200 E. WELLS ST., ROOM 105, MILWAUKEE, WI 53202
(414) 286-2238 • license@milwaukee.gov • www.milwaukee.gov/license

Legal Entity Name: **Premium Loaves Inc, II**

Premises Address: **1344 E Brady St., Milwaukee, WI 53202**

SECTION 1 TYPE OF BUSINESS

What will be the majority of your food sales? (check one)

Restaurant Items (meals):

MEALS include, but are not limited to, chicken, ribs, sandwiches, roasted corn, baked potatoes, hot dogs, brats, tacos, nachos w/ cheese and meat, French fries, cooked or deep fried vegetables/fruit, cooked cheese curds, corn dogs, egg rolls, salads.

Retail Items (snacks and beverages):

RETAIL items include, but are not limited to, ice cream/soft serve, lemonade, snow cones, coffee, espresso, cappuccino, tea, fruit juice, smoothies, candy, dispensed soda, fruit cups, bakery, cookies, kettle corn, cotton candy, funnel cakes, fritters, tortilla chips w/ cheese.

Will it be a convenience store? Yes No

A convenience store contains less than 5,000 square feet of retail space and has, as its primary business, the sale of basic food items and in addition, sells household products or is a filling station that sells basic food items and household products.

Bed & Breakfast

Micro Market

All Applicants: Submit a menu or a list of food items that will be sold.

Will any wholesale business be done? No Yes If yes, what percentage of food sales will be wholesale?

Less than 25%

25% or More AND:

Restaurant Items (meals) will be sold -- Complete this application and also contact DATCP.

NO restaurant items (meals) will be sold - Do NOT complete this application. Contact DATCP only.

SECTION 2 FOOD PROCESSING

Will any food processing be done? No Yes

Processing is defined as assembling, grinding, cutting, mixing, baking, coating, stuffing, packing, bottling, grilling, canning, extracting, fermenting, distilling, pickling, freezing, drying, smoking; or packaging.

SECTION 3 FOOD REQUIRING TEMPERATURE CONTROL

Will any food that requires temperature control be sold? No Yes
(includes dairy products such as milk, cheese, and ice cream, fish, shellfish, meat, poultry)

If yes, list the types of food items: **sandwiches, deli meat, cheese, fruit/vegetables, dough**

SECTION 4 DETAILS OF OPERATION

Will you have seating on site for dining? No Yes

Will you be doing any catering? No Yes

Will you be doing any delivery? No Yes

Will you have outdoor activities? No Yes - Check all that apply: Bar Cooking/Grilling Dining

Will you have a drive thru window? No Yes - Are hours different from inside? No Yes
 If Yes, provide drive thru hours: _____

Will scales or barcode scanners be used? No Yes - You must also apply for a Weights & Measures License.

SECTION 5 ADDITIONAL SITES

Where will food be prepared and/or sold?

At a single site At multiple sites: How many? _____ (for example, a hotel with several dining rooms or bars)

If multiple sites, attach a Food Dealer Additional Site Addendum (ccl-foodadd) for each additional site.

SECTION 6 CONSTRUCTION OR CHANGES

Are you planning any construction, remodeling or equipment changes?

No If No, SKIP to Section 8

Yes If Yes, check all that apply: New construction of a building Renovation or remodeling
 Construction changes to existing building Equipment changes only

Provide a brief description of the changes: _____

Start date: _____

Name, Address & Phone Number of Architect: _____

Name, Address & Phone Number of Contractor: _____

SECTION 7 ALCOHOL BEVERAGES

Are you applying for an alcohol beverage license?

No If No, SKIP to Section 8

Yes If YES, if your food license is approved prior to the alcohol license, when do you want the food license issued?
 Immediately At the same time as the alcohol license

SECTION 8 ACKNOWLEDGEMENTS & SIGNATURE

You must initial each item confirming your understanding:

ML I understand the Health Department must conduct an inspection and advise the License Division of their approval before the license may be issued.

ML I understand I must obtain an occupancy permit from the Department of Neighborhood Services and an inspection may be required. Neighborhood Services must advise the License Division of their approval before the license may be issued.

ML I understand the district alderperson will review and either support or object to my application. If he/she objects, I may appeal and be scheduled to appear before the Licenses Committee. The Licenses Committee will then make a recommendation to the Common Council. The Common Council must grant the license before it may be issued.

ML I understand proof of payment for all license fees must be on file in the License Division before the license may be issued and the license must be issued and posted in my establishment prior to opening for business.

ML I will not operate my food business until the license has been issued and posted in the establishment.

Signature of Sole Proprietor, Partner, or 20% Shareholder: _____

Signature of Additional Partner: _____

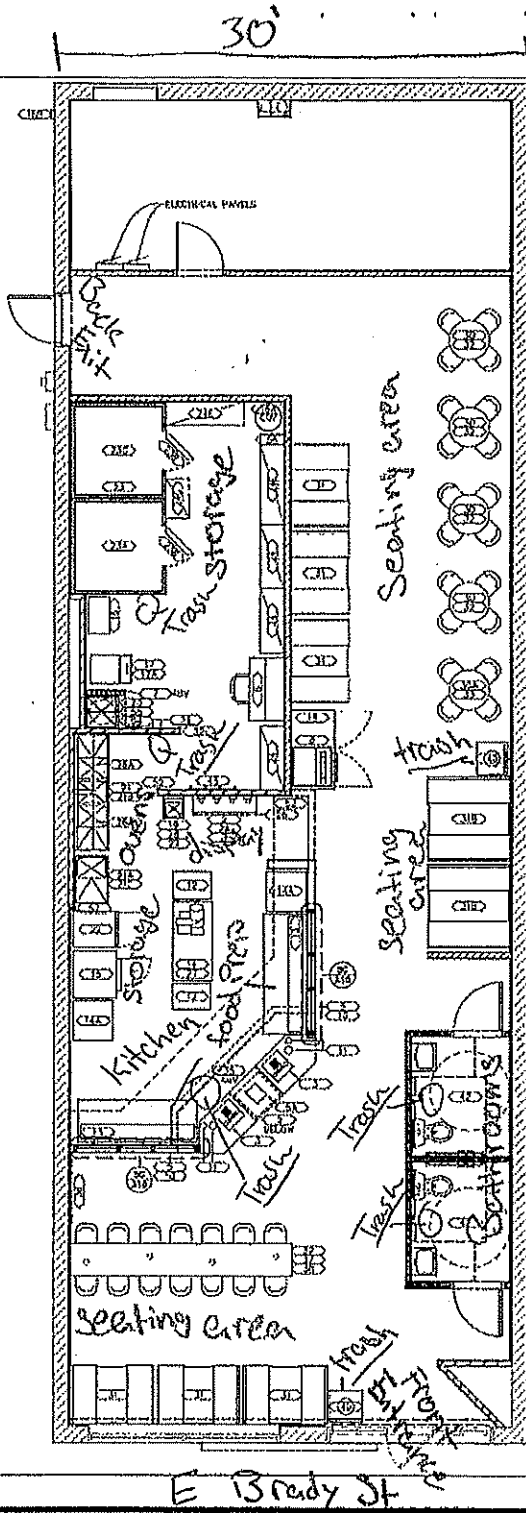

GENERAL NOTES

1. PORTABLE FIRE EXTINGUISHERS SHALL BEAR THE LABEL OF AN APPROVED AGENCY, BE AN APPROVED TYPE, AND BE INSTALLED AT A LOCATION, HEIGHT AND ACCESSIBLE TO THE OCCUPANTS. FINAL LOCATION BY FIRE PREVENTION BUREAU FOR FC 9011.
2. PORTABLE FIRE EXTINGUISHERS HAVING A GROSS WEIGHT NOT EXCEEDING 40 LBS. SHALL BE POSITIONED SO THAT ITS TOP IS NOT MORE THAN 60" ABOVE THE FLOOR. PORTABLE FIRE EXTINGUISHERS HAVING A GROSS WEIGHT EXCEEDING 40 LBS. SHALL BE INSTALLED SO THAT THE TOP IS NOT MORE THAN 42" ABOVE THE FLOOR. THE CLEARANCE BETWEEN THE FLOOR AND THE BOTTOM OF INSTALLED HAND-HELD EXTINGUISHERS SHALL NOT BE LESS THAN 2".
3. PROVIDE ONE (2) TYPE 2A 10BC FIRE EXTINGUISHER WITH MAX TRAVEL DISTANCES OF 75'-0" (150'-0" OCC) MOUNTED BETWEEN 5' AND 6'0" AND NOT PROXIMATE MORE THAN 4" INTO A CIRCULATION PATH WHEN LEADING EDGE BETWEEN 37" AND 63" AFF HARDWARE TO FEO SHALL BE AT ACCESSIBLE HEIGHTS/LOCATIONS.
4. THE WOODLAM MILLWORK COMPONENTS ARE COORDINATED OFF SITE BY AN APPROVED SHOP AND ARE INSTALLED BY THE GC. LOCATE WOODLAM COMPONENTS AS INDICATED.
5. TOILETS, URINALS, HAND SINKS, 3-COMPARTMENT & POPE SINKS, HOT BATH AND PERMITS COMPONENTS AND CHANGES MUST BE SIGNED TO FLOOR/WALLS WITH A SIGNATURE EACH DAY.
6. PROVIDE VAPOR BARRIER EQUIPMENT LIGHTING IN COOLING & FREEDY MANTAIN AIR SPACE PER VHS'S RECOMMENDATION.
7. IF HAND SINKS HAVE TRIMS-LOCATED FAUCETS, THEY WILL RUI FOR A MINIMUM OF 15 SECONDS.
8. INSTALL 35 CORNER GLAZES ON ALL OUTSIDE CORNERS IN KITCHEN.
9. COUPON ALL 600 BARS ARE INSTALLED WITH WALLS & FLOOR CEILING, NO FAPPED 600 LINES ALLOWED.

NOTE:
CONTRACTOR TO CONFIRM TYPE OF WALK-IN COMPRESSOR CONFIGURATION WITH EQUIPMENT SUPPLIER AND FRANCHISEE OPTIONS ARE REMOTE AND DIRECT MOUNTED. REF MEP3 FOR ALTERNATE COMPRESSOR INSTALLATION REQUIREMENTS.

P. J. JOHNS
 1344 EAST BRADY STREET
 MILWAUKEE, WISCONSIN 53202
 PHONE: 414.224.1111
 FAX: 414.224.1112
 WWW.PJJOHNS.COM

SEAL

DATE: 09-24-12
 DATE PLOTTED: 9-20-11
 FILE NO: 2-5011

JIMMY JOHNS
 #0276
 1344 EAST BRADY STREET
 MILWAUKEE, WISCONSIN 53202

SHEET TITLE:
 EQUIPMENT PLAN,
 SCHEDULE, AND NOTES

REVISIONS:

NO.	DATE	BY

PROJECT NO: 11197.002
 DRAWN BY: EP

40 EQUIPMENT PLAN
 14 SCALE 1/4" = 1'-0"

Total sq ft = 2,550'
 Premium Locves II DBA Jimmy Johns
 1344 E Brady St, Milwaukee, WI 53202
 Agent: Marc Largent

FREAKY FAST® FREAKY FRESH®



1 CHOOSE YOUR BREAD

FRENCH



9-GRAIN

Originals: 17 & 13 cal 128-210/290-330 cal
All others add 20-110/40-210 cal



THICK-SLICED WHEAT

Originals: 17 & 13 cal 80 cal
All others less 20 cal

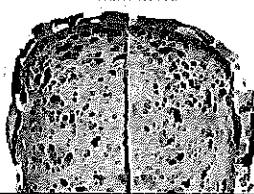

UNWICH®

Originals: 17 & 13 cal 280 cal
All others less 210 cal



MAKE IT A 16-INCH

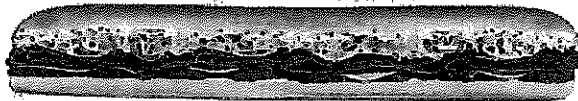

2 CHOOSE A SANDWICH

Calories are shown for 8" / 16" on french bread

FAVORITES

8-INCH 16-INCH

- #7 SPICY EAST COAST ITALIAN** 1020/2050 cal
DOUBLE GENOA SALAMI, DOUBLE CAPICOLA & DOUBLE CHEESE hot peppers, saucis, onion, lettuce, tomato & easy mayo (DUTTED) Dress. Good as it gets!
- #8 BILLY CLUB®** 850/1710 cal
ROAST BEEF, HAM & PROVOLONE Dijon, lettuce, tomato & mayo
- #9 ITALIAN NIGHT CLUB®** 970/1940 cal
SALAMI, CAPICOLA, HAM & PROVOLONE onion, lettuce, tomato, mayo, oil & vinegar, & oregano-basil
- #10 HUNTER'S CLUB®** 870/1730 cal
DOUBLE ROAST BEEF & PROVOLONE lettuce, tomato & mayo
- #11 COUNTRY CLUB®** 820/1650 cal
TURKEY, HAM & PROVOLONE lettuce, tomato & mayo
- #12 BEACH CLUB®** 900/1790 cal
TURKEY, PROVOLONE & AVOCADO cucumber, lettuce, tomato & mayo
- #13 JIMMY CUBANO®** 770/1540 cal
BACON, SMOKED HAM & CHEESE sliced pickle, mayo & Dijon (Jimmy's version of the famous Cuban)
- #14 BOOTLEGGER CLUB®** 720/1450 cal
ROAST BEEF & TURKEY lettuce, tomato & mayo
- #15 CLUB TUNA®** 890/1780 cal
TUNA SALAD, PROVOLONE cucumber, lettuce & tomato
- #16 CLUB LULU®** 730/1450 cal
TURKEY & BACON lettuce, tomato & mayo
- #17 ULTIMATE PORKER®** 730/1470 cal
HAM & BACON lettuce, tomato & mayo

PLAIN SLIMS®

PERFECT FOR KIDS! NO FREEBIES.

- #1 HAM & CHEESE** 580/1160 cal
- #2 ROAST BEEF** 480/960 cal
- #3 TUNA SALAD** 640/1280 cal
- #4 TURKEY** 460/910 cal
- #5 ITALIAN** 870/1340 cal
- #6 CHEESE** 630/1260 cal

8-INCH 16-INCH

ORIGINALS

8-INCH 16-INCH

- #1 THE PEPE®** 650/1300 cal
HAM & PROVOLONE lettuce, tomato & mayo
- #2 BIG JOHN®** 550/1110 cal
ROAST BEEF lettuce, tomato & mayo
- #3 TOTALLY TUNA®** 550/1100 cal
TUNA SALAD rancher, lettuce & tomato
- #4 TURKEY TOM®** 530/1060 cal
TURKEY lettuce, tomato & mayo
- #5 VITO®** 630/1260 cal
SALAMI, CAPICOLA & PROVOLONE onion, lettuce, tomato, oil & vinegar, & oregano-basil
- #6 THE VEGGIE** 730/1450 cal
PROVOLONE & AVOCADO cucumber, lettuce, tomato & mayo
- J.J.B.L.T.®** 650/1290 cal
BACON lettuce, tomato & mayo

**BREAD
BAKED EVERY
4 HOURS**

**LOCALLY
PURCHASED
FRESH
VEGGIES**

**ALL-NATURAL
HAND-SLICED
MEATS**

**HIGH
QUALITY
INGREDIENTS**

GARGANTUAN

8-INCH 16-INCH

- THE J.J. GARGANTUAN®** 1120/2240 cal
SALAMI, CAPICOLA, TURKEY, ROAST BEEF, HAM & PROVOLONE onion, lettuce, tomato, mayo, oil & vinegar, & oregano-basil

3 ADD-ONS

16" add-ons are twice the price

- HAM 70/140 cal
- ROAST BEEF 80/160 cal
- ALL-NATURAL MEATS: TURKEY 60/120 cal
- SALAMI & CAPICOLA 160/320 cal
- TUNA SALAD 240/480 cal
- BACON 90/180 cal
- FAVES: SIDE OF KICKIN' RANCH® 160 cal ea.
- PROVOLONE CHEESE 120/240 cal
- AVOCADO GUAC 20/45 cal
- Added calories for 8" / 16"

4 FREEBIES

- JIMMY MUSTARD® 10/20 cal
- GREY POUPON® 5/10 cal
- SAUCES & HERBS: YELLOW MUSTARD 5 cal ea.
- MAYO 160/330 cal
- OIL & VINEGAR 40/80 cal
- DREGANO-BASIL 0/0 cal
- SLICED PICKLES 0/0 cal
- ONION 5/15 cal
- VEGGIES: JIMMY PEPPERS® 0/5 cal
- CUCUMBER 0/0 cal
- TOMATO 10/15 cal
- LETTUCE 5/15 cal
- Added calories for 8" / 16"

5 DRINKS & SIDES

- SODA POP: 22oz SOFT DRINK 0-320 cal
- 30oz SOFT DRINK 0-440 cal
- DASANI® BOTTLED WATER 0 cal
- JIMMY CHIPS: REGULAR 300 cal
- BBQ 290 cal
- JALAPEÑO 290 cal
- SALT & VINEGAR 290 cal
- THINNY CHIPS® 200 cal
- COOKIES: TRIPLE CHOCOLATE CHUNK 410 cal
- CRANES: OATMEAL RAISIN 370 cal
- JUMBO KOSHER BILL PICKLE 20 cal

WE DELIVER!

DELIVERY ORDERS WILL INCLUDE A DELIVERY CHARGE
Delivery charges are not distributed to employees as tips.

2,000 CALORIES A DAY IS USED FOR GENERAL NUTRITION ADVICE, BUT CALORIE NEEDS VARY. ADDITIONAL NUTRITION INFORMATION AVAILABLE UPON REQUEST.

1600 Market Street • Philadelphia, PA 19102 • 800-368-5898 • www.jimmyjohns.com • ©2022 Jimmy John's Franchisor, SPT, LLC. All Rights Reserved. We reserve the right to modify any items or pricing at any time.