

THIS DRAWING IS MADE SOLELY FOR THE INDIVIDUAL NAMED HEREIN AND IS THE PROPERTY OF DAVID J. FRANK LANDSCAPE CONTRACTING, INC. ANY UNAUTHORIZED USE OR DUPLICATION IS IN VIOLATION OF THE COPYRIGHT LAWS AND SUBJECT TO PROSECUTION.



Landscape Development for  
Leswing Residence  
2623 North Wahl Avenue  
Milwaukee, Wisconsin 53211

David J. Frank  
Design Group

N120 W21350 Freistadt Road  
P.O. Box 70  
Germanstown, WI 53022  
U.S.A.  
Tel: (262) 255-4888  
Fax: (262) 628-4729  
Email: mail@davidfrank.com  
www.davidfrank.com

Landscape  
Development by  
Emily Schoenrock, Assoc  
Landscape Architect

Sheet 1  
of 1

Date: 03.21.18  
Revision: 04.10.18

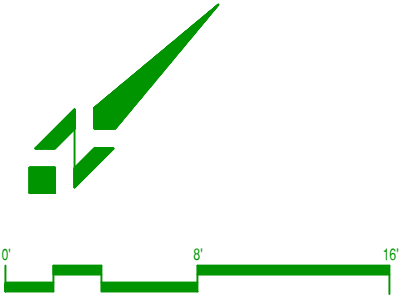
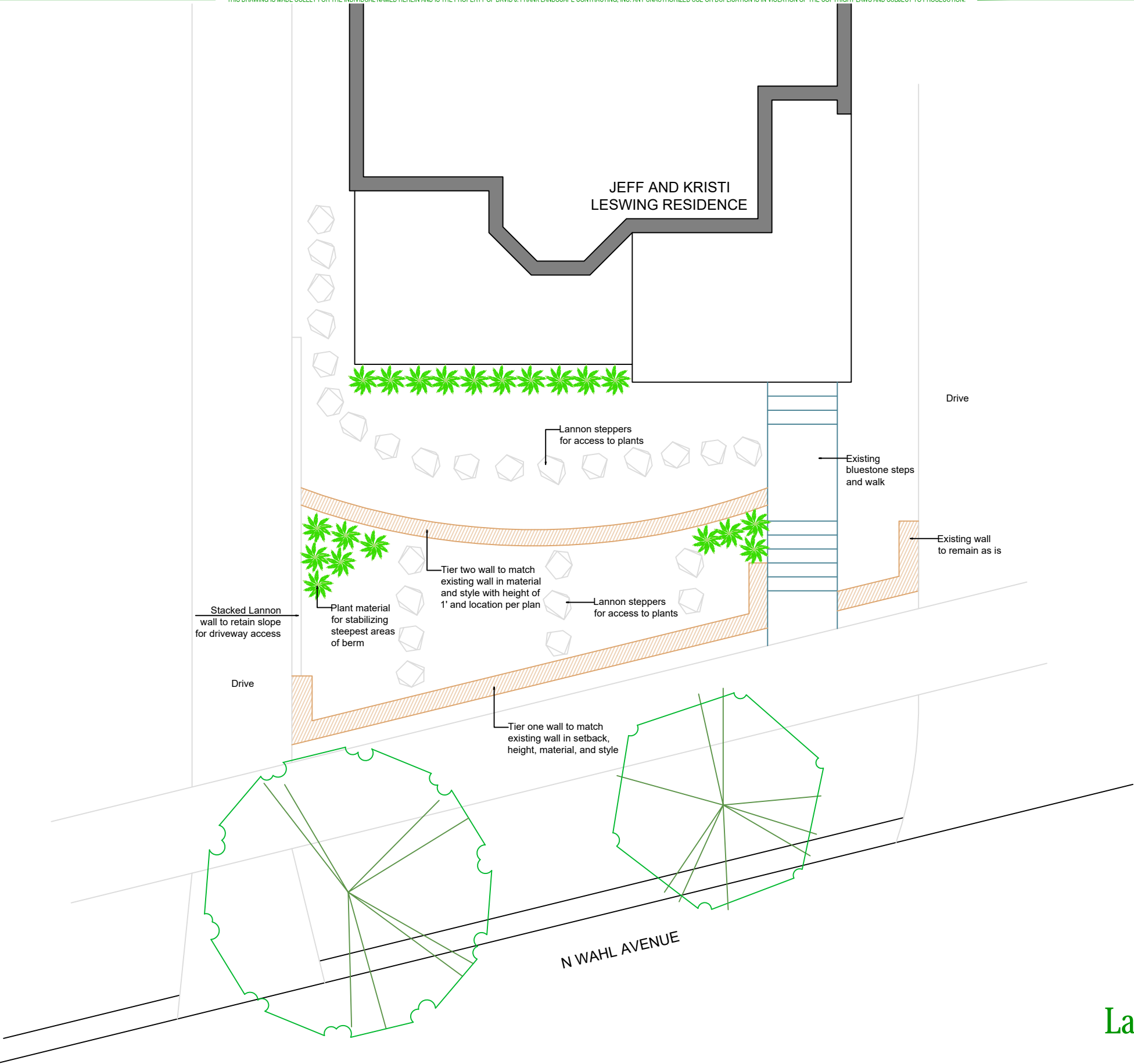

# Landscape Plan A

Scale: 1"=8'-0"

PLANTINGS, STRUCTURES AND OTHER REPRESENTATIONS SHOWN ON THIS PLAN ARE FOR THE PURPOSE OF CONVEYING LANDSCAPE DESIGN FEATURES. REFER TO PREPARED CONTRACT DOCUMENTS FOR SPECIFIC ITEMS INCLUDED IN ANY PARTICULAR PHASE OF LANDSCAPE CONSTRUCTION.