



CITY OF MILWAUKEE
OFFICE OF THE CITY CLERK

Wednesday, May 15, 2024

COMMITTEE MEETING NOTICE

AD 12

BLANKS, Nicole A, Agent
Motherwit LLC
2419 N BREMEN St
Milwaukee, WI 53212

You are requested to attend a hearing which is to be held in Room 301-B, Third Floor, City Hall or you may attend virtually using the link below.

Wednesday, May 29, 2024 at 09:10 AM

The access code is <https://meet.goto.com/790544861>. If you wish to call in: +1 (872) 240-3412 and use Access Code: 790-544-861
Please see the enclosed best practices document for further instructions.

Regarding: Your Class B Tavern and Public Entertainment Premises License Applications Requesting Instrumental Musicians, Jukebox, Bands, Karaoke, 2 Amusement Machines, Poetry Readings, Patron Contests, Comedy Acts, Patrons Dancing and 1 Pool Table as submitted for "Motherwit LLC" for "The People's Inn" at 1139 W MAPLE St.

There is a possibility that your application may be denied for one or more of the following reasons: The recommendation of the committee regarding the application shall be based on evidence presented at the hearing. Per MCO 85-2.7-4, probative evidence concerning whether or not a new license should be granted may be presented on the following subjects: whether or not the applicant meets the municipal requirements, the appropriateness of the location and premises where the licensed premises is to be located and whether use of the premises for the purposes or activities permitted by the license would tend to facilitate a public or private nuisance or create undesirable neighborhood problems such as disorderly patrons, unreasonably loud noise, litter, and excessive traffic and parking congestion. Probative evidence relating to these matters may be taken from the plan of operation submitted with the license application, if any, but shall not include the content of any music. Evidence regarding the fitness of the location of the premises to be maintained as the principal place of business, including but not limited to whether there is an overconcentration of businesses of the type for which the license is sought; whether the proposal is consistent with any pertinent neighborhood business or development plans, or the location's proximity to areas where children are typically present. The applicant's record in operating similarly licensed premises; and whether or not the applicant has been charged with or convicted of any felony, misdemeanor, municipal offense or other offense, the circumstances of which substantially relate to the activity to be permitted by the license being applied for or any other factor which reasonably relates to the public health, safety or welfare may also be considered. See attached police report or correspondence.

Notice for applicants with warrants or unpaid fines: Proof of warrant satisfaction or payment of fines must be submitted at the hearing on the above date and time. Failure to comply with this requirement may result in a delay of the granting/denial of your application.

Failure to appear at this meeting may result in the denial of your license. Individual applicants must appear only in person or by an attorney. Corporate or Limited Liability applicants must appear only by the agent designated on the application or by an attorney. Partnership applicants must appear by a partner listed on the application or by an attorney. If you wish to do so and at your own expense, you may be accompanied by an attorney of your choosing to represent you at this hearing. You will be given an opportunity to speak on behalf of the application and to respond and challenge any charges or reasons given for the denial. No petitions can be accepted by the committee, unless the people who signed the petition are present at the committee hearing and willing to testify. You may present witnesses under oath and you may also confront and cross-examine opposing witnesses under oath. If you have difficulty with the English language, you should bring an interpreter with you, at your expense, so that you can answer questions and participate in your hearing. You may examine the application file at this office during regular business hours prior to the hearing date. Inquiries regarding this matter may be directed to the person whose signature appears below.

Limited parking for persons attending meetings during normal business hours is available at reduced rates (5 hour limit) at the Milwaukee Center on the southwest corner of Kilbourn Avenue and Water Street. You must present a copy of the meeting notice to the parking cashier.

PLEASE NOTE: Upon reasonable notice, efforts will be made to accommodate the needs of disabled individuals through sign language interpreters or other auxiliary aids. For additional information or to request this service, contact the Council Services Division ADA Coordinator at (414) 286-2998, Fax - (414) 286-3456, TDD - (414) 286-2025.

JIM OWCZARSKI, CITY CLERK

BY: _____
Jim Cooney
License Division Manager

If you have questions regarding this notice, please contact the License Division at (414) 286-2238.

200 E. Wells Street, Room 105, City Hall, Milwaukee, WI 53202. www.milwaukee.gov/license
Phone: (414) 286-2238 Fax: (414) 286-3057 Email Address: License@milwaukee.gov

Date:04/17/24
Officer: Vodicka

City of Milwaukee Police Department
90-5-1.5 Crime Prevention Survey
Tavern Inspection

Name of Premise: People's Inn
Address: 1137 W Maple St
Phone: 414-552-8482

Owner: Nicole BLANKS / Motherwit LLC
Owner address: 2419 N Bremen St
City State Zip: Milwaukee, WI 53212
Owner Phone: 414-552-8482
Owner email: PastornikkiDPC@gmail.com

Licensee/Agent: Same
Home Address:
City State Zip:
Phone:
Email:

Preferred contact: Same

Location currently open: YES NO

Projected open date: 05/01/24

Day's open: S M T W Th F SA ALL

Hours of Operation: Sun: 12p-2am 24 hours Y N
Mon: 2p-2am
Tue: "
Wed: "
Thu: "
Fri: "
Sat: 12p-2a

Premise Type: Tavern/Bar
 Restaurant
 Other:

Licenses currently held:

- Alcohol: Yes No Class: #:
Tobacco: Yes No #:
Food: Yes No #:
Other: Yes No Type: Bartender #:
Other: Yes No Type: #:

Exterior Survey:

1. Is the area around the location clean? Yes No
2. What surrounds the location? (Check all the apply)
 - a. Park
 - b. School
 - c. Youth Center
 - d. Church
 - e. Tavern(s) If so, how many 1
 - f. Residential
 - g. Other businesses
 - h. Other:
3. Can you see from the outside of the location into the interior Yes No
4. Can you see the employees inside of the location from the outside Yes No
5. Are exterior windows free of signage Yes No
6. Street parking Yes No
7. Is there a parking lot Yes No
8. Is the parking lot clean? Yes No
9. Is the parking lot well lit? Yes No
10. Valet Parking Yes No
 - a. Will this lot have a guard? Yes No
 - b. Will this lot have cameras? Yes No
11. Are there areas where a person could conceal themselves Yes No
12. Is there exterior lighting? Yes No. Does it appears to be adequate Yes No
13. Exterior Payphone? Yes No
14. Are there No Loitering Signs posted? Yes No
15. Are there exterior security cameras Yes No How Many: 3
16. Are the address numbers prominently displayed and easy to see Yes No

Camera Survey:

17. Does this location have security cameras? Yes No
18. Are they in working order? Yes No
19. What format are the cameras?
 - a. Color Yes No
 - b. Digital Yes No
 - c. VCR Yes No
 - d. Recorded Yes No
20. How long is footage stored for later viewing: unknown
21. Are there exterior cameras Yes No How many: 3
22. Are there interior cameras Yes No How many: 5

23. Do all employees know how to retrieve recorded digital images/footage? Yes No
24. Cameras located in parking lot Yes No How many N/A

Interior Survey:

25. What is the planned/posted capacity 45
26. What is the minimum number of employees that will be on premise 2
27. Is the storeowner willing to be a standing complainant regarding loitering? Yes No
a. If yes have them fill out the standing complaint form and give them two of the commercial signs Yes No
28. Is the interior of the location neat and clean? Yes No
29. Does an interior camera face the entrance/exit? Yes No
30. Are emergency and non-emergency numbers posted near the phone? Yes No
31. Does the owner know how to contact their police district directly? Yes No
a. Did you provide a district contact guide to the owner? Yes No

Security

32. How many security personnel are going to be employed: 1 or 2
33. How will they be deployed: Interior 1 Exterior 1
34. What days will they be deployed Mon Tue Wed Thu Fri Sat Sun
35. Will the security be managed by business or contracted
36. Will they be armed Yes No
37. What type of security measures will be used:
 Wanding/metal detector
 ID Scanner
 Dress Code
 Cover Charge
 Age restriction
 Other
38. When at capacity, how will the overflow crowd be managed? licensee
39. Will a guard monitor the overflow crowd at all times? Yes No

ADDITIONAL COMMENTS/RECOMMENDATIONS:

Applicant may amend hours of operation to open weekends at 10am and close 2:30 am

Area of Interest (AOI) Information

Area : 21,862,585.6 ft²

Mar 28 2024 11:53:13 Central Daylight Time

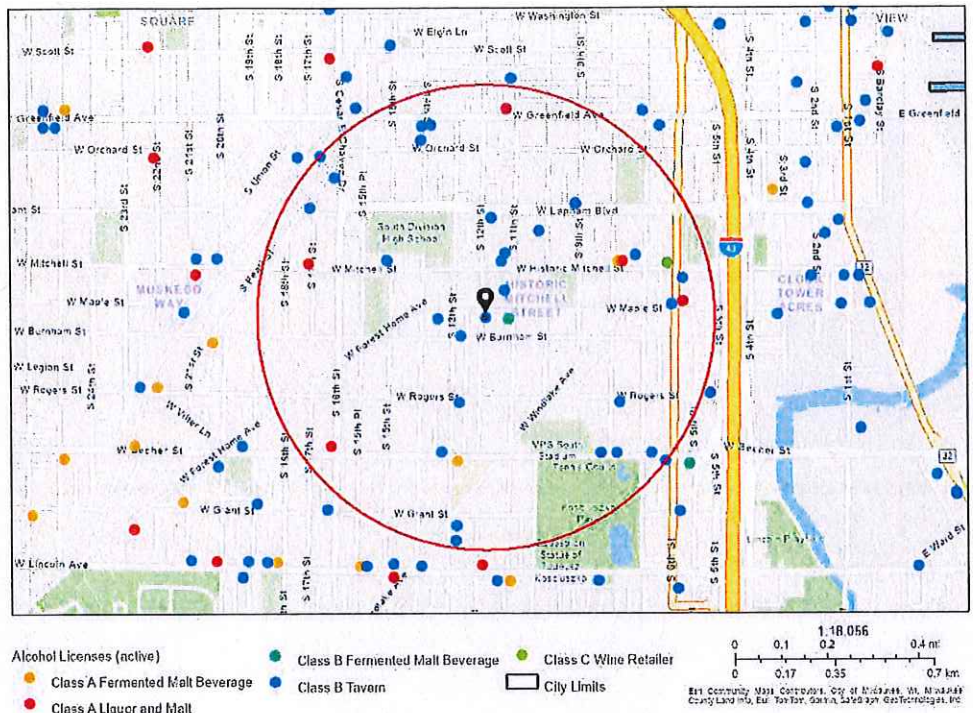

Summary

Name	Count	Area(ft ²)	Length(mi)
Alcohol Licenses	41		

Alcohol Licenses

#	Legal Entity	Trade Name	Licensee	Address	License Type Name	Total Capacity	Expiration Date	Count
1	BUCKAROO LTD	Bryant's Cocktail Lounge	JOHN M DYE, Agt	1579 S 9th ST	Class B Tavern License	99	4/7/2024, 7:00 PM	1
2	1110, CORP	Birreria El Torito	Michael J Widmann, Agt	1108 W GREENFIELD AV	Class B Tavern License	25	4/8/2024, 7:00 PM	1
3	El Sunami II, LLC	Sunami	Ociel Escobar Luvianos, Agt	2222 S 13TH ST	Class B Tavern License	80	4/25/2024, 7:00 PM	1
4	La Luna Liquor Taqueria LLC	La Luna Liquor Taqueria	HANIN K ABDELRAHIM, Agt	552R W MAPLE ST	Class B Tavern License		5/2/2024, 7:00 PM	1
5	Good Fortune Corp	Los Amigos	Bakul H Desai, Agt	2100 S 13TH ST	Class A Fermented Malt Beverage Retailer's License		6/19/2024, 7:00 PM	1
6	GOOD FORTUNE CORP	Mi Pueblo	Bakul H Desai, Agt	1700 W MITCHELL ST	Class A Malt & Class A Liquor License		6/19/2024, 7:00 PM	1
7	Salas' Bar LLC	Sala's Bar and Beer Garden	Agustin Salas Macias, Agt	2078 S 8th ST	Class B Tavern License		6/29/2024, 7:00 PM	1
8	Club 6 LLC	Club 6	BLAS CERDA, Agt	2101 S 6th ST	Class B Tavern License	80	6/30/2024, 7:00 PM	1
9	Restaurante El Local LLC	Restaurante El Local	JESUS SOTO CRUZ, Agt	1801 S 11th ST	Class B Fermented Malt Beverage Retailer's License		7/5/2024, 7:00 PM	1
10	El Barril	El Barril	JOSE L TERRONES, SP	1586 S PEARL ST	Class B Tavern License	59	7/5/2024, 7:00 PM	1
11	Colombia Tropical	Colombia Tropical	RODRIGO DIEZ, Agt	1629 S 10TH ST	Class B Tavern License	90	7/9/2024, 7:00 PM	1
12	Ivette Sanitation LLC	Punta Cana	Maritza Ivette Pica Fuentes, Agt	2000 S 13TH ST	Class B Tavern License		7/11/2024, 7:00 PM	1
13	Tacos Gemelos Restaurant LLC	Los Gemelos Tacos	Juan G Antunez Gomez, Agt	1116 W HISTORIC MITCHELL ST	Class B Tavern License	49	7/22/2024, 7:00 PM	1
14	LA CARRETA VIEJA RESTAURANT	LA CARRETA VIEJA RESTAURANT	ABEL SANTOS, SP	1339 W GREENFIELD AV	Class B Tavern License	223	7/26/2024, 7:00 PM	1
15	MITCHELL STREET ARTS COLLABORATIVE INCORPORATED	MITCHELL STREET ARTS COLLABORATIVE	Andrew Otto Gordon, Agt	710 W HISTORIC MITCHELL ST	Class B Tavern License		8/9/2024, 7:00 PM	1
16	TENTACIONES	TENTACIONES	MARTIN R SAAVEDRA, SP	600 W MAPLE ST	Class B Tavern License	75	8/28/2024, 7:00 PM	1

17	KOZ'S MINI BOWL, INC	KOZ'S MINI BOWL	JUSTIN J KOSAKOSKI, Agt	2078 S 7TH ST	Class B Tavern License	80	9/19/2024, 7:00 PM	1
18	SHORTY'S CATERING, INC	SHORTY'S CATERING & RESTAURANT	ELISA MALDONADO, Agt	2075-79 S 13TH ST	Class B Tavern License	156	9/20/2024, 7:00 PM	1
19	QUALITY DISCOUNT, LLC	QUALITY DISCOUNT	OMAR A ALI, Agt	738 W HISTORIC MITCHELL ST	Class A Fermented Malt Beverage Retailer's License		9/20/2024, 7:00 PM	1
20	1110 Corp	Greenfield Pantry	Michael J Widmann, Agt	1110 W Greenfield AV	Class A Malt & Class A Liquor License		9/24/2024, 7:00 PM	1
21	Acosta Restaurant LLC	El Tlaxcalteca Restaurant	Evaristo Acosta Pena, Agt	1300 W Burnham ST	Class B Tavern License		9/25/2024, 7:00 PM	1
22	La Escondida	La Escondida	Josephine Vargas, SP	1400 W ORCHARD ST	Class B Tavern License		10/13/2024, 7:00 PM	1
23	El Pelon Bar	El Pelon Bar	Joel Velasco Garcia, SP	1832 S 13TH ST	Class B Tavern License	25	10/20/2024, 7:00 PM	1
24	DON JULIO'S BAR AND CLUB LLC	DON JULIO'S BAR AND CLUB	Ruben Medina-Perdomo, Agt	1537 S CESAR E CHAVEZ DR	Class B Tavern License		10/28/2024, 7:00 PM	1
25	The Clem-Pank Group LLC	On My Way Home	DEBI DAMRON, Agt	2079 S 8TH ST	Class B Tavern License	71	11/17/2024, 6:00 PM	1
26	PEOPLES INN	PEOPLES INN	MARIA M RODRIGUEZ, SP	1139 W MAPLE ST	Class B Tavern License	45	11/22/2024, 6:00 PM	1
27	SAN JOSE, LLC	CLUB GUADALAJARA	GUILLERMO RODRIGUEZ, Agt	1135 W LAPHAM BL	Class B Tavern License	240	11/23/2024, 6:00 PM	1
28	Paul's Liquor LLC	Paul's Liquor	RAMINDERJI T KAUR, Agt	1600 W Becher ST	Class A Malt & Class A Liquor License		11/27/2024, 6:00 PM	1
29	MITCHELL BEVERAGE, LLC	SAM'S LIQUOR	RUPINDER KAUR, Agt	732 W HISTORIC MITCHELL ST	Class A Malt & Class A Liquor License		11/29/2024, 6:00 PM	1
30	TEQUILA NIGHT CLUB	TEQUILA NIGHT CLUB	GUSTAVO GUIZAR, JR, SP	1460 S MUSKEGO AV	Class B Tavern License	168	12/10/2024, 6:00 PM	1
31	Kanru, Inc	Mi Super Foods & Liquor	AnkurKumar B Patel, Agt	2200 S 13th ST	Class B Tavern License		1/15/2025, 6:00 PM	1
32	Greater Milwaukee Association of the Deaf Inc	Greater Milwaukee Association of the Deaf	John A Szupica, Agt	1725 S 11th ST	Class B Tavern License	129	1/16/2025, 6:00 PM	1
33	Taqueria El Toro LLC	Taqueria El Toro LLC	Toribio Perez Martinez, Agt	551 W Historic Mitchell ST	Class B Tavern License	94	2/4/2025, 6:00 PM	1
34	Shree Ram 1401 LLC	Max Liquor & Food	Ushaben H Patel, Agt	1401 W GREENFIELD AV	Class B Tavern License		2/5/2025, 6:00 PM	1
35	Carnitas Machetes	Carnitas Machetes	Alberto Morales, SP	2000 S 8th ST	Class B Tavern License		2/5/2025, 6:00 PM	1

36	AQUI ES TAQUERIA LLC	Margarita's Pizza	Rosa Cruz Alvarez, Agt	604-08 W HISTORIC MITCHELL ST	Class B Fermented Malt Beverage Retailer's License	73	2/25/2025, 6:00 PM	1
37	Escvzq Club 69 LLC	Club 69	Lourdes J Jeronimo, Agt	1663 S 11TH ST	Class B Tavern License		2/25/2025, 6:00 PM	1
38	AQUI ES TAQUERIA LLC	Margarita's Pizza	Rosa Cruz Alvarez, Agt	604-08 W HISTORIC MITCHELL ST	Class C Wine Retailer's License	73	2/25/2025, 6:00 PM	1
39	La Sirenita Bar, LLC	La Sirenita Bar	FRANCISCO MARTINEZ VILLEGAS, Agt	1500 W MITCHELL ST	Class B Tavern License	80	2/27/2025, 6:00 PM	1
40	LA LUNA LIQUOR, INC	LA LUNA LIQUOR	HANIN K ABDELRAHIM, Agt	552 W MAPLE ST	Class A Malt & Class A Liquor License		3/20/2025, 7:00 PM	1
41	BUCKAROO LTD	Bryant's Cocktail Lounge	JOHN M DYE, Agt	1579 S 9th ST	Class B Tavern License	99	4/7/2025, 7:00 PM	1

Establishments within a 0.5 miles radius centered on area of interest.



Wednesday, May 15, 2024



Notice of Public Hearing

Blank Notice

BLANKS, Nicole A, Agent

The People's Inn at 1139 W MAPLE St

Class B Tavern and Public Entertainment Premises License Applications Requesting Instrumental Musicians, Jukebox, Bands, Karaoke, 2 Amusement Machines, Poetry Readings, Patron Contests, Comedy Acts, Patrons Dancing and 1 Pool Table

Wednesday, May 29, 2024 at 9:10 AM

To whom it may concern:

The above application has been made by the above named applicant(s). This requires approval from the Licenses Committee and the Common Council of the City of Milwaukee. The hearing before the Licenses Committee will take place on 5/29/2024 at 9:10 AM in Room 301-B, Third Floor, City Hall. This is a public hearing. Those wishing to view the proceeding are able to do so via the City Channel – Channel 25 on Spectrum Cable – or on the Internet at <http://city.milwaukee.gov/citychannel>. Those wishing to provide oral testimony via internet are asked to contact the staff assistant, Yadira Melendez at (414) 286-2775 or stasst5@milwaukee.gov for necessary information. Please make such requests no later than one business day prior to the start of the meeting. You are not required to attend the hearing, but please see the information below if you would like to provide testimony. Once the Licenses Committee makes its recommendation, this recommendation is forwarded to the full Common Council for approval at its next regularly scheduled hearing.

Important details for those wishing to provide information for the Licenses Committee to consider when making its recommendation:

1. The license application is scheduled to be heard at the above time. Due to other hearings running longer than scheduled, you may have to wait some time to provide your testimony.
2. You must appear in person and testify as to matters that you have personally experienced or seen. (You cannot provide testimony for your neighbor, parent or anyone else; this is considered hearsay and cannot be considered by the committee.)
3. No letters or petitions can be accepted by the committee (unless the person who wrote the letter or the persons who signed the petition are present at the committee hearing and willing to testify).
4. Persons opposed to the license application are given the opportunity to testify first; supporters may testify after the opponents have finished.
5. When you are called to testify, you will be sworn in and asked to give your name, and address. (If your first and/or last names are uncommon please spell them.)
6. You may then provide testimony.
 - a. Include only information relating to the above license application.
 - b. Include only information you have personally witnessed or seen.
 - c. Provide concise and relevant information detailing how this business has affected or may affect the peaceful enjoyment of your neighborhood.
 - d. If by the time you have the opportunity to testify, the information you wish to share has already been provided to the committee, you may state that you agree with the previous testimony. Redundant or repetitive testimony will not assist the committee in making its recommendation.
7. After giving your testimony, the members of the Licenses Committee and the licensee may ask questions regarding the testimony you have given or other factors relating to the license application.
8. Business Competition is not a valid basis for denial or non-renewal of a license.

Please Note: If you have submitted an objection to the above application your objection cannot be considered by the committee unless you personally testify at the hearing.

OCCUPANT	MAIL ADDRESS	CITY STATE ZIP
CURRENT OCCUPANT	1106 W MAPLE ST	MILWAUKEE, WI 53204-3323
CURRENT OCCUPANT	1109 W MAPLE ST	MILWAUKEE, WI 53204-3324
CURRENT OCCUPANT	1110 W MAPLE ST	MILWAUKEE, WI 53204-3323
CURRENT OCCUPANT	1112 W BURNHAM ST	MILWAUKEE, WI 53204-3319
CURRENT OCCUPANT	1112 W MAPLE ST	MILWAUKEE, WI 53204-3323
CURRENT OCCUPANT	1114 W MAPLE ST	MILWAUKEE, WI 53204-3323
CURRENT OCCUPANT	1115 W MAPLE ST	MILWAUKEE, WI 53204-3324
CURRENT OCCUPANT	1117 W BURNHAM ST	MILWAUKEE, WI 53204-3320
CURRENT OCCUPANT	1117 W MAPLE ST	MILWAUKEE, WI 53204-3324
CURRENT OCCUPANT	1117A W MAPLE ST	MILWAUKEE, WI 53204-3324
CURRENT OCCUPANT	1117B W MAPLE ST	MILWAUKEE, WI 53204-3324
CURRENT OCCUPANT	1118 W MAPLE ST	MILWAUKEE, WI 53204-3323
CURRENT OCCUPANT	1123 W MAPLE ST	MILWAUKEE, WI 53204-3324
CURRENT OCCUPANT	1124 W BURNHAM ST	MILWAUKEE, WI 53204-3319
CURRENT OCCUPANT	1124 W MAPLE ST	MILWAUKEE, WI 53204-3323
CURRENT OCCUPANT	1126 W BURNHAM ST	MILWAUKEE, WI 53204-3319
CURRENT OCCUPANT	1127 W MAPLE ST	MILWAUKEE, WI 53204-3324
CURRENT OCCUPANT	1127A W MAPLE ST	MILWAUKEE, WI 53204-3324
CURRENT OCCUPANT	1128 W MAPLE ST	MILWAUKEE, WI 53204-3323
CURRENT OCCUPANT	1129 W BURNHAM ST	MILWAUKEE, WI 53204-3320
CURRENT OCCUPANT	1129 W BURNHAM ST# A	MILWAUKEE, WI 53204-3320
CURRENT OCCUPANT	1130 W MAPLE ST	MILWAUKEE, WI 53204-3323
CURRENT OCCUPANT	1132 W MAPLE ST	MILWAUKEE, WI 53204-3323
CURRENT OCCUPANT	1133 W MAPLE ST	MILWAUKEE, WI 53204-3324
CURRENT OCCUPANT	1133A W MAPLE ST	MILWAUKEE, WI 53204-3324
CURRENT OCCUPANT	1136 W MAPLE ST	MILWAUKEE, WI 53204-3323
CURRENT OCCUPANT	1227 W MAPLE ST	MILWAUKEE, WI 53204-3326
CURRENT OCCUPANT	1733A S 11TH ST	MILWAUKEE, WI 53204-3353
CURRENT OCCUPANT	1742 S 13TH ST	MILWAUKEE, WI 53204-3201
CURRENT OCCUPANT	1742 S 13TH ST# A	MILWAUKEE, WI 53204-3201
CURRENT OCCUPANT	1801 S 12TH ST	MILWAUKEE, WI 53204-3316
CURRENT OCCUPANT	1804 S 12TH ST	MILWAUKEE, WI 53204-3315
CURRENT OCCUPANT	1804A S 12TH ST	MILWAUKEE, WI 53204-3315
CURRENT OCCUPANT	1805 S 12TH ST	MILWAUKEE, WI 53204-3316
CURRENT OCCUPANT	1810 S 13TH ST	MILWAUKEE, WI 53204-3203
CURRENT OCCUPANT	1811 S 12TH ST	MILWAUKEE, WI 53204-3316
CURRENT OCCUPANT	1812 S 13TH ST	MILWAUKEE, WI 53204-3203
CURRENT OCCUPANT	1812A S 13TH ST	MILWAUKEE, WI 53204-3203
CURRENT OCCUPANT	1814 S 12TH ST	MILWAUKEE, WI 53204-3315
CURRENT OCCUPANT	1815 S 12TH ST	MILWAUKEE, WI 53204-3316
CURRENT OCCUPANT	1816 S 13TH ST	MILWAUKEE, WI 53204-3203
CURRENT OCCUPANT	1818 S 12TH ST	MILWAUKEE, WI 53204-3315
CURRENT OCCUPANT	1819 S 11TH ST	MILWAUKEE, WI 53204-3312
CURRENT OCCUPANT	1819 S 12TH ST	MILWAUKEE, WI 53204-3316
CURRENT OCCUPANT	1819A S 12TH ST	MILWAUKEE, WI 53204-3316
CURRENT OCCUPANT	1820 S 13TH ST	MILWAUKEE, WI 53204-3203

CURRENT OCCUPANT	1821 S 12TH ST	MILWAUKEE, WI 53204-3316
CURRENT OCCUPANT	1821A S 12TH ST	MILWAUKEE, WI 53204-3316
CURRENT OCCUPANT	1822 S 12TH ST	MILWAUKEE, WI 53204-3315
CURRENT OCCUPANT	1823 S 11TH ST	MILWAUKEE, WI 53204-3312
CURRENT OCCUPANT	1824 S 12TH ST	MILWAUKEE, WI 53204-3315
CURRENT OCCUPANT	1824 S 13TH ST	MILWAUKEE, WI 53204-3203
CURRENT OCCUPANT	1824A S 12TH ST	MILWAUKEE, WI 53204-3315
CURRENT OCCUPANT	1825 S 11TH ST	MILWAUKEE, WI 53204-3312
CURRENT OCCUPANT	1825 S 12TH ST	MILWAUKEE, WI 53204-3316
CURRENT OCCUPANT	1826 S 12TH ST	MILWAUKEE, WI 53204-3315
CURRENT OCCUPANT	1826 S 13TH ST	MILWAUKEE, WI 53204-3203
CURRENT OCCUPANT	1828 S 12TH ST	MILWAUKEE, WI 53204-3315
CURRENT OCCUPANT	1828 S 13TH ST	MILWAUKEE, WI 53204-3203
CURRENT OCCUPANT	1828A S 13TH ST	MILWAUKEE, WI 53204-3203
CURRENT OCCUPANT	1829 S 11TH ST	MILWAUKEE, WI 53204-3312
CURRENT OCCUPANT	1829 S 12TH ST	MILWAUKEE, WI 53204-3316
CURRENT OCCUPANT	1829A S 12TH ST	MILWAUKEE, WI 53204-3316
CURRENT OCCUPANT	1831 S 12TH ST	MILWAUKEE, WI 53204-3316
CURRENT OCCUPANT	1832 S 12TH ST	MILWAUKEE, WI 53204-3315
CURRENT OCCUPANT	1832A S 12TH ST	MILWAUKEE, WI 53204-3315
CURRENT OCCUPANT	1835 S 12TH ST	MILWAUKEE, WI 53204-3316
CURRENT OCCUPANT	1835A S 12TH ST	MILWAUKEE, WI 53204-3316
CURRENT OCCUPANT	1900A S 12TH ST	MILWAUKEE, WI 53204-3828
CURRENT OCCUPANT	1901 S 11TH ST	MILWAUKEE, WI 53204-3825
CURRENT OCCUPANT	1901A S 11TH ST	MILWAUKEE, WI 53204-3825
CURRENT OCCUPANT	1905 S 12TH ST	MILWAUKEE, WI 53204-3829
CURRENT OCCUPANT	1905A S 12TH ST	MILWAUKEE, WI 53204-3829

Blank Notice

Total Records: 73

Radius 250.0 feet and Center of the Circle: 1139 W Maple St



BUSINESS LICENSE PLAN OF OPERATION

ccl-busplan 5/12/2020

Office of the City Clerk License Division
200 E. Wells St. Room 105, Milwaukee, WI 53202
(414) 286-2238 www.milwaukee.gov/license e-mail address: license@milwaukee.gov

1. Type of Business

Applying for: Extended Hours (12AM to 5AM) - If a food establishment, check all that apply: Delivery Drive Thru Dining Room
 Self Service Laundry Massage Establishment Filling Station
 Other (supplemental application for specific license also required)

Provide a detailed description of the type of business you plan on operating:

Tavern

Do you have any experience operating this type of business? No Yes If yes, explain: Tending Bar

2. Business Operations

- a. Proposed Opening Date: ~~7/1/2022~~ ~~7/2/2022~~ 7/5/2024
- b. Is this premise under construction? No Yes If yes, list estimated completion date: _____
- c. Is this a franchise? No Yes
- d. Is this premises currently licensed? No Yes If yes, list type of license: Tavern "B"
- e. Is the current licensee operating? No Yes If no, list date closed: _____
- f. Do you have future plans for other businesses, licenses or permits at this location? No Yes
If yes, explain: Possible sidewalk dining
- g. Have you previously held an Extended Hours License in Milwaukee? No Yes
If yes, list address(es): _____
- h. Are other businesses operating in the same building? No Yes If yes, describe: _____

3. Litter & Noise

- a. How are grounds kept clean? Sweep Pressure Wash Pick Up Litter Other: _____
- b. How often will grounds be cleaned? Daily Weekly As Needed Monthly Other: _____
- c. Grounds cleaned by: Licensee Building Owner Employees Hired Maintenance Other: _____
- d. How are noise issues prevented and/or addressed? Security Manager approaches customer(s) Call Police
 Signs Posted Other: _____
- e. Will a sound amplification system be used? No Yes If yes, describe: Occasionally for things like karaoke

4. Smoking & Sanitation

- a. Are there designated outdoor smoking areas? No Yes If yes, describe: Receptacle
- b. Number of Garbage Cans: Inside: 8 Locations: 1 per bathroom, 1 by sink, 4 in basement, 2 in kitchen, 1 at en of bar
Outside: 1 Locations: Dumpster on 12th St. next to building
- c. Is a crowd control barrier used? No Yes If yes, describe: _____
- d. How many restrooms are on the premises? 2
- e. Name of solid waste contractor: Advanced Disposal Waste Management Other: Eagle Disposal Inc.

5. Security

a. Are there onsite parking spaces? No Yes If yes, how many? _____ and describe the parking security plan: _____

b. Is there a loading zone? No Yes If yes, describe the loading area security plan: _____

c. Will you have security personnel on premise? No Yes If yes, how many? 2 and answer the following:

What are their responsibilities? check IDs, check for weapons, know the trouble makers & keep them out

Is security equipment used? No Yes If yes, describe Alarms, cameras

List their licensing, certification, or training credentials Bar Manager 30+ yrs

d. Will there be security cameras? No Yes If yes, how many? 8 and list locations: 4 in main bar room, 1 in employee break room/kitchen, 3 outside. All cameras connect to MPD

e. Will searches/identification checks be done upon entry? No Yes If yes, describe Door man

6. Percentage of Sales (must total 100%)

Alcohol <u>94</u> %	Food (chips) <u>1</u> %	Secondhand Merchandise <u>0</u> %	Precious Metals & Gems <u>0</u> %
Entertainment <u>5</u> %	Cigarettes <u>0</u> %	Personal Services (such as tattoo, body piercing, salon, tailor, tanning, etc.) <u>0</u> %	Other <u>0</u> % Describe: _____
Pawnbroker Activity <u>0</u> %	Salvaged Materials (such as scrap metal) <u>0</u> %		

7. Businesses/Licenses on the Premises (check all that apply):

Type 1

Full Service Restaurant
 Cafe/Coffee Shop
 Deli or Fast Food Restaurant
 Private/Fraternal/Veterans Club
 Night Club
 Tavern
 Cocktail Lounge
 Teen Club
 Banquet Hall
 Sports Facility
 Bowling Alley
 Hotel/Motel : Number of Floors: _____
 Rooming House: Number of Floors: _____
 Number of Rooms: _____
 Number of Rooms: _____

Type 2

Liquor Store
 Corner Store
 Supermarket
 Convenience Store
 Gas Station
 Amusement/Phonograph Distributor
 Recycling, Salvage or Towing
 Used Car Dealer
 Personal Service Establishment (such as tattoo business, hair salon, tailor, etc.)
 Recording Studio

What other licenses/permits will you hold at this location? (check all that apply)

- Occupancy Permit
 Cigarette & Tobacco
 Gas Station
 Extended Hours
 Class "B" Tavern
 Weights & Measures
 Secondhand Dealer
 Precious Metal & Gem
 Other: _____

8. Legal Capacity (only if a Type 1 premises in #7 above)

Capacity 45 (Call the Milwaukee Development Center at 414-286-8211 if you have questions.)

9. Premises Description

a. Identify all area(s) of the premises that will be used in operating this business (include areas used only for storage):

1st Floor 2nd Floor Basement Storage Patio Beer Garden Sidewalk Café Deck Rooftop

Other: Describe: _____

b. Describe Location: Major Thoroughfare Secondary Street Other: _____

c. Nearest Major Cross Street: Mitchell & Forest Home

d. Describe Building: Free Standing Building Strip Mall Other: _____

e. Describe Premises Structure: Single Story Multi-Story - # of Stories 2 Other: _____

f. Describe Surrounding Area: Commercial Residential Industrial Other: _____

g. Building Owner Name: Nicole Blanks & Sean Walters Phone Number: 414-552-8482

Building Owner Address: 2419 N. Bremen St., Milwaukee, WI 53212

10. Hours of Operation & Customers

Will customers be entering the premises? No Yes

Day of the Week	Proposed Hours of Operation:		Estimated Number of Customers expected each day	Potential Age Range of Customers	Class B Tavern Applicant Only: Age Restriction (if none, write 'None')
	Open Time (include a.m. or p.m.)	Close Time (include a.m. or p.m.)			
Sunday	Noon	2 AM	30	30-60	Over 21
Monday	2 PM	2 AM	25		
Tuesday	2 PM	2 AM	25		
Wednesday	2 PM	2 AM	25		
Thursday	2 PM	2 AM	25		
Friday	2 PM	2 AM	50		
Saturday	Noon	2 AM	50		

An Extended Hours Establishment License is required for any convenience store, filling station, personal service establishment (such as tattoo, body piercing, salon, tailor, tanning, etc.), recording studio or restaurant which is open between the hours of 12:00 a.m. and 5:00 a.m.

Alcohol Establishments Class A: 8:00 am to 9:00 pm Sunday thru Saturday
 Permitted Hours of Operation: Class B: 6:00 am to 2:00 am Sunday thru Thursday, 6:00 am to 2:30 am Friday & Saturday

Entertainment Outdoor Closing Hours: 10:00pm Sunday-Thursday; 12:00am Friday & Saturday; unless a different time, either earlier or later, is established by the Common Council in its approval of the licensee's plan of operation.

11. Signature(s)

Nicole A. Blanks

Signature of Sole Proprietor, Partner, or 20% or more Shareholder

(if there are no 20% or more shareholders,

Corporate Officer-print name/title and sign)

 Signature of additional partner or 20% or more shareholder

See Application Information for a complete list of all required application forms.



ALCOHOL BEVERAGE & PUBLIC ENTERTAINMENT PREMISES SUPPLEMENTAL APPLICATION

Office of the City Clerk License Division
200 E. Wells St. Room 105, Milwaukee, WI 53202
(414) 286-2238 e-mail address: license@milwaukee.gov www.milwaukee.gov/license

Legal Entity Name: Mother Wit LLC

Premise Address: 1139 W. Maple St. Milwaukee, WI 53204

Proximity of Premises to Church, School, Daycare Center or Hospital

Is the building within 300 feet of any church, school, daycare center or hospital? No Yes

"Service Bar Only" Designation

If applying for Class B or C license, are you applying for "Service Bar Only"? No Yes
Service Bar Only means customers cannot sit at the bar. Alcohol is served to employees who serve patrons seated at tables. No stools, chairs or other articles of furniture shall be placed at the service bar for patrons to sit upon.

Business Information

a) Are you taking out this application for anyone that may not be eligible for a license? No Yes
If yes, list their name and address: _____

b) Will the agent, a partner or the individual licensee be conducting the day-to-day operations of the business? No Yes
If no, list the name and address of the person(s) who will: _____

Class B Applicants: If the agent, a partner or the individual licensee will not be conducting the day-to-day operations of the business, the person(s) listed above must obtain a Class B Managers license.

c) Does anyone else have money invested or any other interest in this business? No Yes
If yes, explain: _____

d) Have you made an agreement with anyone to repay any loan or any other payments based upon income from the business? No Yes If yes, list name and address: _____

Property Information (New & Transfer Applicants Only)

a) Do you own or lease the building? Own Lease

b) Who owns the fixtures (for example, coolers, etc.)? I do.

c) Are you purchasing the stock and/or fixtures? No Yes If yes, amount paid \$2,500 for stock

d) Total amount paid for business \$234,500

e) Total amount paid for goodwill of the business \$ N/A

Goodwill comprises the reputation and customer relationships of an existing business. If the price you pay for the business exceeds the fair market value of all of the rest of the assets of the business, the excess may be considered goodwill.

f) Have you made arrangements with the seller for payment of personal property taxes? No Yes

fixtures included in sale of the building

Lease Information (New & Transfer Applicants who are leasing the premises only)

a) Date lease begins _____ Ends _____

b) Monthly rental \$ _____

c) Do you have an option to renew the lease? No Yes

d) Does your lease allow for assignment to another party without the consent of the owner? No Yes

e) For what length of time have you been guaranteed occupancy (number of years)? _____

Lease Information (Continued)

- f) In addition to paying the monthly rental, will you have to pay anything additional to the owner of the building to guarantee performance of the lease? No Yes If yes, explain _____
- g) Does the present owner or occupant object to the granting of your license? No Yes
If yes, explain _____

Change of Agent Applicants Only

Have there been any changes to the floor plan since the last application was submitted? No Yes
If no, a new floor plan is not required. If yes, submit a new floor plan and explain the change(s):

Signature

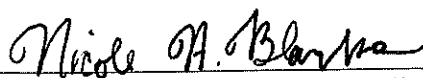

Signature of Sole Proprietor, Partner or 20% or More Shareholder
(if no 20% or more Shareholder, Corporate Officer - print name/title and sign)

Note: All information contained in this application is subject to approval by the Common Council.
Deviating from approved plan of operation will subject licensee to citations, and/or suspension or non-renewal of the license.
Contact the License Division for information on how to request changes.

New and transfer of premises applicants must submit the following:

- Detailed floor plan
- If a restaurant, copy of the menu



PUBLIC ENTERTAINMENT PREMISES LICENSE SUPPLEMENTAL APPLICATION

Office of the City Clerk License Division
200 E. Wells St. Room 105, Milwaukee, WI 53202
(414) 286-2238 www.milwaukee.gov/license e-mail address: license@milwaukee.gov

PREMISES ADDRESS: 1139 W. Maple St., Milwaukee, WI 53204

TYPES OF ENTERTAINMENT (CHECK ALL THAT APPLY)

<input checked="" type="checkbox"/> Instrumental Musicians	<input type="checkbox"/> Battle of the Bands	<input type="checkbox"/> Dancing by Performers	<input checked="" type="checkbox"/> Amusement Machines How many? <u>2</u>
<input checked="" type="checkbox"/> Bands	<input checked="" type="checkbox"/> Comedy Acts	<input type="checkbox"/> Adult Entertainment/ Strippers/Erotic Dance	<input type="checkbox"/> Concerts Approx. # per year? _____
<input type="checkbox"/> Bowling Alley How many? _____	<input type="checkbox"/> Disc Jockey	<input type="checkbox"/> Wrestling	<input type="checkbox"/> Theatrical Performances Approx. # per year? _____
<input checked="" type="checkbox"/> Pool Tables How many? <u>1</u>	<input type="checkbox"/> Magic Shows	<input checked="" type="checkbox"/> Patron Contests	<input checked="" type="checkbox"/> Jukebox
<input type="checkbox"/> Motion Pictures (movies by admission) - How many? _____	<input checked="" type="checkbox"/> Poetry Readings	<input checked="" type="checkbox"/> Patrons Dancing	<input checked="" type="checkbox"/> Karaoke
<input type="checkbox"/> Other: _____			

Entertainment Outdoor Closing Hours: 10:00pm Sunday-Thursdays; 12:00am Friday & Saturday; unless a different time, either earlier or later, is established by the Common Council in its approval of the licensee's plan of operation.

PROMOTERS/SOUND AMPLIFICATION

Will promoters ever be used for any of the entertainment? No Yes If Yes, Describe:

At any time will sound amplification be used? No Yes If Yes, Describe: Jukebox has speakers. May use microphones for things like karaoke, poetry readings, bands. All used inside

LEGAL CAPACITY OF PREMISES

45 (Call the Development Center at 414-286-8211 with questions.) Legal capacity determines the fee for your Public Entertainment Premises License. If you would like to request the license be approved with a lower capacity than that listed above, indicate the lower capacity here: _____. If approved, this lower capacity will print on your license and override the capacity listed on your Occupancy Permit.

ACKNOWLEDGEMENT/SIGNATURE

I understand that after the license has been issued, a change to the plan of operation will require a written request to change and approval from the Common Council. I agree to inform the City Clerk within 10 days of any substantial changes in the information supplied in this application. I understand that I shall not willfully refuse to provide the services offered under this license, or add charges or require deposits not required of the general public because of race, color, sex, religion, national origin or ancestry, age, handicap, lawful source of income, marital status, sexual orientation, gender identity or expression, familial status or the fact that a person is now or has been a member of the military service, whether dressed in uniform or not; and shall not seek such information as a condition of employment, or penalize any employee or discriminate in the selection of personnel for training or promotion on the basis of such information.

I have knowledge of the City Ordinances currently regulating public entertainment, and understand that the license may be subject to suspension, non-renewal or revocation, if I violate any rule, law or regulation of the city of Milwaukee and State of Wisconsin.

Nicole A. Blom
Signature of Sole Proprietor, Partner or 20% or More Shareholder
(If no 20% or more Shareholder, Corporate Officer - print name/title and sign)

Office Use Only.

Initials: _____ Filed: _____ App: _____

Only PEP? No Yes If Yes, Queue to MPD and Email Mgrs/Team Lead (must be heard w/in 60 days)

12th ST.

19'-11"

44'-5 1/2"

21'-10"

16'-6"

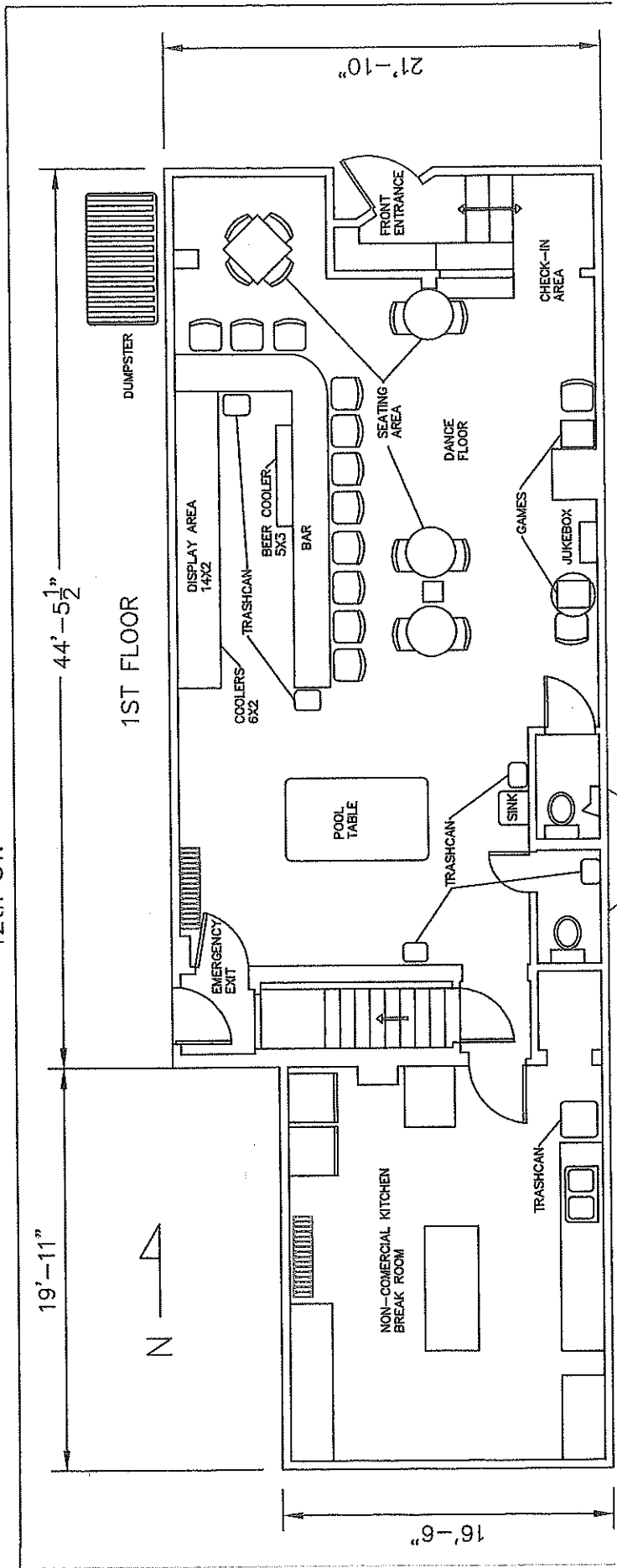

W. Maple ST.

NICOLE BLANKS AGENT FOR
 "MOTHERWIT LLC"
 The Peopies Inn
 1139 W. MAPLE ST.
 DATE: MARCH 20TH, 2024
 1300 sq ft

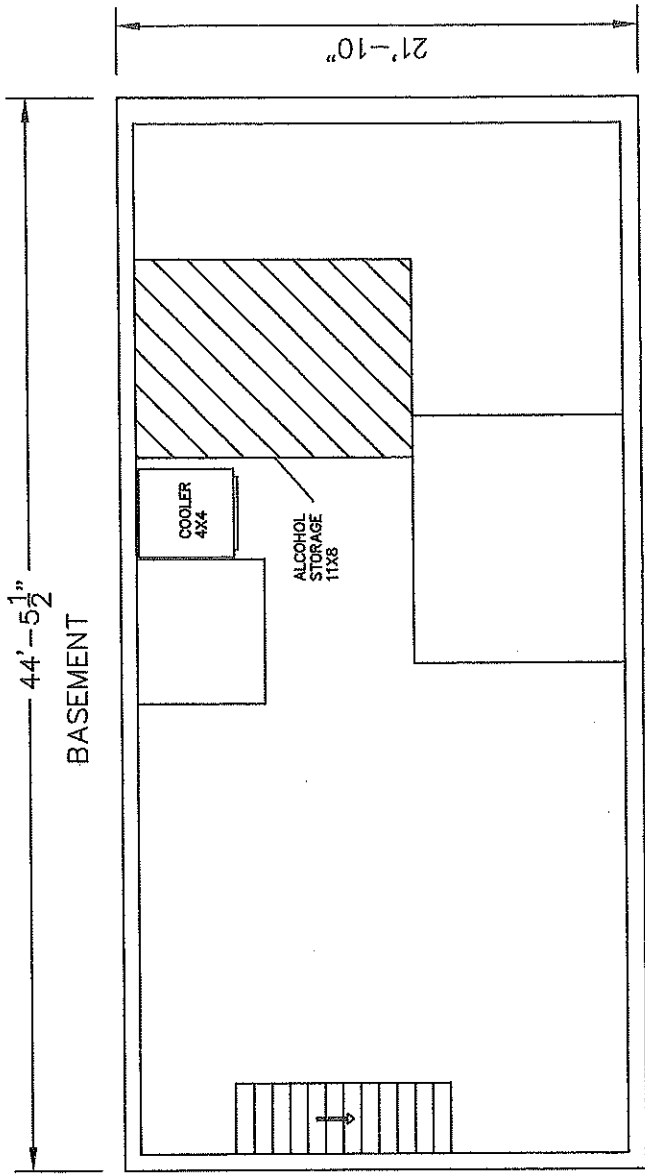

NICOLE BLANKS AGENT FOR
 "MOTHERWIT LLC"
 The Peoples Inn
 1139 W. MAPLE ST.
 DATE: MARCH 20TH, 2024
 970-971 sq. Ft