



CITY OF MILWAUKEE  
OFFICE OF THE CITY CLERK

Wednesday, June 03, 2020

COMMITTEE MEETING NOTICE

AD 06

SINGH, Sukhchain, Agent  
Fateh 1 Inc.  
3565-67 N Teutonia Av

Milwaukee, WI 53206

You are requested to attend a virtual hearing to be held on:

Monday, June 15, 2020 at 09:20 AM 

**Regarding:** Your Class A Malt & Class A Liquor, Food Dealer, and Weights & Measures License Applications as agent for "Fateh 1 Inc." for "Jack's Liquor" at 3565-67 N Teutonia Av.

This meeting will be held via GoToMeeting. Please see the enclosed best practices document for further instructions. The access code is <https://global.gotomeeting.com/join/435425765>. If you wish to call in, please call +1 (872) 240-3212 and use Access Code: 435-425-765.

There is a possibility that your application may be denied for one or more of the following reasons: The recommendation of the committee regarding the application shall be based on evidence presented at the hearing. Per MCO 85-2.7-4, probative evidence concerning whether or not a new license should be granted may be presented on the following subjects: whether or not the applicant meets the municipal requirements, the appropriateness of the location and premises where the licensed premises is to be located and whether use of the premises for the purposes or activities permitted by the license would tend to facilitate a public or private nuisance or create undesirable neighborhood problems such as disorderly patrons, unreasonably loud noise, litter, and excessive traffic and parking congestion. Probative evidence relating to these matters may be taken from the plan of operation submitted with the license application, if any, but shall not include the content of any music. Evidence regarding the fitness of the location of the premises to be maintained as the principal place of business, including but not limited to whether there is an overconcentration of businesses of the type for which the license is sought; whether the proposal is consistent with any pertinent neighborhood business or development plans, or the location's proximity to areas where children are typically present. The applicant's record in operating similarly licensed premises; and whether or not the applicant has been charged with or convicted of any felony, misdemeanor, municipal offense or other offense, the circumstances of which substantially relate to the activity to be permitted by the license being applied for or any other factor which reasonably relates to the public health, safety or welfare may also be considered. See attached police report or correspondence.

**Notice for applicants with warrants or unpaid fines:** Proof of warrant satisfaction or payment of fines must be submitted at the hearing on the above date and time. Failure to comply with this requirement may result in a delay of the granting/denial of your application.

Failure to attend this meeting may result in the denial of your license. Individual applicants and partnership applicants must attend or attend by an attorney. The agent or attorney for corporate or limited liability applicants must attend. If you wish to do so and at your own expense, you may be accompanied by an attorney of your choosing to represent you at this hearing.

You will be given an opportunity to speak on behalf of the application and to respond and challenge any charges or reasons given for the denial. No petitions can be accepted by the committee, unless the people who signed the petition attend the virtual hearing and are willing to testify. You may present witnesses under oath and you may also confront and cross-examine opposing witnesses under oath. If you have difficulty with the English language, you should request an interpreter attend the meeting with you, at your expense, so that you can answer questions and participate in your hearing.

PLEASE NOTE: Upon reasonable notice, efforts will be made to accommodate the needs of disabled individuals through sign language interpreters or other auxiliary aids. For additional information or to request this service, contact the Council Services Division ADA Coordinator at (414) 286-2998, Fax - (414) 286-3456, TDD - (414) 286-2025.

JIM OWCZARSKI, CITY CLERK

BY: \_\_\_\_\_  
Jessica Celella  
License Division Manager

If you have questions regarding this meeting, please contact the staff assistant, Molly Kuether-Steele at (414) 286-2775 or [molly.kuether-steele@milwaukee.gov](mailto:molly.kuether-steele@milwaukee.gov).

200 E. Wells Street, Room 105, City Hall, Milwaukee, WI 53202. [www.milwaukee.gov/license](http://www.milwaukee.gov/license)  
Phone: (414) 286-2238 Fax: (414) 286-3057 Email Address: [License@milwaukee.gov](mailto:License@milwaukee.gov)



**CITY OF MILWAUKEE  
OFFICE OF THE CITY CLERK**

Wednesday, June 03, 2020

**COMMITTEE MEETING NOTICE**

AD 06

SINGH, Sukhchain, Agent  
Fateh 1 Inc.  
718 W Grange Ave  
Apt A  
Milwaukee, WI 53221

You are requested to attend a virtual hearing to be held on:

**Monday, June 15, 2020 at 09:20 AM**

**Regarding:** Your Class A Malt & Class A Liquor, Food Dealer, and Weights & Measures License Applications as agent for "Fateh 1 Inc." for "Jack's Liquor" at 3565-67 N Teutonia Av.

This meeting will be held via GoToMeeting. Please see the enclosed best practices document for further instructions. The access code is <https://global.gotomeeting.com/join/435425765>. If you wish to call in, please call +1 (872) 240-3212 and use Access Code: 435-425-765.

There is a possibility that your application may be denied for one or more of the following reasons: The recommendation of the committee regarding the application shall be based on evidence presented at the hearing. Per MCO 85-2.7-4, probative evidence concerning whether or not a new license should be granted may be presented on the following subjects: whether or not the applicant meets the municipal requirements, the appropriateness of the location and premises where the licensed premises is to be located and whether use of the premises for the purposes or activities permitted by the license would tend to facilitate a public or private nuisance or create undesirable neighborhood problems such as disorderly patrons, unreasonably loud noise, litter, and excessive traffic and parking congestion. Probative evidence relating to these matters may be taken from the plan of operation submitted with the license application, if any, but shall not include the content of any music. Evidence regarding the fitness of the location of the premises to be maintained as the principal place of business, including but not limited to whether there is an overconcentration of businesses of the type for which the license is sought; whether the proposal is consistent with any pertinent neighborhood business or development plans, or the location's proximity to areas where children are typically present. The applicant's record in operating similarly licensed premises; and whether or not the applicant has been charged with or convicted of any felony, misdemeanor, municipal offense or other offense, the circumstances of which substantially relate to the activity to be permitted by the license being applied for or any other factor which reasonably relates to the public health, safety or welfare may also be considered. See attached police report or correspondence.

**Notice for applicants with warrants or unpaid fines:**

Proof of warrant satisfaction or payment of fines must be submitted at the hearing on the above date and time. Failure to comply with this requirement may result in a delay of the granting/denial of your application.

Failure to attend this meeting may result in the denial of your license. Individual applicants and partnership applicants must attend or attend by an attorney. The agent or attorney for corporate or limited liability applicants must attend. If you wish to do so and at your own expense, you may be accompanied by an attorney of your choosing to represent you at this hearing.

You will be given an opportunity to speak on behalf of the application and to respond and challenge any charges or reasons given for the denial. No petitions can be accepted by the committee, unless the people who signed the petition attend the virtual hearing and are willing to testify. You may present witnesses under oath and you may also confront and cross-examine opposing witnesses under oath. If you have difficulty with the English language, you should request an interpreter attend the meeting with you, at your expense, so that you can answer questions and participate in your hearing.

PLEASE NOTE: Upon reasonable notice, efforts will be made to accommodate the needs of disabled individuals through sign language interpreters or other auxiliary aids. For additional information or to request this service, contact the Council Services Division ADA Coordinator at (414) 286-2998, Fax - (414) 286-3456, TDD - (414) 286-2025.

JIM OWCZARSKI, CITY CLERK

BY: \_\_\_\_\_

Jessica Celella

License Division Manager

If you have questions regarding this meeting, please contact the staff assistant, Molly Kuether-Steele at (414) 286-2775 or [molly.kuether-steele@milwaukee.gov](mailto:molly.kuether-steele@milwaukee.gov).

200 E. Wells Street, Room 105, City Hall, Milwaukee, WI 53202. [www.milwaukee.gov/license](http://www.milwaukee.gov/license)  
Phone: (414) 286-2238 Fax: (414) 286-3057 Email Address: [License@milwaukee.gov](mailto:License@milwaukee.gov)

Date: 03/02/2020  
Officer: GARLAND, Keith

City of Milwaukee Police Department  
90-5-1.5 Crime Prevention Survey  
Convenience Store/Liquor Store Inspection

Name of Premise: Jacks Beverage Center  
Address: 3565 N. Teutonia Ave  
Phone: 414-873-8185

Owner: SINGH, Sukhchain NMI (I/M, 02/25/82)  
Owner address: 718 W Grange Ave #A  
City State Zip: Milwaukee WI 53221  
Owner Phone: 414-837-8479  
Owner email: Tinku463@Icloud.com

Manager: SINGH, Surinder P (I/M, 09/06/84)  
Home Address: 718 W Grange Ave #A  
City State Zip: Milwaukee WI 53221  
Phone: 262-349-3230  
Email: Tinku463@Icloud.com

Preferred contact: Phone: 414262-349-3230

Location currently open:  YES  NO

Projected open date: When licenses are approved

Day's open: S M T W Th F SA ALL

Hours of Operation: Sun: 8:00 am to 9:00 pm 24 hours Y N  
Mon: 8:00 am to 9:00 pm  
Tue: 8:00 am to 9:00 pm  
Wed: 8:00 am to 9:00 pm  
Thu: 8:00 am to 9:00 pm  
Fri: 8:00 am to 9:00 pm  
Sat: 8:00 am to 9:00 pm

Premise Type: Liquor Store  
Convenience Store  
Other:

Licenses currently held:

- Alcohol:  Yes  No Class: A Malt/ Liquor #: 0199785  
Tobacco:  Yes  No #: 1028533  
Food:  Yes  No #: 0010152  
Extended Hours:  Yes  No #:  
Secondhand Dealer:  Yes  No Type: #:  
Other:  Yes  No Type: Class D #: 0229895  
Other:  Yes  No Type: #:

**Exterior Survey:**

1. Is the area around the location clean?  Yes  No
2. What surrounds the location? (Check all the apply)
  - a.  Park
  - b.  School
  - c.  Youth Center
  - d.  Church
  - e.  Tavern(s) If so, how many
  - f.  Residential
  - g.  Other businesses
  - h.  Other:
3. Can you see from the outside of the location into the interior  Yes  No
4. Can you see the employees inside of the location from the outside  Yes  No
5. Are exterior windows free of signage  Yes  No
6. Is there a parking lot  Yes  No
7. Is the parking lot clean?  Yes  No
8. Is the parking lot well lit?  Yes  No
9. Are there areas where a person could conceal themselves  Yes  No
10. Is there exterior lighting?  Yes  No. Does it appears to be adequate  Yes  No
11. Exterior Payphone?  Yes  No
12. Are there No Loitering Signs posted?  Yes  No
13. Are there exterior security cameras  Yes  No How Many: 01
14. Are the address numbers prominently displayed and easy to see  Yes  No

**Camera Survey:**

15. Does this location have security cameras?  Yes  No
16. Are they in working order?  Yes  No
17. What format are the cameras?
  - a. Color  Yes  No
  - b. Digital  Yes  No
  - c. VCR  Yes  No
  - d. Recorded  Yes  No
18. How long is footage stored for later viewing: 30 days
19. Are there exterior cameras  Yes  No How many: 01
20. Are there interior cameras  Yes  No How many: 11
21. Do all employees know how to retrieve recorded digital images/footage?  Yes  No

**Interior Survey:**

22. Is the storeowner willing to be a standing complainant regarding loitering?  Yes  No  
a. If yes have them fill out the standing complaint form and give them two of the commercial signs  Yes  No
23. Is the interior of the location neat and clean?  Yes  No
24. Does an interior camera face the entrance/exit?  Yes  No
25. Is there a lockable area that separates employees from customers?  Yes  No
26. Does the store sell single chore boy?  Yes  No
27. Does the store sell blunt wraps?  Yes  No
28. Does the store sell scales?  Yes  No
29. Does the store sell items that may be used as crack pipes?  Yes  No  
a. Describe item
30. Does the store have an over abundance of sandwich baggies:  Yes  No
31. Does the owner understand that these items are often used for drug use?  Yes  No
32. Do the products in the store appear to be new and rotated often?  Yes  No
33. Are emergency and non-emergency numbers posted near the phone?  Yes  No
34. Does the owner know how to contact their police district directly?  Yes  No  
a. Did you provide a district contact guide to the owner?  Yes  No

**Complete this section if alcohol establishment is a convenience store:**

(\*\* Read full ordinance for all details "68-4.3 Convenience Food Stores")

All convenience food stores not exempted under sub. 3 shall:

1. Is the cash register located in a manner so that at the time of a sales transaction, the employee and customer are both visible from the sidewalk?  Yes  No \*\*
2. Are the glass entrance and exit doors clear of any signs or advertisements with the exception of a sign, which states that the cash register contains \$50 or less and that the safe is no accessible to employees?  Yes  No
3. Does the store maintain one of the following on the licensed premise:
  - a. A safe that was in use at the convenience food store on August 17, 1994?  Yes  No
  - b. A drop-safe or time release safe that weighs at least 500 pounds or which is attached to or set into the floor in a manner approved by the police department?  Yes  No
4. Is lighting provided for the store's parking area during all hours of darkness when employees or customers are on the premises at a minimum average of 2-foot candles per square foot, unless the store is not open for business after sunset and before sunrise?  Yes  No  N/A
5. Are at least two high-resolution surveillance security cameras installed?  Yes  No
6. Are the security cameras in working order?  Yes  No
7. Does one camera show an overall view of the counter and register area?  Yes  No
8. Does one camera show a clear, identifiable, full frame image of the face of each person entering and leaving the store?  Yes  No
9. Are the camera views obstructed by fixtures or displays?  Yes  No
10. Is the recorded footage stored for at least 30 days?  Yes  No
11. Do all store employees know how to record footage from the camera system to media capable of being transferred to police custody?  Yes  No

12. Are customer entrances/exits made of glass or other transparent material?  Yes  No  
a. Exception: A store that does not have such doors on August 17, 1994 shall not be required to install such doors until the holder of the store's food dealer license changes.
13. Has the owner and their employees attended the Robbery Prevention Training within 120 days of ownership or employment?  Yes  No  
a. Contact Community Outreach and Education at 935-7836 for schedule.

**Sub 3. Exemptions.** The requirements of this section do not apply to a convenience food store that conforms to either of the following descriptions:

- a-1. The store is located in an enclosed shopping structure, enclosed commercial building or hospital. A convenience food store is not in an enclosed structure or building if a customer can enter it directly from the outside.  
Does store conform to a-1  Yes  No
- a-2. The store physically separates employees from customers with a solid partition that bars a person from entering the employee area from the customer area, has a secure lock on the employee side of any door between the employee area and the customer, and conducts all transaction through a service window or similar arrangement.  
Does store conform to a-2  Yes  No
- a. At the commissioner's discretion, a convenience store may be exempted from any or all of the regulations specified in sub 2.  
Does this location hold an exemption from the commissioner regarding any of the requirements of Sub 2?  Yes  No

**ADDITIONAL COMMENTS/RECOMMENDATIONS:**

The new owner is in the process of applying for the same licenses that the business currently has. The storeowner is in the process of adding more exterior surveillance cameras. The business primarily operates as a liquor store and not a convenience store, but business does sell packaged food items. The interior of the business was not clean, and there was trash and cardboard on the floor in the storage room that needed to be disposed of.

MILWAUKEE POLICE DEPARTMENT  
LICENSE INVESTIGATION UNIT

CRIMINAL RECORD/ORDINANCE VIOLATION/INCIDENTS  
SYNOPSIS

DATE: 05/20/2019

LICENSE TYPE: CLASS A MALT & LIQUOR

NEW:

RENEWAL: X

No. 293767

Application Date: 05/16/2019

Expiration Date:

License Location: 3565-67 N. Teutonia Ave.

Business Name: Toor Retail

Licensee/Applicant: Toor, Davinder S.

(Last Name, First Name, MI)

Date of Birth: 04/23/1983

Male:

Female:

Home Address: 10315 S. George Dr.

City: Oak Creek

State: WI

Zip Code: 53154

Home Phone: (414) 698-4896

This report is written by Police Officer David NOVAK, assigned to the License Investigation Unit, Days.

The Milwaukee Police Department's investigation regarding this application revealed the following:

1. On 06/08/2008 the applicant was cited in Kenosha County for Violate Public Swimming Pool Regulations.

Charge: Violate Public Swimming Pool Regulations

Finding: Guilty

Sentence: Fine

Date: 06/18/2008

Case: 2008FO000563

=====

2. On 07/19/2014 a 17 year old, working in conjunction with Milwaukee police, was able to purchase three Show brand cigars from the cashier at 3565 North Teutonia Avenue (Jack's Beverage Center). The applicant was cited.

Charge: Sale of Cigarettes to Minor/Underage

Finding: Guilty

Sentence: \$130.00 fine

Date: 10/28/2014

Case: 14054187

=====

3. On 10/08/2016 the applicant was cited in the City of Milwaukee at 5009 N. Hampton Av for

Charge: Sale of Cigarettes to Minor/Underage  
Finding: Guilty  
Sentence: Fined \$260.00  
Date: 09/18/2017  
Case: 17034918

=====

4. On 08/11/2018 a 17 year old working in conjunction with the Milwaukee Police Department and WI WINS Tobacco initiative, was able to purchase a Black & Mild cigar from the clerk at Jack's Beverage Center, 3565 N. Teutonia Av, who checked for ID but made the sale anyways. The cashier admitted the sale and apologized. The applicant was mailed MARTS enrollment package.
5. On 03/19/2019 officers conducted a licensed premise check at Jack's Beverage Center, 3565 N. Teutonia Av. The officers checked the licenses and found them to be current and the clerk was cooperative. No violations observed.

**PREVIOUS PREMISE**





# Concentration Map

3565-67 N Teutonia AV.

Area : 21,862,585.97 ft<sup>2</sup>

Feb 4 2020 10:45:04 Central Standard Time

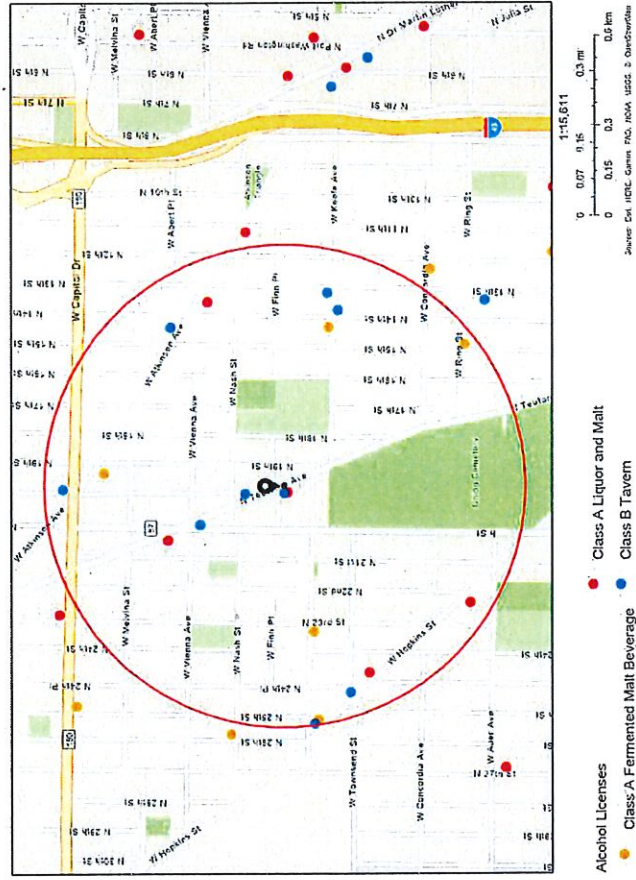

Summary

Name	Count	Area(ft <sup>2</sup> )	Length(mi)
Alcohol Licenses	19		

Alcohol Licenses

#	Legal Entity	Trade Name	Licensee	Address	License Type Name	Total Capacity	Expiration Date	Count
1	Bungalow Restaurant, LLC	Henry and Bobbie's Bungalow	Demetrius T Jones, Agt	3466 N 14th ST	Class B Tavern License		6/10/2020, 7:00 PM	1
2	FAITH GROCERIES, INC	FAITH GROCERIES	HARJINDER KHASRIA, Agt	3451 N 23RD ST	Class A Fermented Malt Beverage Retailer's License		4/10/2020, 7:00 PM	1
3	MALLETT'S FOODS	MALLETT'S FOODS	JOE F MALLETT, SP	3501 N 14TH ST	Class A Fermented Malt Beverage Retailer's License		10/16/2020, 7:00 PM	1
4	BIG MANS PLACE	BIG MANS PLACE	JAMES BANKS, SP	1932 W CAPITOL DR	Class B Tavern License	76	11/7/2020, 6:00 PM	1
5	CASPAR'S LOUNGE	CASPAR'S LOUNGE	LUTHER BROWN, SP	1300 W KEEFEAV	Class B Tavern License	60	6/29/2020, 7:00 PM	1
6	SHANAA GROCERY, INC	MIR F FOODS	BASSEL S HAMZA, Agt	3246 N 15TH ST	Class A Fermented Malt Beverage Retailer's License		12/15/2020, 6:00 PM	1
7	Toor Retail LLC	Jack's Beverage Center	Davinder S Toor, Agt	3565-67 N Teutonia AV	Class A Malt & Class A Liquor License		7/29/2020, 7:00 PM	1
8	WARREN'S LOUNGE	WARREN'S LOUNGE	WARREN G HARPER, SP	2534 W HOPKINS ST	Class B Tavern License	180	7/7/2020, 7:00 PM	1
9	Freez Food Mart LLC	Freez Food Mart	Jehad A Fares, Agt	2526 W Hopkins ST	Class A Fermented Malt Beverage Retailer's License		1/17/2021, 6:00 PM	1
10	KHASRIA 3, INC	BIG JIM LIQUOR	BHUPINDER SINGH, Agt	2161 W HOPKINS ST	Class A Malt & Class A Liquor License		1/18/2021, 6:00 PM	1
11	1301 Stark Inc	Stark Food Market	CHARNJIT KAUR, Agt	1301 W ATKINSON AV	Class A Malt & Class A Liquor License		2/26/2020, 6:00 PM	1
12	SINDHI, INC	Express Liquor	NAVPREET S MANHANI, Agt	3833 N TEUTONIA AV	Class A Malt & Class A Liquor License		7/16/2020, 7:00 PM	1

13	Y&A LLC	Mothers Food and Liquor	Gurcharan Singh, Agt	2438 W Hopkins ST	Class A Malt & Class A Liquor License		2/28/2020, 6:00 PM	1
14	Murray's Bar, LLC	Murray's Bar LLC	Mark A Murray, Agt	2474 W HOPKINS ST	Class B Tavern License	75	5/19/2020, 7:00 PM	1
15	SHANANIGAN S	SHANANIGAN S	CETTERY M GARDNER, SP	3751 N TEUTONIA AV	Class B Tavern License	70	9/23/2020, 7:00 PM	1
16	YOUNG'S BAR, INC	YOUNG'S BAR	CHARLENE E GRAY, Agt	3571 N TEUTONIA AV	Class B Tavern License	50	6/13/2020, 7:00 PM	1
17	CATFISH LOUNGE, INC	CATFISH LOUNGE	JAMIE N GLADNEY, Agt	3646 N TEUTONIA AV	Class B Tavern License	80	6/12/2020, 7:00 PM	1
18	Tip Top Foods LLC	Tip Top Foods	Gagan K Gill, Agt	1901 W ATKINSON AV	Class A Fermented Malt Beverage Retailer's License		10/30/2020, 7:00 PM	1
19	STEWART'S REST.SPOT	STEWART'S REST SPOT	JESSICA P STEWART, SP	1422 W ATKINSON AV	Class B Tavern License	49	10/10/2020, 7:00 PM	1

Establishments within a 0.5 miles radius centered on area of interest.



Wednesday, June 03, 2020

## Licenses Committee Notice of Hearing

3565 TEUTONIA LLC  
3565 N Teutonia Av  
Milwaukee, WI 53206

The Licenses Committee will consider the following license application:

Class A Malt & Class A Liquor, Food Dealer, and Weights & Measures License  
Applications  
SINGH, Sukhchain, Agent  
Jack's Liquor at 3565-67 N Teutonia Av

Date: 6/15/2020

Time: 09:20 AM

Location: The hearing before the Licenses Committee will take place virtually on Monday, June 15, 2020. This is a public hearing. Those wishing to view the proceeding are able to do so via the City Channel – Channel 25 on Spectrum Cable – or on the Internet at <http://city.milwaukee.gov/citychannel>. Those wishing to provide oral testimony will be asked to do so by phone or internet and are asked to contact the staff assistant, Molly Kuether-Steele at (414) 286-2775 or [molly.kuether-steele@milwaukee.gov](mailto:molly.kuether-steele@milwaukee.gov) for necessary information. Please make such requests no later than one business day prior to the start of the meeting. You are not required to attend the hearing, but please see the information below if you would like to provide testimony.

Please note this application may be recommended for denial based on fitness of the location due to concentration of alcohol beverage outlets in the area. If the application is denied for this reason, no other application for an alcohol beverage license for this location shall be recommended for approval by the Licenses Committee within three years of the date of denial unless the applicant has demonstrated a change of circumstances since the prior denial.





Wednesday, June 03, 2020

## Licenses Committee Notice of Hearing

Pritpal Singh  
PO Box 461  
Butler, WI 53005

The Licenses Committee will consider the following license application:

Class A Malt & Class A Liquor, Food Dealer, and Weights & Measures License Applications  
SINGH, Sukhchain, Agent  
Jack's Liquor at 3565-67 N Teutonia Av

Date: 6/15/2020

Time: 09:20 AM

Location: The hearing before the Licenses Committee will take place virtually on Monday, June 15, 2020. This is a public hearing. Those wishing to view the proceeding are able to do so via the City Channel – Channel 25 on Spectrum Cable – or on the Internet at <http://city.milwaukee.gov/citychannel>. Those wishing to provide oral testimony will be asked to do so by phone or internet and are asked to contact the staff assistant, Molly Kuether-Steele at (414) 286-2775 or [molly.kuether-steele@milwaukee.gov](mailto:molly.kuether-steele@milwaukee.gov) for necessary information. Please make such requests no later than one business day prior to the start of the meeting. You are not required to attend the hearing, but please see the information below if you would like to provide testimony.

Please note this application may be recommended for denial based on fitness of the location due to concentration of alcohol beverage outlets in the area. If the application is denied for this reason, no other application for an alcohol beverage license for this location shall be recommended for approval by the Licenses Committee within three years of the date of denial unless the applicant has demonstrated a change of circumstances since the prior denial.





Wednesday, June 03, 2020



# Notice of Public Hearing

blank  
notice

---

SINGH, Sukhchain, Agent  
Jack's Liquor at 3565-67 N Teutonia Av  
Class A Malt & Class A Liquor, Food Dealer, and Weights & Measures License Applications

**Monday, June 15, 2020 at 9:20 AM**

To whom it may concern:

The above application has been made by the above named applicant(s). This requires approval from the Licenses Committee and the Common Council of the City of Milwaukee. The hearing before the Licenses Committee will take place virtually on 6/15/2020 at 9:20 AM. This is a public hearing. Those wishing to view the proceeding are able to do so via the City Channel – Channel 25 on Spectrum Cable – or on the Internet at <http://city.milwaukee.gov/citychannel>. Those wishing to provide oral testimony will be asked to do so by phone or internet and are asked to contact the staff assistant, Molly Kuether-Steele at (414) 286-2775 or [molly.kuether-steele@milwaukee.gov](mailto:molly.kuether-steele@milwaukee.gov) for necessary information. Please make such requests no later than one business day prior to the start of the meeting. You are not required to attend the hearing, but please see the information below if you would like to provide testimony. Once the Licenses Committee makes its recommendation, this recommendation is forwarded to the full Common Council for approval at its next regularly scheduled hearing.

---

## Important details for those wishing to provide information for the Licenses Committee to consider when making its recommendation:

1. The license application is scheduled to be heard at the above time. Due to other hearings running longer than scheduled, you may have to wait some time to provide your testimony.
2. You must testify as to matters that you have personally experienced or seen. (You cannot provide testimony for your neighbor, parent or anyone else; this is considered hearsay and cannot be considered by the committee.)
3. No letters or petitions can be accepted by the committee (unless the person who wrote the letter or the persons who signed the petition are willing to testify).
4. Persons opposed to the license application are given the opportunity to testify first; supporters may testify after the opponents have finished.
5. When you are called to testify, you will be sworn in and asked to give your name, and address. (If your first and/or last names are uncommon please spell them.)
6. You may then provide testimony.
  - a. Include only information relating to the above license application.
  - b. Include only information you have personally witnessed or seen.
  - c. Provide concise and relevant information detailing how this business has affected or may affect the peaceful enjoyment of your neighborhood.
  - d. If by the time you have the opportunity to testify, the information you wish to share has already been provided to the committee, you may state that you agree with the previous testimony. Redundant or repetitive testimony will not assist the committee in making its recommendation.
7. After giving your testimony, the members of the Licenses Committee and the licensee may ask questions regarding the testimony you have given or other factors relating to the license application.
8. Business Competition is not a valid basis for denial or non-renewal of a license.

**Please Note: If you have submitted an objection to the above application your objection cannot be considered by the committee unless you personally testify at the hearing.**

OCCUPANT	MAIL ADDRESS	CITY, STATE ZIP
CURRENT OCCUPANT	3556 N 19TH ST	MILWAUKEE, WI 53206
CURRENT OCCUPANT	1907 W FINN PL	MILWAUKEE, WI 53206
CURRENT OCCUPANT	1917 W FINN PL	MILWAUKEE, WI 53206
CURRENT OCCUPANT	3530A N 20TH ST	MILWAUKEE, WI 53206
CURRENT OCCUPANT	3520A N 20TH ST	MILWAUKEE, WI 53206
CURRENT OCCUPANT	1926A W KEEFE AVE	MILWAUKEE, WI 53206
CURRENT OCCUPANT	3544A N TEUTONIA AVE 3	MILWAUKEE, WI 53206
CURRENT OCCUPANT	3554 N 19TH ST	MILWAUKEE, WI 53206
CURRENT OCCUPANT	3572 N TEUTONIA AVE	MILWAUKEE, WI 53206
CURRENT OCCUPANT	1956 W FINN PL	MILWAUKEE, WI 53206
CURRENT OCCUPANT	3606A N 20TH ST	MILWAUKEE, WI 53206
CURRENT OCCUPANT	3617 N TEUTONIA AVE	MILWAUKEE, WI 53206
CURRENT OCCUPANT	3550A N 19TH ST	MILWAUKEE, WI 53206
CURRENT OCCUPANT	3544A N TEUTONIA AVE 2	MILWAUKEE, WI 53206
CURRENT OCCUPANT	1947 W FINN PL	MILWAUKEE, WI 53206
CURRENT OCCUPANT	1954 W FINN PL	MILWAUKEE, WI 53206
CURRENT OCCUPANT	1964 W FINN PL	MILWAUKEE, WI 53206
CURRENT OCCUPANT	3621B N TEUTONIA AVE	MILWAUKEE, WI 53206
CURRENT OCCUPANT	3558 N 19TH ST	MILWAUKEE, WI 53206
CURRENT OCCUPANT	3560 N 19TH ST	MILWAUKEE, WI 53206
CURRENT OCCUPANT	3530 N 20TH ST	MILWAUKEE, WI 53206
CURRENT OCCUPANT	1958 W KEEFE AVE	MILWAUKEE, WI 53206
CURRENT OCCUPANT	1945 W FINN PL	MILWAUKEE, WI 53206
CURRENT OCCUPANT	1953 W FINN PL	MILWAUKEE, WI 53206
CURRENT OCCUPANT	3606 N 20TH ST	MILWAUKEE, WI 53206
CURRENT OCCUPANT	1932 W KEEFE AVE	MILWAUKEE, WI 53206
CURRENT OCCUPANT	1936 W KEEFE AVE	MILWAUKEE, WI 53206
CURRENT OCCUPANT	1941 W FINN PL	MILWAUKEE, WI 53206
CURRENT OCCUPANT	3566A N 19TH.ST	MILWAUKEE, WI 53206
CURRENT OCCUPANT	1959 W FINN PL	MILWAUKEE, WI 53206
CURRENT OCCUPANT	3615 N TEUTONIA AVE	MILWAUKEE, WI 53206
CURRENT OCCUPANT	1926 W KEEFE AVE	MILWAUKEE, WI 53206
CURRENT OCCUPANT	3520 N 20TH ST	MILWAUKEE, WI 53206
CURRENT OCCUPANT	1954 W KEEFE AVE	MILWAUKEE, WI 53206
CURRENT OCCUPANT	1957 W FINN PL	MILWAUKEE, WI 53206
CURRENT OCCUPANT	1963A W FINN PL	MILWAUKEE, WI 53206
CURRENT OCCUPANT	3550 N 19TH ST	MILWAUKEE, WI 53206
CURRENT OCCUPANT	3566 N 19TH ST	MILWAUKEE, WI 53206
CURRENT OCCUPANT	1963 W FINN PL	MILWAUKEE, WI 53206
CURRENT OCCUPANT	3602 N 20TH ST	MILWAUKEE, WI 53206
CURRENT OCCUPANT	3544A N TEUTONIA AVE	MILWAUKEE, WI 53206
CURRENT OCCUPANT	3573 N 19TH ST	MILWAUKEE, WI 53206
CURRENT OCCUPANT	3577 N 19TH ST	MILWAUKEE, WI 53206
CURRENT OCCUPANT	3611A N TEUTONIA AVE	MILWAUKEE, WI 53206
CURRENT OCCUPANT	3512 N 20TH ST	MILWAUKEE, WI 53206
CURRENT OCCUPANT	3512A N 20TH ST	MILWAUKEE, WI 53206



CURRENT OCCUPANT	1965 W FINN PL	MILWAUKEE, WI 53206
CURRENT OCCUPANT	3621A N TEUTONIA AVE	MILWAUKEE, WI 53206
blank	notice	

Total Records: 49

Radius: 250.0 feet and Center of Circle: 3565 N Teutonia Ave



# BUSINESS LICENSE PLAN OF OPERATION

ccl-busplan 3/15/18

Office of the City Clerk License Division  
200 E. Wells St. Room 105, Milwaukee, WI 53202  
(414) 286-2238 www.milwaukee.gov/license e-mail address: [license@milwaukee.gov](mailto:license@milwaukee.gov)

## 1. Type of Business

Applying for:  Extended Hours (12AM to 5AM) - If a food establishment, check all that apply:  Delivery  Drive Thru  Dining Room  
 Self Service Laundry  Massage Establishment  Filling Station  
 Other (supplemental application for specific license also required)

Provide a detailed description of the type of business you plan on operating:

CONVENIENCE STORE / LIQUOR STORE.

Do you have any experience operating this type of business?  No  Yes If yes, explain: 4 years manager at gas station

## 2. Business Operations

2 years manager liquor store

- a. Proposed Opening Date: FEB 01, 2020
- b. Is this premise under construction?  No  Yes If yes, list estimated completion date: \_\_\_\_\_
- c. Is this a franchise?  No  Yes
- d. Is this premises currently licensed?  No  Yes If yes, list type of license: CLASS A LIQUOR.
- e. Is the current licensee operating?  No  Yes If no, list date closed: \_\_\_\_\_
- f. Do you have future plans for other businesses, licenses or permits at this location?  No  Yes  
If yes, explain: \_\_\_\_\_
- g. Have you previously held an Extended Hours License in Milwaukee?  No  Yes  
If yes, list address(es): \_\_\_\_\_
- h. Are other businesses operating in the same building?  No  Yes If yes, describe: \_\_\_\_\_

## 3. Litter & Noise

- a. How are grounds kept clean?  Sweep  Pressure Wash  Pick Up Litter  Other: CAS NEEDED
- b. How often will grounds be cleaned?  Daily  Weekly  As Needed  Monthly  Other: CAS NEEDED
- c. Grounds cleaned by:  Licensee  Building Owner  Employees  Hired Maintenance  Other: \_\_\_\_\_
- d. How are noise issues prevented and/or addressed?  Security  Manager approaches customer(s)  Call Police  
 Signs Posted  Other: \_\_\_\_\_
- e. Will a sound amplification system be used?  No  Yes If yes, describe: \_\_\_\_\_

## 4. Smoking & Sanitation

- a. Are there designated outdoor smoking areas?  No  Yes If yes, describe: \_\_\_\_\_
- b. Number of Garbage Cans: Inside: 3 Locations: COUNTER ROOM, LOBBY, REAR ROOM.  
Outside: 2 Locations: FRONT
- c. Is a crowd control barrier used?  No  Yes If yes, describe: \_\_\_\_\_
- d. How many restrooms are on the premises? (2)
- e. Name of solid waste contractor:  Advanced Disposal  Waste Management  Other: Advanced Disposal

### 5. Security

- a. Are there onsite parking spaces?  No  Yes If yes, how many? 16 and describe the parking security plan: Cameras.
- b. Is there a loading zone?  No  Yes If yes, describe the loading area security plan: \_\_\_\_\_
- c. Will you have security personnel on premise?  No  Yes If yes, how many? \_\_\_\_\_ and answer the following:  
 What are their responsibilities? \_\_\_\_\_  
 Is security equipment used?  No  Yes If yes, describe Security Cameras.  
 List their licensing, certification, or training credentials \_\_\_\_\_
- d. Will there be security cameras?  No  Yes If yes, how many? 8 and list locations: Rear, Front, Side, back, etc.
- e. Will searches/identification checks be done upon entry?  No  Yes If yes, describe \_\_\_\_\_

### 6. Percentage of Sales (must total 100%)

Alcohol <u>50</u> %	Food <u>40</u> %	Secondhand Merchandise _____ %	Precious Metals & Gems _____ %
Entertainment _____ %	Cigarettes <u>10</u> %	_____ %	_____ %
Pawnbroker Activity _____ %	Salvaged Materials _____ % (such as scrap metal)	Personal Services (such as tattoo, body piercing, salon, tailor, tanning, etc.) _____ %	Other _____ % Describe: _____

### 7. Businesses/Licenses on the Premises (check all that apply):

#### Type 1

- Full Service Restaurant     Cafe/Coffee Shop     Deli or Fast Food Restaurant     Private/Fraternal/Veterans Club
- Night Club     Tavern     Cocktail Lounge     Teen Club
- Banquet Hall     Sports Facility     Bowling Alley
- Hotel/Motel : Number of Floors: \_\_\_\_\_     Rooming House: Number of Floors: \_\_\_\_\_  
 Number of Rooms: \_\_\_\_\_    Number of Rooms: \_\_\_\_\_

#### Type 2

- Liquor Store     Corner Store     Supermarket     Convenience Store
- Gas Station     Amusement/Phonograph Distributor     Recycling, Salvage or Towing
- Used Car Dealer     Personal Service Establishment  
(such as tattoo business, hair salon, tailor, etc.)     Recording Studio

What other licenses/permits will you hold at this location? (check all that apply)

- Occupancy Permit     Cigarette & Tobacco     Gas Station     Extended Hours     Class "B" Tavern     Weights & Measures
- Secondhand Dealer     Precious Metal & Gem     Other: \_\_\_\_\_

### 8. Legal Capacity (only if a Type 1 premises in #7 above)

Capacity \_\_\_\_\_ (Call the Milwaukee Development Center at 414-286-8211 if you have questions.)

## 9. Premises Description

- a. Identify all area(s) of the premises that will be used in operating this business (include areas used only for storage):  
 1<sup>st</sup> Floor  2<sup>nd</sup> Floor  Basement Storage  Patio  Beer Garden  Sidewalk Café  Deck  Rooftop  
 Other: Describe: \_\_\_\_\_
- b. Describe Location:  Major Thoroughfare  Secondary Street  Other: \_\_\_\_\_
- c. Nearest Major Cross Street: Keefe Ave
- d. Describe Building:  Free Standing Building  Strip Mall  Other: \_\_\_\_\_
- e. Describe Premises Structure:  Single Story  Multi-Story - # of Stories \_\_\_\_\_  Other: \_\_\_\_\_
- f. Describe Surrounding Area:  Commercial  Residential  Industrial  Other: \_\_\_\_\_
- g. Building Owner Name: Prakash Singh Phone Number: 414-803-2700  
 Business Owner Address: P.O. Box 461, Butler, WI 53005

## 10. Hours of Operation & Customers

Will customers be entering the premises?  No  Yes

Day of the Week	Proposed Hours of Operation:		Estimated Number of Customers expected each day	Potential Age Range of Customers	Class B Tavern Applicant Only: Age Restriction (If none, write 'None')
	Open Time (include a.m. or p.m.)	Close Time (include a.m. or p.m.)			
Sunday	8 a.m.	9 p.m.	150	35-60	
Monday	8 a.m.	9 p.m.	150	35-60	
Tuesday	8 a.m.	9 p.m.	150	35-60	
Wednesday	8 a.m.	9 p.m.	150	35-60	
Thursday	8 a.m.	9 p.m.	200	35-60	
Friday	8 a.m.	9 p.m.	300	35-60	
Saturday	8 a.m.	9 p.m.	250	35-60	

An Extended Hours Establishment license is required for any convenience store, filling station, personal service establishment (such as tattoo, body piercing, salon, tailor, tanning, etc.), recording studio or restaurant which is open between the hours of 12:00 a.m. and 5:00 a.m.

Alcohol Establishments Permitted Hours of Operation: Class A: 8:00 am to 9:00 pm Sunday thru Saturday  
 Class B: 6:00 am to 2:00 am Sunday thru Thursday, 6:00 am to 2:30 am Friday & Saturday

Entertainment Outdoor Closing Hours: 10:00pm Sunday-Thursday; 12:00am Friday & Saturday; unless a different time, either earlier or later, is established by the Common Council in its approval of the licensee's plan of operation.

## 11. Signature(s)

Swarna S  
 Signature of Sole Proprietor, Partner, or 20% or more Shareholder  
 (If there are no 20% or more shareholders,  
 Corporate Officer-print name/title and sign)

\_\_\_\_\_  
 Signature of additional partner or 20% or more shareholder

See Application Information for a complete list of all required application forms.



## ALCOHOL BEVERAGE & PUBLIC ENTERTAINMENT PREMISES SUPPLEMENTAL APPLICATION

Office of the City Clerk License Division  
200 E. Wells St. Room 105, Milwaukee, WI 53202  
(414) 286-2238 e-mail address: license@milwaukee.gov [www.milwaukee.gov/license](http://www.milwaukee.gov/license)

Legal Entity Name: FATEH 1 INC. D.B.A JACK'S LIQUOR

Premise Address: 356S/3567 NORTH TEBOWZA AVE Milwaukee, WI 53206

### Proximity of Premises to Church, School, Daycare Center or Hospital

Is the building within 300 feet of any church, school, daycare center or hospital?  No  Yes

### "Service Bar Only" Designation

If applying for Class B or C license, are you applying for "Service Bar Only"?  No  Yes

Service Bar Only means customers cannot sit at the bar. Alcohol is served to employees who serve patrons seated at tables. No stools, chairs or other articles of furniture shall be placed at the service bar for patrons to sit upon.

### Business Information

a) Are you taking out this application for anyone that may not be eligible for a license?  No  Yes

If yes, list their name and address: \_\_\_\_\_

b) Will the agent, a partner or the individual licensee be conducting the day-to-day operations of the business?  No  Yes

If no, list the name and address of the person(s) who will: \_\_\_\_\_

Class B Applicants: If the agent, a partner or the individual licensee will not be conducting the day-to-day operations of the business, the person(s) listed above must obtain a Class B Managers license.

c) Does anyone else have money invested or any other interest in this business?  No  Yes

If yes, explain: \_\_\_\_\_

d) Have you made an agreement with anyone to repay any loan or any other payments based upon income from the business?

No  Yes If yes, list name and address: \_\_\_\_\_

### Proof of Ownership, Lease, or Offer to Purchase (New & Transfer Applicants Only)

Submit proof of ownership, lease, or offer to purchase the building with this application.

A lease or offer to purchase must:

- Be in the same legal entity name as that apply for the license
- Reflect the same address as the premises address on this application
- Reflect current dates and
- Be signed by the lessor/seller and lessee/buyer

### Property Information (New & Transfer Applicants Only)

a) Do you own or lease the building?  Own  Lease

b) Who owns the fixtures (for example, coolers, etc.)? to be paid with rent on monthly basis

c) Are you purchasing the stock and/or fixtures?  No  Yes If yes, amount paid \$ 50,000

d) Total amount paid for business \$ NONE

e) Total amount paid for goodwill of the business \$ NONE

Goodwill comprises the reputation and customer relationships of an existing business. If the price you pay for the business exceeds the fair market value of all of the rest of the assets of the business, the excess may be considered goodwill.

f) Have you made arrangements with the seller for payment of personal property taxes?  No  Yes

**See Application Information for a list of all required application forms.**

**Lease Information (New & Transfer Applicants who are leasing the premises only)**

- a) Date lease begins JAN 1 2020 Ends JAN 1 2025
- b) Monthly rental \$ 9,000<sup>00</sup>
- c) Do you have an option to renew the lease?  No  Yes
- d) Does your lease allow for assignment to another party without the consent of the owner?  No  Yes
- e) For what length of time have you been guaranteed occupancy (number of years)? 5 years
- f) In addition to paying the monthly rental, will you have to pay anything additional to the owner of the building to guarantee performance of the lease?  No  Yes If yes, explain \_\_\_\_\_
- g) Does the present owner or occupancy object to the granting of your license?  No  Yes  
If yes, explain \_\_\_\_\_

**Change of Agent Applicants Only**

Have there been any changes to the floor plan since the last application was submitted?  No  Yes

If no, a new floor plan is not required. If yes, submit a new floor plan and explain the change(s): \_\_\_\_\_

**Signature**

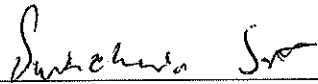

Signature of Sole Proprietor, Partner or 20% or More Shareholder  
(If no 20% or more Shareholder, Corporate Officer - print name/title and sign)

Note: All information contained in this application is subject to approval by the Common Council.  
Deviating from approved plan of operation will subject licensee to citations, and/or suspension or non-renewal of the license.  
Contact the License Division for information on how to request changes.

**New and transfer of premises applicants must submit the following:**

- Proof of ownership, lease or offer to purchase the building
- Detailed floor plan
- If a restaurant, copy of the menu



# FOOD DEALER LICENSE PLAN OF OPERATION

OFFICE OF THE CITY CLERK, LICENSE DIVISION  
 CITY HALL, 200 E. WELLS ST, ROOM 105, MILWAUKEE, WI 53202  
 (414) 286-2238 • [license@milwaukee.gov](mailto:license@milwaukee.gov) • [www.milwaukee.gov/license](http://www.milwaukee.gov/license)

Legal Entity Name: FATEH INC. D.B.A JACK'S LIQUOR

Premises Address: 3565-3567 NORTH TEUTONIA Milwaukee, WI 53206

**SECTION 1 TYPE OF BUSINESS**

What will be the majority of your food sales? (check one)

Restaurant Items (meals):  
 MEALS include, but are not limited to, chicken, ribs, sandwiches, roasted corn, baked potatoes, hot dogs, brats, tacos, nachos w/ cheese and meat, French fries, cooked or deep fried vegetables/fruit, cooked cheese curds, corn dogs, egg rolls, salads.

Retail Items (snacks and beverages):  
 RETAIL items include, but are not limited to, ice cream/soft serve, lemonade, snow cones, coffee, espresso, cappuccino, tea, fruit juice, smoothies, candy, dispensed soda, fruit cups, bakery, cookies, kettle corn, cotton candy, funnel cakes, fritters, tortilla chips w/ cheese.

Will it be a convenience store?  Yes  No

A convenience store contains less than 5,000 square feet of retail space and has, as its primary business, the sale of basic food items and in addition, sells household products or is a filling station that sells basic food items and household products.

- Bed & Breakfast
- Micro Market

All Applicants: Submit a menu or a list of food items that will be sold.

Will any wholesale business be done?  No  Yes If yes, what percentage of food sales will be wholesale?

Less than 25%

25% or More AND:

- Restaurant items (meals) will be sold – Complete this application and also contact DATCP.
- NO restaurant items (meals) will be sold - Do NOT complete this application. Contact DATCP only.

**SECTION 2 FOOD PROCESSING**

Will any food processing be done?  No  Yes

Processing is defined as assembling, grinding, cutting, mixing, baking, coating, stuffing, packing, bottling, grilling, canning, extracting, fermenting, distilling, pickling, freezing, drying, smoking, or packaging.

**SECTION 3 FOOD REQUIRING TEMPERATURE CONTROL**

Will any food that requires temperature control be sold?  No  Yes  
 (includes dairy products such as milk, cheese, and ice cream, fish, shellfish, meat, poultry)

If yes, list the types of food items: milk, cheese, ice cream, etc.

**SECTION 4 DETAILS OF OPERATION**

Will you have seating on site for dining?  No  Yes

Will you be doing any catering?  No  Yes

Will you be doing any delivery?  No  Yes

Will you have outdoor activities?  No  Yes - Check all that apply:  Bar  Cooking/Grilling  Dining

Will you have a drive thru window?  No  Yes - Are hours different from inside?  No  Yes

If Yes, provide drive thru hours: \_\_\_\_\_

Will scales or barcode scanners be used?  No  Yes - You must also apply for a Weights & Measures License.

**SECTION 5 ADDITIONAL SITES**

Where will food be prepared and/or sold?

At a single site  At multiple sites: How many? \_\_\_\_\_ (for example, a hotel with several dining rooms or bars)

If multiple sites, attach a Food Dealer Additional Site Addendum (ccl-foodadd) for each additional site.

**SECTION 6 CONSTRUCTION OR CHANGES**

Are you planning any construction, remodeling or equipment changes?

No If No, SKIP to Section 8

Yes If Yes, check all that apply:  New construction of a building  Renovation or remodeling

Construction changes to existing building  Equipment changes only

Provide a brief description of the changes: \_\_\_\_\_

Start date: \_\_\_\_\_

Name, Address & Phone Number of Architect: \_\_\_\_\_

Name, Address & Phone Number of Contractor: \_\_\_\_\_

**SECTION 7 ALCOHOL BEVERAGES**

Are you applying for an alcohol beverage license?

No If No, SKIP to Section 8

Yes If YES, if your food license is approved prior to the alcohol license, when do you want the food license issued?

Immediately  At the same time as the alcohol license

**SECTION 8 ACKNOWLEDGEMENTS & SIGNATURE**

You must initial each Item confirming your understanding:

SS ✓ I understand the Health Department must conduct an inspection and advise the License Division of their approval before the license may be issued.

SS ✓ I understand I must obtain an occupancy permit from the Department of Neighborhood Services and an inspection may be required. Neighborhood Services must advise the License Division of their approval before the license may be issued.

SS ✓ I understand the district alderperson will review and either support or object to my application. If he/she objects, I may appeal and be scheduled to appear before the Licenses Committee. The Licenses Committee will then make a recommendation to the Common Council. The Common Council must grant the license before it may be issued.

SS ✓ I understand proof of payment for all license fees must be on file in the License Division before the license may be issued and the license must be issued and posted in my establishment prior to opening for business.

SS ✓ I will not operate my food business until the license has been issued and posted in the establishment.

Signature of Sole Proprietor, Partner, or 20% Shareholder: Sanchari Singh

Signature of Additional Partner: \_\_\_\_\_





**WEIGHTS & MEASURES LICENSE  
SUPPLEMENTAL APPLICATION**

OFFICE OF THE CITY CLERK, LICENSE DIVISION  
CITY HALL, 200 E. WELLS ST, ROOM 105, MILWAUKEE, WI 53202  
(414) 286-2238 • [license@milwaukee.gov](mailto:license@milwaukee.gov) • [www.milwaukee.gov/license](http://www.milwaukee.gov/license)

Office Use Only:	
App#	_____
Filed	_____
Initials	_____
Paid	_____
Lic #	_____

Legal Entity Name: FATEH I INC. D.B.A. JACK'S LIQUOR  
 Premise Address: 3567/3565 NORTH TEUTONIA AVE MILWAUKEE, WI 53206

**Device Type(s)**

- Check all device types for which you need a license.
  - For each device type checked, indicate how many you have in the Number of Devices column (b).
  - Calculate the Total Fee Per Device Type by multiplying the Fee Per Device Type (a) by the Number of Devices (b).
  - Add all Total Fee Per Device Type amounts together and that will be your Total Fee Due.
- \* **Exception:** The Scanner fee is not per device. Check the box for the appropriate range.  
 If you have 1-3 scanners, the total due is \$130. If you have 4 or more scanners, the total due is \$250.  
 Check the Number of Devices (b).

Device Type	License Period	Fee Per Device Type (a)	Number of Devices (b)	Total Fee Per Device Type (a x b)
<b>Liquid Measuring Devices</b>				
<input type="checkbox"/> Retail Petroleum Meters	12 months	\$60		
<input type="checkbox"/> 0 to 30 gallons per minute	24 months	\$60		
<input type="checkbox"/> 31 to 200 gallons per minute	24 months	\$250		
<input type="checkbox"/> Over 200 gallons per minute	24 months	\$250		
<b>Scales</b>				
<input type="checkbox"/> Measuring any weight amount	24 months	\$55		
<b>Scanners</b>				
		Fee for scanners is by range	Check how many scanners you have	
<input checked="" type="checkbox"/> Up to 3 scanners	24 months	\$130 total*	<input type="checkbox"/> 1 <input type="checkbox"/> 2 <input checked="" type="checkbox"/> 3	
<input type="checkbox"/> Four or more scanners	24 months	\$250 total*	<input type="checkbox"/> 4 <input type="checkbox"/> Other _____	
<b>Other Devices</b>				
<input type="checkbox"/> Length Measuring Device	24 months	\$60		
<input type="checkbox"/> Timing Device	24 months	\$30		

Total Fee Due \$ 130.00

**Signature**

I hereby agree that I will comply with the applicable sections of the Wisconsin State Statutes, Administrative Code and the Milwaukee Code of Ordinances regarding the operation of weighing and measuring devices.

I understand that all devices must be operated within the specifications, tolerances and other technical requirements set forth in the National Institute of Standards and Technology Handbook 44. I understand that the license for which I am applying must be posted on the premises or in my vehicle prior to opening for business or operating the device.

I understand that these device licenses are not transferable (with the exception of scanners). If the device is replaced or needs to be resealed, I must apply for and receive a new license so that an inspection of the device can be performed prior to its use.

I acknowledge that as a condition of being issued this license, I must allow the Health Department into the establishment to test the device to validate its specifications/tolerances. If my devices are found out of compliance, I may be charged inspection fees.

I have read, understand, and will adhere to all the above acknowledgments.

Signature of Sole Proprietor, Partner, or 20% or more Shareholder  
(If there are no 20% or more shareholders, Corporate Officer-print name/title and sign)

Signature of additional partner or 20% or more shareholder

This form must be submitted with the Business License Application, Weights & Measures Plan of Operation, and appropriate fee. Forms can be obtained online at [www.milwaukee.gov/licenses](http://www.milwaukee.gov/licenses).



# WEIGHTS & MEASURES PLAN OF OPERATION

ccl-wmplan 1/9/18

Office of the City Clerk License Division  
200 E. Wells St. Room 105, Milwaukee, WI 53202  
(414) 286-2238 [www.milwaukee.gov/license](http://www.milwaukee.gov/license) [license@milwaukee.gov](mailto:license@milwaukee.gov)

Legal Entity Name: FATEH 1 INC. D.B.A. JACK'S LIQUOR.  
Premise Address: 3565/3567 NORTH TEUTONIA Ave Milwaukee, WI 53206

## Type of Business

Provide a brief description of the establishment/business: LIQUOR STORE selling household items, Grocery, beverages, health and beauty products, etc.

Other licenses may be required depending on the type of business you are operating.

## Litter & Noise

- a. How are grounds kept clean?  Sweep  Pressure Wash  Pick Up Litter  Other: As needed
- b. How often will grounds be cleaned?  Daily  Weekly  As Needed  Monthly  Other: As needed
- c. Grounds cleaned by:  Licensee  Building Owner  Employees  Hired Maintenance  Other: As needed
- d. How are noise issues prevented and/or addressed?  Security  Manager approaches customer(s)  Call Police  
 Signs Posted  Other: As needed

## Signature

[Signature]  
Signature of Sole Proprietor, Partner, or 20% or more Shareholder  
(If there are no 20% or more shareholders,  
Corporate Officer-print name/title and sign)

\_\_\_\_\_  
Signature of additional partner or 20% or more shareholder

This form must be submitted with the Business License Application, Weights & Measures License Supplemental Application, and appropriate fee. Forms can be obtained online at [www.milwaukee.gov/licenses](http://www.milwaukee.gov/licenses).

N. TEUTONIA AVENUE

EXIT APPROACH

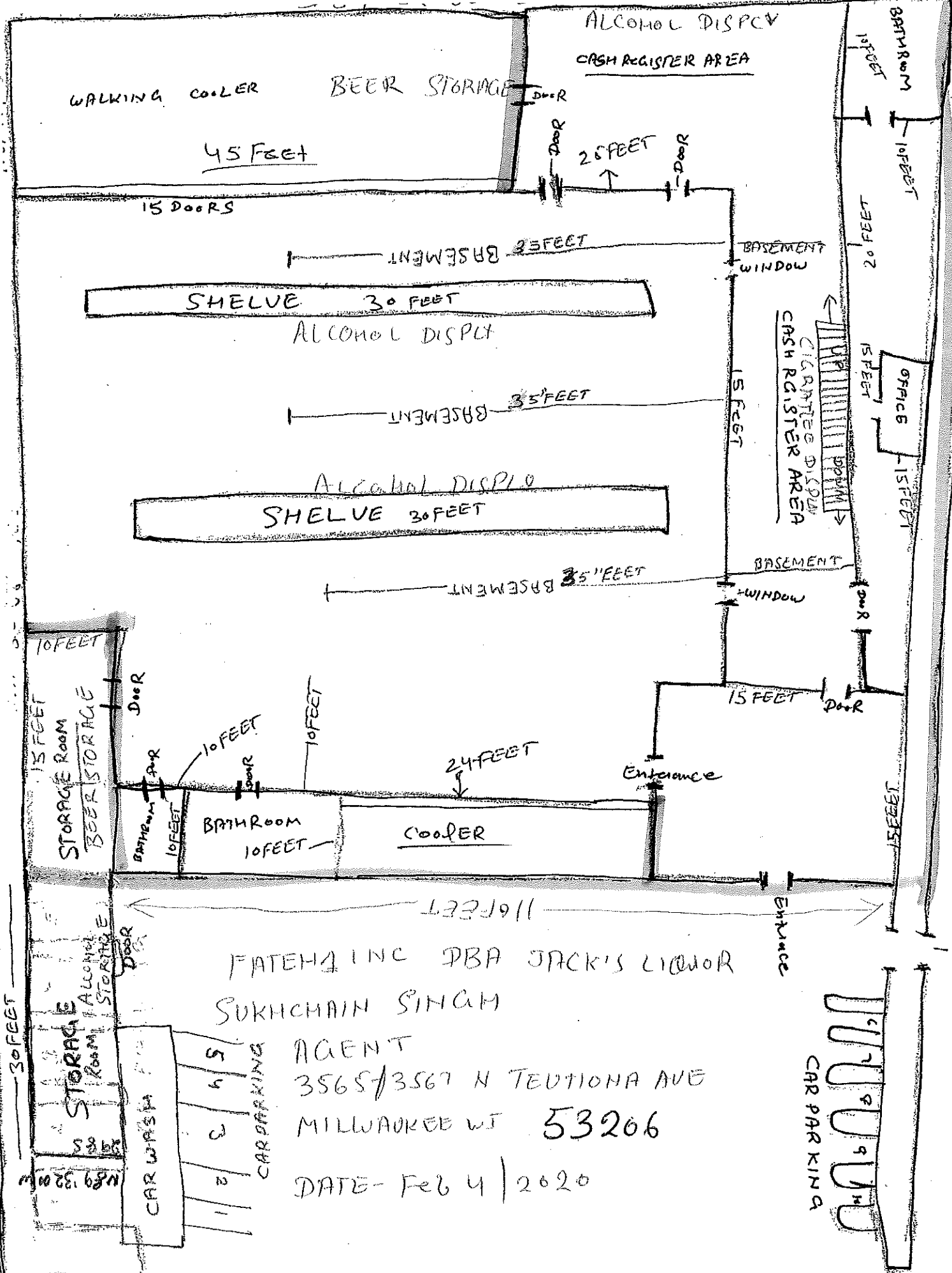

FATEH INC DBA JACK'S LIQUOR  
 SUKHCHAIN SINGH

AGENT  
 3565/3567 N TEUTONIA AVE  
 MILWAUKEE WI 53206

DATE - Feb 4 / 2020

