



CITY OF MILWAUKEE
OFFICE OF THE CITY CLERK

Thursday, September 16, 2021

COMMITTEE MEETING NOTICE

AD 03

PLENNES, Amy R, Agent
The National, LLC
1784 Elm Av

South Milwaukee, WI 53172

You are requested to attend a virtual hearing to be held on:

Tuesday, September 28, 2021 at 11:35 AM

Regarding: Your Class B Tavern, Food Dealer, and Sidewalk Dining License Applications as agent for "The National, LLC" for "The LaFayette Place" at 1978 N Farwell Av.

This meeting will be held via GoToMeeting. Please see the enclosed  best practices document for further instructions. The access code is <https://global.gotomeeting.com/join/284170701>. If you wish to call in, please call +1 (786) 535-3211 and use Access Code: 284-170-701.

There is a possibility that your application may be denied for one or more of the following reasons: The recommendation of the committee regarding the application shall be based on evidence presented at the hearing. Per MCO 85-2.7-4, probative evidence concerning whether or not a new license should be granted may be presented on the following subjects: whether or not the applicant meets the municipal requirements, the appropriateness of the location and premises where the licensed premises is to be located and whether use of the premises for the purposes or activities permitted by the license would tend to facilitate a public or private nuisance or create undesirable neighborhood problems such as disorderly patrons, unreasonably loud noise, litter, and excessive traffic and parking congestion. Probative evidence relating to these matters may be taken from the plan of operation submitted with the license application, if any, but shall not include the content of any music. Evidence regarding the fitness of the location of the premises to be maintained as the principal place of business, including but not limited to whether there is an overconcentration of businesses of the type for which the license is sought; whether the proposal is consistent with any pertinent neighborhood business or development plans, or the location's proximity to areas where children are typically present. The applicant's record in operating similarly licensed premises; and whether or not the applicant has been charged with or convicted of any felony, misdemeanor, municipal offense or other offense, the circumstances of which substantially relate to the activity to be permitted by the license being applied for or any other factor which reasonably relates to the public health, safety or welfare may also be considered. See attached police report or correspondence.

Notice for applicants with warrants or unpaid fines:

Proof of warrant satisfaction or payment of fines must be submitted at the hearing on the above date and time. Failure to comply with this requirement may result in a delay of the granting/denial of your application.

Failure to attend this meeting may result in the denial of your license. Individual applicants and partnership applicants must attend or attend by an attorney. The agent or attorney for corporate or limited liability applicants must attend. If you wish to do so and at your own expense, you may be accompanied by an attorney of your choosing to represent you at this hearing.

You will be given an opportunity to speak on behalf of the application and to respond and challenge any charges or reasons given for the denial. No petitions can be accepted by the committee, unless the people who signed the petition attend the virtual hearing and are willing to testify. You may present witnesses under oath and you may also confront and cross-examine opposing witnesses under oath. If you have difficulty with the English language, you should request an interpreter attend the meeting with you, at your expense, so that you can answer questions and participate in your hearing.

PLEASE NOTE: Upon reasonable notice, efforts will be made to accommodate the needs of disabled individuals through sign language interpreters or other auxiliary aids. For additional information or to request this service, contact the Council Services Division ADA Coordinator at (414) 286-2998, Fax - (414) 286-3456, TDD - (414) 286-2025.

JIM OWCZARSKI, CITY CLERK

BY: _____

Jim Cooney

License Division Manager

If you have questions regarding this meeting, please contact the staff assistant, Molly Kuether-Steele at (414) 286-2775 or molly.kuether-steele@milwaukee.gov.

200 E. Wells Street, Room 105, City Hall, Milwaukee, WI 53202. www.milwaukee.gov/license
Phone: (414) 286-2238 Fax: (414) 286-3057 Email Address: License@milwaukee.gov

Date: September 3, 2021
Officer: Carlos Felix

City of Milwaukee Police Department
90-5-1.5 Crime Prevention Survey
Tavern Inspection

Name of Premise: Lafayette Place
Address: 1978 N. Farwell Av.
Phone:

Owner:
Owner address:
City State Zip:
Owner Phone:
Owner email:

Licensee/Agent: Amy Plennes (P452-0168-2850-03)
Home Address: 1784 Elm Av
City State Zip: South Milwaukee, WI 53172
Phone: 414-861-0731
Email: Amy@nationaleats.com

Preferred contact: Same

Location currently open: YES NO

Projected open date: Oct 2021

Day's open: S M T W Th F SA ALL

Hours of Operation: Sun: 8:30A - 2:00PM 24 hours Y N
Mon:
Tue:
Wed:
Thu: 8:30A - 2:00PM
Fri: 8:30A - 2:00PM
Sat: 8:30A - 2:00PM

Premise Type: Tavern/Bar
 Restaurant
 Other:

Licenses currently held:

- Alcohol: Yes No Class: #:
Tobacco: Yes No #:
Food: Yes No #:
Occupancy: Yes No #:
Other: Yes No Type: #:
Other: Yes No Type: #:

Exterior Survey:

1. Is the area around the location clean? Yes No
2. What surrounds the location? (Check all the apply)
 - a. Park
 - b. School
 - c. Youth Center
 - d. Church
 - e. Tavern(s) If so, how many
 - f. Residential
 - g. Other businesses
 - h. Other:
3. Can you see from the outside of the location into the interior Yes No
4. Can you see the employees inside of the location from the outside Yes No
5. Are exterior windows free of signage Yes No
6. Is there a bus stop? Yes No
7. Is there a bus shelter? Yes No N/A
8. Street parking Yes No
9. Is there a parking lot Yes No
10. Is the parking lot clean? Yes No N/A
11. Is the parking lot well lit? Yes No N/A
12. Valet Parking Yes No
 - a. Will this lot have a guard? Yes No N/A
 - b. Will this lot have cameras? Yes No N/A
13. Are there areas where a person could conceal themselves Yes No
14. Is there exterior lighting? Yes No. Does it appears to be adequate Yes No
15. Exterior Payphone? Yes No
16. Are there No Loitering Signs posted? Yes No
17. Are there exterior security cameras Yes No How Many:
18. Are the address numbers prominently displayed and easy to see Yes No

Exterior Comments:

Camera Survey:

19. Does this location have security cameras? Yes No
20. Are they in working order? Yes No
21. What format are the cameras?
 - a. Color Yes No
 - b. Digital Yes No
 - c. VCR Yes No

- d. Recorded Yes No
22. How long is footage stored for later viewing: 30 Days
23. Are there exterior cameras Yes No How many:
24. Are there interior cameras Yes No How many: 2
25. Do all employees know how to retrieve recorded digital images/footage? Yes No
26. Cameras located in parking lot Yes No N/A How many

Camera Survey Comments:

Interior Survey:

27. What is the planned/posted capacity 26
28. What is the minimum number of employees that will be on premise 4
29. Is the storeowner willing to be a standing complainant regarding loitering? Yes No
- a. If yes have them fill out the standing complaint form and give them two of the commercial signs Yes No
30. Is the interior of the location neat and clean? Yes No
31. Does an interior camera face the entrance/exit? Yes No
32. Are emergency and non-emergency numbers posted near the phone? Yes No
33. Does the owner know how to contact their police district directly? Yes No
- a. Did you provide a district contact guide to the owner? Yes No

Interior Comments:

Security

34. How many security personnel are going to be employed: N/A
35. How will they be deployed: Interior Exterior N/A
36. What days will they be deployed Mon Tue Wed Thu Fri Sat Sun ALL
37. Will the security be managed by business or contracted
38. Will they be armed Yes No N/A
39. What type of security measures will be used: N/A
- Wanding/metal detector
 - ID Scanner
 - Dress Code
 - Cover Charge
 - Age restriction
 - Other Check ID's for drinks
40. When at capacity, how will the overflow crowd be managed? Wait outside or leave number for call back when a table is available
41. Will a guard monitor the overflow crowd at all times? Yes No

Security Comments:

ADDITIONAL COMMENTS/RECOMMENDATIONS:

This report submitted by Officer Carlos Felix assigned to District One, Early Shift. On September 3, 2021 at 12:00PM the CPTED was conducted at the property which is a mix use building with the business at street level. At the time of the inspection the space was under minor construction. The two public space cameras were removed for painting, but one will be reinstalled facing the entrance and a second the cash register. There is a camera in the kitchen

area and a one in a space used as an office. I advised that the hard drive should be in a secured area. A safe will be affixed in the office to secure currency. The business was a café known as Celesta but is currently closed and the new agent taking over the lease plans to open her second location in the space. The business will remain a café and only have a limited selection of alcoholic beverages. They will only serve Bloody Mary's and prepackaged wines. The agent was given a self-stick card with the nonemergency and 911 numbers printed on them.
End of inspection.



1978 N Farwell Av

Area of Interest (AOI) Information

Area : 21,862,585.85 ft²

Aug 25 2021 12:02:31 Central Daylight Time

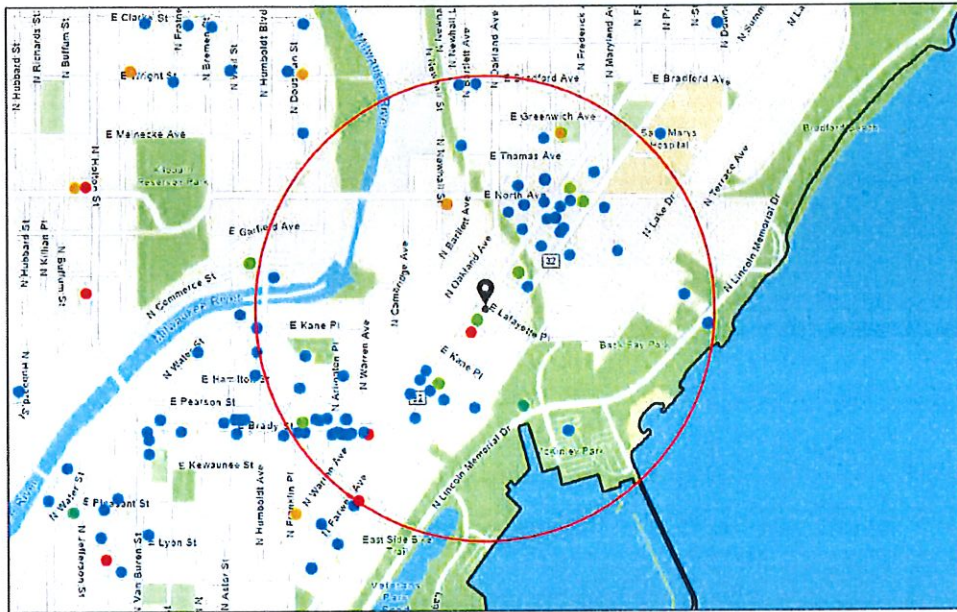

- Alcohol Licenses
- Class A Intoxicating Liquor
- Class A Fermented Malt Beverage
- Class A Liquor and Mall
- Class B Fermented Malt Beverage
- Class B Tavern
- Class C Wine Retailer
- ▭ City Limits

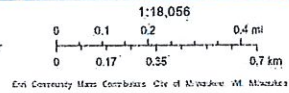

Summary

Name	Count	Area(ft ²)	Length(mi)
Alcohol Licenses	83		

Alcohol Licenses

#	Legal Entity	Trade Name	Licensee	Address	License Type Name	Total Capacity	Expiration Date	Count
1	The Original MKE, LLC	The Original	Eric E Rzepka, Agt	2498 N Bartlett AV	Class B Tavern License	99	9/3/2021, 7:00 PM	1
2	Kawa Ramen & Sushi Inc	Kawa	LinJin Xiao, Agt	2321-23 N Murray AV	Class B Tavern License		9/12/2021, 7:00 PM	1
3	Strange Town, LLC	Strange Town	Andrew J Noble, Agt	2101-2103 N Prospect AV	Class B Tavern License	49	9/23/2021, 7:00 PM	1
4	Ardent Milwaukee, LLC	Ardent	Justin K Carlisle, Agt	1749-51 N Farwell AV	Class B Tavern License		10/13/2021, 7:00 PM	1
5	Colectivo Coffee Roasters Inc	Colectivo Coffee Roasters Inc	William D Suskey, Agt	2211 N Prospect AV	Class B Tavern License	299	10/17/2021, 7:00 PM	1
6	SEOUL KOREAN RESTAURANT	SEOUL KOREAN RESTAURANT	HAE JIN PARK, SP	2178 N PROSPECT AV	Class B Tavern License		9/20/2021, 7:00 PM	1
7	Yangzi, LLC	Huan Xi	Jun Yang, Agt	2428 N Murray AV	Class B Fermented Malt Beverage Retailer's License		10/31/2021, 7:00 PM	1
8	EE SANE THAI LAO CUISINE	EE SANE THAI LAO CUISINE	Prasith Nanthasane, SP	1806 N FARWELL AV	Class B Tavern License		10/28/2021, 7:00 PM	1
9	Yangzi, LLC	Huan Xi	Jun Yang, Agt	2428 N Murray AV	Class C Wine Retailer's License		10/31/2021, 7:00 PM	1
10	FAMOUS CIGAR, LLC	FAMOUS CIGAR	JOHN PIETTE, Agt	1213 E BRADY ST	Class B Tavern License		10/11/2021, 7:00 PM	1
11	Mari Corp	Merge	Karandeep S Randhawa, Agt	1932 E KENILWORTH PL	Class B Tavern License	99	11/13/2021, 6:00 PM	1
12	The Jazz Estate Inc	The Jazz Estate	JOHN M DYE, Agt	2423 N MURRAY AV	Class B Tavern License	65	12/14/2021, 6:00 PM	1
13	Charles Allis and Villa Terrace Museums, Inc.	Charles Allis Art Museum	John C Sterr, Agt	1801 N PROSPECT AV	Class B Tavern License	99	11/29/2021, 6:00 PM	1
14	Charles Allis and Villa Terrace Museums, Inc.	Villa Terrace Decorative Arts Museum	John C Sterr, Agt	2220 N TERRACE AV	Class B Tavern License	85	11/29/2021, 6:00 PM	1
15	Stone Bowl Grill, LLC	Stone Bowl	Young B Kim, Agt	1958-62 N Farwell AV	Class B Tavern License	99	12/15/2021, 6:00 PM	1
16	Door County Brewing Co, LLC	Hacienda Beer Co	Adam R Miller, Agt	2018 E North AV	Class C Wine Retailer's License	240	11/24/2021, 6:00 PM	1
17	FOUR STAR INC OF MILWAUKEE	MURRAY PANTRY	MURAD M ALI, Agt	2430 N MURRAY AV	Class A Fermented Malt Beverage Retailer's License		1/14/2022, 6:00 PM	1

18	Lazy Tiger Group LLC	Easy Tyger Restaurant	NONGLUK BURANABUN YUT, Agt	1230 E Brady ST	Class B Tavern License		1/28/2022, 6:00 PM	1
19	Izzy Hops LLC	Izzy Hops	MICHAEL J VITUCCI, Agt	2311 N Murray AV	Class B Tavern License		2/6/2022, 6:00 PM	1
20	EI Grupo J & K, LLC	Judy's on North / EI Grupo J & K	Kevin I Lopez, Agt	2207 E North AV	Class B Tavern License		2/3/2022, 6:00 PM	1
21	Saint John's Communities, Inc	Saint John's on the Lake	Renee E Anderson, Agt	1840 N PROSPECT AV	Class B Tavern License		2/3/2022, 6:00 PM	1
22	APOLLO CAFE	APOLLO CAFE	PETER A LIMBERATOS, VIVIAN ANTON-LIMBERATOS	1310 E BRADY ST	Class B Tavern License	100	12/19/2021, 6:00 PM	1
23	Lin & Chen Fushimi, LLC	Fushimi Sushi Seafood Buffet	Gui Lin, Agt	2116 N Farwell AV	Class B Tavern License		1/19/2022, 6:00 PM	1
24	ETHIOPIAN COTTAGE RESTAURANT, INC	ETHIOPIAN COTTAGE RESTAURANT	YITLETU DEBEBE, Agt	1824 N FARWELL AV	Class B Fermented Malt Beverage Retailer's License	75	1/14/2022, 6:00 PM	1
25	ETHIOPIAN COTTAGE RESTAURANT, INC	ETHIOPIAN COTTAGE RESTAURANT	YIGLETU DEBEBE, Agt	1824 N FARWELL AV	Class C Wine Retailer's License		1/14/2022, 6:00 PM	1
26	ZAFFIRO BROS, INC	ZAFFIRO'S PIZZA	MICHAEL J ZAFFIRO, Agt	1724 N FARWELL AV	Class B Tavern License	25	1/25/2022, 6:00 PM	1
27	Krikar LLC	Koppa's Fulbeli Deli	Karthik B Pothumachi, Agt	1940 N FARWELL AV	Class A Malt & Class A Liquor License		2/26/2022, 6:00 PM	1
28	Ian's Pizza Milwaukee, LLC	Ian's Pizza Milwaukee	Ryan W Donovan, Agt	2035 E NORTH AV	Class B Fermented Malt Beverage Retailer's License		3/1/2022, 6:00 PM	1
29	Fink's of Milwaukee, Inc	Fink's	KRISTYN A Eitel, Agt	1875 N Humboldt AV	Class B Tavern License	80	2/20/2022, 6:00 PM	1
30	Ian's Pizza Milwaukee, LLC	Ian's Pizza Milwaukee	Ryan W Donovan, Agt	2035 E NORTH AV	Class C Wine Retailer's License		3/1/2022, 6:00 PM	1
31	Erth Wellness, LLC	Kind Oasis	Salem J Kashou, Agt	2169 N FARWELL AV	Class B Tavern License		2/7/2022, 6:00 PM	1
32	MILAP, INC	SMITH BEER & LIQUOR MART	AMARJIT S KALSEY, Agt	1413 E BRADY ST	Class A Malt & Class A Liquor License		3/21/2022, 7:00 PM	1
33	Colectivo Coffee Roasters Inc	Colectivo Coffee Roasters Inc	William D Suskey, Agt	1701 N LINCOLN MEMORIAL DR	Class B Fermented Malt Beverage Retailer's License		3/29/2022, 7:00 PM	1
34	SPTresto, LLC	Rice N Roll Bistro	Bundid Muangsiri, Agt	1952 N Farwell AV	Class B Fermented Malt Beverage Retailer's License		3/29/2022, 7:00 PM	1

35	PIZZA SHUTTLE, INC	PIZZA SHUTTLE	MARK H, GOLD, Agt	1827 N Farwell AV	Class B Tavern License	150	3/6/2022, 6:00 PM	1
36	JAMOHEAD, INC	JAMO'S	JAMISON H GOLL, Agt	1800 N ARLINGTON PL	Class B Tavern License	25	3/24/2022, 7:00 PM	1
37	MJE, INC	HI HAT LOUNGE & GARAGE	LESLIE S MONTEMURRO, Agt	1701-03 N ARLINGTON PL	Class B Tavern License	159	9/27/2021, 7:00 PM	1
38	PADDY'S PET & PUB, LLC	PADDY'S PET & PUB	ORLEN G WOOD, Agt	2339-A N MURRAY AV	Class B Tavern License	179	3/1/2022, 6:00 PM	1
39	SPTresto, LLC	Rice N Roll Bistro	Bundid Muangsiri, Agt	1952 N Farwell AV	Class C Wine Retailer's License		3/29/2022, 7:00 PM	1
40	NOMADIC VENTURES, INC	NOMAD WORLD PUB	MICHAEL J EITEL, Agt	1401 E BRADY ST	Class B Tavern License	99	3/8/2022, 6:00 PM	1
41	Saz's Catering Inc	Jan Serr Studio	Stephanie L Sazama-Schneck, Agt	2155 N Prospect AV	Class B Tavern License		4/4/2022, 7:00 PM	1
42	GPJ OF MILWAUKEE, INC	MA FISCHER'S	HEIDI A PANAGIOTOP OULOS, Agt	2214 N FARWELL AV	Class B Tavern License	240	4/11/2022, 7:00 PM	1
43	Sorivilla Inc	Kompali	KARLOS J SORIANO, Agt	1205 E Brady ST	Class B Tavern License	99	3/21/2022, 7:00 PM	1
44	PROSPECTOR PARTNERSHIP LLC	VINTAGE	REBECCA E GODFREY, Agt	2203 N PROSPECT AV	Class B Tavern License	151	4/10/2022, 7:00 PM	1
45	LANDMARK BARS, INC	LANDMARK LANES	SLAVA TUZHILKOV, Agt	2220 N FARWELL AV	Class B Tavern License	240	4/11/2022, 7:00 PM	1
46	Crossroads Collective, LLC	Crossroads Collective	TIM B GOKHMAN, Agt	2238 N Farwell AV	Class B Tavern License		12/10/2021, 6:00 PM	1
47	BUSSEN MARSHALL LLC	Pete's Pub	PETER R MARSHALL, Agt	1234 E BRADY ST	Class B Tavern License		4/20/2022, 7:00 PM	1
48	JC Capital Dorsia LLC	Dorsia	JENO J CATALDO, Agt	1301-07 E Brady ST	Class B Tavern License	199	4/24/2022, 7:00 PM	1
49	JC CAPITAL SAINT BIBIANA LLC	St. Bibiana/St. Bibi	JENO J CATALDO, Agt	1327 E BRADY ST	Class B Tavern License		4/28/2022, 7:00 PM	1
50	Bharat Enterprise, Inc	Bharat Mart	RAVI SACHDEVA, Agt	1556 N Farwell AV	Class A Malt & Class A Liquor License		5/2/2022, 7:00 PM	1
51	Nine Below Inc	Nine Below	Marla R Poytinger, Agt	1905 E North AV	Class B Tavern License	270	5/30/2022, 7:00 PM	1
52	Splash Studio Inc.	Splash Studio Inc.	Marla R Poytinger, Agt	1815 E Kenilworth PL	Class B Tavern License		5/30/2022, 7:00 PM	1
53	Stubby's Gastrogrub LLC	Stubby's Gastrogrub & Beer Bar	BRADLEY H TODD, Agt	2060 N HUMBOLDT AV	Class B Tavern License	410	5/23/2022, 7:00 PM	1

54	Axe MKE, Inc	Axe MKE	Marla R Poytinger, Agt	1924 E KENILWORTH PL	Class B Tavern License		5/30/2022, 7:00 PM	1
55	DP Hospitality Group LLC	Tavolino	Peter J Dietrich, Agt	2315 N MURRAY AV	Class B Tavern License	99	5/26/2022, 7:00 PM	1
56	Dairyland Retail Group LLC	7-Eleven #35852B	Elizabeth J Evans, Agt	1609 E NORTH AV	Class A Retailer's Intoxicating Liquor License		6/14/2022, 7:00 PM	1
57	Dairyland Retail Group LLC	7-Eleven #35852B	Elizabeth J Evans, Agt	1609 E NORTH AV	Class A Fermented Malt Beverage Retailer's License		6/14/2022, 7:00 PM	1
58	Jack's American Pub, LLC	Jack's American Pub	SCOTT A SCHAEFER, Agt	1323 E Brady ST	Class B Tavern License	240	6/30/2022, 7:00 PM	1
59	HOOLIGAN'S SUPER IRISH DELI & BAR, INC	HOOLIGAN'S	MARK B BUESING, Agt	2017 E NORTH AV	Class B Tavern License	118	6/29/2022, 7:00 PM	1
60	VITUCCI'S, INC	VITUCCI'S COCKTAIL LOUNGE	Julie A Vitucci, Agt	1832 E NORTH AV	Class B Tavern License	160	7/7/2022, 7:00 PM	1
61	Black Gate LLC	Von Trier	MARK A ZIERATH, Agt	2235 N Farwell AV	Class B Tavern License	153	6/13/2022, 7:00 PM	1
62	OCTOPUS, LTD	WOLSKI'S TAVERN	DENNIS BONDAR, Agt	1836 N PULASKI ST	Class B Tavern License	80	6/29/2022, 7:00 PM	1
63	BENJAMIN'S FINE WINE & SPIRITS LLC	Waterford Wine Company	BENJAMIN T CHRISTIANS EN, Agt	2120 N FARWELL AV	Class B Tavern License		6/18/2022, 7:00 PM	1
64	Sip & Purr LLC	Sip & Purr Cat Cafe	Katherine E McHugh, Agt	2021 E Ivanhoe PL	Class B Tavern License		6/14/2022, 7:00 PM	1
65	CHAMPION'S PUB, LLC	CHAMPION'S PUB	ROBERT R GREENYA, Agt	2417 N BARTLETT AV	Class B Tavern License	148	6/28/2022, 7:00 PM	1
66	JOEY C'S, INC	JO-CAT'S PUB	PATRICIA A CATALDO, Agt	1311 E BRADY ST	Class B Tavern License	220	6/29/2022, 7:00 PM	1
67	IFM Farwell LLC	Oriental Theatre	Kristen C Heller, Agt	2230 N FARWELL AV	Class B Tavern License	1,834	7/23/2022, 7:00 PM	1
68	Good City Brewing LLC	Good City Brewing	David C Dupee, Agt	2108 N Farwell AV	Class C Wine Retailer's License		7/28/2022, 7:00 PM	1
69	BEANS & BARLEY, INC	BEANS & BARLEY	JAMES C NEUMEYER, Agt	1901 E NORTH AV	Class B Tavern License	180	6/29/2022, 7:00 PM	1
70	M P ON BRADY, INC	CLUB BRADY	MICHAEL D LEE, Agt	1339 E BRADY ST	Class B Tavern License	143	6/29/2022, 7:00 PM	1
71	MILWAUKEE YACHT CLUB	MILWAUKEE YACHT CLUB	Matthew F Michael, Agt	1700 N LINCOLN MEMORIAL DR	Class B Tavern License	180	7/5/2022, 7:00 PM	1

72	Smith Sisters, LLC	Brewed Cafe	SHEILA M PUF AHL-BETTIN, Agt	1208 E Brady ST	Class B Fermented Malt Beverage Retailer's License		6/13/2022, 7:00 PM	1
73	Smith Sisters, LLC	Brewed Cafe	SHEILA M PUF AHL-BETTIN, Agt	1208 E Brady ST	Class C Wine Retailer's License		6/13/2022, 7:00 PM	1
74	ROCHAMBO, LTD	ROCHAMBO COFFEE & TEA HOUSE	MICHAEL R HONKAMP, II, Agt	1317 E BRADY ST	Class B Tavern License	110	6/13/2022, 7:00 PM	1
75	WHOLE FOODS MARKET GROUP, INC	WHOLE FOODS MARKET	Brooke M Remitz, Agt	2305 N PROSPECT AV	Class B Tavern License		6/13/2022, 7:00 PM	1
76	TKCS Brady LLC	The King Crab Shack	Tam Ngo, Agt	1330 E Brady ST	Class B Tavern License		9/20/2021, 7:00 PM	1
77	Dock Bradford, LLC	The Dock at Bradford Beach	BRIAN C RANDALL, Agt	2400 N Lincoln Memorial DR	Class B Tavern License		7/26/2022, 7:00 PM	1
78	J & S Malone, LLC	Malone's on Brady	JOSHUA L MALONE, Agt	1329 E BRADY ST	Class B Tavern License	80	7/21/2022, 7:00 PM	1
79	1754 NFRANKLINBAR LLC	The Standard Tavern	STEPHEN G GILBERTSON, Agt	1754 N FRANKLIN PL	Class B Tavern License	78	8/1/2022, 7:00 PM	1
80	MOOSA BURGER, INC.	Moosa's	ALAA I MUSA, Agt	2272 N LINCOLN MEMORIAL DR	Class B Tavern License		7/28/2022, 7:00 PM	1
81	Kawa Ramen & Sushi Inc	Kawa	LinJin Xiao, Agt	2321-23 N Murray AV	Class B Tavern License		9/12/2022, 7:00 PM	1
82	WV, LLC	TESS	MITCHELL D WAKEFIELD, Agt	2499 N BARTLETT AV	Class B Tavern License	60	7/30/2022, 7:00 PM	1
83	Hangout MKE Cafe & Lounge Co	Hangout MKE	Rebecca M Riddle, Agt	1819 N Farwell AV	Class B Tavern License	150	8/7/2022, 7:00 PM	1

Establishments within a 0.5 miles radius centered on area of interest.



Thursday, September 16, 2021

Licenses Committee Notice of Hearing

Alice Abu's LLC
168 W CLOVERNOOK Ln
Glendale, WI 53217

The Licenses Committee will consider the following license application:

Class B Tavern, Food Dealer, and Sidewalk Dining License Applications
PLENNES, Amy R, Agent
The LaFayette Place at 1978 N Farwell Av

Date: 9/28/2021

Time: 11:35 AM

Location: The hearing before the Licenses Committee will take place virtually on Tuesday, September 28, 2021. This is a public hearing. Those wishing to view the proceeding are able to do so via the City Channel – Channel 25 on Spectrum Cable – or on the Internet at <http://city.milwaukee.gov/citychannel>. Those wishing to provide oral testimony will be asked to do so by phone or internet and are asked to contact the staff assistant, Molly Kuether-Steele at (414) 286-2775 or molly.kuether-steele@milwaukee.gov for necessary information. Please make such requests no later than one business day prior to the start of the meeting. You are not required to attend the hearing, but please see the information below if you would like to provide testimony

Please note this application may be recommended for denial based on fitness of the location due to concentration of alcohol beverage outlets in the area. If the application is denied for this reason, no other application for an alcohol beverage license for this location shall be recommended for approval by the Licenses Committee within three years of the date of denial unless the applicant has demonstrated a change of circumstances since the prior denial.





Thursday, September 16, 2021



Notice of Public Hearing

blank
notice

PLENNES, Amy R, Agent
The LaFayette Place at 1978 N Farwell Av
Class B Tavern, Food Dealer, and Sidewalk Dining License Applications

Tuesday, September 28, 2021 at 11:35 AM

To whom it may concern:

The above application has been made by the above named applicant(s). This requires approval from the Licenses Committee and the Common Council of the City of Milwaukee. The hearing before the Licenses Committee will take place virtually on 9/28/2021 at 11:35 AM. This is a public hearing. Those wishing to view the proceeding are able to do so via the City Channel – Channel 25 on Spectrum Cable – or on the Internet at <http://city.milwaukee.gov/citychannel>. Those wishing to provide oral testimony will be asked to do so by phone or internet and are asked to contact the staff assistant, Molly Kuether-Steele at (414) 286-2775 or molly.kuether-steele@milwaukee.gov for necessary information. Please make such requests no later than one business day prior to the start of the meeting. You are not required to attend the hearing, but please see the information below if you would like to provide testimony. Once the Licenses Committee makes its recommendation, this recommendation is forwarded to the full Common Council for approval at its next regularly scheduled hearing.

Important details for those wishing to provide information for the Licenses Committee to consider when making its recommendation:

1. The license application is scheduled to be heard at the above time. Due to other hearings running longer than scheduled, you may have to wait some time to provide your testimony.
2. You must testify as to matters that you have personally experienced or seen. (You cannot provide testimony for your neighbor, parent or anyone else; this is considered hearsay and cannot be considered by the committee.)
3. No letters or petitions can be accepted by the committee (unless the person who wrote the letter or the persons who signed the petition are willing to testify).
4. Persons opposed to the license application are given the opportunity to testify first; supporters may testify after the opponents have finished.
5. When you are called to testify, you will be sworn in and asked to give your name, and address. (If your first and/or last names are uncommon please spell them.)
6. You may then provide testimony.
 - a. Include only information relating to the above license application.
 - b. Include only information you have personally witnessed or seen.
 - c. Provide concise and relevant information detailing how this business has affected or may affect the peaceful enjoyment of your neighborhood.
 - d. If by the time you have the opportunity to testify, the information you wish to share has already been provided to the committee, you may state that you agree with the previous testimony. Redundant or repetitive testimony will not assist the committee in making its recommendation.
7. After giving your testimony, the members of the Licenses Committee and the licensee may ask questions regarding the testimony you have given or other factors relating to the license application.
8. Business Competition is not a valid basis for denial or non-renewal of a license.

Please Note: If you have submitted an objection to the above application your objection cannot be considered by the committee unless you personally testify at the hearing.

OCCUPANT	MAIL ADDRESS	CITY STATE ZIP
BUSINESS OCCUPANT	1706 E IRVING PL	MILWAUKEE, WI 53202-1458
BUSINESS OCCUPANT	1721 E LAFAYETTE PL, 1	MILWAUKEE, WI 53202-1194
BUSINESS OCCUPANT	1721 E LAFAYETTE PL, 2	MILWAUKEE, WI 53202-1194
BUSINESS OCCUPANT	1721 E LAFAYETTE PL, 3	MILWAUKEE, WI 53202-1194
BUSINESS OCCUPANT	1721 E LAFAYETTE PL, 4	MILWAUKEE, WI 53202-1194
BUSINESS OCCUPANT	1721 E LAFAYETTE PL, 5	MILWAUKEE, WI 53202-1194
BUSINESS OCCUPANT	1721 E LAFAYETTE PL, 6	MILWAUKEE, WI 53202-1194
BUSINESS OCCUPANT	1803 E LAFAYETTE PL	MILWAUKEE, WI 53202-1160
BUSINESS OCCUPANT	1952 N FARWELL AVE	MILWAUKEE, WI 53202-1466
BUSINESS OCCUPANT	1956 N FARWELL AVE	MILWAUKEE, WI 53202-1466
BUSINESS OCCUPANT	1958 N FARWELL AVE	MILWAUKEE, WI 53202-1466
BUSINESS OCCUPANT	1977 N FARWELL AVE, 1	MILWAUKEE, WI 53202-1480
BUSINESS OCCUPANT	1977 N FARWELL AVE, 2	MILWAUKEE, WI 53202-1480
BUSINESS OCCUPANT	1977 N FARWELL AVE, 3	MILWAUKEE, WI 53202-1480
BUSINESS OCCUPANT	1977 N FARWELL AVE, 4	MILWAUKEE, WI 53202-1480
BUSINESS OCCUPANT	1977 N FARWELL AVE, 5	MILWAUKEE, WI 53202-1480
BUSINESS OCCUPANT	1978 N FARWELL AVE	MILWAUKEE, WI 53202-1466
BUSINESS OCCUPANT	2000 N FARWELL AVE	MILWAUKEE, WI 53202-1104
BUSINESS OCCUPANT	2004 N FARWELL AVE	MILWAUKEE, WI 53202-1104
BUSINESS OCCUPANT	2008 N FARWELL AVE	MILWAUKEE, WI 53202-1104
BUSINESS OCCUPANT	2010 N FARWELL AVE	MILWAUKEE, WI 53202-1104
BUSINESS OCCUPANT	2014 N FARWELL AVE	MILWAUKEE, WI 53202-1104
CURRENT OCCUPANT	1614 E IRVING PL	MILWAUKEE, WI 53202-1416
CURRENT OCCUPANT	1622 E IRVING PL, 11	MILWAUKEE, WI 53202-1416
CURRENT OCCUPANT	1622 E IRVING PL, 12	MILWAUKEE, WI 53202-1416
CURRENT OCCUPANT	1622 E IRVING PL, 14	MILWAUKEE, WI 53202-1416
CURRENT OCCUPANT	1622 E IRVING PL, 15	MILWAUKEE, WI 53202-1416
CURRENT OCCUPANT	1622 E IRVING PL, 16	MILWAUKEE, WI 53202-1416
CURRENT OCCUPANT	1622 E IRVING PL, 21	MILWAUKEE, WI 53202-1416
CURRENT OCCUPANT	1622 E IRVING PL, 22	MILWAUKEE, WI 53202-1416
CURRENT OCCUPANT	1622 E IRVING PL, 23	MILWAUKEE, WI 53202-1416
CURRENT OCCUPANT	1622 E IRVING PL, 24	MILWAUKEE, WI 53202-1416
CURRENT OCCUPANT	1622 E IRVING PL, 25	MILWAUKEE, WI 53202-1416
CURRENT OCCUPANT	1622 E IRVING PL, 26	MILWAUKEE, WI 53202-1416
CURRENT OCCUPANT	1622 E IRVING PL, 27	MILWAUKEE, WI 53202-1416
CURRENT OCCUPANT	1622 E IRVING PL, 28	MILWAUKEE, WI 53202-1416
CURRENT OCCUPANT	1622 E IRVING PL, 31	MILWAUKEE, WI 53202-1416
CURRENT OCCUPANT	1622 E IRVING PL, 32	MILWAUKEE, WI 53202-1416
CURRENT OCCUPANT	1622 E IRVING PL, 33	MILWAUKEE, WI 53202-1416
CURRENT OCCUPANT	1622 E IRVING PL, 34	MILWAUKEE, WI 53202-1416
CURRENT OCCUPANT	1622 E IRVING PL, 35	MILWAUKEE, WI 53202-1416
CURRENT OCCUPANT	1622 E IRVING PL, 36	MILWAUKEE, WI 53202-1416
CURRENT OCCUPANT	1622 E IRVING PL, 37	MILWAUKEE, WI 53202-1416
CURRENT OCCUPANT	1622 E IRVING PL, 38	MILWAUKEE, WI 53202-1416
CURRENT OCCUPANT	1622 E IRVING PL, 41	MILWAUKEE, WI 53202-1416
CURRENT OCCUPANT	1622 E IRVING PL, 42	MILWAUKEE, WI 53202-1416

CURRENT OCCUPANT	1812 E LAFAYETTE PL, 503	MILWAUKEE, WI 53202-1161
CURRENT OCCUPANT	1812 E LAFAYETTE PL, 504	MILWAUKEE, WI 53202-1161
CURRENT OCCUPANT	1812 E LAFAYETTE PL, 505	MILWAUKEE, WI 53202-1161
CURRENT OCCUPANT	1812 E LAFAYETTE PL, 506	MILWAUKEE, WI 53202-1161
CURRENT OCCUPANT	1812 E LAFAYETTE PL, 507	MILWAUKEE, WI 53202-1161
CURRENT OCCUPANT	1812 E LAFAYETTE PL, 508	MILWAUKEE, WI 53202-1161
CURRENT OCCUPANT	1817 E LAFAYETTE PL, 1	MILWAUKEE, WI 53202-1160
CURRENT OCCUPANT	1817 E LAFAYETTE PL, 2	MILWAUKEE, WI 53202-1160
CURRENT OCCUPANT	1817 E LAFAYETTE PL, 3	MILWAUKEE, WI 53202-1160
CURRENT OCCUPANT	1825 E LAFAYETTE PL, M	MILWAUKEE, WI 53202-1160
CURRENT OCCUPANT	1825 E LAFAYETTE PL, N	MILWAUKEE, WI 53202-1160
CURRENT OCCUPANT	1825 E LAFAYETTE PL, O	MILWAUKEE, WI 53202-1160
CURRENT OCCUPANT	1825 E LAFAYETTE PL, P	MILWAUKEE, WI 53202-1160
CURRENT OCCUPANT	1825 E LAFAYETTE PL, Q	MILWAUKEE, WI 53202-1160
CURRENT OCCUPANT	1825 E LAFAYETTE PL, R	MILWAUKEE, WI 53202-1160
CURRENT OCCUPANT	1831 E LAFAYETTE PL, F	MILWAUKEE, WI 53202-1160
CURRENT OCCUPANT	1831 E LAFAYETTE PL, G	MILWAUKEE, WI 53202-1160
CURRENT OCCUPANT	1831 E LAFAYETTE PL, H	MILWAUKEE, WI 53202-1160
CURRENT OCCUPANT	1831 E LAFAYETTE PL, I	MILWAUKEE, WI 53202-1160
CURRENT OCCUPANT	1831 E LAFAYETTE PL, J	MILWAUKEE, WI 53202-1160
CURRENT OCCUPANT	1831 E LAFAYETTE PL, K	MILWAUKEE, WI 53202-1160
CURRENT OCCUPANT	1831 E LAFAYETTE PL, L	MILWAUKEE, WI 53202-1160
CURRENT OCCUPANT	1964 N FARWELL AVE	MILWAUKEE, WI 53202-1466
CURRENT OCCUPANT	1966 N FARWELL AVE	MILWAUKEE, WI 53202-1466
CURRENT OCCUPANT	1967 N FARWELL AVE	MILWAUKEE, WI 53202-1465
CURRENT OCCUPANT	1969 N FARWELL AVE	MILWAUKEE, WI 53202-1465
CURRENT OCCUPANT	1970 N FARWELL AVE	MILWAUKEE, WI 53202-1466
CURRENT OCCUPANT	1972 N FARWELL AVE, 1	MILWAUKEE, WI 53202-1466
CURRENT OCCUPANT	1972 N FARWELL AVE, 2	MILWAUKEE, WI 53202-1466
CURRENT OCCUPANT	1972 N FARWELL AVE, 3	MILWAUKEE, WI 53202-1466
CURRENT OCCUPANT	1973 N FARWELL AVE	MILWAUKEE, WI 53202-1465
CURRENT OCCUPANT	1973 N FARWELL AVE, A	MILWAUKEE, WI 53202-1465
CURRENT OCCUPANT	1976 N FARWELL AVE	MILWAUKEE, WI 53202-1466
CURRENT OCCUPANT	1981 N PROSPECT AVE, 1	MILWAUKEE, WI 53202-1450
CURRENT OCCUPANT	1981 N PROSPECT AVE, 2	MILWAUKEE, WI 53202-1450
CURRENT OCCUPANT	1981 N PROSPECT AVE, 3	MILWAUKEE, WI 53202-1450
CURRENT OCCUPANT	1981 N PROSPECT AVE, 4	MILWAUKEE, WI 53202-1450
CURRENT OCCUPANT	1981 N PROSPECT AVE, 5	MILWAUKEE, WI 53202-1495
CURRENT OCCUPANT	1981 N PROSPECT AVE, 6	MILWAUKEE, WI 53202-1495
CURRENT OCCUPANT	1981 N PROSPECT AVE, 7	MILWAUKEE, WI 53202-1495
CURRENT OCCUPANT	1981 N PROSPECT AVE, 8	MILWAUKEE, WI 53202-1495
CURRENT OCCUPANT	2006 N FARWELL AVE, 201	MILWAUKEE, WI 53202-1104
CURRENT OCCUPANT	2006 N FARWELL AVE, 202	MILWAUKEE, WI 53202-1104
CURRENT OCCUPANT	2006 N FARWELL AVE, 203	MILWAUKEE, WI 53202-1104
CURRENT OCCUPANT	2006 N FARWELL AVE, 204	MILWAUKEE, WI 53202-1104
CURRENT OCCUPANT	2006 N FARWELL AVE, 301	MILWAUKEE, WI 53202-1104
CURRENT OCCUPANT	2006 N FARWELL AVE, 302	MILWAUKEE, WI 53202-1104

CURRENT OCCUPANT	2019 N FARWELL AVE, 203	MILWAUKEE, WI 53202-1143
CURRENT OCCUPANT	2019 N FARWELL AVE, 204	MILWAUKEE, WI 53202-1143
CURRENT OCCUPANT	2019 N FARWELL AVE, 205	MILWAUKEE, WI 53202-1143
CURRENT OCCUPANT	2019 N FARWELL AVE, 206	MILWAUKEE, WI 53202-1143
CURRENT OCCUPANT	2019 N FARWELL AVE, 207	MILWAUKEE, WI 53202-1143
CURRENT OCCUPANT	2019 N FARWELL AVE, 208	MILWAUKEE, WI 53202-1143
CURRENT OCCUPANT	2019 N FARWELL AVE, 209	MILWAUKEE, WI 53202-1142
CURRENT OCCUPANT	2019 N FARWELL AVE, 210	MILWAUKEE, WI 53202-1142
CURRENT OCCUPANT	2019 N FARWELL AVE, 211	MILWAUKEE, WI 53202-1142
CURRENT OCCUPANT	2019 N FARWELL AVE, 212	MILWAUKEE, WI 53202-1142
CURRENT OCCUPANT	2019 N FARWELL AVE, 213	MILWAUKEE, WI 53202-1142
CURRENT OCCUPANT	2019 N FARWELL AVE, 214	MILWAUKEE, WI 53202-1142
CURRENT OCCUPANT	2019 N FARWELL AVE, 215	MILWAUKEE, WI 53202-1142
CURRENT OCCUPANT	2019 N FARWELL AVE, 216	MILWAUKEE, WI 53202-1142
CURRENT OCCUPANT	2019 N FARWELL AVE, 301	MILWAUKEE, WI 53202-1142
CURRENT OCCUPANT	2019 N FARWELL AVE, 302	MILWAUKEE, WI 53202-1142
CURRENT OCCUPANT	2019 N FARWELL AVE, 303	MILWAUKEE, WI 53202-1142
CURRENT OCCUPANT	2019 N FARWELL AVE, 304	MILWAUKEE, WI 53202-1142
CURRENT OCCUPANT	2019 N FARWELL AVE, 305	MILWAUKEE, WI 53202-1144
CURRENT OCCUPANT	2019 N FARWELL AVE, 306	MILWAUKEE, WI 53202-1144
CURRENT OCCUPANT	2019 N FARWELL AVE, 307	MILWAUKEE, WI 53202-1144
CURRENT OCCUPANT	2019 N FARWELL AVE, 308	MILWAUKEE, WI 53202-1144
CURRENT OCCUPANT	2019 N FARWELL AVE, 309	MILWAUKEE, WI 53202-1144
CURRENT OCCUPANT	2019 N FARWELL AVE, 310	MILWAUKEE, WI 53202-1144
CURRENT OCCUPANT	2019 N FARWELL AVE, 311	MILWAUKEE, WI 53202-1144
CURRENT OCCUPANT	2019 N FARWELL AVE, 312	MILWAUKEE, WI 53202-1144
CURRENT OCCUPANT	2019 N FARWELL AVE, 313	MILWAUKEE, WI 53202-1144
CURRENT OCCUPANT	2019 N FARWELL AVE, 314	MILWAUKEE, WI 53202-1144
CURRENT OCCUPANT	2019 N FARWELL AVE, 315	MILWAUKEE, WI 53202-1144
CURRENT OCCUPANT	2019 N FARWELL AVE, 316	MILWAUKEE, WI 53202-1144
blank	notice	

Total Records: 264

Radius: 250.0 feet and Center of Circle: 1978 N Farwell Ave



BUSINESS LICENSE PLAN OF OPERATION

ccl-busplan 5/12/2020

Office of the City Clerk License Division
200 E. Wells St. Room 105, Milwaukee, WI 53202
(414) 286-2238 www.milwaukee.gov/license e-mail address: license@milwaukee.gov

1. Type of Business

Applying for: Extended Hours (12AM to 5AM) - If a food establishment, check all that apply: Delivery Drive Thru Dining Room
 Self Service Laundry Massage Establishment Filling Station
 Other (supplemental application for specific license also required)

Provide a detailed description of the type of business you plan on operating:

Vegan Cafe serving food, coffee, smoothies and limited Alcoholic beverages

Do you have any experience operating this type of business? No Yes If yes, explain: this will be a second location

2. Business Operations

- a. Proposed Opening Date: September 1 2021
- b. Is this premise under construction? No Yes If yes, list estimated completion date: _____
- c. Is this a franchise? No Yes
- d. Is this premises currently licensed? No Yes If yes, list type of license: Food dealer, Class B Tavern
- e. Is the current licensee operating? No Yes If no, list date closed: May 21 2021
- f. Do you have future plans for other businesses, licenses or permits at this location? No Yes
If yes, explain: _____
- g. Have you previously held an Extended Hours License in Milwaukee? No Yes
If yes, list address(es): _____
- h. Are other businesses operating in the same building? No Yes If yes, describe: _____

3. Litter & Noise

- a. How are grounds kept clean? Sweep Pressure Wash Pick Up Litter Other: Window washing
- b. How often will grounds be cleaned? Daily Weekly As Needed Monthly Other: _____
- c. Grounds cleaned by: Licensee Building Owner Employees Hired Maintenance Other: _____
- d. How are noise issues prevented and/or addressed? Security Manager approaches customer(s) Call Police
 Signs Posted Other: _____
- e. Will a sound amplification system be used? No Yes If yes, describe: _____

4. Smoking & Sanitation

- a. Are there designated outdoor smoking areas? No Yes If yes, describe: _____
- b. Number of Garbage Cans: Inside: 6 Locations: behind bar, bathroom, dish area, 3x kitchen
Outside: 1 Locations: by dining tables
- c. Is a crowd control barrier used? No Yes If yes, describe: _____
- d. How many restrooms are on the premises? 1
- e. Name of solid waste contractor: Advanced Disposal Waste Management Other: _____

5. Security

- a. Are there onsite parking spaces? No Yes If yes, how many? _____ and describe the parking security plan: _____
- b. Is there a loading zone? No Yes If yes, describe the loading area security plan: _____
- c. Will you have security personnel on premise? No Yes If yes, how many? _____ and answer the following:
 What are their responsibilities? _____
 Is security equipment used? No Yes If yes, describe _____
 List their licensing, certification, or training credentials _____
- d. Will there be security cameras? No Yes If yes, how many? 4 and list locations: front door, Register, Kitchen, office
- e. Will searches/identification checks be done upon entry? No Yes If yes, describe _____

6. Percentage of Sales (must total 100%)

Alcohol <u>10</u> %	Food <u>90</u> %	Secondhand Merchandise <u>0</u> %	Precious Metals & Gems <u>0</u> %
Entertainment <u>0</u> %	Cigarettes <u>0</u> %	Personal Services (such as tattoo, body piercing, salon, tailor, tanning, etc.) <u>0</u> %	Other <u>0</u> % Describe: _____
Pawnbroker Activity <u>0</u> %	Salvaged Materials <u>0</u> % (such as scrap metal)		

7. Businesses/Licenses on the Premises (check all that apply):

Type 1

- Full Service Restaurant Cafe/Coffee Shop Deli or Fast Food Restaurant Private/Fraternal/Veterans Club
- Night Club Tavern Cocktail Lounge Teen Club
- Banquet Hall Sports Facility Bowling Alley
- Hotel/Motel: Number of Floors: _____ Number of Rooms: _____
 Rooming House: Number of Floors: _____ Number of Rooms: _____

Type 2

- Liquor Store Corner Store Supermarket Convenience Store
- Gas Station Amusement/Phonograph Distributor Recycling, Salvage or Towing
- Used Car Dealer Personal Service Establishment (such as tattoo business, hair salon, tailor, etc.) Recording Studio

What other licenses/permits will you hold at this location? (check all that apply)

- Occupancy Permit Cigarette & Tobacco Gas Station Extended Hours Class "B" Tavern Weights & Measures
- Secondhand Dealer Precious Metal & Gem Other: _____

8. Legal Capacity (only if a Type 1 premises in #7 above)

Capacity 25 (Call the Milwaukee Development Center at 414-286-8211 if you have questions.)

9. Premises Description

- a. Identify all area(s) of the premises that will be used in operating this business (include areas used only for storage):
 1st Floor 2nd Floor Basement Storage Patio Beer Garden Sidewalk Café Deck Rooftop
 Other: Describe: 1st Floor dining, lower level kitchen
- b. Describe Location: Major Thoroughfare Secondary Street Other: _____
- c. Nearest Major Cross Street: hoyden & Farwell
- d. Describe Building: Free Standing Building Strip Mail Other: store front w/ housing above
- e. Describe Premises Structure: Single Story Multi-Story - # of Stories _____ Other: _____
- f. Describe Surrounding Area: Commercial Residential Industrial Other: _____
- g. Building Owner Name: Alice Abu's LLC Phone Number: 414-305-6549
 Building Owner Address: 1168 W Clover Brook Rd, Glendale, WI 53217

10. Hours of Operation & Customers

Will customers be entering the premises? No Yes

Day of the Week	Proposed Hours of Operation:		Estimated Number of Customers expected each day	Potential Age Range of Customers	Class B Tavern Applicant Only: Age Restriction (If none, write 'None')
	Open Time (include a.m. or p.m.)	Close Time (include a.m. or p.m.)			
Sunday	8:30am	2:00PM	100	20-60	none
Monday	Closed				
Tuesday	Closed				
Wednesday	Closed				
Thursday	8:30am	2:00PM	75	20-60	none
Friday	8:30am	2:00PM	75	20-60	none
Saturday	8:30am	2:00PM	100	20-60	none

An Extended Hours Establishment License is required for any convenience store, filling station, personal service establishment (such as tattoo, body piercing, salon, tailor, tanning, etc.), recording studio or restaurant which is open between the hours of 12:00 a.m. and 5:00 a.m.

Alcohol Establishments Class A: 8:00 am to 9:00 pm Sunday thru Saturday
 Permitted Hours of Operation: Class B: 6:00 am to 2:00 am Sunday thru Thursday, 6:00 am to 2:30 am Friday & Saturday

Entertainment Outdoor Closing Hours: 10:00pm Sunday-Thursday; 12:00am Friday & Saturday; unless a different time, either earlier or later, is established by the Common Council in its approval of the licensee's plan of operation.

11. Signature(s)

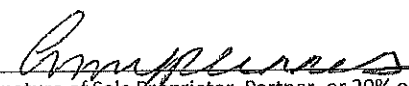
 Signature of Sole Proprietor, Partner, or 20% or more Shareholder
 (If there are no 20% or more shareholders, Corporate Officer-print name/title and sign)

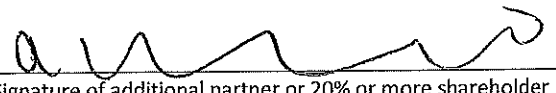
 Signature of additional partner or 20% or more shareholder

See Application Information for a complete list of all required application forms.



ALCOHOL BEVERAGE & PUBLIC ENTERTAINMENT PREMISES SUPPLEMENTAL APPLICATION

Office of the City Clerk License Division
200 E. Wells St. Room 105, Milwaukee, WI 53202
(414) 286-2238 e-mail address: license@milwaukee.gov www.milwaukee.gov/license

Legal Entity Name: The National LLC

Premise Address: 1978 N. Fairview Ave Milwaukee, WI 53215

Proximity of Premises to Church, School, Daycare Center or Hospital

Is the building within 300 feet of any church, school, daycare center or hospital? No Yes

"Service Bar Only" Designation

If applying for Class B or C license, are you applying for "Service Bar Only"? No Yes
Service Bar Only means customers cannot sit at the bar. Alcohol is served to employees who serve patrons seated at tables. No stools, chairs or other articles of furniture shall be placed at the service bar for patrons to sit upon.

Business Information

- a) Are you taking out this application for anyone that may not be eligible for a license? No Yes
If yes, list their name and address: _____
 - b) Will the agent, a partner or the individual licensee be conducting the day-to-day operations of the business? No Yes
If no, list the name and address of the person(s) who will: _____
- Class B Applicants: If the agent, a partner or the individual licensee will not be conducting the day-to-day operations of the business, the person(s) listed above must obtain a Class B Managers license.
- c) Does anyone else have money invested or any other interest in this business? No Yes
If yes, explain: _____
 - d) Have you made an agreement with anyone to repay any loan or any other payments based upon income from the business?
 No Yes If yes, list name and address: _____

Property Information (New & Transfer Applicants Only)

- a) Do you own or lease the building? Own Lease
 - b) Who owns the fixtures (for example, coolers, etc.)? The National LLC
 - c) Are you purchasing the stock and/or fixtures? No Yes If yes, amount paid \$21,500
 - d) Total amount paid for business \$21,500
 - e) Total amount paid for goodwill of the business \$ 0
- Goodwill comprises the reputation and customer relationships of an existing business. If the price you pay for the business exceeds the fair market value of all of the rest of the assets of the business, the excess may be considered goodwill.
- f) Have you made arrangements with the seller for payment of personal property taxes? No Yes

Lease Information (New & Transfer Applicants who are leasing the premises only)

- a) Date lease begins July 1 2021 Ends Jan 31 2024
- b) Monthly rental \$ 1950.00
- c) Do you have an option to renew the lease? No Yes
- d) Does your lease allow for assignment to another party without the consent of the owner? No Yes
- e) For what length of time have you been guaranteed occupancy (number of years)? 2.5

Lease Information (Continued)

- f) In addition to paying the monthly rental, will you have to pay anything additional to the owner of the building to guarantee performance of the lease? No Yes If yes, explain _____
- g) Does the present owner or occupancy object to the granting of your license? No Yes
If yes, explain _____

Change of Agent Applicants Only

Have there been any changes to the floor plan since the last application was submitted? No Yes
If no, a new floor plan is not required. If yes, submit a new floor plan and explain the change(s):

Signature

Signature of Sole Proprietor, Partner or 20% or More Shareholder
(If no 20% or more Shareholder, Corporate Officer - print name/title and sign)

Note: All information contained in this application is subject to approval by the Common Council.
Deviating from approved plan of operation will subject licensee to citations, and/or suspension or non-renewal of the license.
Contact the License Division for information on how to request changes.

New and transfer of premises applicants must submit the following:

- Detailed floor plan
 If a restaurant, copy of the menu



FOOD DEALER LICENSE PLAN OF OPERATION

OFFICE OF THE CITY CLERK, LICENSE DIVISION
CITY HALL, 200 E. WELLS ST, ROOM 105, MILWAUKEE, WI 53202
(414) 286-2238 • license@milwaukee.gov • www.milwaukee.gov/license

Legal Entity Name: The National LLC

Premises Address: 1978 N. Farwell Ave. Milwaukee, WI 53215

SECTION 1 TYPE OF BUSINESS

What will be the majority of your food sales? (check one)

Restaurant Items (meals):
MEALS include, but are not limited to, chicken, ribs, sandwiches, roasted corn, baked potatoes, hot dogs, brats, tacos, nachos w/ cheese and meat, French fries, cooked or deep fried vegetables/fruit, cooked cheese curds, corn dogs, egg rolls, salads.

Retail Items (snacks and beverages):
RETAIL items include, but are not limited to, ice cream/soft serve, lemonade, snow cones, coffee, espresso, cappuccino, tea, fruit juice, smoothies, candy, dispensed soda, fruit cups, bakery, cookies, kettle corn, cotton candy, funnel cakes, fritters, tortilla chips w/ cheese.

Will it be a convenience store? Yes No

A convenience store contains less than 5,000 square feet of retail space and has, as its primary business, the sale of basic food items and in addition, sells household products or is a filling station that sells basic food items and household products.

Bed & Breakfast

Micro Market

All Applicants: Submit a menu or a list of food items that will be sold.

Will any wholesale business be done? No Yes If yes, what percentage of food sales will be wholesale?

Less than 25%

25% or More AND:

Restaurant items (meals) will be sold – Complete this application and also contact DATCP.

NO restaurant items (meals) will be sold - Do NOT complete this application. Contact DATCP only.

SECTION 2 FOOD PROCESSING

Will any food processing be done? No Yes

Processing is defined as assembling, grinding, cutting, mixing, baking, coating, stuffing, packing, bottling, grilling, canning, extracting, fermenting, distilling, pickling, freezing, drying, smoking, or packaging.

SECTION 3 FOOD REQUIRING TEMPERATURE CONTROL

Will any food that requires temperature control be sold? No Yes
(includes dairy products such as milk, cheese, and ice cream, fish, shellfish, meat, poultry)

If yes, list the types of food items: Fruit, vegetables, Cheese, Meat

SECTION 4 DETAILS OF OPERATION

Will you have seating on site for dining? No Yes

Will you be doing any catering? No Yes

Will you be doing any delivery? No Yes

Will you have outdoor activities? No Yes - Check all that apply: Bar Cooking/Grilling Dining

Will you have a drive thru window? No Yes - Are hours different from inside? No Yes
 If Yes, provide drive thru hours: _____

Will scales or barcode scanners be used? No Yes - You must also apply for a Weights & Measures License.

SECTION 5 ADDITIONAL SITES

Where will food be prepared and/or sold?
 At a single site At multiple sites: How many? _____ (for example, a hotel with several dining rooms or bars)
 If multiple sites, attach a Food Dealer Additional Site Addendum (ccl-foodadd) for each additional site.

SECTION 6 CONSTRUCTION OR CHANGES

Are you planning any construction, remodeling or equipment changes?
 No If No, SKIP to Section 8
 Yes If Yes, check all that apply: New construction of a building Renovation or remodeling
 Construction changes to existing building Equipment changes only

Provide a brief description of the changes: Painting, new light fixtures, wall hangings, Tire Backsplash

Start date: JULY 1 2021

Name, Address & Phone Number of Architect: N/A

Name, Address & Phone Number of Contractor: N/A

SECTION 7 ALCOHOL BEVERAGES

Are you applying for an alcohol beverage license?
 No If No, SKIP to Section 8
 Yes If YES, if your food license is approved prior to the alcohol license, when do you want the food license issued?
 Immediately At the same time as the alcohol license

SECTION 8 ACKNOWLEDGEMENTS & SIGNATURE

You must initial each item confirming your understanding:

AP I understand the Health Department must conduct an inspection and advise the License Division of their approval before the license may be issued.

AP I understand I must obtain an occupancy permit from the Department of Neighborhood Services and an inspection may be required. Neighborhood Services must advise the License Division of their approval before the license may be issued.

AP I understand the district alderperson will review and either support or object to my application. If he/she objects, I may appeal and be scheduled to appear before the Licenses Committee. The Licenses Committee will then make a recommendation to the Common Council. The Common Council must grant the license before it may be issued.

AP I understand proof of payment for all license fees must be on file in the License Division before the license may be issued and the license must be issued and posted in my establishment prior to opening for business.

AP I will not operate my food business until the license has been issued and posted in the establishment.

Signature of Sole Proprietor, Partner, or 20% Shareholder: [Signature]

Signature of Additional Partner: _____



Sidewalk Dining Facility Supplemental Application

ccl-side1 2/21/18

Office of the City Clerk License Division
200 E. Wells St. Room 105, Milwaukee, WI 53202
(414) 286-2238 www.milwaukee.gov/license e-mail address: license@milwaukee.gov

Business Name: <u>The Lafayette Place</u>	Aldermanic District #
---	-----------------------

Premises Address: 1978 N. Farwell Ave Milwaukee, WI 53215

Business Operations

- Check one: I/we are also applying for Food/Alcohol license(s) at this time.
 I/we currently hold Food/Alcohol license(s) AND
- confirm that the Business Plan of Operation on file which was previously submitted with the Food and/or Alcohol application has not changed, except for the addition of this sidewalk dining facility.
- have included a new Business Plan of Operation reflecting requested changes.

Sidewalk Dining Facility will operate from: Start Date: March ~~September~~ 1 2021 to End Date: October 31

Will any food preparation be done outdoors? No Yes
 If yes, describe: _____

Will any sidewalk dining facility improvements be physically attached to public structures? No Yes
 If yes, describe: _____

Property Owner

Check one: Applicant owns the property
 Property owner's information/signature provided below (REQUIRED):

Name: Alice Abu's LLC Phone # 414-305-6549
 Address: 1108 Clover Ave, W Glendale, WI 53217
 Property Owner's Signature: [Signature] Michel Aboul-2/16/21

Signature(s)

[Signature]
 Signature of Sole Proprietor, Partner, or 20% or more Shareholder
 (If there are no 20% or more shareholders, Corporate Officer-print name/title and sign)

[Signature]
 Signature of additional partner or 20% or more shareholder

Office Use Only:

Initials _____ Filed _____ App # _____

Processing LS: Queue to: HD DNS CC Email To: DPW Primary LS

Also: holds is applying for: Food Alcohol Perm Ext

Lafayette Place menu Draft

Drinks

Coffee

Cold Brew 12 oz 16oz

Brewed Anodyne Coffee 12 oz 16 oz

Oatmilk Café Au Lait 12 oz 16 oz

Tea

Iced Oatmilk Chai 12 oz 16 oz

Oatmilk Chai Latte 12 oz 16oz

Iced Sport Tea

Earl Grey

Ginger Tumeric

Jade Cloud

London Fog

Kombucha

La Croix

Smoothies:

Banana Chai Smoothie

Peach Basil

Blueberry Muffin

Berry Blast

Green Machine

Lunch

Southern Soy Boy- blackened soy curls on a baguette with pickled onions and cucumbers, arugula, and a spicy garlic ranch. Served with sea salt kettle chips

Veggie Melt- roasted carrots, red peppers, portobellas, shaved brussel sprouts, and melted chez and chipotle mayo on toasted sourdough. Served with sea salt kettle chips

Portobello Bahn Mi- sesame soy marinated portobellas, pickled daikon slaw with cilantro sriracha mayo

Muffaletta- prosciutto and ham with shredded chez, muffaletta mix, pickled onions on a pressed roll

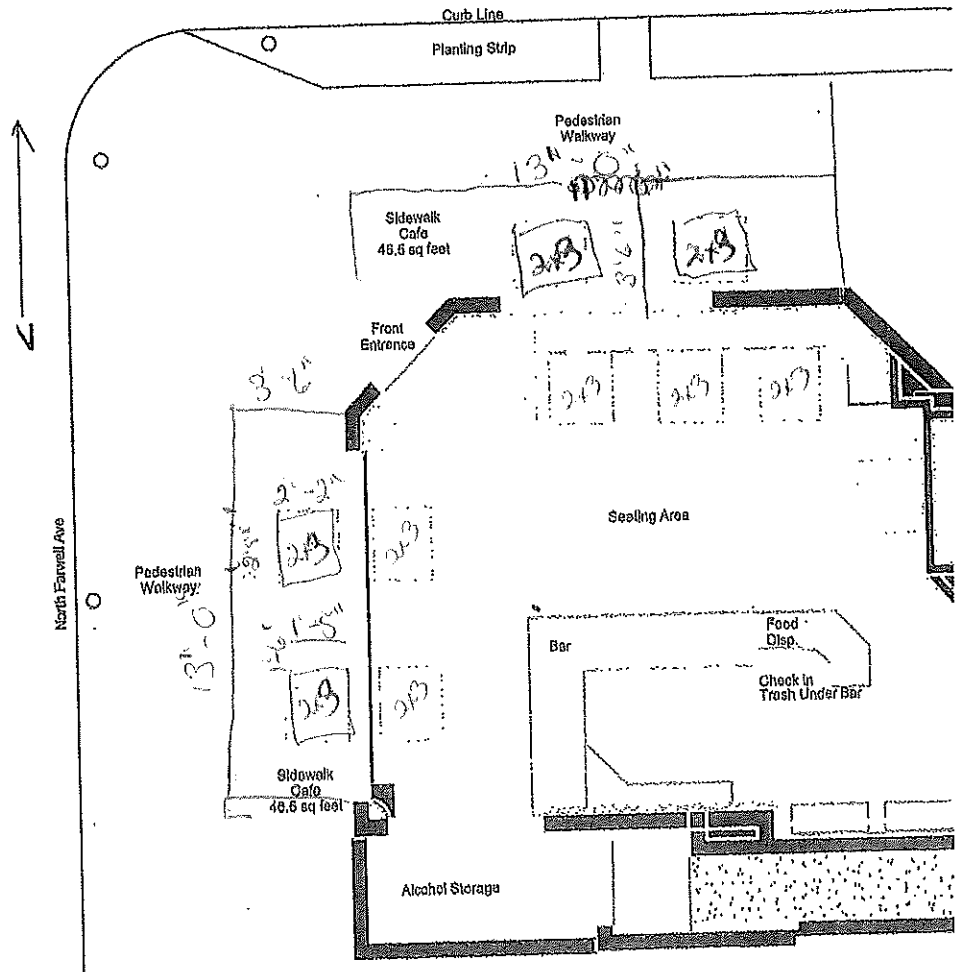

Any Plannes Agent for "The National LLC"
 "The Lafayette Place"
 1078 N Farwell Ave Milwaukee WI 53202
 Date: August 23rd 2021
 1122 sq feet