

PROJECT ID: 2984-25-02/03 (C)
WITH:

COUNTY: MILWAUKEE

ORDER OF SHEETS

- Section No. 1 Title
- Section No. 2 Typical Sections and Details
- Section No. 3 Estimate of Quantities
- Section No. 3 Miscellaneous Quantities
- Section No. 4 Right of Way Plat
- Section No. 5 Plan and Profile
- Section No. 6 Standard Detail Drawings
- Section No. 7 Sign Plates
- Section No. 8 Structure Plans
- Section No. 9 Computer Earthwork Data
- Section No. 9 Cross Sections

TOTAL SHEETS =

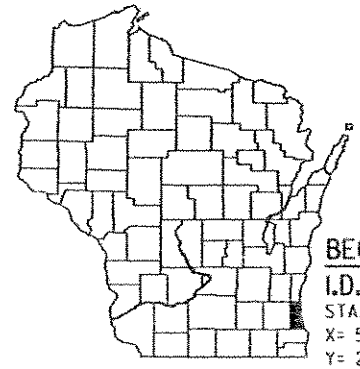

BEGIN PROJECT
I.D. 2984-25-02/03 (C)
STA. 46+00
X= 590012.58
Y= 295173.05

DESIGN DESIGNATION

MILLER PARK TO 25TH ST	
A.A.D.T. (2005) =	4,900
A.A.D.T. (2025) =	15,300
D.H.V. =	1,160
D.D. =	65/35
T. =	10.5%
DESIGN SPEED =	35 MPH
ESALS =	2,416,300

CONVENTIONAL SYMBOLS

- PLAN**
- CORPORATE LIMITS
 - PROPERTY LINE
 - LOT LINE
 - LIMITED HIGHWAY EASEMENT
 - EXISTING RIGHT OF WAY
 - PROPOSED OR NEW R/W LINE
 - SLOPE INTERCEPT
 - REFERENCE LINE
 - EXISTING CULVERT
 - PROPOSED CULVERT (Box or Pipe)
 - COMBUSTIBLE FLUIDS
 - MARSH AREA
 - WOODED OR SHRUB AREA

- PROFILE**
- GRADE LINE
 - ORIGINAL GROUND
 - MARSH OR ROCK PROFILE (To be noted as such)
 - SPECIAL DITCH
 - GRADE ELEVATION
 - CULVERT (Profile View)
 - UTILITIES
 - ELECTRIC
 - FIBER OPTIC
 - GAS
 - SANITARY SEWER
 - STORM SEWER
 - TELEPHONE
 - WATER
 - UTILITY PEDESTAL
 - POWER POLE
 - TELEPHONE POLE

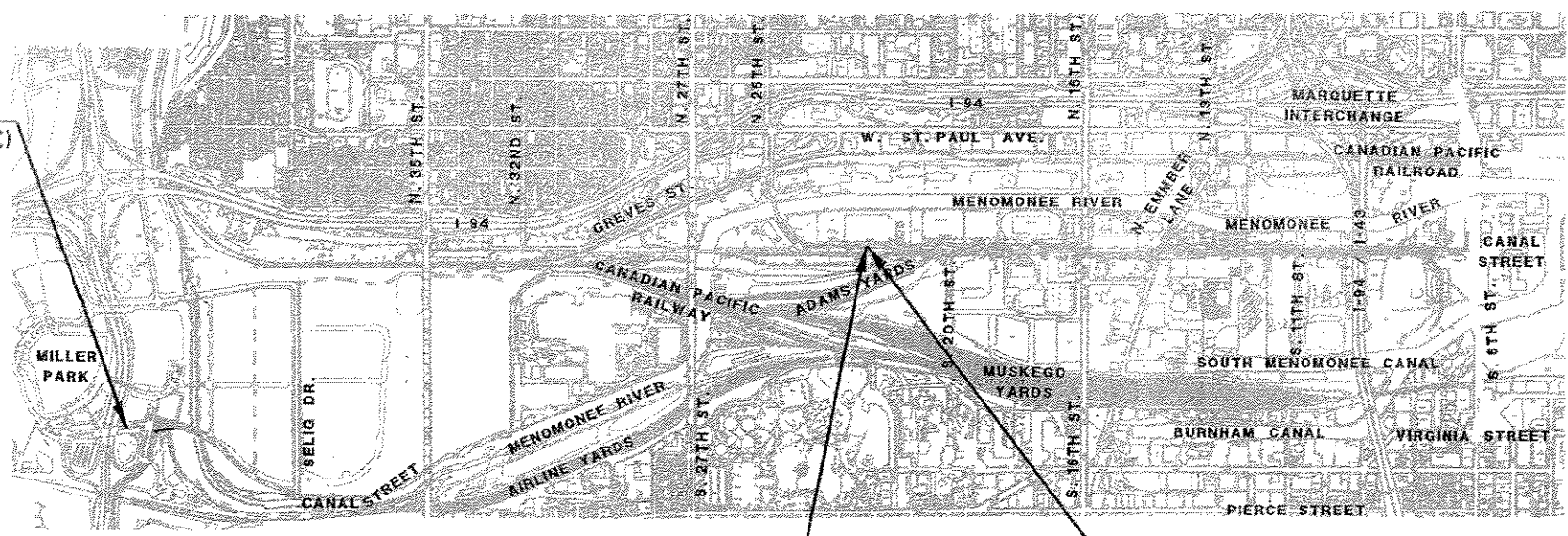

END PROJECT
I.D. 2984.25-02/03 (C)
STA. 74+16
X= 592155.70
Y= 295112.67

END PROJECT
I.D. 1000-32-55
STA. 138+73
X= 597524.12
Y= 296956.53



TOTAL NET LENGTH OF CENTERLINE = 0.533 MILES (URBAN)

CITY OF MILWAUKEE
DEPARTMENT OF PUBLIC WORKS
PLAN OF PROPOSED IMPROVEMENT

CANAL STREET
MILLER PARK REVERSIBLE LANES
LOCAL STREET
CITY OF MILWAUKEE
MILWAUKEE COUNTY

STATE PROJECT NUMBER
2984-25-02/03 (C)

CANAL STREET
MILLER PARK REVERSIBLE LANES
VMS
CITY OF MILWAUKEE
MILWAUKEE COUNTY

STATE PROJECT NUMBER
1000-32-55

STATE PROJECT	FEDERAL PROJECT	
	PROJECT	CONTRACT
2984-25-02/03 (C)		
1000-32-55		

ORIGINAL PLANS APPROVED BY
CITY OF MILWAUKEE
10/3/05 *[Signature]*
(Date) (Title) (City Engineer)

10/3/05 *[Signature]*
(Date) (Title) (Commissioner of Public Works)

ORIGINAL PLANS PREPARED BY:
MILWAUKEE TRANSPORTATION PARTNERS



9/30/05 *[Signature]*
(Date) (Signature)

COORDINATES ON THIS PLAN ARE REFERENCED TO THE WISCONSIN COUNTY COORDINATE SYSTEM (WCCS), MILWAUKEE COUNTY NAD 83 (91) SOUTH ZONE.

ELEVATIONS SHOWN ARE REFERENCED TO CITY OF MILWAUKEE VERTICAL DATUM.

TO CONVERT ELEVATIONS SHOWN ON THIS PLAN TO NATIONAL GEODETIC VERTICAL DATUM OF 1929, ADD 580.603 TO ELEVATIONS SHOWN ON THIS PLAN.

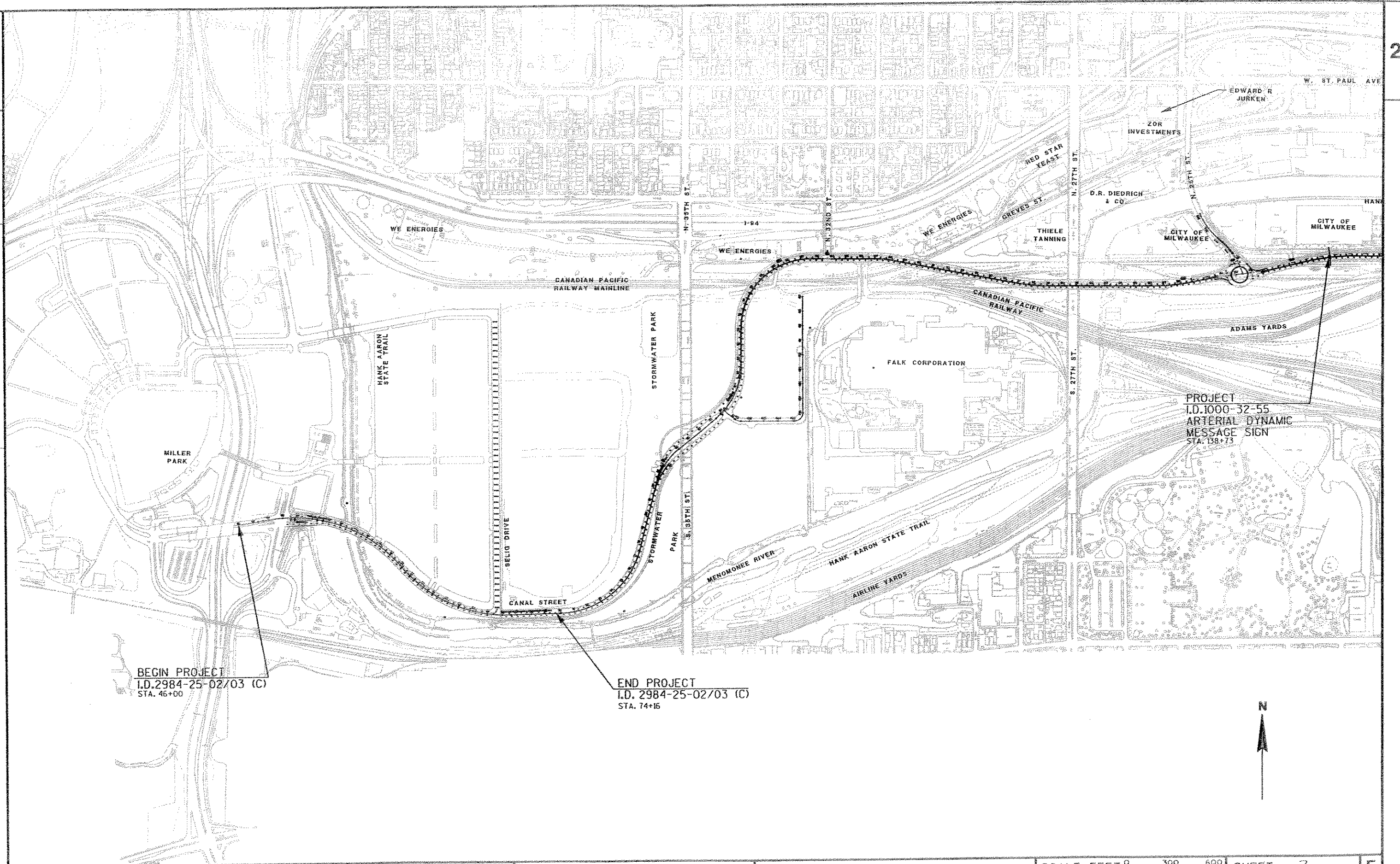

BEGIN PROJECT
 I.D. 2984-25-02/03 (C)
 STA. 46+00

END PROJECT
 I.D. 2984-25-02/03 (C)
 STA. 74+15

PROJECT
 I.D. 1000-32-55
 ARTERIAL DYNAMIC
 MESSAGE SIGN
 STA. 138+75



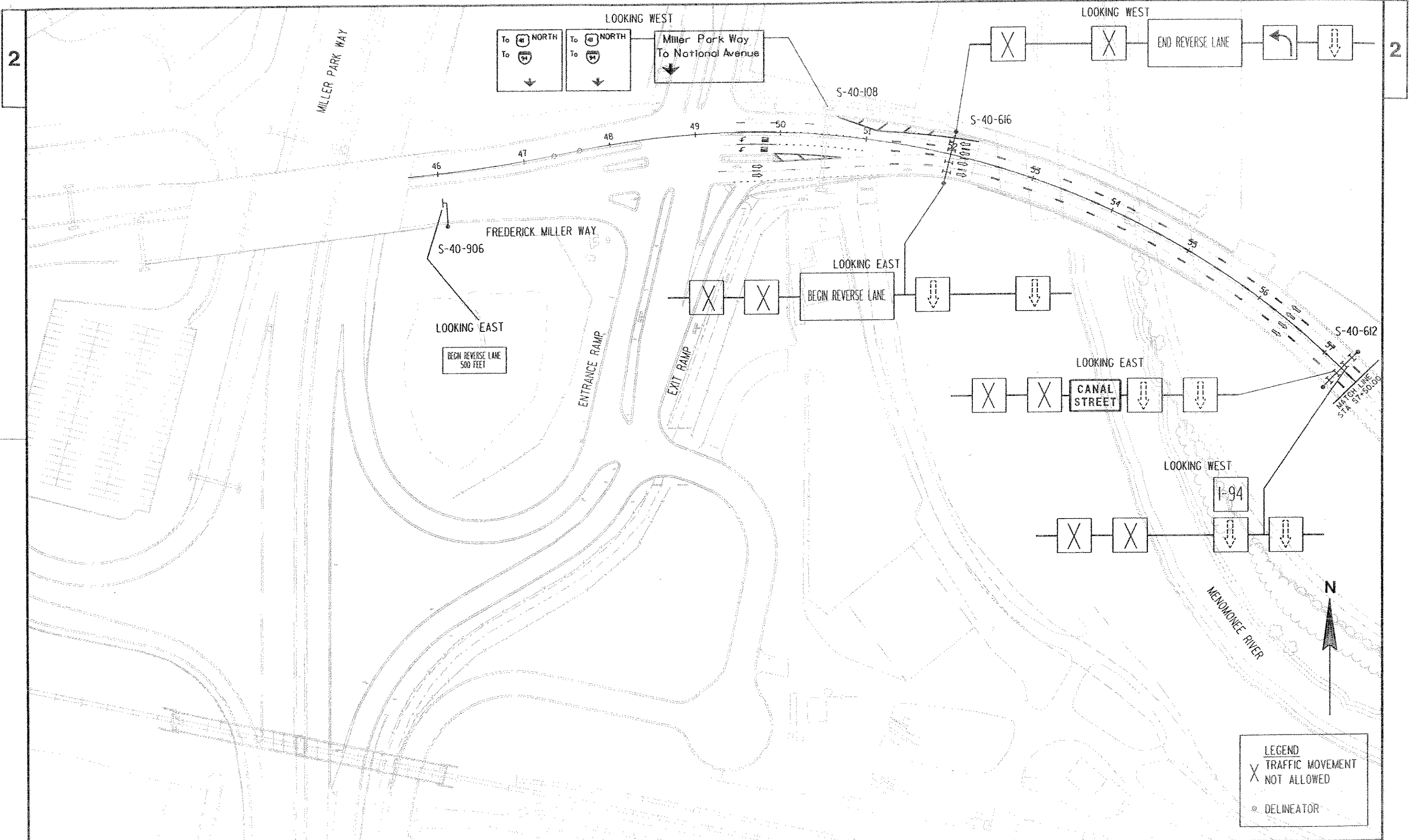

LEGEND
 X TRAFFIC MOVEMENT NOT ALLOWED
 ○ DELINEATOR

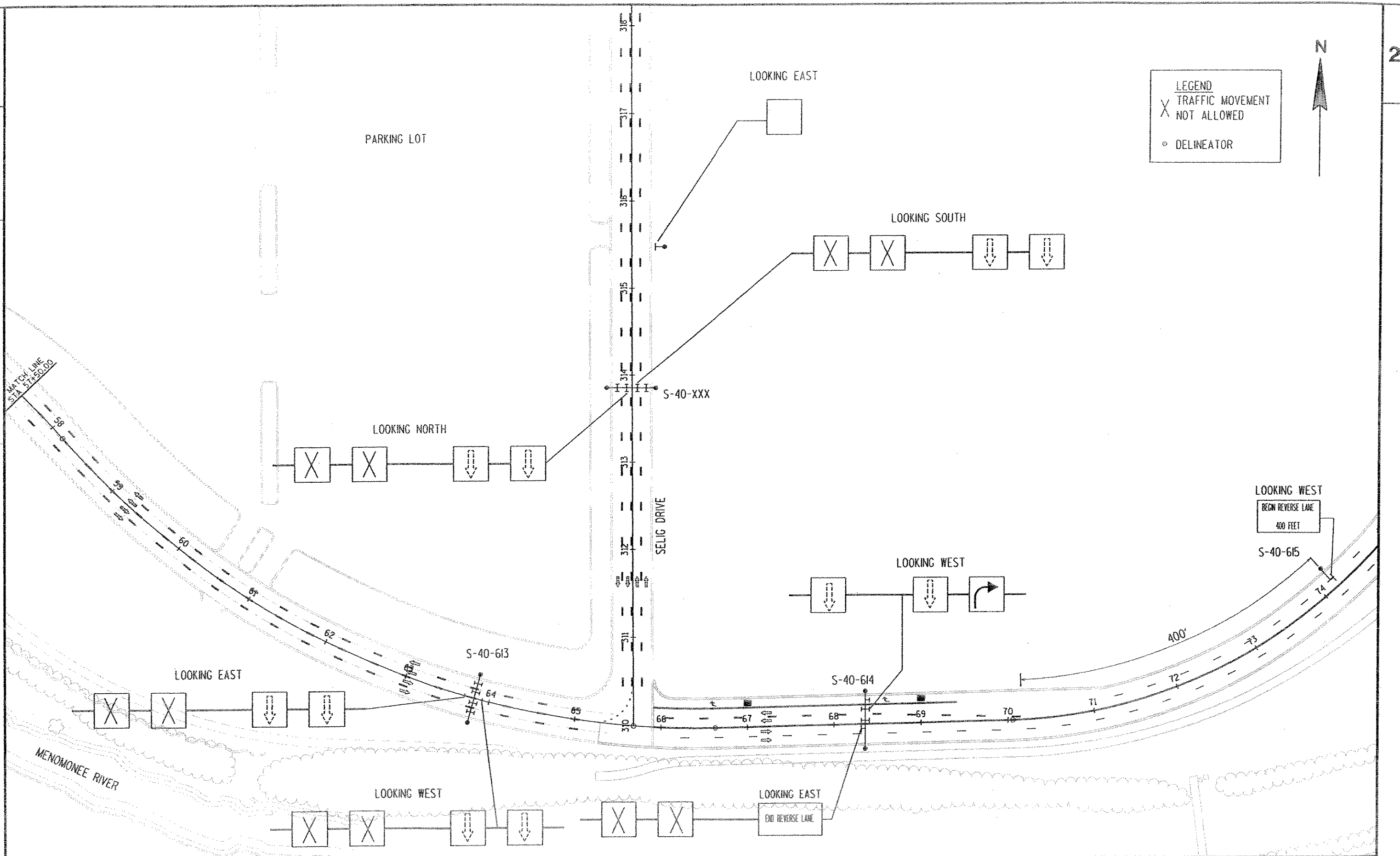

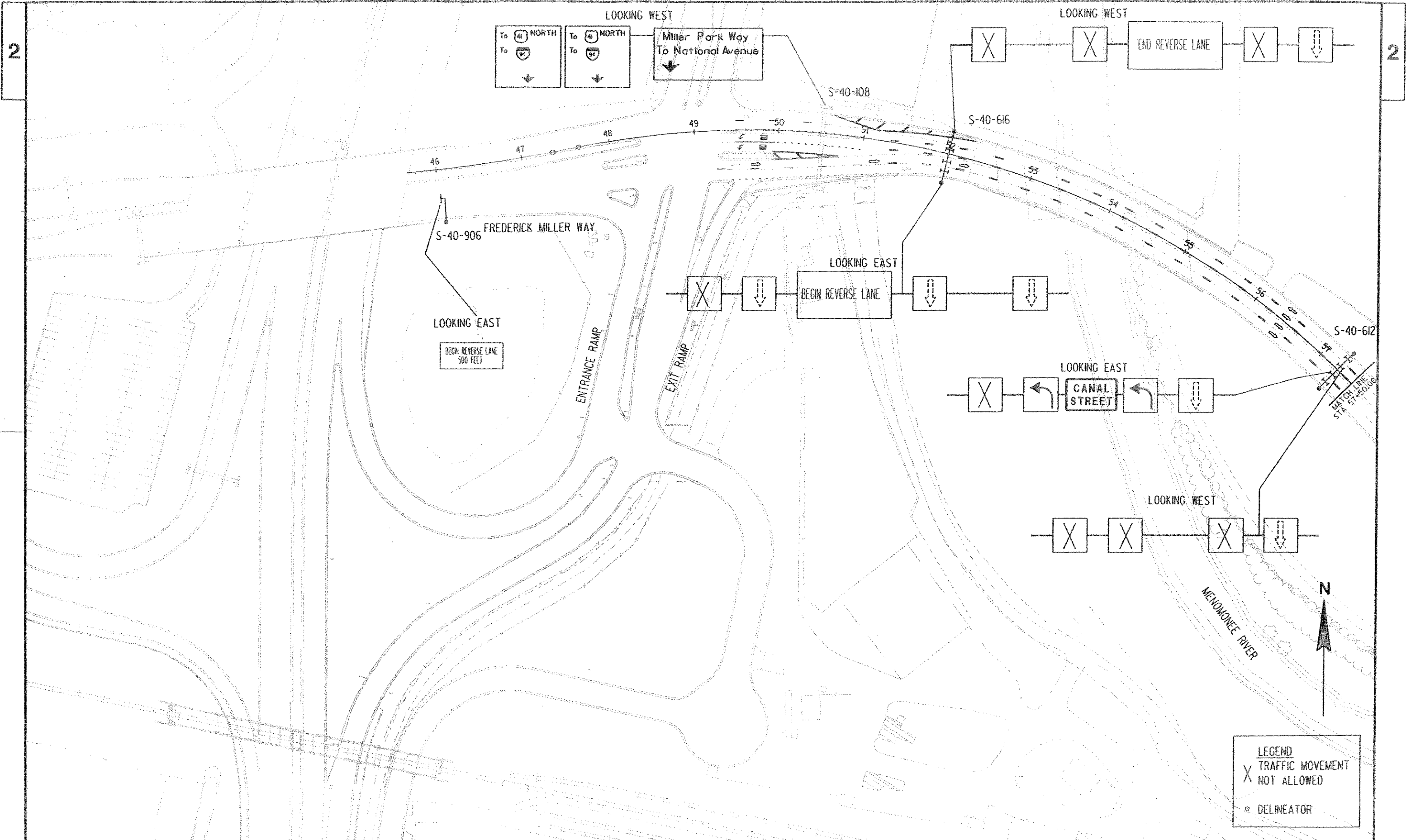

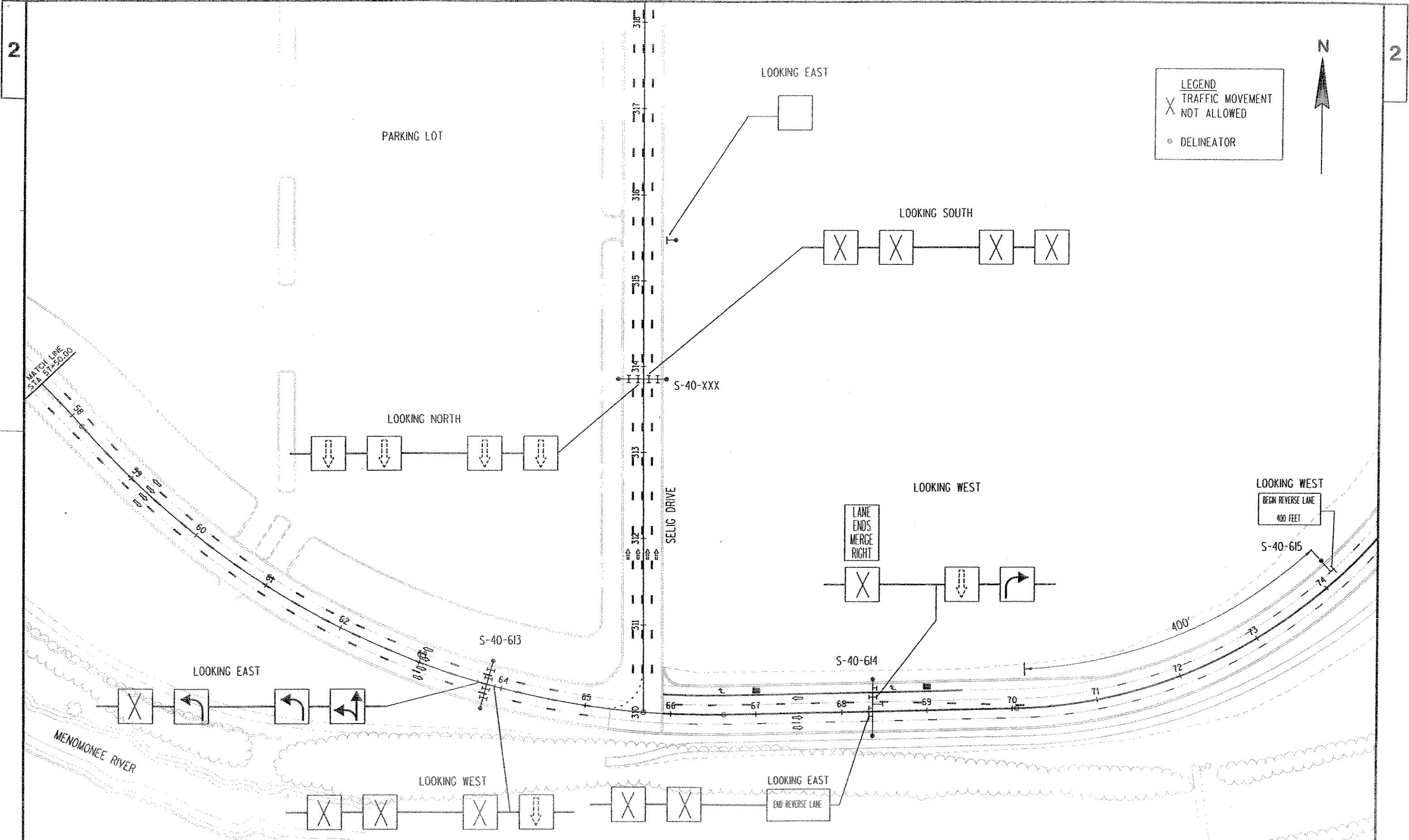

LEGEND
 X TRAFFIC MOVEMENT NOT ALLOWED
 ○ DELINEATOR

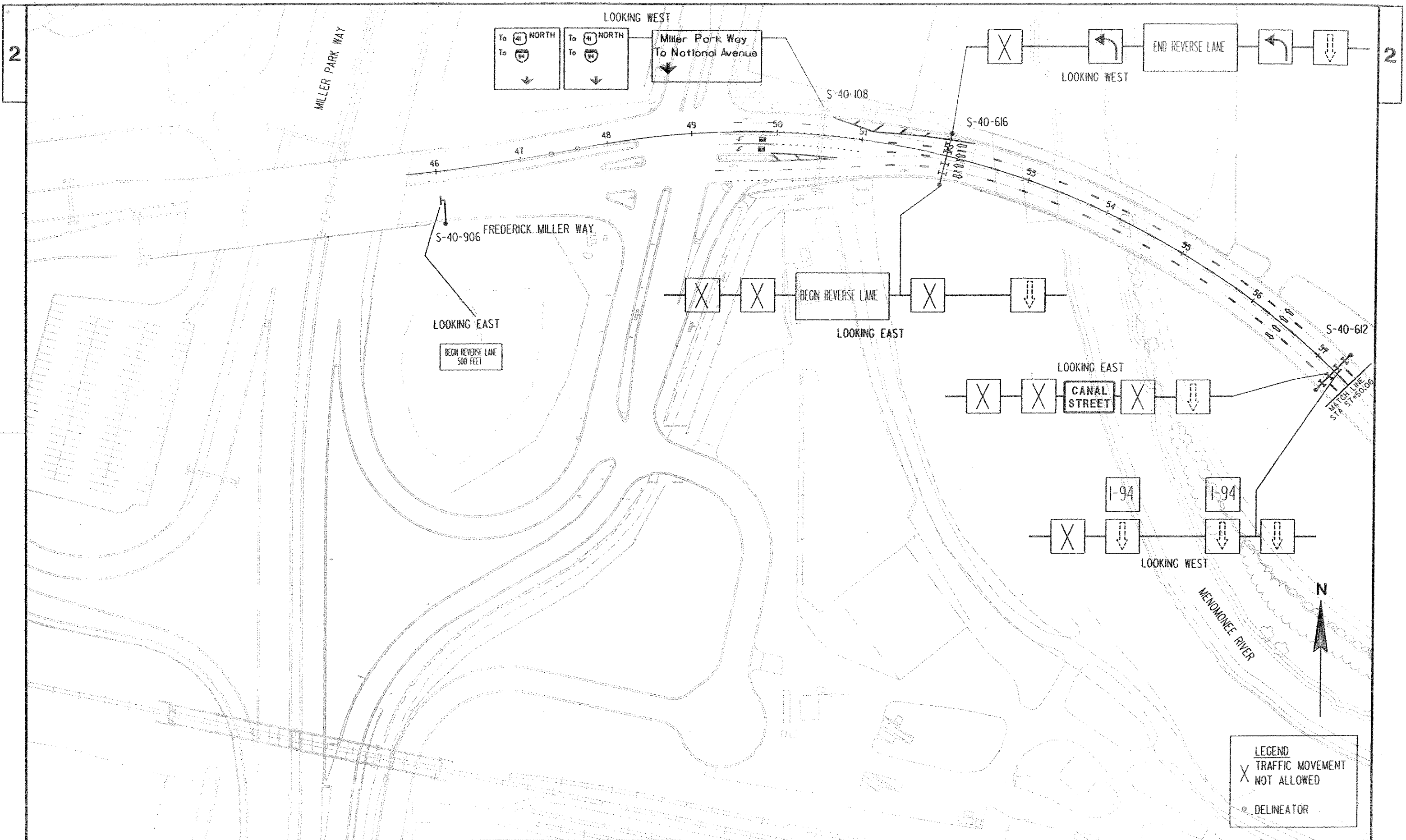

PROJECT NO: 2984-25-02/03 (C)

HWY: CANAL STREET

COUNTY: MILWAUKEE

OVERVIEW OUTBOUND OPERATION

SCALE, FEET SHEET 8

E

FILE NAME : \\s...designfile...s

PLOT DATE : \\s...plottingdate...s PLOT BY : \\s...plotuser...s PLOT NAME :

PLOT SCALE : \\s...plotscale...s WISDOT/CADD SHEET 42

LEGEND

- X TRAFFIC MOVEMENT NOT ALLOWED
- o DELINEATOR

LEGEND
 X TRAFFIC MOVEMENT NOT ALLOWED
 ○ DELINEATOR

