



**CITY OF MILWAUKEE
OFFICE OF THE CITY CLERK**

Wednesday, March 17, 2021

COMMITTEE MEETING NOTICE

AD 15

SALEM, Ahmed I, Agent
OMAR FOOD MARKET LLC
2803 N 35TH St

Milwaukee, WI 53210

You are requested to attend a virtual hearing to be held on:

Tuesday, March 30, 2021 at 01:10 PM

Regarding: Your Class A Malt and Food Dealer License Applications as agent for "OMAR FOOD MARKET LLC" for "Omar Food" at 2803 N 35TH St. 

This meeting will be held via GoToMeeting. Please see the enclosed best practices document for further instructions. The access code is <https://global.gotomeeting.com/join/669376909>. If you wish to call in, please call +1 (646) 749-3122 and use Access Code: 669-376-909.

There is a possibility that your application may be denied for one or more of the following reasons: The recommendation of the committee regarding the application shall be based on evidence presented at the hearing. Per MCO 85-2.7-4, probative evidence concerning whether or not a new license should be granted may be presented on the following subjects: whether or not the applicant meets the municipal requirements, the appropriateness of the location and premises where the licensed premises is to be located and whether use of the premises for the purposes or activities permitted by the license would tend to facilitate a public or private nuisance or create undesirable neighborhood problems such as disorderly patrons, unreasonably loud noise, litter, and excessive traffic and parking congestion. Probative evidence relating to these matters may be taken from the plan of operation submitted with the license application, if any, but shall not include the content of any music. Evidence regarding the fitness of the location of the premises to be maintained as the principal place of business, including but not limited to whether there is an overconcentration of businesses of the type for which the license is sought; whether the proposal is consistent with any pertinent neighborhood business or development plans, or the location's proximity to areas where children are typically present. The applicant's record in operating similarly licensed premises; and whether or not the applicant has been charged with or convicted of any felony, misdemeanor, municipal offense or other offense, the circumstances of which substantially relate to the activity to be permitted by the license being applied for or any other factor which reasonably relates to the public health, safety or welfare may also be considered. See attached police report or correspondence.

Notice for applicants with warrants or unpaid fines:

Proof of warrant satisfaction or payment of fines must be submitted at the hearing on the above date and time. Failure to comply with this requirement may result in a delay of the granting/denial of your application.

Failure to attend this meeting may result in the denial of your license. Individual applicants and partnership applicants must attend or attend by an attorney. The agent or attorney for corporate or limited liability applicants must attend. If you wish to do so and at your own expense, you may be accompanied by an attorney of your choosing to represent you at this hearing.

You will be given an opportunity to speak on behalf of the application and to respond and challenge any charges or reasons given for the denial. No petitions can be accepted by the committee, unless the people who signed the petition attend the virtual hearing and are willing to testify. You may present witnesses under oath and you may also confront and cross-examine opposing witnesses under oath. If you have difficulty with the English language, you should request an interpreter attend the meeting with you, at your expense, so that you can answer questions and participate in your hearing.

PLEASE NOTE: Upon reasonable notice, efforts will be made to accommodate the needs of disabled individuals through sign language interpreters or other auxiliary aids. For additional information or to request this service, contact the Council Services Division ADA Coordinator at (414) 286-2998, Fax - (414) 286-3456, TDD - (414) 286-2025.

JIM OWCZARSKI, CITY CLERK

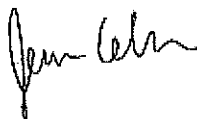

BY: _____

Jessica Celella
License Division Manager

If you have questions regarding this meeting, please contact the staff assistant, Molly Kuether-Steele at (414) 286-2775 or molly.kuether-steele@milwaukee.gov.

200 E. Wells Street, Room 105, City Hall, Milwaukee, WI 53202. www.milwaukee.gov/license
Phone: (414) 286-2238 Fax: (414) 286-3057 Email Address: License@milwaukee.gov



**CITY OF MILWAUKEE
OFFICE OF THE CITY CLERK**

Wednesday, March 17, 2021

COMMITTEE MEETING NOTICE

AD 15

SALEM, Ahmed I, Agent
OMAR FOOD MARKET LLC
6257 S 26th St

Milwaukee, WI 53221

You are requested to attend a virtual hearing to be held on:

Tuesday, March 30, 2021 at 01:10 PM

Regarding: Your Class A Malt and Food Dealer License Applications as agent for "OMAR FOOD MARKET LLC" for "Omar Food" at 2803 N 35TH St.

This meeting will be held via GoToMeeting. Please see the enclosed best practices document for further instructions. The access code is <https://global.gotomeeting.com/join/669376909>. If you wish to call in, please call +1 (646) 749-3122 and use Access Code: 669-376-909.

There is a possibility that your application may be denied for one or more of the following reasons: The recommendation of the committee regarding the application shall be based on evidence presented at the hearing. Per MCO 85-2.7-4, probative evidence concerning whether or not a new license should be granted may be presented on the following subjects: whether or not the applicant meets the municipal requirements, the appropriateness of the location and premises where the licensed premises is to be located and whether use of the premises for the purposes or activities permitted by the license would tend to facilitate a public or private nuisance or create undesirable neighborhood problems such as disorderly patrons, unreasonably loud noise, litter, and excessive traffic and parking congestion. Probative evidence relating to these matters may be taken from the plan of operation submitted with the license application, if any, but shall not include the content of any music. Evidence regarding the fitness of the location of the premises to be maintained as the principal place of business, including but not limited to whether there is an overconcentration of businesses of the type for which the license is sought; whether the proposal is consistent with any pertinent neighborhood business or development plans, or the location's proximity to areas where children are typically present. The applicant's record in operating similarly licensed premises; and whether or not the applicant has been charged with or convicted of any felony, misdemeanor, municipal offense or other offense, the circumstances of which substantially relate to the activity to be permitted by the license being applied for or any other factor which reasonably relates to the public health, safety or welfare may also be considered. See attached police report or correspondence.

Notice for applicants with warrants or unpaid fines:

Proof of warrant satisfaction or payment of fines must be submitted at the hearing on the above date and time. Failure to comply with this requirement may result in a delay of the granting/denial of your application.

Failure to attend this meeting may result in the denial of your license. Individual applicants and partnership applicants must attend or attend by an attorney. The agent or attorney for corporate or limited liability applicants must attend. If you wish to do so and at your own expense, you may be accompanied by an attorney of your choosing to represent you at this hearing.

You will be given an opportunity to speak on behalf of the application and to respond and challenge any charges or reasons given for the denial. No petitions can be accepted by the committee, unless the people who signed the petition attend the virtual hearing and are willing to testify. You may present witnesses under oath and you may also confront and cross-examine opposing witnesses under oath. If you have difficulty with the English language, you should request an interpreter attend the meeting with you, at your expense, so that you can answer questions and participate in your hearing.

PLEASE NOTE: Upon reasonable notice, efforts will be made to accommodate the needs of disabled individuals through sign language interpreters or other auxiliary aids. For additional information or to request this service, contact the Council Services Division ADA Coordinator at (414) 286-2998, Fax - (414) 286-3456, TDD - (414) 286-2025.

JIM OWCZARSKI, CITY CLERK

BY: _____

Jessica Celella

License Division Manager

If you have questions regarding this meeting, please contact the staff assistant, Molly Kuether-Steele at (414) 286-2775 or molly.kuether-steele@milwaukee.gov.

MILWAUKEE POLICE DEPARTMENT
LICENSE INVESTIGATION UNIT

CRIMINAL RECORD/ORDINANCE VIOLATION/INCIDENTS
SYNOPSIS

DUPLICATE

DATE: 04/20/2019

LICENSE TYPE: AMALT

NEW:

RENEWAL: X

No. 308896

Application Date: 04/16/2020

Expiration Date:

License Location: 2803 N 35th Street

Aldermanic District:15

Business Name: Family Food Market

Licensee/Applicant: Asad, Naser

(Last Name, First Name, MI)

Date of Birth: 10/09/69

Male: X

Female:

Home Address: 6872 S Tumblecreek Dr

City: Franklin

State: Wi

Zip Code: 53132

Home Phone: (414) 817-0202

This report is written by Police Officer David NOVAK, assigned to the License Investigation Unit, Days.

The Milwaukee Police Department's investigation regarding this application revealed the following:

1. On 08-21-04, applicant received a citation for Sale of Cigarettes to Minor/Underage at 2438 W Greenfield Avenue.

Charge: Sale of Cigarettes to Minor/Underage
Finding: Guilty
Sentence: Fined \$152.00
Date: 10/12/04
Case: 04102671

- =====
2. On 06/17/2017 a 17 year old working in conjunction with the Milwaukee Police Department and WI WINS Tobacco initiative, was able to purchase a 2 pack White Grape flavored White Owl cigar from the clerk at Family Food Market, 2803 N. 35th St. The clerk was identified as Osyed SALEM who admitted to the sale. The officer asked to see SALEM's Class D Operators license but he did not have one. The applicant was mailed a MARTS letter. As of 09/21/2017 the applicant did not enroll in the program and was issued a citation for the violation.

Charge 1: Responsible Person on Premise

2: Sale of Cigarettes to Minor/Underage

Finding 1: Guilty

2: Guilty

Sentence 1: Fined \$378.00
2: Fined \$260.00
Date: 08/04/2017
Case 1: 17027915
2: 17051157

DUPLICATE

- =====
3. On 08/04/2018 a 17 year old working in conjunction with the Milwaukee Police Department and WI WINS Tobacco initiative, was able to purchase a Swisher Sweet cigar from the clerk at 2803 N. 35th St. The clerk did ask for ID but made the sale anyways. The clerk was identified as Draoui DRISS. He stated he did not recall the sale. He was advised the agent would receive a MARTS enrollment package in the mail.
- =====

4. On 05/22/2019 an officer was advised the applicant did enroll in MARTS for item #3 but failed a mystery shopper visit on 12/08/2018. The applicant was issued a citation for Sale of Cigarette to Minor/Underage for the 08/04/2018 violation.

Charge: Sale of Cigarette to Minor/Underage
Finding: Guilty
Sentence: Fined \$350.00
Date: 08/14/2019
Case: 19026296

PREVIOUS PREMISE

DUPLICATE

Date: 1/11/2021

Officer: Bowie Buchner

City of Milwaukee Police Department

90-5-1.5 Crime Prevention Survey

Convenience Store/Liquor Store Inspection

Name of Business: Omar Food Market

Address: 2803 N 35th St

Phone: Click here to enter text.

Owner: Ahmed I Salem

Owner address: 6257 S 26th St

City State Zip: Milwaukee, WI 53221

Owner Phone: 414-552-3357

Owner email: dameen749@gmail.com

Manager: Click here to enter text.

Home Address: Click here to enter text.

City State Zip: Click here to enter text.

Phone: Click here to enter text.

Email: Click here to enter text.

Preferred contact: Ahmed Salem

DUPLICATE

Location currently open: YES NO

Projected open date: Click here to enter text.

Day's open: S M T W Th F SA ALL

Hours of Operation: Sun: 9:00A.M. – 9:00P.M. 24 hours Y N

Mon: 9:00A.M. – 9:00P.M.

Tue: 9:00A.M. – 9:00P.M.

Wed: 9:00A.M. – 9:00P.M.

Thu: 9:00A.M. – 9:00P.M.

Fri: 9:00A.M. – 9:00P.M.

Sat: 9:00A.M. – 9:00P.M.

Premise Type: Liquor Store

Convenience Store

Other:

Licenses currently held:

Alcohol: Yes No Class: A #: AMALT 317148

Tobacco: Yes No #: CIG 317149

Food: Yes No #: FOOD 317150

Extended Hours: Yes No #: Click here to enter text.

Secondhand Dealer: Yes No Type:Click here to enter text. #: Click here to enter text.

Other: Yes No Type:Click here to enter text. #: Click here to enter text.

Other: Yes No Type: Click here to enter text. #: Click here to enter text.

Who is your alcohol distributor? Miller and Budweiser

DUPLICATE

Exterior Survey:

1. Is the area around the location clean? Yes No
2. What surrounds the location? (Check all the apply)
 - a. Park
 - b. School
 - c. Youth Center
 - d. Church
 - e. Tavern(s) If so, how many 1 (not currently open)
 - f. Residential
 - g. Other businesses
 - h. Other: Click here to enter text.
3. Can you see from the outside of the location into the interior Yes No
4. Can you see the employees inside of the location from the outside Yes No
5. Are exterior windows free of signage Yes No
6. Is there a parking lot Yes No
7. Is the parking lot clean? Yes No
8. Is the parking lot well lit? Yes No
9. Are there areas where a person could conceal themselves Yes No
10. Is there exterior lighting? Yes No. Does it appears to be adequate Yes No
11. Exterior Payphone? Yes No, inoperable
12. Are there No Loitering Signs posted? Yes No
13. Are the address numbers prominently displayed and easy to see Yes No

DUPLICATE

Camera Survey:

14. Does this location have security cameras? Yes No
15. Are they in working order? Yes No
16. What format are the cameras?
- a. Color Yes No
 - b. Digital Yes No
 - c. VCR Yes No
 - d. Recorded Yes No
17. How long is footage stored for later viewing: Video is stored until storage is full then loops to record over the oldest footage. Approximately 90 days
18. Are there exterior cameras Yes No How many:
19. Are there interior cameras Yes No How many:
20. Do all employees know how to retrieve recorded digital images/footage? Yes No

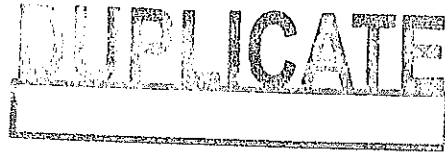

Interior Survey:

21. Is the storeowner willing to be a standing complainant regarding loitering? Yes No
- a. If yes have them fill out the standing complaint form and give them two of the commercial signs Yes No
22. Is the interior of the location neat and clean? Yes No
23. Does an interior camera face the entrance/exit? Yes No
24. Is there a lockable area that separates employees from customers? Yes No
25. Does the store sell single chore boy? Yes No
26. Does the store sell blunt wraps? Yes No
27. Does the store sell scales? Yes No
28. Does the store sell items that may be used as crack pipes? Yes No
- a. Describe item : Click here to enter text.
29. Does the store have an overabundance of sandwich baggies: Yes No
30. Does the owner understand that these items are often used for drug use? Yes No
31. Do the products in the store appear to be new and rotated often? Yes No
32. Are emergency and non-emergency numbers posted near the phone? Yes No
33. Does the owner know how to contact their police district directly? Yes No
- a. Did you provide a district contact guide to the owner? Yes No

Duplicate

Complete this section if alcohol establishment is a convenience store:

(** Read full ordinance for all details "68-55 Convenience Food Stores")

All convenience food stores not exempted under sub. 3 shall:

1. Is the cash register located in a manner so that at the time of a sales transaction, the employee and customer are both visible from the sidewalk? Yes No **
2. Are the glass entrance and exit doors clear of any signs or advertisements with the exception of a sign which states that the cash register contains \$50 or less and that the safe is no accessible to employees? Yes No
3. Does the store maintain one of the following on the licensed premise:
 - a. A safe that was in use at the convenience food store on August 17, 1994?
Yes No
 - b. A drop-safe or time release safe that weighs at least 500 pounds or which is attached to or set into the floor in a manner approved by the police department? Yes No
4. Is lighting provided for the store's parking area during all hours of darkness when employees or customers are on the premises at a minimum average of 2-foot candles per square foot, unless the store is not open for business after sunset and before sunrise? Yes No N/A
5. Are at least two high-resolution surveillance security cameras installed?
Yes No
6. Are the security cameras in working order? Yes No
7. Does one camera show an overall view of the counter and register area?
Yes No
8. Does one camera show a clear, identifiable, full frame image of the face of each person entering and leaving the store? Yes No

DPLICATE

9. Are the camera views obstructed by fixtures or displays? Yes No
10. Is the recorded footage stored for at least 30 days? Yes No
11. Do all store employees know how to record footage from the camera system to media capable of being transferred to police custody? Yes No
12. Are customer entrances/exits made of glass or other transparent material?
- Yes No
- a. Exception: A store that does not have such doors on August 17, 1994 shall not be required to install such doors until the holder of the store's food dealer license changes.
13. Has the owner and their employees attended the Robbery Prevention Training within 120 days of ownership or employment? Yes No
- a. Contact Community Outreach and Education at 935-7836 for schedule.

DUPLICATE

Sub 3. Exemptions. The requirements of this section do not apply to a convenience food store that conforms to either of the following descriptions:

a-1. The store is located in an enclosed shopping structure, enclosed commercial building or hospital. A convenience food store is not in an enclosed structure or building if a customer can enter it directly from the outside.

Does store conform to a-1 Yes No

a-2 The store physically separates employees from customers with a solid partition that bars a person from entering the employee area from the customer area, has a secure lock on the employee side of any door between the employee area and the customer, and conducts all transaction through a service window or similar arrangement.

Does store conform to a-2 Yes No

a. At the commissioner's discretion, a convenience store may be exempted from any or all of the regulations specified in sub 2.

Does this location hold an exemption from the commissioner regarding any of the requirements of Sub 2? Yes No

ADDITIONAL COMMENTS/RECOMMENDATIONS:

This location has four exterior cameras and five interior cameras. The owner has not attended the Robbery Prevention Training, but the employees have. Lastly, since the owner is expemted from sub 3 due to a-2 I did not advise that he is required to take the Robbery Prevention Training

City of Milwaukee
2803 N 35th St

Area of Interest (AOI) Information

Area : 21,862,585.6 ft²

Nov 3 2020 14:46:51 Central Standard Time

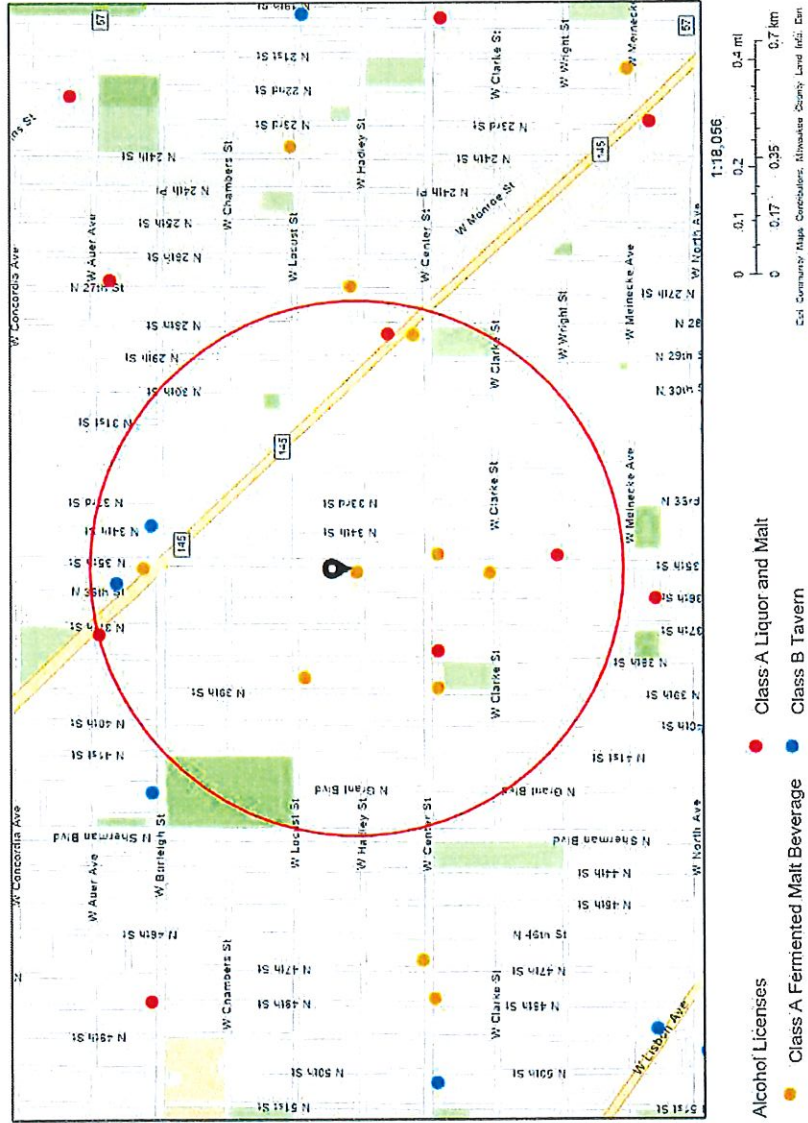

DUPLICATE

Summary

Name	Count	Area(ft ²)	Length(mi)
Alcohol Licenses	13		

Alcohol Licenses

DUPLICATE

#	Legal Entity	Trade Name	Licensee	Address	License Type Name	Total Capacity	Expiration Date	Count
1	Lama LLC	One Stop Mart	BELAL N ATARI, Agt	2709 N 28th ST	Class A Fermented Malt Beverage Retailer's License		2/7/2021, 6:00 PM	1
2	Y & A Food Inc	Alliance Super Food Market	Salah Qandeel, Agt	2672 N 35th ST	Class A Fermented Malt Beverage Retailer's License		2/20/2021, 6:00 PM	1
3	BUYRITE FOOD & LIQUOR	BUYRITE FOOD & LIQUOR	GEORGE C KUSAK, SP	2500 N 35TH ST	Class A Malt & Class A Liquor License		7/5/2021, 7:00 PM	1
4	NAT LIQUOR & FOOD MART, INC	S & A LIQUOR	MAMTA SINGH, Agt	3725 W CENTER ST	Class A Malt & Class A Liquor License		7/5/2021, 7:00 PM	1
5	SKYWAY FOOD MART	SKYWAY FOOD MART	AVTAR S KANG, SP	2601 N 35TH ST	Class A Fermented Malt Beverage Retailer's License		3/22/2021, 7:00 PM	1
6	Ravneet Liquor, Inc	ABC Beer & Liquor Depot	KANWARVIR SINGH, Agt	2816 W Fond du Lac AV	Class A Malt & Class A Liquor License		8/11/2021, 7:00 PM	1
7	Lucky & Bill, Inc	All For Us	Baljinder Singh, Agt	3500 W Fond Du Lac AV	Class A Fermented Malt Beverage Retailer's License		9/23/2021, 7:00 PM	1
8	Walters Grocery, LLC	Walters Grocery	ASTON B WALTERS, Agt	3821 W LOCUST ST	Class A Fermented Malt Beverage Retailer's License		6/9/2021, 7:00 PM	1
9	Vibez Creative Arts Space LLC	Vibez Creative Arts Space	Chrishella R Carter, Agt	3536 W Fond Du Lac AV 201	Class B Tavern License		12/18/2020, 6:00 PM	1

DUPLICATE

10	QUICK FOOD MARKET	QUICK FOOD MARKET	BALJEET KAUR, Raghwi nder Singh	3833 W CENTER ST	Class A Fermented Malt Beverage Retailer's License	12/26/2020, 6:00 PM	1
11	FAMILY FOOD MARKET	FAMILY FOOD MARKET	NASERA ASAD, SP	2803 N 35TH ST	Class A Fermented Malt Beverage Retailer's License	5/25/2021, 7:00 PM	1
12	PEOPLE'S LOUNGE	PEOPLE'S LOUNGE	MC WILLIE LEWIS, SP	3328 W BURLEIGH ST	Class B Tavern License	6/29/2021, 7:00 PM	150
13	G & R, INC	POLINA'S LIQUOR	YANINA GOBERMAN, Agt	3179 N 37TH ST	Class A Malt & Class A Liquor License	2/6/2021, 6:00 PM	1

Establishments within a 0.5 miles radius centered on area of interest.

DUPLICATE



Wednesday, March 17, 2021

Licenses Committee Notice of Hearing

NASER ASAD
6872 S TUMBLECREEK DR
FRANKLIN, WI 53132

The Licenses Committee will consider the following license application:

Class A Malt and Food Dealer License Applications
SALEM, Ahmed I, Agent
Omar Food at 2803 N 35TH St

Date: 3/30/2021

Time: 01:10 PM

Location: The hearing before the Licenses Committee will take place virtually on Tuesday, March 30, 2021. This is a public hearing. Those wishing to view the proceeding are able to do so via the City Channel – Channel 25 on Spectrum Cable – or on the Internet at <http://city.milwaukee.gov/citychannel>. Those wishing to provide oral testimony will be asked to do so by phone or internet and are asked to contact the staff assistant, Molly Kuether-Steele at (414) 286-2775 or molly.kuether-steele@milwaukee.gov for necessary information. Please make such requests no later than one business day prior to the start of the meeting. You are not required to attend the hearing, but please see the information below if you would like to provide testimony

Please note this application may be recommended for denial based on fitness of the location due to concentration of alcohol beverage outlets in the area. If the application is denied for this reason, no other application for an alcohol beverage license for this location shall be recommended for approval by the Licenses Committee within three years of the date of denial unless the applicant has demonstrated a change of circumstances since the prior denial.





Wednesday, March 17, 2021



Notice of Public Hearing

blank
notice

SALEM, Ahmed I, Agent
Omar Food at 2803 N 35TH St
Class A Malt and Food Dealer License Applications

Tuesday, March 30, 2021 at 1:10 PM

To whom it may concern:

The above application has been made by the above named applicant(s). This requires approval from the Licenses Committee and the Common Council of the City of Milwaukee. The hearing before the Licenses Committee will take place virtually on 3/30/2021 at 1:10 PM. This is a public hearing. Those wishing to view the proceeding are able to do so via the City Channel – Channel 25 on Spectrum Cable – or on the Internet at <http://city.milwaukee.gov/citychannel>. Those wishing to provide oral testimony will be asked to do so by phone or internet and are asked to contact the staff assistant, Molly Kuether-Steele at (414) 286-2775 or molly.kuether-steele@milwaukee.gov for necessary information. Please make such requests no later than one business day prior to the start of the meeting. You are not required to attend the hearing, but please see the information below if you would like to provide testimony. Once the Licenses Committee makes its recommendation, this recommendation is forwarded to the full Common Council for approval at its next regularly scheduled hearing.

Important details for those wishing to provide information for the Licenses Committee to consider when making its recommendation:

1. The license application is scheduled to be heard at the above time. Due to other hearings running longer than scheduled, you may have to wait some time to provide your testimony.
2. You must testify as to matters that you have personally experienced or seen. (You cannot provide testimony for your neighbor, parent or anyone else; this is considered hearsay and cannot be considered by the committee.)
3. No letters or petitions can be accepted by the committee (unless the person who wrote the letter or the persons who signed the petition are willing to testify).
4. Persons opposed to the license application are given the opportunity to testify first; supporters may testify after the opponents have finished.
5. When you are called to testify, you will be sworn in and asked to give your name, and address. (If your first and/or last names are uncommon please spell them.)
6. You may then provide testimony.
 - a. Include only information relating to the above license application.
 - b. Include only information you have personally witnessed or seen.
 - c. Provide concise and relevant information detailing how this business has affected or may affect the peaceful enjoyment of your neighborhood.
 - d. If by the time you have the opportunity to testify, the information you wish to share has already been provided to the committee, you may state that you agree with the previous testimony. Redundant or repetitive testimony will not assist the committee in making its recommendation.
7. After giving your testimony, the members of the Licenses Committee and the licensee may ask questions regarding the testimony you have given or other factors relating to the license application.
8. Business Competition is not a valid basis for denial or non-renewal of a license.

Please Note: If you have submitted an objection to the above application your objection cannot be considered by the committee unless you personally testify at the hearing.

OCCUPANT	MAIL ADDRESS	CITY, STATE ZIP
CURRENT OCCUPANT	2826A N 35TH ST	MILWAUKEE, WI 53210
CURRENT OCCUPANT	2776 N 35TH ST 3	MILWAUKEE, WI 53210
CURRENT OCCUPANT	2776 N 35TH ST 5	MILWAUKEE, WI 53210
CURRENT OCCUPANT	2776 N 35TH ST 7	MILWAUKEE, WI 53210
CURRENT OCCUPANT	2772 N 35TH ST	MILWAUKEE, WI 53210
CURRENT OCCUPANT	2823 N 34TH ST 1	MILWAUKEE, WI 53210
CURRENT OCCUPANT	2823 N 34TH ST 2	MILWAUKEE, WI 53210
CURRENT OCCUPANT	2819 N 34TH ST	MILWAUKEE, WI 53210
CURRENT OCCUPANT	2815 N 34TH ST	MILWAUKEE, WI 53210
CURRENT OCCUPANT	2779 N 34TH ST	MILWAUKEE, WI 53210
CURRENT OCCUPANT	2773 N 34TH ST	MILWAUKEE, WI 53210
CURRENT OCCUPANT	2809 N 35TH ST	MILWAUKEE, WI 53210
CURRENT OCCUPANT	2823 N 35TH ST	MILWAUKEE, WI 53210
CURRENT OCCUPANT	2828 N 36TH ST	MILWAUKEE, WI 53210
CURRENT OCCUPANT	3515 W HADLEY ST 105	MILWAUKEE, WI 53210
CURRENT OCCUPANT	3515 W HADLEY ST 107	MILWAUKEE, WI 53210
CURRENT OCCUPANT	3515 W HADLEY ST 205	MILWAUKEE, WI 53210
CURRENT OCCUPANT	3515 W HADLEY ST 215	MILWAUKEE, WI 53210
CURRENT OCCUPANT	3515 W HADLEY ST 218	MILWAUKEE, WI 53210
CURRENT OCCUPANT	3515 W HADLEY ST 306	MILWAUKEE, WI 53210
CURRENT OCCUPANT	3515 W HADLEY ST 314	MILWAUKEE, WI 53210
CURRENT OCCUPANT	2776 N 35TH ST 2	MILWAUKEE, WI 53210
CURRENT OCCUPANT	2823 N 34TH ST 3	MILWAUKEE, WI 53210
CURRENT OCCUPANT	2777 N 34TH ST	MILWAUKEE, WI 53210
CURRENT OCCUPANT	2810A N 36TH ST	MILWAUKEE, WI 53210
CURRENT OCCUPANT	2817 N 36TH ST	MILWAUKEE, WI 53210
CURRENT OCCUPANT	2821 N 35TH ST	MILWAUKEE, WI 53210
CURRENT OCCUPANT	3515 W HADLEY ST 112	MILWAUKEE, WI 53210
CURRENT OCCUPANT	3515 W HADLEY ST 202	MILWAUKEE, WI 53210
CURRENT OCCUPANT	3515 W HADLEY ST 303	MILWAUKEE, WI 53210
CURRENT OCCUPANT	3515 W HADLEY ST 318	MILWAUKEE, WI 53210
CURRENT OCCUPANT	3515 W HADLEY ST 304	MILWAUKEE, WI 53210
CURRENT OCCUPANT	3515 W HADLEY ST 308	MILWAUKEE, WI 53210
CURRENT OCCUPANT	3515 W HADLEY ST 315	MILWAUKEE, WI 53210
CURRENT OCCUPANT	2756 N 35TH ST	MILWAUKEE, WI 53210
CURRENT OCCUPANT	2818 N 35TH ST	MILWAUKEE, WI 53210
CURRENT OCCUPANT	2810 N 35TH ST	MILWAUKEE, WI 53210
CURRENT OCCUPANT	2776 N 35TH ST 1	MILWAUKEE, WI 53210
CURRENT OCCUPANT	2823 N 34TH ST 6	MILWAUKEE, WI 53210
CURRENT OCCUPANT	2815A N 34TH ST	MILWAUKEE, WI 53210
CURRENT OCCUPANT	2800 N 36TH ST	MILWAUKEE, WI 53210
CURRENT OCCUPANT	2806 N 36TH ST	MILWAUKEE, WI 53210
CURRENT OCCUPANT	2820 N 36TH ST	MILWAUKEE, WI 53210
CURRENT OCCUPANT	2824 N 36TH ST	MILWAUKEE, WI 53210
CURRENT OCCUPANT	2829 N 35TH ST	MILWAUKEE, WI 53210
CURRENT OCCUPANT	2831 N 35TH ST	MILWAUKEE, WI 53210

CURRENT OCCUPANT	2841 N 35TH ST	MILWAUKEE, WI 53210
CURRENT OCCUPANT	2839 N 35TH ST	MILWAUKEE, WI 53210
CURRENT OCCUPANT	3515 W HADLEY ST 102	MILWAUKEE, WI 53210
CURRENT OCCUPANT	3515 W HADLEY ST 120	MILWAUKEE, WI 53210
CURRENT OCCUPANT	3515 W HADLEY ST 206	MILWAUKEE, WI 53210
CURRENT OCCUPANT	3515 W HADLEY ST 219	MILWAUKEE, WI 53210
CURRENT OCCUPANT	3515 W HADLEY ST 316	MILWAUKEE, WI 53210
CURRENT OCCUPANT	3515 W HADLEY ST 319	MILWAUKEE, WI 53210
CURRENT OCCUPANT	3515 W HADLEY ST 311	MILWAUKEE, WI 53210
CURRENT OCCUPANT	2764 N 35TH ST	MILWAUKEE, WI 53210
CURRENT OCCUPANT	2767 N 34TH ST	MILWAUKEE, WI 53210
CURRENT OCCUPANT	2826 N 35TH ST	MILWAUKEE, WI 53210
CURRENT OCCUPANT	2820 N 35TH ST	MILWAUKEE, WI 53210
CURRENT OCCUPANT	2823 N 34TH ST 4	MILWAUKEE, WI 53210
CURRENT OCCUPANT	2810 N 36TH ST	MILWAUKEE, WI 53210
CURRENT OCCUPANT	2815 N 35TH ST	MILWAUKEE, WI 53210
CURRENT OCCUPANT	2825 N 35TH ST	MILWAUKEE, WI 53210
CURRENT OCCUPANT	2834 N 36TH ST	MILWAUKEE, WI 53210
CURRENT OCCUPANT	2837 N 35TH ST	MILWAUKEE, WI 53210
CURRENT OCCUPANT	2832 N 35TH ST	MILWAUKEE, WI 53210
CURRENT OCCUPANT	3515 W HADLEY ST 101	MILWAUKEE, WI 53210
CURRENT OCCUPANT	3515 W HADLEY ST 110	MILWAUKEE, WI 53210
CURRENT OCCUPANT	3515 W HADLEY ST 111	MILWAUKEE, WI 53210
CURRENT OCCUPANT	3515 W HADLEY ST 203	MILWAUKEE, WI 53210
CURRENT OCCUPANT	3515 W HADLEY ST 207	MILWAUKEE, WI 53210
CURRENT OCCUPANT	3515 W HADLEY ST 208	MILWAUKEE, WI 53210
CURRENT OCCUPANT	3515 W HADLEY ST 209	MILWAUKEE, WI 53210
CURRENT OCCUPANT	3515 W HADLEY ST 212	MILWAUKEE, WI 53210
CURRENT OCCUPANT	3515 W HADLEY ST 217	MILWAUKEE, WI 53210
CURRENT OCCUPANT	2830 N 35TH ST	MILWAUKEE, WI 53210
CURRENT OCCUPANT	2776 N 35TH ST 4	MILWAUKEE, WI 53210
CURRENT OCCUPANT	2817 N 35TH ST	MILWAUKEE, WI 53210
CURRENT OCCUPANT	3515 W HADLEY ST 103	MILWAUKEE, WI 53210
CURRENT OCCUPANT	3515 W HADLEY ST 104	MILWAUKEE, WI 53210
CURRENT OCCUPANT	3515 W HADLEY ST 106	MILWAUKEE, WI 53210
CURRENT OCCUPANT	3515 W HADLEY ST 108	MILWAUKEE, WI 53210
CURRENT OCCUPANT	3515 W HADLEY ST 115	MILWAUKEE, WI 53210
CURRENT OCCUPANT	3515 W HADLEY ST 117	MILWAUKEE, WI 53210
CURRENT OCCUPANT	3515 W HADLEY ST 210	MILWAUKEE, WI 53210
CURRENT OCCUPANT	3515 W HADLEY ST 211	MILWAUKEE, WI 53210
CURRENT OCCUPANT	3515 W HADLEY ST 214	MILWAUKEE, WI 53210
CURRENT OCCUPANT	3515 W HADLEY ST 307	MILWAUKEE, WI 53210
CURRENT OCCUPANT	3515 W HADLEY ST 310	MILWAUKEE, WI 53210
CURRENT OCCUPANT	3515 W HADLEY ST 312	MILWAUKEE, WI 53210
CURRENT OCCUPANT	2814A N 35TH ST	MILWAUKEE, WI 53210
CURRENT OCCUPANT	2814 N 35TH ST	MILWAUKEE, WI 53210
CURRENT OCCUPANT	3424 W HADLEY ST	MILWAUKEE, WI 53210

CURRENT OCCUPANT	2811 N 34TH ST	MILWAUKEE, WI 53210
CURRENT OCCUPANT	2779 N 36TH ST	MILWAUKEE, WI 53210
CURRENT OCCUPANT	2813 N 36TH ST	MILWAUKEE, WI 53210
CURRENT OCCUPANT	2813 N 35TH ST	MILWAUKEE, WI 53210
CURRENT OCCUPANT	2827 N 36TH ST	MILWAUKEE, WI 53210
CURRENT OCCUPANT	2838 N 36TH ST	MILWAUKEE, WI 53210
CURRENT OCCUPANT	2767 N 36TH ST	MILWAUKEE, WI 53210
CURRENT OCCUPANT	3515 W HADLEY ST 116	MILWAUKEE, WI 53210
CURRENT OCCUPANT	3515 W HADLEY ST 118	MILWAUKEE, WI 53210
CURRENT OCCUPANT	3515 W HADLEY ST 119	MILWAUKEE, WI 53210
CURRENT OCCUPANT	3515 W HADLEY ST 201	MILWAUKEE, WI 53210
CURRENT OCCUPANT	3515 W HADLEY ST 317	MILWAUKEE, WI 53210
CURRENT OCCUPANT	2766 N 35TH ST	MILWAUKEE, WI 53210
CURRENT OCCUPANT	2760 N 35TH ST	MILWAUKEE, WI 53210
CURRENT OCCUPANT	2760A N 35TH ST	MILWAUKEE, WI 53210
CURRENT OCCUPANT	2756A N 35TH ST	MILWAUKEE, WI 53210
CURRENT OCCUPANT	2769 N 34TH ST	MILWAUKEE, WI 53210
CURRENT OCCUPANT	2810A N 35TH ST	MILWAUKEE, WI 53210
CURRENT OCCUPANT	2776 N 35TH ST 6	MILWAUKEE, WI 53210
CURRENT OCCUPANT	2776 N 35TH ST 8	MILWAUKEE, WI 53210
CURRENT OCCUPANT	2823 N 34TH ST 5	MILWAUKEE, WI 53210
CURRENT OCCUPANT	2817 N 34TH ST	MILWAUKEE, WI 53210
CURRENT OCCUPANT	2777 N 36TH ST	MILWAUKEE, WI 53210
CURRENT OCCUPANT	2819 N 35TH ST	MILWAUKEE, WI 53210
CURRENT OCCUPANT	2835 N 35TH ST	MILWAUKEE, WI 53210
CURRENT OCCUPANT	2769 N 36TH ST	MILWAUKEE, WI 53210
CURRENT OCCUPANT	3515 W HADLEY ST 113	MILWAUKEE, WI 53210
CURRENT OCCUPANT	3515 W HADLEY ST 204	MILWAUKEE, WI 53210
CURRENT OCCUPANT	3515 W HADLEY ST 220	MILWAUKEE, WI 53210
CURRENT OCCUPANT	3515 W HADLEY ST 301	MILWAUKEE, WI 53210
CURRENT OCCUPANT	3515 W HADLEY ST 302	MILWAUKEE, WI 53210
CURRENT OCCUPANT	3515 W HADLEY ST 305	MILWAUKEE, WI 53210
CURRENT OCCUPANT	3515 W HADLEY ST 309	MILWAUKEE, WI 53210
CURRENT OCCUPANT	3515 W HADLEY ST 313	MILWAUKEE, WI 53210
CURRENT OCCUPANT	2766A N 35TH ST	MILWAUKEE, WI 53210
CURRENT OCCUPANT	2807 N 36TH ST	MILWAUKEE, WI 53210
CURRENT OCCUPANT	2809A N 35TH ST	MILWAUKEE, WI 53210
CURRENT OCCUPANT	3515 W HADLEY ST 109	MILWAUKEE, WI 53210
CURRENT OCCUPANT	3515 W HADLEY ST 114	MILWAUKEE, WI 53210
CURRENT OCCUPANT	3515 W HADLEY ST 213	MILWAUKEE, WI 53210
CURRENT OCCUPANT	3515 W HADLEY ST 216	MILWAUKEE, WI 53210
CURRENT OCCUPANT	3515 W HADLEY ST 320	MILWAUKEE, WI 53210
blank	notice	

Total Records: 135

Radius: 250.0 feet and Center of Circle: 2803 N 35th St



BUSINESS LICENSE PLAN OF OPERATION

Office of the City Clerk License Division
200 E. Wells St. Room 105, Milwaukee, WI 53202
(414) 286-2238 www.milwaukee.gov/license e-mail address: license@milwaukee.gov

DUPLICATE
ccl-busplan 3/15/18

1. Type of Business

Applying for: Extended Hours (12AM to 5AM) - If a food establishment, check all that apply: Delivery Drive Thru Dining Room
 Self Service Laundry Massage Establishment Filling Station
 Other (supplemental application for specific license also required)

Provide a detailed description of the type of business you plan on operating:

Convenience Store

Do you have any experience operating this type of business? No Yes If yes, explain: Worked in a store 10 years.

2. Business Operations

- a. Proposed Opening Date: 8/20/2020
- b. Is this premise under construction? No Yes If yes, list estimated completion date: _____
- c. Is this a franchise? No Yes
- d. Is this premises currently licensed? No Yes If yes, list type of license: Food, occupancy, tobacco
- e. Is the current licensee operating? No Yes If no, list date closed: _____
- f. Do you have future plans for other businesses, licenses or permits at this location? No Yes
If yes, explain: _____
- g. Have you previously held an Extended Hours License in Milwaukee? No Yes
If yes, list address(es): _____
- h. Are other businesses operating in the same building? No Yes If yes, describe: _____

3. Litter & Noise

- a. How are grounds kept clean? Sweep Pressure Wash Pick Up Litter Other: _____
- b. How often will grounds be cleaned? Daily Weekly As Needed Monthly Other: _____
- c. Grounds cleaned by: Licensee Building Owner Employees Hired Maintenance Other: _____
- d. How are noise issues prevented and/or addressed? Security Manager approaches customer(s) Call Police
 Signs Posted Other: _____
- e. Will a sound amplification system be used? No Yes If yes, describe: _____

4. Smoking & Sanitation

- a. Are there designated outdoor smoking areas? No Yes If yes, describe: _____
- b. Number of Garbage Cans: Inside: 1 Locations: front
Outside: 2 Locations: back building
- c. Is a crowd control barrier used? No Yes If yes, describe: _____
- d. How many restrooms are on the premises? 1
- e. Name of solid waste contractor: Advanced Disposal Waste Management Other: _____

DUPLICATE

5. Security

- a. Are there onsite parking spaces? No Yes If yes, how many? _____ and describe the parking security plan: _____
- b. Is there a loading zone? No Yes If yes, describe the loading area security plan: _____
- c. Will you have security personnel on premise? No Yes If yes, how many? _____ and answer the following:
What are their responsibilities? _____
Is security equipment used? No Yes If yes, describe _____
List their licensing, certification, or training credentials _____
- d. Will there be security cameras? No Yes If yes, how many? 8 and list locations: inside 4 front door, back and surrounding outside 4.
- e. Will searches/identification checks be done upon entry? No Yes If yes, describe _____

6. Percentage of Sales (must total 100%)

Alcohol <u>20</u> %	Food <u>45</u> %	Secondhand Merchandise _____ %	Precious Metals & Gems _____ %
Entertainment _____ %	Cigarettes <u>25</u> %	Personal Services (such as tattoo, body piercing, salon, tailor, tanning, etc.) _____ %	Other <u>10</u> % Describe: <u>TISSUE, diapers, paper plates,</u>
Pawnbroker Activity _____ %	Salvaged Materials _____ % (such as scrap metal)		

7. Businesses/Licenses on the Premises (check all that apply):

- Type 1
- Full Service Restaurant Cafe/Coffee Shop Deli or Fast Food Restaurant Private/Fraternal/Veterans Club
- Night Club Tavern Cocktail Lounge Teen Club
- Banquet Hall Sports Facility Bowling Alley
- Hotel/Motel : Number of Floors: _____ Rooming House: Number of Floors: _____
Number of Rooms: _____ Number of Rooms: _____

- Type 2
- Liquor Store Corner Store Supermarket Convenience Store
- Gas Station Amusement/Phonograph Distributor Recycling, Salvage or Towing
- Used Car Dealer Personal Service Establishment
(such as tattoo business, hair salon, tailor, etc.) Recording Studio

What other licenses/permits will you hold at this location? (check all that apply)

- Occupancy Permit Cigarette & Tobacco Gas Station Extended Hours Class "B" Tavern Weights & Measures
- Secondhand Dealer Precious Metal & Gem Other: _____

8. Legal Capacity (only if a Type 1 premises in #7 above)

Capacity _____ (Call the Milwaukee Development Center at 414-286-8211 if you have questions.)

DUPLICATE

9. Premises Description

- a. Identify all area(s) of the premises that will be used in operating this business (include areas used only for storage):
 1st Floor 2nd Floor Basement Storage Patio Beer Garden Sidewalk Café Deck Rooftop
 Other: Describe: _____
- b. Describe Location: Major Thoroughfare Secondary Street Other: _____
- c. Nearest Major Cross Street: N. 35th Street
- d. Describe Building: Free Standing Building Strip Mall Other: _____
- e. Describe Premises Structure: Single Story Multi-Story - # of Stories _____ Other: _____
- f. Describe Surrounding Area: Commercial Residential Industrial Other: _____
- g. Building Owner Name: Naser Asad Phone Number: (414) 384-0808
 Business Owner Address: 2803 N 35th St Milwaukee WI 53210

10. Hours of Operation & Customers

Will customers be entering the premises? No Yes

Day of the Week	Proposed Hours of Operation:		Estimated Number of Customers expected each day	Potential Age Range of Customers	Class B Tavern Applicant Only: Age Restriction (If none, write 'None')
	Open Time (Include a.m. or p.m.)	Close Time (Include a.m. or p.m.)			
Sunday	8am	9pm	100	7-80	
Monday	"	"	"	"	
Tuesday	"	"	"	"	
Wednesday	"	"	"	"	
Thursday	"	"	"	"	
Friday	"	"	"	"	
Saturday	"	"	"	"	

An Extended Hours Establishment License is required for any convenience store, filling station, personal service establishment (such as tattoo, body piercing, salon, tailor, tanning, etc.), recording studio or restaurant which is open between the hours of 12:00 a.m. and 5:00 a.m.

Alcohol Establishments Permitted Hours of Operation: Class A: 8:00 am to 9:00 pm Sunday thru Saturday
 Class B: 6:00 am to 2:00 am Sunday thru Thursday, 6:00 am to 2:30 am Friday & Saturday

Entertainment Outdoor Closing Hours: 10:00pm Sunday-Thursday; 12:00am Friday & Saturday; unless a different time, either earlier or later, is established by the Common Council in its approval of the licensee's plan of operation.

11. Signature(s)

Anmer Salem
 Signature of Sole Proprietor, Partner, or 20% or more Shareholder
 (If there are no 20% or more shareholders,
 Corporate Officer-print name/title and sign)

 Signature of additional partner or 20% or more shareholder

See Application Information for a complete list of all required application forms.



**ALCOHOL BEVERAGE & PUBLIC ENTERTAINMENT PREMISES
SUPPLEMENTAL APPLICATION**

Office of the City Clerk License Division
200 E. Wells St. Room 105, Milwaukee, WI 53202
(414) 286-2238 e-mail address: license@milwaukee.gov www.milwaukee.gov/license

DUPLICATE

Legal Entity Name: Omar Food Market LLC

Premise Address: 2803 N 35th St. Milwaukee, WI 53210

Proximity of Premises to Church, School, Daycare Center or Hospital

Is the building within 300 feet of any church, school, daycare center or hospital? No Yes

"Service Bar Only" Designation

If applying for Class B or C license, are you applying for "Service Bar Only"? No Yes

Service Bar Only means customers cannot sit at the bar. Alcohol is served to employees who serve patrons seated at tables. No stools, chairs or other articles of furniture shall be placed at the service bar for patrons to sit upon.

Business Information

a) Are you taking out this application for anyone that may not be eligible for a license? No Yes

If yes, list their name and address: _____

b) Will the agent, a partner or the individual licensee be conducting the day-to-day operations of the business? No Yes

If no, list the name and address of the person(s) who will: _____

Class B Applicants: If the agent, a partner or the individual licensee will not be conducting the day-to-day operations of the business, the person(s) listed above must obtain a Class B Managers license.

c) Does anyone else have money invested or any other interest in this business? No Yes

If yes, explain: _____

d) Have you made an agreement with anyone to repay any loan or any other payments based upon income from the business?

No Yes If yes, list name and address: _____

Property Information (New & Transfer Applicants Only)

a) Do you own or lease the building? Own Lease

b) Who owns the fixtures (for example, coolers, etc.)? Parent Owner

c) Are you purchasing the stock and/or fixtures? No Yes if yes, amount paid \$ _____

d) Total amount paid for business \$ 0

e) Total amount paid for goodwill of the business \$ 0

Goodwill comprises the reputation and customer relationships of an existing business. If the price you pay for the business exceeds the fair market value of all of the rest of the assets of the business, the excess may be considered goodwill.

f) Have you made arrangements with the seller for payment of personal property taxes? No Yes

Lease Information (New & Transfer Applicants who are leasing the premises only)

a) Date lease begins 9-1-2020 Ends 8-31-2030

b) Monthly rental \$ 1,200.00

c) Do you have an option to renew the lease? No Yes

d) Does your lease allow for assignment to another party without the consent of the owner? No Yes

e) For what length of time have you been guaranteed occupancy (number of years)? 10 years

Lease Information (Continued)

- f) In addition to paying the monthly rental, will you have to pay anything additional to the owner of the building to guarantee performance of the lease? No Yes If yes, explain Utilities, Telephone & Internet, Sanitation
- g) Does the present owner or occupancy object to the granting of your license? No Yes
If yes, explain _____

Change of Agent Applicants Only

Have there been any changes to the floor plan since the last application was submitted? No Yes
If no, a new floor plan is not required. If yes, submit a new floor plan and explain the change(s):

Signature

Anmer & Selem

Signature of Sole Proprietor, Partner or 20% or More Shareholder
(If no 20% or more Shareholder, Corporate Officer - print name/title and sign)

Note: All information contained in this application is subject to approval by the Common Council. Deviating from approved plan of operation will subject licensee to citations, and/or suspension or non-renewal of the license. Contact the License Division for information on how to request changes.

DUPLICATE

New and transfer of premises applicants must submit the following:

- Detailed floor plan
- If a restaurant, copy of the menu



FOOD DEALER LICENSE PLAN OF OPERATION

OFFICE OF THE CITY CLERK, LICENSE DIVISION
CITY HALL, 200 E. WELLS ST, ROOM 105, MILWAUKEE, WI 53202
(414) 286-2238 • license@milwaukee.gov • www.milwaukee.gov/license

scf-foodplan 2/28/19

DUPLICATE

Legal Entity Name:	Omar Food Market LLC
Premises Address:	2803 N 35th St. Milwaukee, WI 53210
SECTION 1 TYPE OF BUSINESS	
What will be the majority of your food sales? (check one)	
<input type="checkbox"/> Restaurant Items (meals): MEALS include, but are not limited to, chicken, ribs, sandwiches, roasted corn, baked potatoes, hot dogs, brats, tacos, nachos w/ cheese and meat, French fries, cooked or deep fried vegetables/fruit, cooked cheese curds, corn dogs, egg rolls, salads.	
<input checked="" type="checkbox"/> Retail Items (snacks and beverages): RETAIL items include, but are not limited to, ice cream/soft serve, lemonade, snow cones, coffee, espresso, cappuccino, tea, fruit juice, smoothies, candy, dispensed soda, fruit cups, bakery, cookies, kettle corn, cotton candy, funnel cakes, fritters, tortilla chips w/ cheese.	
Will it be a convenience store? <input checked="" type="checkbox"/> Yes <input type="checkbox"/> No A convenience store contains less than 5,000 square feet of retail space and has, as its primary business, the sale of basic food items and in addition, sells household products or is a filling station that sells basic food items and household products.	
<input type="checkbox"/> Bed & Breakfast <input type="checkbox"/> Micro Market	
All Applicants: Submit a menu or a list of food items that will be sold.	
Will any wholesale business be done? <input checked="" type="checkbox"/> No <input type="checkbox"/> Yes If yes, what percentage of food sales will be wholesale?	
<input type="checkbox"/> Less than 25%	
<input type="checkbox"/> 25% or More AND:	
<input type="checkbox"/> Restaurant items (meals) will be sold – Complete this application and also contact DATCP.	
<input type="checkbox"/> NO restaurant items (meals) will be sold - Do NOT complete this application. Contact DATCP only.	
SECTION 2 FOOD PROCESSING	
Will any food processing be done? <input checked="" type="checkbox"/> No <input type="checkbox"/> Yes	
Processing is defined as assembling, grinding, cutting, mixing, baking, coating, stuffing, packing, bottling, grilling, canning, extracting, fermenting, distilling, pickling, freezing, drying, smoking, or packaging.	
SECTION 3 FOOD REQUIRING TEMPERATURE CONTROL	
Will any food that requires temperature control be sold? <input type="checkbox"/> No <input checked="" type="checkbox"/> Yes (Includes dairy products such as milk, cheese, and ice cream, fish, shellfish, meat, poultry)	
If yes, list the types of food items: <u>Milk, Cheese, ice cream, eggs</u>	

DUPLICATE

SECTION 4 DETAILS OF OPERATION

Will you have seating on site for dining? No Yes

Will you be doing any catering? No Yes

Will you be doing any delivery? No Yes

Will you have outdoor activities? No Yes - Check all that apply: Bar Cooking/Grilling Dining

Will you have a drive thru window? No Yes - Are hours different from inside? No Yes
If Yes, provide drive thru hours: _____

Will scales or barcode scanners be used? No Yes - You must also apply for a Weights & Measures License.

SECTION 5 ADDITIONAL SITES

Where will food be prepared and/or sold?

At a single site At multiple sites: How many? _____ (for example, a hotel with several dining rooms or bars)

If multiple sites, attach a Food Dealer Additional Site Addendum (ccl-foodadd) for each additional site.

SECTION 6 CONSTRUCTION OR CHANGES

Are you planning any construction, remodeling or equipment changes?

No If No, SKIP to Section 8

Yes If Yes, check all that apply: New construction of a building Renovation or remodeling
 Construction changes to existing building Equipment changes only

Provide a brief description of the changes: _____

Start date: _____

Name, Address & Phone Number of Architect: _____

Name, Address & Phone Number of Contractor: _____

SECTION 7 ALCOHOL BEVERAGES

Are you applying for an alcohol beverage license?

No If No, SKIP to Section 8

Yes If YES, if your food license is approved prior to the alcohol license, when do you want the food license issued?
 Immediately At the same time as the alcohol license

SECTION 8 ACKNOWLEDGEMENTS & SIGNATURE

You must initial each item confirming your understanding:

AS I understand the Health Department must conduct an inspection and advise the License Division of their approval before the license may be issued.

AS I understand I must obtain an occupancy permit from the Department of Neighborhood Services and an inspection may be required. Neighborhood Services must advise the License Division of their approval before the license may be issued.

AS I understand the district alderperson will review and either support or object to my application. If he/she objects, I may appeal and be scheduled to appear before the Licenses Committee. The Licenses Committee will then make a recommendation to the Common Council. The Common Council must grant the license before it may be issued.

AS I understand proof of payment for all license fees must be on file in the License Division before the license may be issued and the license must be issued and posted in my establishment prior to opening for business.

AS I will not operate my food business until the license has been issued and posted in the establishment.

Signature of Sole Proprietor, Partner, or 20% Shareholder: Ahmed Salem

Signature of Additional Partner: _____

Legal Entity - Omar Food Market LLC

Agent - Ahmed Salem

DBA - Omar Food Market

2803 N. 35th Street
Milwaukee, WI 53210

Oct. 12. 2020

In Basement

Rear Entrance



N 35th Street

Restroom

Dimensions 20 by 45 - 900 square ft.

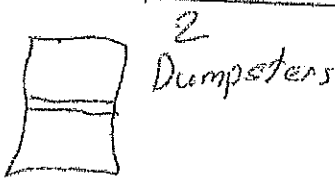
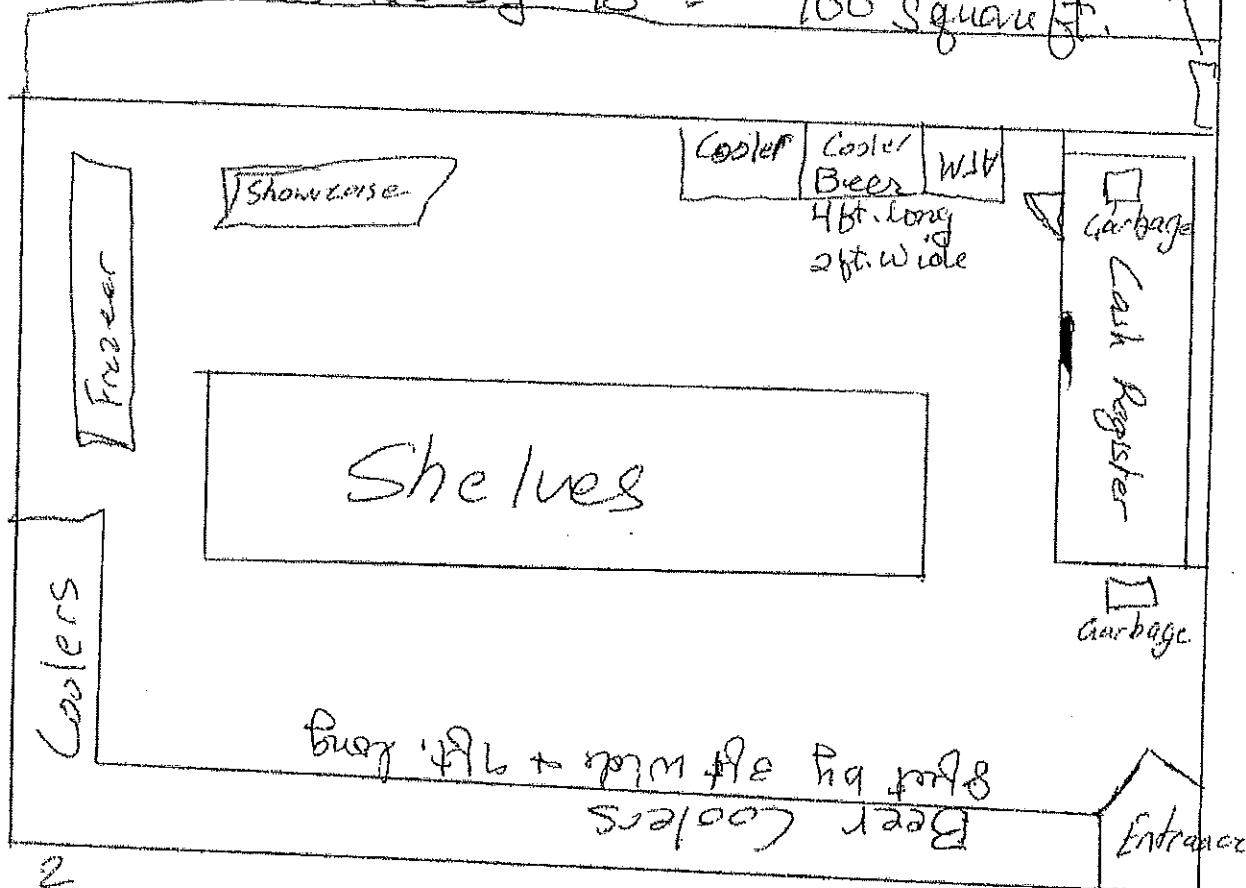

Street Parking

Side Walk

W. Hadley Street

DUPLICATE