





- LEGEND**
-  STABILIZED CONSTRUCTION ENTRANCE
 -  SILT FENCE
 -  REMOVE EXISTING TREE
 -  CLEAR AND GRUB EXISTING VEGETATION



W.S.
743.4

W.S.
744.4

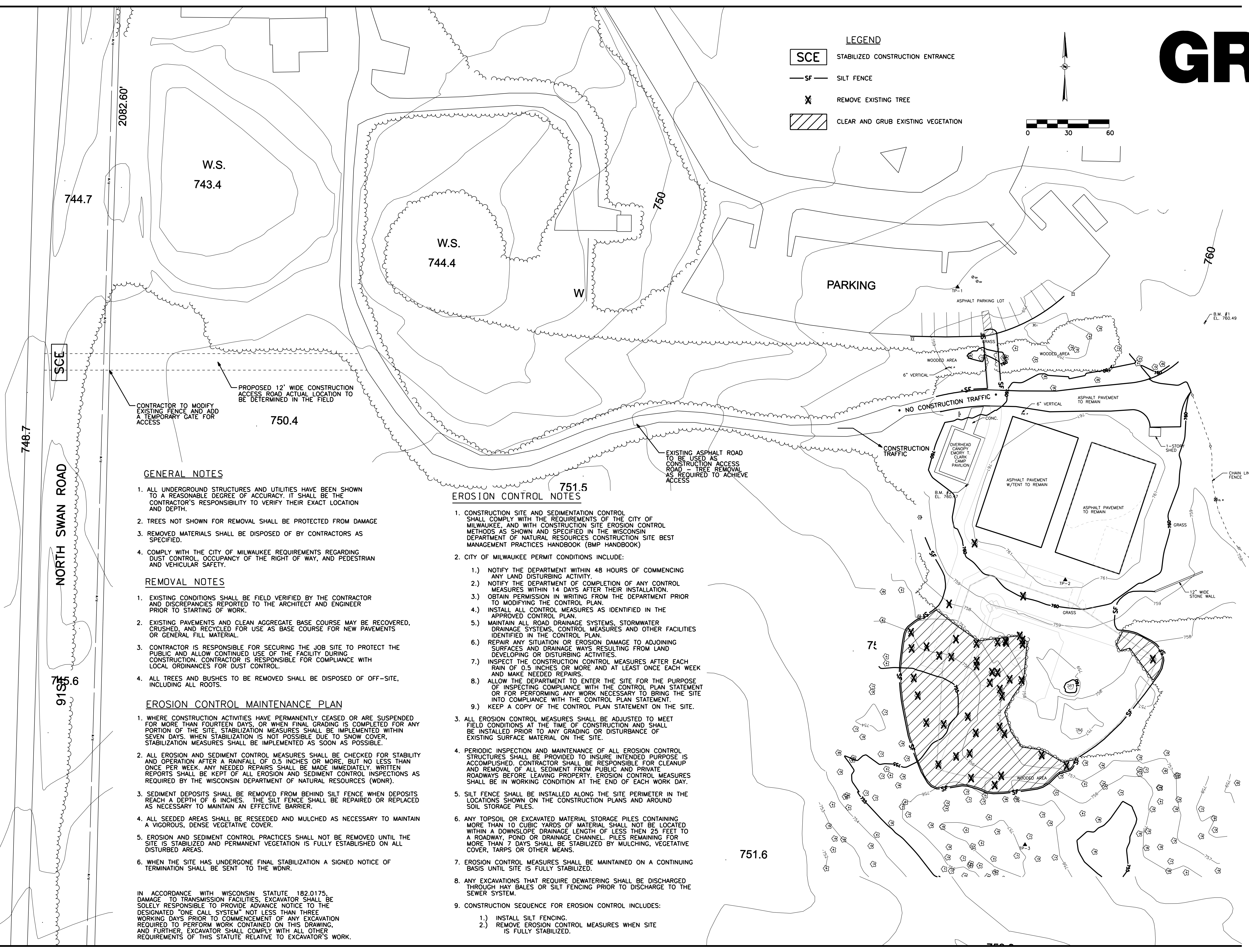
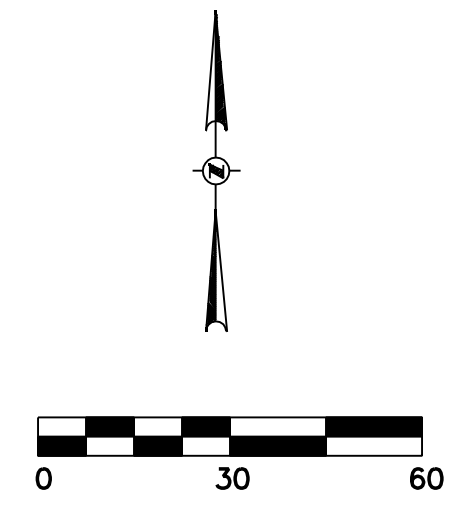
W

PARKING

CONTRACTOR TO MODIFY EXISTING FENCE AND ADD A TEMPORARY GATE FOR ACCESS

PROPOSED 12' WIDE CONSTRUCTION ACCESS ROAD ACTUAL LOCATION TO BE DETERMINED IN THE FIELD

EXISTING ASPHALT ROAD TO BE USED AS CONSTRUCTION ACCESS ROAD - TREE REMOVAL AS REQUIRED TO ACHIEVE ACCESS

GENERAL NOTES

1. ALL UNDERGROUND STRUCTURES AND UTILITIES HAVE BEEN SHOWN TO A REASONABLE DEGREE OF ACCURACY. IT SHALL BE THE CONTRACTOR'S RESPONSIBILITY TO VERIFY THEIR EXACT LOCATION AND DEPTH.
2. TREES NOT SHOWN FOR REMOVAL SHALL BE PROTECTED FROM DAMAGE
3. REMOVED MATERIALS SHALL BE DISPOSED OF BY CONTRACTORS AS SPECIFIED.
4. COMPLY WITH THE CITY OF MILWAUKEE REQUIREMENTS REGARDING DUST CONTROL, OCCUPANCY OF THE RIGHT OF WAY, AND PEDESTRIAN AND VEHICULAR SAFETY.

REMOVAL NOTES

1. EXISTING CONDITIONS SHALL BE FIELD VERIFIED BY THE CONTRACTOR AND DISCREPANCIES REPORTED TO THE ARCHITECT AND ENGINEER PRIOR TO STARTING OF WORK.
2. EXISTING PAVEMENTS AND CLEAN AGGREGATE BASE COURSE MAY BE RECOVERED, CRUSHED, AND RECYCLED FOR USE AS BASE COURSE FOR NEW PAVEMENTS OR GENERAL FILL MATERIAL.
3. CONTRACTOR IS RESPONSIBLE FOR SECURING THE JOB SITE TO PROTECT THE PUBLIC AND ALLOW CONTINUED USE OF THE FACILITY DURING CONSTRUCTION. CONTRACTOR IS RESPONSIBLE FOR COMPLIANCE WITH LOCAL ORDINANCES FOR DUST CONTROL.
4. ALL TREES AND BUSHES TO BE REMOVED SHALL BE DISPOSED OF OFF-SITE, INCLUDING ALL ROOTS.

EROSION CONTROL MAINTENANCE PLAN

1. WHERE CONSTRUCTION ACTIVITIES HAVE PERMANENTLY CEASED OR ARE SUSPENDED FOR MORE THAN FOURTEEN DAYS, OR WHEN FINAL GRADING IS COMPLETED FOR ANY PORTION OF THE SITE, STABILIZATION MEASURES SHALL BE IMPLEMENTED WITHIN SEVEN DAYS. WHEN STABILIZATION IS NOT POSSIBLE DUE TO SNOW COVER, STABILIZATION MEASURES SHALL BE IMPLEMENTED AS SOON AS POSSIBLE.
2. ALL EROSION AND SEDIMENT CONTROL MEASURES SHALL BE CHECKED FOR STABILITY AND OPERATION AFTER A RAINFALL OF 0.5 INCHES OR MORE, BUT NO LESS THAN ONCE PER WEEK. ANY NEEDED REPAIRS SHALL BE MADE IMMEDIATELY. WRITTEN REPORTS SHALL BE KEPT OF ALL EROSION AND SEDIMENT CONTROL INSPECTIONS AS REQUIRED BY THE WISCONSIN DEPARTMENT OF NATURAL RESOURCES (WDNR).
3. SEDIMENT DEPOSITS SHALL BE REMOVED FROM BEHIND SILT FENCE WHEN DEPOSITS REACH A DEPTH OF 6 INCHES. THE SILT FENCE SHALL BE REPAIRED OR REPLACED AS NECESSARY TO MAINTAIN AN EFFECTIVE BARRIER.
4. ALL SEEDED AREAS SHALL BE RESEED AND MULCHED AS NECESSARY TO MAINTAIN A VIGOROUS, DENSE VEGETATIVE COVER.
5. EROSION AND SEDIMENT CONTROL PRACTICES SHALL NOT BE REMOVED UNTIL THE SITE IS STABILIZED AND PERMANENT VEGETATION IS FULLY ESTABLISHED ON ALL DISTURBED AREAS.
6. WHEN THE SITE HAS UNDERGONE FINAL STABILIZATION A SIGNED NOTICE OF TERMINATION SHALL BE SENT TO THE WDNR.

IN ACCORDANCE WITH WISCONSIN STATUTE 182.0175, DAMAGE TO TRANSMISSION FACILITIES, EXCAVATOR SHALL BE SOLELY RESPONSIBLE TO PROVIDE ADVANCE NOTICE TO THE DESIGNATED "ONE CALL SYSTEM" NOT LESS THAN THREE WORKING DAYS PRIOR TO COMMENCEMENT OF ANY EXCAVATION REQUIRED TO PERFORM WORK CONTAINED ON THIS DRAWING, AND FURTHER, EXCAVATOR SHALL COMPLY WITH ALL OTHER REQUIREMENTS OF THIS STATUTE RELATIVE TO EXCAVATOR'S WORK.

EROSION CONTROL NOTES

1. CONSTRUCTION SITE AND SEDIMENTATION CONTROL SHALL COMPLY WITH THE REQUIREMENTS OF THE CITY OF MILWAUKEE, AND WITH CONSTRUCTION SITE EROSION CONTROL METHODS AS SHOWN AND SPECIFIED IN THE WISCONSIN DEPARTMENT OF NATURAL RESOURCES CONSTRUCTION SITE BEST MANAGEMENT PRACTICES HANDBOOK (BMP HANDBOOK)
2. CITY OF MILWAUKEE PERMIT CONDITIONS INCLUDE:
 - 1.) NOTIFY THE DEPARTMENT WITHIN 48 HOURS OF COMMENCING ANY LAND DISTURBING ACTIVITY
 - 2.) NOTIFY THE DEPARTMENT OF COMPLETION OF ANY CONTROL MEASURES WITHIN 14 DAYS AFTER THEIR INSTALLATION.
 - 3.) OBTAIN PERMISSION IN WRITING FROM THE DEPARTMENT PRIOR TO MODIFYING THE CONTROL PLAN.
 - 4.) INSTALL ALL CONTROL MEASURES AS IDENTIFIED IN THE APPROVED CONTROL PLAN.
 - 5.) MAINTAIN ALL ROAD DRAINAGE SYSTEMS, STORMWATER DRAINAGE SYSTEMS, CONTROL MEASURES AND OTHER FACILITIES IDENTIFIED IN THE CONTROL PLAN.
 - 6.) REPAIR ANY SITUATION OR EROSION DAMAGE TO ADJOINING SURFACES AND DRAINAGE WAYS RESULTING FROM LAND DEVELOPING OR DISTURBING ACTIVITIES.
 - 7.) INSPECT THE CONSTRUCTION CONTROL MEASURES AFTER EACH RAIN OF 0.5 INCHES OR MORE AND AT LEAST ONCE EACH WEEK AND MAKE NEEDED REPAIRS.
 - 8.) ALLOW THE DEPARTMENT TO ENTER THE SITE FOR THE PURPOSE OF INSPECTING COMPLIANCE WITH THE CONTROL PLAN STATEMENT OR FOR PERFORMING ANY WORK NECESSARY TO BRING THE SITE INTO COMPLIANCE WITH THE CONTROL PLAN STATEMENT.
 - 9.) KEEP A COPY OF THE CONTROL PLAN STATEMENT ON THE SITE.
3. ALL EROSION CONTROL MEASURES SHALL BE ADJUSTED TO MEET FIELD CONDITIONS AT THE TIME OF CONSTRUCTION AND SHALL BE INSTALLED PRIOR TO ANY GRADING OR DISTURBANCE OF EXISTING SURFACE MATERIAL ON THE SITE.
4. PERIODIC INSPECTION AND MAINTENANCE OF ALL EROSION CONTROL STRUCTURES SHALL BE PROVIDED TO INSURE INTENDED PURPOSE IS ACCOMPLISHED. CONTRACTOR SHALL BE RESPONSIBLE FOR CLEANUP AND REMOVAL OF ALL SEDIMENT FROM PUBLIC AND PRIVATE ROADWAYS BEFORE LEAVING PROPERTY. EROSION CONTROL MEASURES SHALL BE IN WORKING CONDITION AT THE END OF EACH WORK DAY.
5. SILT FENCE SHALL BE INSTALLED ALONG THE SITE PERIMETER IN THE LOCATIONS SHOWN ON THE CONSTRUCTION PLANS AND AROUND SOIL STORAGE PILES.
6. ANY TOPSOIL OR EXCAVATED MATERIAL STORAGE PILES CONTAINING MORE THAN 10 CUBIC YARDS OF MATERIAL SHALL NOT BE LOCATED WITHIN A DOWNSLOPE DRAINAGE LENGTH OF LESS THAN 25 FEET TO A ROADWAY, POND OR DRAINAGE CHANNEL. PILES REMAINING FOR MORE THAN 7 DAYS SHALL BE STABILIZED BY MULCHING, VEGETATIVE COVER, TARPS OR OTHER MEANS.
7. EROSION CONTROL MEASURES SHALL BE MAINTAINED ON A CONTINUING BASIS UNTIL SITE IS FULLY STABILIZED.
8. ANY EXCAVATIONS THAT REQUIRE DEWATERING SHALL BE DISCHARGED THROUGH HAY BALES OR SILT FENCING PRIOR TO DISCHARGE TO THE SEWER SYSTEM.
9. CONSTRUCTION SEQUENCE FOR EROSION CONTROL INCLUDES:
 - 1.) INSTALL SILT FENCING.
 - 2.) REMOVE EROSION CONTROL MEASURES WHEN SITE IS FULLY STABILIZED.

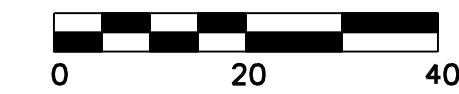
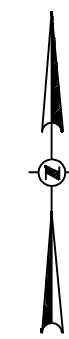

LEGEND

- 759— EXISTING CONTOUR
- 759--- PROPOSED CONTOUR
- + (759.00) PROPOSED SPOT GRADE
- ▭ PROPOSED ASPHALT PAVEMENT
- - - - PROPOSED CHAIN LINK FENCE

BENCHMARKS

- B.M. #1 - CHISELED SQUARE ON CONCRETE PAD
EL. 760.49
- B.M. #2 - CHISELED SQUARE ON CONCRETE PAD
EL. 760.47

GENERAL NOTES

1. ALL ELEVATIONS SHOWN ARE REFERENCED TO THE NORTH AMERICAN DATUM OF 1927. SUBTRACT 580.60' TO PLACE IN CITY OF MILWAUKEE DATUM.
2. ALL UNDERGROUND STRUCTURES ARE SHOWN TO A REASONABLE DEGREE OF ACCURACY. IT SHALL BE THE CONTRACTOR'S RESPONSIBILITY TO VERIFY THEIR EXACT LOCATION AND DEPTH.

IMPERVIOUS SURFACES

1. PROPOSED PATH/FIELD = 20268.6 SF
 2. FUTURE COURT REMOVAL = (4140.2 SF)
 3. FUTURE PLAYGROUND/CONCESSIONS BUILDING = 3071.8 SF
- TOTAL PROPOSED IMPERVIOUS SURFACE = 19200.2 SF (0.44 ACRES)

CONSULTANTS:

PROJECT TITLE:

JOHN C CUDAHY YMCA
MIRACLE FIELD

ISSUE:

PROJECT INFORMATION:

PROJECT NUMBER: 2010-0230.00
 DATE: 08/20/10
 DRAWN BY: JMH
 CHECKED BY: JMH
 APPROVED BY: BTP
 SCALE: 1"=20'

SHEET TITLE:

SITE PAVING AND GRADING PLAN

SHEET NUMBER:



IN ACCORDANCE WITH WISCONSIN STATUTE 182.0175, DAMAGE TO TRANSMISSION FACILITIES, EXCAVATOR SHALL BE SOLELY RESPONSIBLE TO PROVIDE ADVANCE NOTICE TO THE DESIGNATED "ONE CALL SYSTEM" NOT LESS THAN THREE WORKING DAYS PRIOR TO COMMENCEMENT OF ANY EXCAVATION REQUIRED TO PERFORM WORK CONTAINED ON THIS DRAWING AND FURTHER EXCAVATOR SHALL COMPLY WITH ALL OTHER REQUIREMENTS OF THIS STATUTE RELATIVE TO EXCAVATOR'S WORK.