



CITY OF MILWAUKEE  
OFFICE OF THE CITY CLERK

Thursday, September 02, 2021

COMMITTEE MEETING NOTICE

AD 12

HERRERA ORTIZ, Emanuel I, Agent  
Manny's Grocery Store LLC  
2366 S 9TH PI

Milwaukee, WI 53215

You are requested to attend a virtual hearing to be held on:

**Monday, September 20, 2021 at 11:10 AM**

**Regarding:** Your Class A Malt & Class A Liquor, Food Dealer, Weights & Measures License Applications as agent for "Manny's Grocery Store LLC" for "Manny's Grocery Store" at 2366 S 9TH PI.

This meeting will be held via GoToMeeting. Please see the enclosed best practices document for further instructions. The access code is <https://global.gotomeeting.com/join/733111181>. If you wish to call in, please call +1 (646) 749-3122 and use Access Code: 733-111-181.

There is a possibility that your application may be denied for one or more of the following reasons: The recommendation of the committee regarding the application shall be based on evidence presented at the hearing. Per MCO 85-2.7-4, probative evidence concerning whether or not a new license should be granted may be presented on the following subjects: whether or not the applicant meets the municipal requirements, the appropriateness of the location and premises where the licensed premises is to be located and whether use of the premises for the purposes or activities permitted by the license would tend to facilitate a public or private nuisance or create undesirable neighborhood problems such as disorderly patrons, unreasonably loud noise, litter, and excessive traffic and parking congestion. Probative evidence relating to these matters may be taken from the plan of operation submitted with the license application, if any, but shall not include the content of any music. Evidence regarding the fitness of the location of the premises to be maintained as the principal place of business, including but not limited to whether there is an overconcentration of businesses of the type for which the license is sought; whether the proposal is consistent with any pertinent neighborhood business or development plans, or the location's proximity to areas where children are typically present. The applicant's record in operating similarly licensed premises; and whether or not the applicant has been charged with or convicted of any felony, misdemeanor, municipal offense or other offense, the circumstances of which substantially relate to the activity to be permitted by the license being applied for or any other factor which reasonably relates to the public health, safety or welfare may also be considered. See attached police report or correspondence.

**Notice for applicants with warrants or unpaid fines:**

Proof of warrant satisfaction or payment of fines must be submitted at the hearing on the above date and time. Failure to comply with this requirement may result in a delay of the granting/denial of your application.

Failure to attend this meeting may result in the denial of your license. Individual applicants and partnership applicants must attend or attend by an attorney. The agent or attorney for corporate or limited liability applicants must attend. If you wish to do so and at your own expense, you may be accompanied by an attorney of your choosing to represent you at this hearing.

You will be given an opportunity to speak on behalf of the application and to respond and challenge any charges or reasons given for the denial. No petitions can be accepted by the committee, unless the people who signed the petition attend the virtual hearing and are willing to testify. You may present witnesses under oath and you may also confront and cross-examine opposing witnesses under oath. If you have difficulty with the English language, you should request an interpreter attend the meeting with you, at your expense, so that you can answer questions and participate in your hearing.

PLEASE NOTE: Upon reasonable notice, efforts will be made to accommodate the needs of disabled individuals through sign language interpreters or other auxiliary aids. For additional information or to request this service, contact the Council Services Division ADA Coordinator at (414) 286-2998, Fax - (414) 286-3456, TDD - (414) 286-2025.

JIM OWCZARSKI, CITY CLERK

BY: \_\_\_\_\_

Jim Cooney

License Division Manager

**If you have questions regarding this meeting, please contact the staff assistant, Molly Kuether-Steele at (414) 286-2775 or [molly.kuether-steele@milwaukee.gov](mailto:molly.kuether-steele@milwaukee.gov).**

200 E. Wells Street, Room 105, City Hall, Milwaukee, WI 53202. [www.milwaukee.gov/license](http://www.milwaukee.gov/license)  
Phone: (414) 286-2238 Fax: (414) 286-3057 Email Address: [License@milwaukee.gov](mailto:License@milwaukee.gov)



**CITY OF MILWAUKEE  
OFFICE OF THE CITY CLERK**

Thursday, September 02, 2021

**COMMITTEE MEETING NOTICE**

AD 12

HERRERA ORTIZ, Emanuel I, Agent  
Manny's Grocery Store LLC  
2462A S 9TH PI

Milwaukee, WI 53215

You are requested to attend a virtual hearing to be held on:

**Monday, September 20, 2021 at 11:10 AM**

**Regarding:** Your Class A Malt & Class A Liquor, Food Dealer, and Weights & Measures License Applications as agent for "Manny's Grocery Store LLC" for "Manny's Grocery Store" at 2366 S 9TH PI.

This meeting will be held via GoToMeeting. Please see the enclosed best practices document for further instructions. The access code is <https://global.gotomeeting.com/join/733111181>. If you wish to call in, please call +1 (646) 749-3122 and use Access Code: 733-111-181.

There is a possibility that your application may be denied for one or more of the following reasons: The recommendation of the committee regarding the application shall be based on evidence presented at the hearing. Per MCO 85-2.7-4, probative evidence concerning whether or not a new license should be granted may be presented on the following subjects: whether or not the applicant meets the municipal requirements, the appropriateness of the location and premises where the licensed premises is to be located and whether use of the premises for the purposes or activities permitted by the license would tend to facilitate a public or private nuisance or create undesirable neighborhood problems such as disorderly patrons, unreasonably loud noise, litter, and excessive traffic and parking congestion. Probative evidence relating to these matters may be taken from the plan of operation submitted with the license application, if any, but shall not include the content of any music. Evidence regarding the fitness of the location of the premises to be maintained as the principal place of business, including but not limited to whether there is an overconcentration of businesses of the type for which the license is sought; whether the proposal is consistent with any pertinent neighborhood business or development plans, or the location's proximity to areas where children are typically present. The applicant's record in operating similarly licensed premises; and whether or not the applicant has been charged with or convicted of any felony, misdemeanor, municipal offense or other offense, the circumstances of which substantially relate to the activity to be permitted by the license being applied for or any other factor which reasonably relates to the public health, safety or welfare may also be considered. See attached police report or correspondence.

**Notice for applicants with warrants or unpaid fines:**

Proof of warrant satisfaction or payment of fines must be submitted at the hearing on the above date and time. Failure to comply with this requirement may result in a delay of the granting/denial of your application.

Failure to attend this meeting may result in the denial of your license. Individual applicants and partnership applicants must attend or attend by an attorney. The agent or attorney for corporate or limited liability applicants must attend. If you wish to do so and at your own expense, you may be accompanied by an attorney of your choosing to represent you at this hearing.

You will be given an opportunity to speak on behalf of the application and to respond and challenge any charges or reasons given for the denial. No petitions can be accepted by the committee, unless the people who signed the petition attend the virtual hearing and are willing to testify. You may present witnesses under oath and you may also confront and cross-examine opposing witnesses under oath. If you have difficulty with the English language, you should request an interpreter attend the meeting with you, at your expense, so that you can answer questions and participate in your hearing.

PLEASE NOTE: Upon reasonable notice, efforts will be made to accommodate the needs of disabled individuals through sign language interpreters or other auxiliary aids. For additional information or to request this service, contact the Council Services Division ADA Coordinator at (414) 286-2998, Fax - (414) 286-3456, TDD - (414) 286-2025.

JIM OWCZARSKI, CITY CLERK

BY: \_\_\_\_\_

Jim Cooney  
License Division Manager

**If you have questions regarding this meeting, please contact the staff assistant, Molly Kuether-Steele at (414) 286-2775 or [molly.kuether-steele@milwaukee.gov](mailto:molly.kuether-steele@milwaukee.gov).**

200 E. Wells Street, Room 105, City Hall, Milwaukee, WI 53202. [www.milwaukee.gov/license](http://www.milwaukee.gov/license)  
Phone: (414) 286-2238 Fax: (414) 286-3057 Email Address: [License@milwaukee.gov](mailto:License@milwaukee.gov)

Date: 11/25/2020  
Officer: P.O. CONTRERAS

City of Milwaukee Police Department  
90-5-1.5 Crime Prevention Survey  
Convenience Store/Liquor Store Inspection

Name of Premise: Manny's Grocery Store  
Address: 2366 S 9th Pl  
Phone: 414-313-8097

Owner: Emanuel Isreal Herrera Ortiz  
Owner address: 2462 S 9th Pl #A  
City State Zip: Milwaukee, WI 53215  
Owner Phone: 414-313-8097  
Owner email: emanuelortiz1879@gmail.com

Manager: Same  
Home Address:  
City State Zip:  
Phone:  
Email:

Preferred contact: Same

Location currently open:  YES  NO

Projected open date:

Day's open: S M T W Th F SA ALL

Hours of Operation: Sun: 9a-9p 24 hours Y N  
Mon: "  
Tue: "  
Wed: "  
Thu: "  
Fri: "  
Sat: "

Premise Type: Liquor Store  
Convenience Store  
Other:

Licenses currently held:

- Alcohol:  Yes  No Class: #:  
Tobacco:  Yes  No #:  
Food:  Yes  No #:  
Extended Hours:  Yes  No #:  
Secondhand Dealer:  Yes  No Type: #:  
Other:  Yes  No Type: #:  
Other:  Yes  No Type: #:

**Exterior Survey:**

1. Is the area around the location clean?  Yes  No
2. What surrounds the location? (Check all the apply)
  - a.  Park
  - b.  School
  - c.  Youth Center
  - d.  Church
  - e.  Tavern(s) If so, how many
  - f.  Residential
  - g.  Other businesses
  - h.  Other:
3. Can you see from the outside of the location into the interior  Yes  No
4. Can you see the employees inside of the location from the outside  Yes  No
5. Are exterior windows free of signage  Yes  No
6. Is there a parking lot  Yes  No
7. Is the parking lot clean?  Yes  No
8. Is the parking lot well lit?  Yes  No
9. Are there areas where a person could conceal themselves  Yes  No
10. Is there exterior lighting?  Yes  No. Does it appears to be adequate  Yes  No
11. Exterior Payphone?  Yes  No
12. Are there No Loitering Signs posted?  Yes  No
13. Are there exterior security cameras  Yes  No How Many: 4
14. Are the address numbers prominently displayed and easy to see  Yes  No

**Camera Survey:**

15. Does this location have security cameras?  Yes  No
16. Are they in working order?  Yes  No
17. What format are the cameras?
  - a. Color  Yes  No
  - b. Digital  Yes  No
  - c. VCR  Yes  No
  - d. Recorded  Yes  No
18. How long is footage stored for later viewing: Unknown
19. Are there exterior cameras  Yes  No How many: 4
20. Are there interior cameras  Yes  No How many: 6
21. Do all employees know how to retrieve recorded digital images/footage?  Yes  No

**Interior Survey:**

22. Is the storeowner willing to be a standing complainant regarding loitering?  Yes  No  
a. If yes have them fill out the standing complaint form and give them two of the commercial signs  Yes  No
23. Is the interior of the location neat and clean?  Yes  No
24. Does an interior camera face the entrance/exit?  Yes  No
25. Is there a lockable area that separates employees from customers?  Yes  No
26. Does the store sell single chore boy?  Yes  No
27. Does the store sell blunt wraps?  Yes  No
28. Does the store sell scales?  Yes  No
29. Does the store sell items that may be used as crack pipes?  Yes  No  
a. Describe item
30. Does the store have an over abundance of sandwich baggies:  Yes  No
31. Does the owner understand that these items are often used for drug use?  Yes  No
32. Do the products in the store appear to be new and rotated often?  Yes  No
33. Are emergency and non-emergency numbers posted near the phone?  Yes  No
34. Does the owner know how to contact their police district directly?  Yes  No  
a. Did you provide a district contact guide to the owner?  Yes  No

**Complete this section if alcohol establishment is a convenience store:**

(\*\* Read full ordinance for all details "68-4.3 Convenience Food Stores")

All convenience food stores not exempted under sub. 3 shall:

1. Is the cash register located in a manner so that at the time of a sales transaction, the employee and customer are both visible from the sidewalk?  Yes  No \*\*
2. Are the glass entrance and exit doors clear of any signs or advertisements with the exception of a sign which states that the cash register contains \$50 or less and that the safe is no accessible to employees?  Yes  No
3. Does the store maintain one of the following on the licensed premise:
  - a. A safe that was in use at the convenience food store on August 17, 1994?  Yes  No
  - b. A drop-safe or time release safe that weighs at least 500 pounds or which is attached to or set into the floor in a manner approved by the police department?  Yes  No
4. Is lighting provided for the store's parking area during all hours of darkness when employees or customers are on the premises at a minimum average of 2-foot candles per square foot, unless the store is not open for business after sunset and before sunrise?  Yes  No  N/A
5. Are at least two high-resolution surveillance security cameras installed?  Yes  No
6. Are the security cameras in working order?  Yes  No
7. Does one camera show an overall view of the counter and register area?  Yes  No
8. Does one camera show a clear, identifiable, full frame image of the face of each person entering and leaving the store?  Yes  No
9. Are the camera views obstructed by fixtures or displays?  Yes  No
10. Is the recorded footage stored for at least 30 days?  Yes  No
11. Do all store employees know how to record footage from the camera system to media capable of being transferred to police custody?  Yes  No

12. Are customer entrances/exits made of glass or other transparent material?  Yes  No  
a. Exception: A store that does not have such doors on August 17, 1994 shall not be required to install such doors until the holder of the store's food dealer license changes.
13. Has the owner and their employees attended the Robbery Prevention Training within 120 days of ownership or employment?  Yes  No  
a. Contact Community Outreach and Education at 935-7836 for schedule.

**Sub 3. Exemptions.** The requirements of this section do not apply to a convenience food store that conforms to either of the following descriptions:

- a-1. The store is located in an enclosed shopping structure, enclosed commercial building or hospital. A convenience food store is not in an enclosed structure or building if a customer can enter it directly from the outside.  
Does store conform to a-1  Yes  No
- a-2. The store physically separates employees from customers with a solid partition that bars a person from entering the employee area from the customer area, has a secure lock on the employee side of any door between the employee area and the customer, and conducts all transaction through a service window or similar arrangement.  
Does store conform to a-2  Yes  No
- a. At the commissioner's discretion, a convenience store may be exempted from any or all of the regulations specified in sub 2.  
Does this location hold an exemption from the commissioner regarding any of the requirements of Sub 2?  Yes  No

**ADDITIONAL COMMENTS/RECOMMENDATIONS:**

Licensee needs to obtain password from camera system from current owner.

# MILWAUKEE POLICE DEPARTMENT LICENSING

## CRIMINAL RECORD/ORDINANCE VIOLATION/INCIDENTS SYNOPSIS

DATE: 08/13/2020  
LICENSE TYPE: AMALT  
NEW:   
RENEWAL:

No. 312815  
Application Date: 08/12/2020

License Location: 2366 S 9<sup>th</sup> Pl  
Business Name: La Franja Grocery

Licensee/Applicant: GONZALEZ, Marco A  
(Last Name, First Name, MI)  
Date of Birth: 01/17/1976

Home Address: 2872 S 13<sup>th</sup> St  
City: Milwaukee State: WI Zip Code: 53215  
Home Phone:

This report is written by Police Officer David Novak, assigned to the License Investigation Unit, Days.

The Milwaukee Police Department's investigation regarding this application revealed the following:

1. On 10/14/2017 a 17 year old working in conjunction with the Milwaukee Police Department and WI WINS Tobacco initiative, was able to purchase a Jaz Black and Mild cigar from the clerk at La Franja Grocery, 2366 S 9<sup>th</sup> Pl. The clerk did ask for ID but sold the cigar even though the ID showed she was 17 years old. The clerk was identified as the applicant. He stated he must have calculated the age wrong. A MARTS letter was mailed to the applicant.

=====

### PREVIOUS PREMISE

# City of Milwaukee Concentration Map

2366 S 9th PI

Area : 21,862,585.89 ft<sup>2</sup>

Oct 30 2020 11:01:37 Central Daylight Time

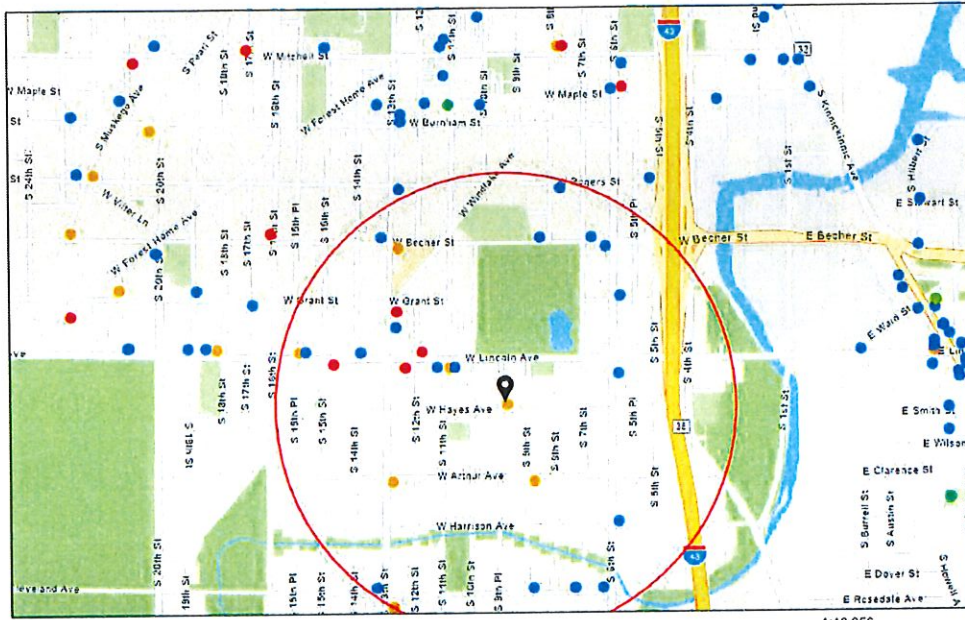



### Summary

Name	Count	Area(ft <sup>2</sup> )	Length(mi)
Alcohol Licenses	29		

Alcohol Licenses

#	Legal Entity	Trade Name	Licensee	Address	License Type Name	Total Capacity	Expiration Date	Count
1	REYNA'S BAR	REYNA'S BAR	MANUEL G RODRIGUEZ, SP	2566 S 6TH ST	Class B Tavern License	80	2/5/2021, 6:00 PM	1
2	Taqueria La Sierrita LLC	Taqueria La Sierrita	Miguel Leon Santos, Agt	2689 S 13th ST	Class B Tavern License	64	7/22/2021, 7:00 PM	1
3	3 HERMANOS, INC	3 Hermanos Club	RAMON OROZCO, Agt	1332 W LINCOLN AV	Class B Tavern License	163	2/19/2021, 6:00 PM	1
4	Beer Town LLC	Beer Town	PARAMJIT KAUR, Agt	1029 W Lincoln AV	Class A Fermented Malt Beverage Retailer's License		4/2/2021, 7:00 PM	1
5	EL SALVADOR RESTAURANT	EL SALVADOR RESTAURANT	DAVID A ARIAS, SP	2316 S 6TH ST	Class B Tavern License	50	7/4/2021, 7:00 PM	1
6	FRANKS FOOD	FRANKS FOOD	FAHIM N MAHMOUD, SP	2500 S 9TH ST	Class A Fermented Malt Beverage Retailer's License		9/20/2021, 7:00 PM	1
7	SHORTY'S CATERING, INC	SHORTY'S CATERING & RESTAURANT	ELISA MALDONADO, Agt	2075-79 S 13TH ST	Class B Tavern License	156	9/20/2021, 7:00 PM	1
8	KOZ'S MINI BOWL, INC	KOZ'S MINI BOWL	JUSTIN J KOSAKOSKI, Agt	2078 S 7TH ST	Class B Tavern License	80	8/30/2021, 7:00 PM	1
9	Singh's Corner Grocery Inc	South Star Food	BALJINDER SINGH, Agt	2714 S 13th ST	Class A Fermented Malt Beverage Retailer's License		10/31/2020, 7:00 PM	1
10	La Pasadita Bar LLC	La Pasadita Bar	Luis Lopez-Gonzalez, Agt	2691 S 6th ST	Class B Tavern License	99	11/10/2020, 6:00 PM	1
11	La Salsita Restaurant LLC	La Salsita Restaurant	Nicolas Santa Cruz-Ruedas, Agt	1105 W Lincoln AV	Class B Tavern License		11/3/2020, 6:00 PM	1
12	El Sunami II, LLC	Sunami	Ociel Escobar Luvianos, Agt	2222 S 13TH ST	Class B Tavern License	49	4/19/2021, 7:00 PM	1
13	A & J POLISH DELI, INC	A & J POLISH DELI	JADWIGA T ROZAK, Agt	1215 W LINCOLN AV	Class A Malt & Class A Liquor License		10/9/2021, 7:00 PM	1
14	GP Food Market LLC	Los Amigos	KARAMVIR K DHALIWAL, Agt	2100 S 13TH ST	Class A Fermented Malt Beverage Retailer's License		11/27/2020, 6:00 PM	1
15	La Franja Grocery LLC	La Franja Groceries	Marco A Gonzalez, Agt	2366 S 9TH PL	Class A Fermented Malt Beverage Retailer's License		9/20/2021, 7:00 PM	1

16	Singh's Corner Grocery Inc	South Star Food	BALJINDER SINGH, Agt	2714 S 13th ST	Class A Fermented Malt Beverage Retailer's License		10/31/2021, 7:00 PM	1
17	YASMINE FOODS, LLC	LINCOLN SUPERMARKET	LOAI A ATARI, Agt	1534 W LINCOLN AV	Class A Fermented Malt Beverage Retailer's License		12/10/2020, 6:00 PM	1
18	Carnitas Machetes	Carnitas Machetes	Alberto Morales, SP	2000 S 8th ST	Class B Tavern License		12/6/2020, 6:00 PM	1
19	MESA GARIBALDI, LLC	FIESTA GARIBALDI	VALDEMAR ESCOBAR, Agt	821-23 W LINCOLN AV	Class B Tavern License		12/11/2020, 6:00 PM	1
20	The Clem-Pank Group LLC	On My Way Home	DEBI DAMRON, Agt	2079 S 8th ST	Class B Tavern License	71	11/17/2020, 6:00 PM	1
21	Channa Sales Inc	Arthur Mini Mart	Baljeet S Channa, Agt	2500 S 13TH ST	Class A Fermented Malt Beverage Retailer's License		6/12/2021, 7:00 PM	1
22	KOTHALA, LLC	SOUTHSIDE BEER & LIQUOR	JASBIR S PANU, Agt	1434 W WINDLAKE AV	Class A Malt & Class A Liquor License		6/13/2021, 7:00 PM	1
23	THE END ZONE	THE END ZONE	JODY A THOMAS, SP	2690 S 9TH ST	Class B Tavern License	118	6/4/2021, 7:00 PM	1
24	EL LUCERO LIQUOR, INC	EL LUCERO LIQUOR	HANIN K ABDELRAHIM, Agt	1132-A W LINCOLN AV	Class A Malt & Class A Liquor License		6/5/2021, 7:00 PM	1
25	Huckski's LLC	Money Pit & Bar Grill	Lanette Huck, Agt	2691 S 7th ST	Class B Tavern License		10/18/2021, 7:00 PM	1
26	CEDAR INN	CEDAR INN	JOANNE M HUMSIK, SP	2178 S 6TH ST	Class B Tavern License	25	6/29/2021, 7:00 PM	1
27	LA GUADALUPANA	LA GUADALUPANA	ANA M RAZO, SP	1520 W LINCOLN AV	Class B Tavern License	99	1/19/2021, 6:00 PM	1
28	Mi Super Foods, & Liquor Inc	Mi Super Foods & Liquor	Gurinder S Nagra, Agt	2200 S 13th ST	Class A Malt & Class A Liquor License		1/19/2021, 6:00 PM	1
29	Club 6 LLC	Club 6	BLAS CERDA, Agt	2101 S 6th ST	Class B Tavern License		6/30/2021, 7:00 PM	1

Establishments within a 0.5 miles radius centered on area of interest.



Thursday, September 02, 2021

## Licenses Committee Notice of Hearing

Jose Estrada  
912 S 10th St  
Milwaukee, WI 53204

The Licenses Committee will consider the following license application:

Class A Malt & Class A Liquor, Food Dealer, and Weights & Measures License  
Applications  
HERRERA ORTIZ, Emanuel I, Agent  
Manny's Grocery Store at 2366 S 9TH PI

Date: 9/20/2021

Time: 11:10 AM

Location: The hearing before the Licenses Committee will take place virtually on Monday, September 20, 2021. This is a public hearing. Those wishing to view the proceeding are able to do so via the City Channel – Channel 25 on Spectrum Cable – or on the Internet at <http://city.milwaukee.gov/citychannel>. Those wishing to provide oral testimony will be asked to do so by phone or internet and are asked to contact the staff assistant, Molly Kuether-Steele at (414) 286-2775 or [molly.kuether-steele@milwaukee.gov](mailto:molly.kuether-steele@milwaukee.gov) for necessary information. Please make such requests no later than one business day prior to the start of the meeting. You are not required to attend the hearing, but please see the information below if you would like to provide testimony

Please note this application may be recommended for denial based on fitness of the location due to concentration of alcohol beverage outlets in the area. If the application is denied for this reason, no other application for an alcohol beverage license for this location shall be recommended for approval by the Licenses Committee within three years of the date of denial unless the applicant has demonstrated a change of circumstances since the prior denial.





Thursday, September 02, 2021



# Notice of Public Hearing

blank  
notice

---

HERRERA ORTIZ, Emanuel I, Agent  
Manny's Grocery Store at 2366 S 9TH PI  
Class A Malt & Class A Liquor, Food Dealer, and Weights & Measures License Applications

**Monday, September 20, 2021 at 11:10 AM**

To whom it may concern:

The above application has been made by the above named applicant(s). This requires approval from the Licenses Committee and the Common Council of the City of Milwaukee. The hearing before the Licenses Committee will take place virtually on 9/20/2021 at 11:10 AM. This is a public hearing. Those wishing to view the proceeding are able to do so via the City Channel – Channel 25 on Spectrum Cable – or on the Internet at <http://city.milwaukee.gov/citychannel>. Those wishing to provide oral testimony will be asked to do so by phone or internet and are asked to contact the staff assistant, Molly Kuether-Steele at (414) 286-2775 or [molly.kuether-steele@milwaukee.gov](mailto:molly.kuether-steele@milwaukee.gov) for necessary information. Please make such requests no later than one business day prior to the start of the meeting. You are not required to attend the hearing, but please see the information below if you would like to provide testimony. Once the Licenses Committee makes its recommendation, this recommendation is forwarded to the full Common Council for approval at its next regularly scheduled hearing.

---

## Important details for those wishing to provide information for the Licenses Committee to consider when making its recommendation:

1. The license application is scheduled to be heard at the above time. Due to other hearings running longer than scheduled, you may have to wait some time to provide your testimony.
2. You must testify as to matters that you have personally experienced or seen. (You cannot provide testimony for your neighbor, parent or anyone else; this is considered hearsay and cannot be considered by the committee.)
3. No letters or petitions can be accepted by the committee (unless the person who wrote the letter or the persons who signed the petition are willing to testify).
4. Persons opposed to the license application are given the opportunity to testify first; supporters may testify after the opponents have finished.
5. When you are called to testify, you will be sworn in and asked to give your name, and address. (If your first and/or last names are uncommon please spell them.)  
**Please Note: If you have submitted an objection to the above application your objection cannot be considered by the committee unless you personally testify at the hearing.**
6. You may then provide testimony.
  - a. Include only information relating to the above license application.
  - b. Include only information you have personally witnessed or seen.
  - c. Provide concise and relevant information detailing how this business has affected or may affect the peaceful enjoyment of your neighborhood.
  - d. If by the time you have the opportunity to testify, the information you wish to share has already been provided to the committee, you may state that you agree with the previous testimony. Redundant or repetitive testimony will not assist the committee in making its recommendation.
7. After giving your testimony, the members of the Licenses Committee and the licensee may ask questions regarding the testimony you have given or other factors relating to the license application.
8. Business Competition is not a valid basis for denial or non-renewal of a license.

OCCUPANT	MAIL ADDRESS	CITY STATE ZIP
CURRENT OCCUPANT	2326 S 9TH PL	MILWAUKEE, WI 53215-3212
CURRENT OCCUPANT	2326A S 9TH PL	MILWAUKEE, WI 53215-3212
CURRENT OCCUPANT	2327 S 9TH ST	MILWAUKEE, WI 53215-3207
CURRENT OCCUPANT	2327A S 9TH ST	MILWAUKEE, WI 53215-3207
CURRENT OCCUPANT	2329 S 9TH PL	MILWAUKEE, WI 53215-3211
CURRENT OCCUPANT	2329A S 9TH PL	MILWAUKEE, WI 53215-3211
CURRENT OCCUPANT	2330 S 9TH PL	MILWAUKEE, WI 53215-3212
CURRENT OCCUPANT	2330A S 9TH PL	MILWAUKEE, WI 53215-3212
CURRENT OCCUPANT	2331 S 9TH ST	MILWAUKEE, WI 53215-3207
CURRENT OCCUPANT	2331A S 9TH ST	MILWAUKEE, WI 53215-3207
CURRENT OCCUPANT	2333 S 9TH PL	MILWAUKEE, WI 53215-3211
CURRENT OCCUPANT	2333A S 9TH PL	MILWAUKEE, WI 53215-3211
CURRENT OCCUPANT	2335 S 9TH ST	MILWAUKEE, WI 53215-3207
CURRENT OCCUPANT	2335A S 9TH ST	MILWAUKEE, WI 53215-3207
CURRENT OCCUPANT	2336 S 9TH PL	MILWAUKEE, WI 53215-3212
CURRENT OCCUPANT	2336A S 9TH PL	MILWAUKEE, WI 53215-3212
CURRENT OCCUPANT	2337 S 9TH PL	MILWAUKEE, WI 53215-3211
CURRENT OCCUPANT	2337A S 9TH PL	MILWAUKEE, WI 53215-3211
CURRENT OCCUPANT	2337B S 9TH PL	MILWAUKEE, WI 53215-3211
CURRENT OCCUPANT	2338 S 9TH PL	MILWAUKEE, WI 53215-3212
CURRENT OCCUPANT	2338A S 9TH PL	MILWAUKEE, WI 53215-3212
CURRENT OCCUPANT	2339 S 9TH ST	MILWAUKEE, WI 53215-3207
CURRENT OCCUPANT	2339A S 9TH ST	MILWAUKEE, WI 53215-3207
CURRENT OCCUPANT	2340 S 10TH ST	MILWAUKEE, WI 53215-3247
CURRENT OCCUPANT	2340A S 10TH ST	MILWAUKEE, WI 53215-3247
CURRENT OCCUPANT	2341 S 9TH PL	MILWAUKEE, WI 53215-3211
CURRENT OCCUPANT	2341A S 9TH PL	MILWAUKEE, WI 53215-3211
CURRENT OCCUPANT	2341B S 9TH PL	MILWAUKEE, WI 53215-3211
CURRENT OCCUPANT	2342 S 9TH PL	MILWAUKEE, WI 53215-3212
CURRENT OCCUPANT	2342 S 9TH ST	MILWAUKEE, WI 53215-3208
CURRENT OCCUPANT	2343 S 9TH ST	MILWAUKEE, WI 53215-3207
CURRENT OCCUPANT	2343A S 9TH ST	MILWAUKEE, WI 53215-3207
CURRENT OCCUPANT	2344 S 10TH ST	MILWAUKEE, WI 53215-3247
CURRENT OCCUPANT	2344 S 9TH ST	MILWAUKEE, WI 53215-3208
CURRENT OCCUPANT	2344A S 10TH ST	MILWAUKEE, WI 53215-3247
CURRENT OCCUPANT	2345 S 9TH PL	MILWAUKEE, WI 53215-3211
CURRENT OCCUPANT	2345 S 9TH ST	MILWAUKEE, WI 53215-3207
CURRENT OCCUPANT	2345A S 9TH PL	MILWAUKEE, WI 53215-3211
CURRENT OCCUPANT	2345B S 9TH PL	MILWAUKEE, WI 53215-3211
CURRENT OCCUPANT	2345C S 9TH PL	MILWAUKEE, WI 53215-3211
CURRENT OCCUPANT	2346 S 9TH PL	MILWAUKEE, WI 53215-3212
CURRENT OCCUPANT	2346 S 9TH ST	MILWAUKEE, WI 53215-3208
CURRENT OCCUPANT	2346A S 9TH PL	MILWAUKEE, WI 53215-3212
CURRENT OCCUPANT	2346A S 9TH ST	MILWAUKEE, WI 53215-3208
CURRENT OCCUPANT	2347 S 9TH ST	MILWAUKEE, WI 53215-3207
CURRENT OCCUPANT	2348 S 10TH ST	MILWAUKEE, WI 53215-3247

CURRENT OCCUPANT	2349 S 9TH PL	MILWAUKEE, WI 53215-3211
CURRENT OCCUPANT	2350 S 10TH ST	MILWAUKEE, WI 53215-3247
CURRENT OCCUPANT	2350 S 9TH PL	MILWAUKEE, WI 53215-3212
CURRENT OCCUPANT	2350 S 9TH ST	MILWAUKEE, WI 53215-3208
CURRENT OCCUPANT	2350A S 10TH ST	MILWAUKEE, WI 53215-3247
CURRENT OCCUPANT	2350A S 9TH PL	MILWAUKEE, WI 53215-3212
CURRENT OCCUPANT	2351 S 9TH PL	MILWAUKEE, WI 53215-3211
CURRENT OCCUPANT	2351 S 9TH ST	MILWAUKEE, WI 53215-3207
CURRENT OCCUPANT	2351A S 9TH ST	MILWAUKEE, WI 53215-3207
CURRENT OCCUPANT	2352 S 10TH ST	MILWAUKEE, WI 53215-3247
CURRENT OCCUPANT	2352 S 9TH ST	MILWAUKEE, WI 53215-3208
CURRENT OCCUPANT	2352A S 10TH ST	MILWAUKEE, WI 53215-3247
CURRENT OCCUPANT	2352A S 9TH ST	MILWAUKEE, WI 53215-3208
CURRENT OCCUPANT	2354 S 9TH ST	MILWAUKEE, WI 53215-3208
CURRENT OCCUPANT	2354A S 9TH ST	MILWAUKEE, WI 53215-3208
CURRENT OCCUPANT	2355 S 9TH ST	MILWAUKEE, WI 53215-3263
CURRENT OCCUPANT	2355 S 9TH ST, 1	MILWAUKEE, WI 53215-3263
CURRENT OCCUPANT	2355 S 9TH ST, 2	MILWAUKEE, WI 53215-3263
CURRENT OCCUPANT	2355 S 9TH ST, 3	MILWAUKEE, WI 53215-3263
CURRENT OCCUPANT	2356 S 9TH PL	MILWAUKEE, WI 53215-3212
CURRENT OCCUPANT	2356 S 9TH ST	MILWAUKEE, WI 53215-3208
CURRENT OCCUPANT	2357 S 9TH PL	MILWAUKEE, WI 53215-3211
CURRENT OCCUPANT	2358 S 10TH ST	MILWAUKEE, WI 53215-3247
CURRENT OCCUPANT	2358 S 9TH PL	MILWAUKEE, WI 53215-3212
CURRENT OCCUPANT	2358 S 9TH ST	MILWAUKEE, WI 53215-3208
CURRENT OCCUPANT	2358A S 9TH PL	MILWAUKEE, WI 53215-3212
CURRENT OCCUPANT	2360 S 10TH ST	MILWAUKEE, WI 53215-3247
CURRENT OCCUPANT	2360 S 9TH PL	MILWAUKEE, WI 53215-3212
CURRENT OCCUPANT	2361 S 9TH PL	MILWAUKEE, WI 53215-3211
CURRENT OCCUPANT	2361 S 9TH ST	MILWAUKEE, WI 53215-3207
CURRENT OCCUPANT	2361A S 9TH ST	MILWAUKEE, WI 53215-3207
CURRENT OCCUPANT	2362 S 10TH ST	MILWAUKEE, WI 53215-3247
CURRENT OCCUPANT	2362 S 9TH ST	MILWAUKEE, WI 53215-3208
CURRENT OCCUPANT	2362 S 9TH ST, A	MILWAUKEE, WI 53215-3208
CURRENT OCCUPANT	2362A S 10TH ST	MILWAUKEE, WI 53215-3247
CURRENT OCCUPANT	2363 S 9TH ST	MILWAUKEE, WI 53215-3207
CURRENT OCCUPANT	2363A S 9TH ST	MILWAUKEE, WI 53215-3207
CURRENT OCCUPANT	2365 S 9TH PL	MILWAUKEE, WI 53215-3211
CURRENT OCCUPANT	2366 S 10TH ST	MILWAUKEE, WI 53215-3247
CURRENT OCCUPANT	2366 S 9TH ST	MILWAUKEE, WI 53215-3208
CURRENT OCCUPANT	2367 S 9TH ST	MILWAUKEE, WI 53215-3207
CURRENT OCCUPANT	2400A S 9TH PL	MILWAUKEE, WI 53215-3214
CURRENT OCCUPANT	2401 S 9TH PL	MILWAUKEE, WI 53215-3213
CURRENT OCCUPANT	2401 S 9TH ST	MILWAUKEE, WI 53215-3209
CURRENT OCCUPANT	2401 S 9TH ST, A	MILWAUKEE, WI 53215-3209
CURRENT OCCUPANT	2401 S 9TH ST, B	MILWAUKEE, WI 53215-3209
CURRENT OCCUPANT	2401 S 9TH ST, C	MILWAUKEE, WI 53215-3209

CURRENT OCCUPANT	2402 S 10TH ST	MILWAUKEE, WI 53215-3249
CURRENT OCCUPANT	2402 S 10TH ST, A	MILWAUKEE, WI 53215-3249
CURRENT OCCUPANT	2406 S 10TH ST	MILWAUKEE, WI 53215-3249
CURRENT OCCUPANT	2406 S 10TH ST, A	MILWAUKEE, WI 53215-3249
CURRENT OCCUPANT	2406 S 9TH PL	MILWAUKEE, WI 53215-3214
CURRENT OCCUPANT	2406 S 9TH ST	MILWAUKEE, WI 53215-3210
CURRENT OCCUPANT	2406A S 9TH PL	MILWAUKEE, WI 53215-3214
CURRENT OCCUPANT	2407 S 9TH PL, 1	MILWAUKEE, WI 53215-3213
CURRENT OCCUPANT	2407 S 9TH PL, 2	MILWAUKEE, WI 53215-3213
CURRENT OCCUPANT	2407 S 9TH PL, 3	MILWAUKEE, WI 53215-3213
CURRENT OCCUPANT	2407 S 9TH PL, 4	MILWAUKEE, WI 53215-3213
CURRENT OCCUPANT	2407 S 9TH ST	MILWAUKEE, WI 53215-3209
CURRENT OCCUPANT	2407A S 9TH ST	MILWAUKEE, WI 53215-3209
CURRENT OCCUPANT	2408 S 10TH ST	MILWAUKEE, WI 53215-3249
CURRENT OCCUPANT	2410 S 10TH ST	MILWAUKEE, WI 53215-3249
CURRENT OCCUPANT	2410 S 9TH PL	MILWAUKEE, WI 53215-3214
CURRENT OCCUPANT	2410 S 9TH ST	MILWAUKEE, WI 53215-3210
CURRENT OCCUPANT	2411 S 9TH PL	MILWAUKEE, WI 53215-3213
CURRENT OCCUPANT	2411 S 9TH ST	MILWAUKEE, WI 53215-3209
CURRENT OCCUPANT	2413 S 9TH PL	MILWAUKEE, WI 53215-3213
CURRENT OCCUPANT	2413A S 9TH PL	MILWAUKEE, WI 53215-3213
CURRENT OCCUPANT	2414 S 9TH PL	MILWAUKEE, WI 53215-3214
CURRENT OCCUPANT	2414A S 9TH PL	MILWAUKEE, WI 53215-3214
CURRENT OCCUPANT	2415 S 9TH ST	MILWAUKEE, WI 53215-3209
CURRENT OCCUPANT	2415A S 9TH ST	MILWAUKEE, WI 53215-3209
CURRENT OCCUPANT	2416 S 9TH PL	MILWAUKEE, WI 53215-3214
CURRENT OCCUPANT	2417 S 9TH PL	MILWAUKEE, WI 53215-3213
CURRENT OCCUPANT	2419 S 9TH ST	MILWAUKEE, WI 53215-3209
CURRENT OCCUPANT	2419A S 9TH ST	MILWAUKEE, WI 53215-3209
CURRENT OCCUPANT	2422 S 9TH PL	MILWAUKEE, WI 53215-3214
CURRENT OCCUPANT	2422A S 9TH PL	MILWAUKEE, WI 53215-3214
CURRENT OCCUPANT	2423 S 9TH PL	MILWAUKEE, WI 53215-3213
CURRENT OCCUPANT	2423 S 9TH ST	MILWAUKEE, WI 53215-3209
CURRENT OCCUPANT	2423A S 9TH ST	MILWAUKEE, WI 53215-3209
CURRENT OCCUPANT	2426 S 9TH PL	MILWAUKEE, WI 53215-3214
CURRENT OCCUPANT	2427 S 9TH PL	MILWAUKEE, WI 53215-3213
CURRENT OCCUPANT	2429 S 9TH ST	MILWAUKEE, WI 53215-3209
CURRENT OCCUPANT	2429 S 9TH ST	MILWAUKEE, WI 53215-3209
CURRENT OCCUPANT	824 W HAYES AVE	MILWAUKEE, WI 53215-3216
CURRENT OCCUPANT	828 W HAYES AVE	MILWAUKEE, WI 53215-3216
CURRENT OCCUPANT	828A W HAYES AVE	MILWAUKEE, WI 53215-3216
CURRENT OCCUPANT	924 W HAYES AVE	MILWAUKEE, WI 53215-3218
CURRENT OCCUPANT	924A W HAYES AVE	MILWAUKEE, WI 53215-3218
CURRENT OCCUPANT	958 W HAYES AVE	MILWAUKEE, WI 53215-3254
CURRENT OCCUPANT	978 W HAYES AVE	MILWAUKEE, WI 53215-3254
CURRENT OCCUPANT	978 W HAYES AVE, A	MILWAUKEE, WI 53215-3254

blank

notice



Total Records: 139

Radius: 250.0 feet and Center of Circle: 2366 S 9th Pl



# BUSINESS LICENSE PLAN OF OPERATION

ccl-busplan 5/12/2020

Office of the City Clerk License Division  
200 E. Wells St. Room 105, Milwaukee, WI 53202  
(414) 286-2238 www.milwaukee.gov/license e-mail address: [license@milwaukee.gov](mailto:license@milwaukee.gov)

## 1. Type of Business

Applying for:  Extended Hours (12AM to 5AM) - If a food establishment, check all that apply:  Delivery  Drive Thru  Dining Room  
 Self Service Laundry  Massage Establishment  Filling Station  
 Other (supplemental application for specific license also required)

Provide a detailed description of the type of business you plan on operating:

Liquor and Grocery store

Do you have any experience operating this type of business?  No  Yes If yes, explain:

## 2. Business Operations

- a. Proposed Opening Date: 9/1/2020
- b. Is this premise under construction?  No  Yes If yes, list estimated completion date: \_\_\_\_\_
- c. Is this a franchise?  No  Yes
- d. Is this premises currently licensed?  No  Yes If yes, list type of license: Liquor and Food license
- e. Is the current licensee operating?  No  Yes If no, list date closed: \_\_\_\_\_
- f. Do you have future plans for other businesses, licenses or permits at this location?  No  Yes  
If yes, explain: \_\_\_\_\_
- g. Have you previously held an Extended Hours License in Milwaukee?  No  Yes  
If yes, list address(es): \_\_\_\_\_
- h. Are other businesses operating in the same building?  No  Yes If yes, describe: \_\_\_\_\_

## 3. Litter & Noise

- a. How are grounds kept clean?  Sweep  Pressure Wash  Pick Up Litter  Other: \_\_\_\_\_
- b. How often will grounds be cleaned?  Daily  Weekly  As Needed  Monthly  Other: \_\_\_\_\_
- c. Grounds cleaned by:  Licensee  Building Owner  Employees  Hired Maintenance  Other: \_\_\_\_\_
- d. How are noise issues prevented and/or addressed?  Security  Manager approaches customer(s)  Call Police  
 Signs Posted  Other: \_\_\_\_\_
- e. Will a sound amplification system be used?  No  Yes If yes, describe: \_\_\_\_\_

## 4. Smoking & Sanitation

- a. Are there designated outdoor smoking areas?  No  Yes If yes, describe: \_\_\_\_\_
- b. Number of Garbage Cans: Inside: 3 Locations: bathroom, front door, behind counter  
Outside: 1 Locations: back
- c. Is a crowd control barrier used?  No  Yes If yes, describe: \_\_\_\_\_
- d. How many restrooms are on the premises? 1
- e. Name of solid waste contractor:  Advanced Disposal  Waste Management  Other: Eagle Disposal

### 5. Security

- a. Are there onsite parking spaces?  No  Yes If yes, how many? \_\_\_\_\_ and describe the parking security plan: \_\_\_\_\_
- b. Is there a loading zone?  No  Yes If yes, describe the loading area security plan: \_\_\_\_\_
- c. Will you have security personnel on premise?  No  Yes If yes, how many? \_\_\_\_\_ and answer the following:  
 What are their responsibilities? \_\_\_\_\_  
 Is security equipment used?  No  Yes If yes, describe \_\_\_\_\_  
 List their licensing, certification, or training credentials \_\_\_\_\_
- d. Will there be security cameras?  No  Yes If yes, how many? 7 and list locations: behind counter, by liquor, stock room, office, outside
- e. Will searches/identification checks be done upon entry?  No  Yes If yes, describe \_\_\_\_\_

### 6. Percentage of Sales (must total 100%)

Alcohol <u>30</u> %	Food <u>70</u> %	Secondhand Merchandise _____%	Precious Metals & Gems _____%
Entertainment _____%	Cigarettes _____%	Personal Services (such as tattoo, body piercing, salon, tailor, tanning, etc.) _____%	Other _____%
Pawnbroker Activity _____%	Salvaged Materials _____% (such as scrap metal)		Describe: _____

### 7. Businesses/Licenses on the Premises (check all that apply):

#### Type 1

- Full Service Restaurant     Cafe/Coffee Shop     Deli or Fast Food Restaurant     Private/Fraternal/Veterans Club
- Night Club     Tavern     Cocktail Lounge     Teen Club
- Banquet Hall     Sports Facility     Bowling Alley
- Hotel/Motel : Number of Floors: \_\_\_\_\_     Rooming House: Number of Floors: \_\_\_\_\_  
 Number of Rooms: \_\_\_\_\_    Number of Rooms: \_\_\_\_\_

#### Type 2

- Liquor Store     Corner Store     Supermarket     Convenience Store
- Gas Station     Amusement/Phonograph Distributor     Recycling, Salvage or Towing
- Used Car Dealer     Personal Service Establishment  
(such as tattoo business, hair salon, tailor, etc.)     Recording Studio

What other licenses/permits will you hold at this location? (check all that apply)

- Occupancy Permit     Cigarette & Tobacco     Gas Station     Extended Hours     Class "B" Tavern     Weights & Measures
- Secondhand Dealer     Precious Metal & Gem     Other: \_\_\_\_\_

### 8. Legal Capacity (only if a Type 1 premises in #7 above)

Capacity 20 (Call the Milwaukee Development Center at 414-286-8211 if you have questions.)

## 9. Premises Description

a. Identify all area(s) of the premises that will be used in operating this business (include areas used only for storage):

1st Floor  2nd Floor  Basement Storage  Patio  Beer Garden  Sidewalk Café  Deck  Rooftop

Other: Describe: \_\_\_\_\_

b. Describe Location:  Major Thoroughfare  Secondary Street  Other: \_\_\_\_\_

c. Nearest Major Cross Street: Lincoln Ave

d. Describe Building:  Free Standing Building  Strip Mall  Other: \_\_\_\_\_

e. Describe Premises Structure:  Single Story  Multi-Story - # of Stories 2  Other: \_\_\_\_\_

f. Describe Surrounding Area:  Commercial  Residential  Industrial  Other: \_\_\_\_\_

g. Building Owner Name: Jose Estrada Phone Number: 414-899-98100

Building Owner Address: 912 S 10th St Milwaukee WI 53204

## 10. Hours of Operation & Customers

Will customers be entering the premises?  No  Yes

Day of the Week	Proposed Hours of Operation:		Estimated Number of Customers expected each day	Potential Age Range of Customers	Class B Tavern Applicant Only: Age Restriction (If none, write 'None')
	Open Time (include a.m. or p.m.)	Close Time (include a.m. or p.m.)			
Sunday	9 AM	9 PM	20	AU	
Monday	9 AM	9 PM	20	AU	
Tuesday	9 AM	9 PM	20	AU	
Wednesday	9 AM	9 PM	20	AU	
Thursday	9 AM	9 PM	20	AU	
Friday	9 AM	9 PM	20	AU	
Saturday	9 AM	9 PM	20	AU	

An Extended Hours Establishment License is required for any convenience store, filling station, personal service establishment (such as tattoo, body piercing, salon, tailor, tanning, etc.), recording studio or restaurant which is open between the hours of 12:00 a.m. and 5:00 a.m.

Alcohol Establishments Class A: 8:00 am to 9:00 pm Sunday thru Saturday  
 Permitted Hours of Operation: Class B: 6:00 am to 2:00 am Sunday thru Thursday, 6:00 am to 2:30 am Friday & Saturday

Entertainment Outdoor Closing Hours: 10:00pm Sunday-Thursday; 12:00am Friday & Saturday; unless a different time, either earlier or later, is established by the Common Council in its approval of the licensee's plan of operation.

## 11. Signature(s)

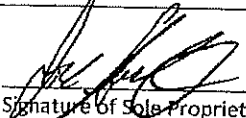
  
 Signature of Sole Proprietor, Partner, or 20% or more Shareholder  
 (If there are no 20% or more shareholders,  
 Corporate Officer-print name/title and sign)

\_\_\_\_\_  
 Signature of additional partner or 20% or more shareholder

See Application Information for a complete list of all required application forms.



**ALCOHOL BEVERAGE & PUBLIC ENTERTAINMENT PREMISES  
SUPPLEMENTAL APPLICATION**

Office of the City Clerk License Division  
200 E. Wells St. Room 105, Milwaukee, WI 53202  
(414) 286-2238 e-mail address: license@milwaukee.gov www.milwaukee.gov/license

Legal Entity Name: <u>Manny's Grocery Store LLC</u>
Premise Address: <u>2366 S 9th Pl Milwaukee WI 53215</u>
<b>Proximity of Premises to Church, School, Daycare Center or Hospital</b>
Is the building within 300 feet of any church, school, daycare center or hospital? <input checked="" type="checkbox"/> No <input type="checkbox"/> Yes
<b>"Service Bar Only" Designation</b>
If applying for Class B or C license, are you applying for "Service Bar Only"? <input checked="" type="checkbox"/> No <input type="checkbox"/> Yes Service Bar Only means customers cannot sit at the bar. Alcohol is served to employees who serve patrons seated at tables. No stools, chairs or other articles of furniture shall be placed at the service bar for patrons to sit upon.
<b>Business Information</b>
a) Are you taking out this application for anyone that may not be eligible for a license? <input checked="" type="checkbox"/> No <input type="checkbox"/> Yes If yes, list their name and address: _____
b) Will the agent, a partner or the individual licensee be conducting the day-to-day operations of the business? <input type="checkbox"/> No <input checked="" type="checkbox"/> Yes If no, list the name and address of the person(s) who will: _____
Class B Applicants: If the agent, a partner or the individual licensee will not be conducting the day-to-day operations of the business, the person(s) listed above must obtain a Class B Managers license.
c) Does anyone else have money invested or any other interest in this business? <input checked="" type="checkbox"/> No <input type="checkbox"/> Yes If yes, explain: _____
d) Have you made an agreement with anyone to repay any loan or any other payments based upon income from the business? <input type="checkbox"/> No <input checked="" type="checkbox"/> Yes If yes, list name and address: <u>LaFranja Grocery LLC 2366 S 9th Pl</u>
<b>Property Information (New &amp; Transfer Applicants Only)</b>
a) Do you own or lease the building? <input type="checkbox"/> Own <input checked="" type="checkbox"/> Lease
b) Who owns the fixtures (for example, coolers, etc.)? <u>owner</u>
c) Are you purchasing the stock and/or fixtures? <input checked="" type="checkbox"/> No <input type="checkbox"/> Yes If yes, amount paid \$ _____
d) Total amount paid for business \$ <u>0</u>
e) Total amount paid for goodwill of the business \$ <u>0</u>
Goodwill comprises the reputation and customer relationships of an existing business. If the price you pay for the business exceeds the fair market value of all of the rest of the assets of the business, the excess may be considered goodwill.
f) Have you made arrangements with the seller for payment of personal property taxes? <input checked="" type="checkbox"/> No <input type="checkbox"/> Yes
<b>Lease Information (New &amp; Transfer Applicants who are leasing the premises only)</b>
a) Date lease begins <u>Sept 1, 2020</u> Ends <u>Aug 1, 2025</u>
b) Monthly rental \$ <u>1,550</u>
c) Do you have an option to renew the lease? <input type="checkbox"/> No <input checked="" type="checkbox"/> Yes
d) Does your lease allow for assignment to another party without the consent of the owner? <input checked="" type="checkbox"/> No <input type="checkbox"/> Yes
e) For what length of time have you been guaranteed occupancy (number of years)? <u>5 yrs</u>

**Lease Information (Continued)**

- f) In addition to paying the monthly rental, will you have to pay anything additional to the owner of the building to guarantee performance of the lease?  No  Yes If yes, explain \_\_\_\_\_
- g) Does the present owner or occupancy object to the granting of your license?  No  Yes  
If yes, explain \_\_\_\_\_

**Change of Agent Applicants Only**

Have there been any changes to the floor plan since the last application was submitted?  No  Yes  
If no, a new floor plan is not required. If yes, submit a new floor plan and explain the change(s):  
\_\_\_\_\_

**Signature**

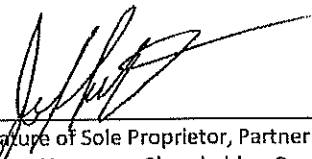

\_\_\_\_\_  
Signature of Sole Proprietor, Partner or 20% or More Shareholder  
(If no 20% or more Shareholder, Corporate Officer - print name/title and sign)

Note: All information contained in this application is subject to approval by the Common Council.  
Deviating from approved plan of operation will subject licensee to citations, and/or suspension or non-renewal of the license.  
Contact the License Division for information on how to request changes.

**New and transfer of premises applicants must submit the following:**

- Detailed floor plan
- If a restaurant, copy of the menu



# FOOD DEALER LICENSE PLAN OF OPERATION

ccl-foodplan 2/28/19

OFFICE OF THE CITY CLERK, LICENSE DIVISION  
CITY HALL, 200 E. WELLS ST, ROOM 105, MILWAUKEE, WI 53202  
(414) 286-2238 • [license@milwaukee.gov](mailto:license@milwaukee.gov) • [www.milwaukee.gov/license](http://www.milwaukee.gov/license)

Legal Entity Name: Manny's Grocery Store LLC

Premises Address: 2366 S 9th Pl Milwaukee, WI 53215

## SECTION 1 TYPE OF BUSINESS

What will be the majority of your food sales? (check one)

Restaurant Items (meals):  
MEALS include, but are not limited to, chicken, ribs, sandwiches, roasted corn, baked potatoes, hot dogs, brats, tacos, nachos w/ cheese and meat, French fries, cooked or deep fried vegetables/fruit, cooked cheese curds, corn dogs, egg rolls, salads.

Retail Items (snacks and beverages):  
RETAIL items include, but are not limited to, ice cream/soft serve, lemonade, snow cones, coffee, espresso, cappuccino, tea, fruit juice, smoothies, candy, dispensed soda, fruit cups, bakery, cookies, kettle corn, cotton candy, funnel cakes, fritters, tortilla chips w/ cheese.

Will it be a convenience store?  Yes  No

A convenience store contains less than 5,000 square feet of retail space and has, as its primary business, the sale of basic food items and in addition, sells household products or is a filling station that sells basic food items and household products.

Bed & Breakfast

Micro Market

All Applicants: Submit a menu or a list of food items that will be sold.

Will any wholesale business be done?  No  Yes If yes, what percentage of food sales will be wholesale?

Less than 25%

25% or More AND:

Restaurant items (meals) will be sold -- Complete this application and also contact DATCP.

NO restaurant items (meals) will be sold - Do NOT complete this application. Contact DATCP only.

## SECTION 2 FOOD PROCESSING

Will any food processing be done?  No  Yes

Processing is defined as assembling, grinding, cutting, mixing, baking, coating, stuffing, packing, bottling, grilling, canning, extracting, fermenting, distilling, pickling, freezing, drying, smoking, or packaging.

## SECTION 3 FOOD REQUIRING TEMPERATURE CONTROL

Will any food that requires temperature control be sold?  No  Yes  
(Includes dairy products such as milk, cheese, and ice cream, fish, shellfish, meat, poultry)

If yes, list the types of food items: Cheese, meat, milk, poultry, vegetables

**SECTION 4 DETAILS OF OPERATION**

Will you have seating on site for dining?  No  Yes

Will you be doing any catering?  No  Yes

Will you be doing any delivery?  No  Yes

Will you have outdoor activities?  No  Yes - Check all that apply:  Bar  Cooking/Grilling  Dining

Will you have a drive thru window?  No  Yes - Are hours different from inside?  No  Yes  
 If Yes, provide drive thru hours: \_\_\_\_\_

Will scales or barcode scanners be used?  No  Yes - You must also apply for a Weights & Measures License.

**SECTION 5 ADDITIONAL SITES**

Where will food be prepared and/or sold?

At a single site  At multiple sites: How many? \_\_\_\_\_ (for example, a hotel with several dining rooms or bars)

If multiple sites, attach a Food Dealer Additional Site Addendum (ccl-foodadd) for each additional site.

**SECTION 6 CONSTRUCTION OR CHANGES**

Are you planning any construction, remodeling or equipment changes?

No If No, SKIP to Section 8

Yes If Yes, check all that apply:  New construction of a building  Renovation or remodeling  
 Construction changes to existing building  Equipment changes only

Provide a brief description of the changes: \_\_\_\_\_

Start date: \_\_\_\_\_

Name, Address & Phone Number of Architect: \_\_\_\_\_  
 \_\_\_\_\_

Name, Address & Phone Number of Contractor: \_\_\_\_\_  
 \_\_\_\_\_

**SECTION 7 ALCOHOL BEVERAGES**

Are you applying for an alcohol beverage license?

No If No, SKIP to Section 8

Yes If YES, if your food license is approved prior to the alcohol license, when do you want the food license Issued?  
 Immediately  At the same time as the alcohol license

**SECTION 8 ACKNOWLEDGEMENTS & SIGNATURE**

You must initial each item confirming your understanding:

E.H I understand the Health Department must conduct an inspection and advise the License Division of their approval before the license may be issued.

E.H I understand I must obtain an occupancy permit from the Department of Neighborhood Services and an inspection may be required. Neighborhood Services must advise the License Division of their approval before the license may be issued.

E.H I understand the district alderperson will review and either support or object to my application. If he/she objects, I may appeal and be scheduled to appear before the Licenses Committee. The Licenses Committee will then make a recommendation to the Common Council. The Common Council must grant the license before it may be issued.

E.H I understand proof of payment for all license fees must be on file in the License Division before the license may be issued and the license must be issued and posted in my establishment prior to opening for business.

E.H I will not operate my food business until the license has been issued and posted in the establishment.

Signature of Sole Proprietor, Partner, or 20% Shareholder: [Signature]

Signature of Additional Partner: \_\_\_\_\_





**WEIGHTS & MEASURES PLAN OF OPERATION**

ccl-wmpln 1/9/18

Office of the City Clerk License Division  
200 E. Wells St. Room 105, Milwaukee, WI 53202  
(414) 286-2238 [www.milwaukee.gov/license](http://www.milwaukee.gov/license) [license@milwaukee.gov](mailto:license@milwaukee.gov)

Legal Entity Name: Manny's Grocery Store LLC

Premise Address: 23166 S 9th Pl Milwaukee, WI 53215

**Type of Business**

Provide a brief description of the establishment/business:

Grocery Store

*Other licenses may be required depending on the type of business you are operating.*

**Litter & Noise**

- a. How are grounds kept clean?  Sweep  Pressure Wash  Pick Up Litter  Other: \_\_\_\_\_
- b. How often will grounds be cleaned?  Daily  Weekly  As Needed  Monthly  Other: \_\_\_\_\_
- c. Grounds cleaned by:  Licensee  Building Owner  Employees  Hired Maintenance  Other: \_\_\_\_\_
- d. How are noise issues prevented and/or addressed?  Security  Manager approaches customer(s)  Call Police  
 Signs Posted  Other: \_\_\_\_\_

**Signature**

Signature of Sole Proprietor, Partner, or 20% or more Shareholder  
(If there are no 20% or more shareholders,  
Corporate Officer-print name/title and sign)

Signature of additional partner or 20% or more shareholder

*This form must be submitted with the Business License Application, Weights & Measures License Supplemental Application, and appropriate fee. Forms can be obtained online at [www.milwaukee.gov/licenses](http://www.milwaukee.gov/licenses).*

MANNYS GROCERY STORE LLC

MANNYS GROCERY STORE

2366 S 9<sup>TH</sup> PL

MILWAUKEE, WI 53215

AGENT: EMANUEL I. HERRERA ORTIZ

414-313-8097

10/28/2020



TOTAL SQFT: 1800

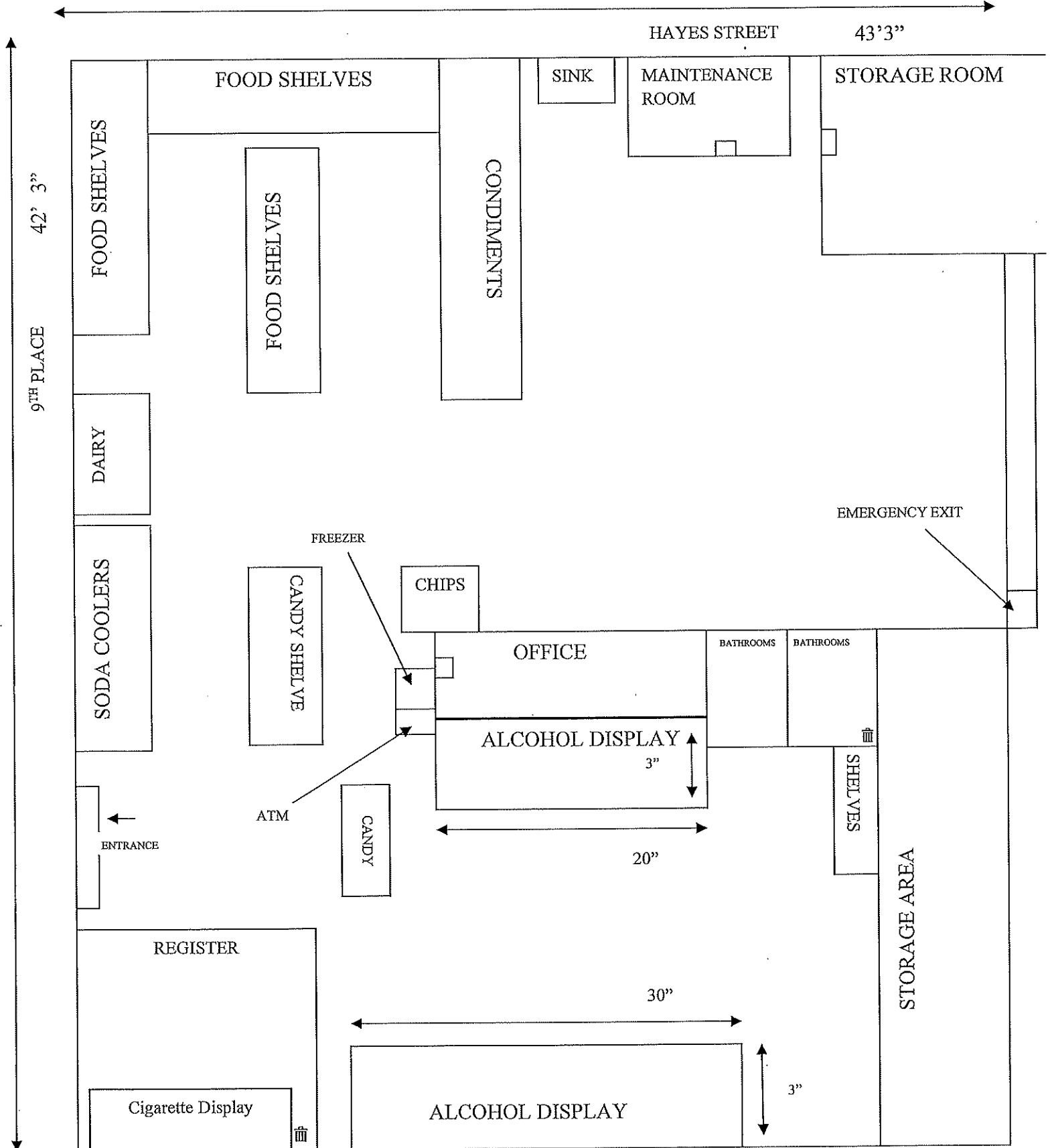



Manny's Grocery Store

Total Sqft: 1,800

Manny's Grocery Store LLC  
 Manny's Grocery Store  
 2366 S 9th Pl  
 Milwaukee WI 53215  
 10/5/2020  
 Agent: Emanuel I. Herrera Ortiz  
 (414) 313-8097

MANNYS GROCERY STORE LLC

MANNYS GROCERY STORE

2366 S 9<sup>TH</sup> PL

MILWAUKEE, WI 53215

AGENT: EMANUEL I. HERRERA ORTIZ

414-313-8097

10/28/2020



TOTAL SQFT: 1800

