

The Southwell - Luber Residence
 3067 N Lake Dr.
 Milwaukee, WI 53211

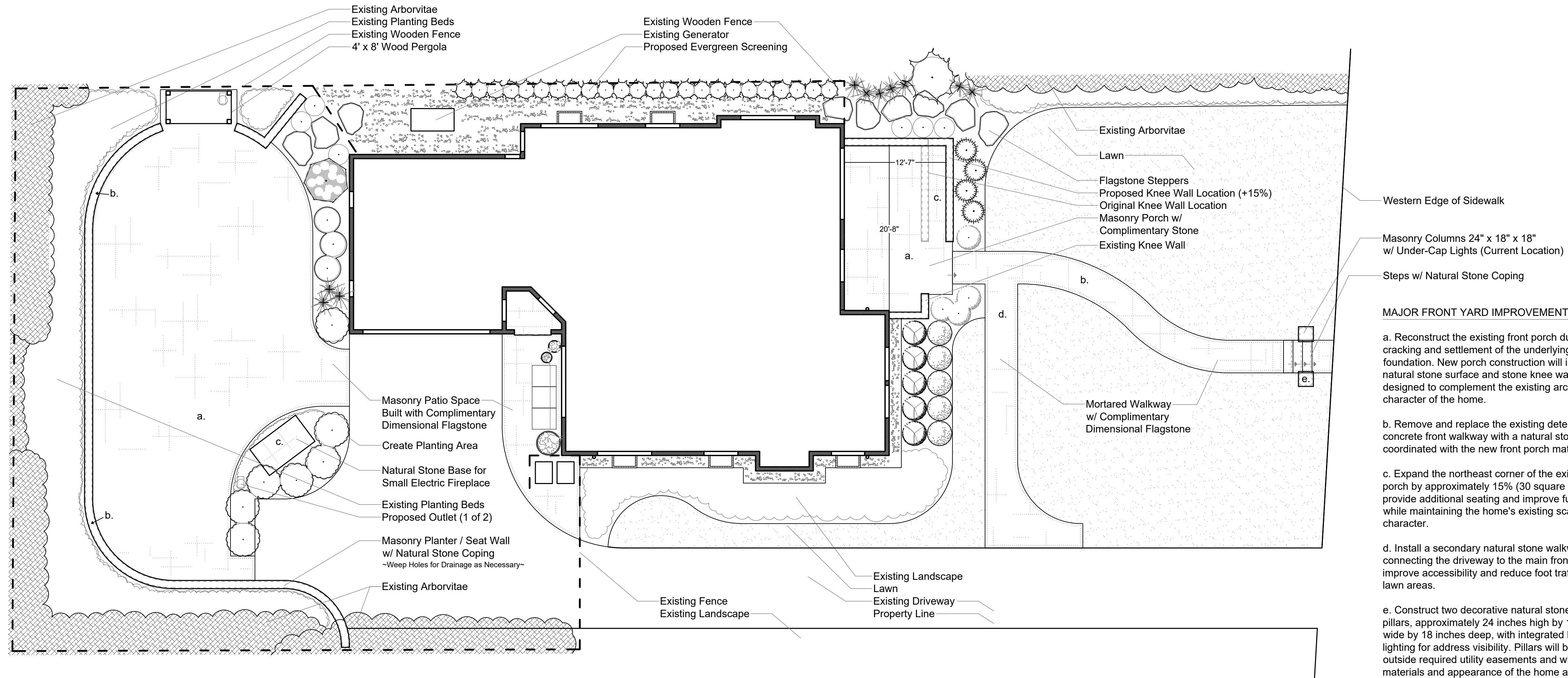

MAJOR BACK YARD IMPROVEMENTS

- a. Remove and replace the existing cracked and settled concrete patio with a natural stone patio designed to complement the home's existing stone elements.
- b. Replace existing deteriorated landscape border walls with mortared natural stone seat walls of similar height and appearance.
- c. Install a natural stone-clad base for an electric outdoor fireplace, approximately 3 feet by 6 feet.
- d. 4 x 8 Wood Pergola, constructed with 4 x 4 post and 2 x 4 cross members for grilling area.



Scale: 1/8" = 1'-0"
