



CERTIFIED SURVEY MAP NO. \_\_\_\_\_

Being a redivision of a part of the Northeast 1/4 of the Northeast 1/4 of Section 36, Town 8 North, Range 21 East, in the City of Milwaukee, Milwaukee County, Wisconsin

SURVEYOR'S CERTIFICATE

STATE OF WISCONSIN )  
MILWAUKEE COUNTY ) SS

I, Dennis C. Sauer, Professional Land Surveyor, do hereby certify:

That I have surveyed, divided and mapped a redivision of a part of the Northeast 1/4 of the Northeast 1/4 of Section 36, Town 8 North, Range 21 East, in the City of Milwaukee, Milwaukee County, Wisconsin, bounded and described as follows: Commencing at the Northeast corner of Section 36, Town 8 North, Range 21 East; thence S 00°12'22" E along the East line of the Northeast 1/4 of said Section 36, 60.00 feet; thence S 89°29'21" W, 50.00 feet to the West Line of North 27<sup>th</sup> Street; thence S 00°12'22" E along said West line 861.95 feet; thence S 89°29'12" W, 379.11 feet; thence S 89°30'08" W, 80.00 feet; thence S 89°29'21" W, 241.71 feet; thence N 00°12'22" W, 14.95 feet; thence S 89°29'21" W, 119.98 feet to the East line of Wisconsin & Southern Railroad; thence N 25°13'21" E along said East line 940.24 feet to the South line of West Silver Spring Drive; thence N 89°29'21" E, along said South line 417.07 feet to the point of beginning. Said lands containing 534,712 square feet (12.28 acres)

That I have made such survey, land division and map by the direction of Silver Spring Self Storage, LLC, owner of said land.

That such map is a correct representation of all the exterior boundaries of the land surveyed and the land division thereof made.

That I have fully complied with the provisions of Chapter 236.34 of the Wisconsin State Statutes and Chapter 119 of the Milwaukee Code of Ordinances, in surveying, dividing and mapping the same.

May 2, 2010

Date 5/20/10

  
Dennis C. Sauer  
Professional Land Surveyor S-2421

Professional Land Surveyor S-2421

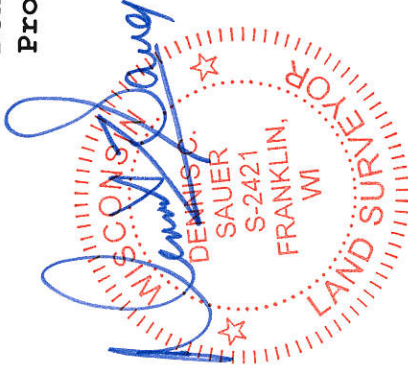

PREPARED FOR:  
Silver Spring Self Storage LLC  
2572 N 94th Street  
Wauwatosa, WI 53226

PREPARED BY: Dennis C. Sauer  
Metropolitan Survey Service, Inc.  
9415 W Forest Home Ave, Suite 202  
Hales Corners, WI 53130

CERTIFIED SURVEY MAP NO. \_\_\_\_\_

Being a redivision of a part of the Northeast 1/4 of the Northeast 1/4 of the Northeast 1/4 of Section 36, Town 8 North, Range 21 East, in the City of Milwaukee, Milwaukee County, Wisconsin

CORPORATE OWNER'S CERTIFICATE OF DEDICATION

Silver Spring Self Storage, LLC, as owner, does hereby certify that they have caused the land described on this map to be surveyed, divided, mapped and dedicated as represented on this map in accordance with Chapter 236.34 of the Wisconsin State Statutes and the requirements of Chapter 119 of the City of Milwaukee Code of Ordinances.

In consideration of the approval of the map by the Common Council and in accordance with Chapter 119 of the Milwaukee Code, the undersigned agrees:

- a) That all utility lines to provide electric power and telephone service and cable television or communication systems, lines or cables to all lots in the certified survey map shall be installed underground in easements provided thereof, where feasible.

This agreement shall be binding on the undersigned and assigns.

IN WITNESS WHEREOF, the said Silver Spring Self Storage, LLC, has caused these presents to be signed at Milwaukee, Wisconsin, this 3rd day of June, 2016.

Cris Schroeder: President  
[Signature]

STATE OF WISCONSIN)  
MILWAUKEE COUNTY) SS

PERSONALLY came before me this 3rd day of JUNE, 2016, Cris Schroeder, President, Silver Spring Self Storage, LLC, Owner, to me known to be the person who executed the foregoing instrument and acknowledged the same.

[Signature]  
Signature

Print Name JAMES R. HENNE  
Notary Public-State of Wisconsin  
My Commission Expires: 9/8/17

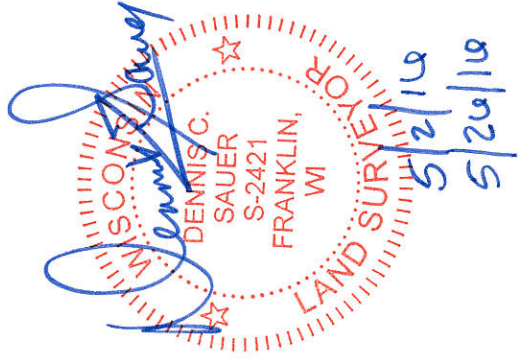

CERTIFIED SURVEY MAP NO. \_\_\_\_\_

Being a redivision of a part of the Northeast 1/4 of the Northeast 1/4 of the Northeast 1/4 of Section 36, Town 8 North, Range 21 East, in the City of Milwaukee, Milwaukee County, Wisconsin

CERTIFICATE OF CITY TREASURER

STATE OF WISCONSIN )  
MILWAUKEE COUNTY ) SS

I, Spencer Coggs, being the duly elected, qualified and acting City Treasurer of the City of Milwaukee, do hereby certify that in accordance with the records in the office of the City Treasurer of the City of Milwaukee there are no unpaid taxes or unpaid special assessments on the land included in this Certified Survey Map.

June 27, 2016  
Date

James J. Kujawa, DEPUTY  
for Spencer Coggs, Treasurer  
City of Milwaukee

COMMON COUNCIL APPROVAL

I certify that this Certified Survey Map was approved and adopted under Resolution File No. 160461, on this 26<sup>th</sup> day of JULY, 2016, by the Common Council of the City of Milwaukee.

Tom Barrett  
Tom Barrett, Mayor  
City of Milwaukee

Richard P. Pff  
James R. Owczarski, City Clerk  
City of Milwaukee

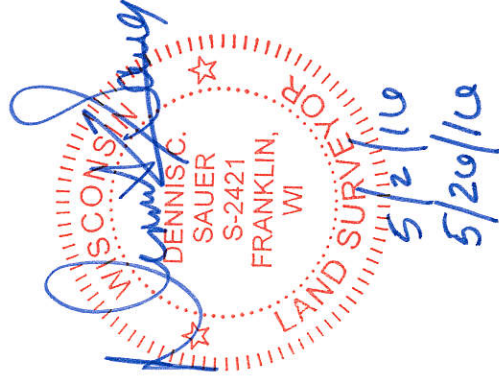

THIS INSTRUMENT WAS DRAFTED BY:  
Dennis C. Sauer, P.L.S. S-2421