

[15517-02] FROEDTERT-FH-EXT-WS1 - Froedtert - Forest Home Health Center - Exterior - Wall sign 1:

Fabricate and install (3) S/F illuminated wall signs, 2'-6" tall x 9'-8" long. Alum sign cabinet & retainers w/ Routed Alum Faces w/ Push-Thru Acrylic Copy, backed w/ White Acrylic. Perforated Vinyl painted "Froedtert Green" appears white when back-lit, applied to 1st surface of ampersand. Internal Illumination w/ White LEDs.

Install at North, West, and South Elevations.

24 Sq. Ft.
25 Sq. Ft. Allowed

APPROVED
Tim Askin , 3/1/2023, 9:48:06 AM

Certificate of Appropriateness

In accordance with the provisions of Section 320-21 (11) and (12) of the Milwaukee Code of Ordinances, the Milwaukee Historic Preservation Commission has issued a certificate of appropriateness for the work listed above. The work was found to be consistent with preservation guidelines.

All work must be done in a craftsman-like manner, and must be completed within one year of the date this certificate was issued. Staff must approve any changes or additions to this certificate before work begins. Work that is not completed in accordance with this certificate may be subject to correction orders or citations. If you require technical assistance, please contact Historic Preservation staff as follows: Phone: (414) 286-5712 or 286-5722 or hpc@milwaukee.gov

If permits are required, you are responsible for obtaining them from the Milwaukee Development Center. If you have questions about permit requirements, please consult the Development Center's web site, www.milwaukee.gov/lms, or call (414) 286-8210.

Color Schedule:

- [C-1] MP Satin Finish, Painted to Match 3M 3630-157 "Sultan Blue"
- [C-2] MAP Satin Finish, Painted to Match 3M 3630-76 "Holly Green"
- [C-3] Perforated Vinyl Film, Painted to Match 3M 3630-76 "Holly Green"
- [C-4] #7328 White Acrylic Faces, backing 1/2" Thk Clear Push-Thru Lettering



1827 W. Glendale Ave. Milwaukee, WI 53209
414.264.5504
414.262.5564
www.signeffectz.com

Disclaimer:
THIS IS AN ORIGINAL DESIGN CREATED BY SIGN EFFECTZ. THE SUBMITTED DESIGN PROTECTED UNDER COPYRIGHT LAWS OF THE UNITED STATES CODE YOU AGREE NOT TO COPY PHOTOGRAPH MODIFY OR SHARE DIRECTLY OR INDIRECTLY ANY OF THE FOREGOING HELD BY YOU WITH ANY OTHER PARTY, NOR WILL YOU PERMIT ANY THIRD PARTY TO DO ANY OF THE FOREGOING WITHOUT THE WRITTEN CONSENT OF SIGN EFFECTZ.

THIS SIGN IS INTENDED TO BE INSTALLED IN ACCORDANCE WITH THE REQUIREMENTS OF ARTICLE 600 OF THE NEC AND/OR OTHER APPLICABLE LOCAL CODES. THIS INCLUDES PROPER GROUNDING AND BONDING OF THE SIGN.

Froedtert - Forest Home Health Center Exterior Signs

[15517-01] FROEDTERT-FH-EXT-SURVEY:

[15517-02] FROEDTERT-FH-EXT-WS1 - Froedtert - Forest Home Health Center - Exterior - Wall sign 1: Fabricate and install (3) S/F illuminated wall signs, 2'-6" tall x 9'-8" long. Alum sign cabinet & retainers w/ polycarbonate face and 1st surface vinyl graphics. Lit w/ White LED's.

[15517-03] FROEDTERT-FH-EXT-WS2 - Froedtert - Forest Home Health Center - Exterior - Wall sign 2: Fabricate and install (1) S/F Non-Lit Wall Sign, 3'-0"H x 16'3"L x 2"D, painted w/ 1st surface vinyl graphics.

[15517-04] PERMIT PROCUREMENT:

Project Address:
Froedtert Hospital
1316 W. Forest Home Ave
Milwaukee, WI 53204
Billing Address:
Froedtert Hospital
7901 S. 6th St.
Oak Creek, WI 53154

Rev.	Description	Date	Init
01			
02			
03			
04			
05			
06			
07			
08			
09			
10			

Project Notes:
TECHNICAL FIELD SURVEY REQ'D FOR ALL SIGNS IN SCOPE.

APPROVAL ON ALL SIZES AND FINISHES REQ'D.

Copyright © 2023 Sign Effectz Inc. All Rights Reserved

AAE	JCB	NB	<input type="checkbox"/> SRFR	<input type="checkbox"/> CUSTOMER APPROVAL
DRAWN BY:	MGR:	CHK BY:	<input type="checkbox"/> PERMIT	<input type="checkbox"/> SURVEY
			<input type="checkbox"/> COMPLETED:	<input type="checkbox"/> ENG
DATE:	02/24/23	SCALE:	3/4" = 1' - 0"	
B	36316985	P_01	00	
SIZE:	PROJECT NO:	SHEET NO:	REV	
PRODUCTION RELEASE NO:		1	VERSION:	.0
15697	15517	-	02	
ESTIMATE NO:	WORK ORDER NO.		ITEM	



2 Left Side View
P_01 3/4" = 1' - 0" Scale

1 S/F Face-Lit, Push-Thru Acrylic ID Sign - 24SF
P_01 (x3) Req'd 3/4" = 1' - 0" Scale

3 Right Side View
P_01 3/4" = 1' - 0" Scale

[15517-03] FROEDTERT-FH-EXT-WS2 - Froedtert - Forest Home Health Center - Exterior - Wall sign 2:

Fabricate and install (1) S/F Non-Lit Wall Sign, 3'-0"H x 16'3"L x 2"D, painted w/ 1st surface vinyl graphics.

Install at South Elevation Drive Thru.
48.75 Sq. Ft.

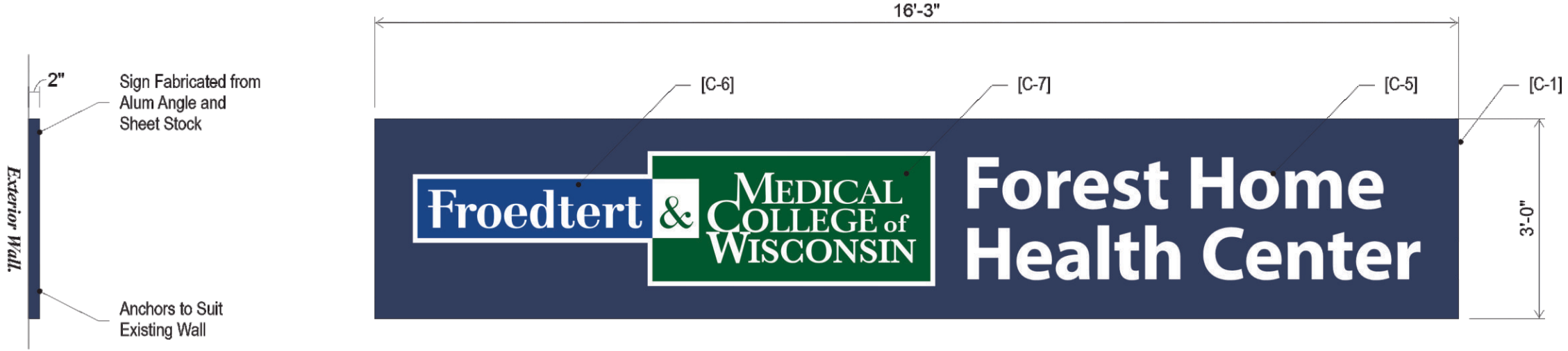

2 Left Side View
P_02 3/4" = 1' - 0" Scale

1 S/F Face-Lit, Push-Thru Acrylic ID Sign - 24SF
P_02 (1) Req'd 1/2" = 1' - 0" Scale

Color Schedule:

- [C-1] MP 3597 "Indigo" Satin Paint Finish
- [C-5] 3M 7725-20 "Matte White" Vinyl Film, 1st surface applied
- [C-6] 3M 3630-157 "Sultan Blue" Vinyl Film, 1st surface applied
- [C-7] 3M 3630-76 "Holly Green" Vinyl Film, 1st surface applied



PROPOSED SOUTH ELEV - NON-LIT SIGN - NTS

Disclaimer:
THIS IS AN ORIGINAL DESIGN CREATED BY SIGN EFFECTZ. THE SUBMITTED DESIGN PROTECTED UNDER COPYRIGHT LAWS OF THE UNITED STATES CODE YOU AGREE NOT TO COPY PHOTOGRAPH MODIFY OR SHARE DIRECTLY OR INDIRECTLY ANY OF THE FOREGOING HELD BY YOU WITH ANY OTHER PARTY, NOR WILL YOU PERMIT ANY THIRD PARTY TO DO ANY OF THE FOREGOING WITHOUT THE WRITTEN CONSENT OF SIGN EFFECTZ.

THIS SIGN IS INTENDED TO BE INSTALLED IN ACCORDANCE WITH THE REQUIREMENTS OF ARTICLE 600 OF THE NEC AND/OR OTHER APPLICABLE LOCAL CODES. THIS INCLUDES PROPER GROUNDING AND BONDING OF THE SIGN.

Froedtert - Forest Home Health Center Exterior Signs

[15517-01] FROEDTERT-FH-EXT-SURVEY:

[15517-02] FROEDTERT-FH-EXT-WS1 - Froedtert - Forest Home Health Center - Exterior - Wall sign 1:
Fabricate and install (3) S/F illuminated wall signs, 2'-6" tall x 9'-8" long. Alum sign cabinet & retainers w/ polycarbonate face and 1st surface vinyl graphics. Lit w/ White LED's.

[15517-03] FROEDTERT-FH-EXT-WS2 - Froedtert - Forest Home Health Center - Exterior - Wall sign 2:
Fabricate and install (1) S/F Non-Lit Wall Sign, 3'-0"H x 16'3"L x 2"D, painted w/ 1st surface vinyl graphics.

[15517-04] PERMIT PROCUREMENT:

Project Address:
Froedtert Hospital
1316 W. Forest Home Ave
Milwaukee, WI 53204

Billing Address:
Froedtert Hospital
7901 S. 6th St.
Oak Creek, WI 53154

Rev.	Description	Date	Init
01			
02			
03			
04			
05			
06			
07			
08			
09			
10			

Project Notes:

TECHNICAL FIELD SURVEY REQ'D FOR ALL SIGNS IN SCOPE.

APPROVAL ON ALL SIZES AND FINISHES REQ'D.

Copyright © 2023 Sign Effectz Inc. All Rights Reserved

AAE	JCB	NB	<input type="checkbox"/> SRFR	<input type="checkbox"/> CUSTOMER APPROVAL
DRAWN BY:	MGR:	CHK BY:	<input type="checkbox"/> PERMIT	<input type="checkbox"/> SURVEY
			<input type="checkbox"/> COMPLETED:	<input type="checkbox"/> ENG

DATE: 02/24/23 SCALE: 3/4" = 1' - 0"

B	36316985	P_02	00
SIZE:	PROJECT NO:	SHEET NO:	REV

PRODUCTION RELEASE NO:	1	VERSION:	.0
------------------------	---	----------	----

15697	15517	-	02
ESTIMATE NO:	WORK ORDER NO.		ITEM

Disclaimer:
 THIS IS AN ORIGINAL DESIGN CREATED BY SIGN EFFECTTZ. THE SUBMITTED DESIGN PROTECTED UNDER COPYRIGHT LAWS OF THE UNITED STATES CODE YOU AGREE NOT TO COPY PHOTOGRAPH MODIFY OR SHARE DIRECTLY OR INDIRECTLY ANY OF THE FOREGOING HELD BY YOU WITH ANY OTHER PARTY, NOR WILL YOU PERMIT ANY THIRD PARTY TO DO ANY OF THE FOREGOING WITHOUT THE WRITTEN CONSENT OF SIGN EFFECTTZ.

THIS SIGN IS INTENDED TO BE INSTALLED IN ACCORDANCE WITH THE REQUIREMENTS OF ARTICLE 600 OF THE NEC AND/OR OTHER APPLICABLE LOCAL CODES. THIS INCLUDES PROPER GROUNDING AND BONDING OF THE SIGN.

**Froedtert - Forest Home Health Center
 Exterior Signs**

[15517-01] FROEDTERT-FH-EXT-SURVEY:

[15517-02] FROEDTERT-FH-EXT-WS1 - Froedtert - Forest Home Health Center - Exterior - Wall sign 1:
 Fabricate and install (3) S/F illuminated wall signs, 2'-6" tall x 9'-8" long. Alum sign cabinet & retainers w/ polycarbonate face and 1st surface vinyl graphics. Lit w/ White LED's.

[15517-03] FROEDTERT-FH-EXT-WS2 - Froedtert - Forest Home Health Center - Exterior - Wall sign 2:
 Fabricate and install (1) S/F Non-Lit Wall Sign, 3'-0"H x 16'3"L x 2"D, painted w/ 1st surface vinyl graphics.

[15517-04] PERMIT PROCUREMENT:

Project Address:
 Froedtert Hospital
 1316 W. Forest Home Ave
 Milwaukee, WI 53204

Billing Address:
 Froedtert Hospital
 7901 S. 6th St.
 Oak Creek, WI 53154

Rev.	Description	Date	Init
01			
02			
03			
04			
05			
06			
07			
08			
09			
10			

Project Notes:

TECHNICAL FIELD SURVEY REQ'D FOR ALL SIGNS IN SCOPE.

APPROVAL ON ALL SIZES AND FINISHES REQ'D.

Copyright © 2023 Sign Effecttz Inc. All Rights Reserved

AAE	JCB	NB	<input type="checkbox"/> SRFR	<input type="checkbox"/> CUSTOMER APPROVAL
DRAWN BY:	MGR:	CHK BY:	<input type="checkbox"/> PERMIT	<input type="checkbox"/> SURVEY
			<input type="checkbox"/> COMPLETED:	<input type="checkbox"/> ENG

DATE: 02/24/23 SCALE: NOT TO SCALE

B	36316985	P_03	00
SIZE:	PROJECT NO:	SHEET NO:	REV

PRODUCTION RELEASE NO: 1 VERSION: .0

15697	15517	-	02
ESTIMATE NO:	WORK ORDER NO.		ITEM

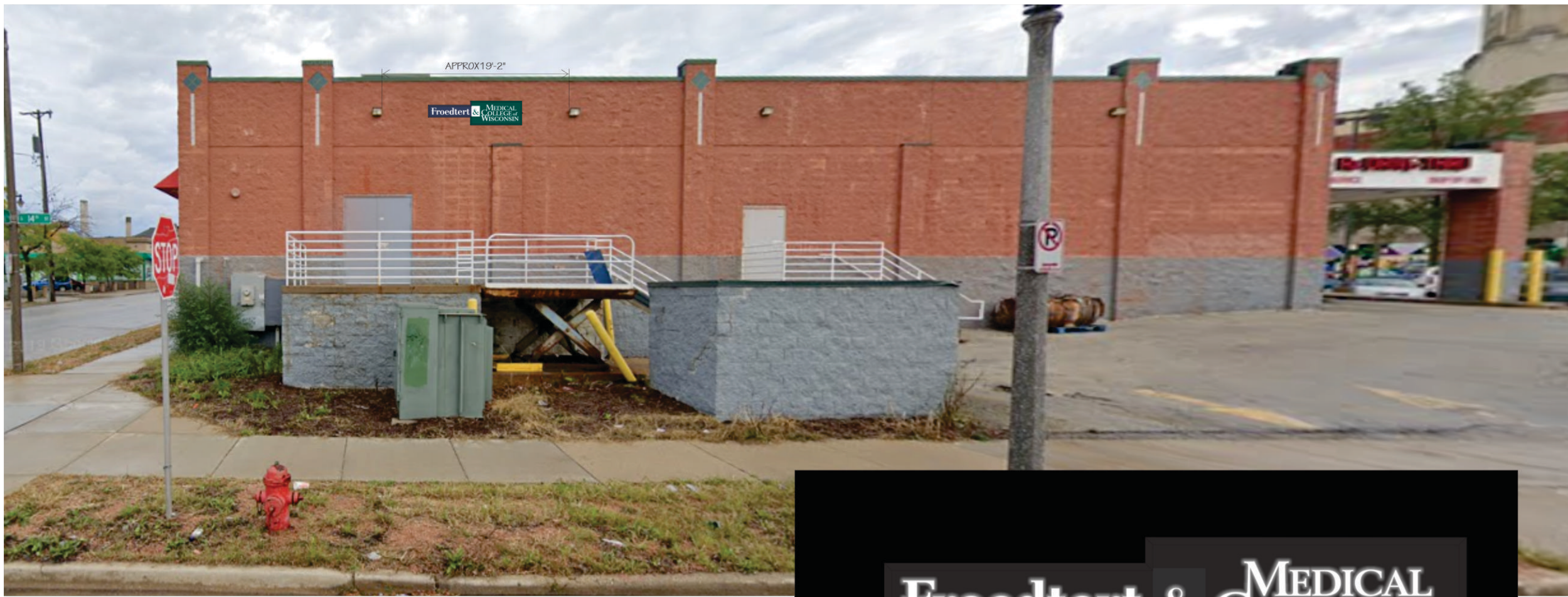

PROPOSED WEST ELEV ID SIGN - NTS



SIMULATED NIGHT VIEW - NTS



PROPOSED NORTH ELEV ID SIGN - NTS



PROPOSED SOUTH ELEV ID SIGN - NTS

Disclaimer:
 THIS IS AN ORIGINAL DESIGN CREATED BY SIGN EFFECTTZ. THE SUBMITTED DESIGN PROTECTED UNDER COPYRIGHT LAWS OF THE UNITED STATES CODE YOU AGREE NOT TO COPY PHOTOGRAPH MODIFY OR SHARE DIRECTLY OR INDIRECTLY ANY OF THE FOREGOING HELD BY YOU WITH ANY OTHER PARTY, NOR WILL YOU PERMIT ANY THIRD PARTY TO DO ANY OF THE FOREGOING WITHOUT THE WRITTEN CONSENT OF SIGN EFFECTTZ.

THIS SIGN IS INTENDED TO BE INSTALLED IN ACCORDANCE WITH THE REQUIREMENTS OF ARTICLE 600 OF THE NEC AND/OR OTHER APPLICABLE LOCAL CODES. THIS INCLUDES PROPER GROUNDING AND BONDING OF THE SIGN.

**Froedtert - Forest Home Health Center
 Exterior Signs**

[15517-01] FROEDTERT-FH-EXT-SURVEY:

[15517-02] FROEDTERT-FH-EXT-WS1 - Froedtert - Forest Home Health Center - Exterior - Wall sign 1:
 Fabricate and install (3) S/F illuminated wall signs, 2'-6" tall x 9'-8" long. Alum sign cabinet & retainers w/ polycarbonate face and 1st surface vinyl graphics. Lit w/ White LED's.

[15517-03] FROEDTERT-FH-EXT-WS2 - Froedtert - Forest Home Health Center - Exterior - Wall sign 2:
 Fabricate and install (1) S/F Non-Lit Wall Sign, 3'-0"H x 16'3"L x 2"D, painted w/ 1st surface vinyl graphics.

[15517-04] PERMIT PROCUREMENT:

Project Address:
 Froedtert Hospital
 1316 W. Forest Home Ave
 Milwaukee, WI 53204

Billing Address:
 Froedtert Hospital
 7901 S. 6th St.
 Oak Creek, WI 53154

Rev.	Description	Date	Init
01			
02			
03			
04			
05			
06			
07			
08			
09			
10			

Project Notes:

TECHNICAL FIELD SURVEY REQ'D FOR ALL SIGNS IN SCOPE.

APPROVAL ON ALL SIZES AND FINISHES REQ'D.

Copyright © 2023 Sign Effecttz Inc. All Rights Reserved

AAE JCB NB SRFR CUSTOMER APPROVAL
 DRAWN BY: MGR: CHK BY: PERMIT SURVEY ENG
 COMPLETED:

DATE: 02/24/23 SCALE: NOT TO SCALE

B 36316985 P_04 00
 SIZE. PROJECT NO. SHEET NO. REV

PRODUCTION RELEASE NO: 1 VERSION: .0

15697 15517 - 02
 ESTIMATE NO. WORK ORDER NO. ITEM

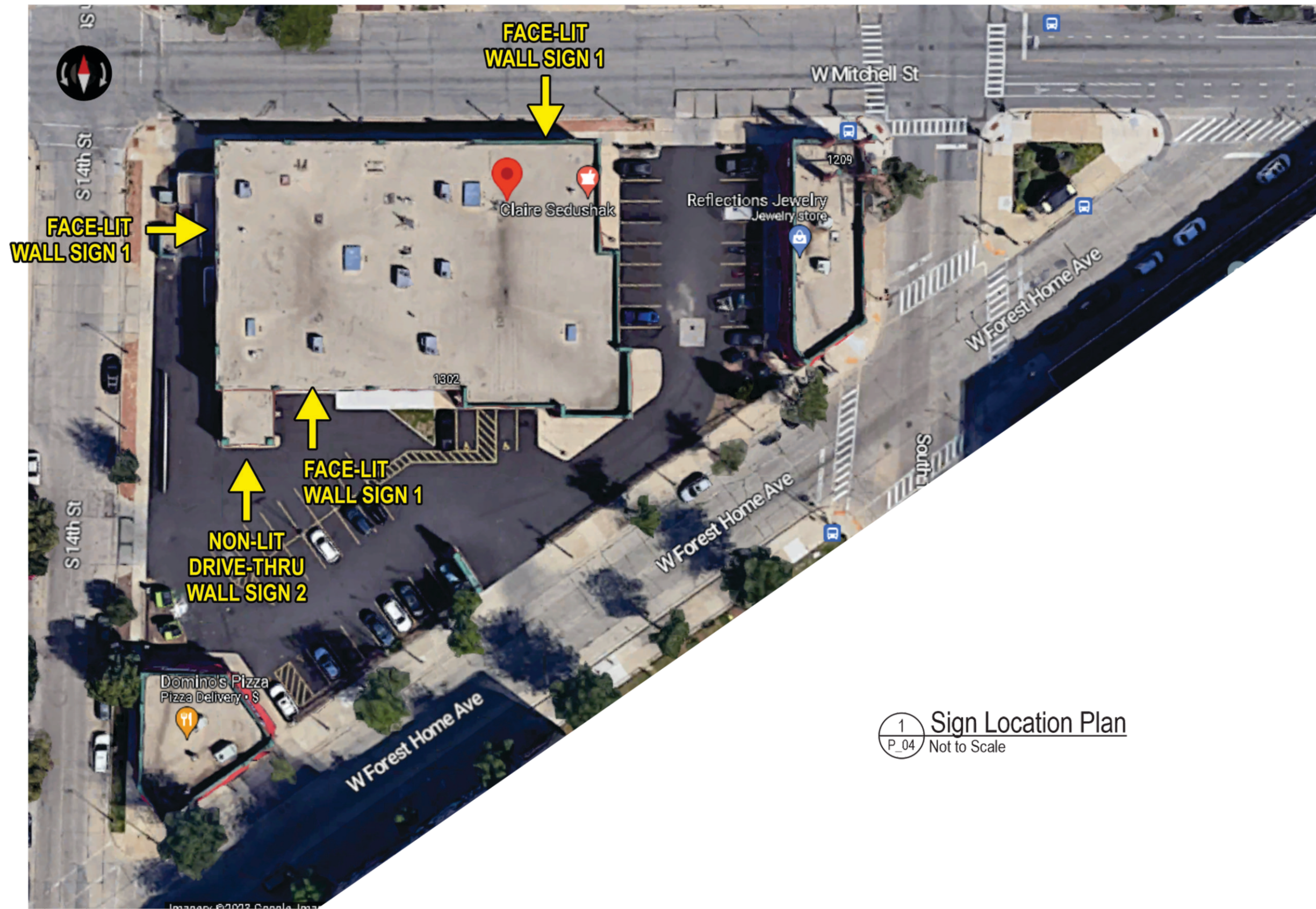

1 Sign Location Plan
 P_04 Not to Scale

D
C
B
A